



INSTALLATION INSTRUCTIONS

Accessory
BLACK EMBLEM

Application
**2024 RIDGELINE
MODEL SERIES**

Publications No.
VERSION 1
Issue Date
NOV 2023

GENERAL VIEW

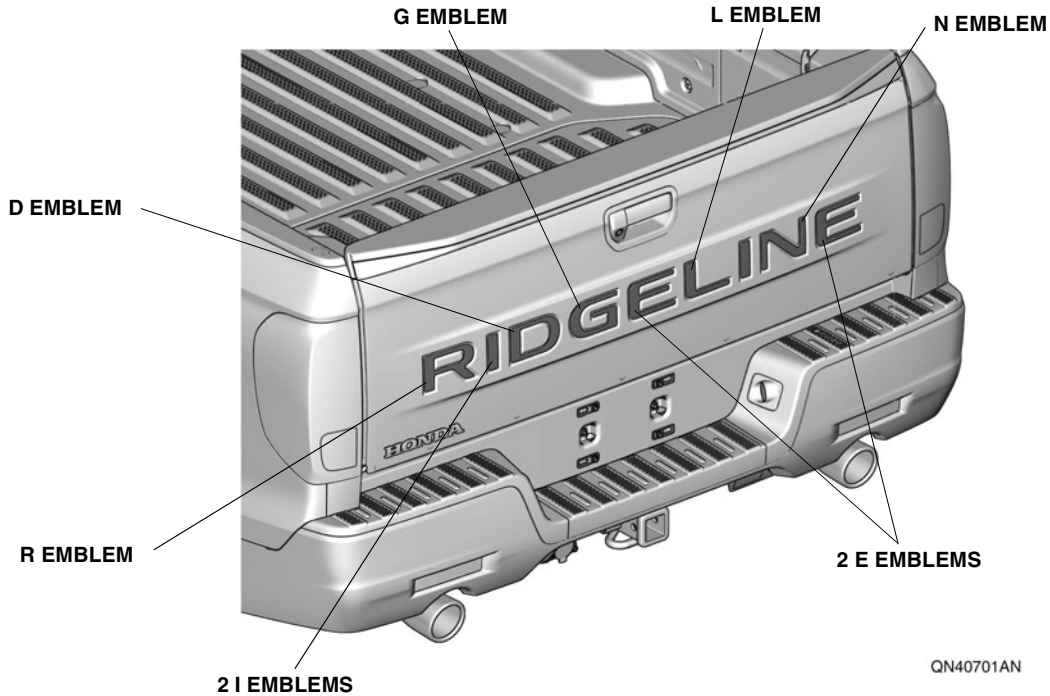

FOR YOUR SAFETY (Read carefully.)

Warning Symbols

Safety: Your safety, and the safety of others, is important. To help you make informed decisions about service procedures, we have provided safety messages where appropriate. Of course, it is not practical or possible to warn you about all the hazards associated with servicing a vehicle - you must use your own good judgment.

You will find important safety messages preceded by one of the following symbols:

*All symbols are not used in all installation instructions.

⚠ DANGER

You will be killed or seriously hurt if you do not follow the instructions.

⚠ WARNING

You can be killed or seriously hurt if you do not follow the instructions.

⚠ CAUTION

You can be hurt if you do not follow the instructions.

NOTICE

Gives advice to prevent damage to the product, vehicle, the environment or other property.

NOTE

Gives helpful information or instructions to be followed when installing this product.



Indicates a prohibited action.

Procedure and Location Icons

These icons indicate the work location and the worker's point of view.

*All icons are not used in all installation instructions.

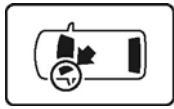

The location on the vehicle.

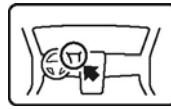

The location in the vehicle.
(Instrument panel.)



Wear eye protection.



Wear heavy gloves.



Use an assistant.



Place the part on a blanket.



Work perpendicular.



Remove any burrs.



Use touch-up paint and allow to dry.



Tighten to the specified torque.



Apply firm pressure while rolling, especially at the ends, to set the adhesive.



Press firmly.



Clean with isopropyl alcohol.



Return the original part to the customer.
(Do not reuse.)

Safety: General

- Be careful not to damage the vehicle or the parts.
- The illustrations may differ slightly from the actual accessory.

Safety: Accessory

- Always use the parts and tools specified in the installation instructions.
- Do not install the accessory on a dirty surface or in direct sunlight.
- Make sure the ambient air temperature is 60°F (15°C) or above when installing accessories that use adhesive material.
- When pressing the accessory firmly with the palm of your hand, be careful not to damage it or the vehicle.
- When applying adhesive material, make sure it is lined up properly before attaching. Once the adhesive material touches the surface, do not try to remove it. If you do, you could damage the part.
- Do not wash the vehicle for 24 hours to allow the adhesive to cure.

PARTS LIST

Black Emblem Kit (P/N 08F20-T6Z-100C)

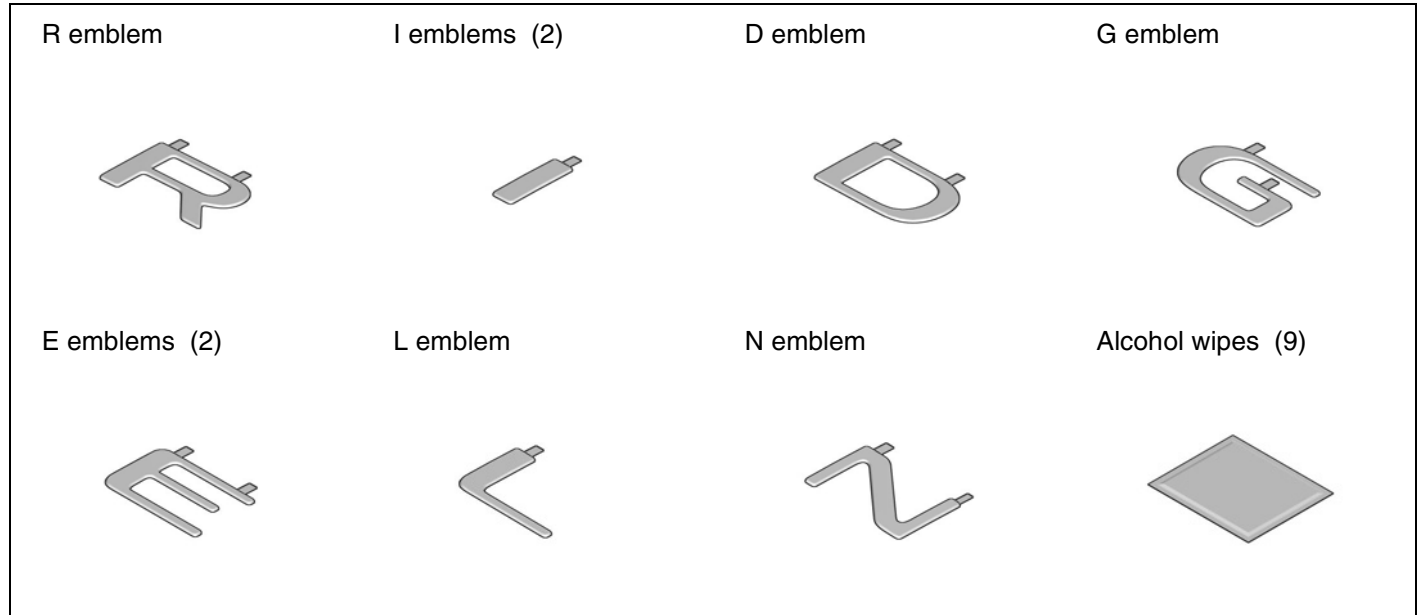

REQUIRED TOOLS AND SUPPLIES

- Masking tape
- Ruler

The following tool is available through the Honda Tool and Equipment Program:
Rubber Roller (T/N MHLE54D)

INSTALLATION

1. Clean the attaching areas.

NOTE

Allow to dry thoroughly.

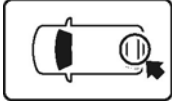

TAILGATE

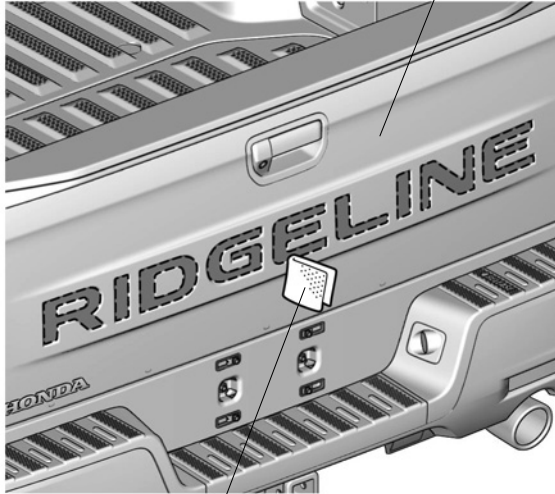

9 ALCOHOL WIPES

QN40702AN

2. Line up the R emblem.

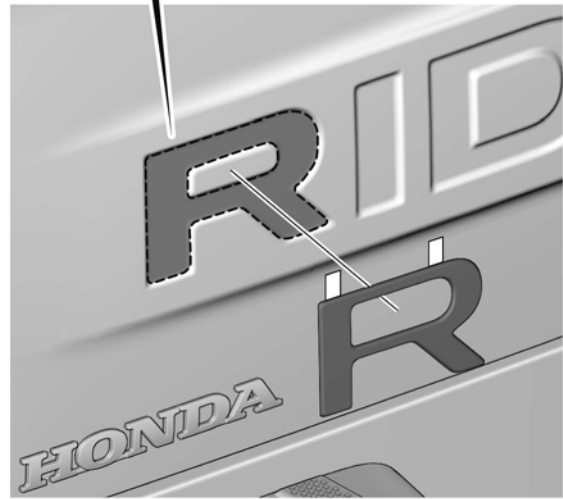
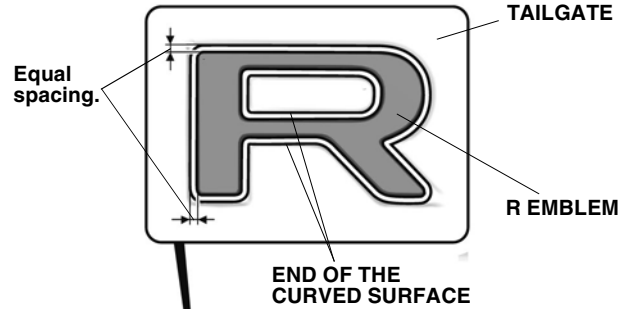
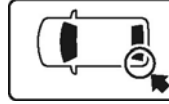

QN40703BN

3. Loosely secure the R emblem.

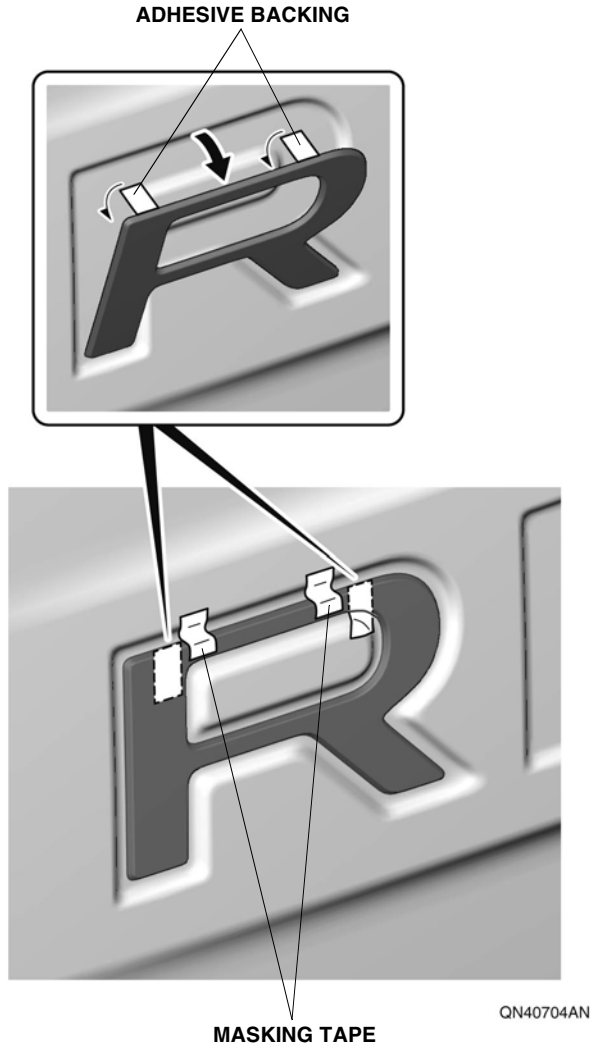

4. Secure the R emblem.

NOTE
Check the position of the double-sided adhesive tape and make sure to press firmly.

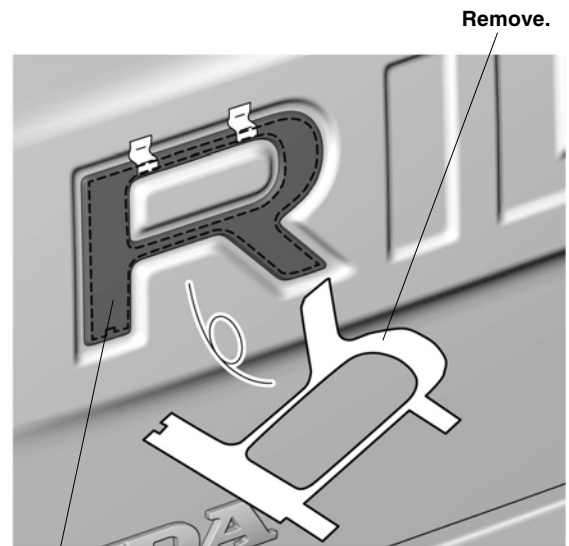
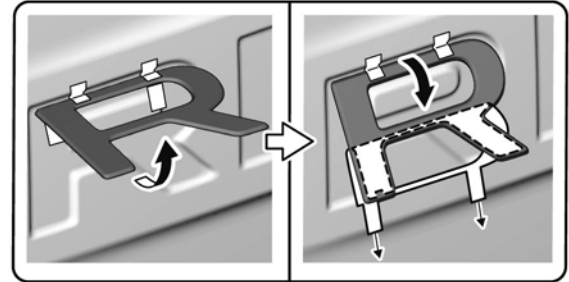

DOUBLE-SIDED
ADHESIVE TAPE



5. Remove the masking tape.

6. Secure the R emblem.



7. Line up the I emblem.

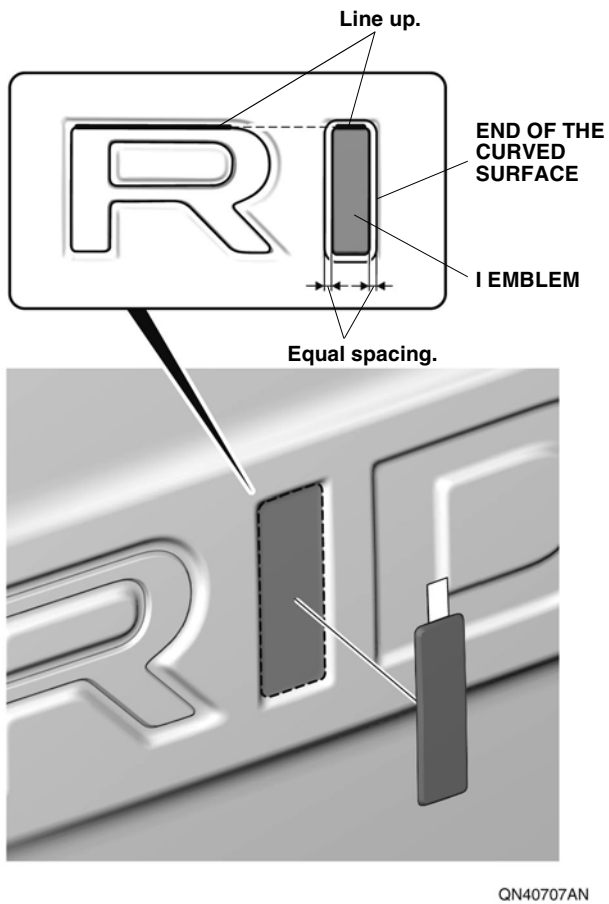

8. Loosely secure the I emblem.

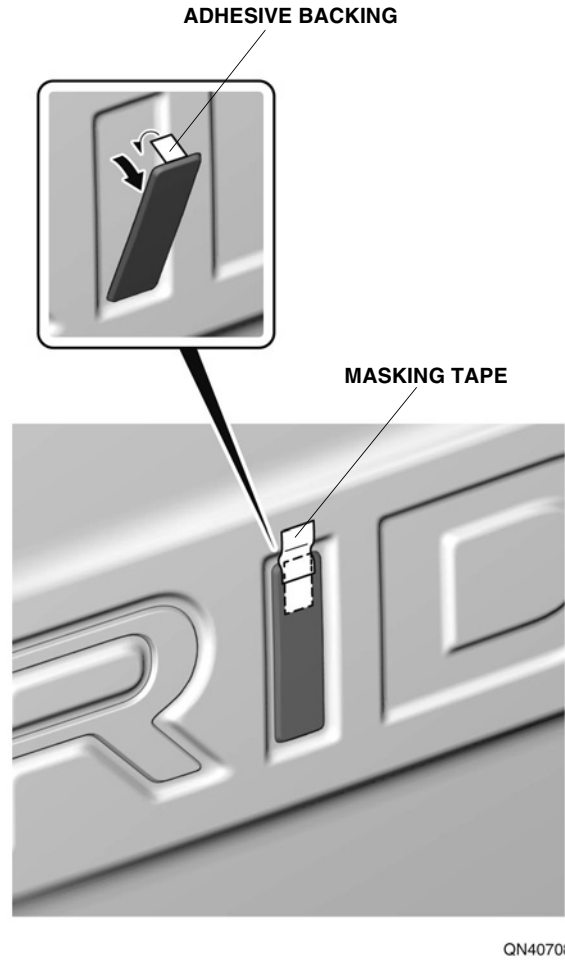

9. Secure the I emblem.

NOTE

Check the position of the double-sided adhesive tape and make sure to press firmly.

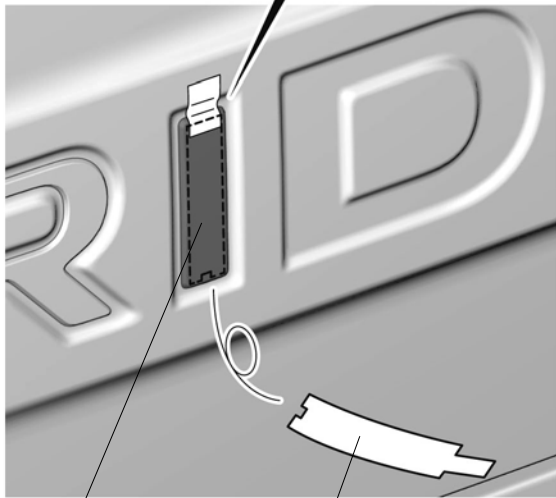
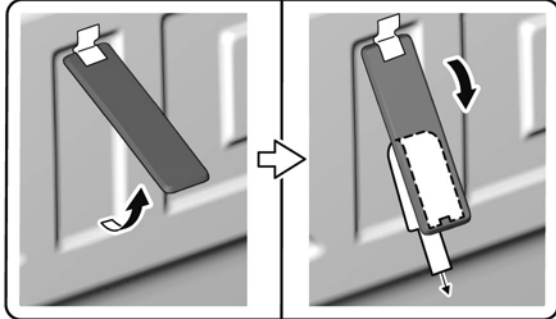

DOUBLE-SIDED ADHESIVE TAPE



Remove.

QN40709AN

10. Remove the masking tape.

11. Secure the I emblem.

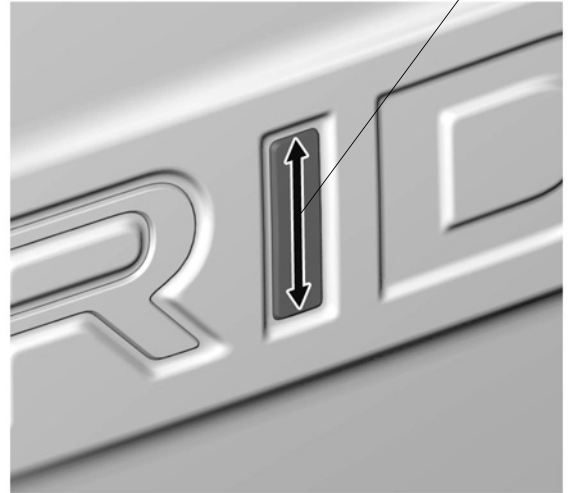

QN40710AN

12. Repeat steps 7 through 11 for the D emblem.

13. Line up the G emblem.

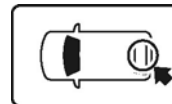

D EMBLEM

Line up.

END OF THE CURVED SURFACE

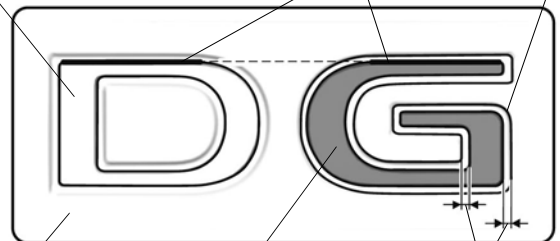

TAILGATE

G EMBLEM

Equal spacing.



QN40711AN

14. Loosely secure the G emblem.

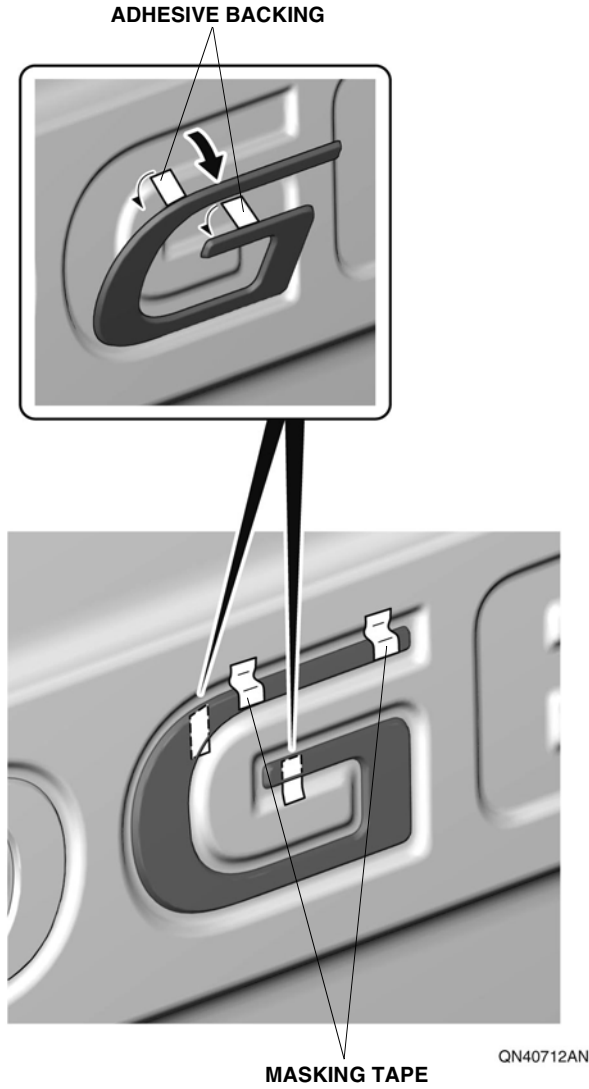

15. Secure the G emblem.

NOTE
Check the position of the double-sided adhesive tape and make sure to press firmly.

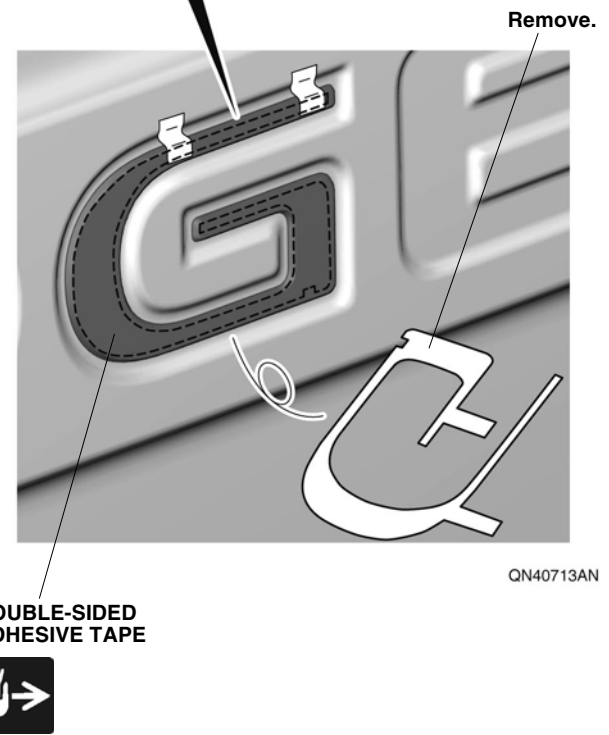
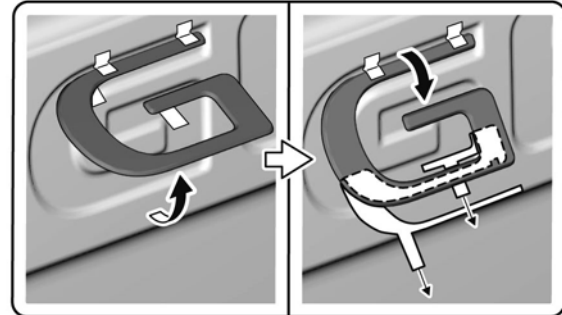

16. Remove the masking tape.

17. Secure the G emblem.



QN40714AN

18. Repeat steps 7 through 11 for the E, L and I emblems.

NOTE

When lining up the I emblem ensure you are using the top of the L emblem as reference for consistency.

19. Line up the N emblem.

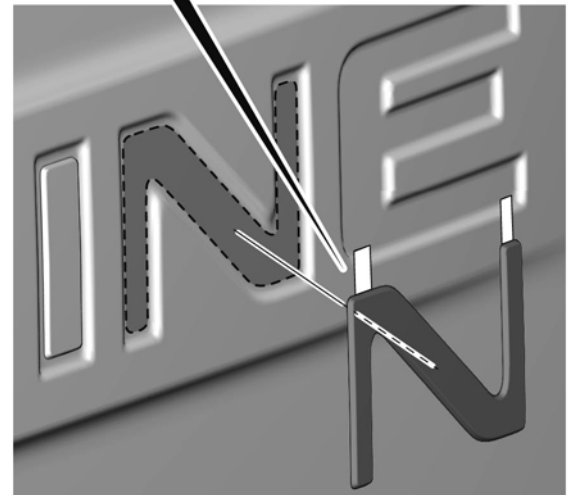
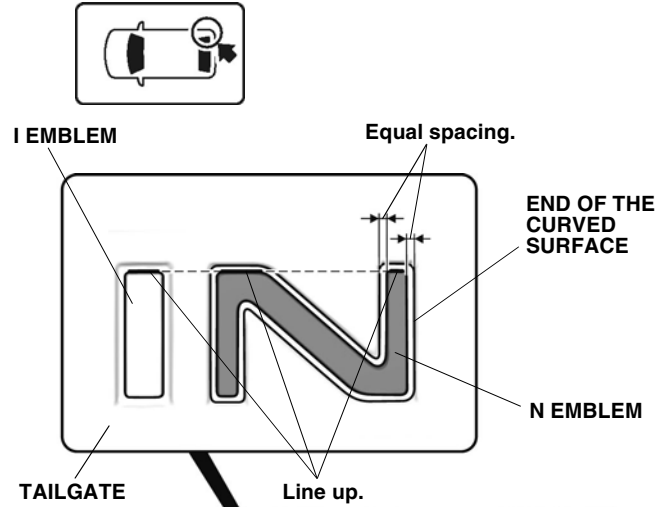

QN40715AN

20. Loosely secure the N emblem.

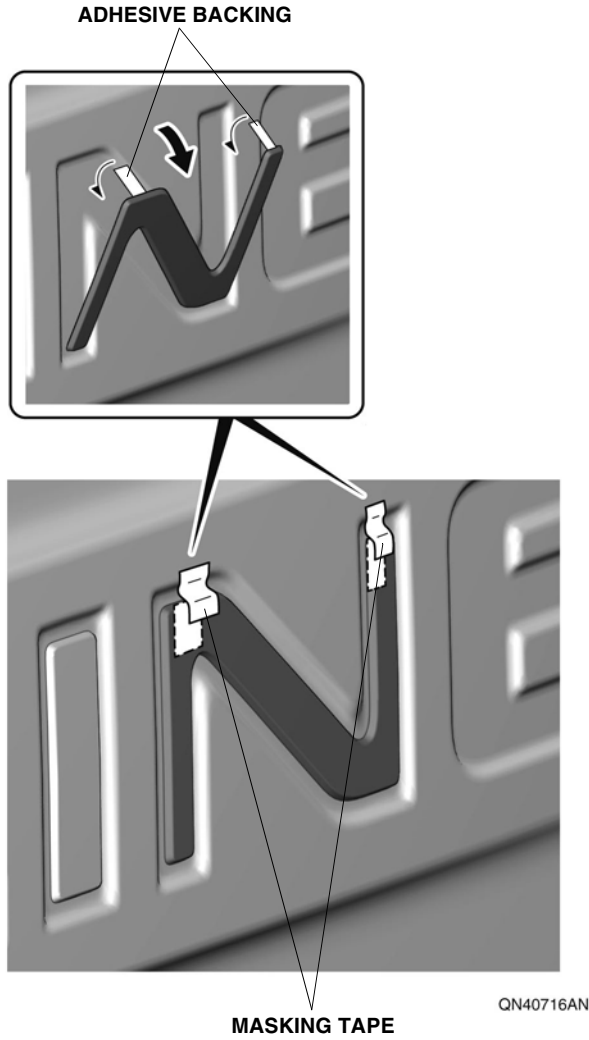

21. Secure the N emblem.

NOTE
Check the position of the double-sided adhesive tape and make sure to press firmly.

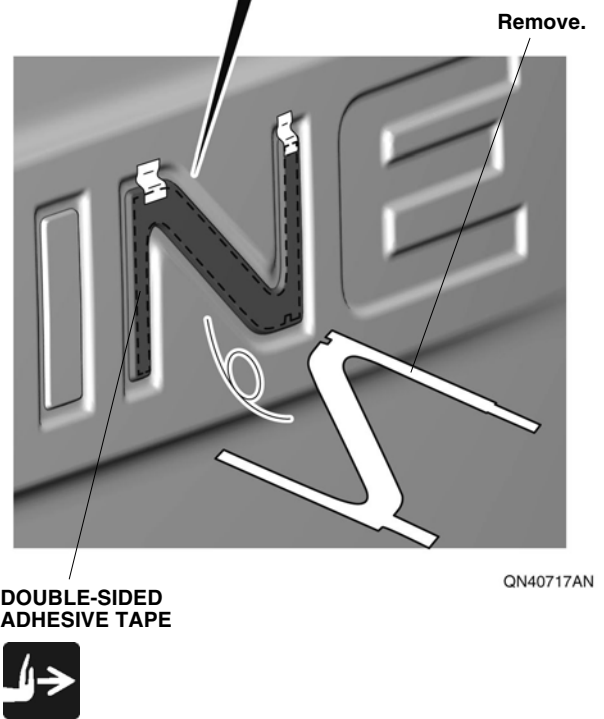
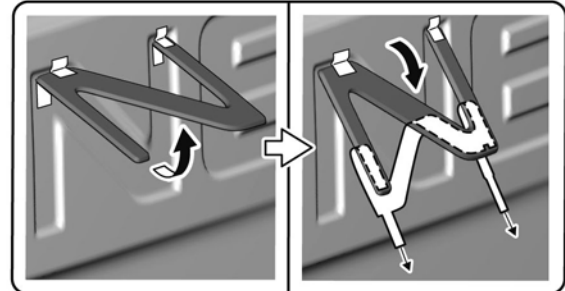

22. Remove the masking tape.

23. Secure the N emblem.

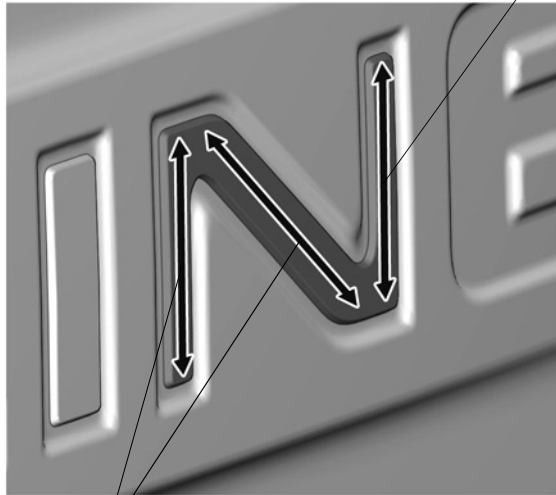

QN40718AN



- 24. Repeat steps 7 through 11 for the E emblem.
- 25. Check that all parts are installed properly.