



## INSTALLATION INSTRUCTIONS

Accessory

WIRELESS CHARGER

Application

2021 RIDGELINE

Publications No.

VERSION 1

Issue Date

JAN 2021

## GENERAL VIEW

WIRELESS CHARGER UNIT

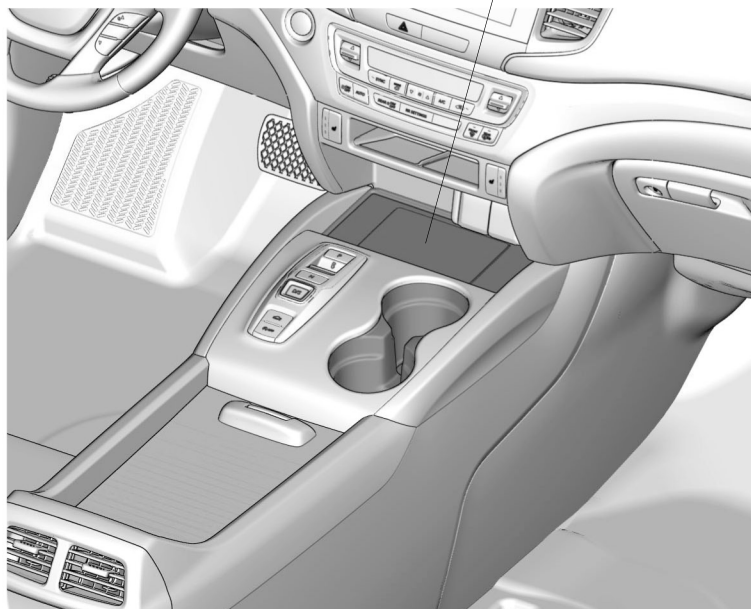

QK70701BG

## FOR YOUR SAFETY (Read carefully.)

### Warning Symbols

Safety: Your safety, and the safety of others, is important. To help you make informed decisions about service procedures, we have provided safety messages where appropriate. Of course, it is not practical or possible to warn you about all the hazards associated with servicing a vehicle - you must use your own good judgment.

You will find important safety messages preceded by one of following symbols:

\*All symbols are not used in all installation instructions.

**⚠ DANGER**

You will be killed or seriously hurt if you do not follow the instructions.

**⚠ WARNING**

You can be killed or seriously hurt if you do not follow the instructions.

**⚠ CAUTION**

You can be hurt if you do not follow the instructions.

**NOTICE**

Gives advice to prevent damage to the product or vehicle or the environment.

**NOTE**

Gives helpful information or instructions to be followed when using the product.



Indicates a prohibited action

## Procedure and Location Icons

These icons indicate the work location and the worker's point of view.

\*All icons are not used in all installation instructions.

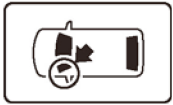

The location on the vehicle.

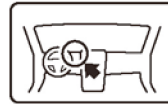

The location in the vehicle.  
(instrument panel.)



Wear eye protection.



Wear heavy gloves.



Use an assistant.



Place the part on a blanket.



Work perpendicular.



Remove any burrs.



Use touch-up paint and allow to dry.



Tighten to the specified torque.



Apply firm pressure while rolling, especially at the ends, to set the adhesive.



Press firmly.



Clean with isopropyl alcohol.



Return the original part to the customer.  
(Do not use.)

## Wire Harness Routing Precautions

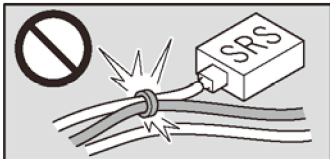

Do not secure the accessory harness and SRS harness together. (except for instruction cases).

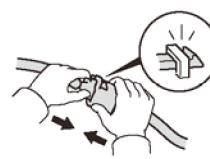

Push the connectors and terminals together until they lock.

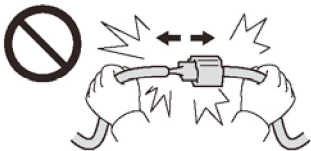

Do not pull the harness to unplug the connectors.

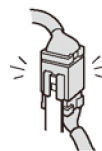

Install removed connectors in their original location.

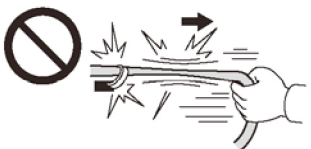

Do not pull the harness.



Secure the accessory harness as shown.



Do not pinch the harness.

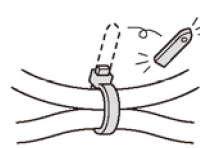

Cut off the excess wire tie.

## Safety: General

- Observe all safety notes and precautions described in the service information, in addition to those described in this Installation Instruction. Be extremely careful for your safety and the safety of others.
- Be careful not to damage the vehicle or the parts.
- Be extremely careful when handling retaining tabs and clips.
- Note the locations of the parts before removing them so they can be properly installed in their original positions.
- The illustrations may differ slightly from the actual accessory.

## Safety: Electric Parts

- Always disconnect the negative cable from the battery before beginning work.

## Safety: Accessory

- Always use the parts and tools specified in the installation instructions.

## PARTS LIST

### Console Panel Kit (P/N 08U58-TG7-100C)

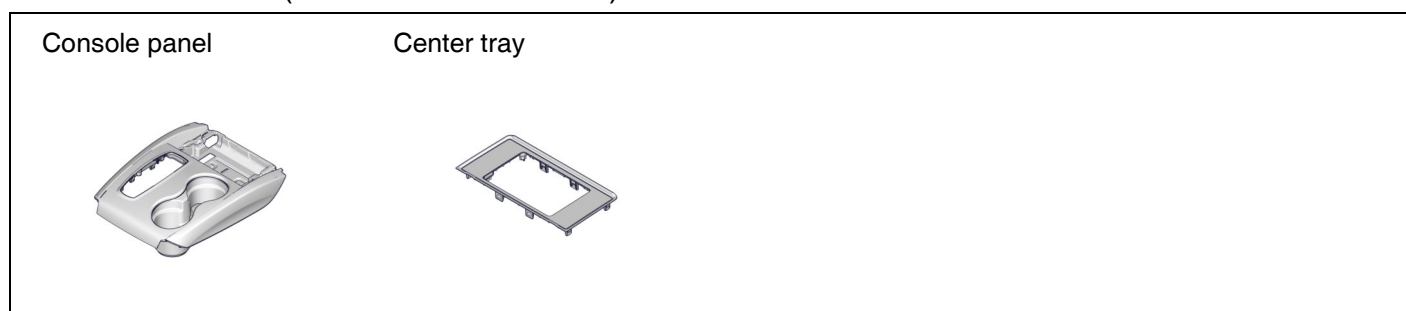

### Wireless Charger Kit (P/N 08U58-TG7-100)



## REQUIRED TOOLS AND SUPPLIES

- 10 mm Open end wrench
- Phillips screwdriver
- Shop towel

The following tools are available through the Honda Tool and Equipment Program:

- Trim Tool Set (T/N SOJATP2014)
- Plastic Trim Tool (T/N SILTRIMTL10)

## INSTALLATION

1. Wrap a shop towel.

### NOTE

Do not remove the shop towel until after the parts are installed.

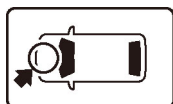

HOOD LATCH  
LEVER

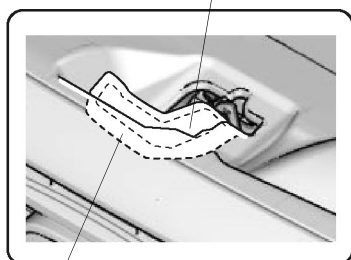

SHOP  
TOWEL

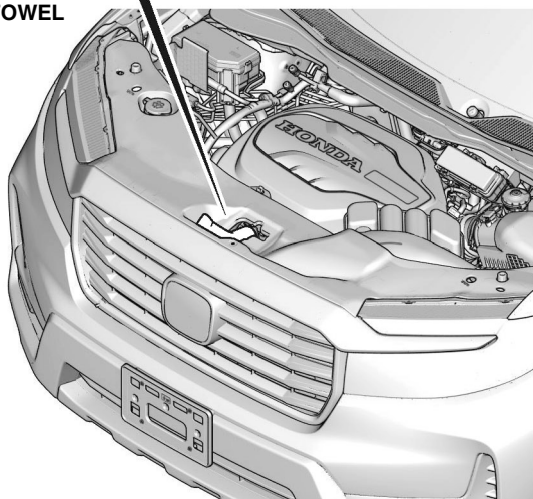

QK63002AG

2. Remove the front bulkhead cover.

10 CLIPS

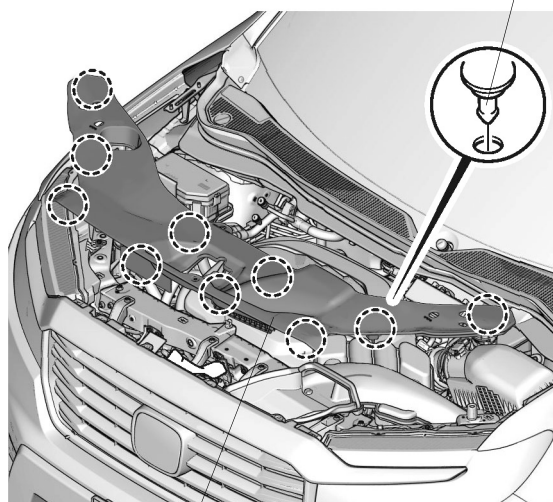

QK63003AG

FRONT BULKHEAD  
COVER

3. Remove the intake air tube.

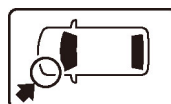

2 CLIPS

INTAKE  
AIR TUBE

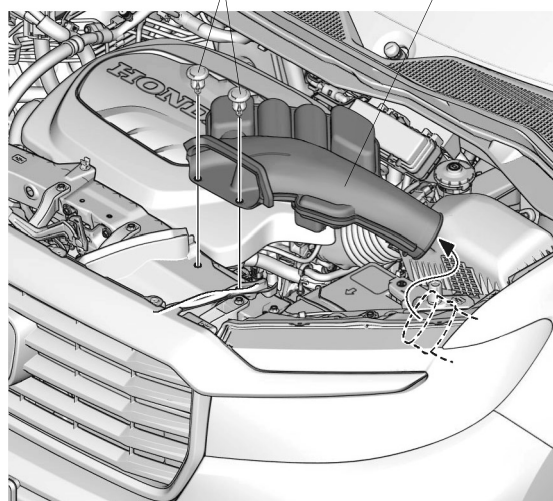

QK63004AG



4. Disconnect the negative cable from the battery.

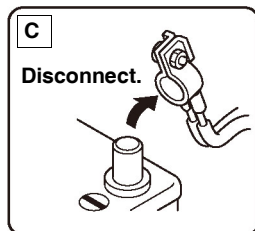
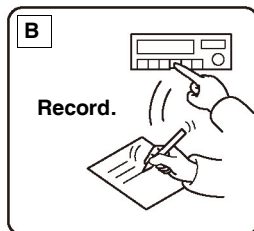
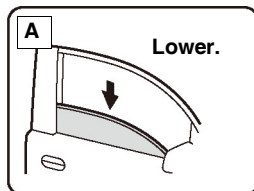

QCD0502BM

5. Remove the center tray.

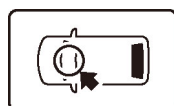

CENTER TRAY

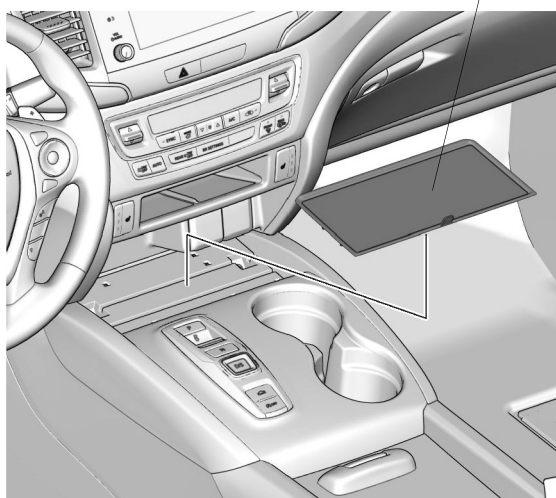

QK70702AG

6. Open the lid.

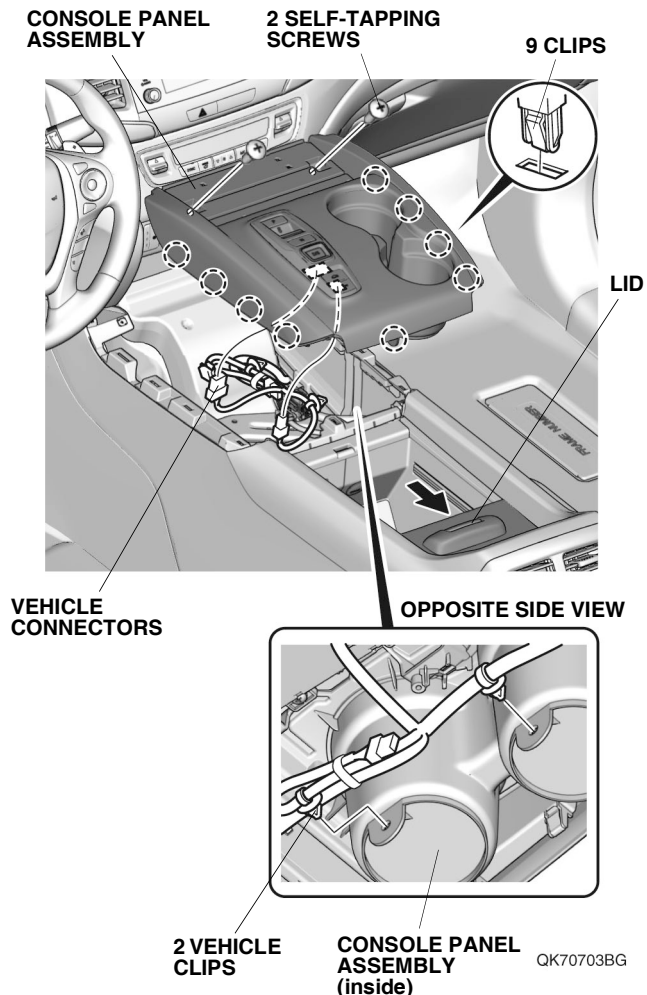

QK70703BG

7. Remove the console panel assembly.  
8. Remove the console panel base from the original console panel.

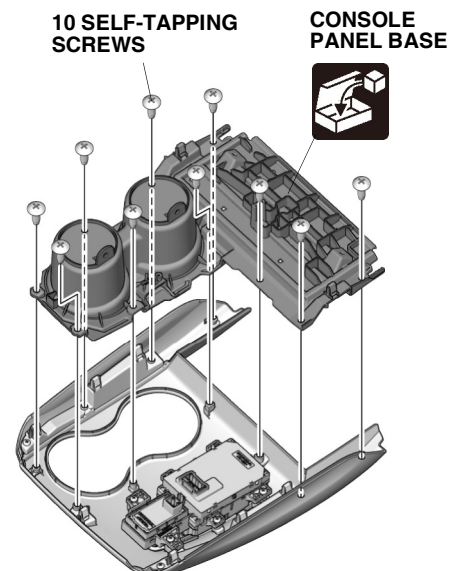

QKD0801AB

9. Remove the console panel base from the new console panel.

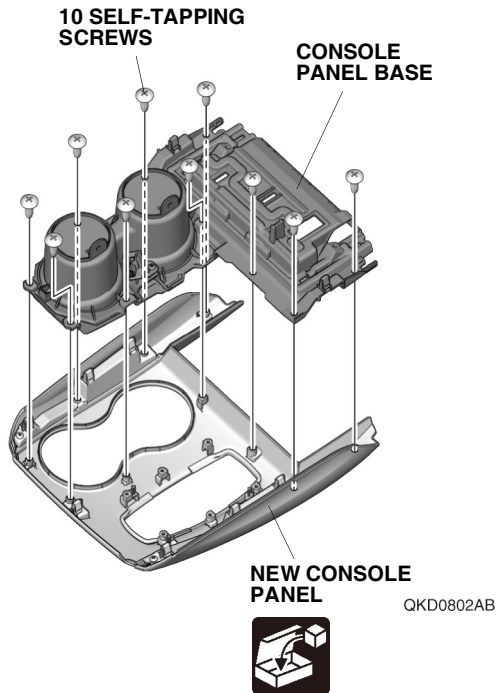

10. Remove the cup holder light from the console panel base removed in step 9.

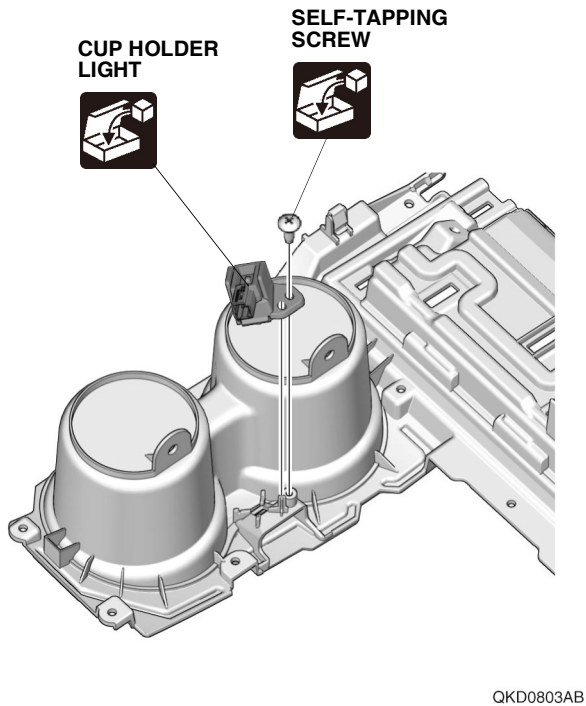

11. Install the console panel base removed in step 9 to the original console panel.

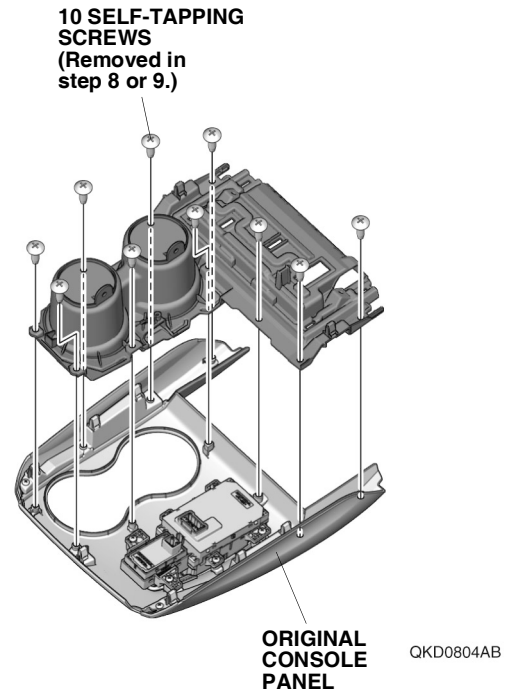

12. Secure the vehicle harness.

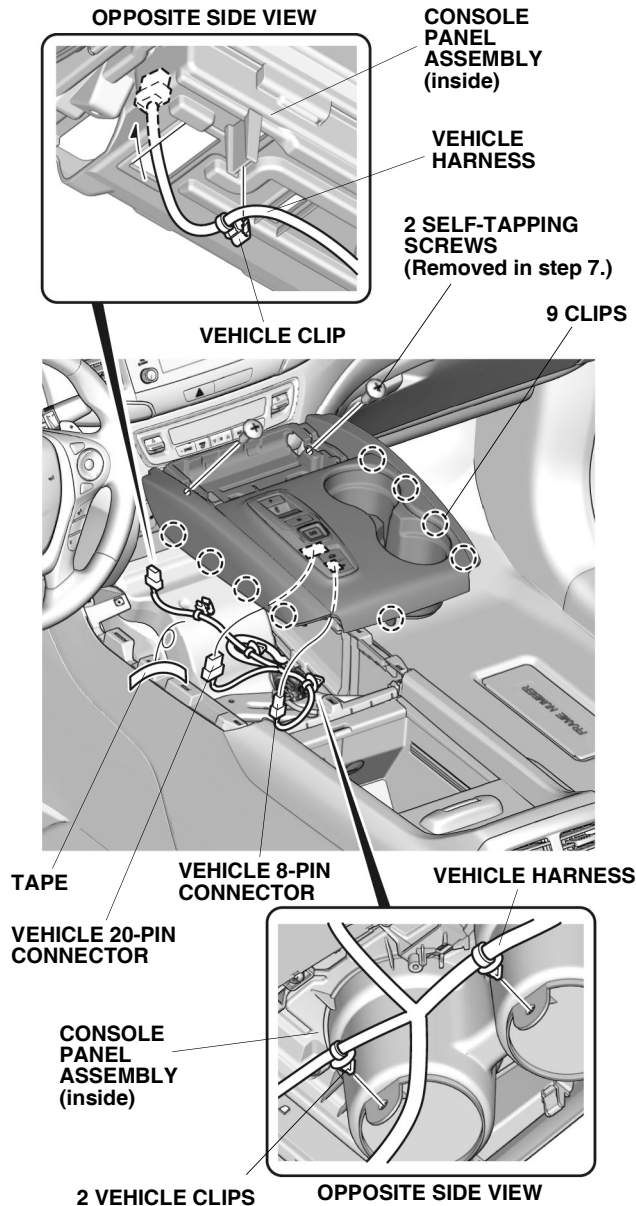

13. Plug-in the vehicle connectors.

14. Install the console panel assembly.

15. Install the wireless charger unit.

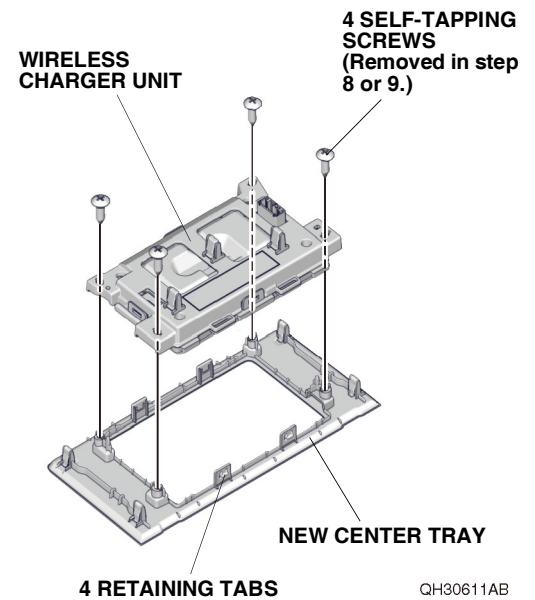

16. Plug-in the vehicle connector.

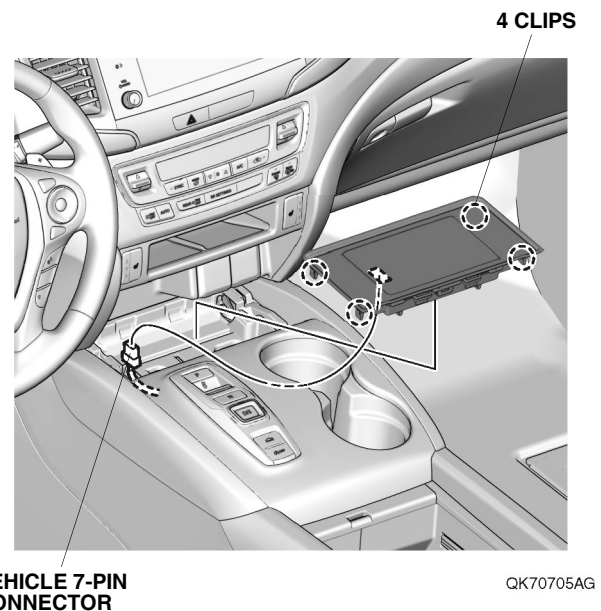

17. Install the new center tray.

18. Check that all parts are installed and properly routed.

## NOTE

- Check that all harnesses are not pulled and not pinched.
- Make sure all clamps and wire ties are securely installed.

19. Install all removed parts except for the front bulkhead cover and intake air tube.
20. Connect the negative cable to the battery.

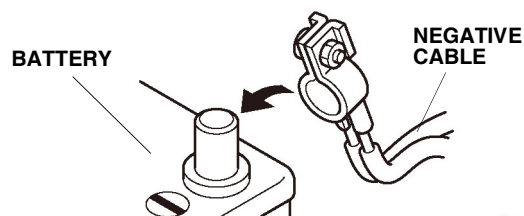

Q060702BM

21. Install the front bulkhead cover and intake air tube.
22. Make sure the accessory operates as described in the User's Information Manual.
23. Make sure all accessories and systems operate properly.
24. If necessary, restore the systems back to normal operation as described in the service information.
25. Press and hold the audio unit power button for 2 seconds to restore the audio and navi (if equipped) system functions.