



INSTALLATION INSTRUCTIONS

Accessory
WELCOME LIGHTS

Application
2021 RIDGELINE

Publications No.
VERSION 1
Issue Date
JAN 2021

GENERAL VIEW

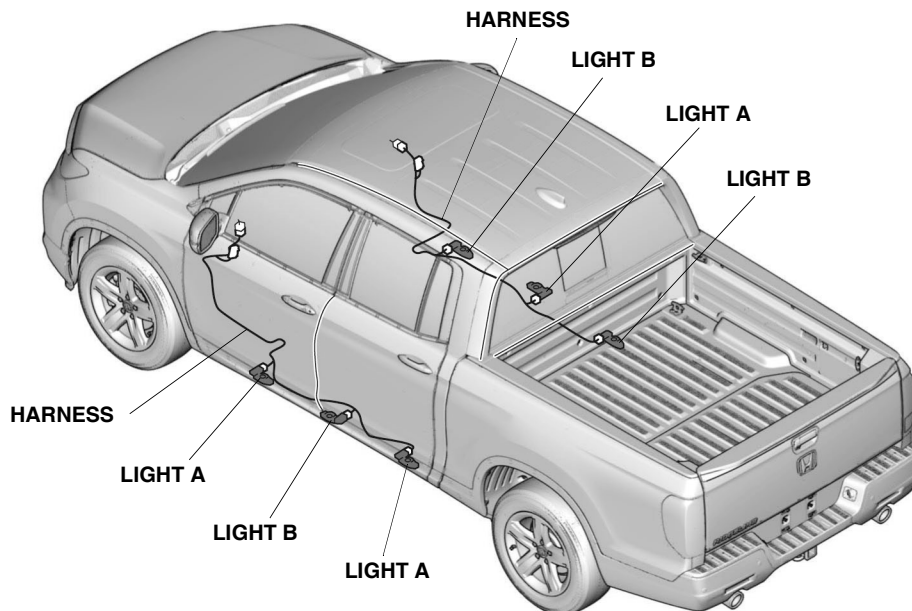

QK71008AX

FOR YOUR SAFETY (Read carefully.)

Warning Symbols

Safety: Your safety, and the safety of others, is important. To help you make informed decisions about service procedures, we have provided safety messages where appropriate. Of course, it is not practical or possible to warn you about all the hazards associated with servicing a vehicle - you must use your own good judgment.

You will find important safety messages preceded by one of following symbols:

*All symbols are not used in all installation instructions.

⚠ DANGER

You will be killed or seriously hurt if you do not follow the instructions.

⚠ WARNING

You can be killed or seriously hurt if you do not follow the instructions.

⚠ CAUTION

You can be hurt if you do not follow the instructions.

NOTICE

Gives advice to prevent damage to the product or vehicle or the environment.

NOTE

Gives helpful information or instructions to be followed when using the product.



Indicates a prohibited action

Procedure and Location Icons

These icons indicate the work location and the worker's point of view.

*All icons are not used in all installation instructions.

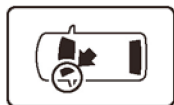

The location on the vehicle.

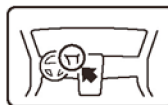

The location in the vehicle.
(instrument panel.)



Wear eye protection.



Wear heavy gloves.



Use an assistant.



Place the part on a blanket.



Work perpendicular.



Remove any burrs.



Use touch-up paint and allow to dry.



Tighten to the specified torque.



Apply firm pressure while rolling, especially at the ends, to set the adhesive.



Press firmly.



Clean with isopropyl alcohol.



Return the original part to the customer.
(Do not use.)

Wire Harness Routing Precautions

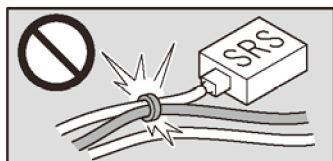

Do not secure the accessory harness and SRS harness together. (except for instruction cases).

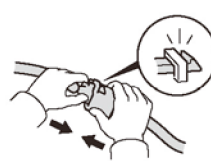

Push the connectors and terminals together until they lock.

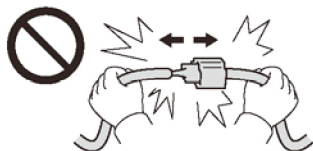

Do not pull the harness to unplug the connectors.



Install removed connectors in their original location.

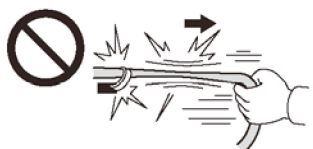

Do not pull the harness.



Secure the accessory harness as shown.



Do not pinch the harness.

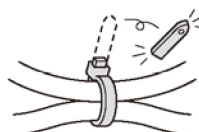

Cut off the excess wire tie.

Safety: General

- Observe all safety notes and precautions described in the service information, in addition to those described in this Installation Instruction. Be extremely careful for your safety and safety of others.
- Be careful not to damage the vehicle or the parts.
- Be extremely careful when handling retaining tabs and clips.
- Note the locations of the parts before removing them so they can be properly installed in their original positions.
- The illustrations may differ slightly from the actual accessory.

Safety: Electric Parts





- Always disconnect the negative cable from the battery before beginning work.

Safety: Accessory

- Always use the parts and tools specified in the installation instructions.
- Do not install the accessory on a dirty surface or in direct sunlight.
- Make sure the ambient air temperature is 60°F (15°C) or above when installing accessories that use a bonding material.
- When pressing the accessory firmly with the palm of your hand, be careful not to damage it or the vehicle.
- When applying adhesive material, make sure it is lined up properly before attaching. Once the adhesive material touches the surface, do not try to remove it. If you do, you could damage the part before the adhesive releases.

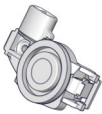
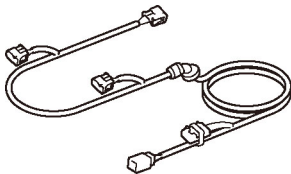
PARTS LIST

Attachment Kit (P/N 08V27-TG7-100)

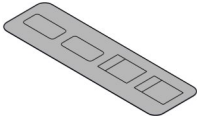
Lights A (identification mark: LH) (3)	Lights B (identification mark: RH) (3)	Harnesses (2)	Trims A (identification mark: A) (3)
			
Trims B (identification mark: B) (3)	Retainers (6)	Wire ties (28) (Some may not be used)	Fuse label
			

Self-tapping screws (6)



Bolts A
(black) (4)

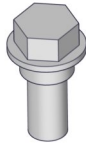

Bolts B
(silver) (2)

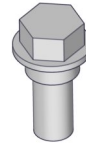

REQUIRED TOOLS AND SUPPLIES

- Phillips screwdriver
- 10 mm Socket
- Utility knife
- Touch-up paint
- Pushpin
- Eye protection (face shield, safety goggles, etc.)
- Ruler
- Ratchet
- Isopropyl alcohol
- Diagonal cutters
- Drill
- 10 mm Open end wrench
- Tape measure
- Shop towel
- File
- 3 mm and 6 mm Drill bits

The following tools are available through the Honda Tool and Equipment Program:

- Trim Tool Set (T/N SOJATP2014)
- Plastic Trim Tool (T/N SILTRIMTL10)

INSTALLATION

Using isopropyl alcohol and a shop towel, thoroughly clean the surface where the accessory adhesive will attach.

NOTE

- Always use isopropyl alcohol where you see this symbol.
- Do not pour isopropyl alcohol directly on the vehicle surface.
- Let the isopropyl alcohol completely evaporate before attaching the adhesive material.



1. Wrap a shop towel.

NOTE

Do not remove the shop towel until after the parts are installed.

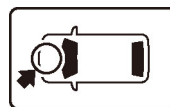

HOOD LATCH
LEVER

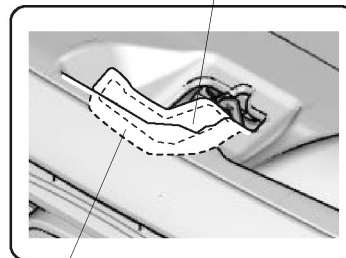

SHOP
TOWEL

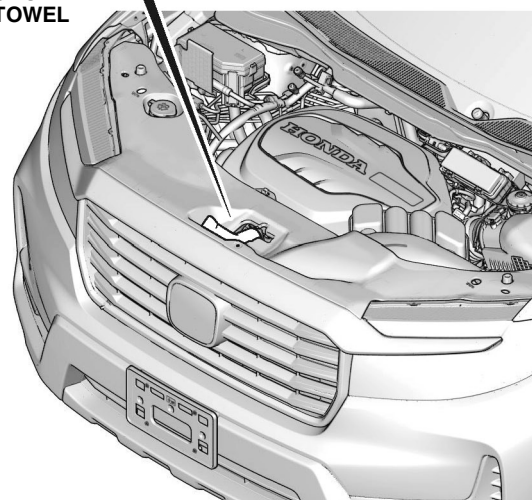

QK63002AG

2. Remove the front bulkhead cover.

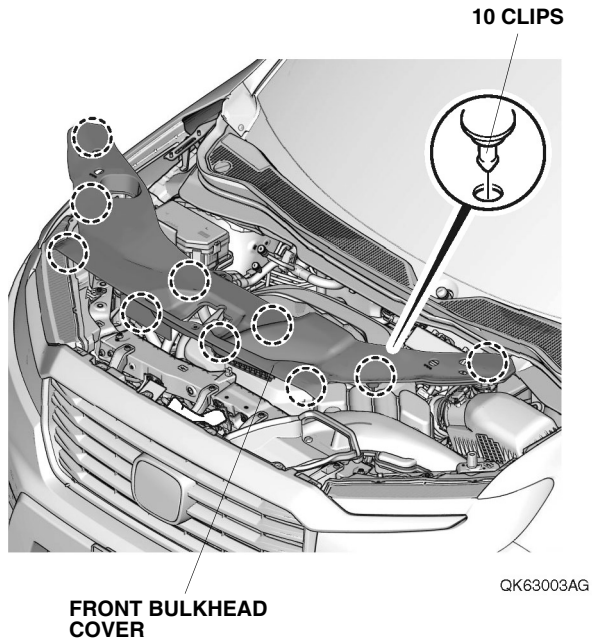

3. Remove the intake air tube.

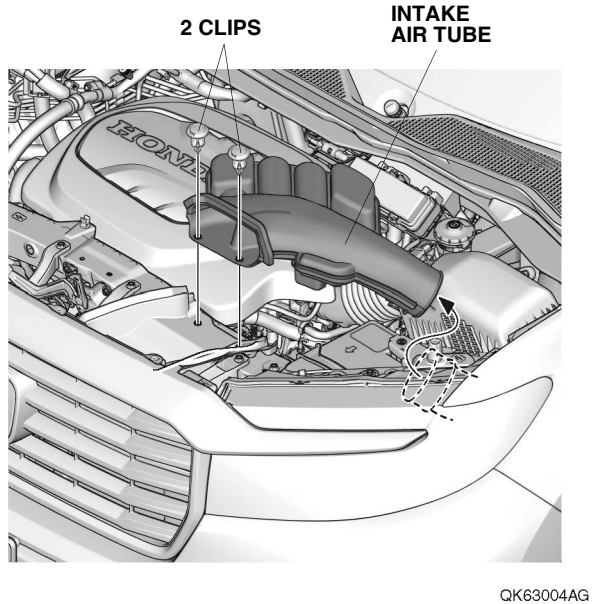
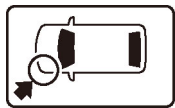

4. Disconnect the negative cable from the battery.

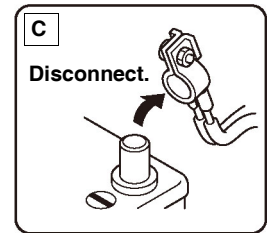
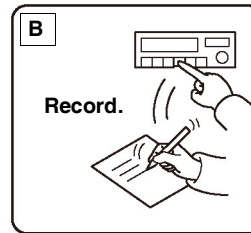
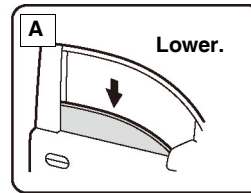

QCD0502BM

5. Remove the passenger's dashboard under cover.

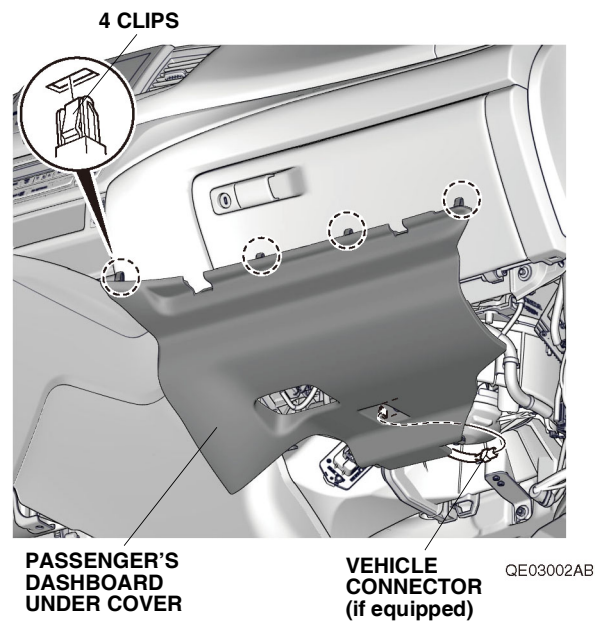

6. Remove the passenger's door sill trim.

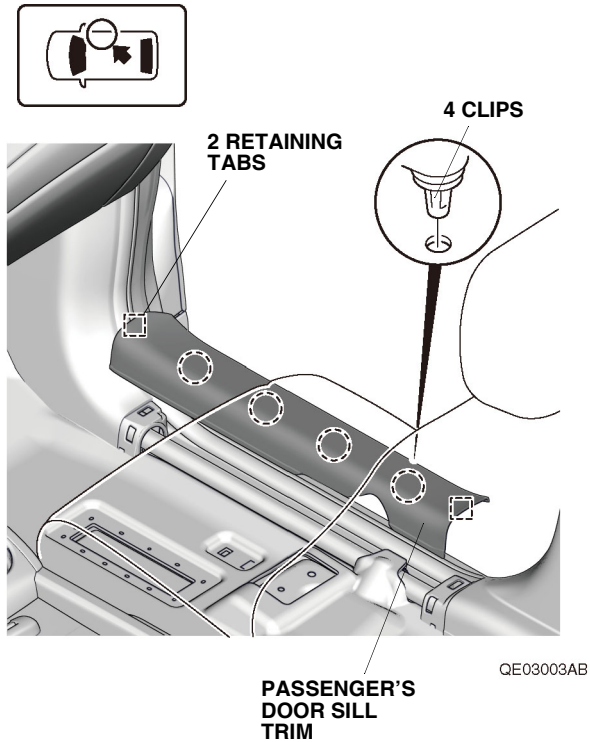

7. Remove the passenger's kick panel.

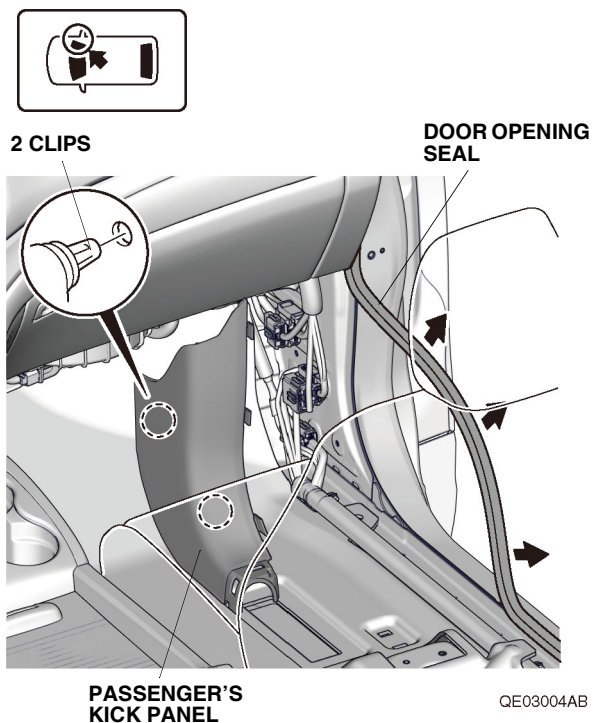

8. Remove the driver's dashboard side lid.

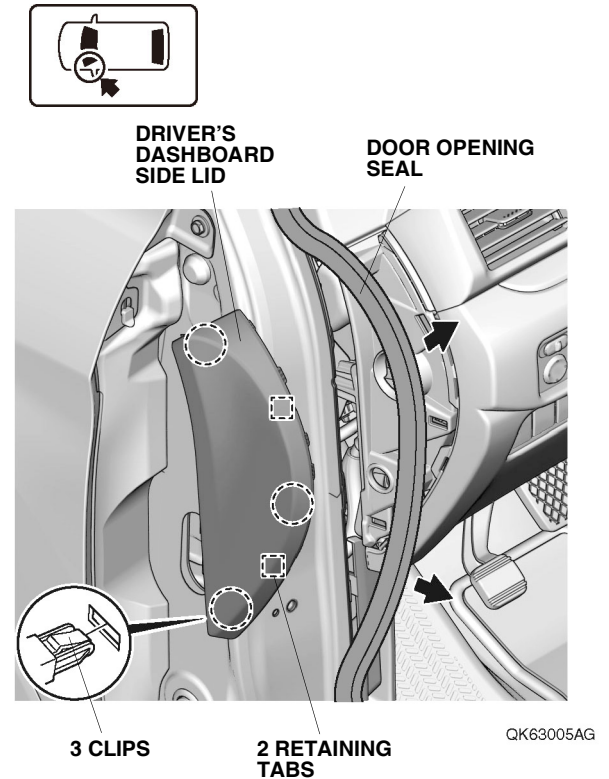

9. Remove the driver's dashboard lower cover.

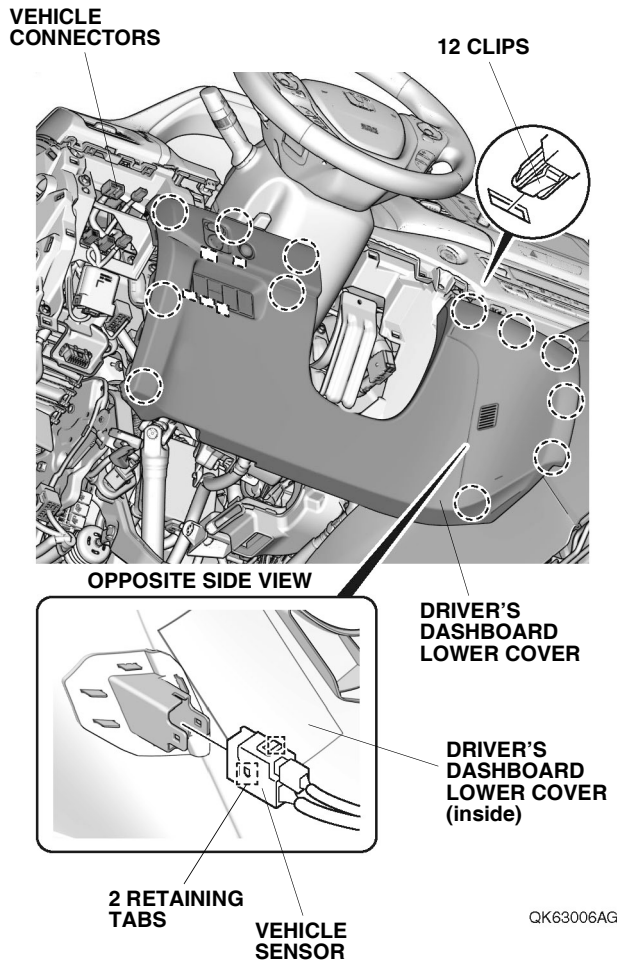

10. Remove the driver's door sill trim.

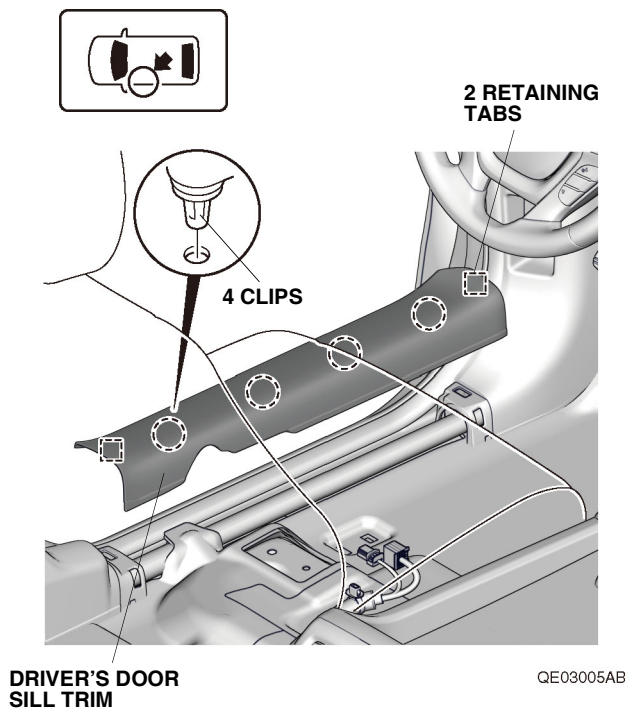

11. Remove the driver's kick panel.

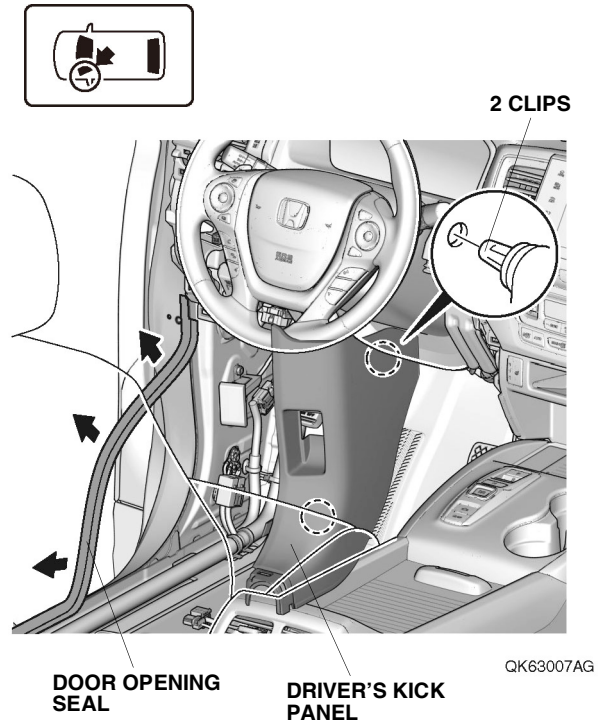

12. Cut off the left side sill panel.

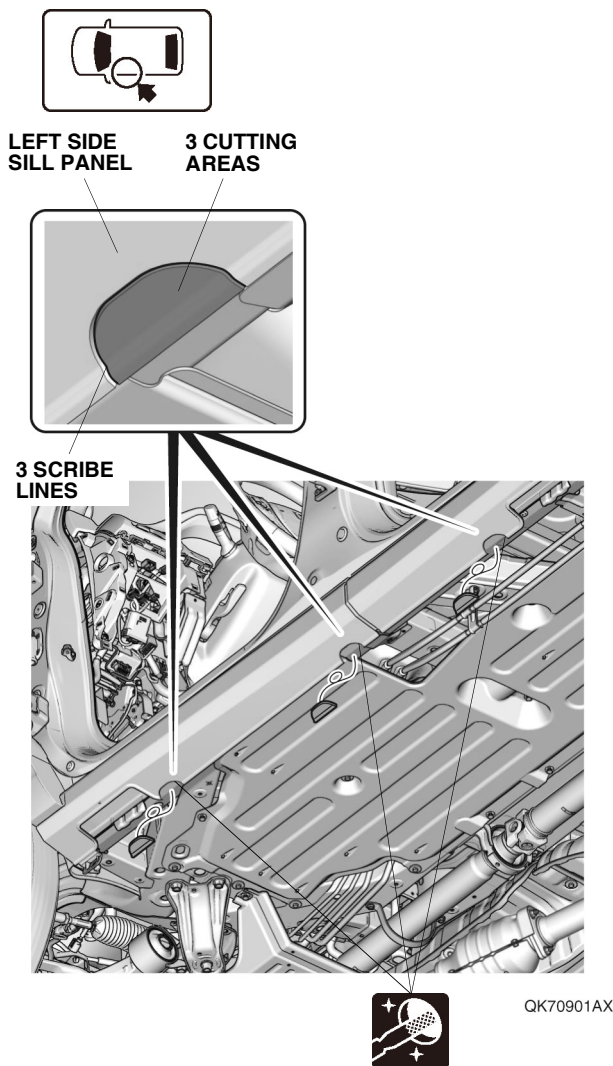

13. Remove the undercoat.

NOTE

Be careful not to damage the frame by filing off excessive undercoat.

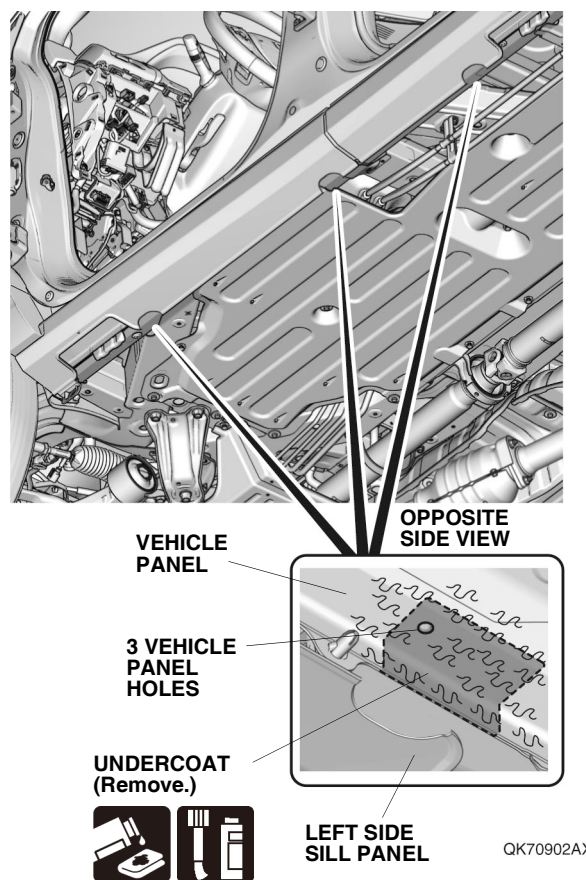

14. Pierce the left side sill panel.

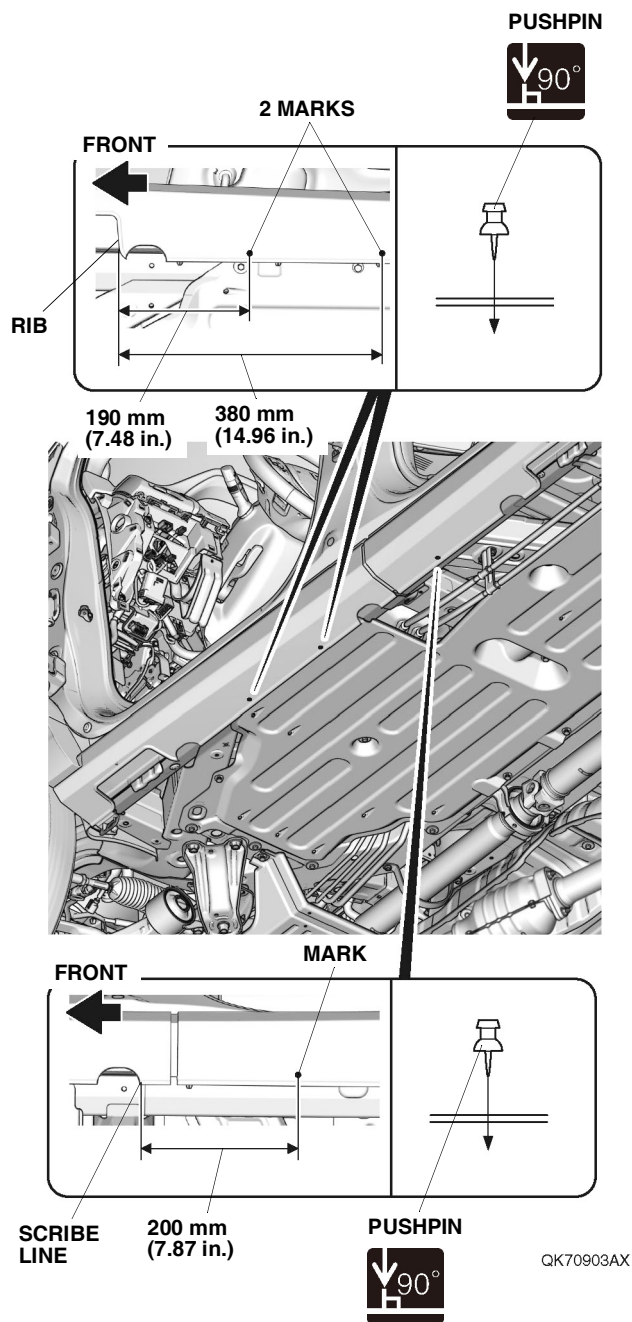

15. Drill the left side sill trim.

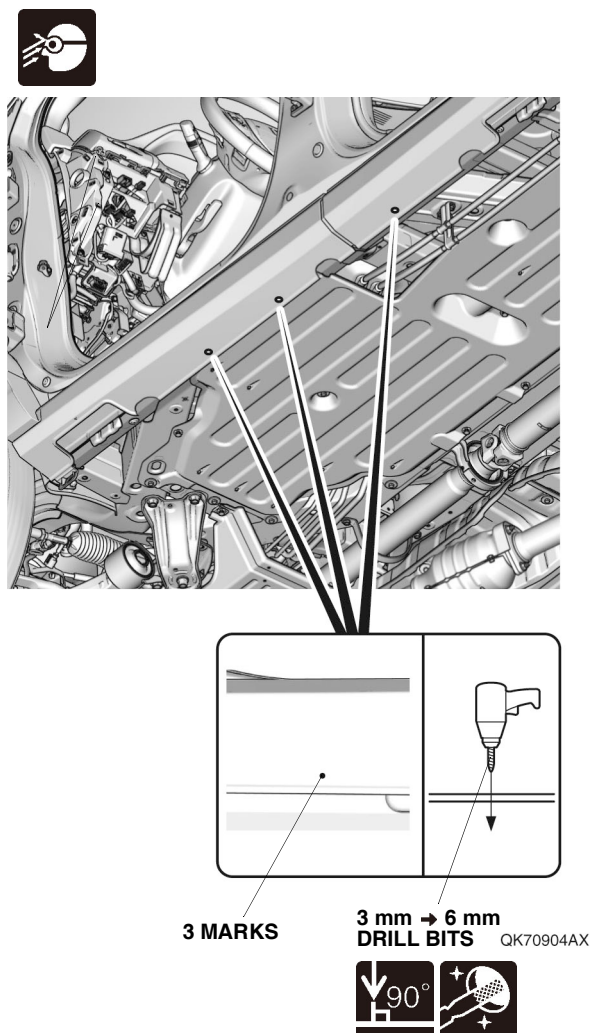

16. Repeat same procedures for the other side.

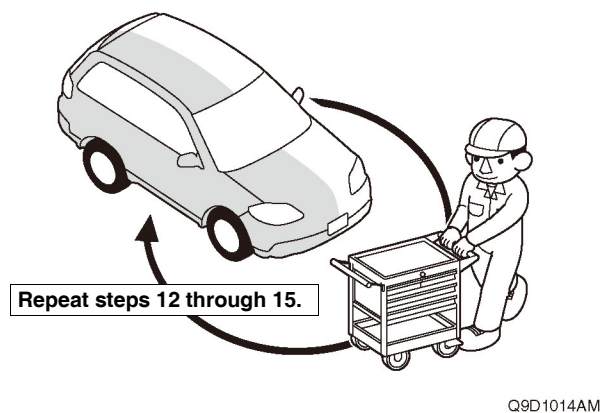

17. Install the lights A.

NOTE

Check the identification marks of the lights and trims.

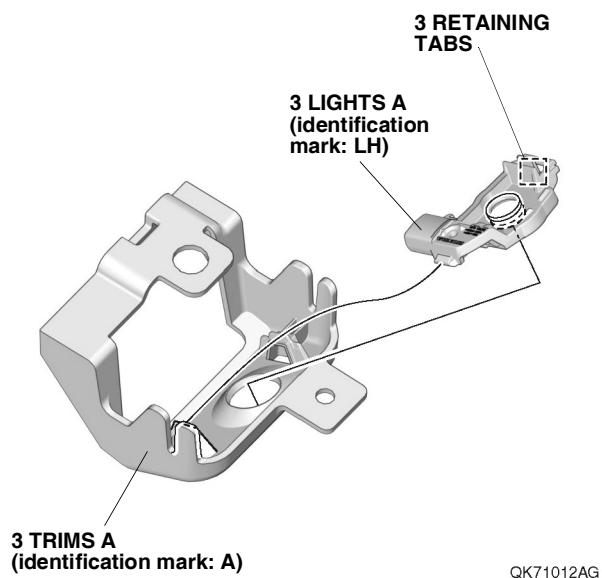

18. Install the retainers.

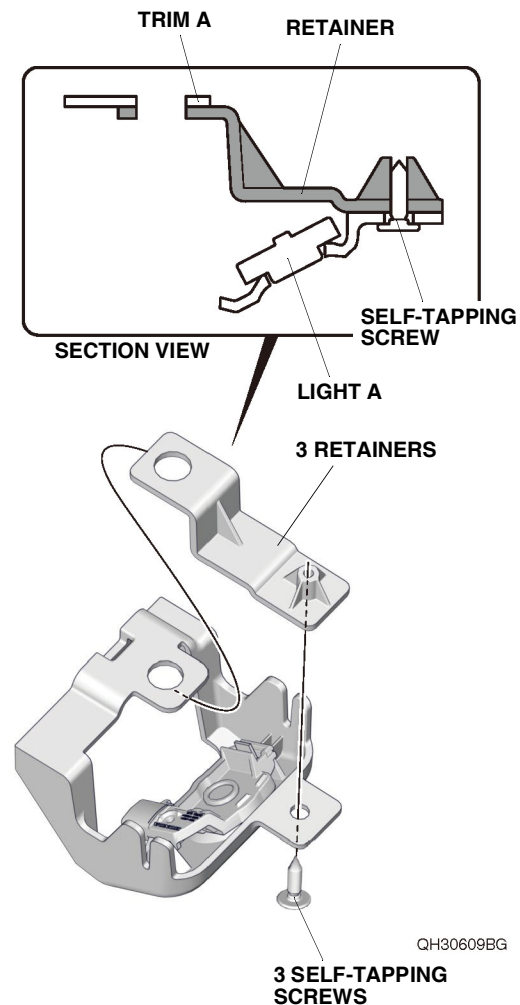

19. Install the lights B.

NOTE

Check the identification marks of the lights and trims.

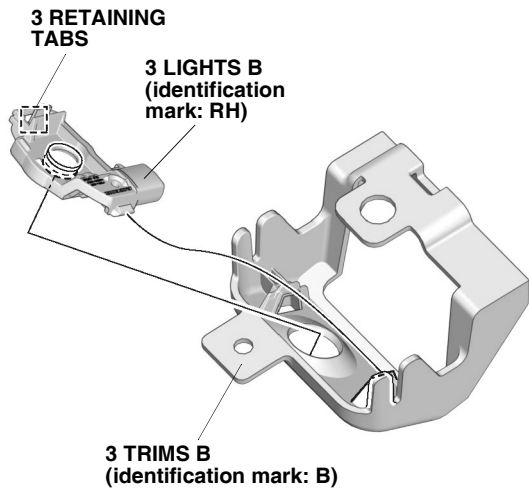

20. Install the retainers.

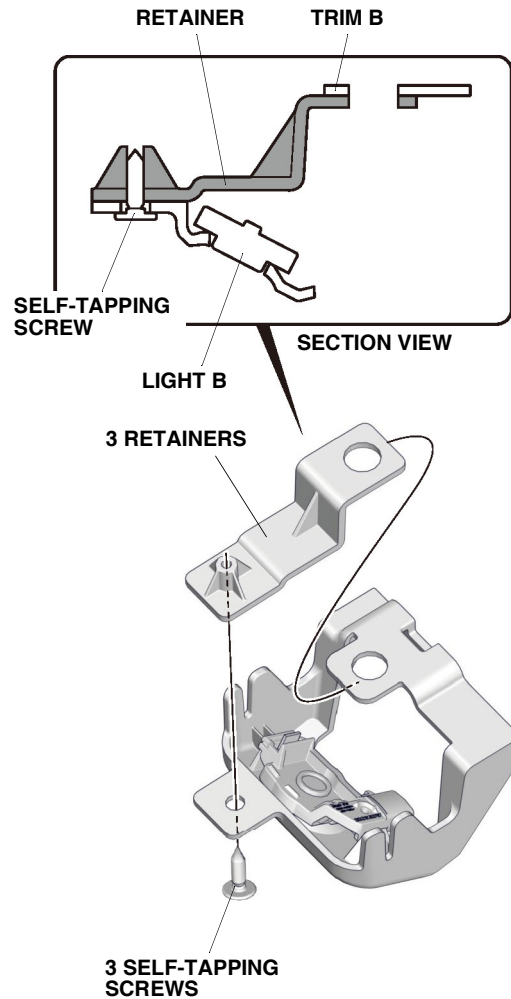

21. Install the trims A and trim B.

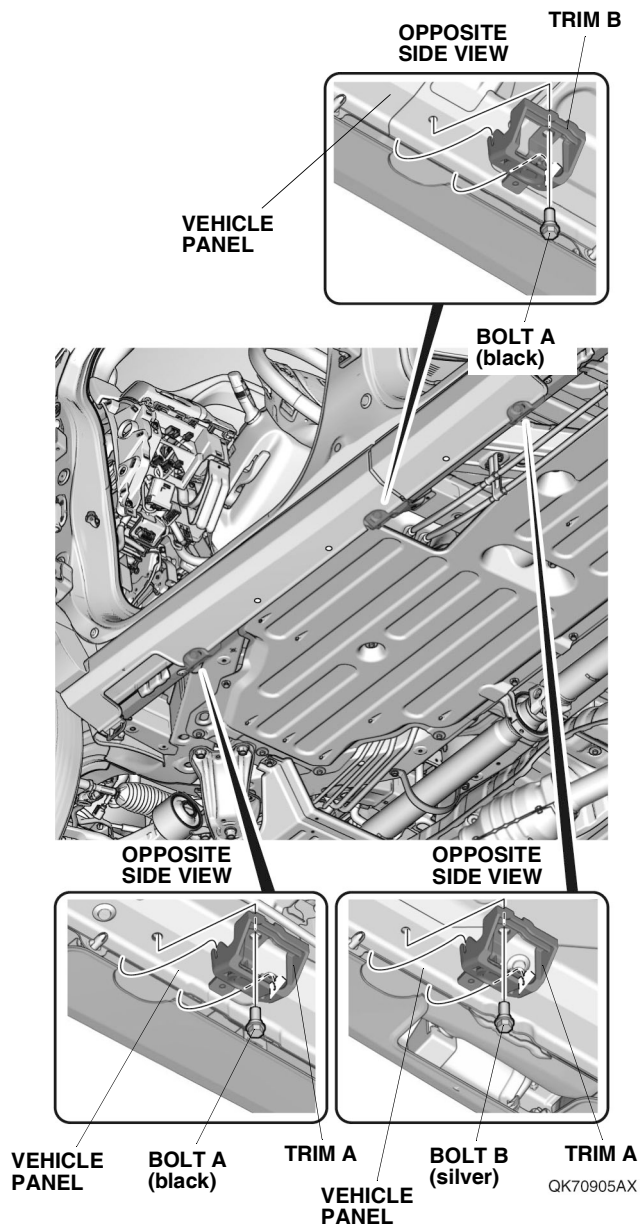

22. Attach the fuse label.

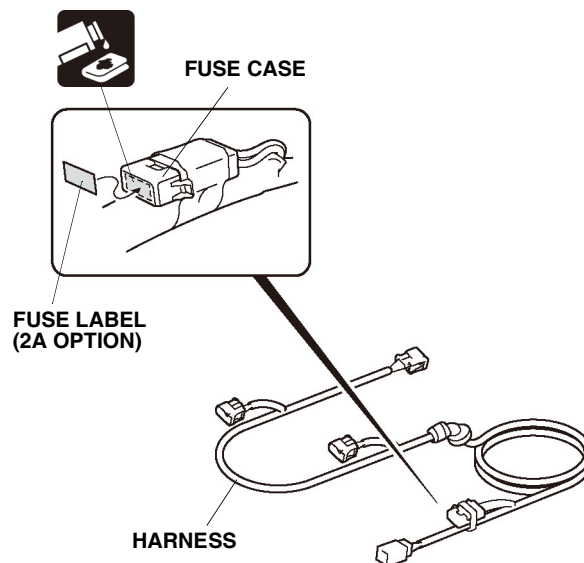

QH30613AG

23. Plug-in the harness connectors.

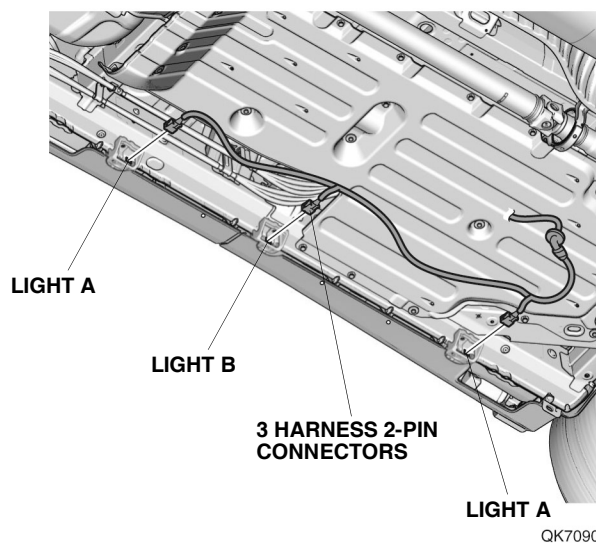
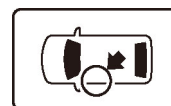

24. Remove the clip and bolts.

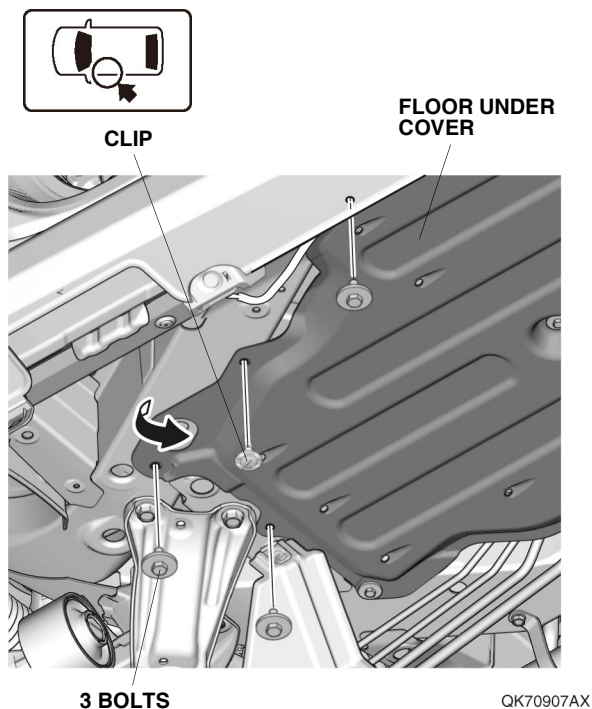

25. Remove the clip.

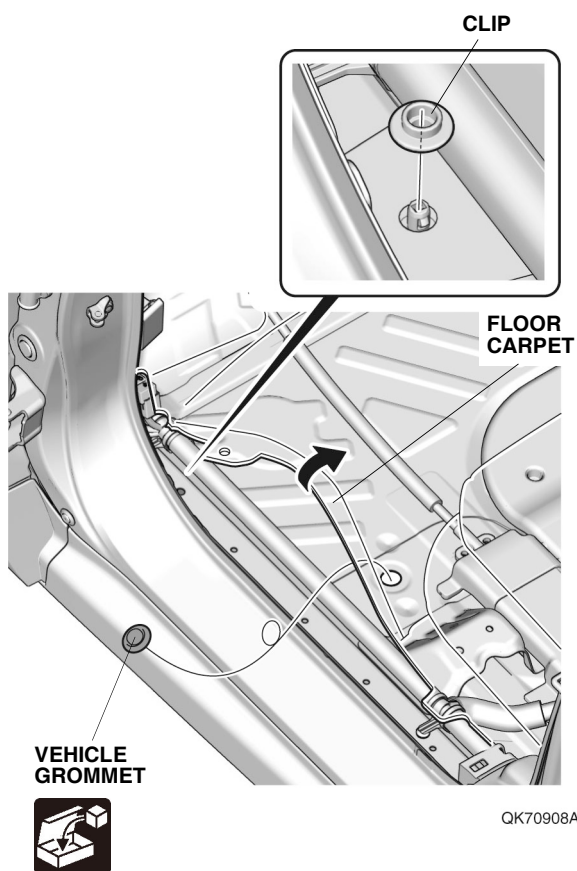

26. Remove the vehicle grommet.

27. Install the harness grommet.

NOTE

- Install the harness by holding the grommet.
- Make sure to check that the grommet is secured properly.

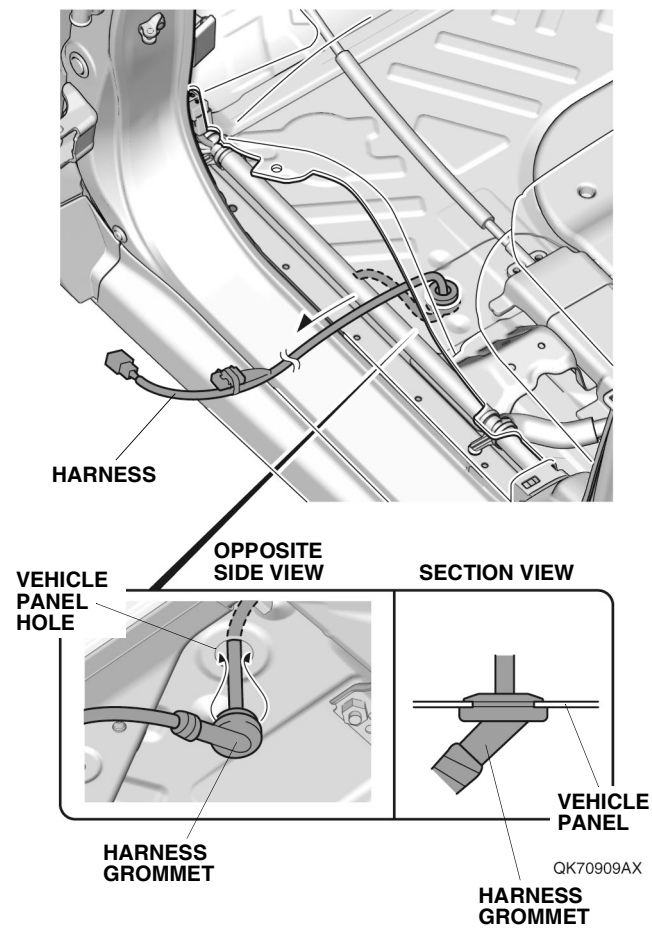

28. Secure the harness.

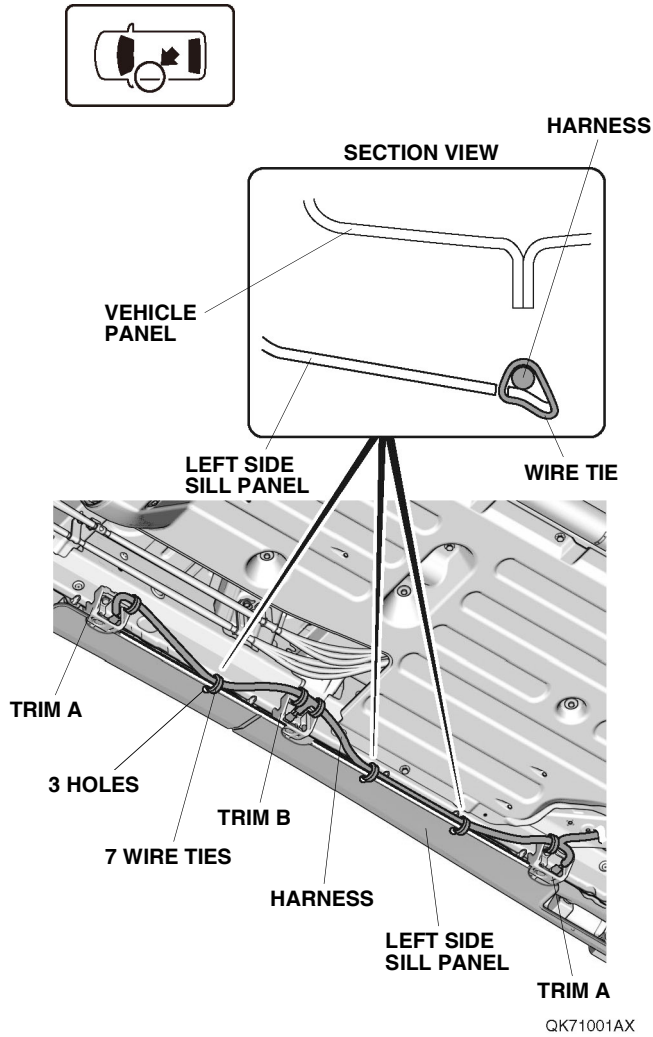

29. Secure the harness.

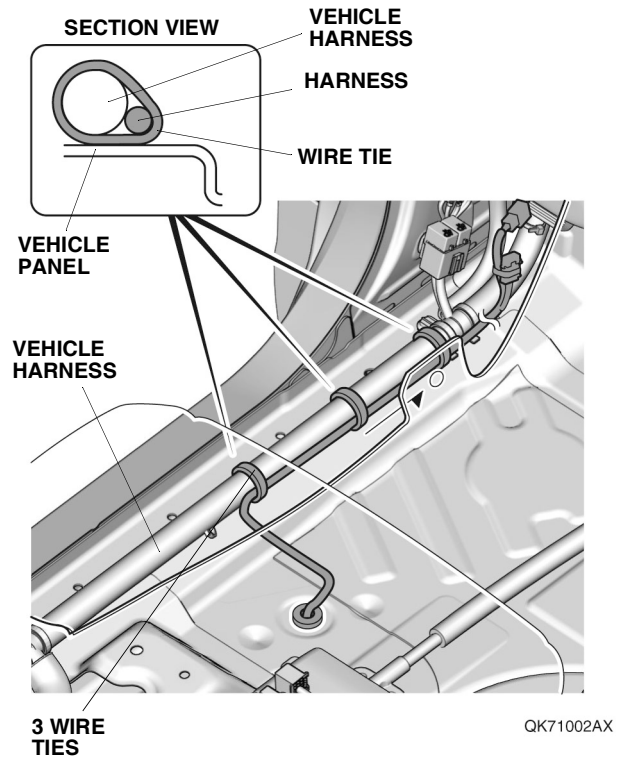

30. Choose one of these options.

- Without another accessory harness
- With another accessory harness

Go to step 31

Go to step 34

31. Plug-in the harness connector.

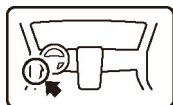

VEHICLE 2-PIN CONNECTOR

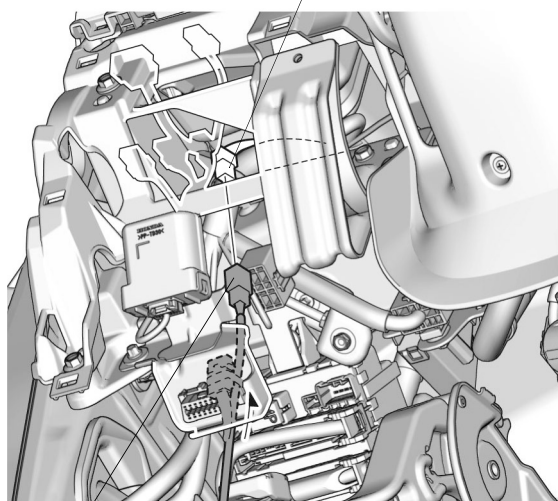

HARNESS 2-PIN CONNECTOR

QK71003AX

32. Secure the harness.

VEHICLE CLIP

2 WIRE TIES

VEHICLE HARNESS

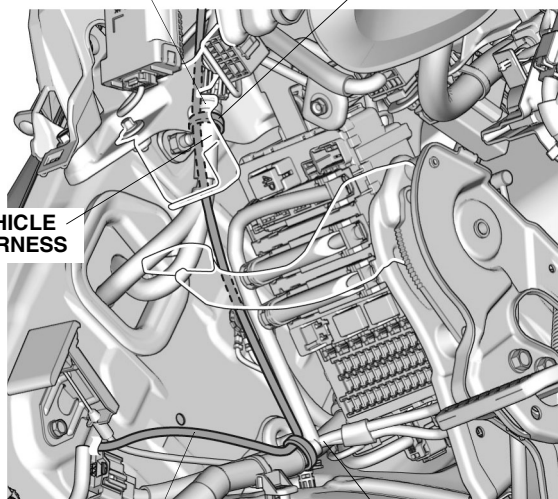

HARNESS

VEHICLE HARNESS

QK71004AX

33. Secure the harness.

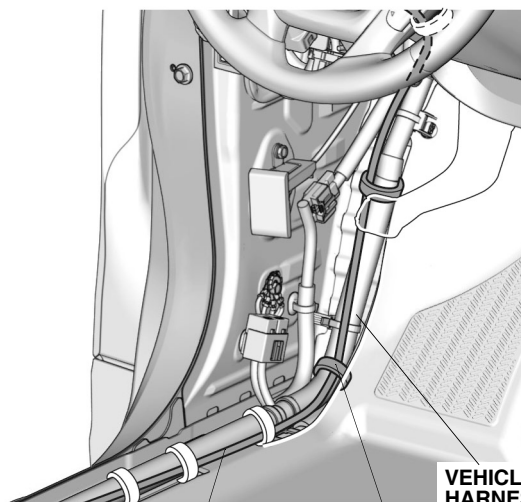
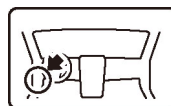

HARNESS

2 WIRE TIES

QK71005AX

Go to step 36

34. Plug-in the other accessory harness connector.

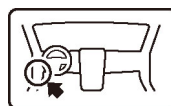

HARNESS 2-PIN CONNECTOR

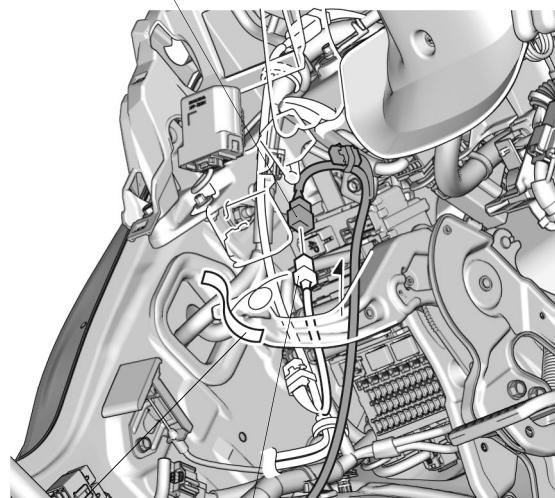

TAPE

OTHER ACCESSORY HARNESS 2-PIN CONNECTOR

QK71006AX

35. Secure the harness and connectors.

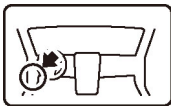

HARNESS
(Bundle up the excess.)

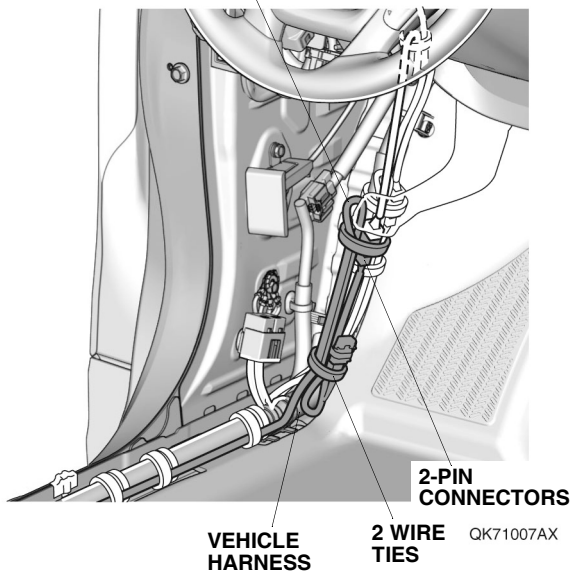

36. Install the trim A and trims B.

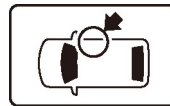

**OPPOSITE
SIDE VIEW**

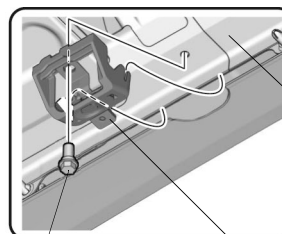

**BOLT A
(black)**

TRIM A

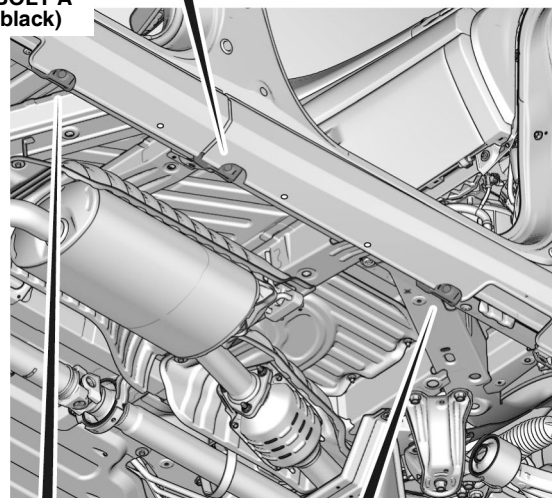

**OPPOSITE
SIDE VIEW**

**OPPOSITE
SIDE VIEW**

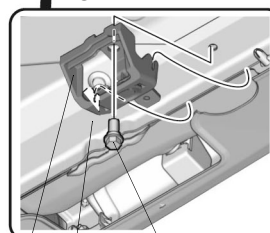

**BOLT B
(silver)**

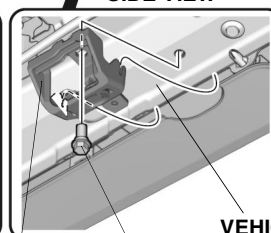

TRIM B

**BOLT A
(black)**

QK71001AG

37. Attach the fuse label.

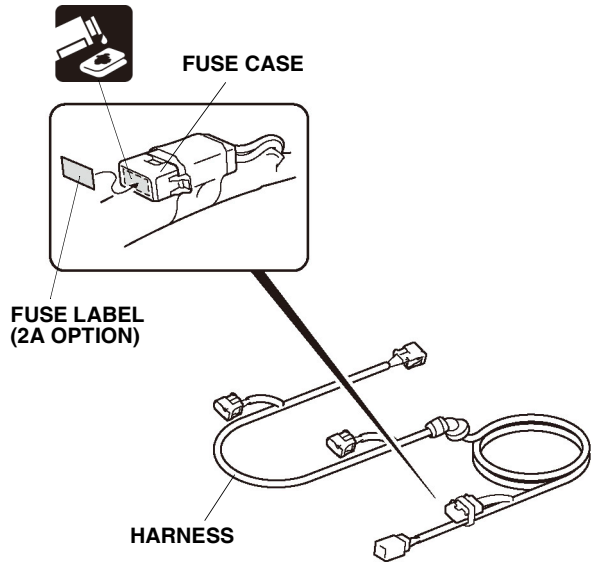

QH30613AG

38. Plug-in the harness connectors.

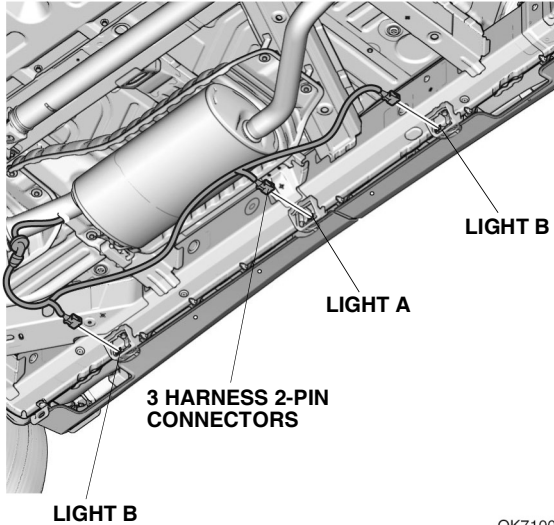

QK71002AG

39. Remove the clip.

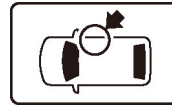

CLIP

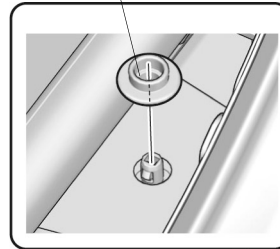

FLOOR CARPET

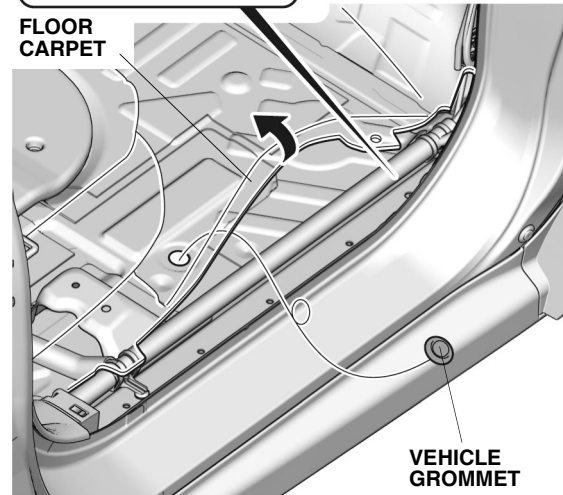

QK71003AG

40. Remove the vehicle grommet.

41. Install the harness grommet.

NOTE

- Install the harness by holding grommet.
- Make sure to check that the grommet is secured properly.

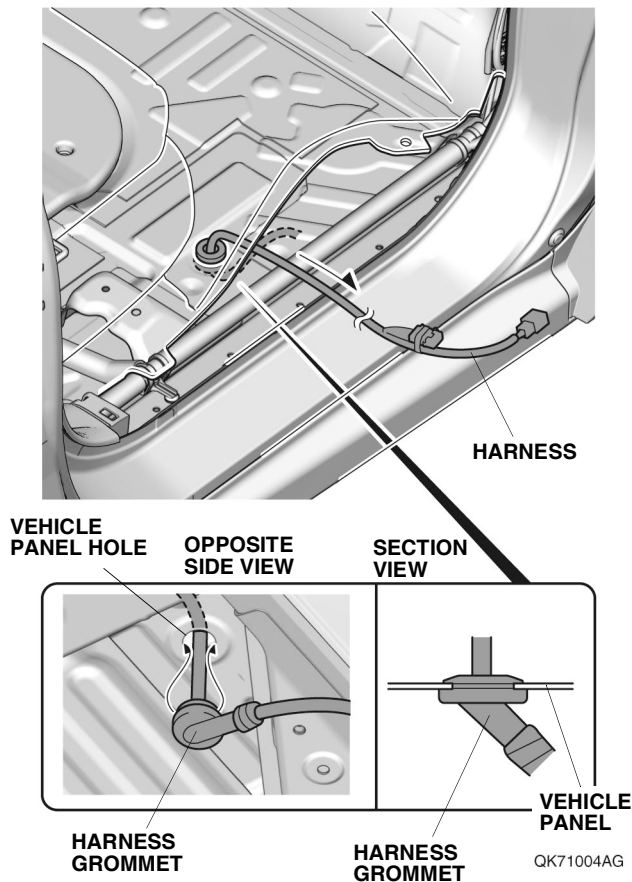

42. Secure the harness.

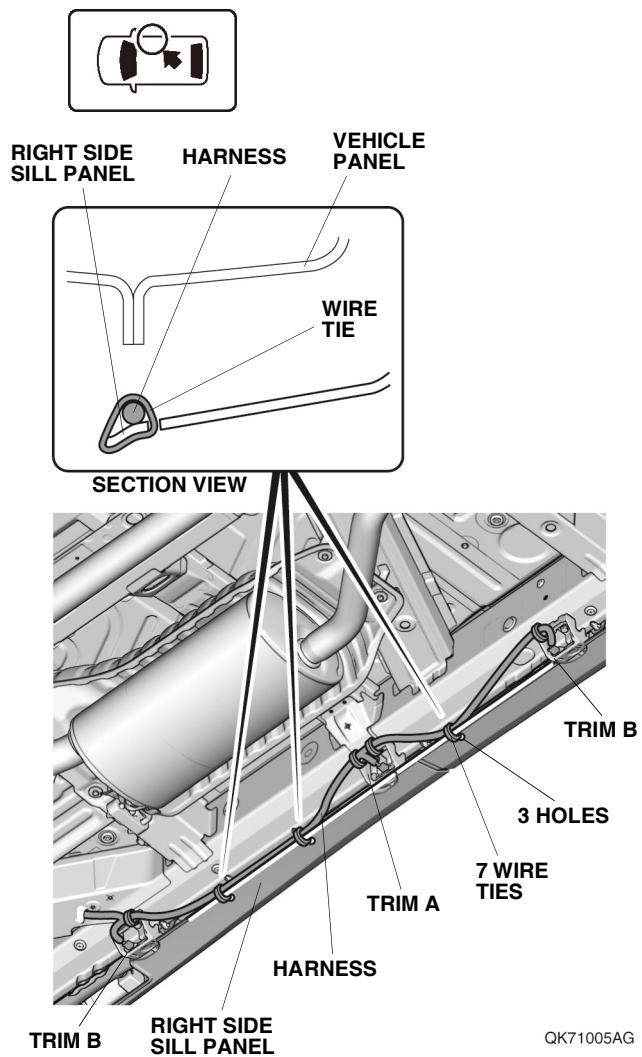

43. Secure the harness.

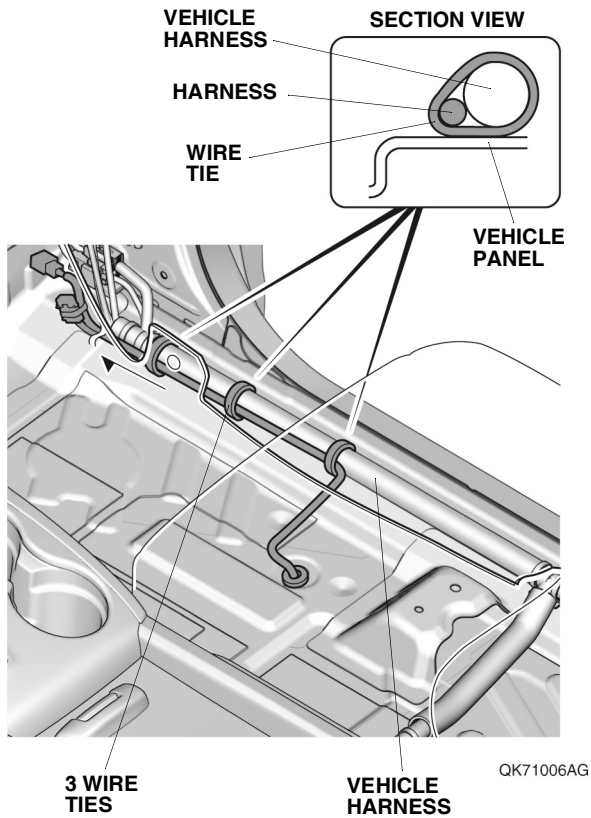

44. Choose one of these options.

- Without another accessory harness
- With another accessory harness

Go to step 45

Go to step 48

45. Plug-in the harness connector.

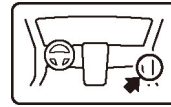

VEHICLE 2-PIN CONNECTOR

HARNESS 2-PIN CONNECTOR

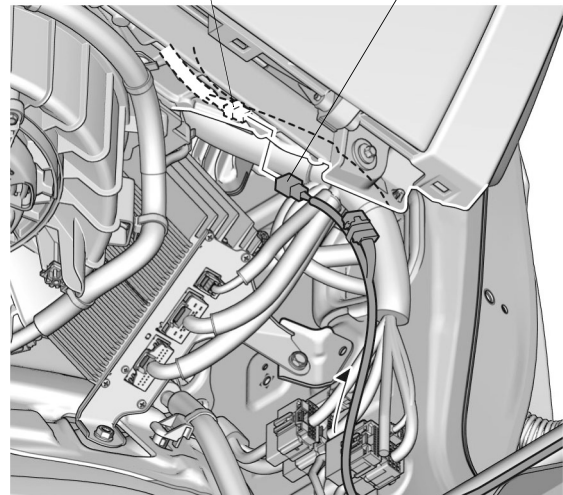

QK71007AG

46. Secure the harness.

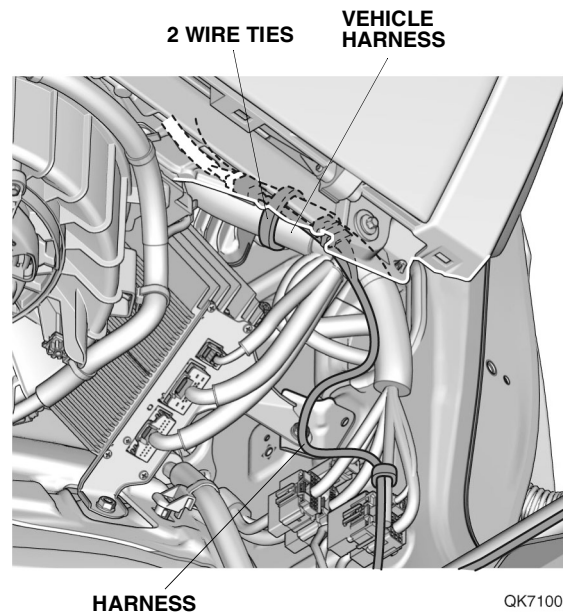

47. Secure the harness.

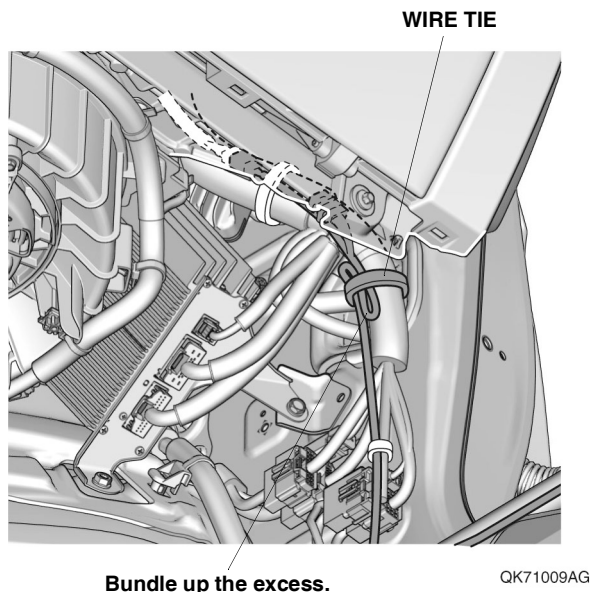

Go to step 50

48. Plug-in the harness connector.

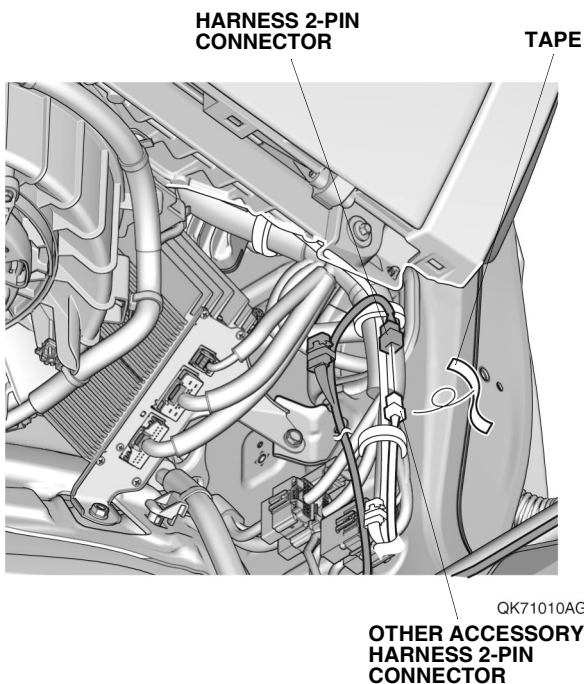
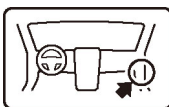

49. Secure the harness and connectors.

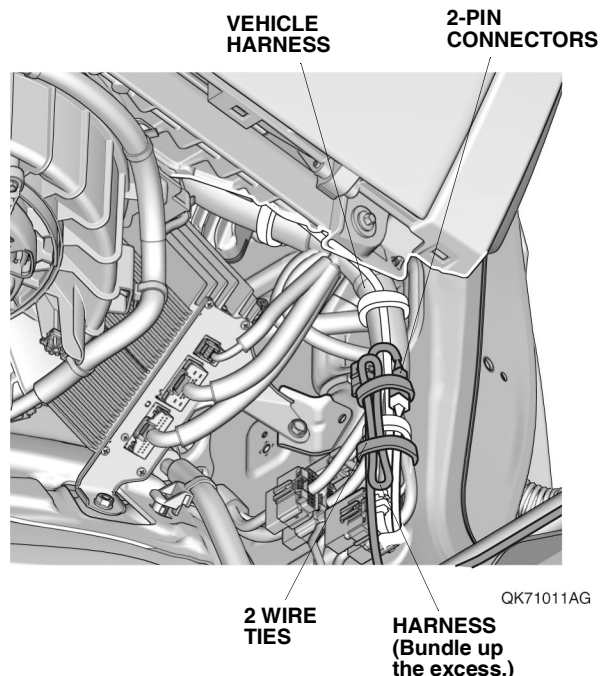

50. Check that all parts are installed and properly routed.

NOTICE

- Check that all harnesses are not pulled and not pinched.
- Make sure all clamps and wire ties are securely installed.

51. Install all removed parts except for the front bulkhead cover and intake air tube.

52. Connect the negative cable to the battery.

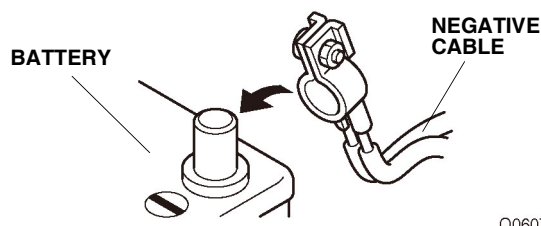

53. Install the front bulkhead cover and intake air tube.

54. Check that the light comes on by opening a door.

55. Make sure all accessories and systems operate properly.

56. If necessary, restore the systems back to normal operation as described in the service information.

57. Press and hold the audio unit power button for 2 seconds to restore the audio and navi (if equipped) system functions.