

Germain Honda of College Hills



INSTALLATION INSTRUCTIONS

Accessory
**SEAT-BACK
PROTECTORS**

Application
**2023 PILOT
MODEL SERIES**

Publications No.
VERSION 1

Issue Date
NOV 2022

GENERAL VIEW

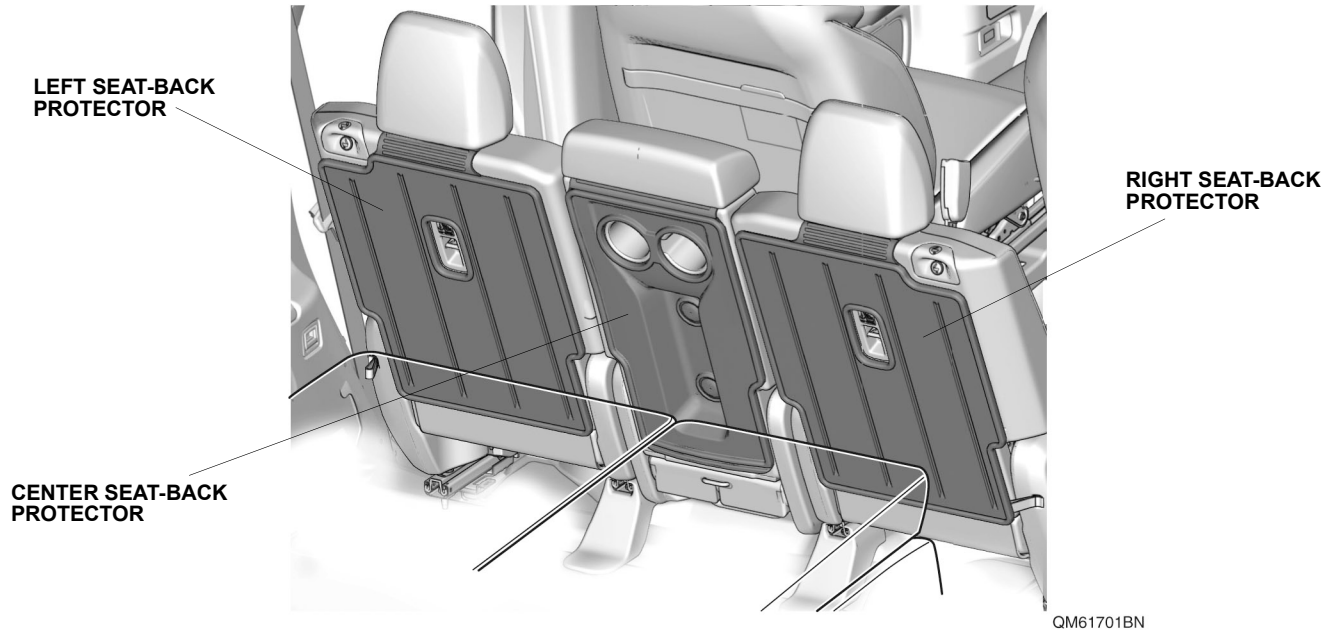

FOR YOUR SAFETY (Read carefully.)

Warning Symbols

Safety: Your safety, and the safety of others, is important. To help you make informed decisions about service procedures, we have provided safety messages where appropriate. Of course, it is not practical or possible to warn you about all the hazards associated with servicing a vehicle - you must use your own good judgment.

You will find important safety messages preceded by one of the following symbols:

*All symbols are not used in all installation instructions.

Introduction of Symbol Messages

- These symbols warn you about the possible hazards and explain how to avoid them. And give you some advices.

⚠ DANGER

You will be killed or seriously hurt if you do not follow the instructions.

⚠ WARNING

You can be killed or seriously hurt if you do not follow the instructions.

⚠ CAUTION

You can be hurt if you do not follow the instructions.

NOTICE

Gives advice to prevent damage to the product, vehicle, the environment or other property.

NOTE

Gives helpful information or instructions to be followed when installing this product.



Indicates a prohibited action.

Germain Honda of College Hills

Procedure and Location Icons

These icons indicate the work location and the worker's point of view.

*All icons are not used in all installation instructions.

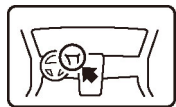

The location on the vehicle.

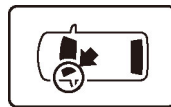

The location in the vehicle.
(Instrument panel.)



Wear eye protection.



Wear heavy gloves.



Use an assistant.



Place the part on a blanket.



Work perpendicular.



Remove any burrs.



Use touch-up paint and allow to dry.



Tighten to the specified torque.



Apply firm pressure while rolling, especially at the ends, to set the adhesive.



Press firmly.



Clean with isopropyl alcohol.



Return the original part to the customer.
(Do not reuse.)

Safety: General

- Be careful not to damage the vehicle or the parts.
- Be extremely careful when handling retaining tabs and clips.
- The illustrations may differ slightly from the actual accessory.

PARTS LIST

Seat Back Protectors Kit

(P/N 08P42-T90-100B)

(P/N 08P42-T90-100C)

(*: The part differs depending on the kit.)

Left seat-back protector
(identification mark: LH)

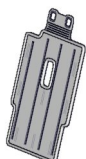

Right seat-back protector
(identification mark: RH)

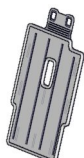

*Center seat-back protector
(identification mark: CTR)
(P/N 08P42-T90-100B)



*Rivets (2)
(P/N 08P42-T90-100B)



Germain Honda of College Hills

REQUIRED TOOLS AND SUPPLIES

- Pushpin
- File
- Drill
- Eye protection
(face shield, safety goggles, etc.)
- 3 mm Drill bit
- Flat-tip screwdriver

The following tools are available through the Honda Tool and Equipment Program:

- Rotabroach Hole Cutting Kit
(T/N BLR11201SO)
- Trim Tool Set
(T/N SOJATP2014)
- Plastic Trim Tool
(T/N SILTRIMMTL10)

Germain Honda of College Hills

INSTALLATION

1. Remove the head restraint.

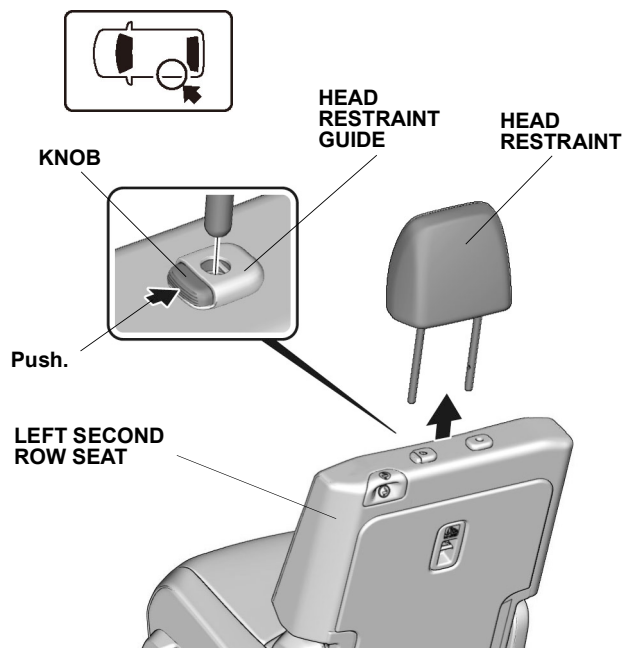

QM61702AN

2. Install the left seat-back protector.

NOTE

Make sure to check the identification mark before installation.

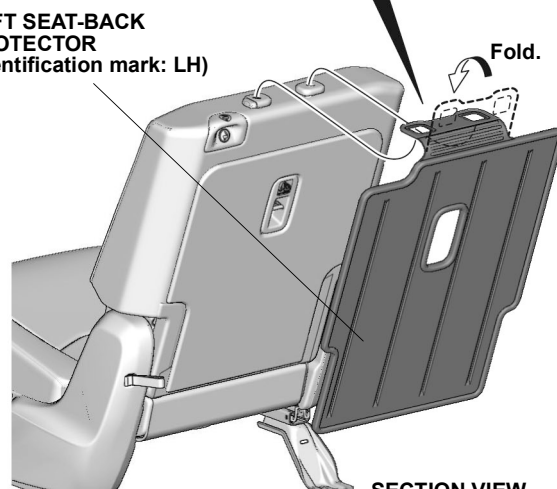
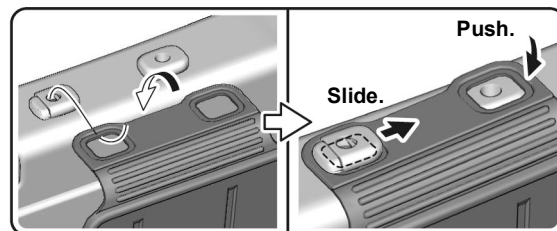

SECTION VIEW

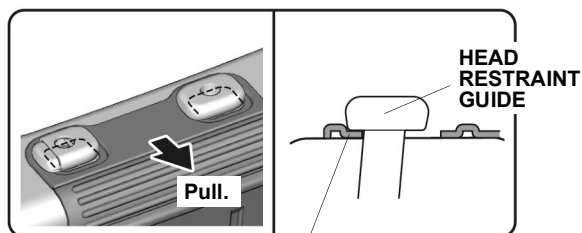

LEFT SEAT-BACK PROTECTOR

QM61703AN

Germain Honda of College Hills

3. Fold down the left second row seat.
4. Install the left seat-back protector.

NOTE

Install in the order shown.

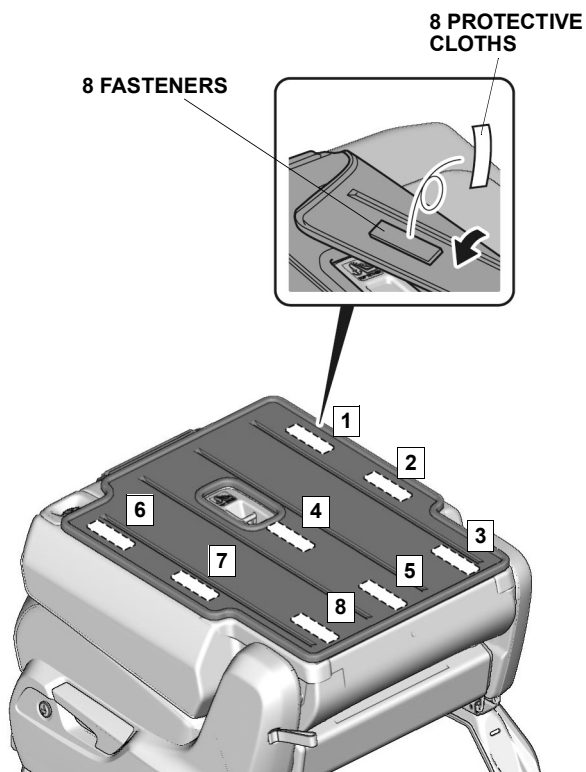

QM61704AN

5. Repeat the same procedures on the other side.

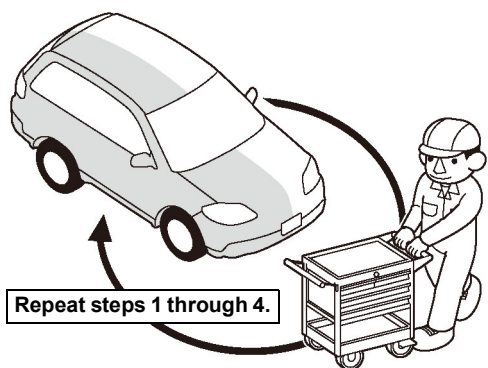

Q9D1014AM

6. Choose one of these options.

- With center second row seat

Go to step 7

- Without center second row seat

Go to step 19

7. Fold down the center second row seat.
8. Remove the second row seat beverage holder.

NOTE

Remove in the order shown.

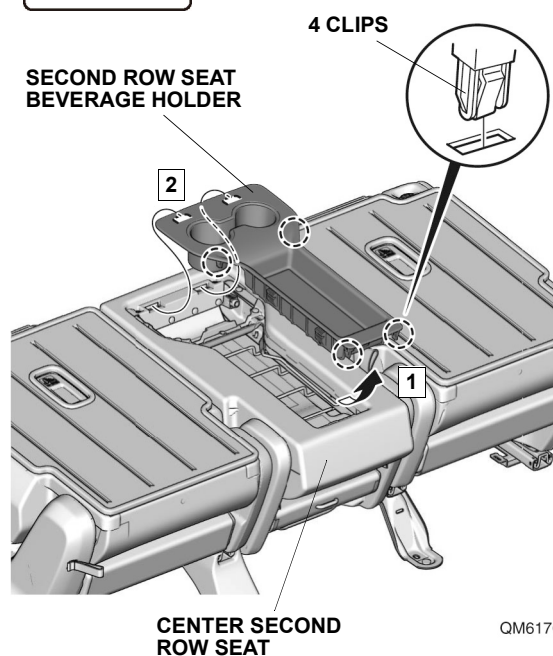
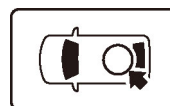

QM61705AN

Germain Honda of College Hills

9. Pierce the second row seat beverage holder.

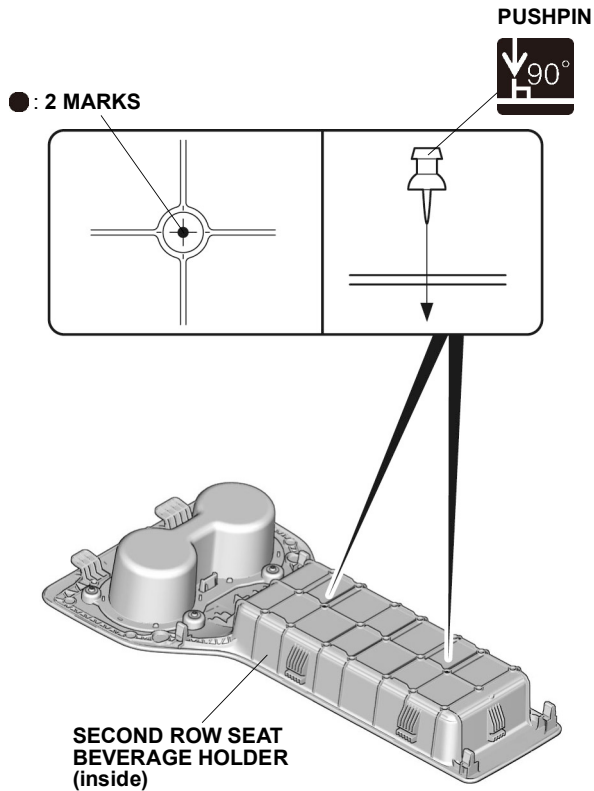

QM61706AN

10. Drill the second row seat beverage holder.

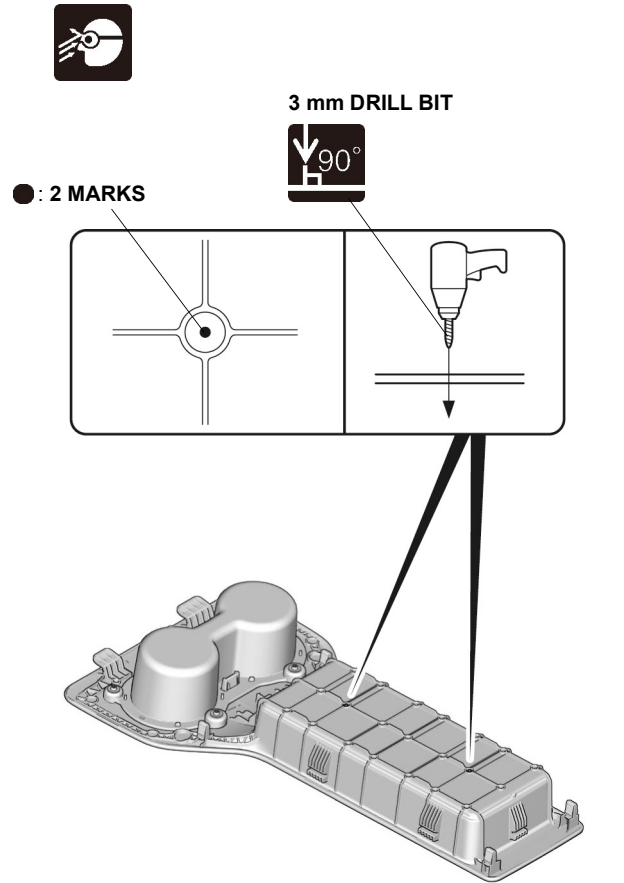

QM61707AN

Germain Honda of College Hills

11. Drill the second row seat beverage holder.

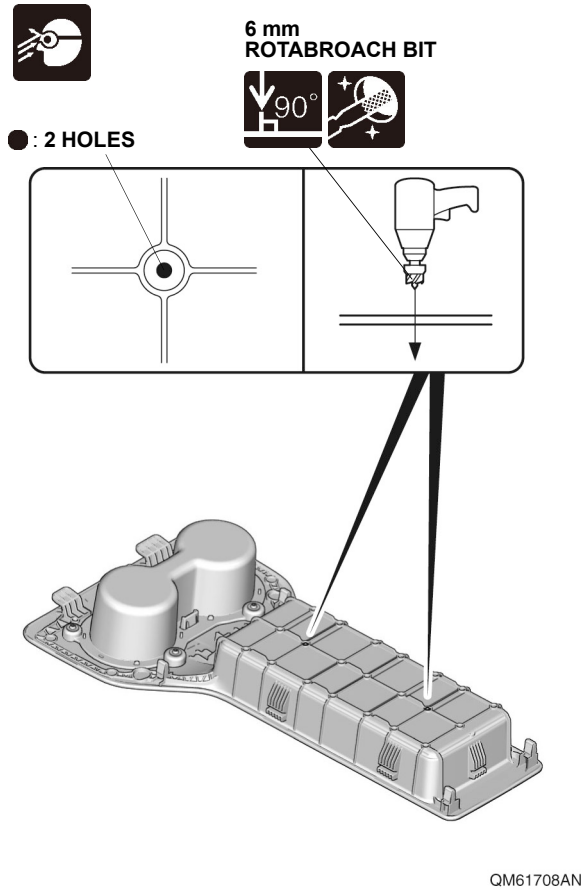

12. Install the rivets.

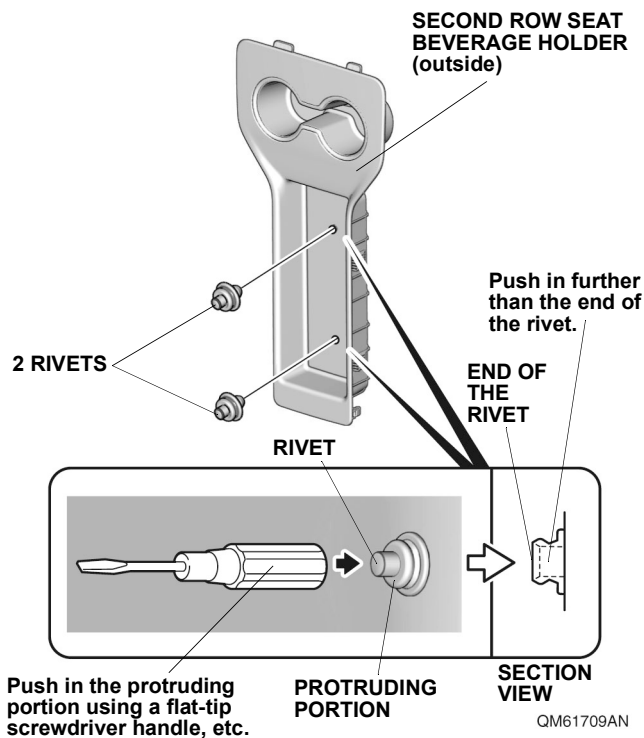

13. Install the second row seat beverage holder.

NOTE
Install in the order shown.

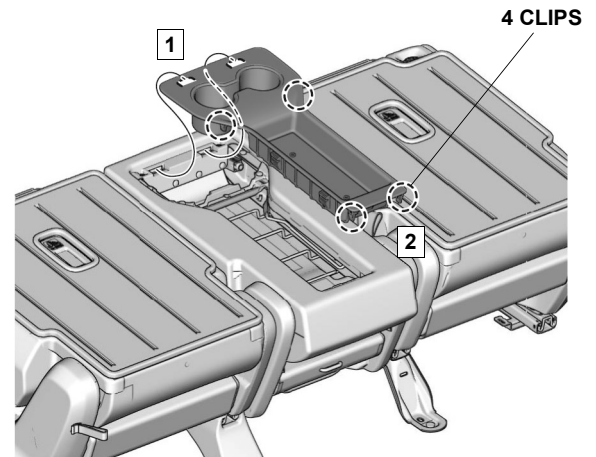

14. Raise the center second row seat.

15. Remove the center head restraint.

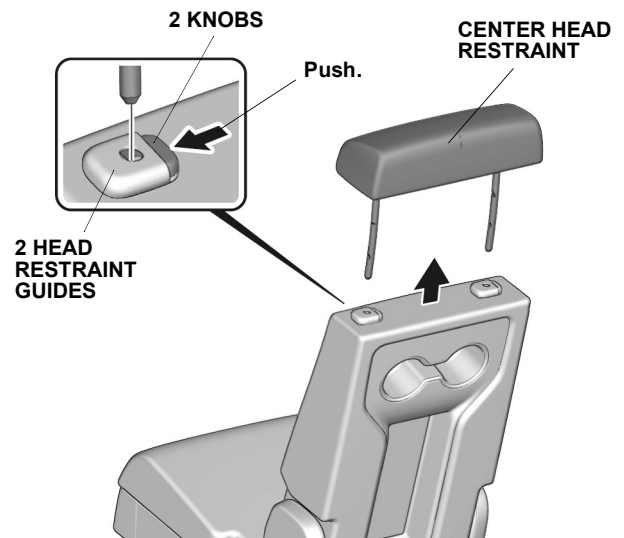

Germain Honda of College Hills

16. Install the center seat-back protector.

NOTE

Make sure to check the identification mark before installation.

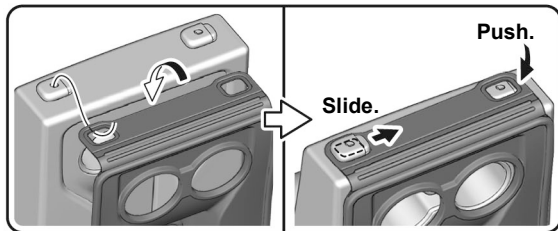

**CENTER SEAT-BACK
PROTECTOR**
(Identification mark: CTR)

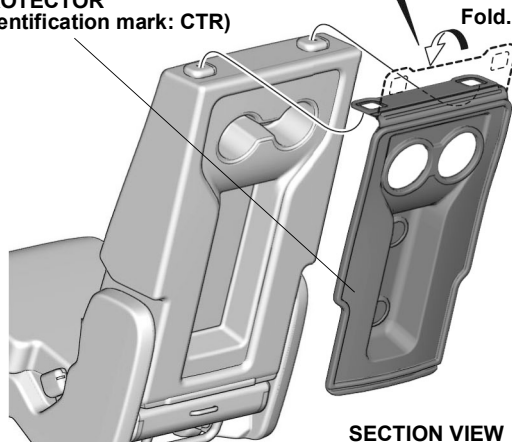

SECTION VIEW

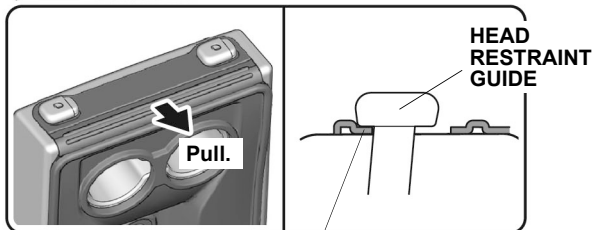

**CENTER SEAT-BACK
PROTECTOR**

QM61712BN

17. Fold down the center second row seat.
18. Secure the center seat-back protector.

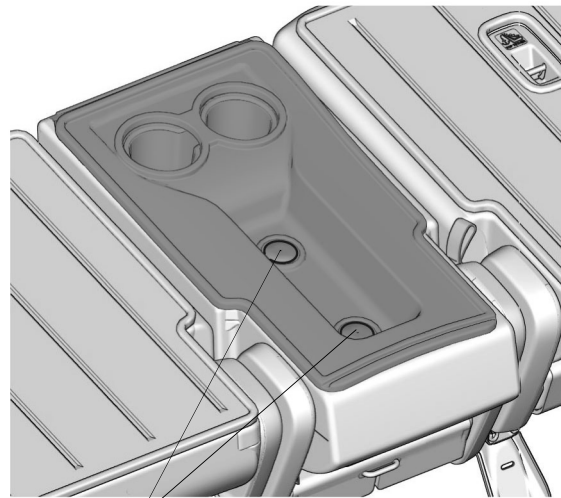

QM61713BN

19. Install the head restraints.
20. Check that all parts are installed properly.