

Germain Honda of College Hills



INSTALLATION INSTRUCTIONS

Accessory
ROOF RAILS

Application
2023 PILOT
MODEL SERIES

Publications No.
VERSION 1
Issue Date
NOV 2022

GENERAL VIEW

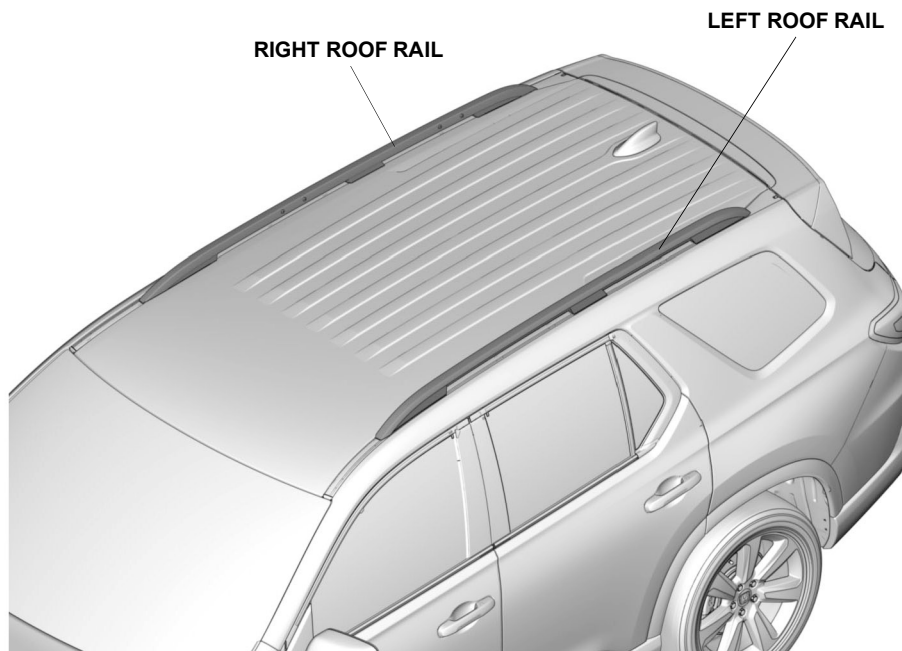

QM60701AA

FOR YOUR SAFETY (Read carefully.)

Warning Symbols

Safety: Your safety, and the safety of others, is important. To help you make informed decisions about service procedures, we have provided safety messages where appropriate. Of course, it is not practical or possible to warn you about all the hazards associated with servicing a vehicle - you must use your own good judgment.

You will find important safety messages preceded by one of the following symbols:

*All symbols are not used in all installation instructions.

 **DANGER**

You will be killed or seriously hurt if you do not follow the instructions.

 **WARNING**

You can be killed or seriously hurt if you do not follow the instructions.

 **CAUTION**

You can be hurt if you do not follow the instructions.

NOTICE

Gives advice to prevent damage to the product, vehicle, the environment or other property.

NOTE

Gives helpful information or instructions to be followed when installing this product.



Indicates a prohibited action.

Germain Honda of College Hills

Procedure and Location Icons

These icons indicate the work location and the worker's point of view.

*All icons are not used in all installation instructions.



The location on the vehicle.



The location in the vehicle.
(Instrument panel.)



Wear eye protection.



Wear heavy gloves.



Use an assistant.



Place the part on a blanket.



Work perpendicular.



Remove any burrs.



Use touch-up paint and allow to dry.



Tighten to the specified torque.



Apply firm pressure while rolling, especially at the ends, to set the adhesive.



Press firmly.



Clean with isopropyl alcohol.



Return the original part to the customer.
(Do not reuse.)

Safety: General

- Observe all safety notes and precautions described in the service information, in addition to those described in this Installation Instruction. Be extremely careful for your safety and safety of others.
- Be careful not to damage the vehicle or the parts.
- Note the locations of the parts before removing them so they can be properly installed in their original positions.
- The illustrations may differ slightly from the actual accessory.

Safety: Accessory

Always use the parts and tools specified in the installation instructions.

PARTS LIST

Roof Rails Kit (P/N 08L02-T90-100B)

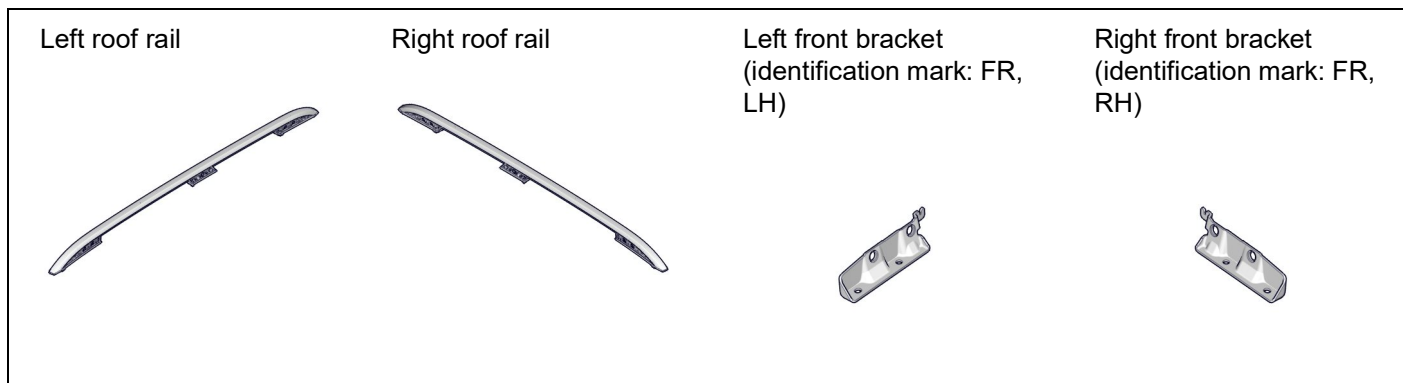

Germain Honda of College Hills

Left center bracket
(identification mark: LH)



Right center bracket
(identification mark: RH)



Left rear bracket
(identification mark: RR,
LH)



Right rear bracket
(identification mark: RR,
RH)



Left front cover
(identification mark: FR,
LH)

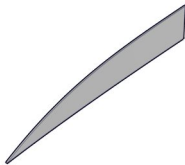

Right front cover
(identification mark: FR,
RH)

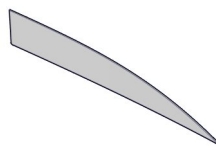

Left center cover
(identification mark: LH)

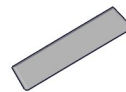

Right center cover
(identification mark: RH)

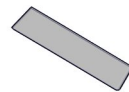

Left rear cover
(identification mark: RR,
LH)

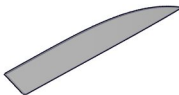

Right rear cover
(identification mark: RR,
RH)

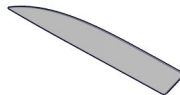

Left clips A (2)
(identification mark: L)

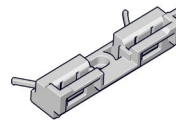

Right clips A (2)
(identification mark: R)

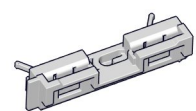

Left clip B

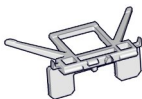

Right clip B

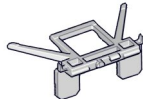

Left clip C

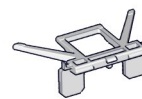

Right clip C

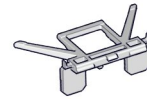

Clips D (6)

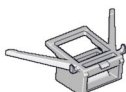

TORX Bolts (10)

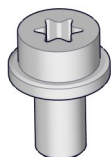

TORX Nuts (12)



Germain Honda of College Hills

REQUIRED TOOLS AND SUPPLIES

- Flat-tip screwdriver
- T-45 TORX bit
- File
- Felt-tip pen
- Masking tape
- Torque wrench
- Ruler
- Tape measure
- Putty knife
- Eye protection (face shield, safety goggles, etc.)

The following tools are available through the Honda Tool and Equipment Program:

- Trim Tool Set (T/N SOJATP2014)
- Plastic Trim Tool (T/N SILTRIMTL10)
- Air Saw (T/N AT192A)

Germain Honda of College Hills

INSTALLATION

1. Attach masking tape.

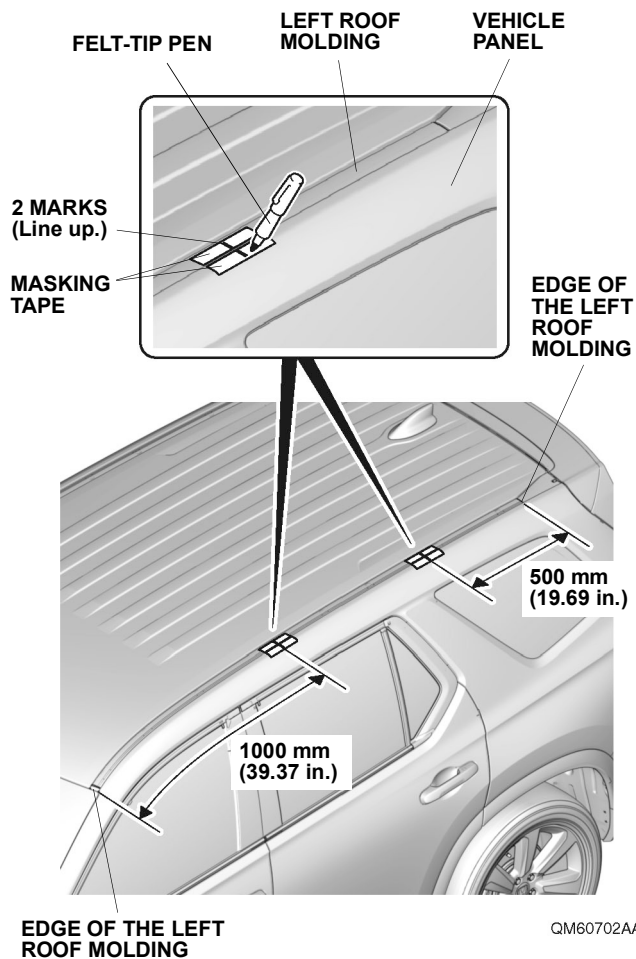
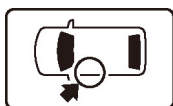

2. Mark the masking tape.

3. Remove the left roof molding.

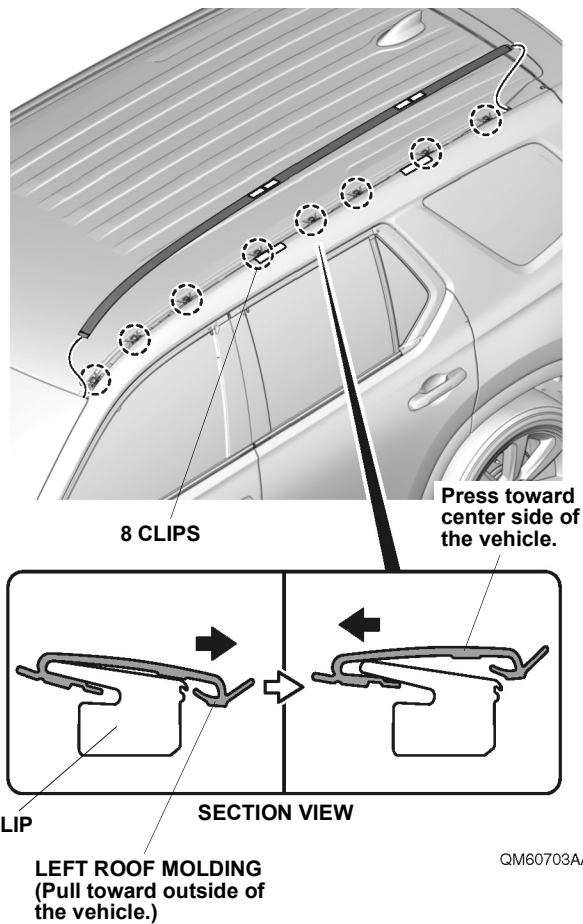

Germain Honda of College Hills

4. Remove the top portion of the clips.

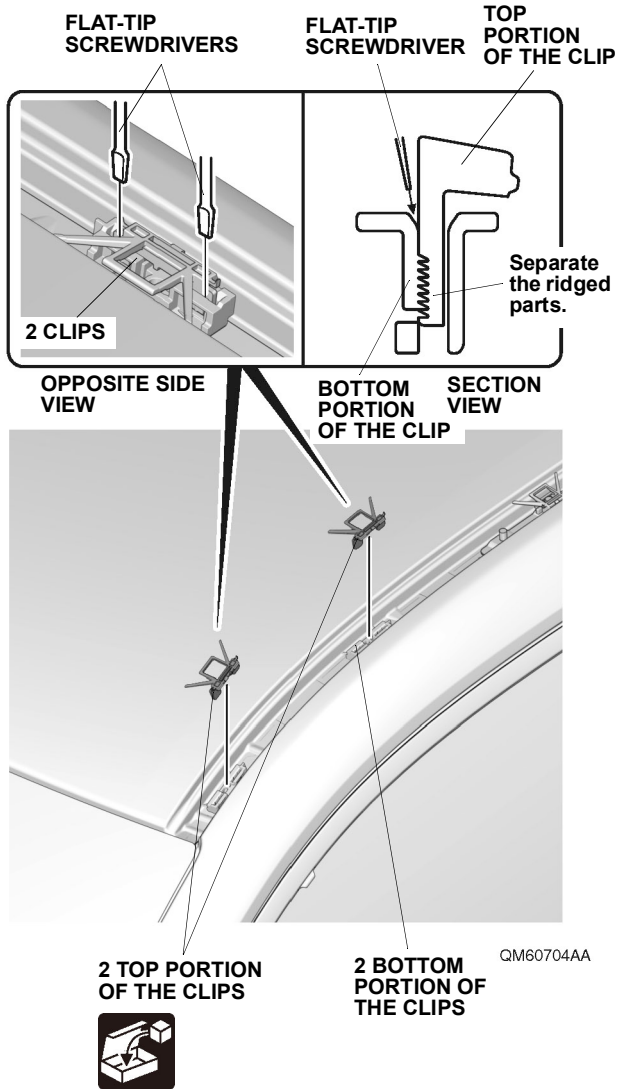

5. Remove the bottom portion of the clips.

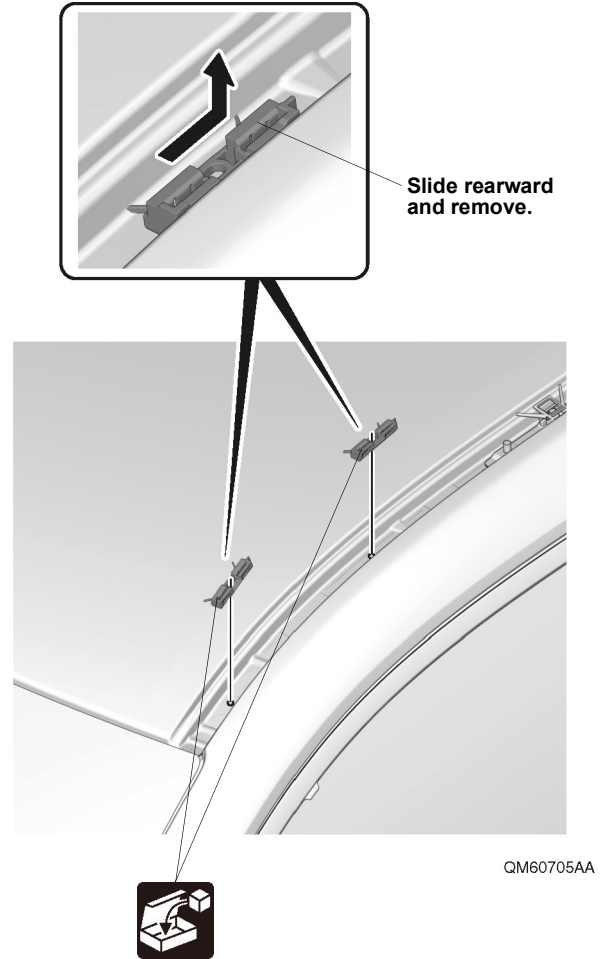

Germain Honda of College Hills

6. Remove the clips.

**FLAT-TIP
SCREWDRIVERS**
(Alternately insert to
release the locking tabs.)

**FLAT-TIP
SCREWDRIVERS**

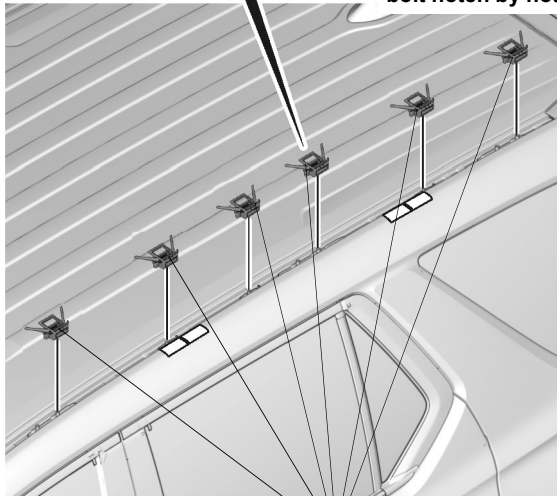
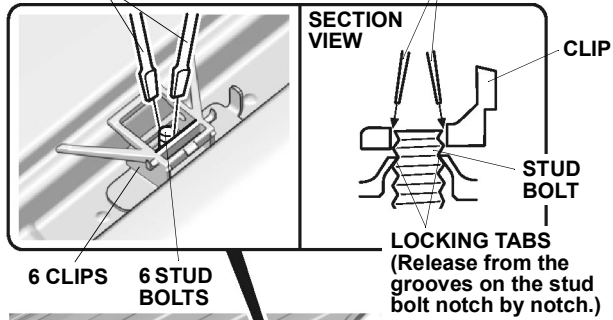

7. Remove the sealant.

6 STUD BOLTS

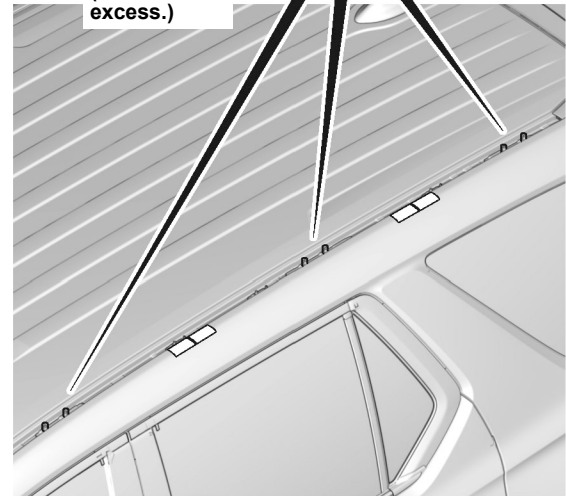
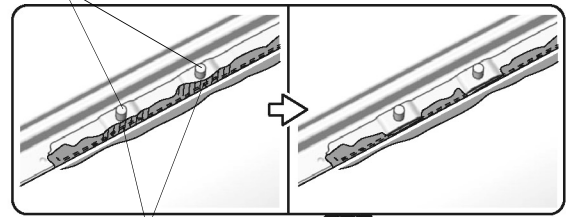

Germain Honda of College Hills

8. Install the left clips A.

NOTE

Make sure to check the identification mark before installation.

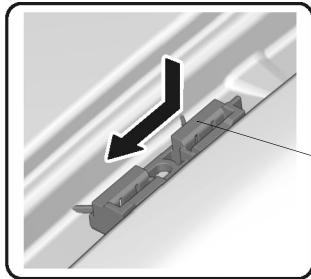

2 LEFT CLIPS A
(identification
mark: L)
(Slide frontward
and install.)

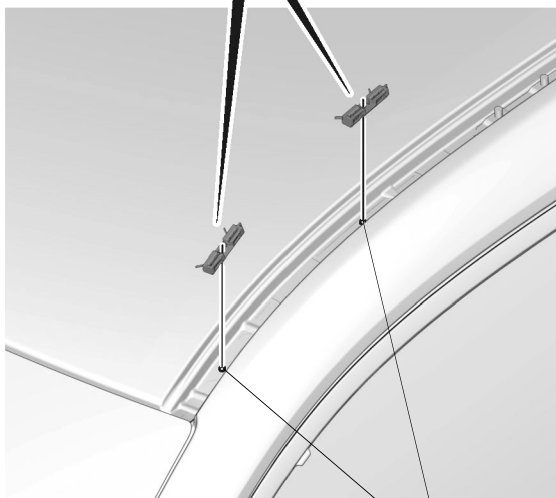

QM60708AA

2 STUDS

9. Mark the left roof molding.

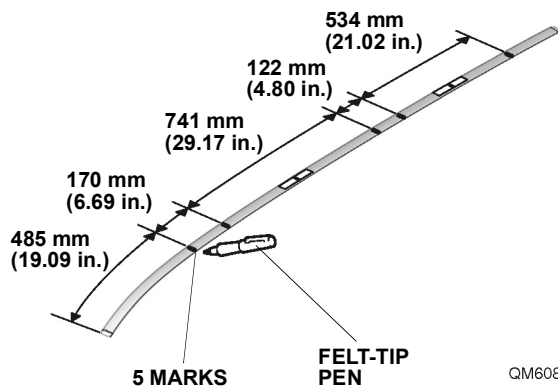

QM60801AA

10. Cut the left roof molding.

NOTE

Do not use a cutting wheel or shears to cut the roof molding; that can damage the roof molding.



5 MARKS

AIR SAW

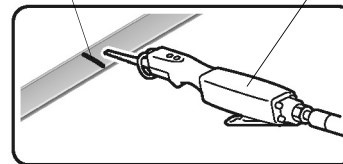

REAR PORTION
OF THE LEFT
ROOF MOLDING

CENTER PORTION
OF THE LEFT
ROOF MOLDING

FRONT PORTION
OF THE LEFT
ROOF MOLDING

QM60802AA

Germain Honda of College Hills

11. Install the left clip B and left clip C.

NOTE

Make sure to check the shape before installation.

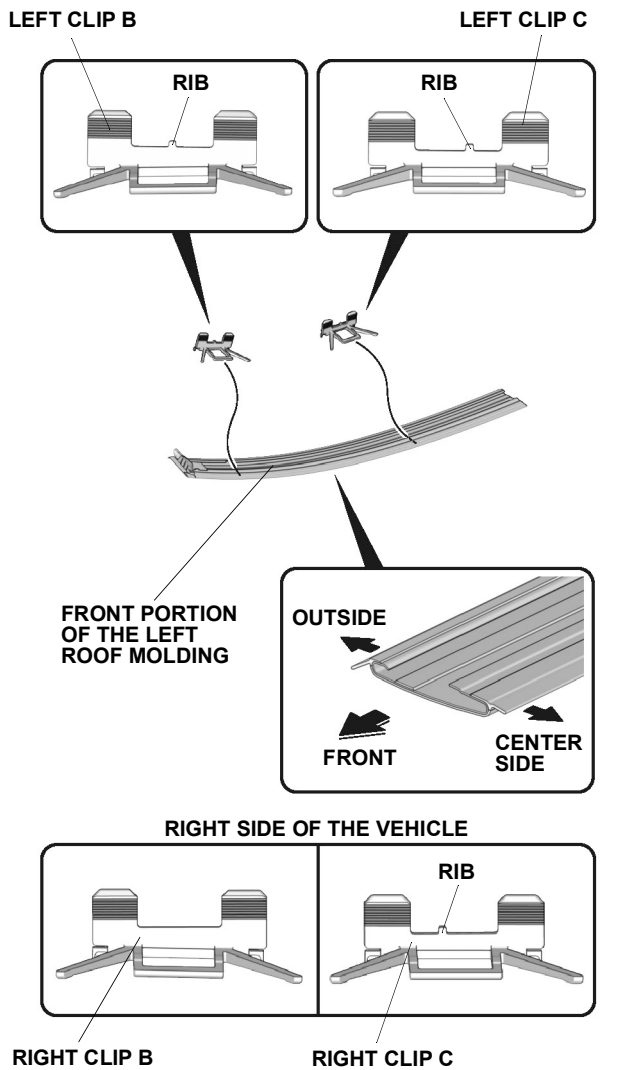

12. Install the clips D.

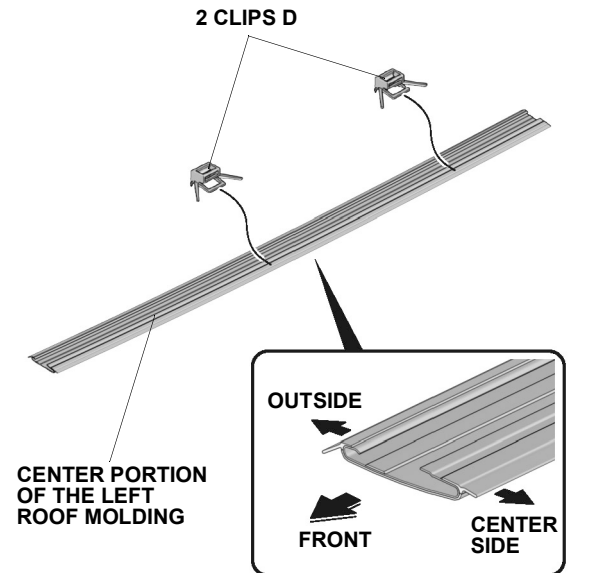

13. Install the clip D.

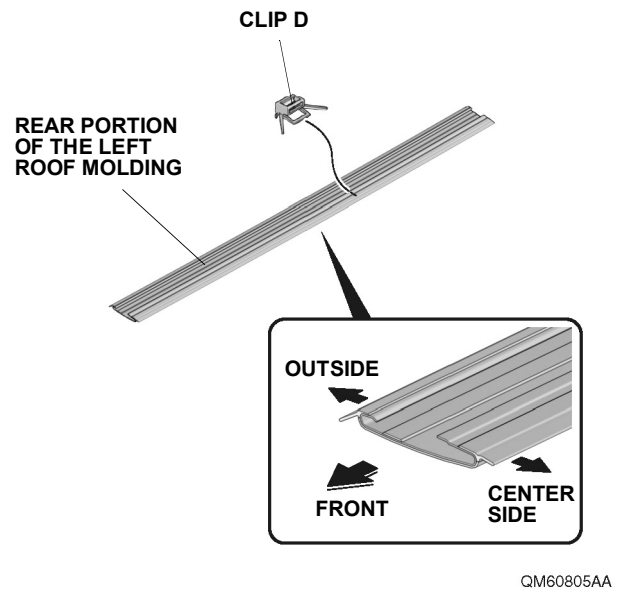

Germain Honda of College Hills

14. Install the left roof molding.

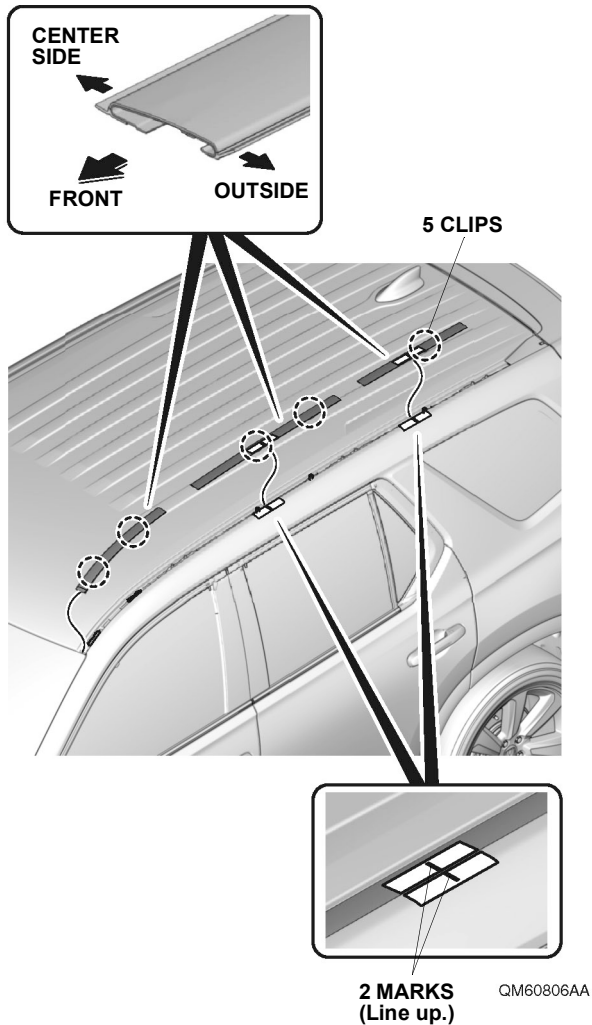

15. Remove the masking tape.

16. Install the left front bracket, left center bracket, and left rear bracket.

NOTE

Make sure to check the identification mark before installation.

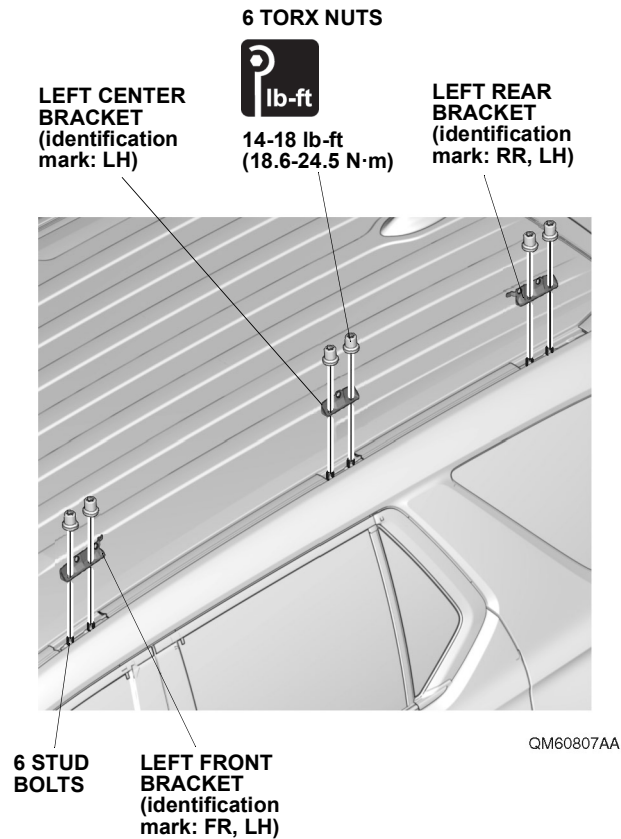

Germain Honda of College Hills

17. Install the left roof rail.

LEFT ROOF RAIL

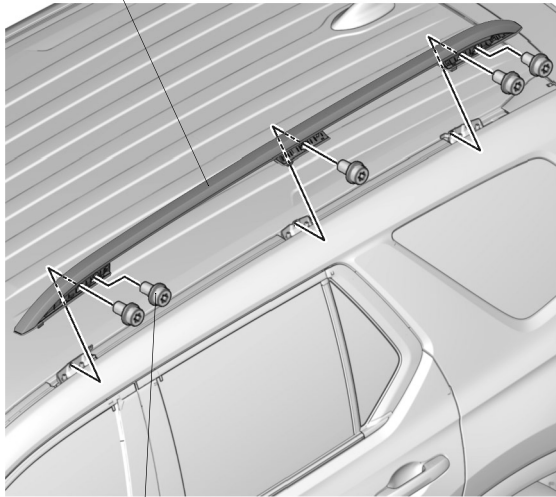

5 TORX BOLTS



14-16.4 lb-ft
(18.6-22.2 N·m)

QM60808AA

18. Install the left front cover, left center cover, and left rear cover.

NOTE

Make sure to check the identification mark before installation.

LEFT CENTER COVER
(identification mark: LH)

LEFT REAR COVER
(identification mark: RR, LH)

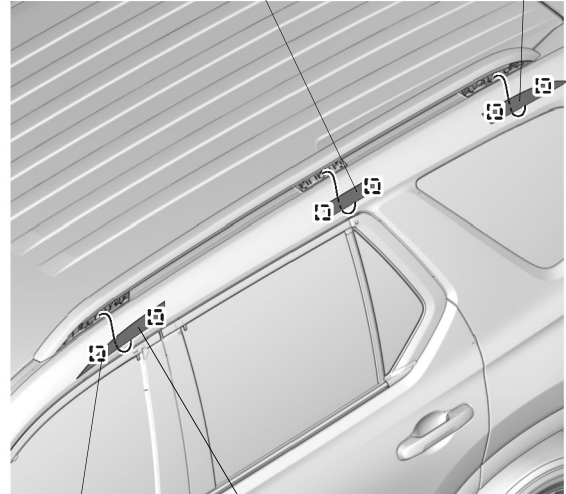

QM60809AA

6 RETAINING TABS

LEFT FRONT COVER
(identification mark: FR, LH)

19. Repeat the same procedures on the other side.

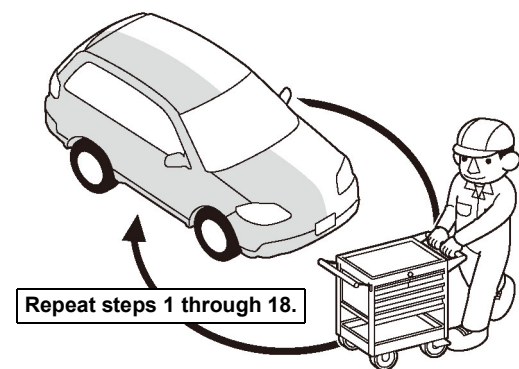

Q9D1014AM

20. Check that all parts are installed properly.