



HONDA

INSTALLATION INSTRUCTIONS

Accessory

TRAILER HARNESS
P/N08L91-TG7-100B

Application

2022 PILOT

Publications No.

VERSION 1

Issue Date

JUL 2021

PARTS LIST

Control unit bracket

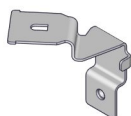

Fuse box bracket



Control unit harness

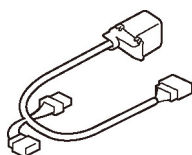

Socket harness

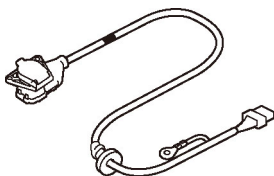

Control unit

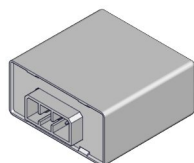

2 Blade fuses, 20A
(Contained in the subharness kit.)

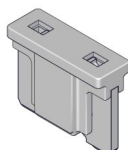

30A Block fuse

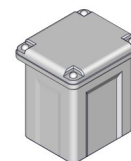

2 Relays

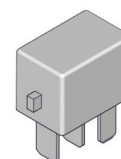

5 Wire ties



6 x 16 mm Flange bolt



6 x 19 mm Shoulder bolt



Washer-bolt



Ground bolt



2 Flange nuts



Aluminum tape

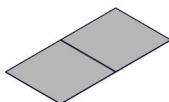

Subharness kit

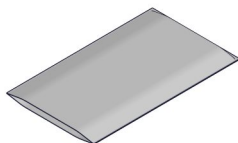

Accessory User's Information Manual

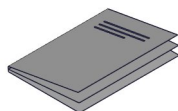

TOOLS AND SUPPLIES REQUIRED

10 mm Open end wrench

Ratchet

Phillips screwdriver

8 mm and 10 mm Sockets

File

Utility knife

Diagonal cutters

Isopropyl alcohol

Shop towel

The following tools are available through the Honda Tool and Equipment Program. On the iN, click on Service > Service Bay > Tool and Equipment Program, then enter the number under "Search." Or, call 888-424-6857.

- Trim Tool Set (T/N SOJATP2014)
- Plastic Trim Tool (T/N SILTRIMTL10)

Illustration of the Trailer Harness on the Vehicle

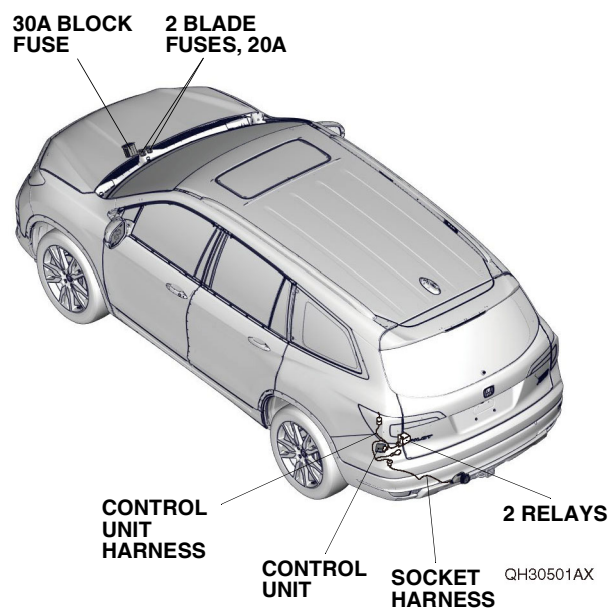

INSTALLATION

Customer Information: The information in this installation instruction is intended for use only by skilled technicians who have the proper tools, equipment, and training to correctly and safely add equipment to your vehicle. These procedures should not be attempted by “do-it-yourselfers.”

NOTE:

- If you are also installing the trailer hitch, install it after you install the trailer hitch harness.
 - If you are also installing the backup sensor, rear welcome lights, or hands-free access power tailgate, install them before you install the trailer hitch harness.
1. Disconnect the negative cable from the battery:
 - Wrap a shop towel around the hood latch.

HOOD LATCH
(Wrap with a shop towel.)

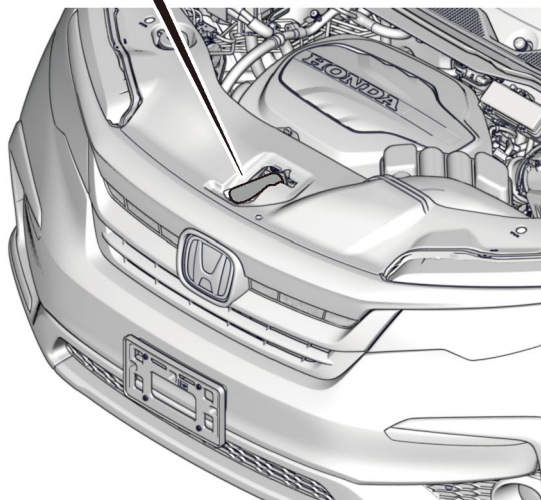
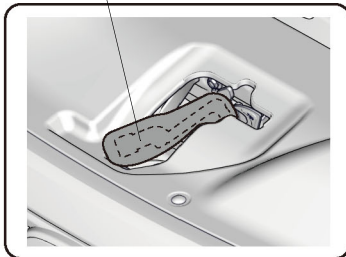

QH21201AB

- Remove the front bulkhead cover.

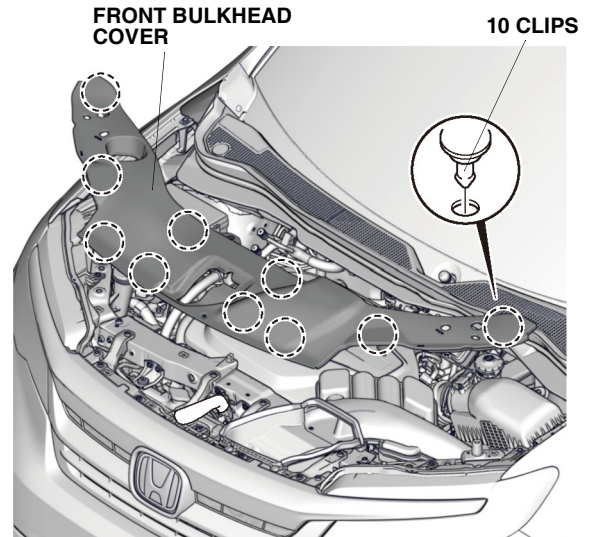

QH21202AB

- Remove the intake air tube.
- Disconnect the negative cable from the battery.

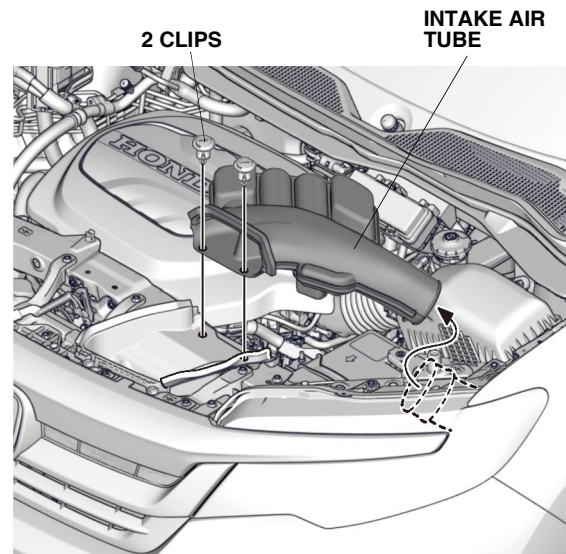

QH21203AB

2. Pull each strap, and fold down the third row seats.

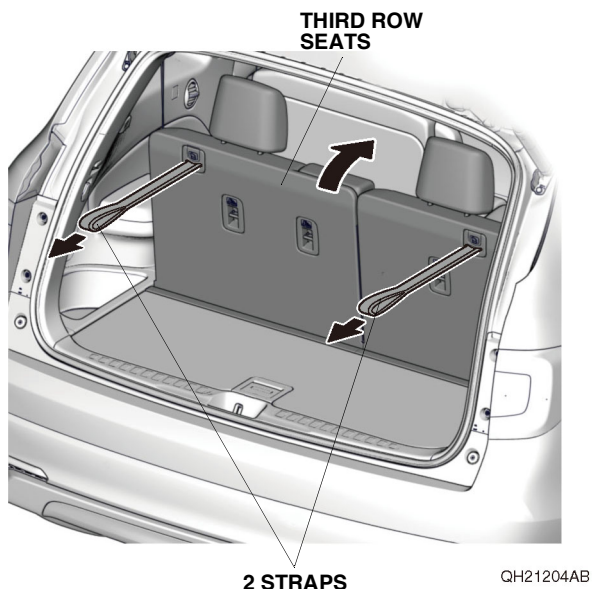

3. Remove the cargo lid.

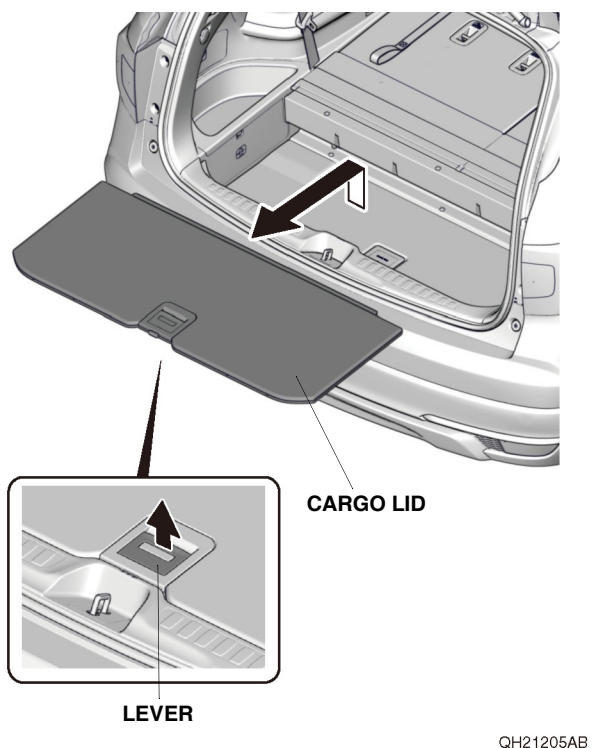

4. Using a plastic trim tool, and remove the access panel.

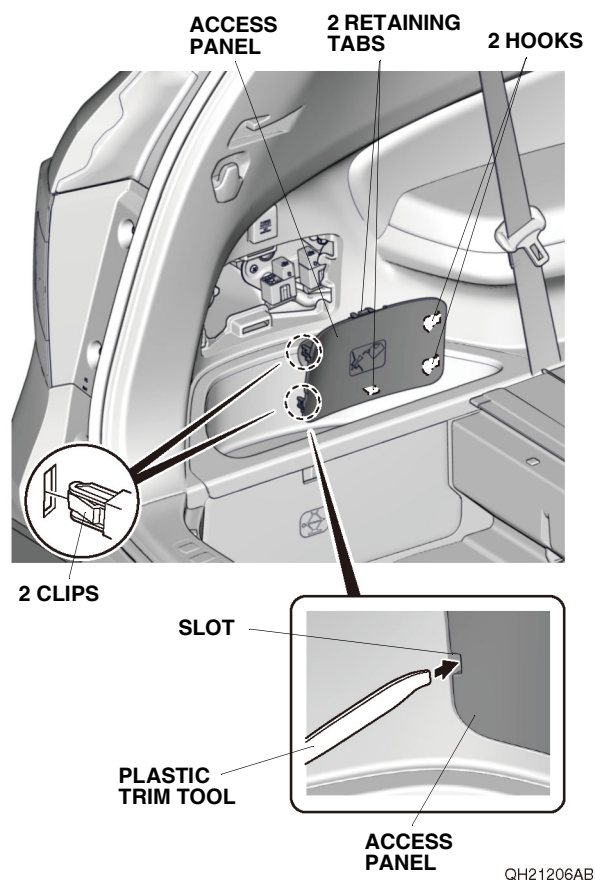

5. Remove the jack access panel.

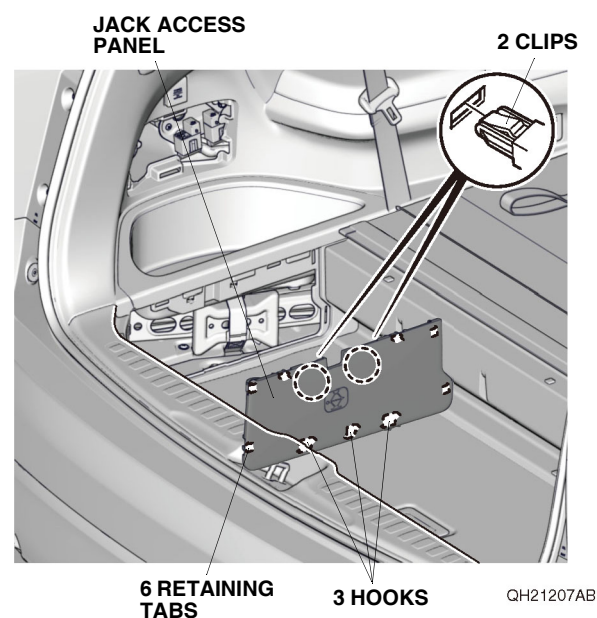

6. Remove the jack.

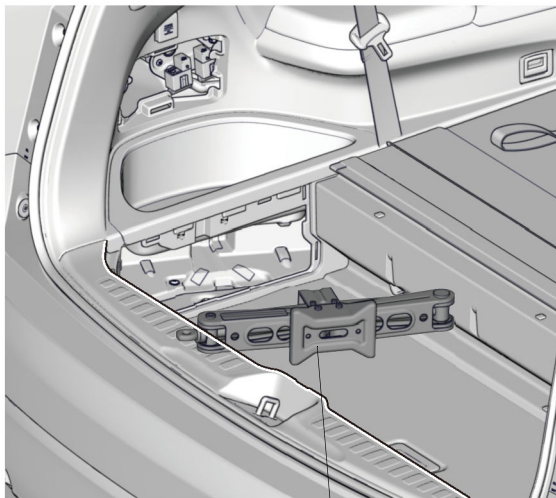

JACK

QH21208AB

7. Install the control unit bracket to the control unit.

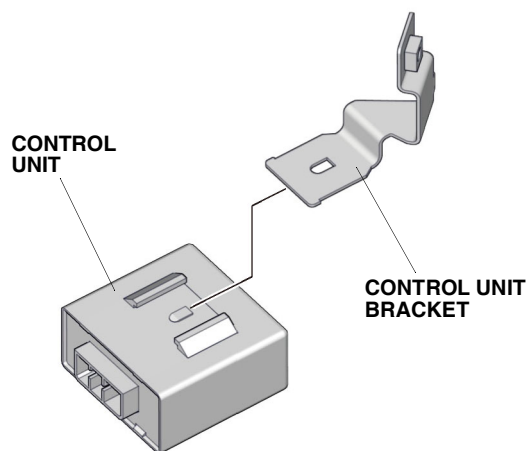

QDD0111AB

8. Loosely install the washer-bolt to the control unit bracket.

**WASHER-BOLT
(Loosely install.)**

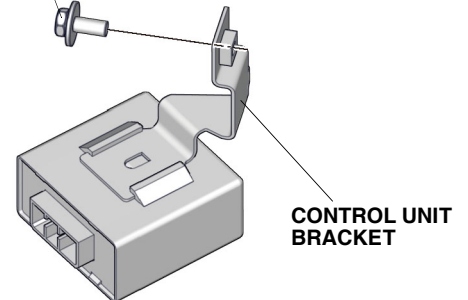

**CONTROL UNIT
BRACKET**

QDD0112AB

9. Install the control unit to the vehicle panel as shown.

**LEFT REAR SIDE
TRIM PANEL**

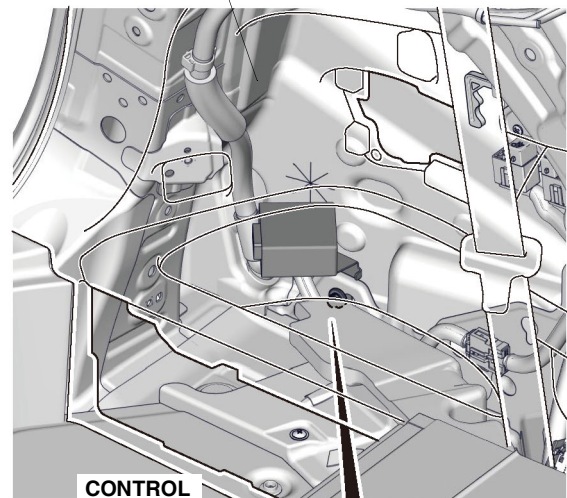

**CONTROL
UNIT**

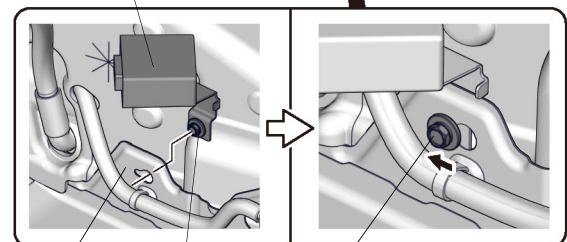

**VEHICLE
PANEL**

**WASHER
-BOLT**

**WASHER-BOLT
(Tighten.)**

QH30502AX

If the vehicle is equipped with another accessory harness, go to step 13; if the vehicle is equipped with two other accessory harnesses, go to step 16; otherwise, continue with step 10.

Without another accessory harness

10. Remove the tape, and pull down the vehicle 14-pin connector as shown.

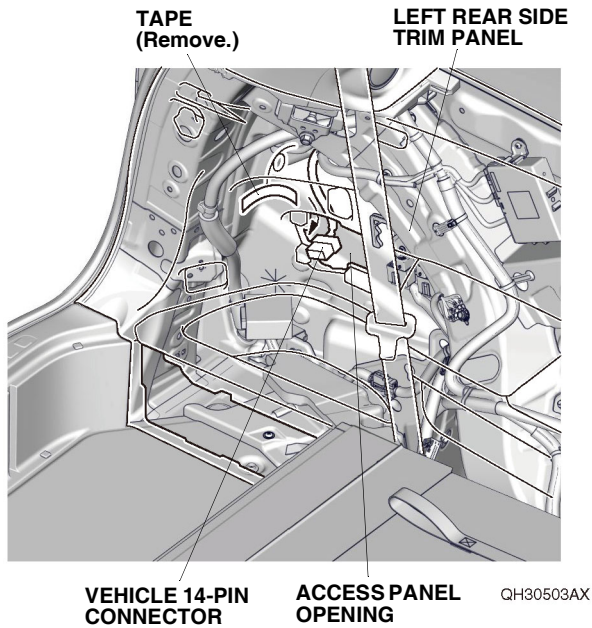

11. Route the control unit harness 14-pin connector, and plug it into the vehicle 14-pin connector.

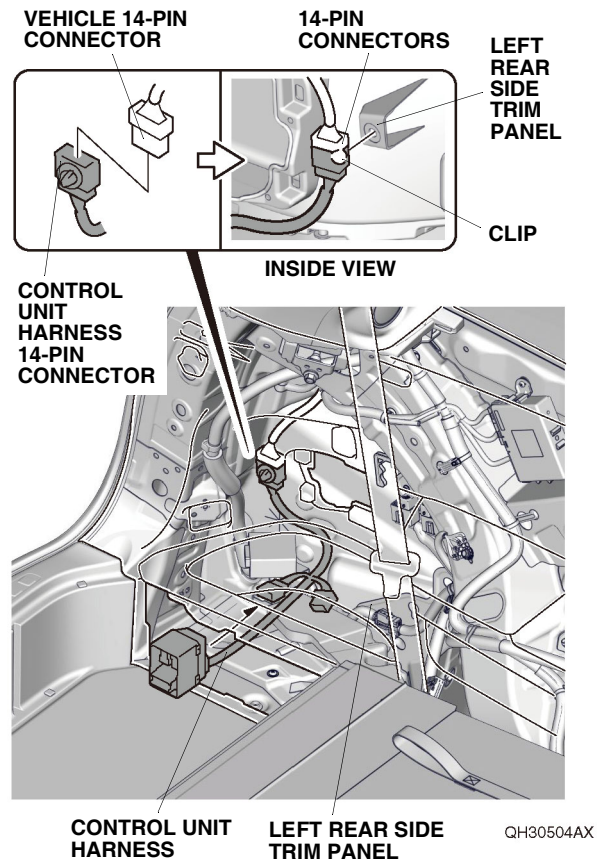

12. Secure the 14-pin connectors to the back of the left rear side trim panel with the clip on the control unit harness 14-pin connector. Go to step 20.

With another accessory harness

13. Remove the tape to free the other accessory harness 14-pin connector as shown.

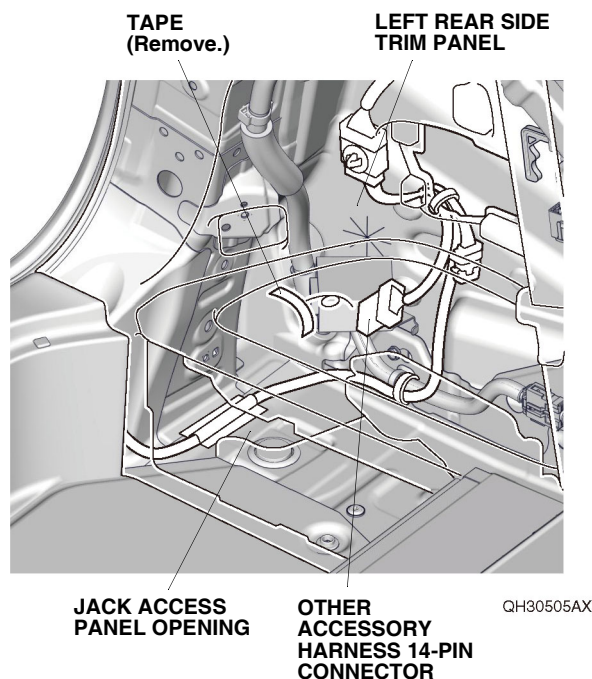

14. Remove the clip from the control unit harness 14-pin connector. Route the control unit harness 14-pin connector, and plug the other accessory harness 14-pin connector into the control unit harness 14-pin connector.

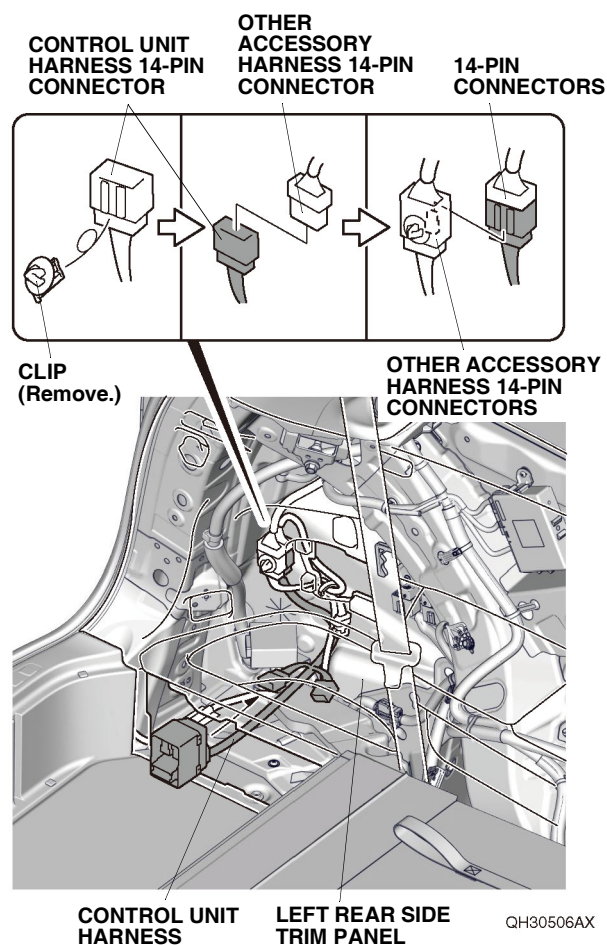

15. Secure the 14-pin connectors to the back of the other accessory harness 14-pin connectors. Go to step 20.

With two other accessory harnesses

16. Remove the tape to free the other accessory harness 14-pin connector as shown.

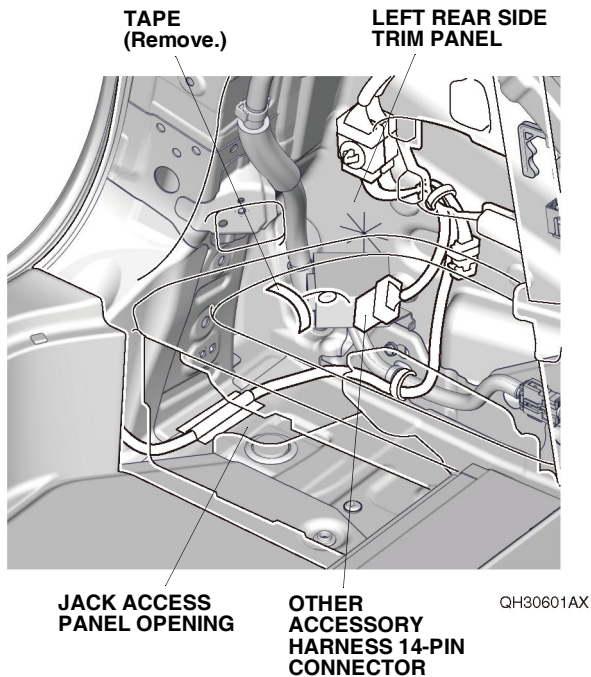

17. Remove the clip from the control unit harness 14-pin connector. Route the control unit harness 14-pin connector, and plug the other accessory harness 14-pin connector into the control unit harness 14-pin connector.

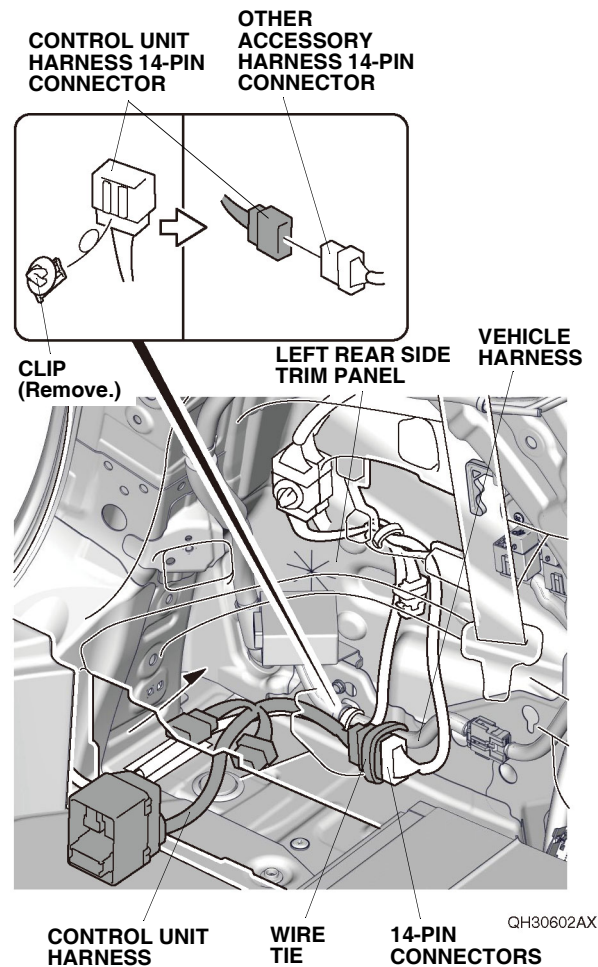

18. Secure the 14-pin connectors to the vehicle harness with one wire tie.

19. Plug the control unit harness 12-pin connector into the control unit. Go to step 21.

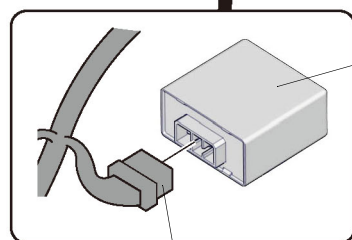
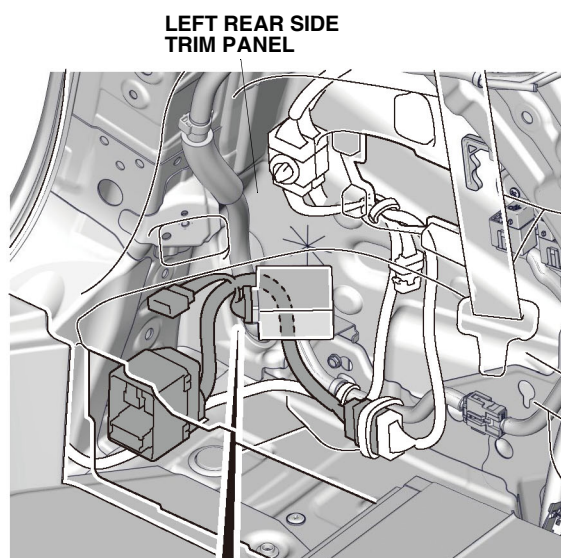

CONTROL UNIT

CONTROL UNIT HARNESS 12-PIN CONNECTOR

QH30603AX

20. Plug the control unit harness 12-pin connector into the control unit.

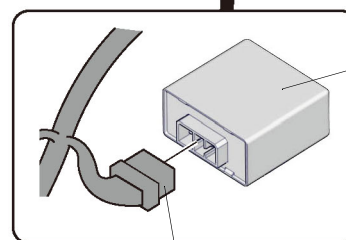
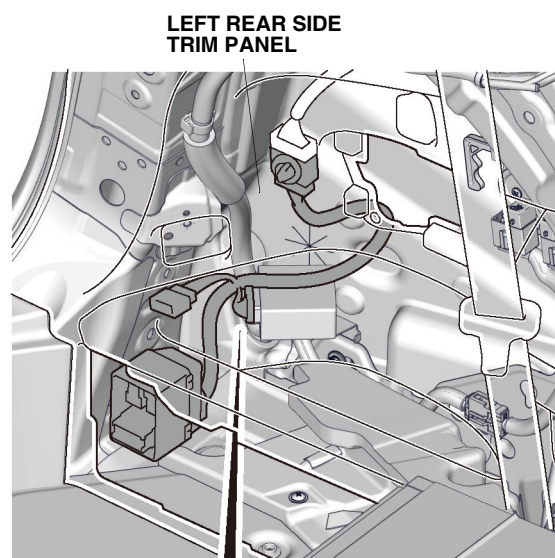

CONTROL UNIT

CONTROL UNIT HARNESS 12-PIN CONNECTOR

QH30604AX

21. Remove the vehicle grommet from the vehicle panel.

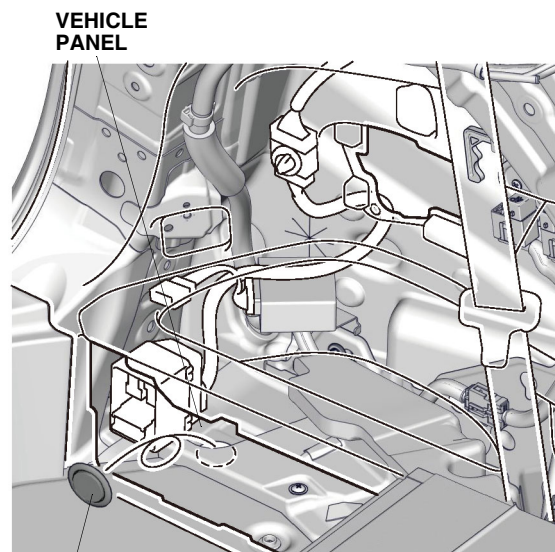

VEHICLE GROMMET (Do not reuse.)

QH30605AX

If the vehicle is equipped with a trailer hitch, continue with step 22; otherwise, go to step 23.

With trailer hitch

22. Remove the trailer hitch as described in the installation instructions.

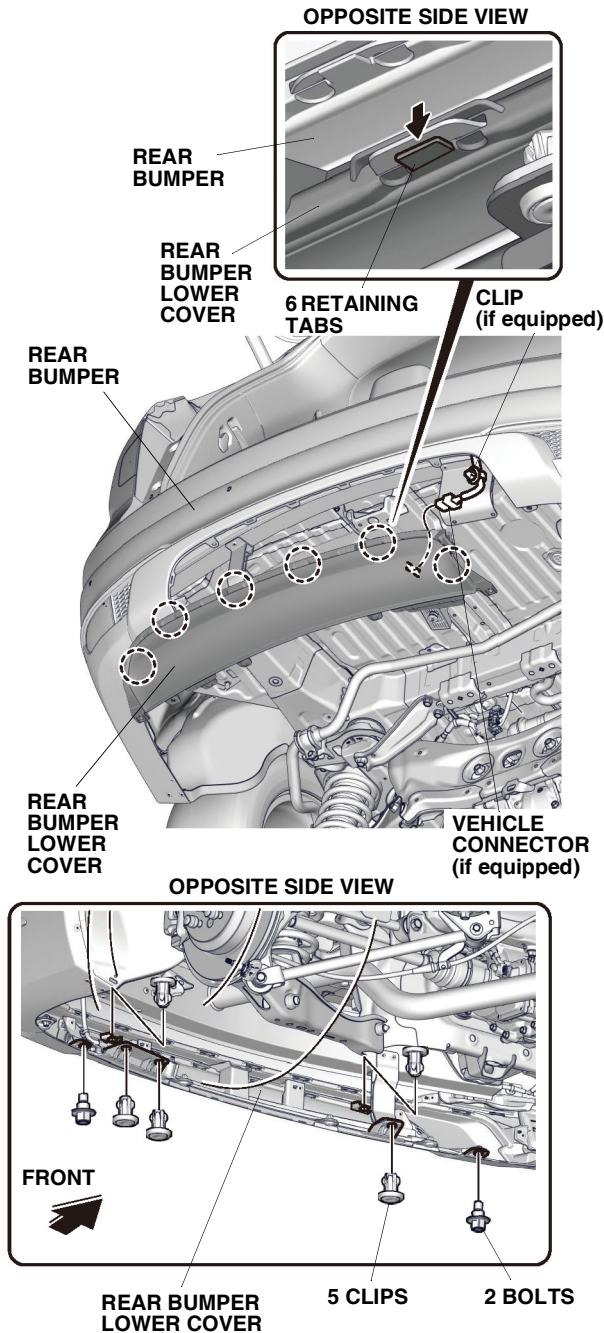

QH30606AX

23. Remove the rear bumper lower cover, and unplug the vehicle connector (if equipped).

24. Route the socket harness 8-pin connector and socket harness ground terminal through the vehicle grommet hole, and install the socket harness grommet into the vehicle grommet hole.

NOTE:

- Install the socket harness by holding the grommet.
- Make sure to check that the grommet is secured properly.

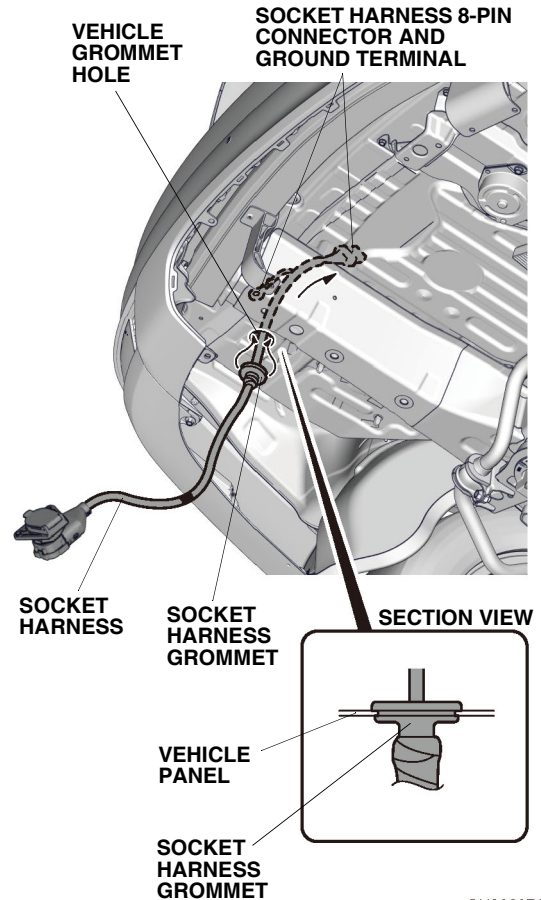

QH30607AX

25. Using a utility knife, cut out the trailer hitch cover as shown. Remove any burrs.

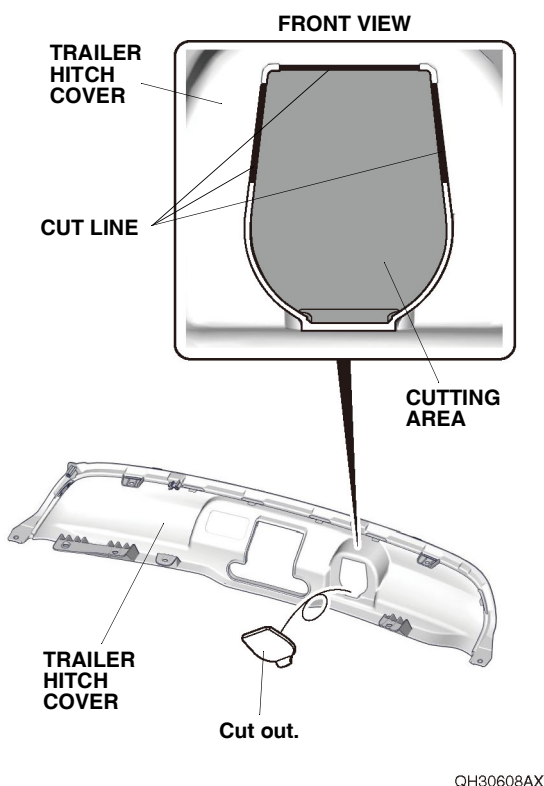

26. Install the trailer hitch cover as described in the trailer hitch installation instructions.
NOTE: Do not install the clip shown below until step 29.

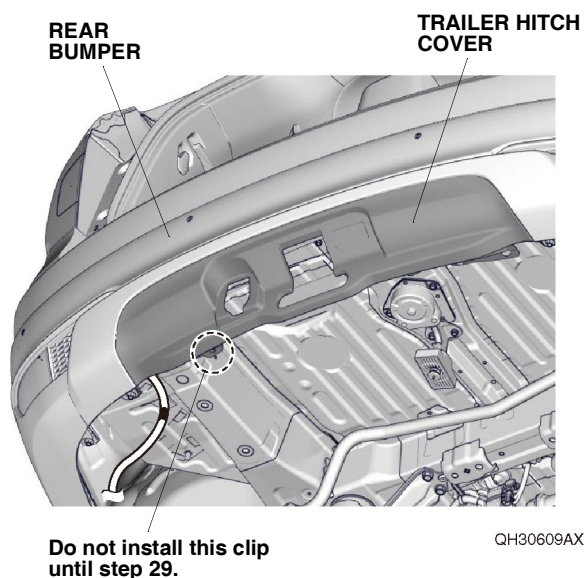

27. With the help of an assistant, bring the trailer hitch close to the vehicle, install the socket harness 7-pin socket to the trailer hitch with one 6 x 16 mm flange bolt, one 6 x 19 mm shoulder bolt, and two flange nuts.

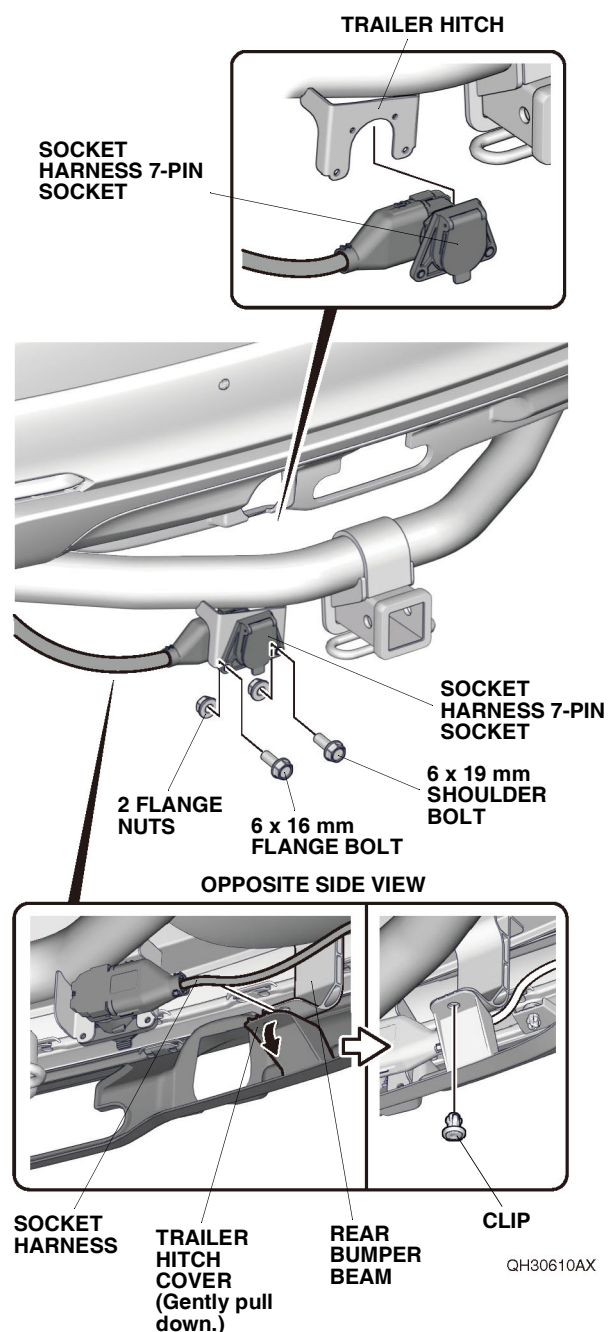

28. Gently pull down on the trailer hitch cover, and route the socket harness between the trailer hitch cover and rear bumper beam as shown. Install the trailer hitch as described in the trailer hitch installation instructions.
29. Install the clip removed in step 23 to the trailer hitch cover.

If the vehicle is equipped with accessory rear welcome lights, continue with step 30; otherwise, go to step 32.

With accessory rear welcome lights

30. Secure the green tape on the socket harness to the vehicle bracket with one wire tie as shown.

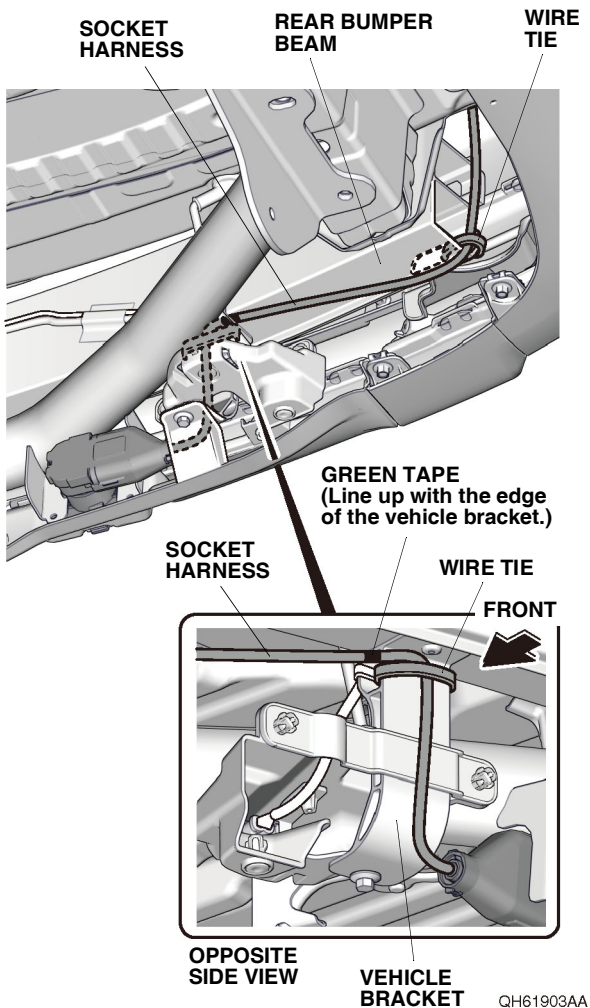

31. Secure the socket harness to the rear bumper beam with one wire tie. Go to step 34.

Without accessory rear welcome lights

32. Secure the green tape on the socket harness to the trailer hitch with one wire tie.

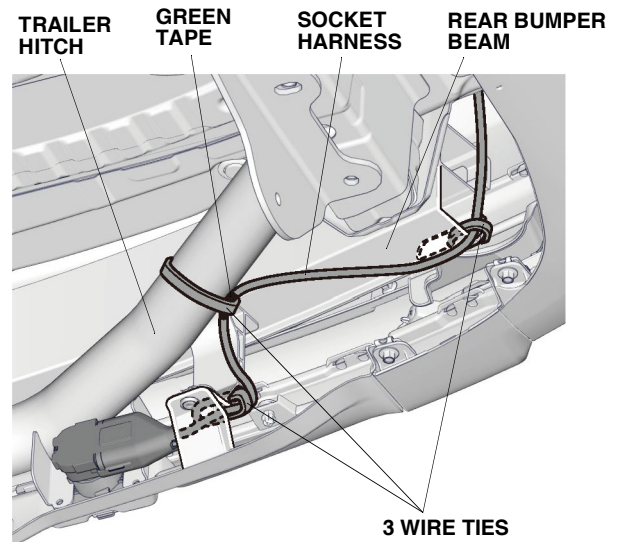

QH30611AX

33. Secure the socket harness to the rear bumper beam with two wire ties.

34. Secure the socket harness ground terminal and fuse box bracket to the vehicle panel with one ground bolt.

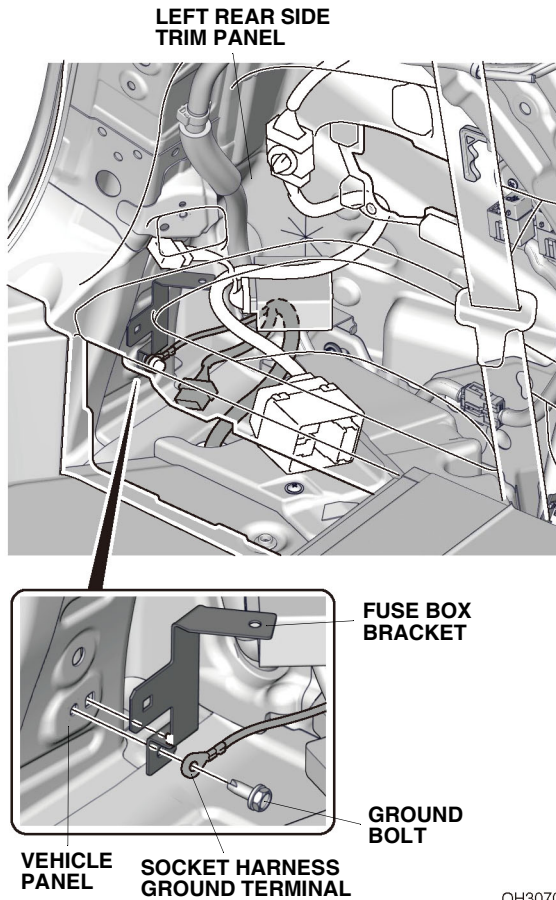

35. Plug the socket harness 8-pin connector to the control unit harness 8-pin connector.

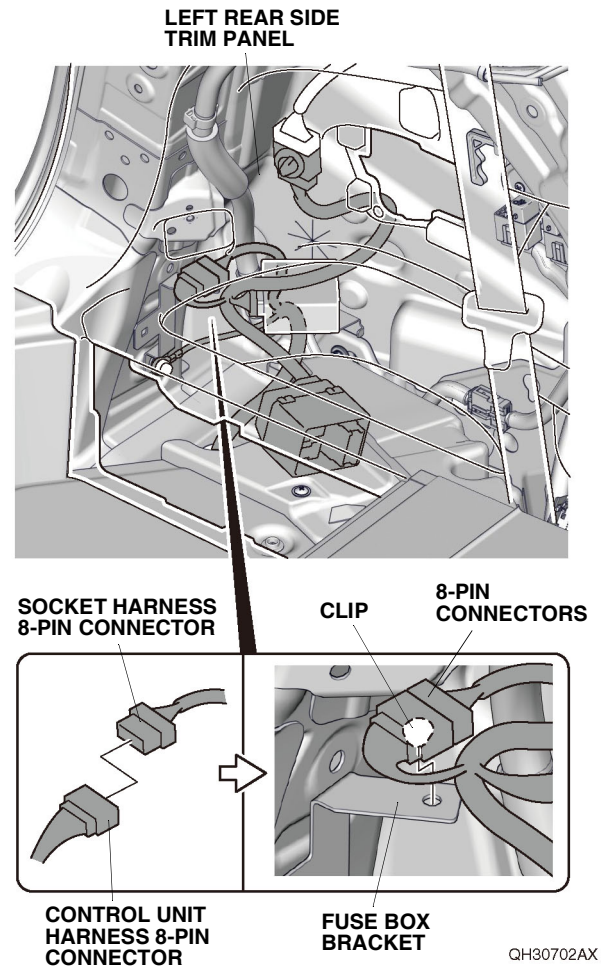

36. Secure the 8-pin connectors to the fuse box bracket with the clip on the control unit harness 8-pin connector.

37. Install the two relays into the fuse box on the control unit harness, and secure the fuse box to the fuse box bracket.

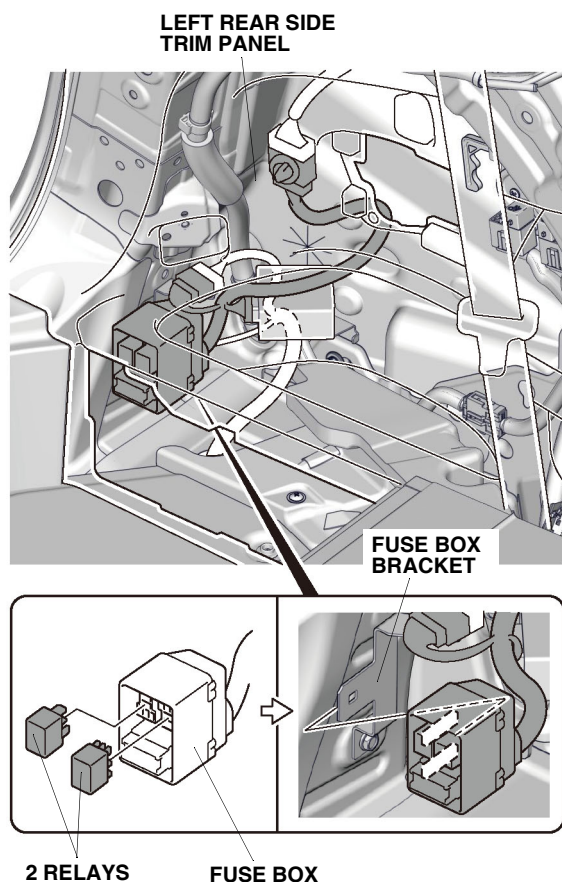

38. Secure the control unit harness to the left rear side trim panel with one wire tie.

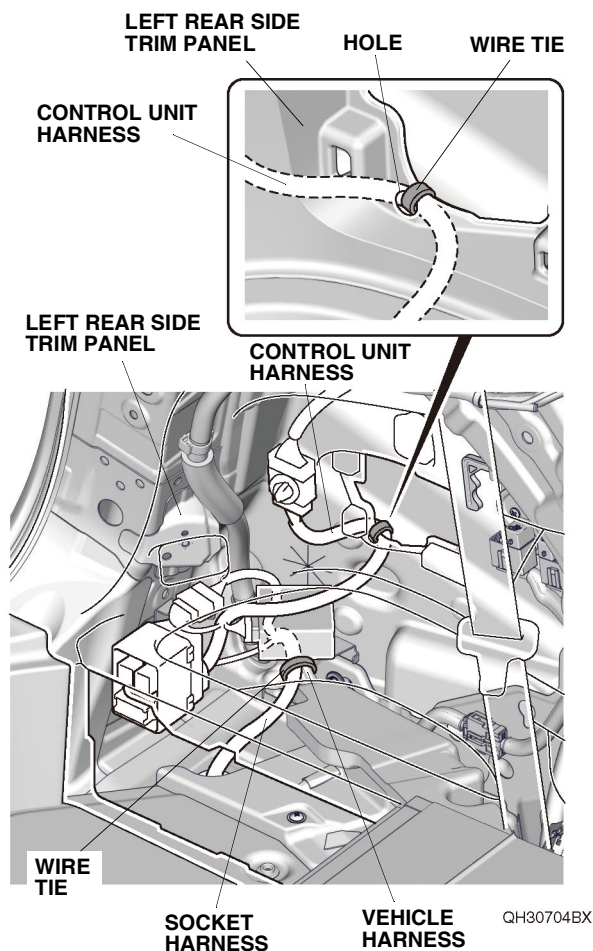

39. Secure the socket harness to the vehicle harness with one wire tie.

40. Using isopropyl alcohol on a shop towel, thoroughly clean the vehicle panel where the aluminum tape will attach.

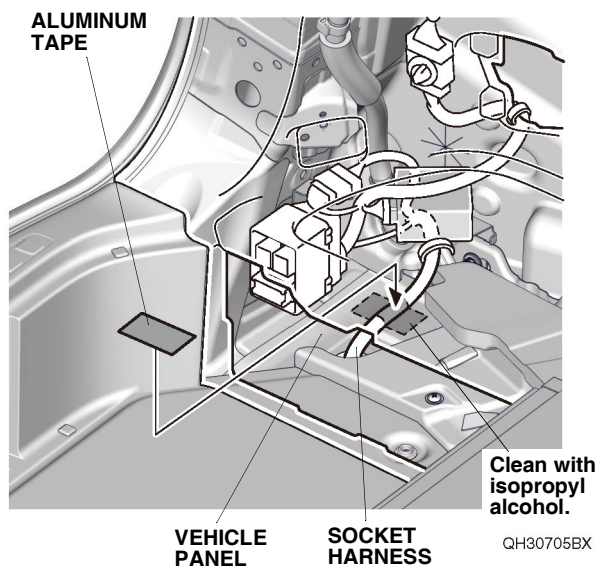

41. Secure the socket harness to the vehicle panel with one aluminum tape.
42. In the engine compartment, remove the cover from the sub fuse box.

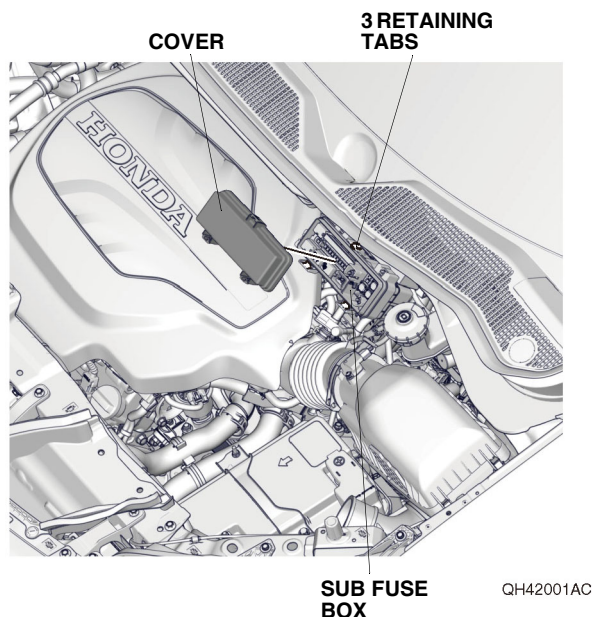

43. Plug the two 20A blade fuses and the 30A block fuse into the sub fuse box.

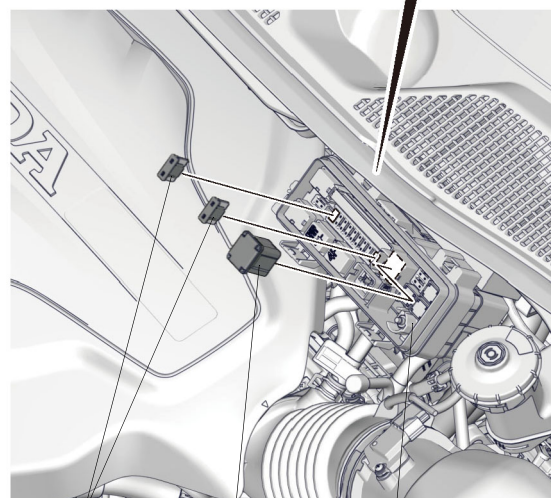
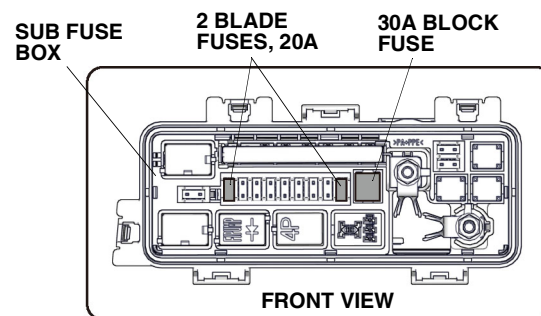

44. Check that all wire harnesses are routed properly and all connectors are plugged in.
45. Install all removed parts except for the front bulkhead cover and the intake air tube.
46. Connect the negative cable to the battery.
47. Install the front bulkhead cover and the intake air tube.
48. Press and hold the audio unit power button for 2 seconds to restore the audio and navi (if equipped) system functions.
49. Set the clock on vehicles without navigation.
50. If necessary, restore the systems back to normal operation as described in the service information.

Check the Operation of the Trailer Harness

51. Refer to the "TRAILER HARNESS TESTER", and perform the "Trailer Harness Circuit Check".

Give a copy of this page to your customer

How to Handle Subharness

This subharness is designed for use with the installation of an electric brake controller. Refer to the vehicle's Owner's Manual for the detailed information about handling this subharness.

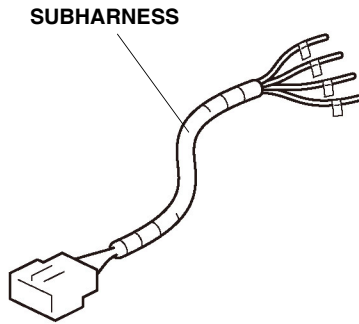

QBN0730AH