



HONDA INSTALLATION INSTRUCTIONS

Accessory

BLACK EMBLEM

Application

2022 PILOT

Publications No.

VERSION 1

Issue Date

JUL 2021

PARTS LIST

Rear Emblem + Car Name Kit
P/N 08F20-TG7-100

Rear H emblem



PILOT emblem



2 Alcohol wipes

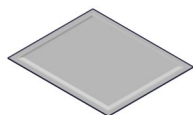

AWD Emblem Kit
P/N 08F20-TGS-100A

AWD emblem



Alcohol wipe



BLACK EDITION Emblem Kit
P/N 08F20-TG7-100G

BLACK EDITION emblem

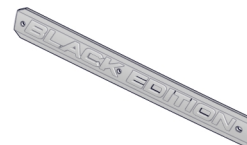

Alcohol wipe

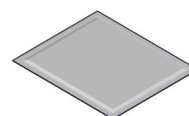

ELITE Emblem Kit
P/N 08F20-THR-100G

ELITE emblem



Alcohol wipe

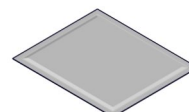

TOOLS AND SUPPLIES REQUIRED

Needle nose pliers

Masking tape

String

Illustration of the Black Emblems Installed on the Vehicle

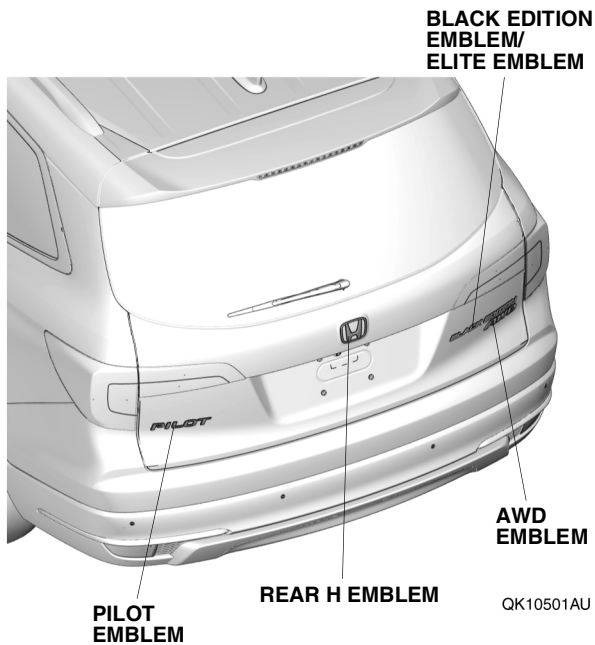

INSTALLATION

Customer Information: The information in this installation instruction is intended for use only by skilled technicians who have the proper tools, equipment, and training to correctly and safely add equipment to your vehicle. These procedures should not be attempted by "do-it-yourselfers."

NOTE:

- Be careful not to damage the body paint finish.
- This kit should be installed only if the ambient air temperature is 60°F (15°C) or above.
- To allow the adhesive to cure, do not wash the vehicle for 24 hours. Make sure the your customer is aware of this.

Installing the Black Emblems

1. Using a piece of string, remove the rear H emblem by cutting along the outer edges as shown.

NOTE:

- Do not damage the vehicle body when removing the H emblem with the string.
- Make sure to thoroughly remove the adhesive tape from the tailgate.

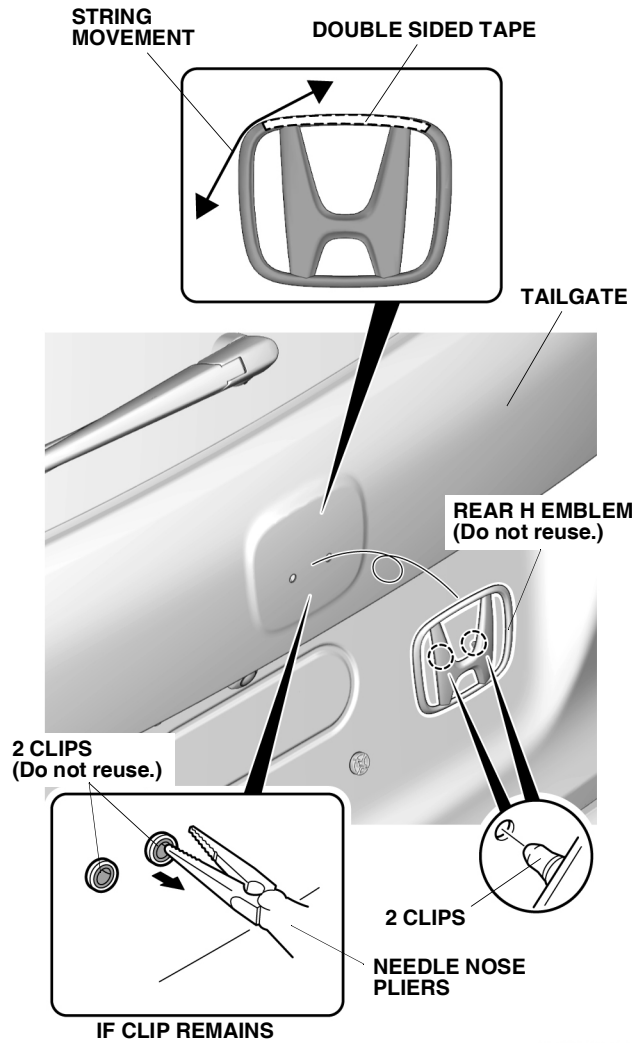

- Using an alcohol wipe, thoroughly clean the tailgate where the rear H emblem will attach.

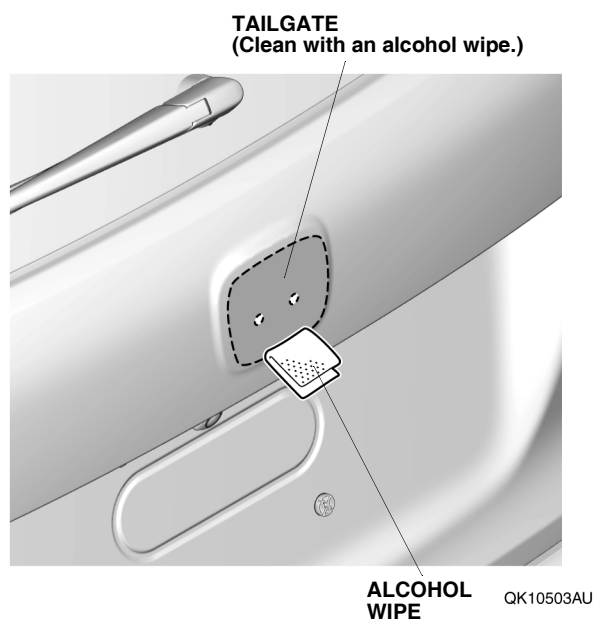

- Remove the adhesive backings from the rear H emblem. Install the rear H emblem to the tailgate as shown.

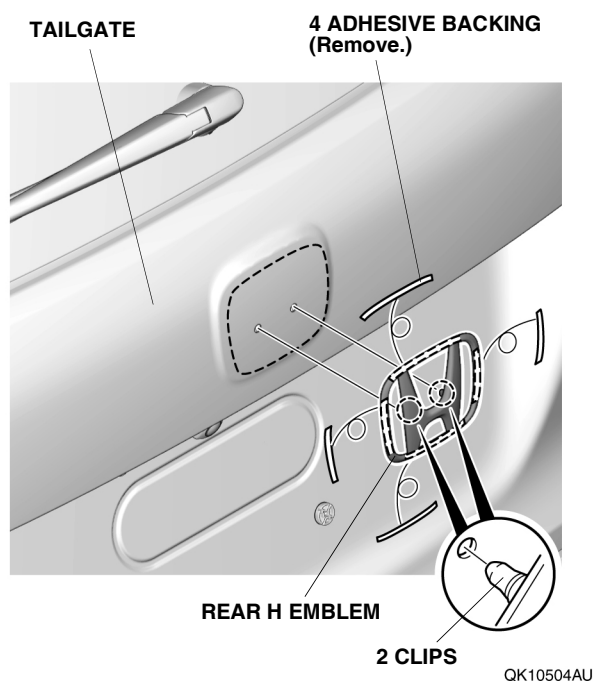

- Using the palm of your hand, firmly press the rear H emblem against the tailgate for 30 seconds.

- Remove the position film from the PILOT emblem, then remove the PILOT emblem from the guide form.

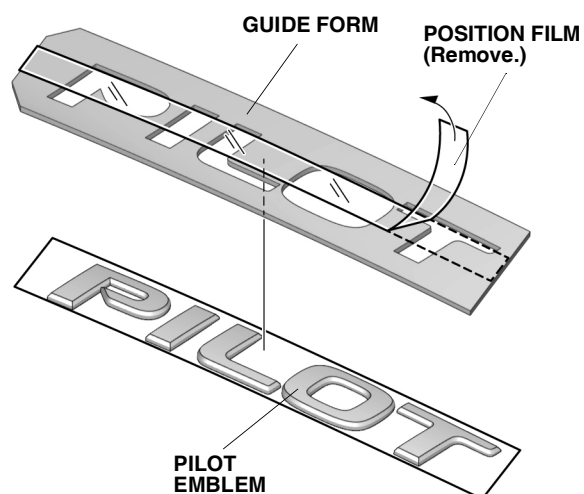

QK10505AU

- Install the guide form to the PILOT emblem on the tailgate.

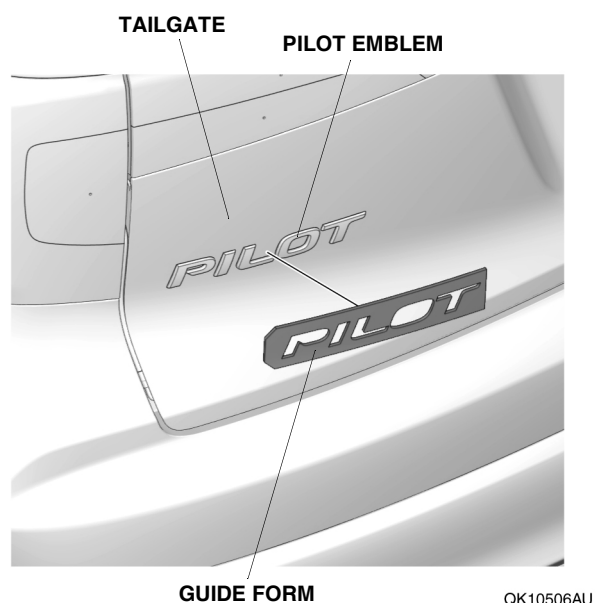

7. Attach masking tape along the guide form as shown.

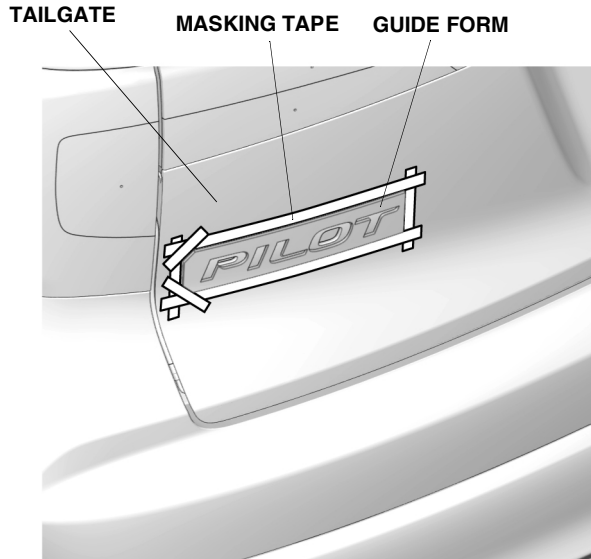

QK10507AU

8. Remove the guide form from the tailgate.

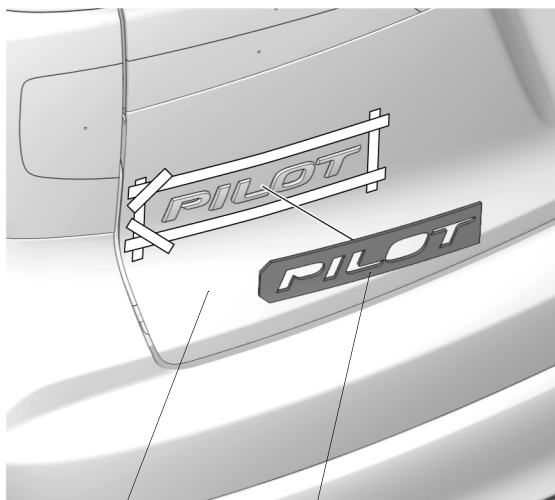

QK10508AU

9. Using a piece of string, remove the PILOT emblem by cutting along the outer edges as shown.

NOTE:

- Do not damage the vehicle body when removing the PILOT emblem with the string.
- Make sure to thoroughly remove the adhesive tape from the vehicle body.

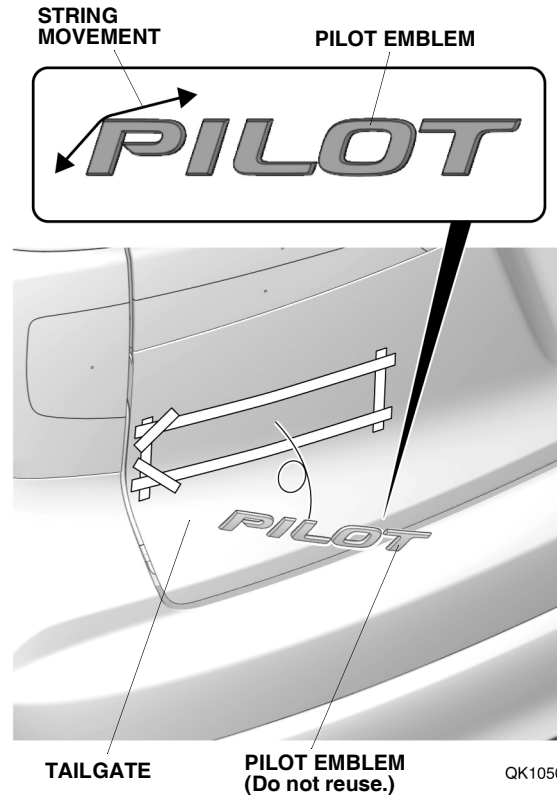

QK10509AU

10. Install the PILOT emblem in the guide form, and temporarily secure it with masking tape.

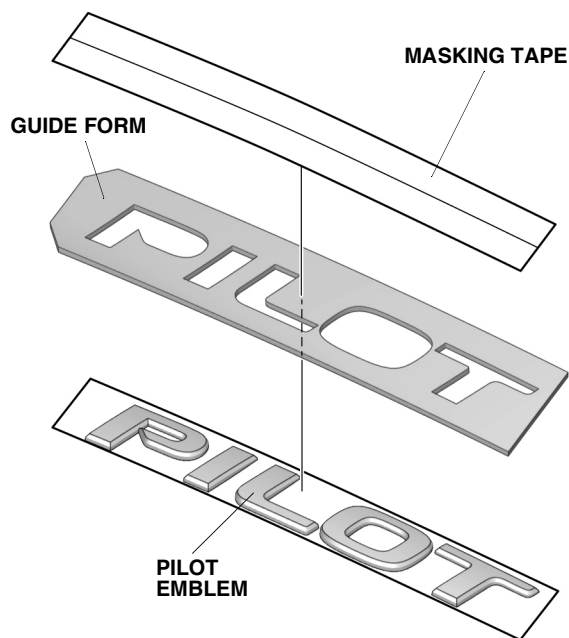

QK10510AU

11. Using an alcohol wipe, thoroughly clean the tailgate where the PILOT emblem will attach.

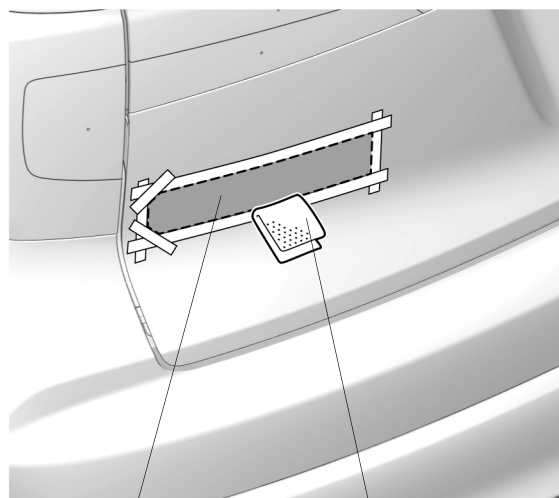

TAILGATE
(Clean with
an alcohol wipe.)

ALCOHOL WIPE

QK10511AU

12. Remove the adhesive backing from the PILOT emblem. Line up the guide form with the masking tape, and attach the PILOT emblem to the tailgate.

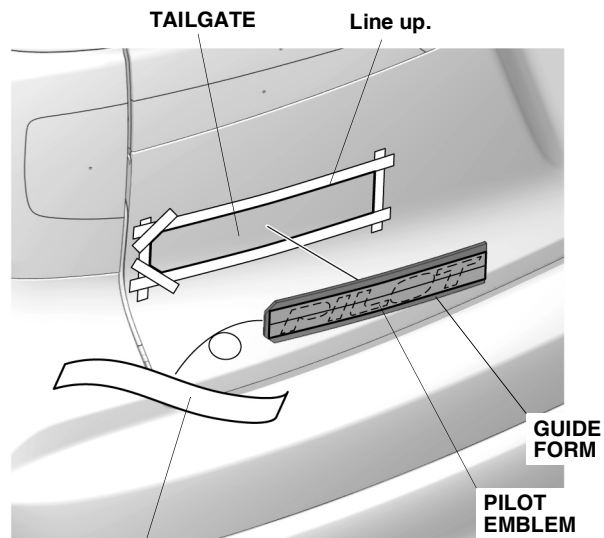

ADHESIVE BACKING
(Remove.)

QK10512AU

13. Remove the guide form and using the palm of your hand, firmly press the PILOT emblem against the tailgate for 30 seconds.

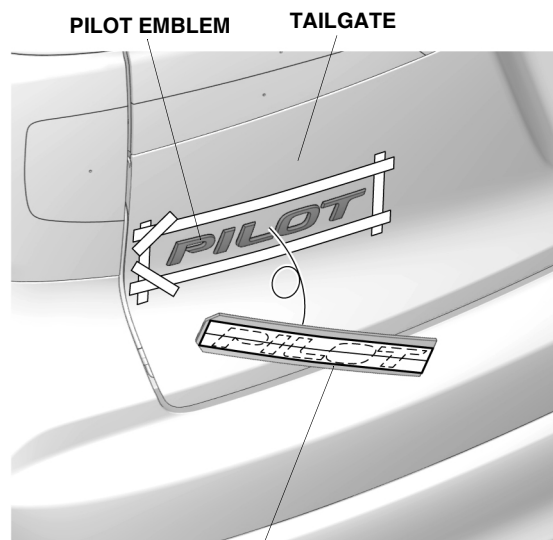

GUIDE FORM
(Remove.)

QK10513AU

14. Remove the masking tape from the tailgate.

If the vehicle is equipped with the AWD emblem, continue with step 15; if not, work is completed.

15. Attach masking tape along the AWD emblem as shown.

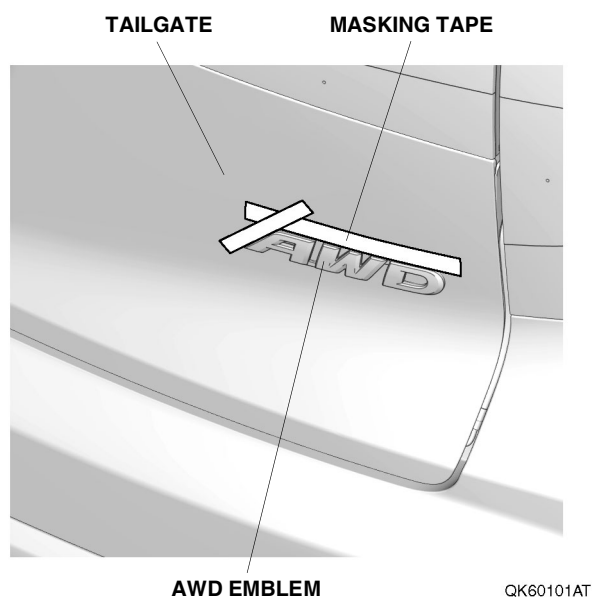

16. Using a piece of string, remove the AWD emblem by cutting along the outer edges as shown.

NOTE:

- Do not damage the vehicle body when removing the AWD emblem with the string.
- Make sure to thoroughly remove the adhesive tape from the vehicle body.

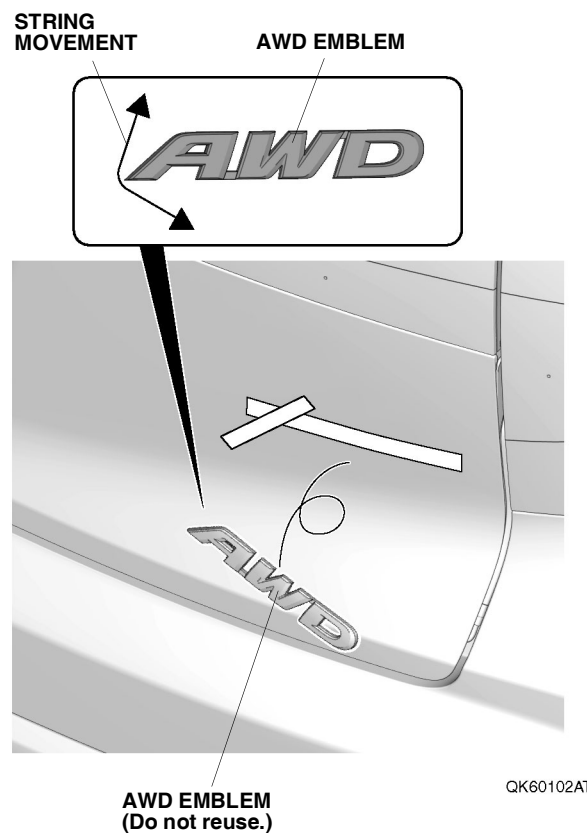

17. Using an alcohol wipe, thoroughly clean the tailgate where the AWD emblem will attach.

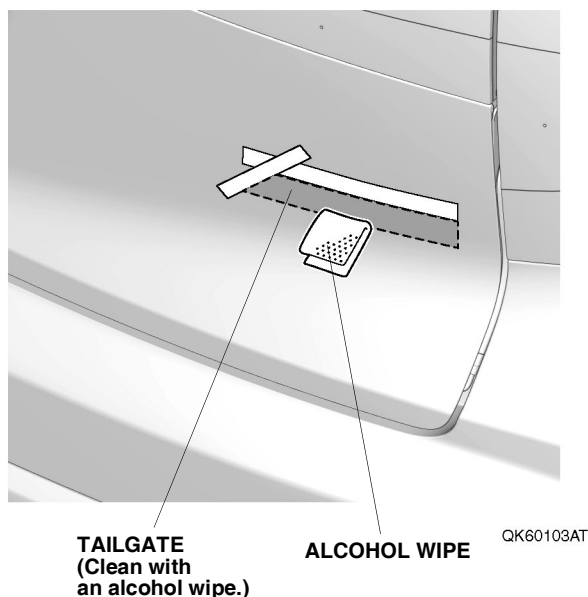

18. Remove the adhesive backing from the AWD emblem. Line up the AWD emblem with the masking tape, and attach the AWD emblem to the tailgate.

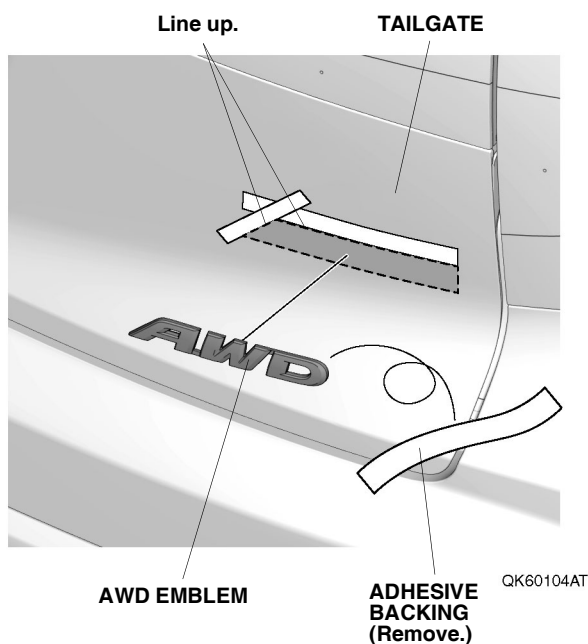

19. Using the palm of your hand, firmly press the AWD emblem against the tailgate for 30 seconds.
20. Remove the masking tape from the tailgate.

If the vehicle is equipped with the **BLACK EDITION** emblem, continue with step 21; if not, go to step 31.

21. Remove the position film from the BLACK EDITION emblem, then remove the BLACK EDITION emblem from the guide form.

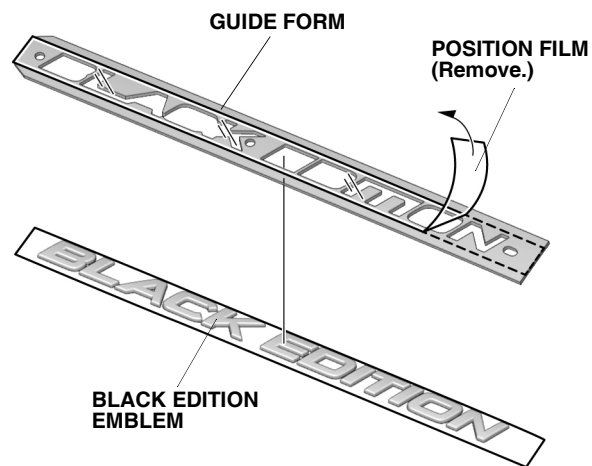

22. Install the guide form to the BLACK EDITION emblem on the tailgate.



23. Attach masking tape along the guide form as shown.

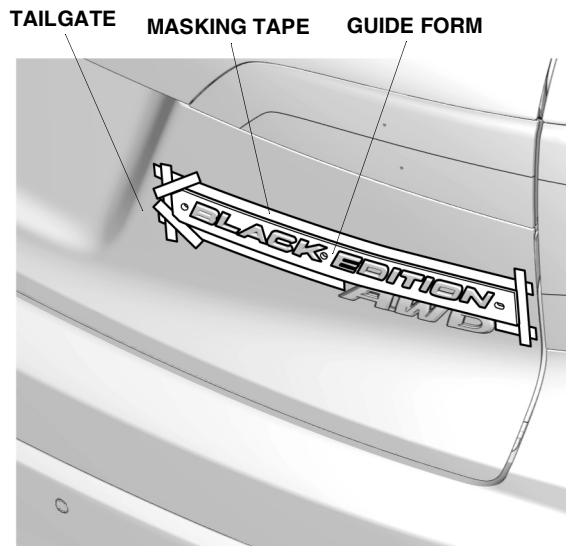

QK10516AU

24. Remove the guide form from the tailgate.

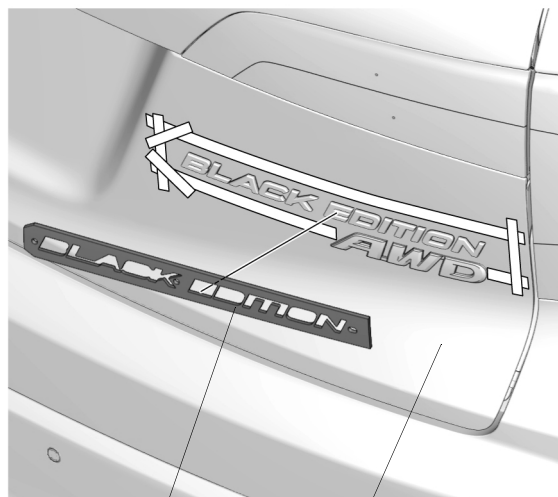

GUIDE FORM

TAILGATE

QK10517AU

25. Using a piece of string, remove the BLACK EDITION emblem by cutting along the outer edges as shown.
NOTE:

- Do not damage the vehicle body when removing the BLACK EDITION emblem with the string.
- Make sure to thoroughly remove the adhesive tape from the vehicle body.

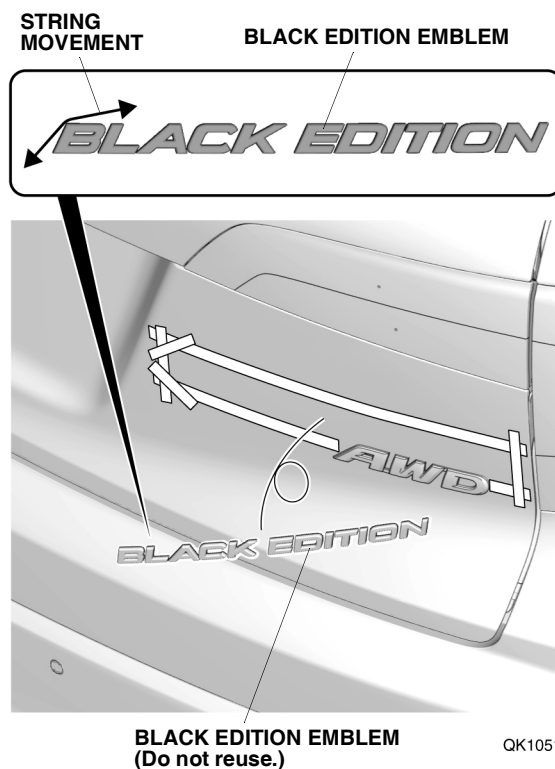

BLACK EDITION EMBLEM
(Do not reuse.)

QK10518AU

26. Install the BLACK EDITION emblem in the guide form, and temporarily secure it with masking tape.

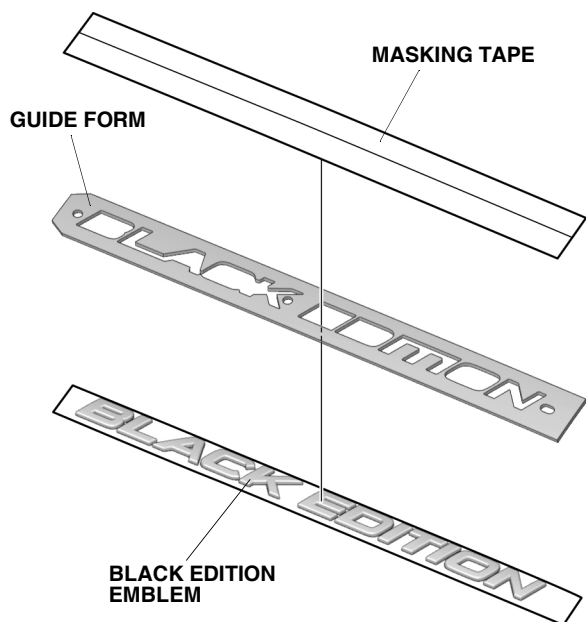

QK10519AU_

27. Using an alcohol wipe, thoroughly clean the tailgate where the BLACK EDITION emblem will attach.

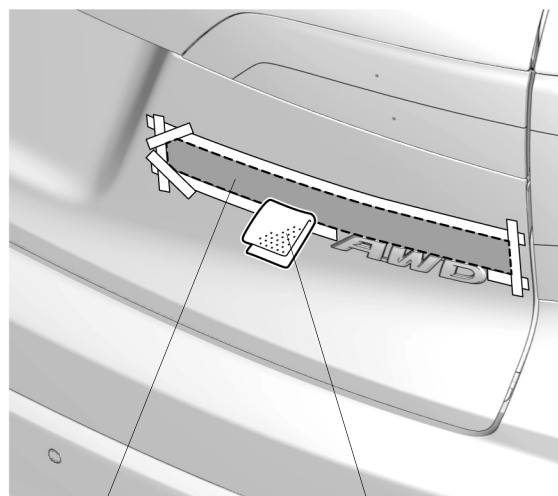

TAILGATE
(Clean with
an alcohol wipe.)

ALCOHOL WIPE

QK10520AU

28. Remove the adhesive backing from the BLACK EDITION emblem. Line up the guide form with the masking tape, and attach the BLACK EDITION emblem to the tailgate.

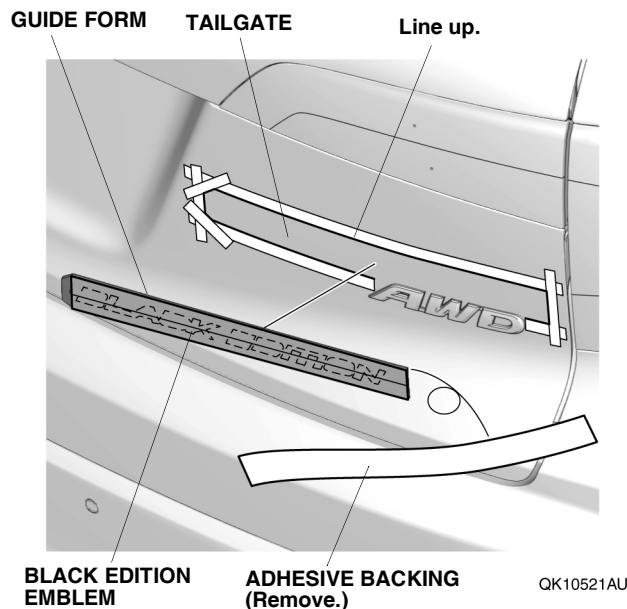

QK10521AU

29. Remove the guide form and using the palm of your hand, firmly press the BLACK EDITION emblem against the tailgate for 30 seconds.

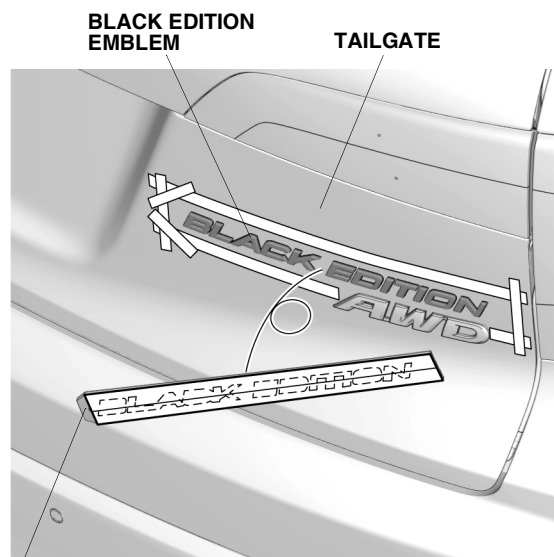

GUIDE FORM
(Remove.)

QK10522AU

30. Remove the masking tape from the tailgate.

If the vehicle is equipped with the ELITE emblem, continue with step 31; if not, work is completed.

31. Remove the position film from the ELITE emblem, then remove the ELITE emblem from the guide form.

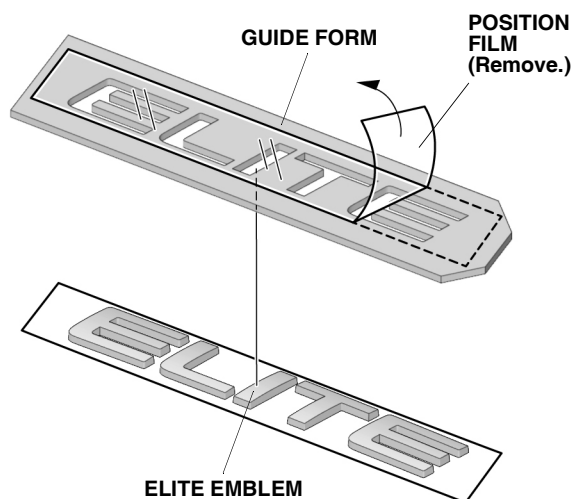

QK10318AU

32. Install the guide form to the ELITE emblem on the tailgate.

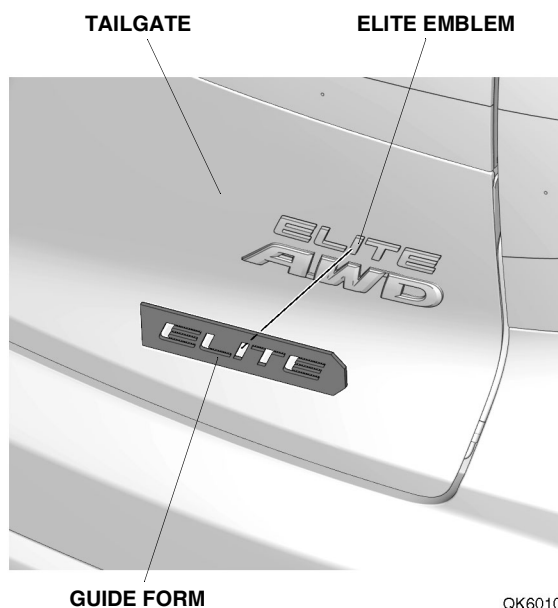

QK60105AT

33. Attach masking tape along the guide form as shown.

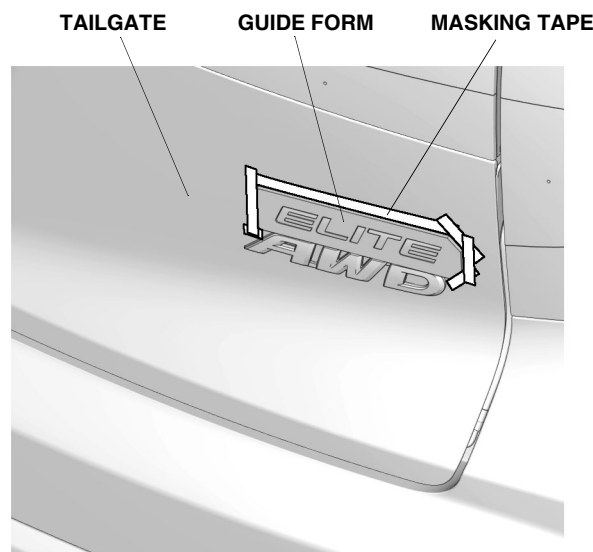

QK60106AT

34. Remove the guide form from the tailgate.

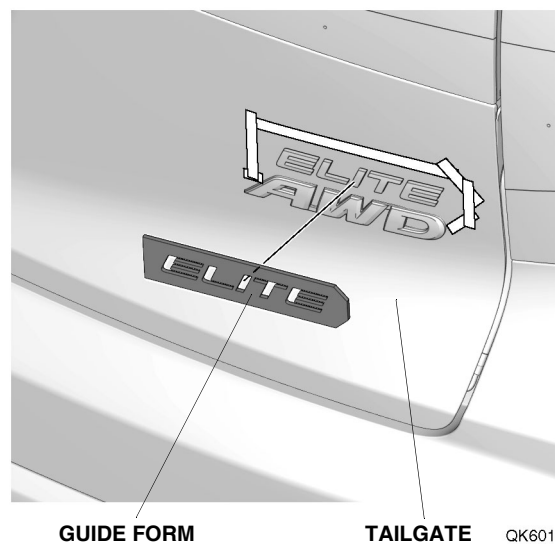

QK60107AT

35. Using a piece of string, remove the ELITE emblem by cutting along the outer edges as shown.

NOTE:

- Do not damage the vehicle body when removing the ELITE emblem with the string.
- Make sure to thoroughly remove the adhesive tape from the vehicle body.

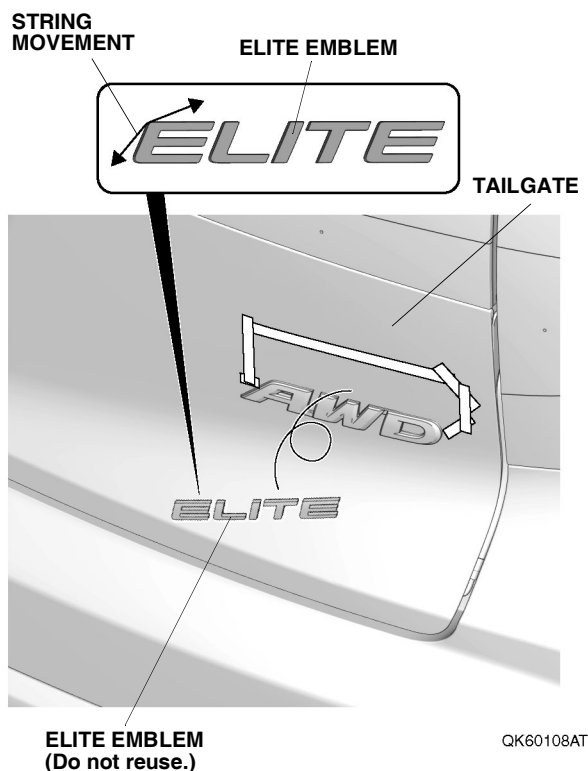

36. Install the ELITE emblem in the guide form, and temporarily secure it with masking tape.

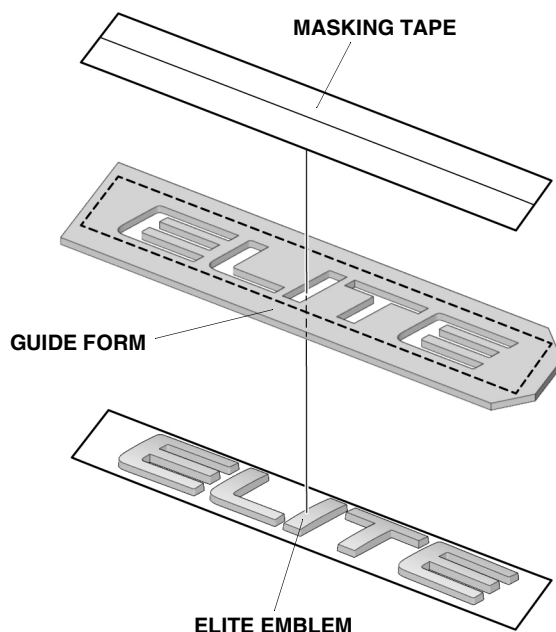

37. Using an alcohol wipe, thoroughly clean the tailgate where the ELITE emblem will attach.

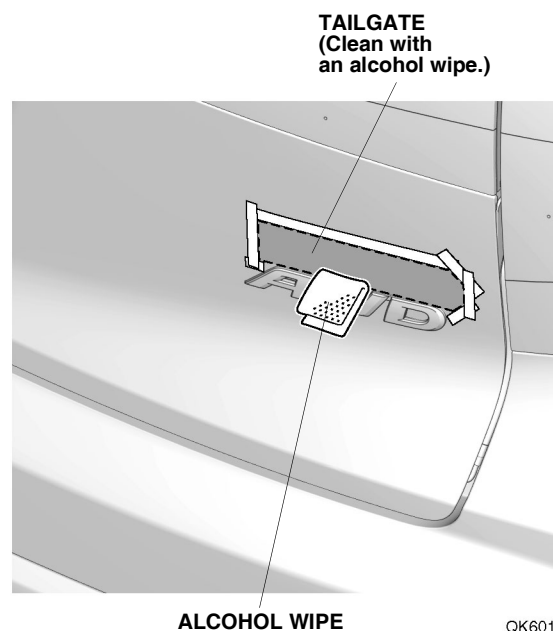

38. Remove the adhesive backing from the ELITE emblem. Line up the guide form with the masking tape, and attach the ELITE emblem to the tailgate.

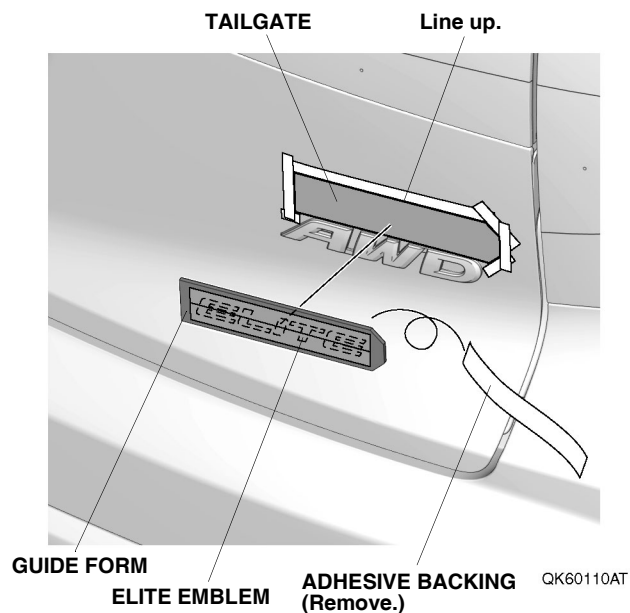

39. Remove the guide form and using the palm of your hand, firmly press the ELITE emblem against the tailgate for 30 seconds.

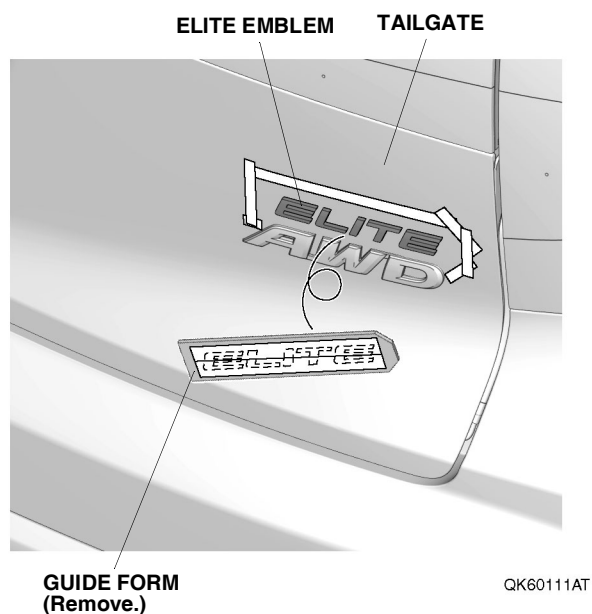

40. Remove the masking tape from the tailgate.