



INSTALLATION INSTRUCTIONS

Accessory
HANDS-FREE ACCESS
POWER TAILGATE

Application
2020 PILOT

Publications No.
VERSION 1
Issue Date
JUL 2019

PARTS LIST

Hands-Free Access Power Tailgate Attachment Kit
P/N 08U59-TG7-100A

Switch



Switch bracket



Hands-free access harness

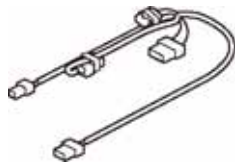

Subharness



Fuse label

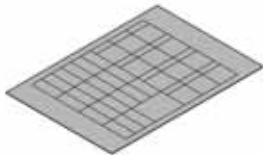

Narrow wire tie



3 Wire ties



Ground bolt



4 Aluminum tapes



4 Self-tapping screws
(Some may not be used)



4 Clips
(Some may not be used)



Connector clip
(May not be used)



Alcohol wipe
(Not used)



Label A



**Hands-Free Access Power Tailgate Unit Kit
(Without accessory trailer hitch)
P/N 08U59-TG7-100**

Hands-free access unit



Accessory user's information manual



**Hands-Free Access Power Tailgate Unit Kit
(With accessory trailer hitch)
P/N 08L91-TG7-100C**

Hands free access unit



Label B



Accessory user's information manual

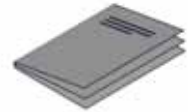

TOOLS AND SUPPLIES REQUIRED

- Phillips screwdriver
- Impact screwdriver
- Scissors
- 10 mm Open end wrench
- 10 mm Socket
- Pushpin
- Ratchet
- 3 mm Drill bit
- Eye protection (face shield, safety goggles, etc.)
- File
- Ruler
- Isopropyl alcohol
- Shop towel
- 26 mm Hole saw
- Drill
- Masking tape
- Diagonal cutters

The following tools are available through the Honda Tool and Equipment Program. On the iN, click on Service > Service Bay > Tool and Equipment Program, then enter the number under "Search." Or, call 888-424-6857.

- Trim Tool Set (T/N SOJATP2014)
- Plastic Trim Tool (T/N SILTRIMTL10)
- Air saw (T/N AT192A)

Illustration of the Hands-Free Access Power Tailgate on the Vehicle

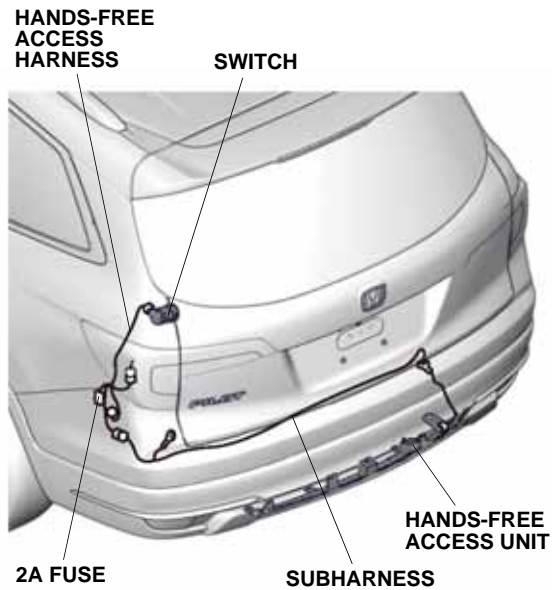

QH31201AB

INSTALLATION

Customer Information: The information in this installation instruction is intended for use only by skilled technicians who have the proper tools, equipment, and training to correctly and safely add equipment to your vehicle. These procedures should not be attempted by “do-it-yourselfers.”

NOTE: If you are also installing the trailer hitch harness, install it after you install the hands-free access power tailgate.

1. Open the tailgate.
2. Disconnect the negative cable from the battery:
 - Wrap a shop towel around the hood latch.

HOOD LATCH
(Wrap with a shop towel.)

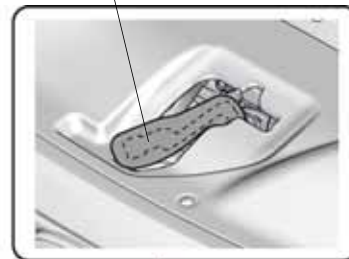

QH21201AB

- Remove the front bulkhead cover.

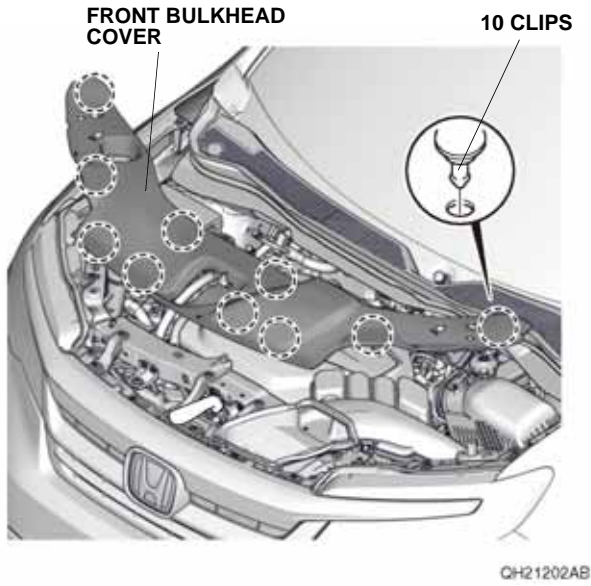

- Remove the intake air tube.
- Disconnect the negative cable from the battery.

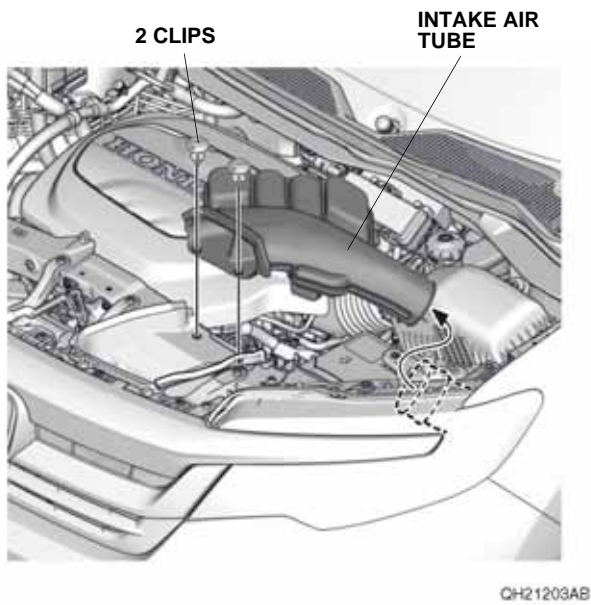

- Pull each strap, and fold down the third row seats.

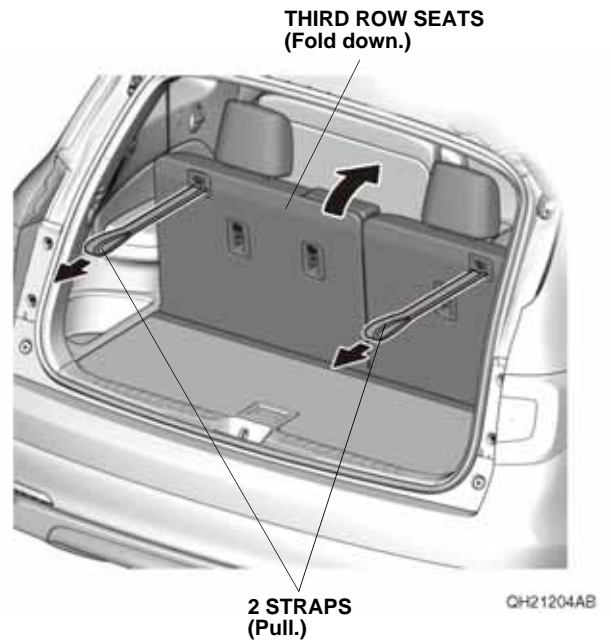

- Remove the cargo lid.

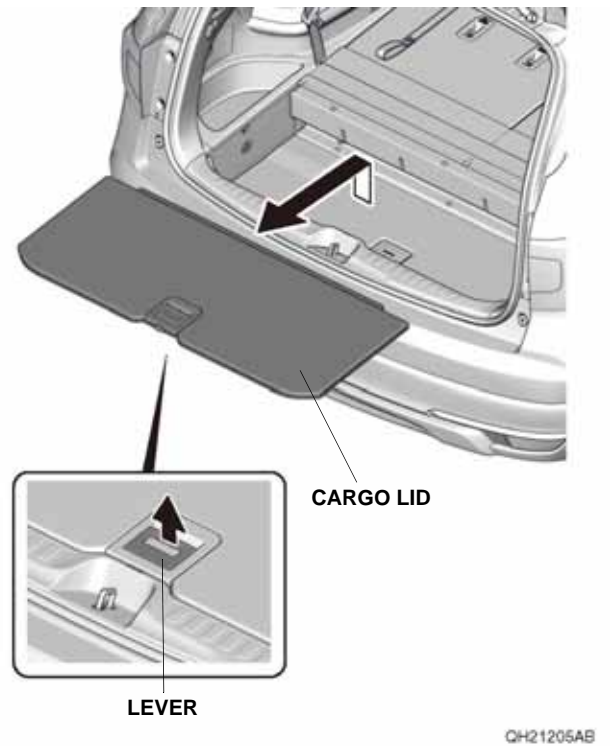

5. Remove the cargo bin divider.

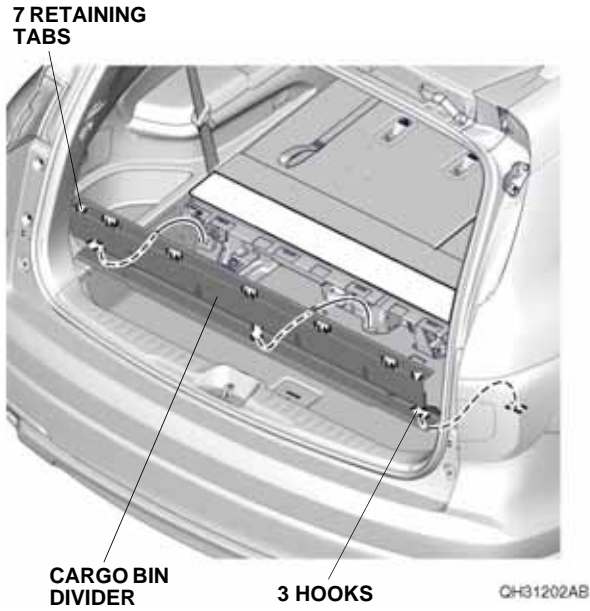

6. Release the 11 hooks.

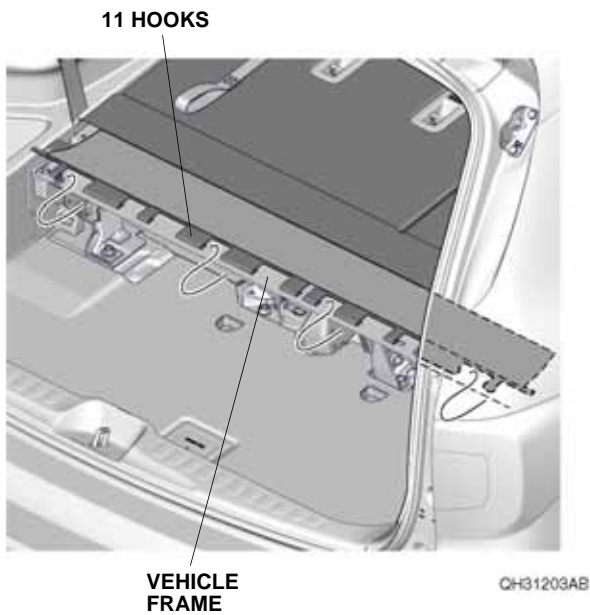

7. Remove the vehicle frame.

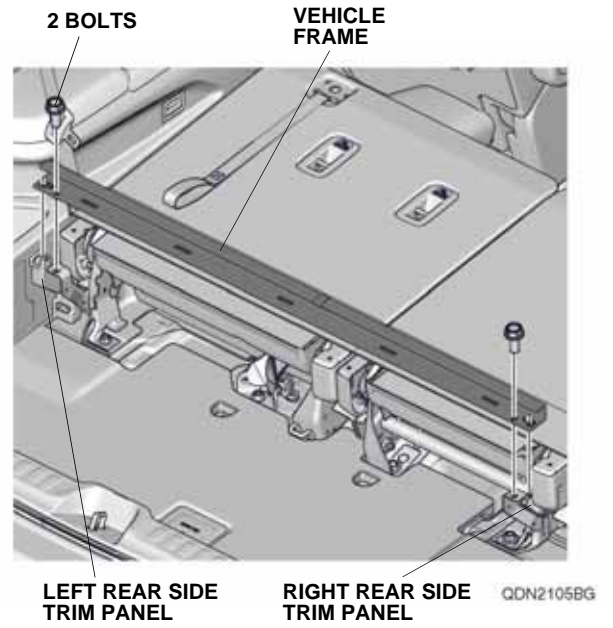

8. Remove the rear trim panel.

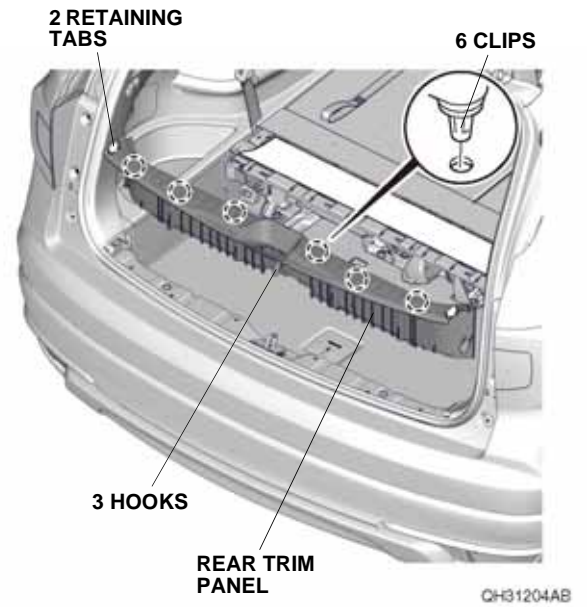

9. Fold down the left second row seat, and move it forward.



QDN2107AG

10. Remove the left rear upper door sill trim.

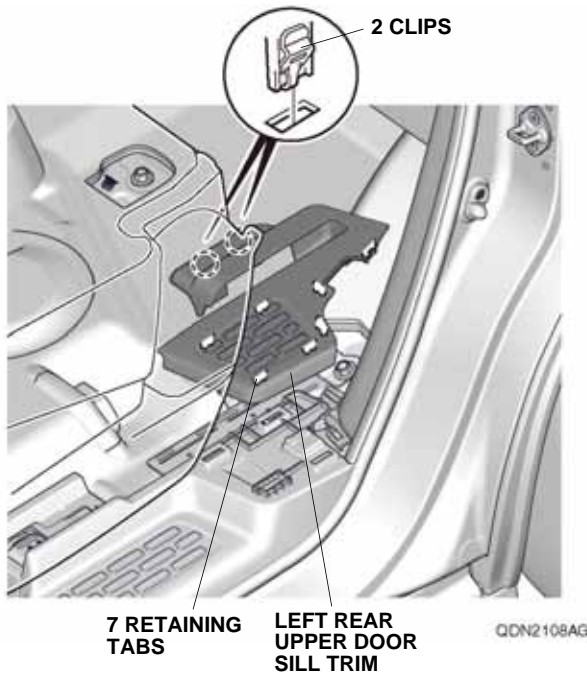

QDN2108AG

11. Using an impact screwdriver, remove the two tie-down hooks.

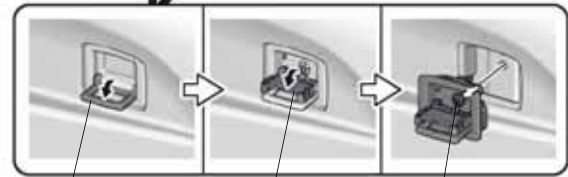
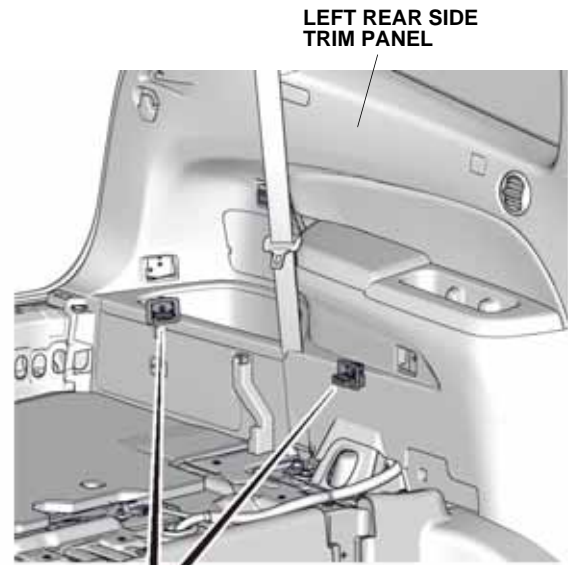

QDN2109AG

12. Using a plastic trim tool, pull the cover and remove the cargo hook.

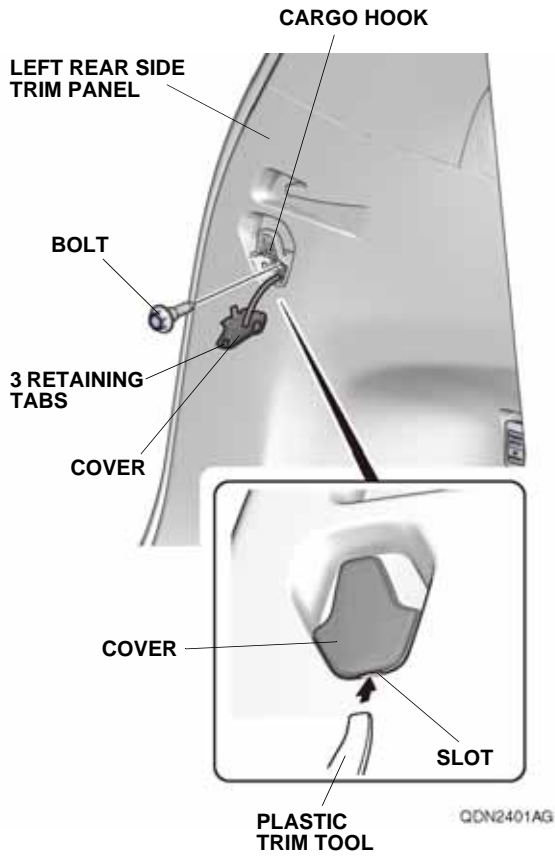

13. Using a plastic trim tool, pull the cover, and remove the screw.

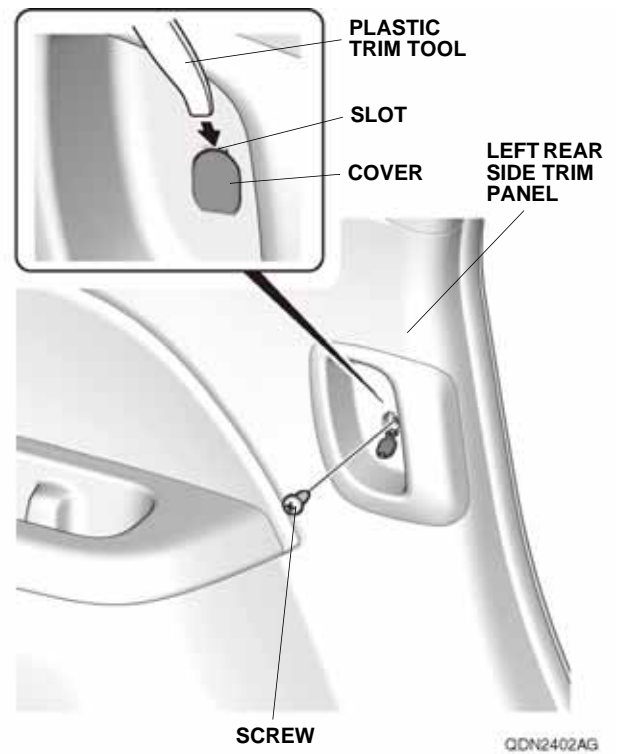

14. Apply masking tape to the left quarter pillar trim as shown.

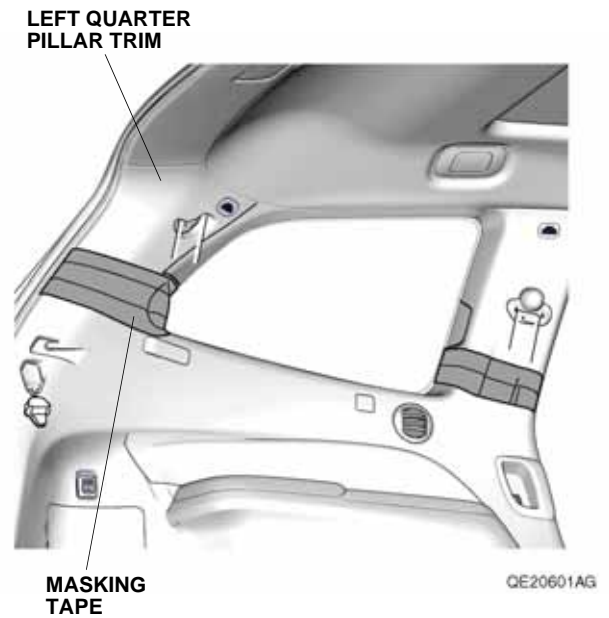

15. Remove the left rear side trim panel, and unplug the vehicle connector (if equipped).

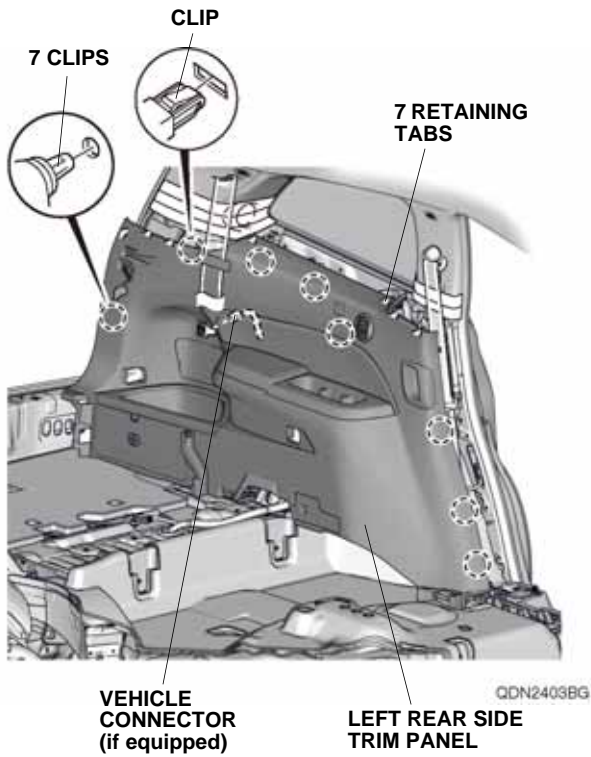

16. Remove the jack.

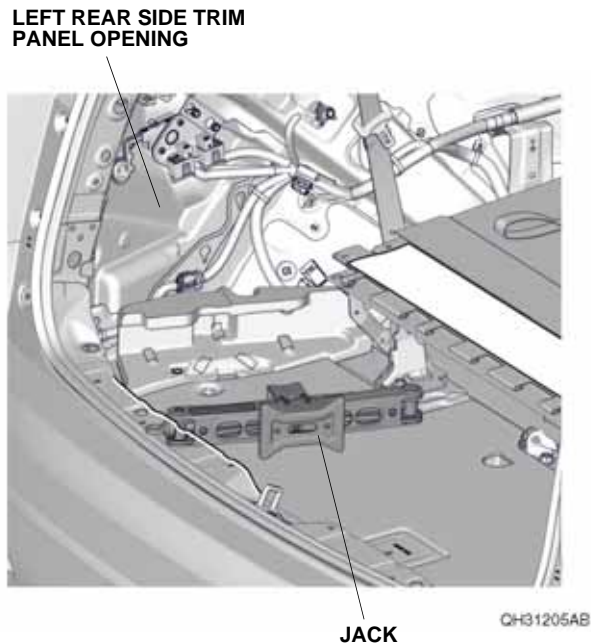

17. Using a plastic trim tool, and remove the access panel.

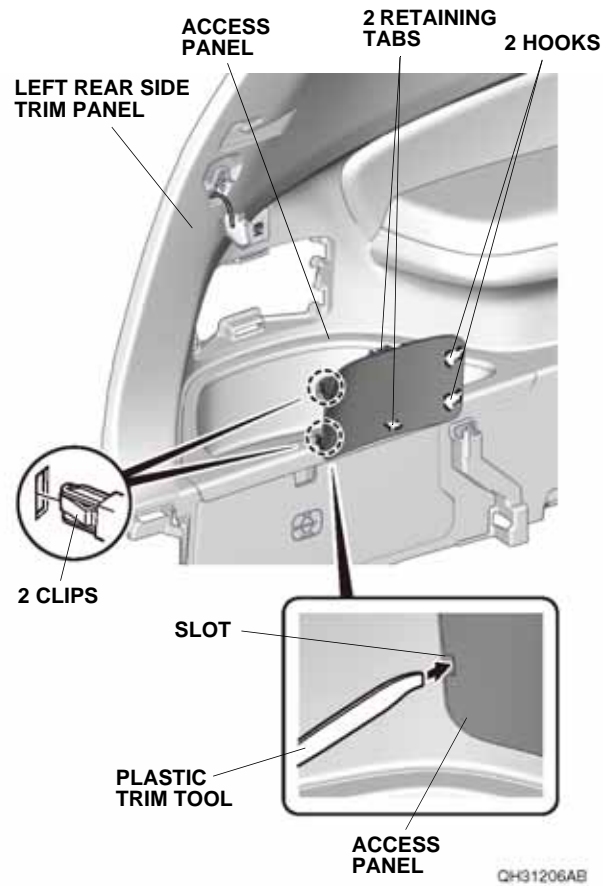

18. Remove the jack access panel.

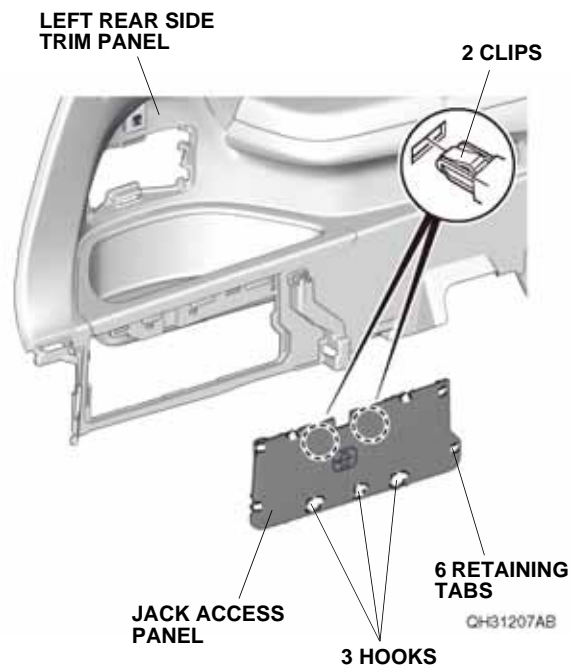

19. Using a pushpin, pierce the left rear side trim panel as shown.
NOTE: Make sure to pierce perpendicular to the left rear side trim panel.

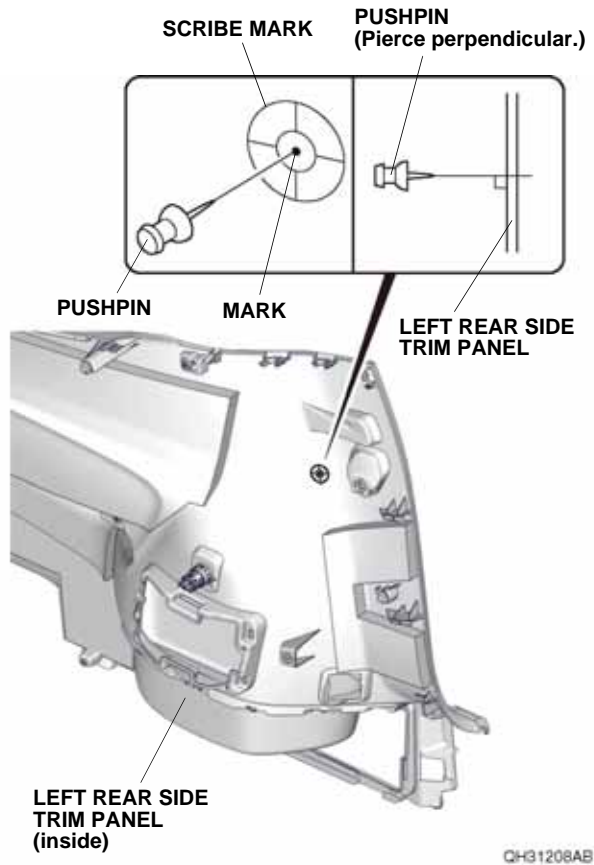

20. While wearing eye protection, drill the pierced mark on the left rear side trim panel using a 3 mm drill bit. Enlarge the 3 mm hole to 26 mm using a 26 mm hole saw, and remove any burrs.
NOTE: Make sure to drill perpendicular to the left rear side trim panel.

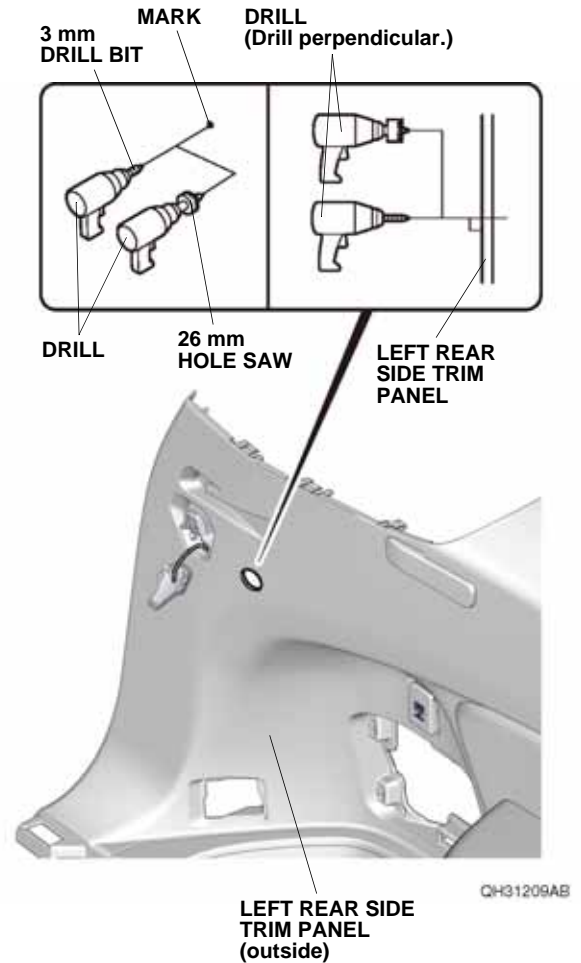

21. Install the switch into the 26 mm hole.
 NOTE: Make sure to install the switch in the correct orientation.

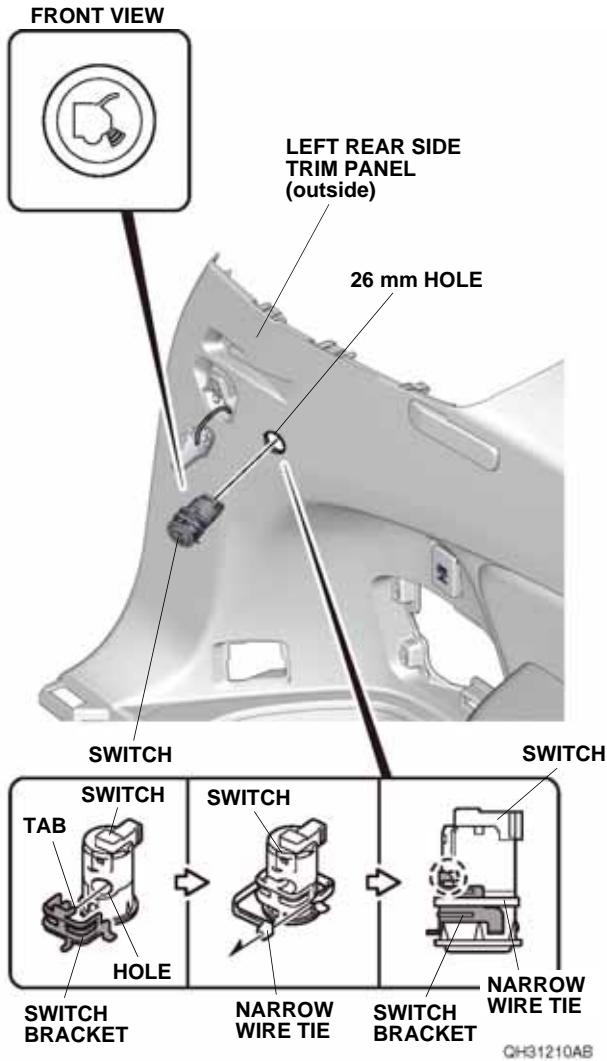

22. Line up the tab on the switch bracket with the hole on the switch and secure the switch bracket to the switch with one narrow wire tie.
 NOTE: Firmly press the switch bracket against the left rear side trim panel, and make sure that there is no clearance between the switch and left rear side trim panel.

23. Using isopropyl alcohol on a shop towel, thoroughly clean the fuse case where the fuse label will attach. Attach the fuse label (2A OPTION) to the fuse case on the hands-free access harness as shown.

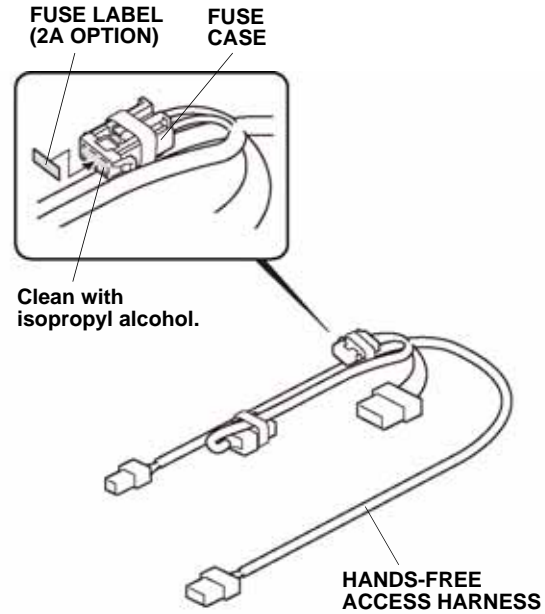

QH31211AB

24. Plug the hands-free access harness 3-pin connector into the switch.

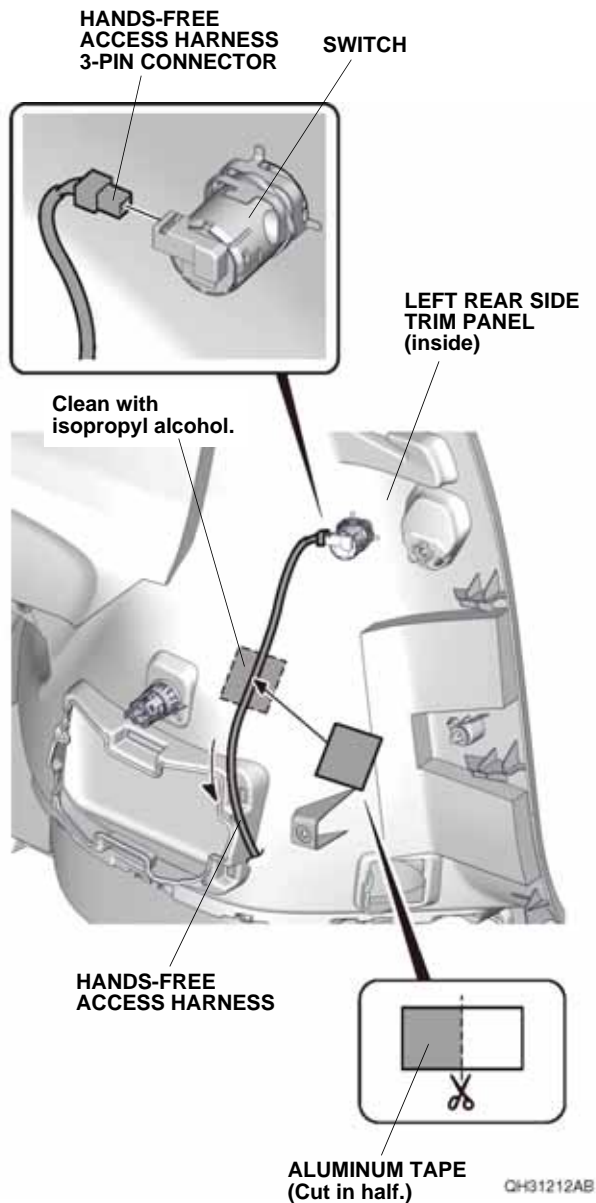

25. Using isopropyl alcohol on a shop towel, thoroughly clean the left rear side trim panel where the aluminum tape will attach.
26. Using scissors, cut one aluminum tape in half, and secure the hands-free access harness to the left rear side trim panel with one piece of aluminum tape as shown.

If the vehicle is equipped with another accessory harness, go to step 30; otherwise, continue with step 27.

Without other accessory harness

27. Remove the tape to free the vehicle 14-pin connector. Install the left rear side trim panel.

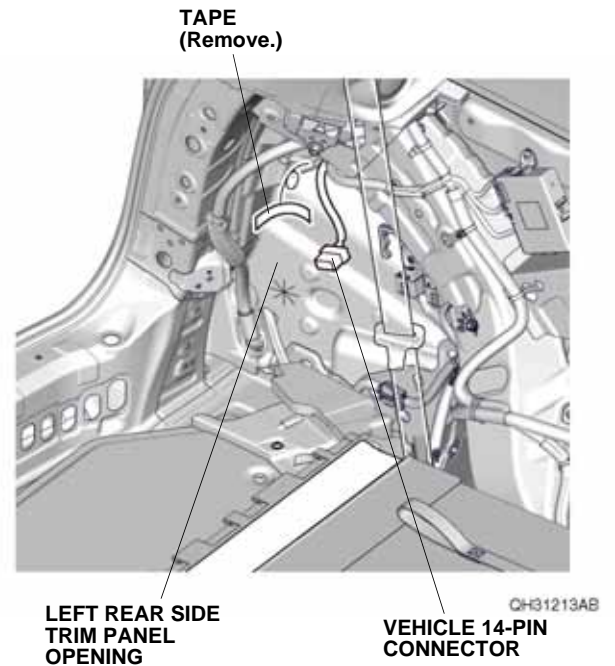

28. Route the hands-free access harness as shown, and plug the vehicle 14-pin connector into the hands-free access harness 14-pin connector.

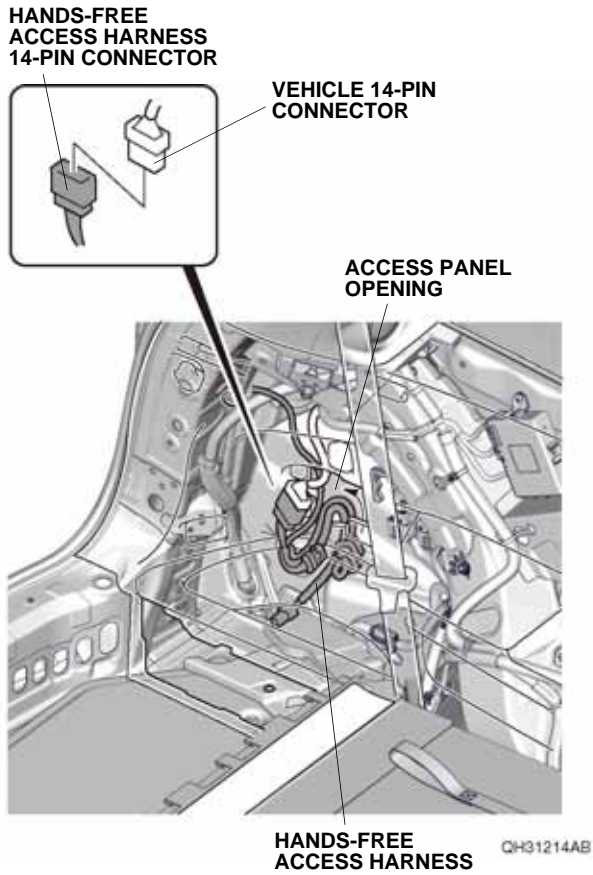

29. Install the connector clip to the 14-pin connectors. Secure the 14-pin connectors to the left rear side trim panel with the connector clip on the 14-pin connectors. Go to step 33.

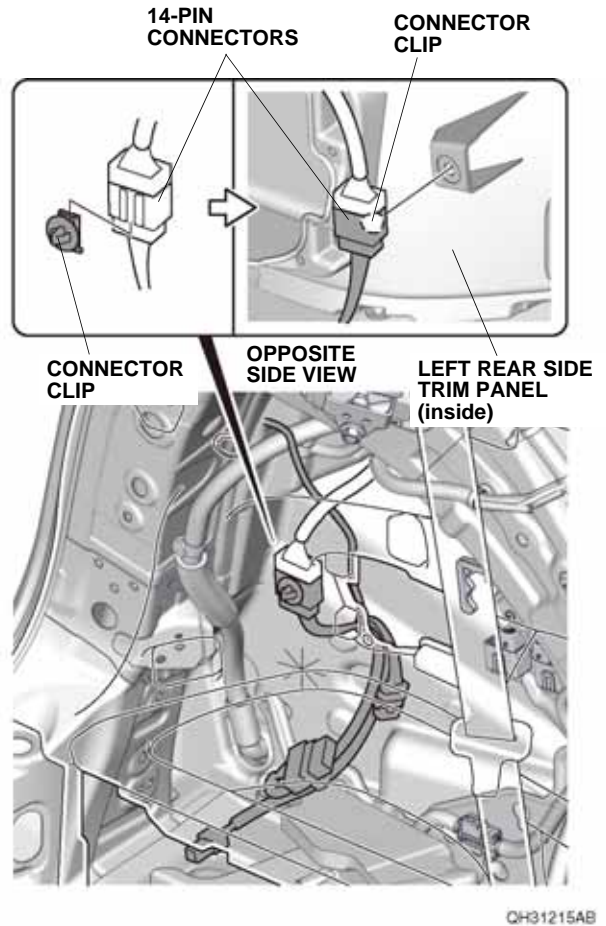

With another accessory harness

30. Install the left rear side trim panel. Remove the tape to free the other accessory harness 14-pin connector.

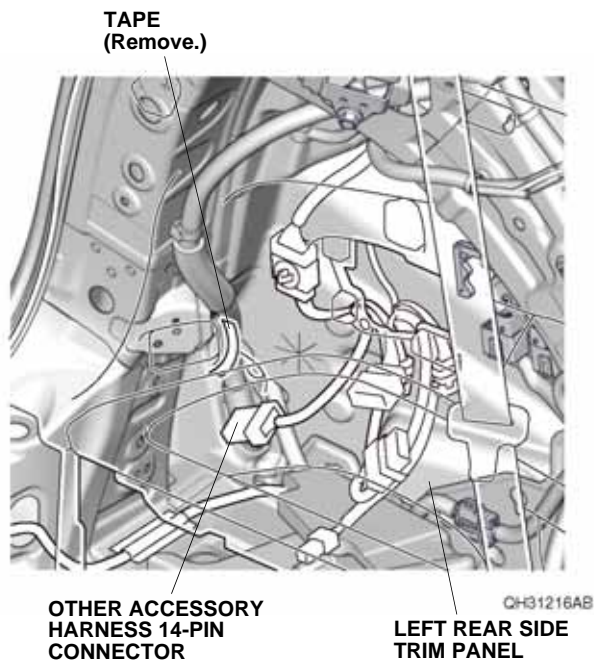

31. Plug the other accessory harness 14-pin connector into the hands-free access harness 14-pin connector.

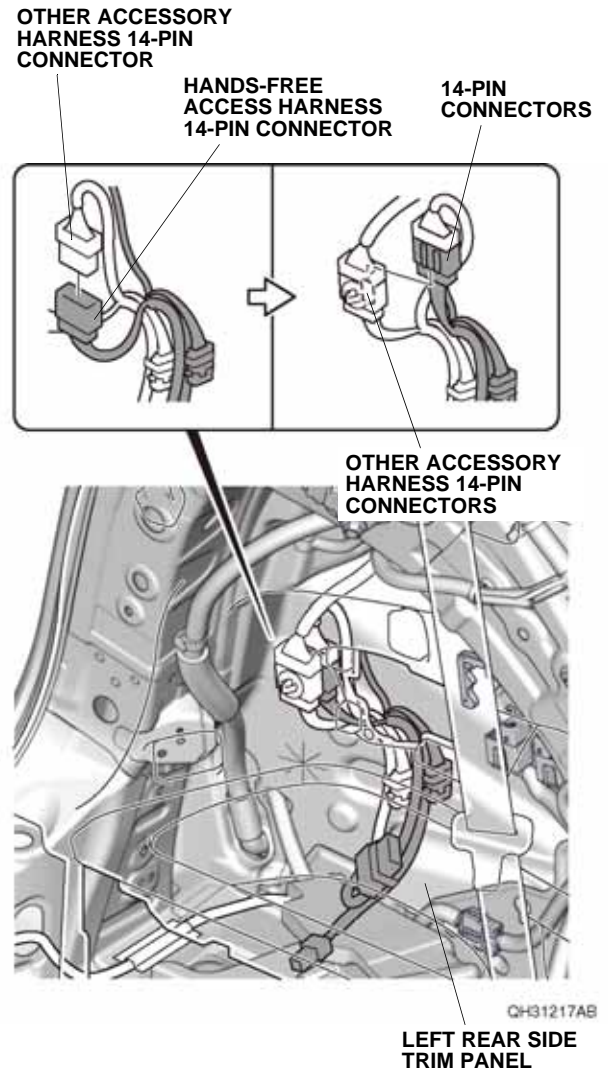

32. Secure the 14-pin connectors to the other accessory harness 14-pin connectors as shown.

33. Secure the hands-free access harness to the left rear side trim panel with two wire ties as shown.

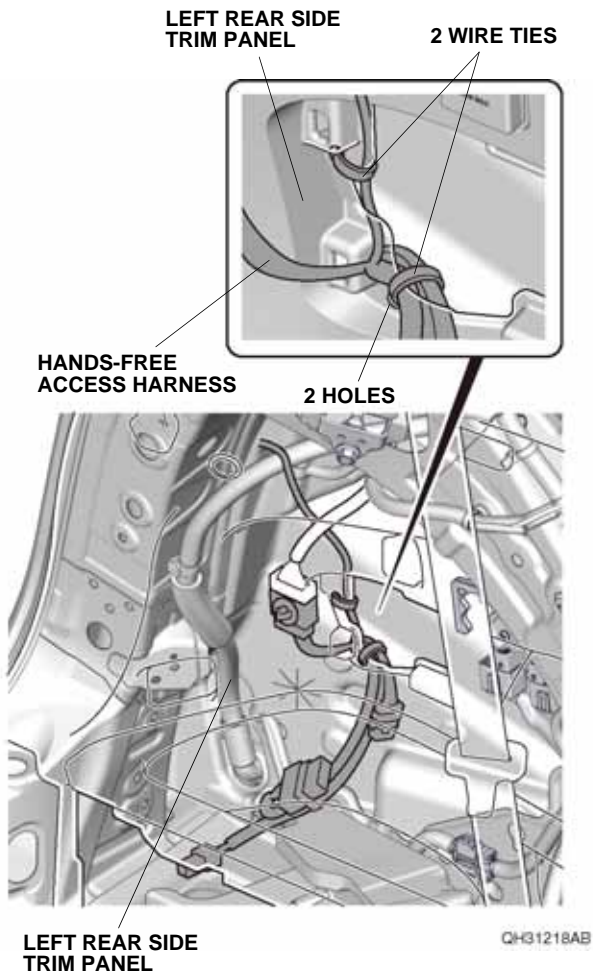

34. Route the subharness as shown. Plug the hands-free access harness 2-pin connector into the subharness 2-pin connector.

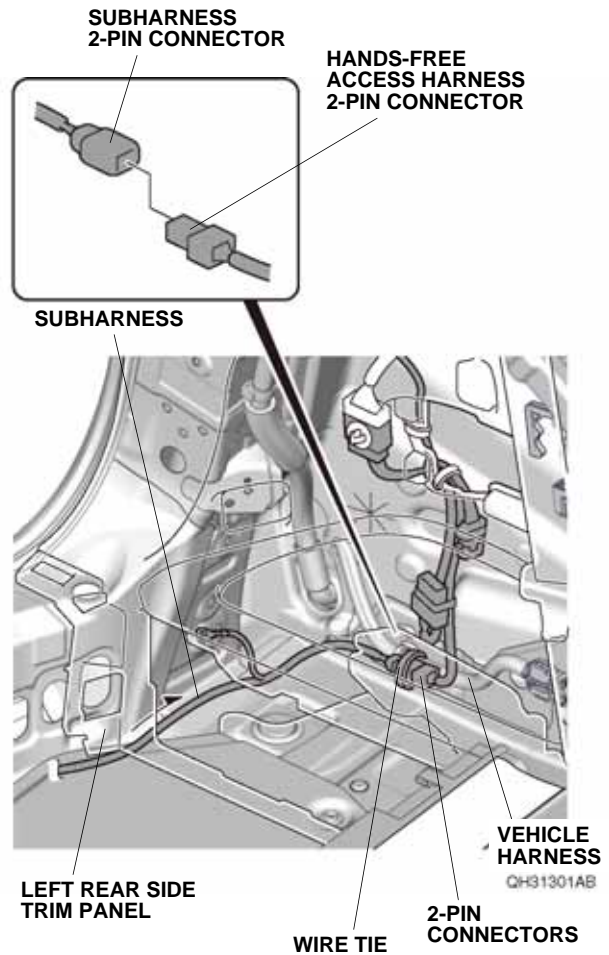

35. Secure the 2-pin connectors to the vehicle harness with one wire tie.

36. Secure the subharness ground terminal to the vehicle panel with one ground bolt.

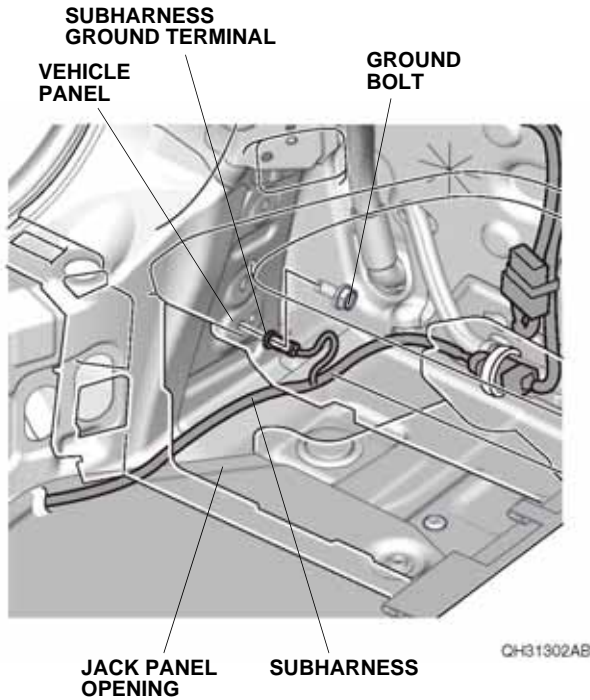

37. Remove the vehicle grommet. Route the subharness through the vehicle panel hole as shown.

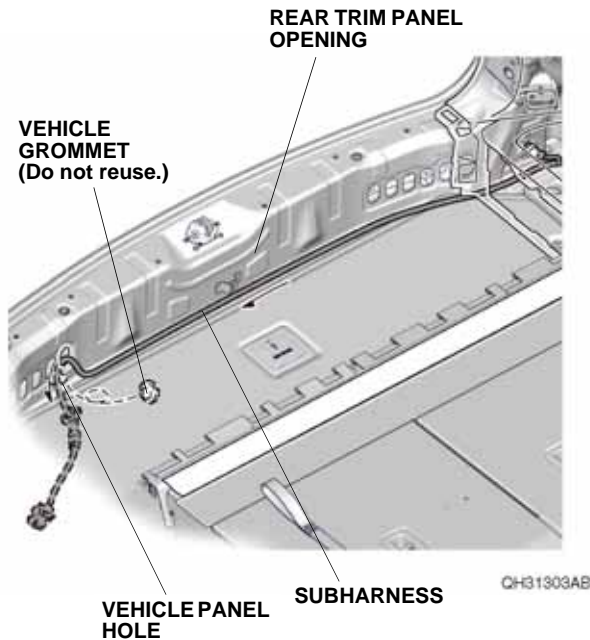

38. Secure the grommet on the subharness to the vehicle panel hole.

NOTE:

- Install the subharness by holding the grommet.
- Make sure the grommet is seated properly.

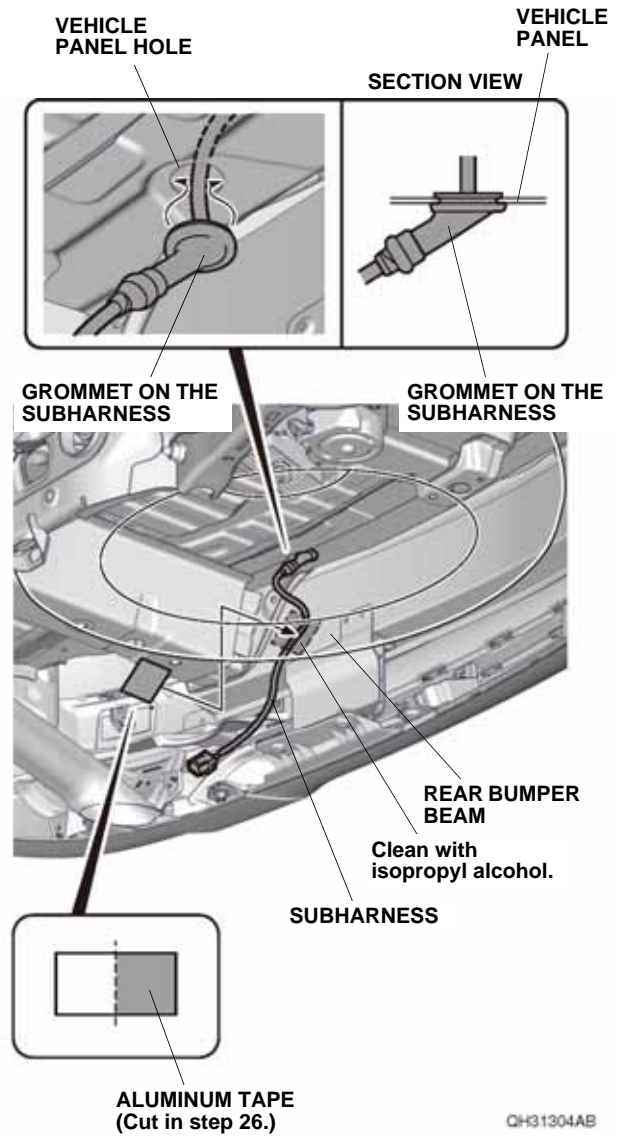

39. Using isopropyl alcohol on a shop towel, thoroughly clean the rear bumper beam where the aluminum tape will attach.
40. Secure the subharness to the rear bumper beam with one piece of aluminum tape cut in step 26.

41. Using isopropyl alcohol on a shop towel, thoroughly clean the vehicle panel where the aluminum tape will attach.

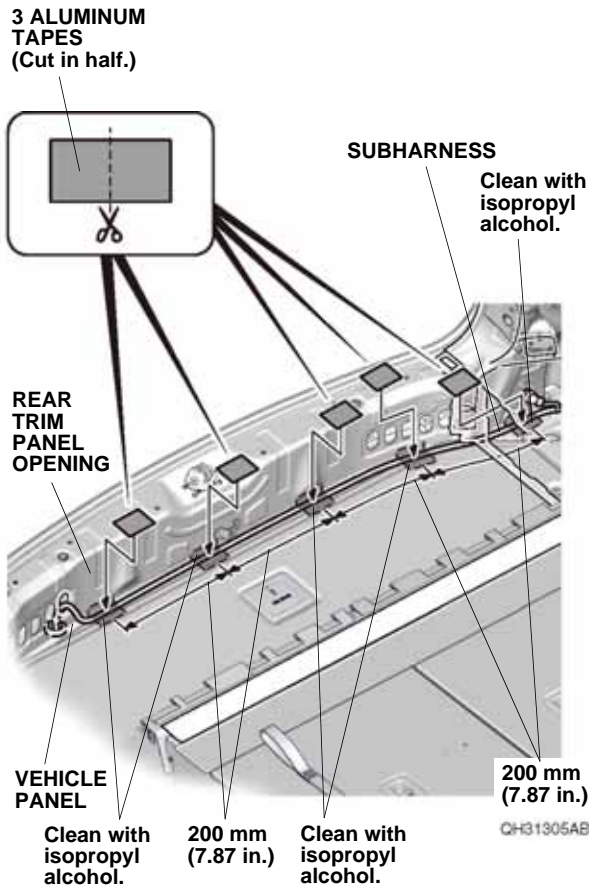

42. Using scissors, cut three aluminum tapes in half, and secure the subharness to the vehicle panel with five pieces of aluminum tape as shown.

If the vehicle is equipped with the accessory trailer hitch, go to step 45; otherwise, continue with step 43.

Without accessory trailer hitch

43. Remove the rear bumper lower cover.

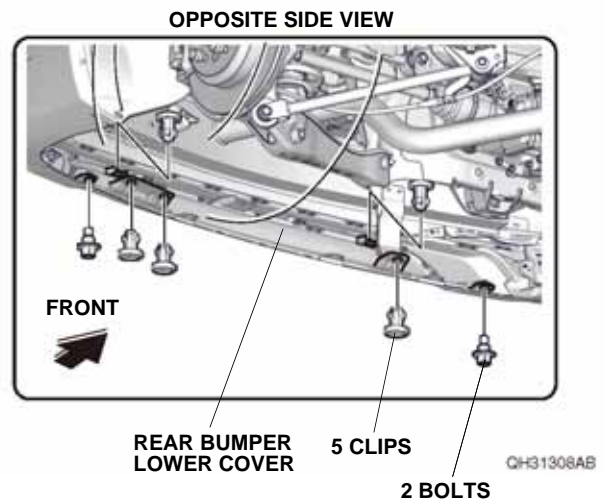
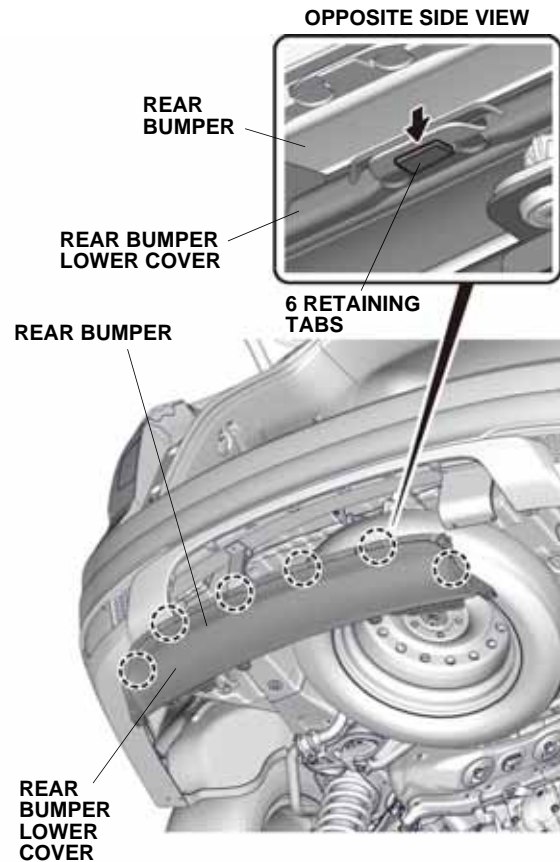

44. Install the hands-free access unit to the rear bumper lower cover with four self-tapping screws and four clips. Go to step 52.

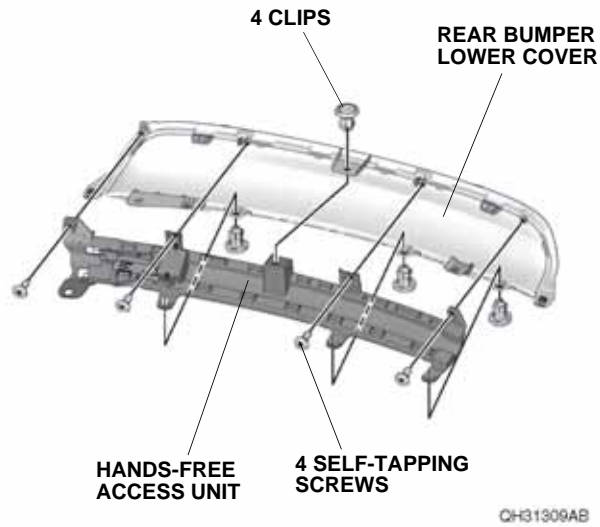

With accessory trailer hitch

45. Release the two sensor bars on the hands-free access unit.

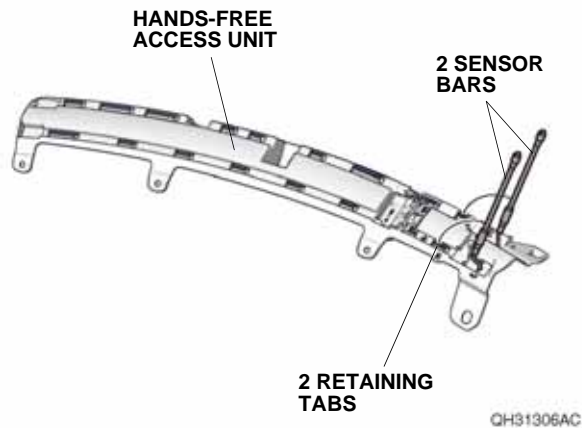

46. While wearing eye protection, use an air saw to cut the hands-free access unit along the scribe line. Remove any burrs.
NOTE: Be careful not to cut sensor bars. If sensor bars are damaged, they must be replaced.

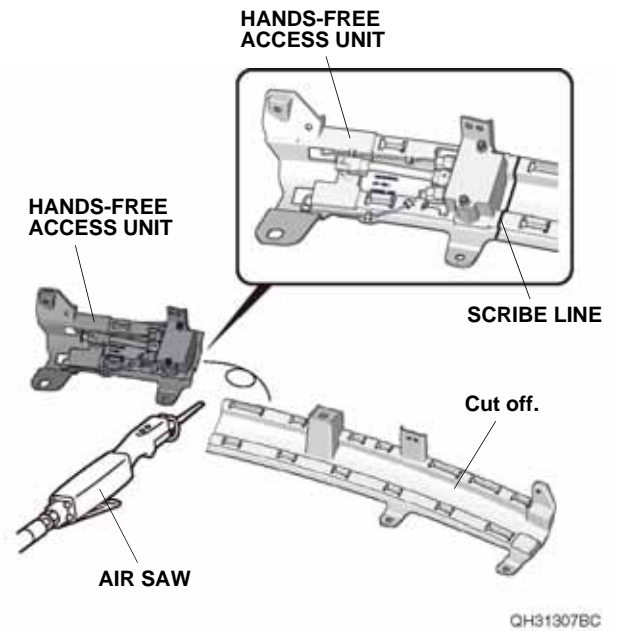

47. Install the two sensor bars to the hands-free access unit. Make sure the sensor bars are positioned properly and the sensor bar wires are secured as shown.

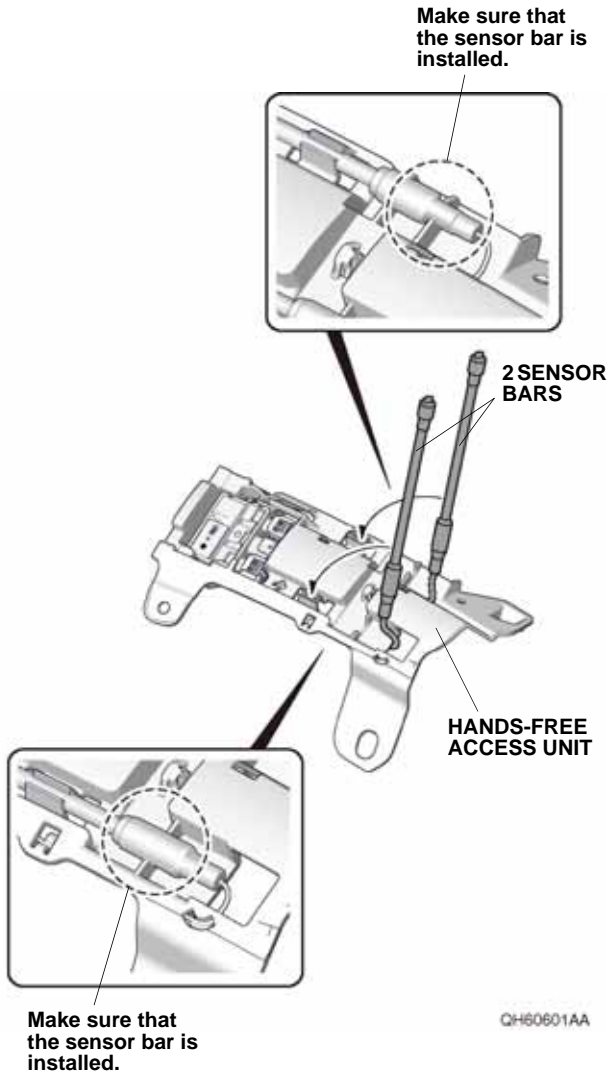

48. Make sure the sensor bar wires are secured as shown.

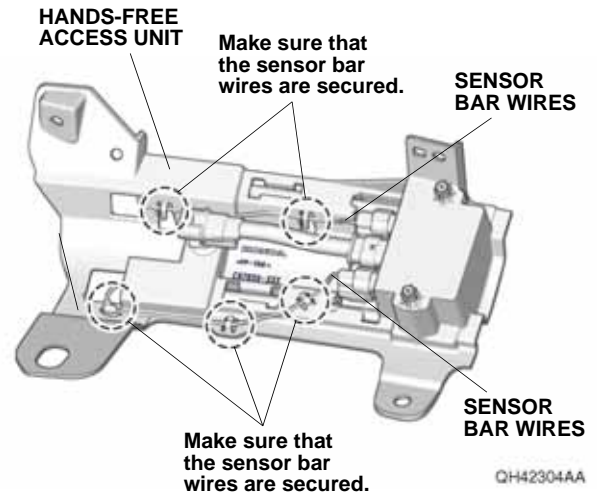

49. Remove the accessory trailer hitch as described in the accessory trailer hitch instructions.

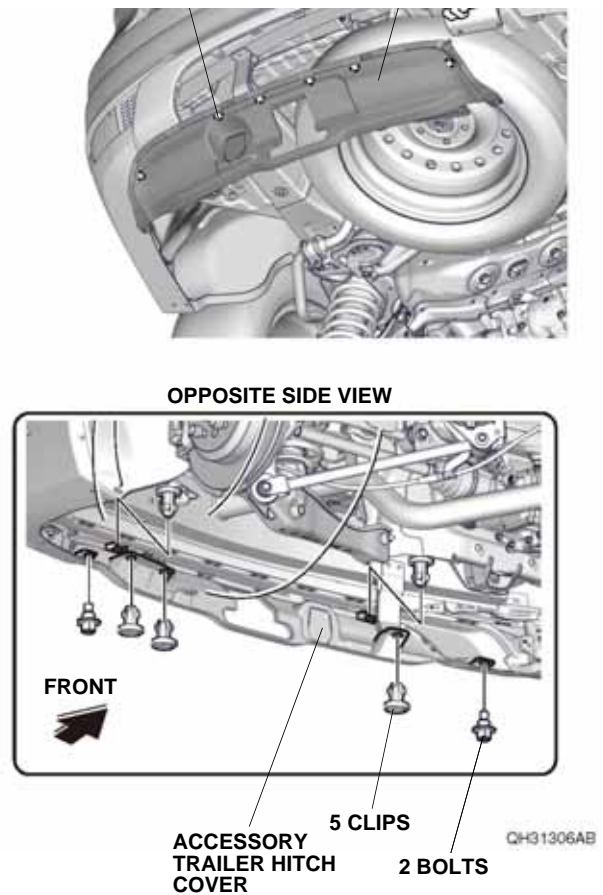

50. Remove the accessory trailer hitch cover.
51. Install the hands-free access unit to the accessory trailer hitch cover with two self-tapping screws and one clip.

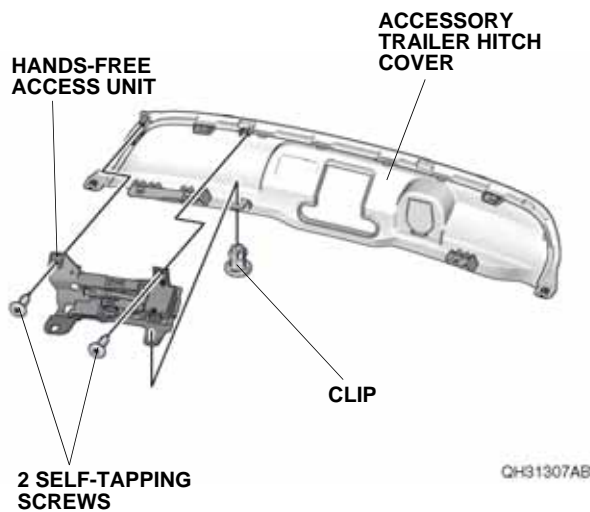

52. Plug the subharness 3-pin connector into the hands-free access unit. Install the rear bumper lower cover or accessory trailer hitch cover.

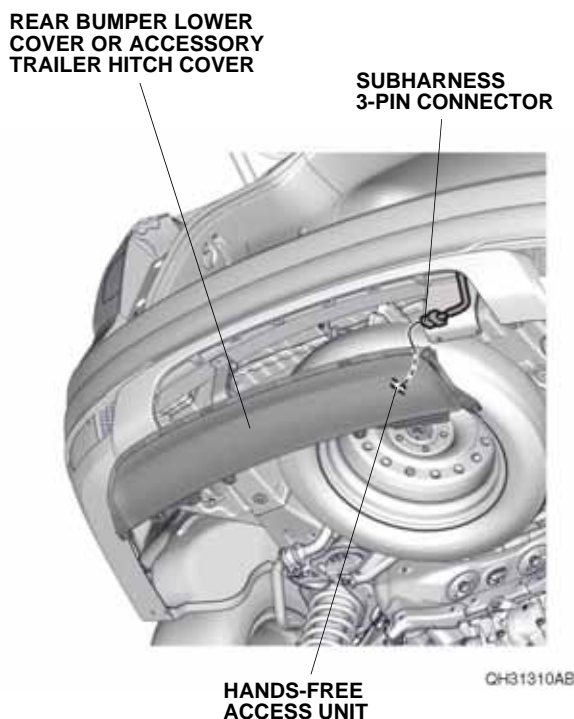

53. Check that all wire harnesses are routed properly and all connectors are plugged in.
54. Install all removed parts except for the front bulkhead cover and the intake air tube.
55. Connect the negative cable to the battery.
56. Install the front bulkhead cover and the intake air tube.
57. Press and hold the audio unit power button for 2 seconds to restore the audio and navi (if equipped) system functions.
58. Set the clock on vehicles without navigation.
59. Using a clean shop towel with soap and water, thoroughly clean where the label A will attach. Then, dry the area with a clean towel.

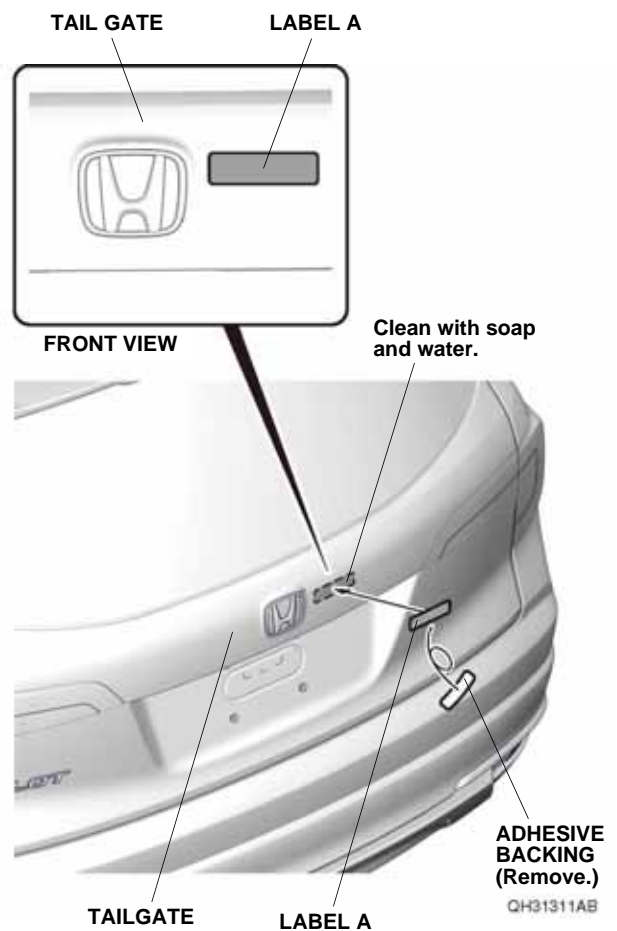

60. Remove the adhesive backing from the label A, and attach the label A to the tailgate as shown. NOTE: Make sure the customer is aware the label A can be removed after reading.

If the vehicle is equipped with the accessory trailer hitch, continue with 61; otherwise, go to step 63.

With accessory trailer hitch

61. Using isopropyl alcohol on a shop towel, thoroughly clean the rear bumper where the label B will attach.

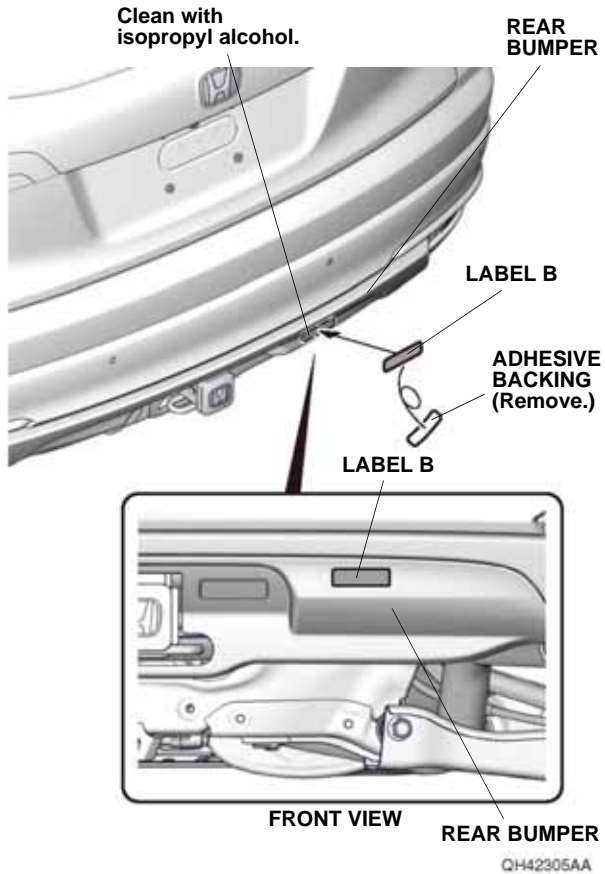

62. Remove the adhesive backing from the label B, and attach the label B to the rear bumper as shown.
NOTE: Make sure the customer is aware that label B can be removed after reading.

Check the Operation of the Hands-Free Access Power Tailgate

63. Make sure that the hands-free access power tailgate works as described in the Accessory User's Information Manual supplied with the hands-free access power tailgate unit kit.