

DOOR HANDLE FILMS	2026 PASSPORT MODEL SERIES	Publications No. VERSION 1
-------------------	-------------------------------	-------------------------------

GENERAL VIEW

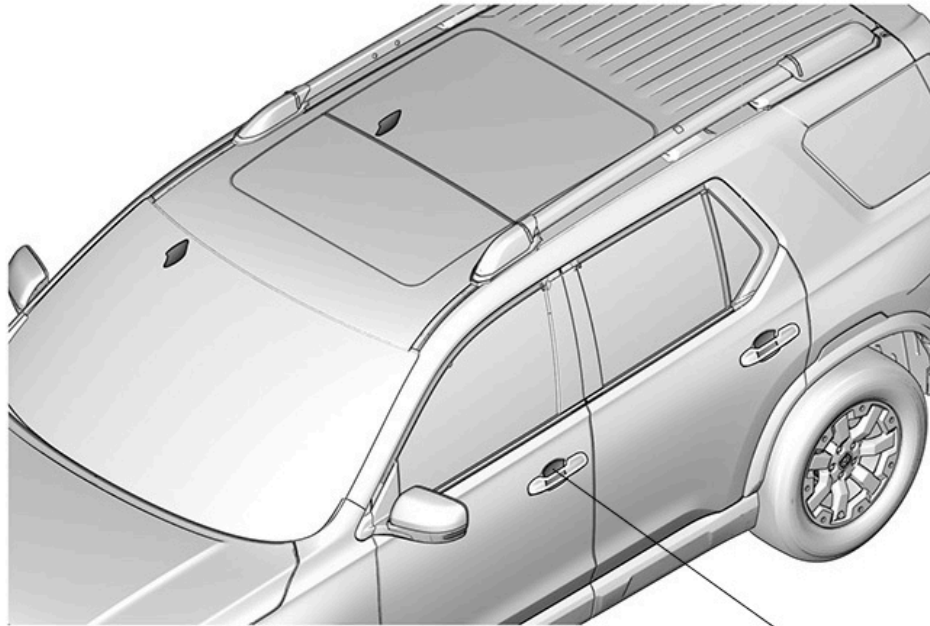

QP61801AD

A

A	DOOR HANDLE FILM(4)
---	---------------------

FOR YOUR SAFETY (Read carefully.)

Warning Symbols

Safety: Your safety, and the safety of others, is important. To help you make informed decisions about service procedures, we have provided safety messages where appropriate. Of course, it is not practical or possible to warn you about all the hazards associated with servicing a vehicle - you must use your own good judgment.

You will find important safety messages preceded by one of the following symbols:

*All symbols are not used in all installation instructions.

DANGER

You will be killed or seriously hurt if you do not follow the instructions.

WARNING

You can be killed or seriously hurt if you do not follow the instructions.

CAUTION

You can be hurt if you do not follow the instructions.

NOTICE

Gives advice to prevent damage to the product, vehicle, the environment or other property.

NOTE

Gives helpful information or instructions to be followed when installing this product.















Indicates a prohibited action.

Procedure and Location Icons

These icons indicate the work location and the worker's point of view.

*All icons are not used in all installation instructions.

	The location on the vehicle.		The location in the vehicle. (Instrument panel.)
---	------------------------------	--	---

	Wear eye protection.		Wear heavy gloves.
	Use an assistant.		Place the part on a blanket.
	Work perpendicular.		Remove any burrs.
	Use touch-up paint and allow to dry.		Tighten to the specified torque.
	Apply firm pressure while rolling, especially at the ends, to set the adhesive.		Press firmly.
	Clean with isopropyl alcohol.		Return the original part to the customer. (Do not reuse.)

Safety: General



- Observe all safety notes and precautions described in the service information, in addition to those described in this Installation Instruction. Be extremely careful for your safety and safety of others.
- Always use the parts and tools specified in the installation instructions.
- Be careful not to damage the vehicle or the parts.
- The illustrations may differ slightly from the actual accessory.

■ Safety: Accessory

- Do not install the accessory on a dirty surface or in direct sunlight.
- Make sure the ambient air temperature is 60°F (15°C) or above when installing accessories that use adhesive material.
- When applying adhesive material, make sure it is lined up properly before attaching. Once the adhesive material touches the surface, do not try to remove it. If you do, you could damage the part.
- Cover nearby parts with a shop towel to prevent getting them wet.
- Always wear gloves when working with 3M protective tape application solution.
- Use the 3M protective tape application solution with a spray bottle.
- Do not wash the vehicle for 24 hours to allow the adhesive to cure.

PARTS LIST

■ Door Handle Films Kit (P/N 08P48-T90-100A)

Parts	Parts name	QTY	Remarks
	Door handle film	4	
	Alcohol wipe	4	

REQUIRED TOOLS AND SUPPLIES

- Shop towel
- Ruler
- Gloves
- 3M Protective tape application solution
- Mini Soft Spreader/Applicator (T/N SBSA2302Y5PK)

INSTALLATION

■ Installing the Door Handle Films

1 Clean the attaching area.

NOTE

Allow to dry thoroughly.

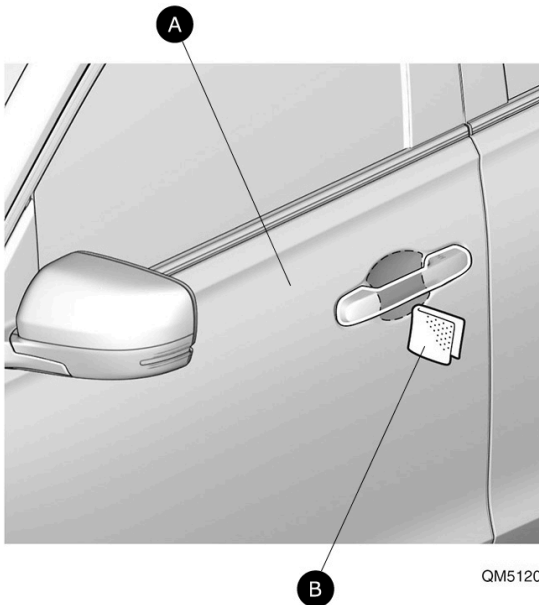

A	LEFT FRONT DOOR
B	ALCOHOL WIPE

2 Spray the left front door.



A	3M PROTECTIVE TAPE APPLICATION SOLUTION
---	---

3 Remove the adhesive backing.



A	ADHESIVE BACKING (Remove.)
A	DOOR HANDLE FILM

4 Spray the door handle film.

5 Line up the door handle film.

NOTE

Make sure to install the door handle film in the correct orientation.

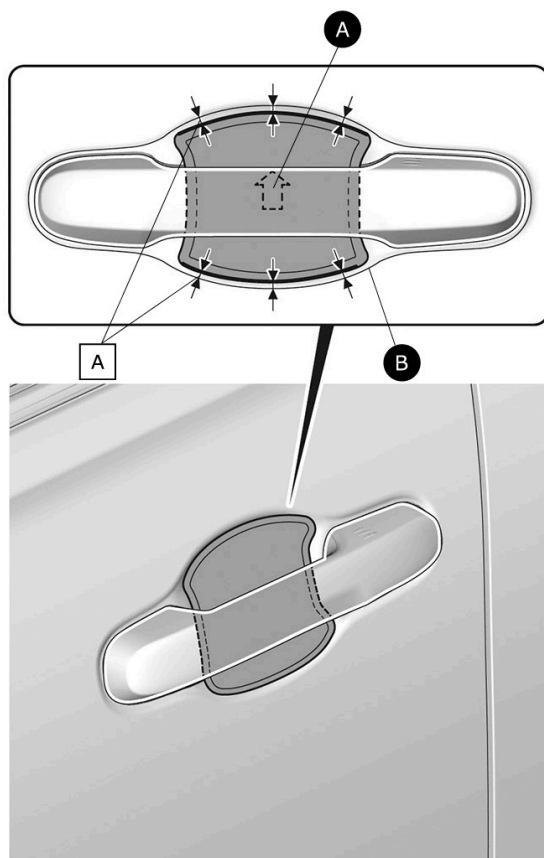

A	ARROW MARK
B	END OF THE CURVED SURFACE
A	Equal spacing.

QM51205AG

6 Secure the door handle film.

NOTE

- Work in one direction only.
- Make sure that there are no air bubbles.

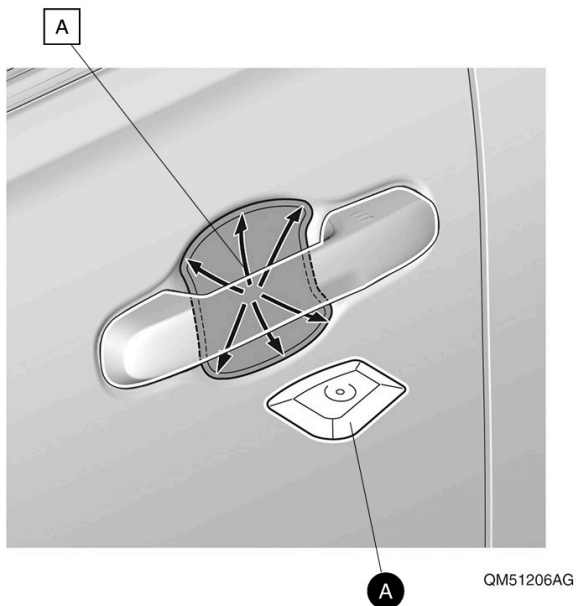

A	MINI SOFT SPREADER/APPLICATOR
A	Work from the center to the outside.

7 Remove the protective film.

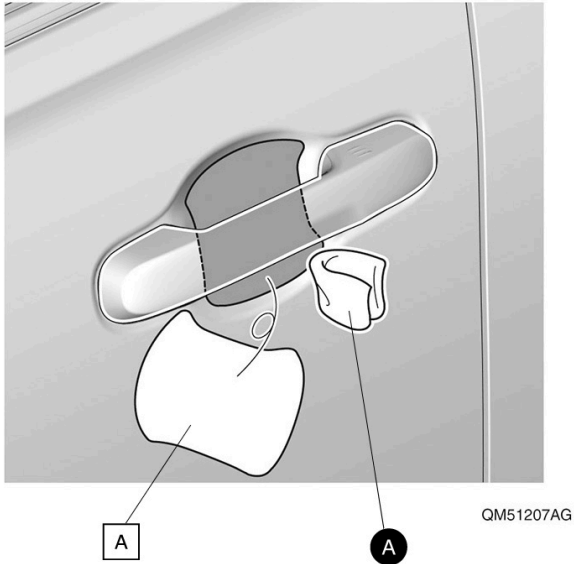

A	PROTECTIVE FILM (Remove.)
A	SHOP TOWEL

8 Wipe off the 3M protective tape application solution.

NOTE

Allow to dry thoroughly.

9 Repeat steps 1 through 8 for the remaining door handle films.

10 Check that all parts are installed properly.