

Germain Honda of College Hills

HONDA *Accessory Installation Tips*

November 2021

AI118533-09

Accessory Trailer Hitch

When installing the trailer hitch to a Passport with an accessory or factory-equipped hands-free access power tailgate, you must install the hands-free access power tailgate sensor trailer hitch adaptor.

To ensure proper trailer hitch installation with hands-free access, use the chart below to help determine what parts you need.

Description	Part Number	Trim Level and Application		
		EX-L		TOURING/ELITE
		Accessory Hands-Free Access w/o Accessory Trailer Hitch	Accessory Hands-Free Access with Accessory Trailer Hitch	Factory equipped Hands-Free Access with Accessory Trailer Hitch
Hands-Free Access Power Tailgate Sensor (Long Sensor)	08U59-TGS-100	•	•	
Hands-Free Access Power Tailgate Sensor Attachment (Long Sensor)	08U59-TGS-100A	•	•	
Hands-Free Access Power Tailgate Sensor Trailer Hitch Adaptor (Short Sensor)	08L91-TGS-100A		•	•
Trailer Hitch	08L92-TGS-100		•	•

For instructions on how to work the hands-free access system, see the online owner's manual.

Germain Honda of College Hills



INSTALLATION INSTRUCTIONS

Accessory

TRAILER HITCH

Application

2022 PASSPORT

Publications No.

VERSION 2

Issue Date

NOV 2021

GENERAL VIEW

If you are also installing trailer hitch harness, install it before you install the trailer hitch.

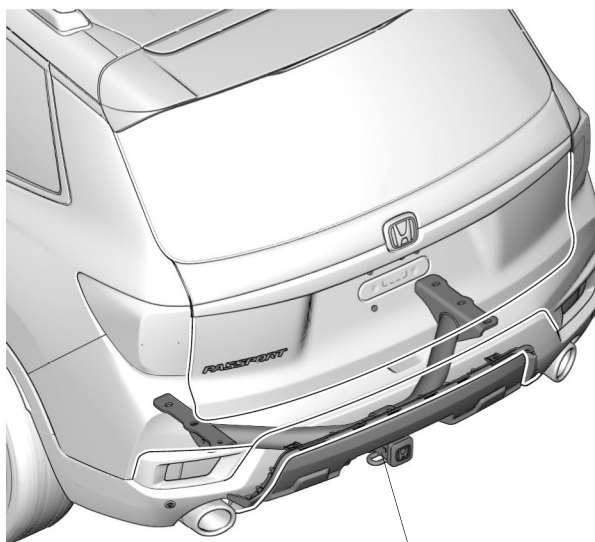

TRAILER HITCH

QL51001AB

FOR YOUR SAFETY (Read carefully.)

Warning Symbols

Safety: Your safety, and the safety of others, is important. To help you make informed decisions about service procedures, we have provided safety messages where appropriate. Of course, it is not practical or possible to warn you about all the hazards associated with servicing a vehicle - you must use your own good judgment.

You will find important safety messages preceded by one of following symbols:

*All symbols are not used in all installation instructions.

⚠ DANGER

You will be killed or seriously hurt if you do not follow the instructions.

⚠ WARNING

You can be killed or seriously hurt if you do not follow the instructions.

⚠ CAUTION

You can be hurt if you do not follow the instructions.

NOTICE

Gives advice to prevent damage to the product, vehicle, the environment or other property.

NOTE

Gives helpful information or instructions to be followed when installing this product.

Germain Honda of College Hills



Indicates a prohibited action.

Procedure and Location Icons

These icons indicate the work location and the worker's point of view.

*All icons are not used in all installation instructions.

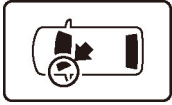

The location on the vehicle.

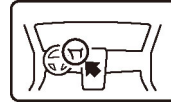

The location in the vehicle.
(instrument panel.)



Wear eye protection.



Wear heavy gloves.



Use an assistant.



Place the part on a blanket.



Work perpendicular.



Remove any burrs.



Use touch-up paint and allow to dry.



Tighten to the specified torque.



Apply firm pressure while rolling, especially at the ends, to set the adhesive.



Press firmly.



Clean with isopropyl alcohol.



Return the original part to the customer.
(Do not reuse.)

Wire Harness Routing Precaution

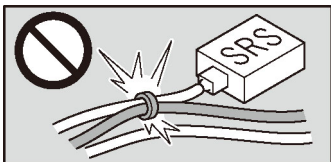

Do not secure the
accessory harness to the
SRS harness.
(except for instruction
cases.)

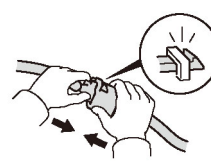

Push the connectors and
terminals together until
they lock.

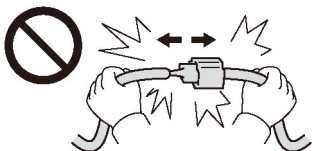

Do not pull the harness to
unplug the connectors.

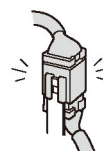

Install removed
connectors in their original
location.

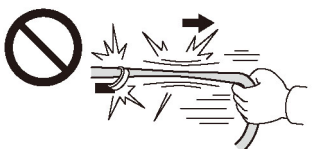

Do not pull the harness.



Secure the accessory
harness as shown.

Germain Honda of College Hills



Do not pinch the harness.

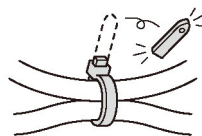

Cut off the excess wire tie.

Safety: General

- Observe all safety notes and precautions described in the service information, in addition to those described in this Installation Instruction. Be extremely careful for your safety and safety of others.
- Be careful not to damage the vehicle or the parts.
- Be extremely careful when handling retaining tabs and clips.
- Note the locations of the parts before removing them so they can be properly installed in their original positions.
- The illustrations may differ slightly from the actual accessory.

Safety: Electric Parts

Always disconnect the negative cable from the battery before beginning work.

Safety: Accessory

- Always use the parts and tools specified in the installation instructions.
- Do not install the accessory on a dirty surface or in direct sunlight.
- Make sure the ambient air temperature is 60°F (15°C) or above when installing accessories that use adhesive material.
- When pressing the accessory firmly with the palm of your hand, be careful not to damage it or the vehicle.
- When applying adhesive material, make sure it is lined up properly before attaching. Once the adhesive material touches the surface, do not try to remove it. If you do, you could damage the part.
- Not to wash the vehicle for 24 hours to allow the adhesive to cure.

PARTS LIST

Trailer Hitch Kit
(P/N 08L92-TGS-100B)
(P/N 08L92-TGS-P00B)

Trailer hitch	Hitch cover panel	Cover	Bolts (6)

Ball Mount Kit (P/N 08L92-TGS-100A)

Germain Honda of College Hills

Ball mount

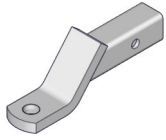

Hitch pin



Hitch pin clip

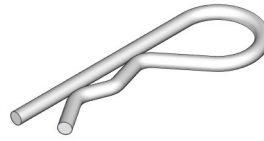

Hands-Free Access Power Tailgate Unit Kit (P/N 08L91-TGS-100B) (P/N 08L91-TGS-P00B)

Hands-free access unit

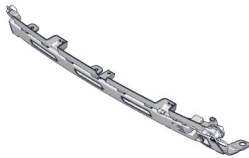

Label A

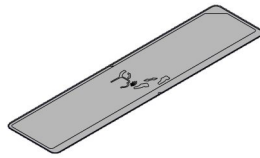

Label B

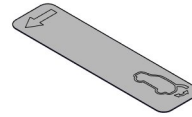

Accessory User's
Information Manual

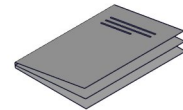

Germain Honda of College Hills

REQUIRED TOOLS AND SUPPLIES

- Phillips screwdriver
- Torque wrench
- Shop towel
- Masking tape
- 10 mm Open end wrench
- 10 mm and 18 mm Sockets
- Blanket
- Isopropyl alcohol

The following tools are available through the Honda Tool and Equipment Program:

- Trim Tool Set (T/N SOJATP2014)
- Plastic Trim Tool (T/N

INSTALLATION

1. Wrap a shop towel.

NOTE

Do not remove the shop towel until after the parts are installed.

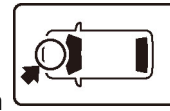

Ratchet

- Torque wrench
- File

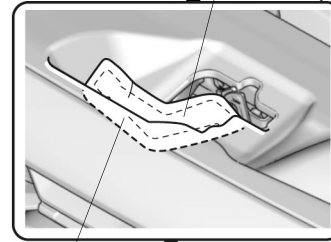

SHOP TOWEL

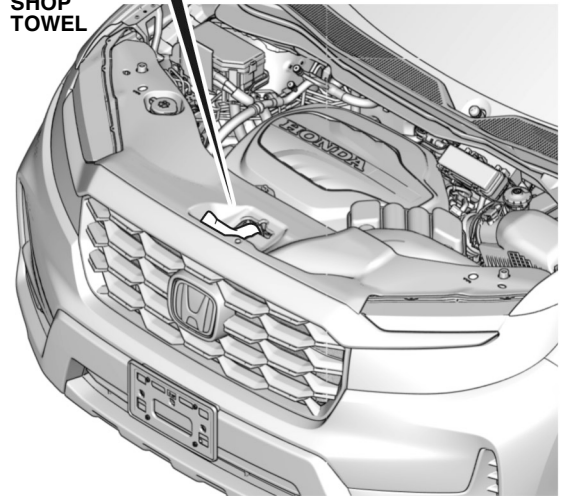

QL42302AA

2. Remove the front bulkhead cover.

Germain Honda of College Hills

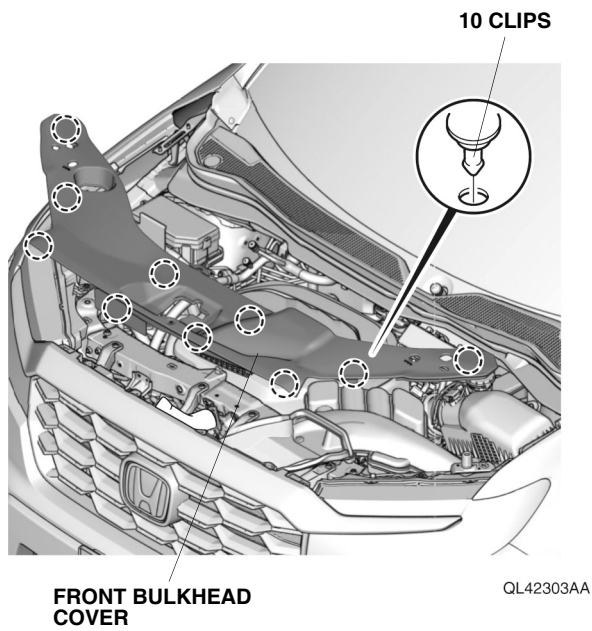

3. Remove the intake air tube.

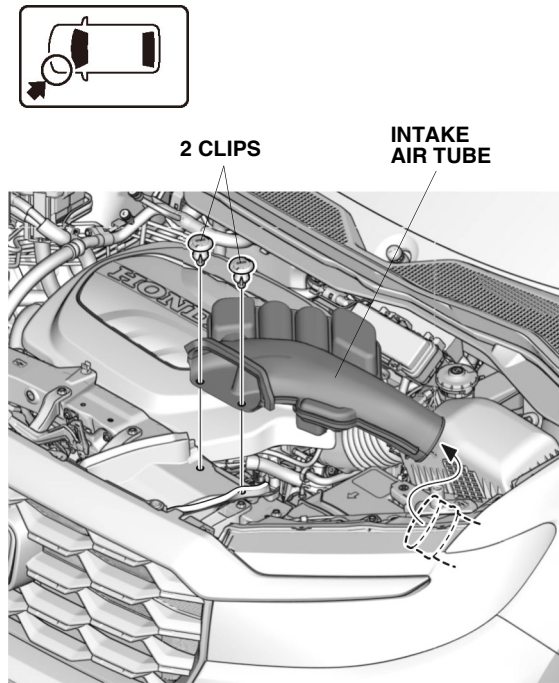

4. Disconnect the negative cable from the battery.

Germain Honda of College Hills

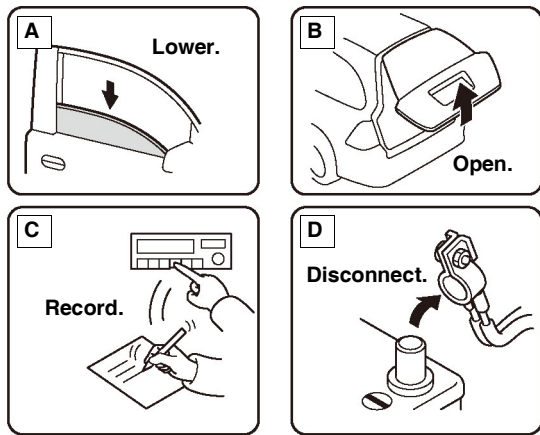

QCD0504BM

5. Open the left rear door and remove the self-tapping screws.

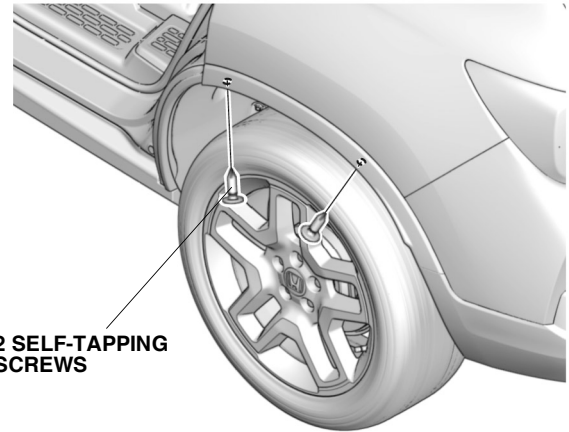
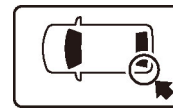

QL51201AA

6. Release the left rear wheel arch protector.

Germain Honda of College Hills

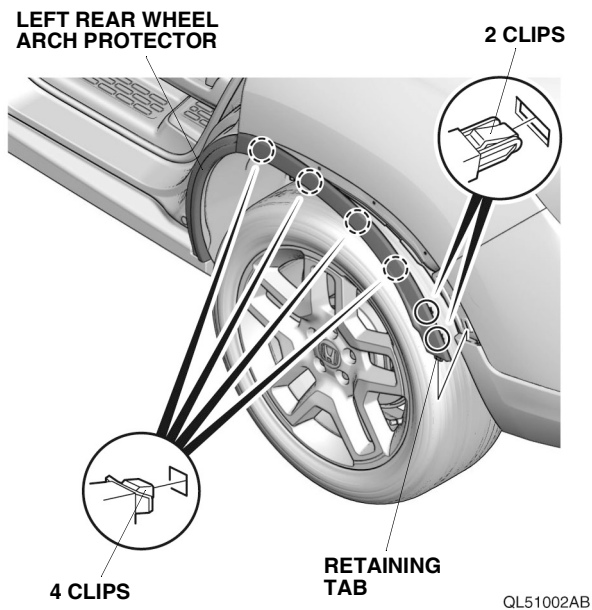

7. Repeat same procedures on the other side.

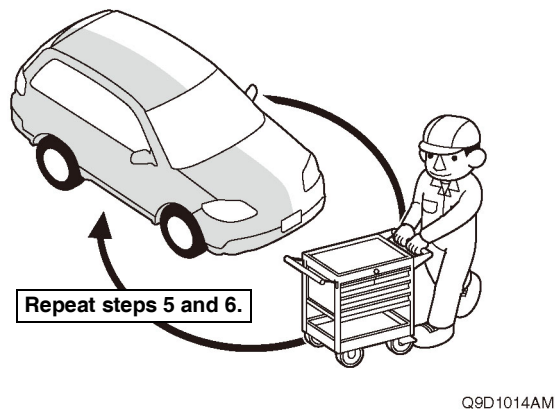

8. Attach masking tape to protect the vehicle.

NOTE

Do not remove the masking tape until after the parts are installed.

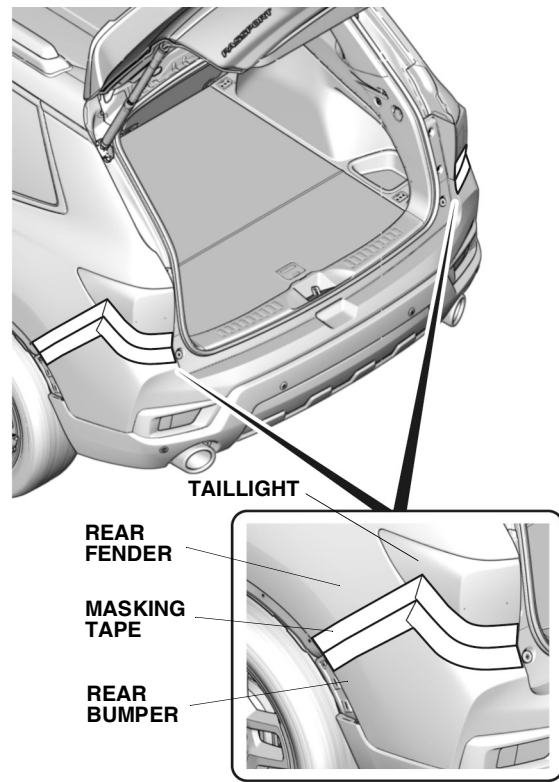
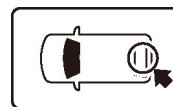

9. Remove the clips, hex bolts, and self-tapping screws.

Germain Honda of College Hills

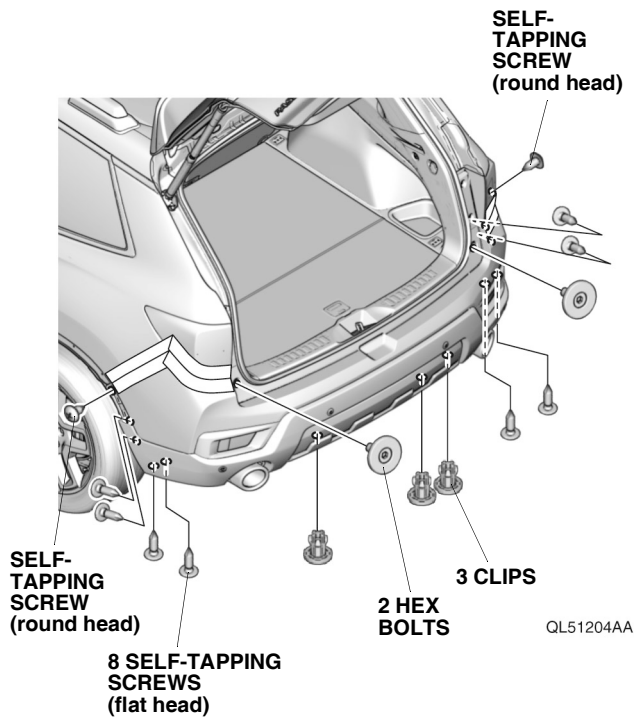

10. Release the retaining tabs.

NOTE

- Release the retaining tabs starting from outside working in.
- Make sure to release the retaining tabs in the correct orientation.

Germain Honda of College Hills

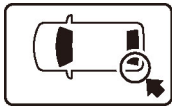

2 RETAINING
TABS

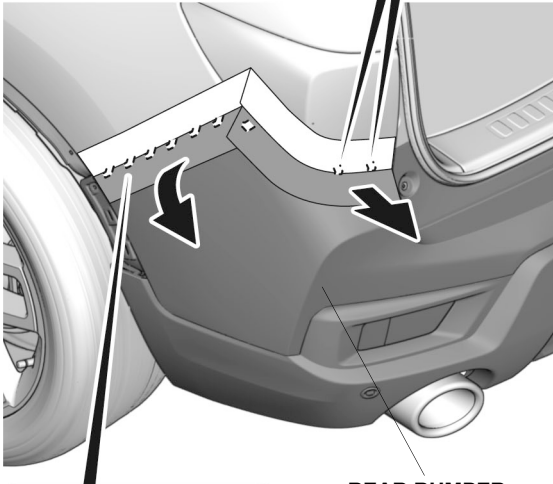
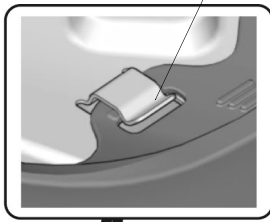

REAR BUMPER

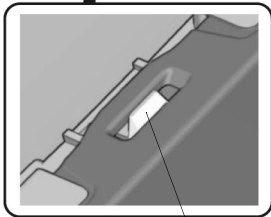

7 RETAINING
TABS

QL51205AA

11. Repeat step 10 on the other side.
12. Remove the rear bumper.

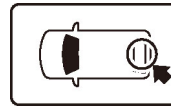

VEHICLE
CONNECTOR
(if equipped)

6 RETAINING
TABS

VEHICLE
CONNECTOR

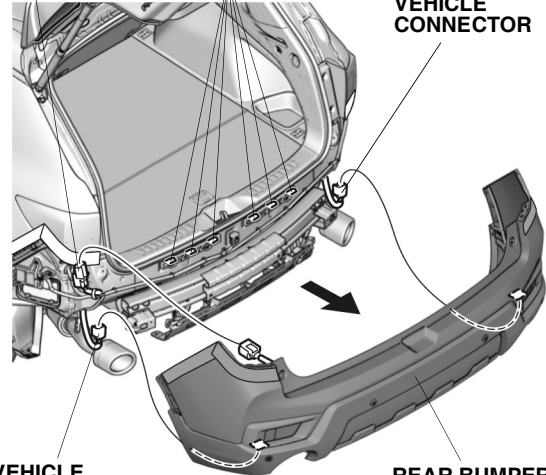

VEHICLE
CONNECTOR

REAR BUMPER

QL51206AA

13. Remove the rear bumper lower cover.

Germain Honda of College Hills

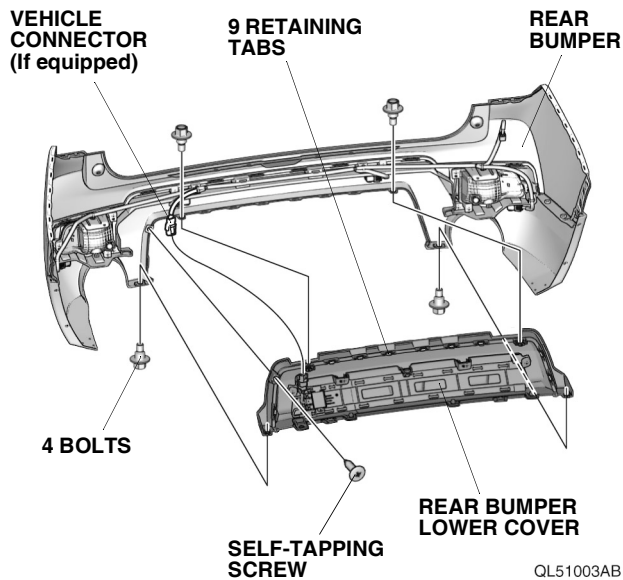

14. Remove the clip (if equipped), self-tapping screws (if equipped), and spring nuts.

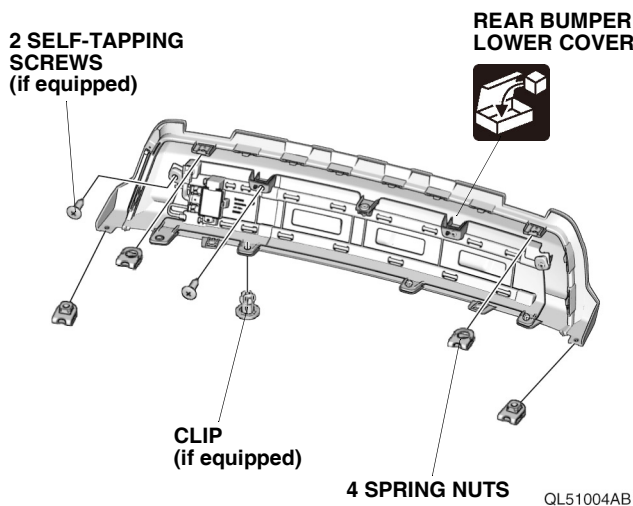

15. Choose one of these options.

- | |
|---|
| <ul style="list-style-type: none"> • With Hands-Free Access Power Tailgate Unit Kit
Go to step 16 • Without Hands-Free Access Power Tailgate Unit Kit
Go to step 20 |
|---|

16. Release the sensor bars.

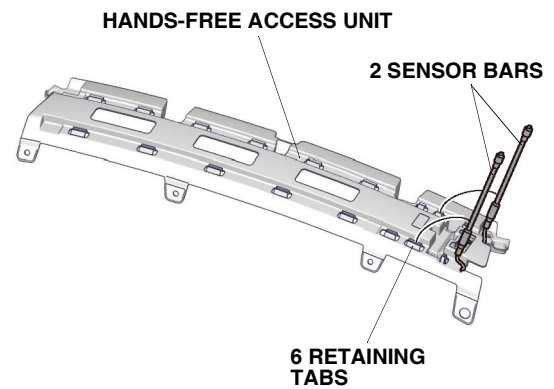

17. Cut the hands-free access unit.

NOTE

Be careful not to damage the sensor bars.

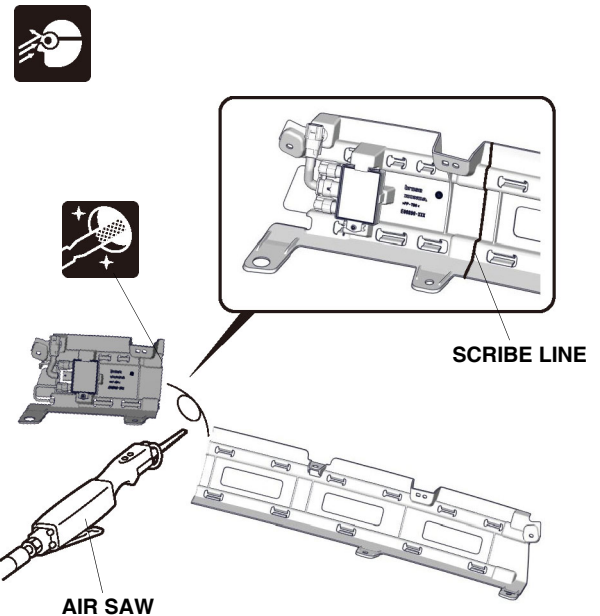

Germain Honda of College Hills

18. Install the sensor bars.

NOTE
Make sure to install the sensor bars in the correct position.

Germain Honda of College Hills

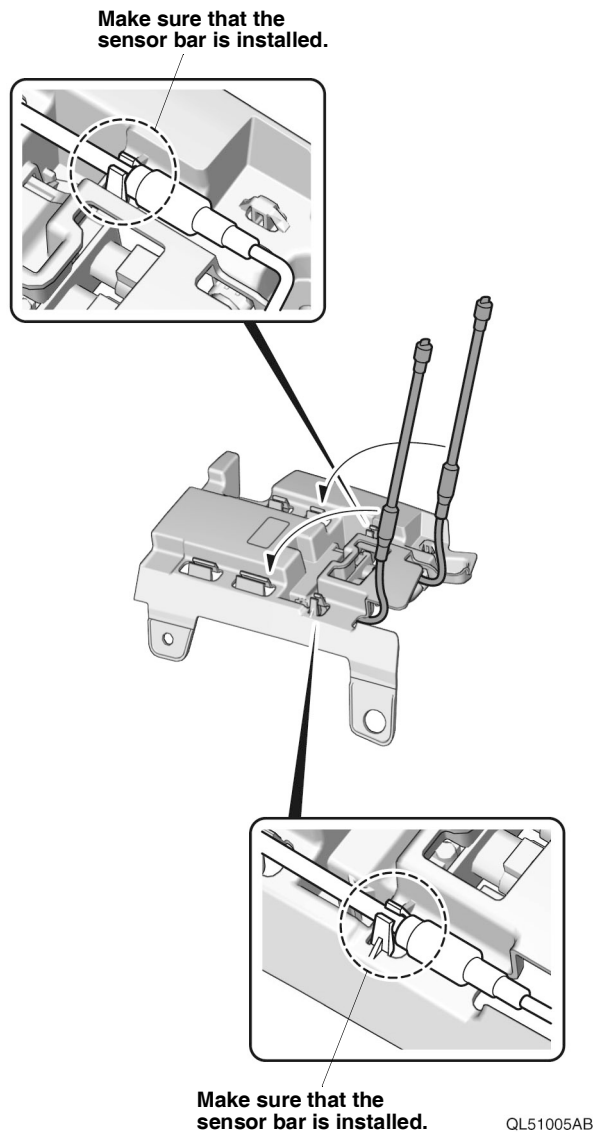

19. Install the hands-free access unit.

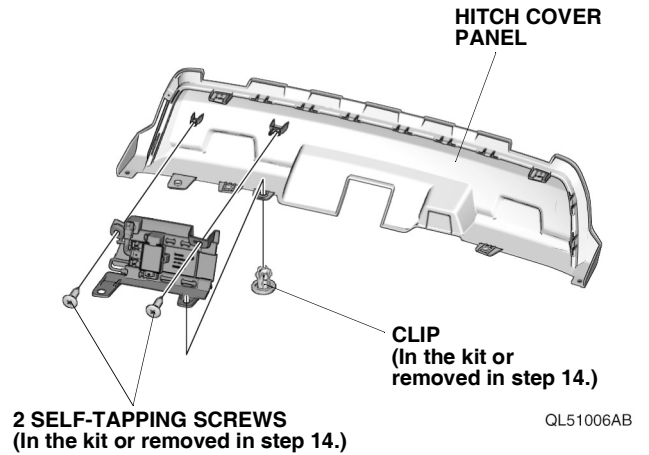

20. Install the spring nuts.

NOTE

Make sure to install the spring nuts in the correct orientation.

Germain Honda of College Hills

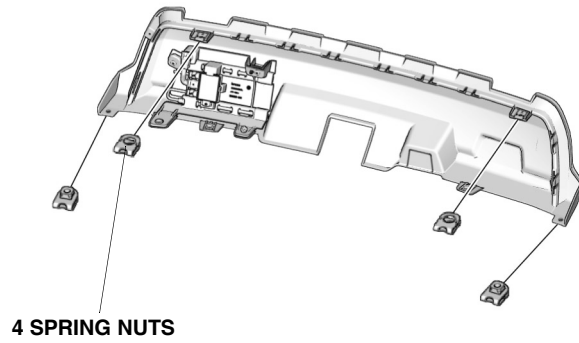

QL51007AB

21. Install the hitch cover panel.

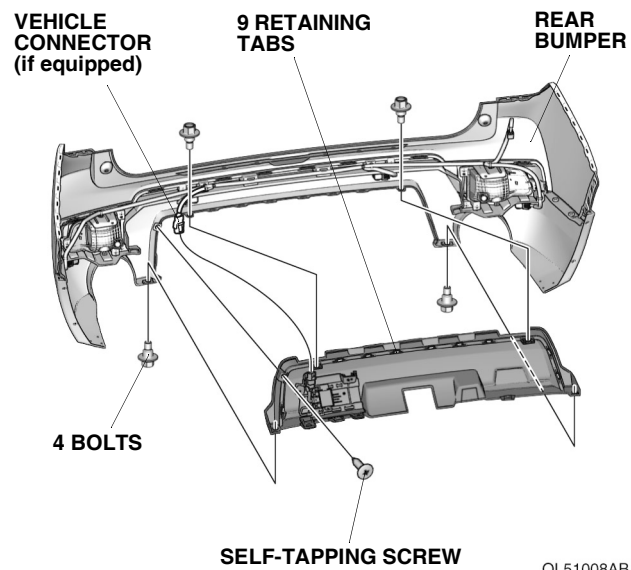

QL51008AB

22. Install the rear bumper.

Germain Honda of College Hills

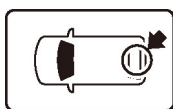

VEHICLE
PANEL

TRAILER HITCH

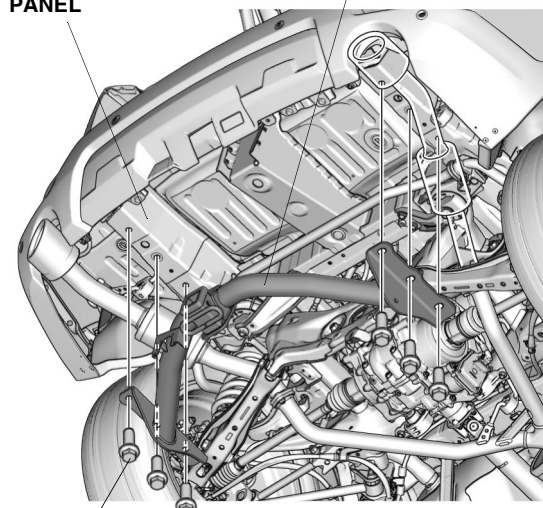

6 BOLTS
(Loosely tighten
by hand.)

QL51101AB

23. Loosely install the trailer hitch.

24. Tighten the bolts.

NOTE

- Tighten in the order shown.
- Tighten the six bolts to an initial torque of 32 lb-ft (43 N·m) as shown. Then, tighten the bolts to a final torque of 63 lb-ft (85 N·m).
- After tightening all the bolts, recheck their torque.

6 BOLTS



32 lb-ft
(43 N·m)

6 BOLTS



63 lb-ft
(85 N·m)

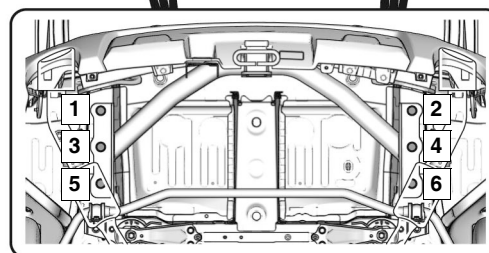
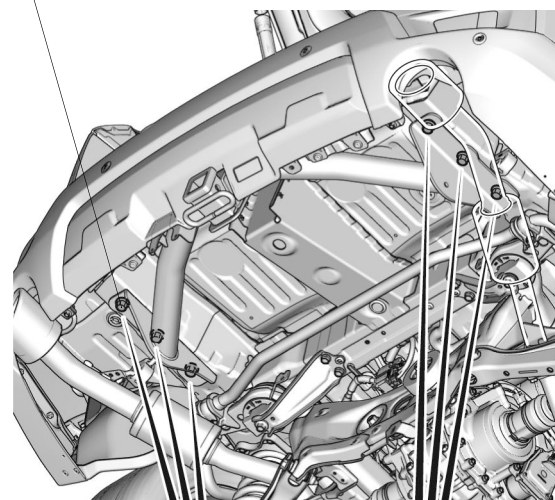

QL51102AB

25. Check that all parts are installed and properly routed.

NOTE

- Check that all harnesses are not pulled and not pinched.
- Make sure all clamps and wire ties are securely installed.

26. Install all removed parts except for the front bulkhead cover and intake air tube.

27. Connect the negative cable to the battery.

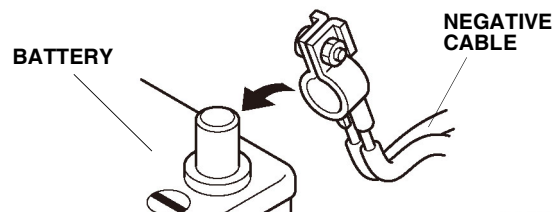

Q060702BM

28. Install the front bulkhead cover and intake air tube.

Germain Honda of College Hills

29. Perform operation check by referring to the accessory user's information manual (with hands-free access power tailgate unit kit).
30. Make sure all accessories and systems operate properly.
31. If necessary, restore the systems back to normal operation as described in the service information.
32. Press and hold the audio unit power button for 2 seconds to restore the audio and navi (if equipped) system functions.

With Hands-Free Access Power Tailgate Unit Kit

33. Remove the label.

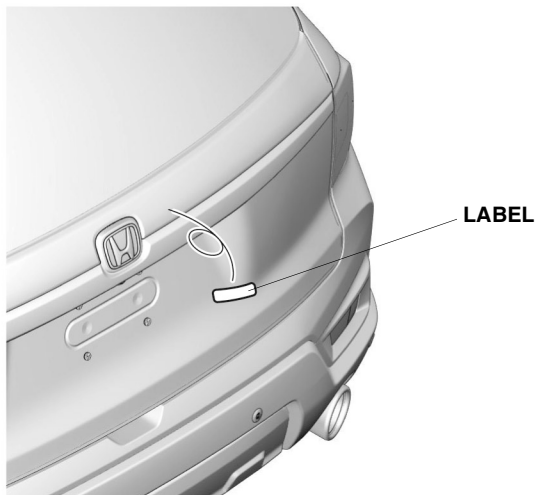
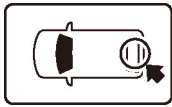

QL01302AN

34. Attach the label A.

NOTE

Make sure the customer is aware the label A can be removed after reading.

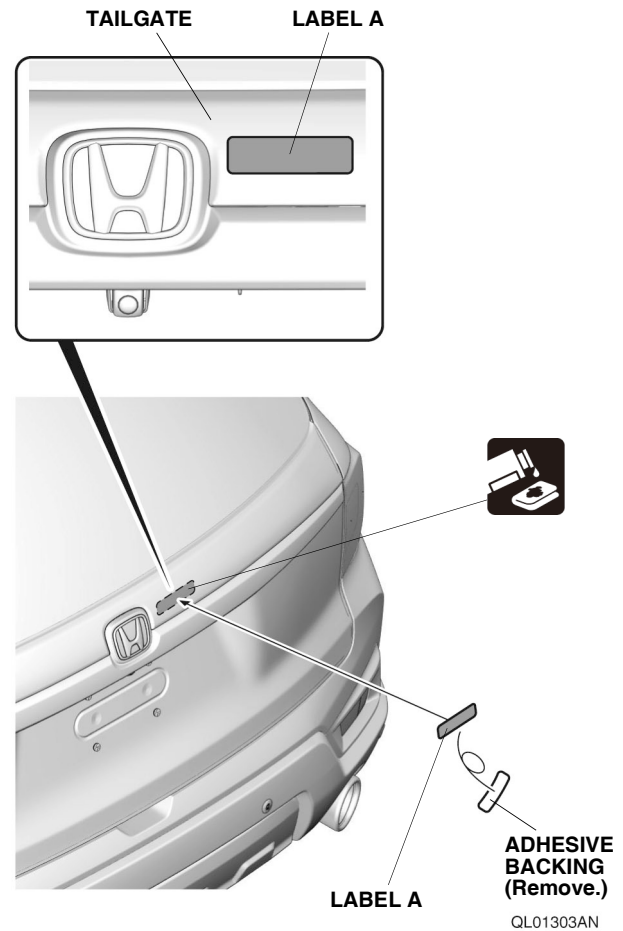

35. Attach the label B.

NOTE

Make sure the customer is aware the label B can be removed after reading.

Germain Honda of College Hills

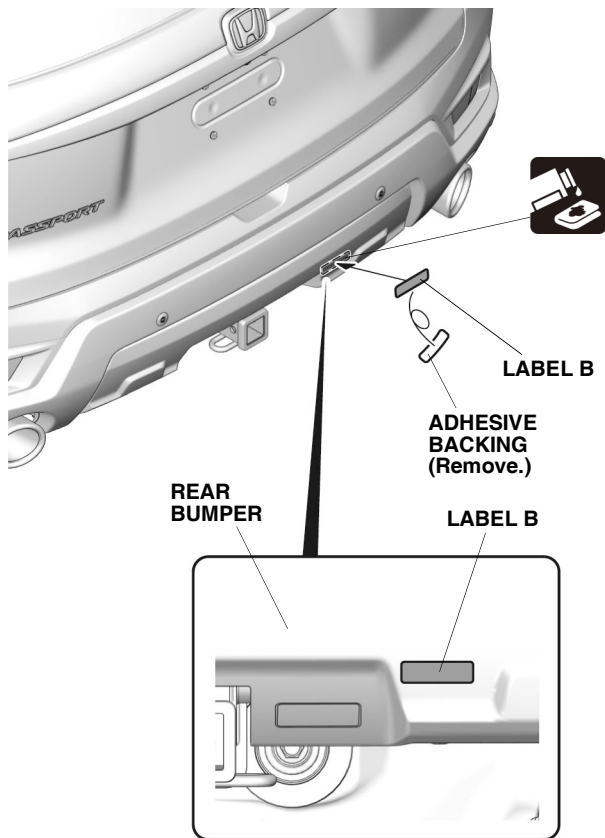

QL01304AN

Please give your customer a copy of this page.

TRAILER HITCH

Whenever you remove the hitch pin clip, the hitch pin, and the ball mount, store them securely in the cargo area. Install the cover into the opening at the end of the trailer hitch.

When you reinstall the ball mount, store the cover in the cargo area.

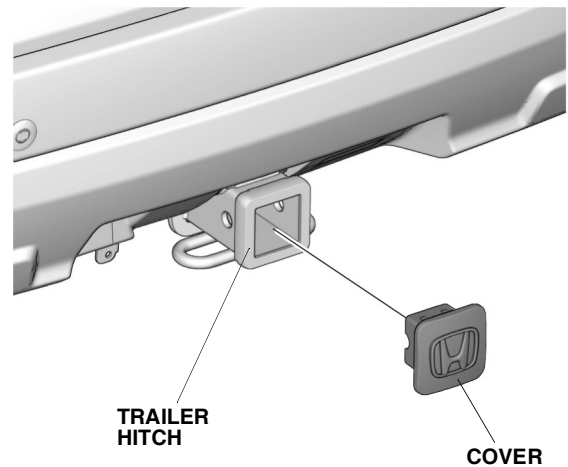

QL51103AB

Install the ball mount into the trailer hitch using a hitch pin clip and hitch pin.

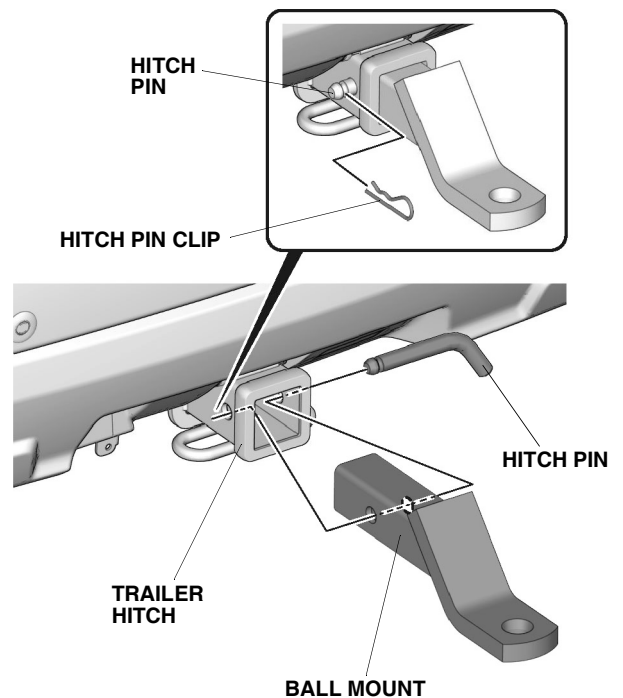

QL01305AN

After the first 600 miles (1,000 km) of towing, have your Honda Dealer check the tightness of the trailer hitch bolts.