



HONDA INSTALLATION INSTRUCTIONS

Accessory

HANDS-FREE ACCESS POWER TAILGATE

Application

2021 PASSPORT

Publications No.

VERSION 1

Issue Date

SEP 2020

PARTS LIST

Hands-Free Access Power Tailgate Attachment Kit P/N 08U59-TGS-100A

Switch



Switch bracket

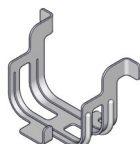

Hands-free access harness
(May not be used)

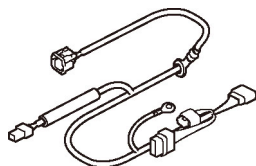

Subharness

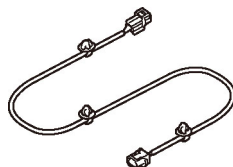

Fuse label
(May not be used)

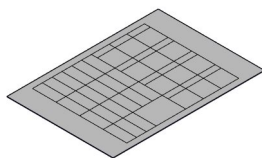

Narrow wire tie



12 Wire ties
(Some may not be used)



Aluminum tape

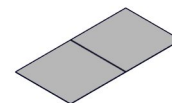

4 Self-tapping screws
(Some may not be used)



4 Clips
(Some may not be used)



Wire tie with clip
(May not be used)



Label A

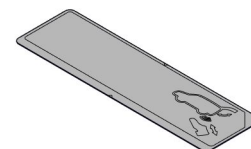

Hands-Free Access Power Tailgate Unit Kit (Without accessory trailer hitch) P/N 08U59-TGS-100

Hands-free access unit



Accessory user's information manual

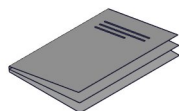

Hands-Free Access Power Tailgate Unit Kit (With accessory trailer hitch) P/N 08L91-TGS-100A

Hands-free access unit

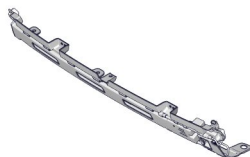

Label B

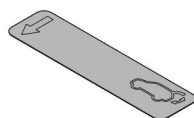

Accessory user's information manual

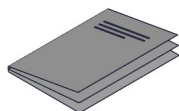

TOOLS AND SUPPLIES REQUIRED

Phillips screwdriver

5 mm Hex wrench

Blanket

10 mm Open end wrench

10 mm Socket

Pushpin

Ratchet

3 mm Drill bit

Eye protection (face shield, safety goggles, etc.)

File

Isopropyl alcohol

Shop towel

26 mm Hole saw

Drill

Masking tape

Diagonal cutters

Utility knife

The following tools are available through the Honda Tool and Equipment Program. On the iN, click on Service > Service Bay > Tool and Equipment Program, then enter the number under "Search." Or, call 888-424-6857.

- Trim Tool Set (T/N SOJATP2014)
- Plastic Trim Tool (T/N SILTRIMTL10)
- Air saw (T/N AT192A)

Illustration of the Hands-Free Access Power Tailgate on the Vehicle

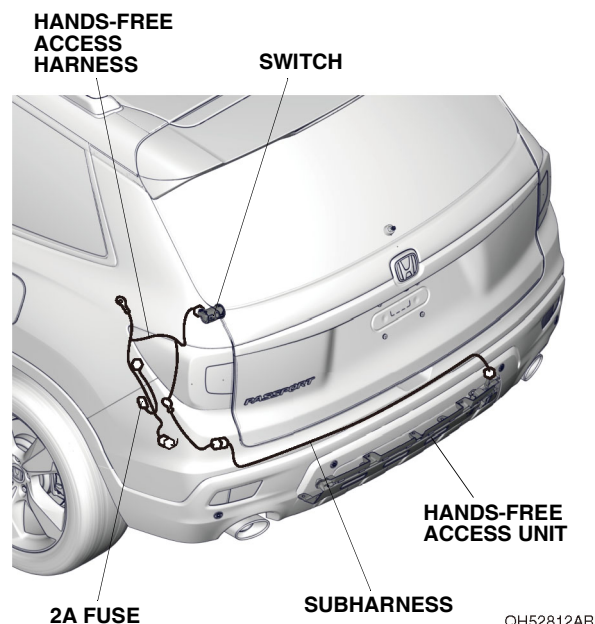

INSTALLATION

Customer Information: The information in this installation instruction is intended for use only by skilled technicians who have the proper tools, equipment, and training to correctly and safely add equipment to your vehicle. These procedures should not be attempted by “do-it-yourselfers.”

NOTE: If you are also installing the backup sensors or rear welcome lights, install them before you install the hands-free access power tailgate.

1. Open the tailgate.
2. Disconnect the negative cable from the battery:
 - Wrap a shop towel around the hood latch.

HOOD LATCH
(Wrap with a shop towel.)

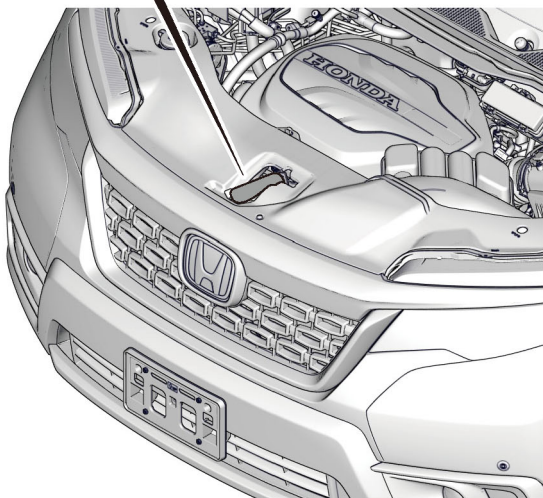
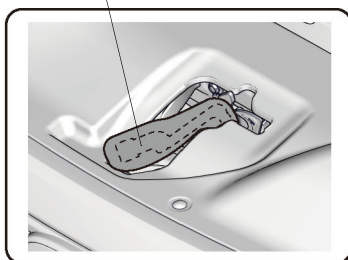

QH50702AB

- Remove the front bulkhead cover.

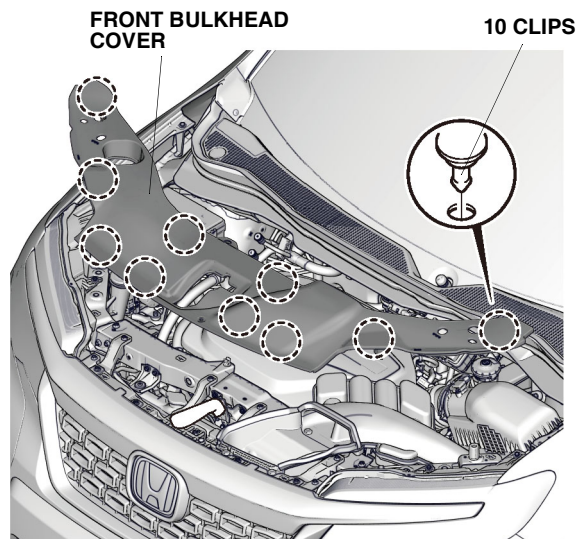

QH50703AB

- Remove the intake air tube.
- Disconnect the negative cable from the battery.

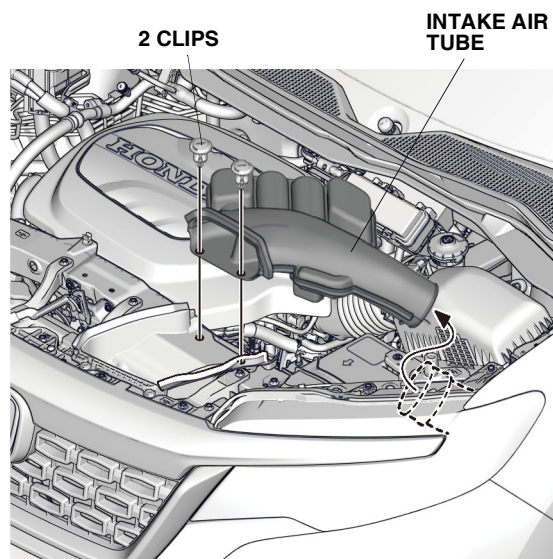

QH50704AB

3. Fold down the left and right rear seats, and move them forward.

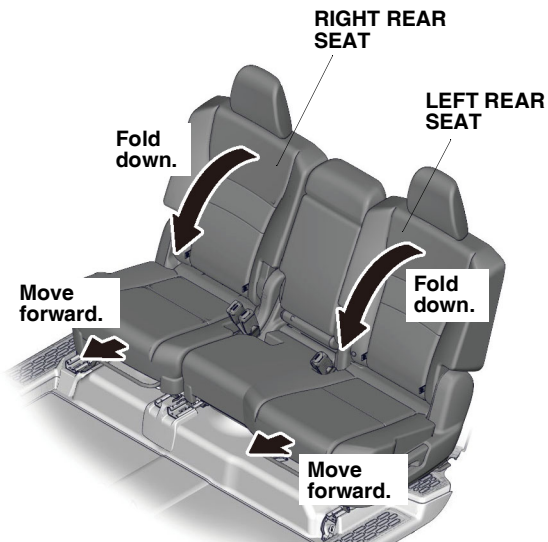

QH52502AX

4. Remove the left rear upper door sill trim.

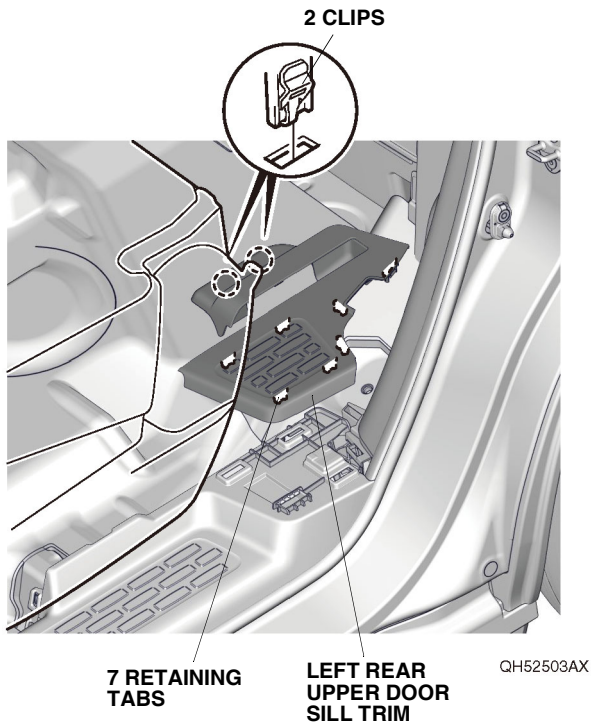

QH52503AX

5. Remove the cargo lid.

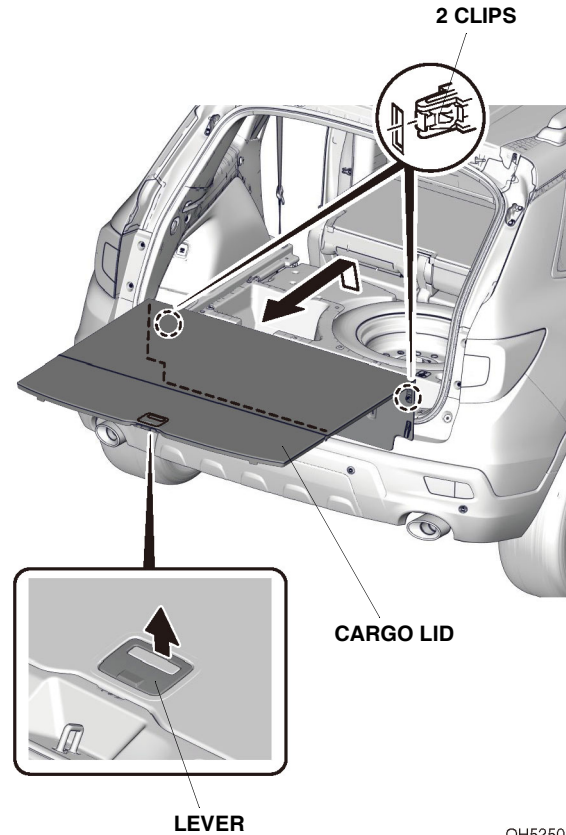

QH52504AX

6. Remove the tool box.

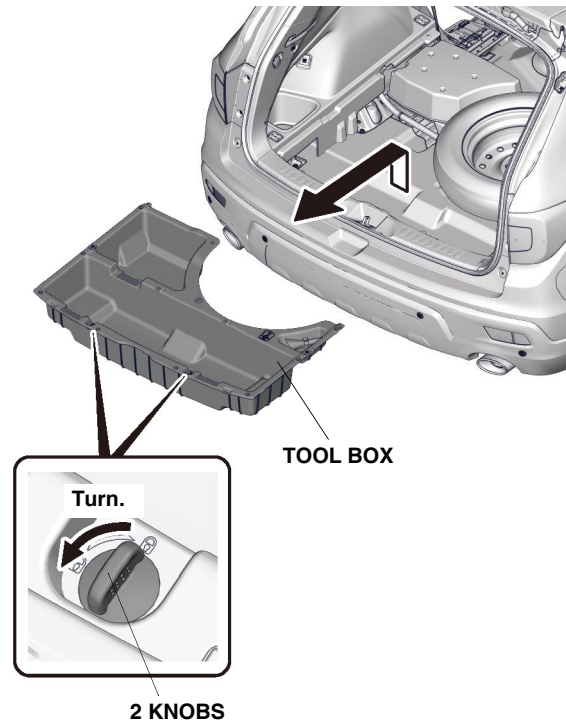

QH52505AX

7. Remove the rear trim panel.

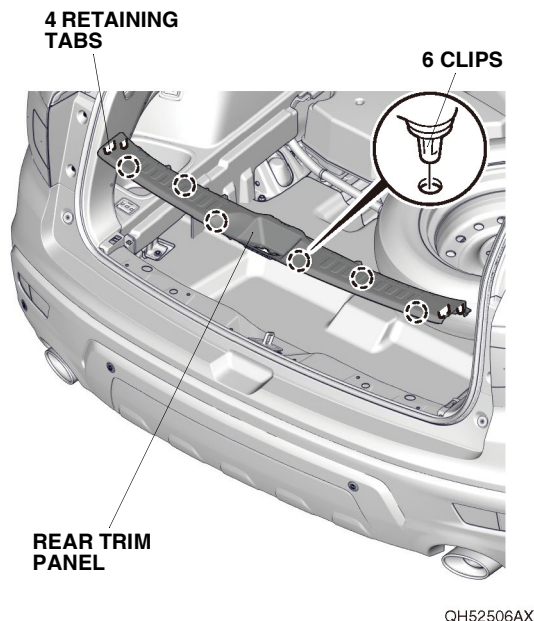

8. Remove the two tie-down hooks.

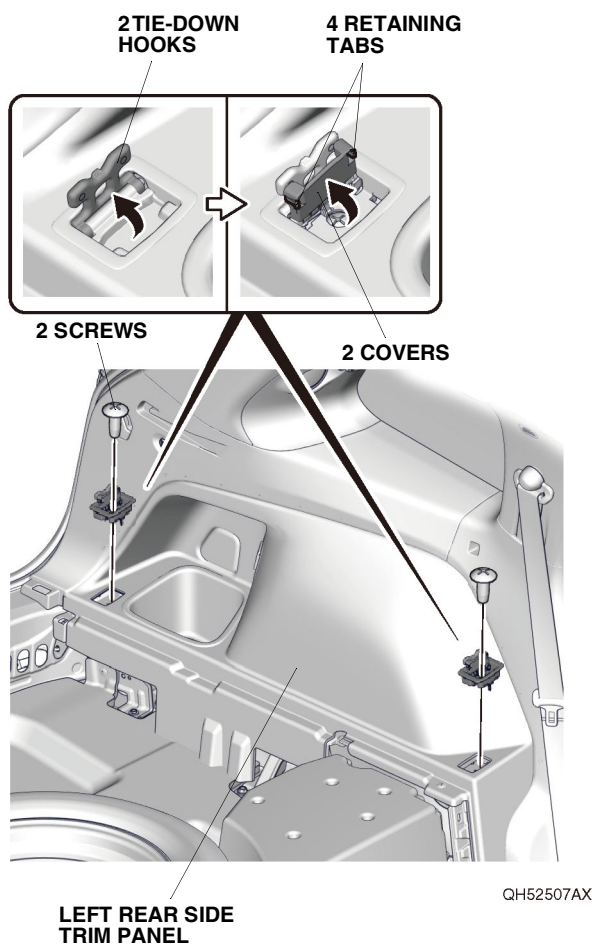

9. Using a plastic trim tool, pull the cover, and remove the cargo hook.

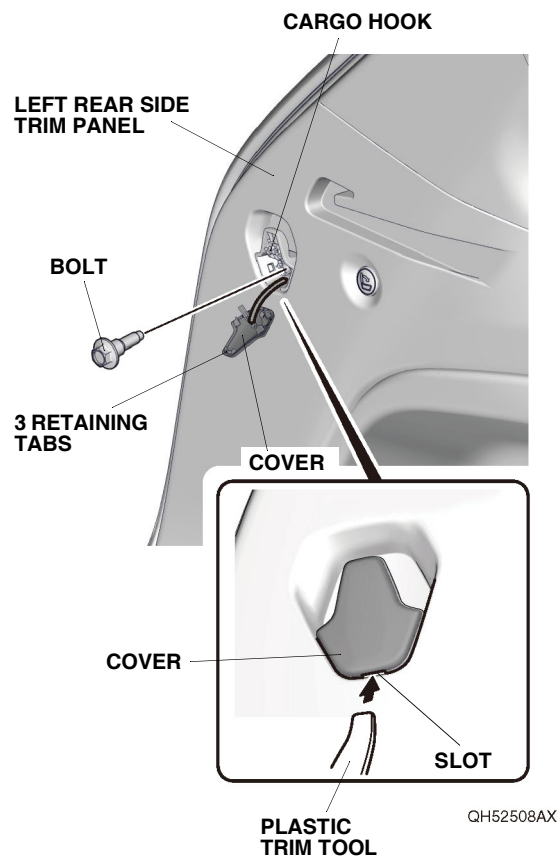

10. Apply masking tape to the left quarter pillar trim as shown.

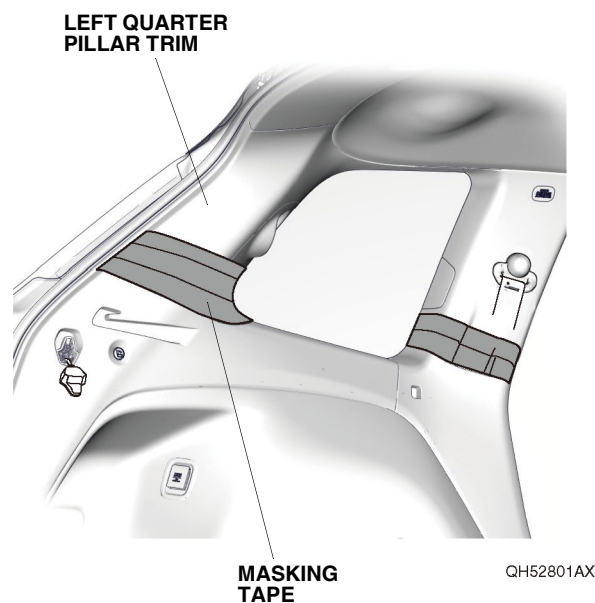

11. Pull away the door opening seal from around the left rear side trim panel. Remove the left rear side trim panel, and unplug the vehicle connectors (if equipped).

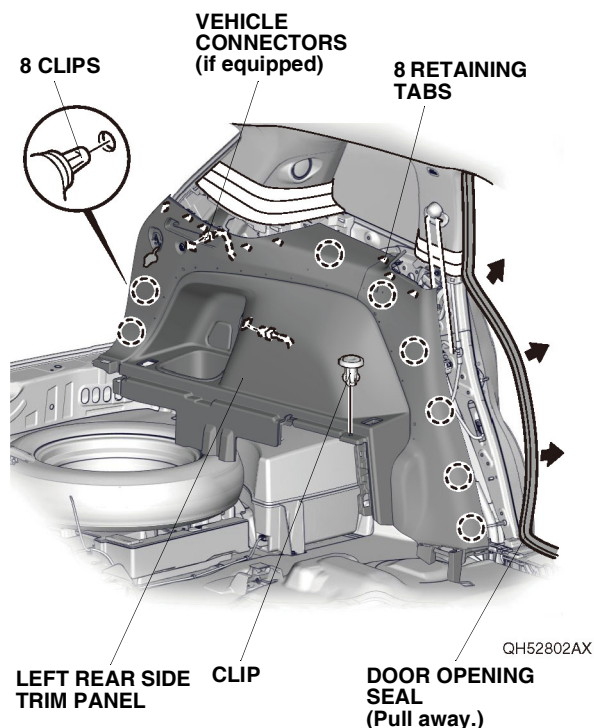

12. Release the vehicle harness to remove the left rear insulator.

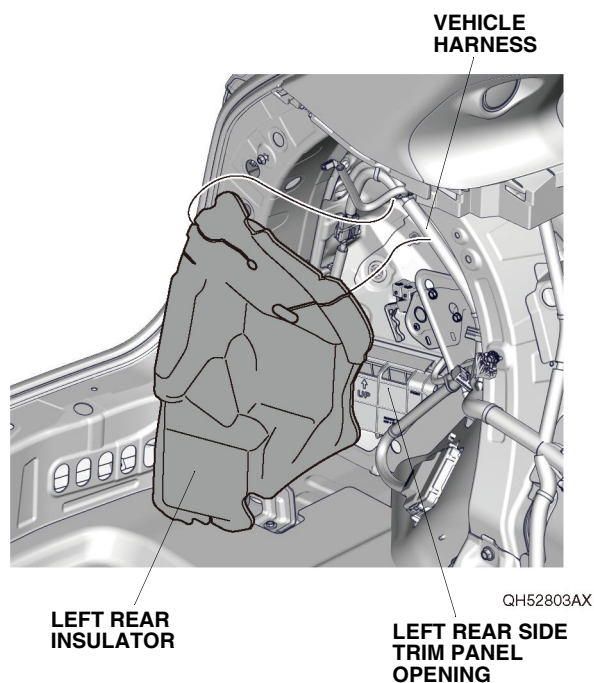

13. Open the right rear door.

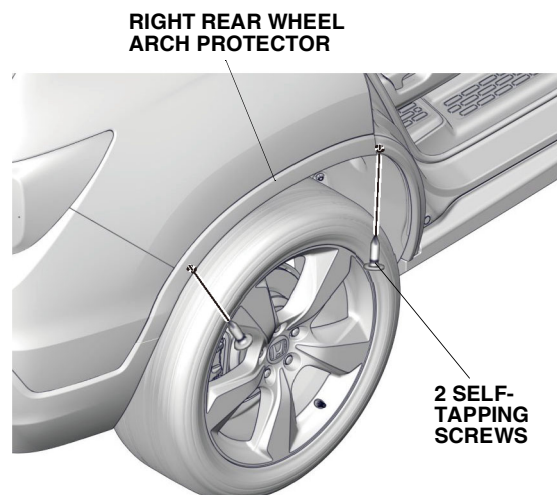

QH51502AC

14. Remove the two self-tapping screws.
15. Release the right rear wheel arch protector.

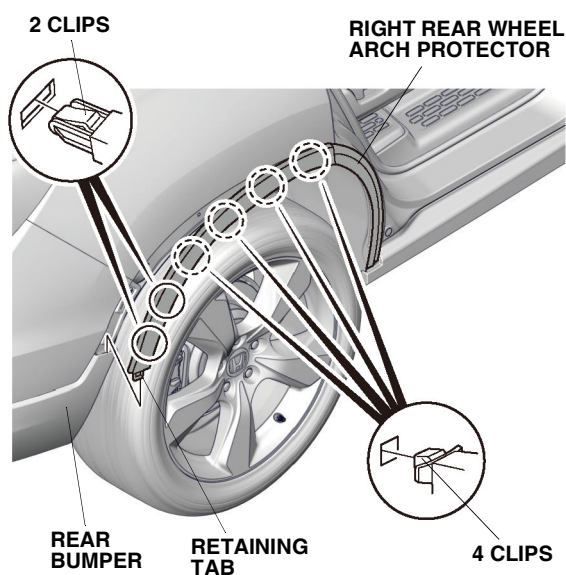

QH51503AC

16. Repeat steps 13 through 15 on the left side of the vehicle.

17. Remove the rear bumper:
- Apply masking tape as shown.

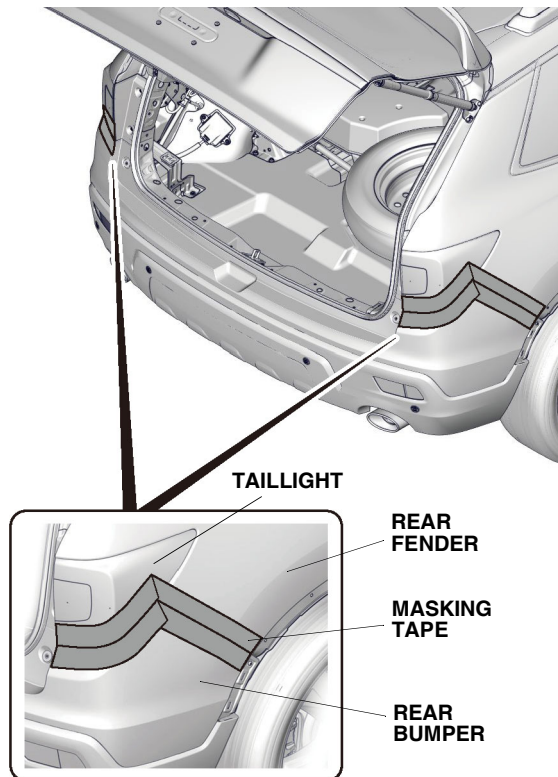

QH52804AX

- Remove the two bumper screws, 10 self-tapping screws, and three clips.

10 SELF-TAPPING SCREWS

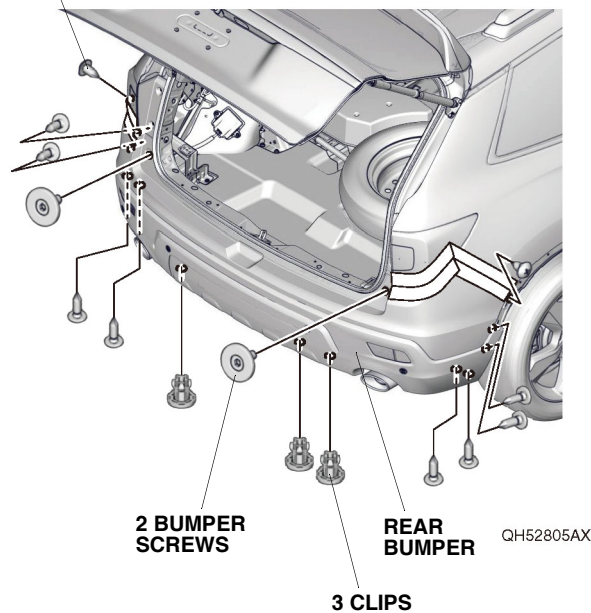

QH52805AX

- With the help of an assistant, release the seven retaining tabs along the fenderwell on each side.

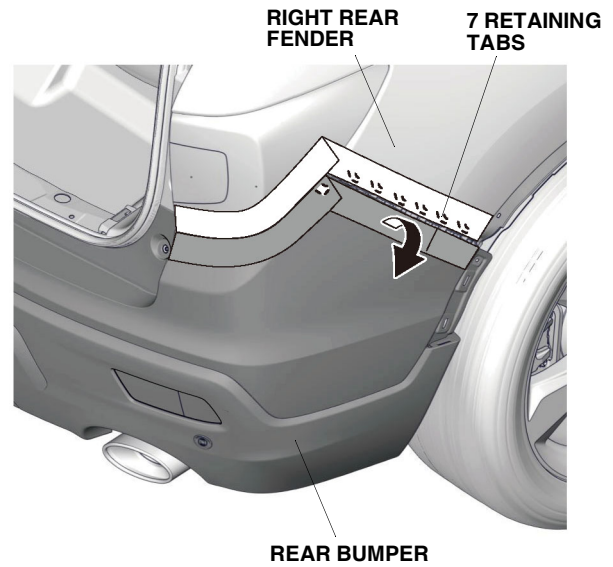

QH52806AX

- With the help of an assistant, release the two retaining tabs on each side.

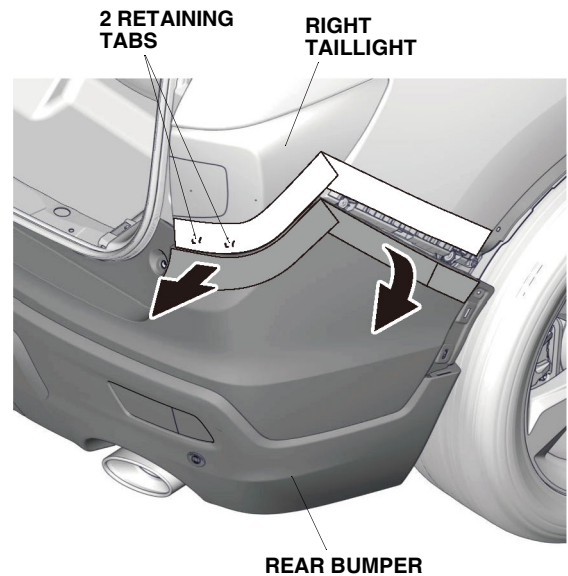

QH52807AX

- With the help of an assistant, remove the rear bumper, and unplug the vehicle connectors.
- Place the rear bumper on a blanket.

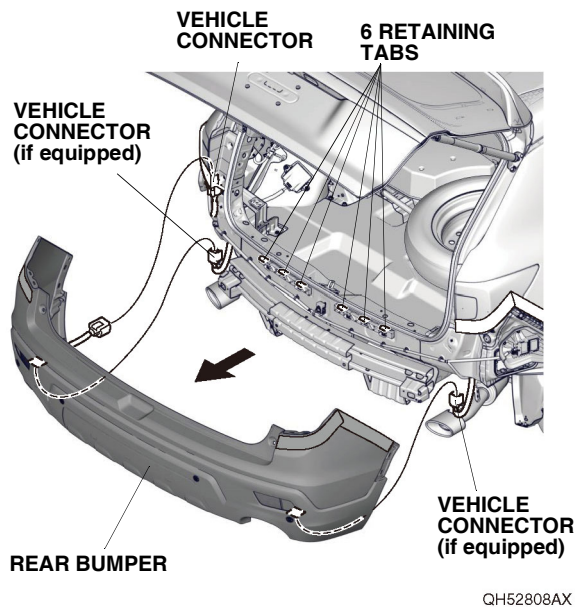

If the vehicle is equipped with the accessory rear side lining protectors, go to step 19; otherwise, continue with step 18.

Without accessory rear side lining protectors

- Using a pushpin, pierce the left rear side trim panel as shown. Go to step 21.

NOTE:

- Make sure to locate the correct scribe mark.
- Make sure to pierce perpendicular to the left rear side trim panel.

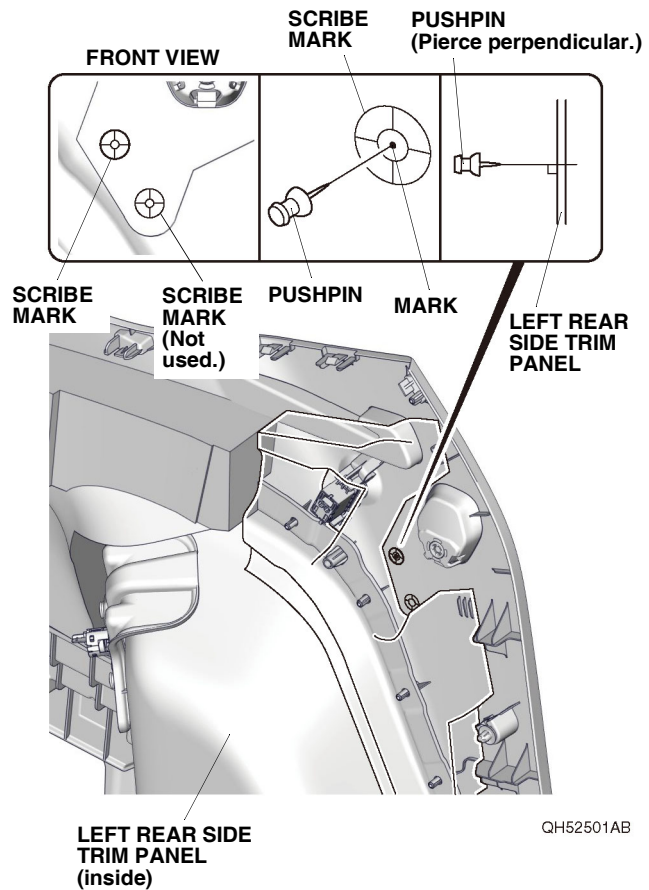

With accessory rear side lining protectors

19. Remove the accessory left rear side lining protector. Cut out the accessory left rear side lining protector as shown.
NOTE: Make sure that the accessory left rear side lining protector is correctly cut.

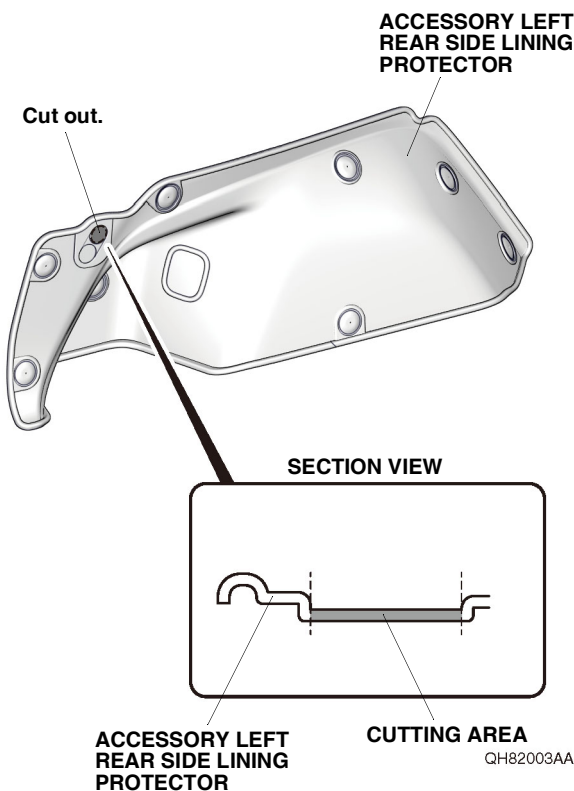

20. Install the accessory left rear side lining protector. Using a pushpin, pierce the left rear side trim panel as shown. Remove the accessory left rear side lining protector.
NOTE: Make sure to pierce perpendicular to the left rear side trim panel.

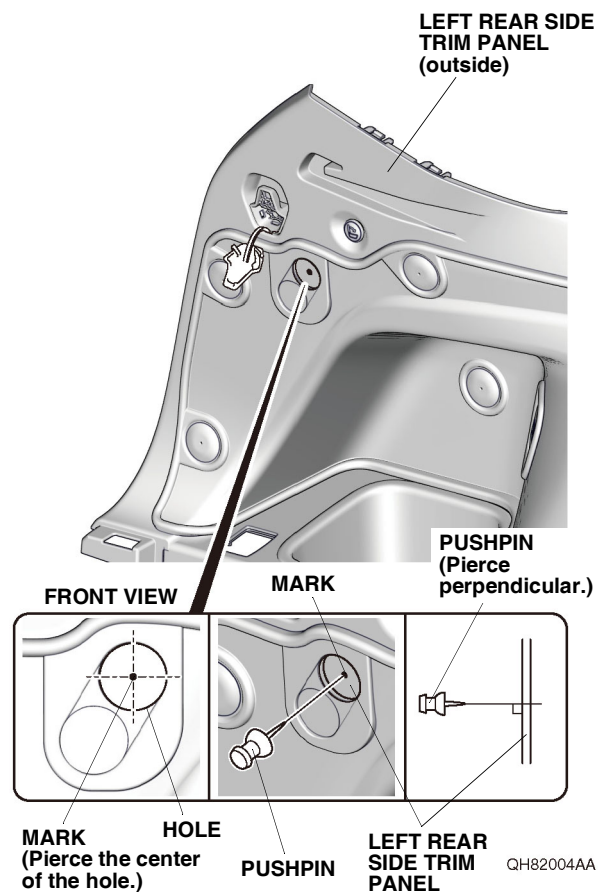

21. While wearing eye protection, drill the pierced mark on the left rear side trim panel with a 3 mm drill bit. Enlarge a 3 mm hole to 26 mm using a 26 mm hole saw. Remove any burrs.
NOTE: Make sure to drill perpendicular to the left rear side trim panel.

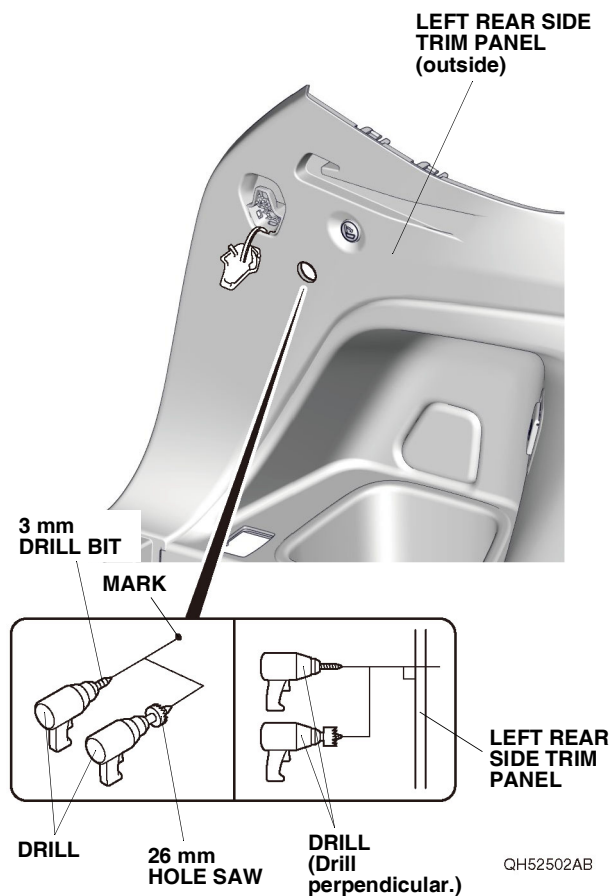

22. Install the switch into the 26 mm hole in the left rear side trim panel.
NOTE: Make sure to install the switch in the correct orientation.

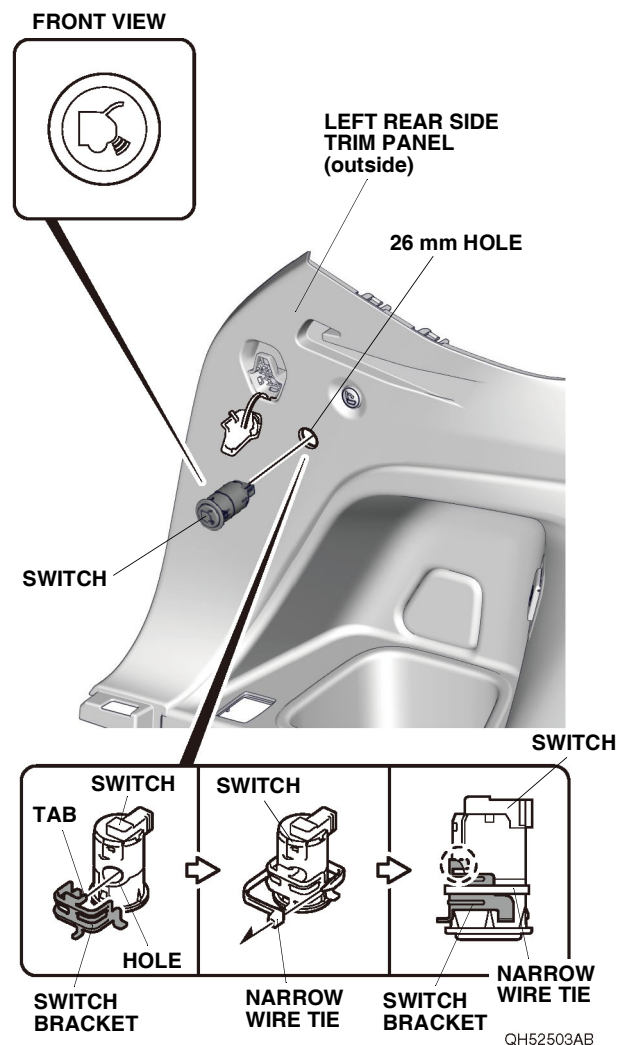

23. Line up the tab on the switch bracket with the hole on the switch and secure the switch bracket to the switch with one narrow wire tie.
NOTE: Firmly press the switch bracket against the left rear side trim panel, and make sure that there is no clearance between the switch and left rear side trim panel.

If the vehicle is equipped with the accessory backup sensors or accessory rear welcome lights, go to step 39; otherwise, continue with step 24.

Without accessory backup sensors or accessory rear welcome lights

24. Using isopropyl alcohol on a shop towel, thoroughly clean the fuse case where the fuse label will attach. Attach the fuse label (2A OPTION) to the fuse case on the hands-free access harness as shown.

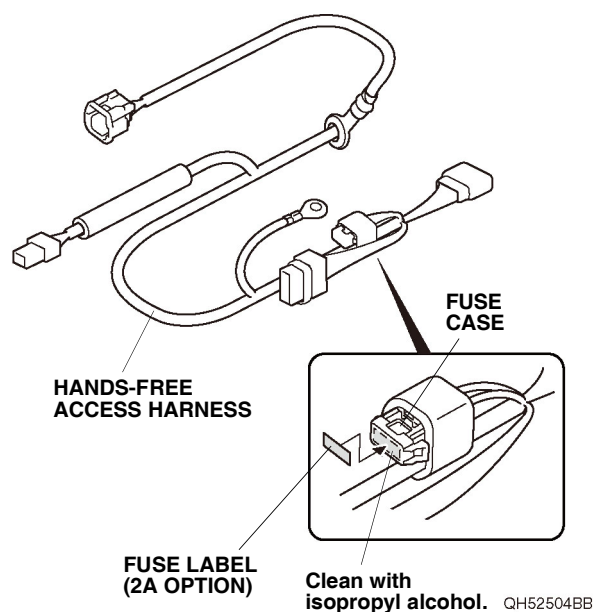

25. Remove the vehicle grommet. Route the hands-free access harness through the vehicle panel hole as shown.

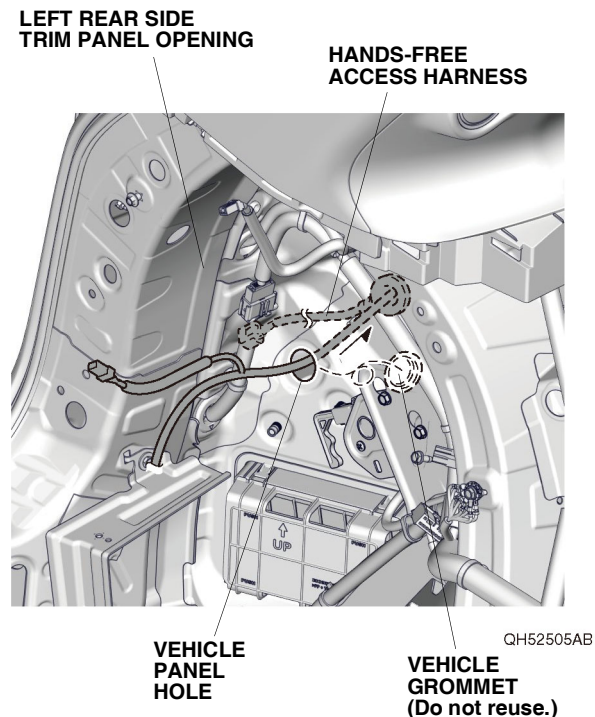

26. Secure the grommet on the hands-free access harness to the vehicle panel hole.

NOTE:

- Install the hands-free access harness by holding the grommet.
- Make sure the grommet is seated properly.

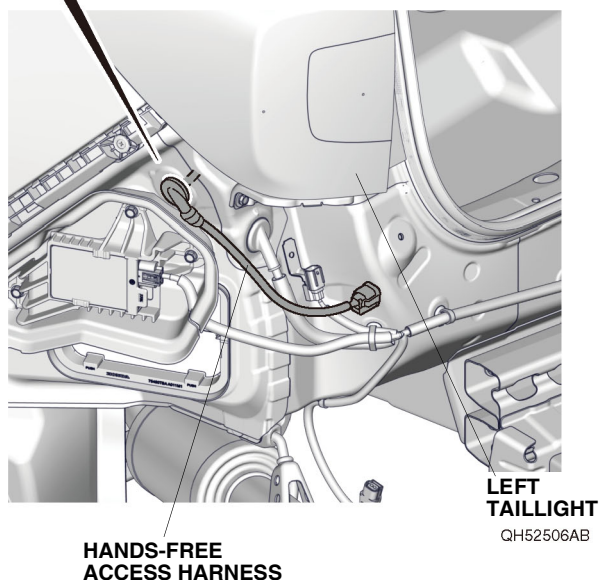
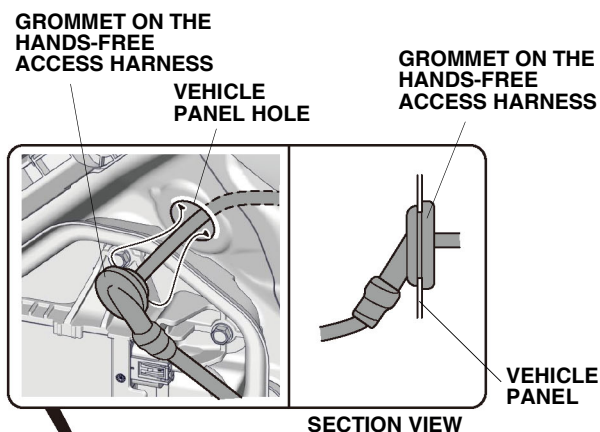

27. Secure the hands-free access harness 4-pin connector to the vehicle harness with one wire tie as shown.

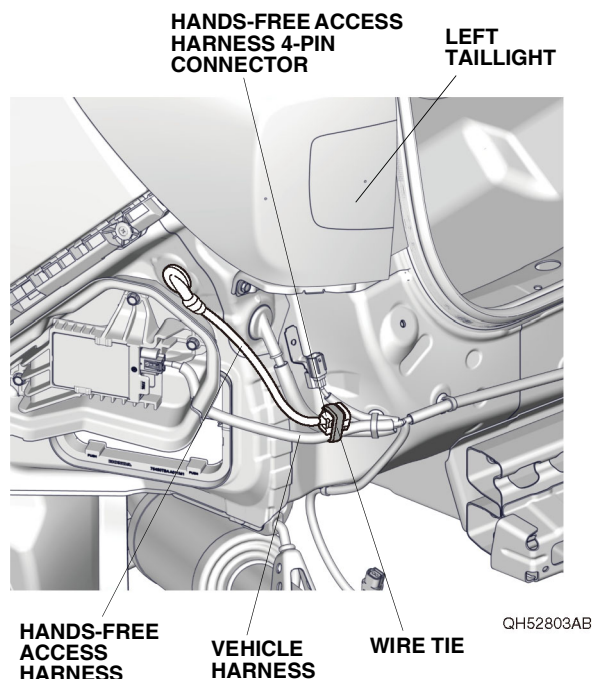

28. Route the hands-free access harness along the vehicle harness, and secure it to the vehicle harness with five wire ties.

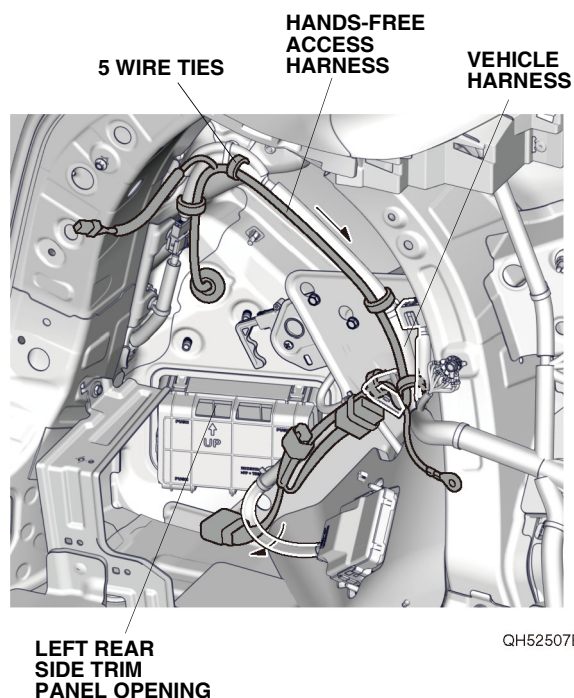

29. Remove the vehicle ground bolt, and secure the hands-free access harness ground terminal using that bolt.
- NOTE: Do not put the ground terminal calkings on top of one another.

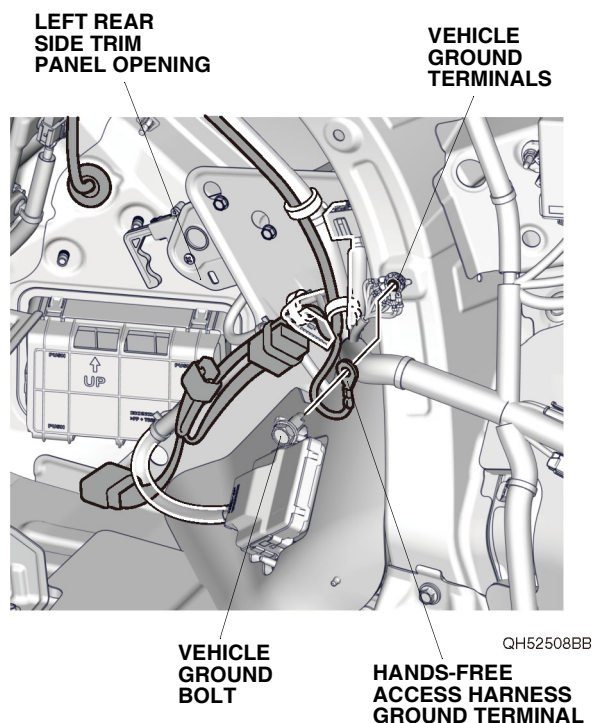

If the vehicle is equipped with the accessory trailer harness, go to step 31; otherwise, continue with step 30.

Without accessory trailer harness

30. Remove the tape to free the vehicle 14-pin connector as shown. Route the vehicle harness, and plug the vehicle 14-pin connector into the hands-free access harness 14-pin connector. Go to step 34.

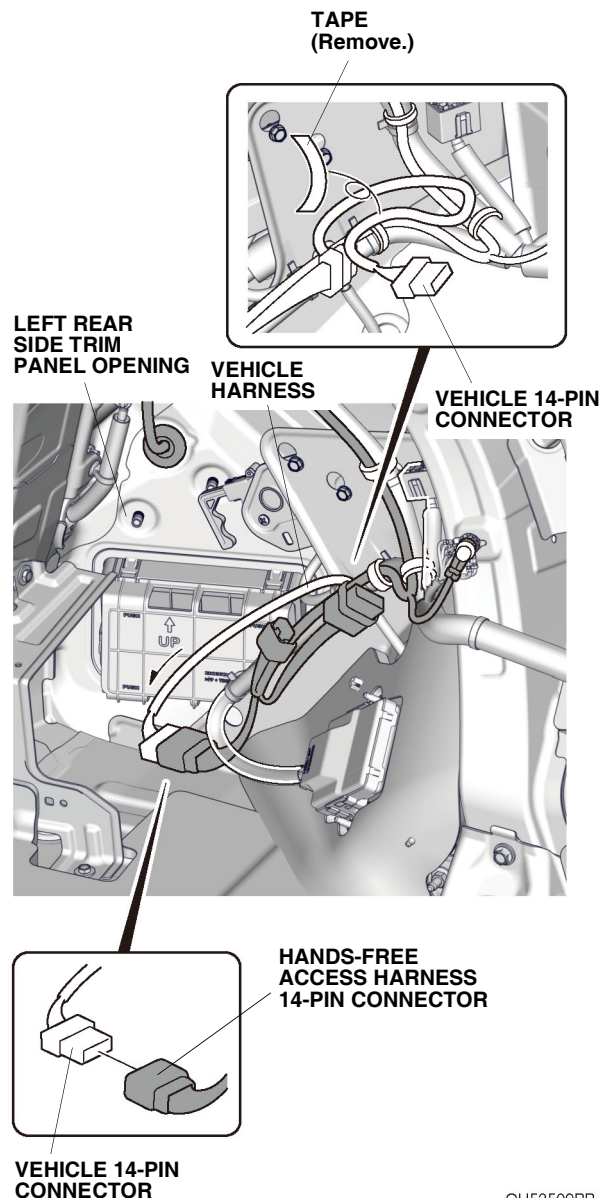

With accessory trailer harness

31. Unplug the vehicle 14-pin connector from the accessory trailer harness 14-pin connector.

**ACCESSORY TRAILER
HARNESS 14-PIN
CONNECTOR**

**LEFT REAR
SIDE TRIM
PANEL OPENING**

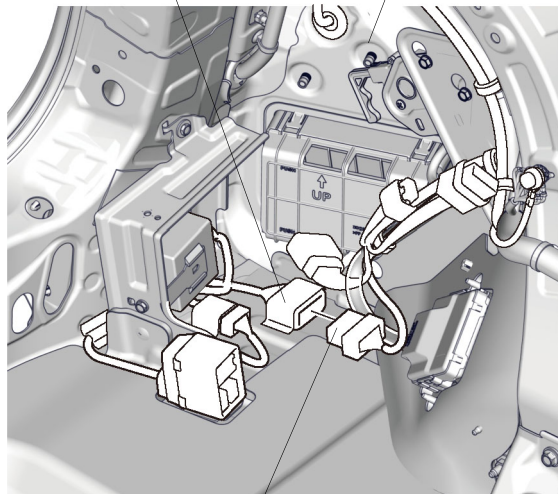

**VEHICLE 14-PIN
CONNECTOR**

QH52510BB

32. Remove the tape to free the hands-free access harness 14-pin connector as shown. Route the hands-free access harness, and plug the hands-free access harness 14-pin connector into the accessory trailer harness 14-pin connector.

**HANDS-FREE
ACCESS HARNESS
14-PIN CONNECTOR**

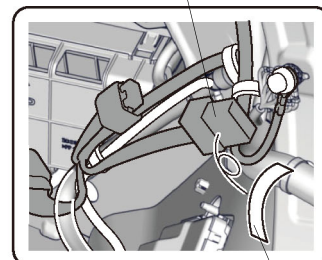

**LEFT REAR
SIDE TRIM
PANEL OPENING**

**TAPE
(Remove.)**

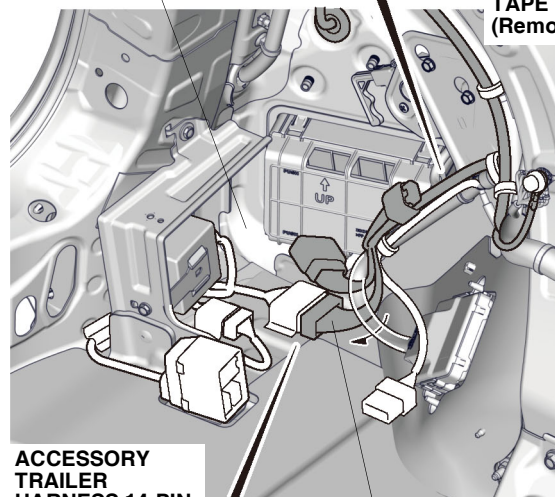

**ACCESSORY
TRAILER
HARNESS 14-PIN
CONNECTOR**

**HANDS-FREE
ACCESS HARNESS**

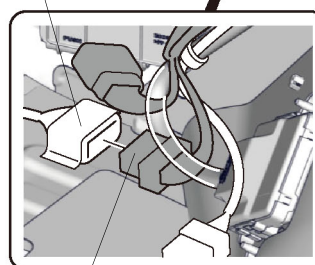

**HANDS-FREE
ACCESS HARNESS
14-PIN CONNECTOR**

QH52511BB

33. Plug the vehicle 14-pin connector into the hands-free access harness 14-pin connector.

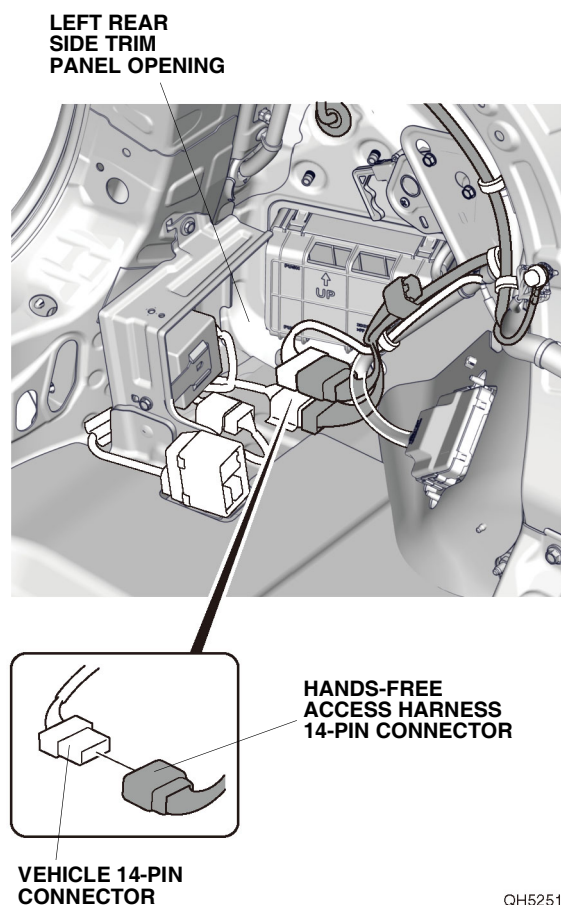

34. Secure the hands-free access harness to the vehicle harness with one wire tie as shown. If the vehicle is 2WD models, secure the vehicle harness to the vehicle panel with one wire tie with clip as shown. Secure the hands-free access harness to the vehicle harness with one wire tie as shown.

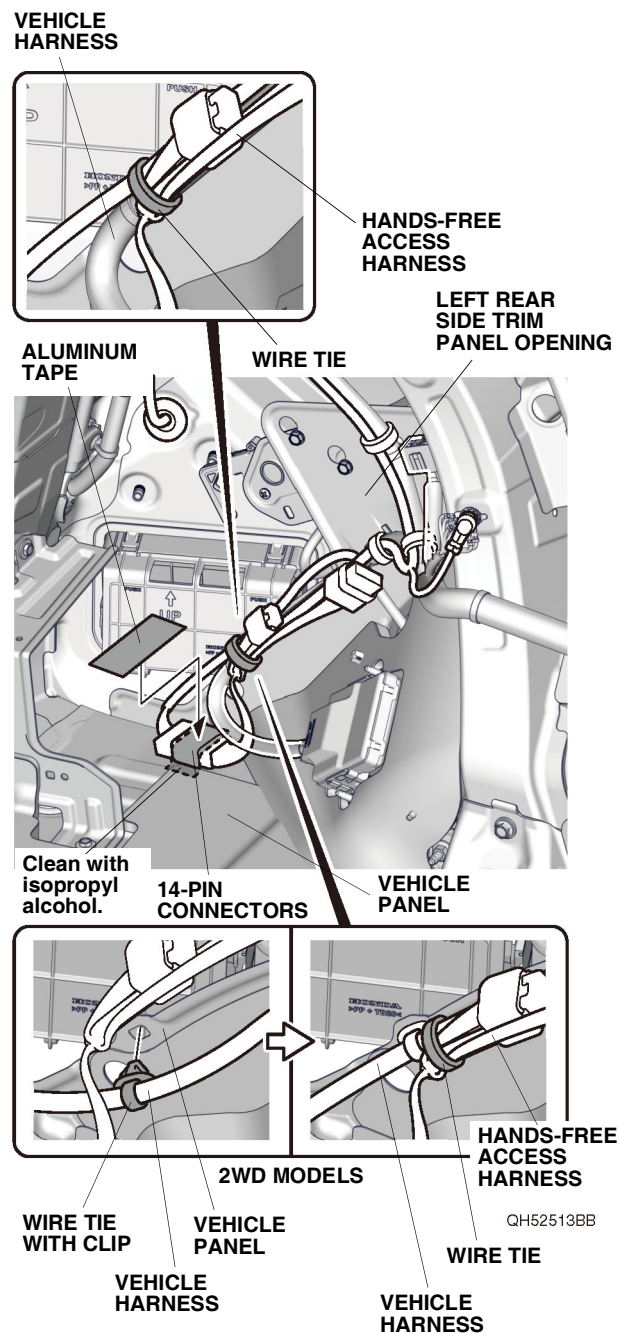

35. Using isopropyl alcohol on a shop towel, thoroughly clean the vehicle panel where the aluminum tape will attach.
36. Secure the 14-pin connectors to the vehicle panel with one piece of aluminum tape as shown.

37. Insert the hands-free access harness to the slit on the left rear insulator as shown. Install the left rear insulator.

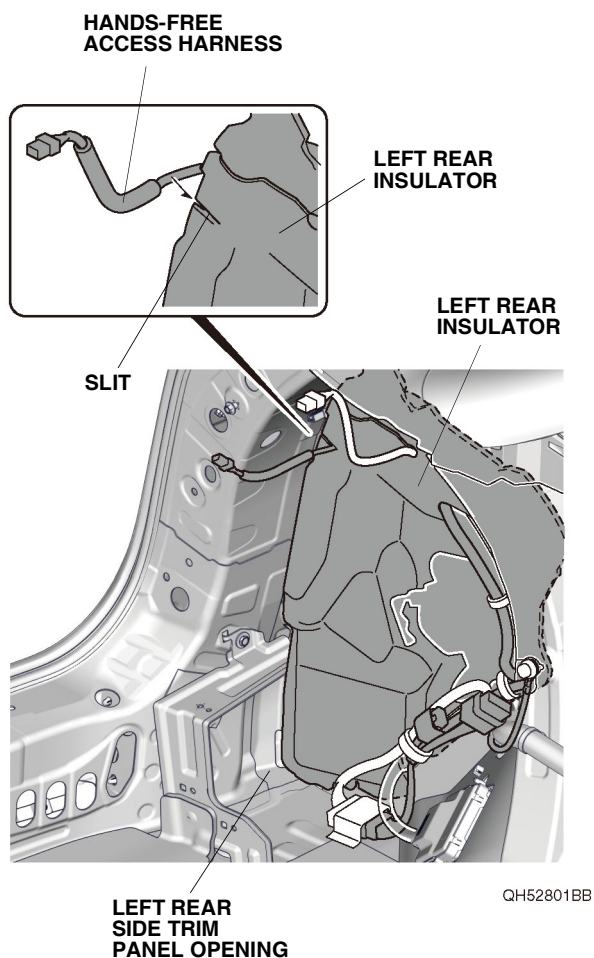

38. Bring the left rear side trim panel into position. Plug the hands-free access harness 3-pin connector into the switch. Install the left rear side trim panel.

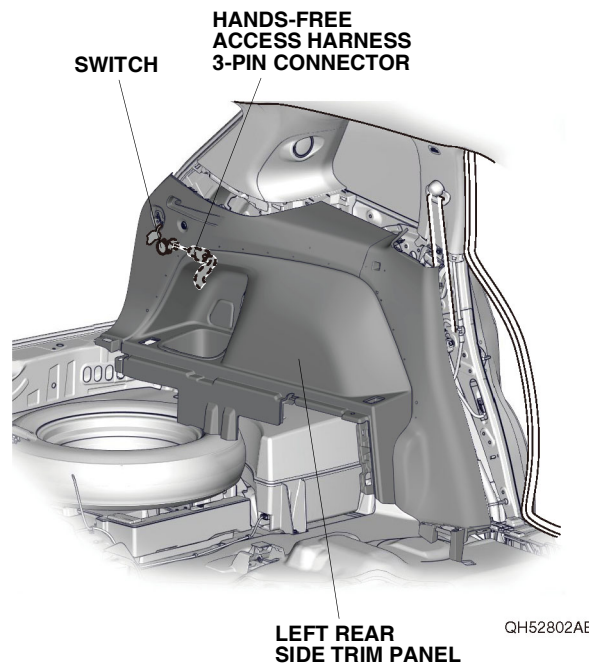

If the vehicle is equipped with the accessory trailer hitch, go to step 40; otherwise, continue with step 39.

Without accessory trailer hitch

39. Install the hands-free access unit to the rear bumper with four clips and four self-tapping screws. Go to step 44.

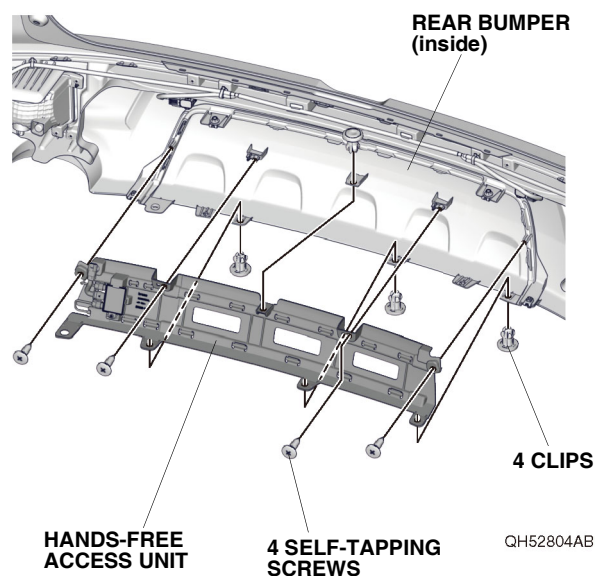

With accessory trailer hitch

40. Release the two sensor bars on the hands-free access unit.

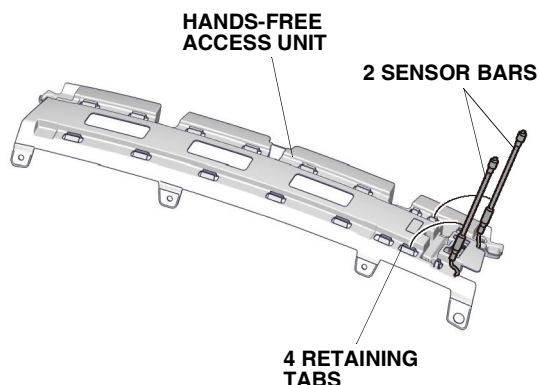

QH52302AX

41. While wearing eye protection, use an air saw to cut the hands-free access unit along the scribe line. Remove any burrs.
NOTE: Be careful not to cut the sensor bars. If sensor bars are damaged, they must be replaced.

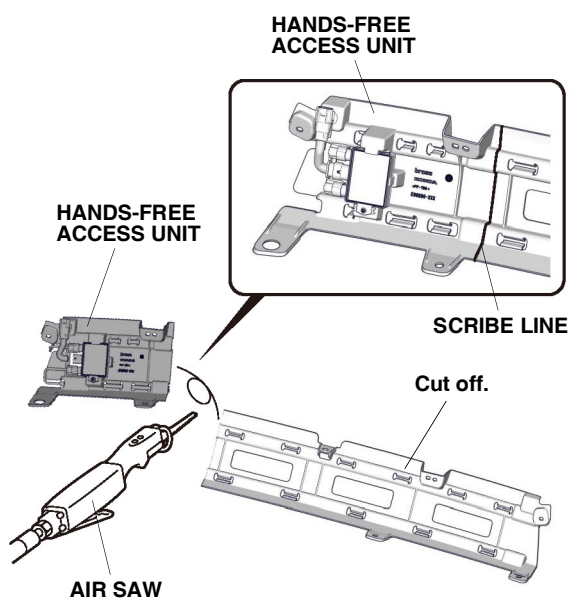

QH52303AX

42. Install the two sensor bars to the hands-free access unit. Make sure the sensor bars are positioned properly.

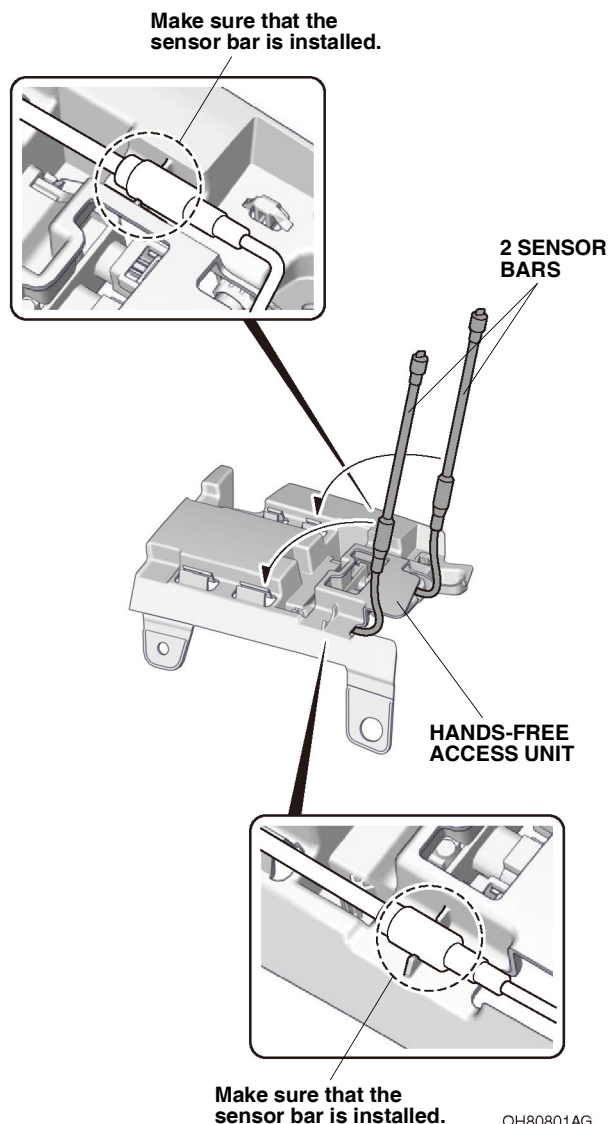

QH80801AG

43. Install the hands-free access unit to the rear bumper with two self-tapping screws and one clip.

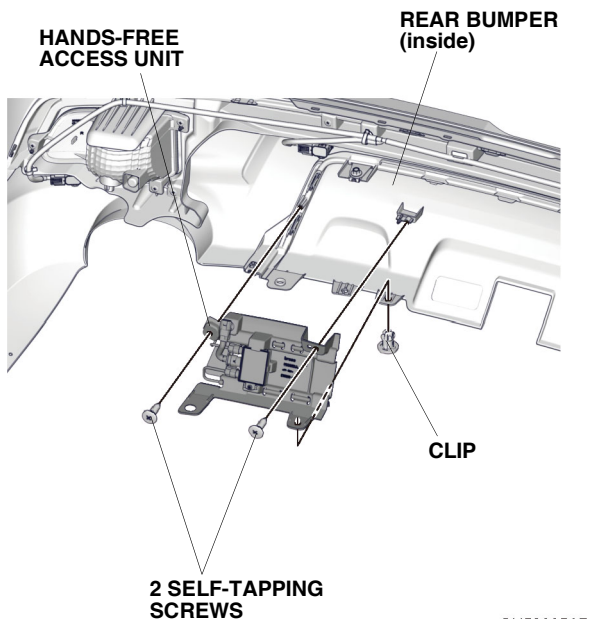

QH52805AB

If the vehicle is equipped with the other harness, go to step 46; otherwise, continue with step 44.

Without other harness

44. Plug the subharness 3-pin connector into the hands-free access unit 3-pin connector.

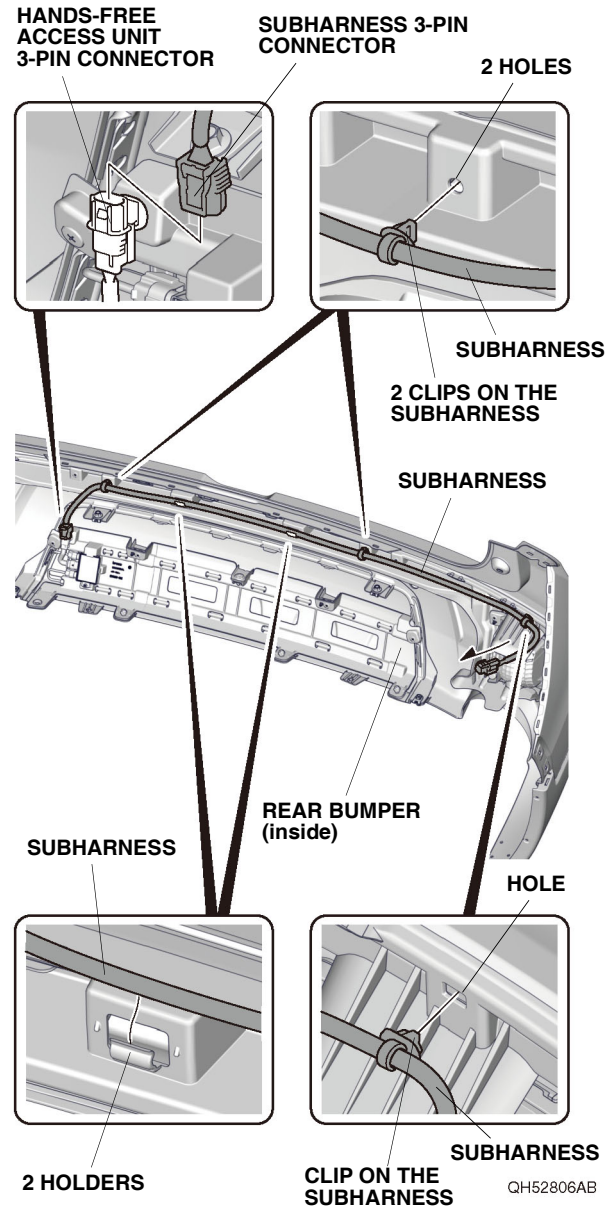

QH52806AB

45. Route the subharness, and secure it to the rear bumper with three clips on the subharness and two holders as shown. Go to step 49.

With other harness

46. Using diagonal cutters, cut off the three clips on the subharness as shown.

NOTE: Be careful not to damage the subharness.

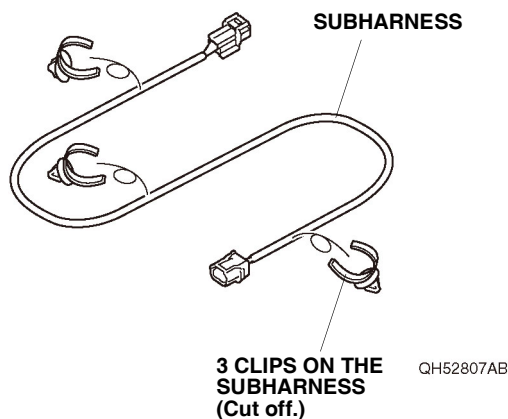

47. Plug the subharness 3-pin connector to the hands-free access unit 3-pin connector.

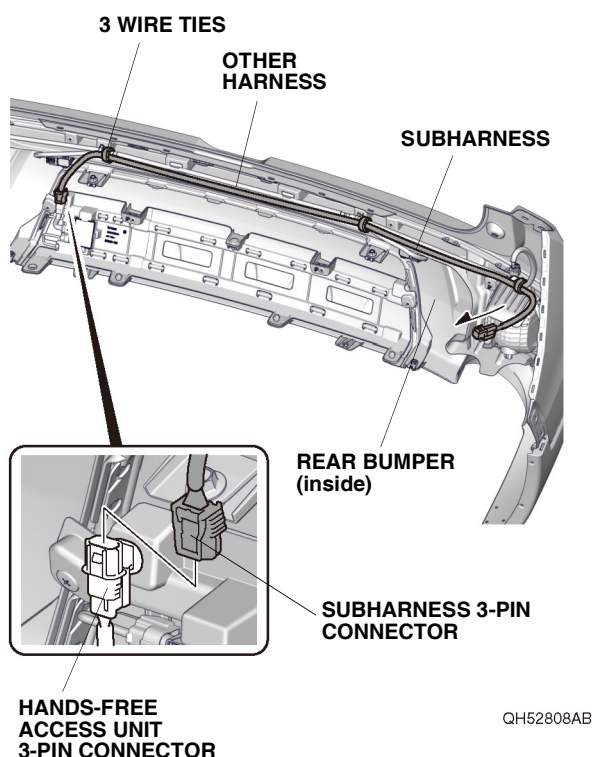

48. Route the subharness along the other harness, and secure it to the other harness with three wire ties as shown.

49. With the help of an assistant, bring the rear bumper close to the vehicle, and plug the subharness 4-pin connector into the hands-free access harness 4-pin connector. If the vehicle is equipped with the accessory rear welcome lights or accessory backup sensors, remove the dummy connector from the accessory rear welcome light harness 4-pin connector or accessory backup sensor harness 4-pin connector. Plug the subharness 4-pin connector into that connector. Install the rear bumper.

WITH ACCESSORY REAR WELCOME LIGHTS OR ACCESSORY BACKUP SENSORS

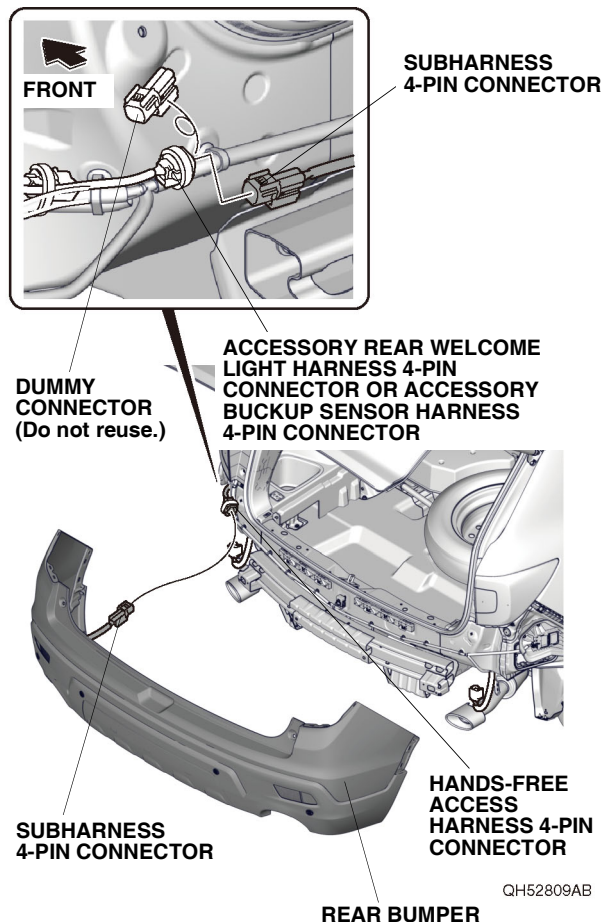

50. Check that all wire harnesses are routed properly and all connectors are plugged in.
51. Install all removed parts except for the front bulkhead cover and the intake air tube.
52. Connect the negative cable to the battery.
53. Install the front bulkhead cover and the intake air tube.
54. Press and hold the audio unit power button for 2 seconds to restore the audio and navi (if equipped) system functions.
55. Set the clock on vehicles without navigation.
56. Using a clean shop towel with soap and water, thoroughly clean the tailgate where the label A will attach. Then, dry the area with a clean towel.

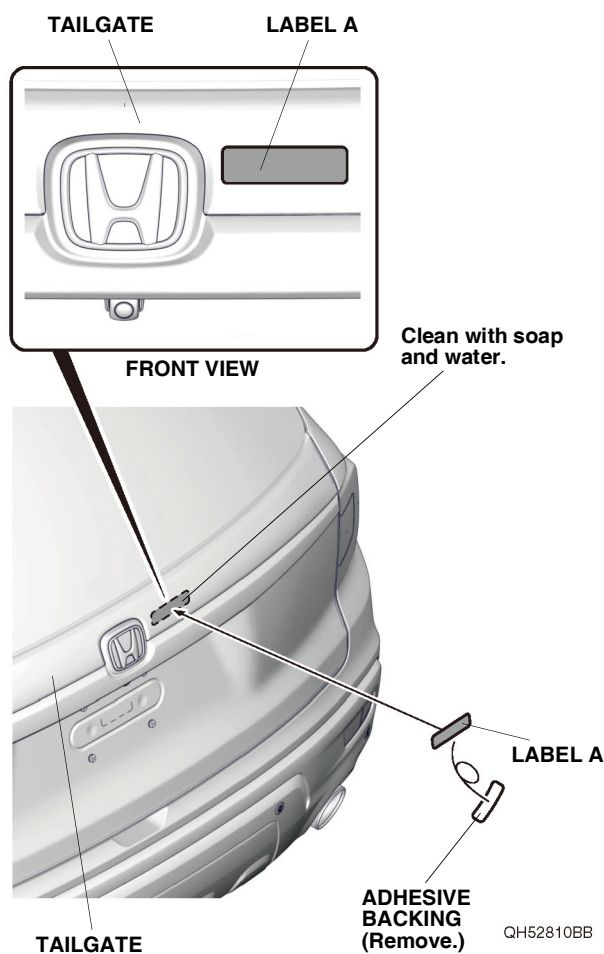

57. Remove the adhesive backing from the label A, and attach the label A to the tailgate as shown.
NOTE: Make sure the customer is aware the label A can be removed after reading.

If the vehicle is equipped with the accessory trailer hitch, continue with 58; otherwise, go to step 60.

With accessory trailer hitch

58. Using isopropyl alcohol on a shop towel, thoroughly clean the rear bumper where the label B will attach.

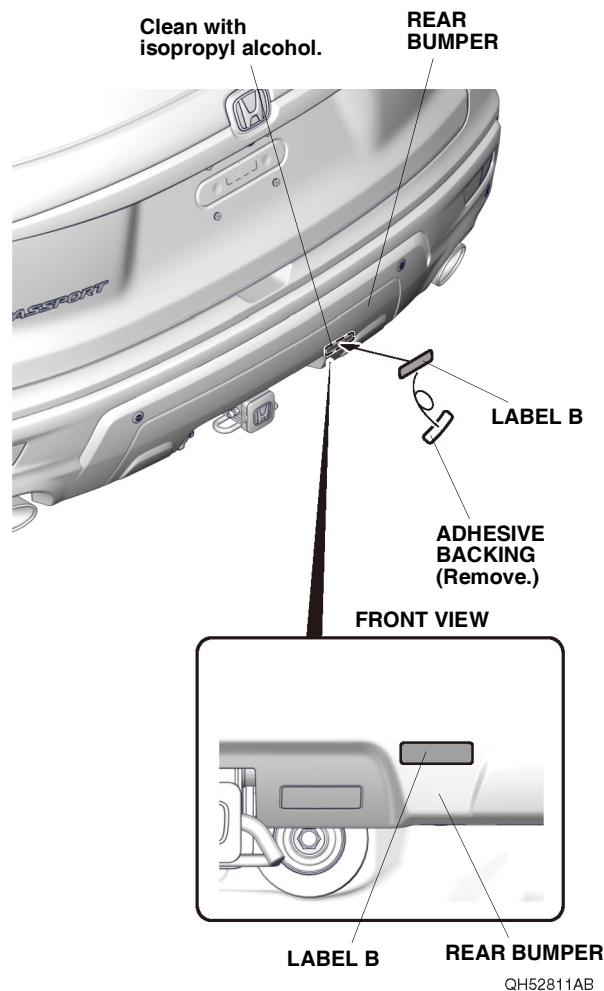

59. Remove the adhesive backing from the label B, and attach the label B to the rear bumper as shown.
NOTE: Make sure the customer is aware that label B can be removed after reading.

Check the Operation of the Hands-Free Access Power Tailgate

60. Make sure that the hands-free access power tailgate works as described in the Accessory User's Information Manual supplied with the hands-free access power tailgate unit kit.