



INSTALLATION INSTRUCTIONS

Accessory
20" ALUMINUM WHEEL
P/N 08W20-TGS-101

Application
2021 PASSPORT

Publications No.
VERSION 1
Issue Date
SEP 2020

PARTS LIST

Aluminum wheel
(The illustration may differ from the actual wheel.)



Wheel center cap
(The illustration may differ from the actual center cap.)



Wheel cleaning information
(Make sure your customer receives this information.)

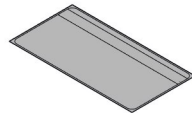

Parts for TPMS sensor assembly

Tire pressure sensor assembly



Washer



Valve nut

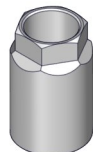

TOOLS AND SUPPLIES REQUIRED

Ratchet
11 mm and 19 mm Sockets
Torque wrench
Isopropyl alcohol
Shop towel

SPECIFICATIONS

Rim size	20 x 8.5 J (inset 55)	
Tire size	265/45R20 104H	
Bolt hole PCD	120 (5 holes)	
Tire pressure (265/45R20 104H)	Front	37 psi (255 kPa)
	Rear	37 psi (255 kPa)

INSTALLATION

Customer Information: The information in this installation instruction is intended for use only by skilled technicians who have the proper tools, equipment, and training to correctly and safely add equipment to your vehicle. These procedures should not be attempted by "do-it-yourselfers."

NOTE:

- This aluminum wheel is designed for use on a vehicle equipped with a tire pressure monitoring system (TPMS).
- This aluminum wheel is equipped with a tire pressure sensor. See the service information for the tire replacement and sensor installation procedures.
- The illustrations of the aluminum wheels are shown for reference purposes only.
- Install the correct size tire.
- Follow the instructions in the online owner's manual when raising the vehicle, and when removing and installing the wheels. Do not overtighten the wheel nuts.
Wheel nut torque: 94 lb-ft (127 N·m).
- Use a tire changer to install and remove the tires per the directions in the Operation Manual furnished with the tire changer. Do not use a tire lever to install and remove the tires as it may cause damage to the tire and aluminum wheel.

1. Before installing the tire pressure sensor, clean the mating surface on the sensor and the aluminum wheel.

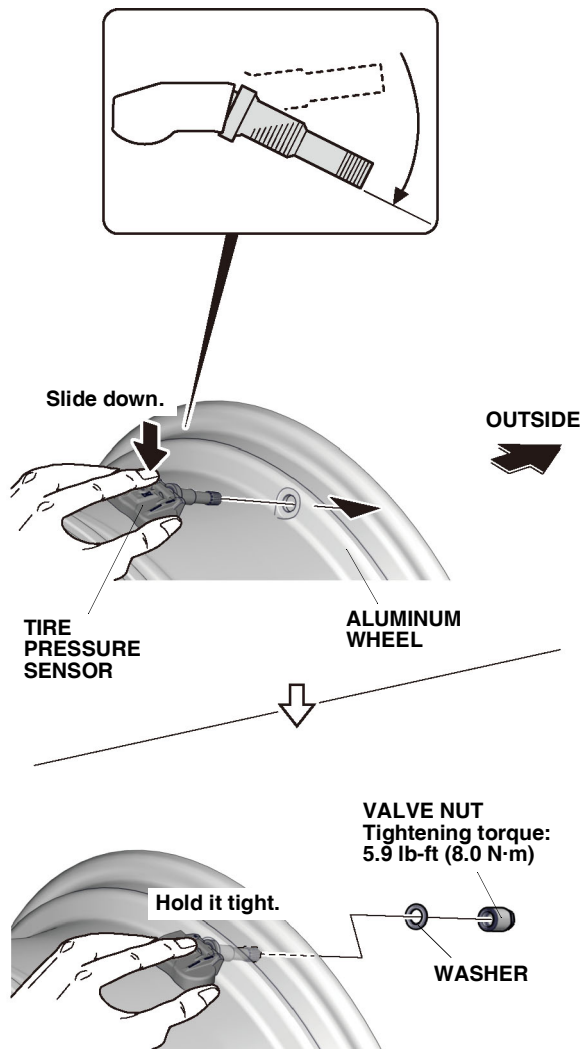

QC02312AA

NOTE:

- Check the grommet on the tire pressure sensor to make sure it is seated properly.
- Make sure the valve stem does not protrude into the sensor housing surface.
- To prevent the sensor housing from getting caught on the bead of the tire, install the tire pressure sensor so the sensor housing does not protrude into the bead area of the wheel.
- Do not reuse a grommet that had been tightened, even one time, to the specified torque, as it is deformed inside.
- Do not use pneumatic or electric tools on the valve nut.
- Tightening the nut above the specified torque can damage the grommet.

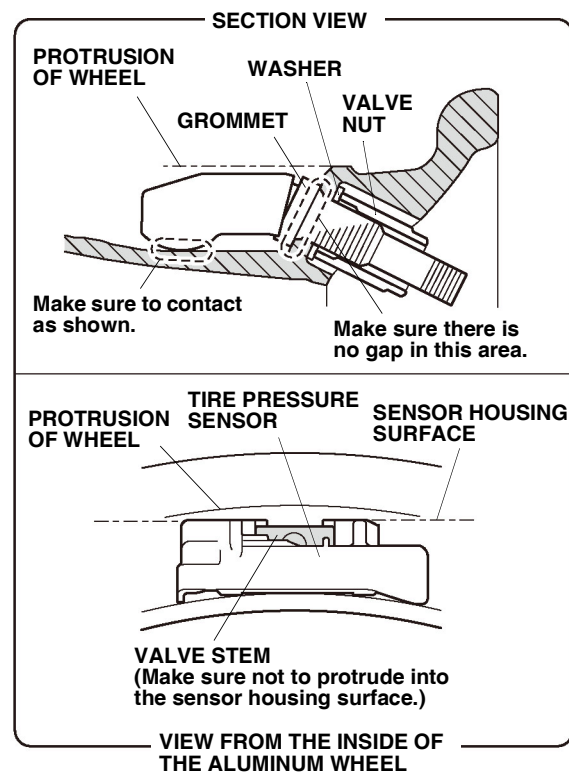

930404BR

2. Install the tire pressure sensor and the washer on the aluminum wheel, and tighten the valve nut by hand. Make sure the pressure sensor is resting on the wheel.
3. While holding the tire pressure sensor against the wheel, tighten the valve nut to the specified torque. Tightening torque: 5.9 lb-ft (8.0 N·m)

4. Install the tires according to the instructions in the Service Manual.
5. Install the wheels on the vehicle and torque to 94 lb-ft (127 N·m).
6. Drive the vehicle for at least 40 seconds at a speed of 15 mph (24 km/h) or more, and all sensor IDs will be memorized automatically.

USE AND CARE

- Use a neutral detergent to clean the wheels.
- Rinse off the neutral detergent promptly after cleaning the wheels.