

# Germain Honda of College Hills



## HONDA INSTALLATION INSTRUCTIONS

### Accessory

TRAILER HARNESS  
P/N 08L91-THR-100

### Application

2023 ODYSSEY

### Publications No.

VERSION 1

### Issue Date

MAR 2022

## PARTS LIST

Control unit harness

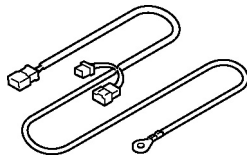

Socket harness

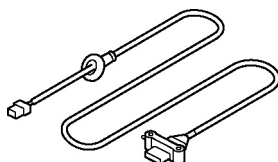

Control unit

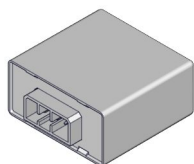

2 Fuses, 7.5A

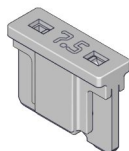

30A Fuse block

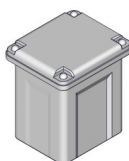

9 Wire ties



2 Flange bolts



5 Wire ties with clip

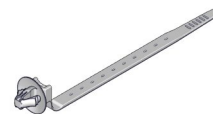

Urethane tape

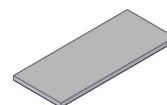

Aluminum tape

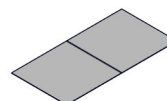

English fuse label  
(May not be used)

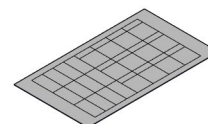

ISO Fuse label  
(May not be used)

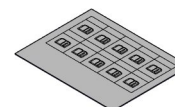

# Germain Honda of College Hills

Accessory User's Information Manual

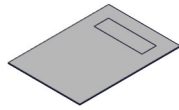

## TOOLS AND SUPPLIES REQUIRED

10 mm Open end wrench  
Ratchet  
Phillips screwdriver  
10 mm Socket  
Scissors  
Diagonal cutters  
Isopropyl alcohol  
Shop towel  
Masking tape  
5 mm Hex wrench  
Blanket

*The following tools are available through the Honda Tool and Equipment Program. On the iN, click on Service > Service Bay > Tool and Equipment Program, then enter the number under "Search." Or, call 888-424-6857.*

- Trim Tool Set (T/N SOJATP2014)
- Plastic Trim Tool (T/N SILTRIMTL10)

## Illustration of the Trailer Harness Installed on the Vehicle

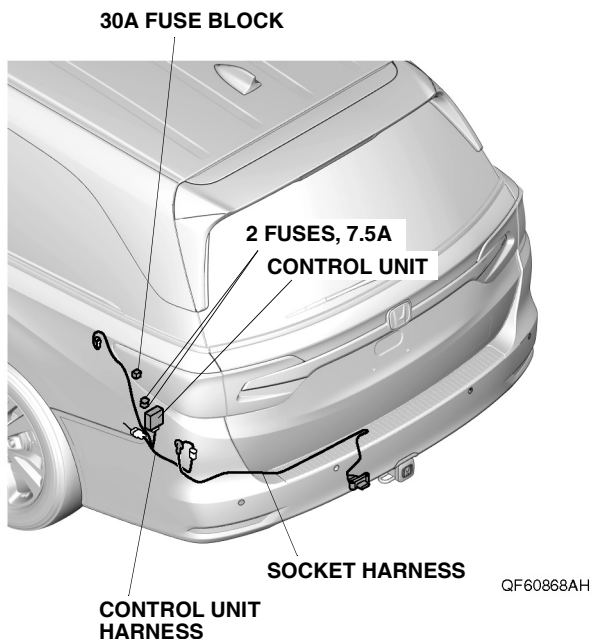

## INSTALLATION

**Customer Information:** The information in this installation instruction is intended for use only by skilled technicians who have the proper tools, equipment, and training to correctly and safely add equipment to your vehicle. These procedures should not be attempted by "do-it-yourselfers."

1. Disconnect the negative cable from the battery:
  - Wrap a shop towel around the hood latch.

HOOD LATCH  
(Wrap with a shop towel.)

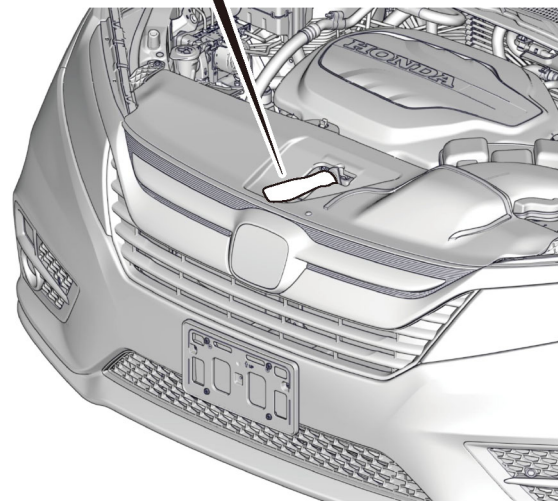
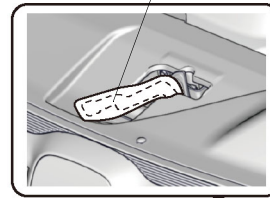

QF52702AG

# Germain Honda of College Hills

- Remove the front bulkhead cover.

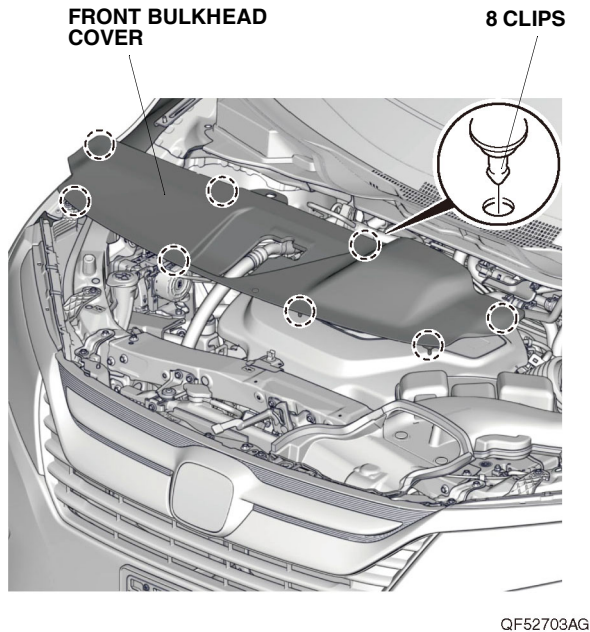

- Remove the intake air tube.
- Disconnect the negative cable from the battery.

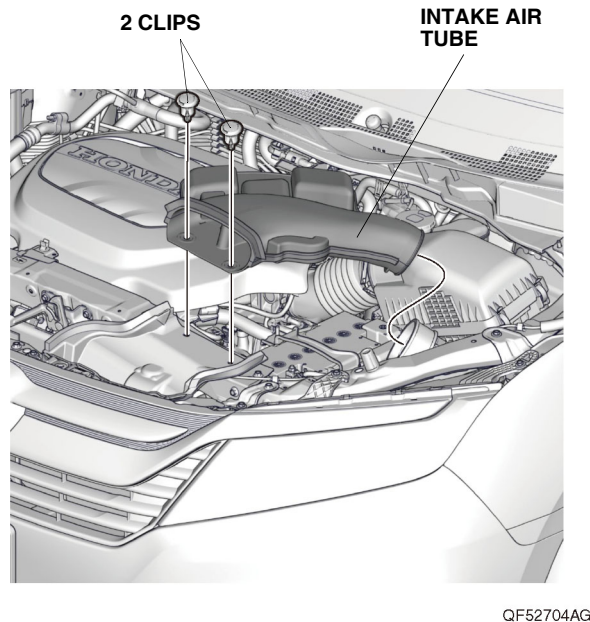

- Remove the left rear door sill trim.

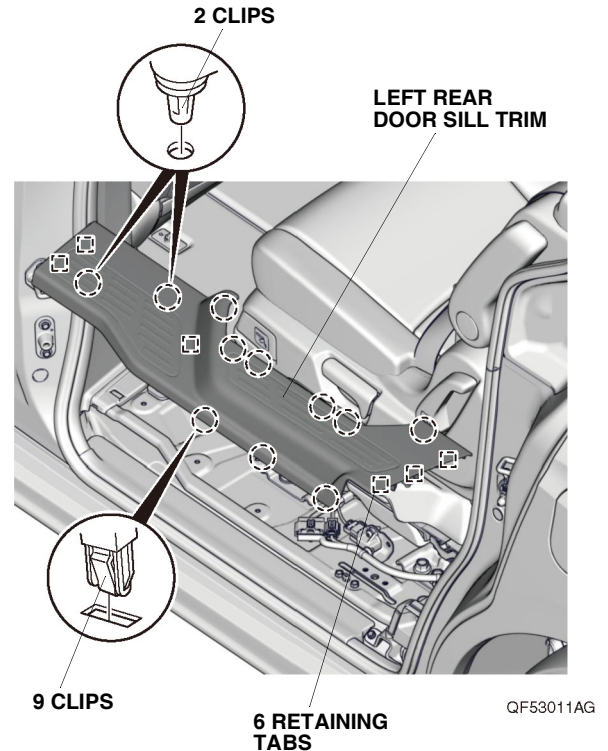

- Remove the rear trim panel.

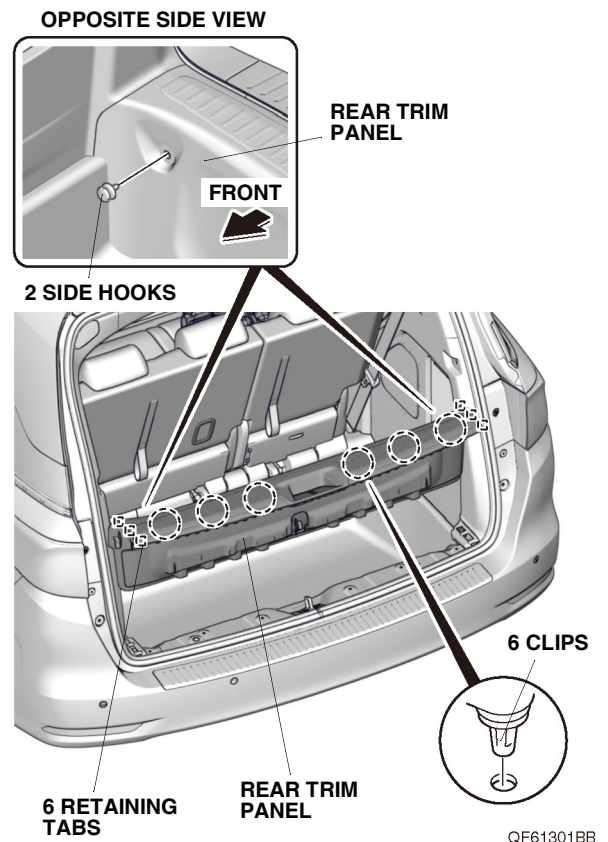

# Germain Honda of College Hills

4. Stow the third row seats.

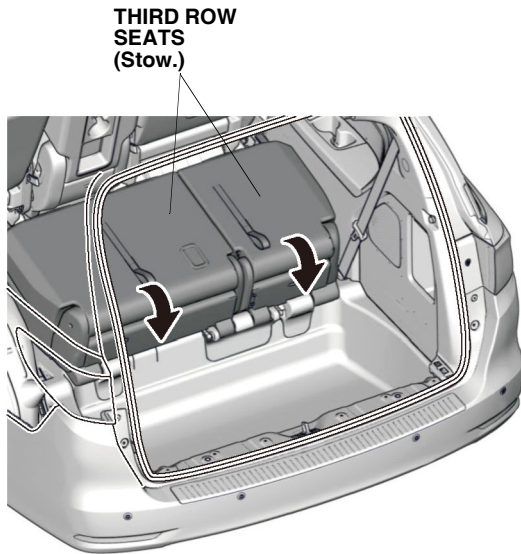

QF60203AG

5. Apply masking tape to the left C-pillar trim and left D-pillar trim as shown.

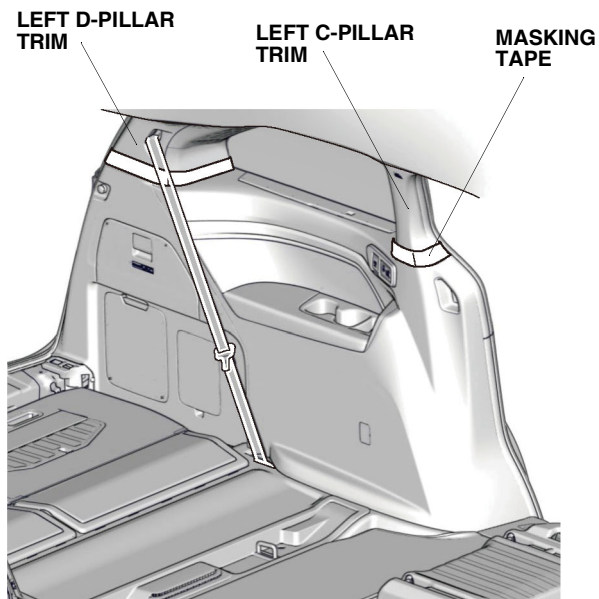

QG21501AN

6. Using the plastic trim tool, open the two covers and remove the two self-tapping screws.

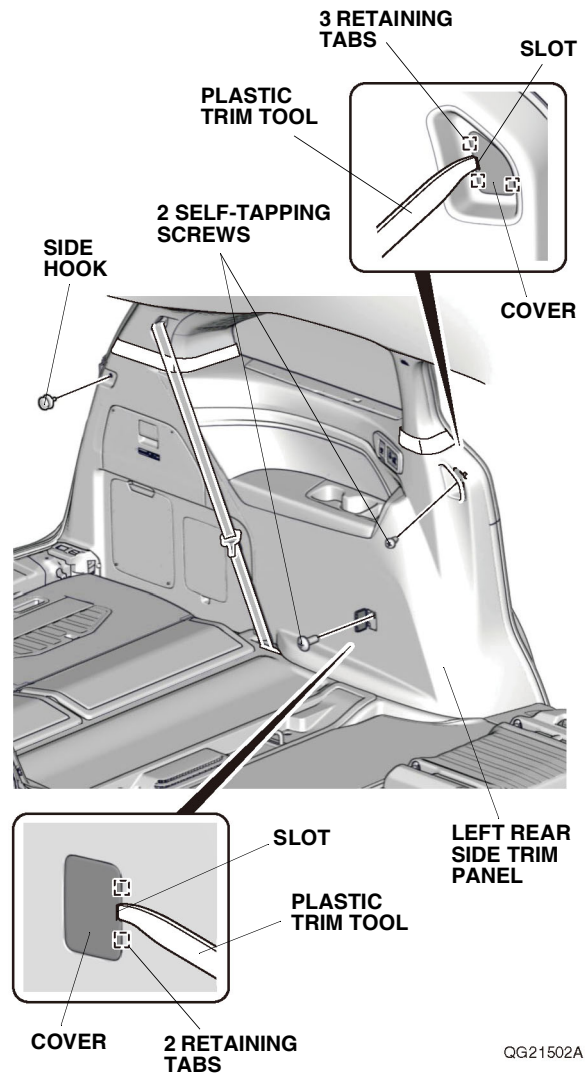

QG21502AN

7. Remove the side hook from the left rear side trim panel.



# Germain Honda of College Hills

8. Pull away the door opening seal and weatherstrip from around the left rear side trim panel. Remove the left rear side trim panel, and unplug the vehicle connectors (if equipped).

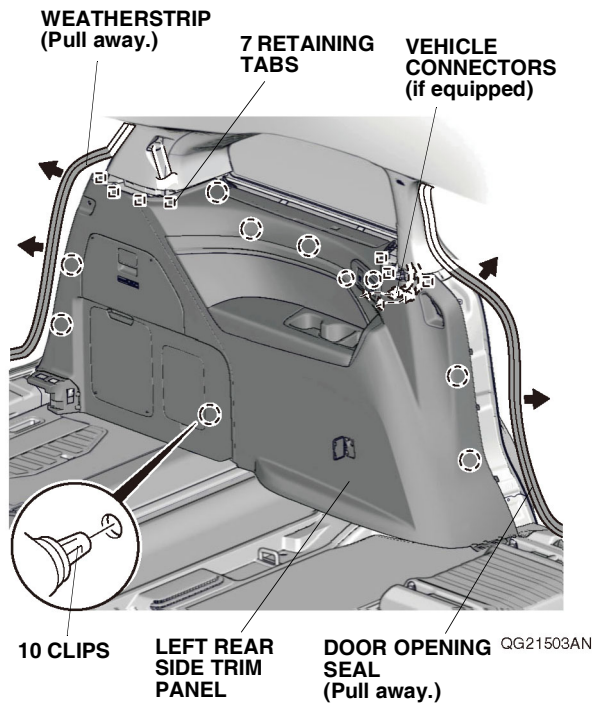

9. Remove the rear bumper:
- Apply masking tape as shown.

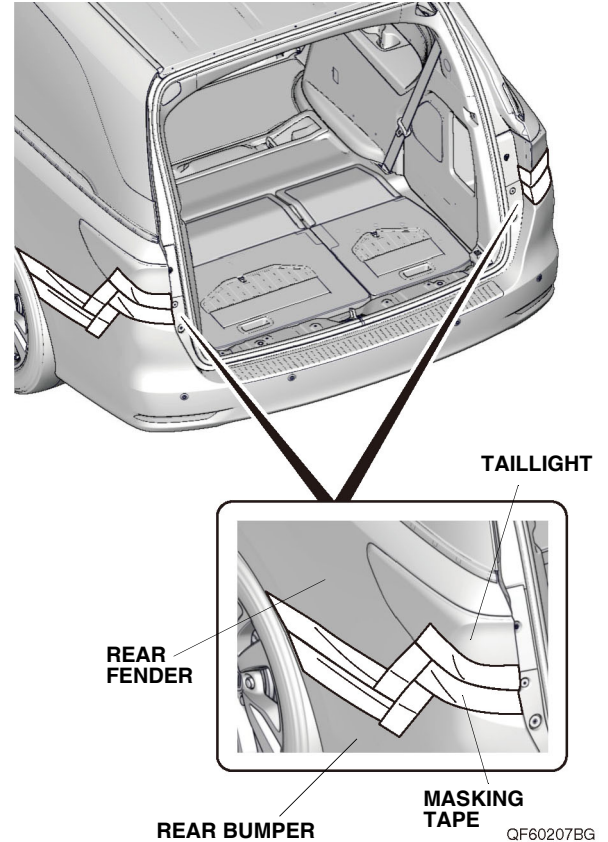

# Germain Honda of College Hills

- Remove the six self-tapping screws, six clips, two large hex bolts, and two small hex bolts as shown.

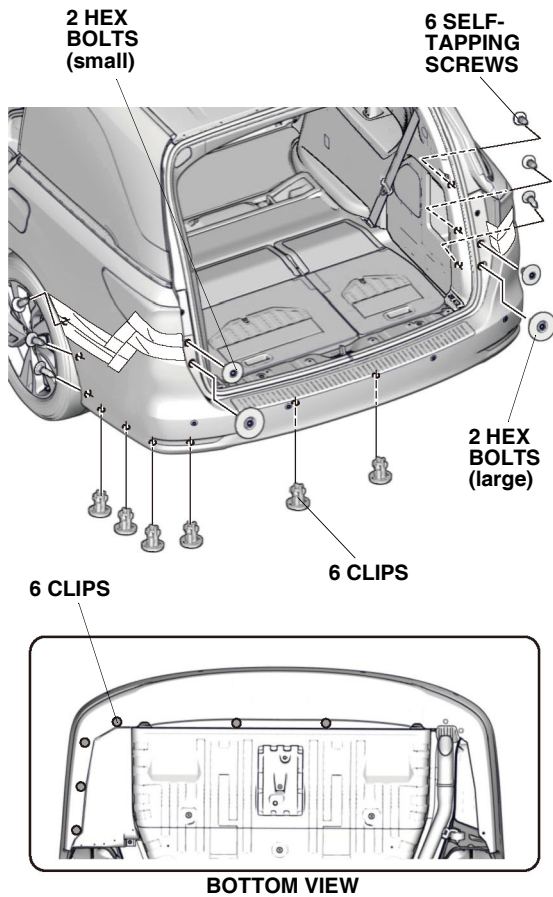

QF60208BG

- With the help of an assistant, release the nine retaining tabs on each side.

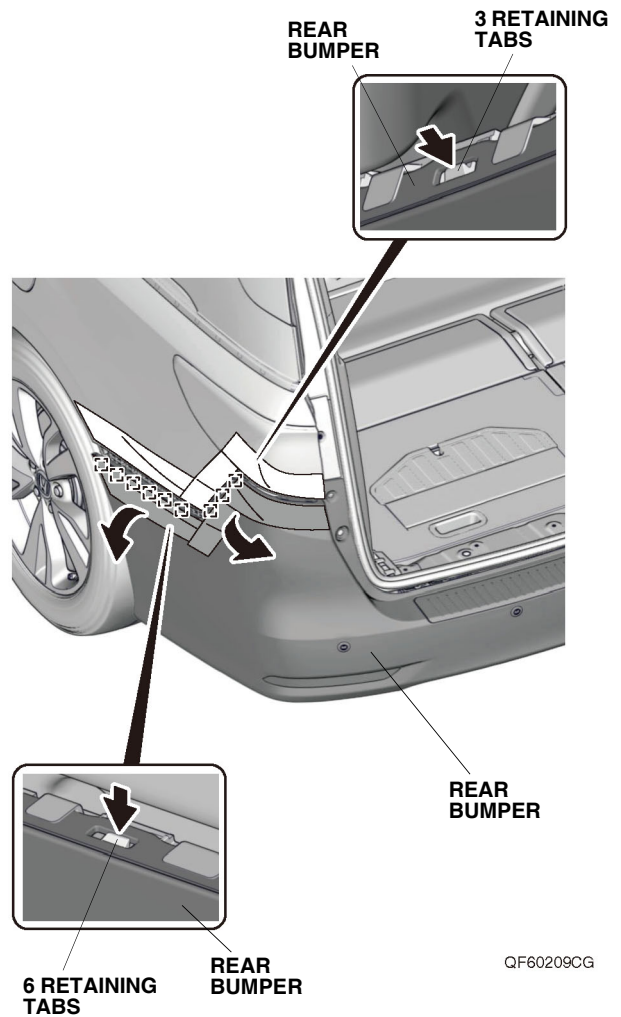

QF60209CG

# Germain Honda of College Hills

- With the help of an assistant, remove the rear bumper and unplug the vehicle connectors (if equipped).
- Place the rear bumper on a blanket.

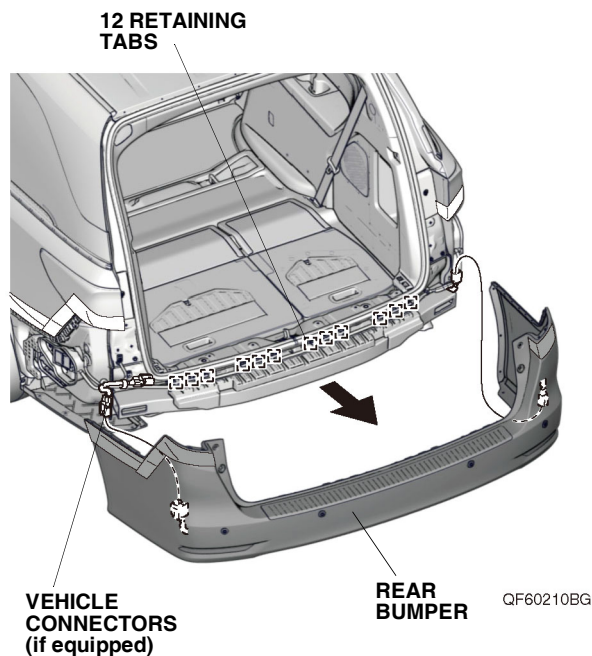

10. Install the control unit to the vehicle bracket.

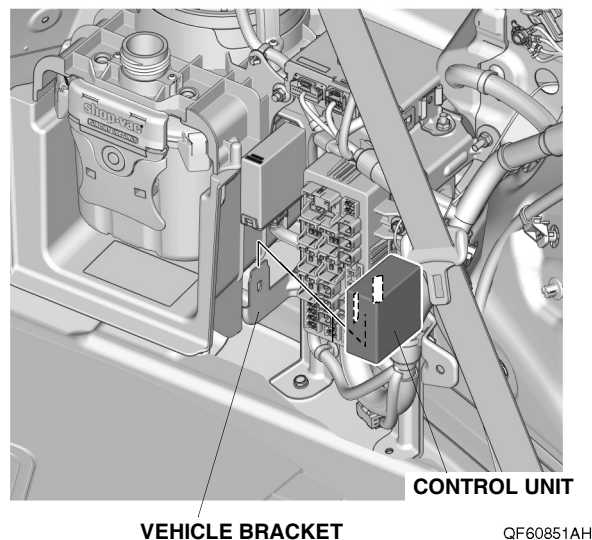

11. Remove the tape from the vehicle 6-pin connector and plug the vehicle 6-pin connector into the control unit harness 6-pin connector. Plug the control unit harness 12-pin connector into the control unit.

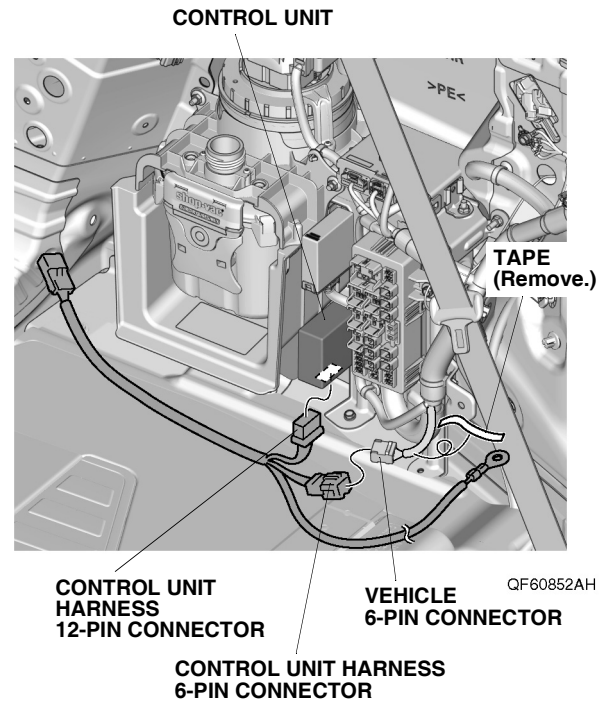

12. Remove the vehicle ground bolt, and install the control unit harness ground terminal with vehicle ground bolt as shown. Do not put the ground terminal calking on top of one another.

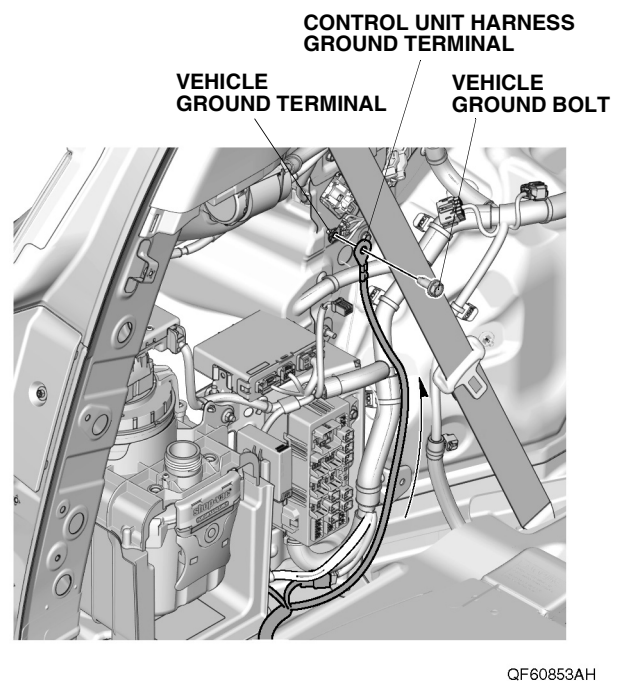

# Germain Honda of College Hills

**If the vehicle is equipped with vacuum cleaner, continue with step 13. If not, go to step 16.**

### With Vacuum Cleaner

13. Route the control unit harness behind the vacuum cleaner as shown.

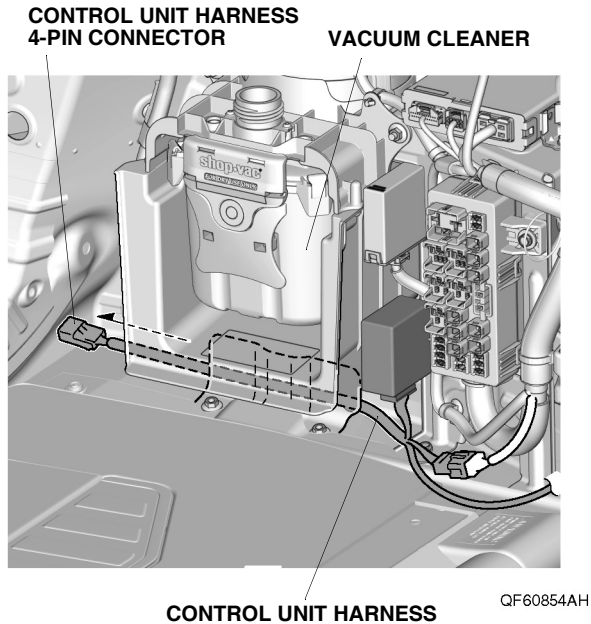

14. Line up the control unit harness 4-pin connector with the vehicle clip and secure the control unit harness 4-pin connector to the vehicle harness with one wire tie.

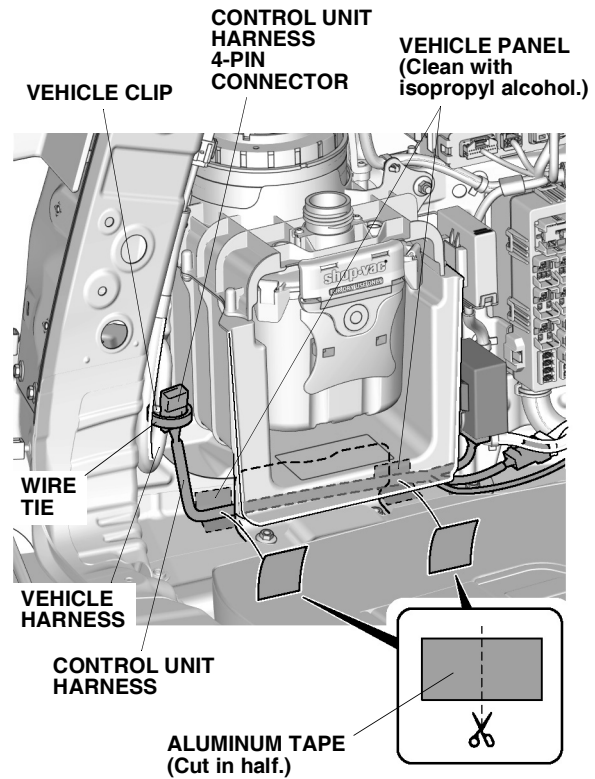

15. Using isopropyl alcohol on a shop towel, thoroughly clean the vehicle panel where the aluminum tape will attach. Using scissors, cut one aluminum tape in half. Secure the control unit harness to the vehicle panel with the two halves of aluminum tape. Go to step 18.



# Germain Honda of College Hills

## Without Vacuum Cleaner

16. Line up the control unit harness 4-pin connector with the vehicle clip and secure the control unit harness 4-pin connector to the vehicle harness with one wire tie.

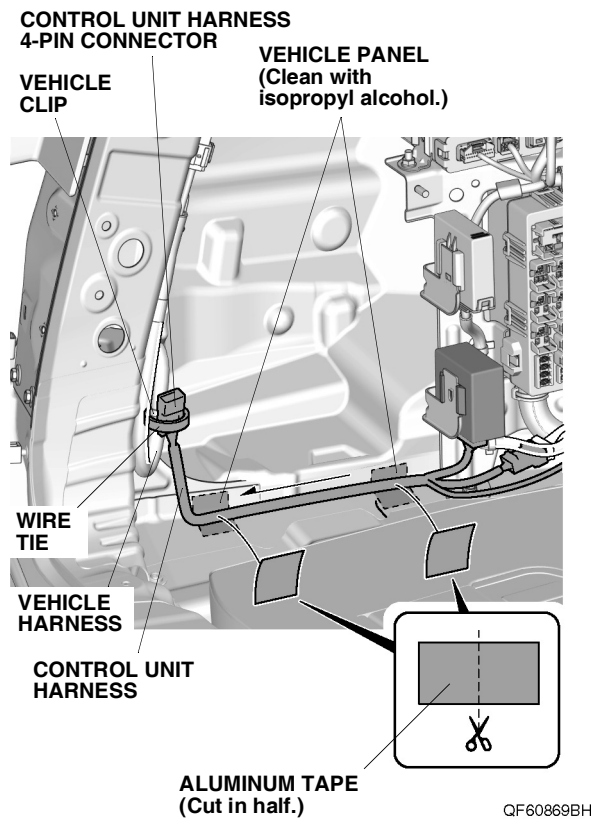

17. Using isopropyl alcohol on a shop towel, thoroughly clean the vehicle panel where the aluminum tape will attach. Using scissors, cut one aluminum tape in half. Secure the control unit harness to the vehicle panel with the two halves of aluminum tape.

18. Using isopropyl alcohol on a shop towel, thoroughly clean the vehicle panel where the urethane tape will attach. Attach the urethane tape to the vehicle panel as shown.

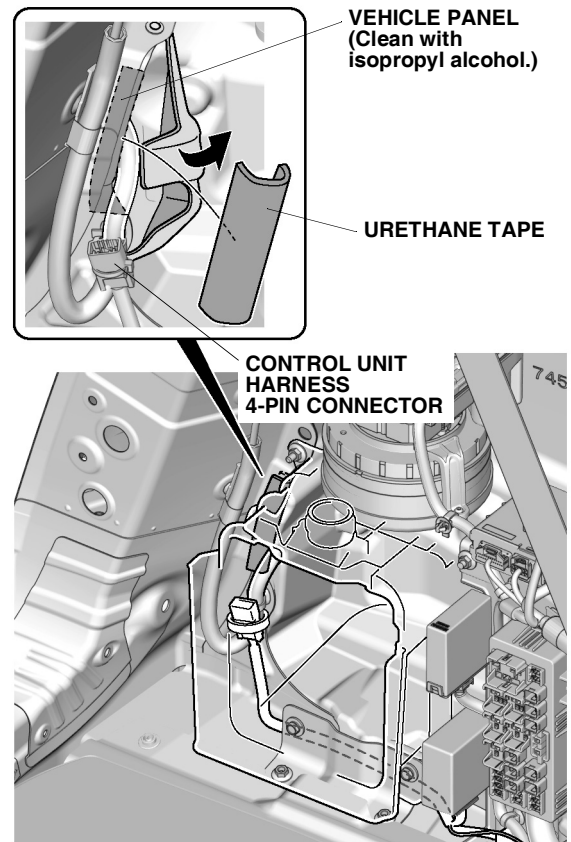

# Germain Honda of College Hills

19. Secure the 6-pin connectors and control unit harness to the vehicle harness with four wire ties.

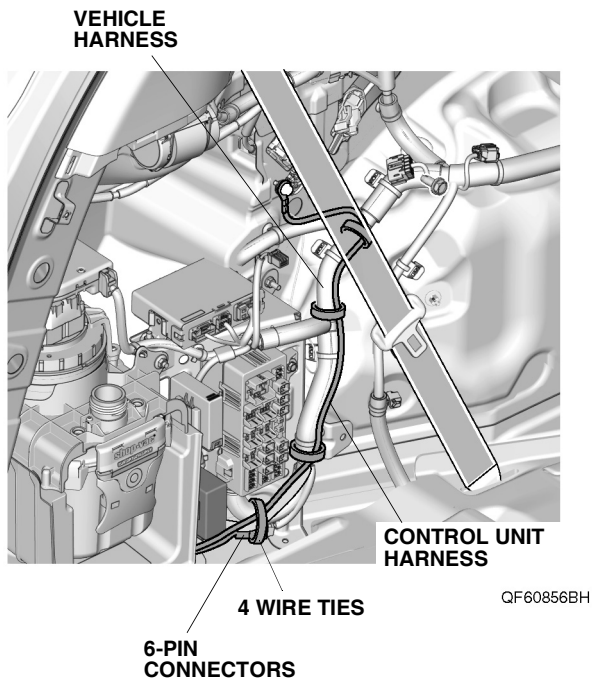

20. Remove the vehicle grommet.

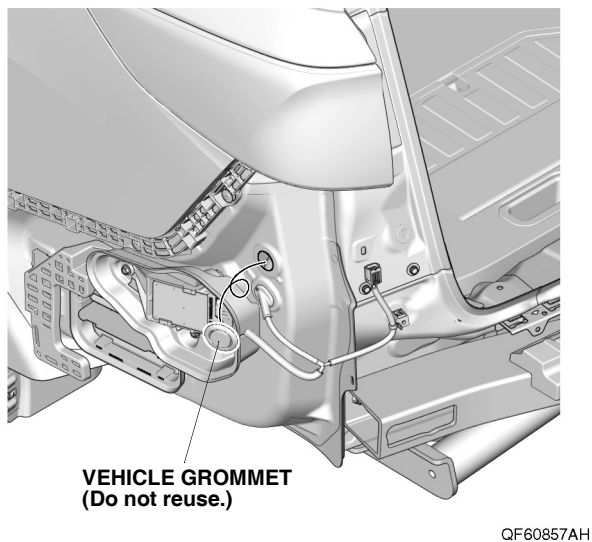

21. Route the socket harness through the vehicle panel hole and secure the grommet on the socket harness into the vehicle panel hole.

**NOTE:**

- Install the socket harness by holding the grommet.
- Make sure to check that the grommet is secured properly.

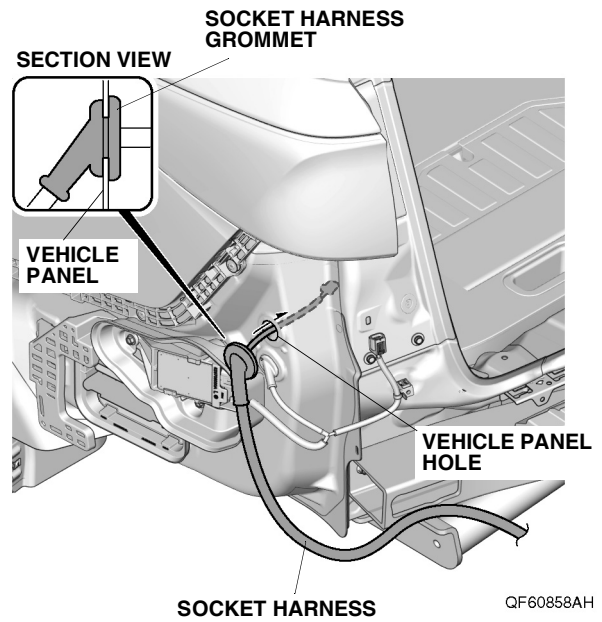

22. Plug the socket harness 4-pin connector into the control unit harness 4-pin connector.

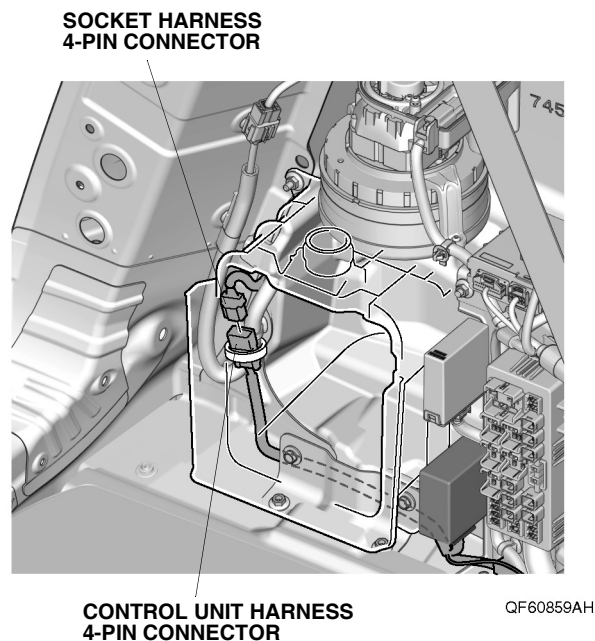

# Germain Honda of College Hills

23. Secure the socket harness to the vehicle harness with three wire ties.

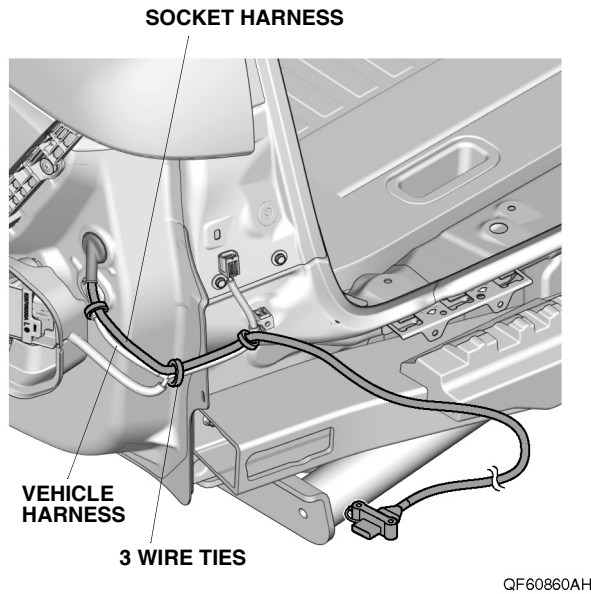

If the vehicle is equipped with vehicle harness, continue with step 24. If not, go to step 26.

## With Vehicle Harness

24. Using diagonal cutters, cut the clip portion off of four wire ties with clip.

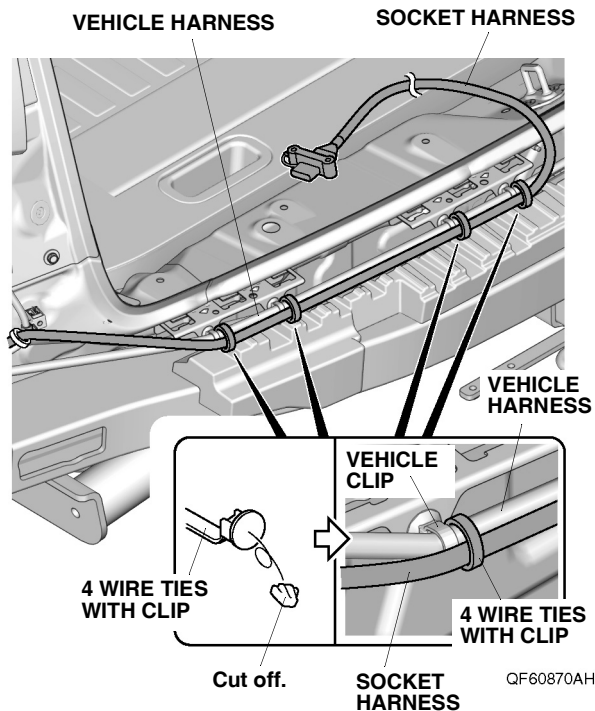

25. Secure the socket harness to the vehicle harness with four wire ties with clip. Go to step 27.

## Without Vehicle Harness

26. Secure the socket harness to the vehicle panel with four wire ties with clip.

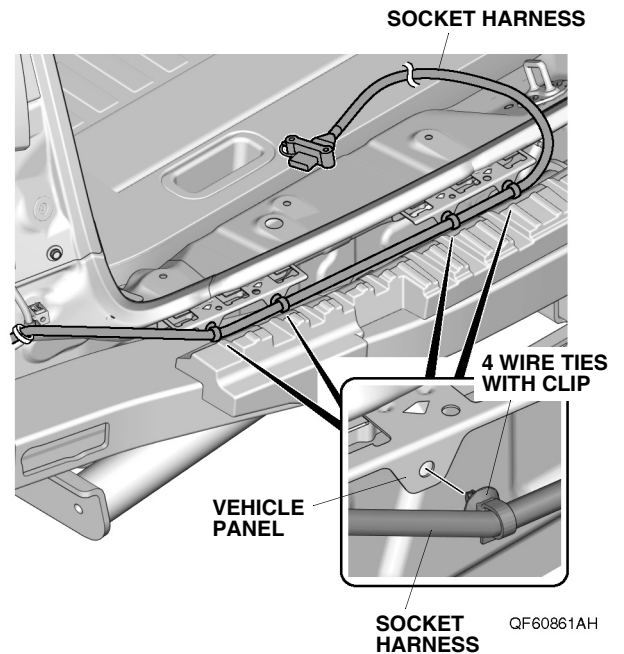

27. Route the socket harness behind the trailer hitch as shown.

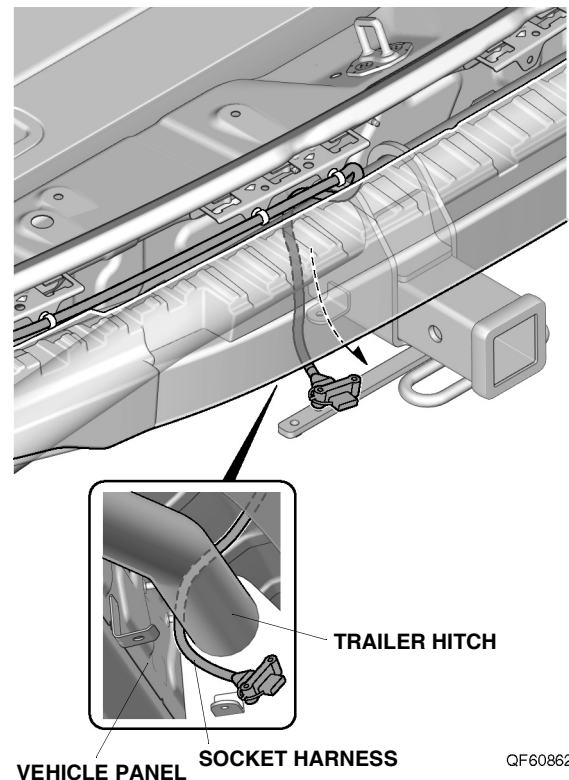

# Germain Honda of College Hills

28. Secure the socket harness 4-pin connector to the trailer hitch with two flange bolts.

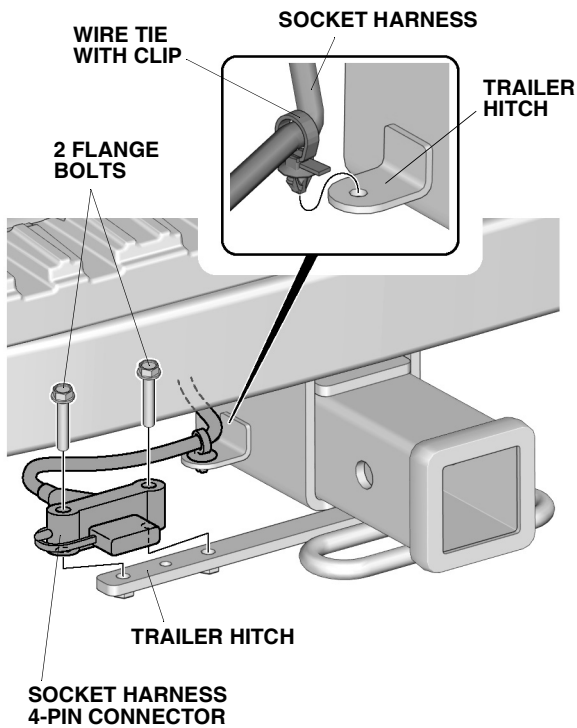

QF60863AH

29. Secure the socket harness to the trailer hitch with one wire tie with clip.

30. Secure the socket harness to the trailer hitch with one wire tie.

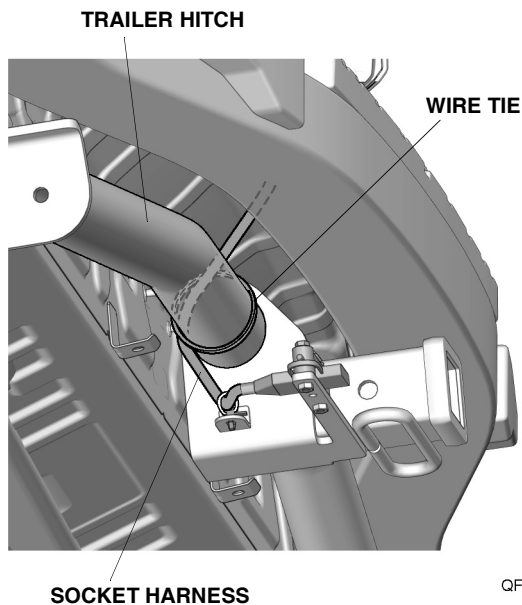

QF60864AH

31. Plug the 30A fuse block and two 7.5A fuses into the rear fuse box.

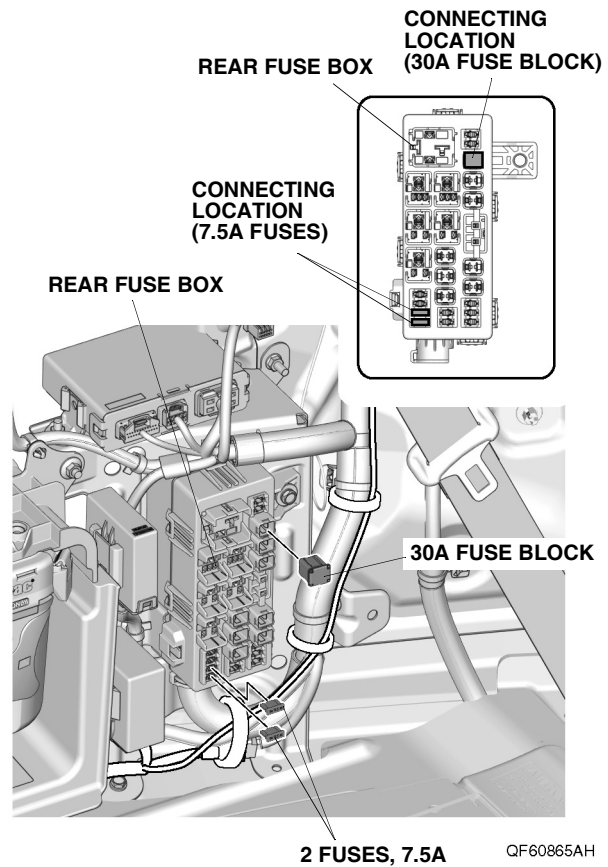

QF60865AH

32. Remove the rear fuse lid from the left rear side trim panel.

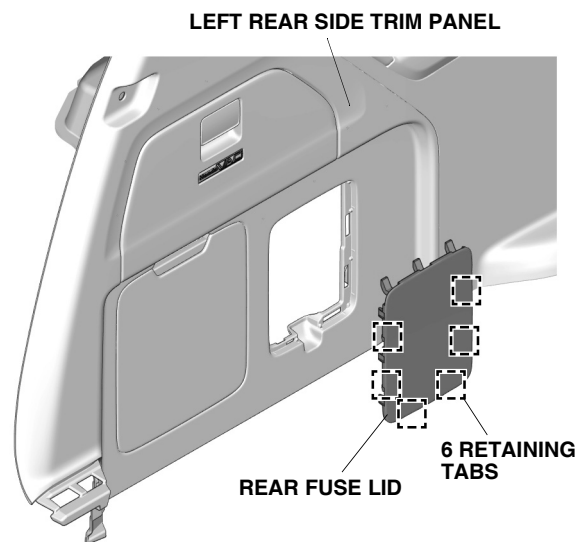

QF60866AH



# Germain Honda of College Hills

33. Using isopropyl alcohol on a shop towel, thoroughly clean the rear fuse lid where the fuse labels will attach. Attach the fuse labels to the rear fuse lid as shown.

For markets with english labels

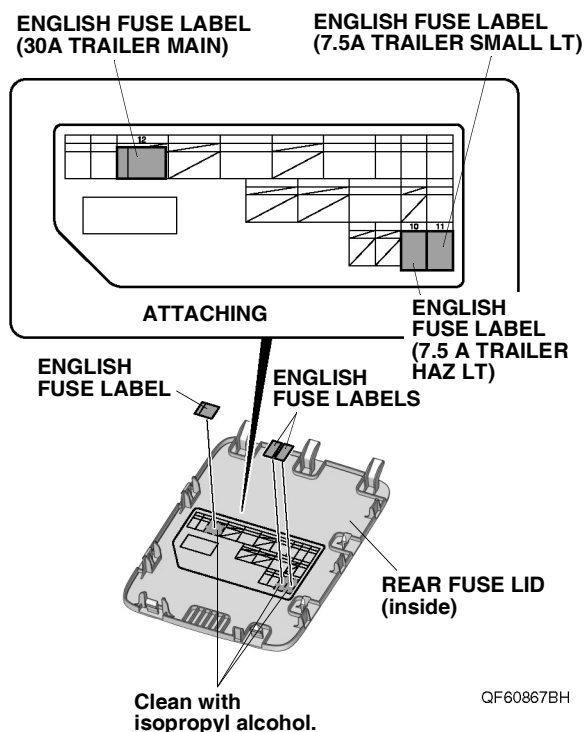

For markets with ISO labels

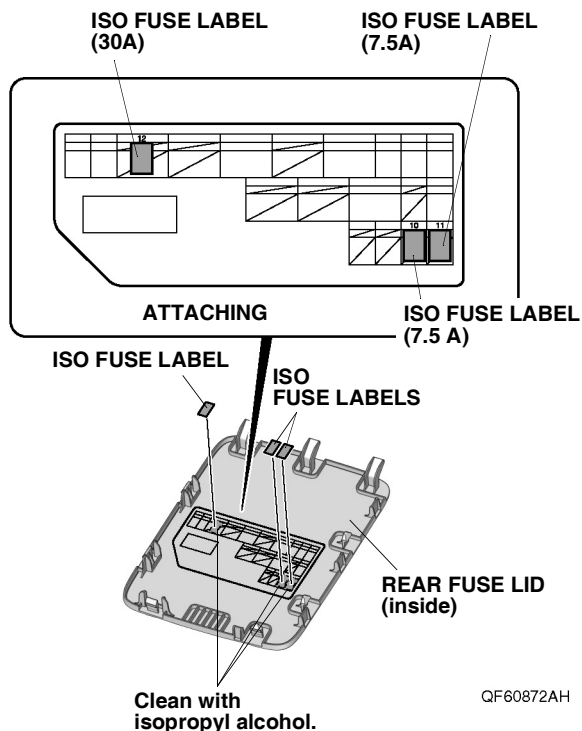

34. Check that all wire harnesses are routed properly and all connectors are plugged in.
35. Install all removed parts except the front bulkhead cover and intake air tube.
36. Connect the negative cable to the battery.
37. Install the front bulkhead cover and intake air tube.
38. Press and hold the audio unit power button for 2 seconds to restore the audio and navi (if equipped) system functions.
39. Set the clock on vehicles without navigation.
40. If necessary, restore the systems back to normal operation as described in the service information.

## Check the Operation of the Trailer Harness

41. Refer to the "TRAILER HARNESS TESTER", and perform the "Trailer Harness Circuit Check".