

Germain Honda of College Hills



INSTALLATION INSTRUCTIONS

Accessory
HANDS-FREE ACCESS POWER
TAILGATE

Application
2023 ODYSSEY

Publications No.
VERSION 1
Issue Date
MAR 2022

PARTS LIST

**Hands-Free Access Power Tailgate Attachment Kit
P/N 08U59-THR-101A**

Hands-Free Access harness

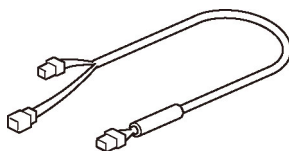

Hands-Free Access ECU harness

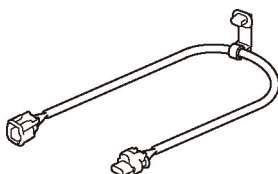

4 Clips



2 Self-tapping screws



8 Wire ties
(Some may not be used)



Urethane tape

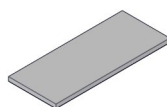

Switch



Switch bracket

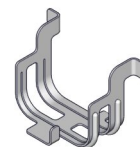

Narrow wire tie



Sticker

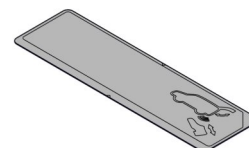

Accessory user's information manual

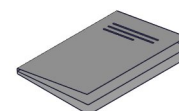

**Hands-Free Access Power Tailgate Unit Kit
P/N 08U59-THR-100**

Hands-Free Access unit



Germain Honda of College Hills

Lower Antenna Kit (With accessory trailer hitch) P/N 08L91-THR-100A

Hands-Free Access ECU

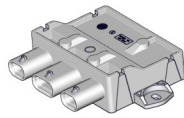

Hands-Free Access lower antenna



Narrow wire tie
(short)



Accessory user's information manual

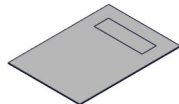

TOOLS AND SUPPLIES REQUIRED

Phillips screwdriver

10 mm Open end wrench

Pushpin

3 mm, 6 mm, 9 mm, and 11 mm Drill bits

Eye protection (face shield, safety goggles, etc.)

File

Masking tape

5 mm Hex wrench

Blanket

Shop towel

26 mm Hole saw

Drill

Stubby Phillips screwdriver

Diagonal cutters

Scissors

T-10 TORX bit

The following tools are available through the Honda Tool and Equipment Program. On the iN, click on Service > Service Bay > Tool and Equipment Program, then enter the number under "Search." Or, call 888-424-6857.

- Trim Tool Set (T/N SOJATP2014)
- Plastic Trim Tool (T/N SILTRIMTL10)

Illustration of the Hands-Free Access Power Tailgate on the Vehicle

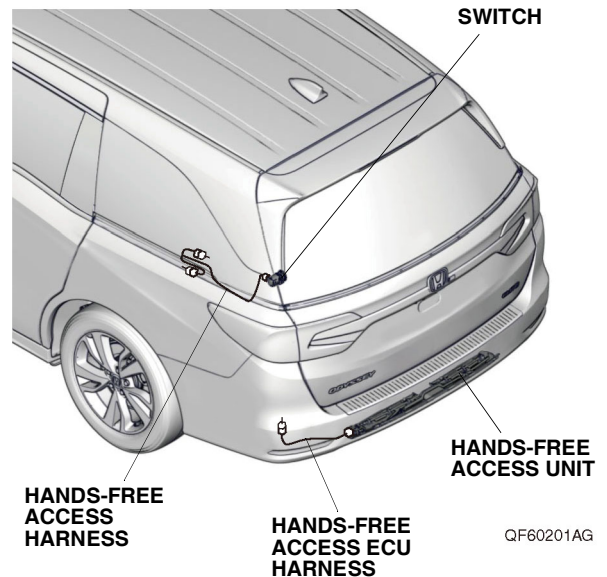

Germain Honda of College Hills

INSTALLATION

Customer Information: The information in this installation instruction is intended for use only by skilled technicians who have the proper tools, equipment, and training to correctly and safely add equipment to your vehicle. These procedures should not be attempted by “do-it-yourselfers.”

NOTE: This accessory cannot be installed with accessory Backup Sensors.

1. Disconnect the negative cable from the battery:
 - Wrap a shop towel around the hood latch.

HOOD LATCH
(Wrap with a shop towel.)

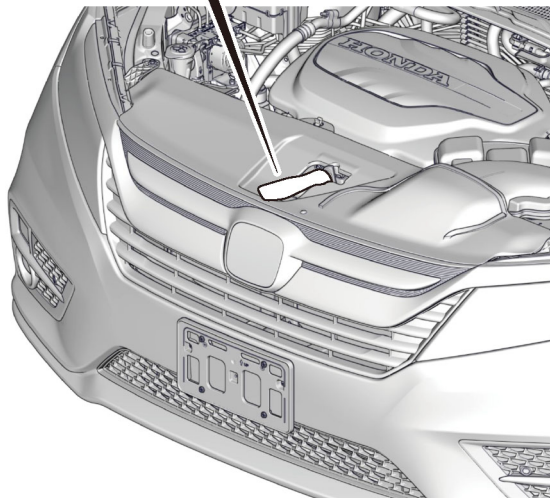
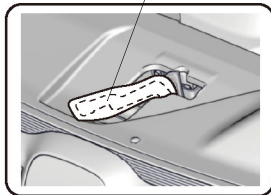

QF52702AG

- Remove the front bulkhead cover.

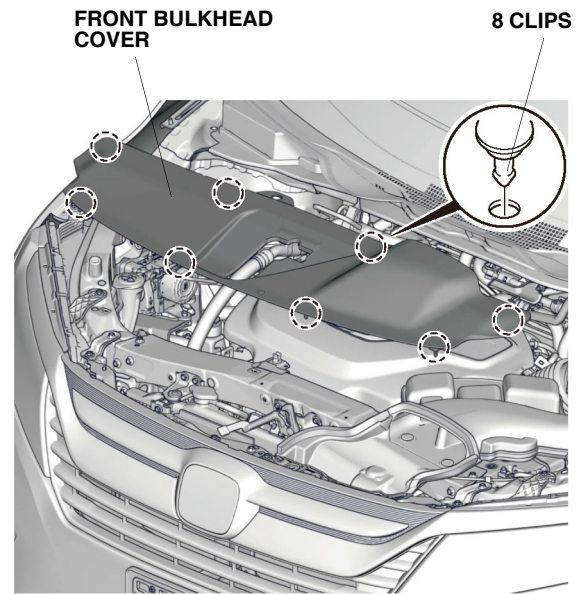

QF52703AG

- Remove the intake air tube.
- Disconnect the negative cable from the battery.

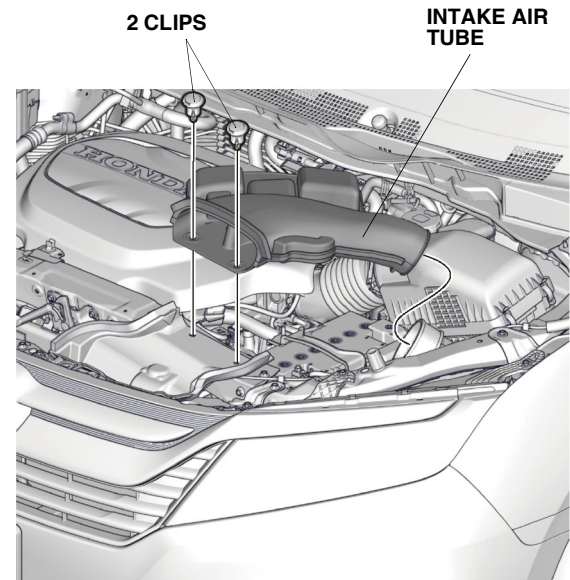

QF52704AG

Germain Honda of College Hills

2. Remove the left rear door sill trim.

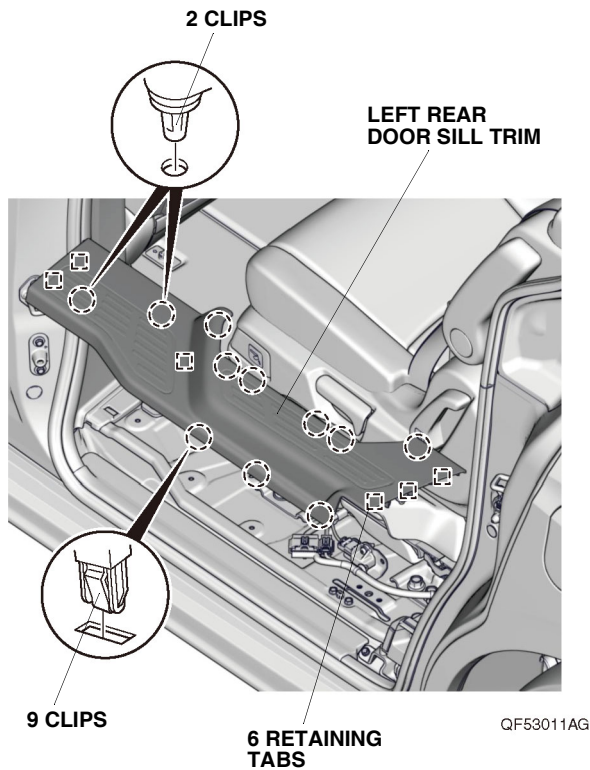

3. Remove the rear trim panel.

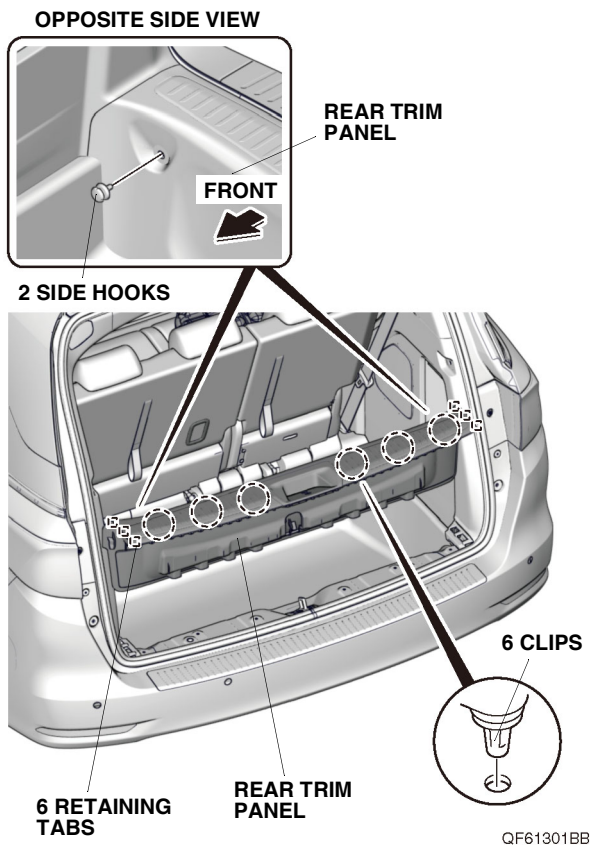

4. Stow the third row seats.

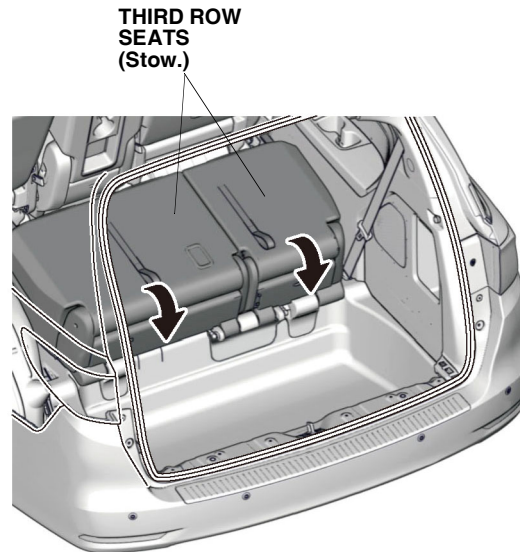

QF60203AG

5. Apply masking tape to the left C-pillar trim and left D-pillar trim as shown.

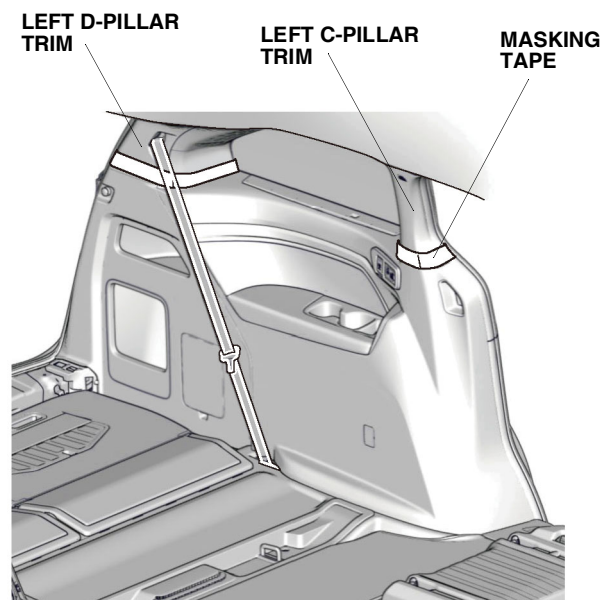

QF60204CG

Germain Honda of College Hills

6. Using the plastic trim tool, open the two covers and remove the two self-tapping screws.

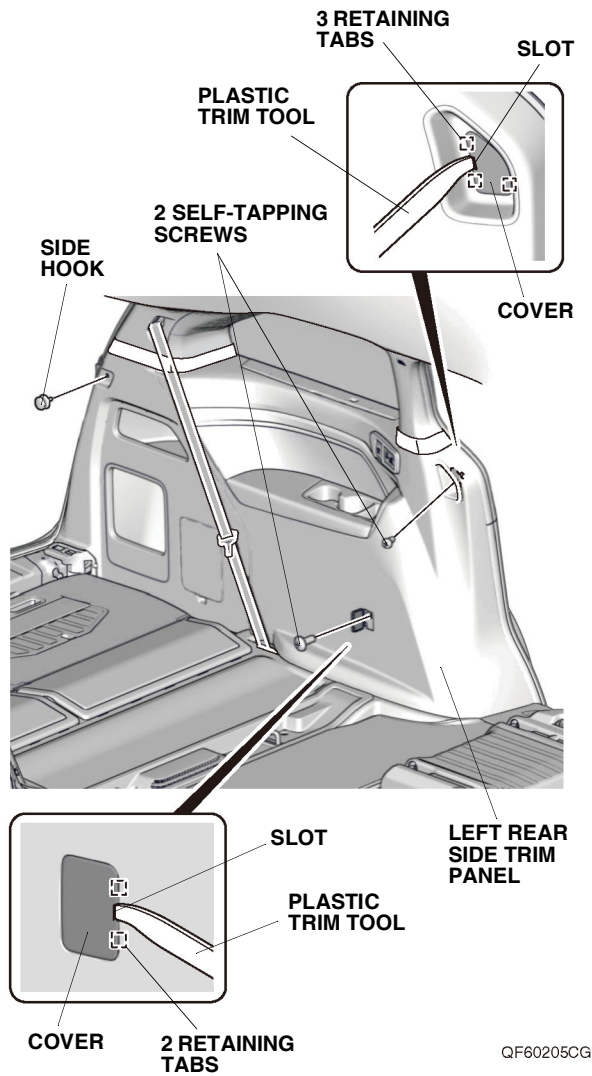

7. Remove the side hook from the left rear side trim panel.

8. Pull away the door opening seal and weatherstrip from around the left rear side trim panel. Remove the left rear side trim panel, and unplug the vehicle connectors (if equipped).

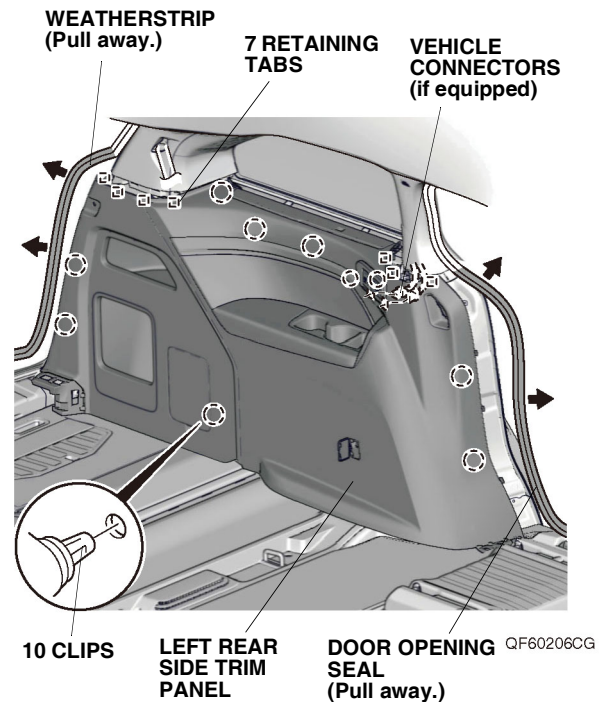

Germain Honda of College Hills

9. Remove the rear bumper:
- Apply masking tape as shown.

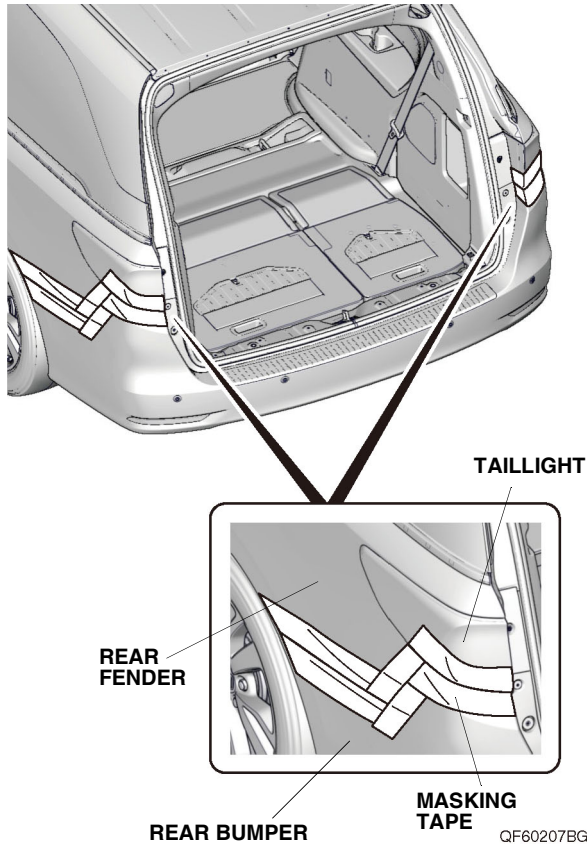

- Remove the six self-tapping screws, six clips, two large hex bolts, and two small hex bolts as shown.

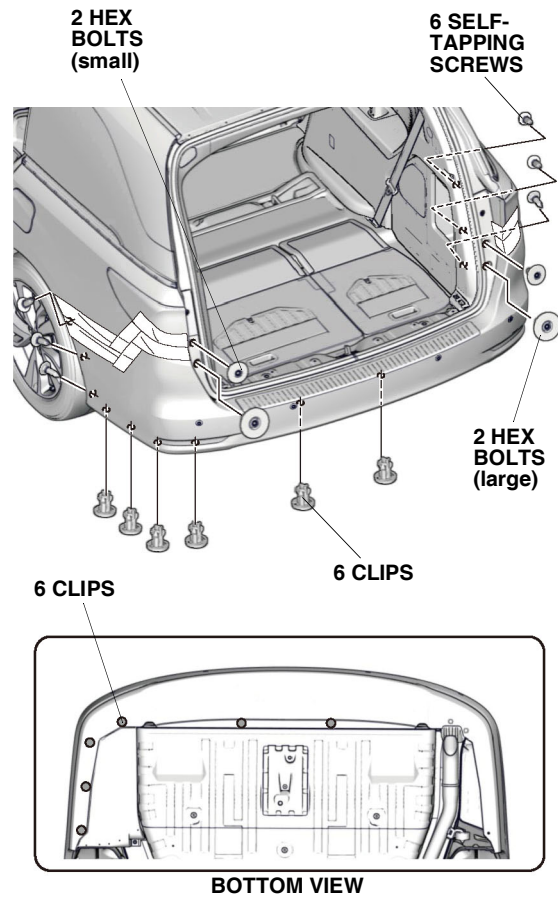

Germain Honda of College Hills

- With the help of an assistant, release the nine retaining tabs on each side.

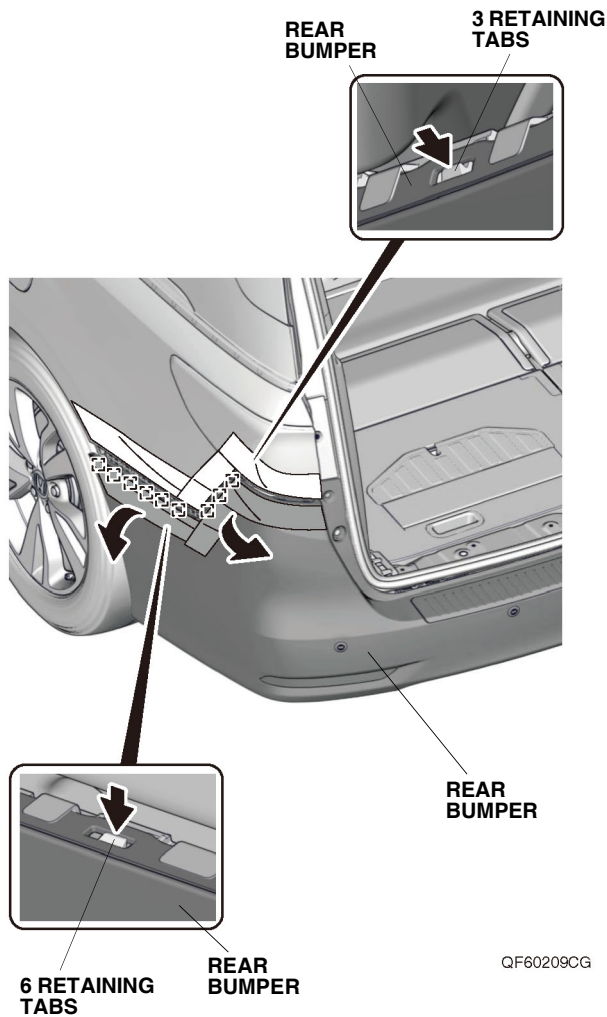

- With the help of an assistant, remove the rear bumper and unplug the vehicle connectors (if equipped).
- Place the rear bumper on a blanket.

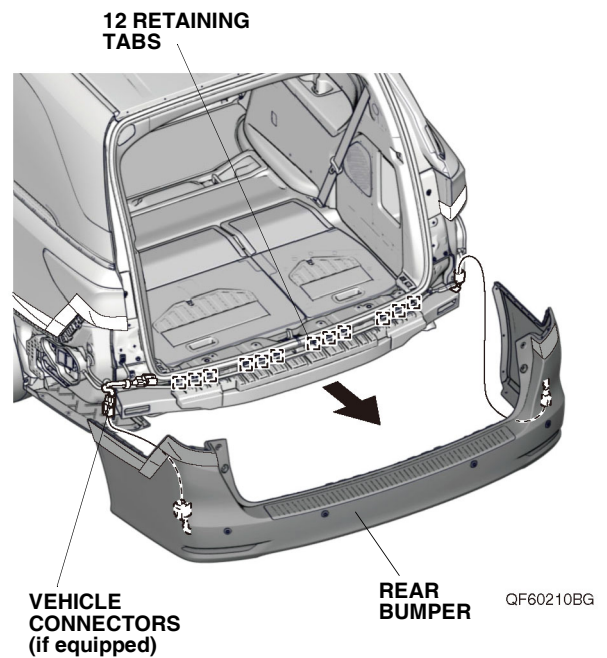

- Remove the tape to free the vehicle 2-pin connector, and unplug the vehicle 2-pin connector.

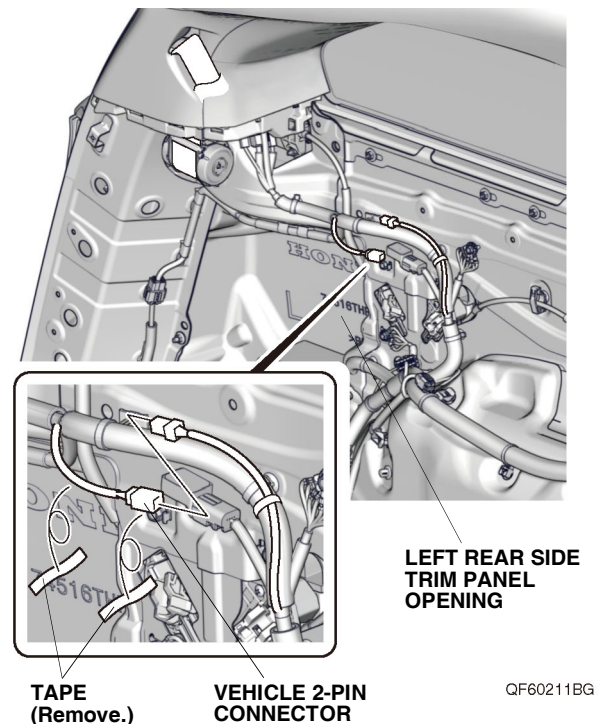

Germain Honda of College Hills

11. Plug the vehicle 2-pin connector into the Hands-Free Access harness 2-pin connector.

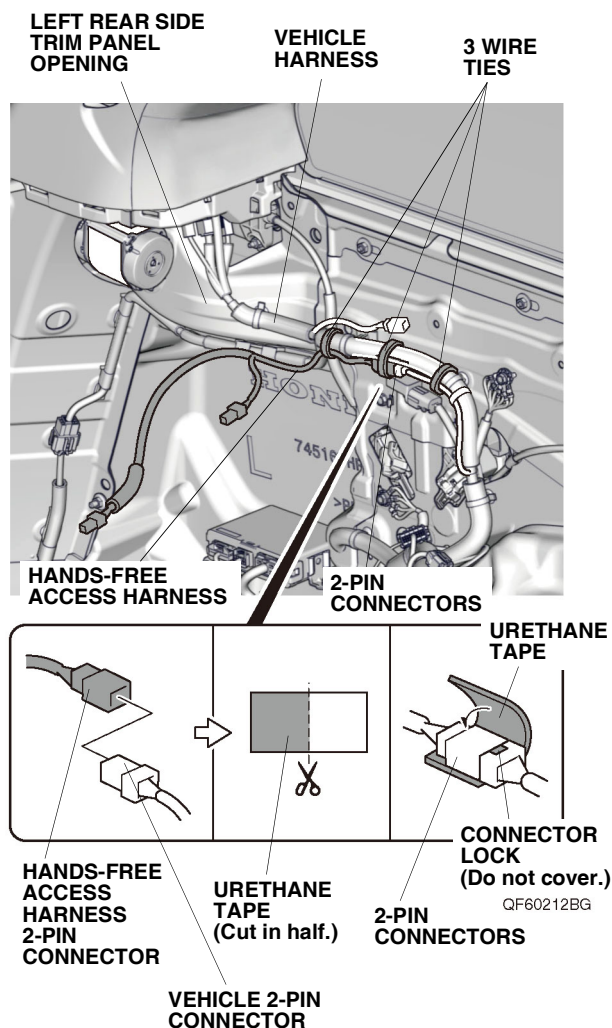

12. Using scissors, cut one urethane tape in half, and attach one half of urethane tape around the 2-pin connectors.
13. Secure the 2-pin connectors and Hands-Free Access harness to the vehicle harness with three wire ties.

14. Plug the Hands-Free Access harness 2-pin connector to the vehicle 2-pin connector.

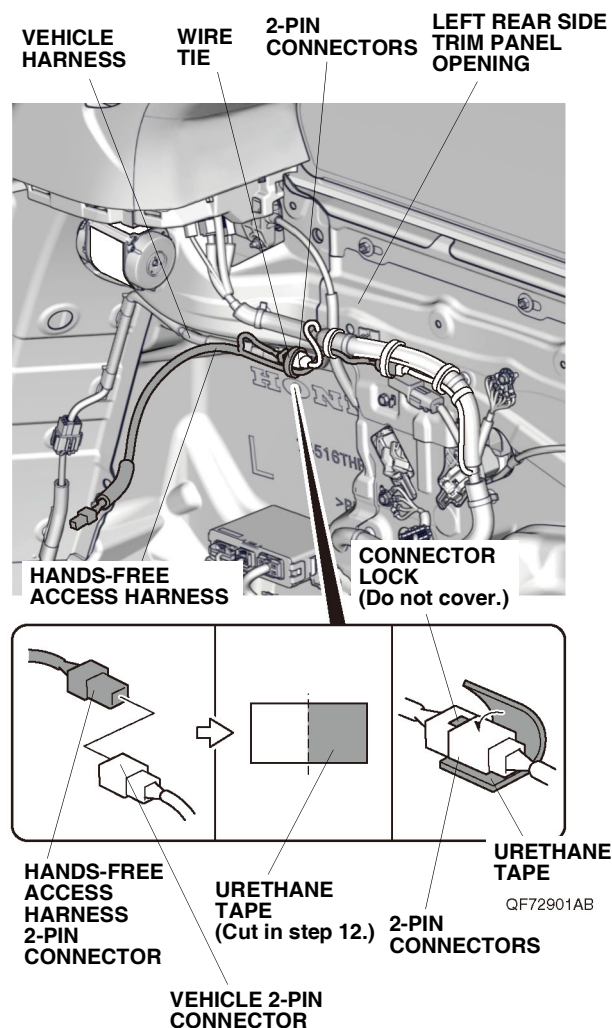

15. Apply one half of urethane tape cut in step 12 around the 2-pin connectors.
16. Secure the 2-pin connectors to the vehicle harness with one wire tie.

Germain Honda of College Hills

17. Secure the Hands-Free Access harness to the vehicle harness with three wire ties.

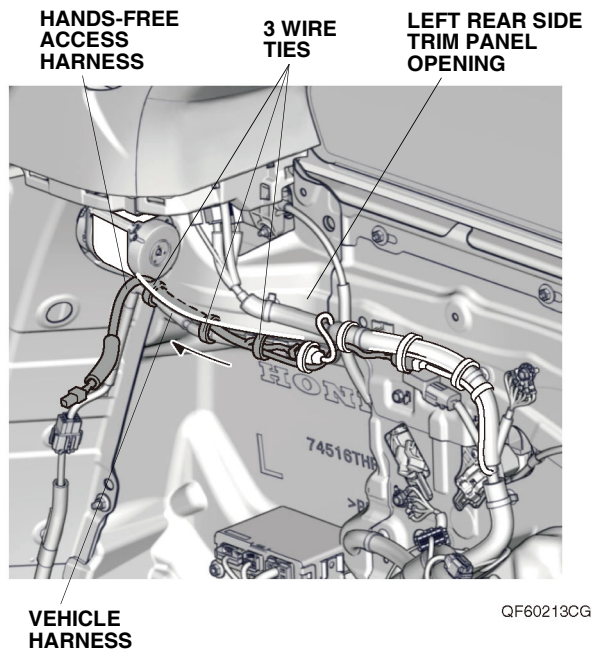

18. Using a pushpin, pierce the center of the scribe mark on the left rear side trim panel.
NOTE: Make sure to pierce the mark perpendicular to the left rear side trim panel.

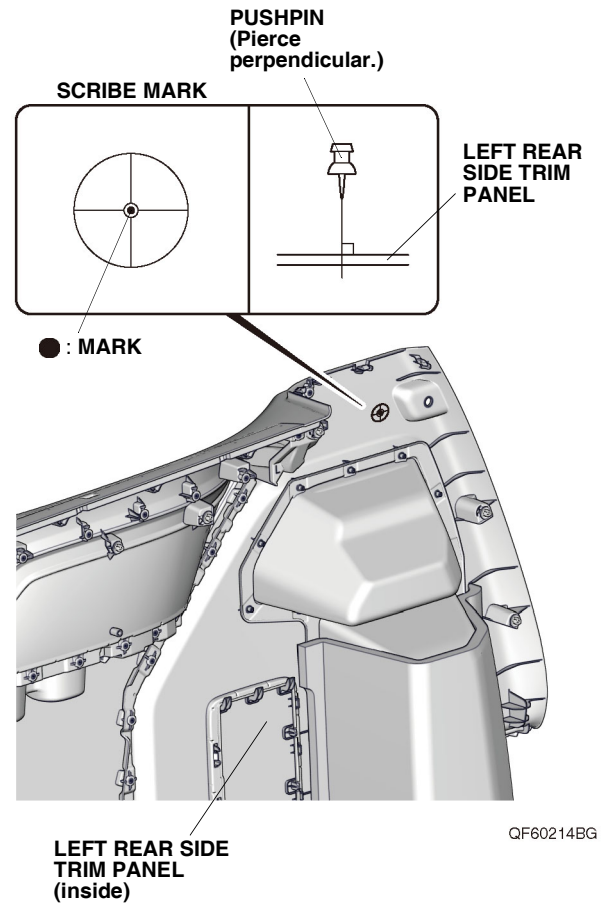

Germain Honda of College Hills

19. While wearing eye protection, drill the pierced mark on the left rear side trim panel with a 3 mm drill bit.
NOTE: Make sure to drill perpendicular to the left rear side trim panel.

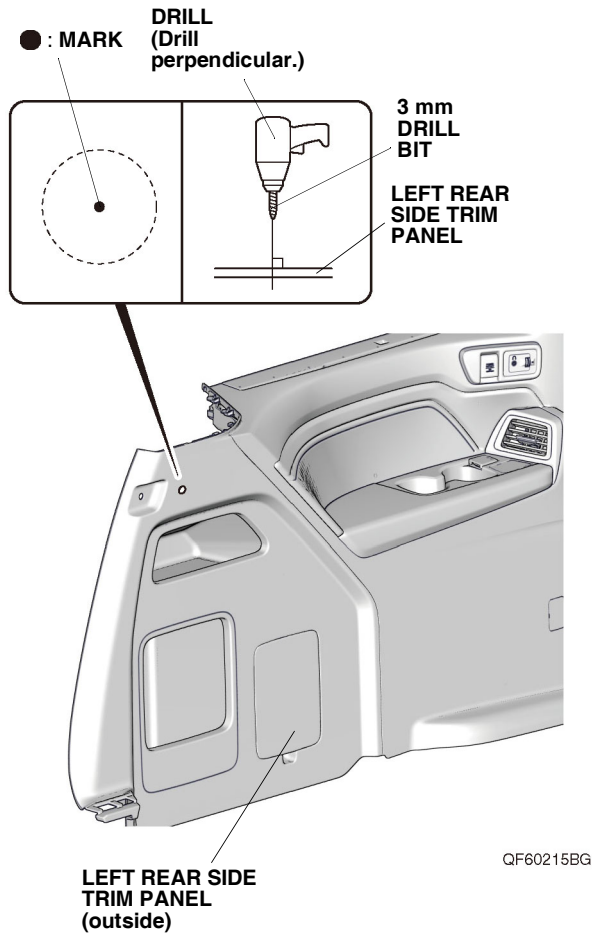

20. While wearing eye protection, enlarge the 3 mm hole to 26 mm using a 26 mm hole saw. Remove any burrs.
NOTE: Make sure to drill perpendicular to the left rear side trim panel.

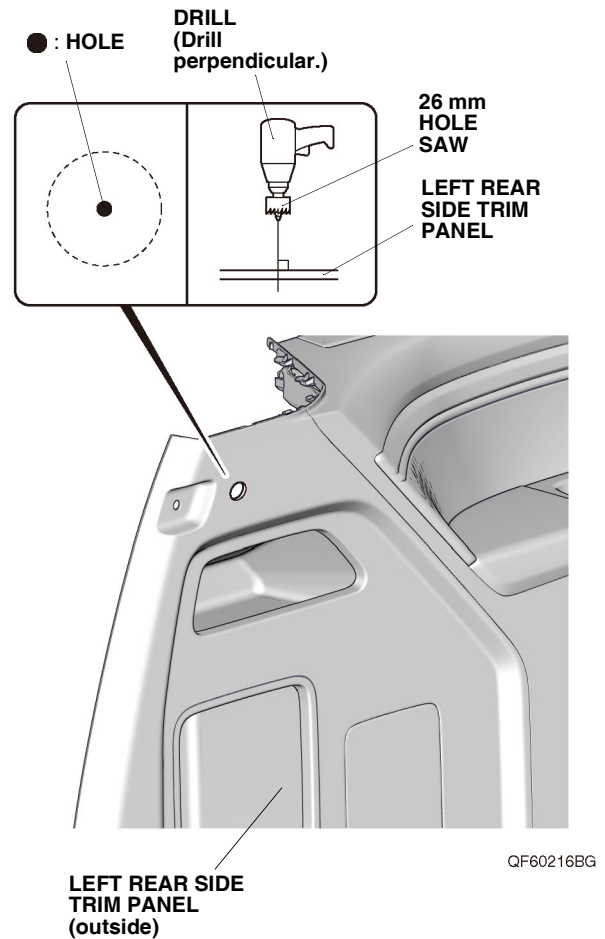

Germain Honda of College Hills

21. Install the switch into the 26 mm hole in the left rear side trim panel.
- NOTE:** Make sure to install the switch in the correct orientation.

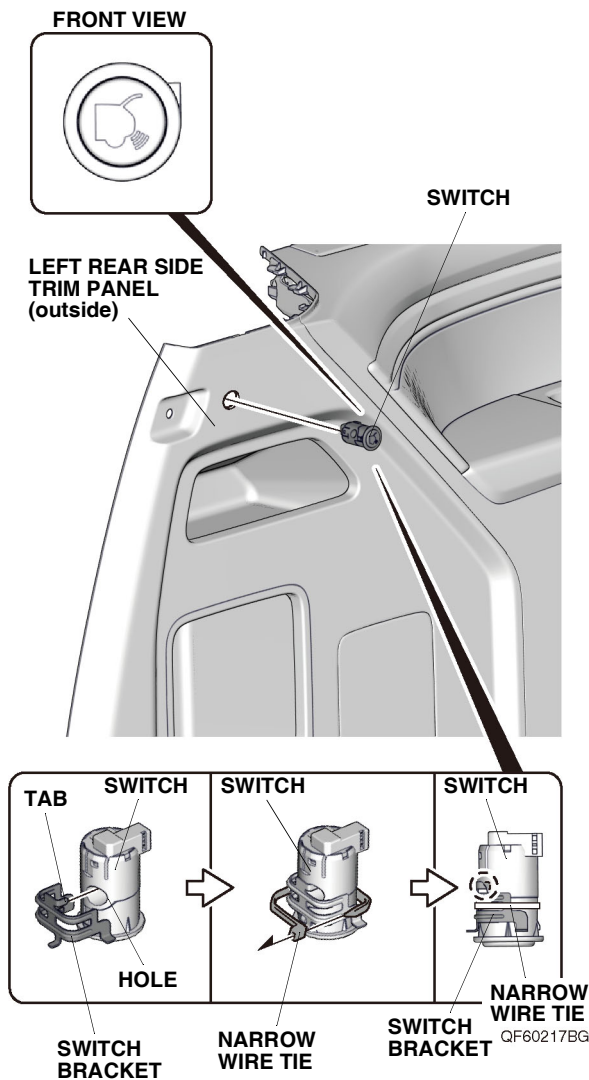

22. Line up the tab on the switch bracket with the hole on the switch and secure the switch bracket to the switch with one narrow wire tie.
- NOTE:** Firmly press the switch bracket against the left rear side trim panel, and make sure that there is no clearance between the switch and left rear side trim panel.

23. Bring the left rear side trim panel into position. Plug the Hands-Free Access harness 3-pin connector into the switch.

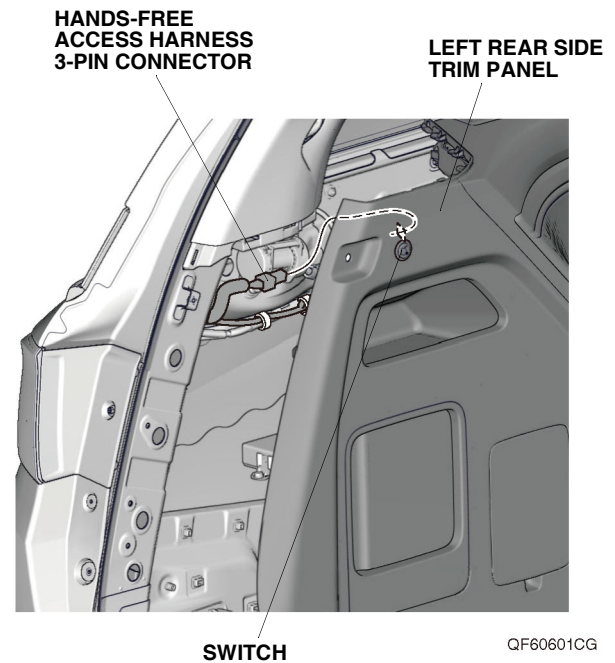

24. Install the left rear side trim panel.

Germain Honda of College Hills

If the vehicle is equipped with the accessory trailer hitch, continue with step 25; otherwise, go to step 30.

With accessory trailer hitch

25. Cut the wire tie on the lower antenna.
NOTE: Be careful not to damage the lower antenna.

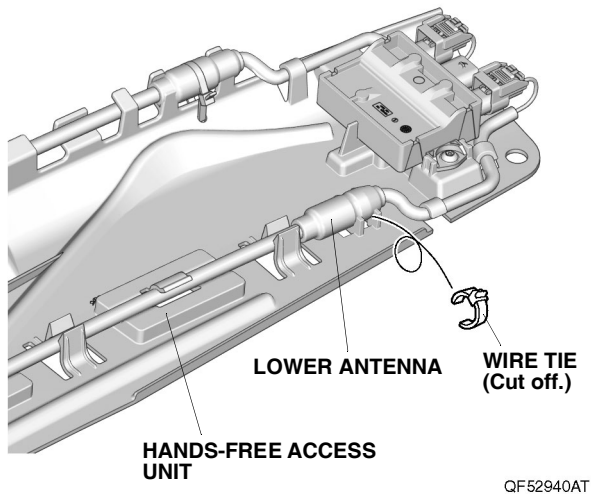

26. Remove the Hands-Free Access ECU and the lower antenna from the Hands-Free Access unit.

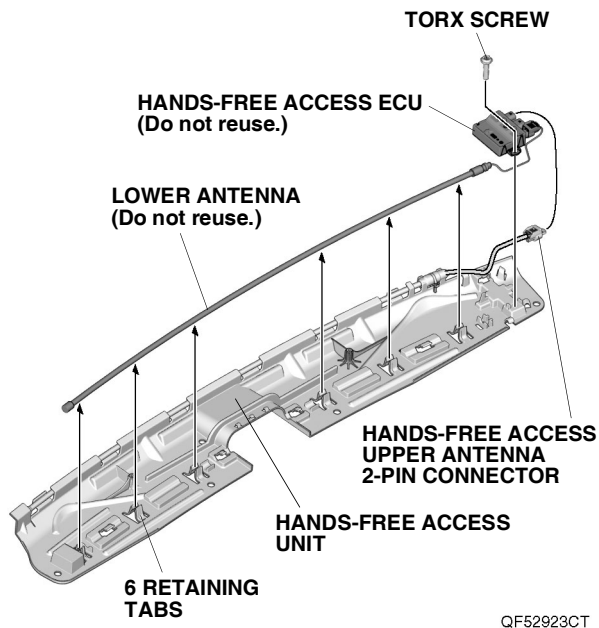

27. Install the new Hands-Free Access ECU on the Hands-Free Access unit with the TORX screw, and plug the Hands-Free Access upper antenna 2-pin connector into the new Hands-Free Access ECU.

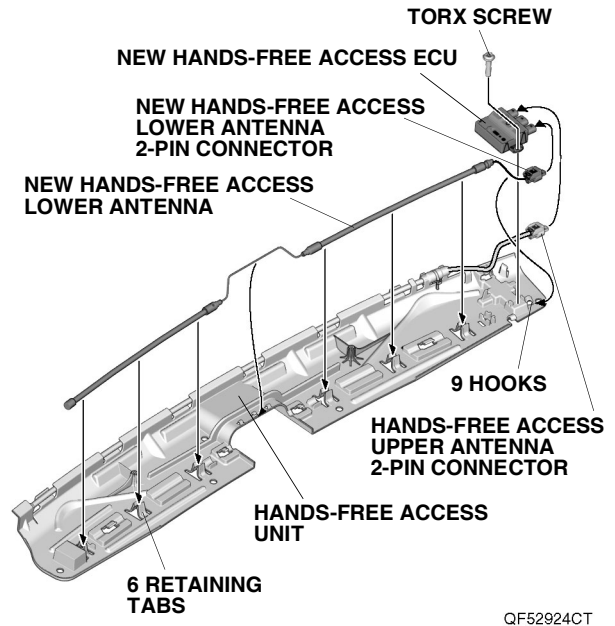

28. Install the new Hands-Free Access lower antenna on the Hands-Free Access unit, and plug the new Hands-Free Access lower antenna 2-pin connector into the new Hands-Free Access ECU.

Germain Honda of College Hills

29. Secure the new Hands-Free Access lower antenna to the Hands-Free Access unit with one narrow wire tie (short).

NOTE: Lower antenna and Hands-Free Access ECU must both be replaced for the system to function properly on vehicles with a accessory trailer hitch.

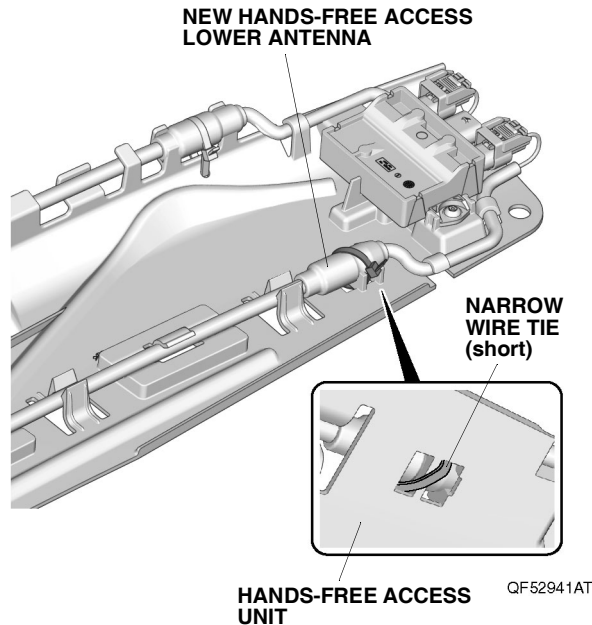

30. Using a pushpin, pierce the center of eight scribe marks on the rear bumper.
- NOTE: Make sure to pierce the marks perpendicular to the rear bumper.

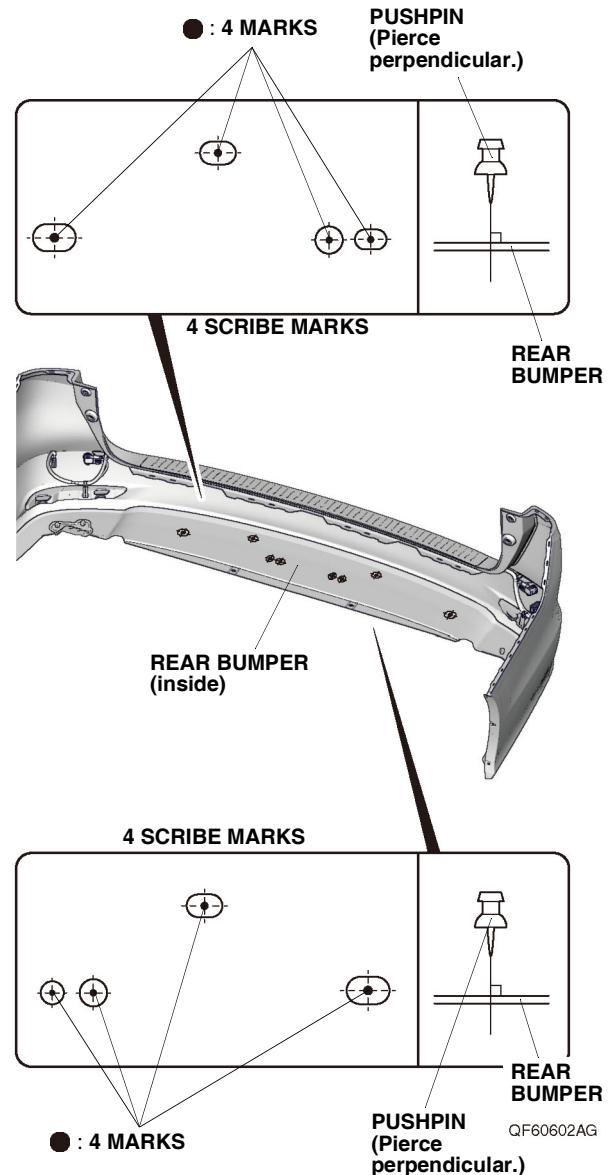

Germain Honda of College Hills

31. While wearing eye protection and drilling from the outside of the rear bumper, drill eight pierced marks with a 3 mm drill bit, then finish with a 6 mm drill bit.
NOTE: Make sure to drill perpendicular to the rear bumper.

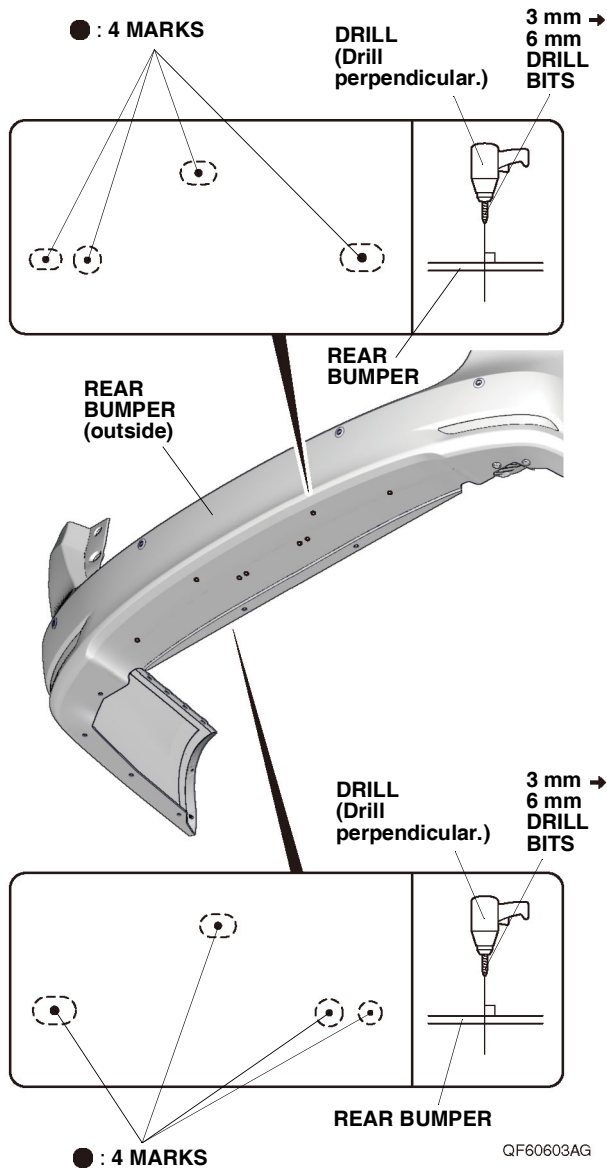

32. While wearing eye protection and drilling from the outside of the rear bumper, enlarge four 6 mm holes, with a 9 mm drill bit, then finish with an 11 mm drill bit.
NOTE: Make sure to drill perpendicular to the rear bumper. Make sure to drill the correct positions.

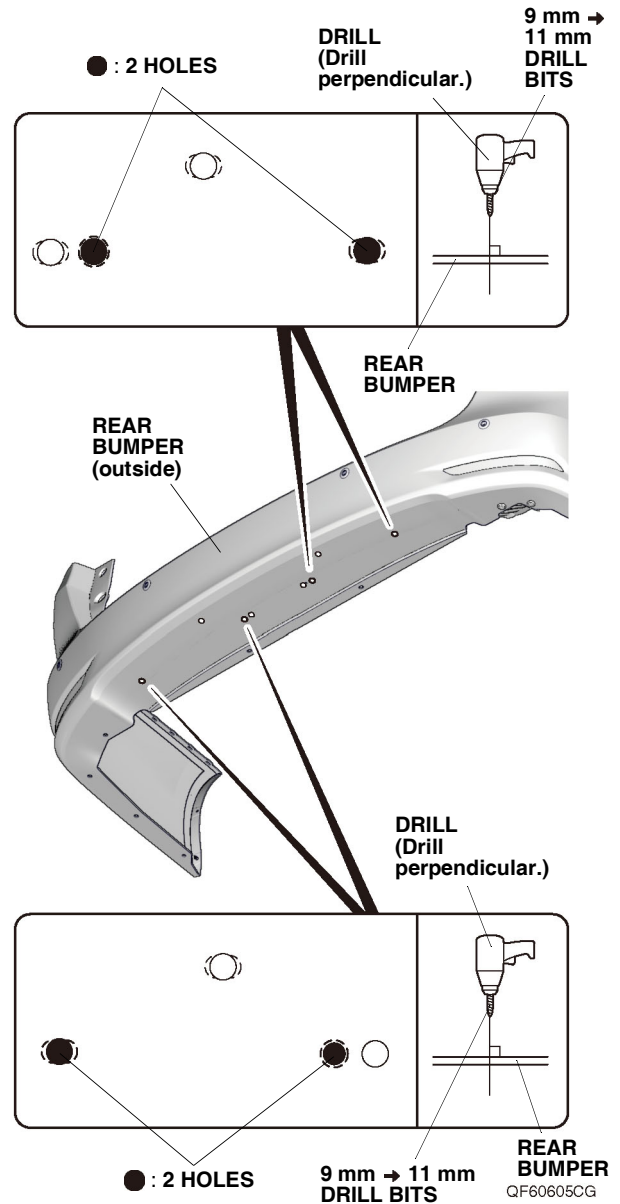

Germain Honda of College Hills

33. Install the Hands-Free Access unit to the rear bumper with four clips and two self-tapping screws.

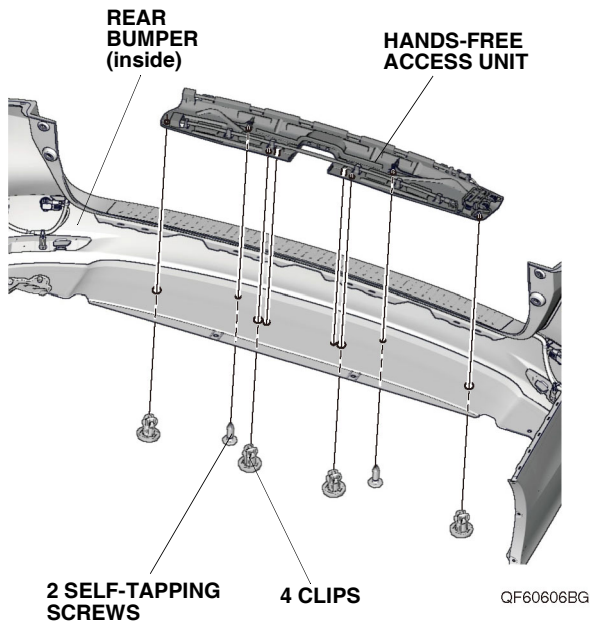

If the vehicle is equipped with the standard backup sensors, continue with step 34; otherwise, go to step 39.

With standard backup sensors

34. Remove the clip on the Hands-Free Access ECU harness.
NOTE: Do not damage the Hands-Free Access ECU harness.

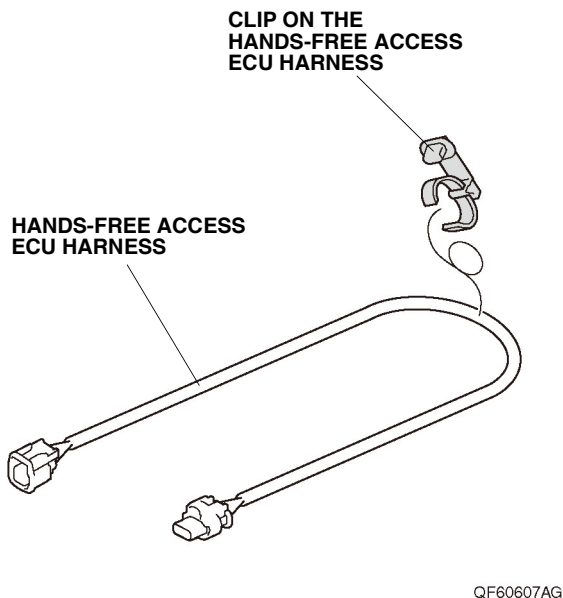

35. Plug the Hands-Free Access ECU harness 3-pin connector to the Hands-Free Access ECU.

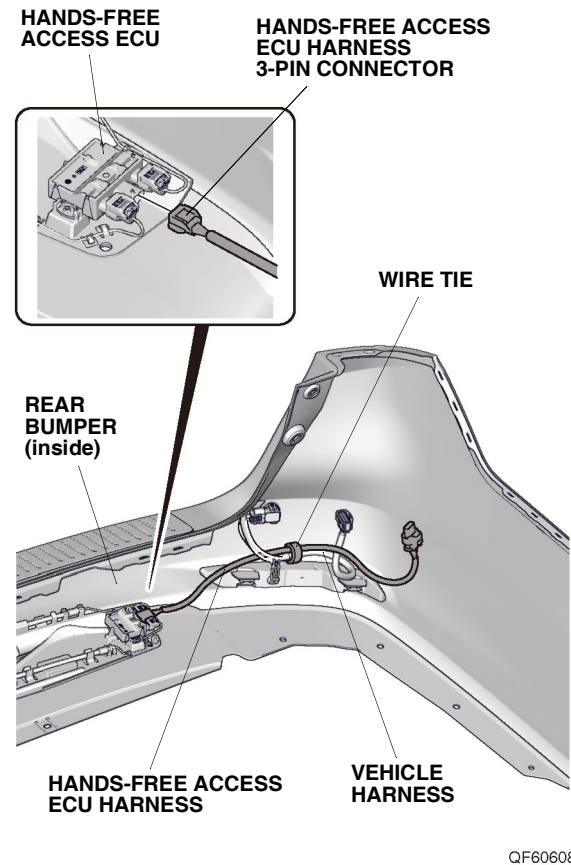

36. Secure the Hands-Free Access ECU harness to the vehicle harness with one wire tie.

Germain Honda of College Hills

37. Remove the tape to free the vehicle 4-pin connector, and remove the dummy connector from the vehicle 4-pin connector.

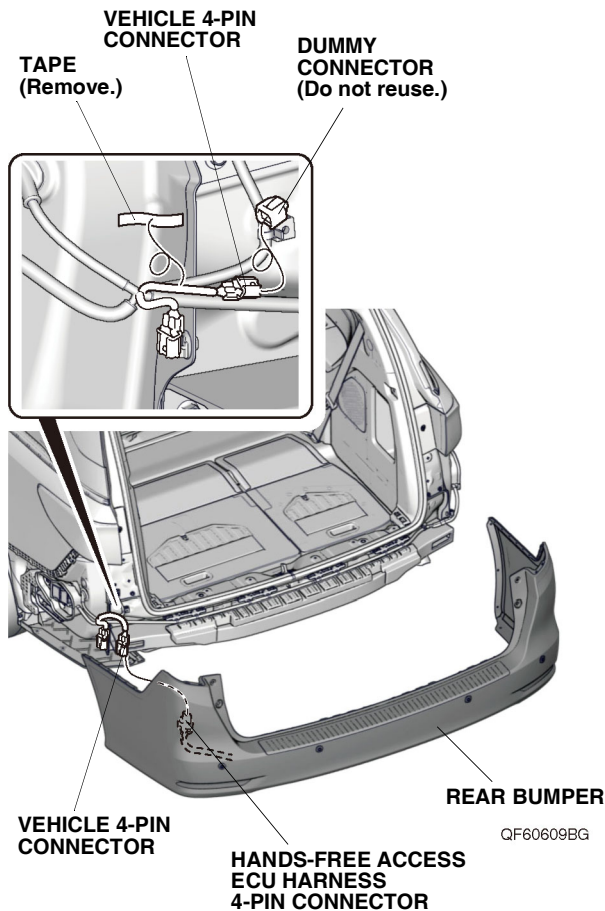

38. With the help of an assistant, bring the rear bumper close to the vehicle, and plug the Hands-Free Access ECU harness 4-pin connector into the vehicle 4-pin connector. Install the rear bumper. Go to step 43.

Without standard backup sensors

39. Plug the Hands-Free Access ECU harness 3-pin connector to the Hands-Free Access ECU.

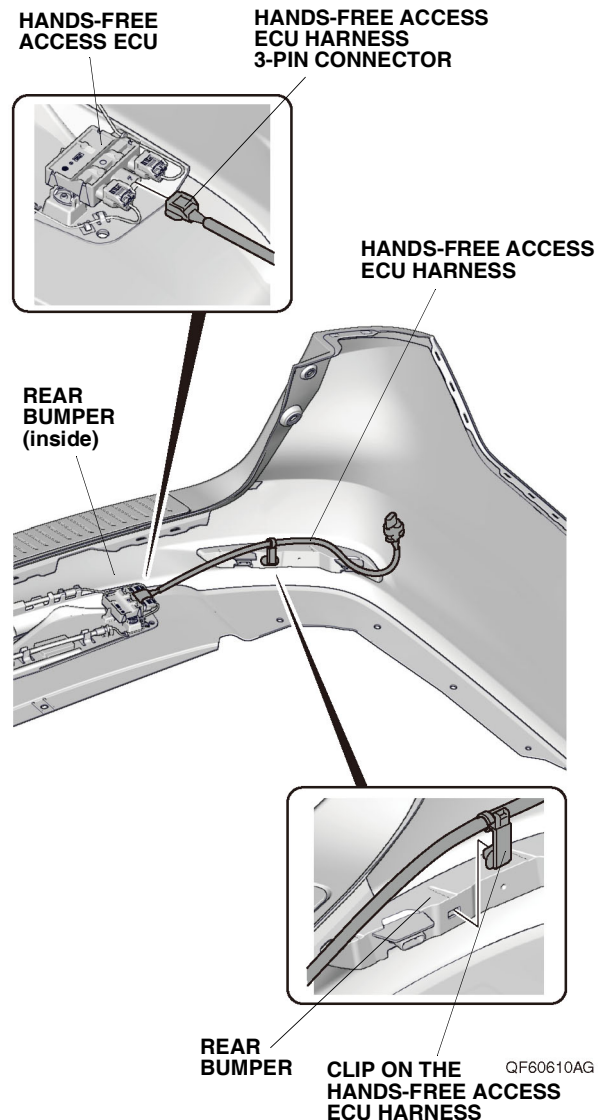

40. Secure the Hands-Free Access ECU harness to the rear bumper with clip on the Hands-Free Access ECU harness.

Germain Honda of College Hills

41. Remove the dummy connector from the vehicle 4-pin connector.

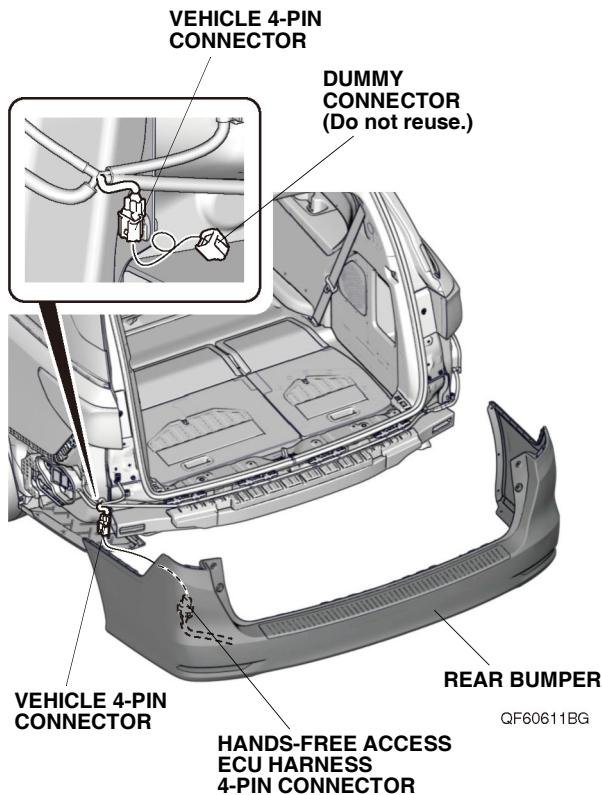

42. With the help of an assistant, bring the rear bumper close to the vehicle, and plug the Hands-Free Access ECU harness 4-pin connector into the vehicle 4-pin connector. Install the rear bumper.
43. Check that all wire harnesses are routed properly and all connectors are plugged in.
44. Install all removed parts except for the front bulkhead cover and the intake air tube.
45. Connect the negative cable to the battery.
46. Install the front bulkhead cover and the intake air tube.
47. Press and hold the audio unit power button for 2 seconds to restore the audio and navi (if equipped) system functions.
48. Set the clock on vehicles without navigation.
49. If necessary, restore the systems back to normal operation as described in the service information.

50. Using a clean shop towel with soap and water, thoroughly clean where the sticker will attach. Then, dry the area with a clean towel.

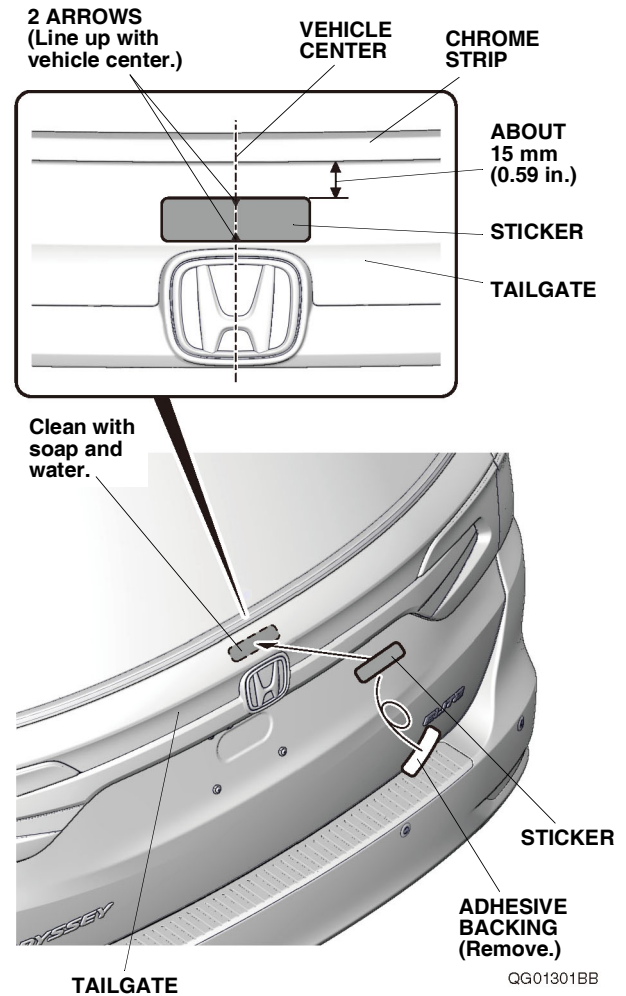

51. Remove the adhesive backing from the sticker. Using the arrows on the sticker, center it about 15 mm (0.59 in.) below the chrome strip and attach it to the tailgate. NOTE: Make sure the customer is aware the sticker can be removed after reading.

Check the Operation of the Hands-Free Access Power Tailgate

52. Check that the Hands-Free Access power tailgate work properly as described in the accessory user's information manual with this kit.