



HONDA INSTALLATION INSTRUCTIONS

Accessory

PUDDLE LIGHTS
P/N 08V27-THR-100A

Application

2022 ODYSSEY

Publications No.

VERSION 1

Issue Date

JAN 2021

PARTS LIST

2 Puddle light harnesses

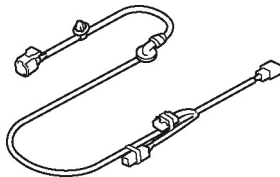

2 Subharnesses

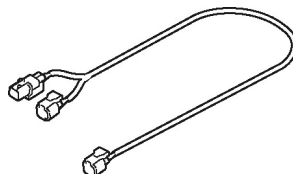

4 Lights



4 Light trims



28 Wire ties
(Some may not be used)

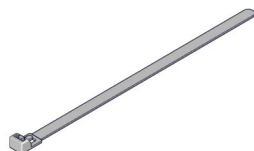

Fuse label

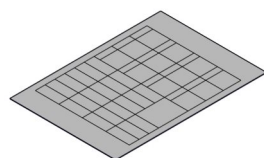

8 Self-tapping screws



5 Urethane tapes

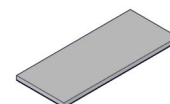

Front template

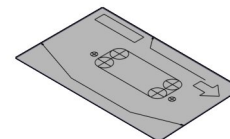

Rear template

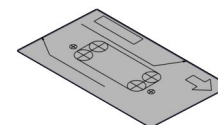

TOOLS AND SUPPLIES REQUIRED

Phillips screwdriver
Stubby Phillips screwdriver
Ratchet
10 mm Socket
Drill
File
Pushpin
3 mm, 6 mm, and 7 mm Drill bits
15 mm and 20 mm Hole saws
Eye protection (face shield, safety goggles, etc.)
Diagonal cutters
Isopropyl alcohol
Scissors
Shop towel
Ruler
Masking tape
Flat-tip screwdriver

The following tools are available through the Honda Tool and Equipment Program. On the iN, click on Service > Service Bay > Tool and Equipment Program, then enter the number under "Search." Or, call 888-424-6857.

- Trim Tool Set (T/N SOJATP2014)
- Plastic Trim Tool (T/N SILTRIMTL10)
- Air Saw (T/N AT192A)

Illustration of the Puddle Lights on the Vehicle

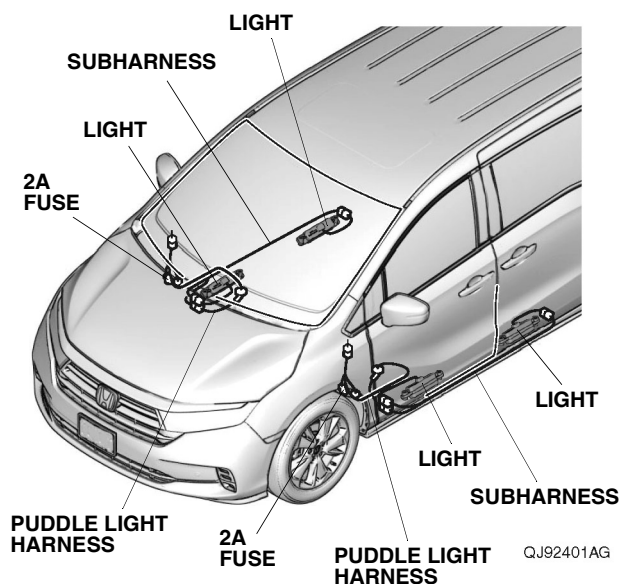

INSTALLATION

Customer Information: The information in this installation instruction is intended for use only by skilled technicians who have the proper tools, equipment, and training to correctly and safely add equipment to your vehicle. These procedures should not be attempted by "do-it-yourselfers."

1. Disconnect the negative cable from the battery:
 - Wrap a shop towel around the hood latch lever.

HOOD LATCH LEVER
(Wrap with a shop towel.)

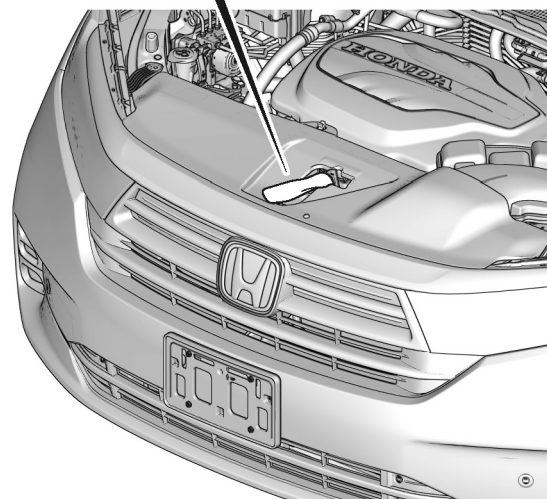
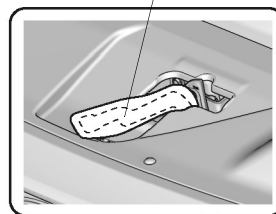

QJ92002AB

- Remove the front bulkhead cover.

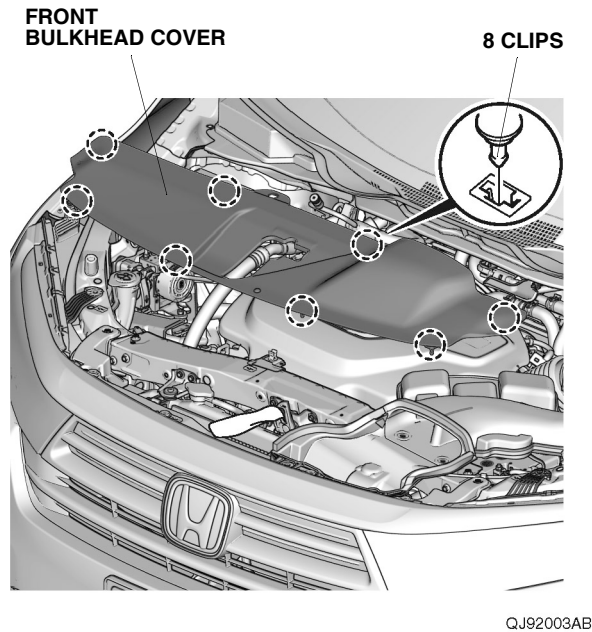

- Remove the intake air tube.
- Disconnect the negative cable from the battery.

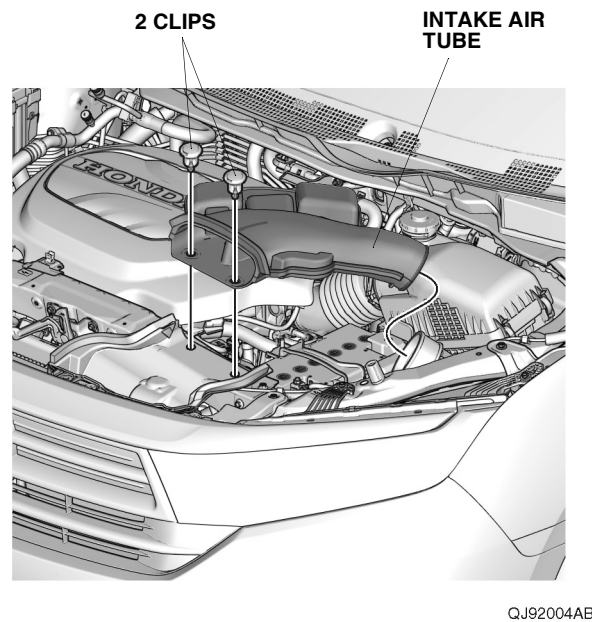

- Remove the passenger's dashboard under cover, and unplug the vehicle connector (if equipped).

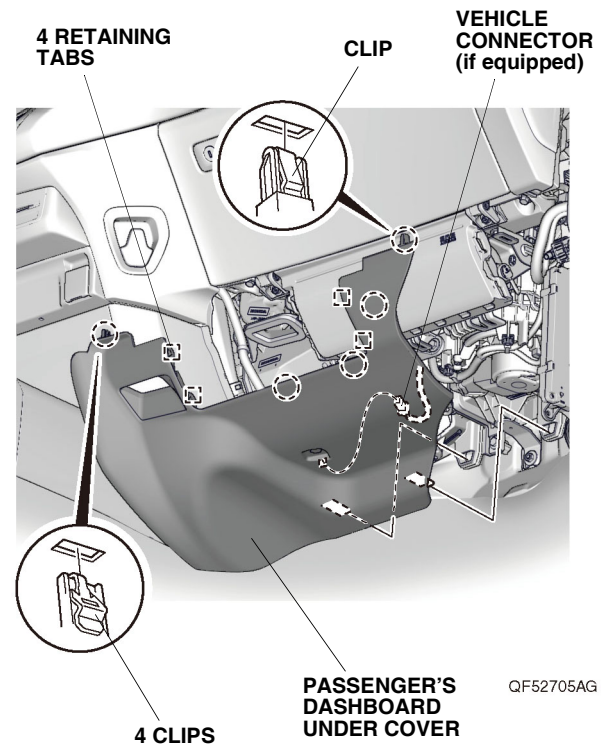

- Open the glove box, and release the damper rod.

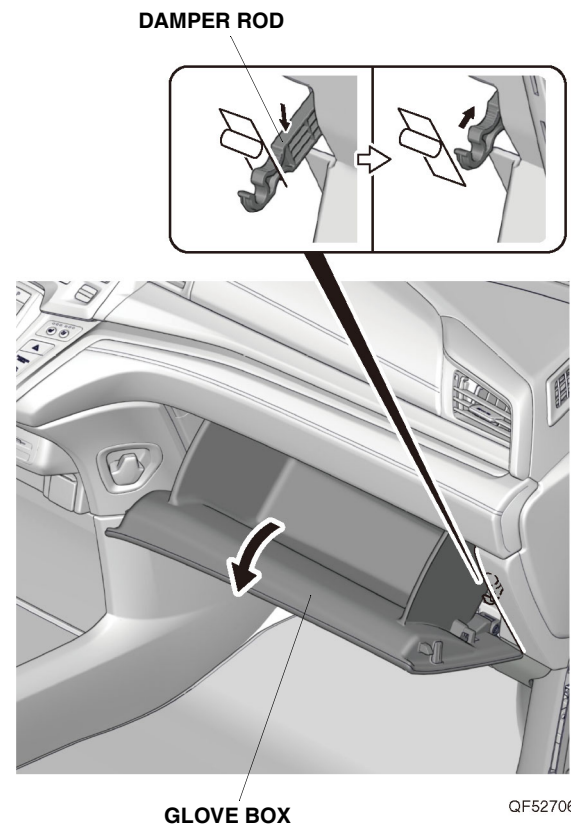

4. Close the glove box, and remove the two bolts.

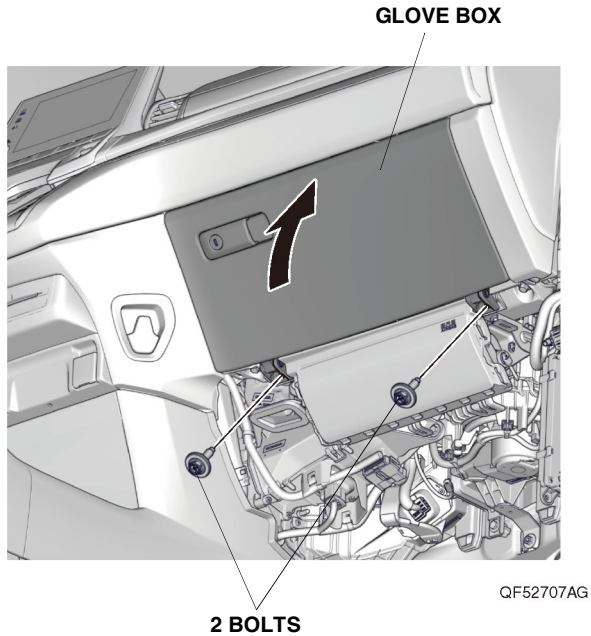

5. Remove the glove box.

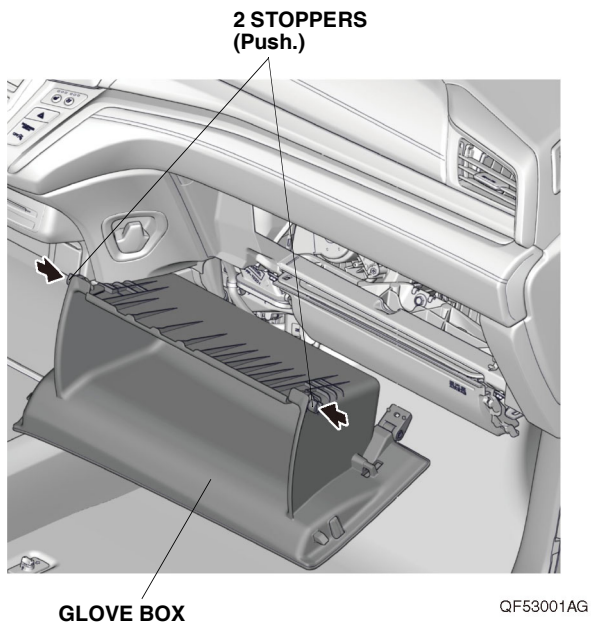

6. Remove the passenger's door sill trim.

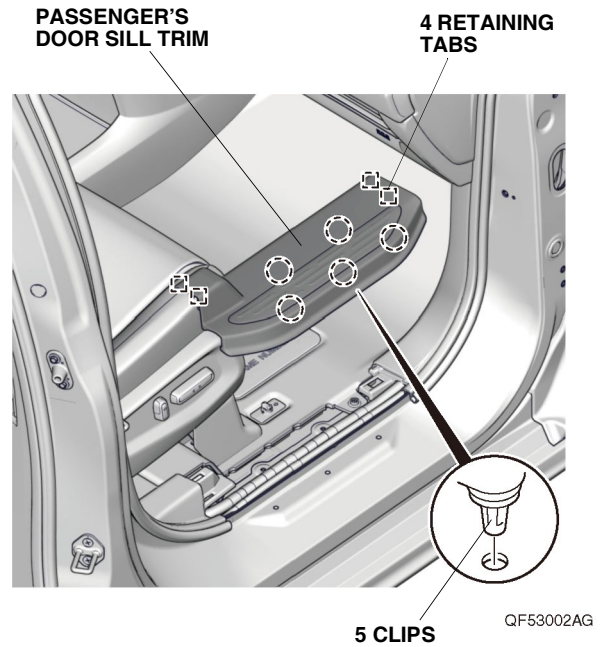

7. Pull away the door opening seal, and remove the passenger's kick panel.

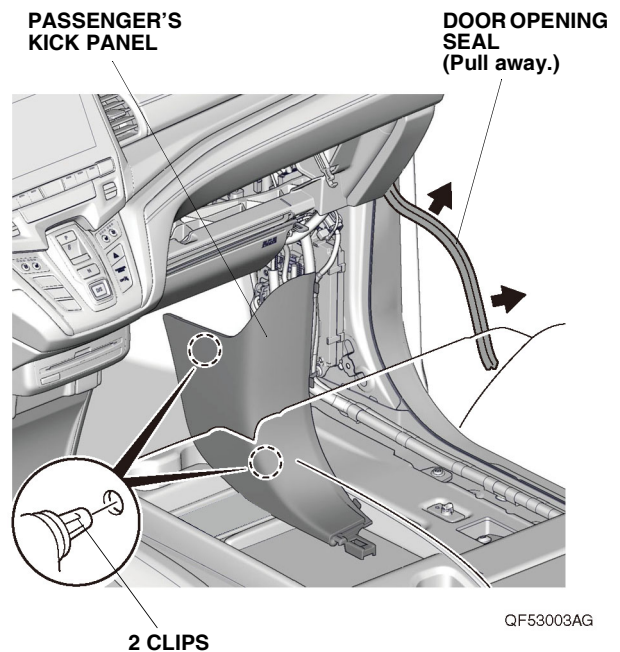

8. Pull away the door opening seal, and remove the driver's dashboard side lid.

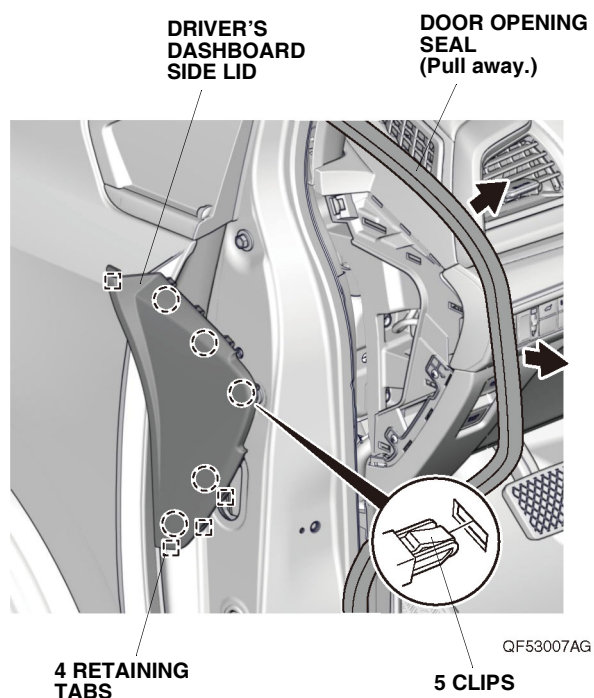

9. Remove the driver's dashboard lower cover, and unplug the vehicle connectors.

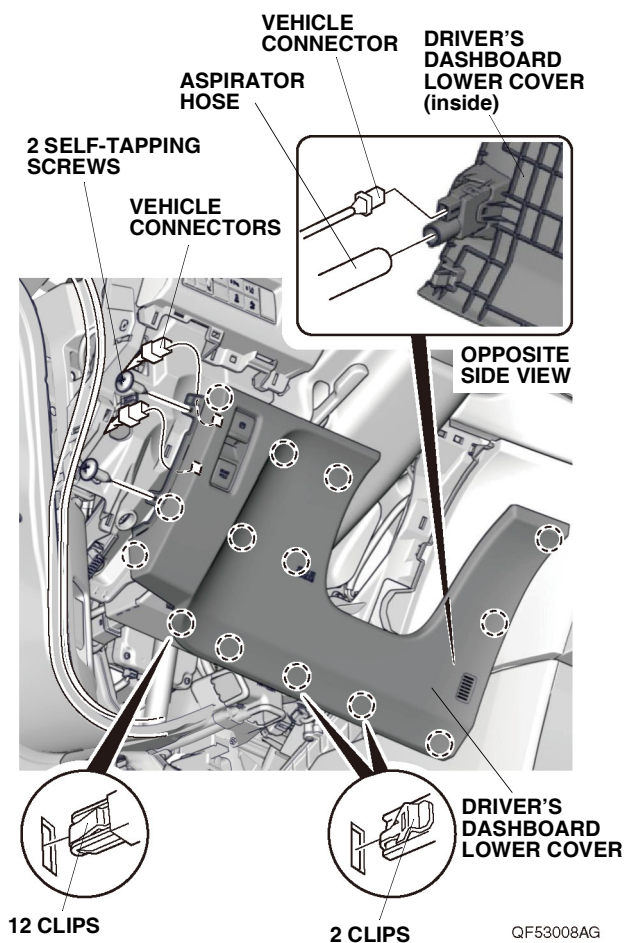

10. Remove the driver's door sill trim.

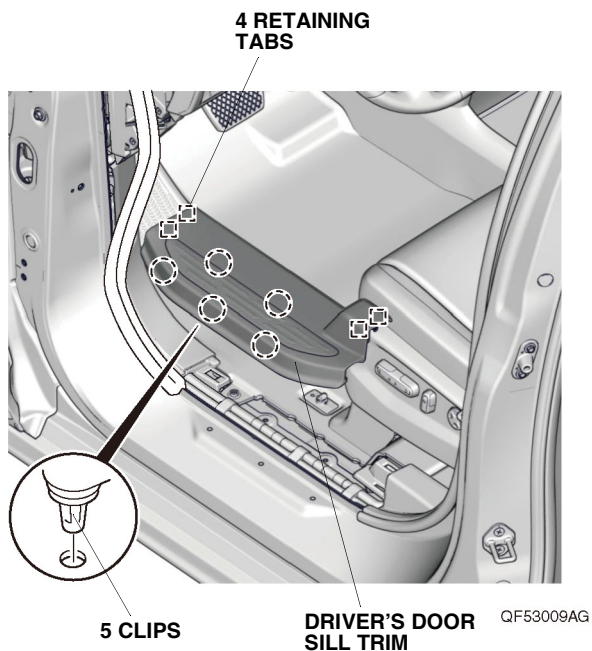

11. Pull away the door opening seal, and remove the driver's kick panel.

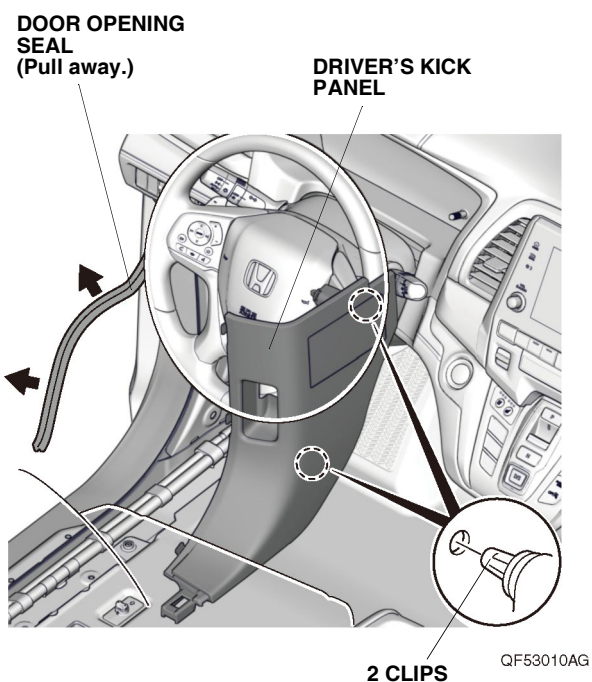

12. Connect the negative cable to the battery, then turn the ignition to ON. Turn the steering wheel fully counterclockwise.

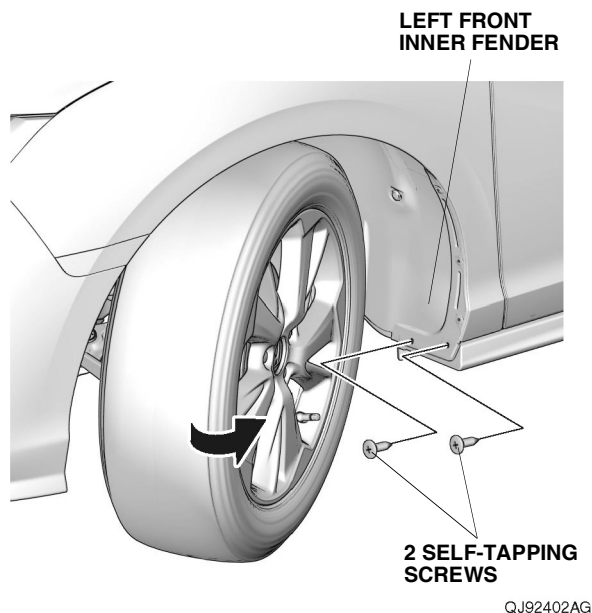

13. Remove the left front self-tapping screws.
14. Remove the left rear self-tapping screws.

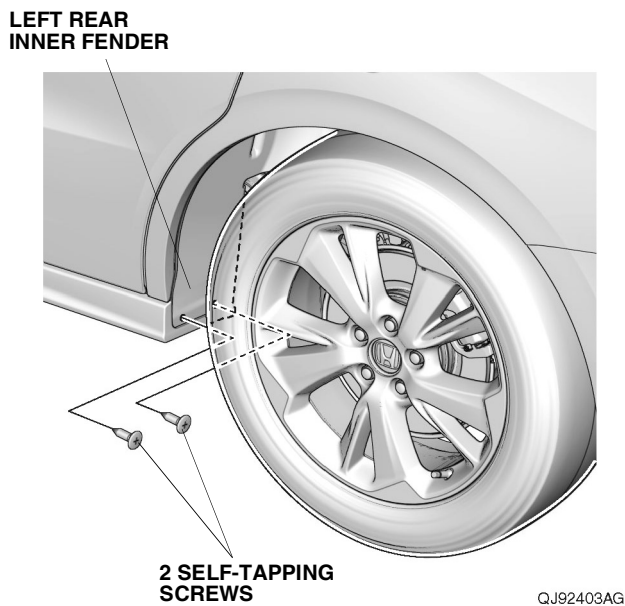

15. Remove the two clips.

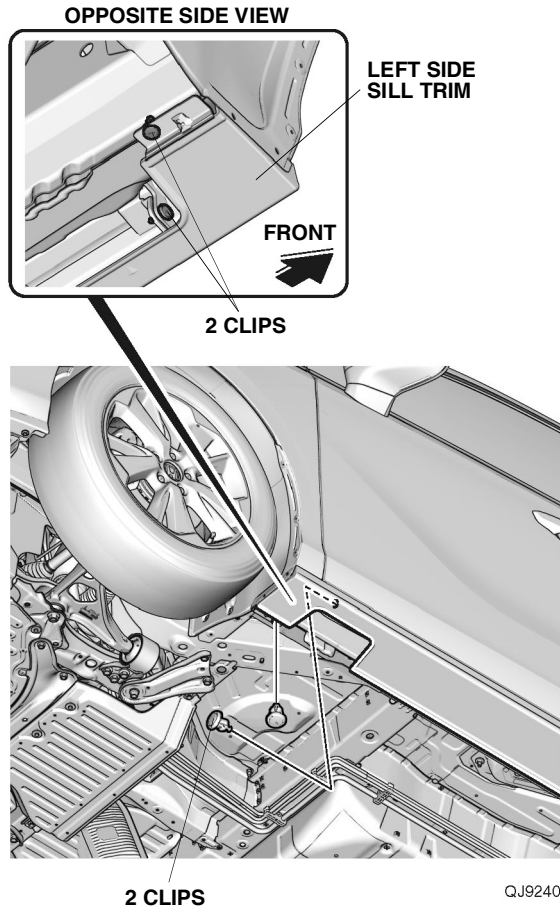

16. Remove the left side sill trim as shown.

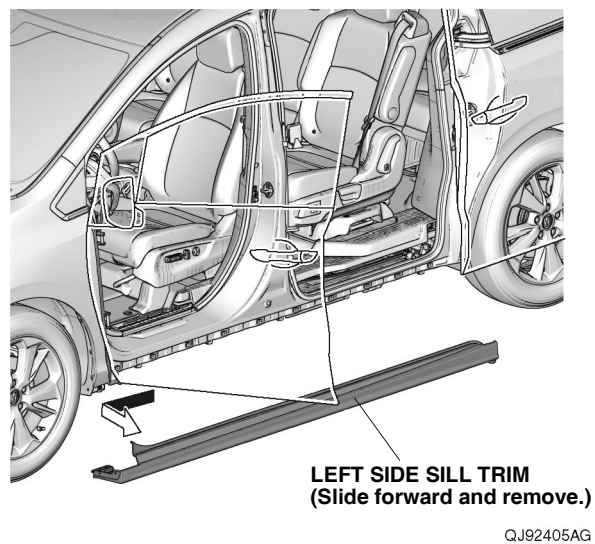

17. Remove the 10 clips.

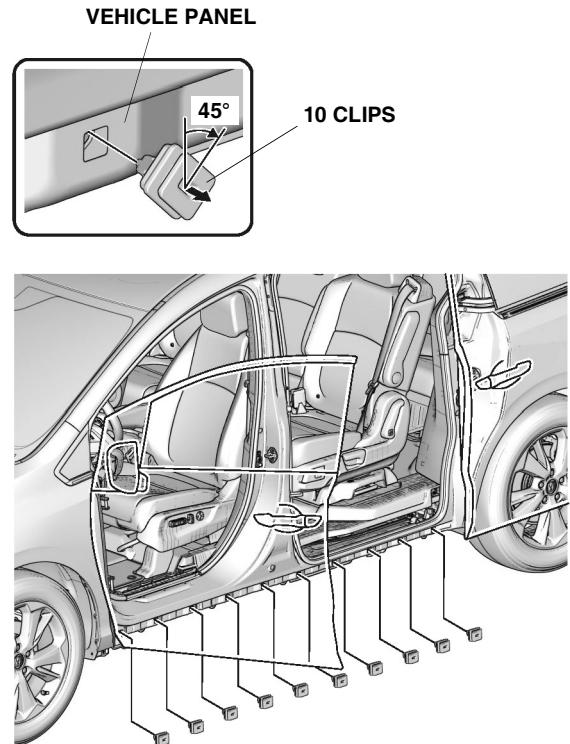

QJ92406AG

18. Remove the five clips.

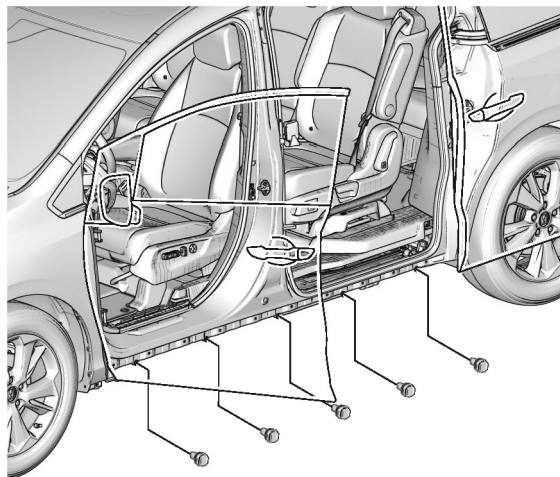
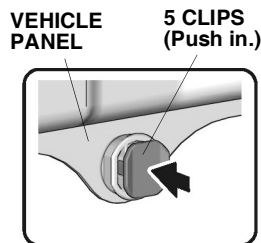

QJ92407BG

19. Turn the steering wheel fully clockwise, and repeat steps 13 through 18 on the right side of the vehicle.
20. Turn the ignition to OFF, then disconnect the negative cable from the battery.

21. Using isopropyl alcohol on a shop towel, thoroughly clean the fuse case where the fuse label will attach. Attach the fuse label (2A PUDDLE LIGHT) to the fuse case on the puddle light harness.

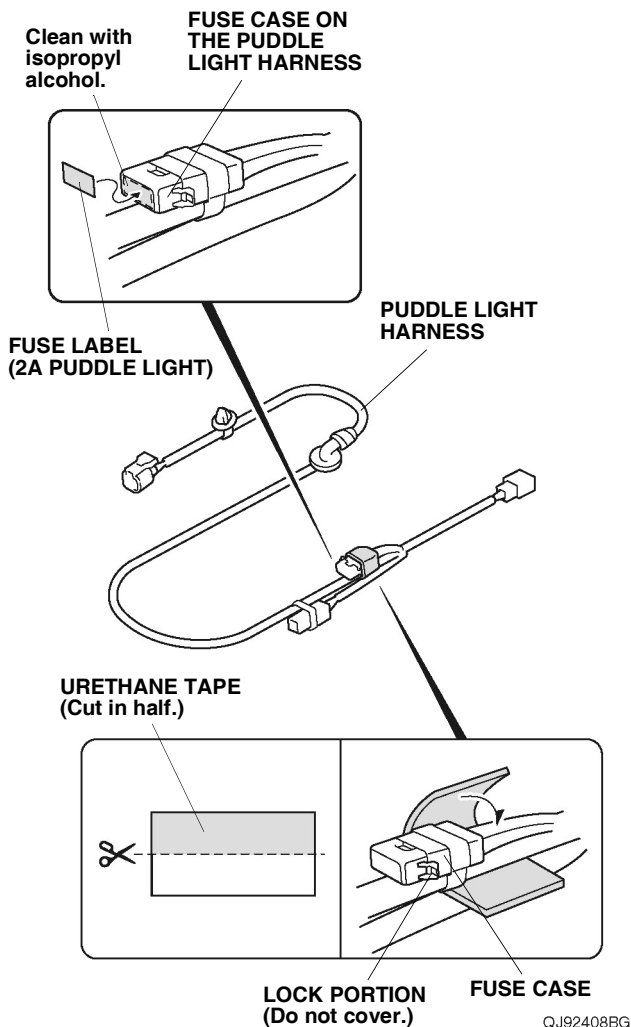

22. Using scissors, cut one urethane tape in half, and wrap one piece around the fuse case as shown.

23. Wrap the remaining piece of urethane tape around the puddle light harness 2-pin connector as shown.

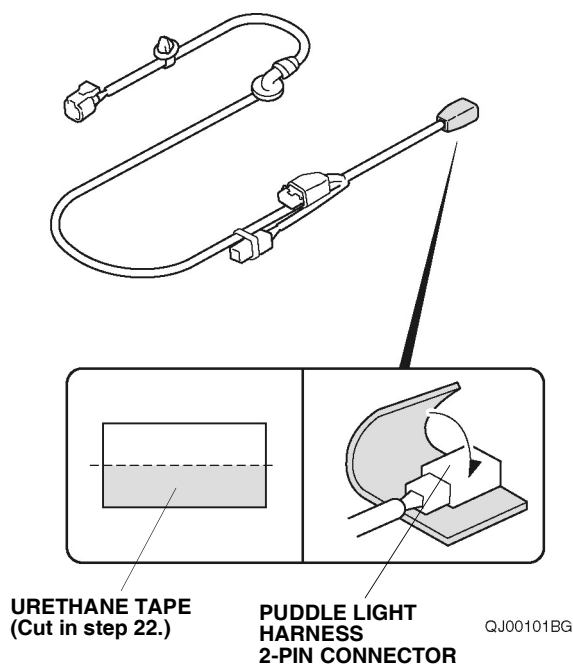

24. Repeat steps 21 through 23 on the remaining puddle light harness.

If the vehicle is equipped with accessory illuminated door sill trims, go to step 29; otherwise, continue with step 25.

Without accessory illuminated door sill trims

25. Plug the vehicle 2-pin connector into the puddle light harness 2-pin connector. Secure the 2-pin connectors to the vehicle harness with one wire tie.

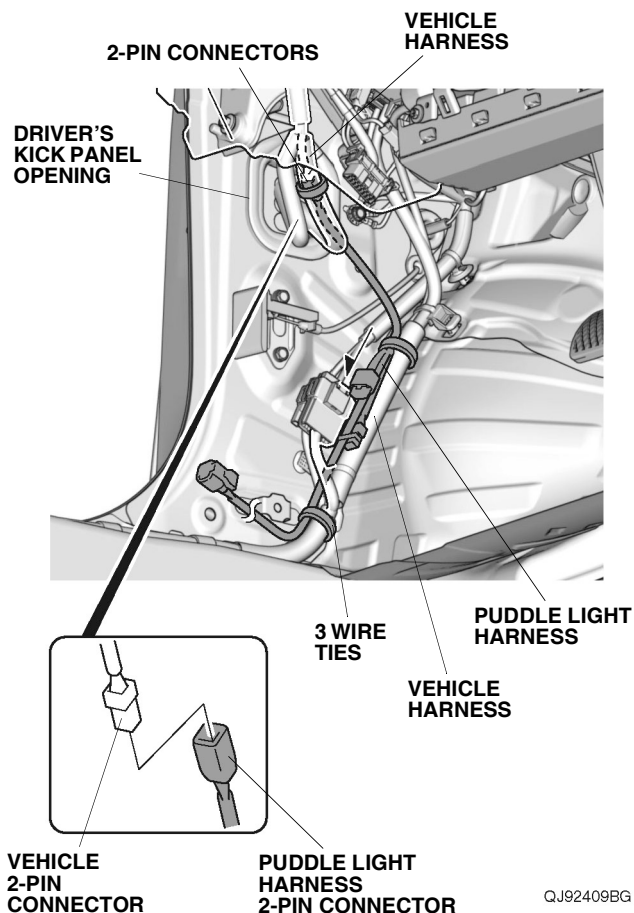

26. Route the puddle light harness along the vehicle harness, and secure it to the vehicle harness with two wire ties.

27. Plug the vehicle 2-pin connector into the puddle light harness 2-pin connector. Secure the 2-pin connectors to the vehicle harness with one wire tie.

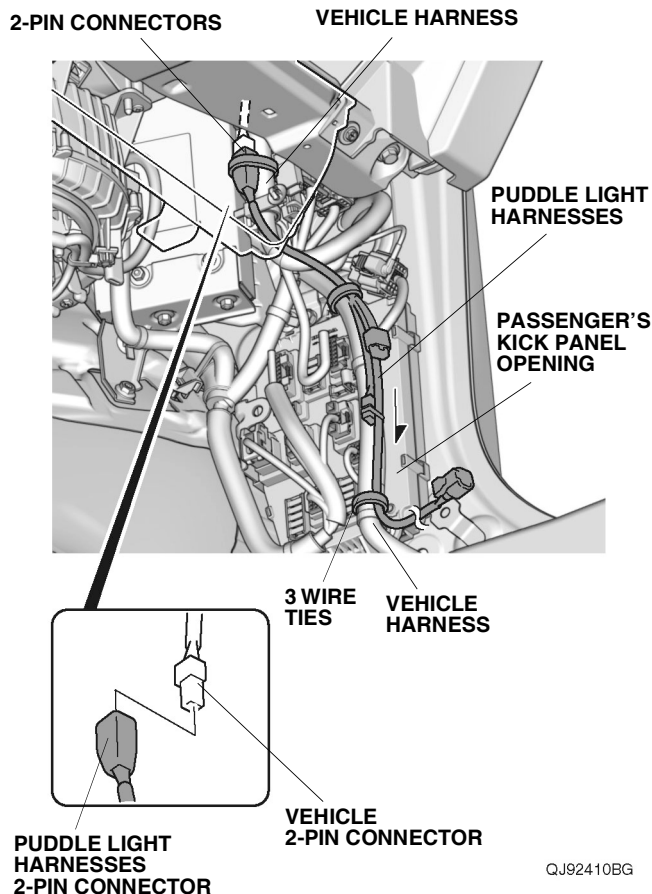

28. Route the puddle light harness along the vehicle harness, and secure it to the vehicle harness with two wire ties. Go to step 39.

With accessory illuminated door sill trims

29. Cut off the wire tie from the accessory illuminated door sill trim 2-pin connectors. Unplug the vehicle 2-pin connector, and plug it into the puddle light harness 2-pin connector.

NOTE: Be careful not to damage the accessory illuminated door sill trim harness.

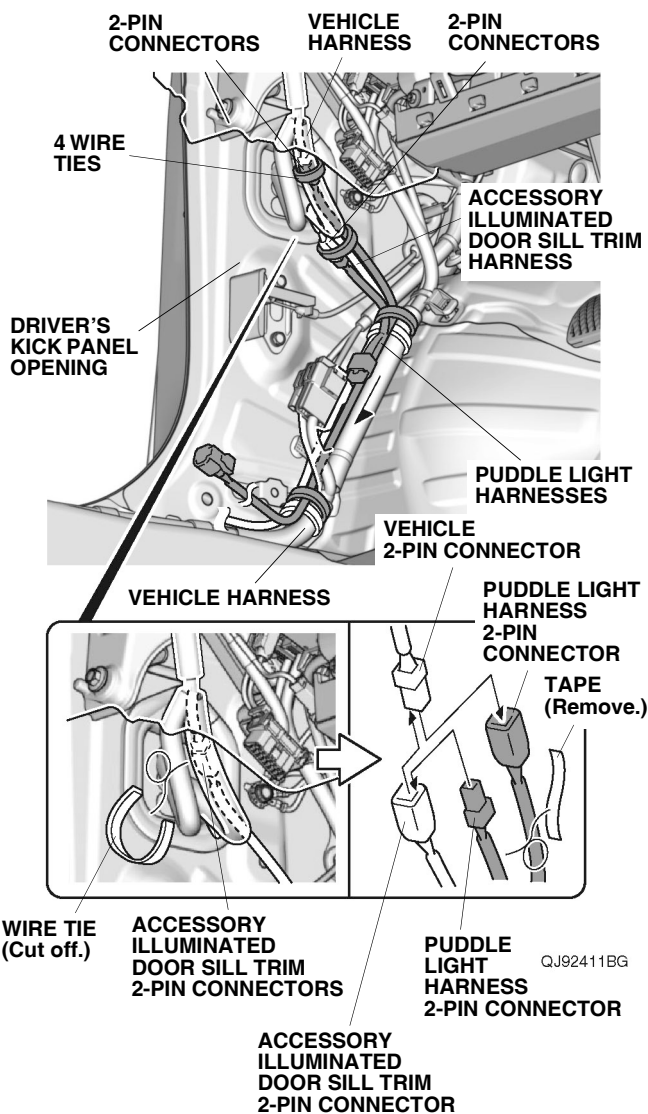

30. Remove the tape to free the puddle light harness 2-pin connector, and plug the puddle light harness 2-pin connector into the accessory illuminated door sill trim 2-pin connector.
31. Secure the 2-pin connectors to the vehicle harness with one wire tie.
32. Secure the 2-pin connectors and puddle light harness to the accessory illuminated door sill trim harness with one wire tie.
33. Route the puddle light harness along the vehicle harness, and secure it to the vehicle harness with two wire ties.

34. Cut off the wire tie from the accessory illuminated door sill trim 2-pin connectors. Unplug the vehicle 2-pin connector, and plug it into the puddle light harness 2-pin connector.

NOTE: Be careful not to damage the accessory illuminated door sill trim harness.

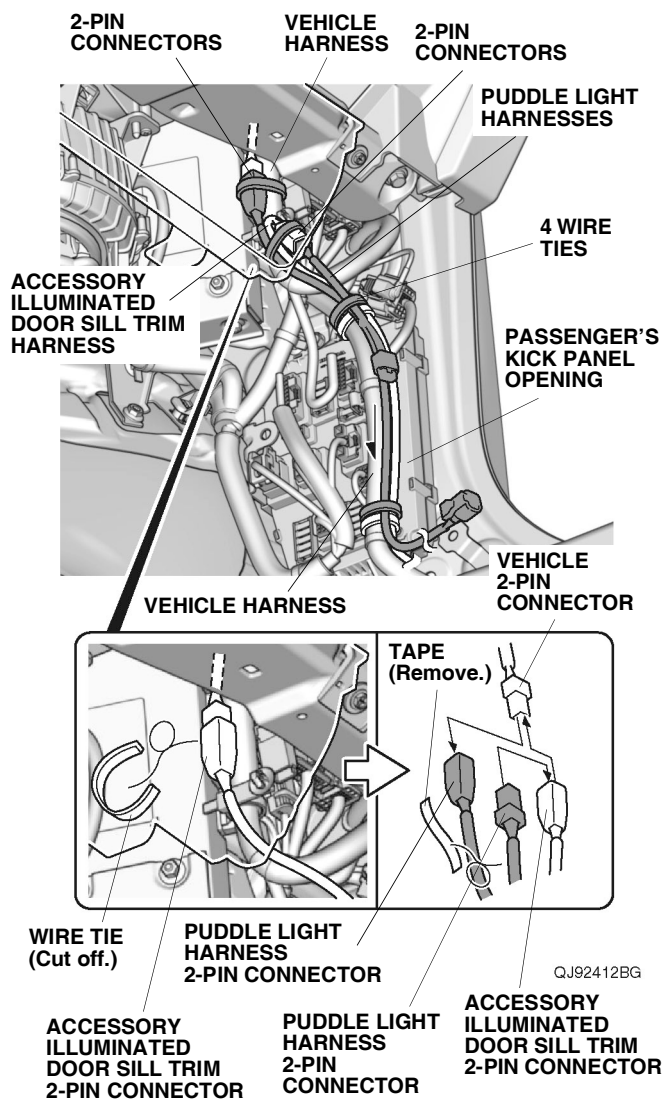

35. Remove the tape to free the puddle light harness 2-pin connector, and plug the puddle light harness 2-pin connector into the accessory illuminated door sill trim 2-pin connector.
36. Secure the 2-pin connectors to the vehicle harness with one wire tie.
37. Secure the 2-pin connectors, puddle light harness, and accessory illuminated door sill trim harness to the vehicle harness with one wire tie.
38. Route the puddle light harness along the vehicle harness, and secure it to the vehicle harness with two wire ties.

39. Release the clip as shown. Peel back the floor carpet, and remove the vehicle grommet.

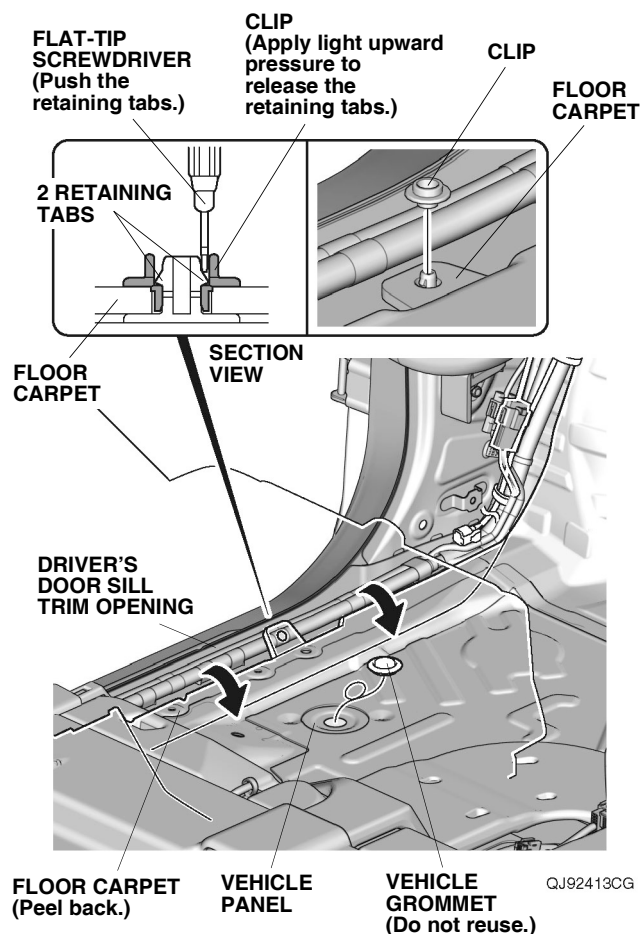

40. Route the puddle light harness as shown, and install the grommet on the puddle light harness to the vehicle panel hole.

NOTE:

- Install the puddle light harness by holding the grommet.
- Make sure the grommet is seated properly.

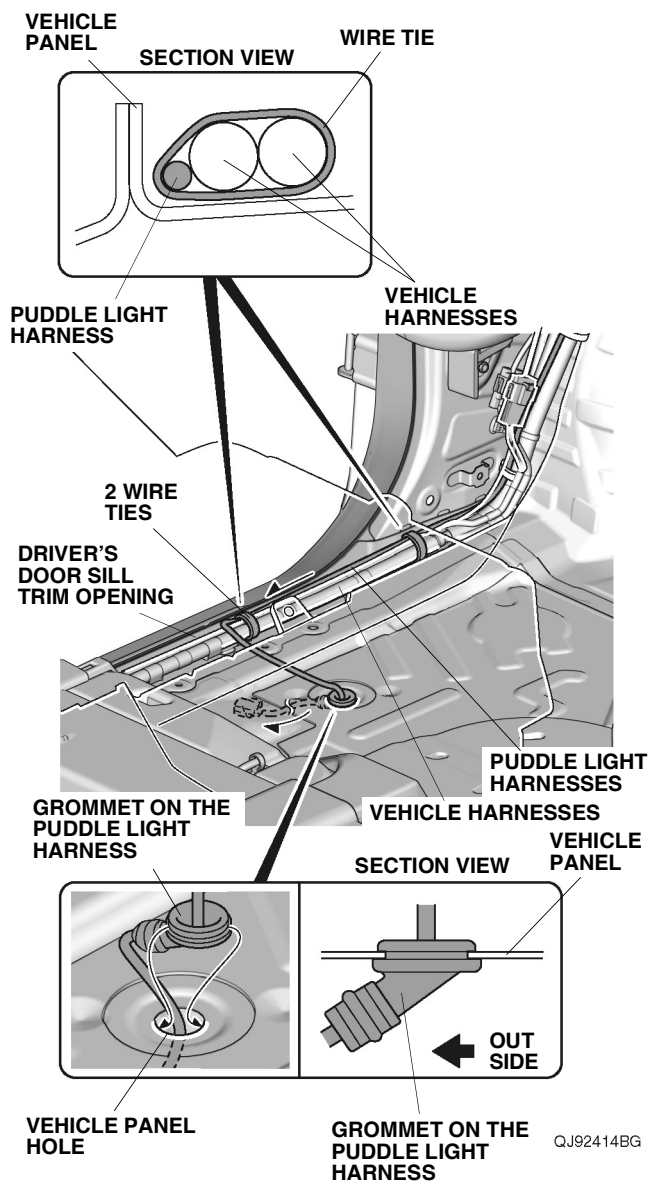

43. Line up the front and rear templates as shown, and secure them to the left side sill trim with masking tape.

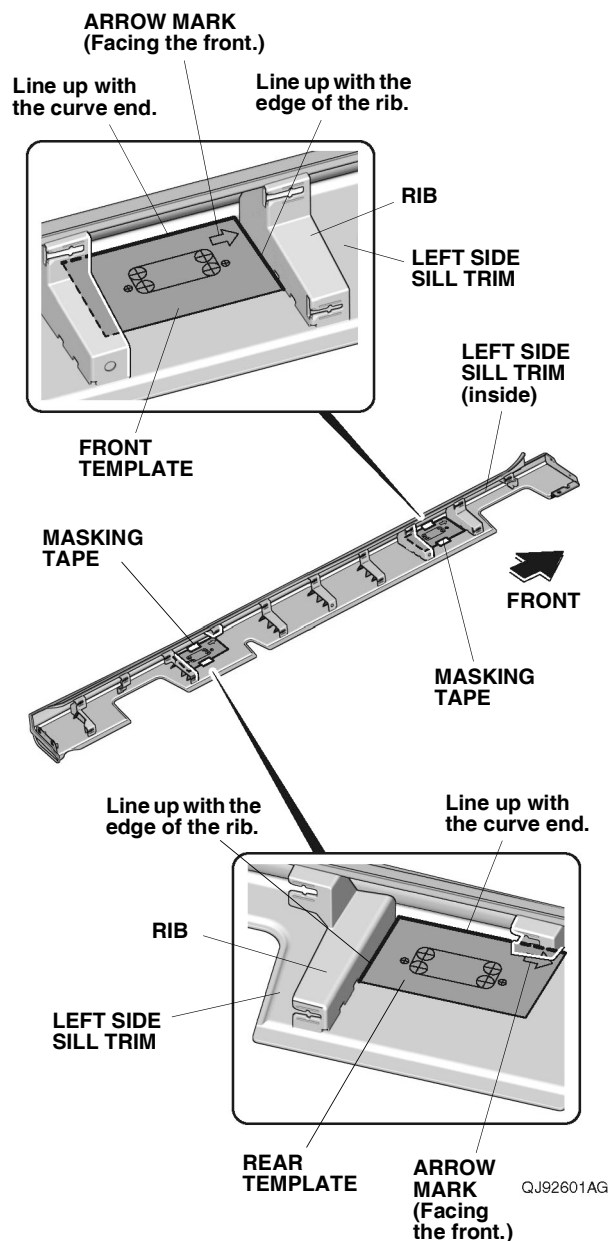

41. Secure puddle light harness to the vehicle harness with two wire ties as shown.
42. Repeat steps 39 through 41 on the right side of the vehicle.

44. Using a pushpin, pierce the inside of the left side sill trim through the center of the 12 printed marks. Remove the front template and rear template.
NOTE: Make sure to pierce perpendicular to the left side sill trim.

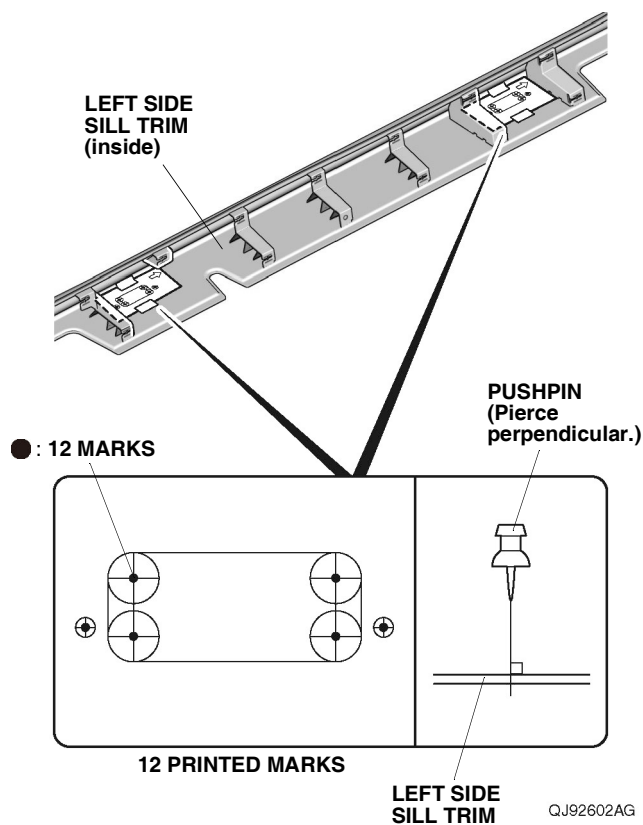

45. While wearing eye protection, drill the 12 pierced marks on the left side sill trim with a 3 mm drill bit. NOTE: Make sure to drill perpendicular to the left side sill trim.

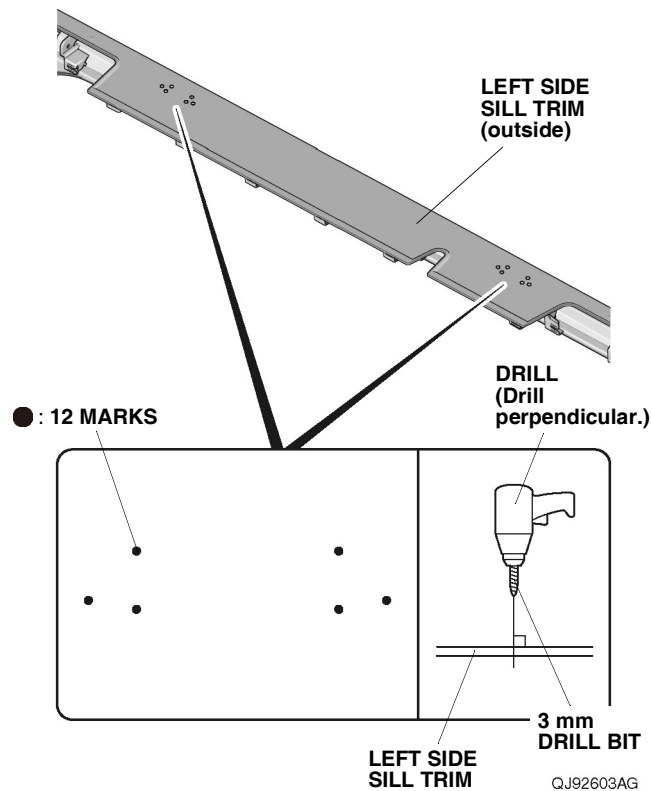

46. While wearing eye protection, enlarge four of the 3 mm holes on the left side sill trim with a 6 mm drill bit. Remove any burrs.

NOTE:

- Make sure to drill the correct positions.
- Make sure to drill perpendicular to the left side sill trim.

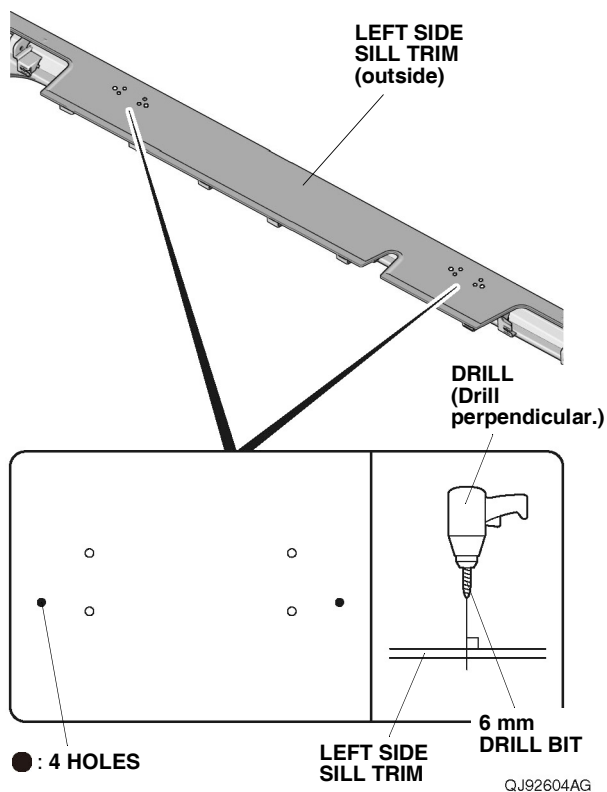

47. While wearing eye protection, enlarge eight of the 3 mm holes on the left side sill trim with a 15 mm hole saw.

NOTE:

- Make sure to drill the correct positions.
- Make sure to drill perpendicular to the left side sill trim.

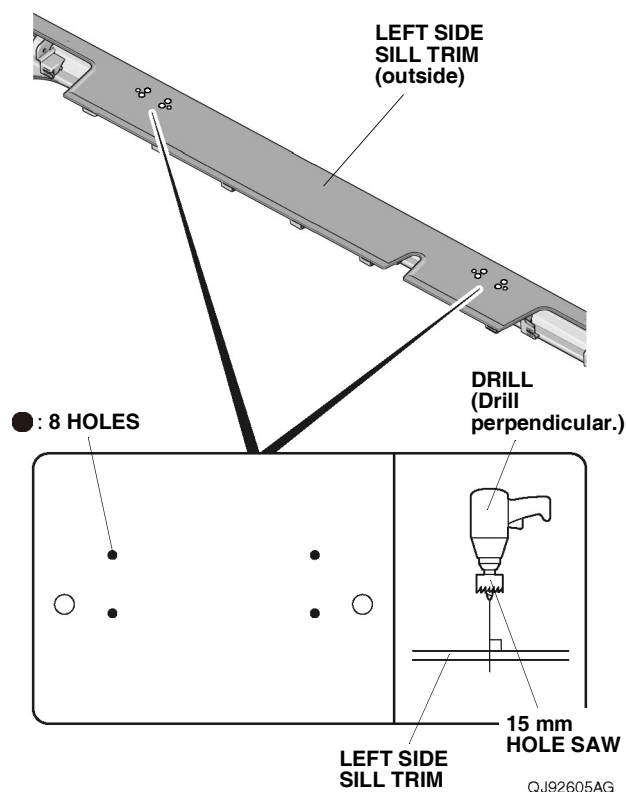

48. While wearing eye protection, using an air saw, cut out the left side sill trim as shown. Remove any burrs.

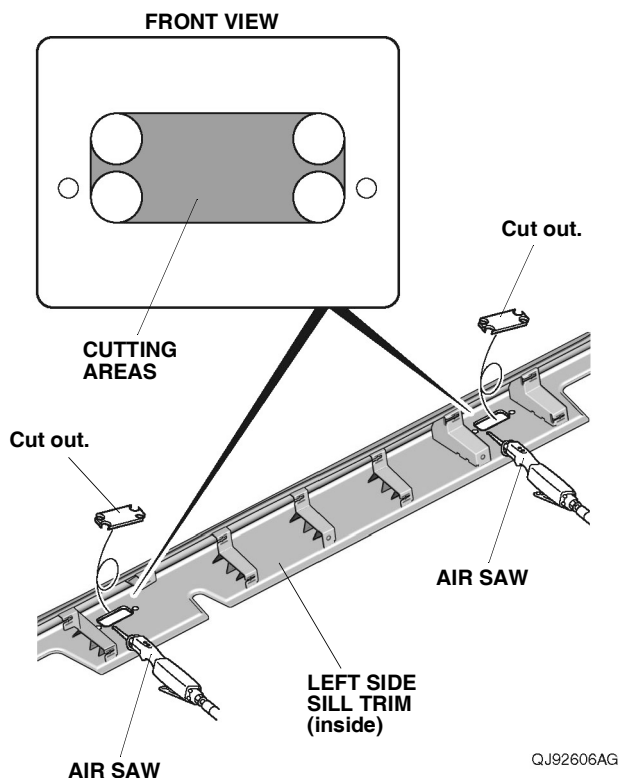

49. Using a pushpin, pierce the inside of the left side sill trim through the center of the four ribs on the left side sill trim.

NOTE: Make sure to pierce perpendicular to the left side sill trim.

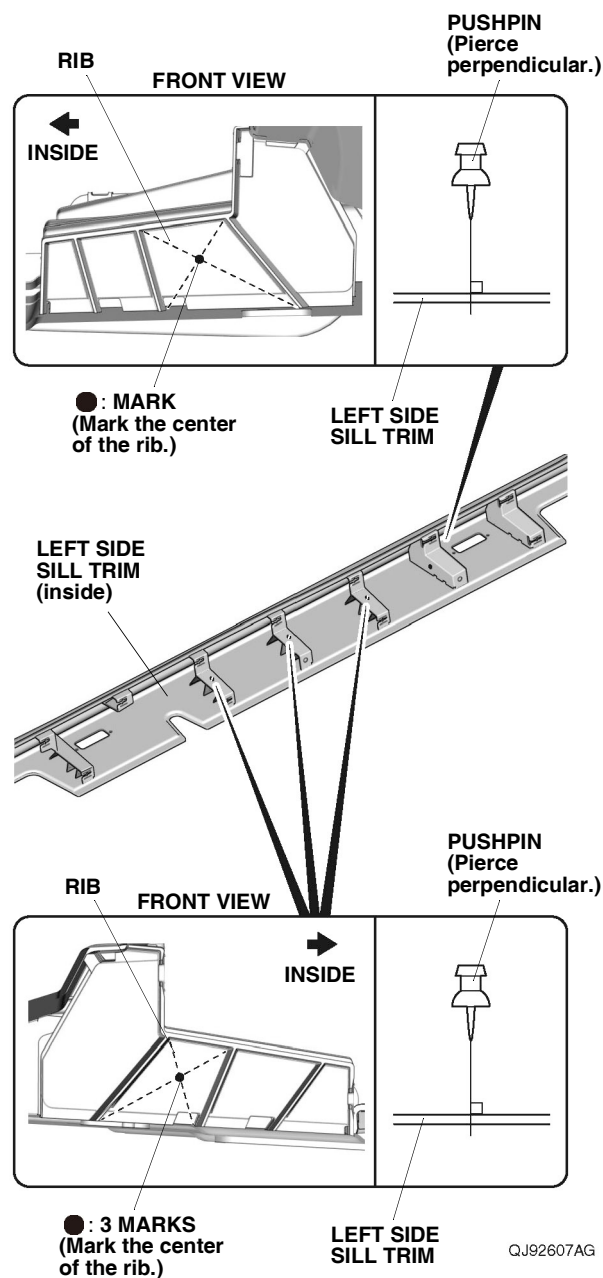

50. While wearing eye protection, drill the four pierced marks on the left side sill trim with a 3 mm drill bit. **NOTE:** Make sure to drill perpendicular to the left side sill trim.

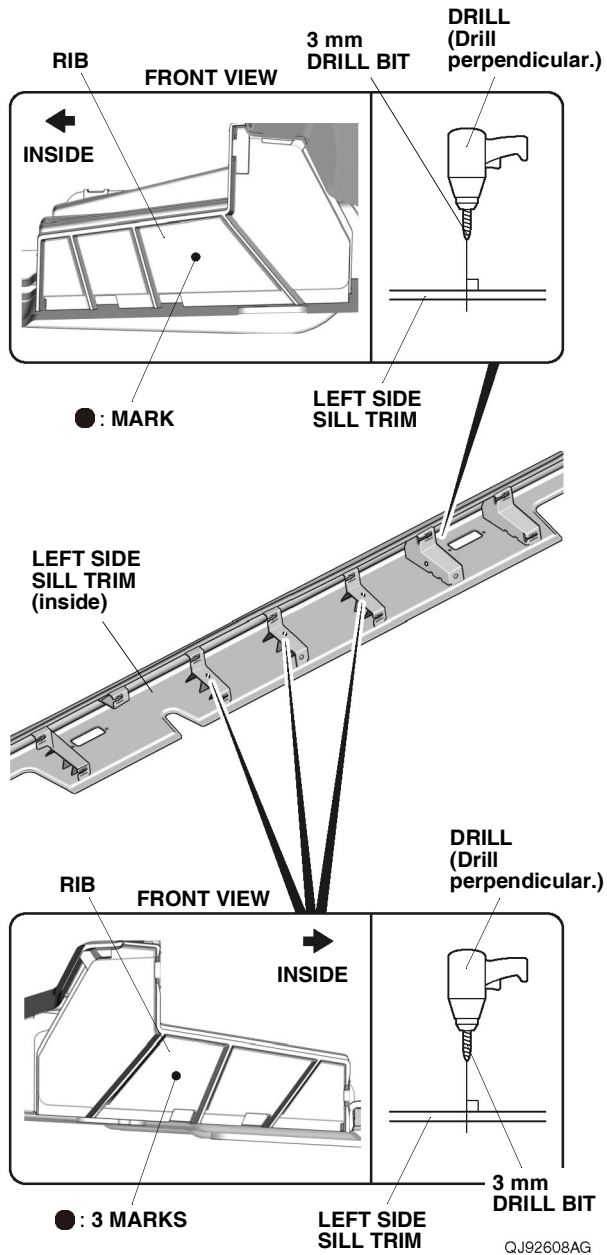

51. While wearing eye protection, enlarge the 3 mm holes on the left side sill trim with a 20 mm hole saw. **NOTE:** Make sure to drill perpendicular to the left side sill trim.

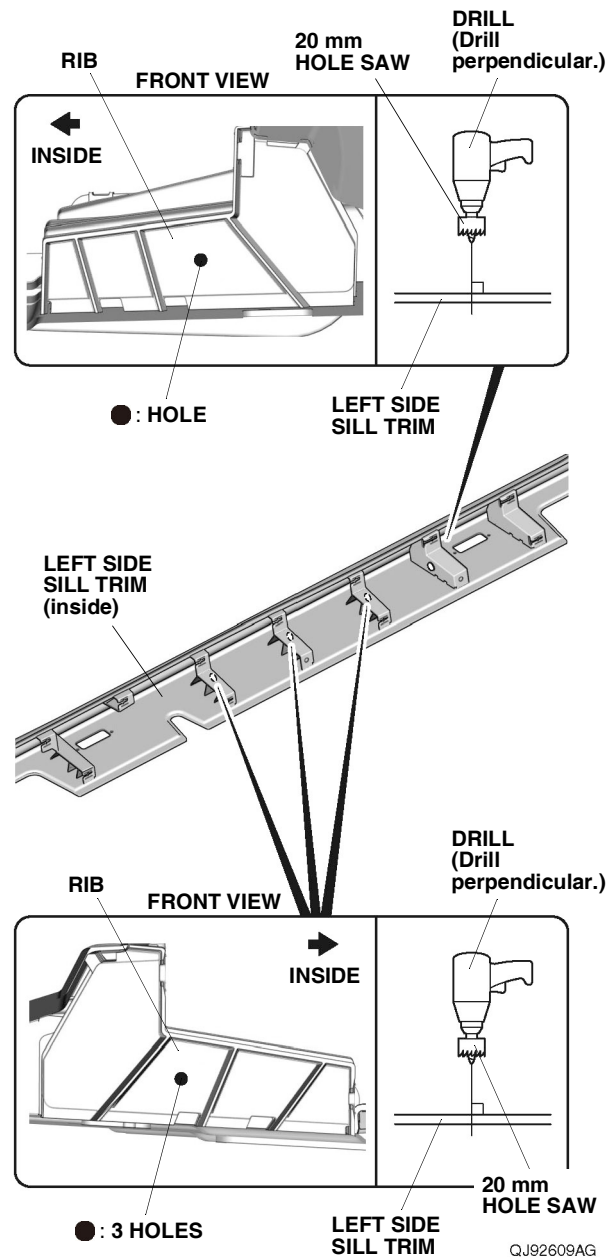

52. Using a pushpin, pierce the left side sill trim as shown.
NOTE: Make sure to pierce perpendicular to the left side sill panel.

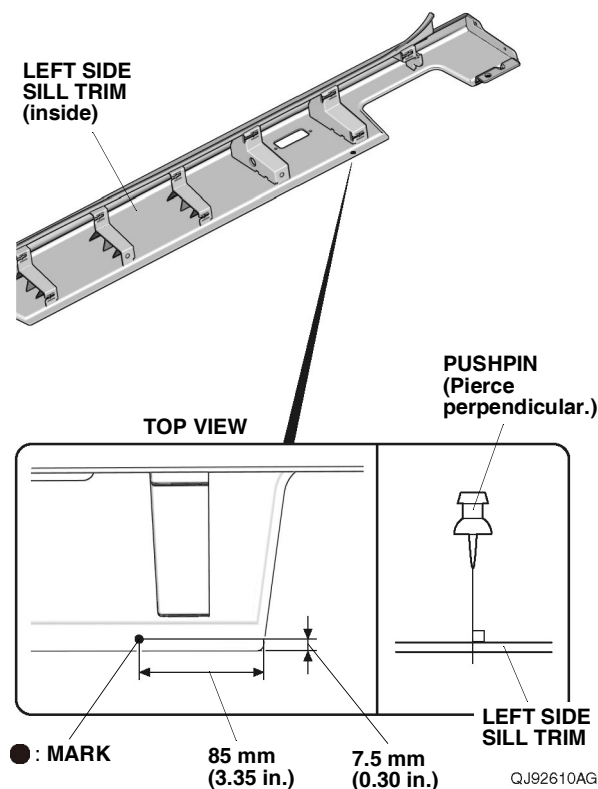

53. While wearing eye protection, drill the pierced mark on the left side sill trim to 7 mm. First drill with a 3 mm drill bit, next with a 6 mm drill bit, and finish with a 7 mm drill bit. Remove any burrs.
NOTE: Make sure to drill perpendicular to the left side sill trim.

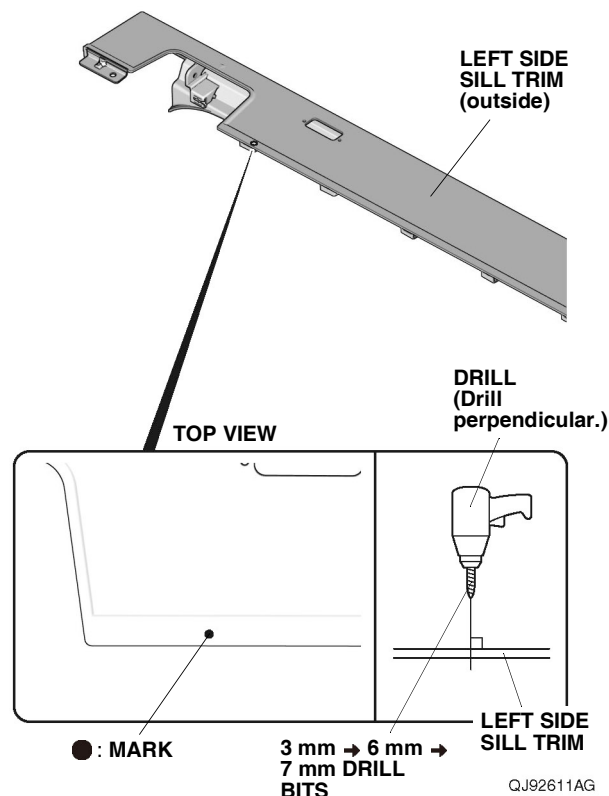

54. Turn the front template and rear template over, and repeat steps 43 through 53 on the right side sill trim.

55. Install the two lights and two light trims to the left side sill trim with four self-tapping screws.

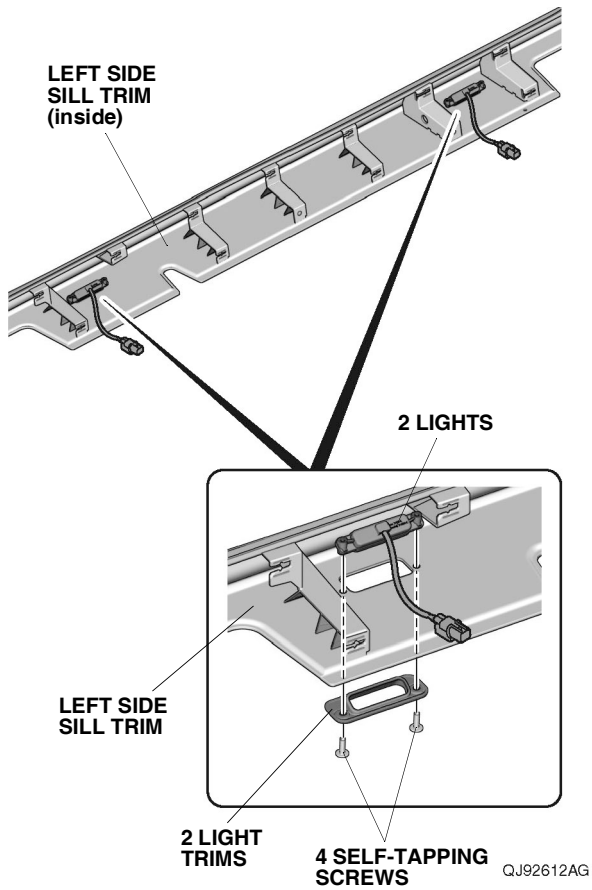

56. Using scissors, cut one urethane tape in half, and wrap one piece of urethane tape around each light 2-pin connector as shown.

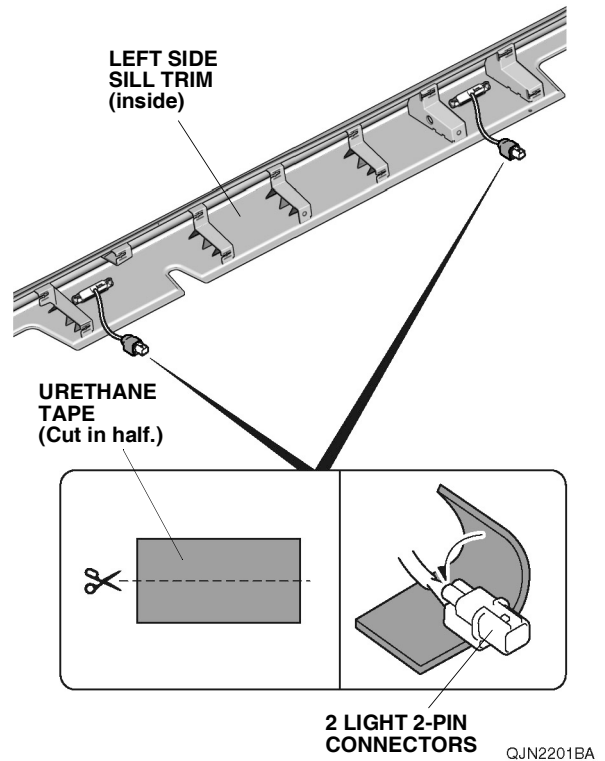

57. Using scissors, cut one urethane tape in half, and wrap one piece of urethane tape around the subharness 2-pin connector as shown.

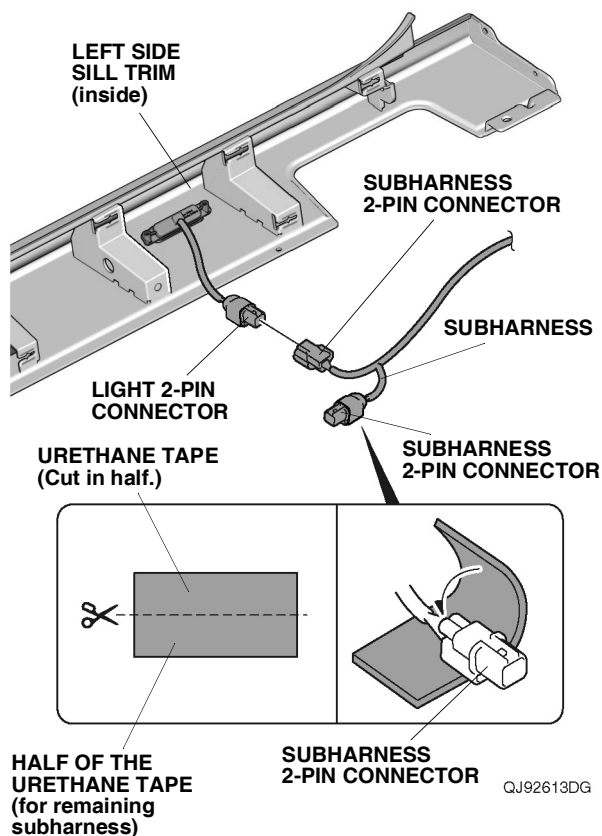

58. Plug the light 2-pin connector into the subharness 2-pin connector.

59. Secure the 2-pin connectors and subharness 2-pin connector to the rib on the left side sill trim with one wire tie as shown.

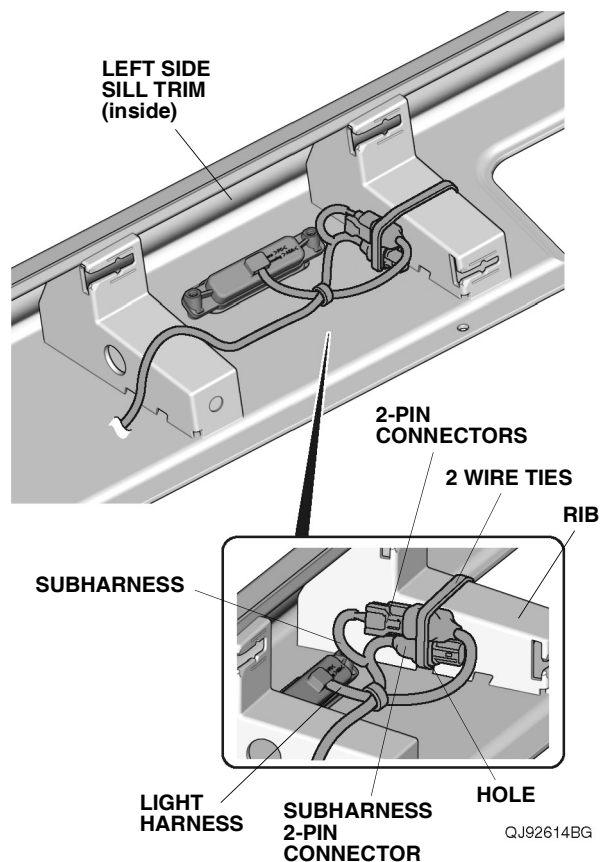

60. Secure the subharness to the light harness with one wire tie as shown.

61. Route the subharness through the four holes on the left side sill trim as shown.

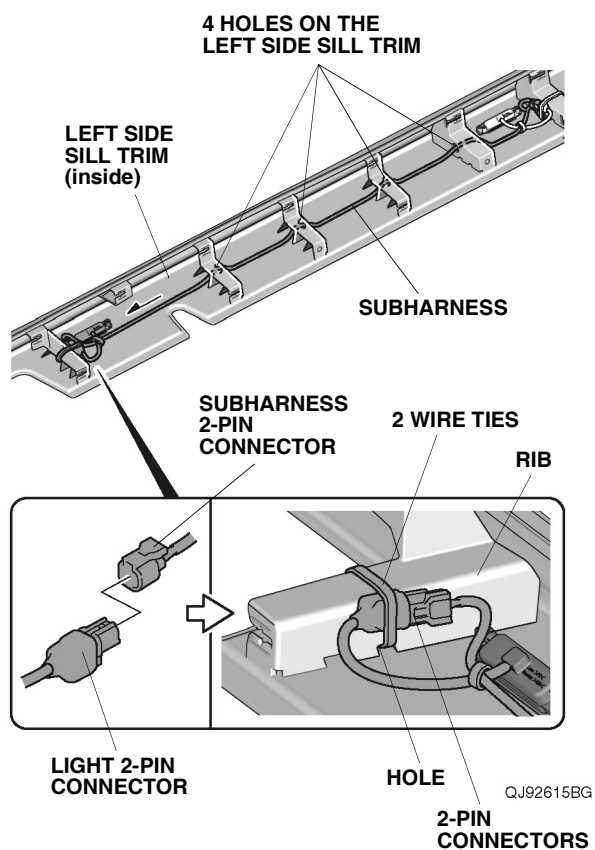

62. Plug the light 2-pin connector into the subharness 2-pin connector. Secure the 2-pin connectors to the rib on the left side sill trim with one wire tie as shown.
63. Secure the subharness to the light harness with one wire tie as shown.

64. Secure the subharness to the left side sill trim with four wire ties as shown.

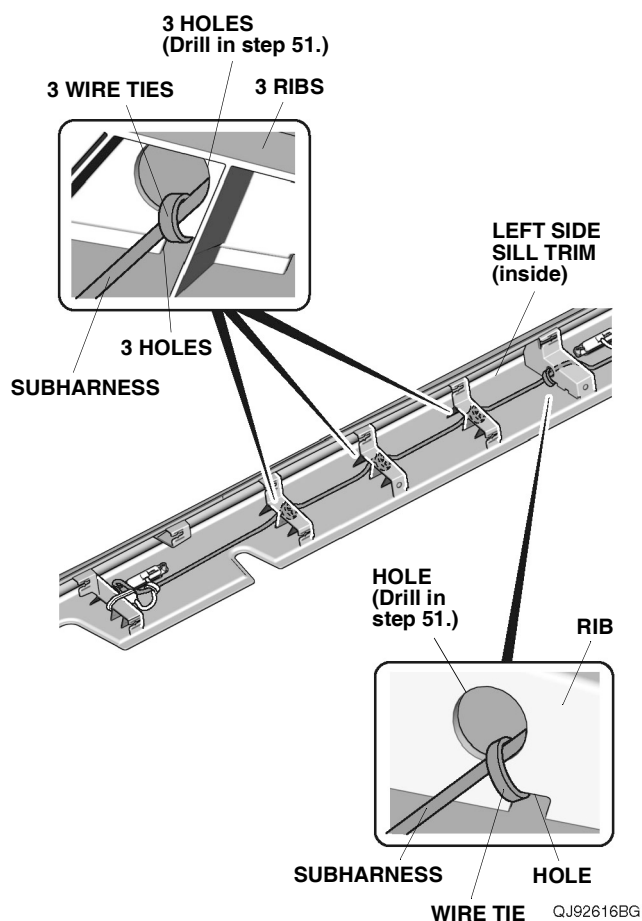

65. Install the 10 clips removed in step 17 to the left side sill trim.

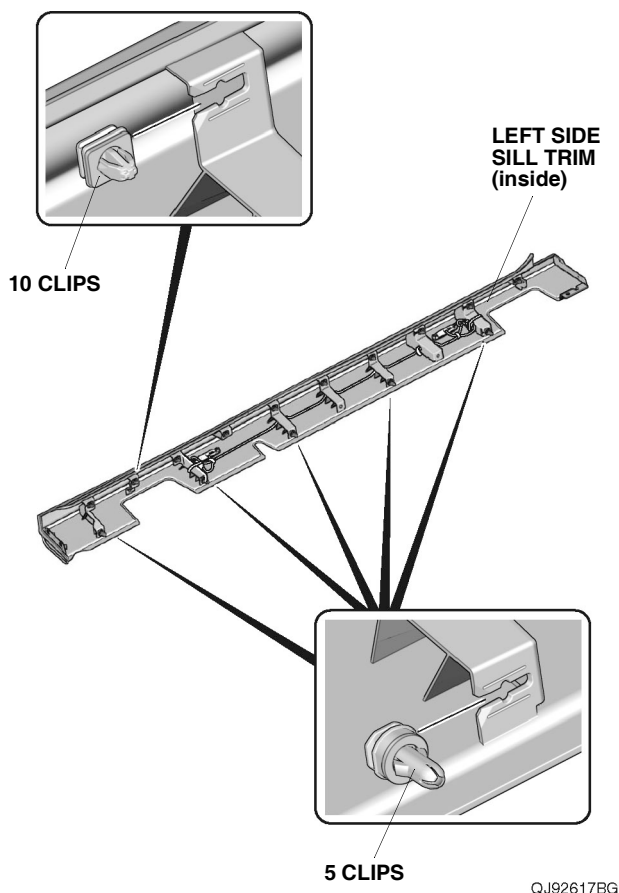

66. Install the five clips removed in step 18 to the left side sill trim.

67. Bring the left side sill trim into position. Plug the puddle light harness 2-pin connector into the subharness 2-pin connector.

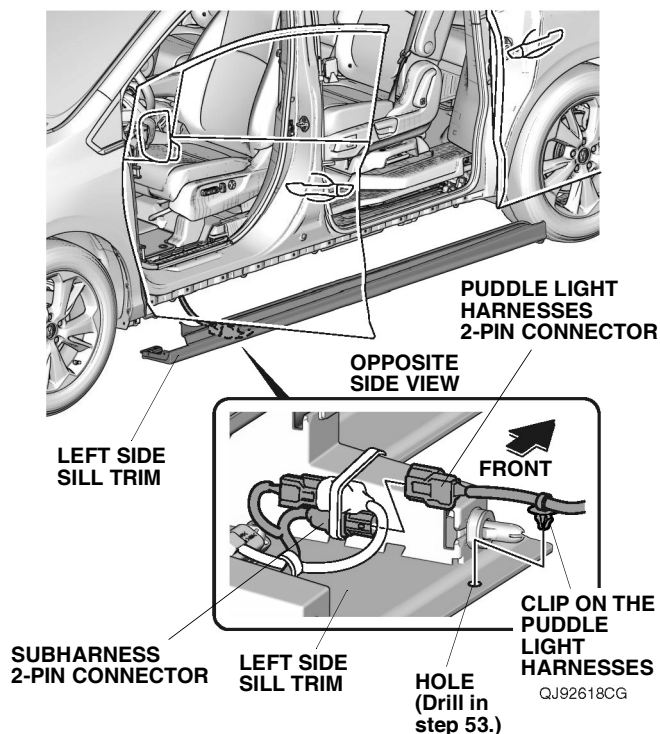

68. Secure the puddle light harness to the left side sill trim with clip on the puddle light harness.
69. Install the left side sill trim to the vehicle.
NOTE: Make sure that puddle light harness is not pinched.
70. Repeat steps 55 through 69 on the right side of the vehicle.
71. Check that all wire harnesses are routed properly and all connectors are plugged in.
72. Install all removed parts except for the front bulkhead cover and the intake air tube.
73. Connect the negative cable to the battery.
74. Install the front bulkhead cover and the intake air tube.
75. Press and hold the audio unit power button for 2 seconds to restore the audio and navi (if equipped) system functions.
76. Set the clock on vehicles without navigation.
77. If necessary, restore the systems back to normal operation as described in the service information.

Check the Operation of the Puddle Lights

78. Make sure the light comes on when you open each door.