



SERVICE INSTRUCTIONS

Items	Application	Publications No.
Service Parts	2024 Motocompacto	VERSION 1
		Issue Date OCT 2023

Contents

Location Index	4
Removal and Installation	
Left and Right Panels	5
Disconnecting the Battery Connectors.....	6
Front Wheel Covers	6
Front Wheel	7
Headlight.....	8
Charge Port.....	9
Taillight.....	9
Battery.....	11
Footpegs.....	12
Kickstand	12
Rear Fender.....	13
Rear Wheel	13
Brake Shoes	14
Rear Arm Sensor	14
Endcaps	15
Grips	16
Display	16
Handlebar	17
Brake Lever Assembly.....	18
Brake Cable	18
Throttle.....	20
Control Unit.....	21
Seat Cushion	22
Maintenance	
Brake Adjust.....	22
Brake Cable Lubrication	23
Footpeg Lubrication	24
Troubleshooting	
Error Codes & Troubleshooting	25

GENERAL VIEW

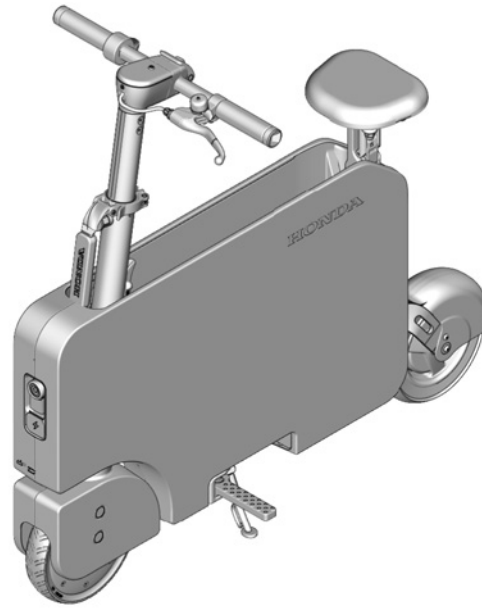

QM90133BH





FOR YOUR SAFETY (Read carefully.)

Warning Symbols

Safety: Your safety, and the safety of others, is important. To help you make informed decisions about service procedures, we have provided safety messages where appropriate. Of course, it is not practical or possible to warn you about all the hazards associated with servicing a vehicle - you must use your own good judgment.

You will find important safety messages preceded by one of the following symbols:

*All symbols are not used in all service instructions.

- | | |
|--|--|
|  DANGER | You will be killed or seriously hurt if you do not follow the instructions. |
|  WARNING | You can be killed or seriously hurt if you do not follow the instructions. |
|  CAUTION | You can be hurt if you do not follow the instructions. |
| NOTICE | Gives advice to prevent damage to the product, vehicle, the environment or other property. |
| NOTE | Gives helpful information or instructions to be followed when installing this product. |
|  | Indicates a prohibited action. |

Safety:

- Observe all safety notes and precautions described in the service instructions. Be extremely careful for your safety and the safety of others.
- Be careful not to damage the vehicle or the parts.
- Be extremely careful when handling retaining tabs and clips.
- Note the locations of the parts before removing them so they can be properly installed in their original positions.
- The illustrations may differ slightly from the actual accessory.
- Always use the parts and tools specified in the service instructions.

REQUIRED TOOLS AND SUPPLIES

- Phillips screwdriver
- Stubby Phillips screwdriver
- Flat-tip screwdriver
- Ratchet
- Torque wrench
- Blanket
- 2.5 mm, 3 mm, 4 mm, and 5 mm Hex bit sockets

The following tools are available through the Honda Tool and Equipment Program:

- Trim Tool Set (T/N SOJATP2014)
- Plastic Trim Tool (T/N SILTRIMTL10)

Location Index

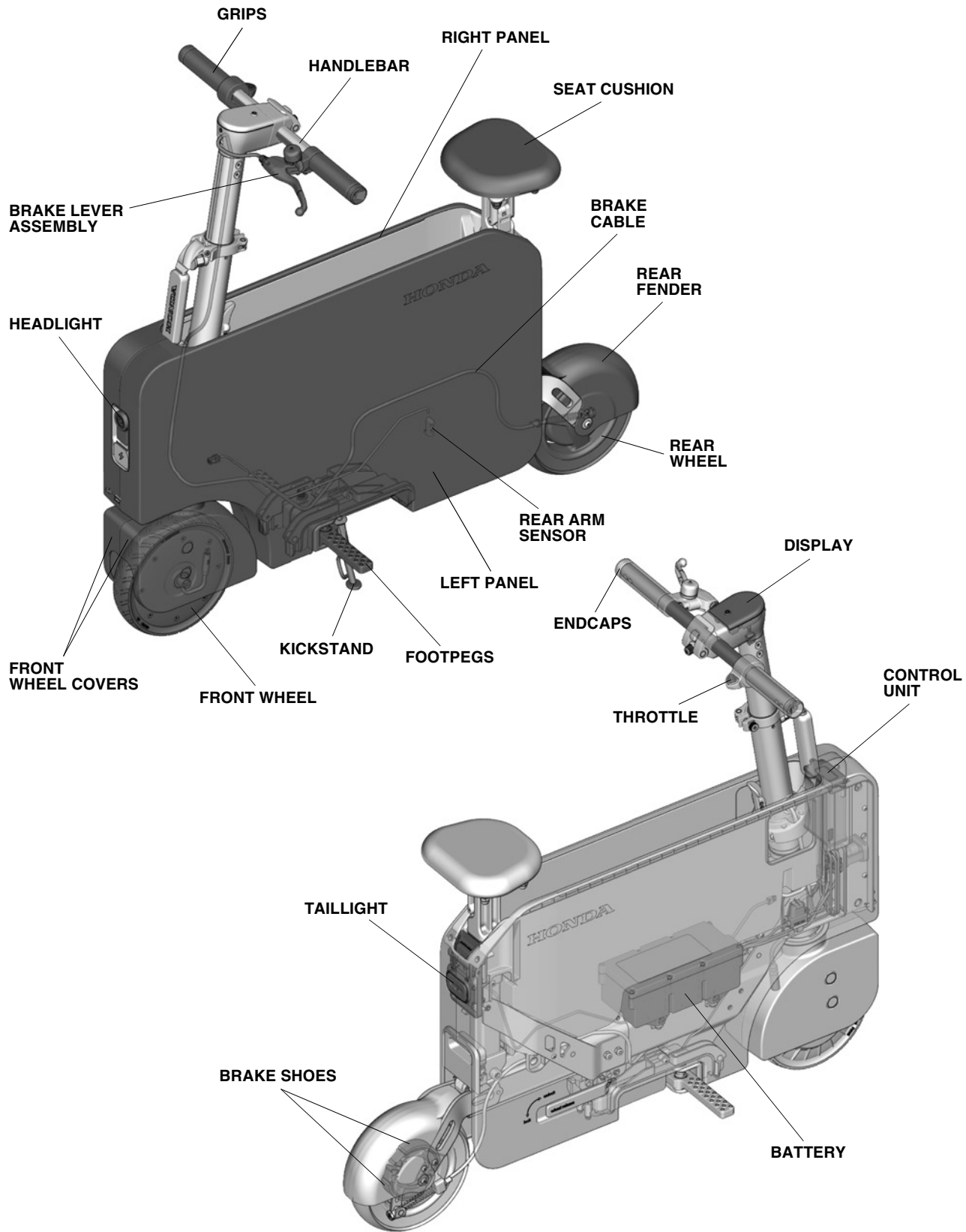

QM90132BH

Removal and Installation

Left and Right Panels

Removal

1. Release the lever.
2. Remove the screws.

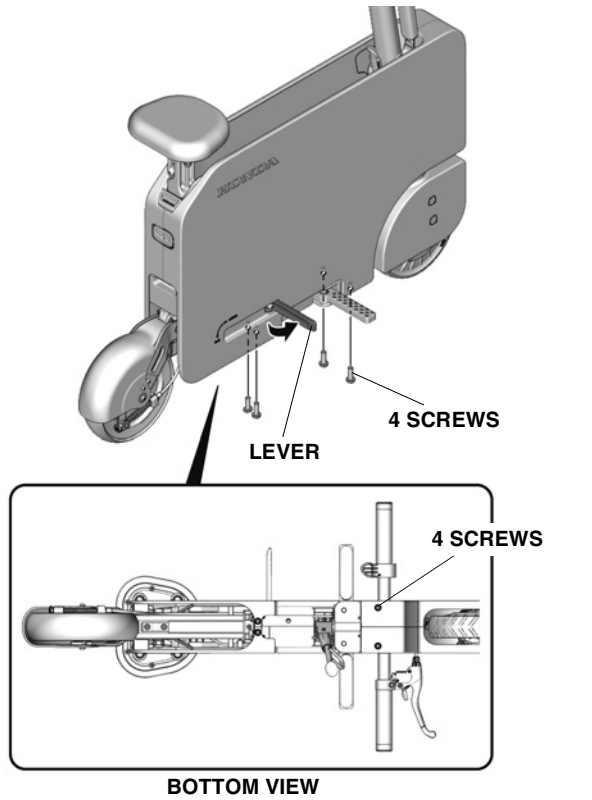

3. Remove the right panel and then remove the left panel.

NOTE

Release the tabs in the order shown.

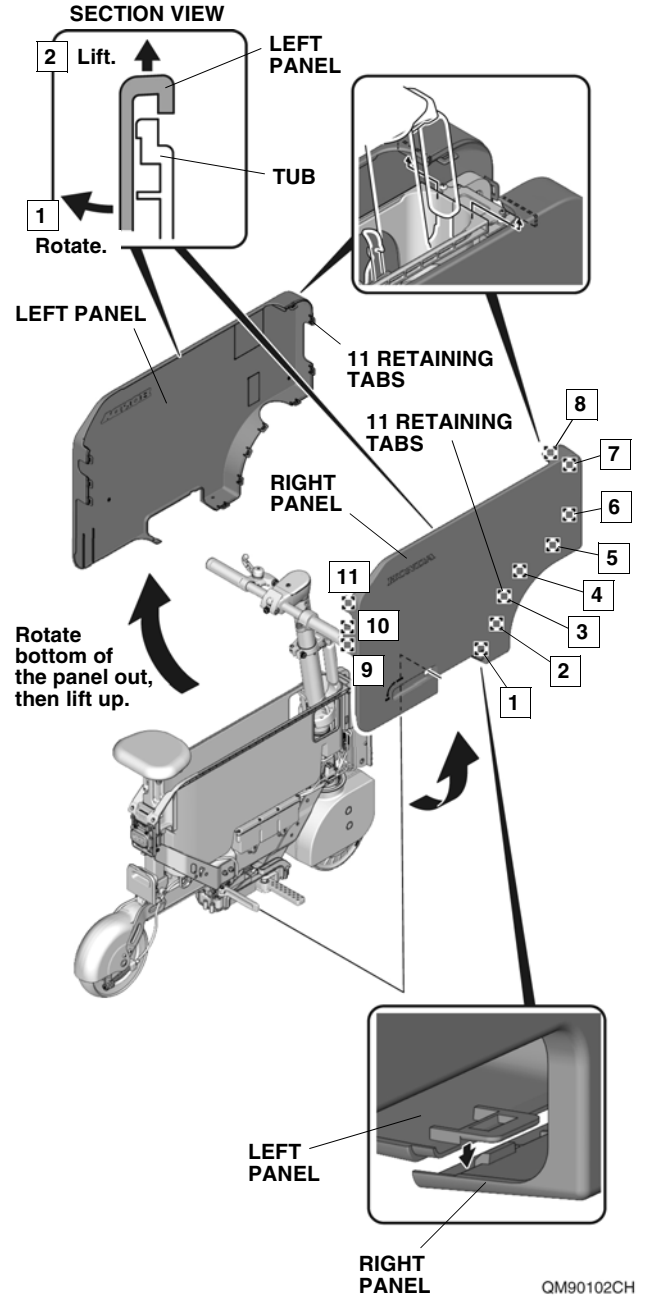

Installation

1. Install the parts in the reverse order of removal.

Disconnecting the Battery Connectors

Removal

1. Remove the left and right panels.
(Refer to **Left and Right Panels.**)

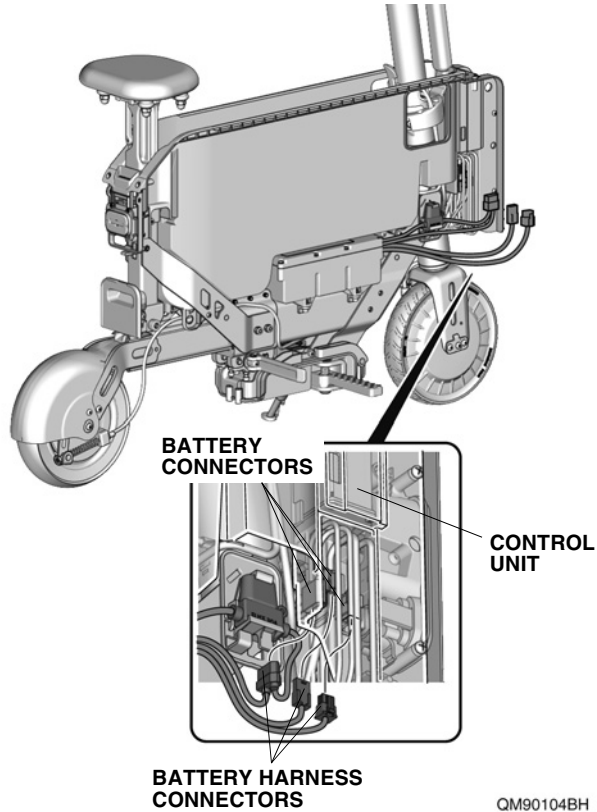

2. Disconnect the battery harness connectors.
(Disconnect the yellow battery harness connector first.)

Installation

1. Install the parts in the reverse order of removal.

Front Wheel Covers

Removal

1. Remove the left and right panels.
(Refer to **Left and Right Panels.**)

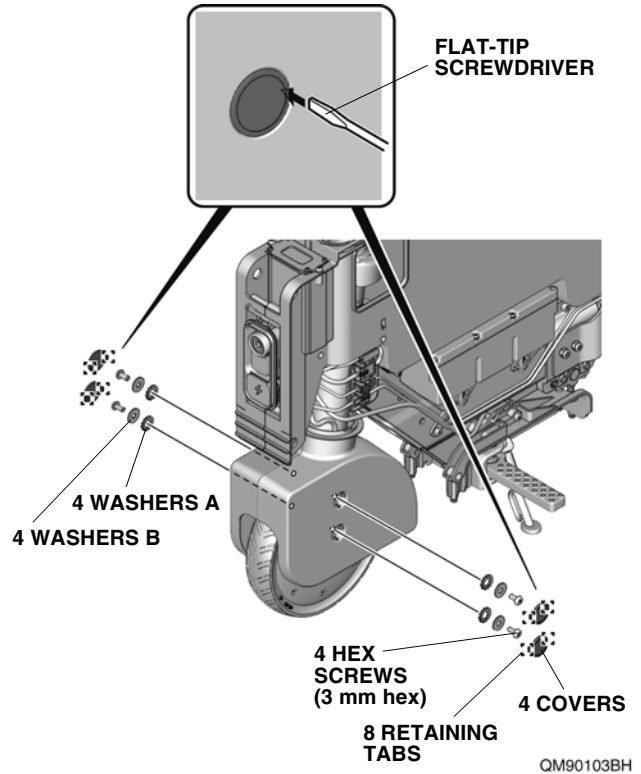

2. Remove the HEX screws.

3. Remove the right and left wheel covers.

NOTE

Release the tabs in the order shown.

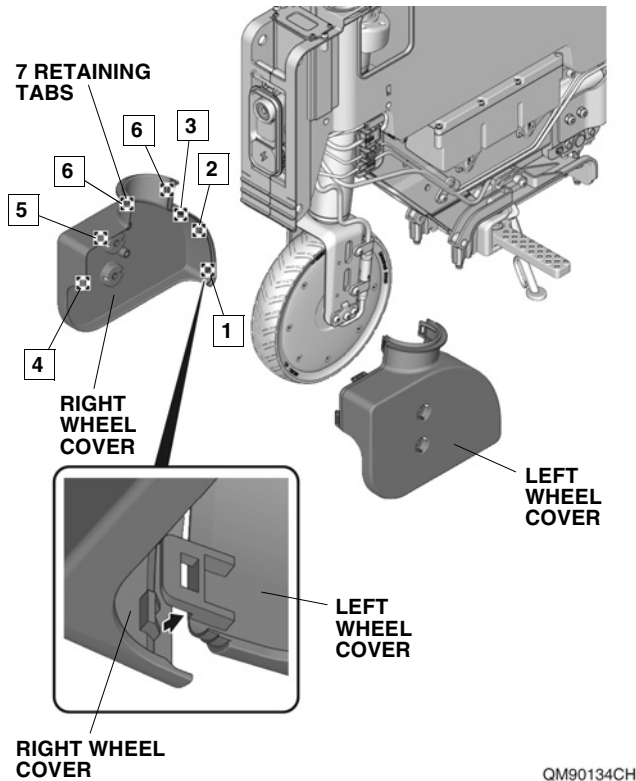

Installation

1. Install the parts in the reverse order of removal.

Front Wheel

Removal

1. Remove the left and right panels.
(Refer to **Left and Right Panels.**)

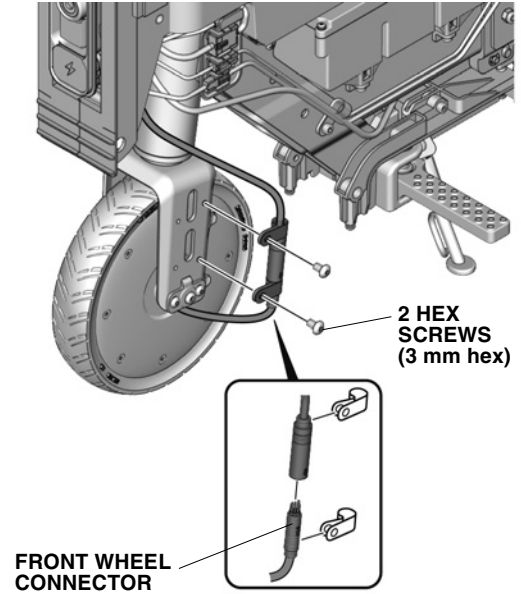

2. Disconnect the battery connectors.
(Refer to **Disconnecting the Battery Connectors.**)
3. Remove the front wheel covers.
(Refer to **Front Wheel Covers.**)
4. Disconnect the front wheel connector.

5. Remove the front wheel.

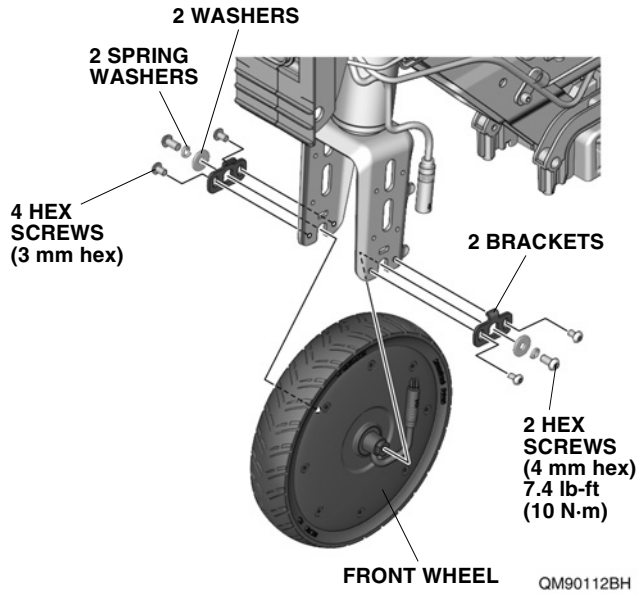

Installation

1. Install the parts in the reverse order of removal.

Headlight

Removal

1. Remove the left and right panels. (Refer to **Left and Right Panels.**)
2. Disconnect the battery connectors. (Refer to **Disconnecting the Battery Connectors.**)
3. Disconnect the headlight harness connector.
4. Remove the headlight assembly.

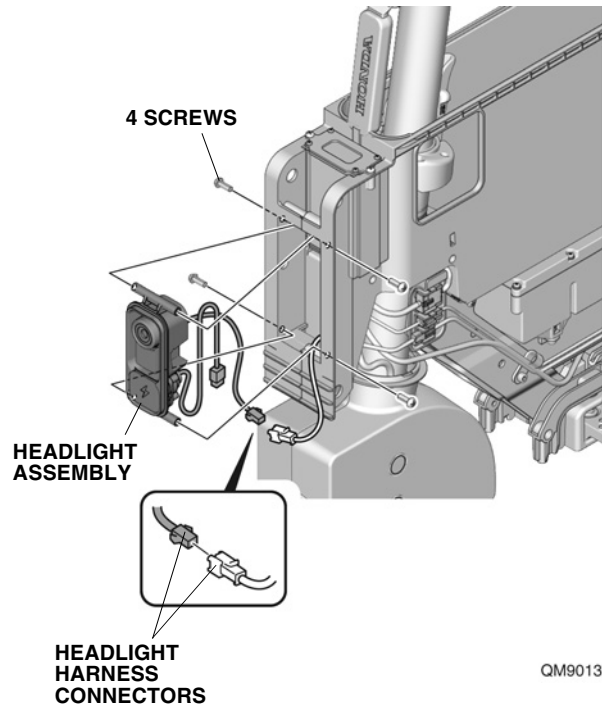

5. Remove the headlight.

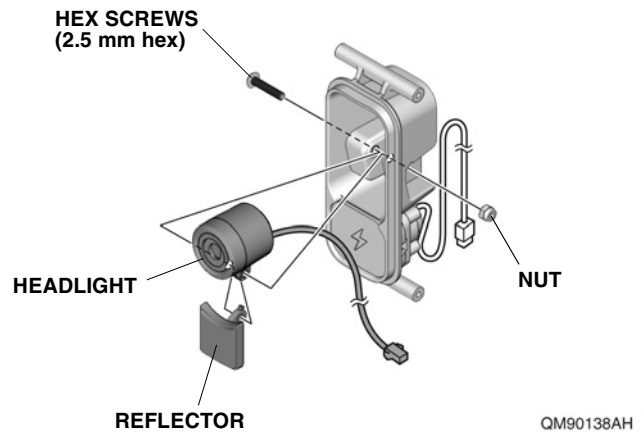

Installation

1. Install the parts in the reverse order of removal.

Charge Port

Removal

1. Remove the left and right panels.
(Refer to **Left and Right Panels**.)
2. Disconnect the battery connectors.
(Refer to **Disconnecting the Battery Connectors**.)
3. Remove the headlight assembly.
(Refer to **Headlight**.)
4. Remove the charge port.

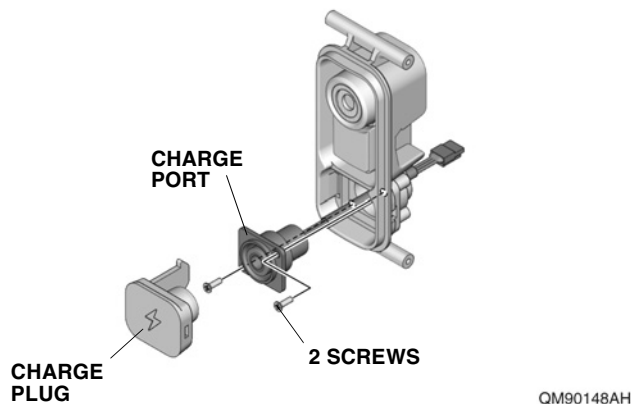

Installation

1. Install the parts in the reverse order of removal.

Taillight

Removal

1. Remove the left and right panels.
(Refer to **Left and Right Panels**.)

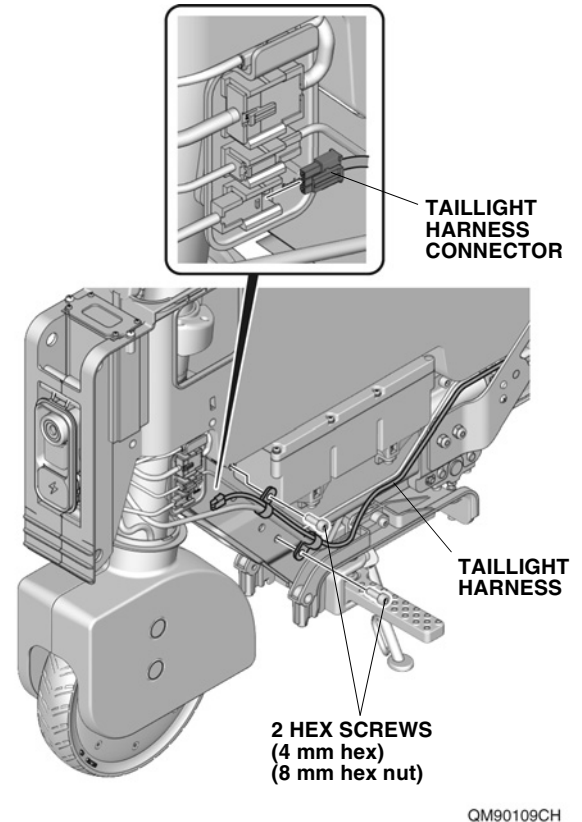

2. Disconnect the battery connectors.
(Refer to **Disconnecting the Battery Connectors**.)
3. Disconnect the taillight harness connector.
4. Remove the HEX screw.

5. Remove the screws.

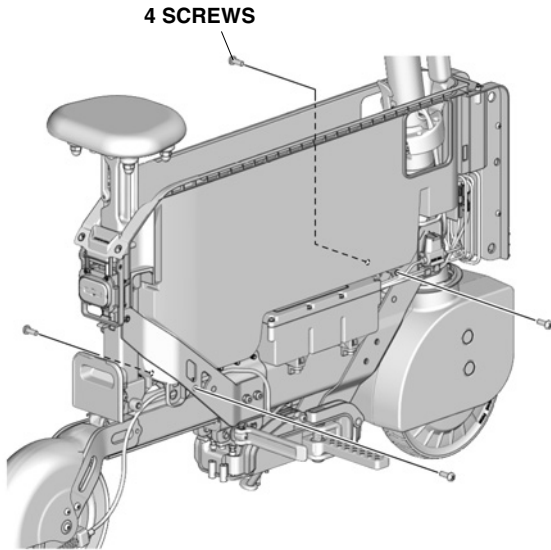

QM90139AH

6. Release the taillight harness.

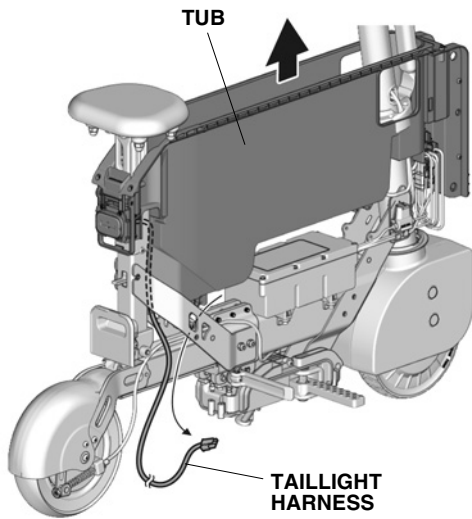

QM90140AH

7. Remove the taillight assembly.

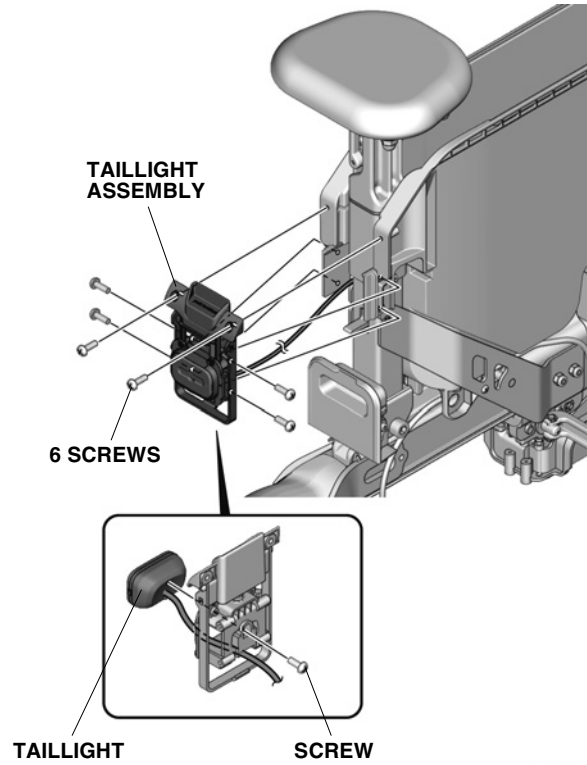

QM90110BH

8. Remove the taillight.

Installation

1. Install the parts in the reverse order of removal.

Battery

Removal

1. Remove the left and right panels.
(Refer to **Left and Right Panels.**)

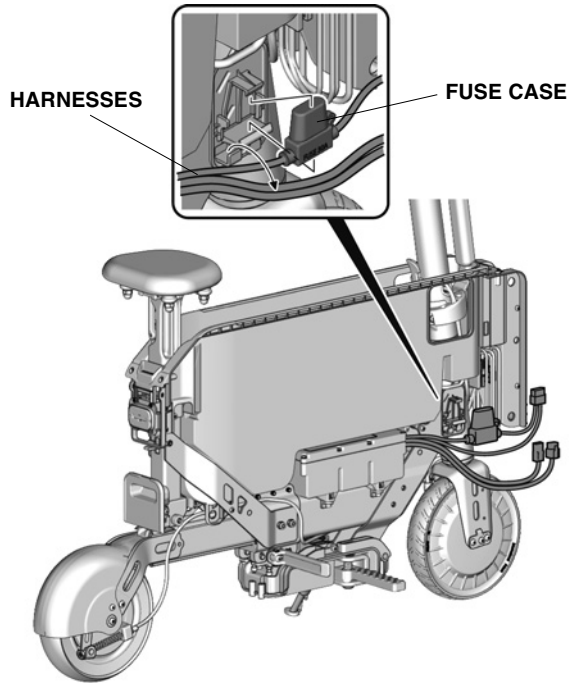

2. Disconnect the battery connectors.
(Refer to **Disconnecting the Battery Connectors.**)
3. Release the harnesses and fuse case.
4. Remove the screws and nuts.

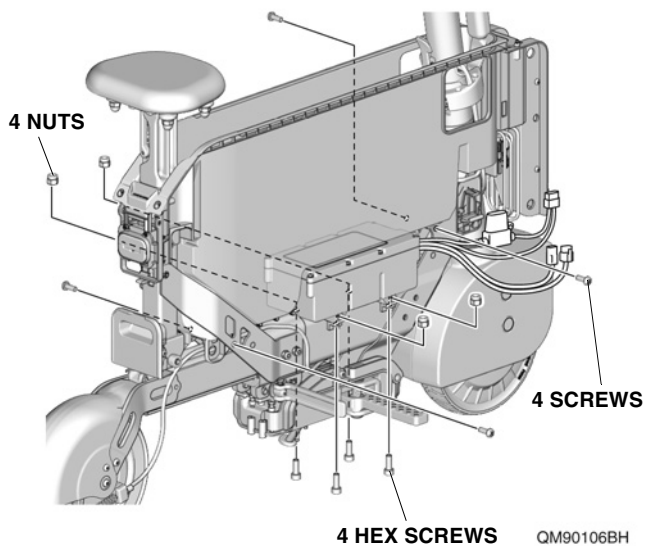

5. Remove the battery.

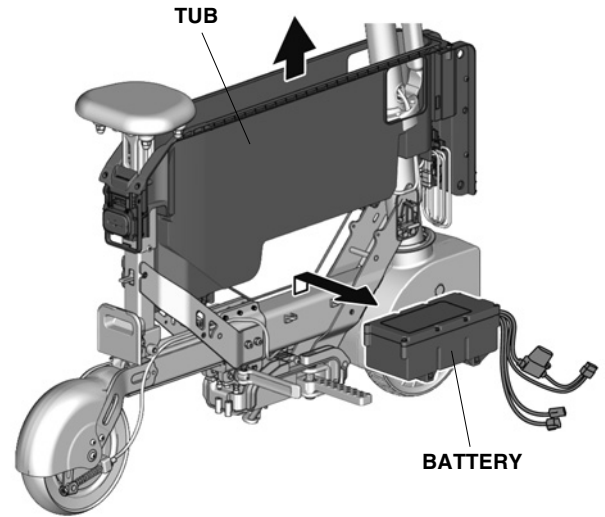

Installation

1. Install the parts in the reverse order of removal.

Footpegs

Removal

1. Remove the left and right panels.
(Refer to **Left and Right Panels**.)

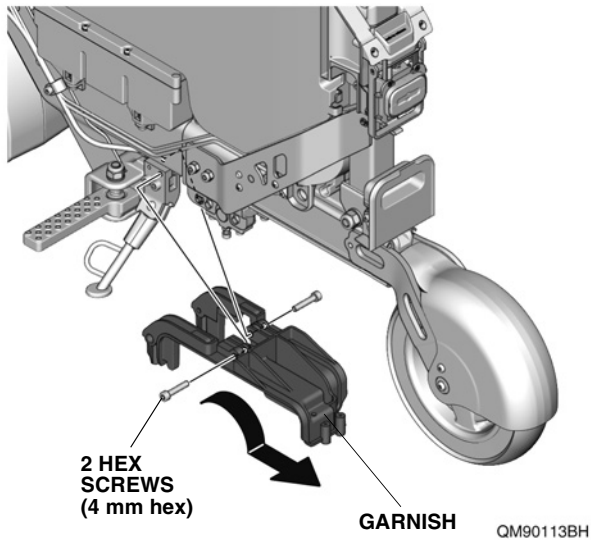

2. Remove the garnish.
3. Remove the left and right footpegs.

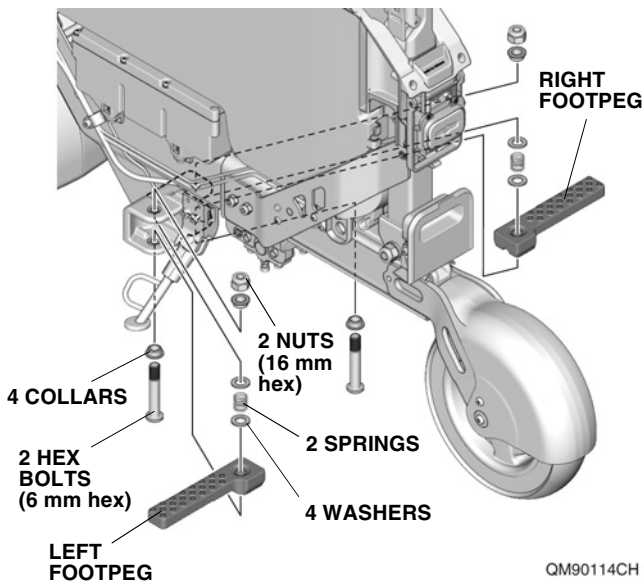

Installation

1. Install the parts in the reverse order of removal.

Kickstand

Removal

1. Remove the left and right panels.
(Refer to **Left and Right Panels**.)

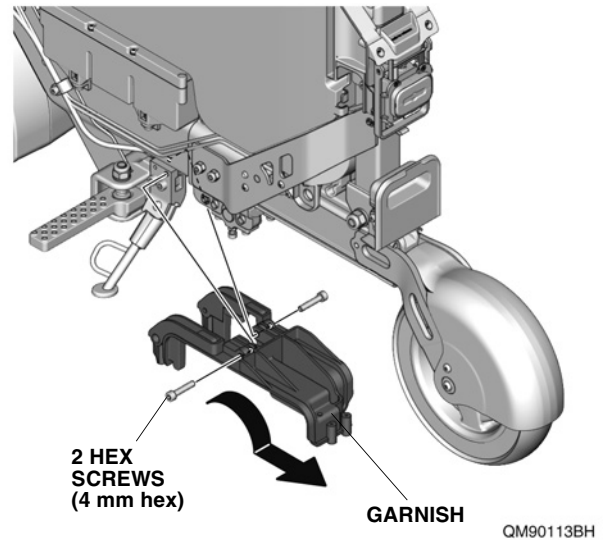

2. Remove the garnish.
3. Remove the kickstand.

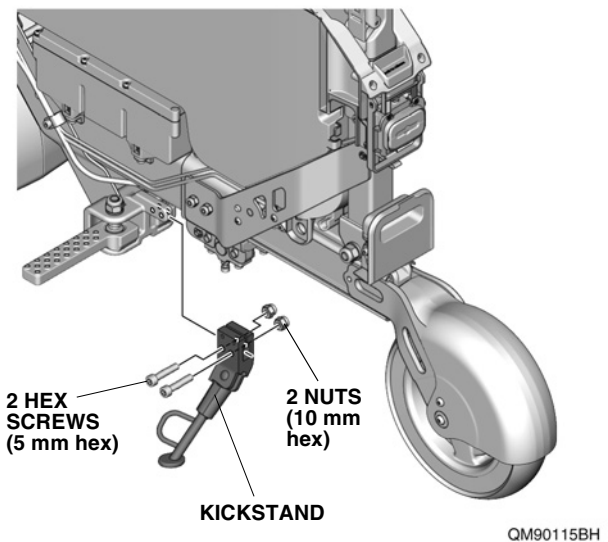

Installation

1. Install the parts in the reverse order of removal.

Rear Fender

Removal

1. Remove the rear fender.

NOTE

Remove in the order shown.

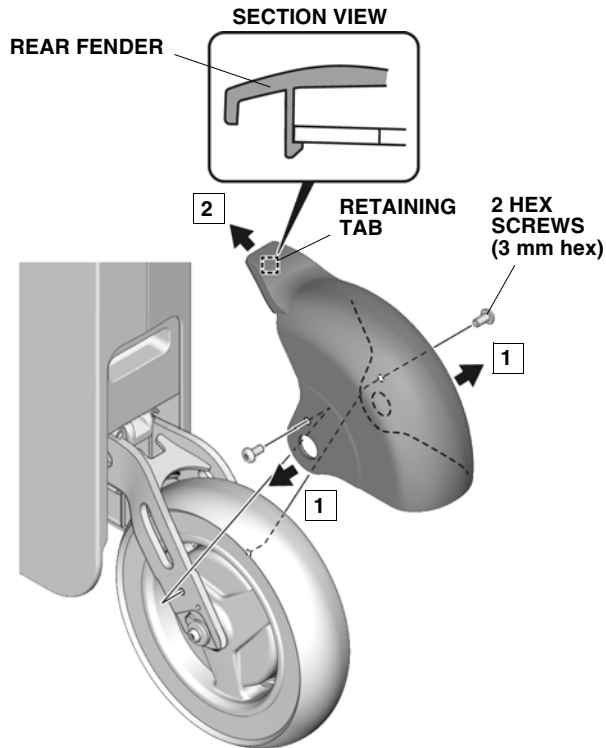

QM90116CH

Installation

1. Install the parts in the reverse order of removal.

Rear Wheel

Removal

1. Remove the rear fender. (Refer to **Rear Fender**.)

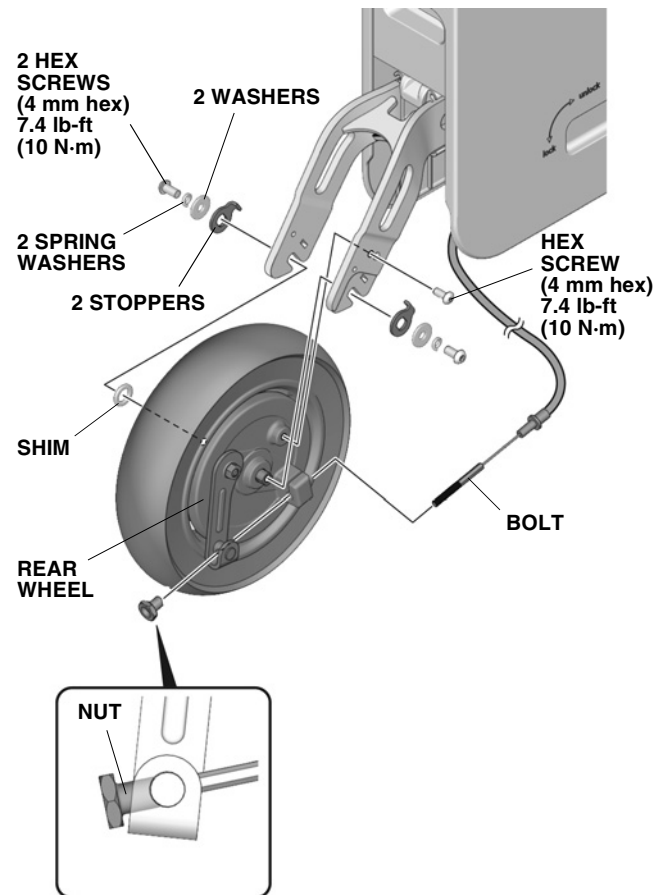

QM90117CH

2. Remove the rear wheel.

Installation

1. Install the parts in the reverse order of removal.
2. Adjust the brake. (Refer to **Brake Adjust.**)

Brake Shoes

Removal

1. Remove the rear fender. (Refer to **Rear Fender**.)

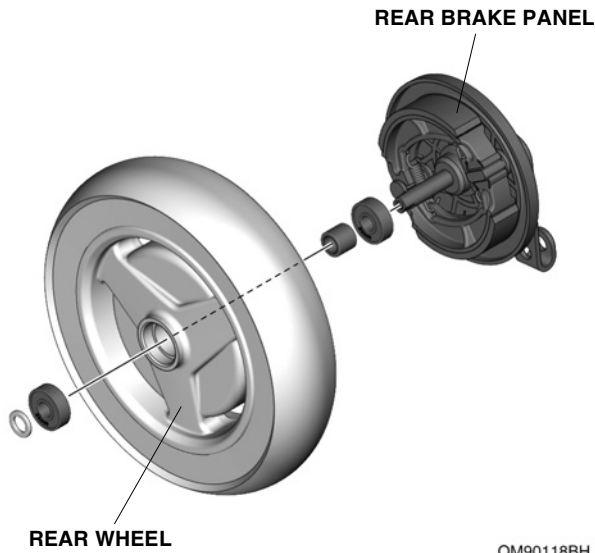

2. Remove the rear wheel. (Refer to **Rear Wheel**.)
3. Remove the rear brake panel.
4. Remove the brake shoes.

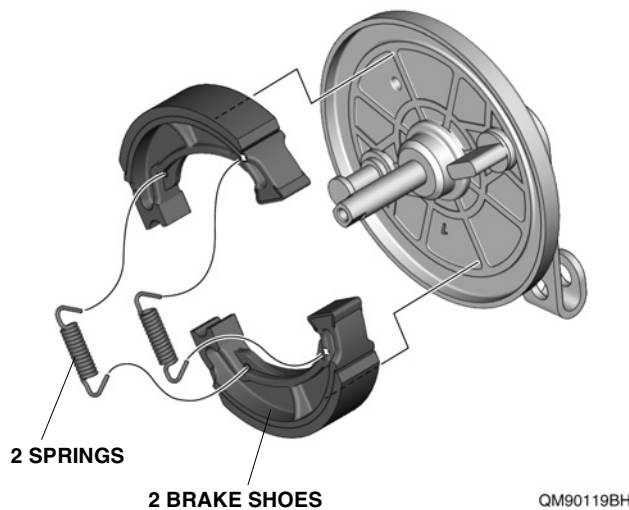

Installation

1. Install the parts in the reverse order of removal.

Rear Arm Sensor

Removal

1. Remove the left and right panels. (Refer to **Left and Right Panels**.)

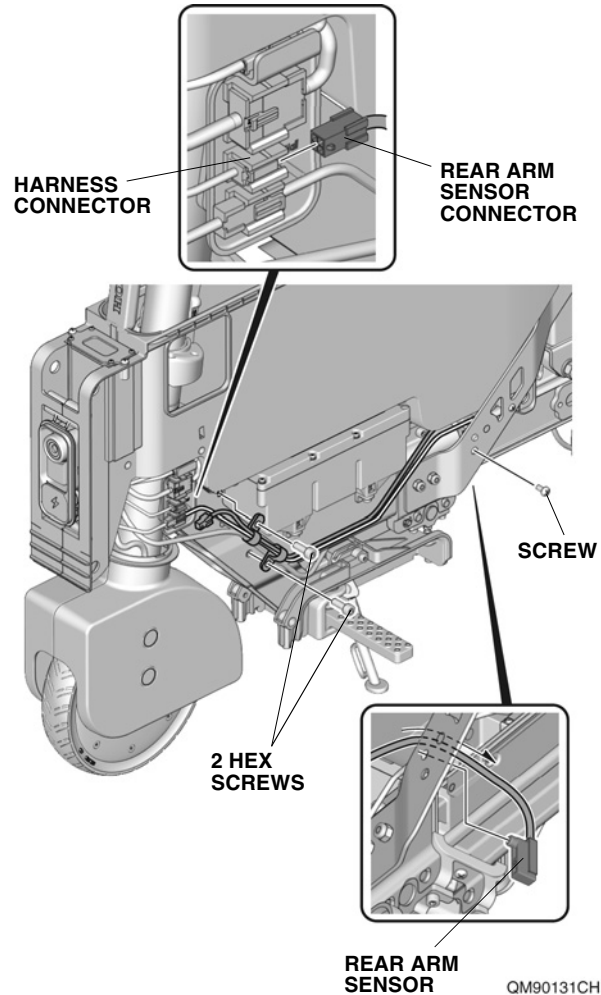

2. Disconnect the battery connectors. (Refer to **Disconnecting the Battery Connectors**.)
3. Remove the rear arm sensor.

Installation

1. Install the parts in the reverse order of removal.

Endcaps

Removal

1. Remove the rubber strips.
2. Loosen the throttle and brake lever assembly and slide them inward.

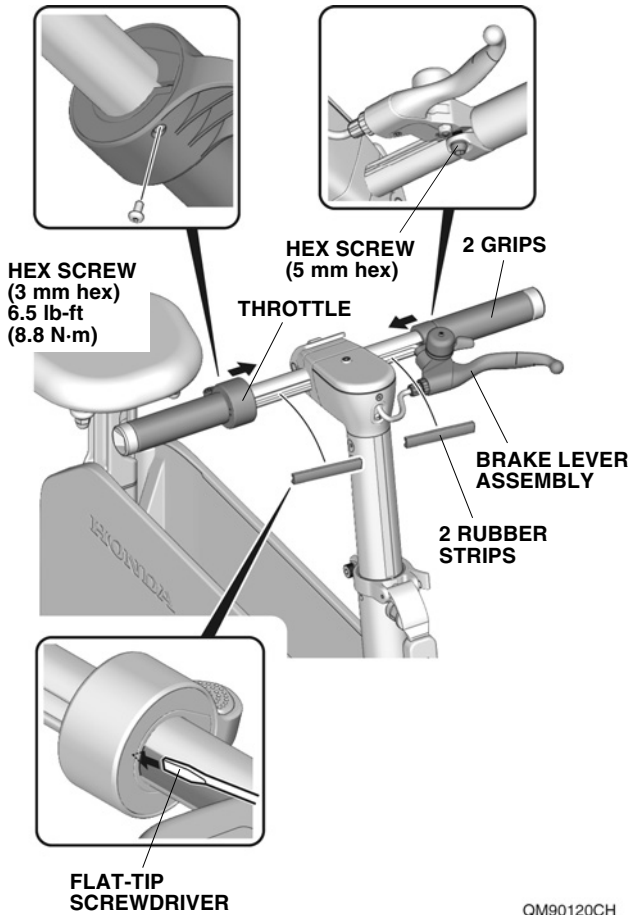

3. Slide the grips inward.

4. Remove the endcaps.

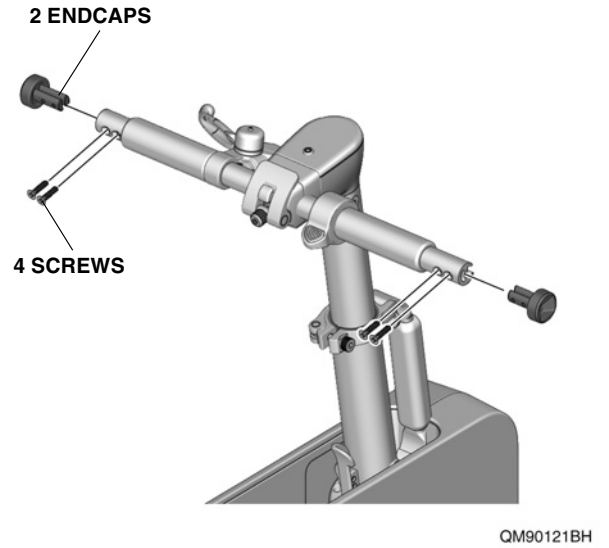

Installation

1. Install the parts in the reverse order of removal.

Grips

Removal

1. Remove the endcaps. (Refer to **Endcaps.**)

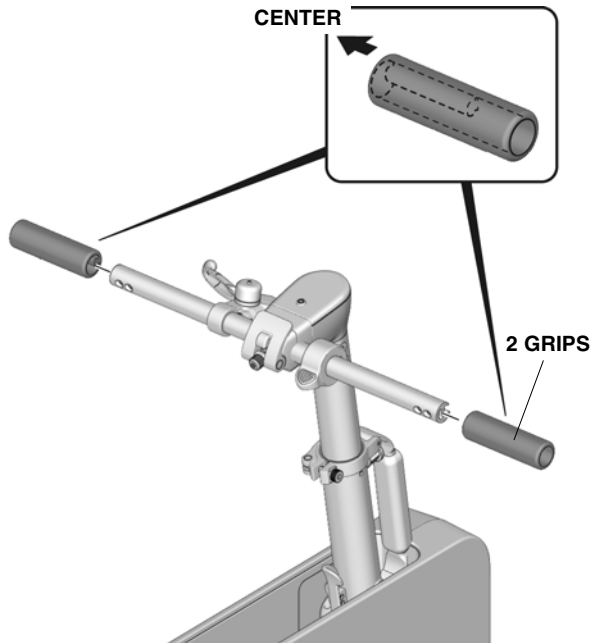

2. Remove the grips.

Installation

1. Install the parts in the reverse order of removal.

Display

Removal

1. Remove the left and right panels.
(Refer to **Left and Right Panels.**)

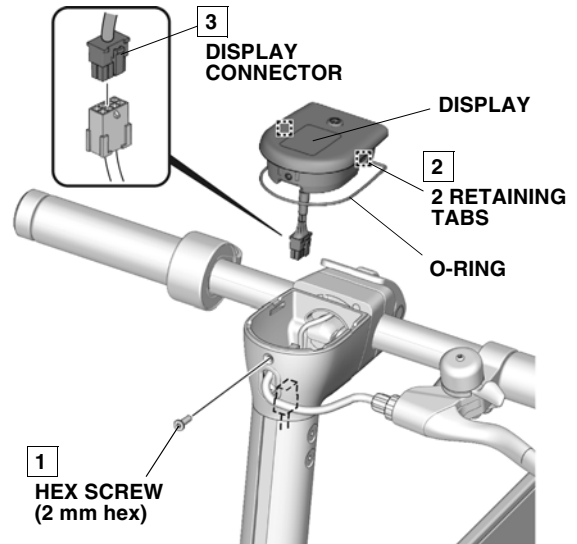

2. Disconnect the battery connectors.
(Refer to **Disconnecting the Battery Connectors.**)
3. Remove the display.

NOTE

Remove in the order shown.

Installation

1. Install the parts in the reverse order of removal except for the o-ring, which is installed after the display has been installed.

Handlebar

Removal

1. Remove the left and right panels.
(Refer to **Left and Right Panels.**)

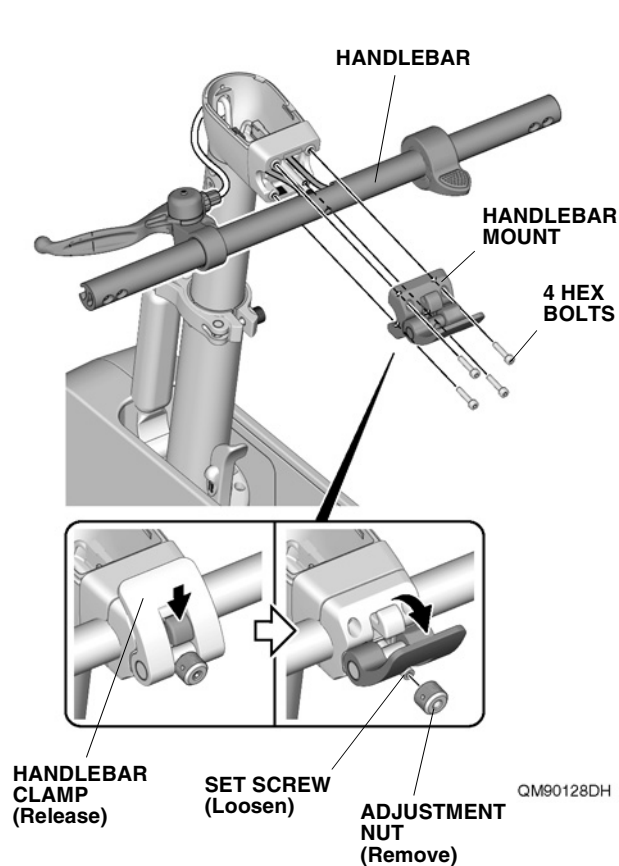

2. Disconnect the battery connectors.
(Refer to **Disconnecting the Battery Connectors.**)
3. Remove the endcaps. (Refer to **Endcaps.**)
4. Remove the grips. (Refer to **Grips.**)
5. Remove the display. (Refer to **Display.**)
6. Release the handle bar clamp and loosen the adjustment nut set screw.
7. Remove the adjustment nut, handlebar clamp and handlebar mount.

8. Disconnect the throttle and brake lever assembly connectors.
9. Slide the throttle assembly off of the handlebar.
10. Slide the handlebar out of the brake assembly.

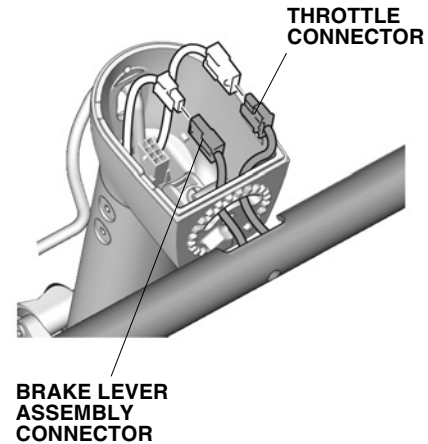

Installation

1. Install the parts in the reverse order of removal.

Brake Lever Assembly

Removal

1. Remove the handlebar. (Refer to **Handlebar**.)

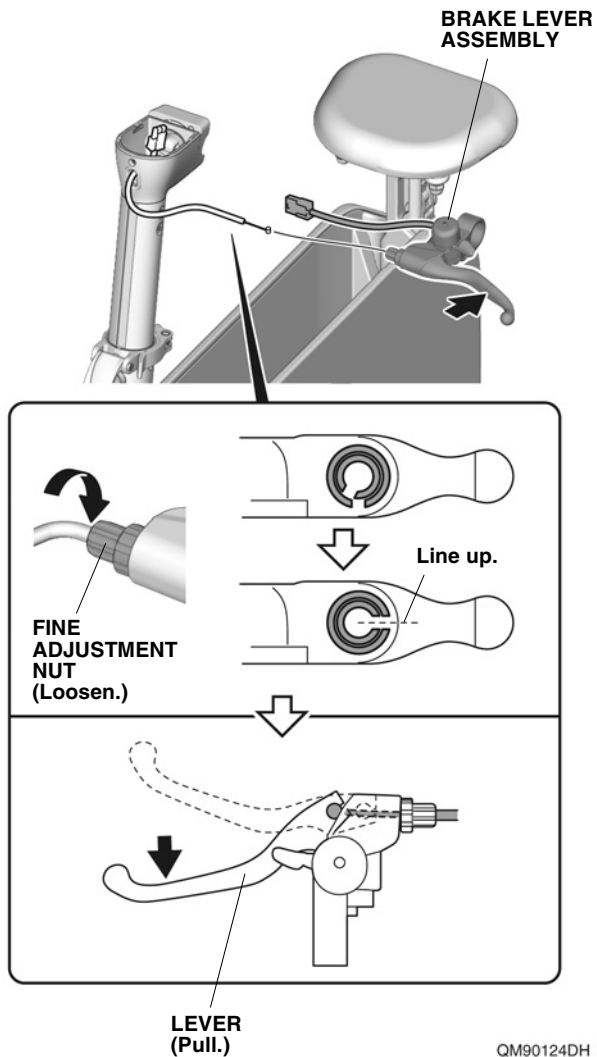

2. Remove the brake lever assembly.

Installation

1. Install the parts in the reverse order of removal.
2. Adjust the brake. (Refer to **Brake Adjust**.)

Brake Cable

Removal

1. Remove the left and right panels. (Refer to **Left and Right Panels**.)
2. Disconnect the battery connectors. (Refer to **Disconnecting the Battery Connectors**.)
3. Remove the display. (Refer to **Display**.)
4. Release the brake cable. (Release rear first).

NOTE

Be careful not to bend the brake cable.

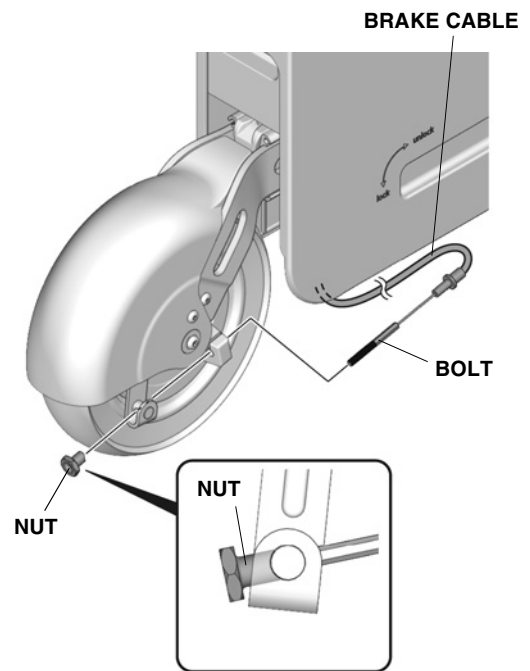

5. Release the brake cable. (Release front second).

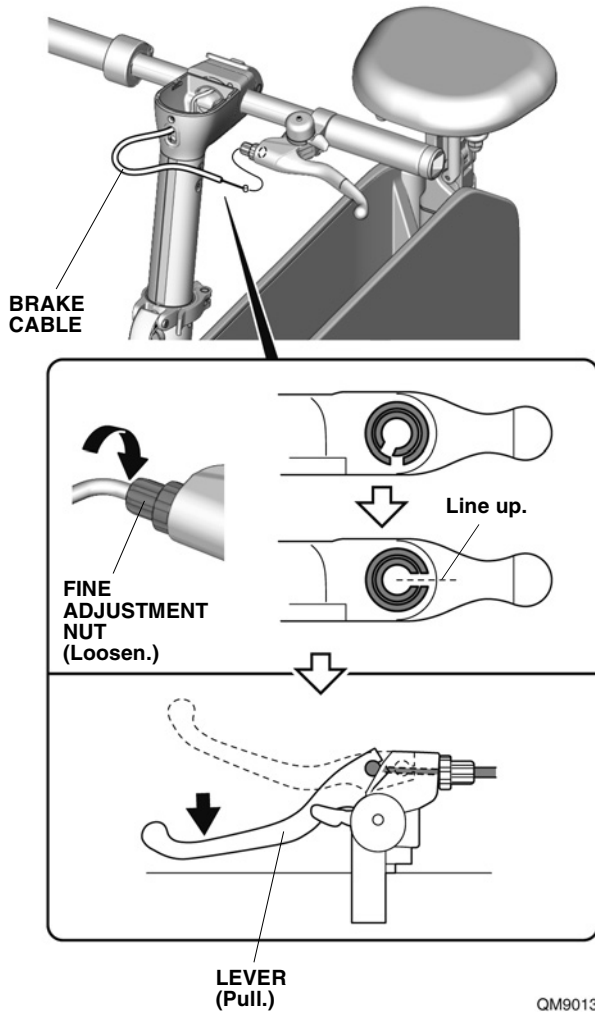

6. Remove the cable holder.

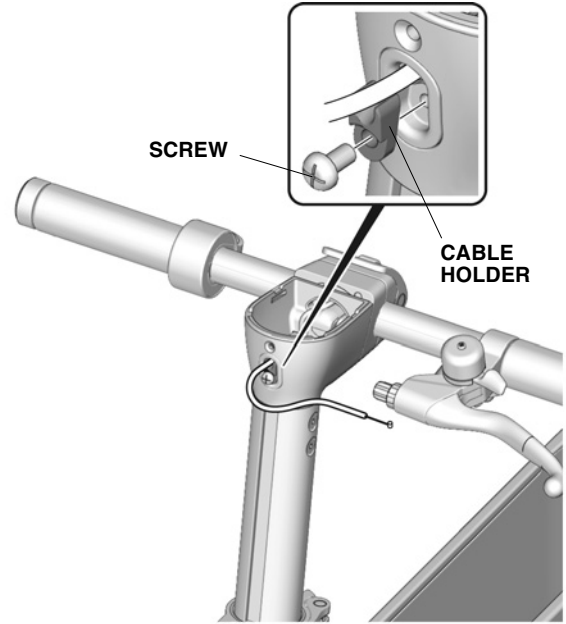

7. Remove the brake cable.

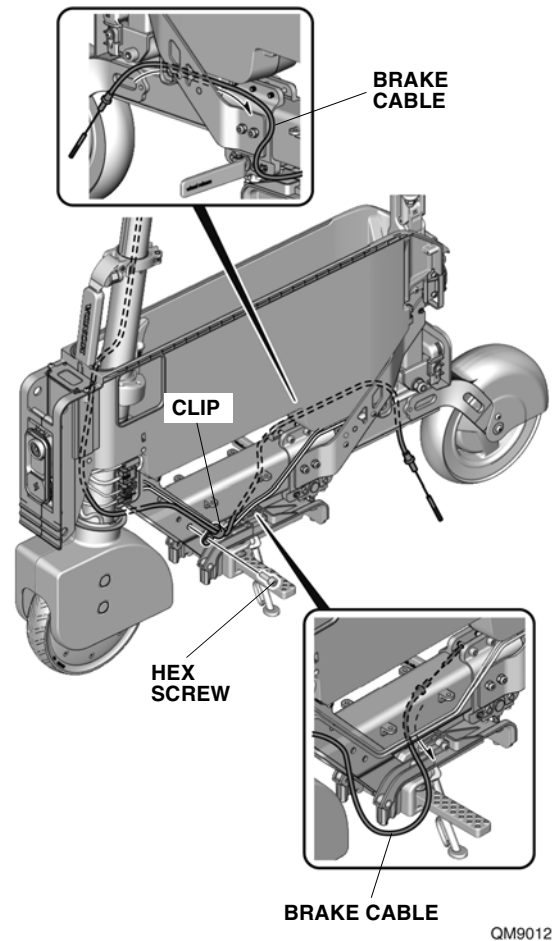

Installation

1. Install the parts in the reverse order of removal.

NOTE

Confirm proper brake cable movement after extending and retracting the rear wheel.

2. Adjust the brake. (Refer to **Brake Adjust.**)

Throttle

Removal

1. Remove the handlebar. (Refer to **Handlebar.**)
2. Remove the throttle.

Installation

1. Install the parts in the reverse order of removal.

Control Unit

Removal

1. Remove the left and right panels.
(Refer to **Left and Right Panels.**)
2. Disconnect the battery connectors.
(Refer to **Disconnecting the Battery Connectors.**)
3. Disconnect the three left side connectors.
(Refer to **Headlight.**)
4. Remove the headlight assembly.
(Refer to **Headlight.**)

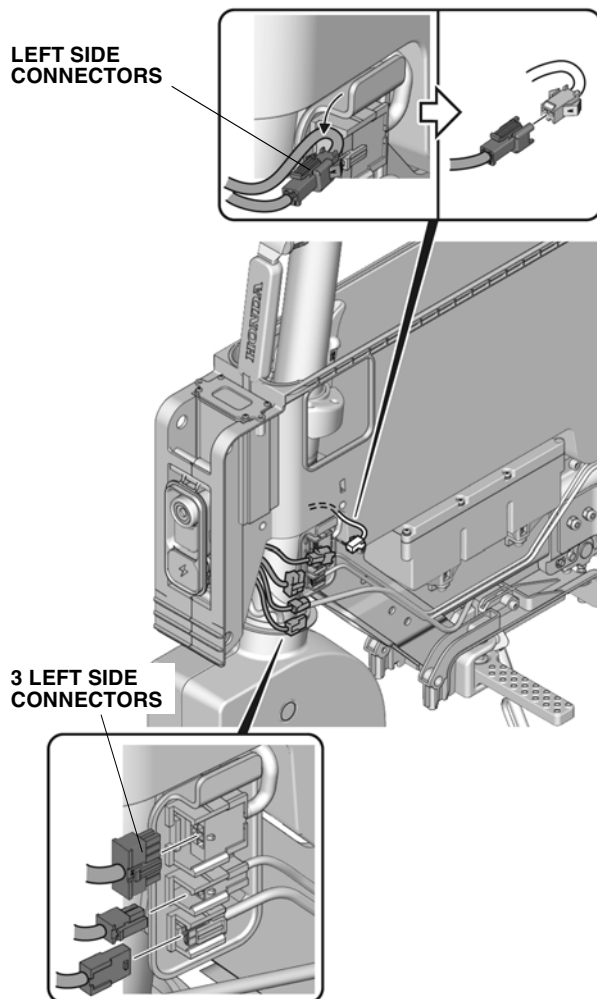

5. Remove the front wheel covers.
(Refer to **Front Wheel Covers.**)

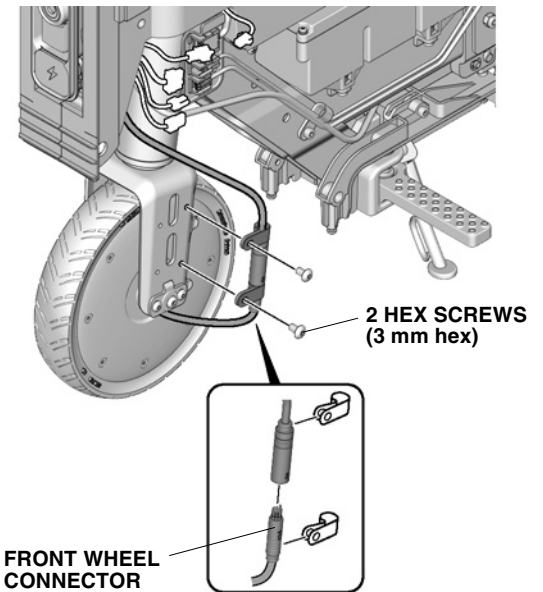

6. Disconnect the front wheel connector.
7. Remove the control unit.

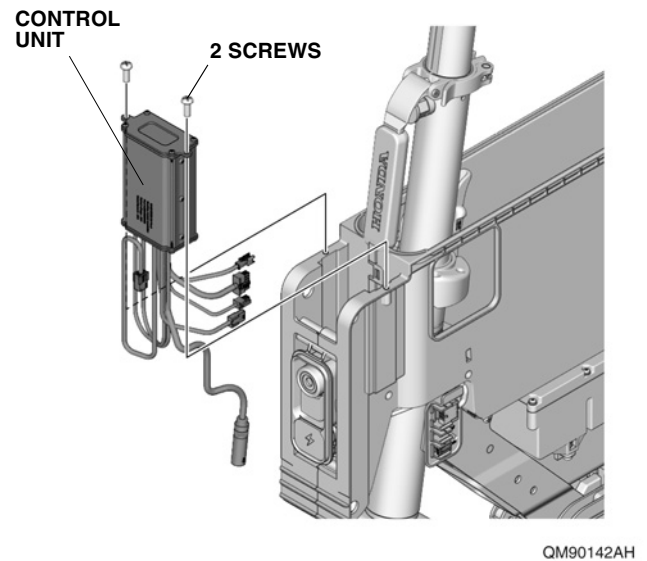

Installation

1. Install the parts in the reverse order of removal.

Seat Cushion

Removal

1. Remove the seat cushion.

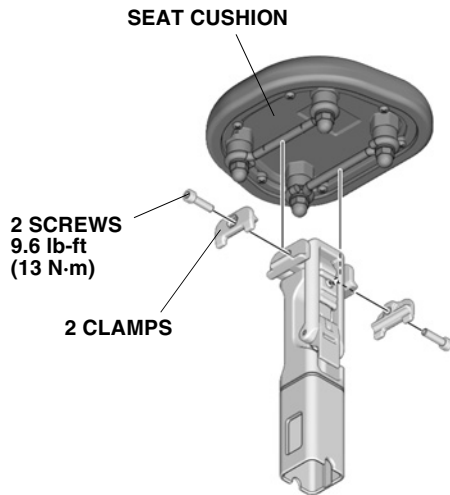

QM90129BH

Installation

1. Install the parts in the reverse order of removal.

Maintenance

Brake Adjust

1. Fully tighten the lock nut and fine adjustment nut so there is no space between the nuts and the brake lever assembly as shown.

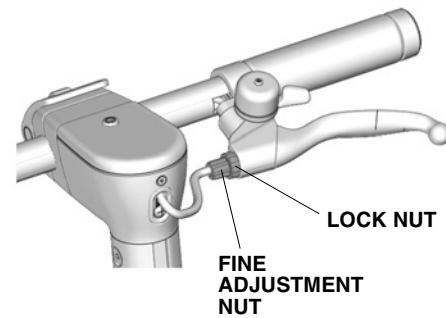

QM90143AH

2. Rotate the brake swing arm and tighten the adjustment nut until you can hear the brake drag.

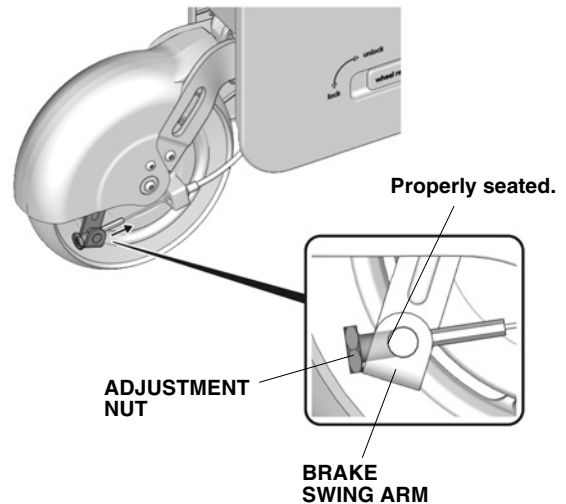

QM90144AH

3. Loosen the adjustment nut one half turn at a time until the rear wheel spins freely without brake drag.
4. Make sure the adjustment nut is properly seated as shown.

5. Use the fine adjustment nut for small brake adjustments by rotating the lock nut and fine adjustment nut counterclockwise until the brake drags slightly. Then turn both nuts clockwise until the brake no longer drags. Turn the lock nut clockwise and tighten to lock the fine adjustment nut in place.

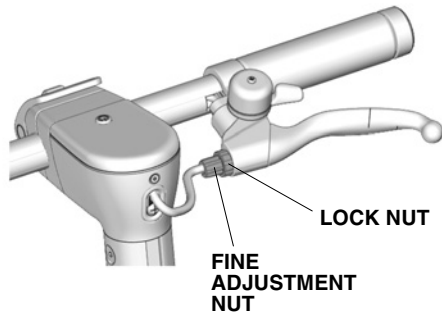

QM90143AH

6. Test the brake function to confirm it is working properly.

Brake Cable Lubrication

1. Lubricate the brake cable occasionally to ensure smooth operation.

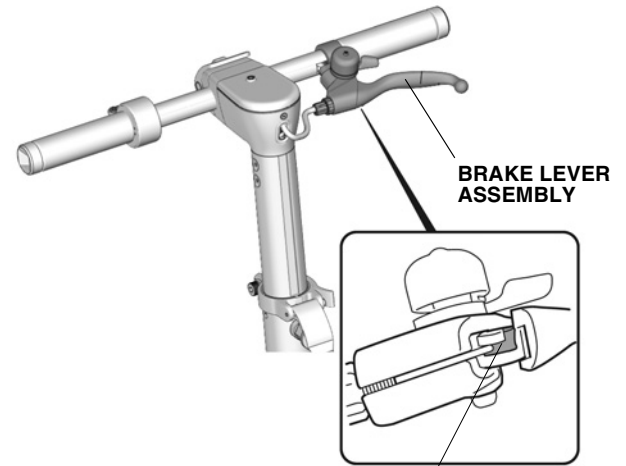

CABLE END
(Apply grease.) QM90145AH

2. Apply grease to the brake cable location shown.

Footpeg Lubrication

1. Lubricate the footpegs occasionally to ensure smooth operation.

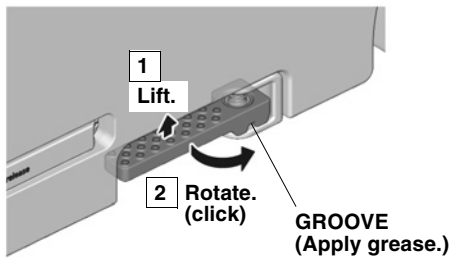



QM90146AH

2. Apply grease inside the groove on the right footpeg.
3. Lift and rotate the footpeg a few times to distribute the grease.
4. Repeat on the left footpeg.

Troubleshooting

Error Codes & Troubleshooting

Error Code	Description	Product Response	Probable Cause or Action
Er22	Throttle sensor error	No driving output	Release the throttle. If error code is still displayed, see your local dealer.
Er24	Motor hall sensor error	No driving output	See your local dealer.
 blinking	Position sensor I warning (wheel folding)	No driving output	Make sure the rear wheel is fully extended. If error code is still displayed, see your local dealer.
 blinking	Position sensor II warning (handlebar folding)	No driving output	Make sure the handlebar is set correctly. If error code is still displayed, see your local dealer.
Er71	Drive communication error	No driving output	See your local dealer.
Er72	Battery communication error	Rides normally but with error code displayed	See your local dealer.
OS	Over speed (22 mph (35 km/h))	No driving output	Slow down.
Pr31	Motor high temperature protection	Slows down and stops	Turn the power off and wait for it to cool down. If error code is still displayed, see your local dealer.
Pr32	Control unit high temperature protection	Slows down and stops	Turn the power off and wait for it to cool down. If error code is still displayed, see your local dealer.
Pr33	Battery high temperature protection	Slows down and stops	Turn the power off and wait for it to cool down. If error code is still displayed, see your local dealer.
 blinking	Low voltage	Slows down and stops	Recharge the battery.
Pr42	Over voltage protection	No driving output	Stop riding or charging and wait for it to cool down. If error code is still displayed, see your local dealer.
Pr43	Current spike	No driving output	Change riding environment or condition and wait for the controller to recover.
Pr45	Motor stall	No driving output	Change riding environment or condition and wait for the motor to recover.
Pr46	Throttle problem	No driving output	Release the throttle and wait until error code clears. If error code is still displayed, see your local dealer.