



HONDA INSTALLATION INSTRUCTIONS

Accessory

WELCOME LIGHTS
P/N 08V27-TXM-100

Application

2022 INSIGHT

Publications No.

VERSION 1

Issue Date

MAY 2021

PARTS LIST

Welcome light harness A

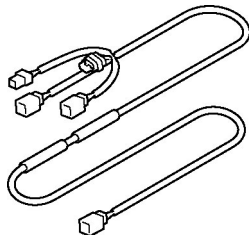

2 Subharnesses
(Some may not be used)

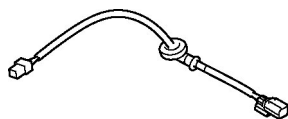

2 Welcome light harnesses B

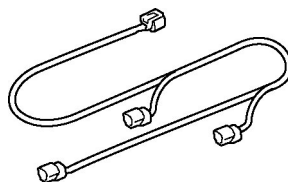

6 Lights

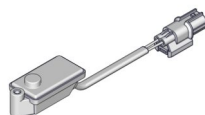

6 Light trims



23 Wire ties
(Some may not be used)

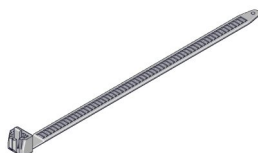

Fuse label

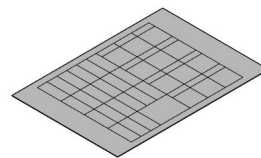

12 Self-tapping screws, 5 x 20 mm



12 Spring nuts



2 Holders

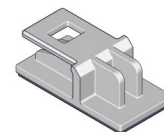

2 Wire ties with clip

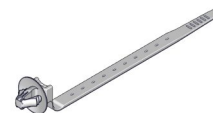

6 Covers



4 Aluminum tapes

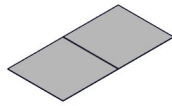

Urethane tape

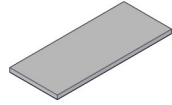

2 Alcohol wipes

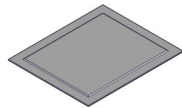

6 Self-tapping screws, 4 x 12 mm



6 Short wire ties



TOOLS AND SUPPLIES REQUIRED

Phillips screwdriver
 Stubby Phillips screwdriver
 Steel wire
 Drill
 File
 Pushpin
 Hacksaw
 3 mm and 6 mm Drill bits
 15 mm Hole saw
 Eye protection (face shield, safety goggles, etc.)
 Diagonal cutters
 10 mm Open end wrench
 Isopropyl alcohol
 Scissors
 Shop towel
 Electrical tape
 Ratchet
 10 mm Socket

The following tools are available through the Honda Tool and Equipment Program. On the iN, click on Service > Service Bay > Tool and Equipment Program, then enter the number under "Search." Or, call 888-424-6857.

- Trim Tool Set (T/N SOJATP2014)
- Plastic Trim Tool (T/N SILTRIMTL10)

Illustration of the Welcome Lights Installed in the Vehicle

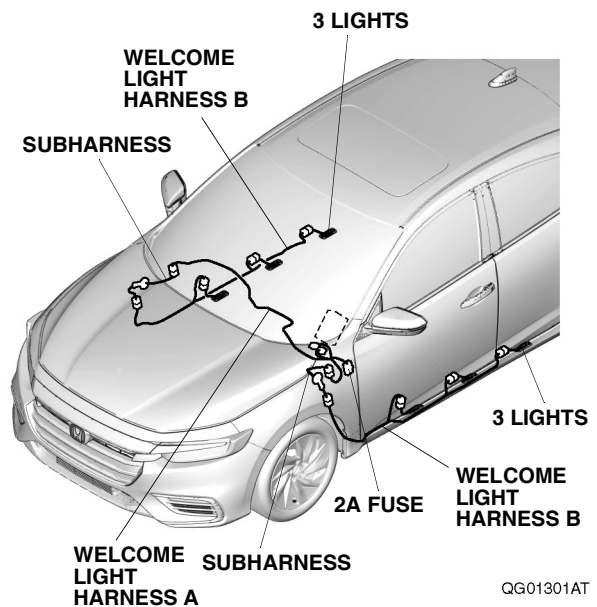

QG01301AT

INSTALLATION

Customer Information: The information in this installation instruction is intended for use only by skilled technicians who have the proper tools, equipment, and training to correctly and safely add equipment to your vehicle. These procedures should not be attempted by “do-it-yourselfers.”

1. Remove the right side panel, and disconnect the negative cable from the battery.
NOTE: Wait 3 minutes after turning the power switch to OFF before disconnecting the battery.

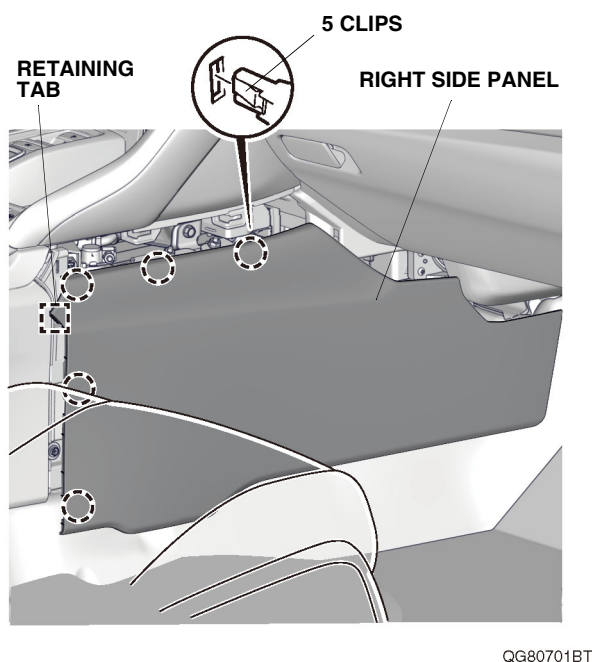

2. Pull away the door opening seal, and remove the passenger's dashboard side lid.

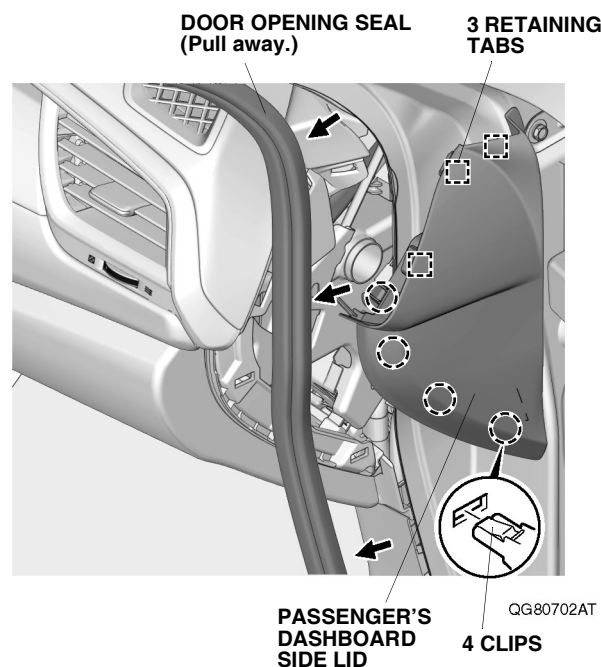

3. Remove the passenger's front door sill trim.

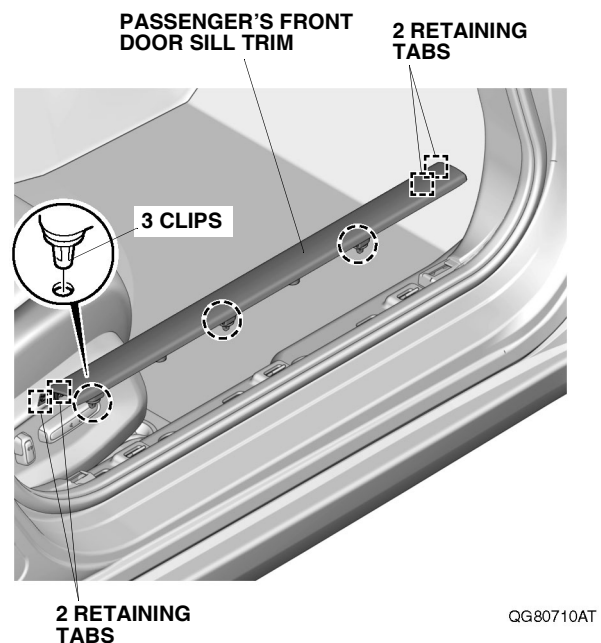

4. Pull away the door opening seal, and remove the passenger's kick panel.

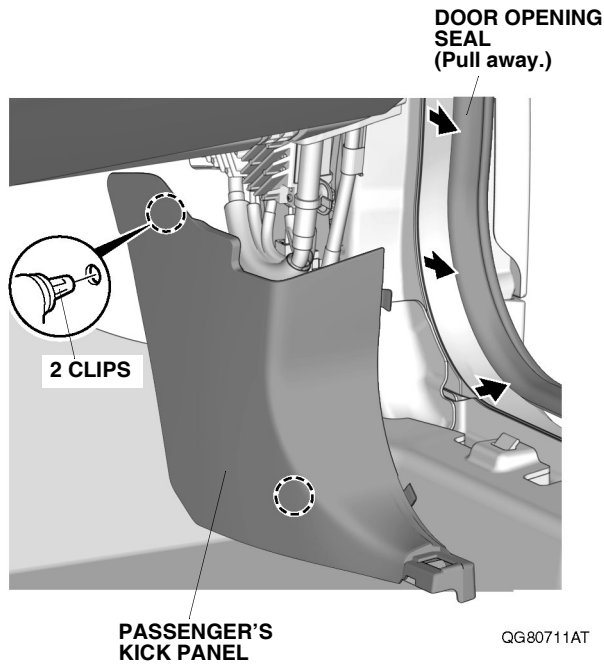

5. Remove the passenger's under cover.

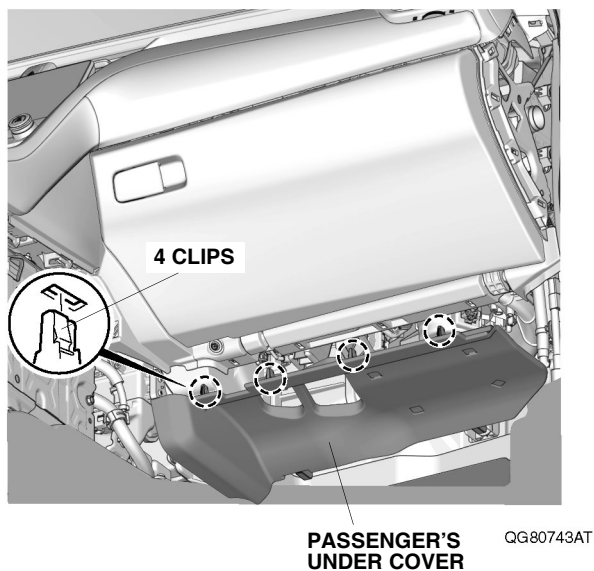

6. Open the glove box, push inward on the glove box stops, and remove the glove box.

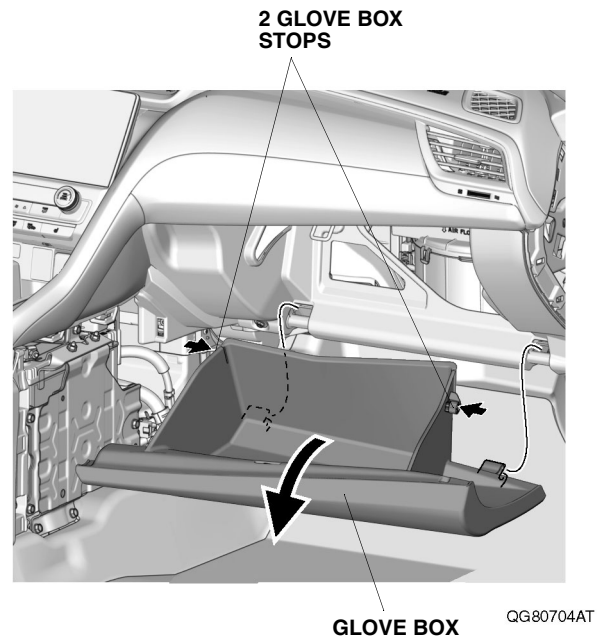

7. Remove the glove box cover.

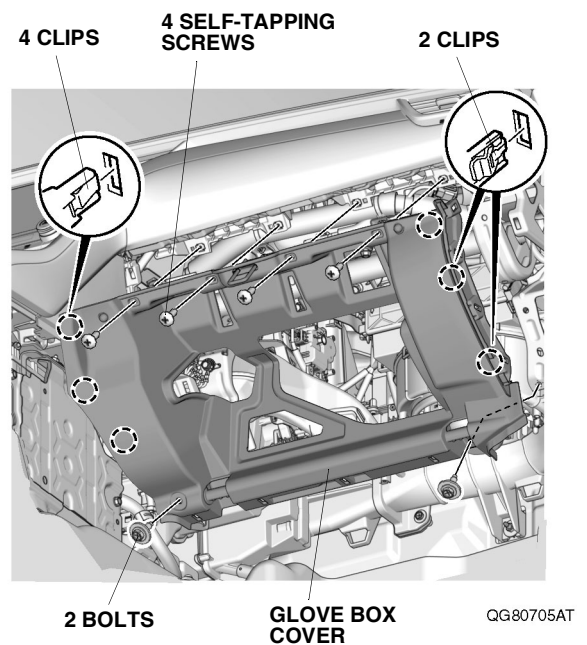

8. Remove the driver's dashboard lower cover, and unplug the vehicle connectors.

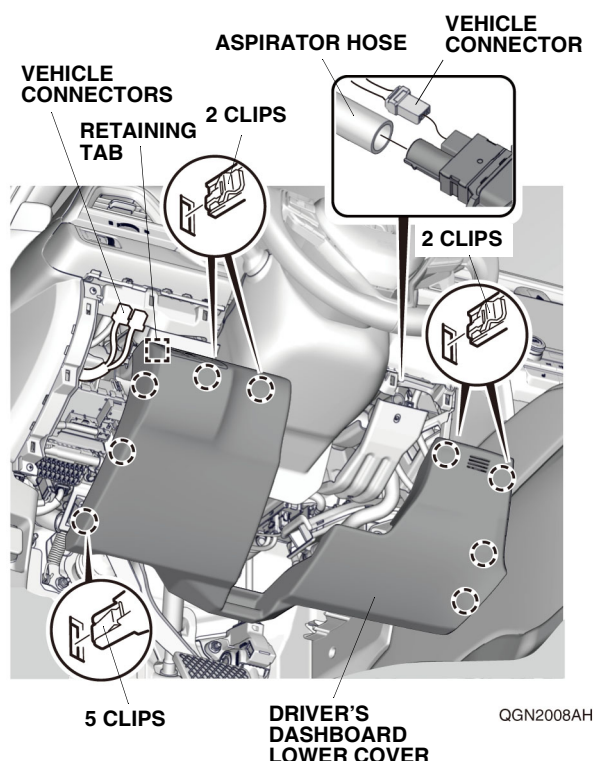

9. Pull away the door opening seal, and remove the driver's dashboard side lid.

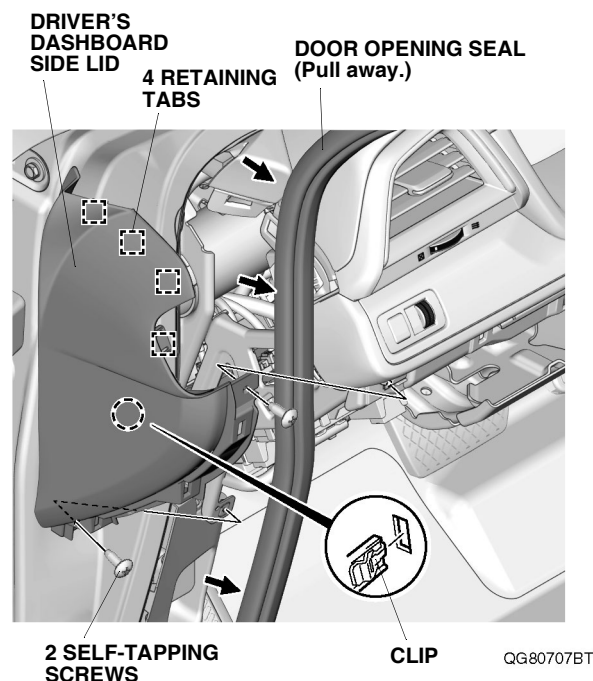

10. Remove the driver's front door sill trim.

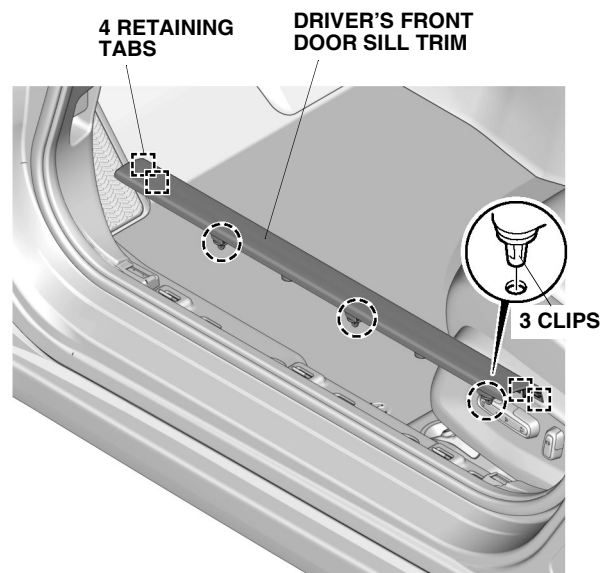

11. Pull away the door opening seal, and remove the driver's kick panel.

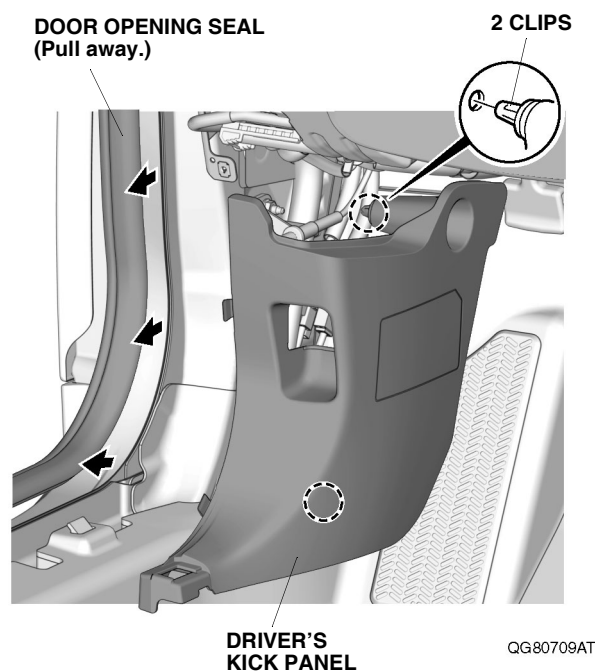

12. Turn the steering wheel fully counterclockwise.

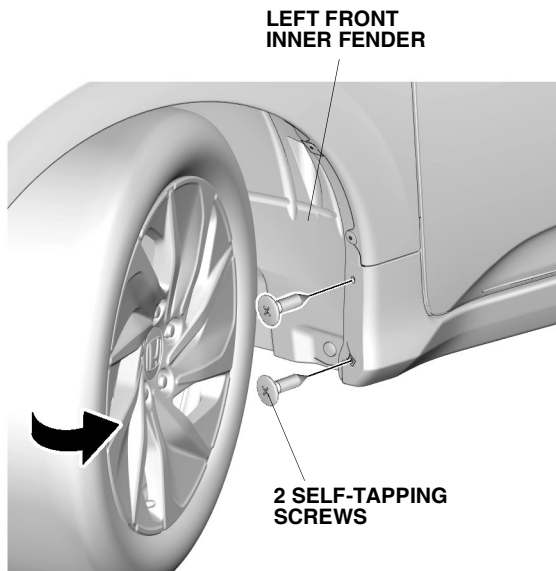

QGN1302AT

13. Remove the two self-tapping screws shown above.
14. Remove the two self-tapping screws shown below.

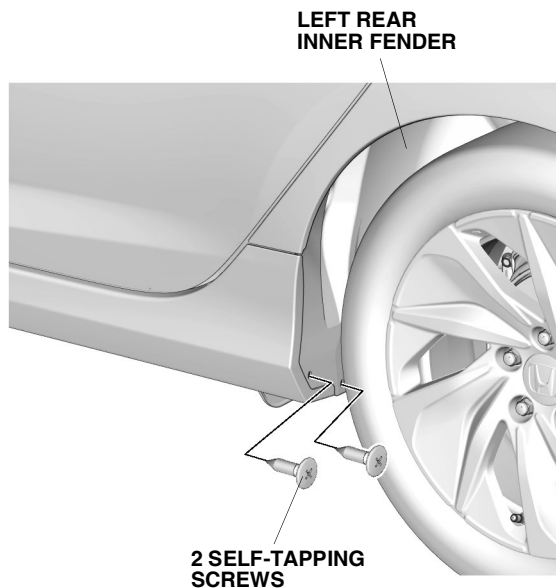

QGN1303AT

15. Remove the four clips from the left side sill trim.

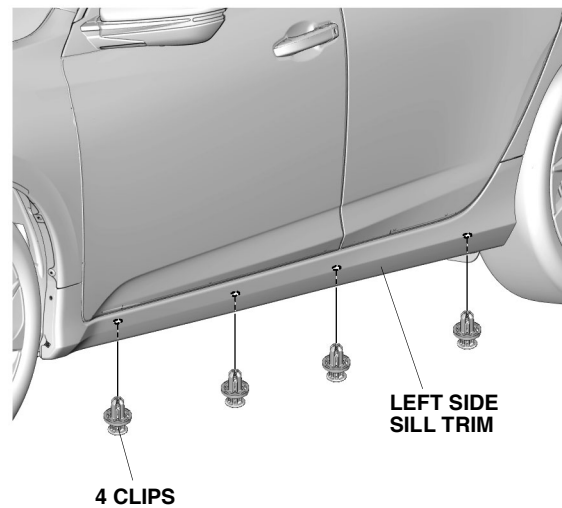

QGN1304AT

16. Open the left front and rear doors.

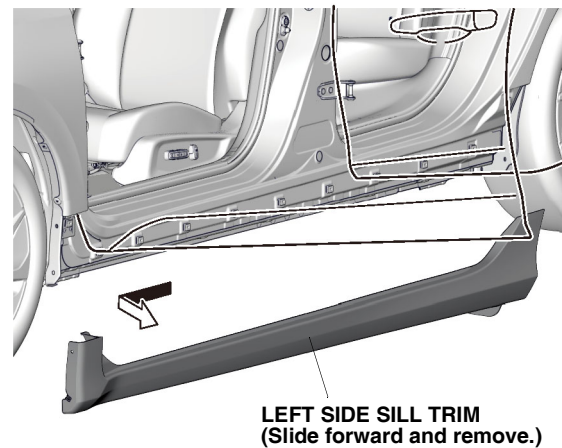

QGN1305BT

17. Remove the left side sill trim.

18. Close the left front and rear doors.

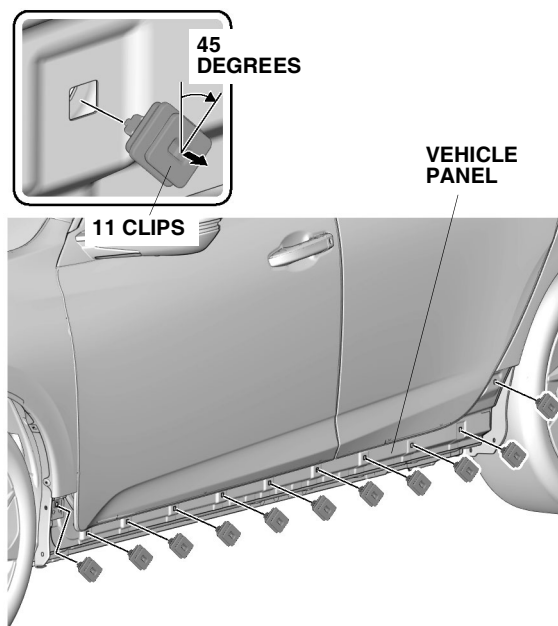

QGN1306AT

19. Remove the 11 clips from vehicle panel.

20. Release the left front inner fender.

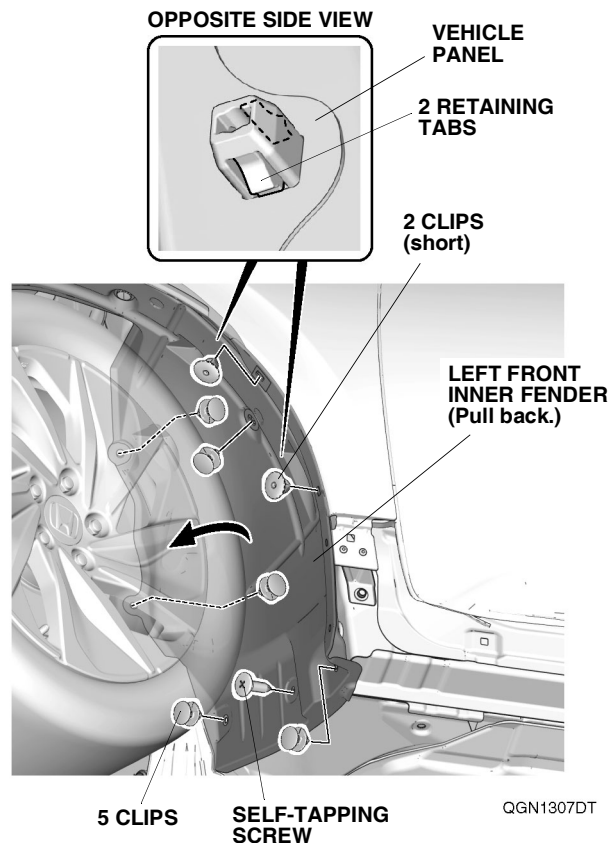

QGN1307DT

21. Turn the steering wheel fully clockwise, and repeat steps 13 through 20 on the right side of the vehicle.
22. Using isopropyl alcohol on a shop towel, thoroughly clean the fuse case where the fuse label will attach.

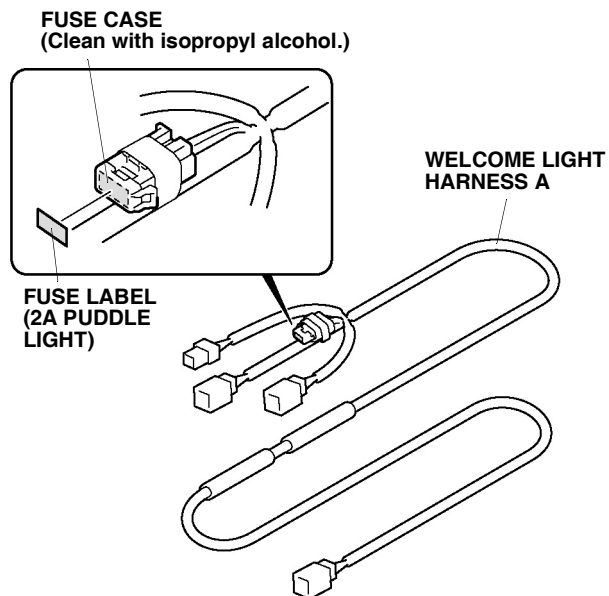

QGN1308AT

23. Attach the fuse label to the welcome light harness A fuse case.

If the vehicle is equipped with another accessory (including parking sensors), go to step 26. If the vehicle is equipped with another accessory (except parking sensors), go to step 28; otherwise continue with step 24.

Without Another Accessory

24. Plug the welcome light harness A 6-pin connector into the vehicle 6-pin connector.

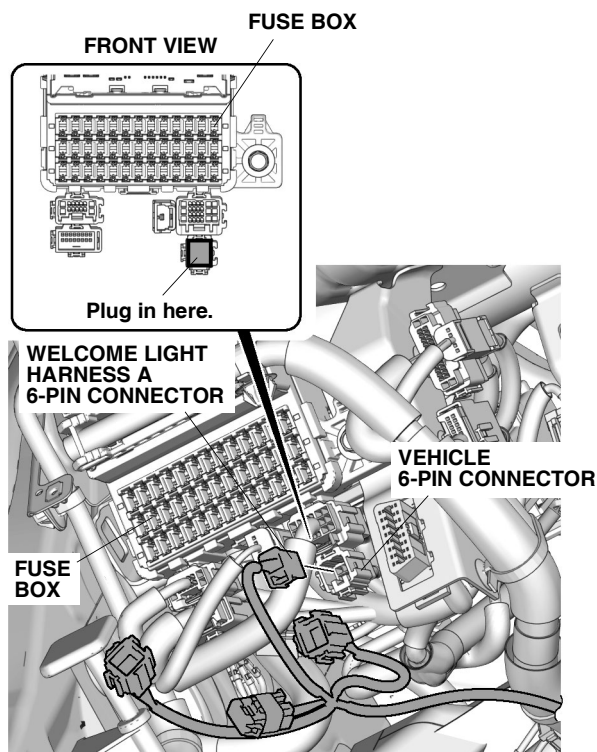

QGN1309AT

25. Attach the welcome light harness A 6-pin connector (white) to the vehicle 6-pin connector. Go to step 30.

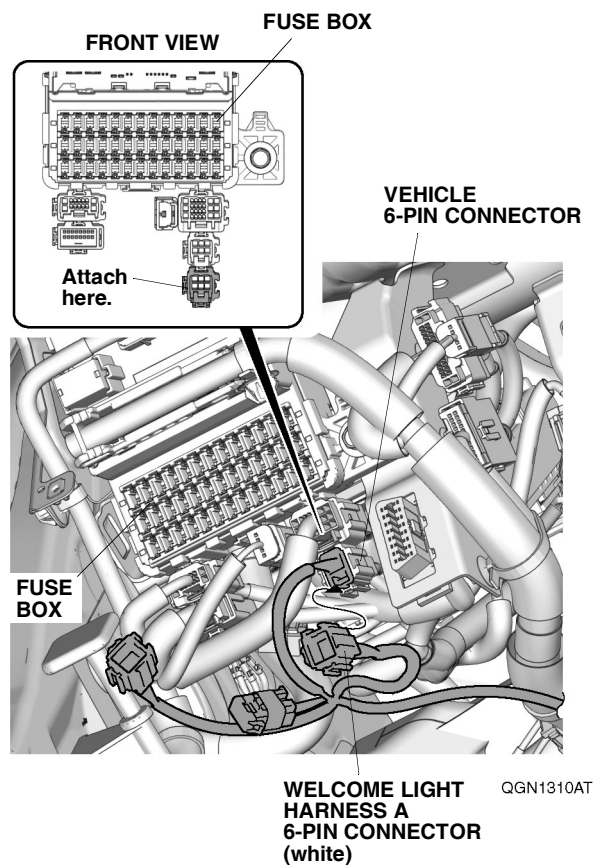

QGN1310AT

With Another Accessory (Including Parking Sensors)

26. If the parking sensor harness 6-pin connector is plugged into the vehicle 6-pin connector, plug the welcome light harness A 6-pin connector into the parking sensor harness 6-pin connector.

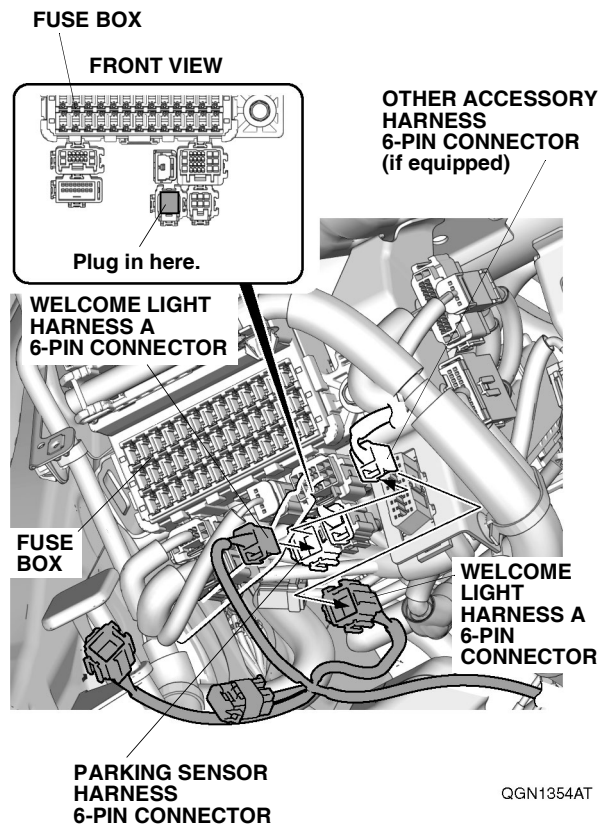

27. Attach the welcome light harness A 6-pin connector (white) to any of the positions shown. Go to step 30.

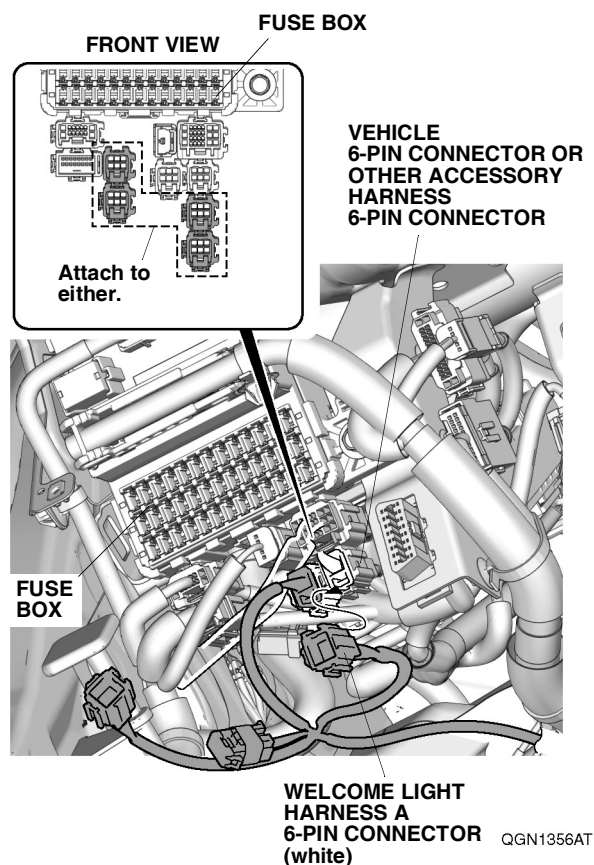

With Another Accessory (Except Parking Sensors)

28. Unplug the other accessory harness 6-pin connector from the vehicle 6-pin connector and plug it into the welcome light harness A 6-pin connector (white). Plug the welcome light harness A 6-pin connector into the vehicle 6-pin connector.

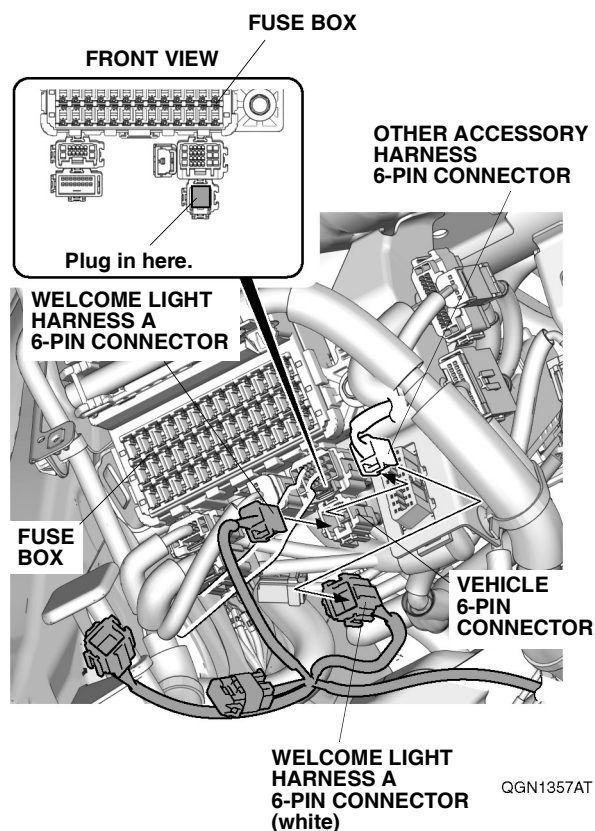

29. Attach the 6-pin connectors to any of the positions shown.

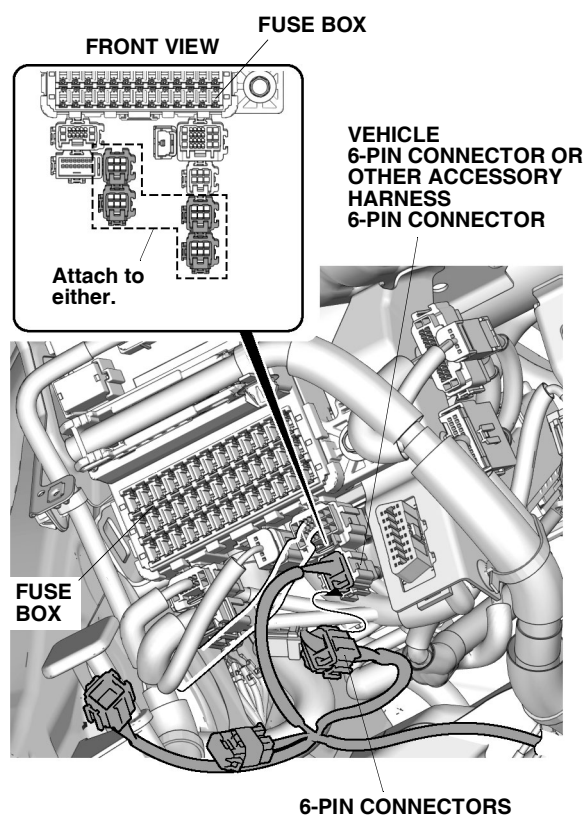

30. Line up the branch of welcome light harness A with the branch of the vehicle harness, and secure it to the vehicle harness with one wire tie as shown.

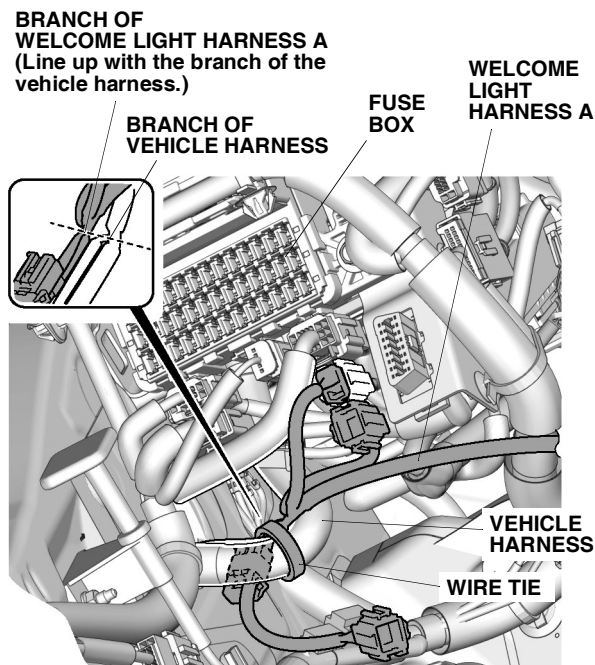

QGN1311BT

31. Route welcome light harness A as shown. Secure it to the vehicle harness and vehicle bracket with three wire ties.

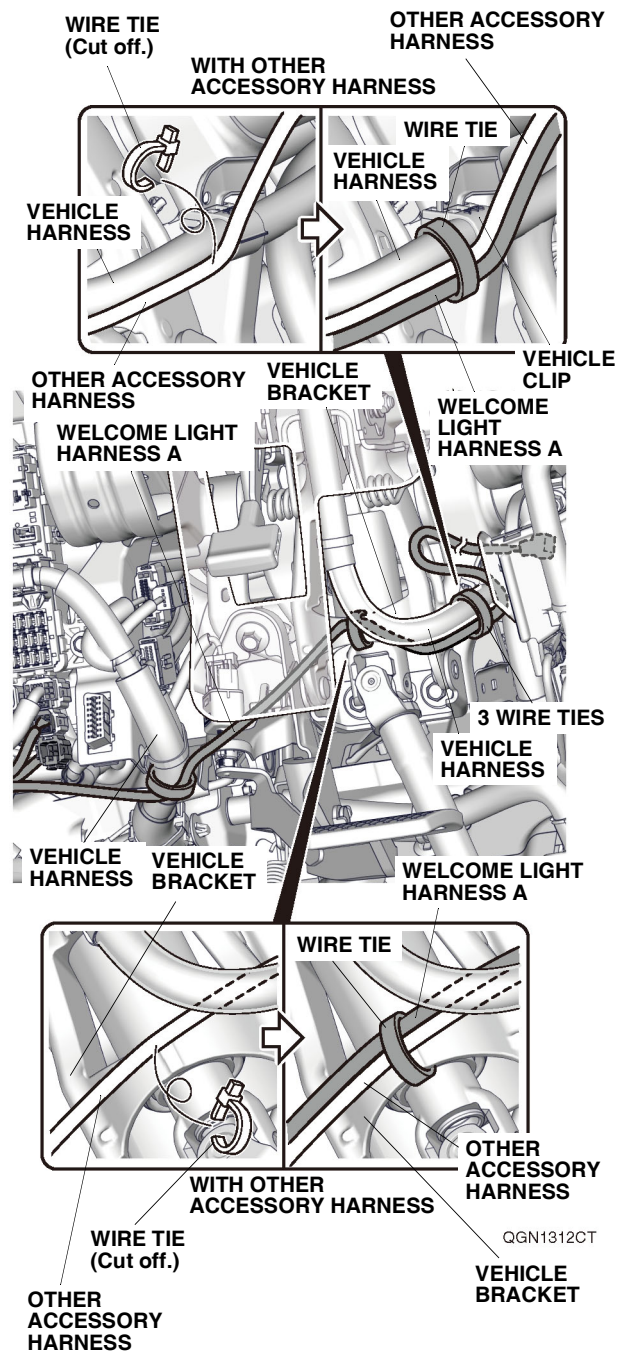

QGN1312CT

32. Route a piece of steel wire as shown.

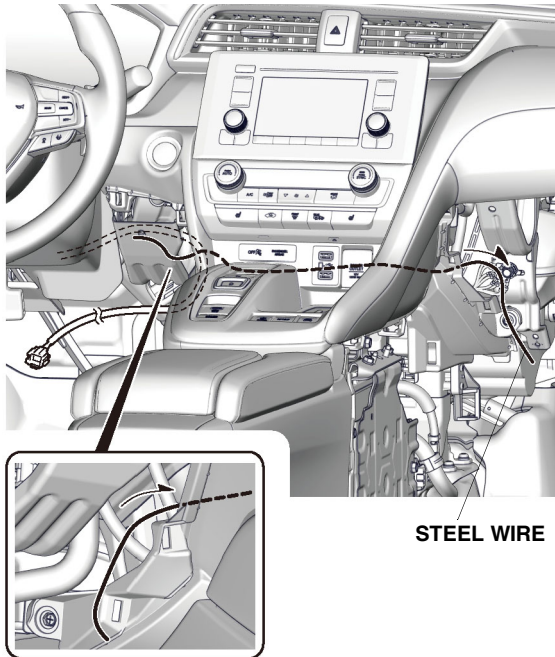

QGN1313CT

33. Attach the steel wire to welcome light harness A with electrical tape.

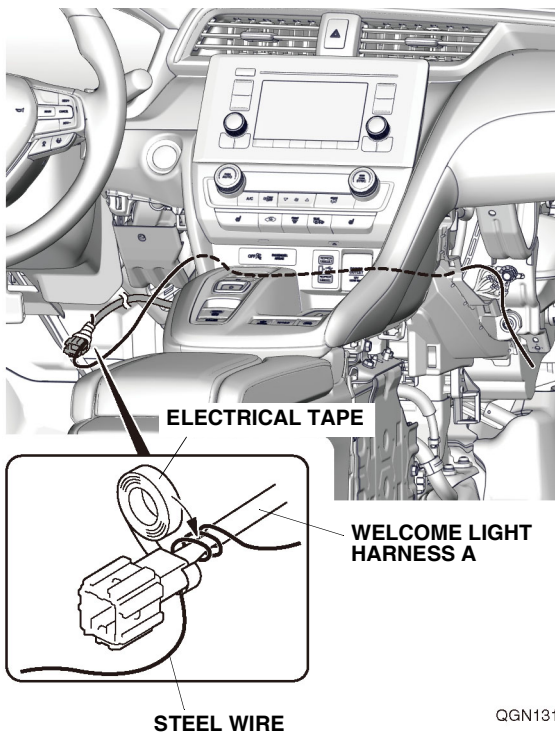

QGN1314CT

34. Route welcome light harness A as shown, and remove the electrical tape and steel wire.



QGN1315CT

35. Join two wire ties together as shown, then secure welcome light harness A to the vehicle duct with one joined wire tie.

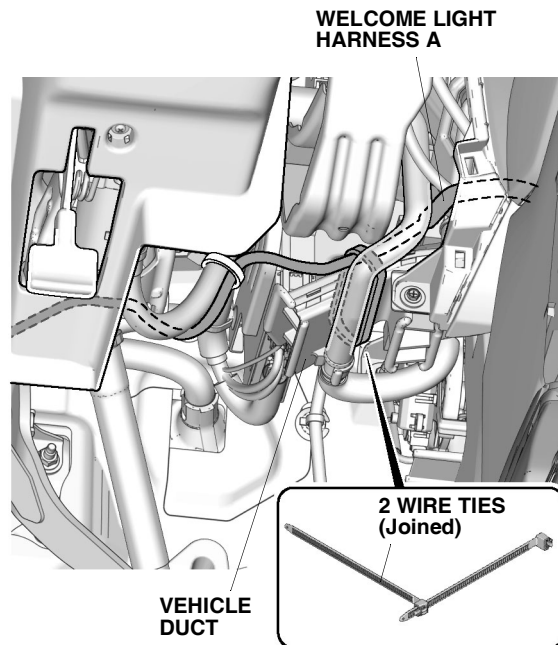

QGN1316CT

36. Route welcome light harness A as shown, and secure it to the vehicle harness with four wire ties.

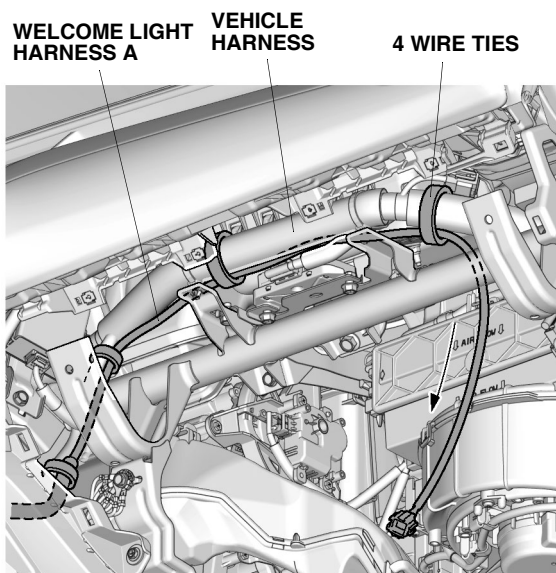

QGN1317BT

If the vehicle is equipped with an amplifier, continue with step 37; otherwise, go to step 38.

With Amplifier

37. Unplug the vehicle connectors, and remove the amplifier.

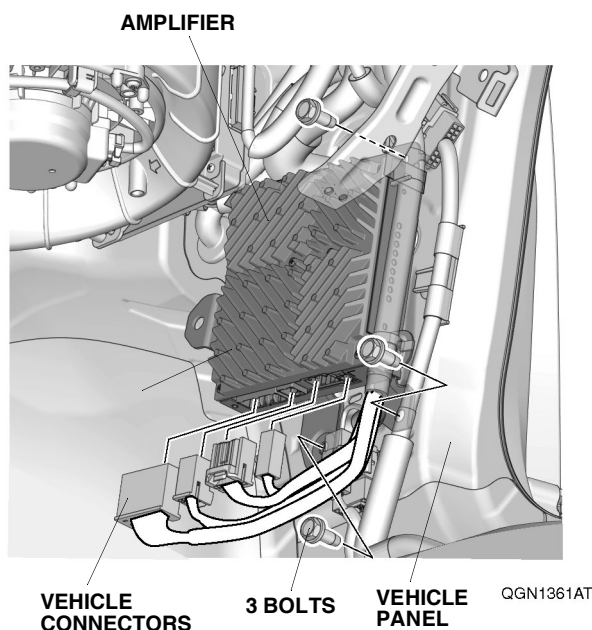

38. Unplug the vehicle connector, and release the vehicle harness as shown.

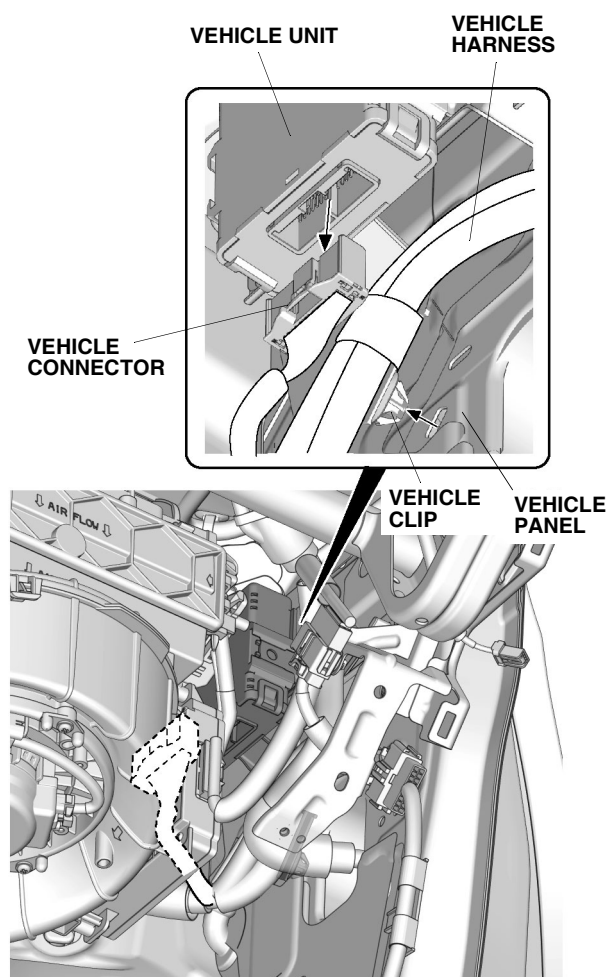

QGN1362AT

39. Peel back the insulator as shown.

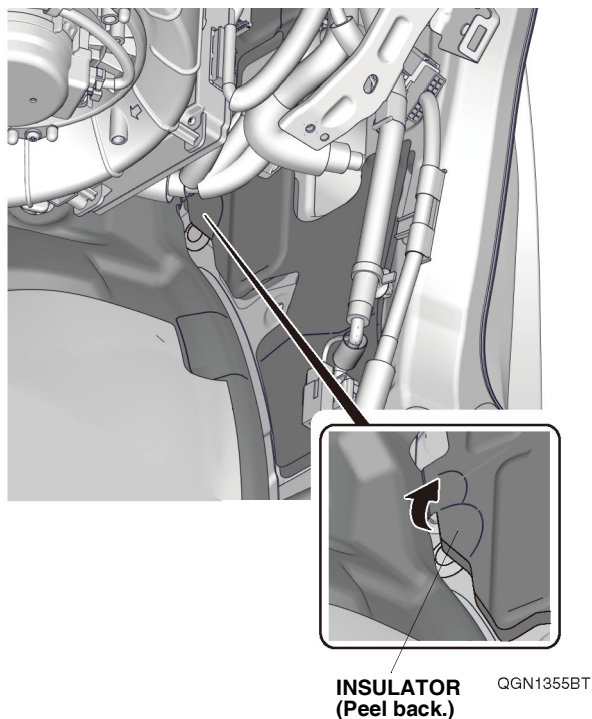

40. Remove the vehicle grommet as shown.

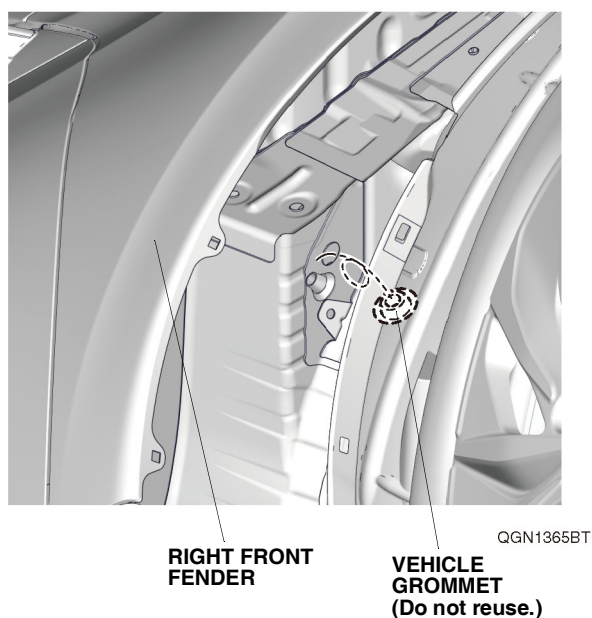

41. Route the subharness through the vehicle panel hole, and secure the subharness grommet to the vehicle panel.

NOTE:

- While holding the grommet, carefully insert it into the vehicle panel hole and make sure it is seated properly.
- Do not pull on the socket or harness when installing the grommet.

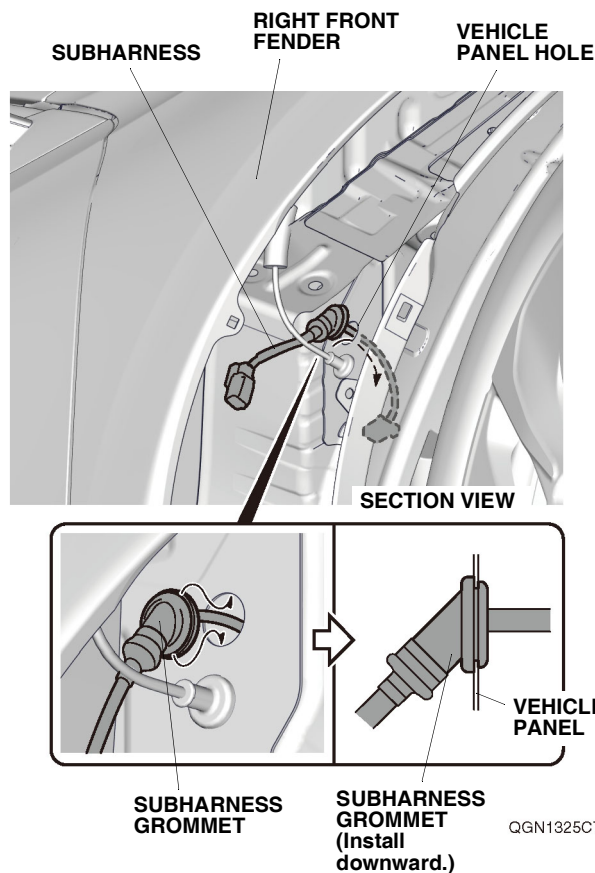

42. Install the amplifier (with amplifier only) and vehicle harness, then plug in the vehicle connectors removed in steps 37 and 38.

43. Attach one piece of urethane tape around the welcome light harness A 6-pin connector.

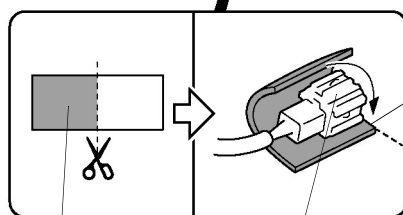
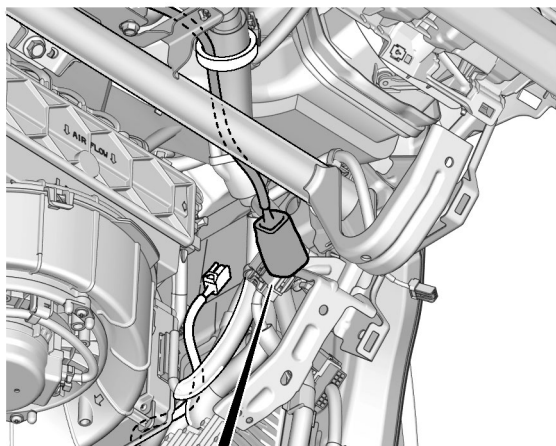

Line up with the end of the connector.

URETHANE TAPE
(Cut in half.)

WELCOME LIGHT
HARNESS A
6-PIN CONNECTOR

QGN1330BH

44. Plug the subharness 6-pin connector into the welcome light harness A 6-pin connector.

WELCOME LIGHT
HARNESS A
6-PIN CONNECTOR

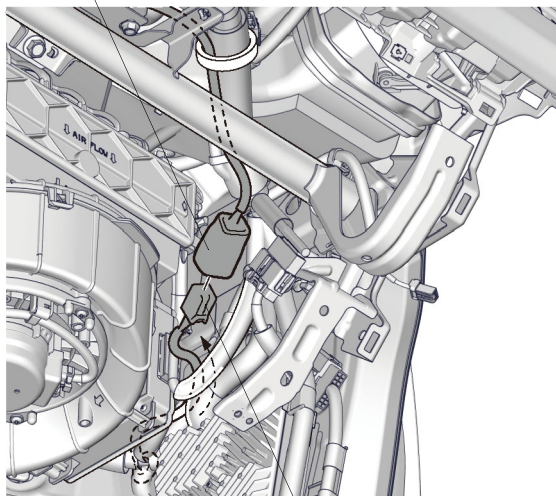

SUBHARNESS
6-PIN CONNECTOR

QGN1326BT

45. Secure the 6-pin connectors to the vehicle harness with one wire tie.

6-PIN CONNECTORS

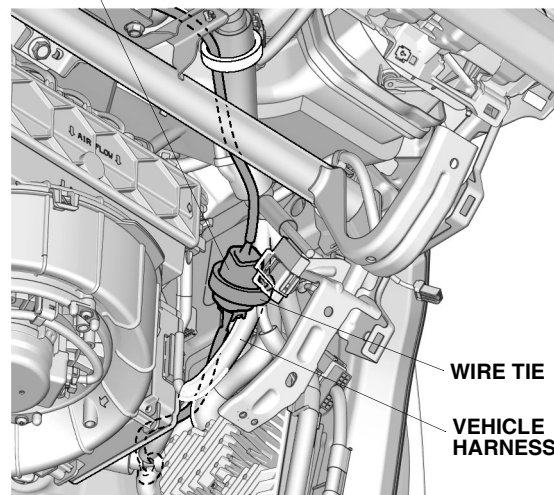

WIRE TIE

VEHICLE
HARNESS

QGN1327AT

If the vehicle is equipped with accessory parking sensors, go to step 54; otherwise, continue with step 46.

Without Accessory Parking Sensors

46. Release the vehicle harness from the vehicle panel.

VEHICLE
PANEL

VEHICLE
CLIP

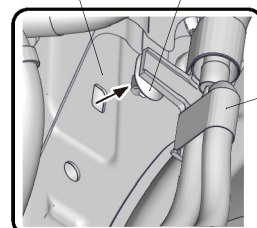

VEHICLE
HARNESS

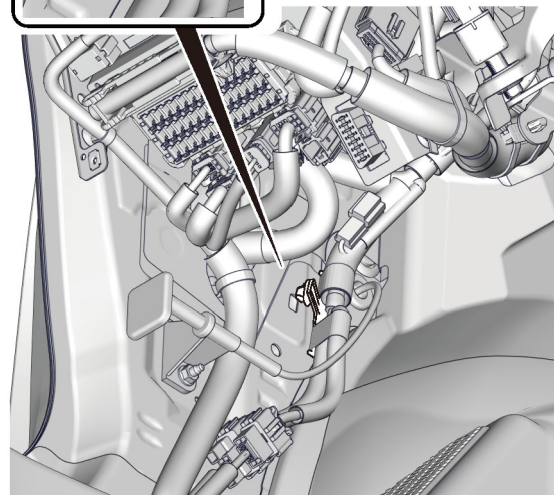

QGN1363AT

47. Peel back the insulator as shown.

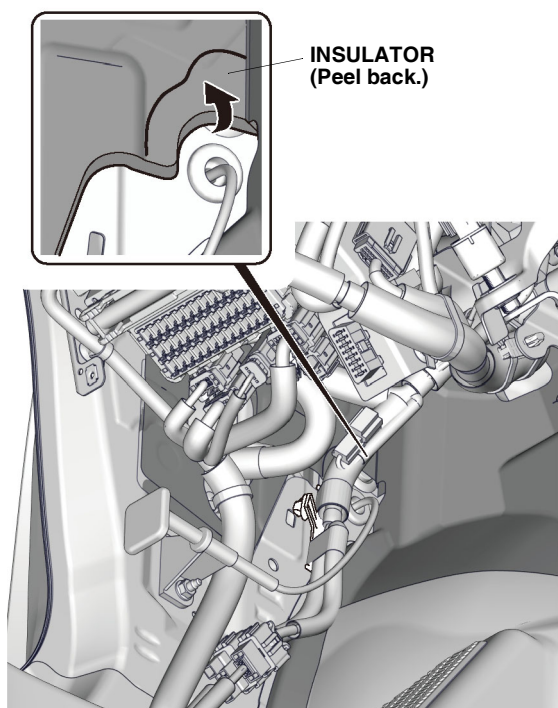

QGN1364AT

48. Remove the vehicle grommet as shown.

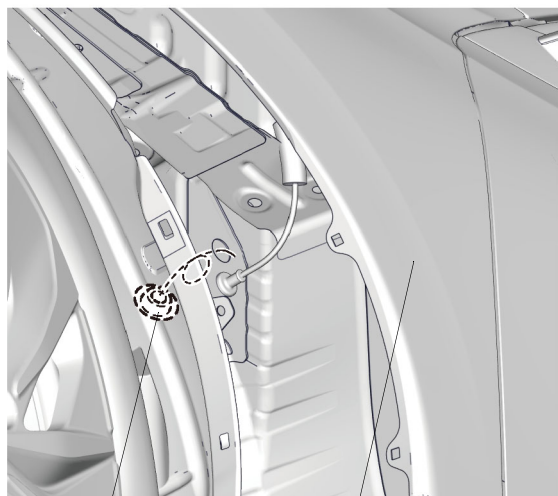

QGN1360BT

49. Route the subharness through the vehicle panel hole, and secure the subharness grommet to the vehicle panel.

NOTE:

- While holding the grommet, carefully insert it into the vehicle panel hole and make sure it is seated properly.
- Do not pull on the socket or harness when installing the grommet.

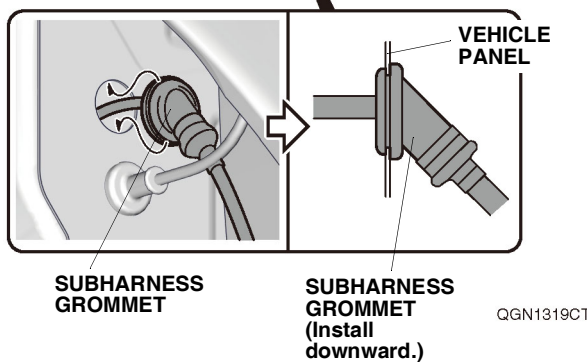
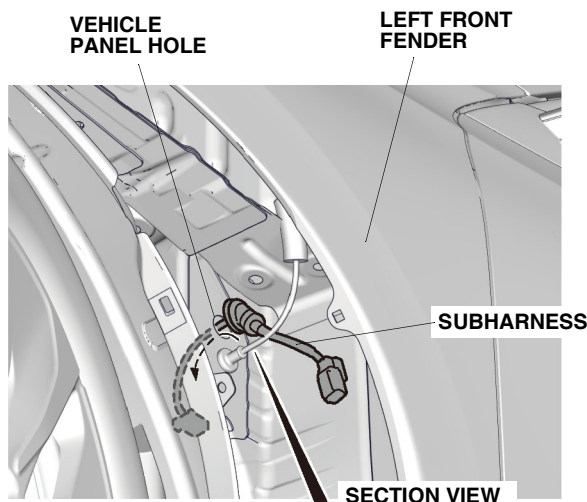

QGN1319CT

50. Install the vehicle harness released in step 46.

51. Attach one piece of urethane tape around the welcome light harness A 6-pin connector (green).

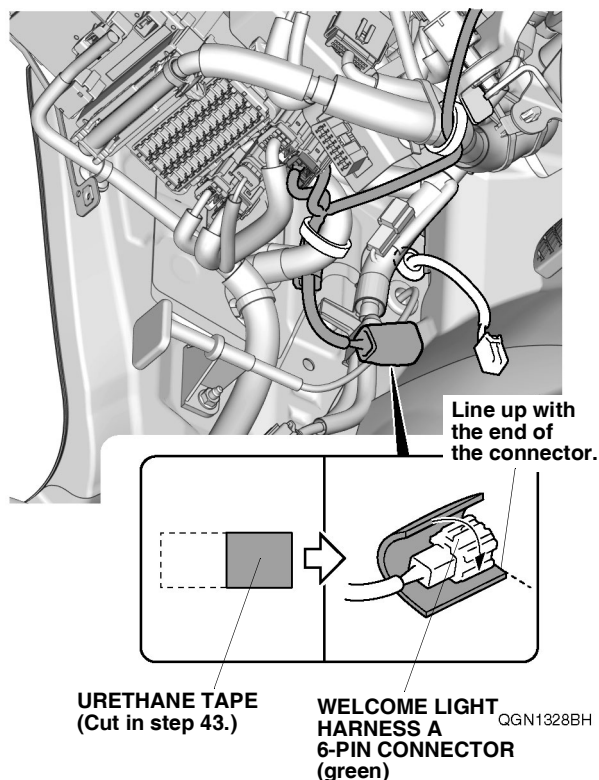

52. Plug the subharness 6-pin connector into the welcome light harness A 6-pin connector (green).

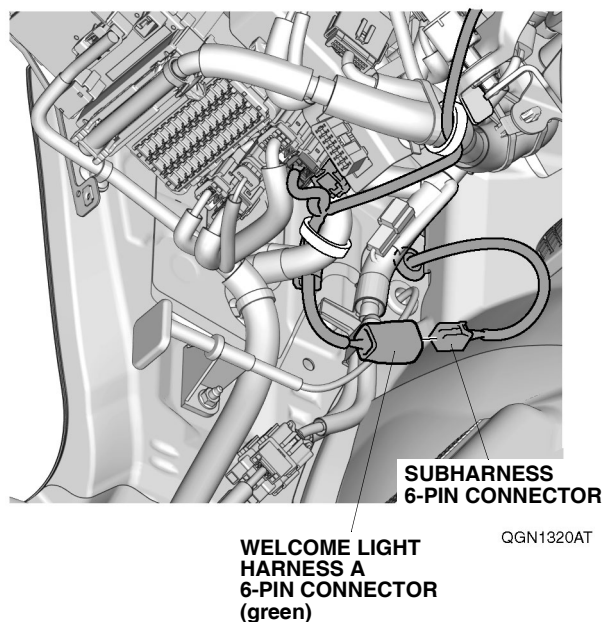

53. Secure the 6-pin connectors and subharness to the vehicle harness with two wire ties. Go to step 57.

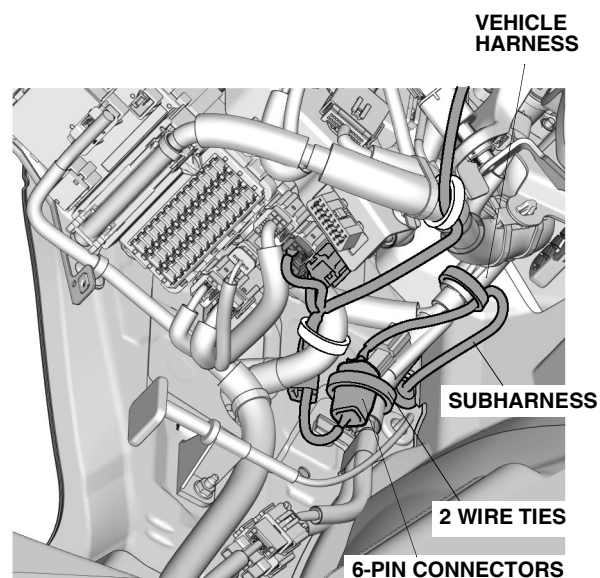

QGN1321BT

With Accessory Parking Sensors

54. Attach one piece of urethane tape around the welcome light harness A 6-pin connector (green).

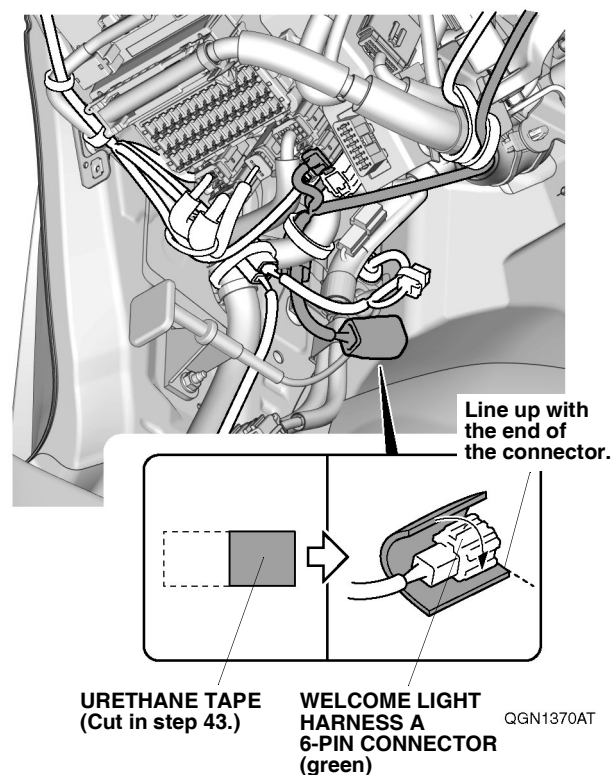

55. Remove the tape from the parking sensor harness, and plug the parking sensor harness 6-pin connector into the welcome light harness A 6-pin connector (green).

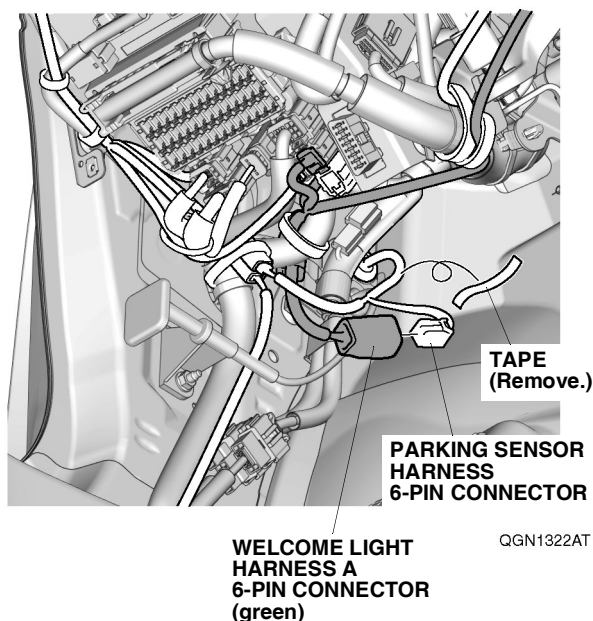

56. Secure the 6-pin connectors to the vehicle harness with one wire tie.

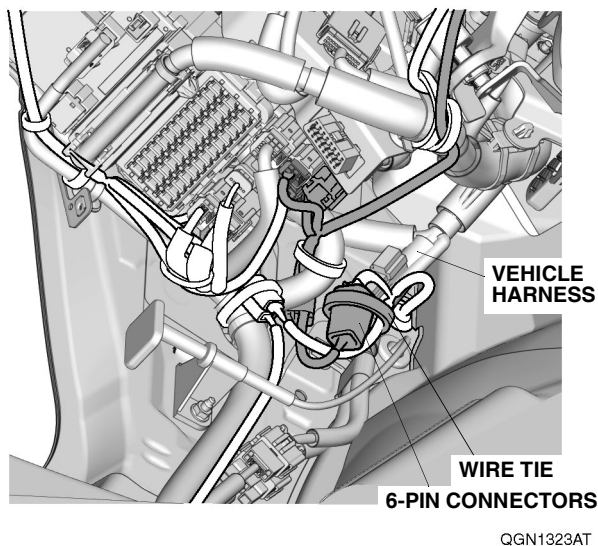

57. Using a pushpin, pierce the inside of the left side sill trim through the center of 18 scribe marks. NOTE: Make sure to pierce perpendicular to the left side sill trim.

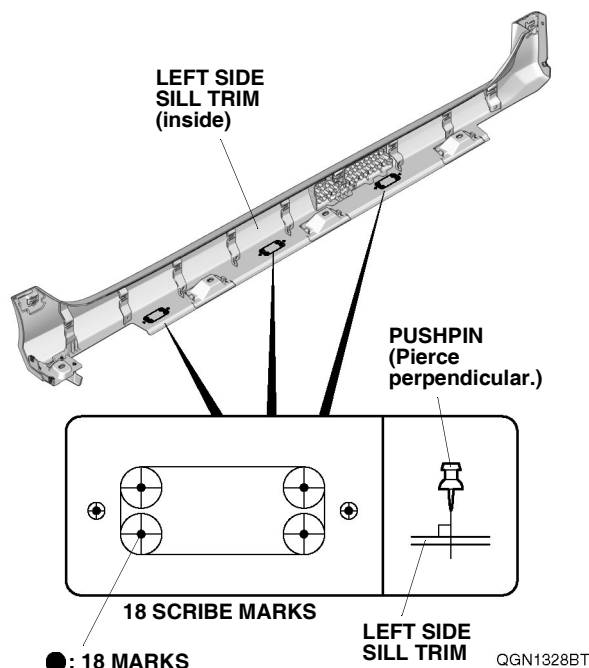

58. While wearing eye protection, drill the 18 pierced marks on the left side sill trim with a 3 mm drill bit. NOTE: Make sure to drill perpendicular to the left side sill trim.

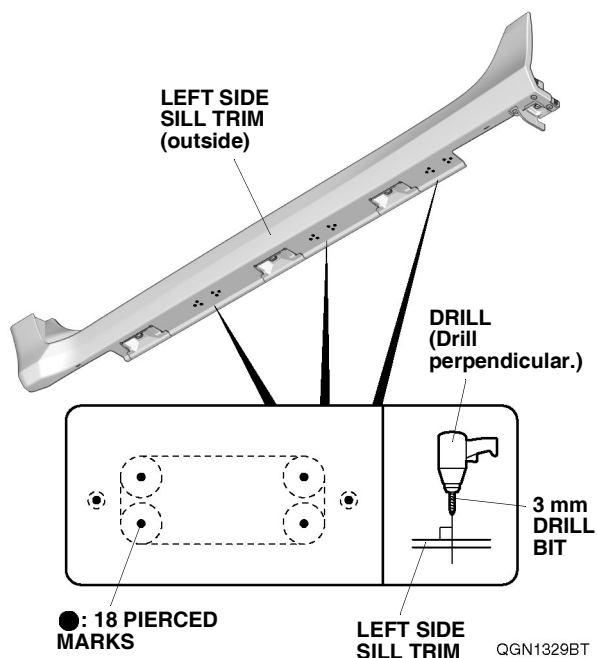

59. While wearing eye protection, enlarge the 3 mm holes on the left side sill trim with a 6 mm drill bit. Remove any burrs.

NOTE:

- Make sure to drill the correct positions.
- Make sure to drill perpendicular to the left side sill trim.

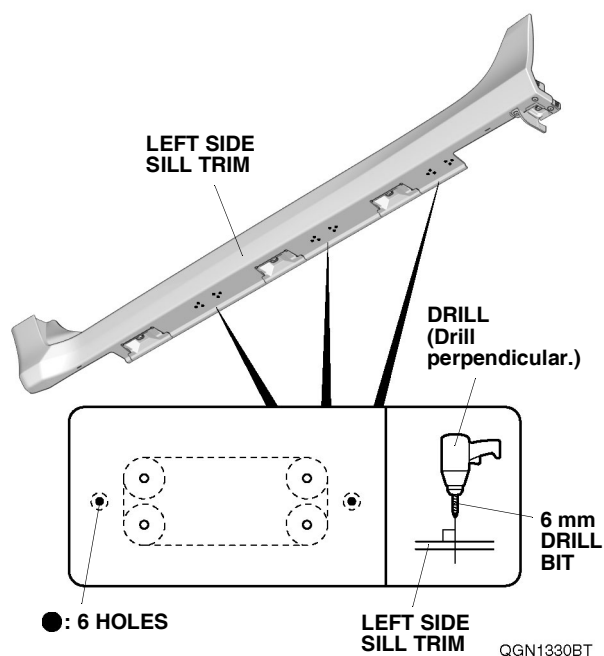

60. While wearing eye protection, enlarge the 3 mm holes on the left side sill trim with a 15 mm hole saw. NOTE:

- Make sure to drill the correct positions.
- Make sure to drill perpendicular to the left side sill trim.

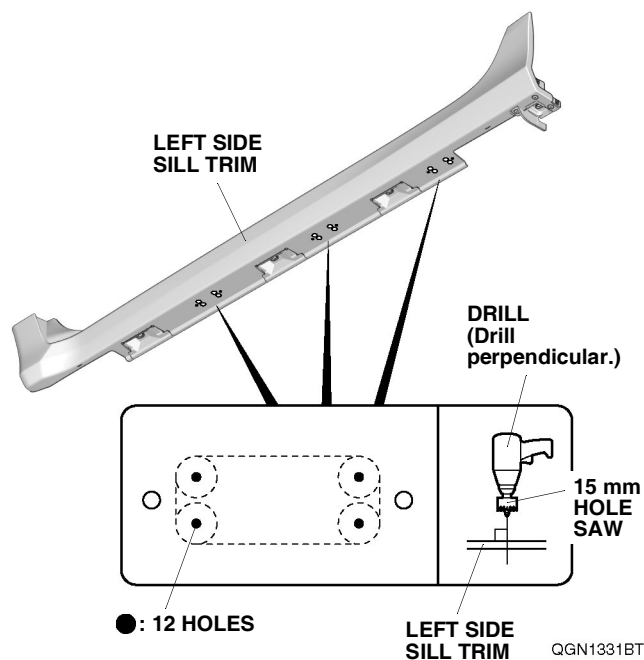

61. Using a hacksaw, cut out the left side sill trim as shown. Remove any burrs.

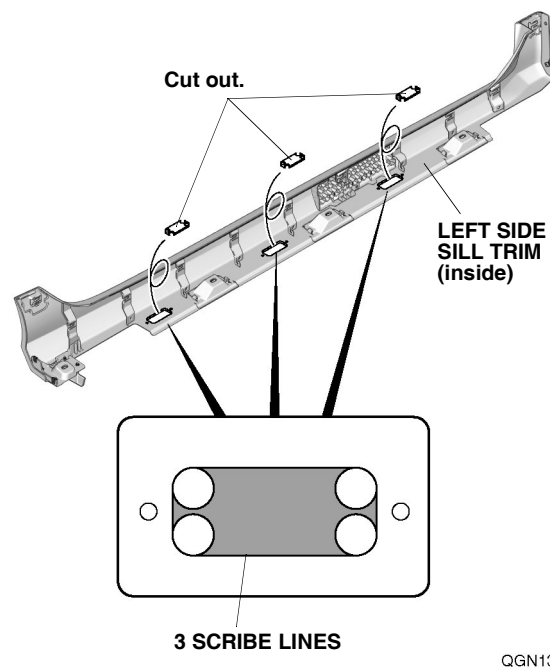

62. Install the six spring nuts on the left side sill trim.
NOTE: Make sure to install the spring nut in the correct orientation.

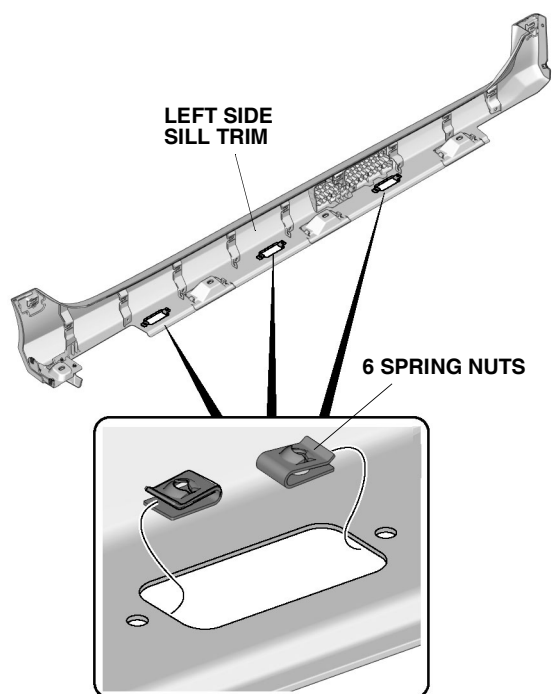

QGN1333AT

63. Install the three covers on the three lights.

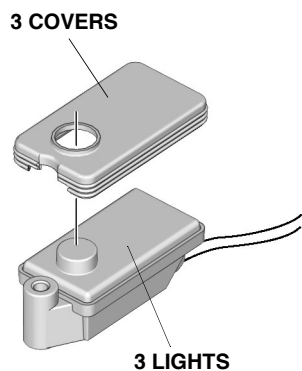

QGN1334AT

64. Install the three lights and three light trims to the left side sill trim with three 4 x 12 mm self-tapping screws and six 5 x 20 mm self-tapping screws.

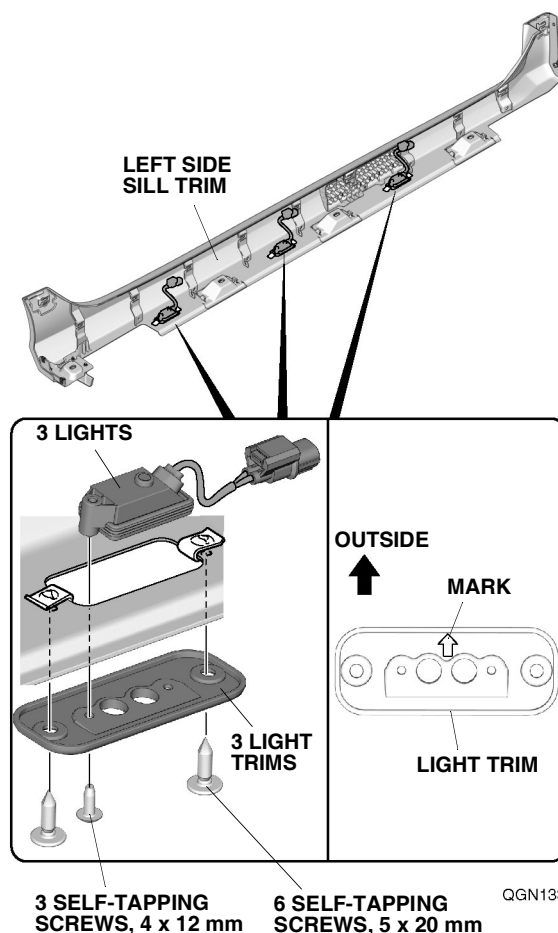

QGN1335BT

65. Plug the welcome light harness B 2-pin connectors into the light 2-pin connectors.

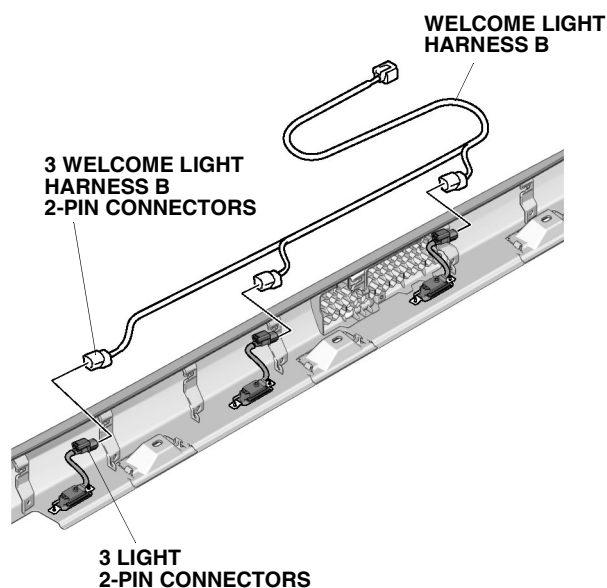

QGN1336AT

66. Install the two wire ties to the 2-pin connectors, and secure the 2-pin connectors to the left side sill trim with two wire ties as shown.

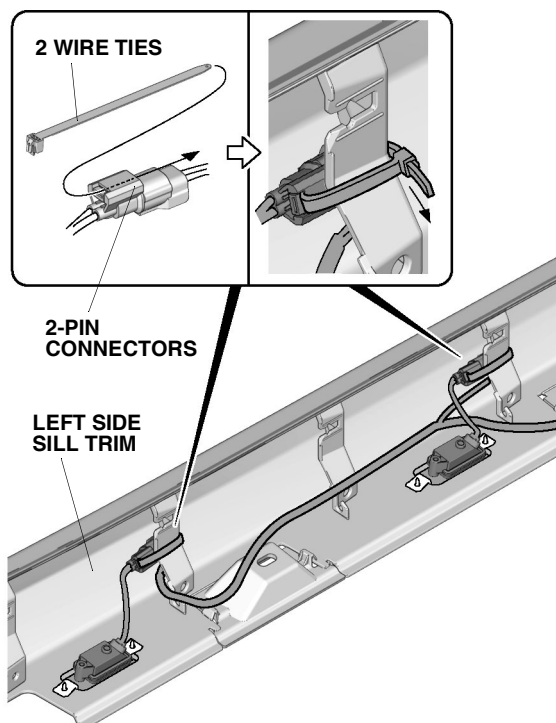

QGN1337BT

67. Secure the 2-pin connectors to the left side sill trim with one wire tie.

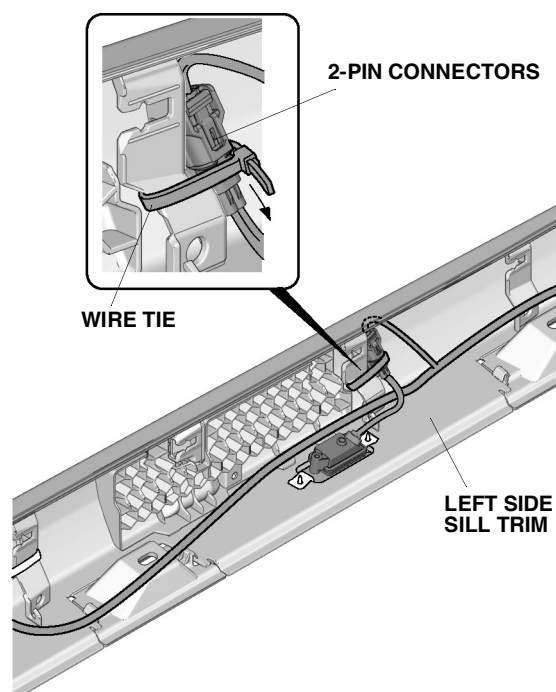

QGN1338AT

68. Secure the welcome light harness B to the left side sill trim.

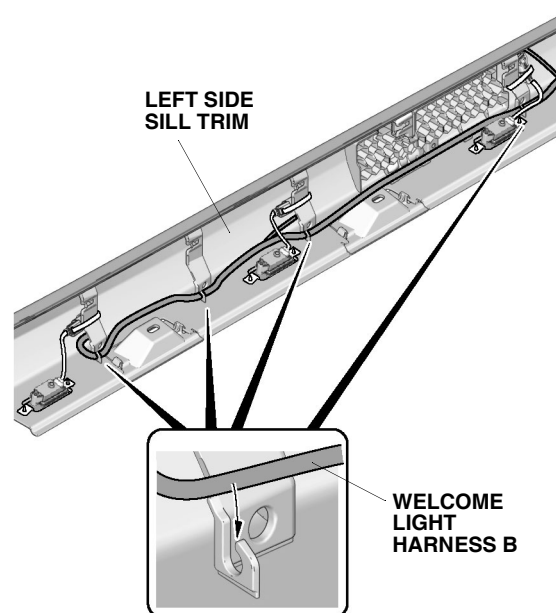

QGN1339AT

69. Secure the one wire tie with clip to the left side sill trim, and secure welcome light harness B with one wire tie with clip.

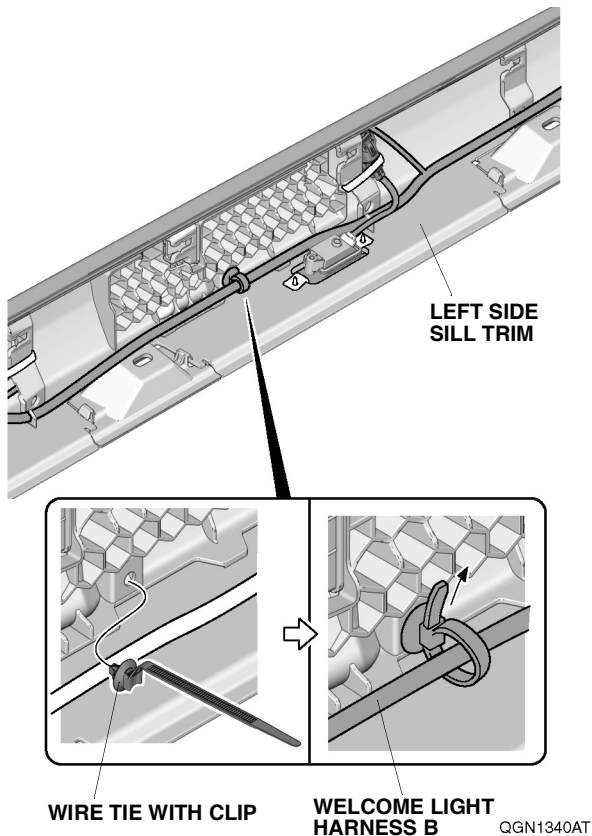

70. Using an alcohol wipe, thoroughly clean the area where the aluminum tape will attach.

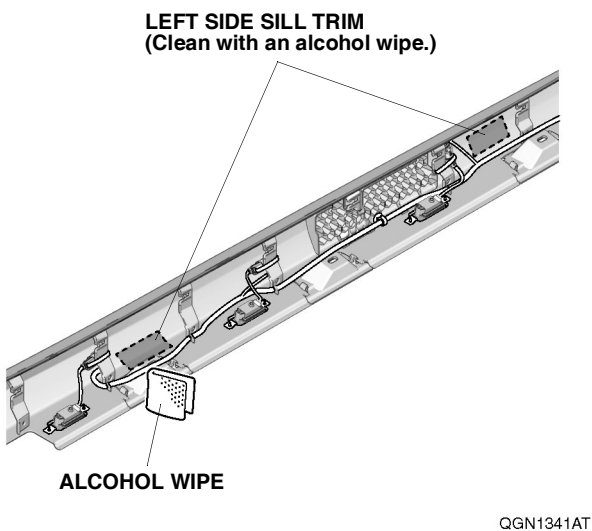

71. Secure welcome light harness B to the left side sill trim with two pieces of aluminum tape as shown.

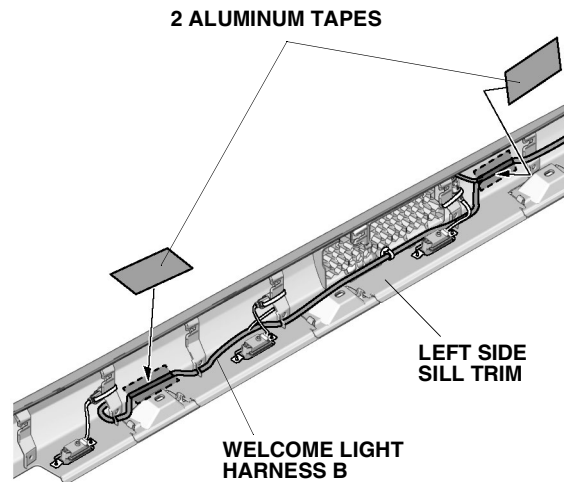

QGN1342AT

72. Secure the light harness to welcome light harness B with one short wire tie.

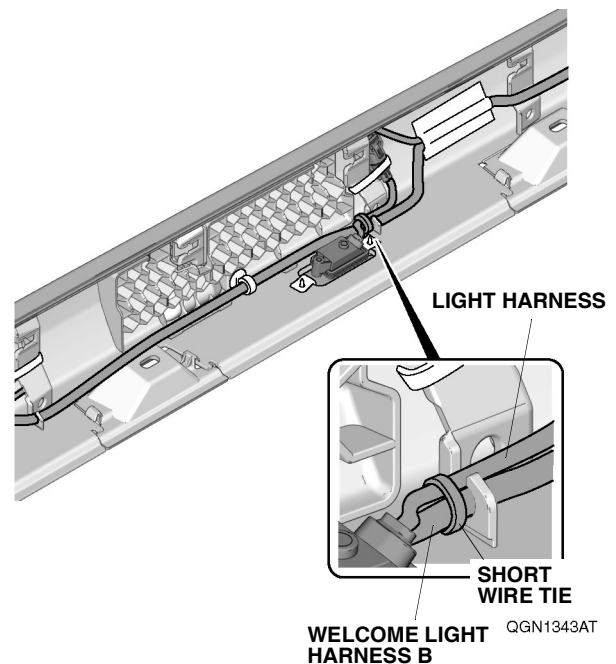

73. Secure welcome light harness B with two short wire ties to the left side sill trim.

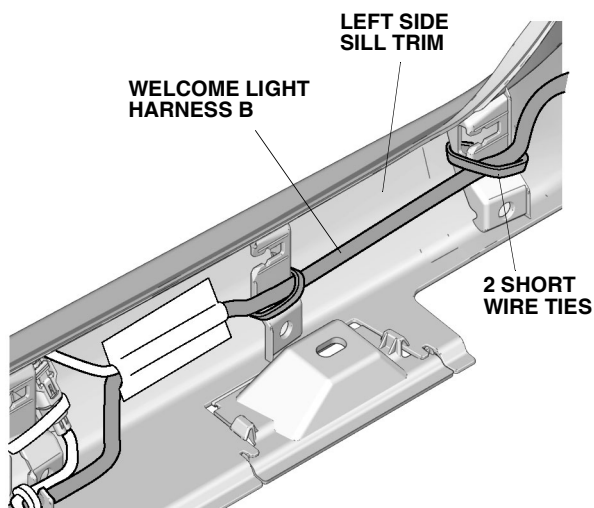

QGN1344AT

74. Install the 11 clips removed in step 19 on the left side sill trim as shown.

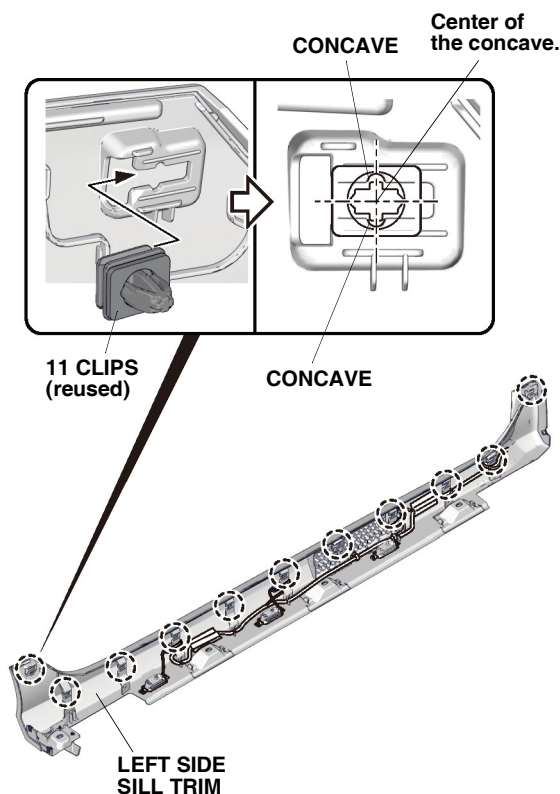

QGN1345BT

75. Secure the one wire tie to the left front fender as shown.

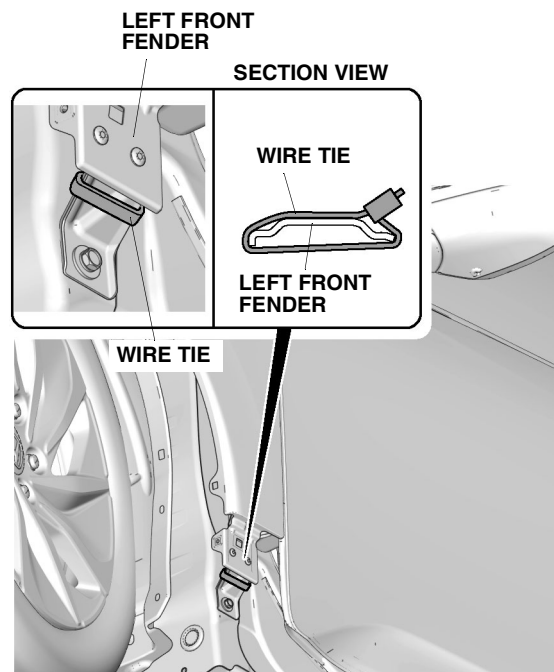

QGN1346AT

76. Install the left side sill trim to the vehicle panel.

If the vehicle is equipped with accessory parking sensors (left side only), go to step 78; otherwise, continue with step 77.

Without Another Accessory

77. Plug the welcome light harness B 6-pin connector into the subharness 6-pin connector. Go to step 79.

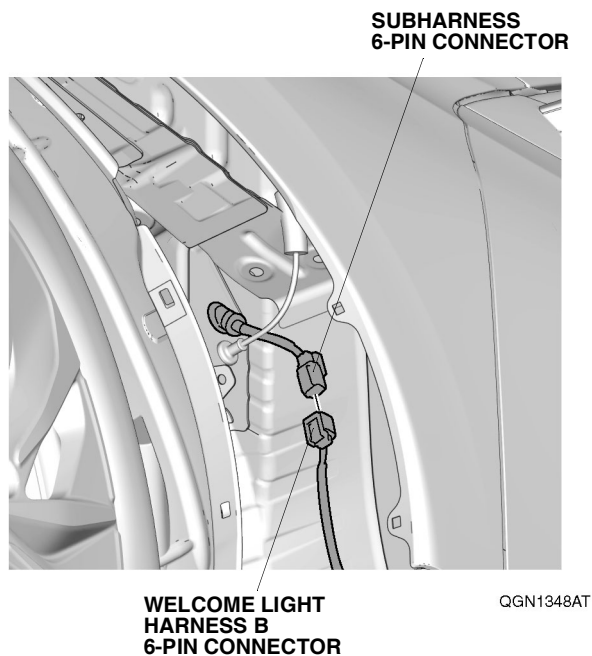

With Accessory Parking Sensors (Left Side Only)

78. Remove the tape and dummy connector from the parking sensor harness 6-pin connector, and plug the welcome light harness B 6-pin connector into the parking sensor harness 6-pin connector.

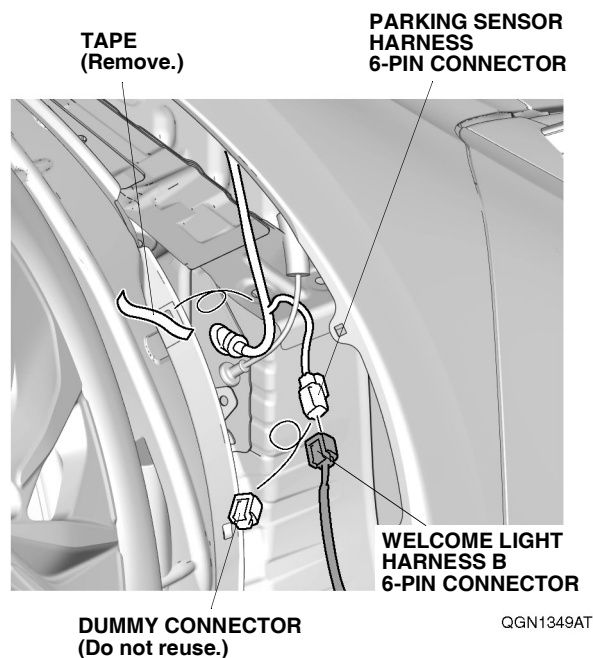

79. Using isopropyl alcohol, thoroughly clean the area where the holder will attach.

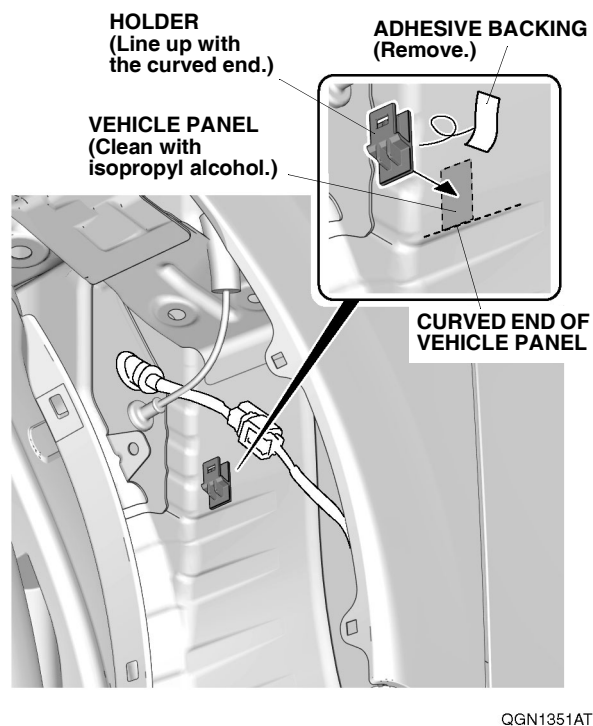

80. Remove the adhesive backing to the holder, and attach the holder to the vehicle panel as shown.

81. Attach the 6-pin connectors to the holder as shown.

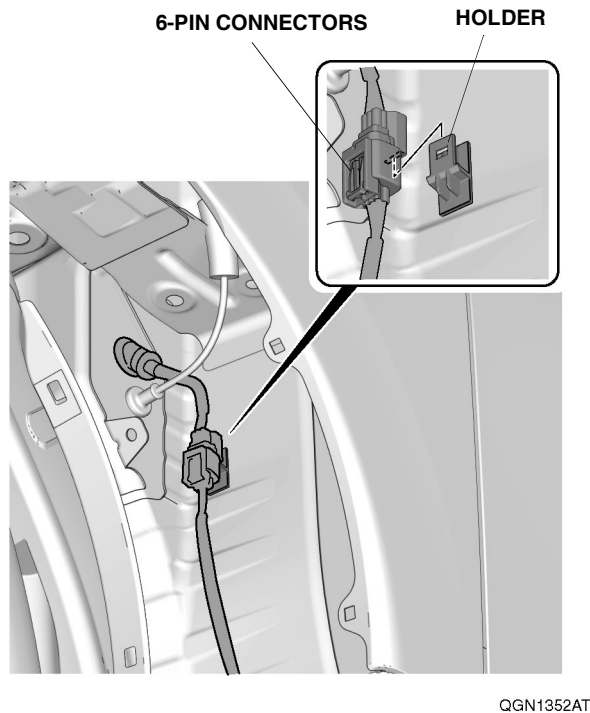

82. Secure the welcome light harness B with one wire tie as shown.

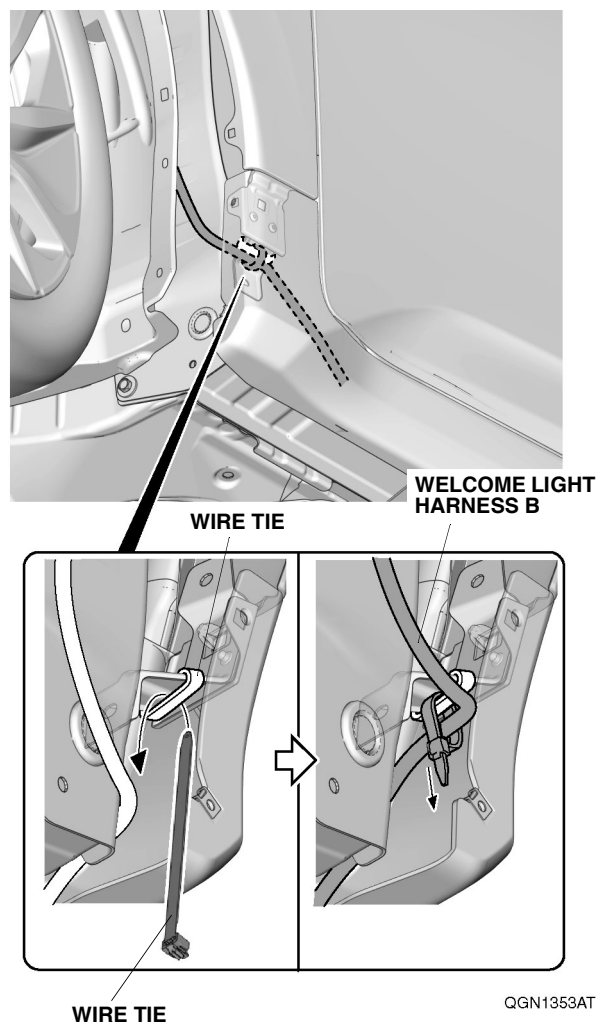

83. Repeat steps 57 through 82 on the right side of the vehicle.
84. Check that all wire harnesses are routed properly and all connectors are plugged in.
85. Install all removed parts except for the right side panel.
86. Connect the negative cable to the battery.
87. Install the right side panel.
88. Press and hold the audio unit power button for 2 seconds to restore the audio and navi (if equipped) system functions.
89. Set the clock on vehicle without navigation.
90. If necessary, restore the systems back to normal operation as described in the service information.

Check the Operation of the Welcome Lights

91. Make sure the light comes on when you open each door.