



HONDA INSTALLATION INSTRUCTIONS

Accessory
DOOR LOWER TRIM

Application
2022 INSIGHT

Publications No.
VERSION 1
Issue Date
MAY 2021

PARTS LIST

Door Lower Trim Kit
P/N 08F57-TXM-100
P/N 08F57-TXM-100A

Left front door lower trim
(Identification mark: FR-L)



Right front door lower trim
(Identification mark: FR-R)



Left rear door lower trim
(Identification mark: RR-L)



Right rear door lower trim
(Identification mark: RR-R)



Front template

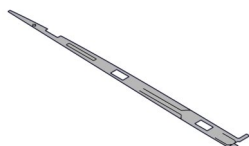

Rear template

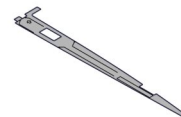

4 Alcohol wipes



TOOLS AND SUPPLIES REQUIRED

Masking tape

The following tool is available through the Honda Tool and Equipment Program. On the iN, click on Service > Service Bay > Tool and Equipment Program, then enter the number under "Search." Or, call 888-424-6857.

Rubber Roller (T/N MHLE54D)

Illustration of the Door Lower Trim Installed on the Vehicle

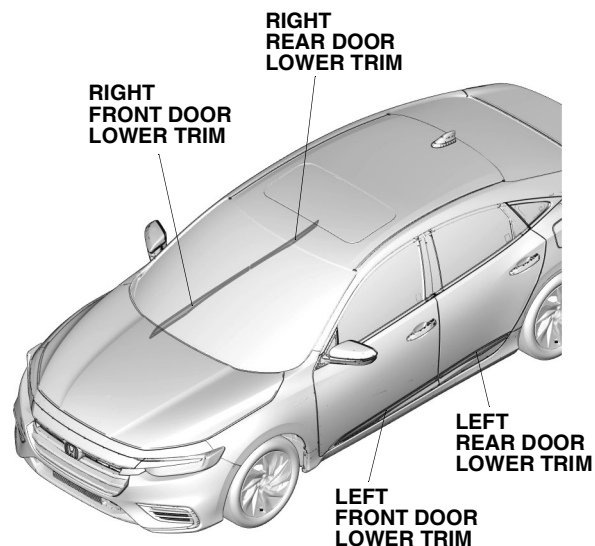

QG00601AT

INSTALLATION

Customer Information: The information in this installation instruction is intended for use only by skilled technicians who have the proper tools, equipment, and training to correctly and safely add equipment to your vehicle. These procedures should not be attempted by "do-it-yourselfers."

NOTE:

- Be careful not to damage the paint finish.
- This door lower trim kit should be installed only if the ambient air temperature is 15°C (60°F) or above.
- To allow the adhesive to cure, do not wash the vehicle for 24 hours. Make sure your customer is aware of this.

1. Fold the front template tab as shown.

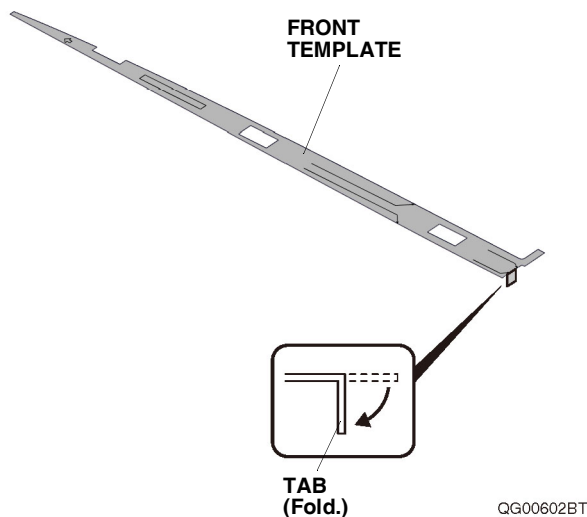

2. Line up the bottom of the front template with the curved end. Then, line up the rear of the front template with the edge of the left front door, and attach it to the left front door with masking tape as shown.

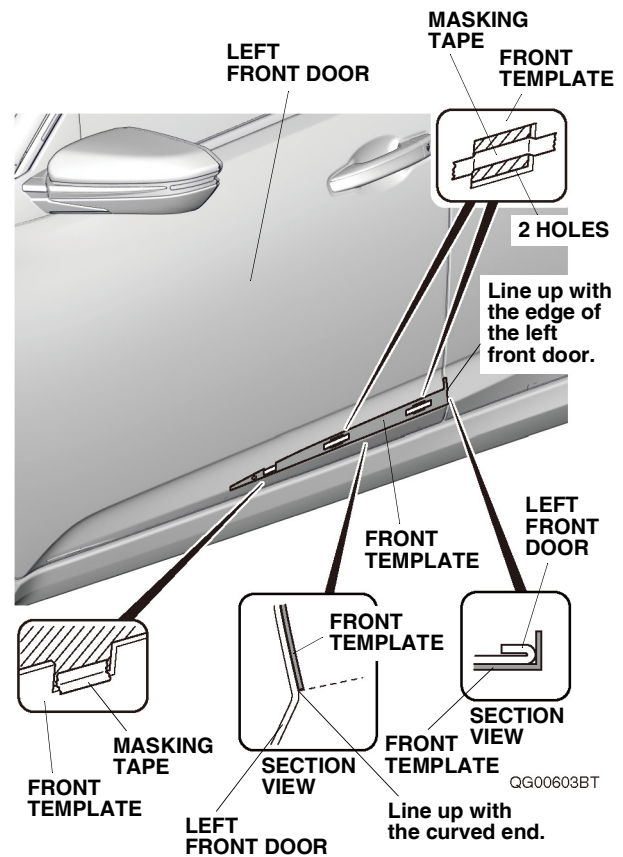

3. Fold the rear template tab as shown.

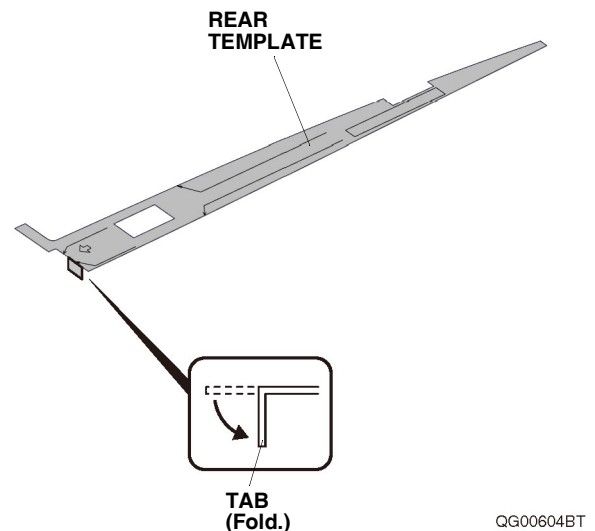

- Line up the bottom of the rear template with the curved end. Then, line up the front of the rear template with the edge of the left rear door, and attach it to the left rear door with masking tape as shown.

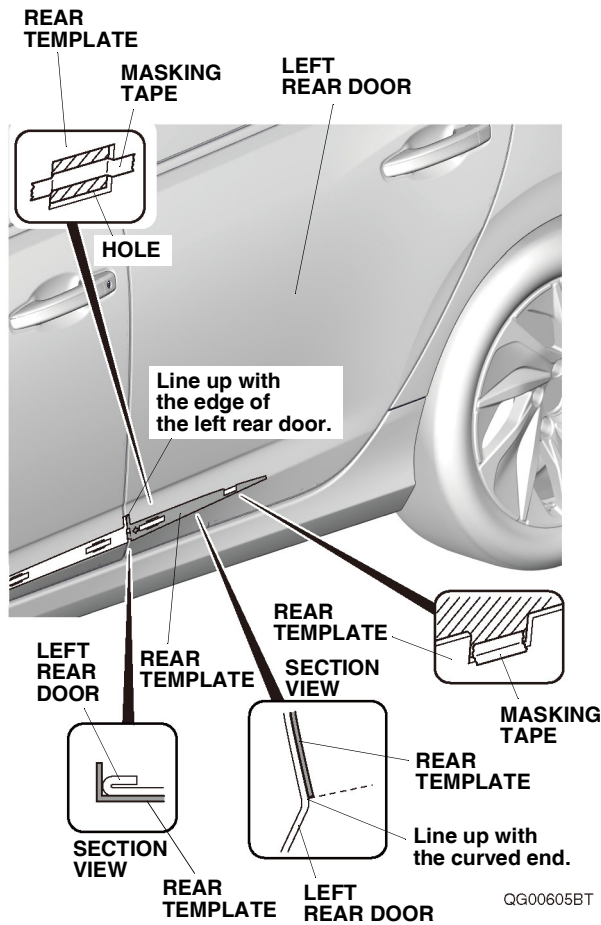

- Using an alcohol wipe, thoroughly clean the area where the left front door lower trim will attach.

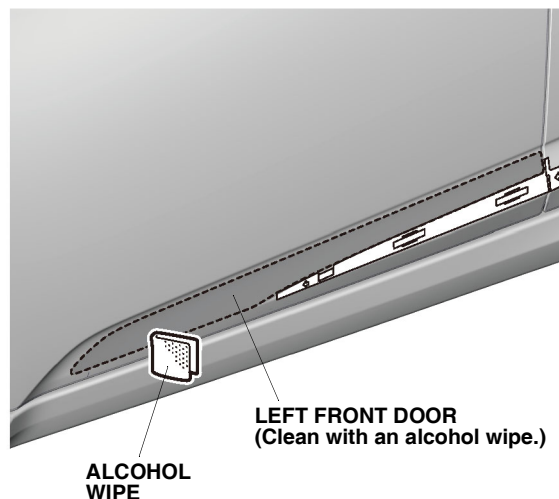

- Using an alcohol wipe, thoroughly clean the left rear door where the left rear door lower trim will attach.

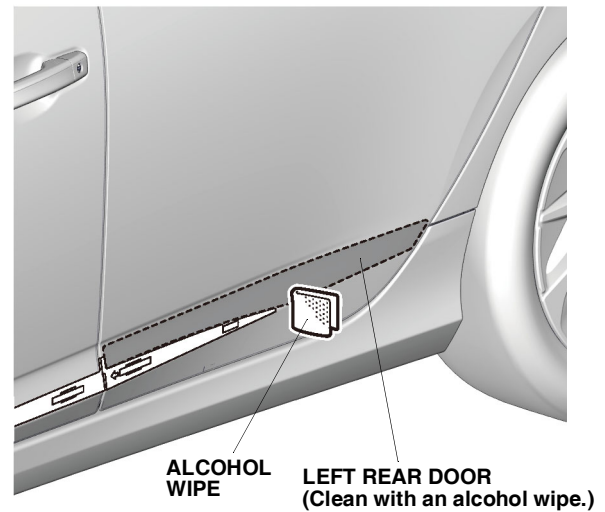

- Peel back the adhesive backings, and tape them to the front surface of the left front door lower trim with masking tape. Remove the other adhesive backings.

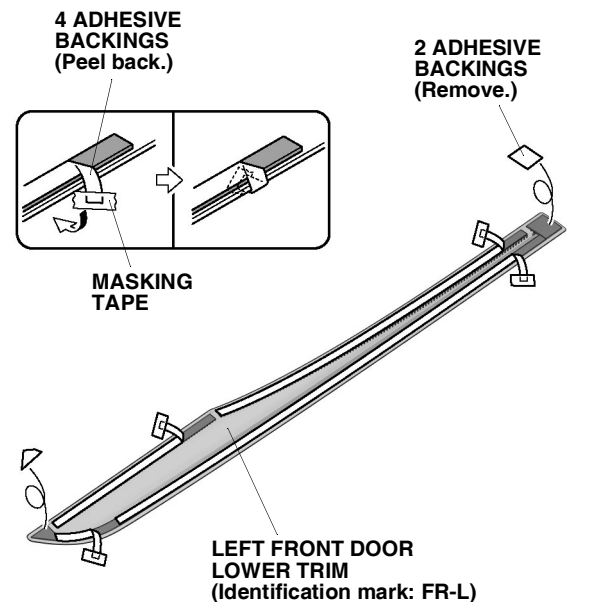

8. Line up the left front door lower trim with the front template, and install the left front door lower trim on the left front door.

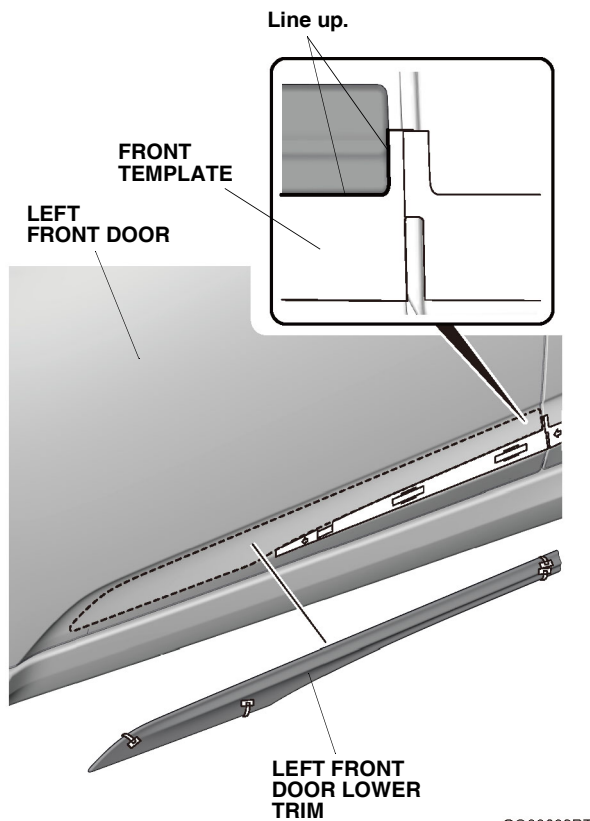

9. While applying light pressure against the left front door lower trim, carefully remove the taped adhesive backings.

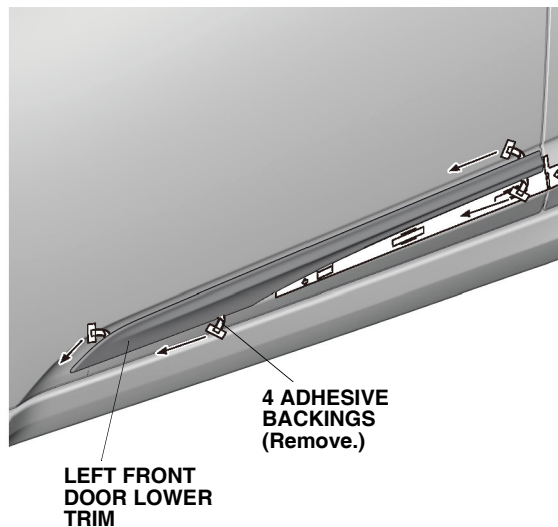

10. Using the rubber roller, apply firm pressure while rolling, especially at the ends, to set the adhesive.

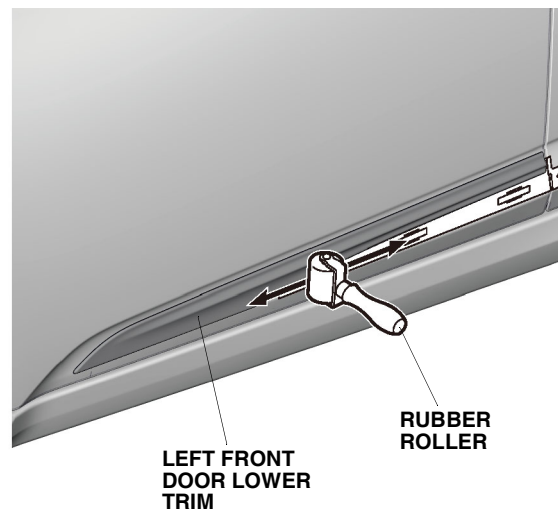

11. Peel back the adhesive backings, and tape them to the front surface of the left rear door lower trim with masking tape. Remove the other adhesive backings.

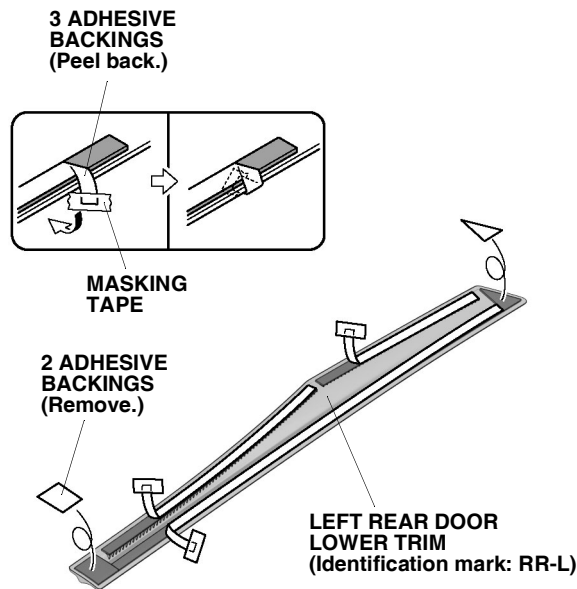

12. Line up the left rear door lower trim with the rear template, and install the left rear door lower trim on the left rear door.

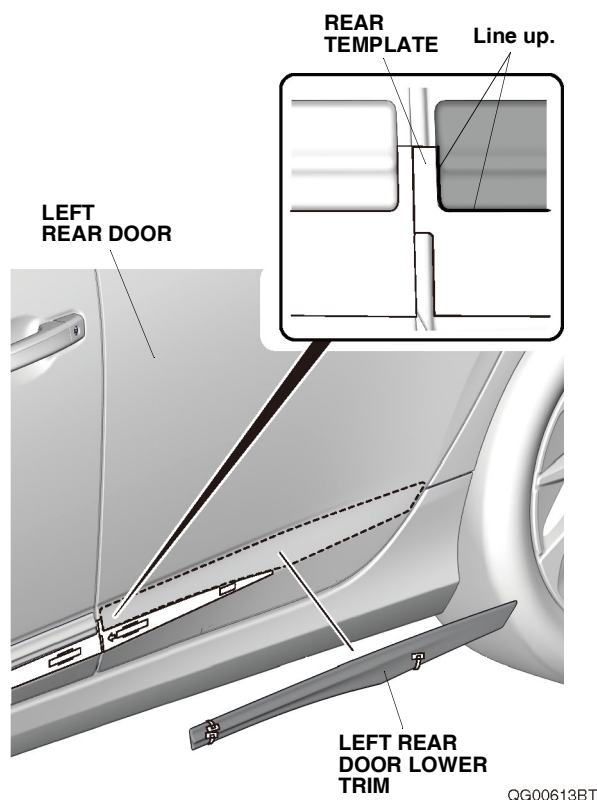

13. While applying light pressure against the left rear door lower trim, carefully remove the taped adhesive backings.

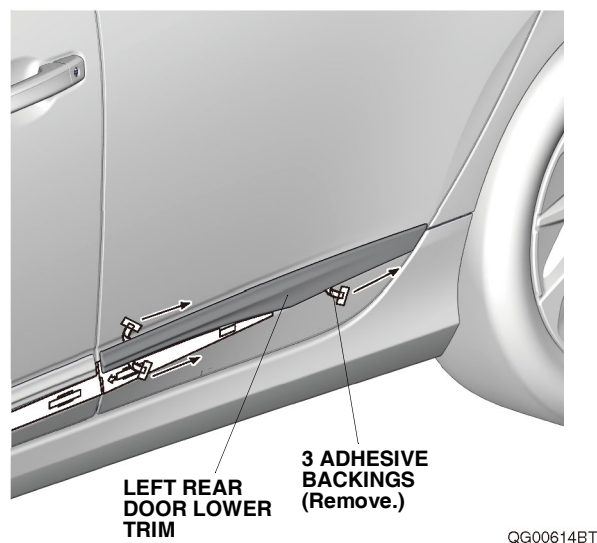

14. Using the rubber roller, apply firm pressure while rolling, especially at the ends, to set the adhesive.

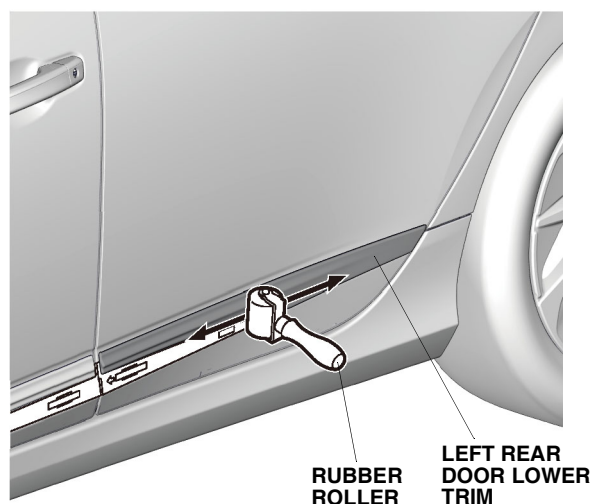

15. Remove the front and rear templates.
16. Turn the front and rear templates over, and repeat steps 1 through 15 to install the right door lower trim.