



HONDA INSTALLATION INSTRUCTIONS

Accessory

FRONT GRILLE TRIM
P/N 08F21-TXM-100A

Application

2022 INSIGHT

Publications No.

VERSION 1

Issue Date

MAY 2021

PARTS LIST

Front grille trim



Template



Alcohol wipe

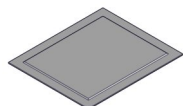

TOOLS AND SUPPLIES REQUIRED

Masking tape

Scissors

Ruler

The following tool is available through the Honda Tool and Equipment Program. On the iN, click on Service > Service Bay > Tool and Equipment Program, then enter the number under "Search." Or, call 888-424-6857.

Rubber Roller (T/N MHLE54D)

Illustration of the Front Grille Trim Installed on the Vehicle

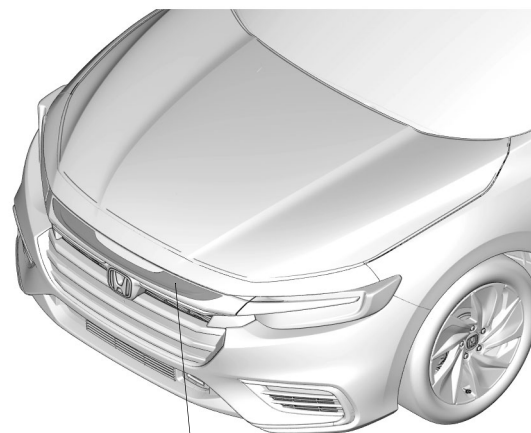

FRONT GRILLE TRIM

QG01201AT

INSTALLATION

Customer Information: The information in this installation instruction is intended for use only by skilled technicians who have the proper tools, equipment, and training to correctly and safely add equipment to your vehicle. These procedures should not be attempted by "do-it-yourselfers."

NOTE:

- Be careful not to damage the body paint finish.
- This kit should be installed only if the ambient air temperature is 15°C (60°F) or above.
- To allow the adhesive to cure, do not wash the vehicle for 24 hours. Make sure your customer is aware of this.

1. Using scissors, cut the template as shown.

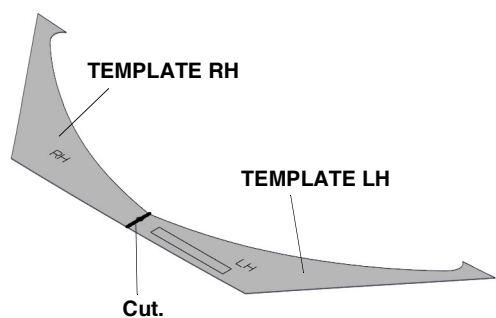

QG01210AT

2. Line up templates LH and RH with the front grille, and attach them with masking tape as shown.

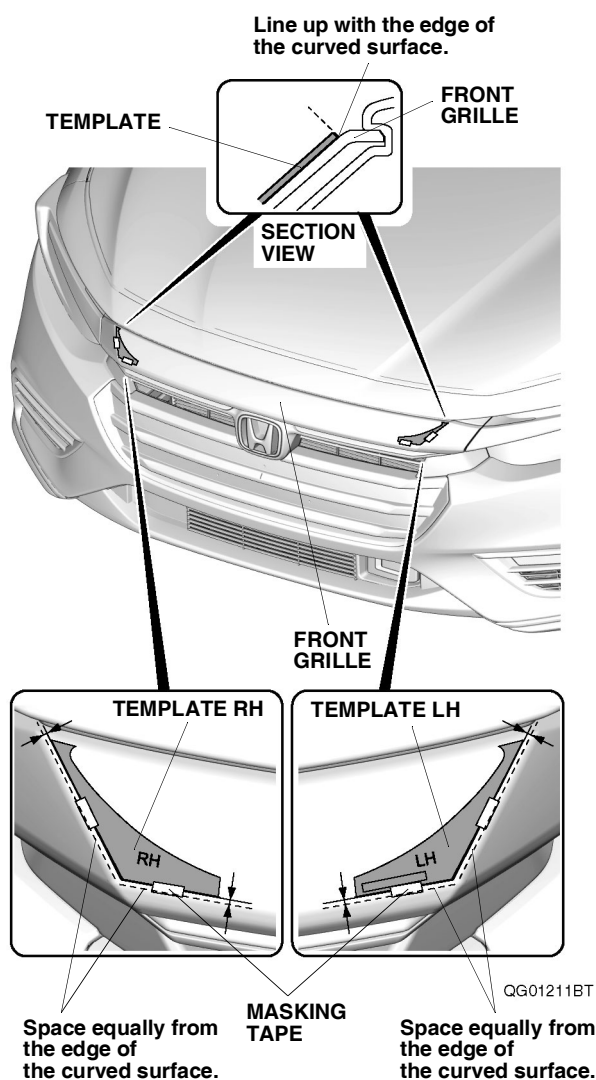

QG01211BT

3. Using an alcohol wipe, thoroughly clean the front grille where the front grille trim will attach.

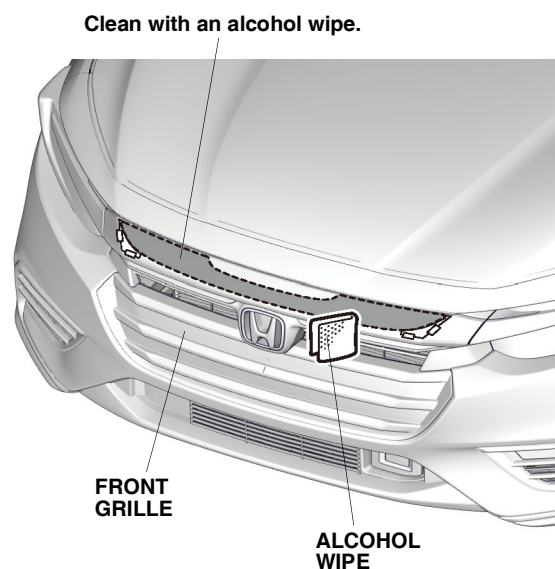

QG01202BT

4. Peel back the adhesive backings, and tape them to the front surface of the front grille trim with masking tape.

10 ADHESIVE BACKINGS
(Peel back.)

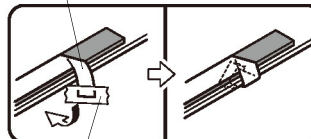

MASKING TAPE

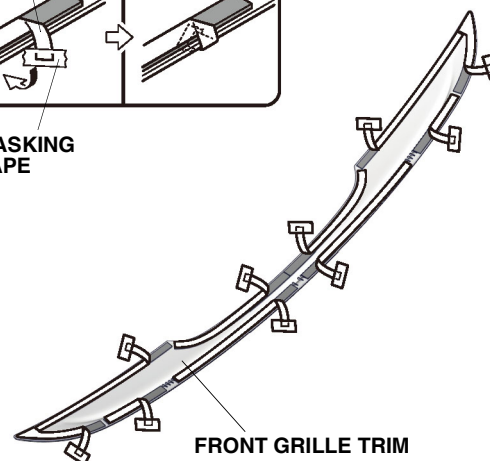

QG01205BT

- Line up the front grille trim with the front grille, and attach it as shown.

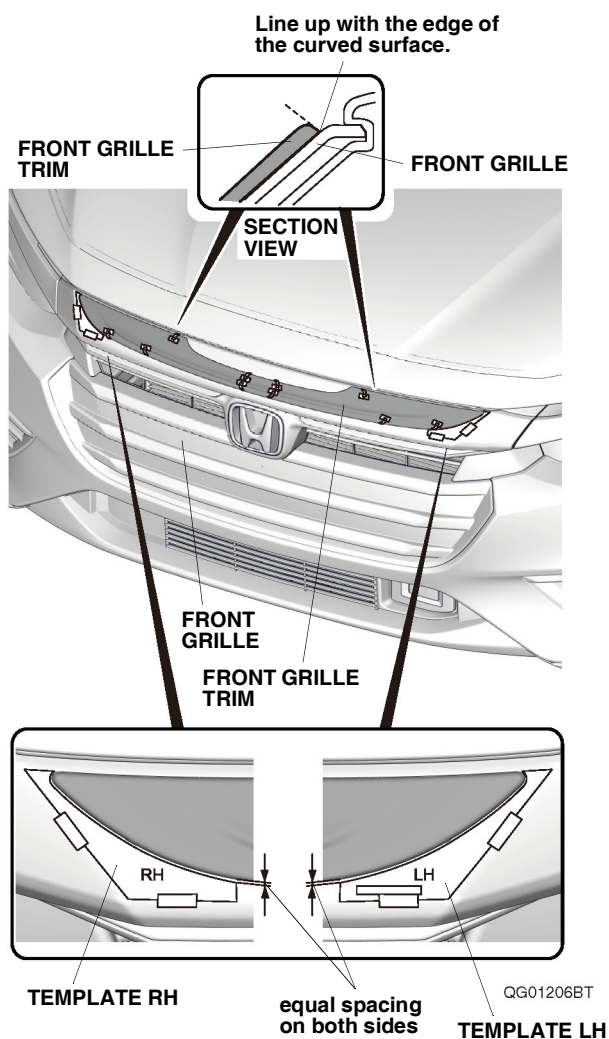

- While applying light pressure against the front grille trim, carefully remove the taped adhesive backings as shown.

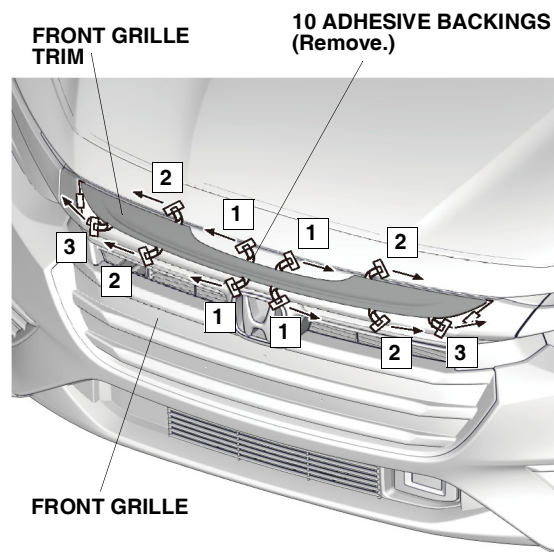

- Using a rubber roller, apply firm pressure while rolling, especially at the ends, to set the adhesive.

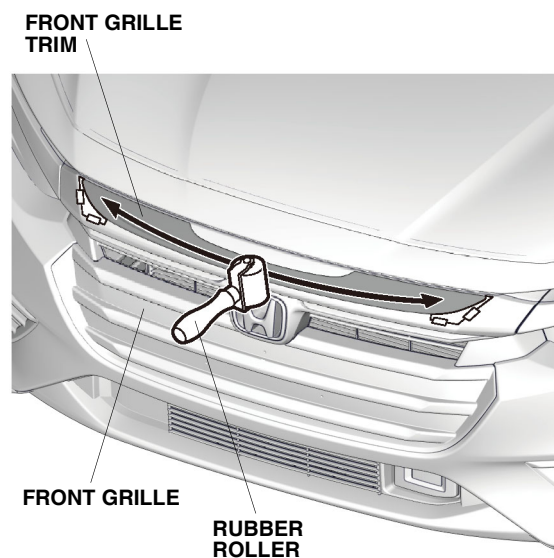

- Remove templates LH and RH.