



HONDA INSTALLATION INSTRUCTIONS

Accessory
DOOR LINING COVERS
P/N 08Z03-TXM-100

Application
2022 INSIGHT

Publications No.
VERSION 1
Issue Date
MAY 2021

PARTS LIST

Right front door lining cover

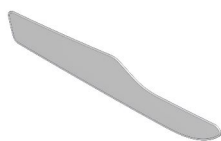

Left front door lining cover



Right rear door lining cover



Left rear door lining cover



Front template

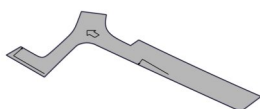

Rear template

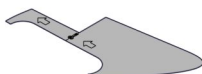

TOOLS AND SUPPLIES REQUIRED

Isopropyl alcohol

Shop towel

Scissors

Masking tape

The following tool is available through the Honda Tool and Equipment Program. On the iN, click on Service > Service Bay > Tool and Equipment Program, then enter the number under "Search." Or, call 888-424-6857.

Rubber Roller (T/N MHLE54D)

Illustration of the Door Lining Covers Installed in the Vehicle

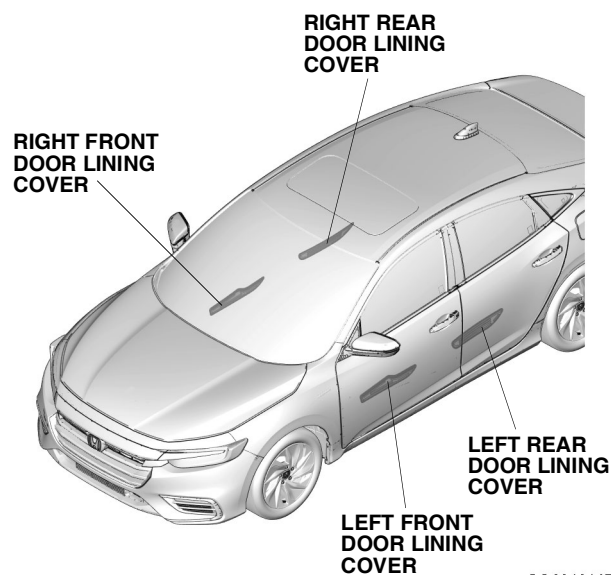

QG00401AT

INSTALLATION

Customer Information: The information in this installation instruction is intended for use only by skilled technicians who have the proper tools, equipment, and training to correctly and safely add equipment to your vehicle. These procedures should not be attempted by "do-it-yourselfers."

NOTE:

- Be careful not to damage the body paint finish.
- This kit should be installed only if the ambient air temperature is 15°C (60°F) or above.

1. Line up the front template with the edges of the right front speaker and right front door pocket as shown. Tape the front template to the right front door lining with masking tape.

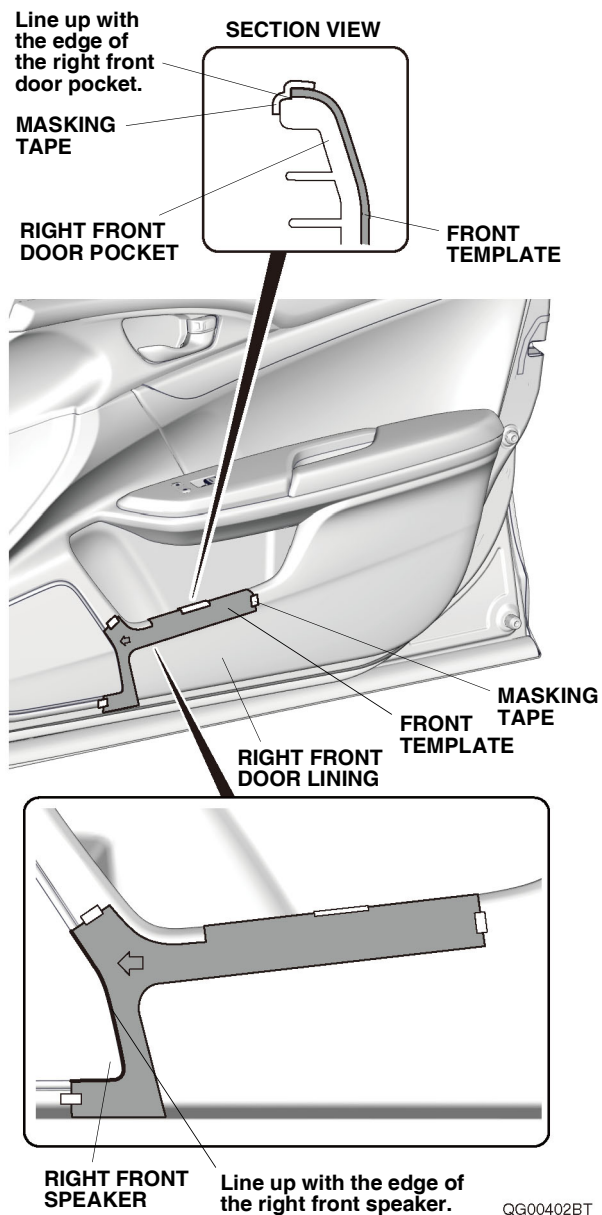

2. Peel back the adhesive backings, and tape them to the front surface of the right front door lining cover with masking tape. Remove the remaining adhesive backings.

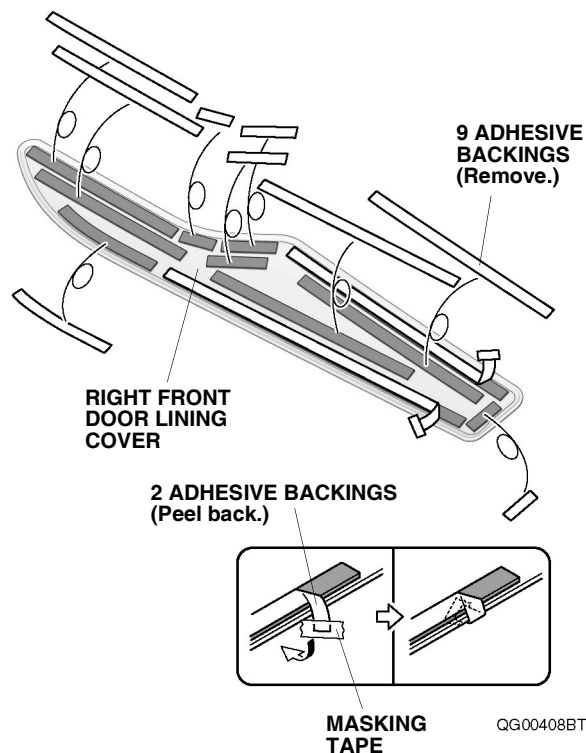

3. Using isopropyl alcohol on a shop towel, thoroughly clean the area where the right front door lining cover will attach.

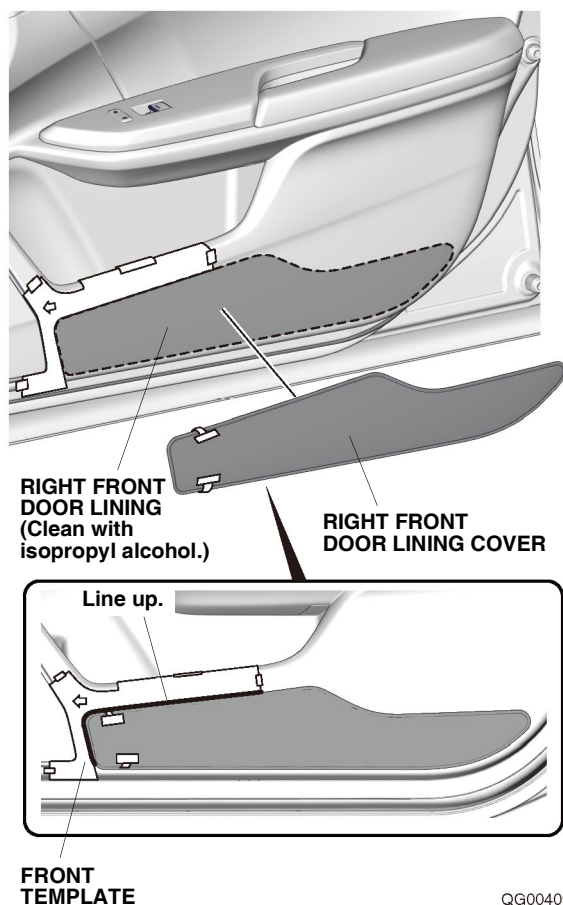

4. Line up the right front door lining cover with the front template, and attach it as shown.

5. While applying light pressure against the right front door lining cover, carefully remove the taped adhesive backings.

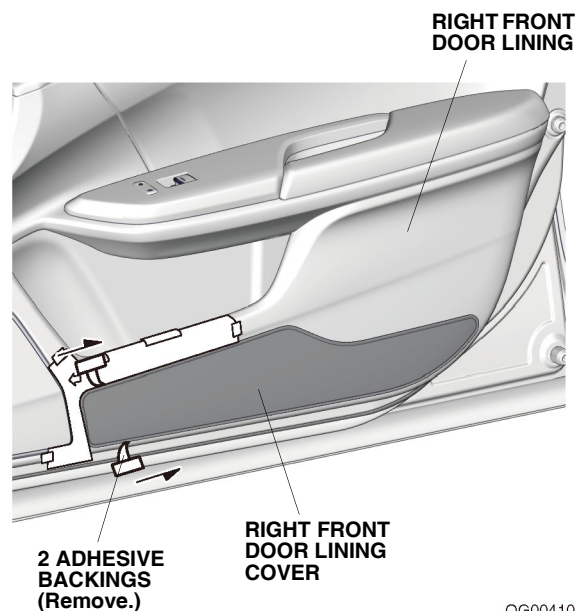

6. Using the rubber roller, apply firm pressure while rolling, especially at the ends, to set the adhesive as shown.

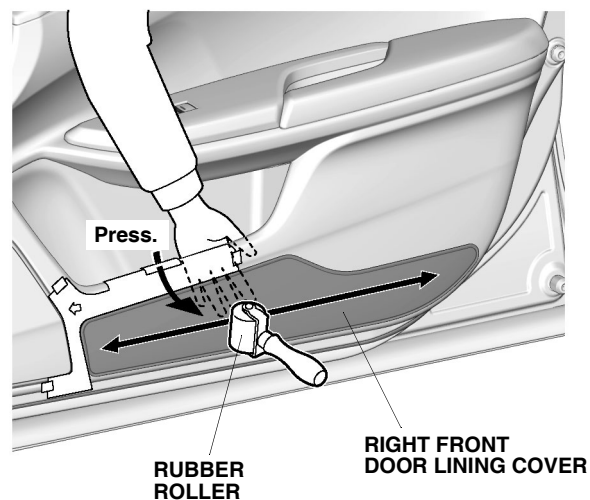

7. Remove the front template.
8. Turn the front template over, and repeat steps 1 through 7 on the left side of the vehicle.

9. Using scissors, cut the rear template as shown.

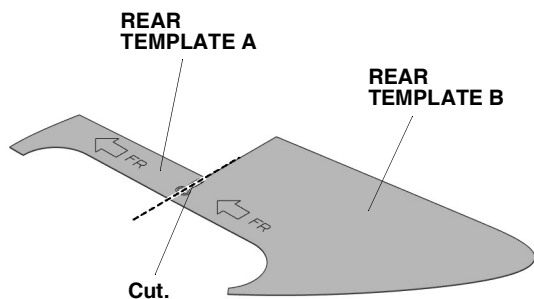

QG00431AT

10. Line up rear templates A and B with the curved end of the right rear door lining as shown. Tape rear templates A and B to the right rear door lining with masking tape.

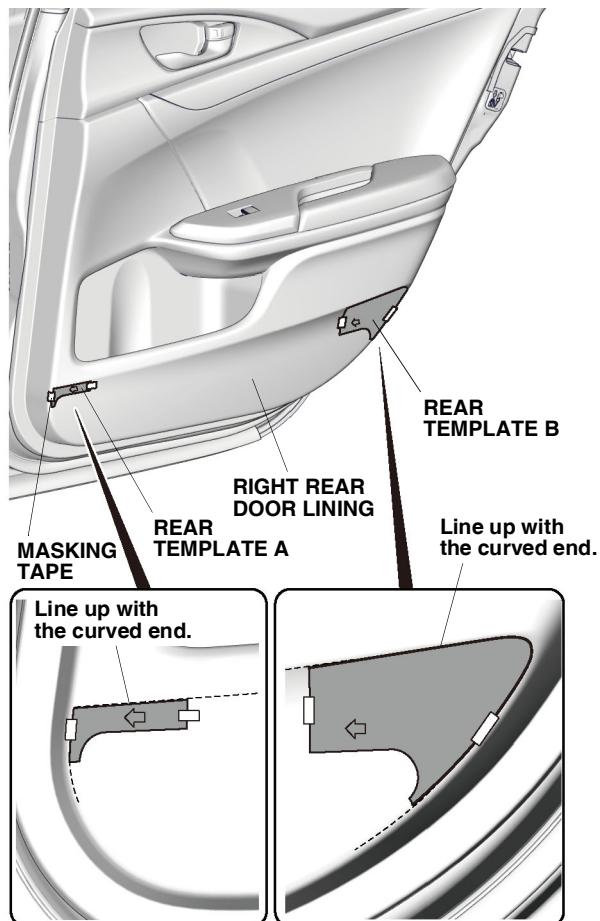

QG00432AT

11. Peel back the adhesive backings, and tape them to the front surface of the right rear door lining cover with masking tape. Remove the remaining adhesive backings.

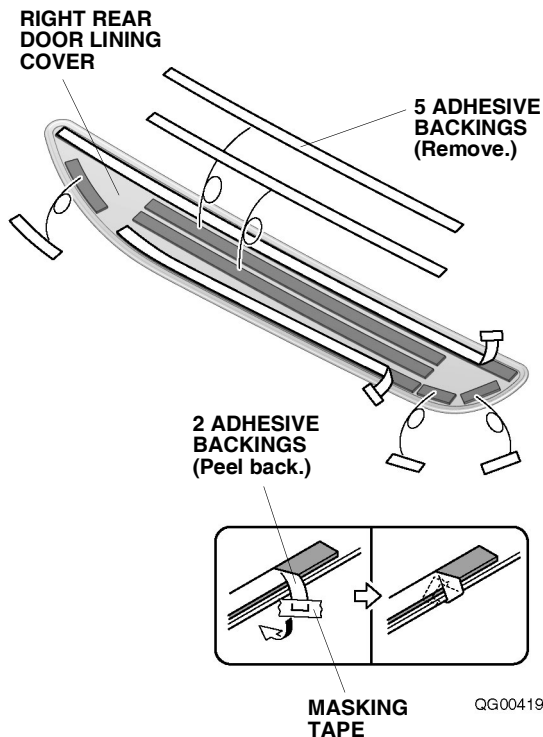

QG00419BT

12. Using isopropyl alcohol on a shop towel, thoroughly clean the area where the right rear door lining cover will attach.

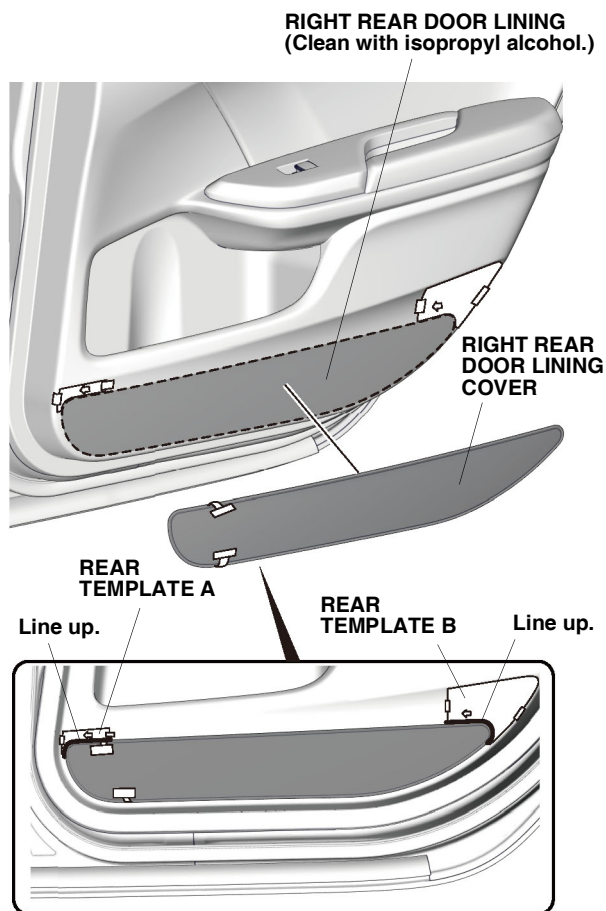

QG00420CT

13. Line up the right rear door lining cover with rear templates A and B, attach it as shown.

14. While applying light pressure against the right rear door lining cover, carefully remove the taped adhesive backings.

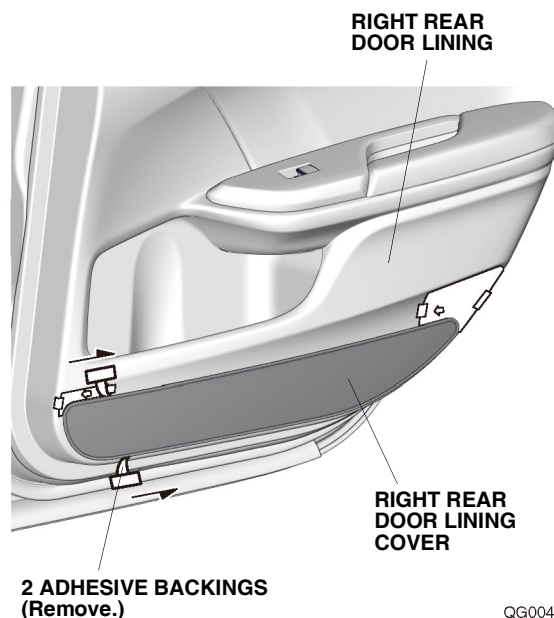

QG00421BT

15. Using the rubber roller, apply firm pressure while rolling, especially at the ends, to set the adhesive as shown.

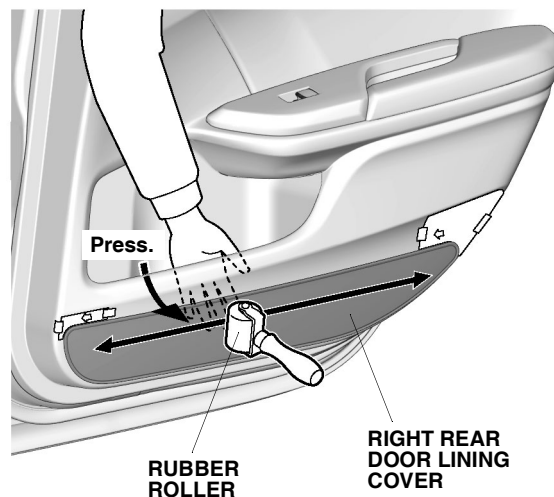

QG00433BT

16. Remove the rear templates.
17. Turn the rear templates over, and repeat steps 10 through 16 on the left side of the vehicle.