



HONDA INSTALLATION INSTRUCTIONS

Accessory
AUTOMATIC DAY/NIGHT
MIRROR

Application
2022 INSIGHT

Publications No.
VERSION 1
Issue Date
MAY 2021

PARTS LIST

Attachment Kit
P/N 08V03-TXM-100

Automatic day/night mirror harness

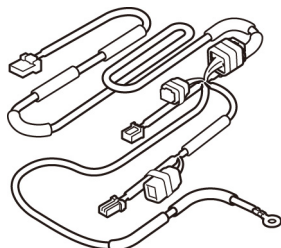

Harness cover



20 Wire ties



Urethane tape

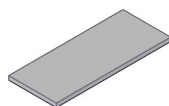

Aluminum tape

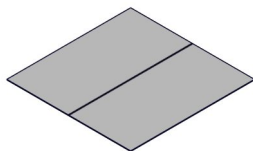

Fuse label

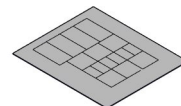

Service Parts

Automatic day/night mirror

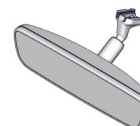

TOOLS AND SUPPLIES REQUIRED

Phillips screwdriver

Flat-tip screwdriver

Ratchet

10 mm Socket

Isopropyl alcohol

Shop towel

Diagonal cutters

Torque wrench

T20 TORX bit

10 mm Open end wrench

Ruler

Masking tape

Scissors

Small flat-tip screwdriver

The following tools are available through the Honda Tool and Equipment Program. On the iN, click on Service > Service Bay > Tool and Equipment Program, then enter the number under "Search." Or, call 888-424-6857.

- Trim Tool Set (T/N SOJATP2014)
- Plastic Trim Tool (T/N SILTRIMTL10)

Illustration of the Automatic Day/Night Mirror Installed in the Vehicle

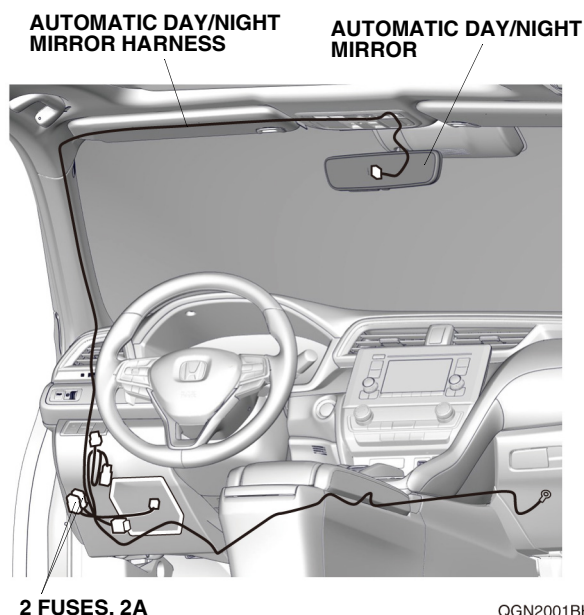

INSTALLATION

Customer Information: The information in this installation instruction is intended for use only by skilled technicians who have the proper tools, equipment, and training to correctly and safely add equipment to your vehicle. These procedures should not be attempted by “do-it-yourselfers.”

1. Remove the right side panel, and disconnect the negative cable from the battery.
NOTE: Wait 3 minutes after turning the power switch to OFF before disconnecting the battery.

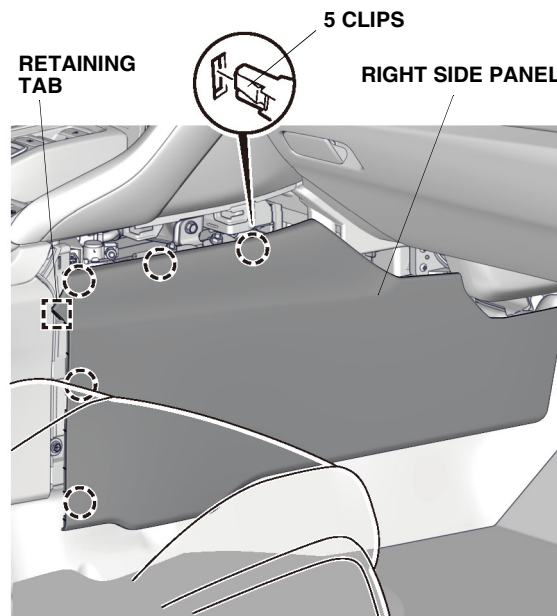

2. Pull away the door opening seal, and remove the passenger's dashboard side lid.

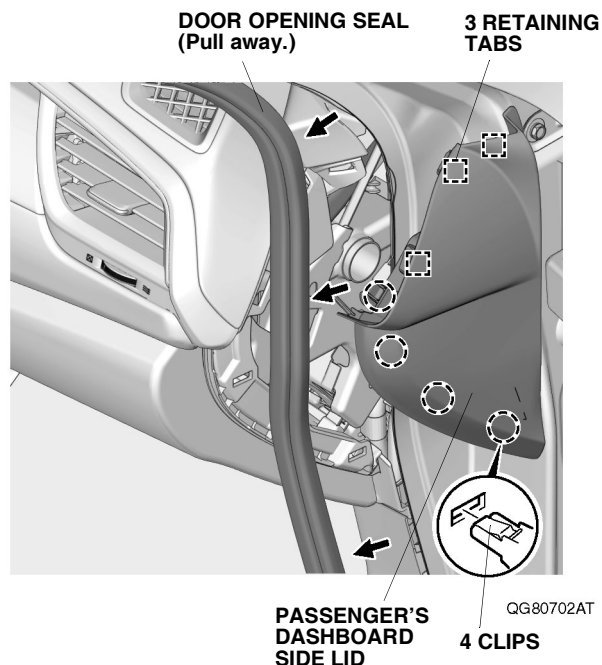

3. Remove the passenger's under cover.

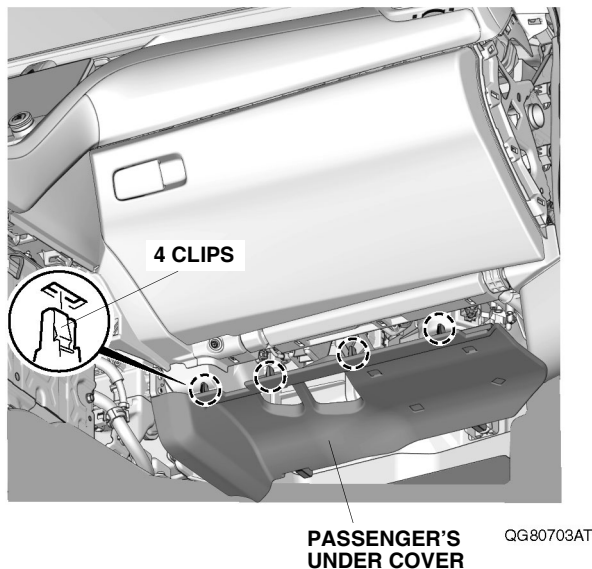

4. Open the glove box, push inward on the glove box stops, and remove the glove box.

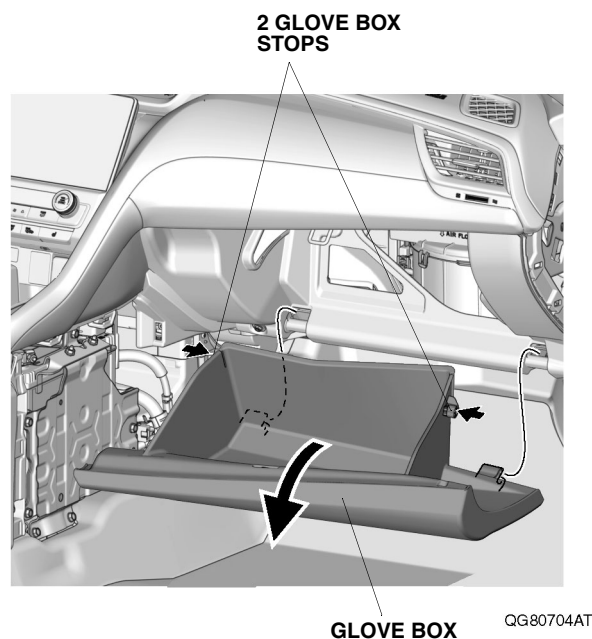

5. Remove the glove box cover.

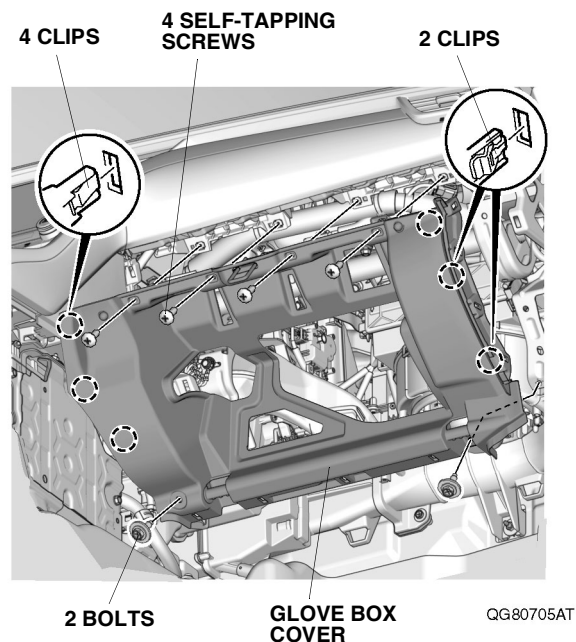

6. Remove the cover from the camera cover.

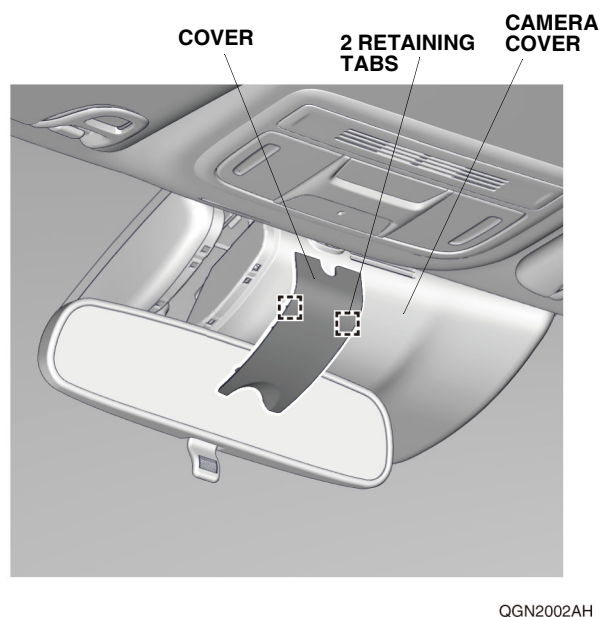

7. Remove the camera cover.
NOTE: To prevent damage, remove carefully in following order.

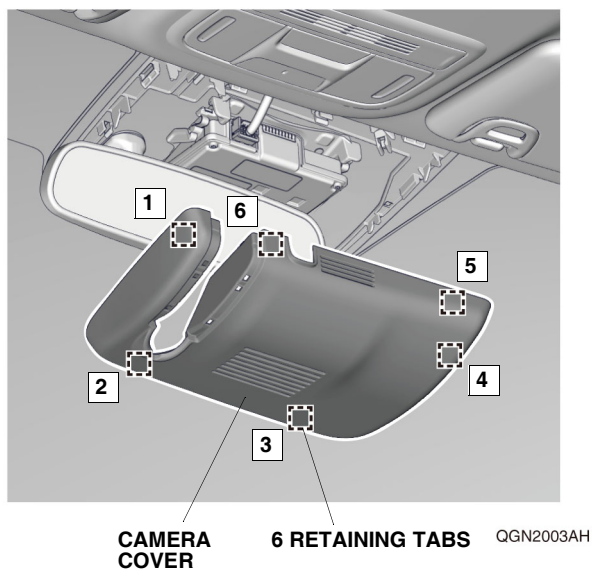

8. Loosen the Torx screw, and remove the rearview mirror from the mirror mount.

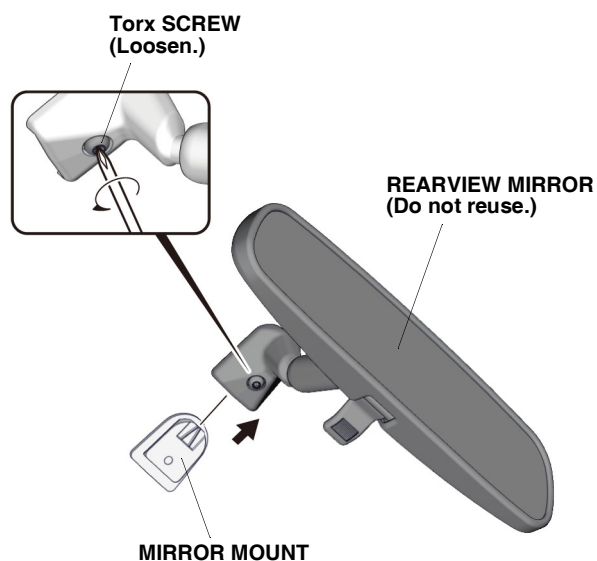

9. Remove the left and right map light lenses from the roof console. Remove the two self-tapping screws. Remove the roof console, and unplug the vehicle connectors.

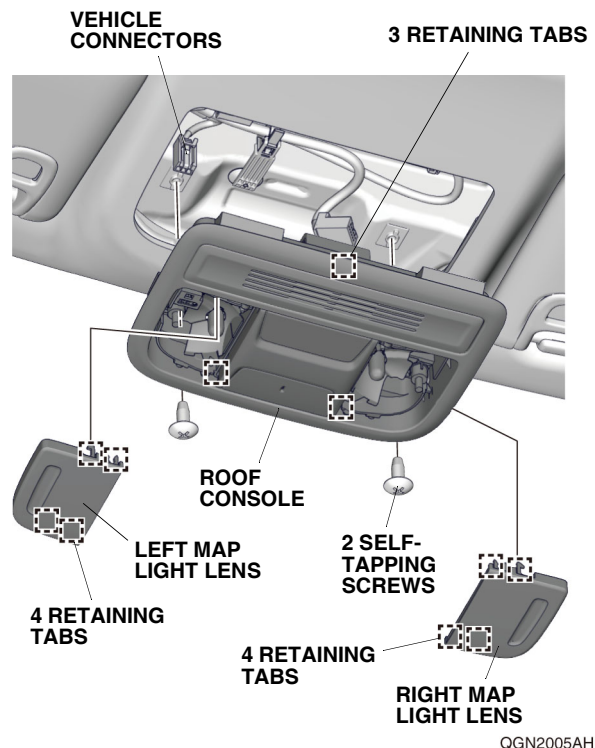

10. Release the passenger's sunvisor from the passenger's sunvisor holder.

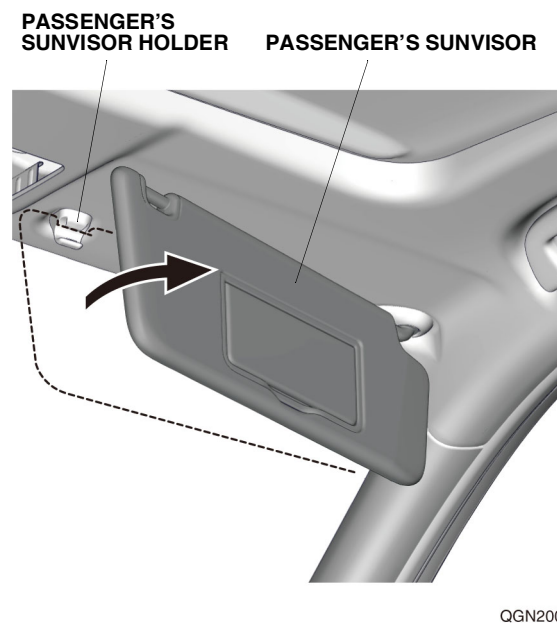

11. Remove the passenger's sunvisor holder by rotating it 90° counterclockwise.

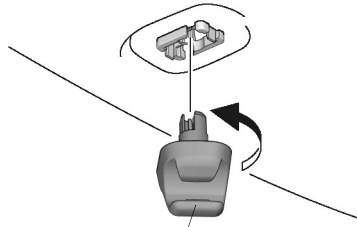

**PASSENGER'S
SUNVISOR HOLDER
(Rotate.)**

QE30408AJ

12. Remove the driver's sunvisor, and unplug the vehicle connector:

- Pivot the driver's sunvisor downward.
 - Wrap masking tape around the tip of a flat-tip screwdriver.
 - Locate the slot in the base cover, and insert the flat-tip screwdriver into the slot. Push in and hold the retaining tab.
 - While holding the retaining tab, push up on the sunvisor and rotate it toward the door.
- NOTE:** If the retaining tab does not stay pushed in, return the sunvisor to its original position and repeat this step.

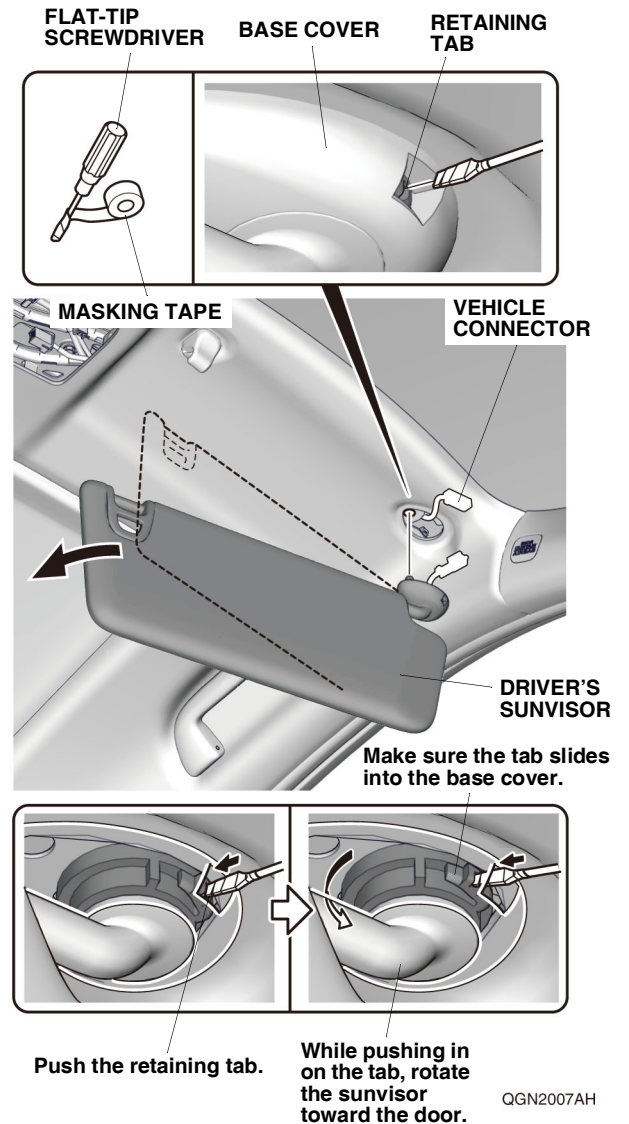

13. Remove the driver's sunvisor holder by rotating it 90° counterclockwise.

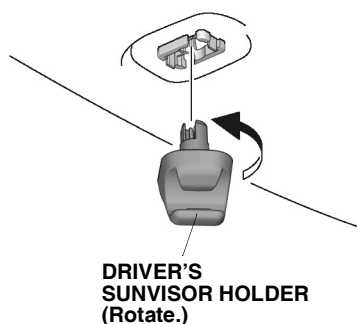

QE30408AJ

14. Open the cap, and remove the bolt.

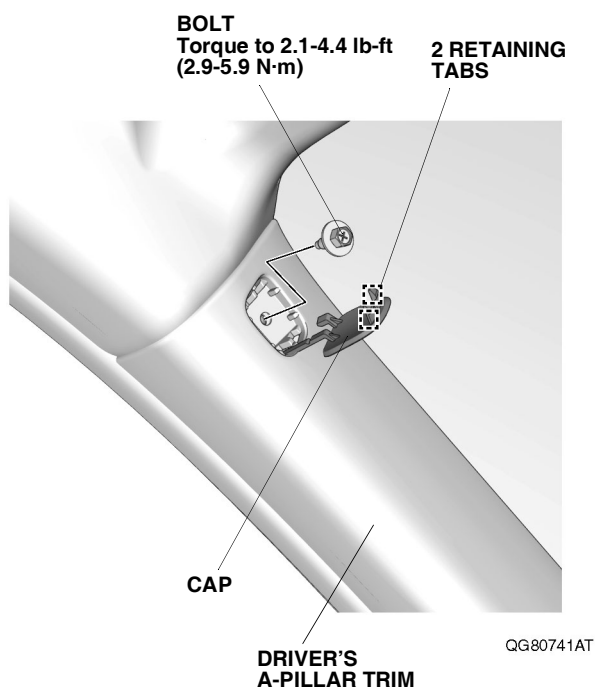

QG80741AT

15. Pull away the door opening seal, and remove the driver's A-pillar trim.

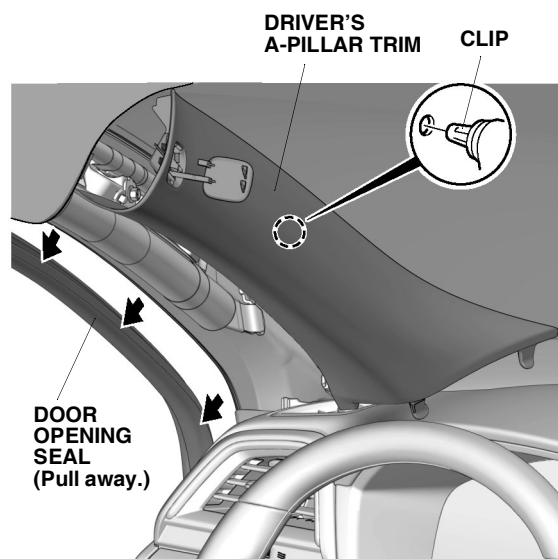

QG80722AT

16. Remove the driver's dashboard lower cover, and unplug the vehicle connectors.

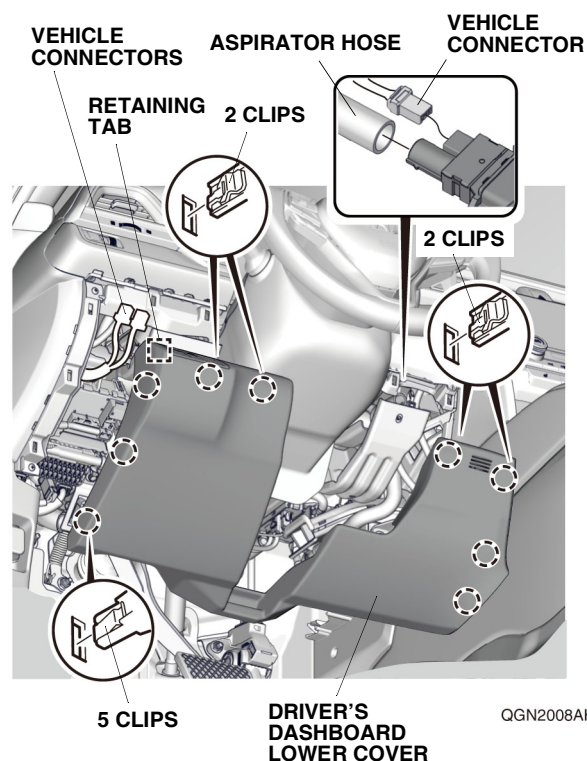

QGN2008AH

17. Pull away the door opening seal, and remove the driver's dashboard side lid.

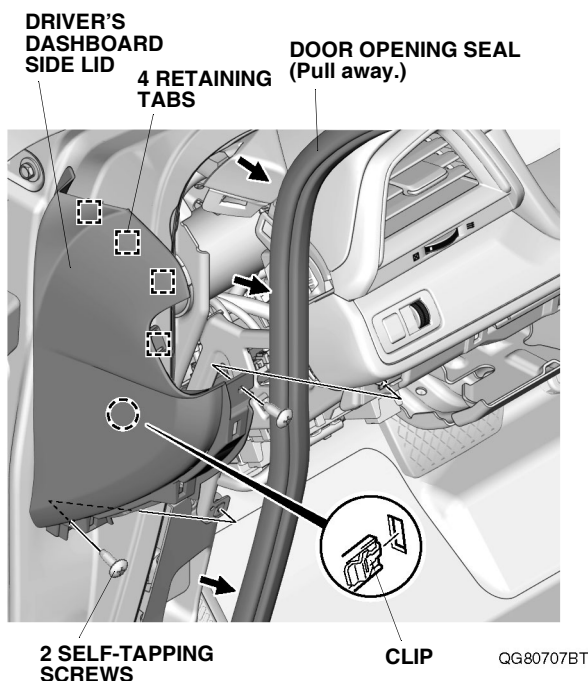

18. Remove the driver's front door sill trim.

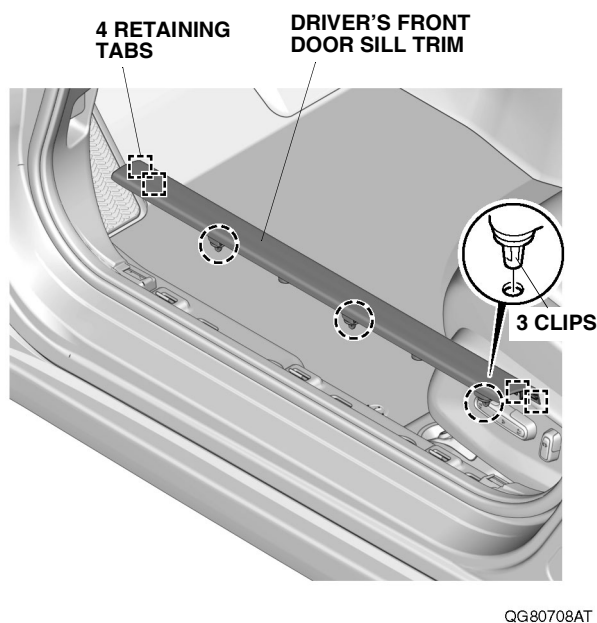

19. Pull away the door opening seal, and remove the driver's kick panel.

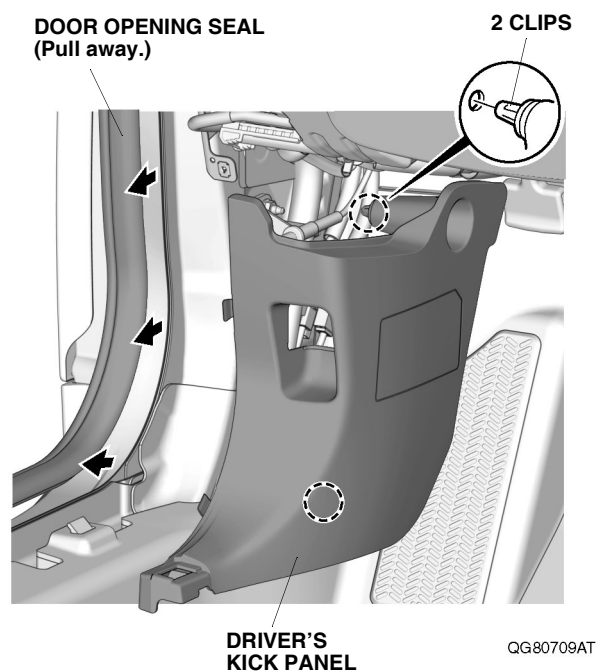

20. Using isopropyl alcohol on a shop towel, thoroughly clean the automatic day/night mirror harness fuse cases where the fuse labels will attach.

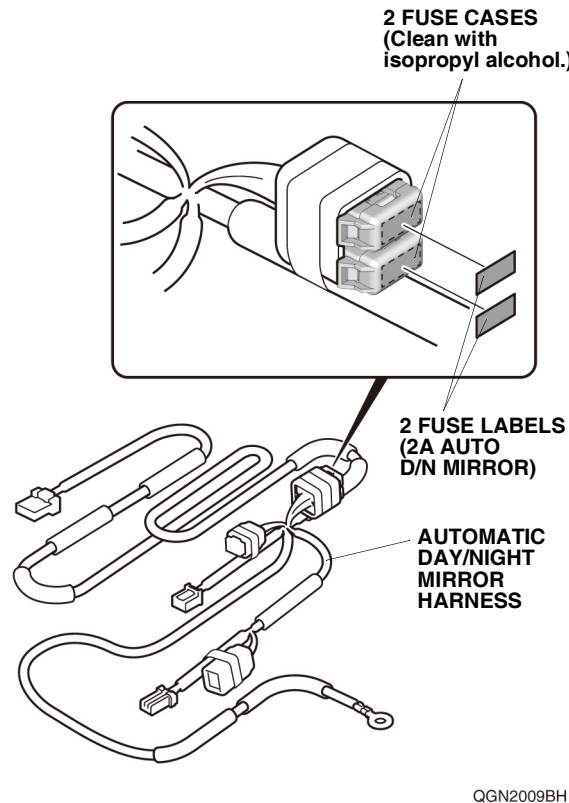

21. Apply the two fuse labels (2A AUTO D/N MIRROR) to the automatic day/night mirror harness fuse cases.

22. Using scissors, cut one urethane tape as shown.

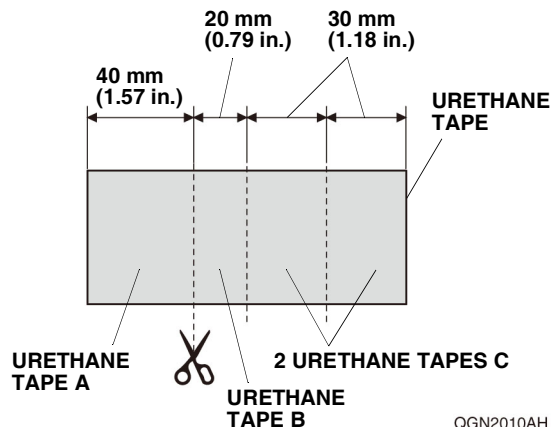

23. Using isopropyl alcohol on a shop towel, thoroughly clean the vehicle panel where urethane tape A will attach.

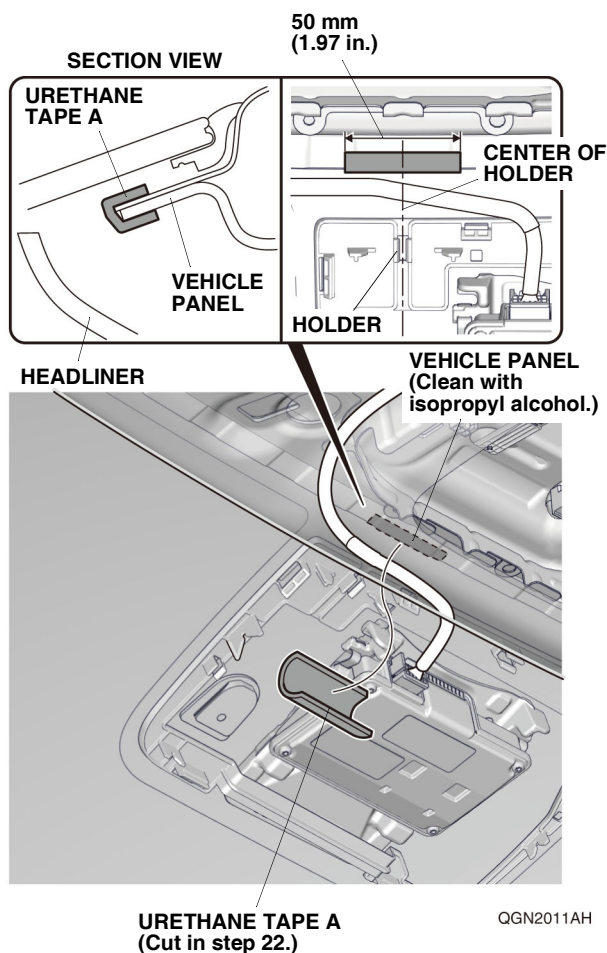

24. Attach urethane tape A to the vehicle panel.
NOTE: Be careful not to crease the headliner.

25. Using isopropyl alcohol on a shop towel, thoroughly clean the vehicle panel where urethane tape B and the two urethane tapes C will attach.

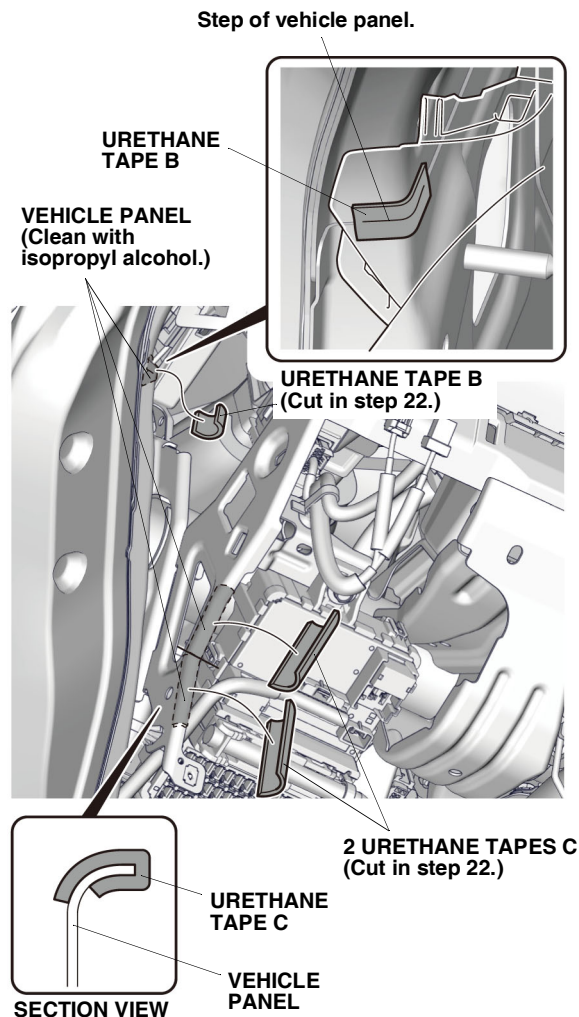

26. Attach urethane tapes B and C to the vehicle panel.

27. Route the automatic day/night mirror harness as shown.

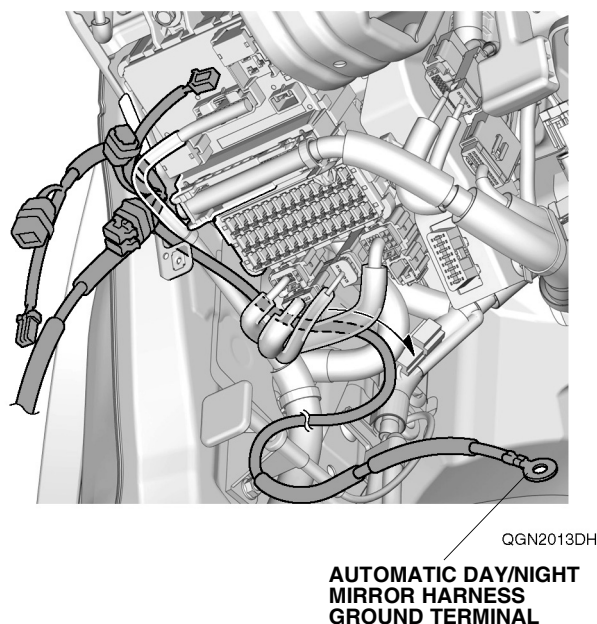

28. Secure the automatic day/night mirror harness to the vehicle panel with one wire tie as shown.

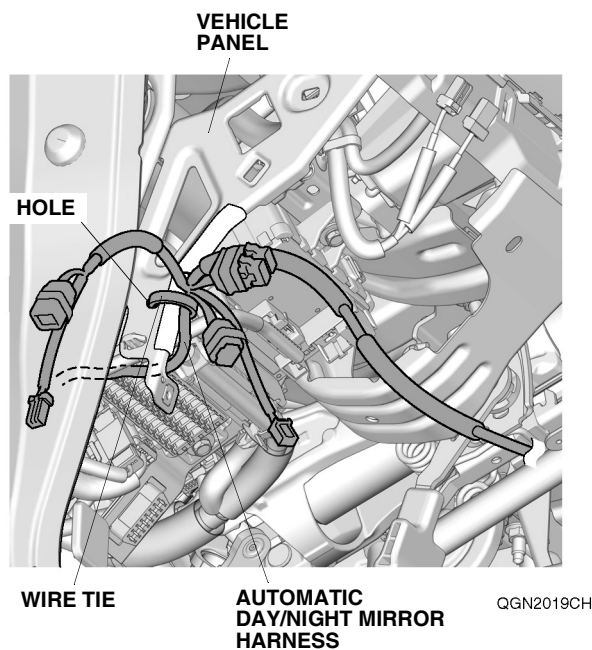

If the vehicle is equipped with another accessory harness 4-pin connector, go to step 30; otherwise, continue with step 29.

Without Another Accessory Harness 4-Pin Connector

29. Plug the automatic day/night mirror harness 4-pin connector into the fuse box. Go to step 31.

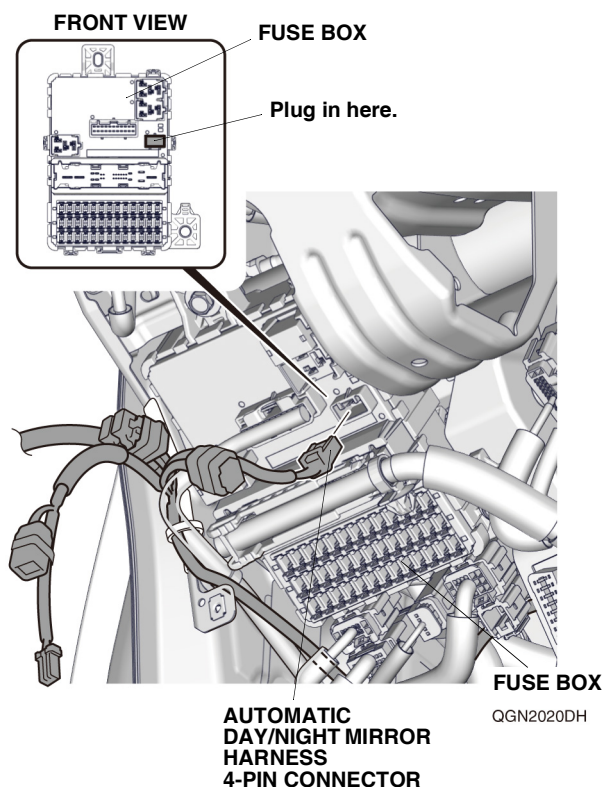

With Another Accessory Harness 4-Pin Connector

30. If the other accessory harness 4-pin connector is plugged into the fuse box, unplug it from the fuse box, then plug the automatic day/night mirror harness 4-pin connector into the fuse box. Remove and do not reuse the dummy connector from the automatic day/night mirror harness 4-pin connector, and plug the other accessory harness 4-pin connector into it.

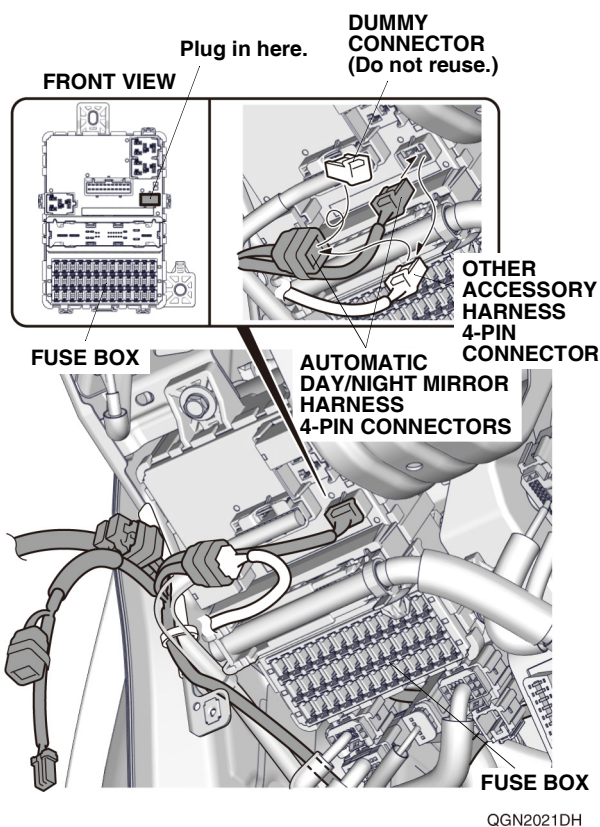

31. Secure the automatic day/night mirror harness to the vehicle harness with one wire tie.

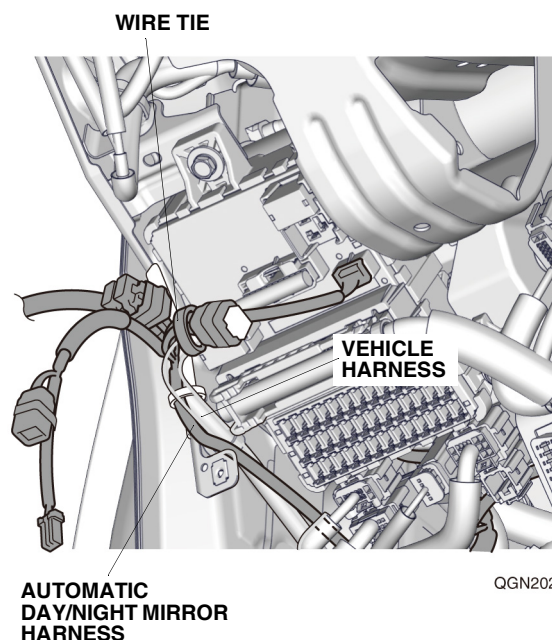

32. Route the automatic day/night mirror harness as shown.

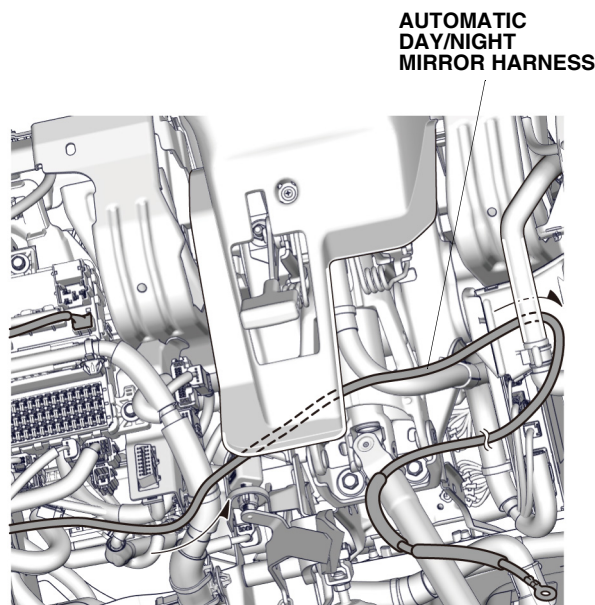

33. Route the automatic day/night mirror harness as shown.

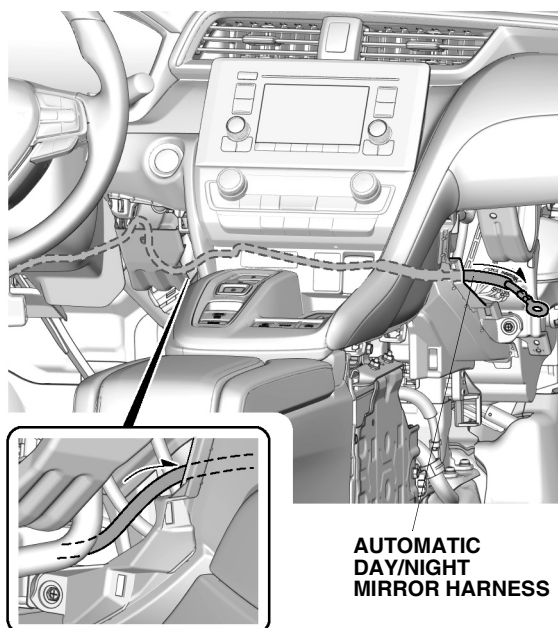

QGN2036CH

34. Remove the vehicle ground bolt. Secure the automatic day/night mirror harness ground terminal and the vehicle ground terminal with the vehicle ground bolt just removed.
NOTE: Do not put the ground terminal calkings on top of one another.

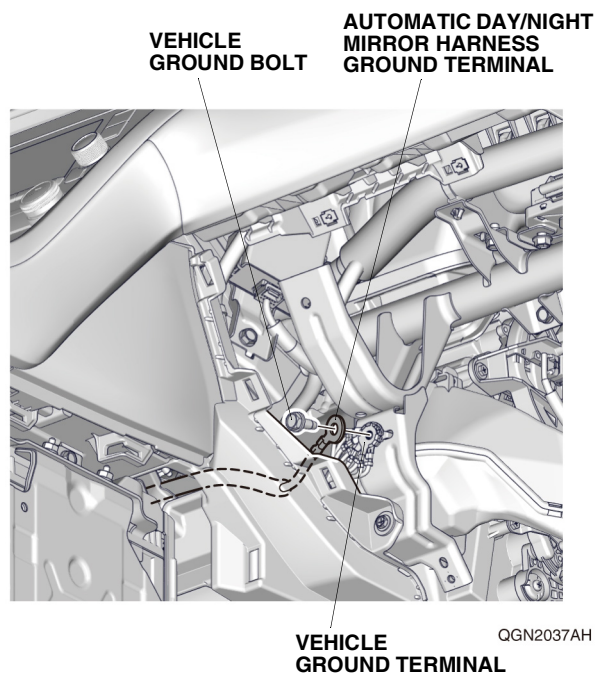

QGN2037AH

35. Secure the automatic day/night mirror harness to the vehicle harness with one wire tie.

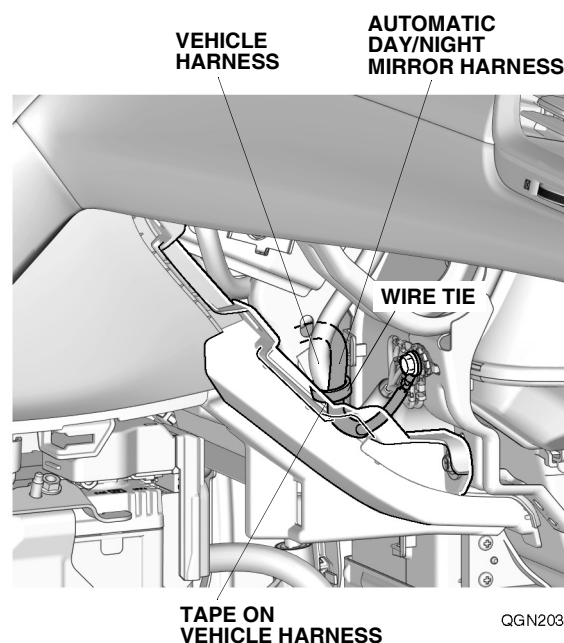

QGN2038AH

36. Secure the automatic day/night mirror harness to the vehicle duct with the two wire ties.

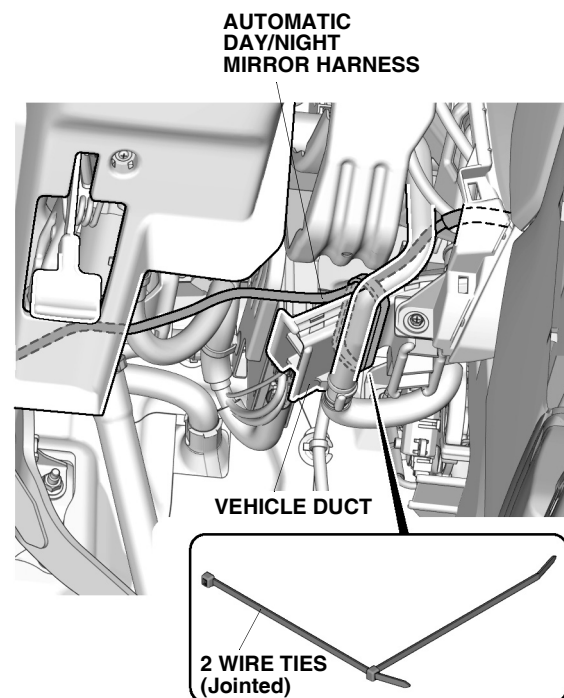

QGN2039CH

37. Secure the automatic day/night mirror harness to the vehicle harness and bracket with the three wire ties.

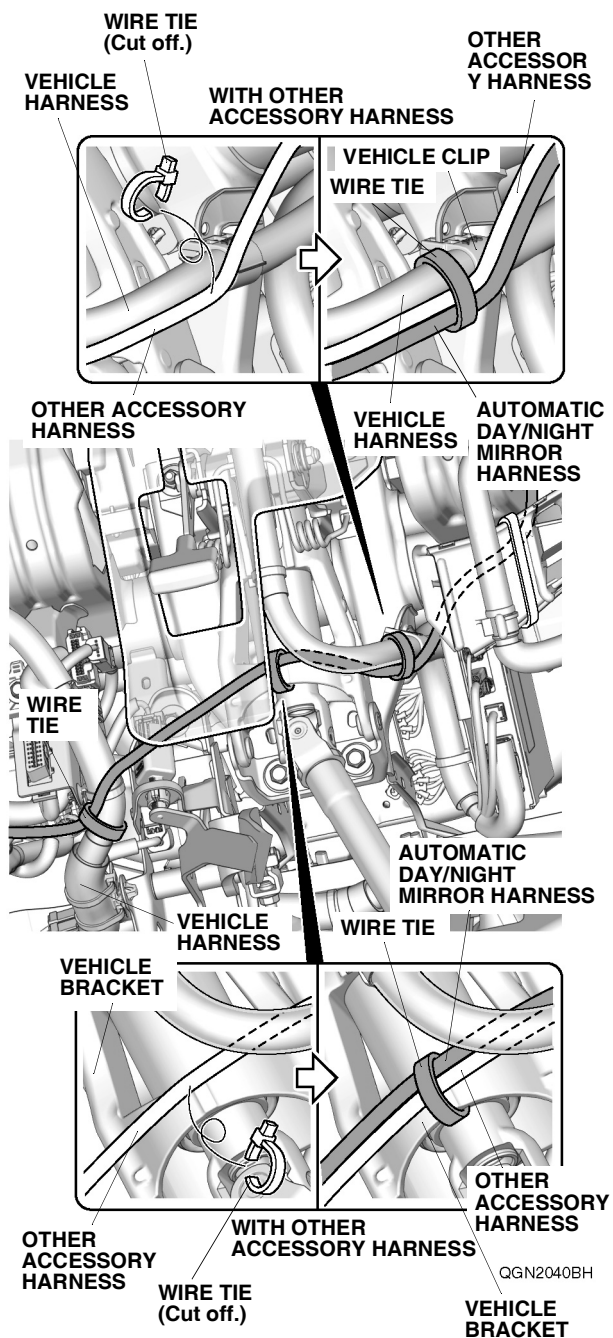

38. Secure the automatic day/night mirror harness to the vehicle harness with the three wire ties.

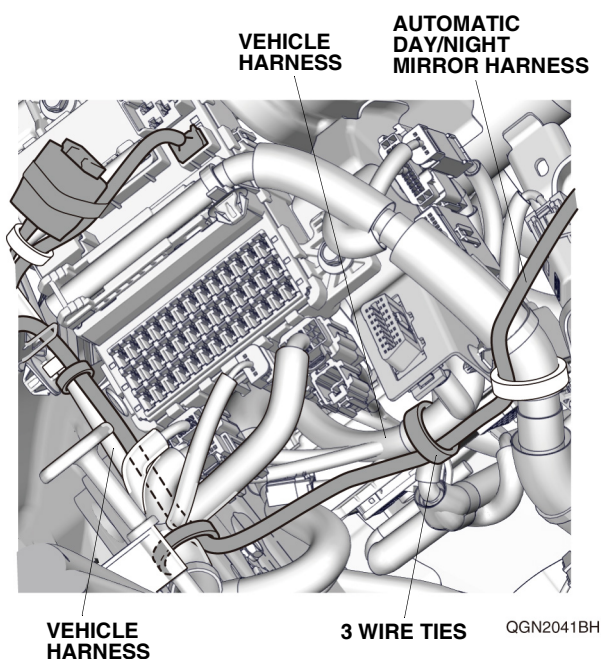

39. Route the automatic day/night mirror harness as shown.

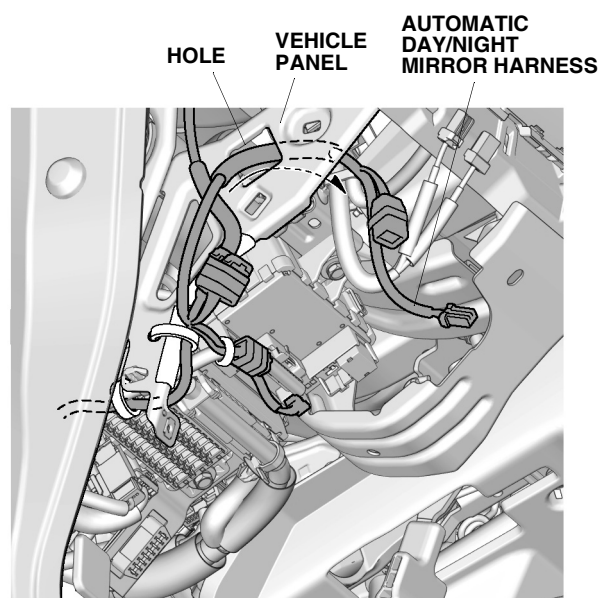

40. Plug the vehicle 4-pin connector into the automatic day/night mirror harness 4-pin connector.

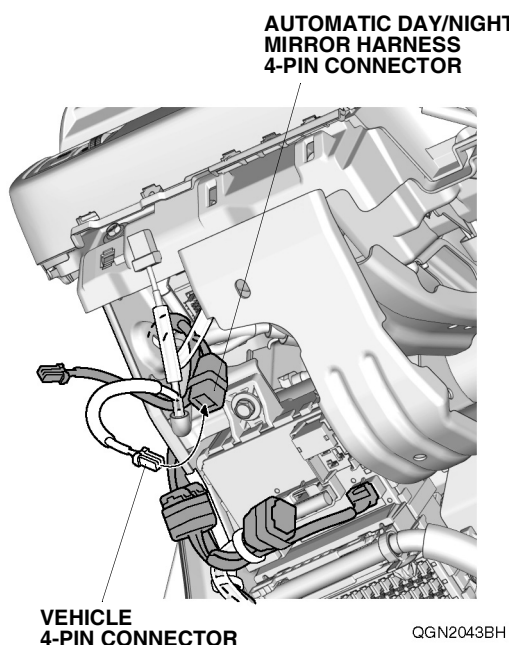

41. Line up the branch of the automatic day/night mirror harness with the clip on the vehicle harness, and secure the automatic day/night mirror harness and 4-pin connectors to the vehicle harness with two wire ties.

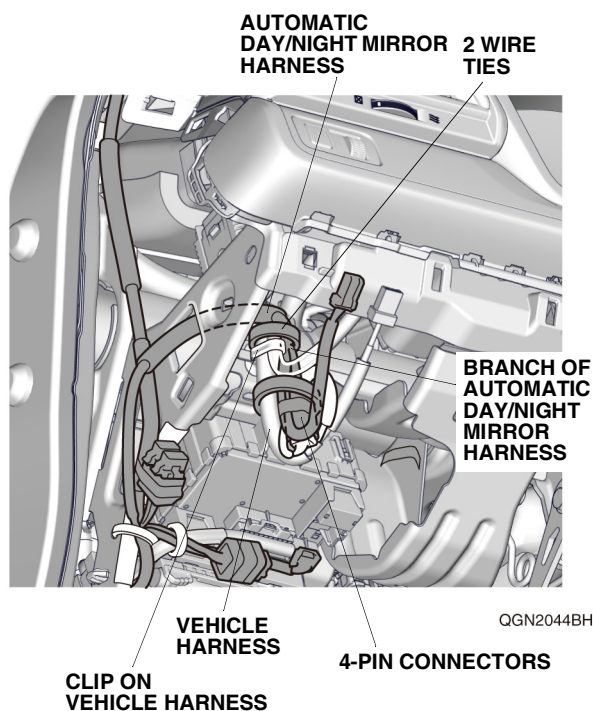

42. Route the automatic day/night mirror harness upward toward the dashboard as shown.

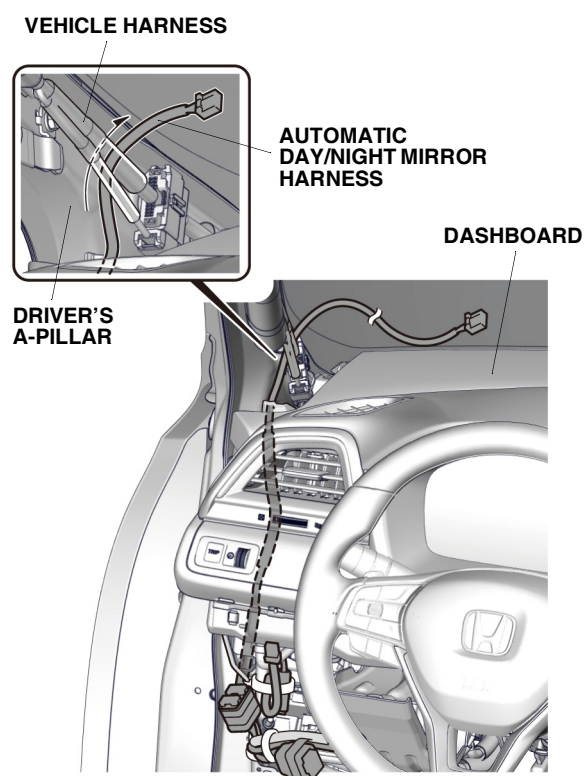

43. Route the automatic day/night mirror harness along the driver's A-pillar. Gently pull back the headliner, and tuck the automatic day/night mirror harness behind the headliner.
- NOTE: Be careful not to crease the headliner.

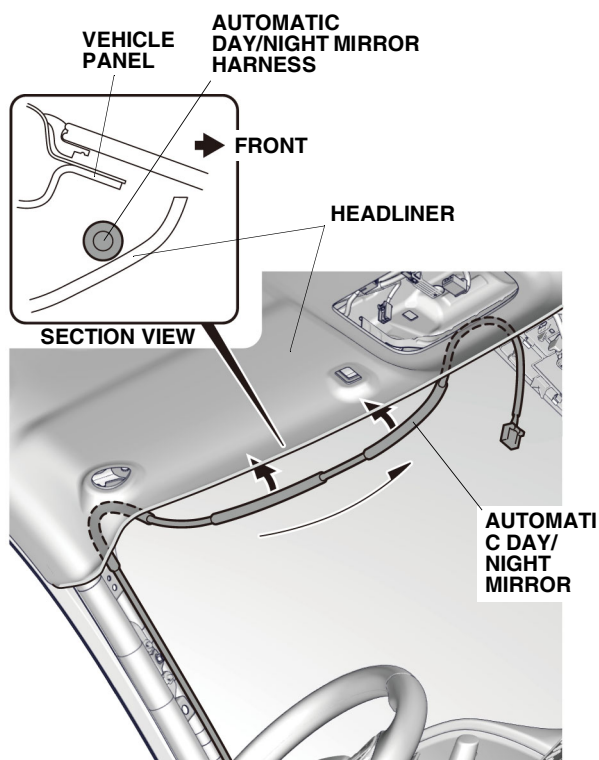

QGN2024AH

44. Line up the end of the urethane tape on the automatic day/night mirror harness with the vehicle bracket, and secure the automatic day/night mirror harness to the vehicle harness with one wire tie as shown.

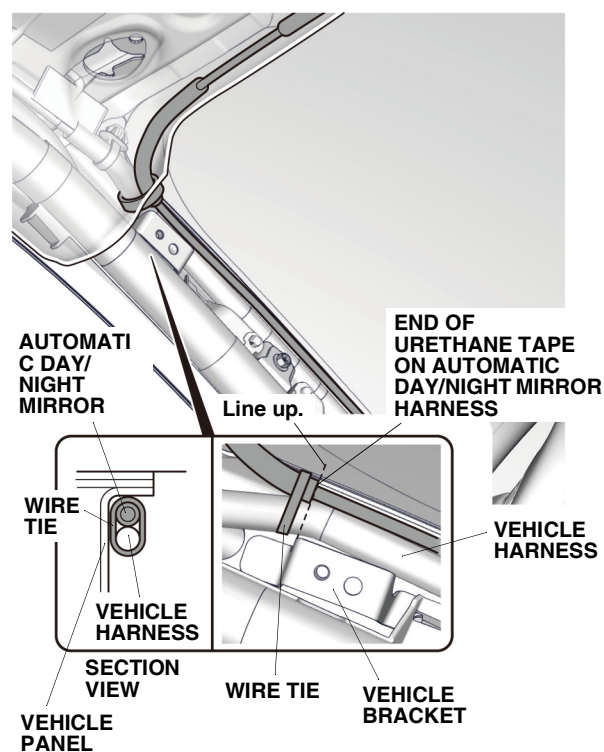

QGN2025AH

45. Using isopropyl alcohol on a shop towel, thoroughly clean the vehicle panel where the aluminum tape will attach.

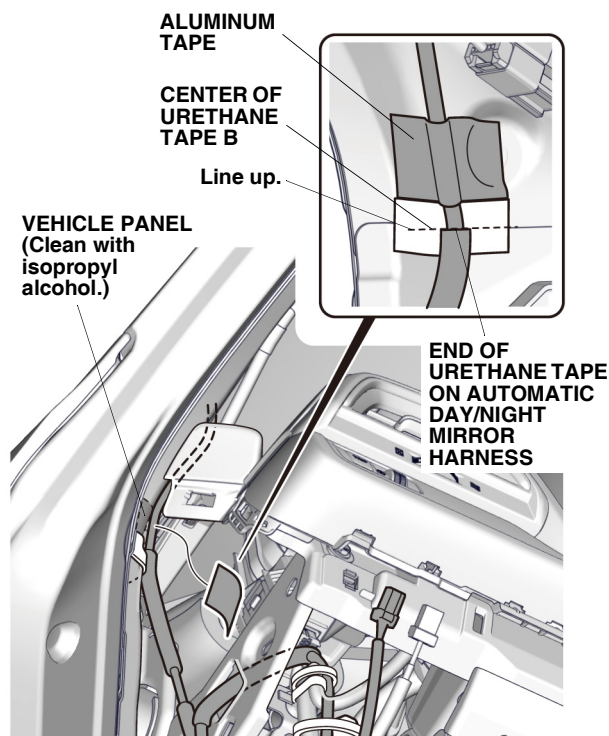

QGN2027BH

46. Line up the end of the urethane tape on the automatic day/night mirror harness with the center of urethane tape B, and secure the automatic day/night mirror harness to the vehicle panel with one piece of aluminum tape as shown.

47. Secure the automatic day/night mirror harness to the vehicle harness with four wire ties as shown. NOTE: Do not cover the installation holes of the driver's A-pillar trim.

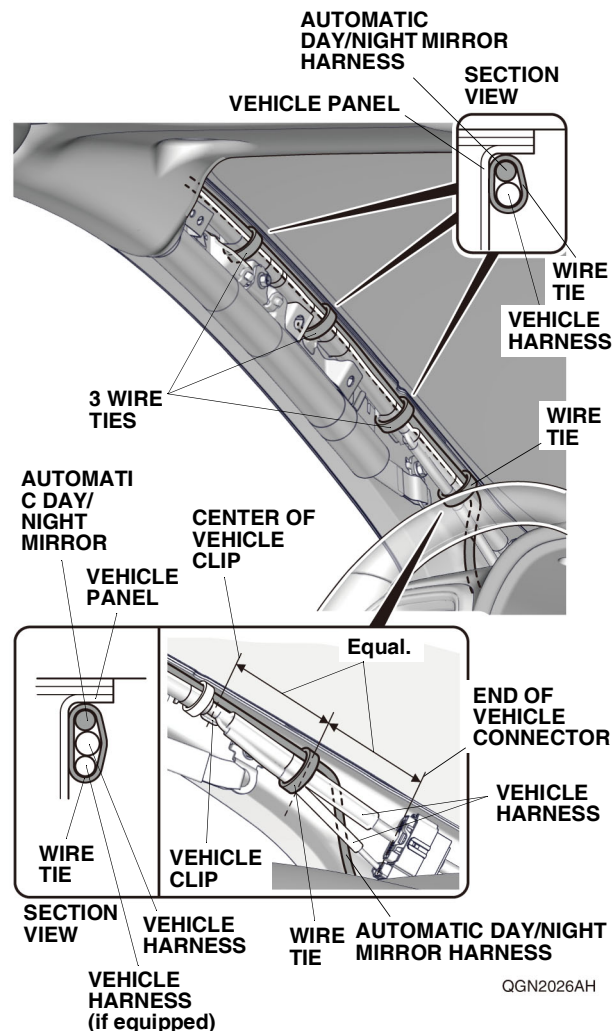

QGN2026AH

48. Secure the automatic day/night mirror harness to the vehicle panel with two wire ties.

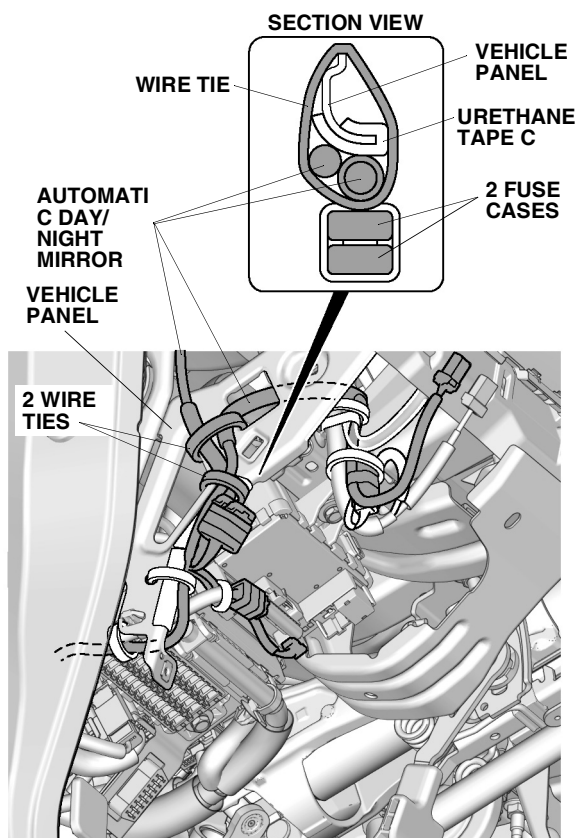

QGN2028BH

49. Install the automatic day/night mirror to the mirror mount as shown. Torque the Torx screw to 1.1-1.5 lb-ft (1.5-2.0 N·m).

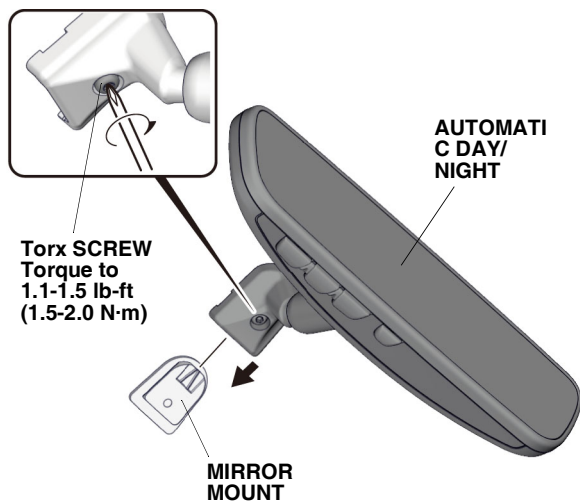

QGN2029AH

50. Plug the automatic day/night mirror harness 7-pin connector into the automatic day/night mirror.

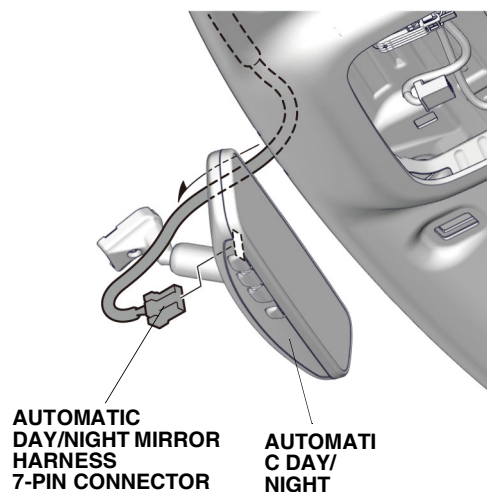

QGN2030AH

51. Secure the automatic day/night mirror harness to the automatic day/night mirror with the harness cover. **NOTE:** Make sure the automatic day/night mirror harness is not pinched.

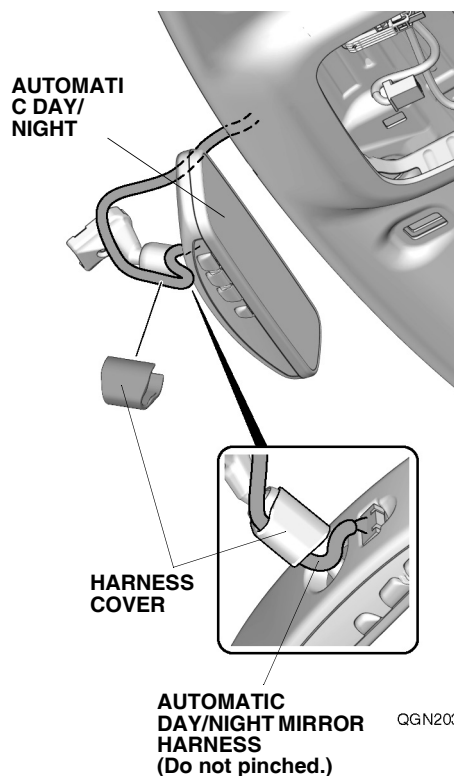

QGN2031AH

52. Secure the automatic day/night mirror harness to the cover base.

NOTE: Make sure that the automatic day/night mirror harness is not pinched.

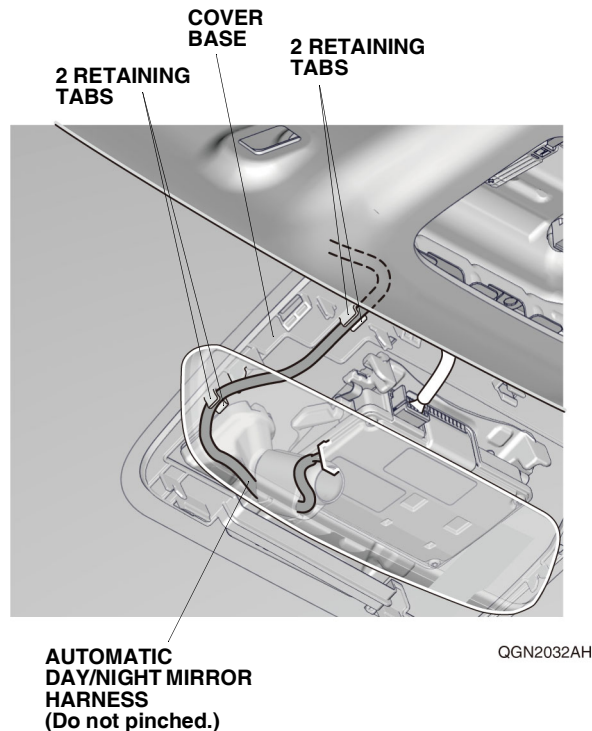

53. Install the driver's dashboard side lid. Plug the automatic day/night mirror harness 4-pin connector into the fuel lid opener switch. Install the driver's dashboard lower cover.

NOTE: The position of the switch depends on the vehicle.

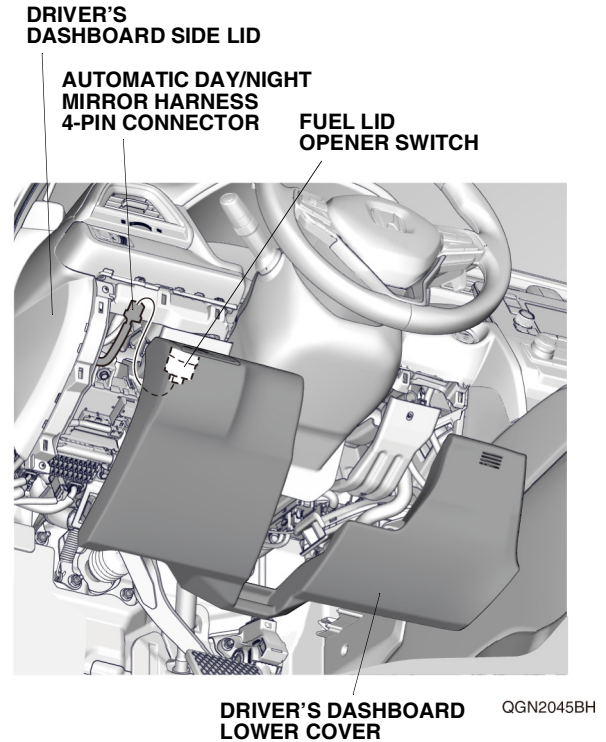

54. Check that all wire harnesses are routed properly and all connectors are plugged in.
55. Install all removed parts except for the right side panel.
56. Connect the negative cable to the battery.
57. Install the right side panel.
58. Press and hold the audio unit power button for 2 seconds to restore the audio and navi (if equipped) system functions.
59. Set the clock on vehicles without navigation.
60. If necessary, restore the systems back to normal operation as described in the service information.

Check the Operation of the Automatic Day/Night Mirror

61. Make sure the automatic day/night mirror works properly as described in the online owner's manual.