



HONDA INSTALLATION INSTRUCTIONS

Accessory

TRUNK TRIM
P/N 08F52-TXM-100

Application

2020 INSIGHT

Publications No.

VERSION 1

Issue Date

SEP 2019

PARTS LIST

Trunk trim



Alcohol wipe



TOOLS AND SUPPLIES REQUIRED

Masking tape

The following tool is available through the Honda Tool and Equipment Program. On the iN, click on Service > Service Bay > Tool and Equipment Program, then enter the number under "Search." Or, call 888-424-6857.

Rubber Roller (T/N MHLE54D)

Illustration of the Trunk Trim Installed on the Vehicle



TRUNK TRIM

QH41001AT

INSTALLATION

Customer Information: The information in this installation instruction is intended for use only by skilled technicians who have the proper tools, equipment, and training to correctly and safely add equipment to your vehicle. These procedures should not be attempted by "do-it-yourselfers."

NOTE:

- Be careful not to damage the paint finish.
 - This trunk trim kit should be installed only if the ambient air temperature is 60°F (15°C) or above.
 - To allow the adhesive to cure, do not wash the vehicle for 24 hours. Make sure the customer is aware of this.
1. Peel back the adhesive backings, and tape them to the front surface of the trunk trim with masking tape. Remove the other adhesive backings.

MASKING TAPE

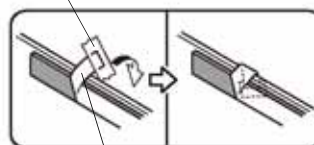

4 ADHESIVE
BACKINGS
(Peel back.)

2 ADHESIVE
BACKINGS
(Remove.)

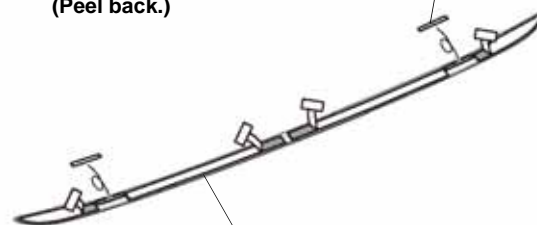

TRUNK TRIM

QH30802BR

- Using an alcohol wipe, thoroughly clean the trunk lid where the trunk trim will attach.



- Adjust the position of the trunk trim so there is equal spacing on both sides.

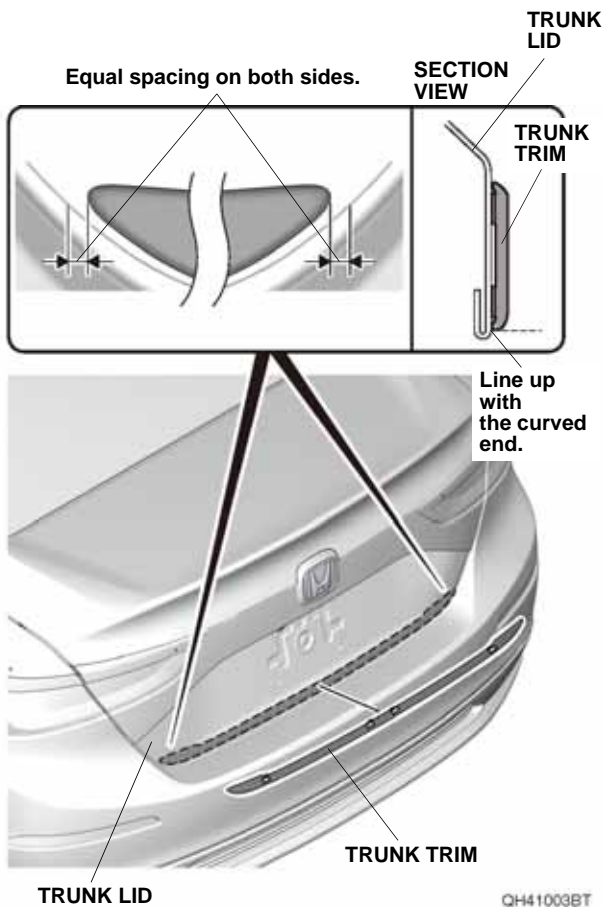

- While applying light pressure against the trunk trim, carefully remove the taped adhesive backings.

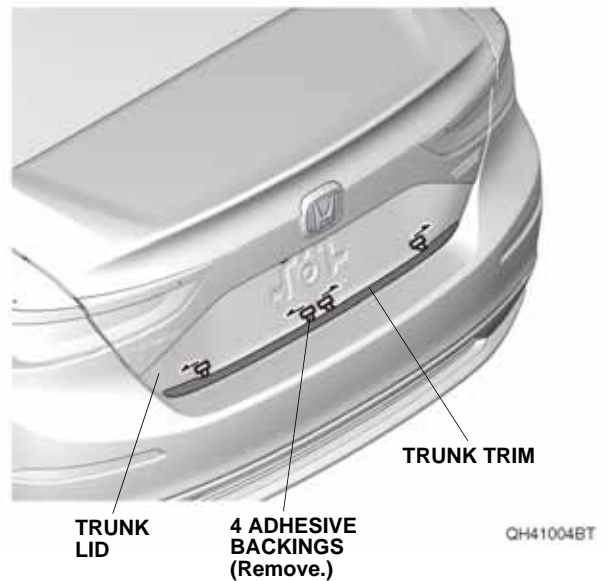

- Using the rubber roller, apply firm pressure while rolling, especially at the ends, to set the adhesive.

