

Germain Honda of College Hills



INSTALLATION INSTRUCTIONS

Accessory
FENDER FLARES

Application
**2023 HR-V
MODEL SERIES**

Publications No.
VERSION 1
Issue Date
MAY 2022

GENERAL VIEW

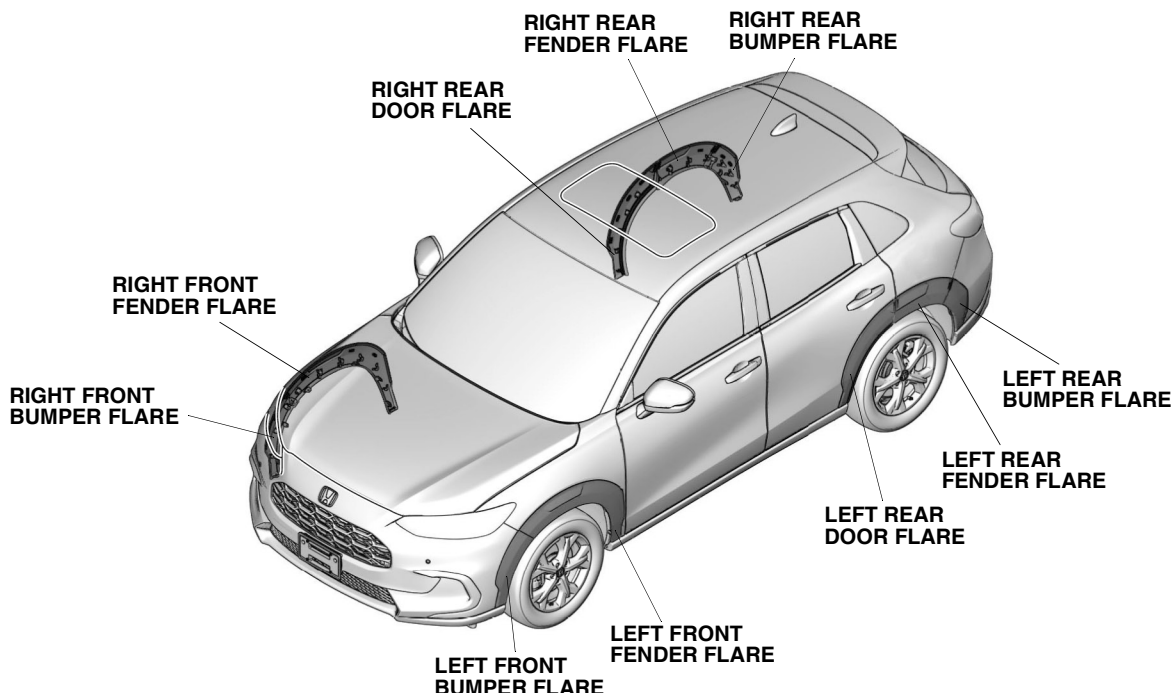

QL60301AB

FOR YOUR SAFETY (Read carefully.)

Warning Symbols

Safety: Your safety, and the safety of others, is important. To help you make informed decisions about service procedures, we have provided safety messages where appropriate. Of course, it is not practical or possible to warn you about all the hazards associated with servicing a vehicle - you must use your own good judgment.

You will find important safety messages preceded by one of following symbols:

*All symbols are not used in all installation instructions.

⚠ DANGER

You will be killed or seriously hurt if you do not follow the instructions.

⚠ WARNING

You can be killed or seriously hurt if you do not follow the instructions.

⚠ CAUTION

You can be hurt if you do not follow the instructions.

NOTICE

Gives advice to prevent damage to the product, vehicle, the environment or other property.

NOTE

Gives helpful information or instructions to be followed when installing this product.



Indicates a prohibited action.

Germain Honda of College Hills

Procedure and Location Icons

These icons indicate the work location and the worker's point of view.

*All icons are not used in all installation instructions.

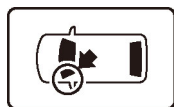

The location on the vehicle.

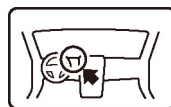

The location in the vehicle.
(instrument panel.)



Wear eye protection.



Wear heavy gloves.



Use an assistant.



Place the part on a blanket.



Work perpendicular.



Remove any burrs.



Use touch-up paint and allow to dry.



Tighten to the specified torque.



Apply firm pressure while rolling, especially at the ends, to set the adhesive.



Press firmly.



Clean with isopropyl alcohol.



Return the original part to the customer.
(Do not reuse.)

Wire Harness Routing Precaution

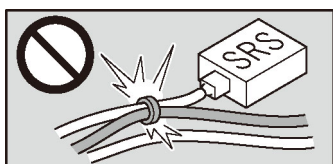

Do not secure the
accessory harness to the
SRS harness.
(except for instruction
cases.)

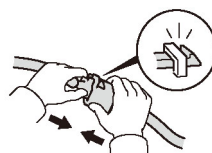

Push the connectors and
terminals together until
they lock.

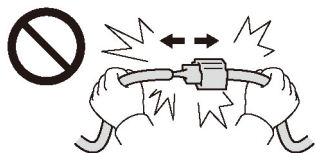

Do not pull the harness to
unplug the connectors.

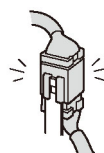

Install removed
connectors in their original
location.

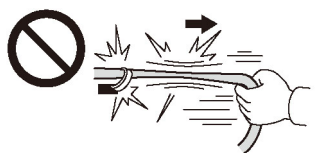

Do not pull the harness.



Secure the accessory
harness as shown.



Do not pinch the harness.

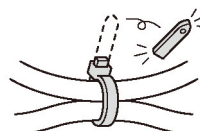

Cut off the excess wire tie.

Germain Honda of College Hills

Safety: General

- Observe all safety notes and precautions described in the service information, in addition to those described in this Installation Instruction. Be extremely careful for your safety and safety of others.
- Be careful not to damage the vehicle or the parts.
- Be extremely careful when handling retaining tabs and clips.
- Note the locations of the parts before removing them so they can be properly installed in their original positions.
- The illustrations may differ slightly from the actual accessory.

Safety: Electric Parts













Always disconnect the negative cable from the battery before beginning work.

Safety: Accessory

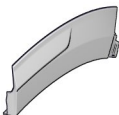
- Always use the parts and tools specified in the installation instructions.
- Do not install the accessory on a dirty surface or in direct sunlight.
- Make sure the ambient air temperature is 60°F (15°C) or above when installing accessories that use adhesive material.
- When pressing the accessory firmly with the palm of your hand, be careful not to damage it or the vehicle.
- When applying adhesive material, make sure it is lined up properly before attaching. Once the adhesive material touches the surface, do not try to remove it. If you do, you could damage the part.
- Do not wash the vehicle for 24 hours to allow the adhesive to cure.

PARTS LIST

Fender Flares Kit (P/N 08P21-3V0-100)

Left front bumper flare	Right front bumper flare	Left front fender flare	Right front fender flare
			
Left rear door flare	Right rear door flare	Left rear fender flare	Right rear fender flare
			
Left rear bumper flare	Right rear bumper flare	Clips A (12)	Clips B (6)
			

Germain Honda of College Hills

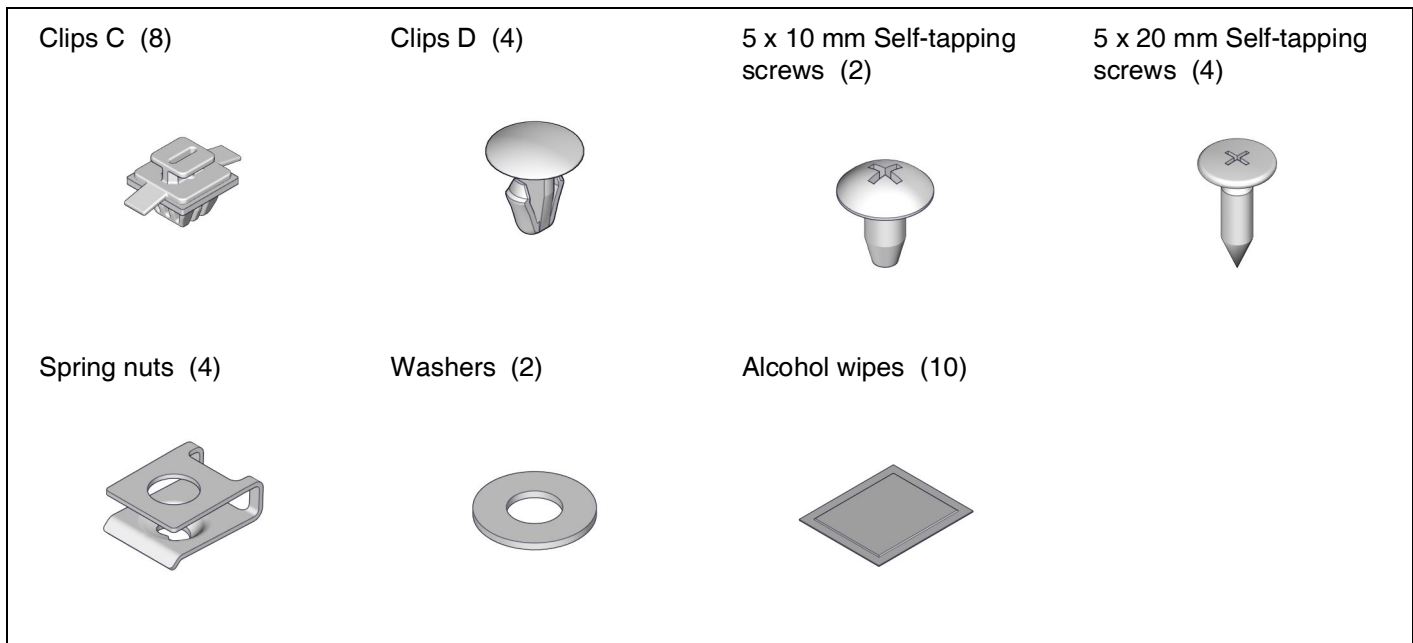

REQUIRED TOOLS AND SUPPLIES

- Phillips screwdriver
- Blanket
- Drill
- Masking tape
- Eye protection (face shield, safety goggles, etc.)
- Stubby Phillips screwdriver
- Shop towel
- File
- 3 mm, 5 mm, and 7mm Drill bits
- 10 mm Open end wrench
- Pushpin
- Utility knife
- 5 mm Hex wrench

The following tools are available through the Honda Tool and Equipment Program:

- Trim Tool Set (T/N SOJATP2014)
- Plastic Trim Tool (T/N SILTRIMTL10)
- Air Saw (T/N AT192A)
- Rubber Roller (T/N MHLE54D)

Germain Honda of College Hills

INSTALLATION

1. Disconnect the negative cable from the battery.

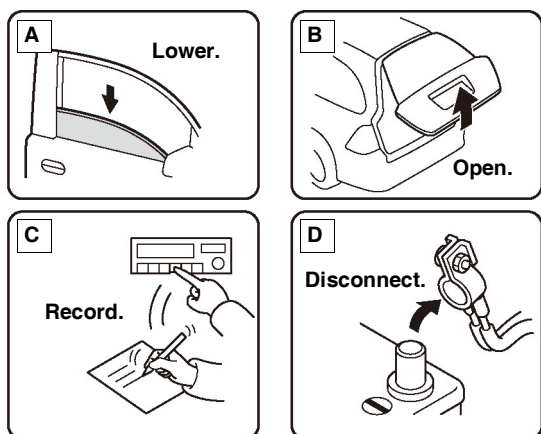

QCD0504BM

2. Remove the self-tapping screws and clips.

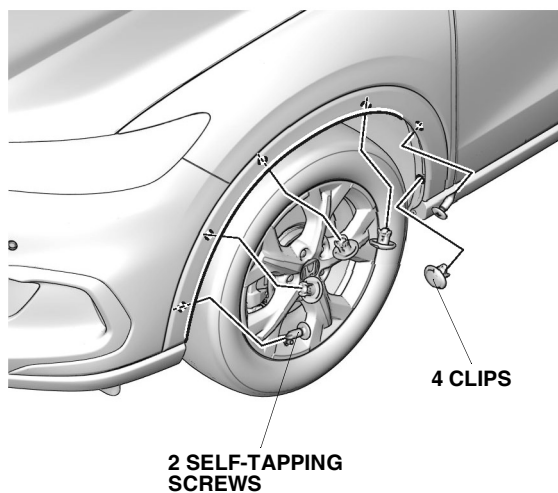
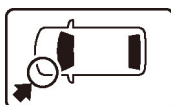

QL51802AG

3. Remove the left front wheel arch protector.

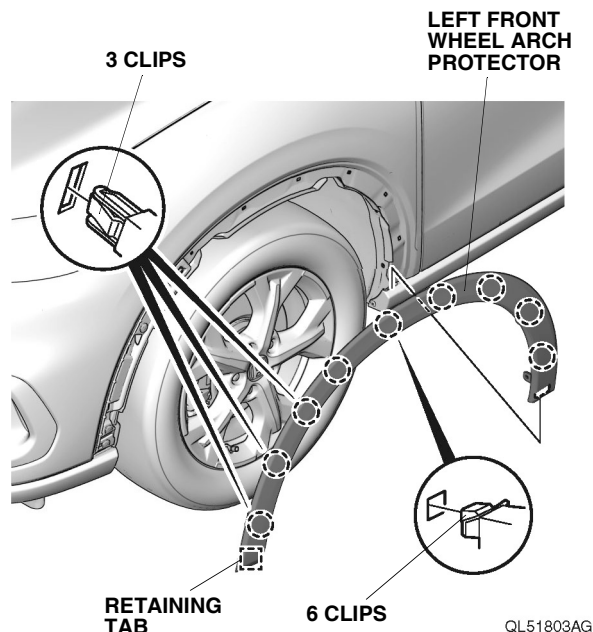

QL51803AG

4. Repeat the same procedures on the other side.

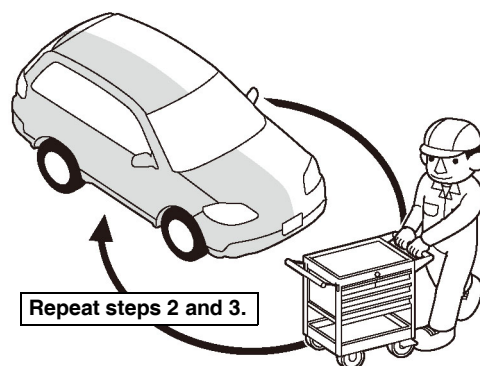

Q9D1014AM

Germain Honda of College Hills

5. Attach masking tape to protect the vehicle.

NOTE

Do not remove the masking tape until after the parts are installed.

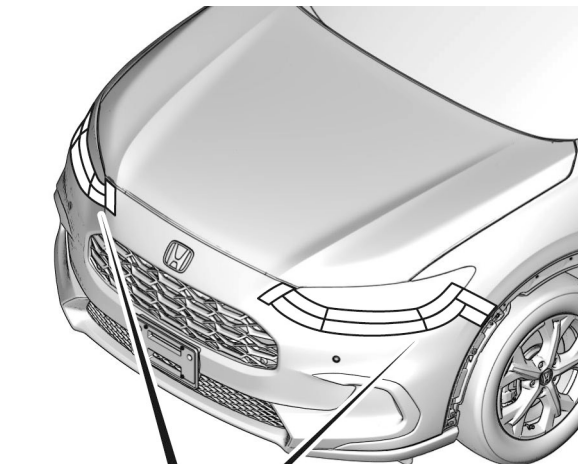
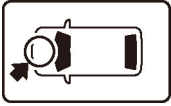

HEADLIGHT

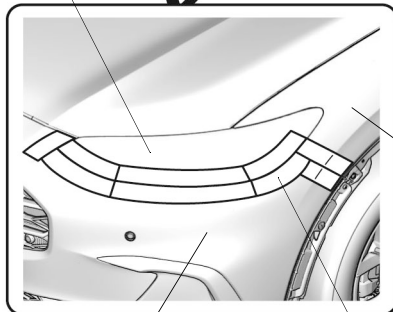

FRONT
FENDER

FRONT
BUMPER

MASKING
TAPE

QLD0706BG

6. Remove the self-tapping screw.

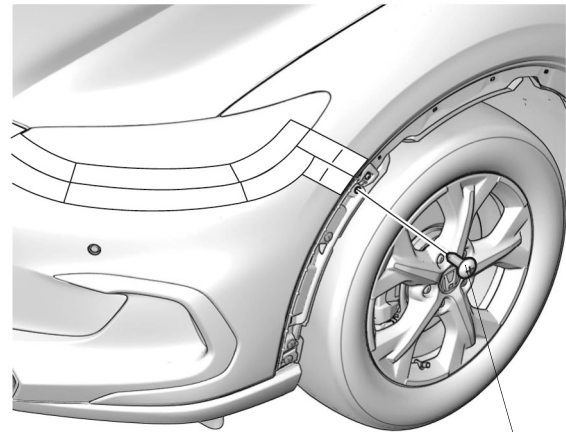
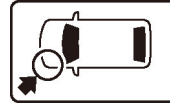

SELF-TAPPING
SCREW

QLD0705BG

Germain Honda of College Hills

7. Release the retaining tabs.

NOTE

- Release the retaining tabs starting from outside working in.
- Make sure to release the retaining tabs in the correct orientation.

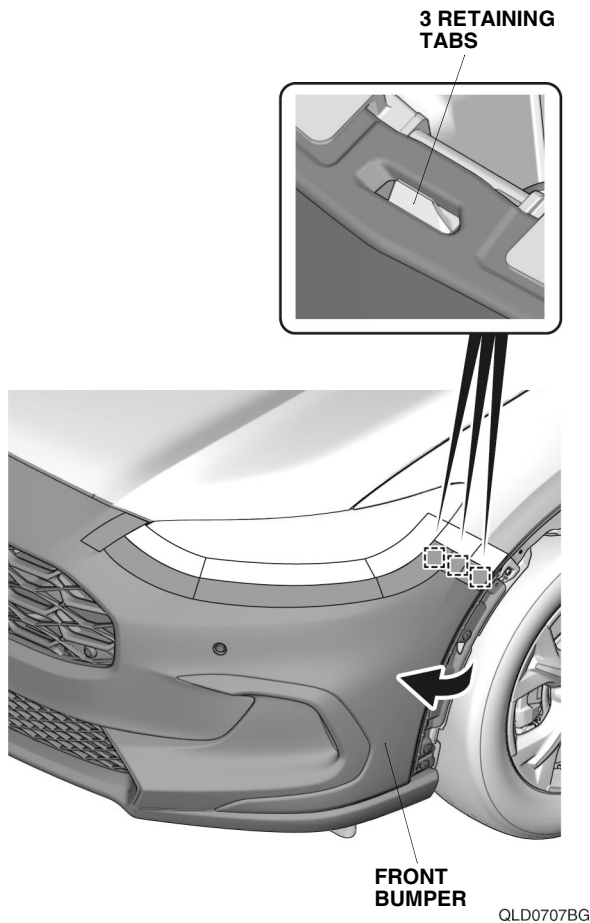

8. Repeat the same procedures on the other side.

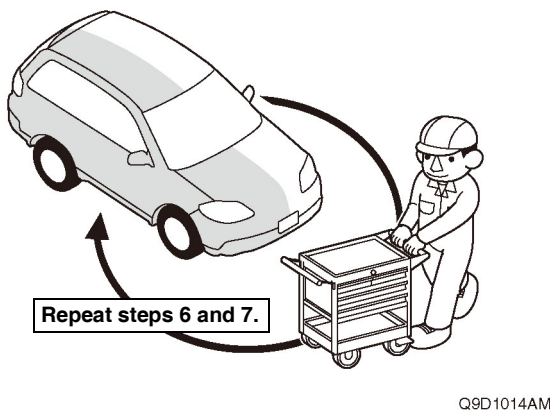

9. Remove the self-tapping screw.

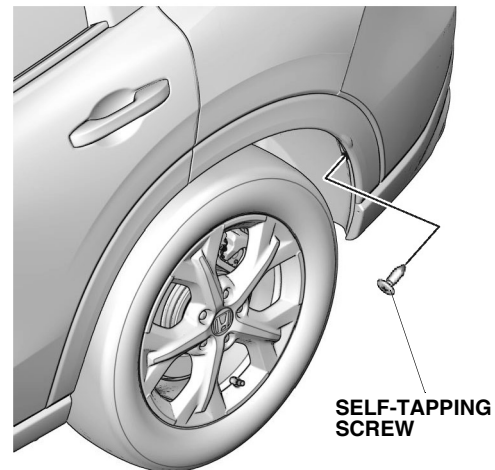
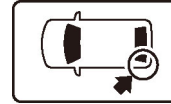

10. Open the left rear door.

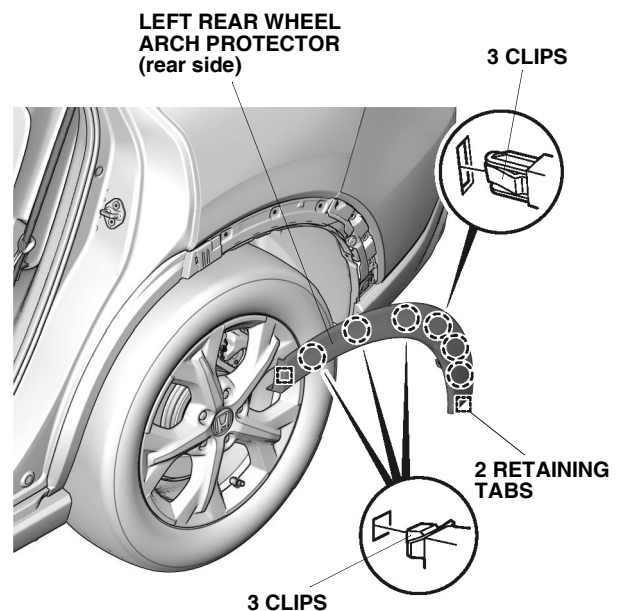

11. Remove the left rear wheel arch protector (rear

Germain Honda of College Hills

side).

12. Repeat the same procedures on the other side.

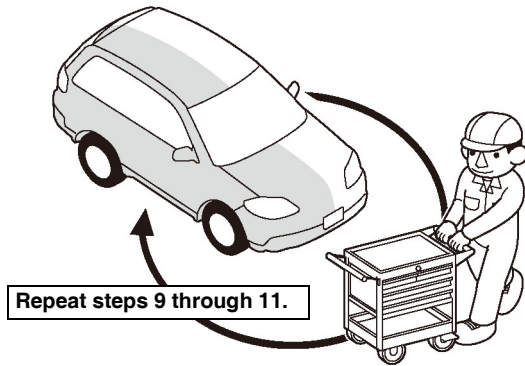

Q9D1014AM

13. Attach masking tape to protect the vehicle.

NOTE
Do not remove the masking tape until after the parts are installed.

Germain Honda of College Hills

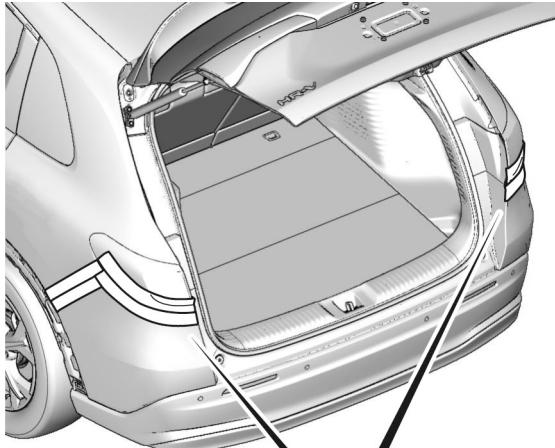
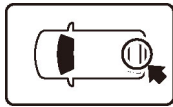

TAILLIGHT

REAR
FENDER

MASKING
TAPE

REAR BUMPER

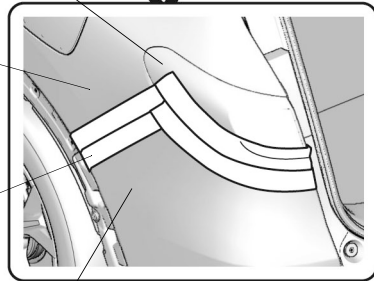

QL52702AN

14. Remove the left cover.

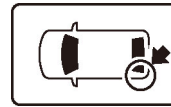

LEFT COVER

4 RETAINING
TABS

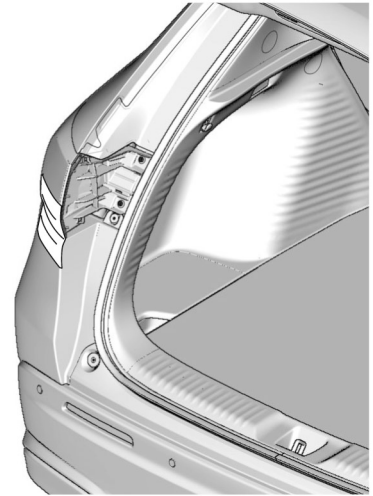

QM20405AN

15. Repeat step 14 on the other side.
16. Remove the hex bolts, clips, and self-tapping screws.

Germain Honda of College Hills

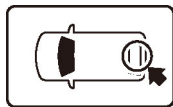

**SELF-TAPPING
SCREW
(round head)**

**SELF-TAPPING
SCREW
(round head)**

CLIP

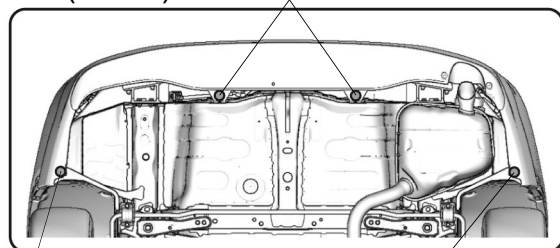
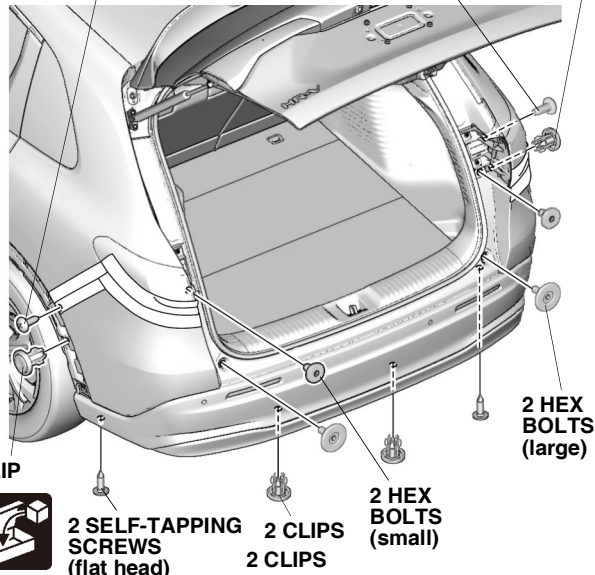

**SELF-TAPPING
SCREW
(flat head)**

**SELF-TAPPING
SCREW
(flat head)**

QL52704AN

17. Release the retaining tabs.

NOTE

- Release the retaining tabs starting from outside working in.
- Make sure to release the retaining tabs in the correct orientation.

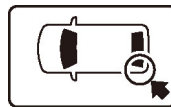

**REAR
BUMPER**

**7 RETAINING
TABS**

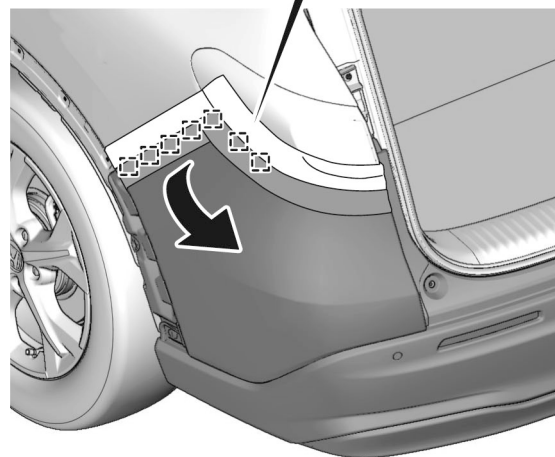
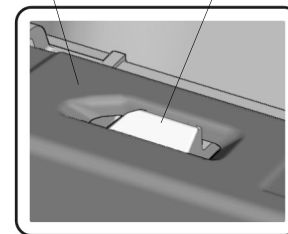

QL52705AN

18. Repeat step 17 on the other side.
19. Remove the rear bumper.

Germain Honda of College Hills

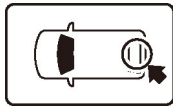

4 RETAINING
TABS

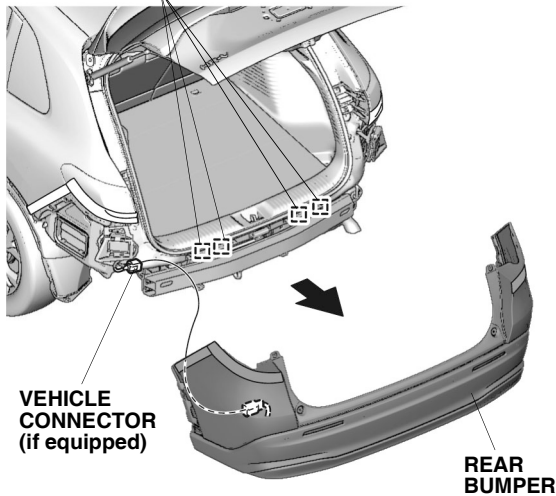

QL52706AN

20. Cut the front bumper.

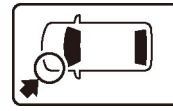

FRONT
BUMPER

CUTTING
AREA

SCRIBE
LINE

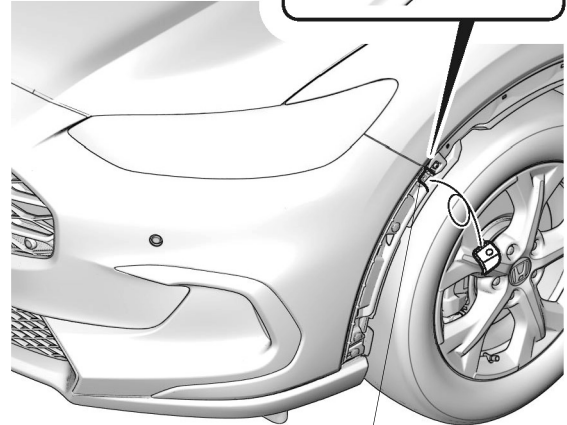
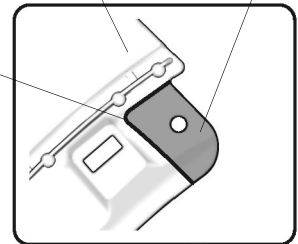

QL60311BB

21. Repeat step 20 on the other side.
22. Remove the clips and spring nut.

Germain Honda of College Hills

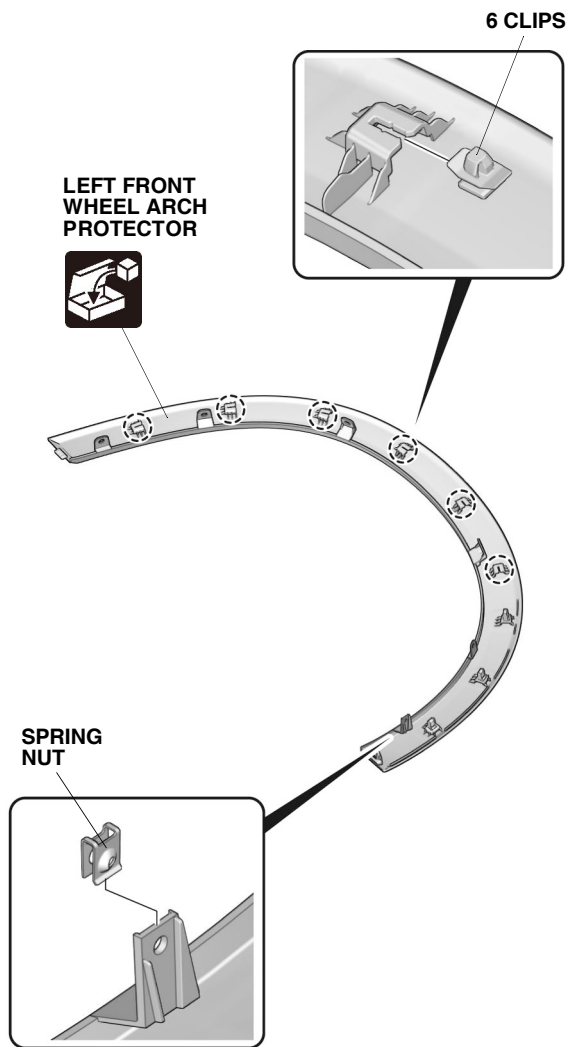

QL60302AB

23. Install the clips and spring nut.

NOTE
Make sure to install the spring nut in the correct orientation.

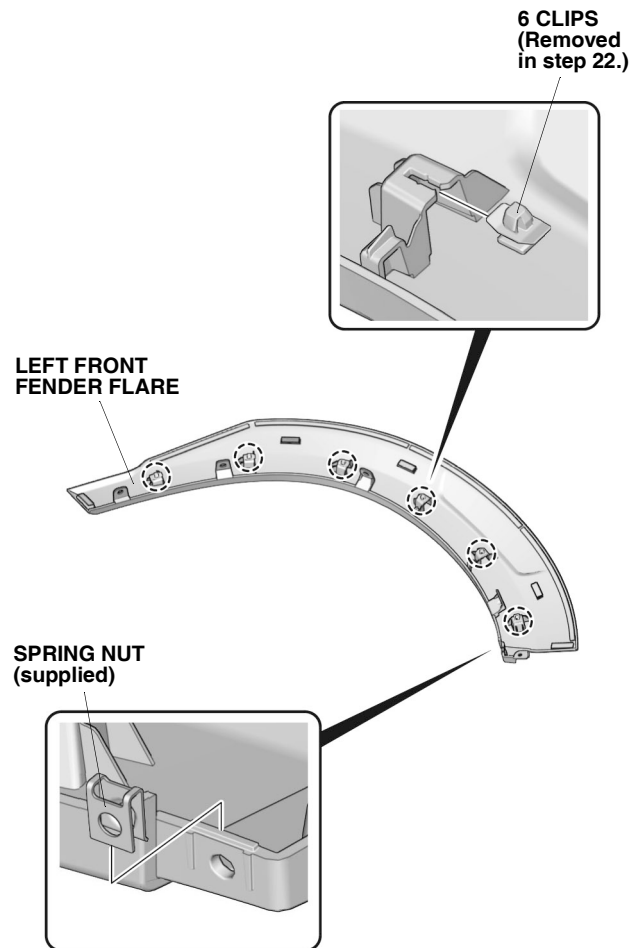

QL60303AB

24. Clean the attaching area.

NOTE
Allow to dry thoroughly.

Germain Honda of College Hills

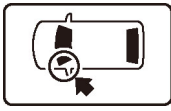

**LEFT FRONT
FENDER**

**ALCOHOL
WIPE**

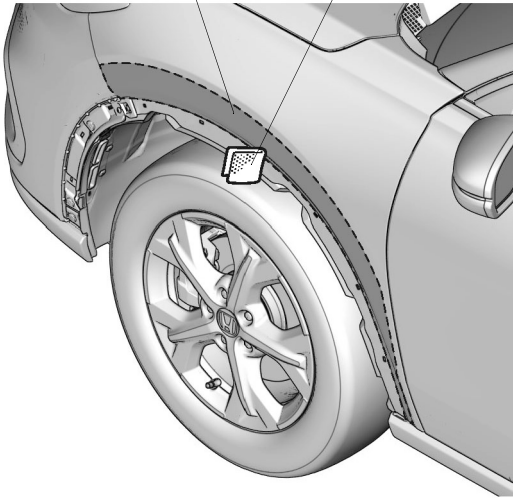

QL60305BB

25. Temporarily attach the adhesive backings.

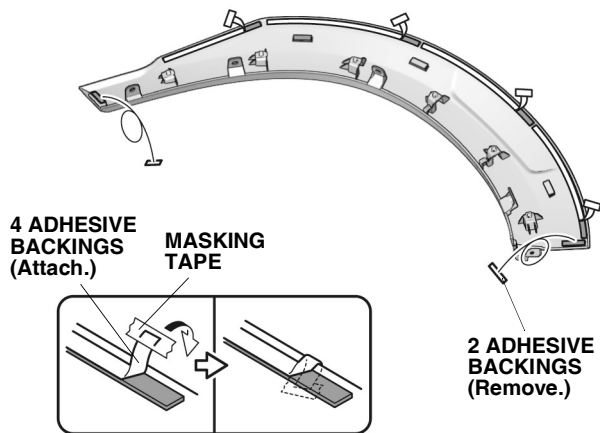

QL60304AB

26. Remove the adhesive backings.
27. Install the left front fender flare.

Germain Honda of College Hills

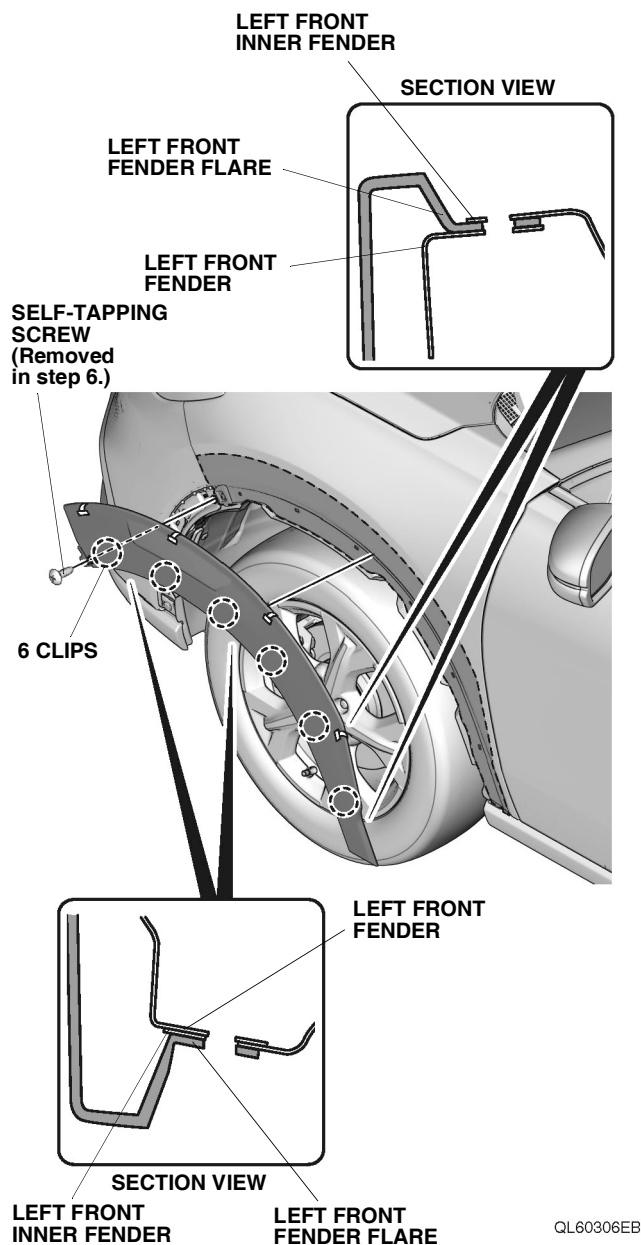

28. Secure the left front fender flare.

NOTE

Check the position of the double-sided adhesive tapes and make sure to press firmly.

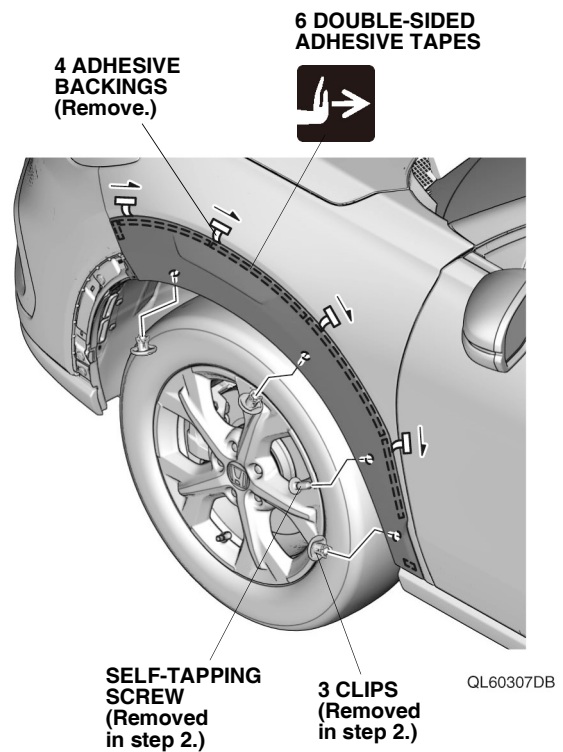

29. Secure the left front fender flare.

Germain Honda of College Hills

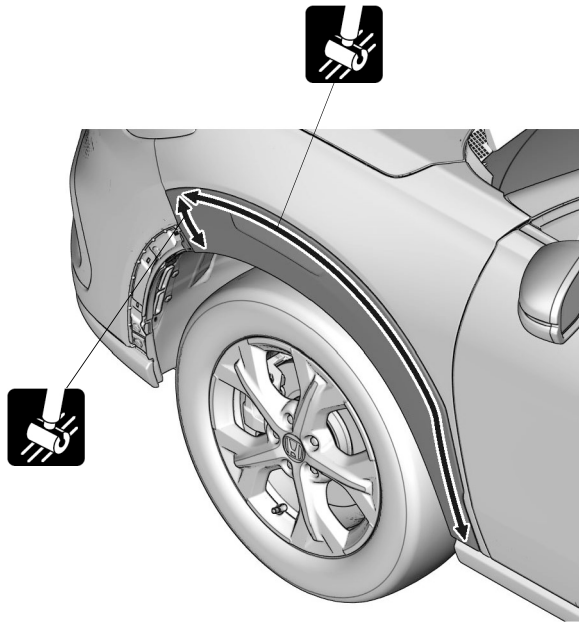

QL60308BB

30. Cut the left front inner fender.

NOTE

Do not damage the fender flare.

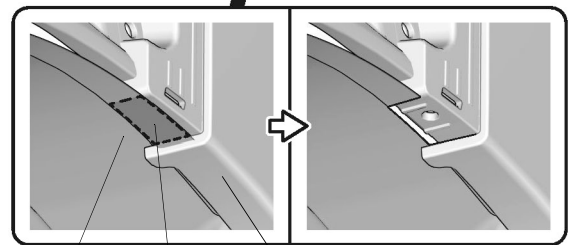
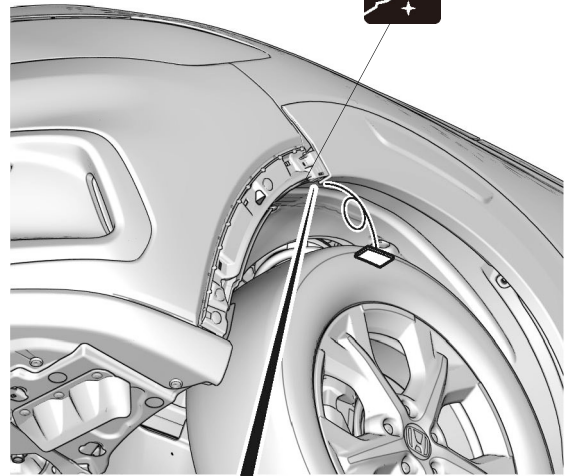
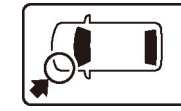

QL60309BB

LEFT FRONT
INNER FENDER

CUTTING
AREA

LEFT FRONT
FENDER FLARE

31. Repeat the same procedures on the other side.

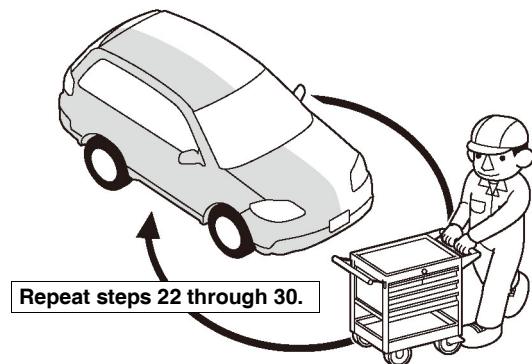

Q9D1014AM

32. Install the clips A and spring nut.

Germain Honda of College Hills

NOTE

Make sure to install the spring nut in the correct orientation.

3 CLIPS A

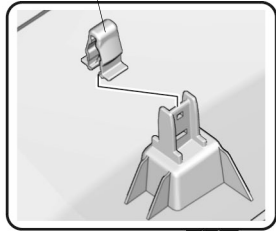

SPRING NUT
(Removed
in step 22.)

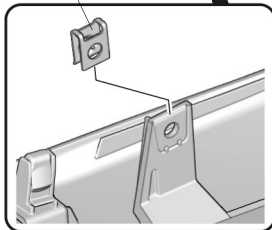

LEFT FRONT
BUMPER FLARE

QL60313AB

33. Install the front bumper.

NOTE

Do not secure the front inner fender in this step.

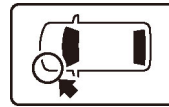

FRONT
BUMPER

ALCOHOL WIPE

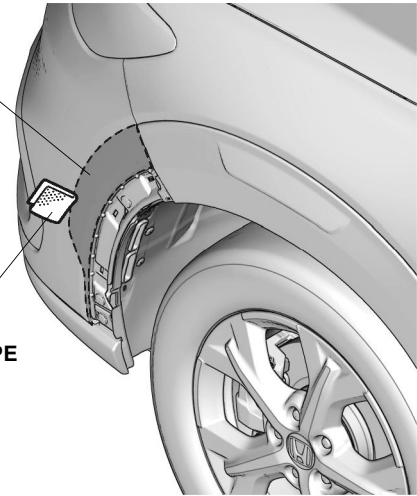

QL60315BB

34. Clean the attaching area.

NOTE

Allow to dry thoroughly.

35. Temporarily attach the adhesive backings.

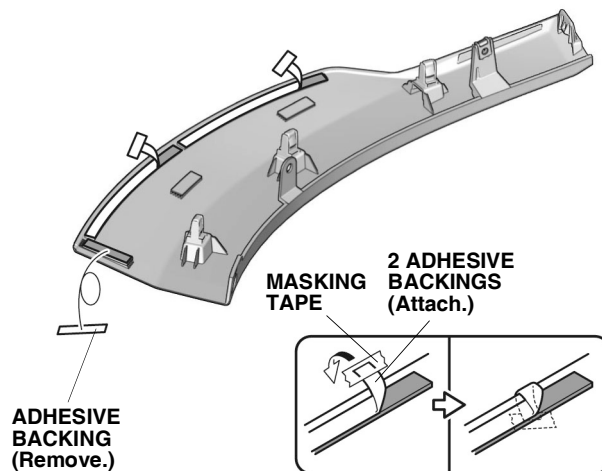

QL60314BB

36. Remove the adhesive backing.

37. Install the left front bumper flare.

Germain Honda of College Hills

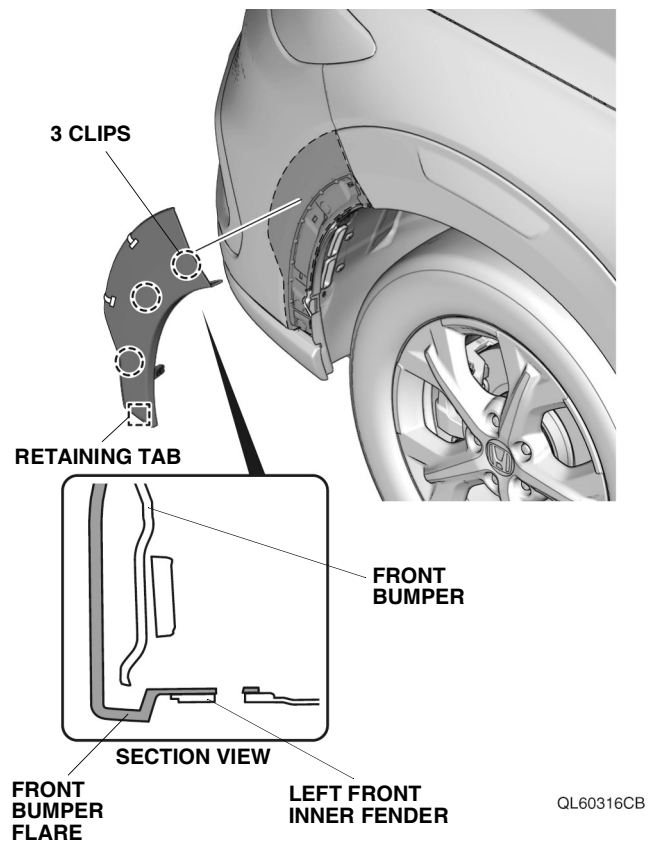

38. Secure the left front bumper flare.

NOTE

Check the position of the double-sided adhesive tapes and make sure to press firmly.

Germain Honda of College Hills

3 DOUBLE-SIDED
ADHESIVE TAPES



5 x 20 mm
SELF-TAPPING
SCREW

2 ADHESIVE
BACKINGS
(Remove.)

SELF-TAPPING
SCREW
(Removed in
step 2.)

CLIP
(Removed in
step 2.)

QL60317CB

39. Secure the left front bumper flare.



QL60318BB

40. Repeat the same procedures on the other side.

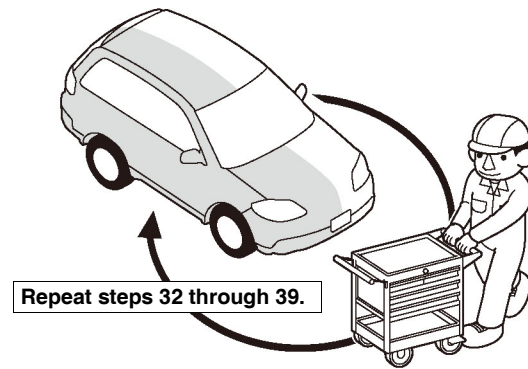

Repeat steps 32 through 39.

Q9D1014AM

41. Install the clips B and spring nut.

NOTE

Make sure to install the spring nut in the correct orientation.

Germain Honda of College Hills

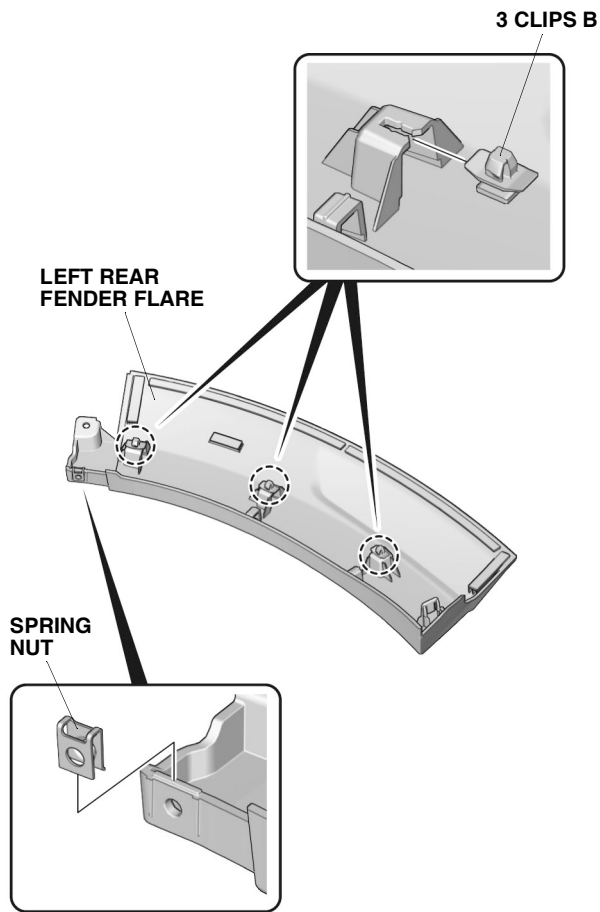

QL60319AB

42. Clean the attaching area.

NOTE

Allow to dry thoroughly.

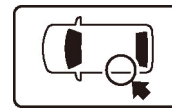

LEFT REAR FENDER

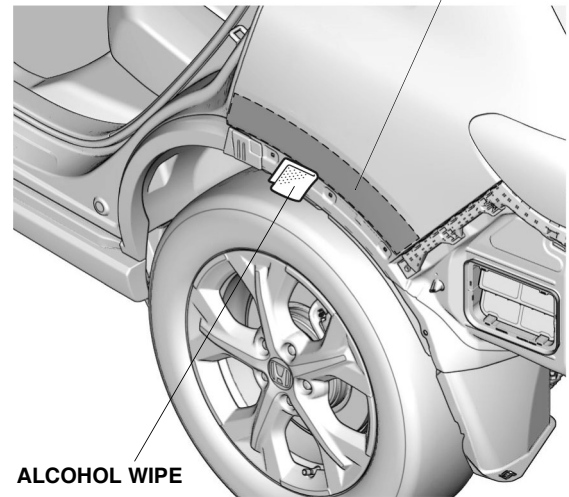

QL60402AB

43. Temporarily attach the adhesive backings.

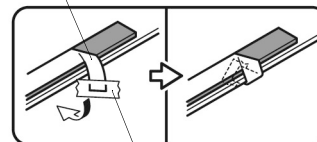
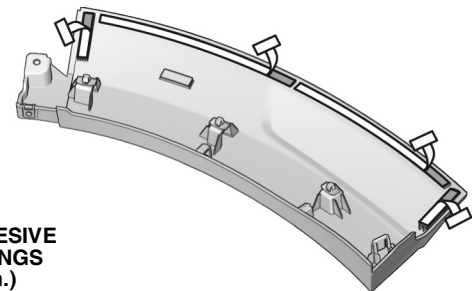

MASKING TAPE

QL60401BB

44. Install the left rear fender flare.

Germain Honda of College Hills

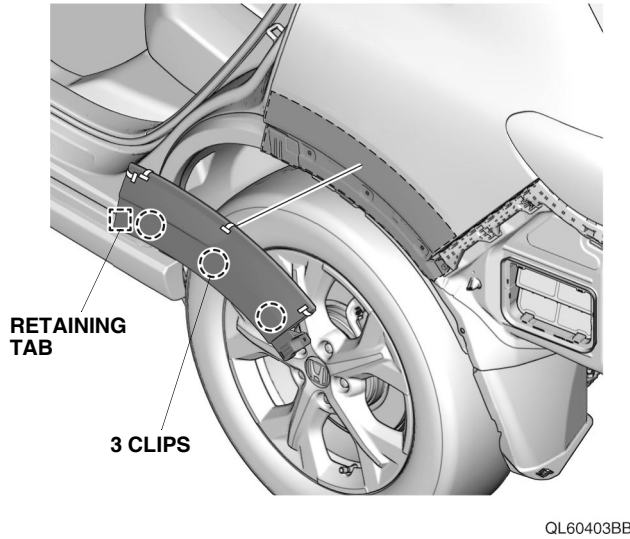

45. Secure the left rear fender flare.

NOTE

Check the position of the double-sided adhesive tapes and make sure to press firmly.

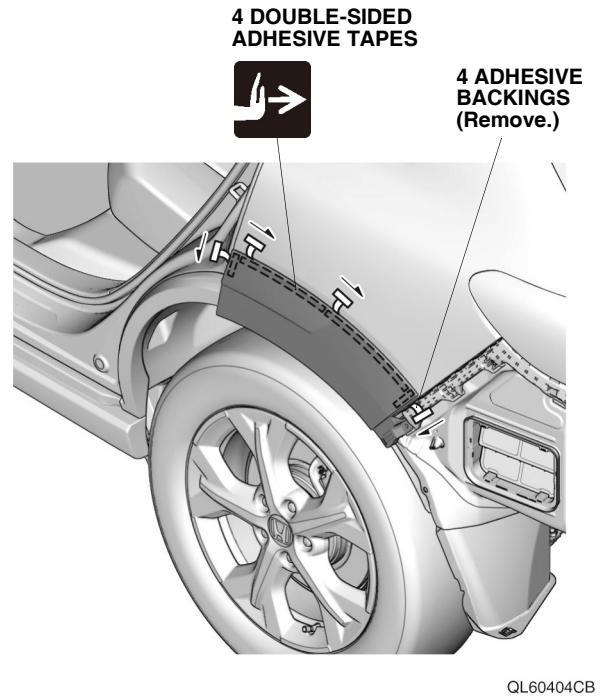

46. Secure the left rear fender flare.

Germain Honda of College Hills



47. Cut the left rear inner fender.

NOTE
Do not damage the fender flare.

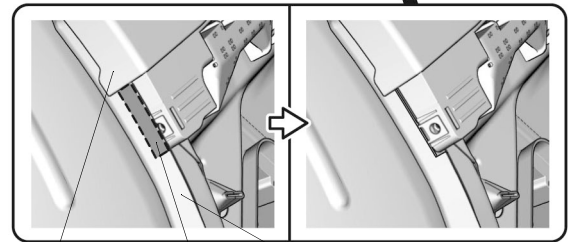
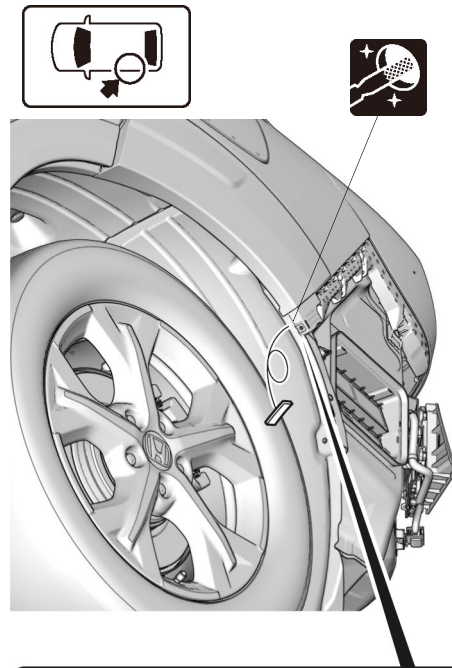

LEFT REAR
FENDER FLARE

CUTTING
AREA

LEFT REAR
INNER FENDER

QL62801AB

48. Secure the left rear fender flare.

Germain Honda of College Hills

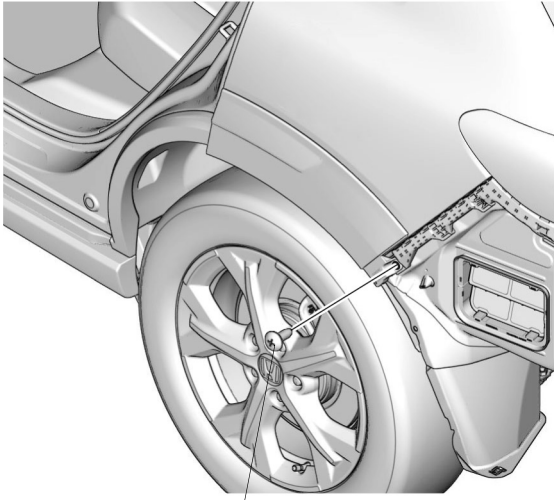
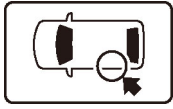

**SELF-TAPPING
SCREW
(round head)
(Removed in step 16.)**

QL60406AB

49. Remove the clips.

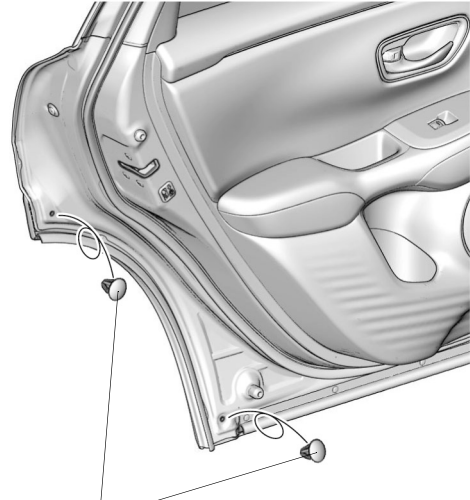
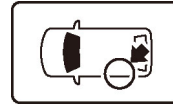

**2 CLIPS
(Do not reuse.)**

QL60407AB

50. Close the left rear door.

Germain Honda of College Hills

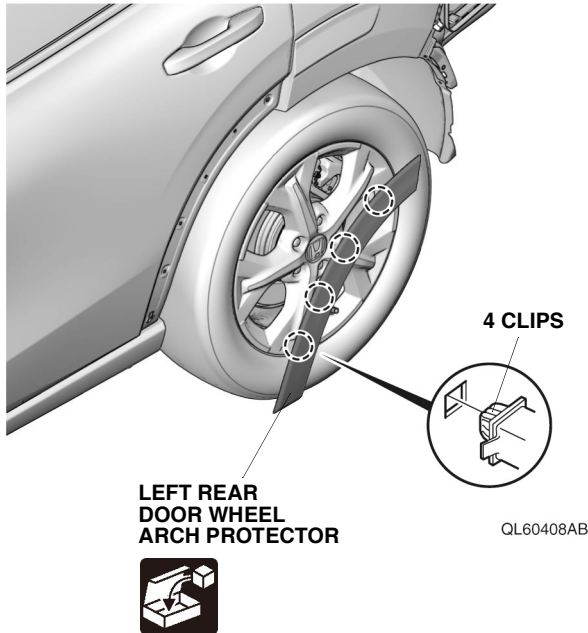
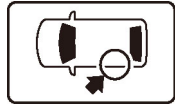

51. Remove the left rear door wheel arch protector.
52. Install the clips C.

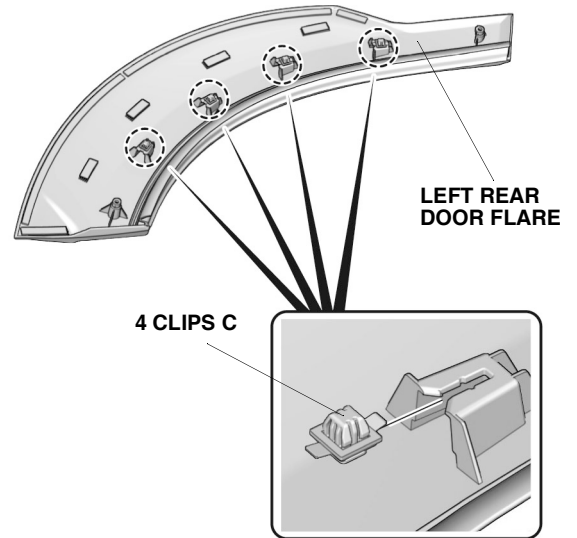

53. Clean the attaching area.

NOTE

Allow to dry thoroughly.

Germain Honda of College Hills

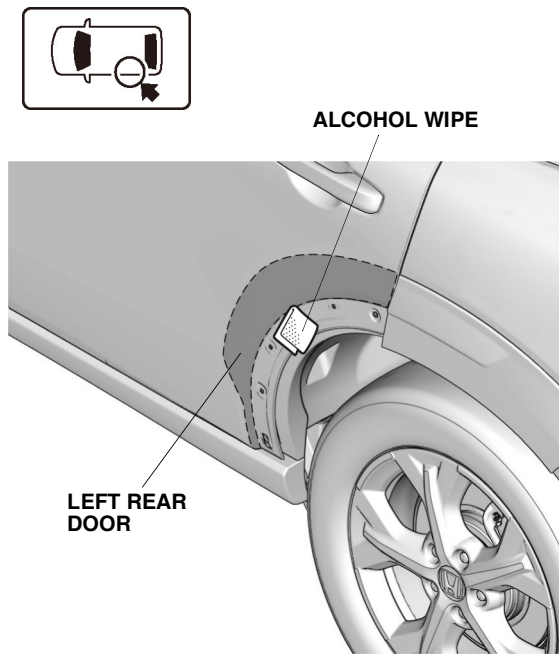

QL60411AB

54. Temporarily attach the adhesive backings.

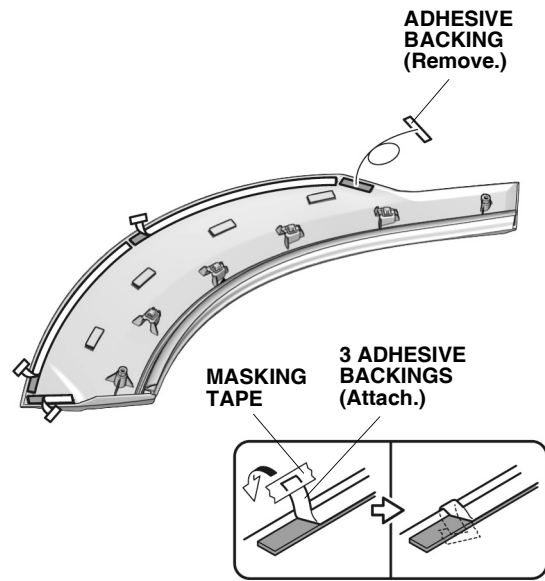

QL60410BB

55. Remove the adhesive backing.
56. Install the left rear door flare.

Germain Honda of College Hills

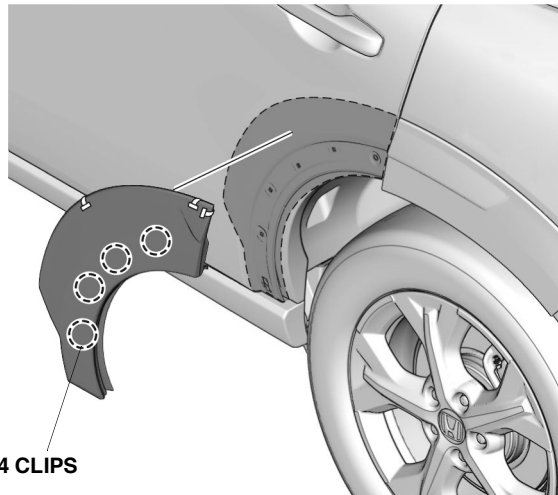

QL60412BB

57. Open the left rear door.

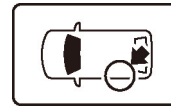

LEFT REAR
DOOR FLARE

2 CLIPS D
(supplied)

QL60415AB

58. Secure the left rear door flare.

NOTE

Make sure to use the replacement clips provided in this kit.

59. Secure the left rear door flare.

NOTE

Check the position of the double-sided adhesive tapes and make sure to press firmly.

Germain Honda of College Hills

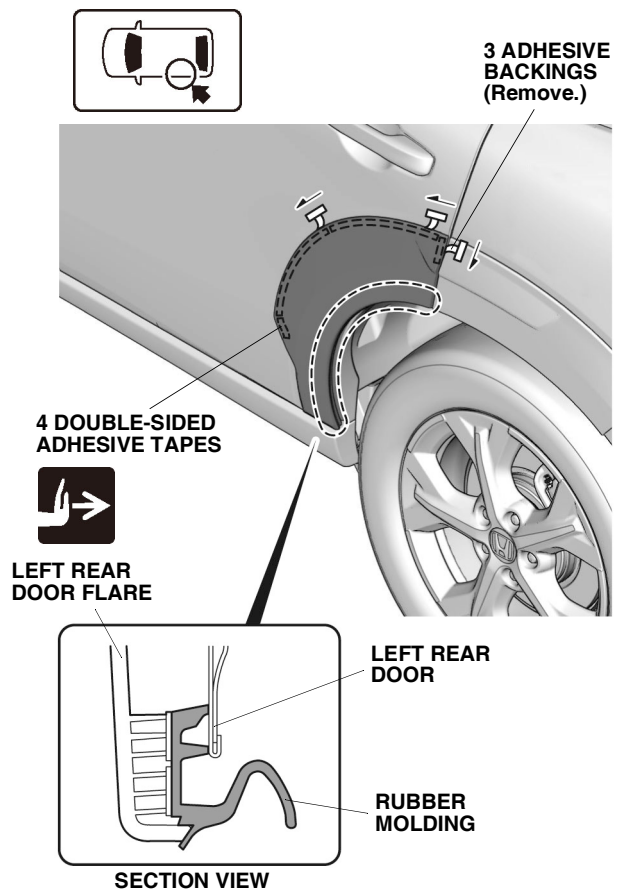

QL60413CB

60. Secure the left rear door flare.

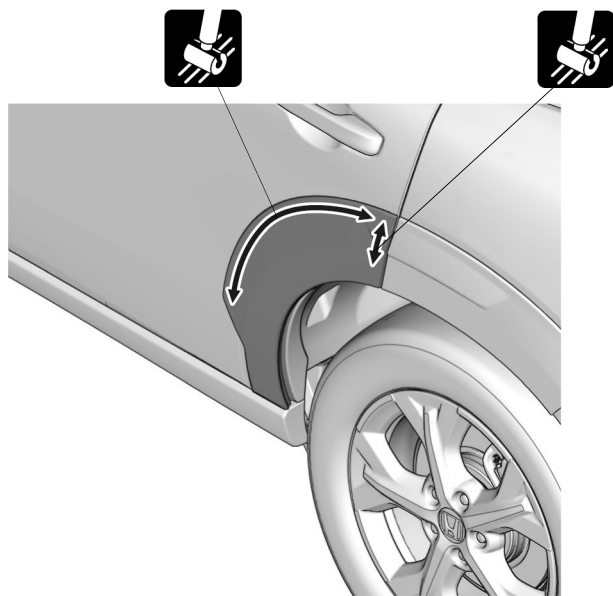

QL60414AB

61. Repeat the same procedures on the other side.

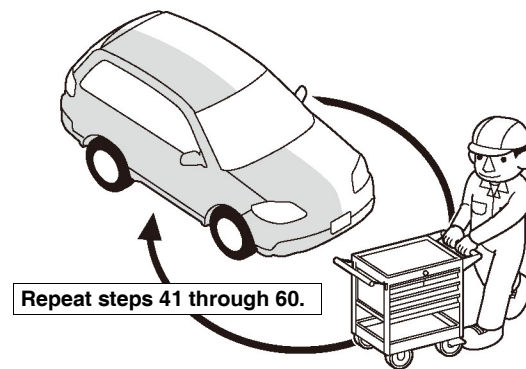

Q9D1014AM

62. Cut the rear bumper.

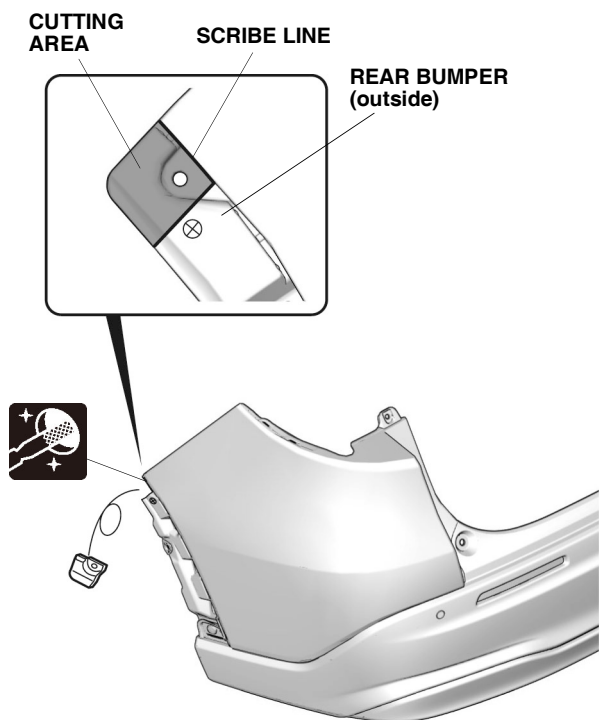

QL60416AB

63. Pierce the rear bumper.

Germain Honda of College Hills

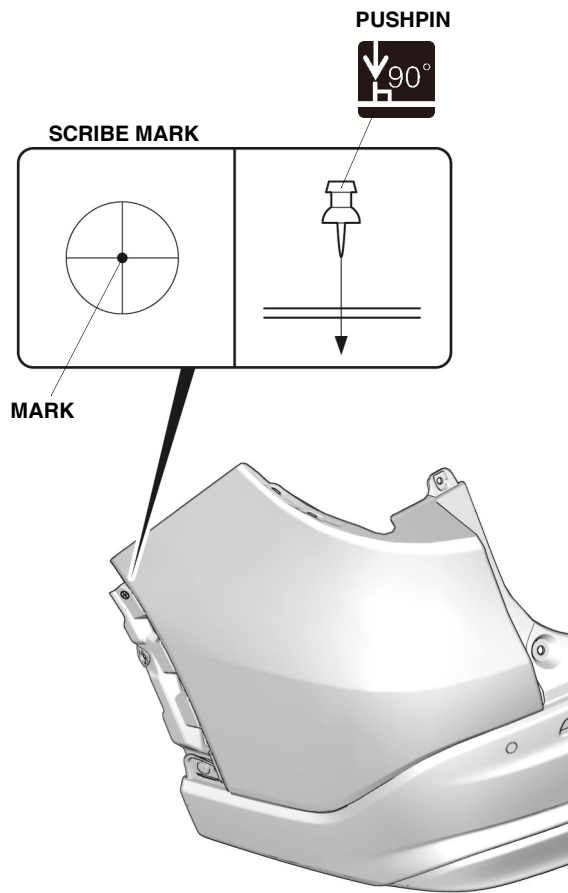

QL60417AB

64. Drill the rear bumper.

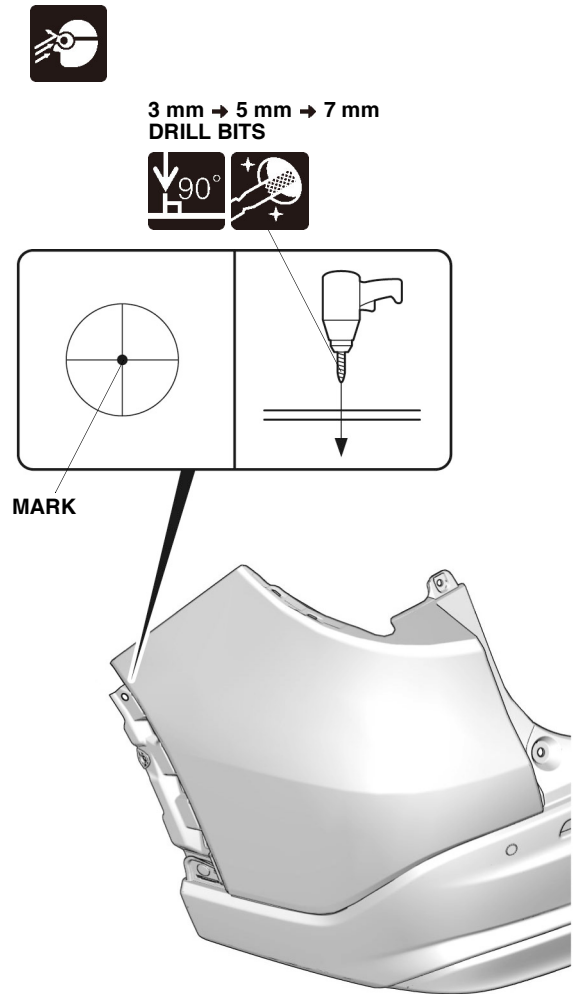

QL60418AB

65. Install the clips A.

Germain Honda of College Hills

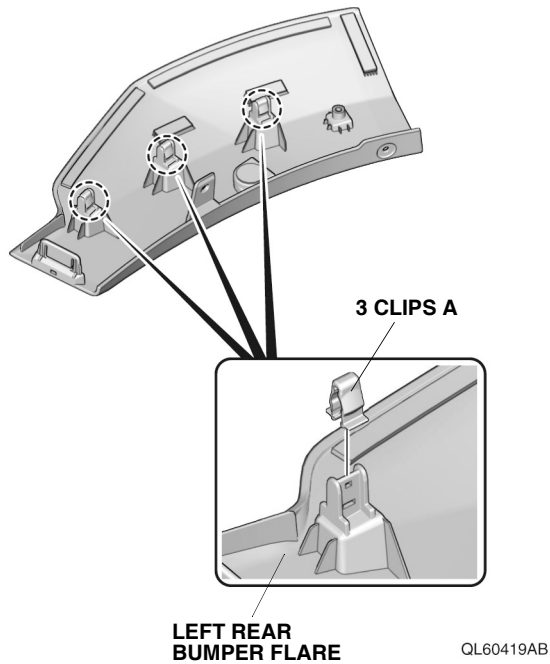

66. Clean the attaching area.

NOTE
Allow to dry thoroughly.

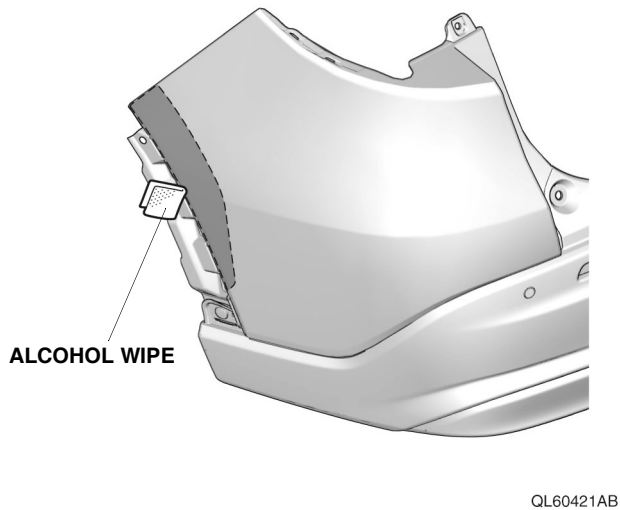

67. Temporarily attach the adhesive backings.

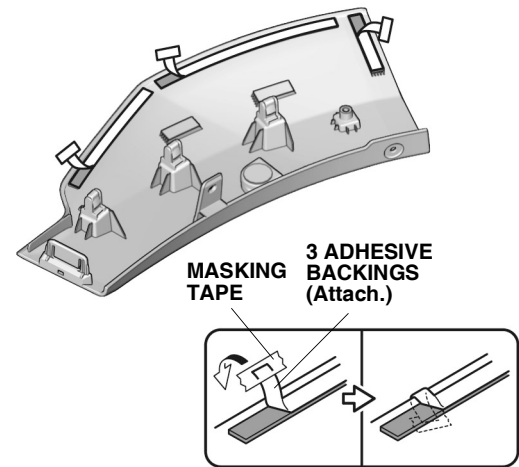

68. Install the left rear bumper flare.

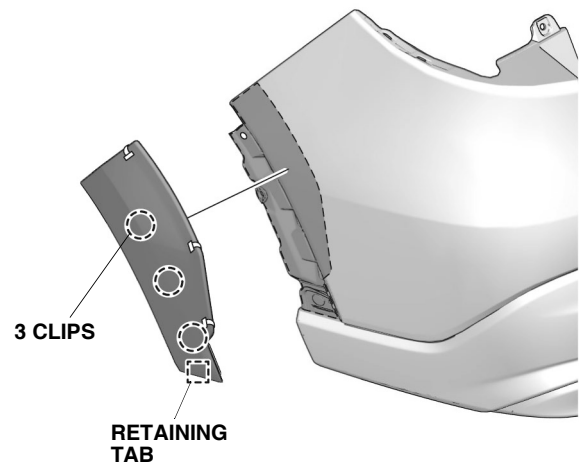

69. Secure the left rear bumper flare.

Germain Honda of College Hills

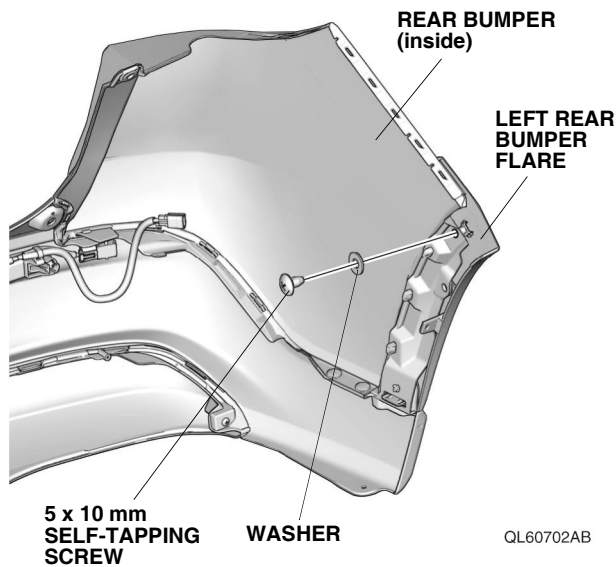

70. Repeat the same procedures on the other side.

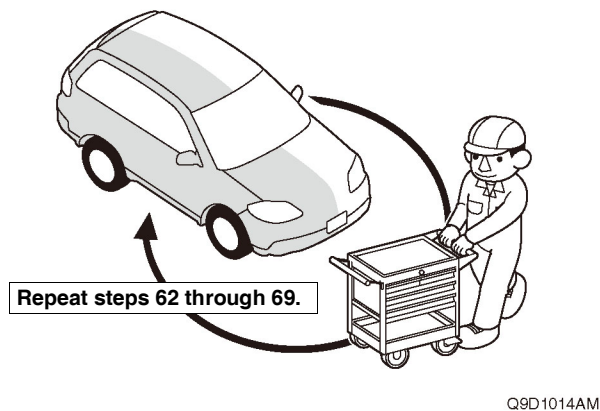

71. Install the rear bumper.

NOTE

Do not secure the left and right rear inner fenders in this step.

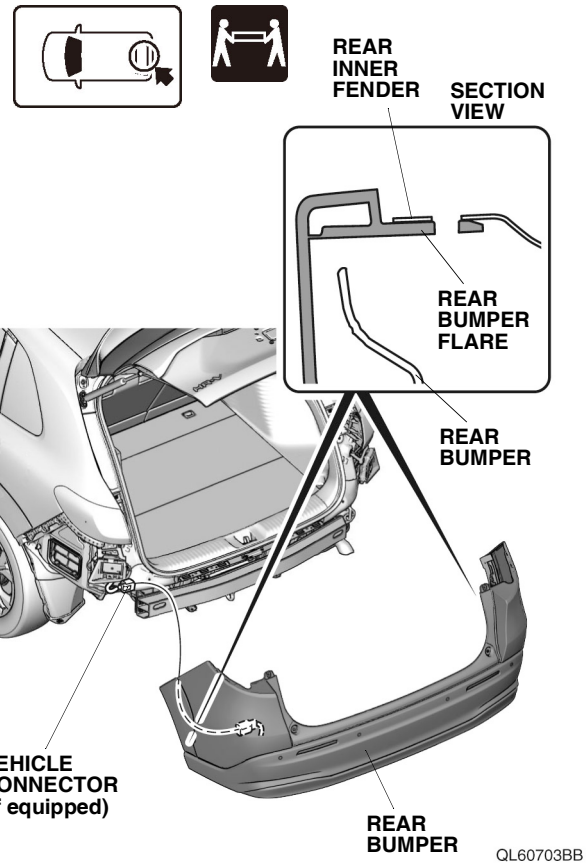

72. Secure the left rear bumper flare and rear bumper.

NOTE

- Firmly press the bumper flare against the rear bumper to install.
- Check the position of the double-sided adhesive tapes and make sure to press firmly.

Germain Honda of College Hills

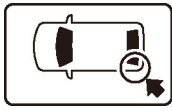

3 ADHESIVE BACKINGS (Remove.)

3 DOUBLE-SIDED ADHESIVE TAPES

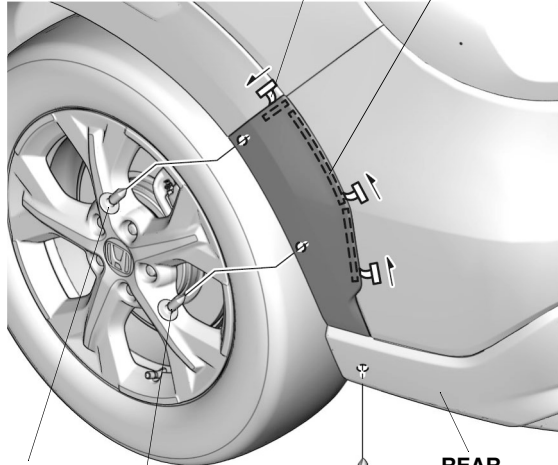

5 x 20 mm SELF-TAPPING SCREW

SELF-TAPPING SCREW (Removed in step 9.)

SELF-TAPPING SCREW (flat head) (Removed in step 16.)

REAR BUMPER

QL60704CB

73. Secure the left rear bumper flare.

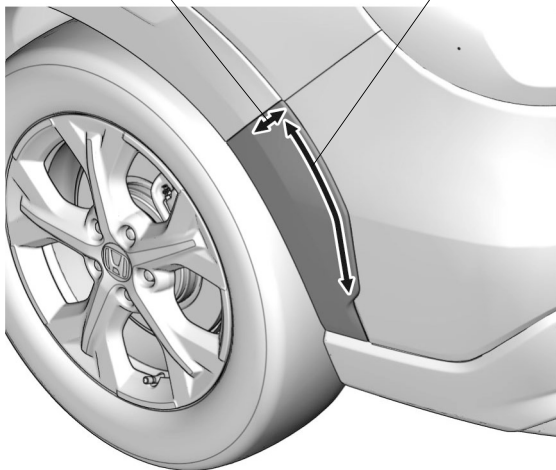

QL60705AB

74. Repeat the same procedures on the other side.

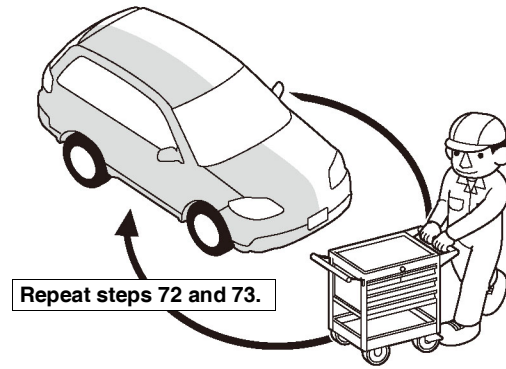

Repeat steps 72 and 73.

Q9D1014AM

75. Check that all parts are installed and properly routed.

NOTE

- Check that all harnesses are not pulled or pinched.
- Make sure all clips and wire ties are securely installed.

76. Install all removed parts.

77. Connect the negative cable to the battery.

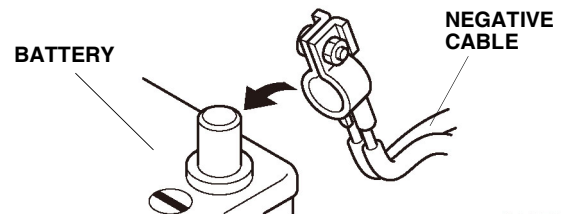

Q060702BM

78. Make sure all accessories and systems operate properly.

79. If necessary, restore the systems back to normal operation as described in the service information.

80. Press and hold the audio unit power button for 2 seconds to restore the audio and navi (if equipped) system functions.