

# Germain Honda of College Hills



## INSTALLATION INSTRUCTIONS

Accessory  
**DOOR EDGE GUARDS**

Application  
**2023 HR-V  
MODEL SERIES**

Publications No.  
**VERSION 1**  
Issue Date  
**MAY 2022**

## GENERAL VIEW

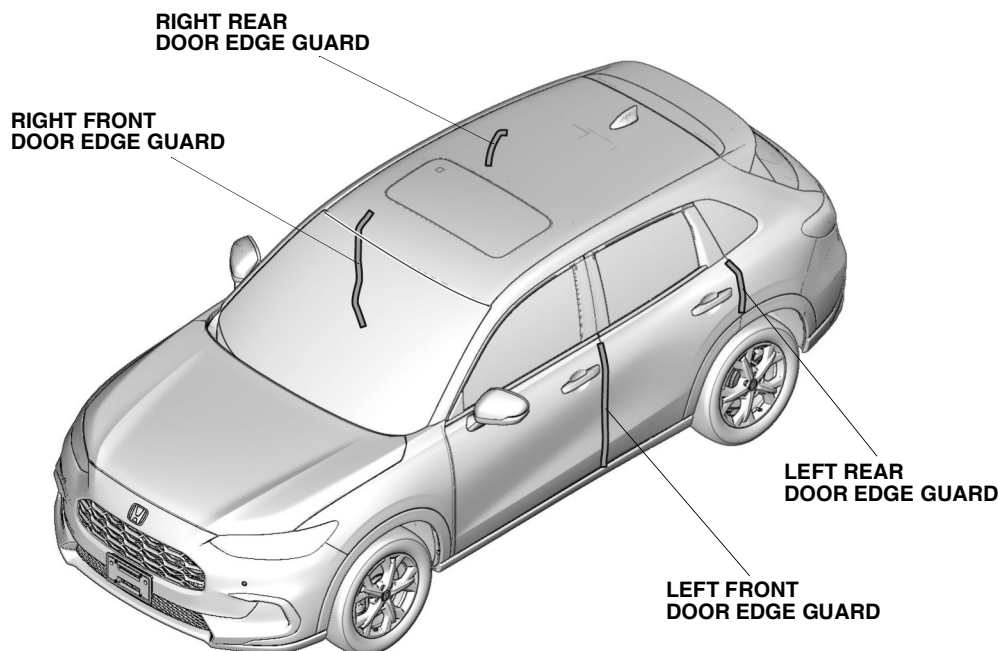

QL60401AN

## FOR YOUR SAFETY (Read carefully.)

### Warning Symbols

**Safety:** Your safety, and the safety of others, is important. To help you make informed decisions about service procedures, we have provided safety messages where appropriate. Of course, it is not practical or possible to warn you about all the hazards associated with servicing a vehicle - you must use your own good judgment.

You will find important safety messages preceded by one of following symbols:

\*All symbols are not used in all installation instructions.

**⚠ DANGER**

You will be killed or seriously hurt if you do not follow the instructions.

**⚠ WARNING**

You can be killed or seriously hurt if you do not follow the instructions.

**⚠ CAUTION**

You can be hurt if you do not follow the instructions.

**NOTICE**

Gives advice to prevent damage to the product, vehicle, the environment or other property.

**NOTE**

Gives helpful information or instructions to be followed when installing this product.



Indicates a prohibited action.

# Germain Honda of College Hills

## Procedure and Location Icons

These icons indicate the work location and the worker's point of view.

\*All icons are not used in all installation instructions.

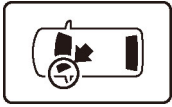

The location on the vehicle.

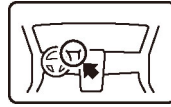

The location in the vehicle.  
(instrument panel.)



Wear eye protection.



Wear heavy gloves.



Use an assistant.



Place the part on a blanket.



Work perpendicular.



Remove any burrs.



Use touch-up paint and allow to dry.



Tighten to the specified torque.



Apply firm pressure while rolling, especially at the ends, to set the adhesive.



Press firmly.



Clean with isopropyl alcohol.



Return the original part to the customer.  
(Do not reuse.)

## Safety: General

- Be careful not to damage the vehicle or the parts.
- The illustrations may differ slightly from the actual accessory.

# Germain Honda of College Hills

## PARTS LIST

Door Edge Guards Kit (P/N 08P20-3V0-100A)

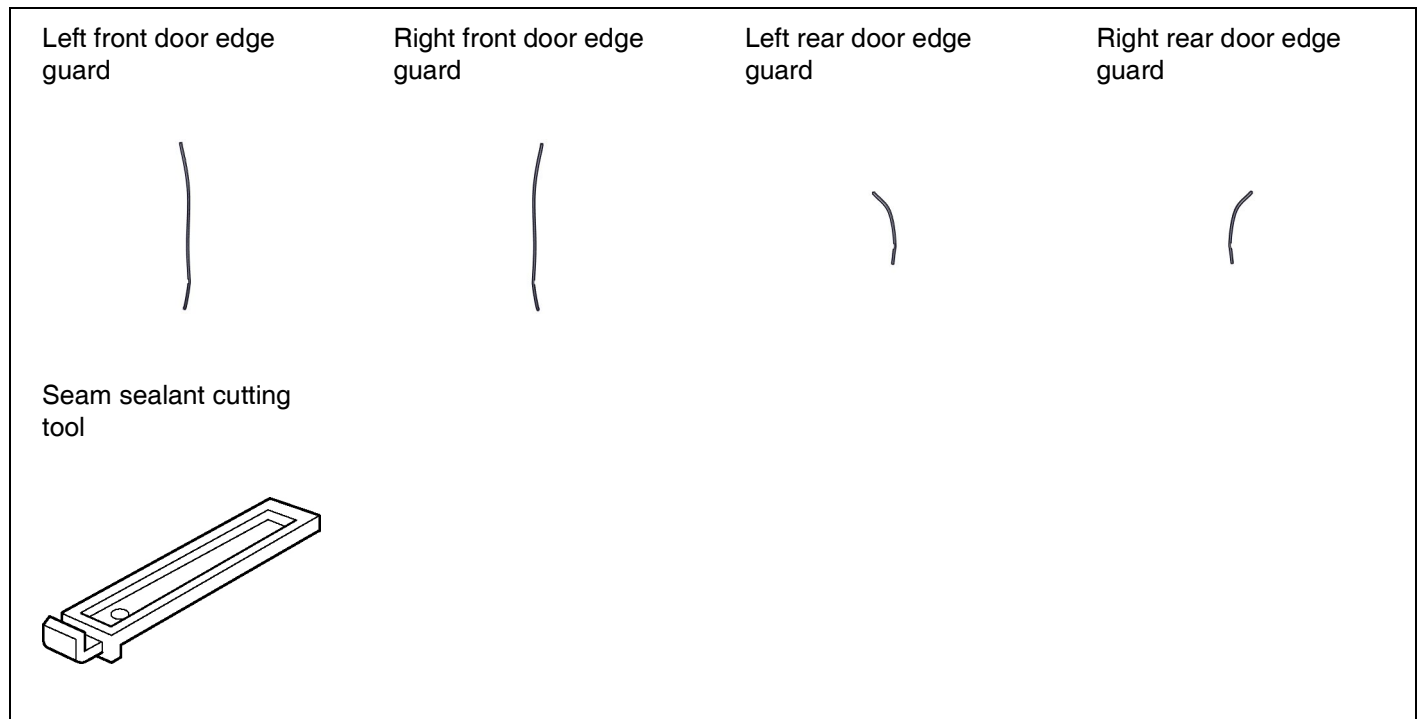

## REQUIRED TOOLS AND SUPPLIES

- Rubber mallet
- Felt-tip pen
- Touch-up paint

# Germain Honda of College Hills

## INSTALLATION

1. Temporarily install the left front door edge guard.

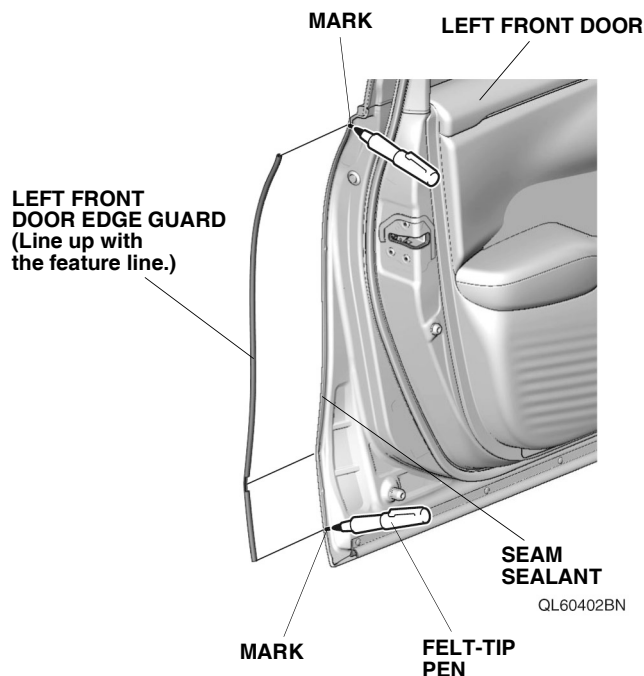
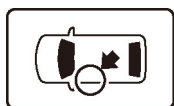

2. Mark the seam sealant.
3. Remove the left front door edge guard.
4. Trim the seam sealant.

### NOTE

The cutting tool cuts in only one direction.

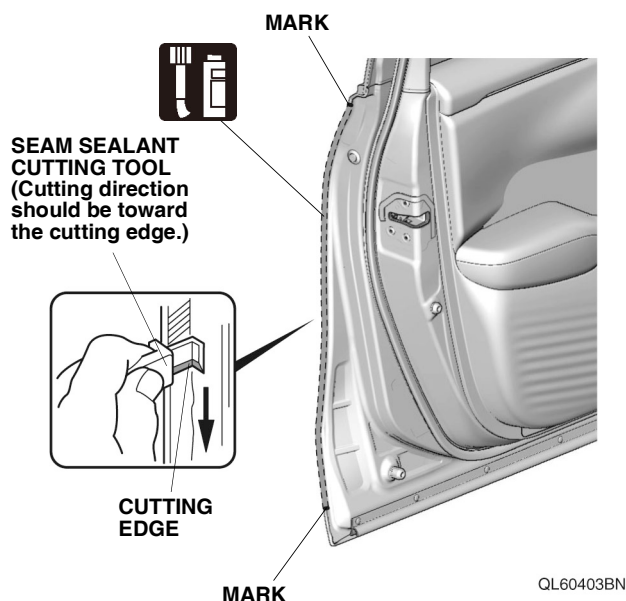

5. Temporarily install the left rear door edge guard.

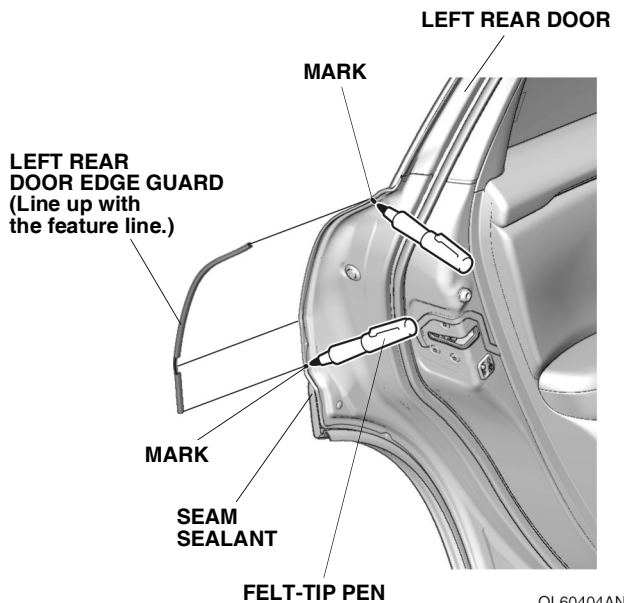
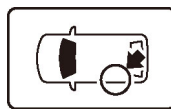

6. Mark the seam sealant.
7. Remove the left rear door edge guard.
8. Trim the seam sealant.

### NOTE

The cutting tool cuts in only one direction.

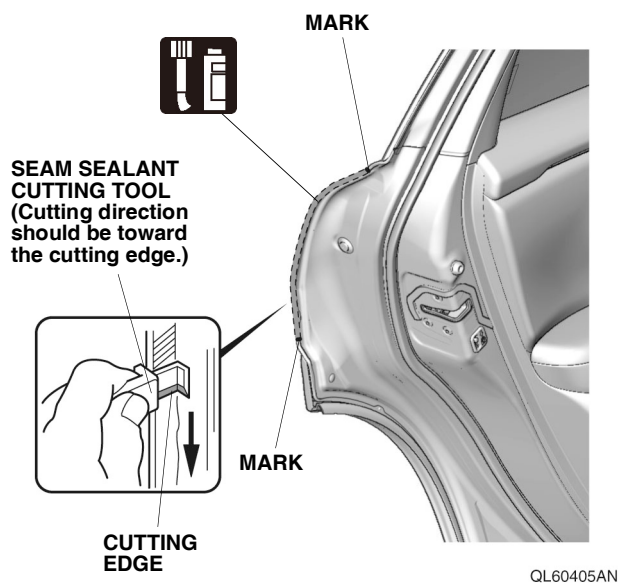

# Germain Honda of College Hills

9. Repeat the same procedures on the other side.

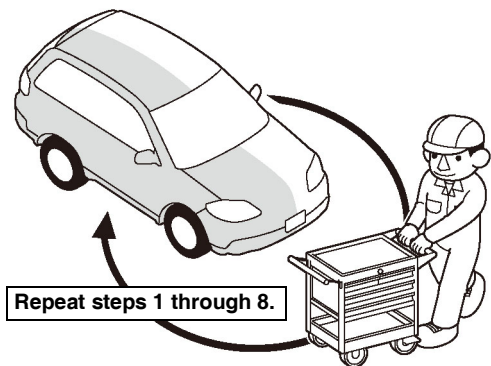

Q9D1014AM

10. Install the left front door edge guard.

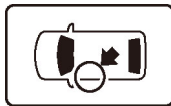

MARK  
(Line up.)

LEFT FRONT DOOR

LEFT FRONT  
DOOR EDGE  
GUARD

LEFT FRONT  
DOOR EDGE  
GUARD

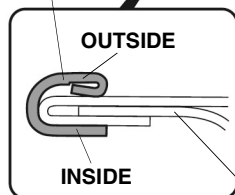

SECTION VIEW

MARK  
(Line up.)

LEFT FRONT  
DOOR

QL60406BN

11. Secure the left front door edge guard.

## NOTE

Once in place, do not remove, reposition, or reinstall the door edge guard or it will not hold securely.

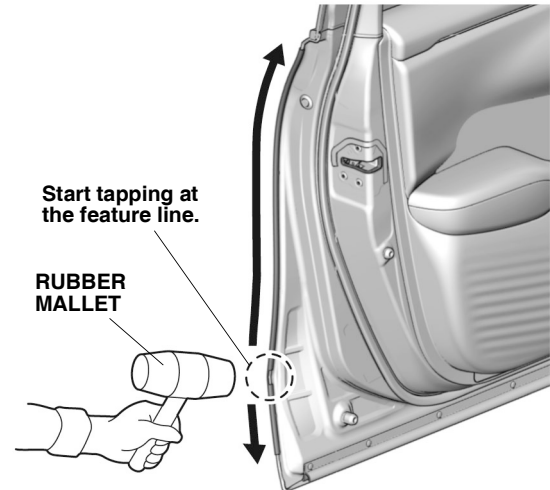

QL60407BN

# Germain Honda of College Hills

12. Install the left rear door edge guard.

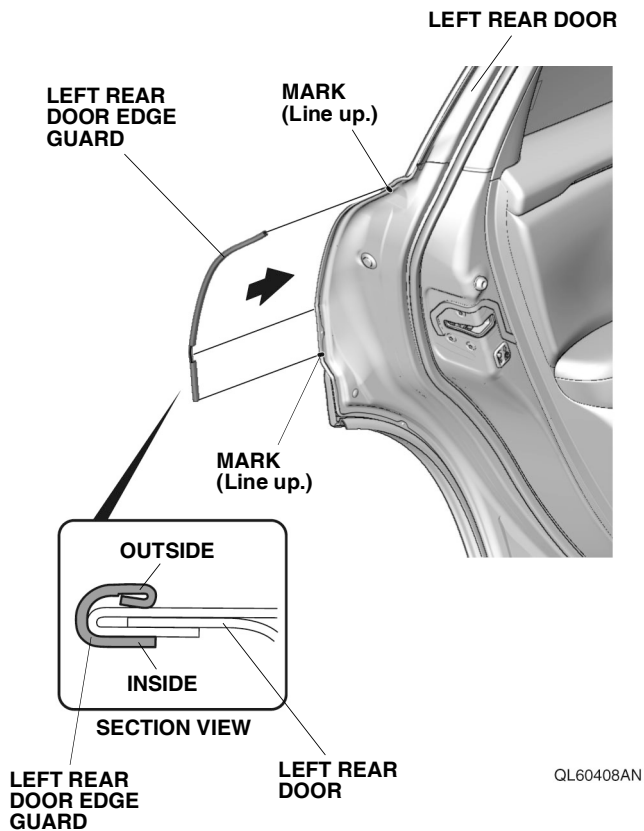
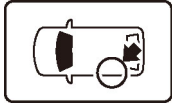

13. Secure the left rear door edge guard.

## NOTE

Once in place, do not remove, reposition, or reinstall the door edge guard or it will not hold securely.

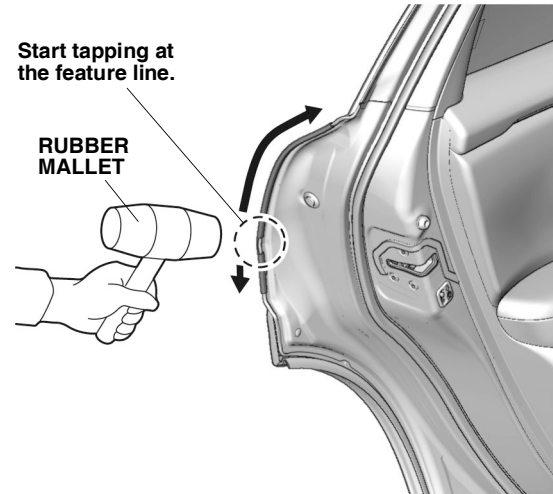

14. Repeat the same procedures on the other side.

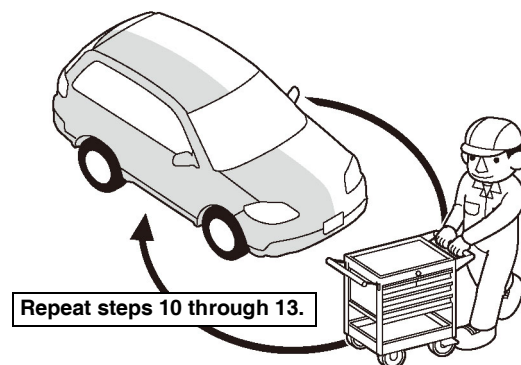

Q9D1014AM

15. Check that all parts are installed properly.