



HONDA INSTALLATION INSTRUCTIONS

Accessory

AMBIENT LIGHTS
P/N 08E10-T7S-100

Application

2022 HR-V

Publications No.

VERSION 1

Issue Date

JUL 2021

PARTS LIST

2 Ambient lights



Bracket



Ambient light harness

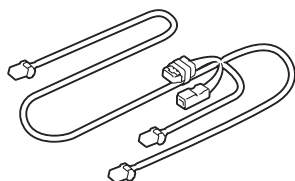

8 Wire ties

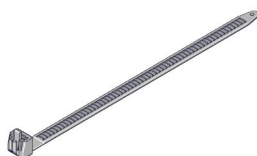

Fuse label

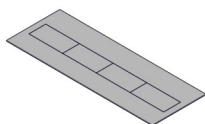

3 Self-tapping screws



TOOLS AND SUPPLIES REQUIRED

Phillips screwdriver

10 mm Open end wrench

Ratchet

10 mm Socket

Diagonal cutters

Isopropyl alcohol

Shop towel

Masking tape

Diagonal Cutters

The following tools are available through the Honda Tool and Equipment Program. On the iN, click on Service > Service Bay > Tool and Equipment Program, then enter the number under "Search." Or, call 888-424-6857.

- Trim Tool Set (T/N SOJATP2014)
- Plastic Trim Tool (T/N SILTRIMTL10)

Illustration of the Ambient Lights in the Vehicle

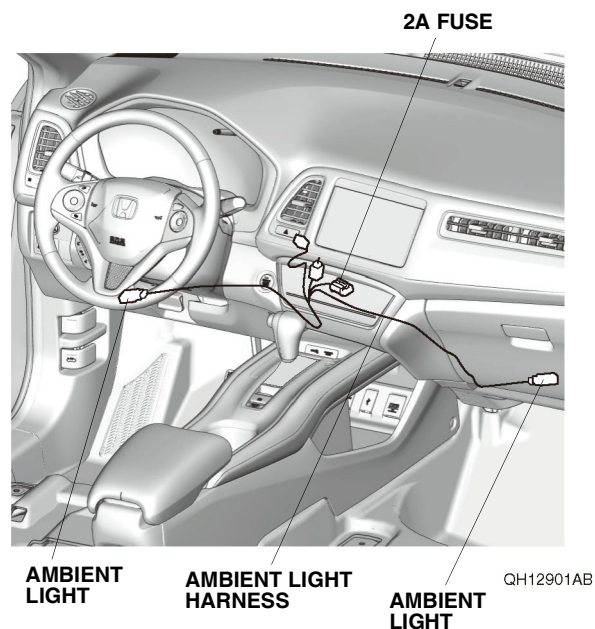

INSTALLATION

Customer Information: The information in this installation instruction is intended for use only by skilled technicians who have the proper tools, equipment, and training to correctly and safely add equipment to your vehicle. These procedures should not be attempted by “do-it-yourselfers.”

1. Disconnect the negative cable from the battery, then wait at least 3 minutes before starting work.
2. Remove the passenger's under cover.

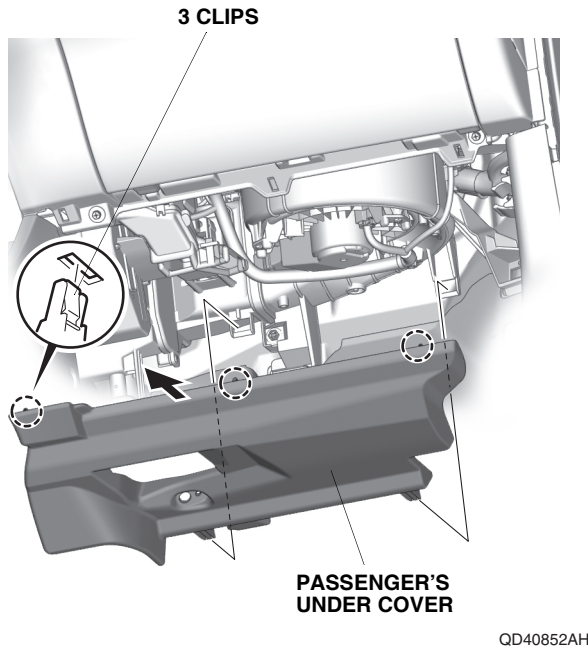

If the vehicle is equipped with front passenger airbag ON/OFF switch, continue with step 3; otherwise, go to step 4.

With front passenger's airbag ON/OFF switch

3. Pull away the door opening seal. Remove the passenger's dashboard side lid, and unplug the vehicle connector. Go to step 5.

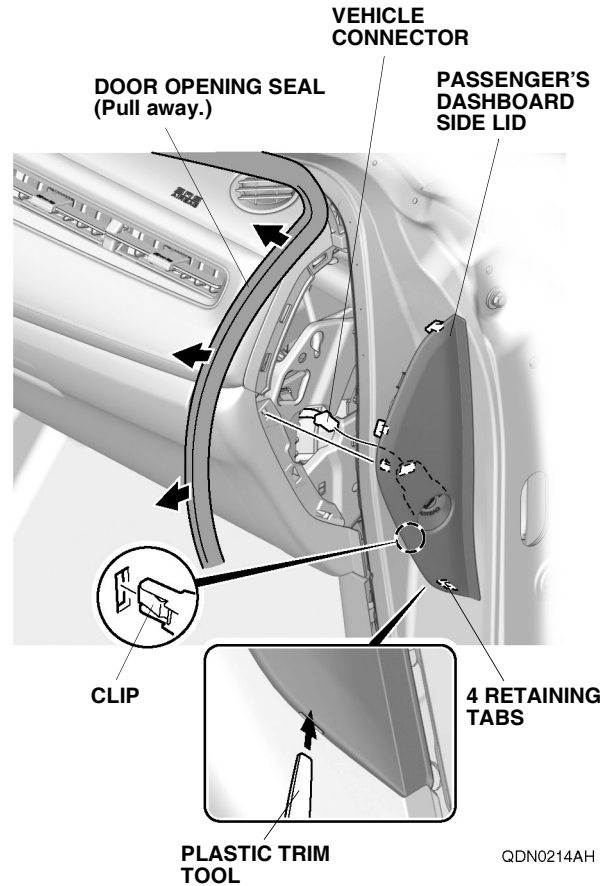

Without front passenger's airbag ON/OFF switch

4. Pull away the door opening seal, and remove the passenger's dashboard side lid.

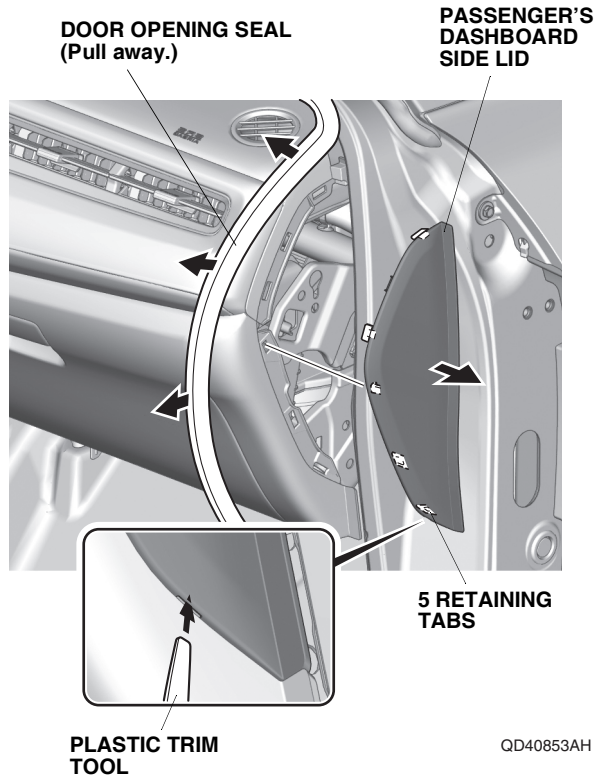

5. Remove the two bolts.

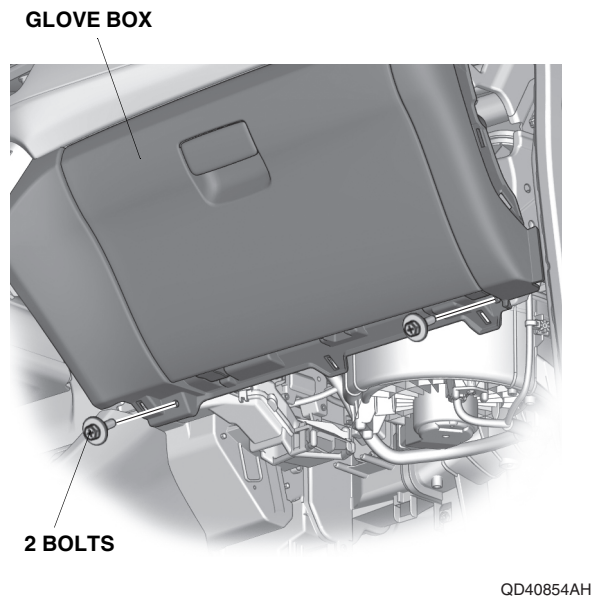

6. Pull away the door opening seal. Open the glove box, and remove the glove box.

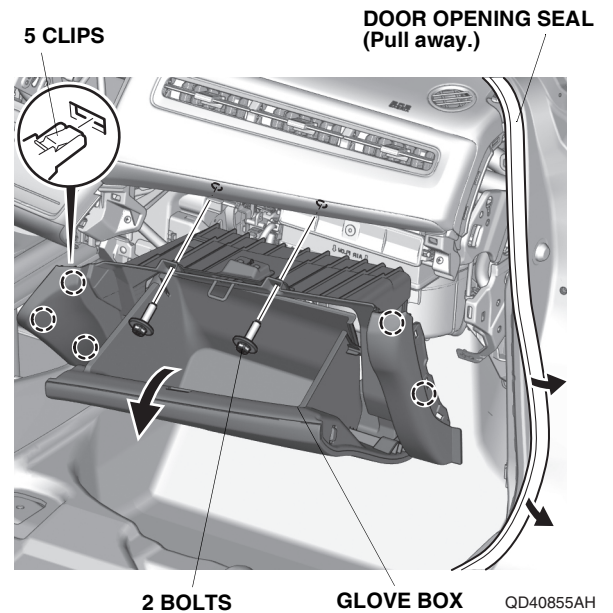

7. Pull away the door opening seal, and remove the driver's dashboard side lid.

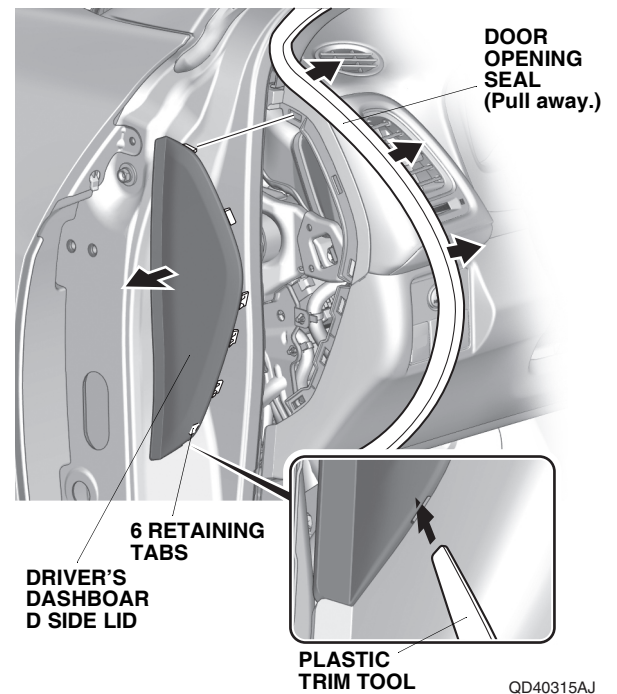

8. Apply masking tape to the lower column cover.

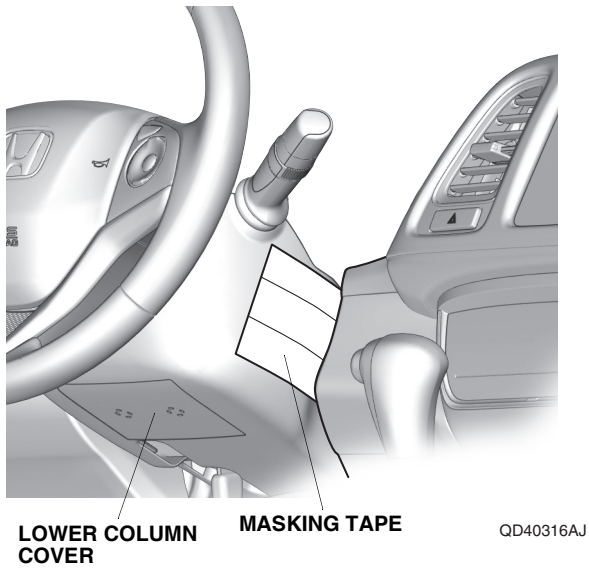

9. Pull away the door opening seal. Remove the driver's dashboard lower cover, and unplug the vehicle connectors.

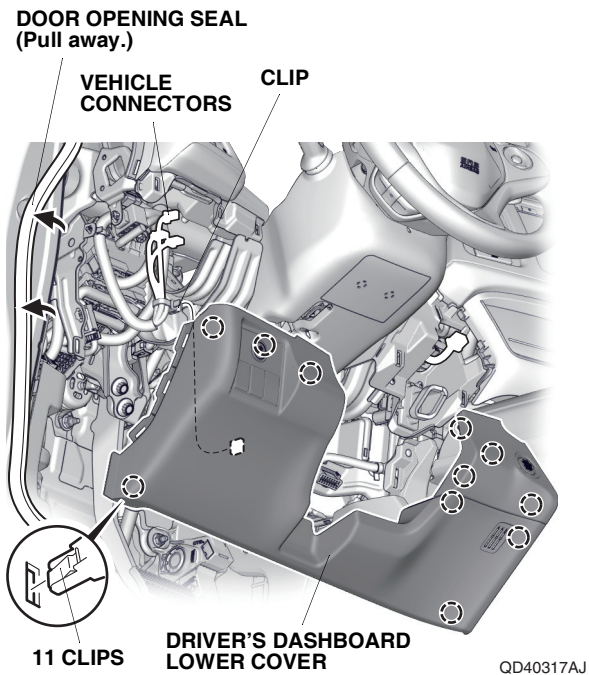

If the vehicle is equipped with automatic climate control, continue with step 10; otherwise, go to step 13.

With automatic climate control

10. Apply masking tape to the climate control unit, center console panel, center console pad, and shift lever as shown. Move the shift lever to Drive.

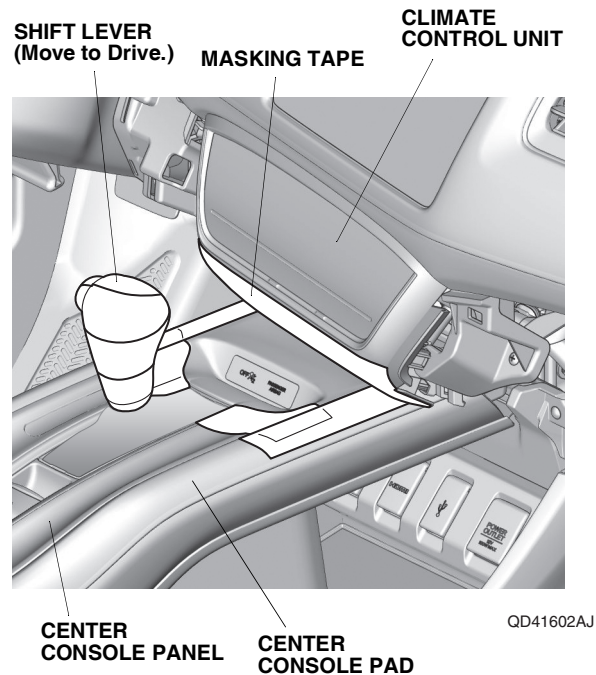

11. Remove the center console switch trim, and unplug the vehicle connector.

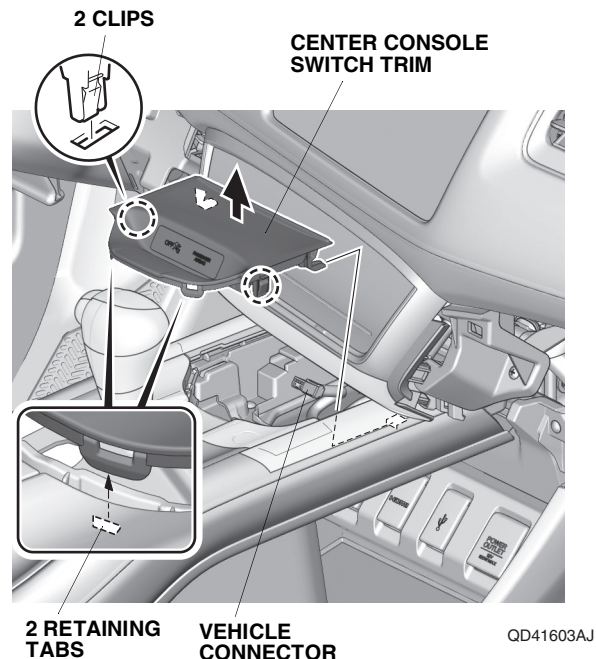

12. Remove the climate control unit, and unplug the vehicle connectors. Go to step 18.

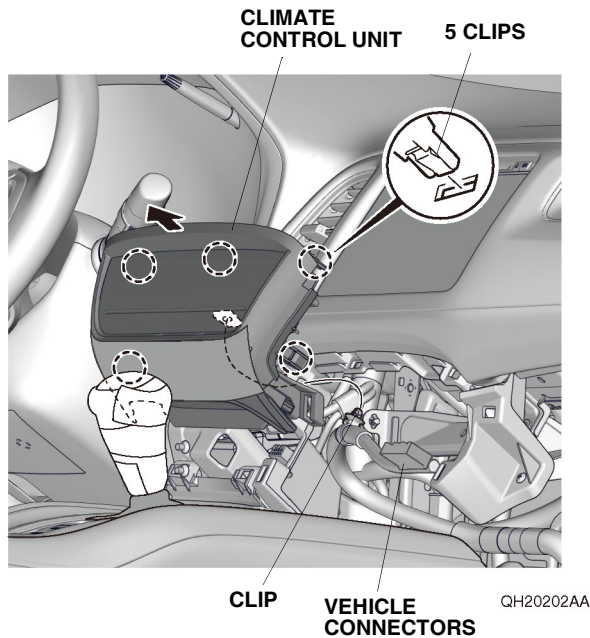

With manual climate control

13. Apply masking tape to the heater control panel, center console panel, center console pad, and shift lever as shown. Move the shift lever to Drive.

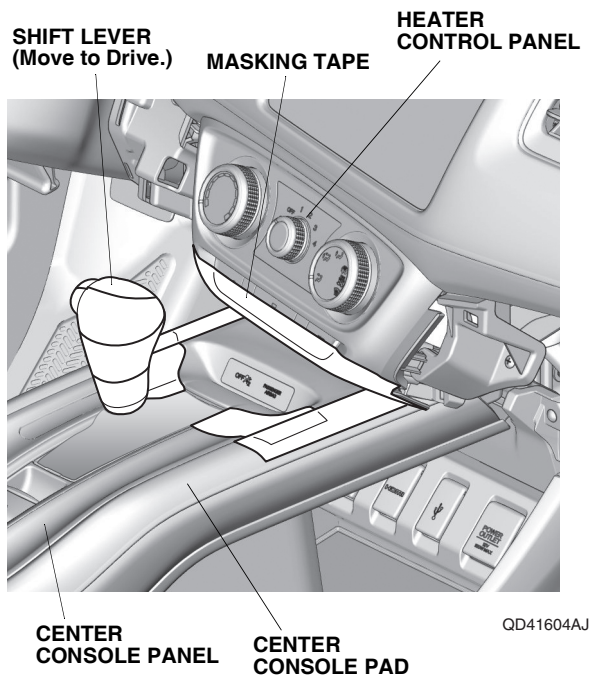

14. Remove the center console switch trim, and unplug the vehicle connector.

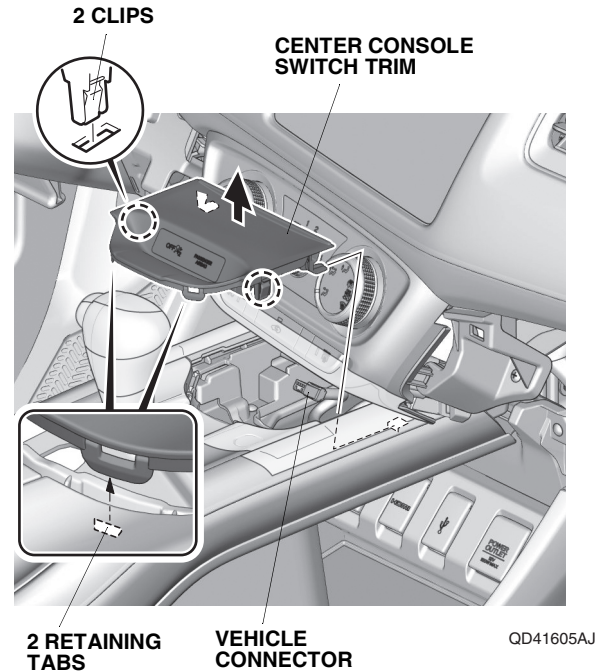

15. Set the mode control dial and the temperature control dial as shown.

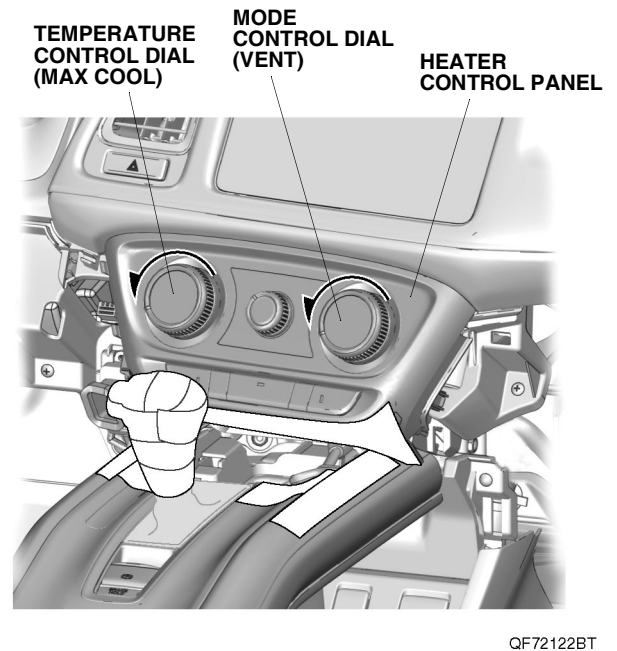

16. Remove the mode control cable and air mix control cable:
- Remove the control cable from the clamp and the groove.
 - Remove the inner cable from the control linkage.

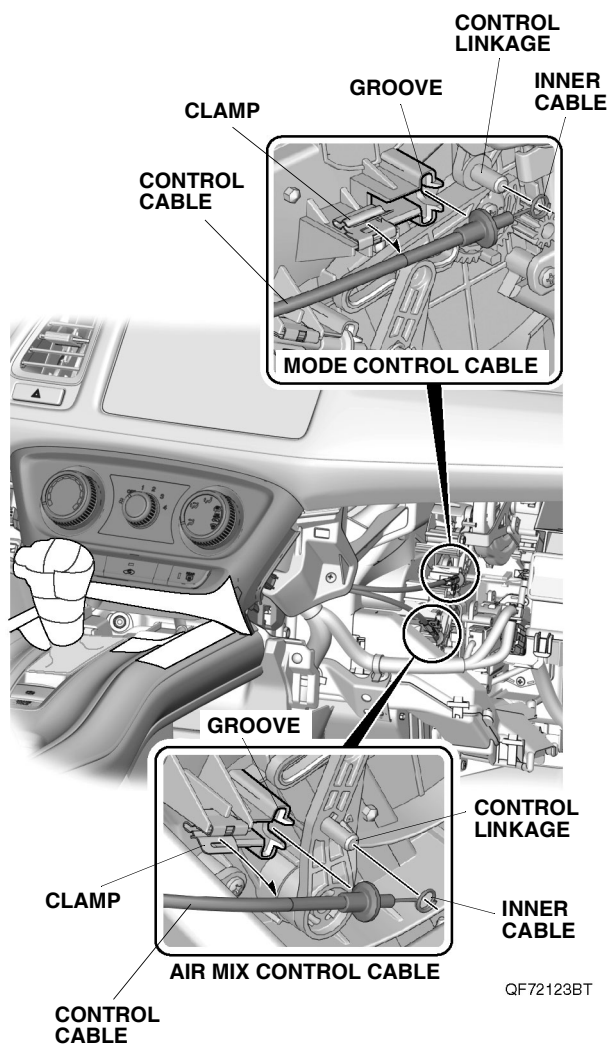

17. Remove the heater control panel, and unplug the vehicle connectors.

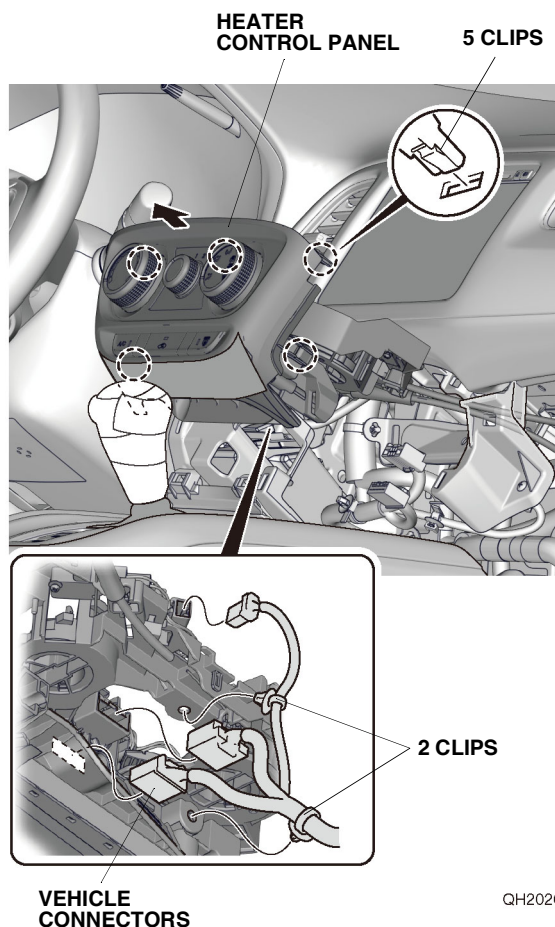

18. Using isopropyl alcohol on a shop towel, thoroughly clean the fuse case where the fuse label will attach.

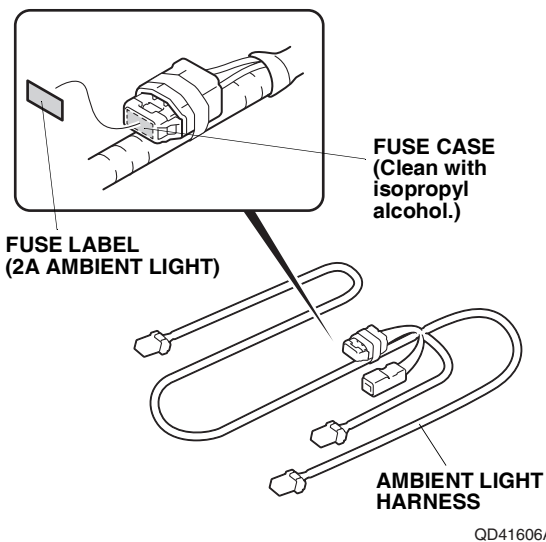

19. Attach the fuse label (2A AMBIENT LIGHT) to the fuse case on the ambient light harness.

20. Unplug the 4-pin connector from the hazard warning switch, and plug it into the ambient light harness 4-pin connector. Plug the ambient light harness 4-pin connector into the hazard warning switch.

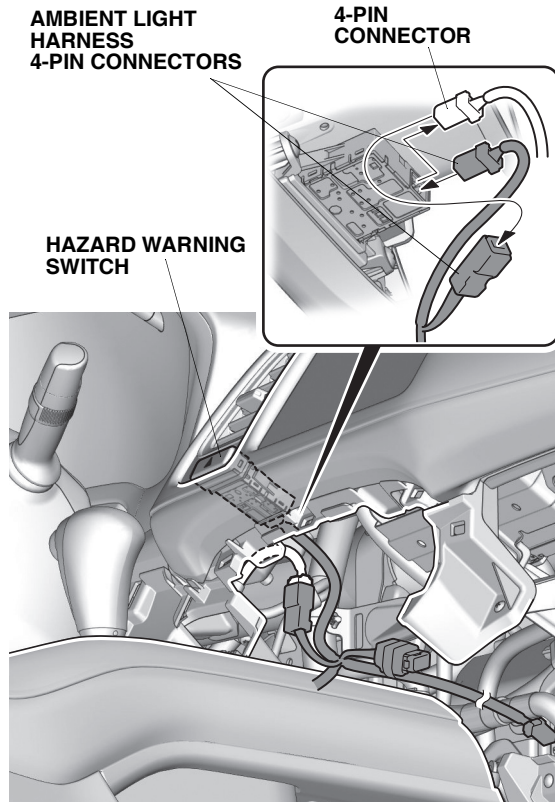

QD41607AJ

21. Secure the 4-pin connectors and ambient light harness to the vehicle harness with one wire tie.

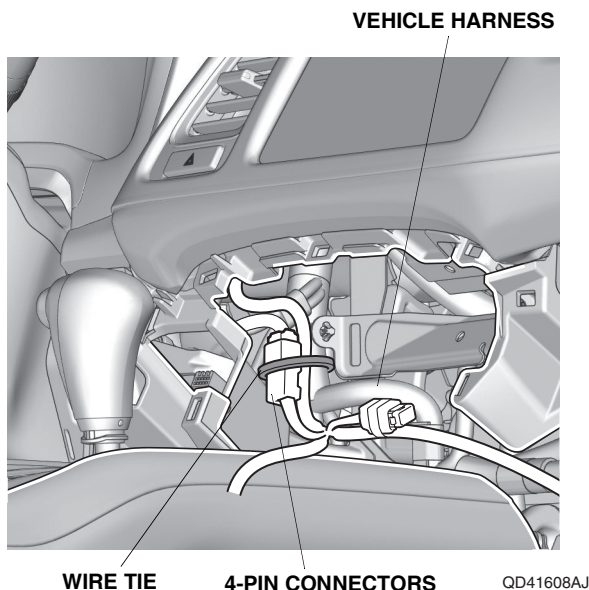

QD41608AJ

22. Route the ambient light harness as shown. Line up the green tape on the ambient light harness with the vehicle clip, and secure the ambient light harness to the vehicle harness with three wire ties.

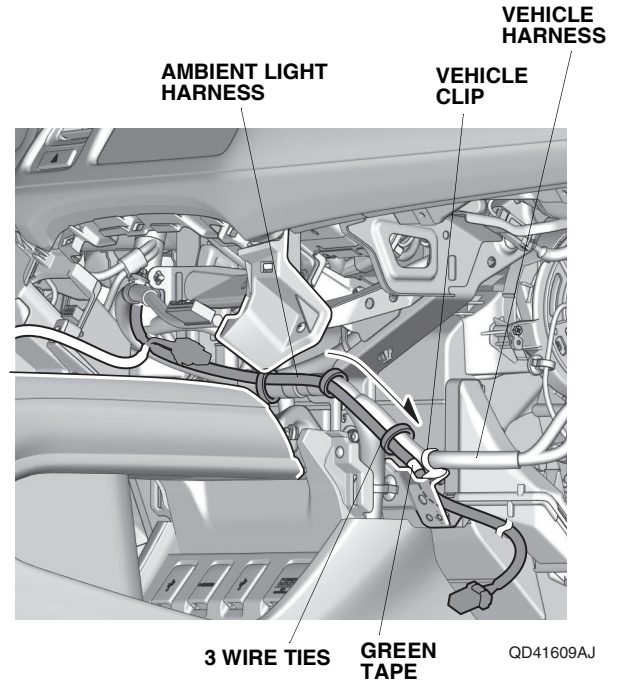

QD41609AJ

23. Route the ambient light harness as shown. Secure the ambient light harness to the vehicle harness with two wire ties.

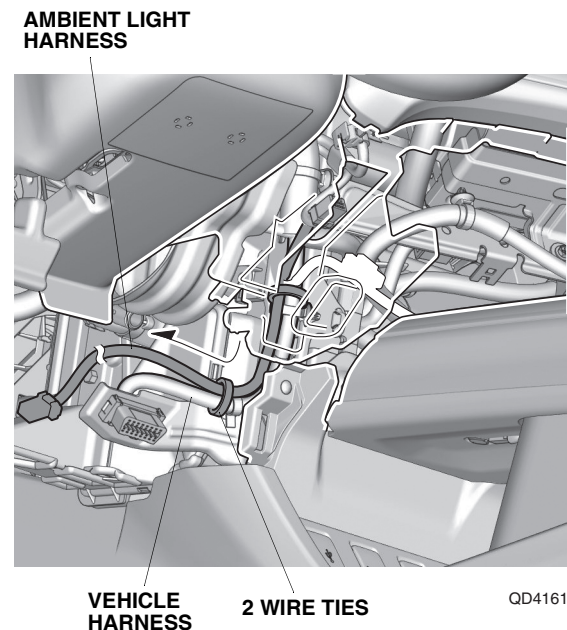

QD41610AJ

24. Secure the ambient light harness to the vehicle harness with two wire ties.

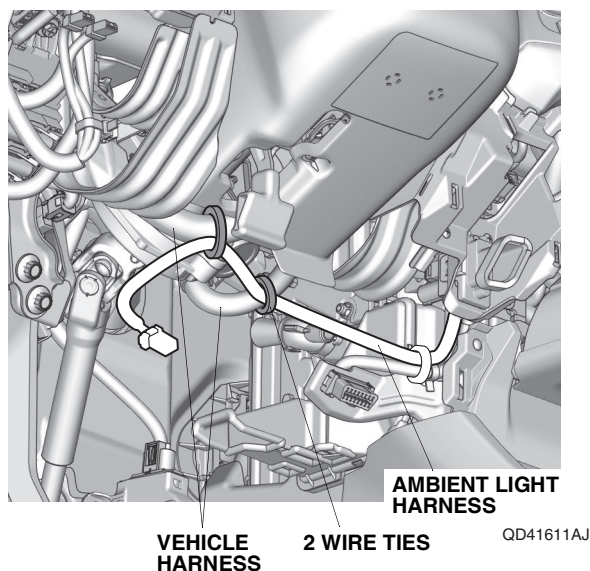

25. Install the climate control unit or heater control panel and glove box.
 26. Install the bracket to the driver's dashboard lower cover with one self-tapping screw.

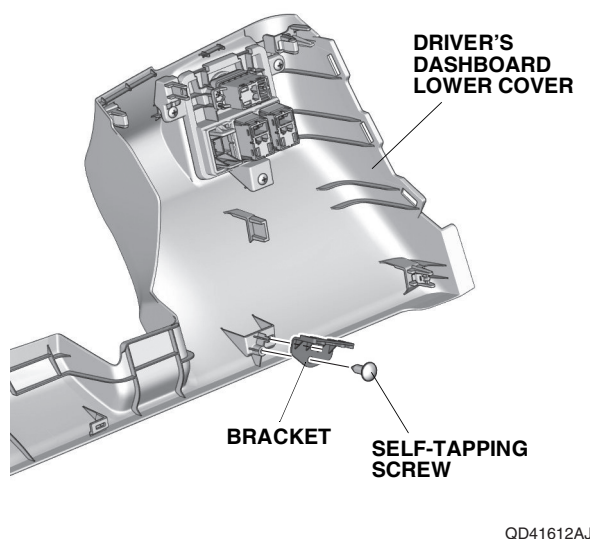

27. Install the ambient light to the bracket with one self-tapping screw.

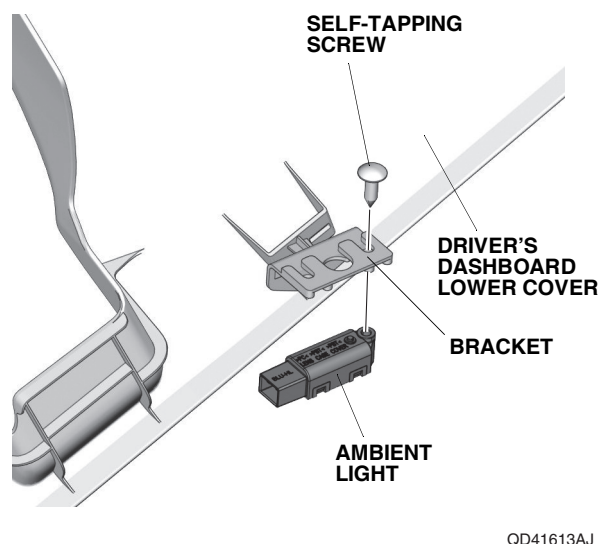

28. Plug the ambient light harness 4-pin connector into the ambient light, and install the driver's dashboard lower cover.

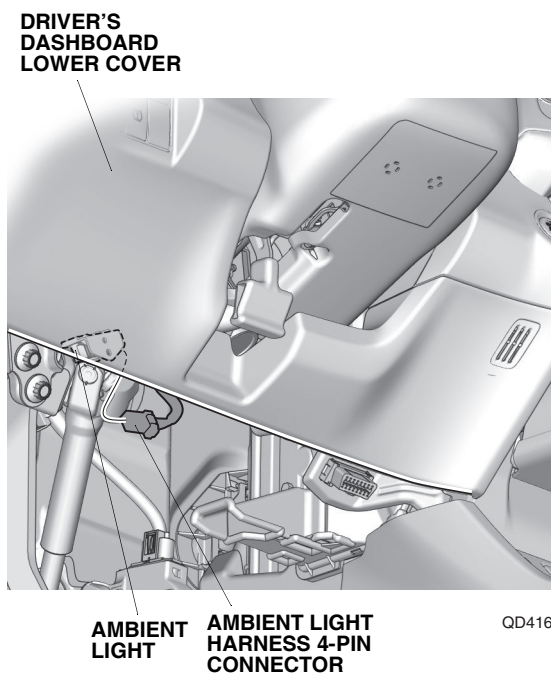

29. Install the ambient light to the passenger's under cover with one self-tapping screw.

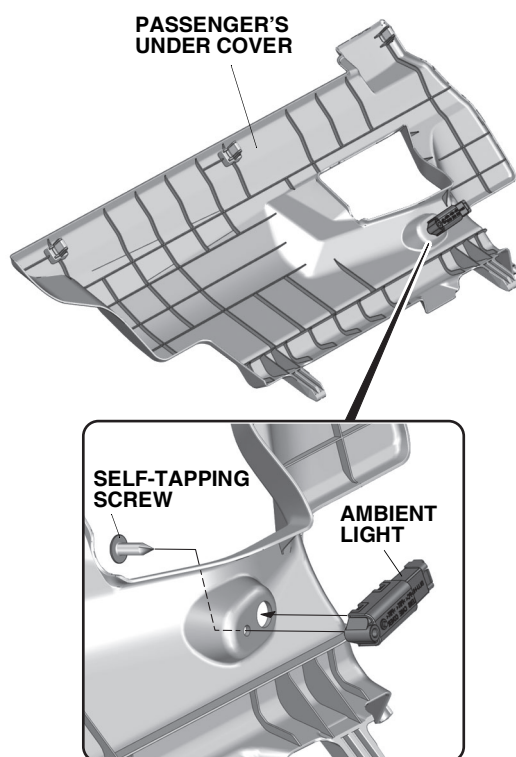

QD41615AJ

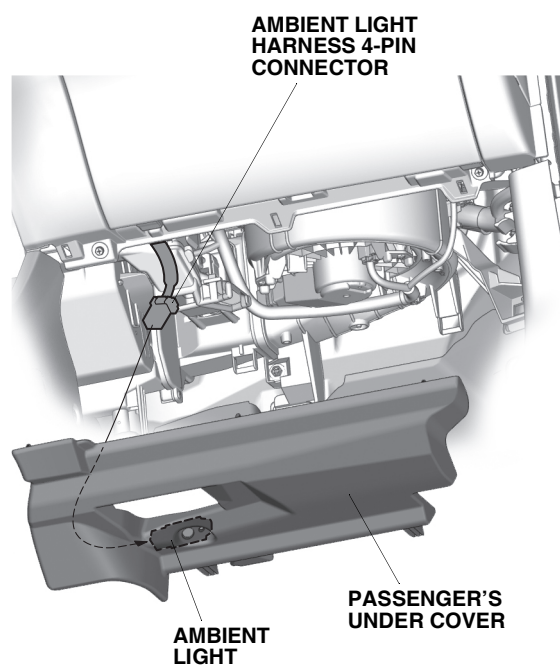

30. Plug the ambient light harness 4-pin connector into the ambient light, and install the passenger's under cover.



QD41616AJ

31. Check that all wire harnesses are routed properly and all connectors are plugged in.
32. Install all removed parts.
33. Connect the negative cable to the battery.
34. Turn the engine switch to ON; the SRS indicator should come on for about 6 seconds and then go off.
35. Press and hold the audio unit power button for 2 seconds to restore the audio and navi (if equipped) system functions.
36. Set the clock on vehicles without navigation.
37. If necessary, restore the systems back to normal operation as described in the service information.

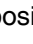
Check the Operation of the Ambient Light

38. Set the light switch set to the  or  position, make sure the ambient lights are on.
39. Set the headlight switch to the AUTO position, and make sure the ambient lights are on with the parking lights or headlights.
40. Check that the interior illumination brightness varies along with the instrument panel brightness by turning the brightness control knob.
41. If the ambient lights do not come on, check the fuse and all the connectors.

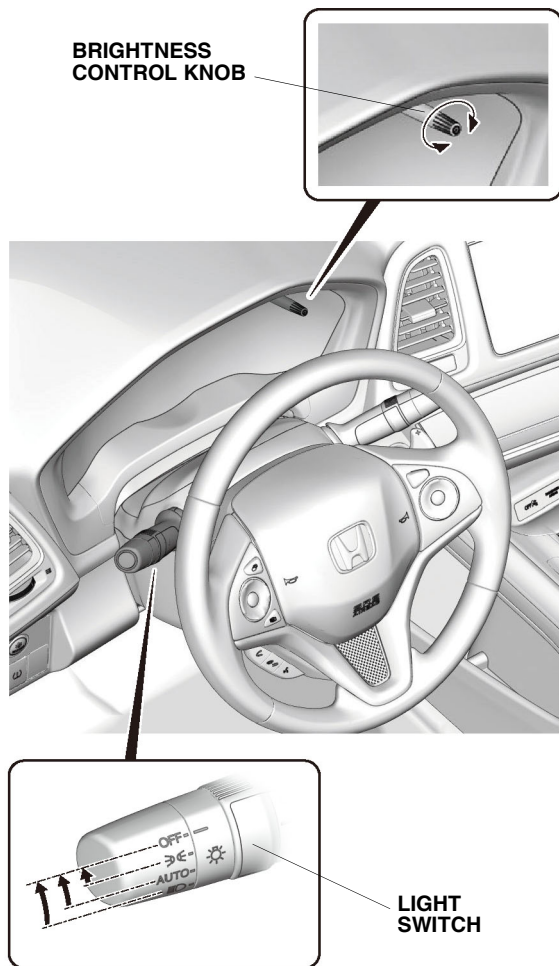

QH42302AA