



## HONDA INSTALLATION INSTRUCTIONS

### Accessory

CONSOLE LIGHTS  
P/N 08E16-T7A-100

### Application

2021 HR-V

### Publications No.

VERSION 1

### Issue Date

SEP 2020

### PARTS LIST

Left light



Right light



Console light harness

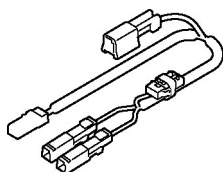

4 Wire ties

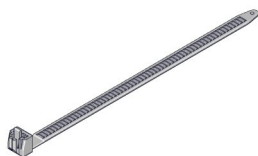

2 Wire ties with clip



2 Washers (small)

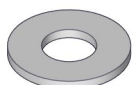

4 Washers (large)

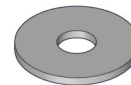

6 Self-tapping screws



Urethane tape

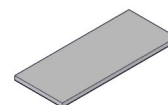

Fuse label

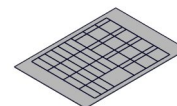

Template  
(May not be used)

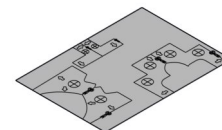

## TOOLS AND SUPPLIES REQUIRED

Phillips screwdriver

Ratchet

10 mm Socket

Isopropyl alcohol

Shop towel

Pushpin

Diagonal cutters

Masking tape

File

10 mm Open end wrench

Drill

3 mm, 6 mm, 8 mm, and 10 mm Drill bits

Eye protection (face shield, safety goggles, etc.)

Scissors

*The following tools are available through the Honda Tool and Equipment Program. On the iN, click on Service > Service Bay > Tool and Equipment Program, then enter the number under "Search." Or, call 888-424-6857.*

- Trim Tool Set (T/N SOJATP2014)
- Plastic Trim Tool (T/N SILTRIMTL10)

### Illustration of the Console Lights in the Vehicle

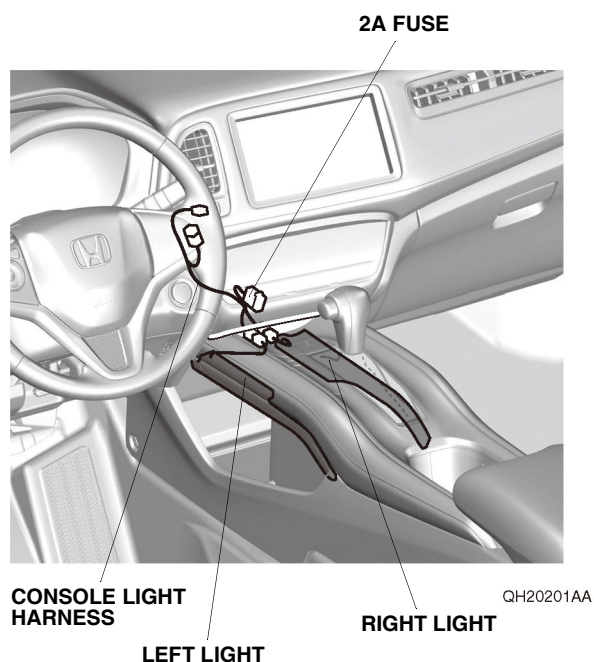

## INSTALLATION

**Customer Information:** The information in this installation instruction is intended for use only by skilled technicians who have the proper tools, equipment, and training to correctly and safely add equipment to your vehicle. These procedures should not be attempted by "do-it-yourselfers."

1. Disconnect the negative cable from the battery.
2. Remove the passenger's under cover.

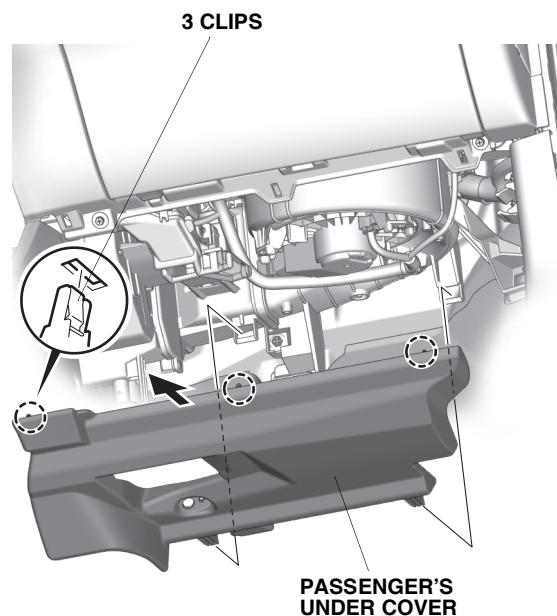

QD40852AH

3. Pull away the door opening seal, and remove the passenger's dashboard side lid.

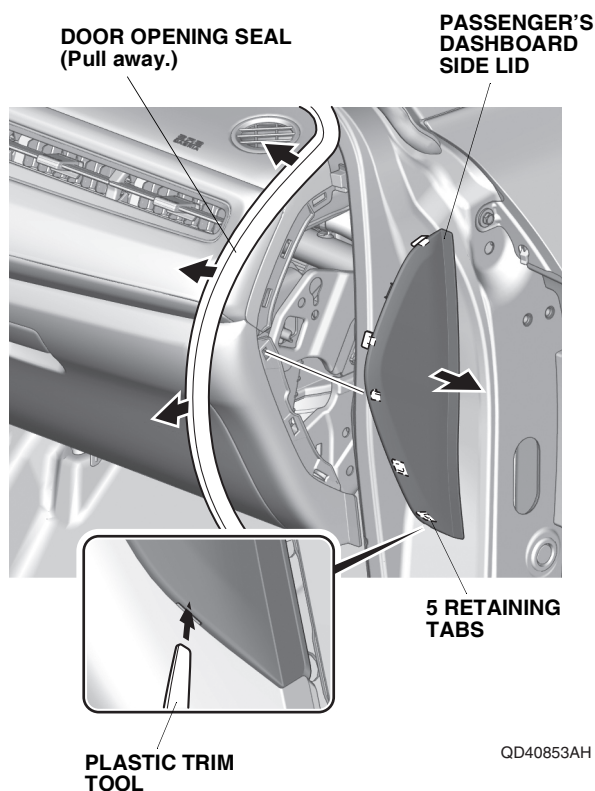

4. Remove the two bolts.

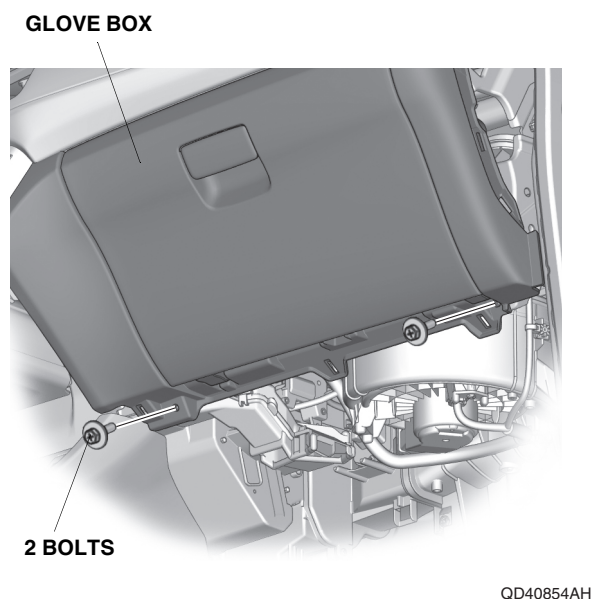

5. Pull away the door opening seal. Open the glove box, and remove it.

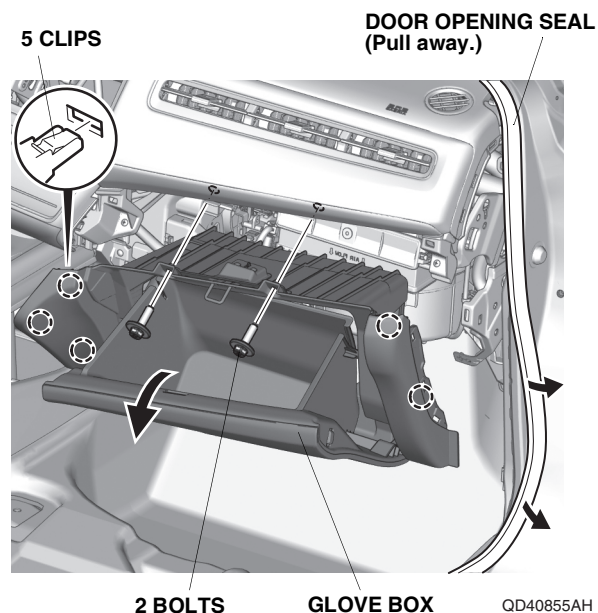

6. Pull away the door opening seal, and remove the driver's dashboard side lid.

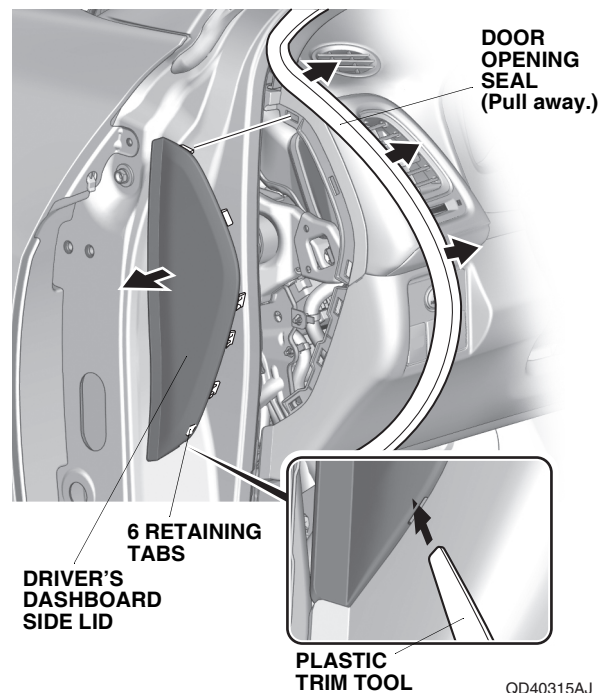

7. Apply masking tape to the lower column cover.

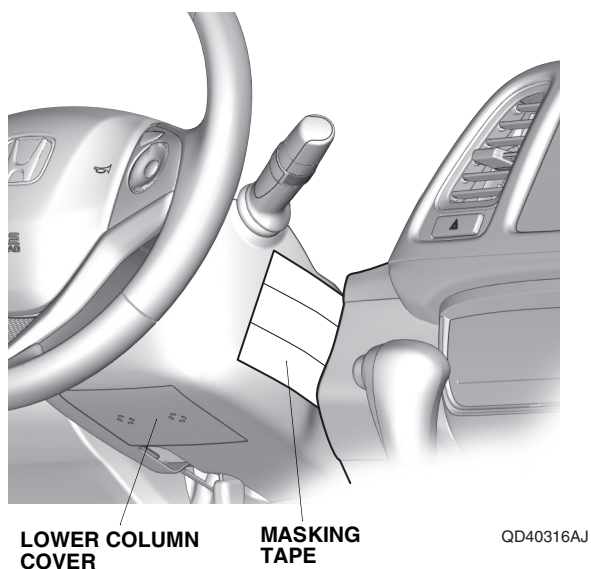

8. Pull away the door opening seal. Remove the driver's dashboard lower cover, and unplug the vehicle connectors.

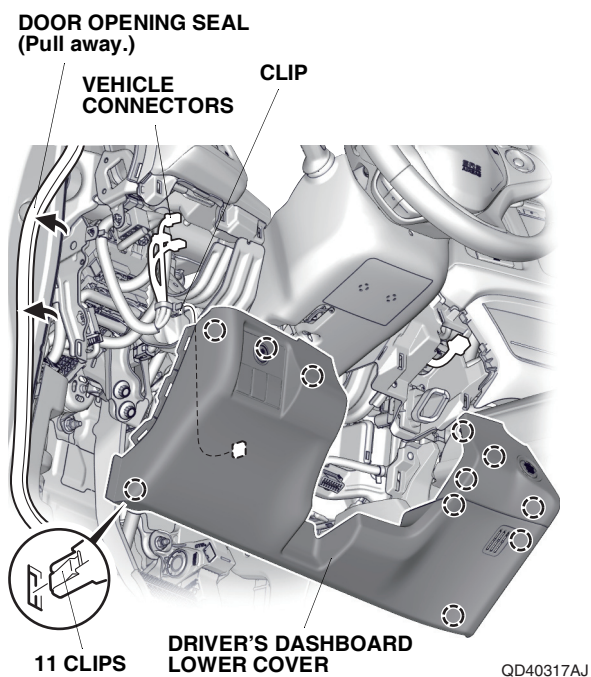

If the vehicle is equipped with automatic climate control, continue with step 9; otherwise, go to step 12.

## With automatic climate control

9. Apply masking tape to the climate control unit, center console panel, center console pad, and shift lever as shown. Move the shift lever to Drive.

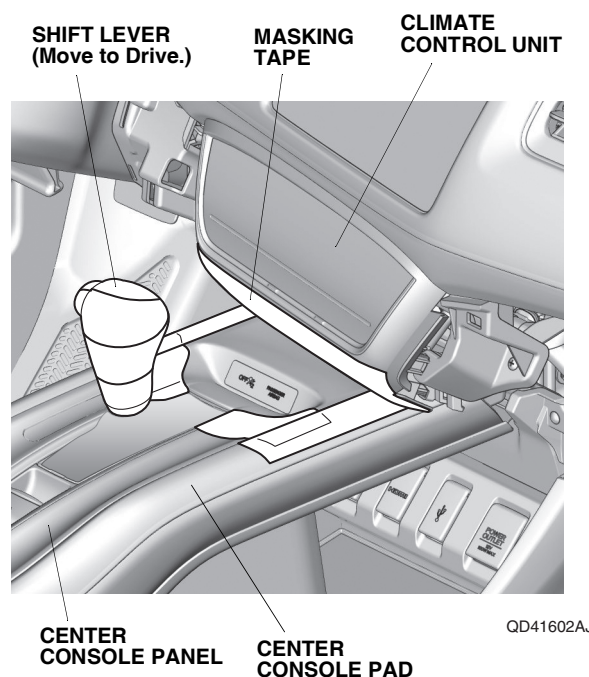

10. Remove the center console switch trim, and unplug the vehicle connector.

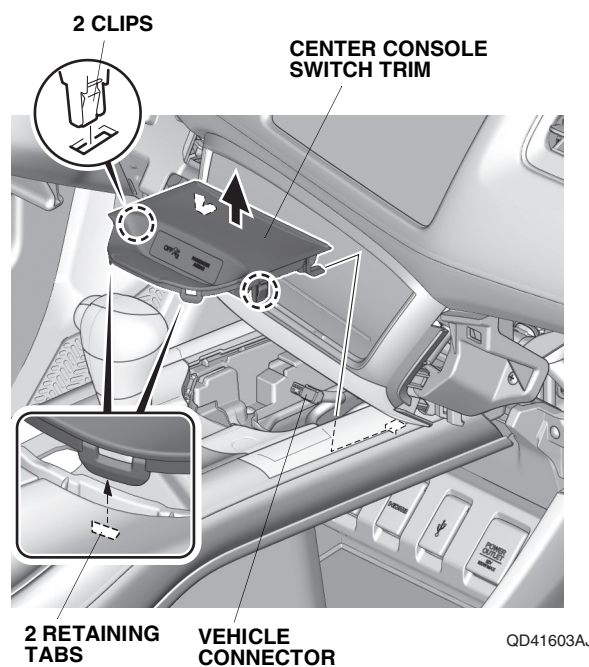



11. Remove the climate control unit, and unplug the vehicle connectors. Go to step 17.

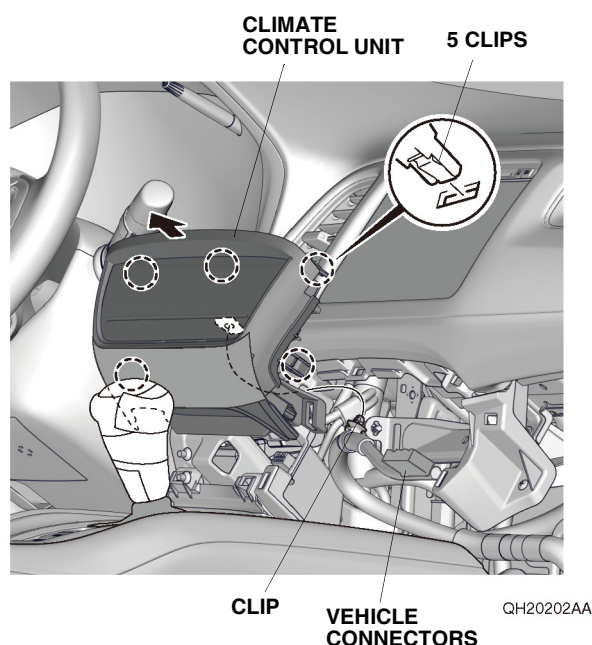

## With manual climate control

12. Apply masking tape to the heater control panel, center console panel, center console pad, and shift lever as shown. Move the shift lever to Drive.

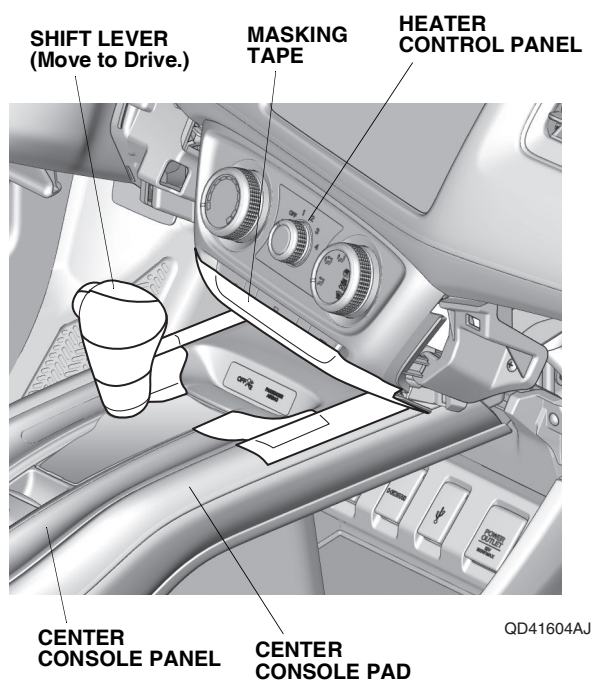

13. Remove the center console switch trim, and unplug the vehicle connector.

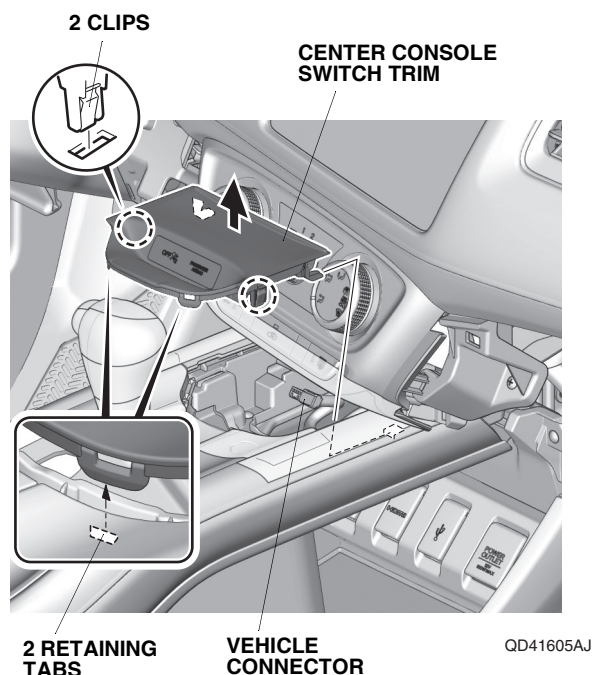

14. Set the mode control dial and the temperature control dial as shown.

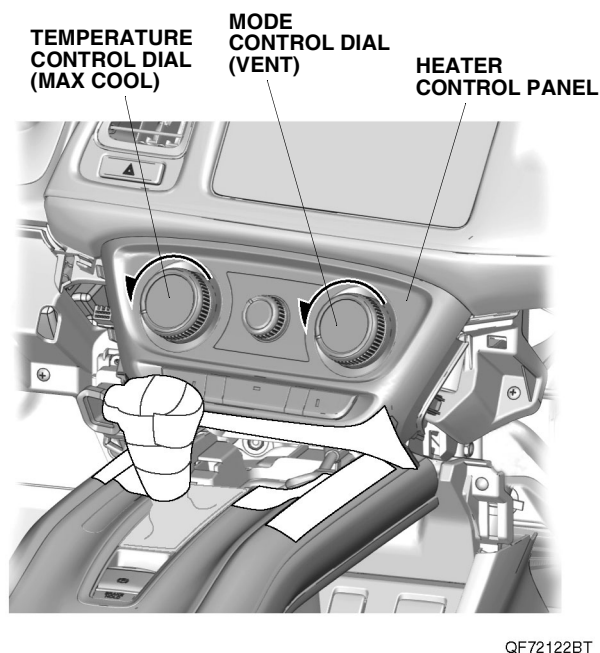

15. Remove the mode control cable and air mix control cable:
- Remove the control cable from the clamp and the groove.
  - Remove the inner cable from the control linkage.

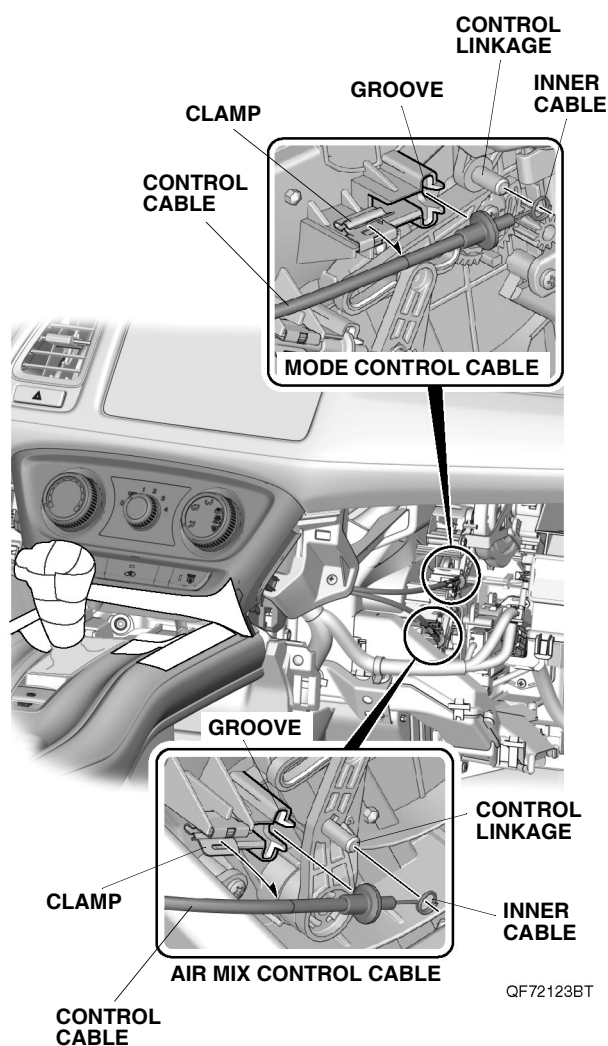

16. Remove the heater control panel, and unplug the vehicle connectors.

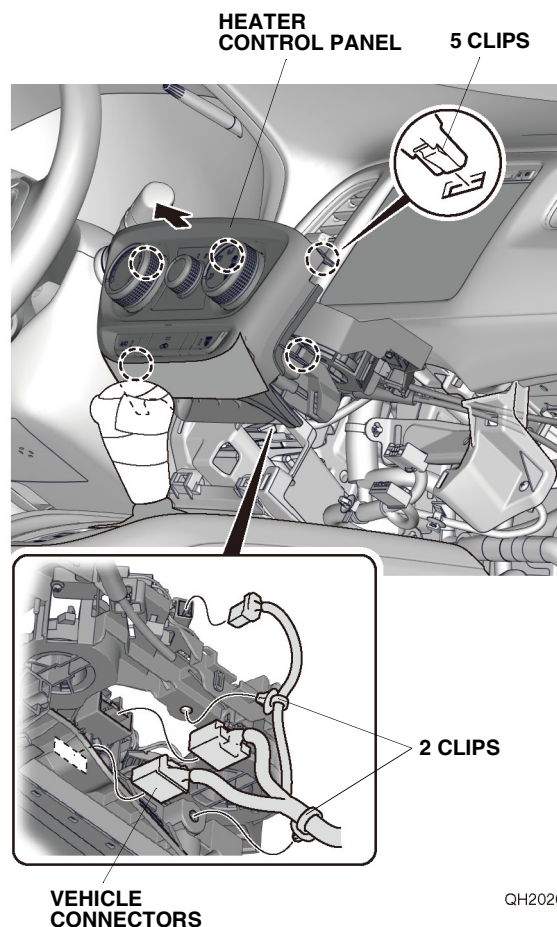

17. Open the console box.

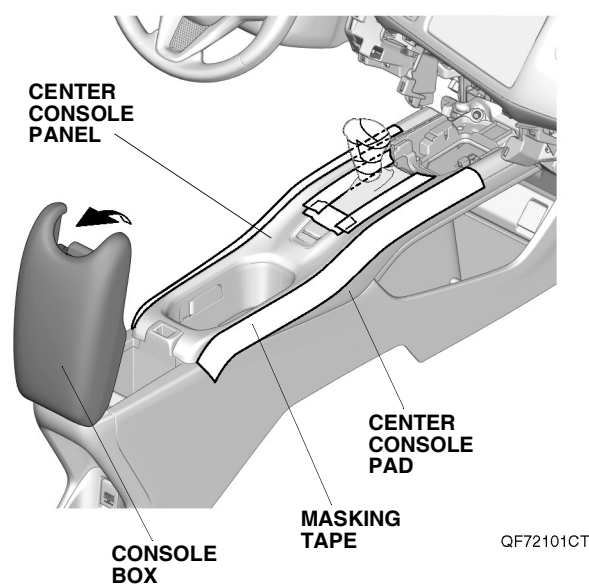

18. Apply masking tape to the center console panel and center console pad as shown.

19. Release the center console panel, and unplug the vehicle connectors.

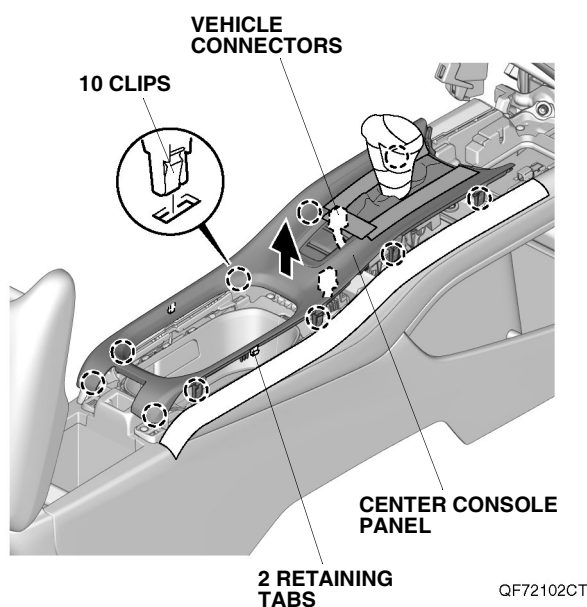

20. Release the shift lever boots, and remove the center console panel.

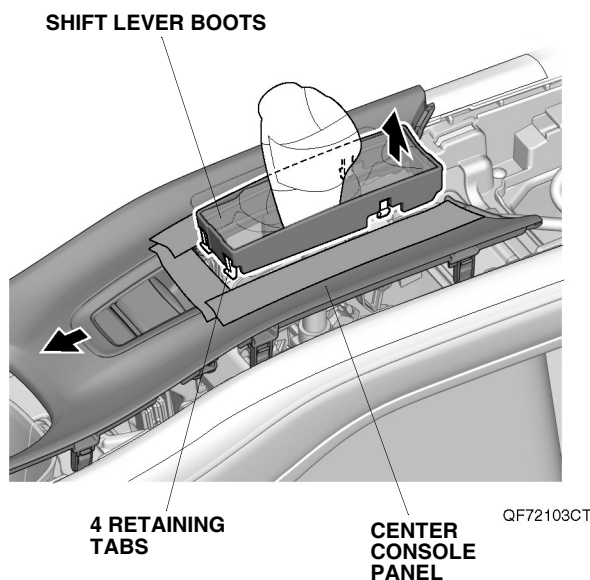

21. Remove the center console pad, and unplug the vehicle connector (if equipped).

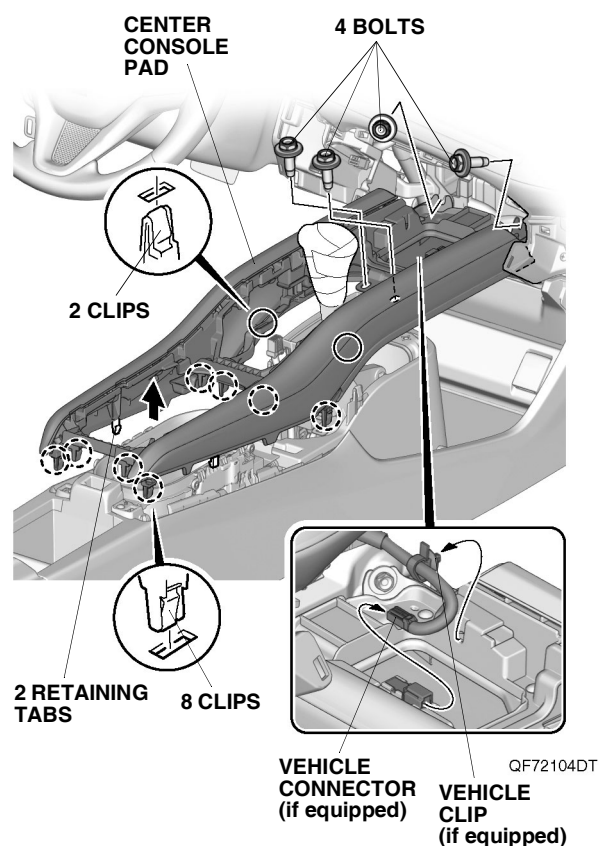

22. Remove the lower panel.

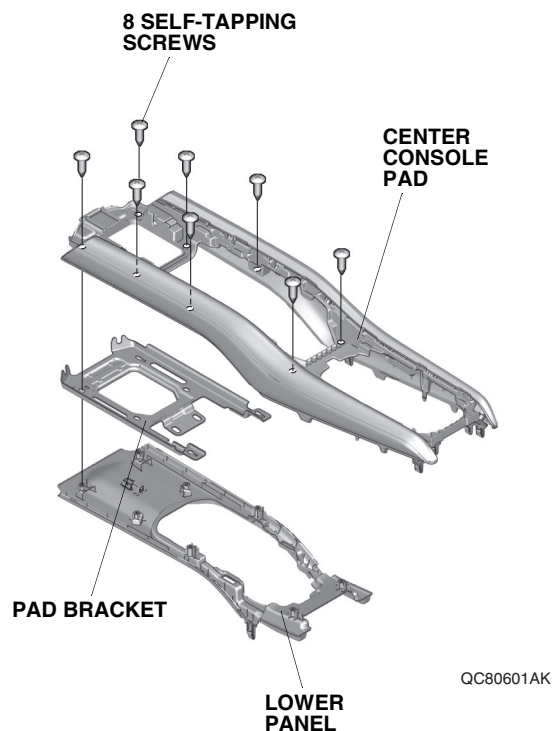



23. Check for eight scribe marks on the lower panel.

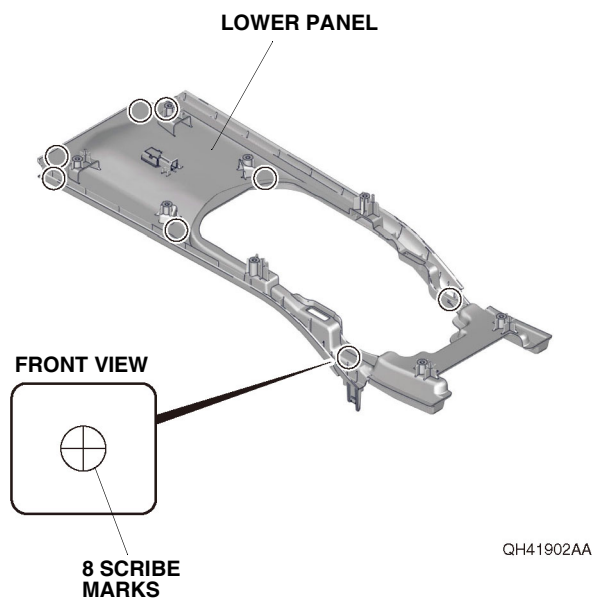

If the vehicle is equipped with eight scribe marks, go to step 28; otherwise, continue with step 24.

## Without eight scribe marks

24. Using scissors, cut out the template.

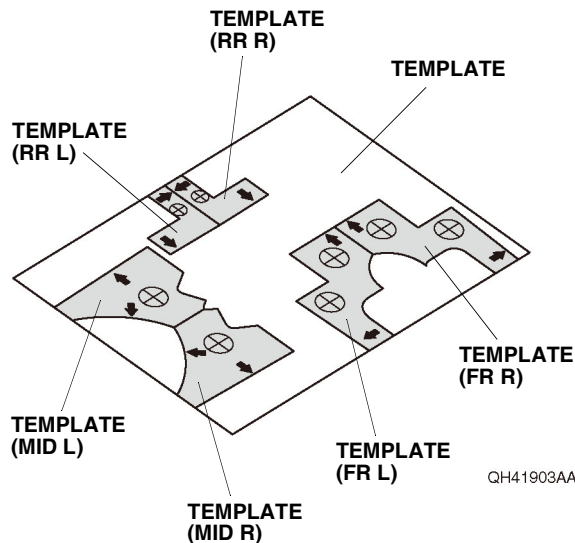

25. Place the four templates on the lower panel as shown. Secure the four templates to the lower panel with masking tape.

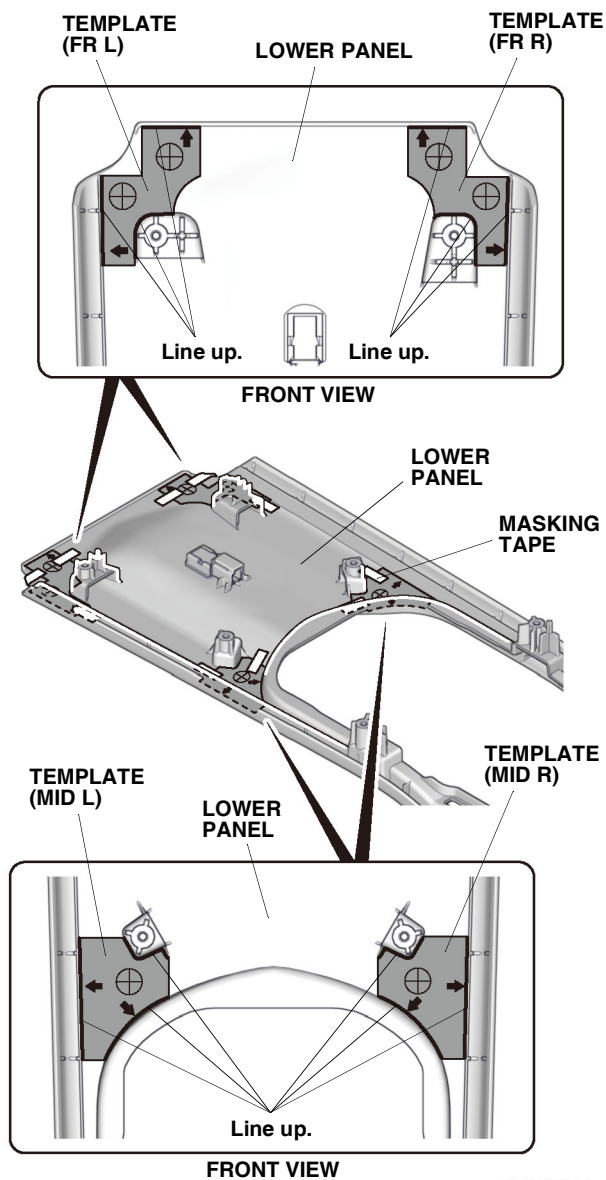



26. Place the two templates on the lower panel as shown. Secure the two templates to the lower panel with masking tape.

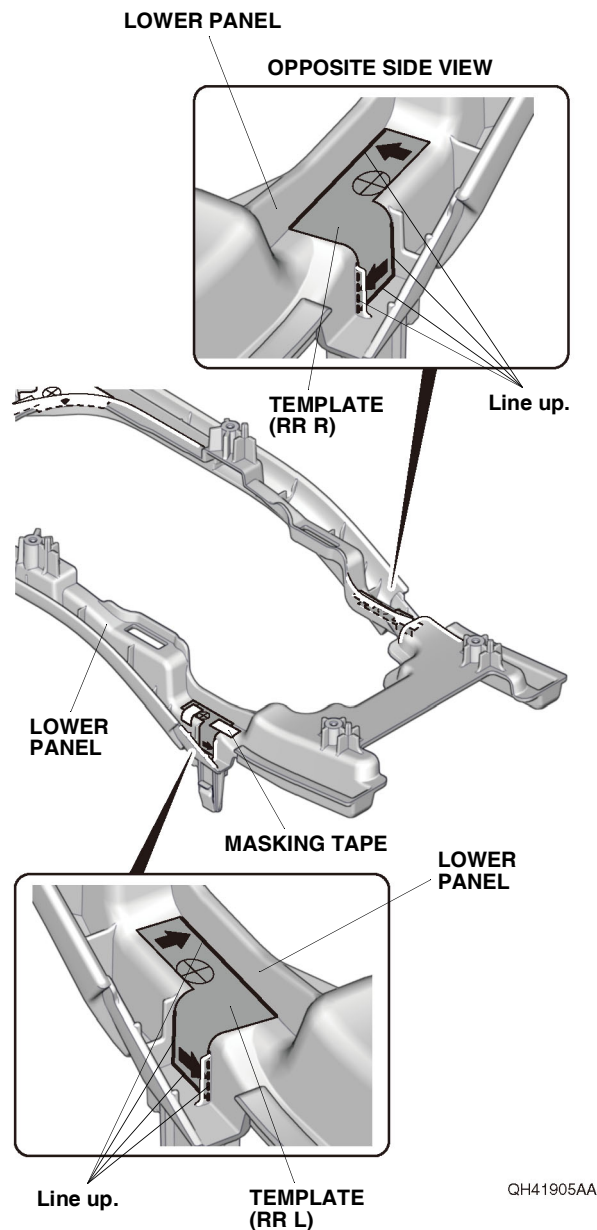

27. Using a pushpin, pierce the lower panel as shown. Remove the six templates. Go to step 29.  
NOTE: Make sure to pierce the printed marks perpendicular to the lower panel.

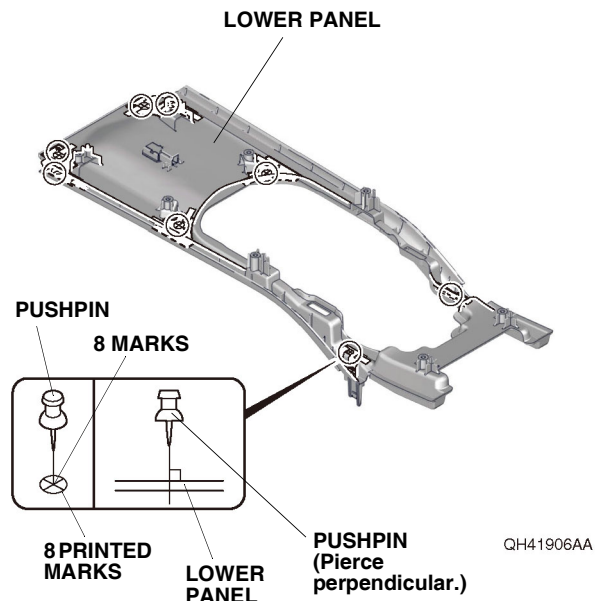

## With eight scribe marks

28. Using a pushpin, pierce the lower panel as shown. NOTE: Make sure to pierce the scribe marks perpendicular to the lower panel.

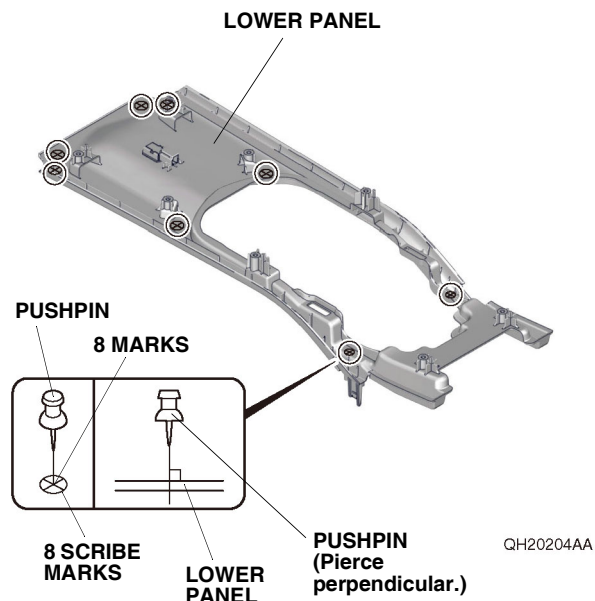

29. While wearing eye protection, drill the eight pierced marks on the lower panel to 6 mm. First, drill with a 3 mm drill bit, then finish with a 6 mm drill bit.  
NOTE: Make sure to drill perpendicular to the lower panel.

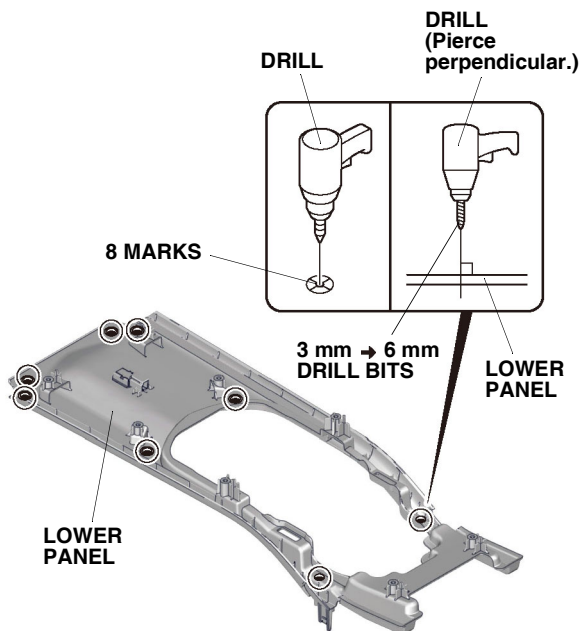

30. While wearing eye protection, drill the six holes on the lower panel to 10 mm as shown. First, drill with an 8 mm drill bit, then finish with an 10 mm drill bit. Remove any burrs.  
NOTE: Make sure to drill perpendicular to the lower panel.

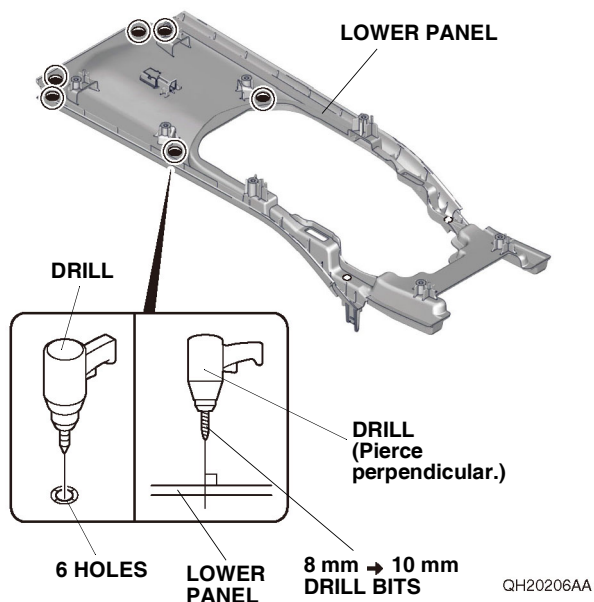

31. Install the left and right light, to the lower panel as shown.

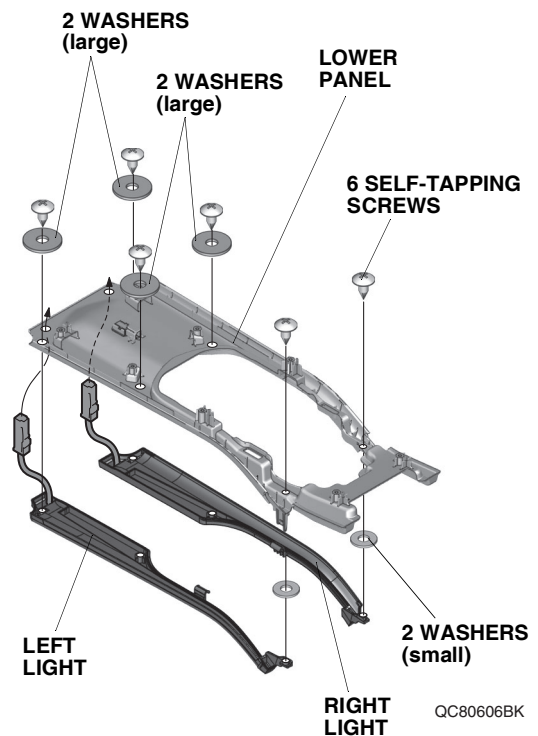

32. Install the lower panel, pad bracket, and center console pad.

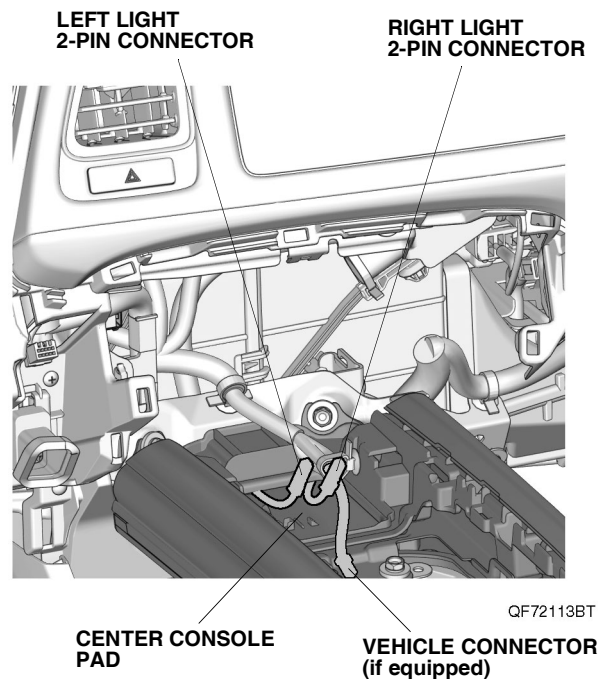

33. Using isopropyl alcohol on a shop towel, thoroughly clean the fuse case where fuse label will attach. Attach fuse label (2A OPTION FUSE) to the fuse case on the console light harness.

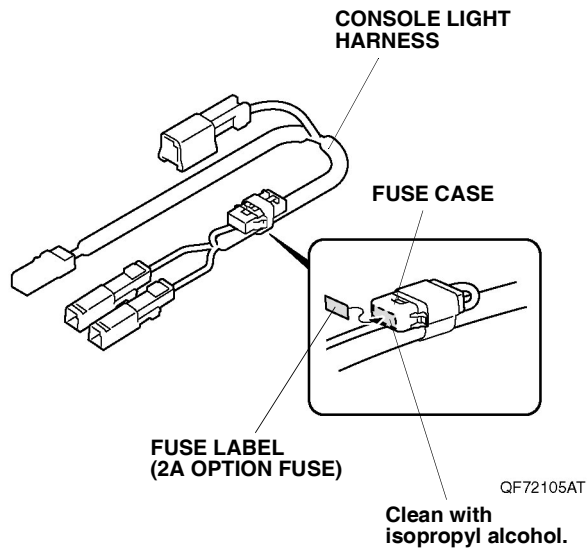

34. Attach the urethane tape to the console light harness 2-pin connectors as shown.

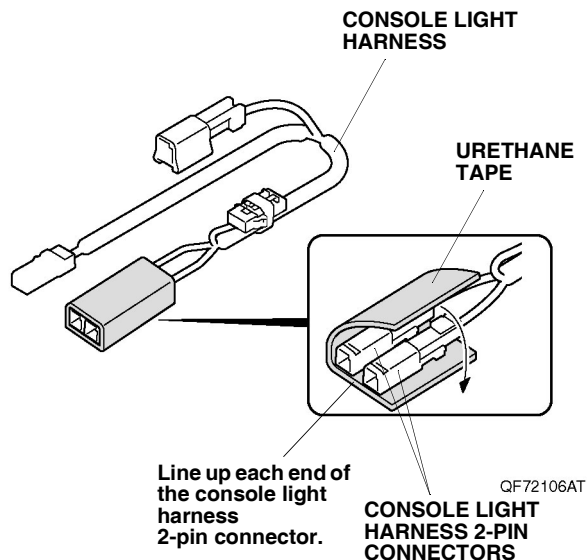

35. Plug the left light 2-pin connector and right light 2-pin connector into the console light harness 2-pin connectors.

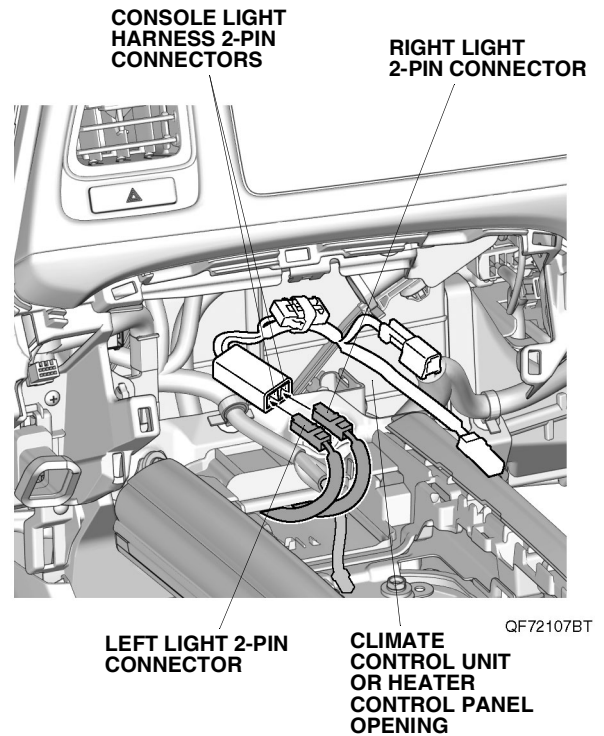

36. Unplug the 4-pin connector from the hazard warning switch, and plug it into the console light harness 4-pin connector. Plug the console light harness 4-pin connector into the hazard warning switch.

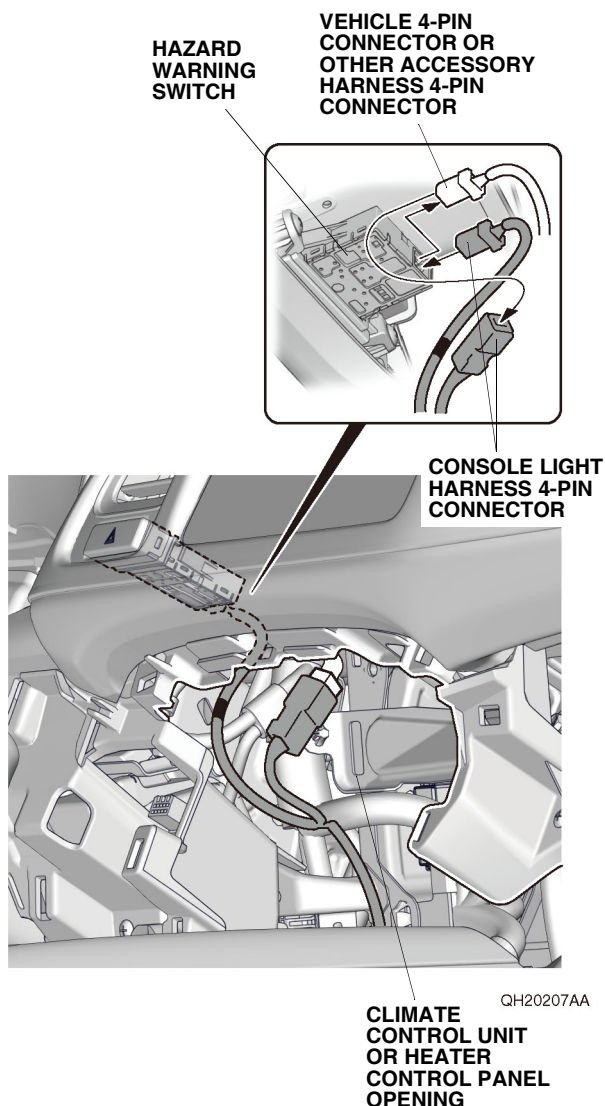

37. Line up the green tape on the console light harness with the vehicle clip, and secure the console light harness to the vehicle harness with one wire tie.

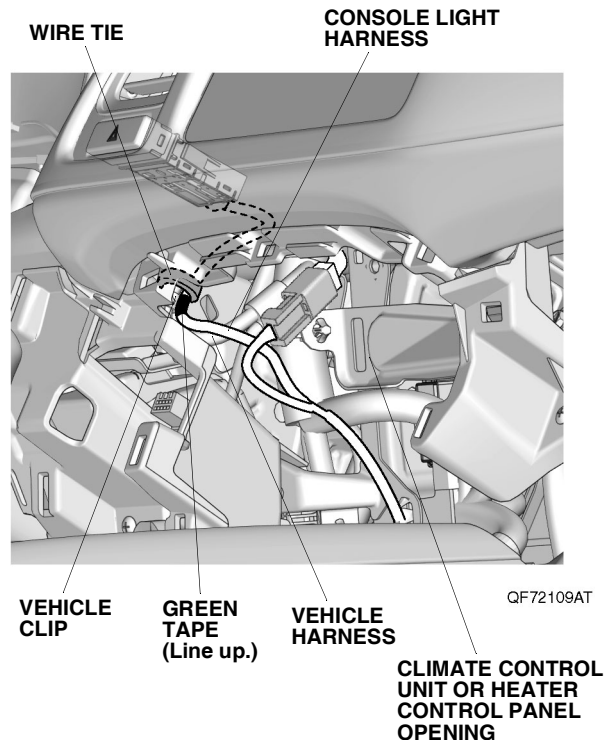

38. Secure the console light harness and 4-pin connectors to the vehicle harness with two wire ties.

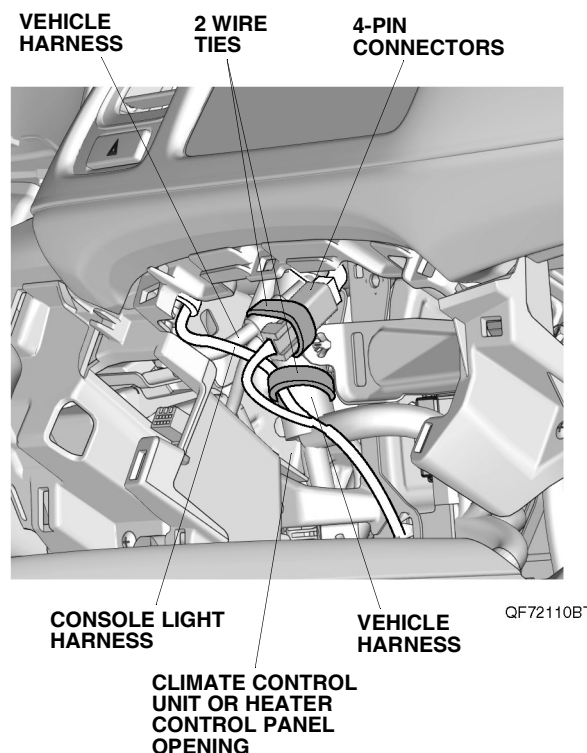



39. Secure the 2-pin connectors to the center console pad with one wire tie with clip as shown. If the vehicle already has a harness there, cut the clip portion off the wire tie and secure the 2-pin connector to the other harness as shown.

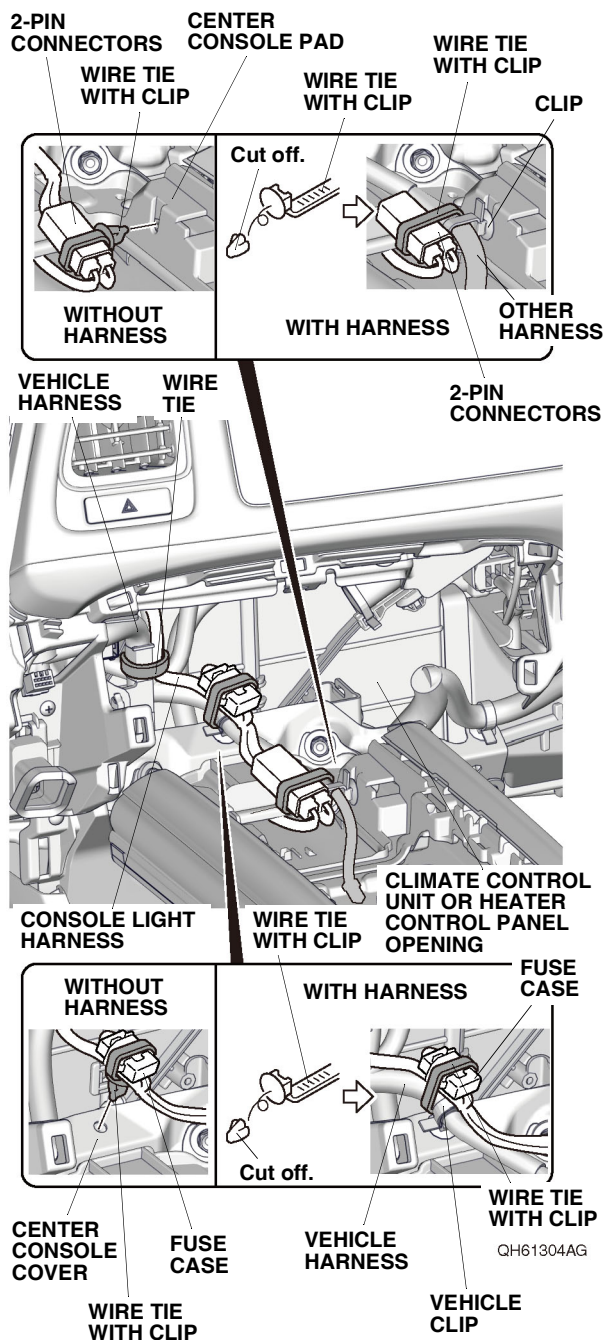

40. Secure the fuse case to the center console cover with one wire tie with clip as shown. If the vehicle already has a harness there, cut the clip portion off the wire tie and secure the fuse case to the vehicle harness as shown.
41. Secure the console light harness to the vehicle harness with one wire tie.

42. Check that all wire harnesses are routed properly and all connectors are plugged in.
43. Install all removed parts.
44. Connect the negative cable to the battery.
45. Press and hold the audio unit power button for 2 seconds to restore the audio and navi (if equipped) system functions.
46. Set the clock on vehicles without navigation.
47. If necessary, restore the systems back to normal operation as described in the service information.

## Check the Operation of the Console Lights

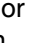
48. With the light switch set to the  or  position, make sure the console lights are on.
49. When the headlight switch is in the AUTO position, make sure the left and right console lights are on with the parking lights or headlights.
50. Check that the console lights brightness varies along with the instrument panel brightness by turning the brightness control knob.
51. If the left and right console lights do not come on, check the fuse and all of the connectors.

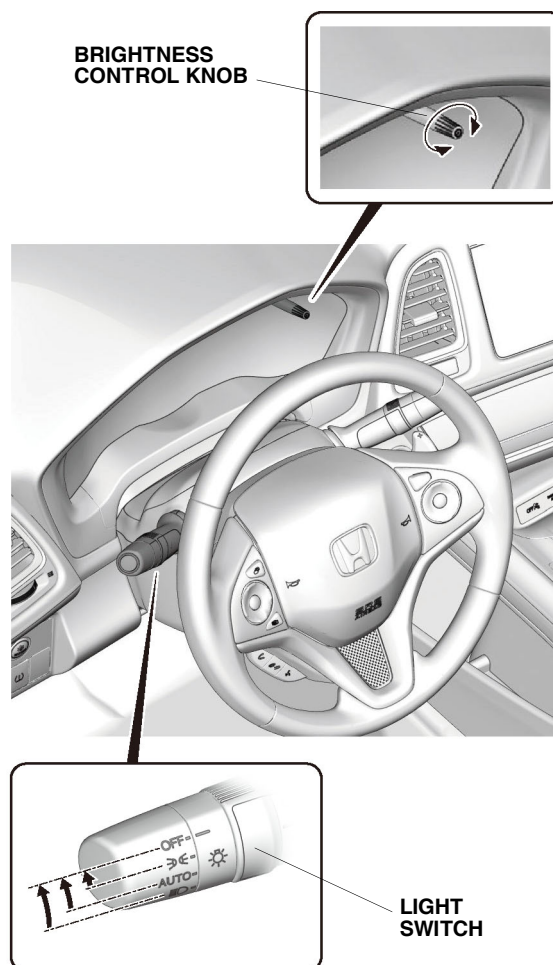

QH42302AA