



INSTALLATION INSTRUCTIONS

Accessory
SPORT PEDALS

Application
2019 FIT

Publications No.
VERSION 1
Issue Date
APR 2018

PARTS LIST

Sport Pedal Kit (CVT models)
P/N 08U74-T5A-100

Accelerator pedal cover



Brake pedal pad cover



Brake pedal pad



3 Rivets A (without groove)



2 Rivets B (with groove)



Sport Pedal Kit (M/T models)
P/N 08U74-T5A-100A

Accelerator pedal cover



2 Pedal pad covers



2 Pedal pads



3 Rivets A (without groove)



6 Rivets B (with groove)



TOOLS AND SUPPLIES REQUIRED

Drill
2 mm and 3.5 mm Drill bits
Eye protection (face shield, safety goggles, etc.)
File
Pushpin
3.5 mm Hand riveter
Masking tape
Ruler
White marker
Center punch

Illustration of the Sport Pedals Installed in the Vehicle

CVT models

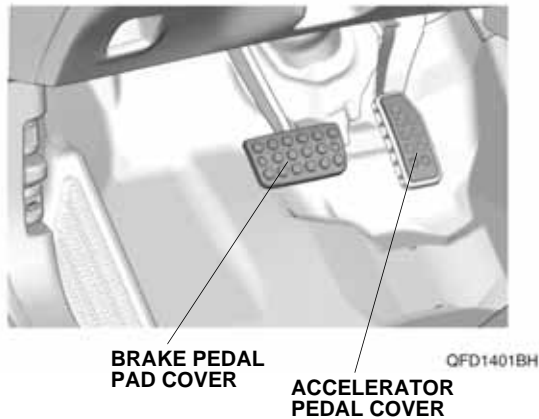

M/T models

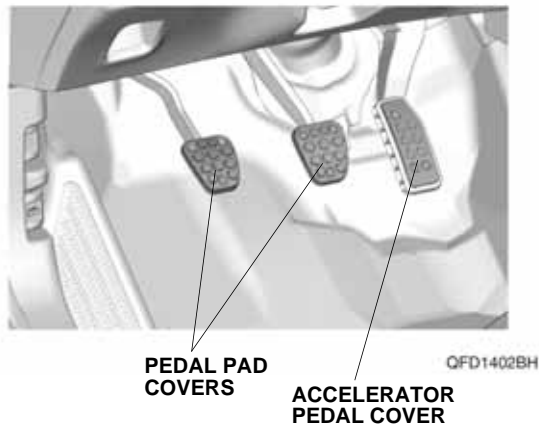

INSTALLATION

Customer Information: The information in this installation instruction is intended for use only by skilled technicians who have the proper tools, equipment, and training to correctly and safely add equipment to your vehicle. These procedures should not be attempted by “do-it-yourselfers.”

Installing the Sport Pedals

1. Set the accelerator pedal cover as shown.

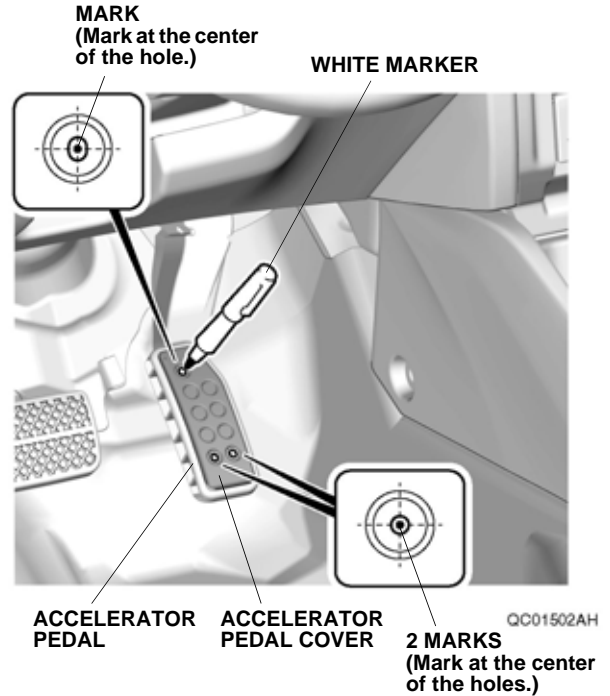

2. Using a white marker, mark the accelerator pedal as shown.

3. Remove the accelerator pedal cover. Using a pushpin, pierce the accelerator pedal as shown.

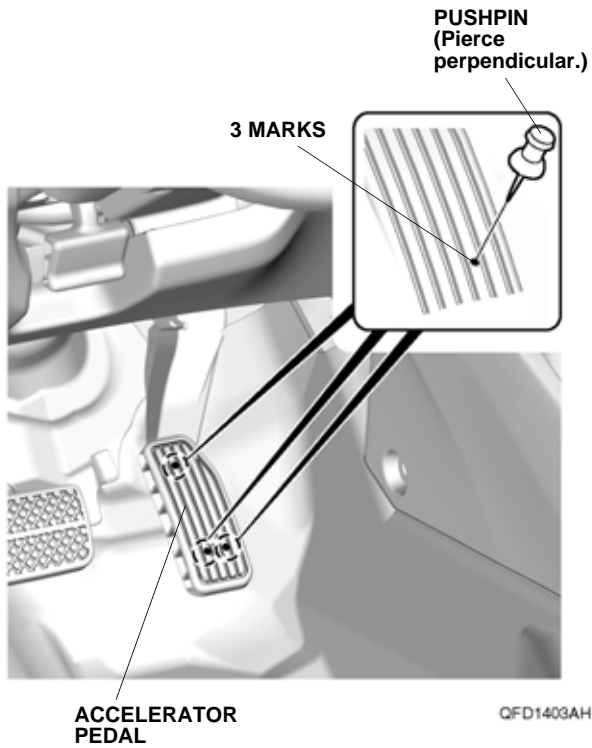

4. While wearing eye protection, drill the accelerator pedal at the three pierced marks using a 2 mm drill bit first, then finish using a 3.5 mm drill bit.

NOTE:

- Wrap masking tape around each drill bit 7 mm (0.28 in.) away from the tip, or use a drill stop.
- Hold the accelerator pedal firmly with your hand while drilling the hole.
- Make sure to drill perpendicular to the accelerator pedal. Remove any burrs.

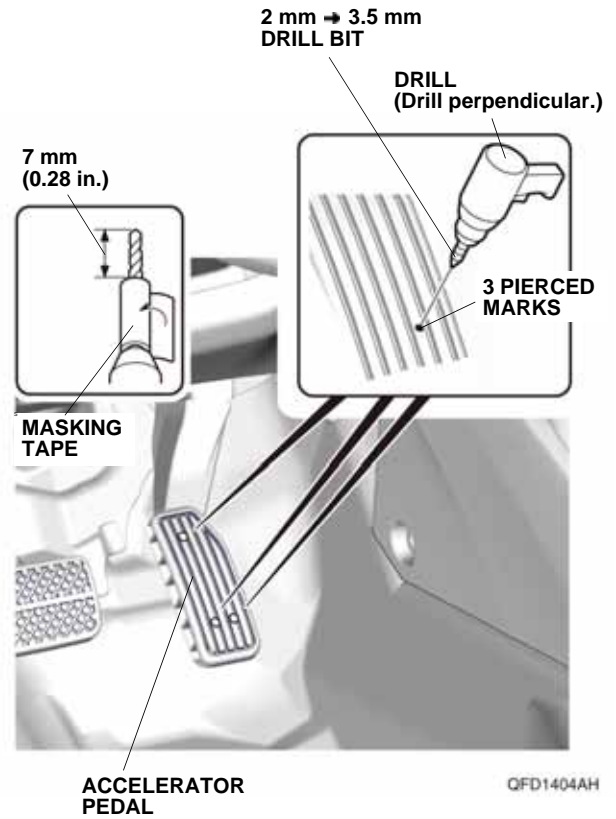

5. Using the hand riveter, secure the accelerator pedal cover to the accelerator pedal with three rivets A as shown.

NOTE:

- Make sure you use the correct rivet before proceeding with the installation.
- Make sure the rivets are attached.

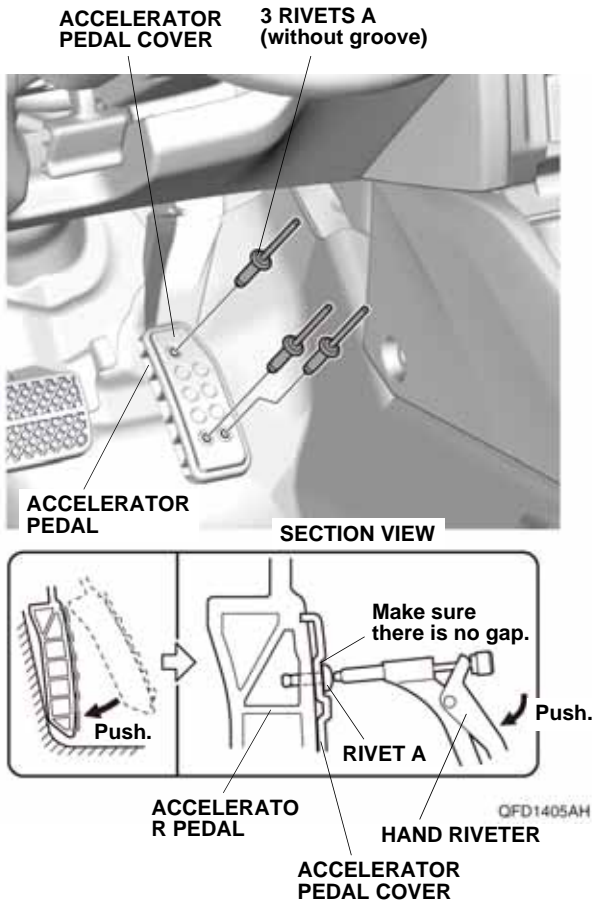

If the vehicle is a CVT, continue with step 6. If the vehicle is a M/T, go to step 14.

CVT models

6. Remove the brake pedal pad from the brake pedal.

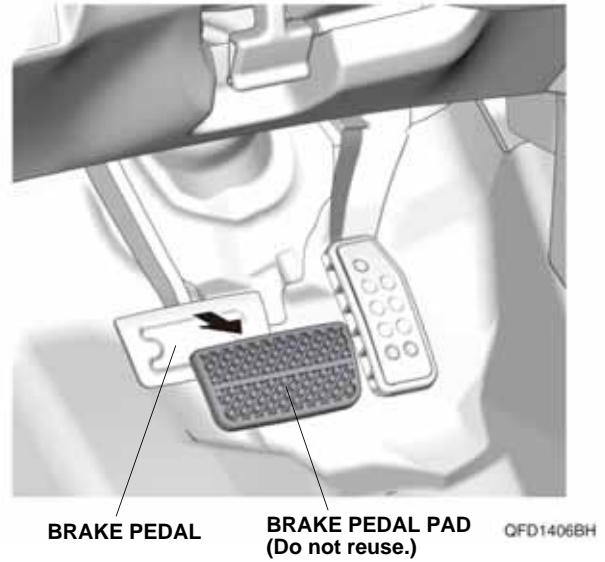

7. Install the new brake pedal pad onto the brake pedal.
NOTE: Make sure the brake pedal pad is properly installed on the brake pedal.

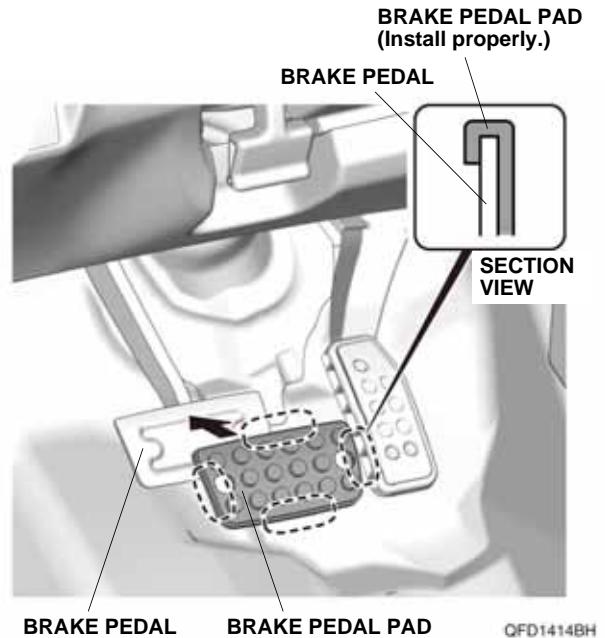

8. Using a white marker, mark the brake pedal as shown.

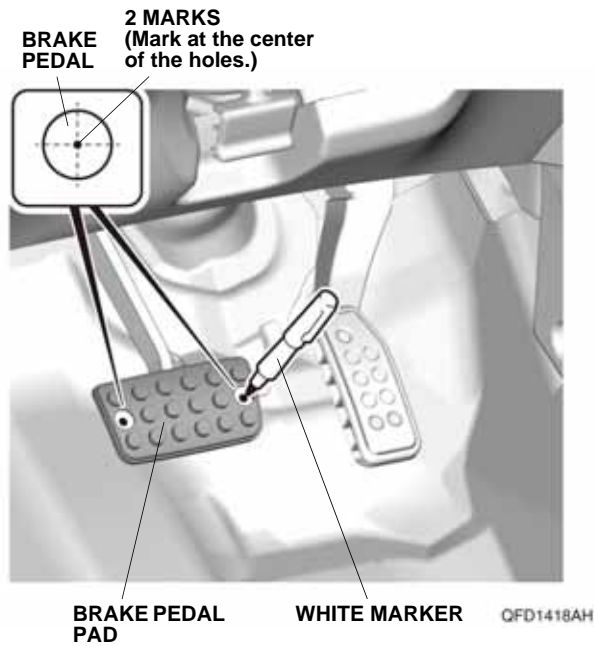

9. Remove the brake pedal pad. Using a center punch, punch the centers of the two marks. If using an automatic center punch, set it to the minimum setting.

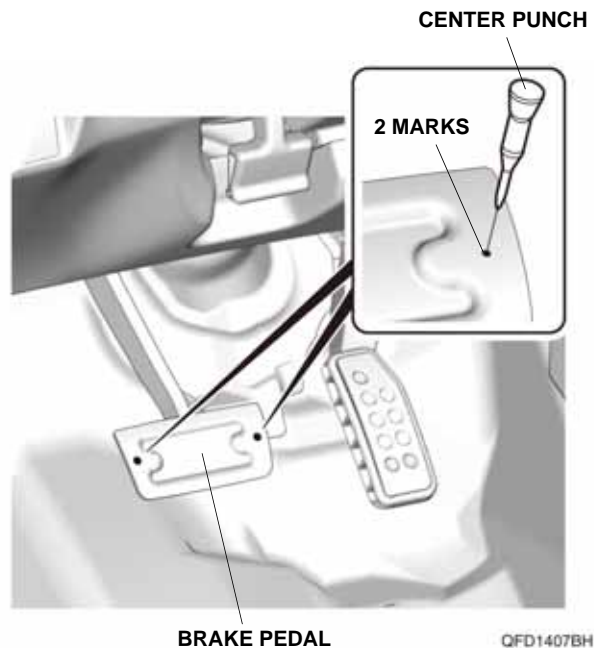

10. While wearing eye protection, drill the brake pedal at the two center-punched marks using a 2 mm drill bit first, then finish using a 3.5 mm drill bit.

NOTE:

- Wrap the masking tape around each drill bit 10 mm (0.39 in.) away from the tip, or use a drill stop.
- Hold the brake pedal firmly with your hand while drilling the hole.
- Make sure to drill perpendicular to the brake pedal. Remove any burrs.

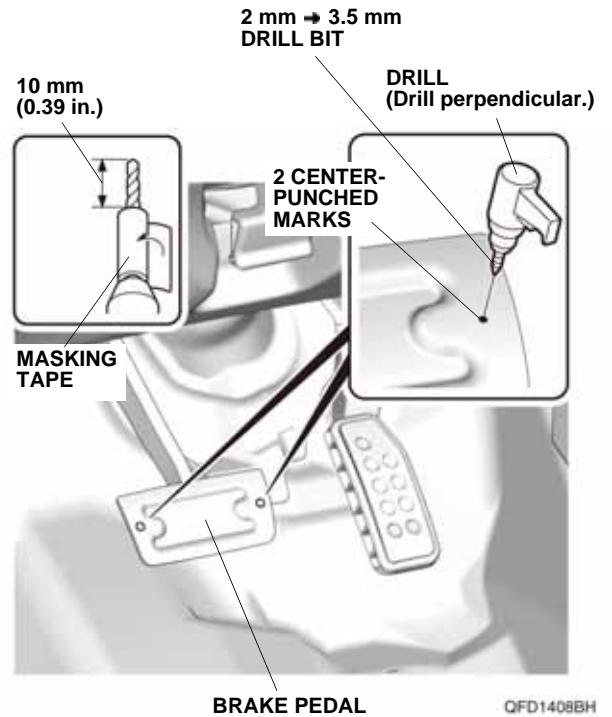

11. Install the new brake pedal pad onto the brake pedal.
NOTE: Make sure the brake pedal pad is properly installed on the brake pedal.

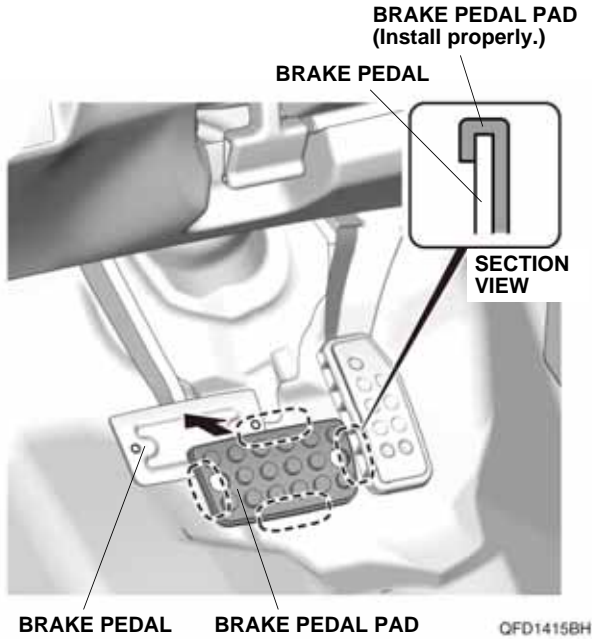

12. Loosely install the brake pedal pad cover on the brake pedal pad.

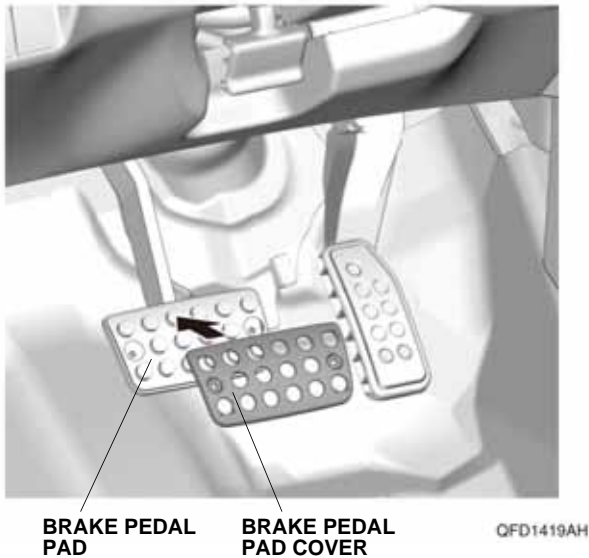

13. Using the hand riveter, install the brake pedal pad cover on the brake pedal with two rivets B as shown.
NOTE:

- Make sure you use the correct rivet before proceeding with the installation.
- Make sure the rivets are attached.

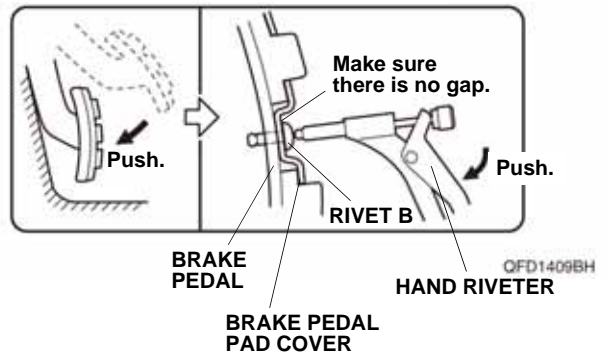
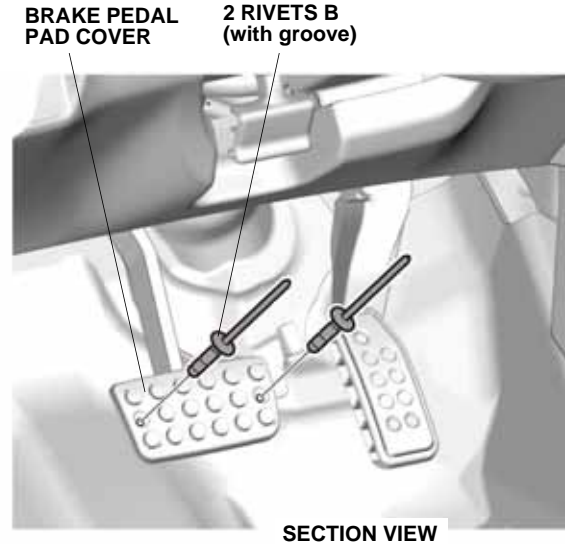

M/T models

14. Remove the brake pedal pad from the brake pedal.

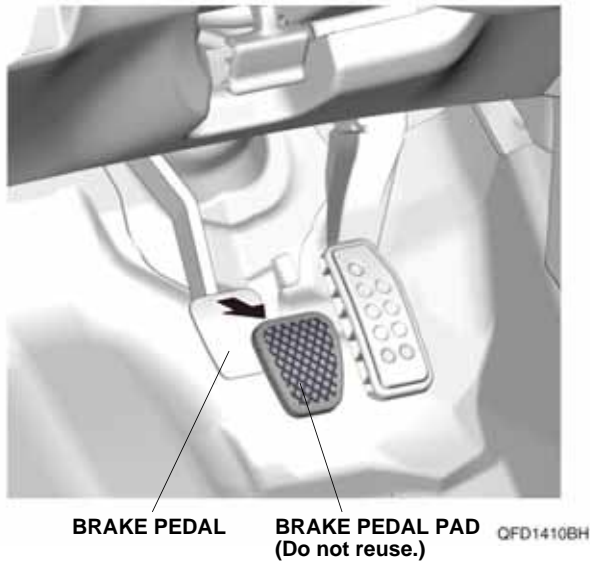

15. Install the pedal pad onto the brake pedal.
NOTE: Make sure the pedal pad is properly installed on the brake pedal.

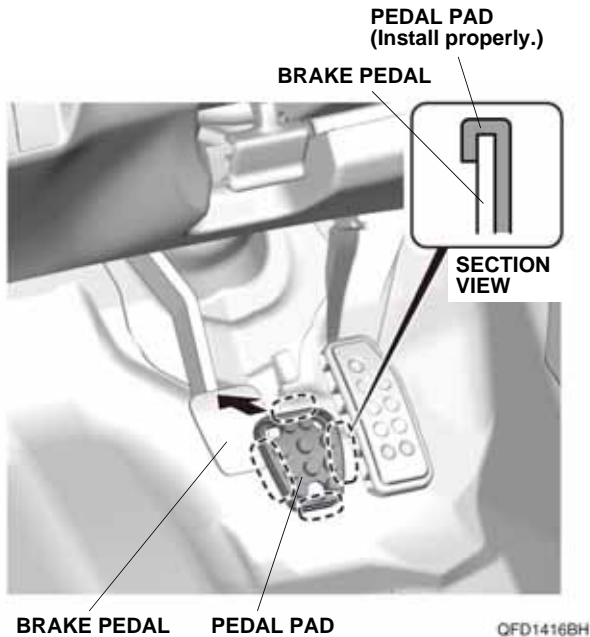

16. Using a white marker, mark the brake pedal as shown.

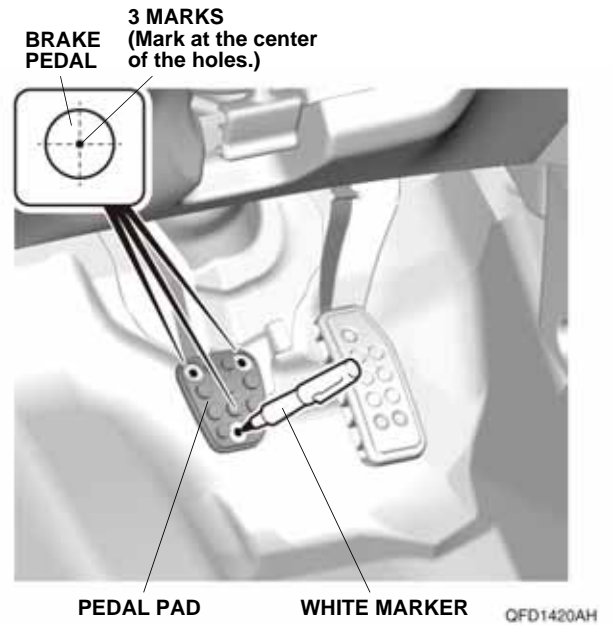

17. Remove the pedal pad. Using a center punch, punch the centers of the three marks. If using an automatic center punch, set it to the minimum setting.

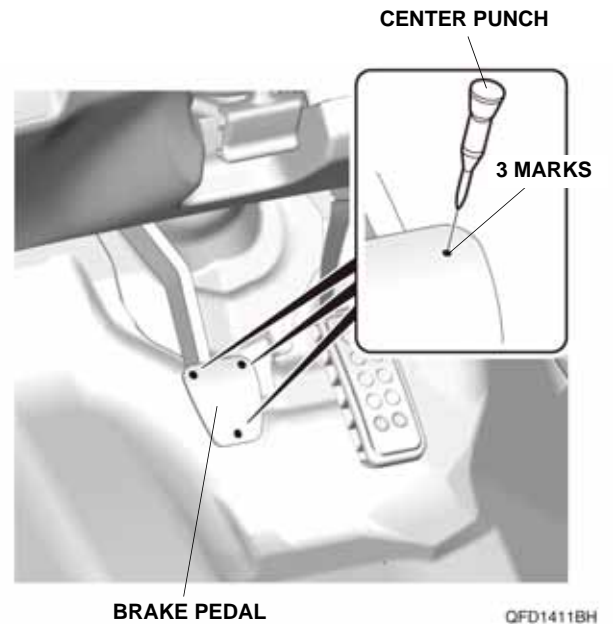

18. While wearing eye protection, drill the brake pedal at the three center-punched marks using a 2 mm drill bit first, then finish using a 3.5 mm drill bit.

NOTE:

- Wrap the masking tape around each drill bit 10 mm (0.39 in.) away from the tip, or use a drill stop.
- Hold the brake pedal firmly with your hand while drilling the hole.
- Make sure to drill perpendicular to the brake pedal. Remove any burrs.

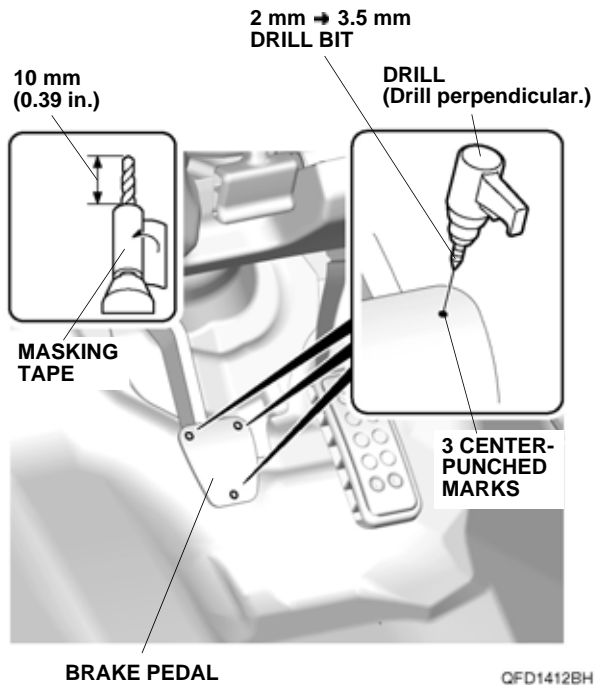

19. Install the pedal pad onto the brake pedal.
NOTE: Make sure the pedal pad is properly installed on the brake pedal.

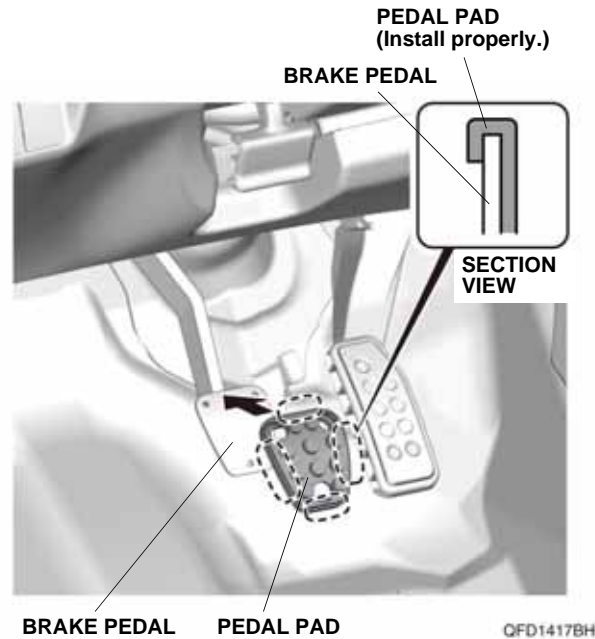

20. Loosely install the pedal pad cover on the pedal pad.

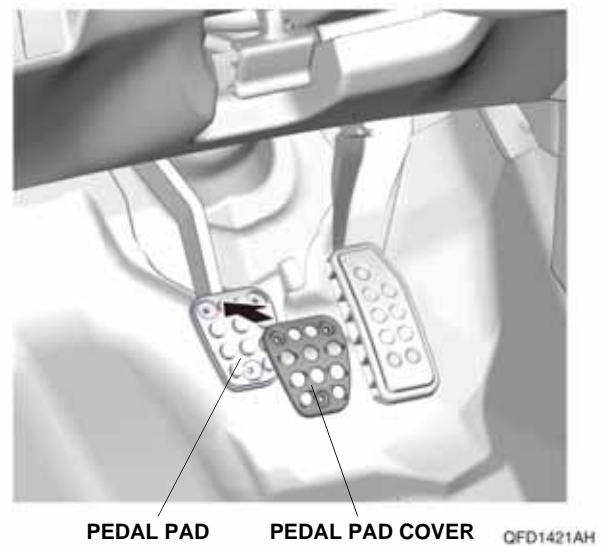

21. Using the hand riveter, install the pedal pad cover on the brake pedal with three rivets B as shown.

NOTE:

- Make sure that you use the correct rivet before proceeding with the installation.
- Make sure the rivets are attached.

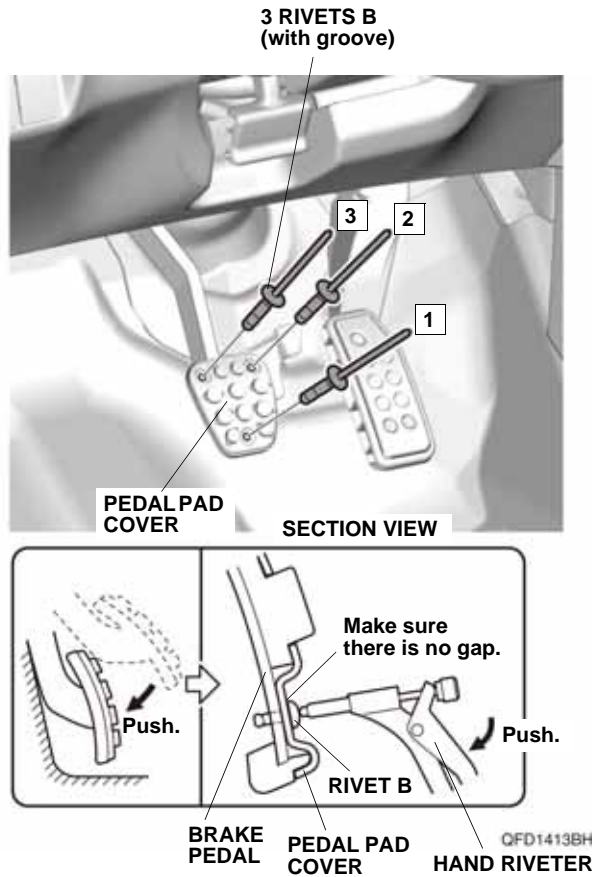

22. Repeat steps 14 through 21 to install the pedal pad and pedal pad cover on the clutch pedal.