

# Germain Honda of College Hills



## INSTALLATION INSTRUCTIONS

Accessory  
**DOOR EDGE GUARDS**

Application  
**2023 CR-V  
MODEL SERIES**

Publications No.  
**VERSION 1**  
Issue Date  
**AUG 2022**

## GENERAL VIEW

If you are also installing body side moldings (sold separately), install them before you install the door edge guards.

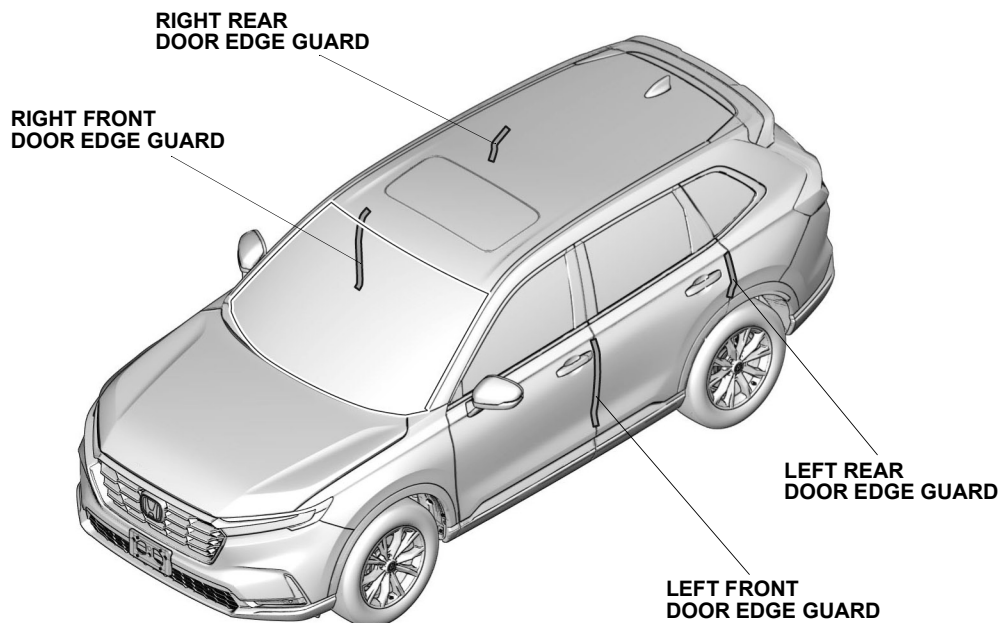

QL01102AN

## FOR YOUR SAFETY (Read carefully.)

### Warning Symbols

Safety: Your safety, and the safety of others, is important. To help you make informed decisions about service procedures, we have provided safety messages where appropriate. Of course, it is not practical or possible to warn you about all the hazards associated with servicing a vehicle - you must use your own good judgment.

You will find important safety messages preceded by one of the following symbols:

\*All symbols are not used in all installation instructions.

**⚠ DANGER**

You will be killed or seriously hurt if you do not follow the instructions.

**⚠ WARNING**

You can be killed or seriously hurt if you do not follow the instructions.

**⚠ CAUTION**

You can be hurt if you do not follow the instructions.

**NOTICE**

Gives advice to prevent damage to the product, vehicle, the environment or other property.

**NOTE**

Gives helpful information or instructions to be followed when installing this product.



Indicates a prohibited action.

# Germain Honda of College Hills

## Procedure and Location Icons

These icons indicate the work location and the worker's point of view.

\*All icons are not used in all installation instructions.



The location on the vehicle.



The location in the vehicle.  
(Instrument panel.)



Wear eye protection.



Wear heavy gloves.



Use an assistant.



Place the part on a blanket.



Work perpendicular.



Remove any burrs.



Use touch-up paint and allow to dry.



Tighten to the specified torque.



Apply firm pressure while rolling, especially at the ends, to set the adhesive.



Press firmly.



Clean with isopropyl alcohol.



Return the original part to the customer.  
(Do not reuse.)

## Safety: General

- Observe all safety notes and precautions described in the service information, in addition to those described in this Installation Instruction. Be extremely careful for your safety and safety of others.
- Be careful not to damage the vehicle or the parts.
- Be extremely careful when handling retaining tabs and clips.
- The illustrations may differ slightly from the actual accessory.

## Safety: Accessory

Always use the parts and tools specified in the installation instructions.

# Germain Honda of College Hills

## PARTS LIST

### Door Edge Guards Kit (P/N 08P20-3A0-100)

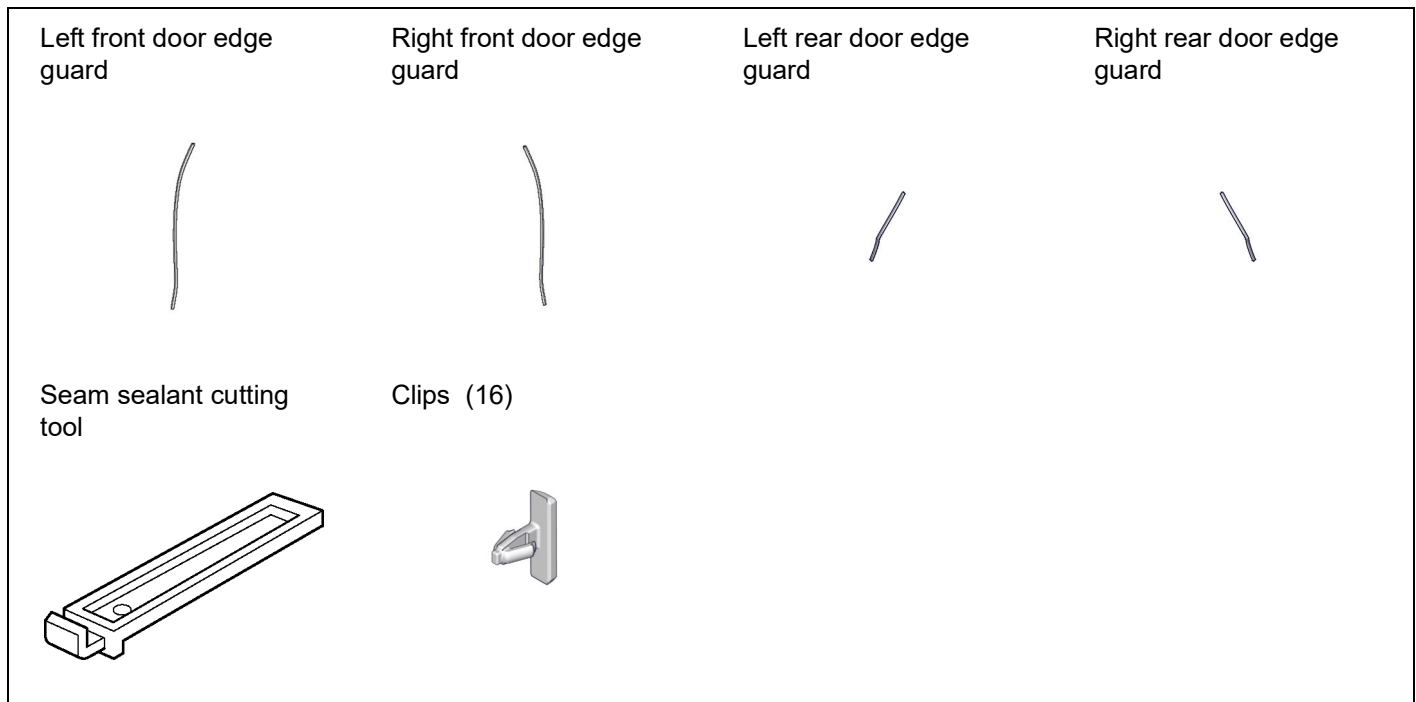

## REQUIRED TOOLS AND SUPPLIES

- Rubber mallet
- Felt-tip pen
- Touch-up paint
- Ruler

The following tools are available through the Honda Tool and Equipment Program:

- Trim Tool Set (T/N SOJATP2014)
- Plastic Trim Tool (T/N SILTRIMTL10)

# Germain Honda of College Hills

## INSTALLATION

1. Pull away the door opening seal.

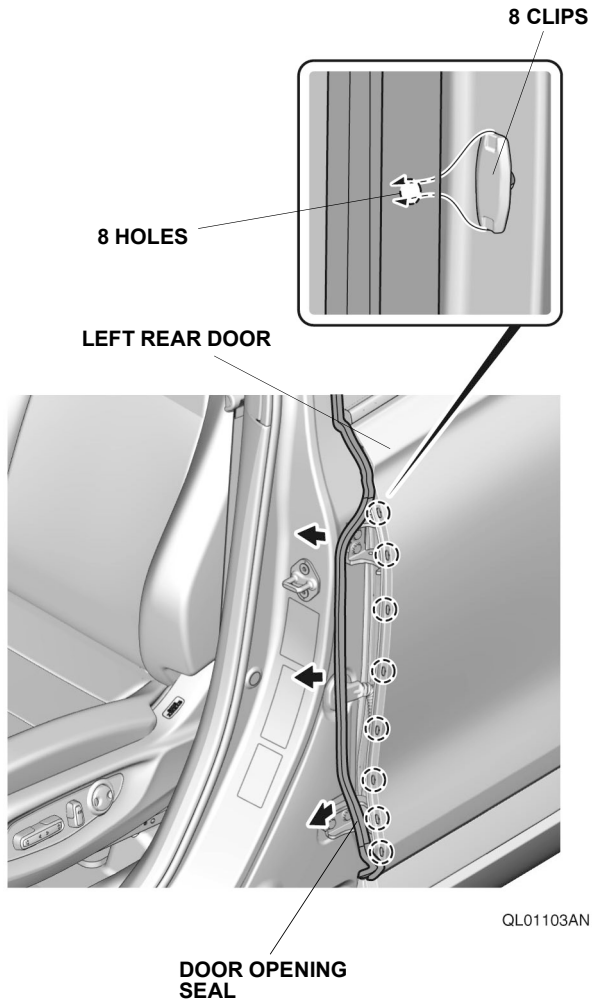
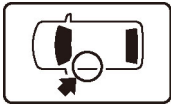

2. Remove the clips.

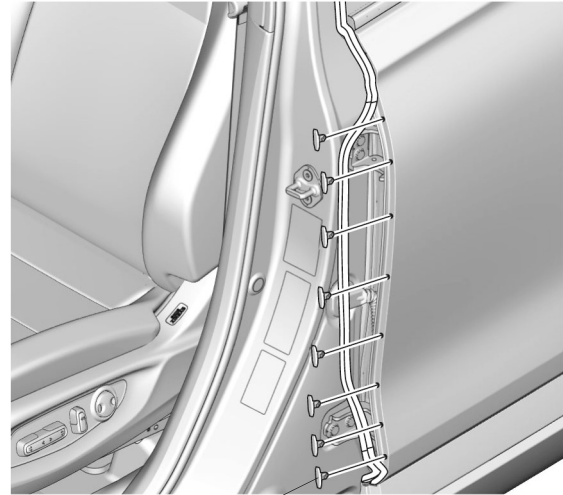

8 CLIPS



3. Install the clips.

### NOTE

Make sure to install the clips in the correct orientation.

8 CLIPS  
(supplied)

8 HOLES

SECTION VIEW

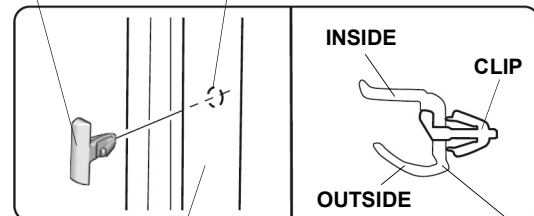

DOOR OPENING SEAL

DOOR  
OPENING  
SEAL

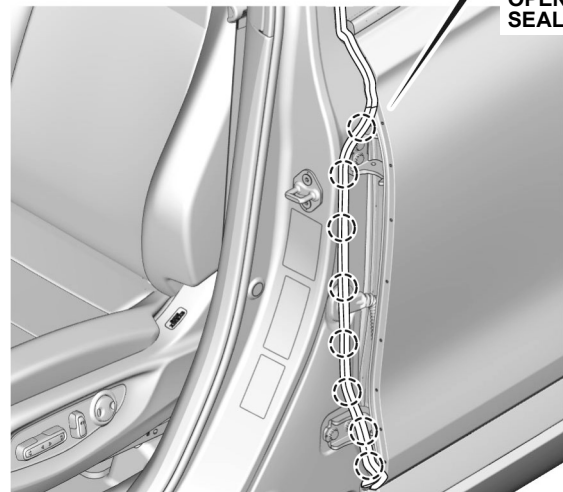

QL01105AN

# Germain Honda of College Hills

4. Temporarily install the left front door edge guard.

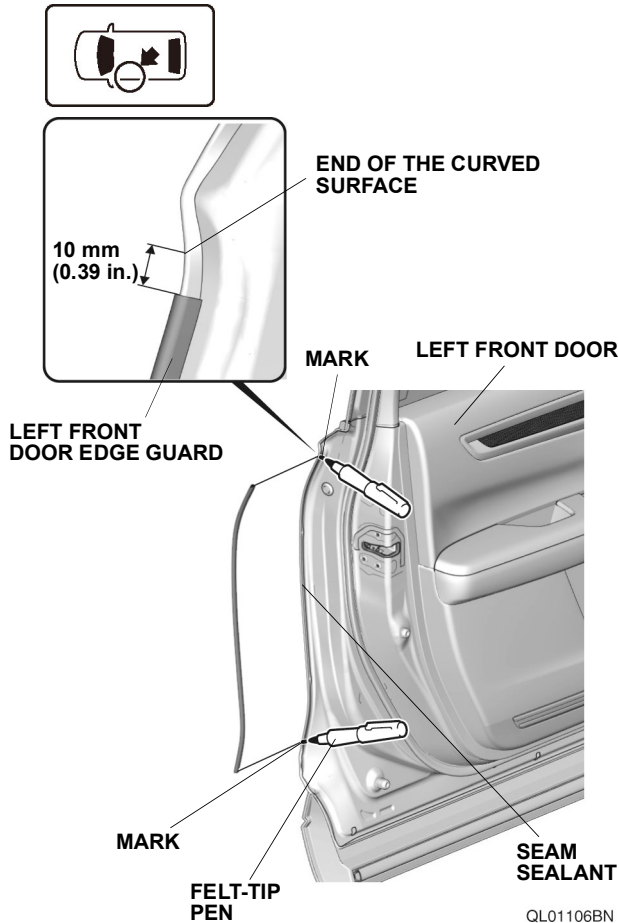

5. Mark the seam sealant.  
6. Remove the left front door edge guard.  
7. Trim the seam sealant.

## NOTE

The cutting tool cuts in only one direction.

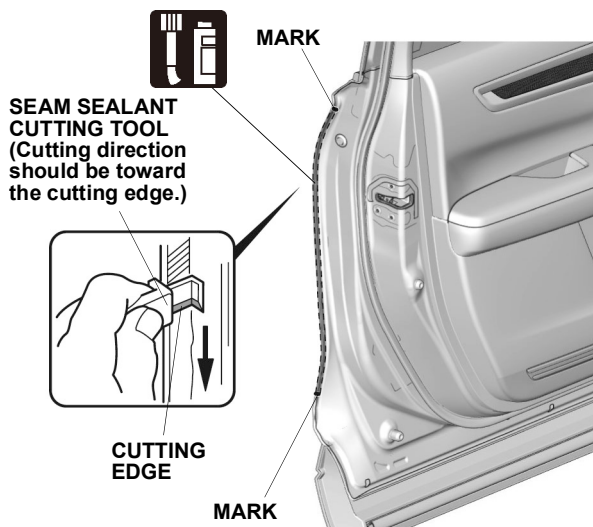

8. Temporarily install the left rear door edge guard.

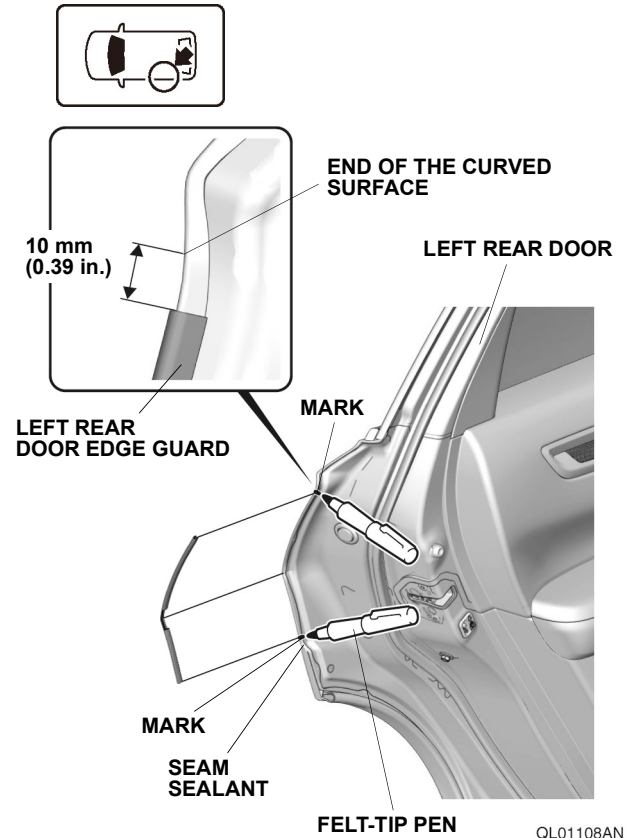

9. Mark the seam sealant.  
10. Remove the left rear door edge guard.  
11. Trim the seam sealant.

## NOTE

The cutting tool cuts in only one direction.

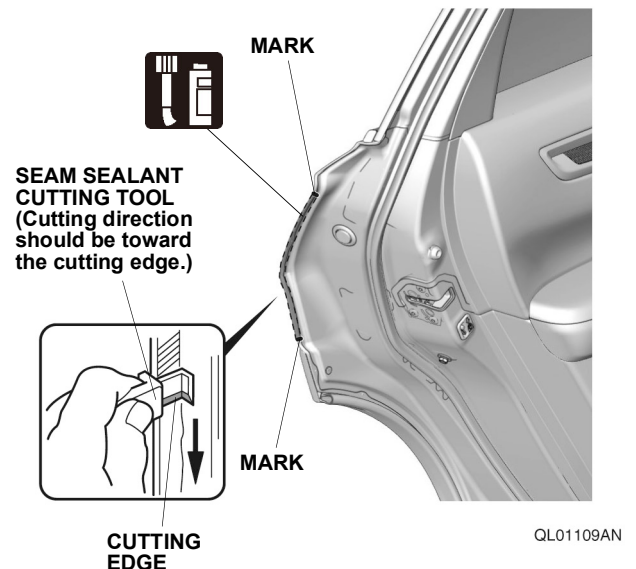

# Germain Honda of College Hills

12. Repeat the same procedures on the other side.

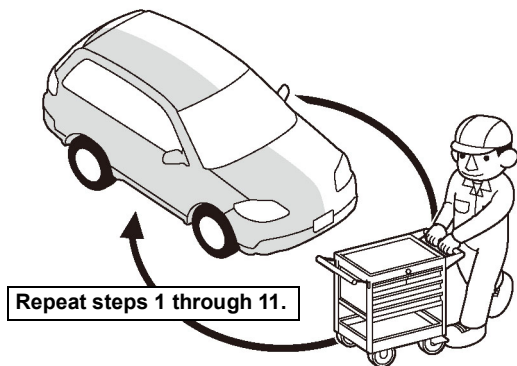

Q9D1014AM

13. Install the left front door edge guard.

## NOTE

Make sure to install the door edge guard in the correct orientation.

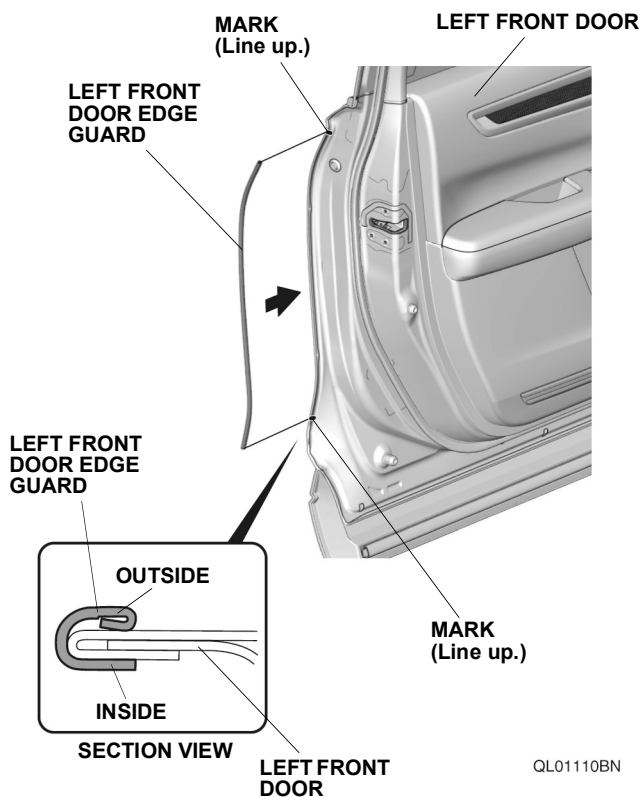
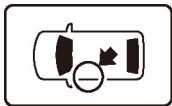

QL01110BN

14. Secure the left front door edge guard.

## NOTE

Once in place, do not remove, reposition, or reinstall the door edge guard or it will not hold securely.

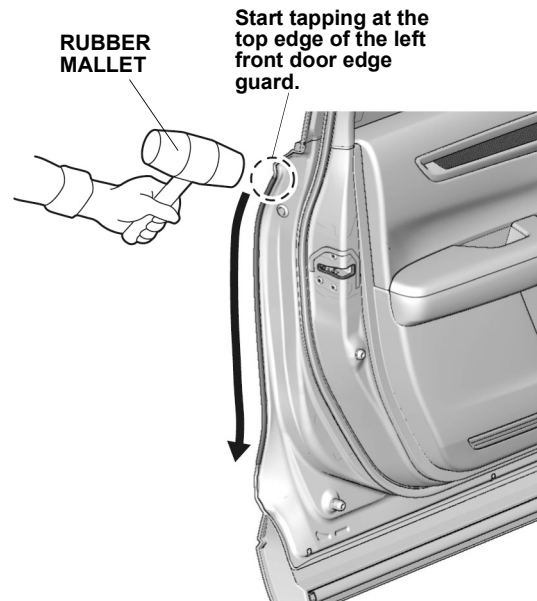

QL01111BN



# Germain Honda of College Hills

15. Install the left rear door edge guard.

## NOTE

Make sure to install the door edge guard in the correct orientation.

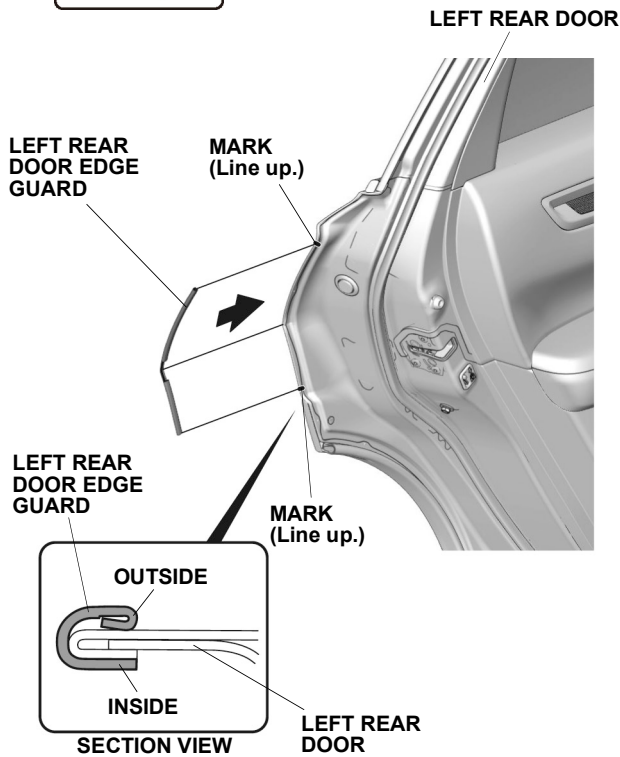
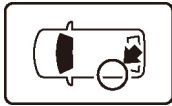

QL01112AN

16. Secure the left rear door edge guard.

## NOTE

Once in place, do not remove, reposition, or reinstall the door edge guard or it will not hold securely.

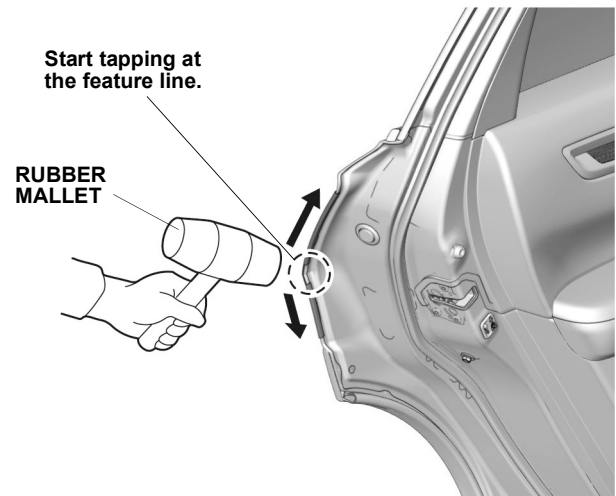

QL01113BN

17. Repeat the same procedures on the other side.

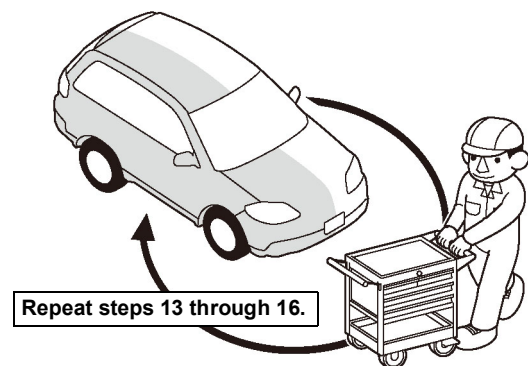

Q9D1014AM

18. Check that all parts are installed properly.