



HONDA INSTALLATION INSTRUCTIONS

Accessory
HEATED STEERING WHEEL

Application
2022 CR-V
2022 CR-V HYBRID
(EX and EX-L)

Publications No.
VERSION 1
Issue Date
AUG 2021

PARTS LIST

Heated Steering Wheel Kit
P/N 08U97-TLA-100E

Heater harness

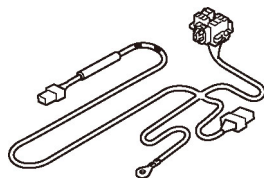

Steering wheel



Control unit



Cable reel

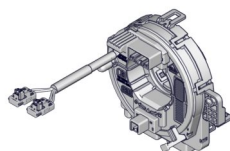

Cable reel cord



Relay

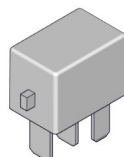

2 Self-tapping screws



Ground bolt

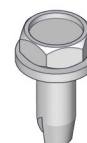

Steering wheel bolt

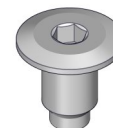

15 Wire ties



Information

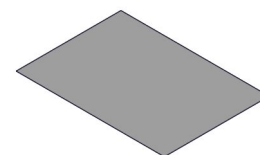

Fuse label

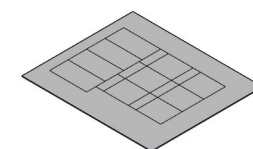

10A Fuse

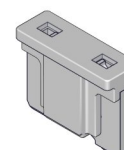

Steering wheel cord protector
(May not be used)



Switch Kit
P/N 08U97-TLA-100D

HSW switch

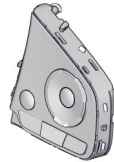

TOOLS AND SUPPLIES REQUIRED

Phillips screwdriver
Flat-tip screwdriver
Punch (diameter of 5.5 mm)
10 mm Open end wrench
10 mm Hex bit
8 mm and 10 mm Sockets
Ratchet
Torque wrench
Steering wheel puller
Isopropyl alcohol
Shop towel
Masking tape
Diagonal cutters
i-HDS

The following tools are available through the Honda Tool and Equipment Program. On the iN, click on Service > Service Bay > Tool and Equipment Program, then enter the number under "Search." Or, call 888-424-6857.

- Trim Tool Set (T/N SOJATP2014)
- Plastic Trim Tool (T/N SILTRIMTL10)

Illustration of the Heated Steering Wheel in the Vehicle

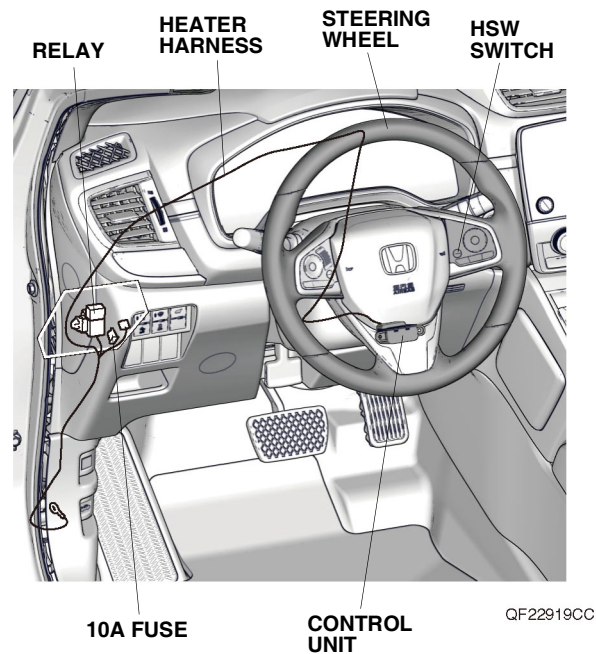

INSTALLATION

Customer Information: The information in this installation instruction is intended for use only by skilled technicians who have the proper tools, equipment, and training to correctly and safely add equipment to your vehicle. These procedures should not be attempted by "do-it-yourselfers."

NOTE:

- Observe all safety notes and precautions in the service information in addition to those in this installation instruction.
 - Be careful not to damage the vehicle.
 - After installing the steering wheel, you must line up the steering wheel spoke angle to the straight-ahead position by adjusting the front toe.
1. Turn the steering wheel so the front wheels are in the straight-ahead position.
 2. Disconnect the negative cable from the battery, and wait at least 3 minutes before you start to install the steering wheel.

If the vehicle is equipped with driver's dashboard under cover, continue with step 3; otherwise, go to step 4.

With driver's dashboard under cover

- Remove the driver's dashboard under cover, and unplug the vehicle connector (if equipped).

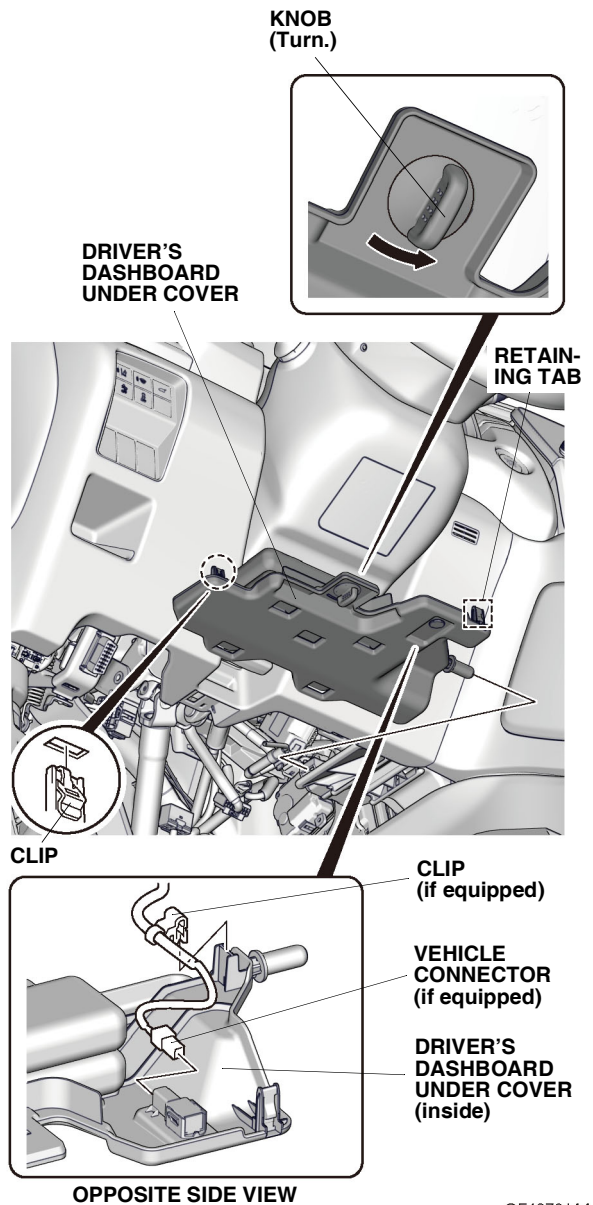

- Pull away the door opening seal. Remove the driver's dashboard lower cover, and unplug the vehicle connectors.

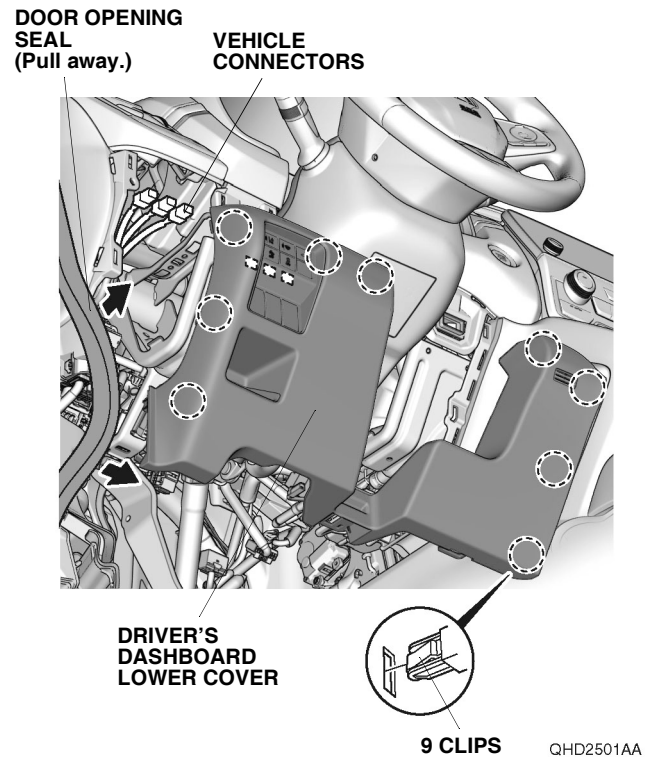

- Remove the driver's door sill trim.

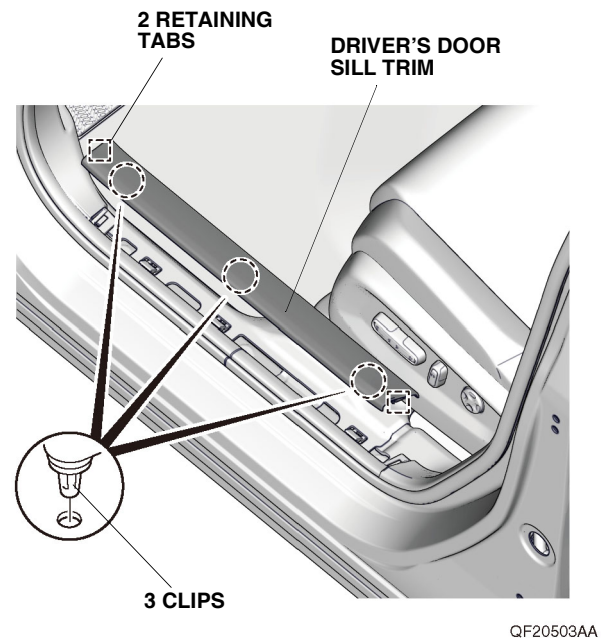

6. Pull away the door opening seal, and remove the driver's kick panel.

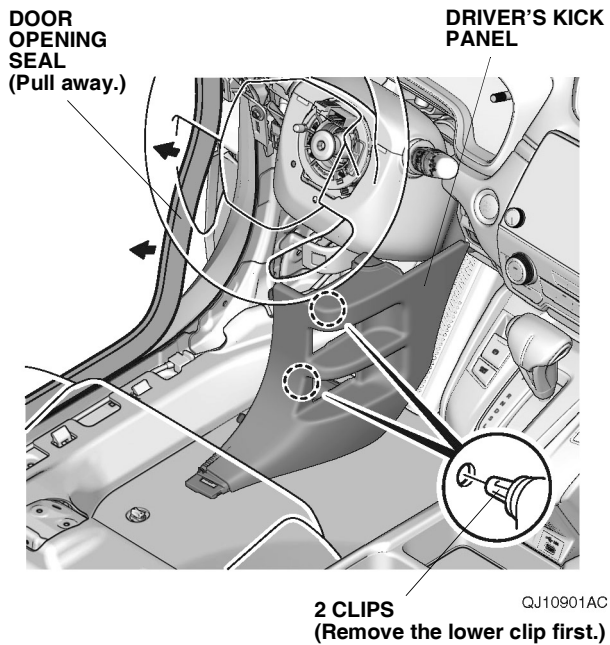

7. Lower and pull out the steering wheel as shown.

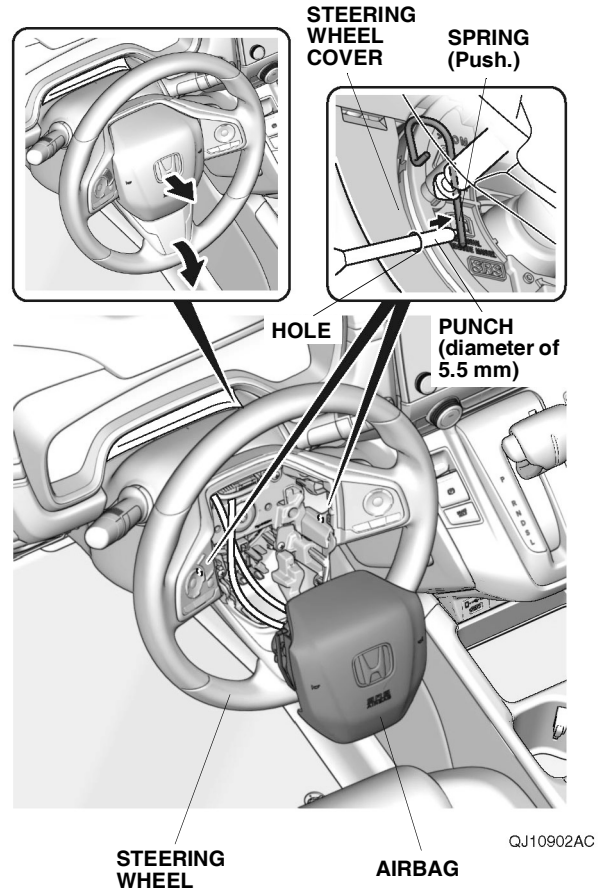

8. Insert a punch (diameter of 5.5 mm) through the left hole of the steering wheel cover, and push the spring to release the airbag. Repeat for the other side.

9. Unplug the cable reel cord 2-pin connector and two cable reel 2-pin connectors by squeezing and pulling up on the locking tabs.

NOTE: Be careful not to damage the connectors.

CABLE REEL
CORD 2-PIN
CONNECTOR

OPPOSITE SIDE VIEW

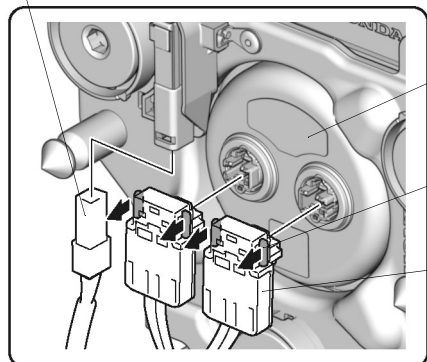

AIRBAG
(inside)

4 LOCKING
TABS
(Pull up.)

2 CABLE REEL
2-PIN
CONNECTORS

CABLE REEL
CORD 2-PIN
CONNECTOR

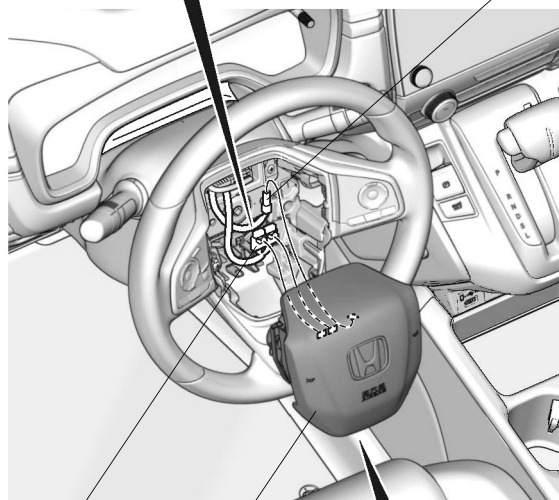

2 CABLE REEL
2-PIN
CONNECTORS

AIRBAG

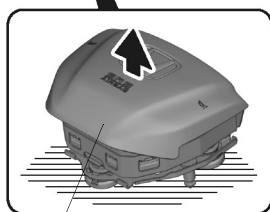

AIRBAG

QJ10903BC

10. Remove the airbag. Do not drop the removed airbag or hit it on an object. Place the removed airbag in a safe place with the padded surface (top) facing up.

11. With the front wheels line up in the straight-ahead position, unplug the vehicle connector from the cable reel, and loosen the steering wheel bolt.

STEERING
WHEEL BOLT
(Loosen.)

STEERING
WHEEL
PULLER

STEERING
WHEEL
PULLER
BOLT

VEHICLE
CONNECTOR

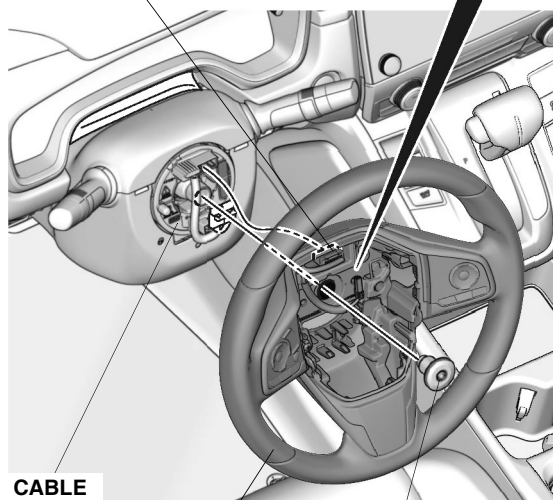
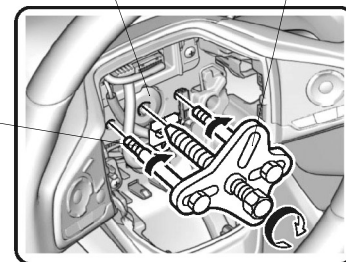

CABLE
REEL

STEERING
WHEEL

STEERING
WHEEL BOLT
(Do not reuse.)

QJ10904BC

12. Using a steering wheel puller, release the steering wheel. Do not thread the steering wheel puller bolts in more than 5 mm (0.20 in.). When removing the steering wheel, take care not to move the front wheels.
13. Remove the steering wheel bolt, then remove the steering wheel.

14. Apply masking tape to the instrument panel, upper column cover, combination light switch, and wiper switch as shown.

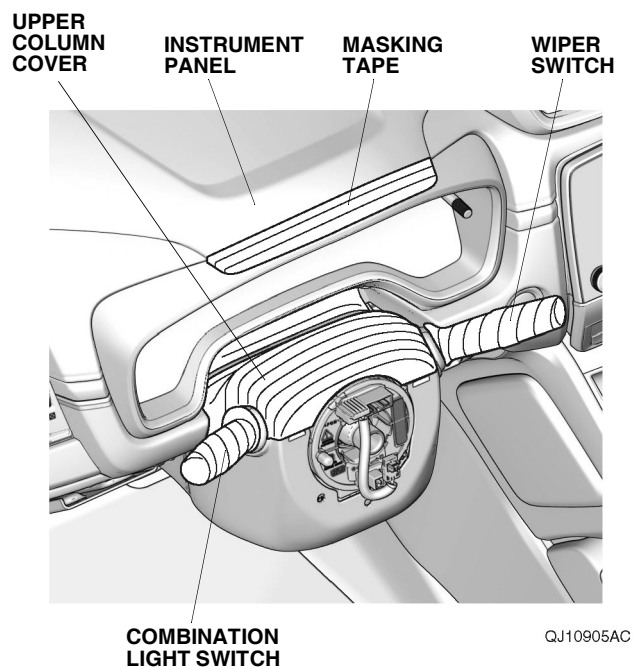

15. Using a plastic trim tool, release the two retaining tabs.

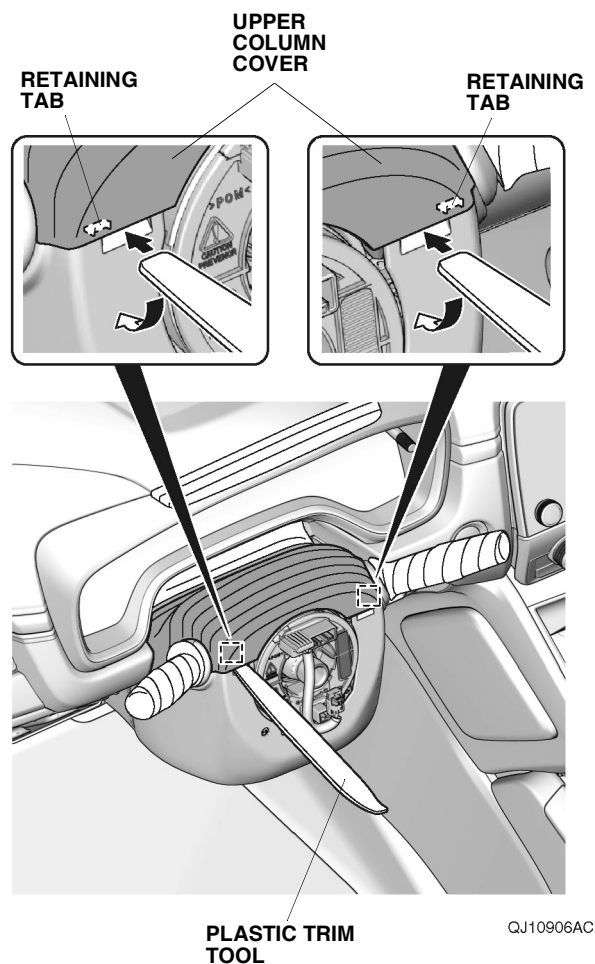

16. Remove the meter visor and upper column cover.

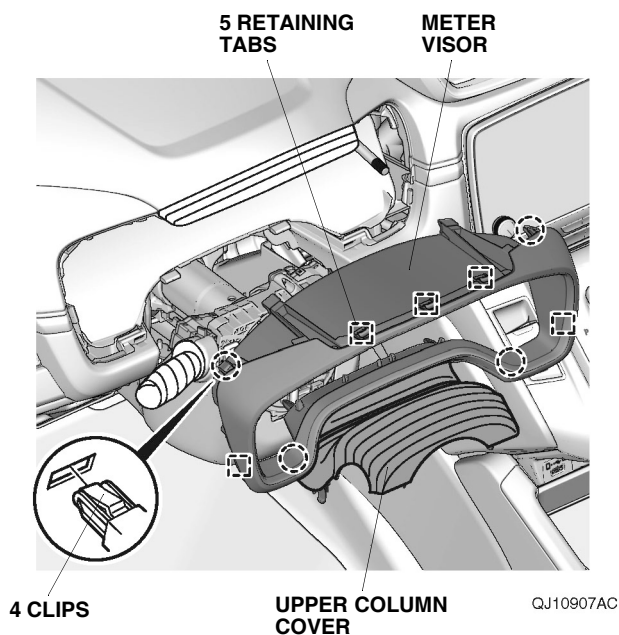

17. Remove the driver's lower ornament panel.

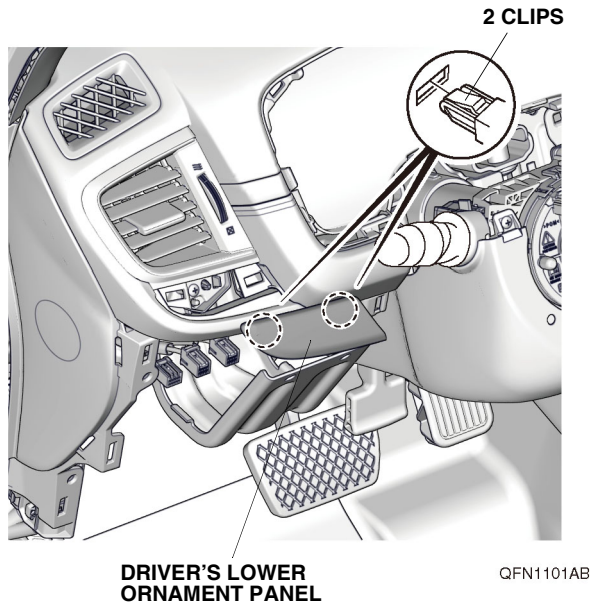

18. Remove the driver's outlet.

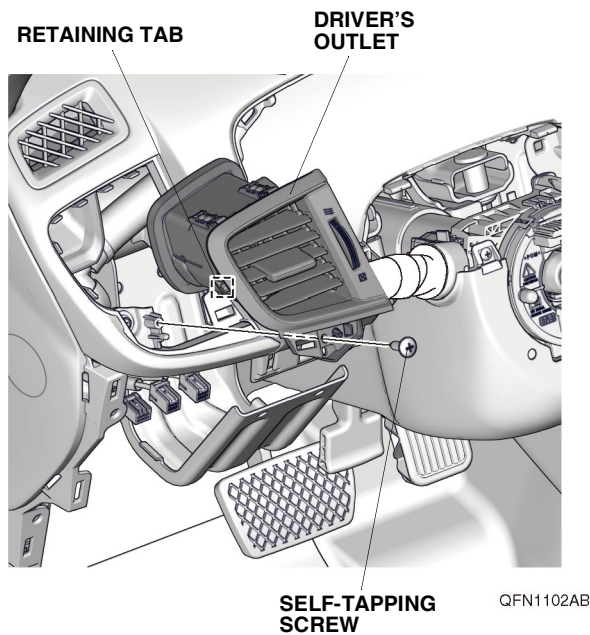

19. Remove the driver's dashboard outer panel.

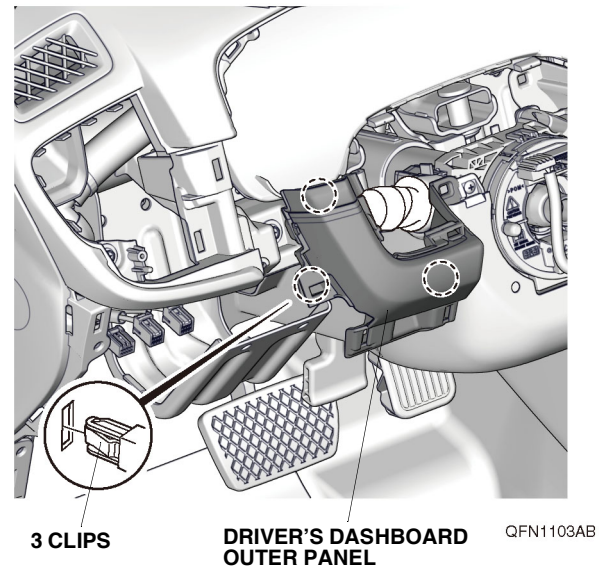

20. Apply masking tape as shown, and cut the masking tape.

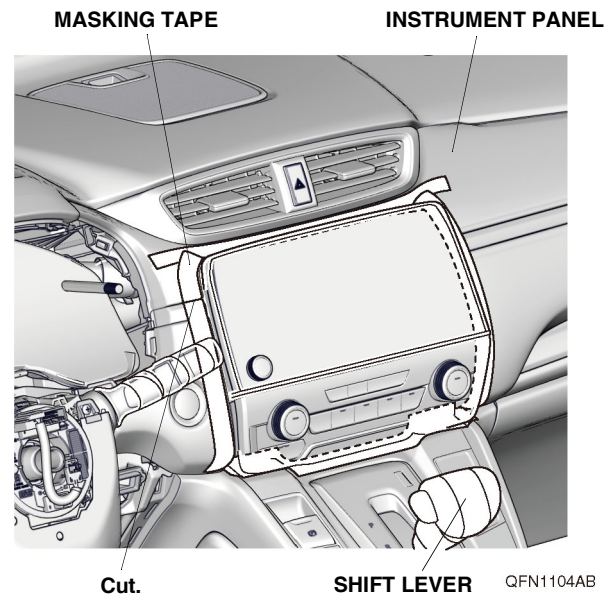

21. Remove the climate control unit, and unplug the vehicle connector.

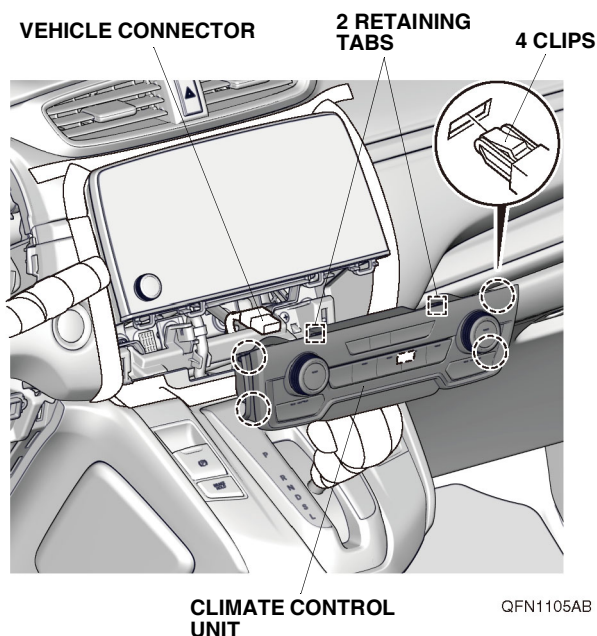

22. Release the audio unit.

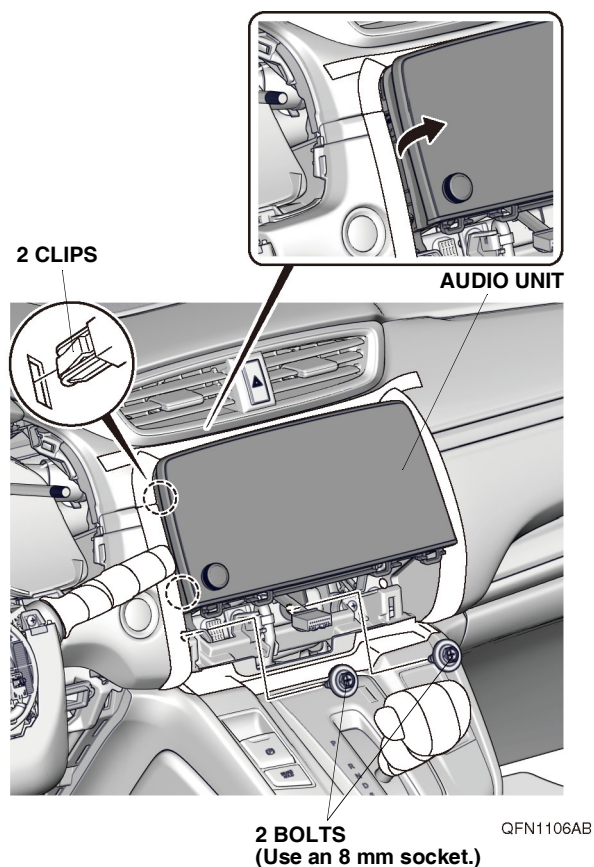

23. Remove the driver's dashboard inner panel, and unplug the vehicle connectors.

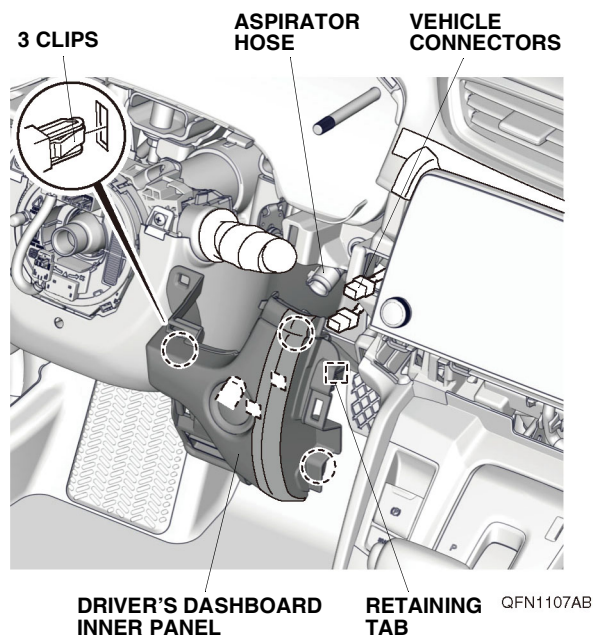

24. Remove the meter, and unplug the vehicle connectors.
NOTE: Do not keep the meter with the dial window down.

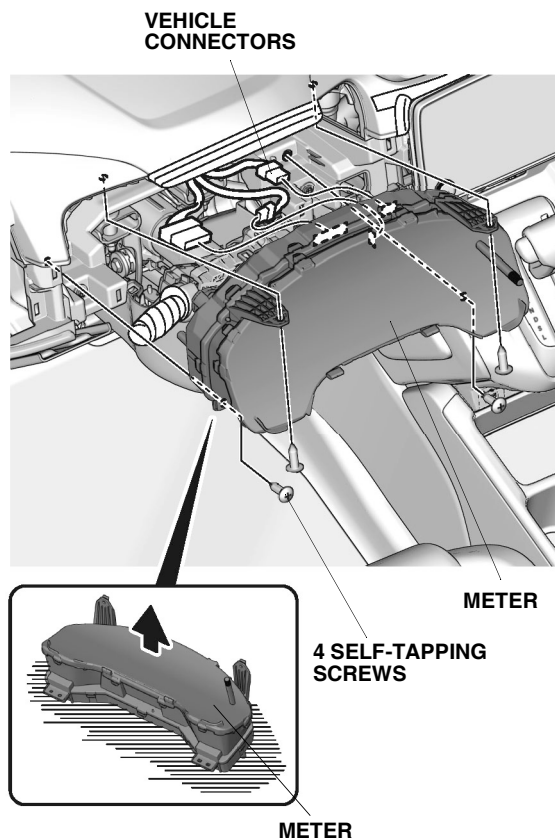

25. Remove the lower column cover.

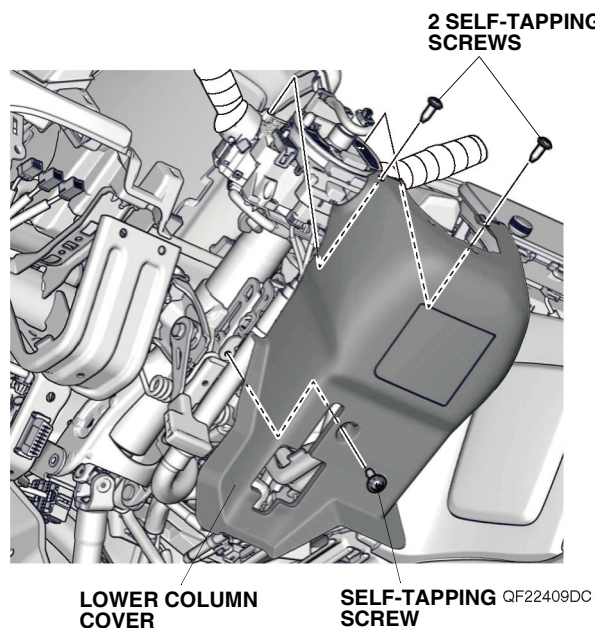

26. Remove the cable reel, and unplug the vehicle connectors.

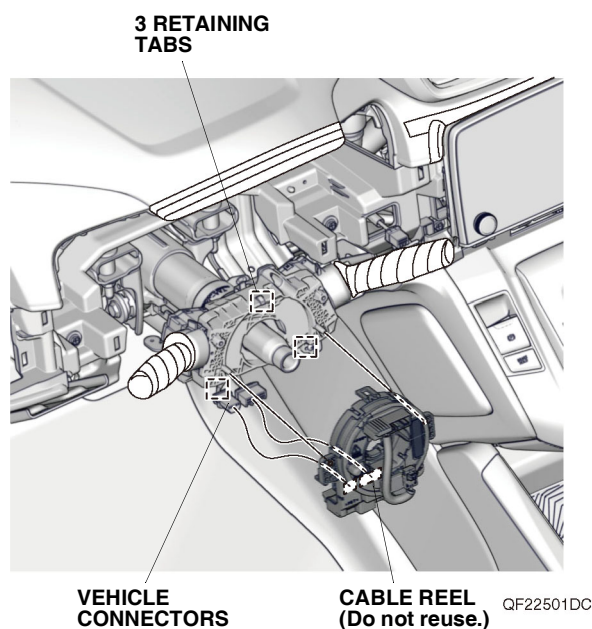

27. Install the new cable reel with three retaining tabs, and plug the vehicle connectors into the new cable reel.

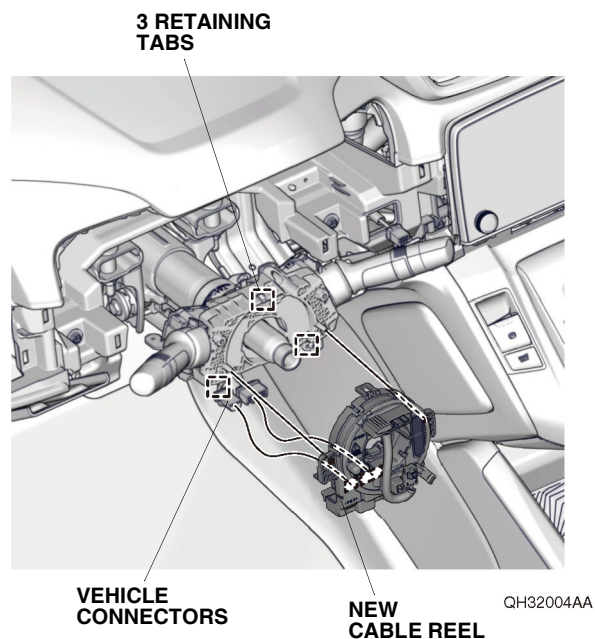

28. Plug the relay into the relay block on the heater harness.

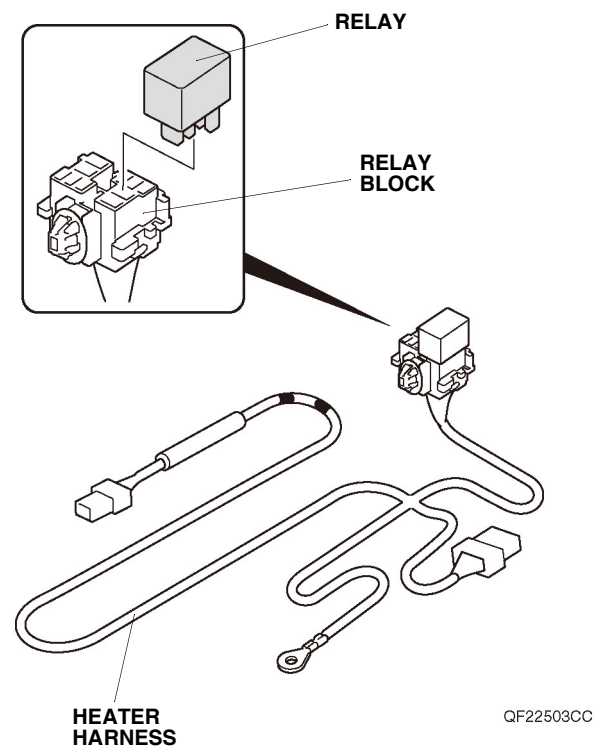

29. Install the relay block on the heater harness to the vehicle panel with clip on the relay block.

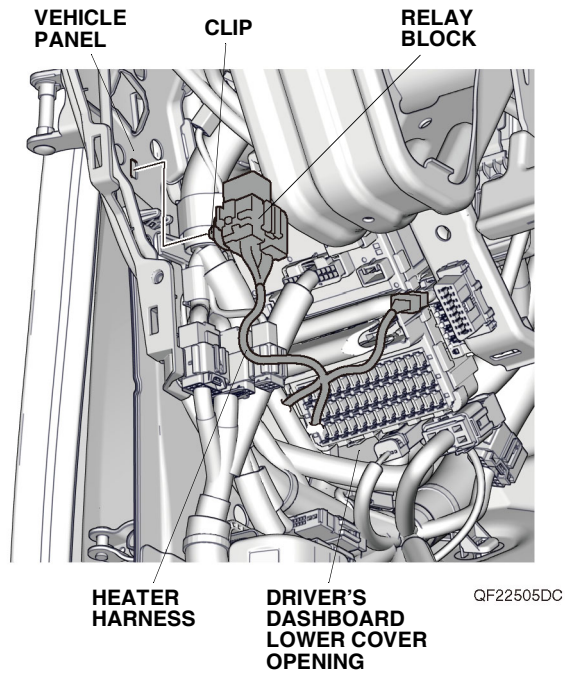

30. Plug the heater harness 4-pin connector into the fuse box.

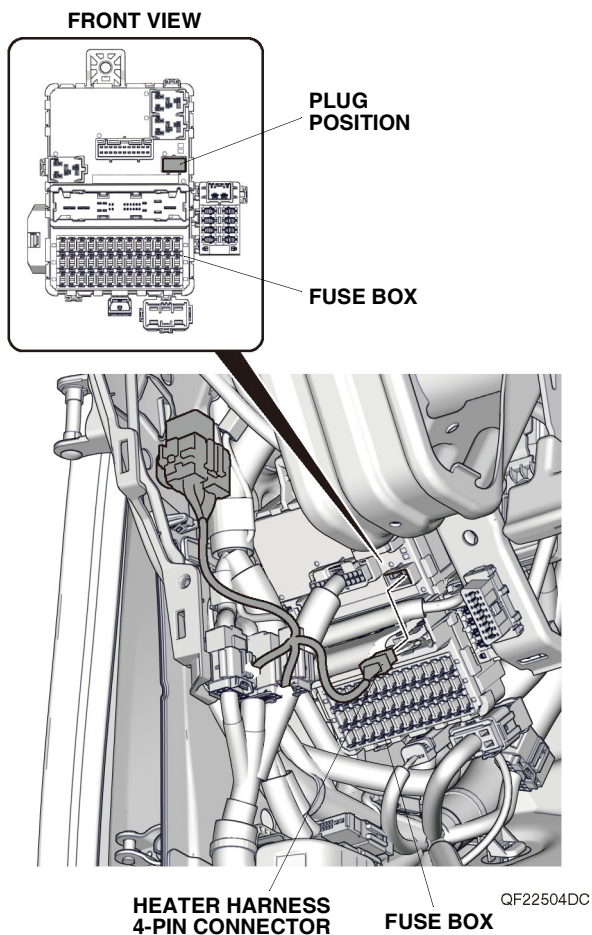

31. Remove the vehicle bolt. Route the heater harness as shown, and secure the heater harness ground terminal to the vehicle bracket with the ground bolt.

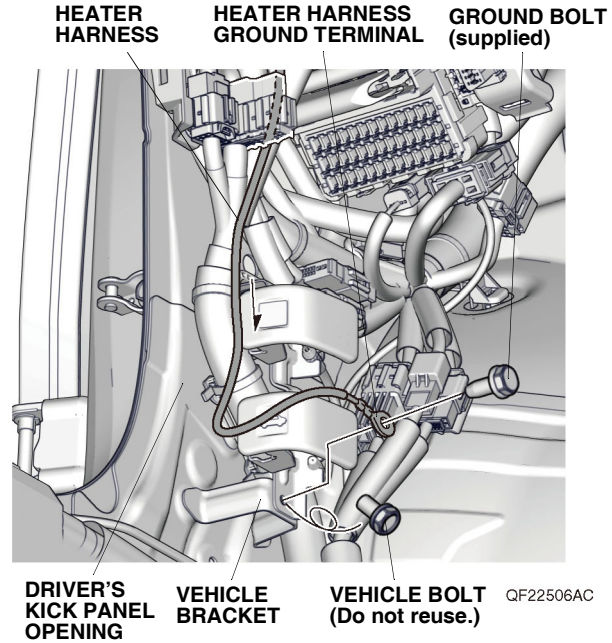

32. Secure the heater harness to the vehicle bracket and vehicle harness with three wire ties.

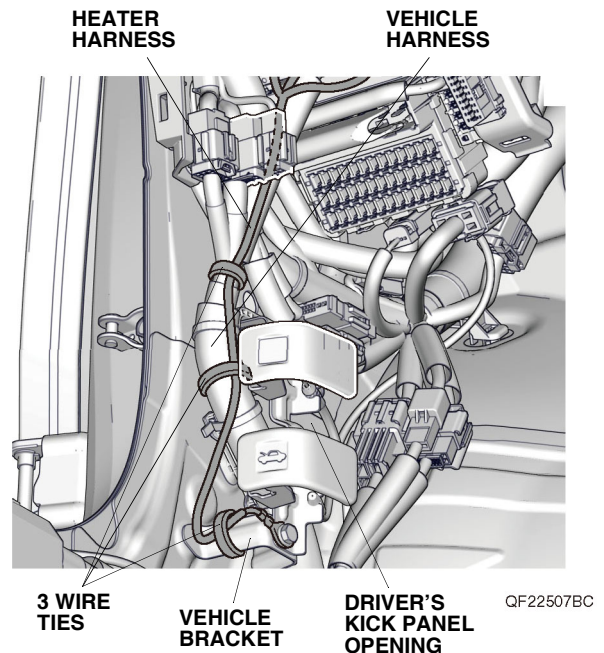

33. Route the heater harness along the vehicle harness, and secure it to the vehicle harness with two wire ties.

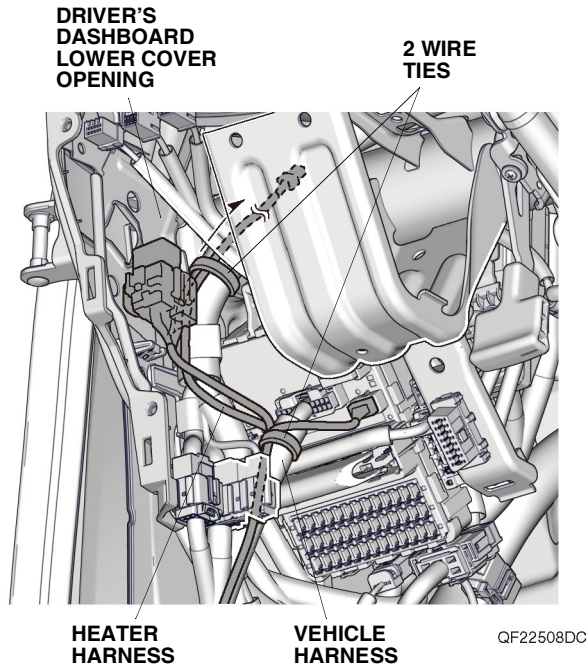

34. Route the heater harness along the vehicle harness, and secure it to the vehicle harness with two wire ties.

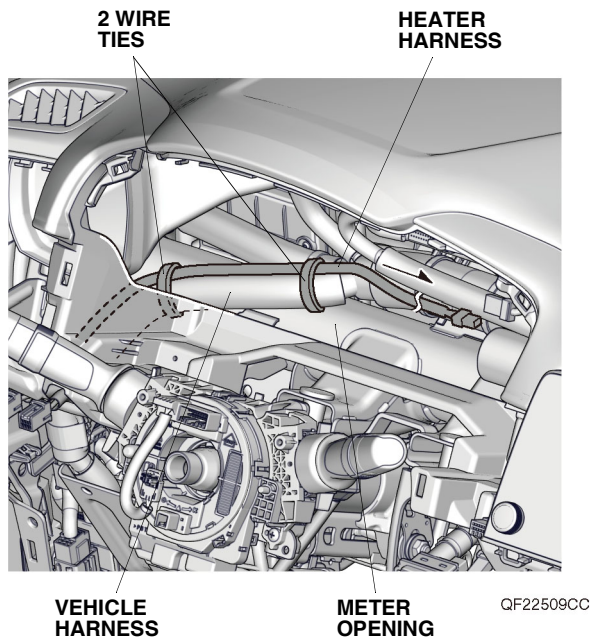

35. Route the heater harness along the driver's dashboard lower cover opening as shown.

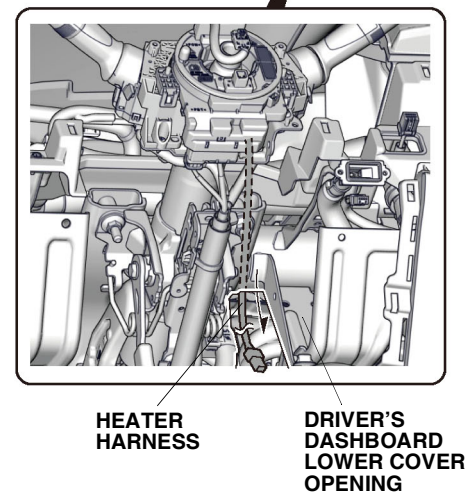
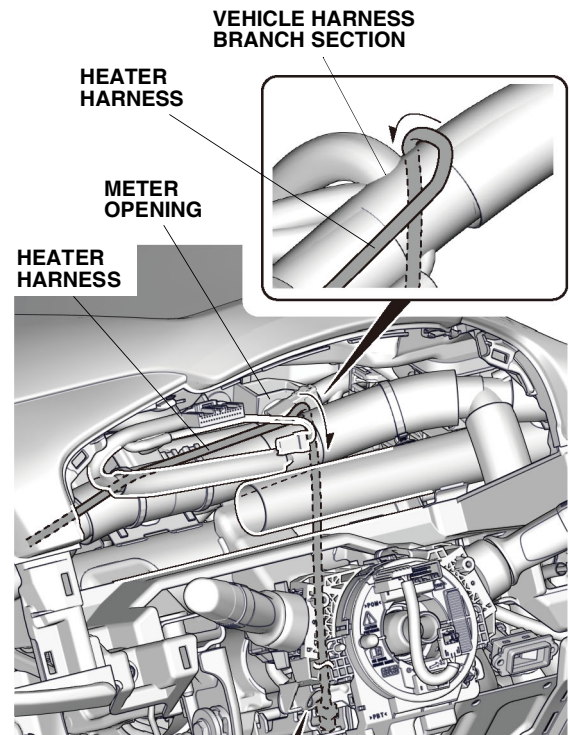

36. Route the heater harness along the vehicle harness, and secure it to the vehicle harness with two wire ties at the green tape on the heater harness.

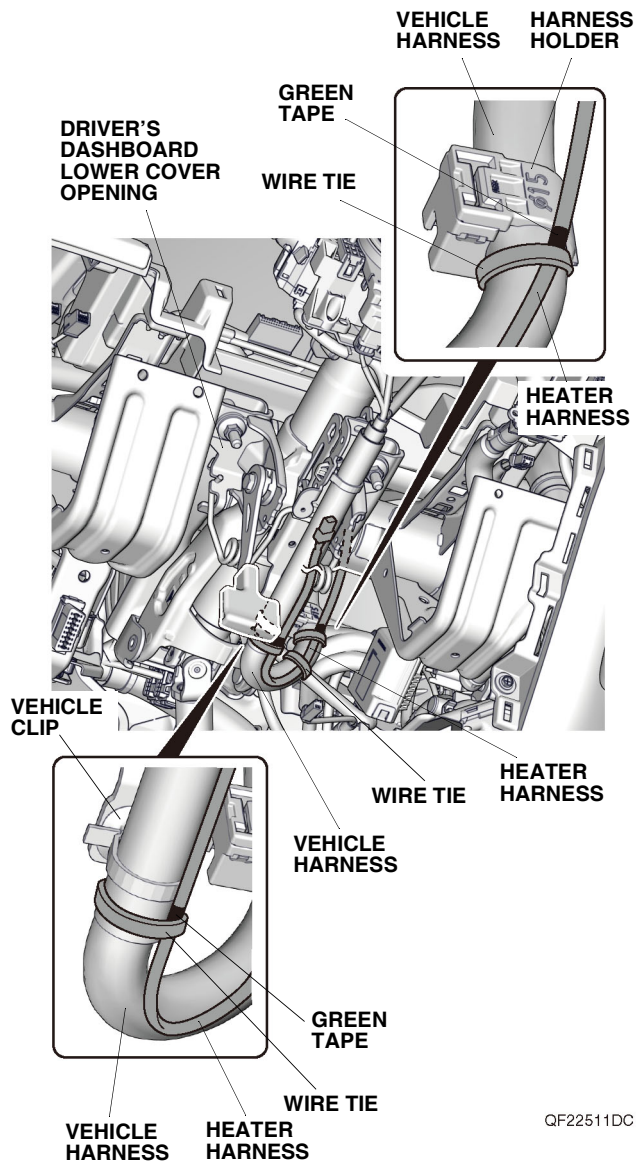

37. Secure the heater harness to the vehicle harness with one wire tie.

38. Secure the heater harness to the vehicle harness with three wire ties.

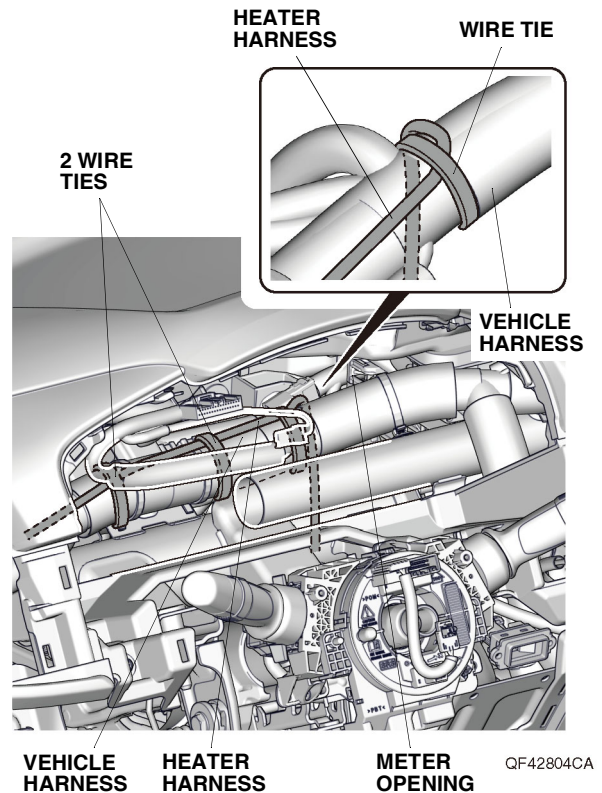

39. Secure the heater harness to the vehicle harnesses with two wire ties.

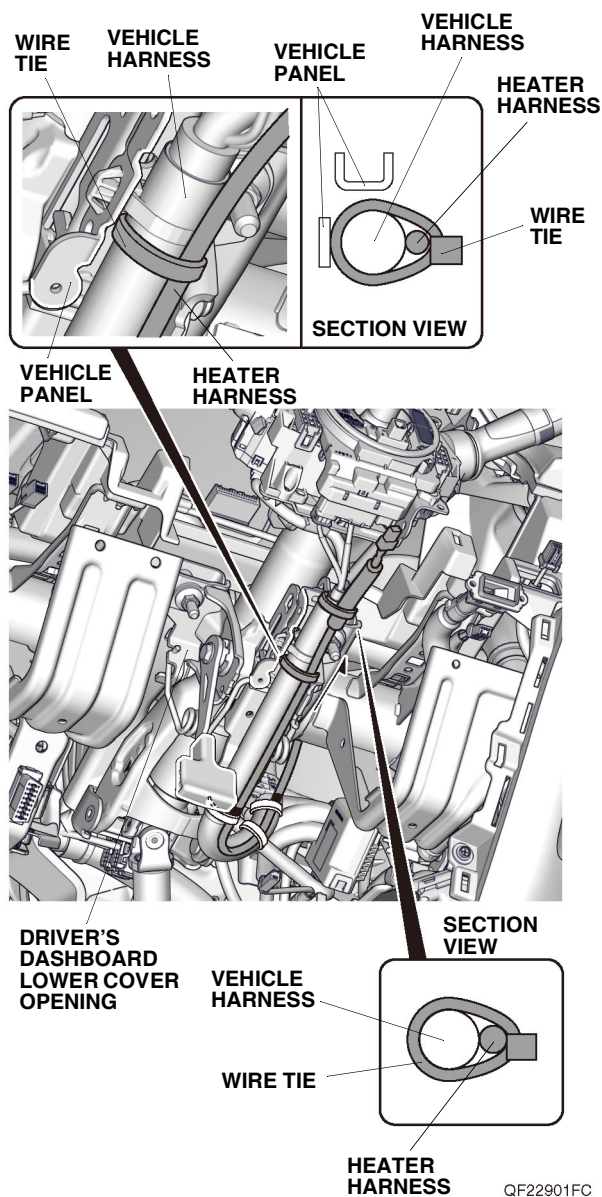

40. Plug the heater harness 2-pin connector into the new cable reel.

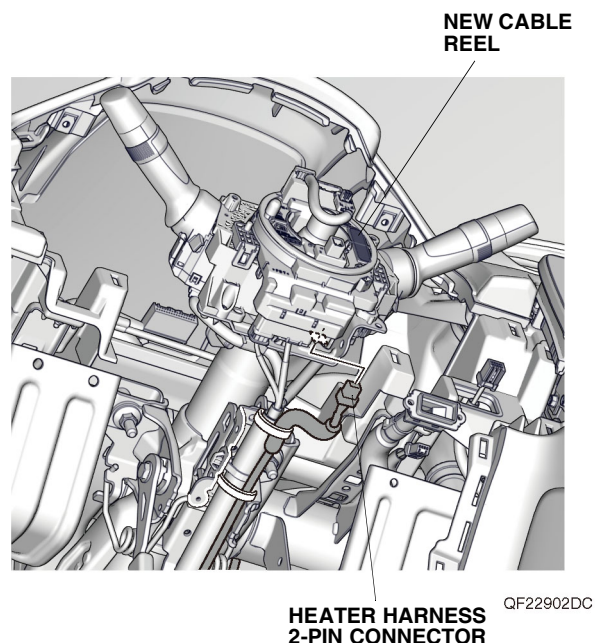

If the vehicle is equipped with paddle shifters, continue with step 41; otherwise, go to step 47.

With paddle shifters

41. Remove the steering wheel cord protector (if equipped) and switch assembly, and unplug the vehicle connectors.
- NOTE: Follow the same procedure for the differently shaped switch assembly.

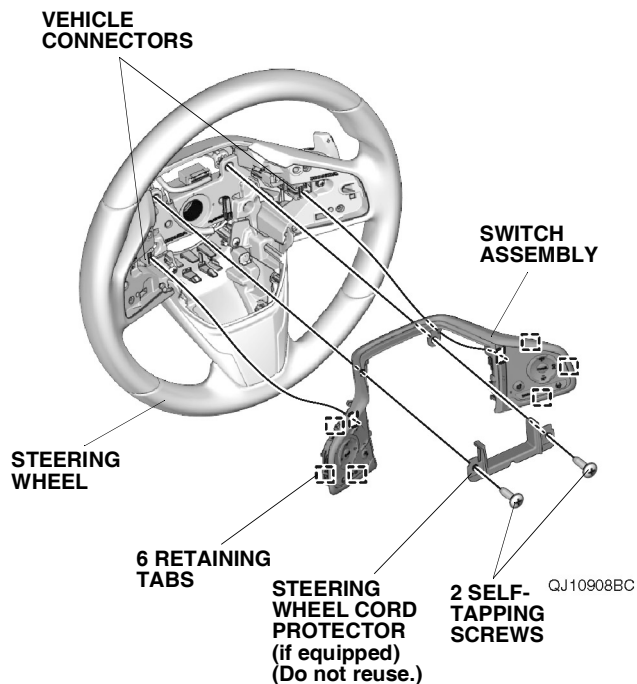

42. Remove the steering wheel cover.

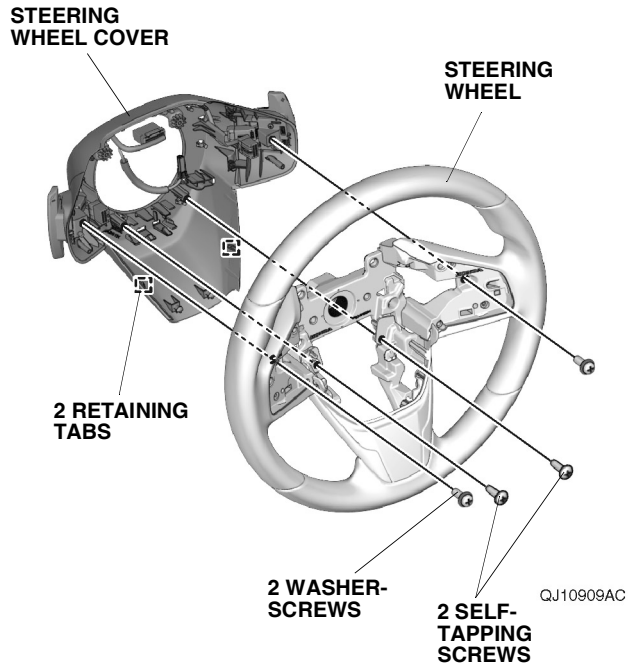

43. Using a Phillips screwdriver, push the pin on the steering wheel trim, and remove the steering wheel trim.

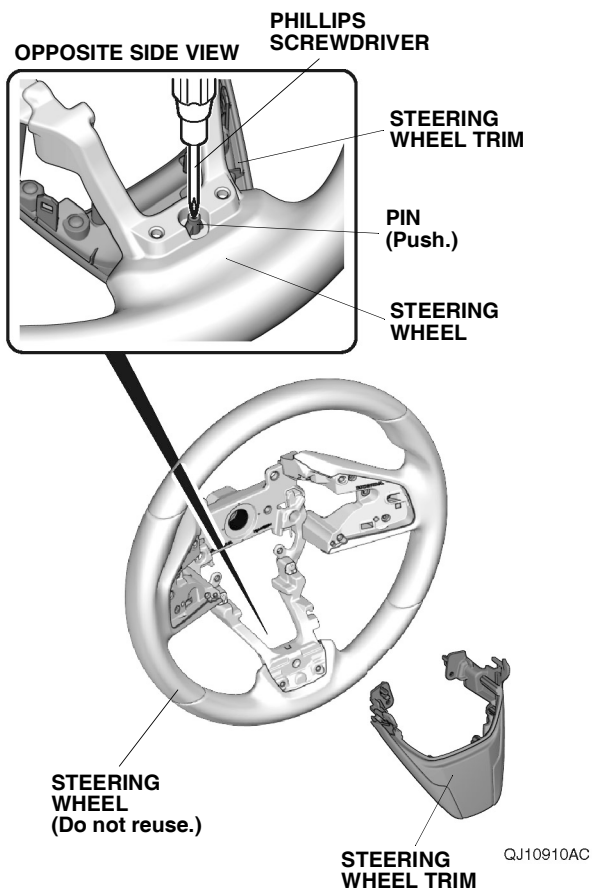

44. Unplug the cable reel cord connectors, and remove the cable reel cord.

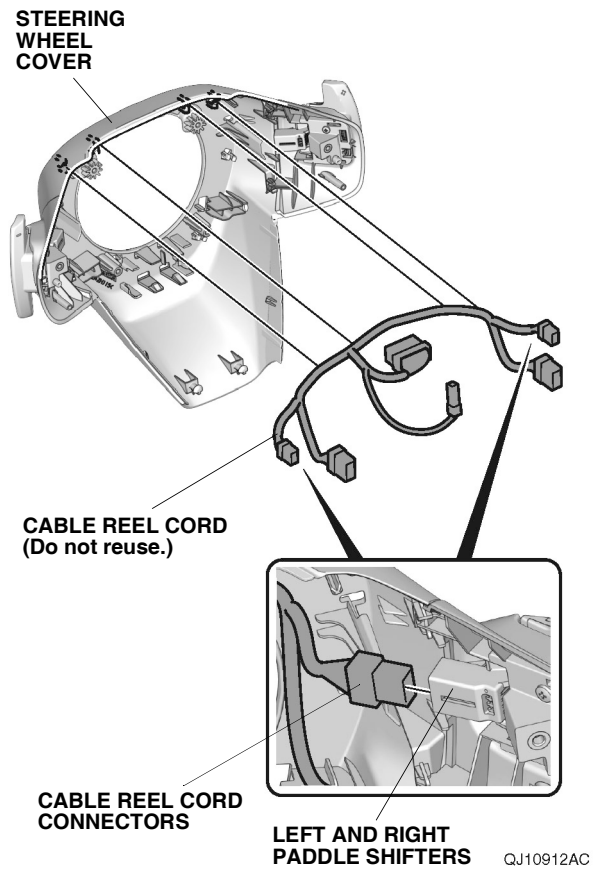

45. Install the new cable reel cord on the steering wheel cover, and plug the new cable reel cord 4-pin connectors into the left and right paddle shifters. **NOTE:** Make sure the cable reel cord is secured properly.

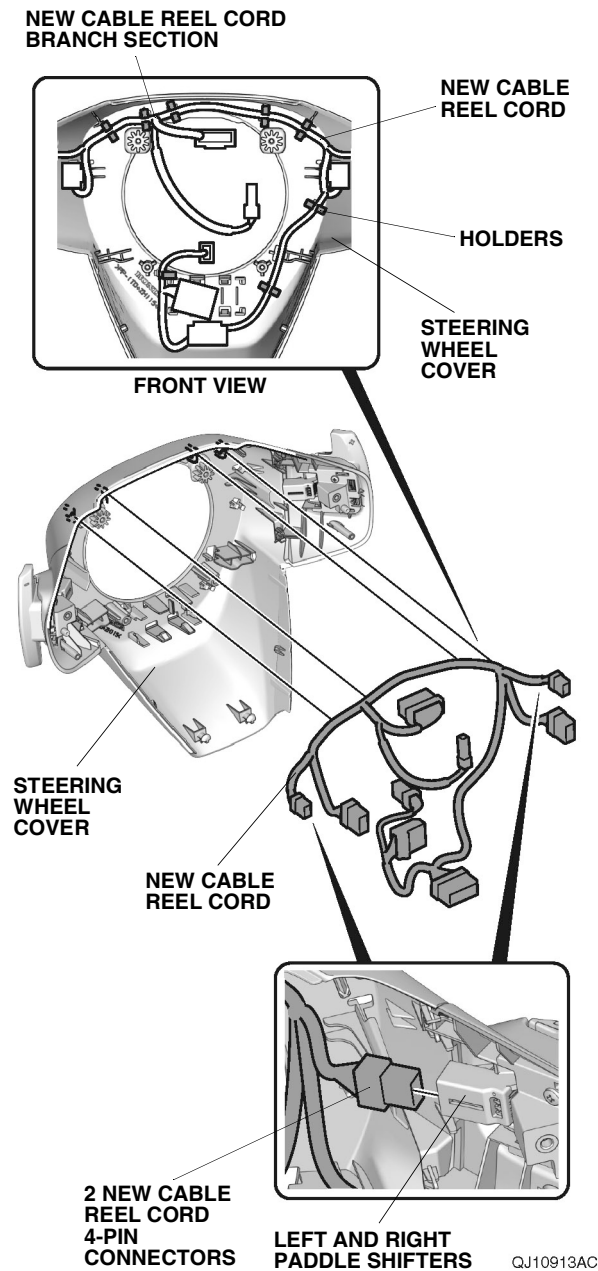

46. Secure the new steering wheel cord to the holder as shown. Plug the new cable reel cord 4-pin connector into the new steering wheel 4-pin connector, and secure the 4-pin connectors to the holder on the steering wheel cover. Install the steering wheel cover on the new steering wheel with two washer-screws removed in step 42. Go to step 55.

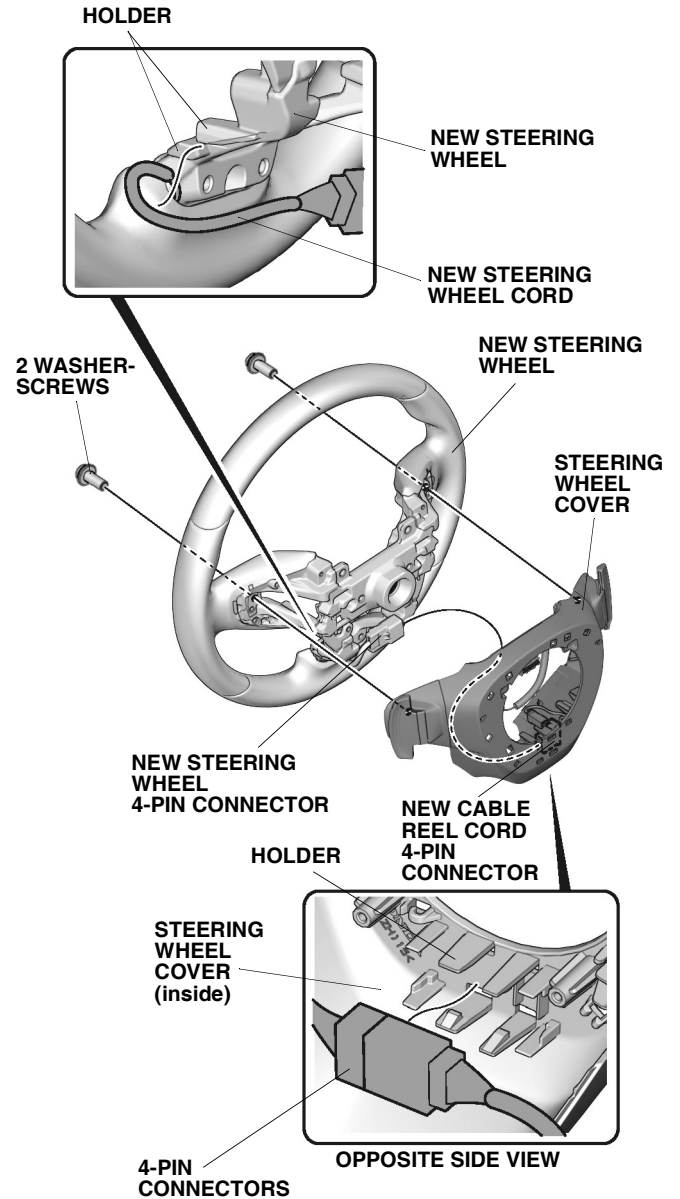

Without paddle shifters

47. Remove the steering wheel cord protector (if equipped) and steering wheel cover, and unplug the vehicle connectors.

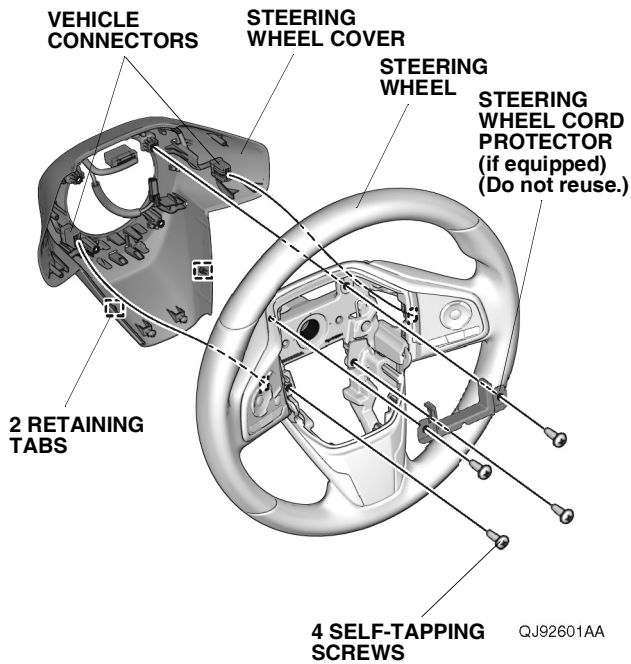

48. Using a Phillips screwdriver, push the pin on the steering wheel trim, and remove the steering wheel trim.

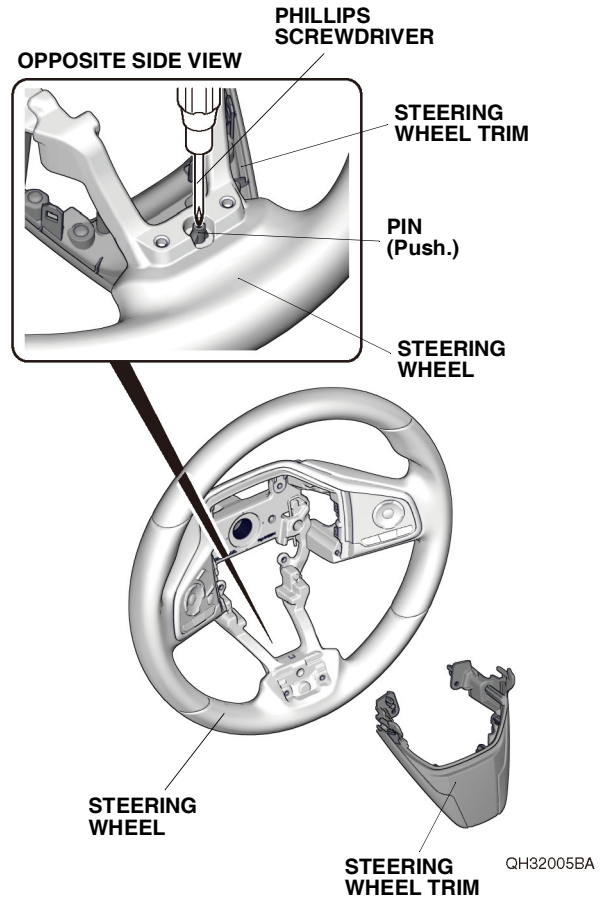

49. Using a flat-tip screwdriver, push the four pins on the switch assembly, and remove the switch assembly.
NOTE: Follow the same procedure for the differently shaped switch assembly.

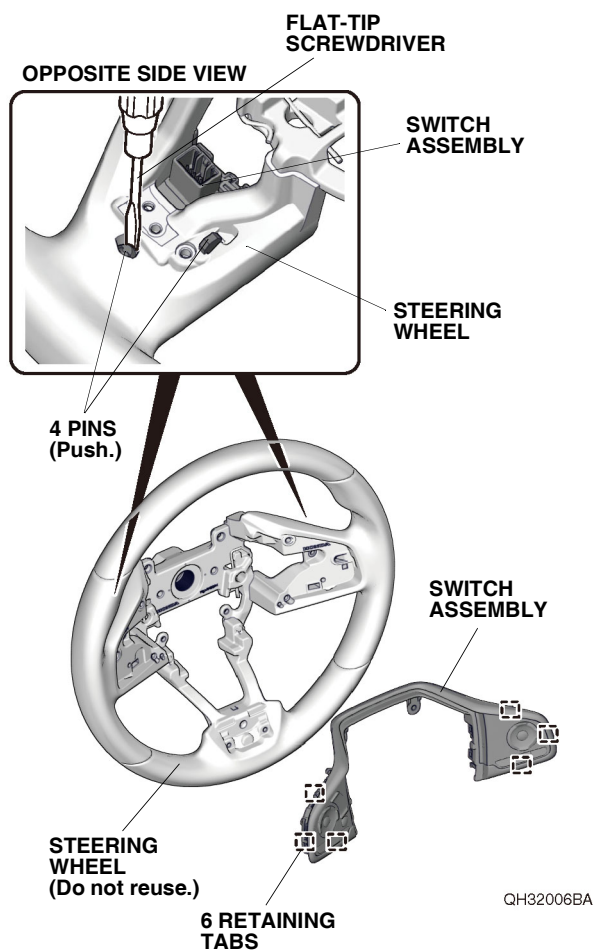

50. Remove the cable reel cord.

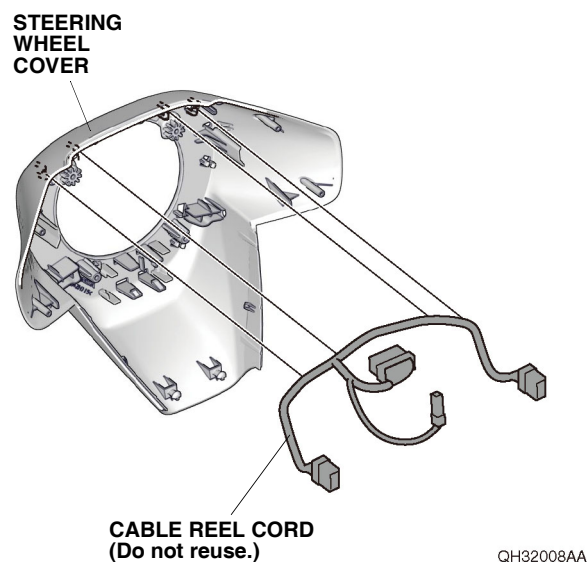

51. Cut the two new cable reel cord 4-pin connectors, and remove the tape.

NOTE:

- Make sure to cut the correct connectors.
- Be careful not to damage the new cable reel cord.

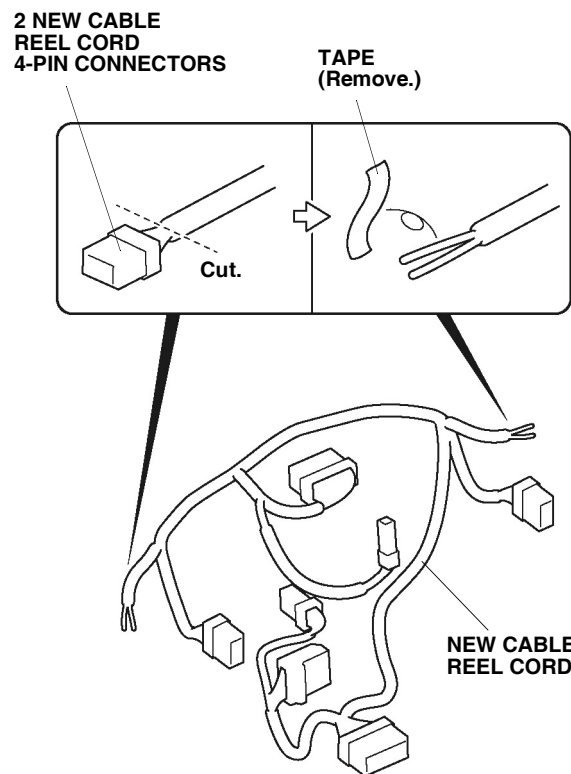

QJ11001AC

52. Wrap the new cable reel cord with electrical tape as shown, and secure it to the new cable reel cord with electrical tape as shown.

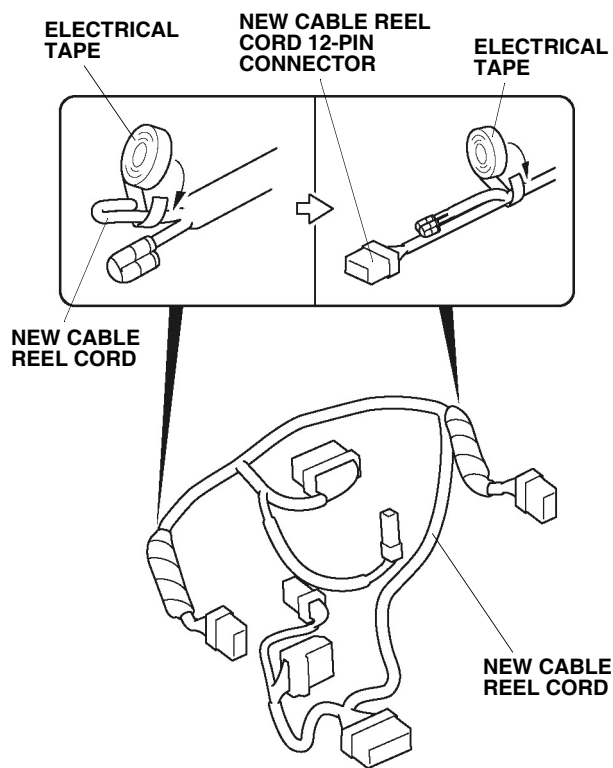

QJ11002AC

53. Install the new cable reel cord on the steering wheel cover.
- NOTE:** Make sure the cable reel cord is secured properly.

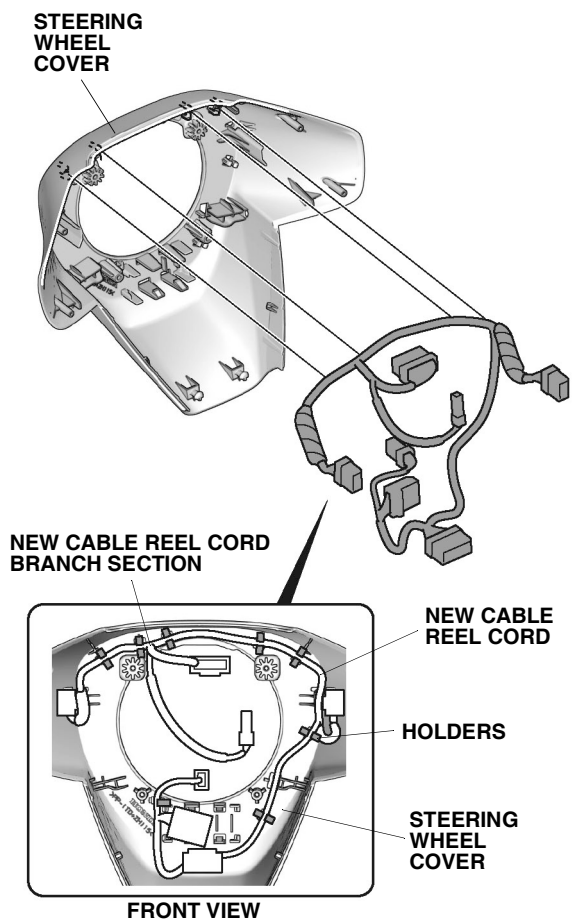

QJ11003AC

54. Secure the new steering wheel cord to the holder as shown. Plug the new cable reel cord 4-pin connector into the new steering wheel 4-pin connector, and secure the 4-pin connectors to the holder on the steering wheel cover. Install the steering wheel cover on the new steering wheel.

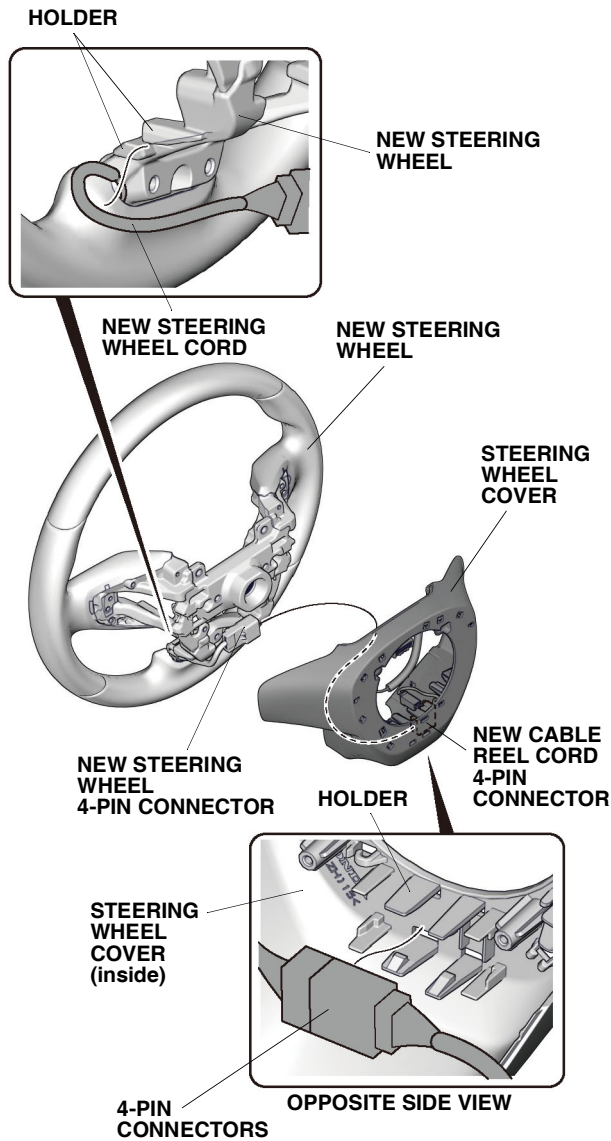

QH32010BA

55. Remove the right vehicle switch.

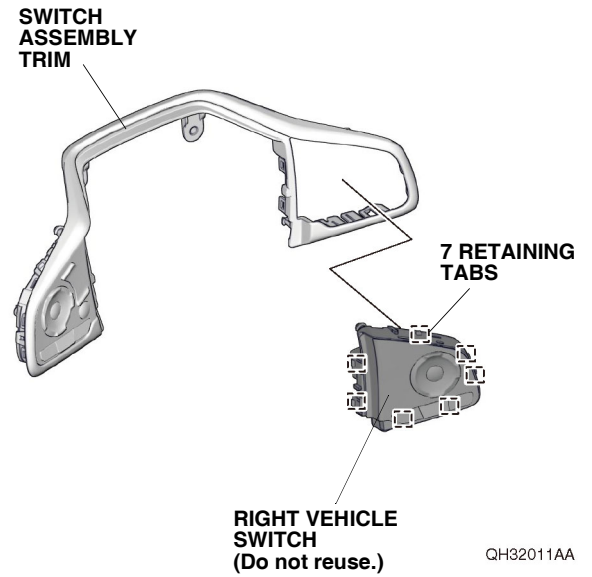

QH32011AA

56. Install the HSW switch on the switch assembly trim with seven retaining tabs.

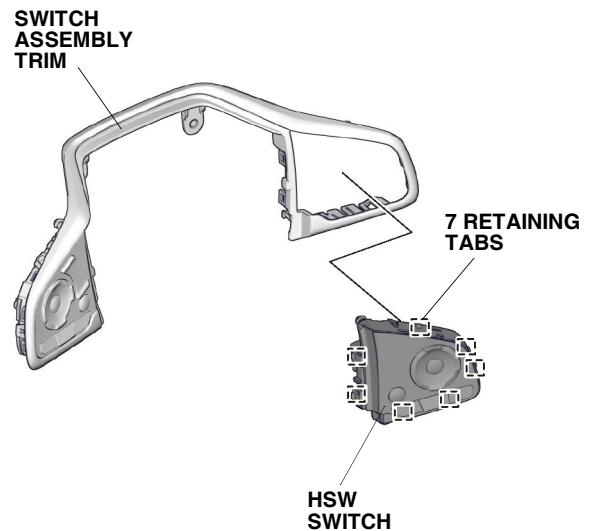

QH32012AA

57. Check the shape of the switch assembly.

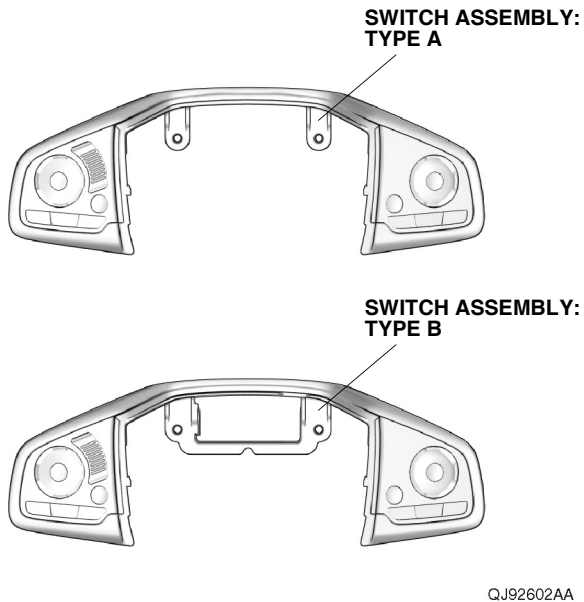

If the vehicle is equipped with the switch assembly type A, continue with step 58; otherwise, go to step 60.

With switch assembly type A

58. Plug the two new cable reel cord 12-pin connectors into the switch assembly, and install the switch assembly on the new steering wheel with six retaining tabs.

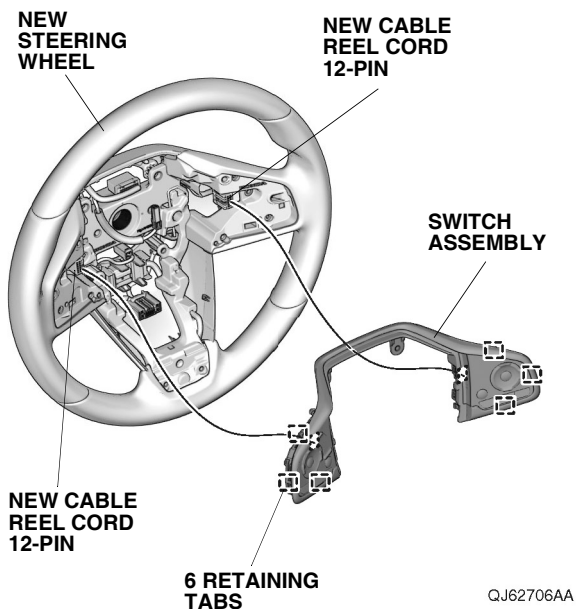

59. Install the new steering wheel cord protector on the new steering wheel with two self-tapping screws removed in step 41 or 47. Go to step 61.

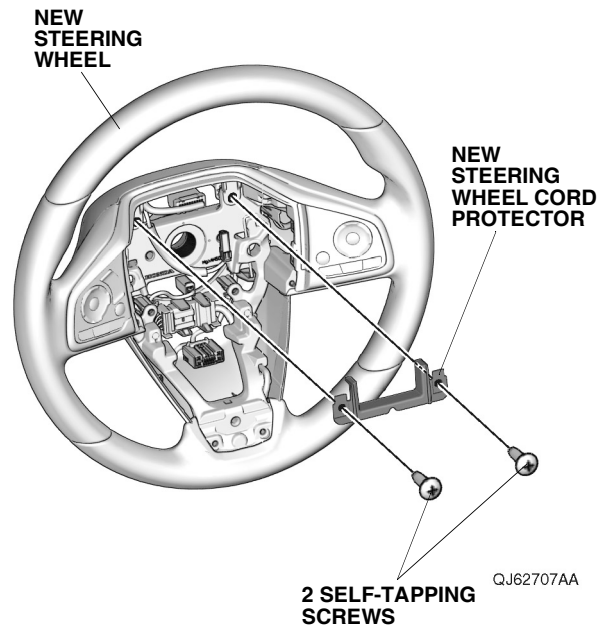

With switch assembly type B

60. Plug the two new cable reel cord 12-pin connectors into the switch assembly, and install the switch assembly on the new steering wheel with six retaining tabs and two self-tapping screws removed in step 41 or 47.

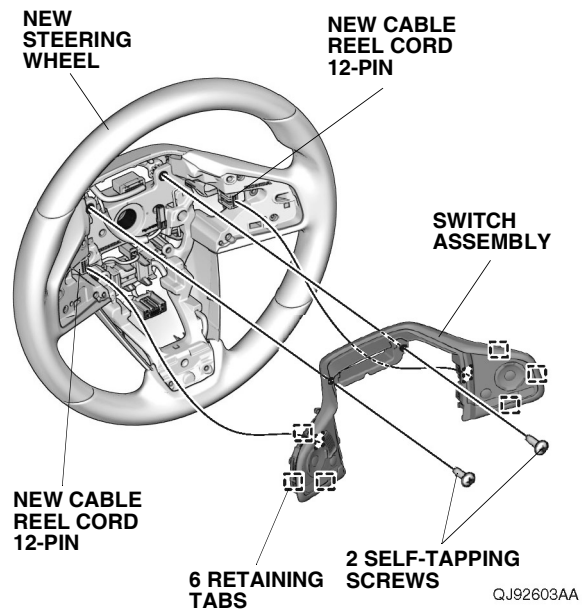

61. Install the control unit on the steering wheel trim with two self-tapping screws.

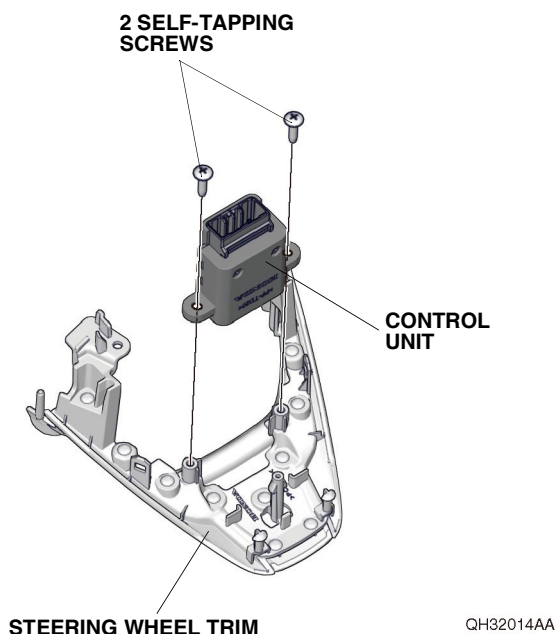

62. Plug the new cable reel cord 14-pin connector into the control unit, and install the steering wheel trim on the new steering wheel with two retaining tabs and two self-tapping screws removed in step 42 or 47.

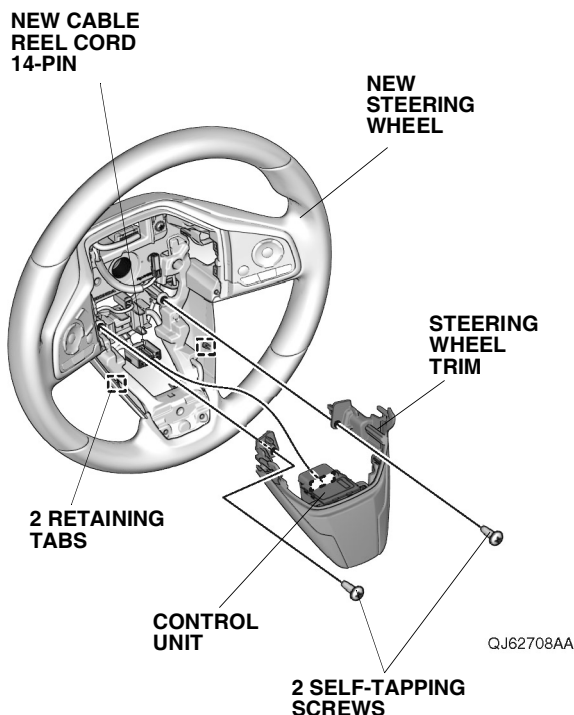

63. Install the meter, driver's dashboard inner panel, audio unit, climate control unit, driver's dashboard outer panel, driver's outlet, driver's lower ornament panel, and meter visor. Secure the upper column cover to the instrument panel with masking tape as shown.

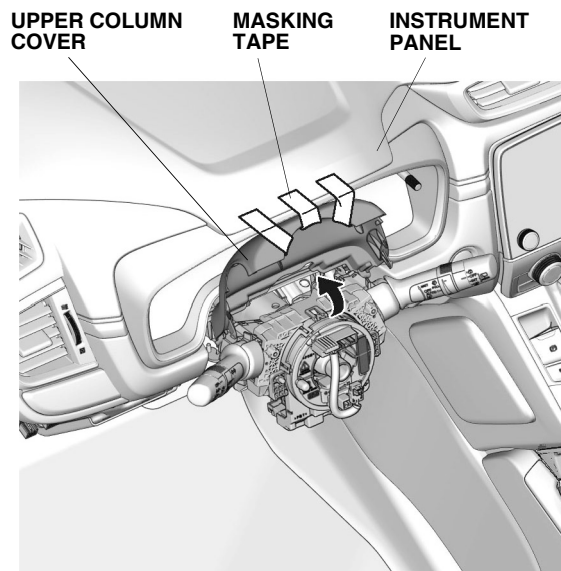

QJ11004AC

64. Remove the locking pin as shown. Before installing the new steering wheel, make sure the front wheels are still pointing straight-ahead. To confirm the new cable reel is lined up properly, rotate the new cable reel clockwise until it stops, then rotate it counterclockwise about three full turns. The arrow mark on the new cable reel label must point straight up.

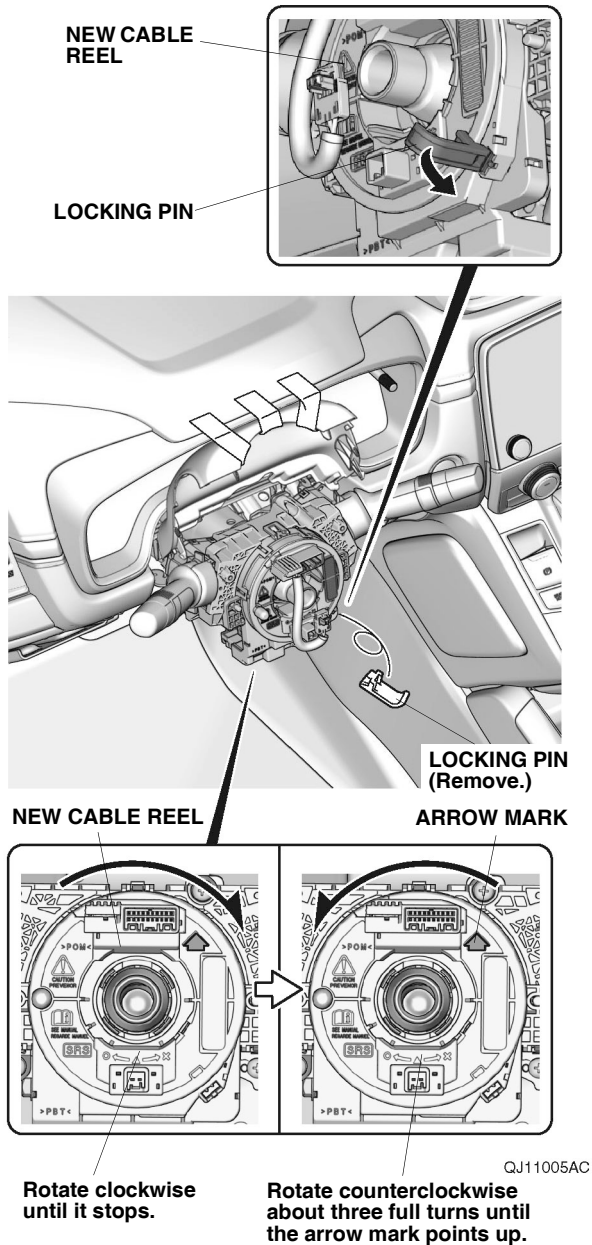

65. Install the new steering wheel onto the steering column shaft in the straight-ahead position:
- Route the new cable reel 2-pin connectors cord through the opening in the new steering wheel. **NOTICE:** The new cable reel 2-pin connectors cord must be routed under the new cable reel cord with 20-pin connector and over the new cable reel cord with 2-pin connector as shown.
 - Check that the wire harnesses are not pinched.

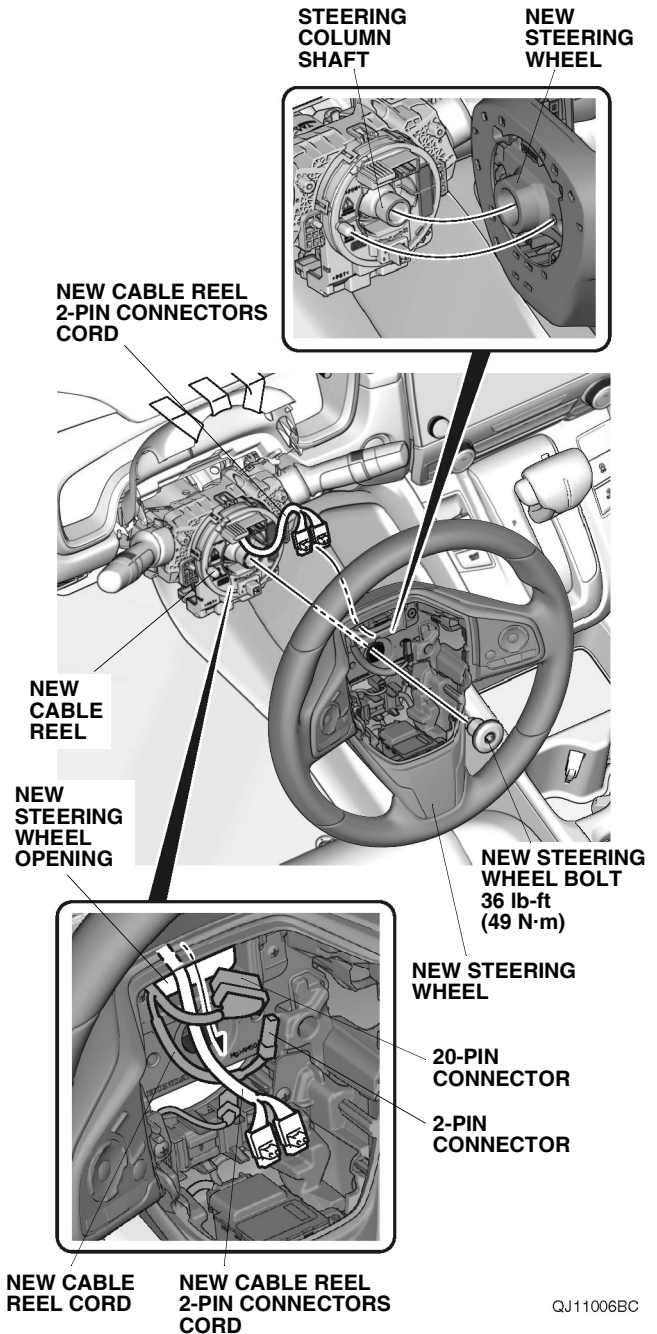

66. Install the new steering wheel bolt. Torque the new steering wheel bolt to 36 lb-ft (49 N·m). Tighten to the specified torque within 5 minutes.

67. Plug the new cable reel cord 2-pin and 20-pin connectors into the new cable reel.

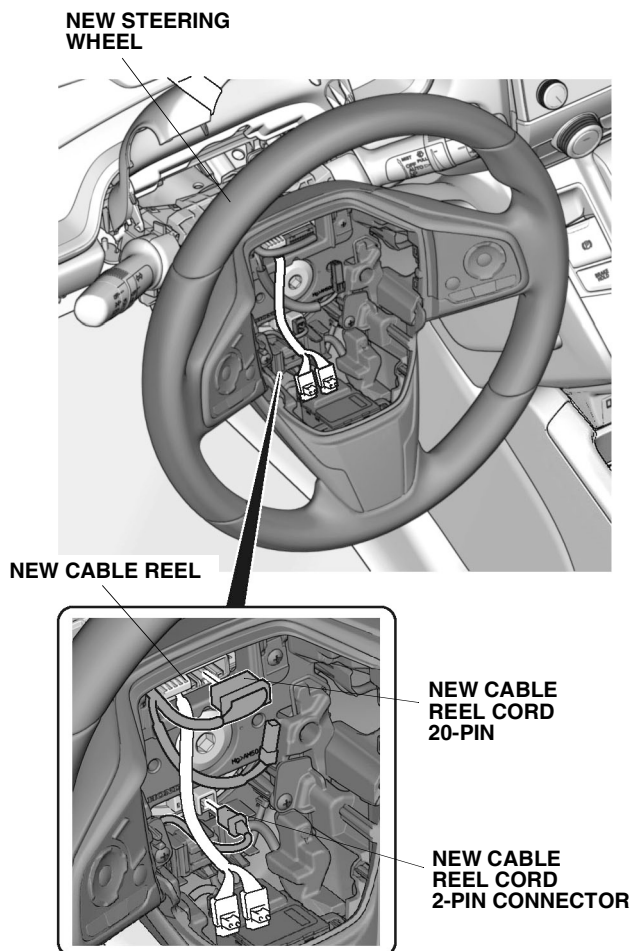

QJ92604AA

68. Plug the new cable reel cord 2-pin connector and two new cable reel 2-pin connectors into the airbag, and install the airbag on the new steering wheel.
- NOTE:** Make sure to work with reference to the service information.

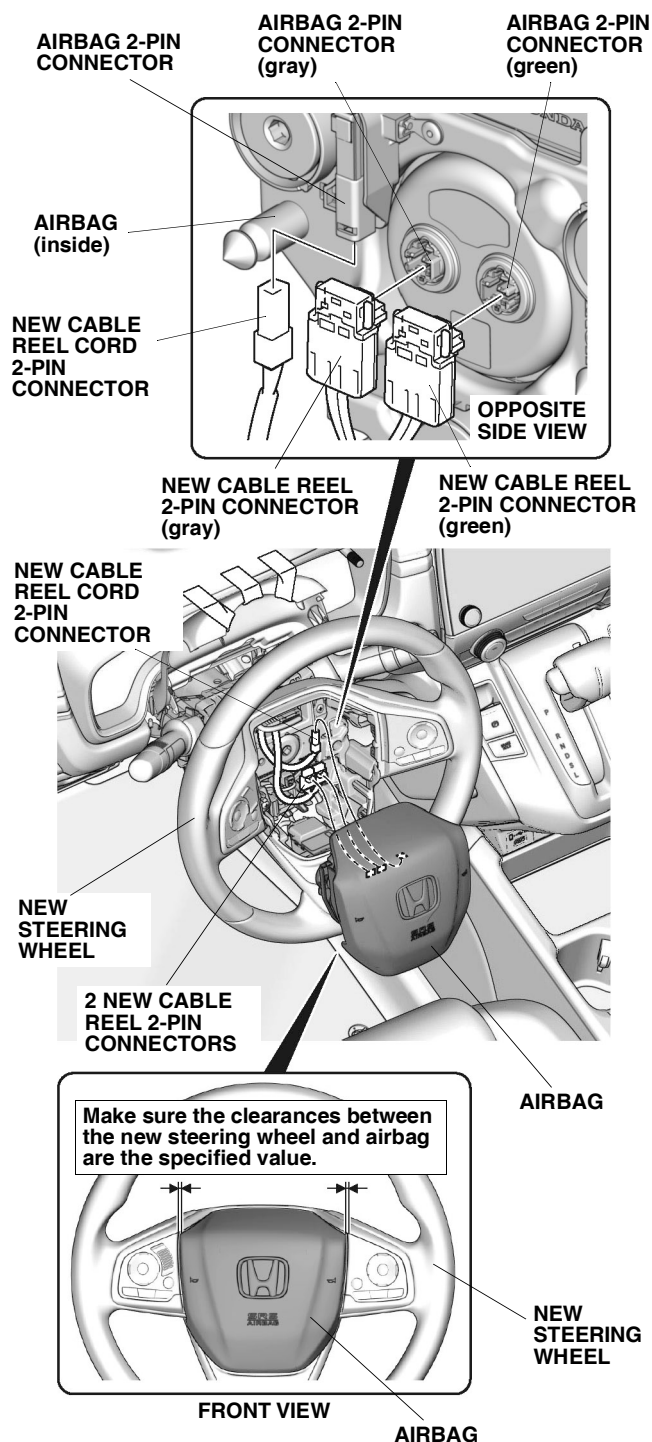

QJ11007BC

69. Check clearance around the heater harness while moving the new steering wheel up and down, back and forth.

NOTE: Adjust the heater harness if necessary.

HEATER HARNESS
(Do not stretch.)

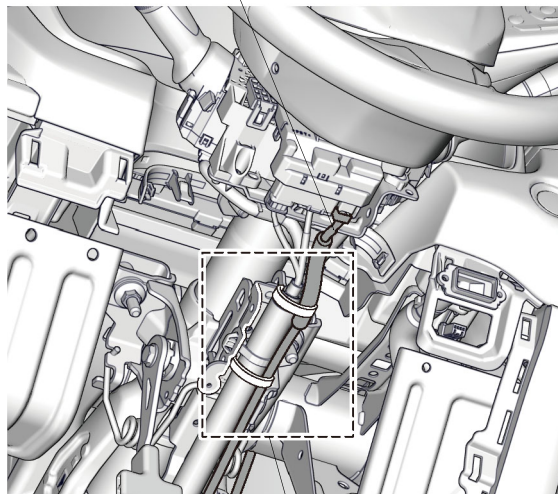

Make sure the heater harness does not interfere with the vehicle.

QF42702CA

70. Remove the vehicle 20A fuse, and install the new 10A fuse to the same slot.

FUSE BOX **20A FUSE**

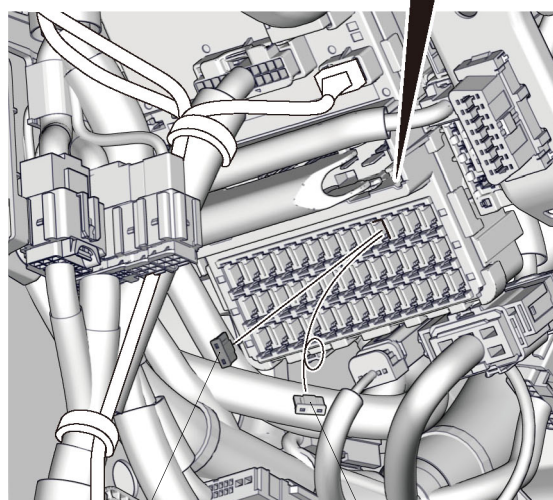
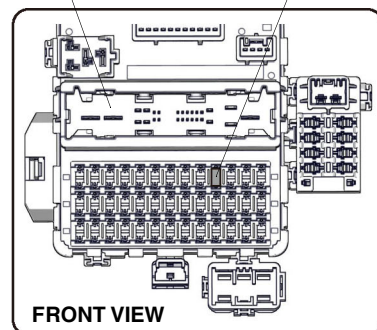

NEW 10A FUSE

VEHICLE 20A FUSE
(Do not reuse.)

QF22917AC

71. Using isopropyl alcohol on a shop towel, thoroughly clean the fuse label where the fuse label will attach. Attach the fuse label (10A HEATED STEERING) to the fuse label on the lower column cover as shown.

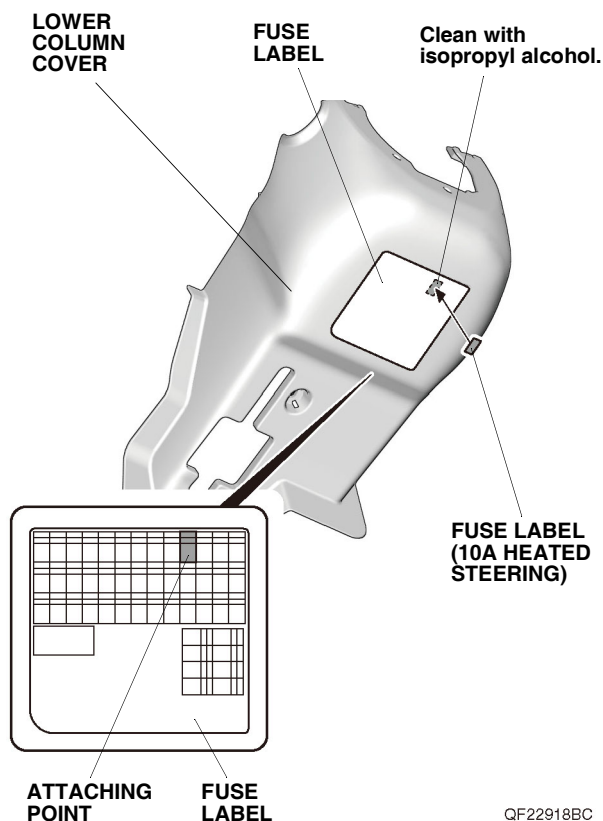

72. Install the lower column cover.

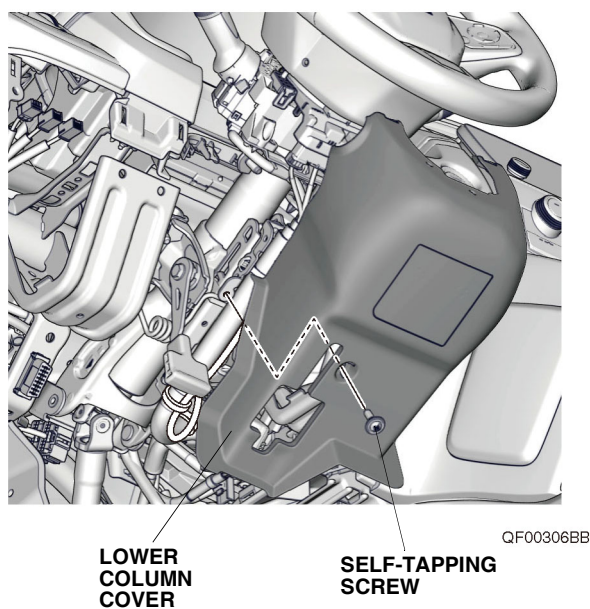

73. Connect the negative cable to the battery, then turn the engine switch to ON. Turn the new steering wheel 90° clockwise. Secure the lower column cover.

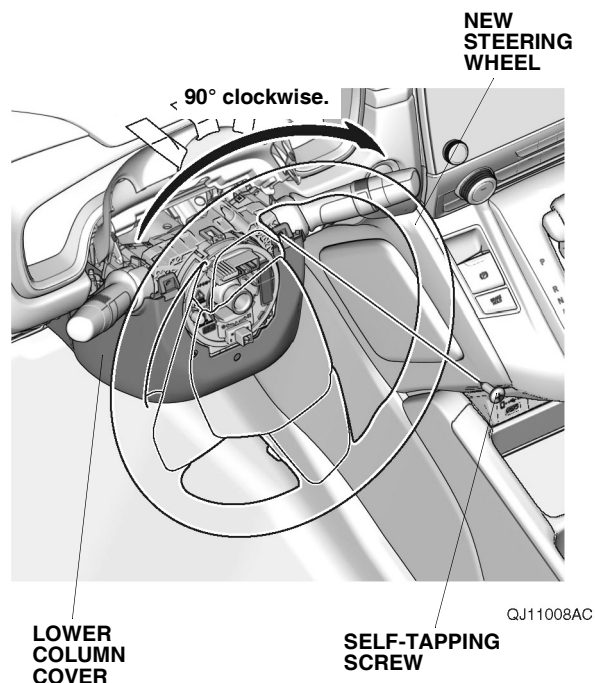

74. Turn the new steering wheel 180° counterclockwise. Secure the lower column cover.

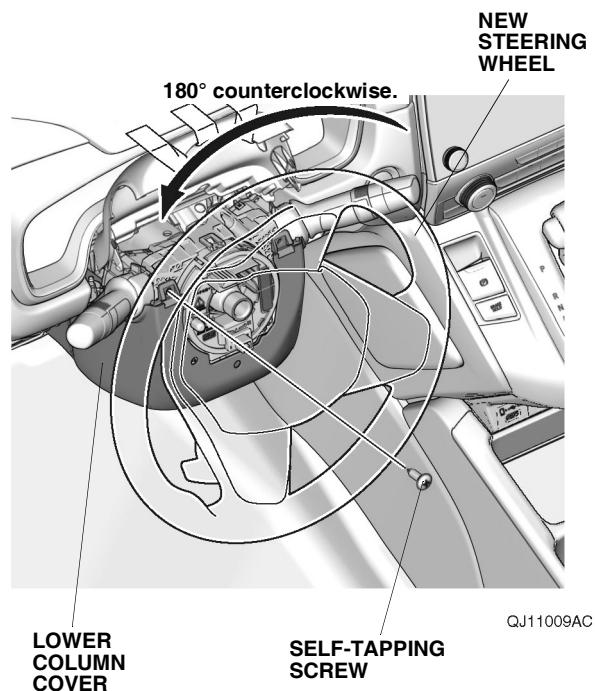

75. Turn the engine switch to OFF, then disconnect the negative cable from the battery.

76. Check that all wire harnesses are routed properly and all connectors are plugged in.
77. Install all removed parts.
78. Connect the negative cable to the battery.
79. Connect the i-HDS, and clear the DTCs.
80. Inspect the following items. If any abnormality is found, perform troubleshooting as described in the service information.
 - Turn the engine switch to ON. The SRS indicator should come on for about 6 seconds and then go off.
 - Make sure the horn and steering wheel switches work properly.
81. Press and hold the audio unit power button for 2 seconds to restore the audio and navi (if equipped) system functions.
82. Set the clock on vehicles without navigation.
83. If necessary, restore the systems back to normal operation as described in the service information.
84. Make sure the new steering wheel is in the straight-ahead position with the front wheels. If the spoke angle of the new steering wheel is not in the straight-ahead position with the front wheels, adjust the front toe as described in the service information.
85. Do the VSA sensor neutral position memorization as described in the service information.

Check the Operation of the Heated Steering Wheel

86. Check that the heated steering wheel works as described in the vehicle owner's manual.