



INSTALLATION INSTRUCTIONS

Accessory	Application	Publications No.
REAR BUMPER APPLIQUE P/N 08P48-TRT-100	2019 CLARITY (All Clarity Vehicles)	VERSION 1
		Issue Date DEC 2018

PARTS LIST

Rear bumper applique

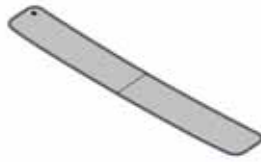

Applicator

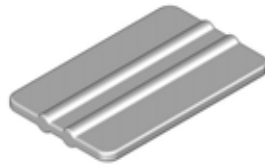

Soft sleeve



Alcohol swab



TOOLS AND SUPPLIES REQUIRED

Shop towel

Spray bottle

3M Protective tape application solution

Illustration of the Rear Bumper Applique Installed in the Vehicle

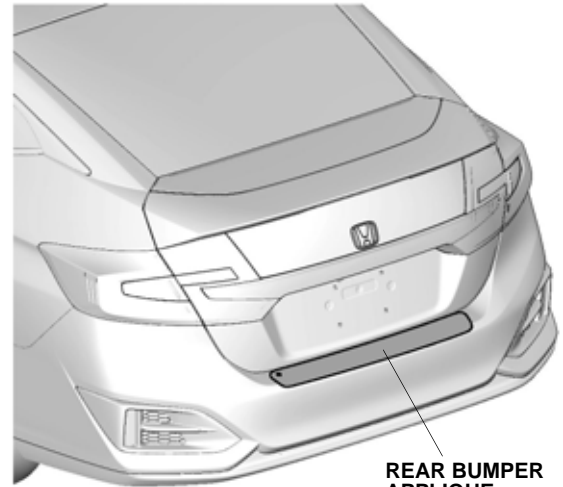

REAR BUMPER APPLIQUE

QF21501AT

INSTALLATION

Customer Information: The information in this installation instruction is intended for use only by skilled technicians who have the proper tools, equipment, and training to correctly and safely add equipment to your vehicle. These procedures should not be attempted by “do-it-yourselfers.”

NOTE:

- Be careful not to damage the paint finish.
- This rear bumper applique kit should be installed only if the ambient air temperature is 15°C (60°F) or above.
- To allow the adhesive to cure, do not wash the vehicle for 24 hours. Make sure your customer is aware of this.

1. Open the trunk lid. Use the alcohol swab to thoroughly clean the area where the rear bumper applique will attach.

REAR BUMPER APPLIQUE LOCATION
(Clean with an alcohol swab.)

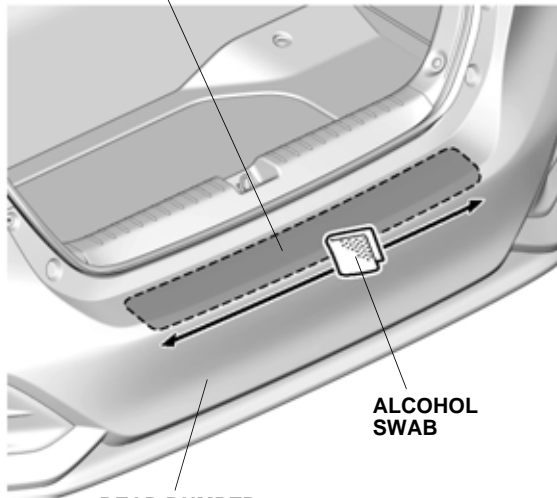

QF21502AT

2. Using a spray bottle with the 3M protective tape application solution, spray the area where the rear bumper applique will attach. Spray some solution on your hands.

Spray with the 3M protective tape application solution.

Spray with the 3M protective tape application solution.

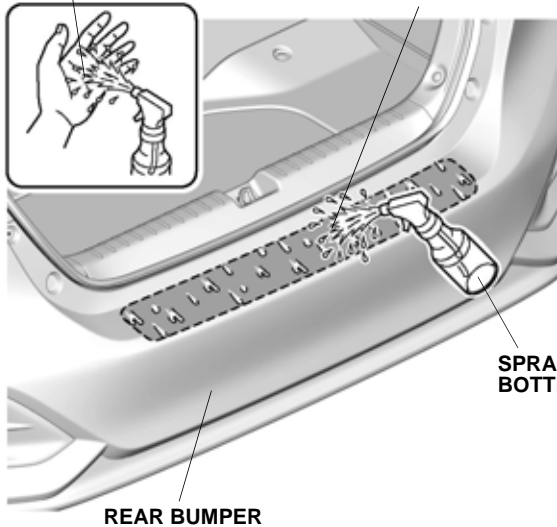

QF21504BT

3. Remove the adhesive backing from the side of the rear bumper applique with the 3M mark.

ADHESIVE BACKING
(Remove the side with the 3M mark.)

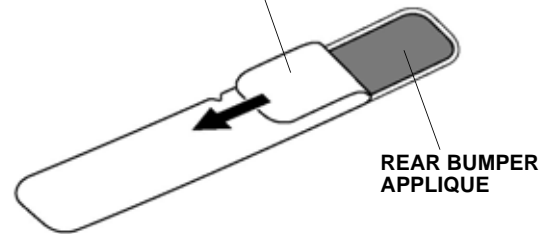

QF21505AT

4. Spray the rear bumper applique with the 3M protective tape application solution.

Spray with the 3M protective tape application

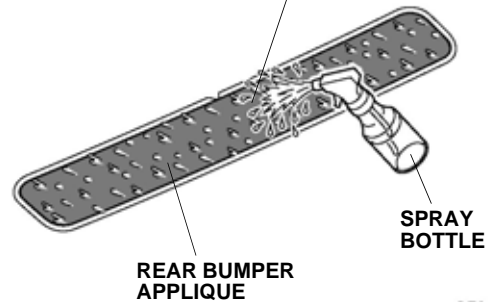

QF21506AT

5. Line up the V-notch on the rear bumper applique with the trunk lid anchor. Line up the edge of the rear bumper applique along the end of the curved surface as shown. Smooth the rear bumper applique against the rear bumper.

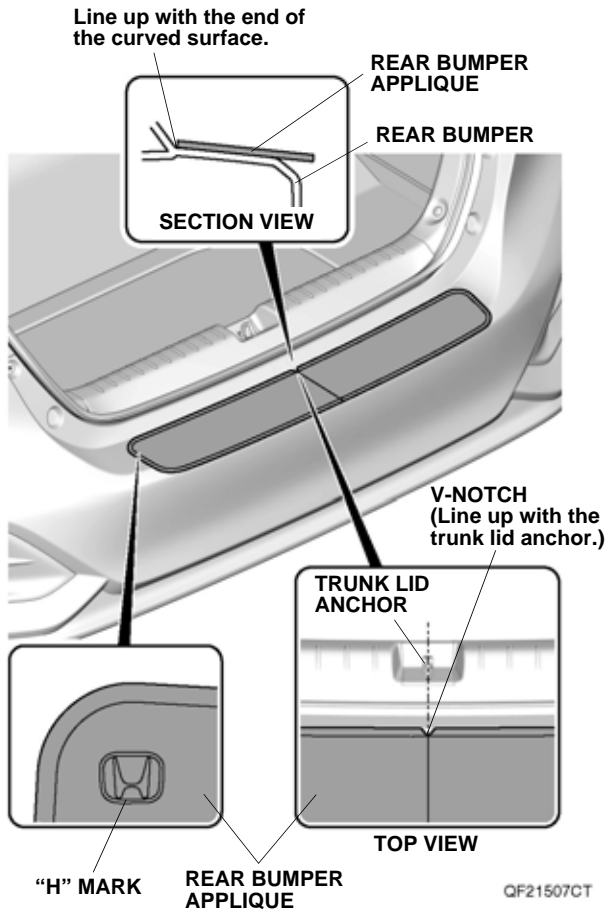

6. Insert the applicator into the soft sleeve.

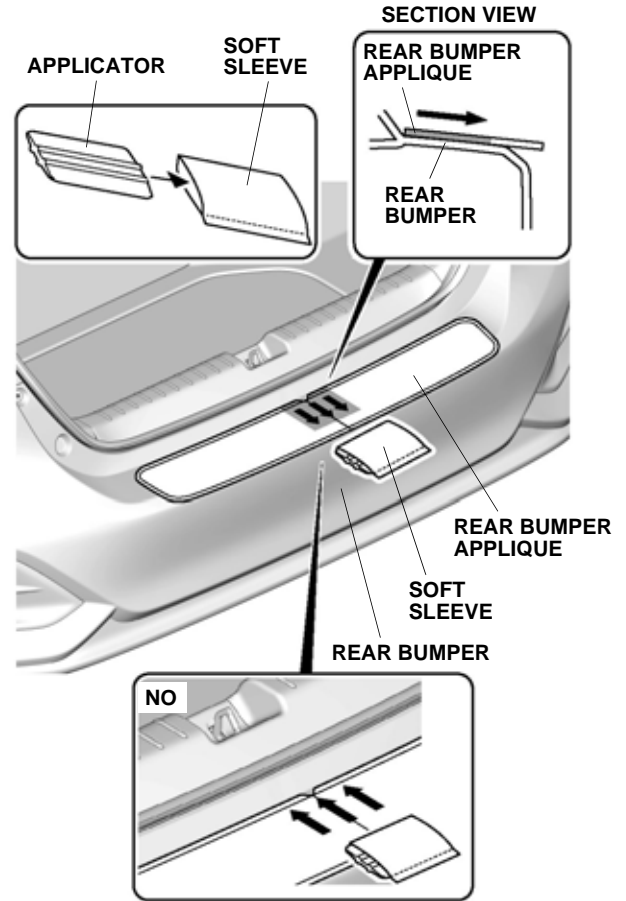

7. Starting from the front and working rearward, use the soft sleeve to smooth out the center of the upper section on the rear bumper applique. Move the soft sleeve in one direction only. If you see an air bubble, stop and gently peel up that section to work out the bubble. Work slowly and keep pressure against the rear bumper applique.

8. Starting from the center and working outward, use the soft sleeve to smooth out the left and right sides of the upper section on the rear bumper applique. Move the soft sleeve in one direction only. If you see an air bubble, stop and gently peel up that section to work out the bubble. Work slowly and keep pressure against the rear bumper applique.

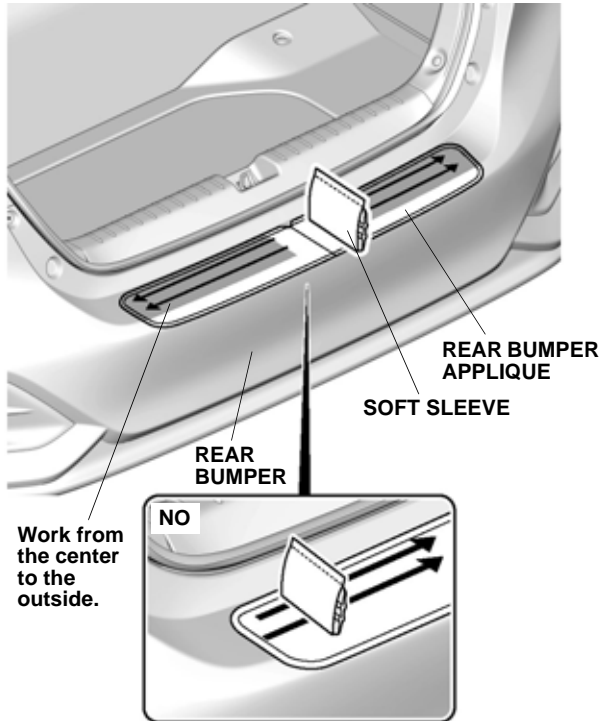

9. Slowly remove the protective film from the rear bumper applique.
NOTE: Do not pull up on the protective film.

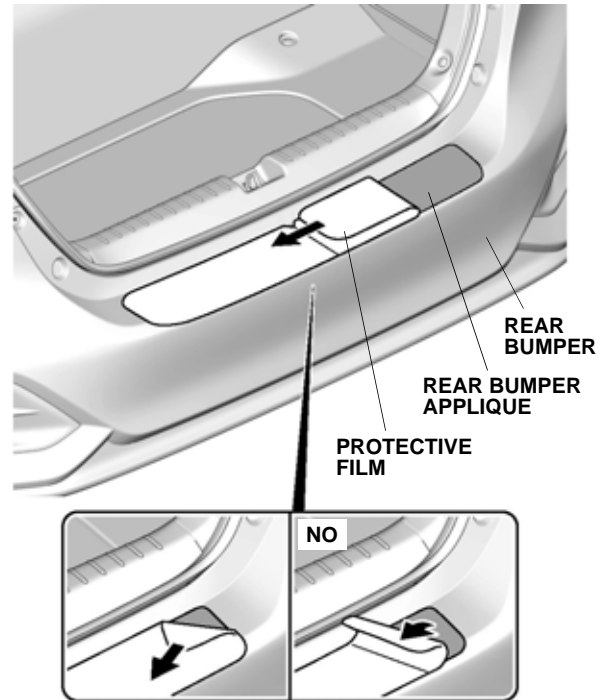

10. Repeat step 7 at the center of the lower section on the rear bumper applique.

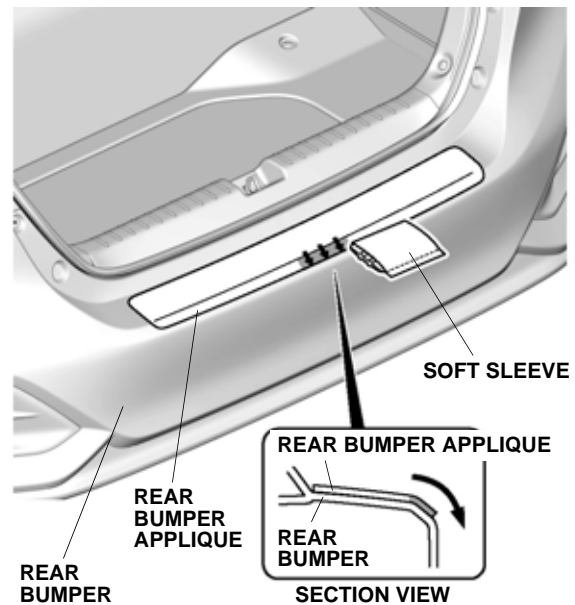

11. Repeat step 8 at the left and right sides of the lower section on the rear bumper applique.

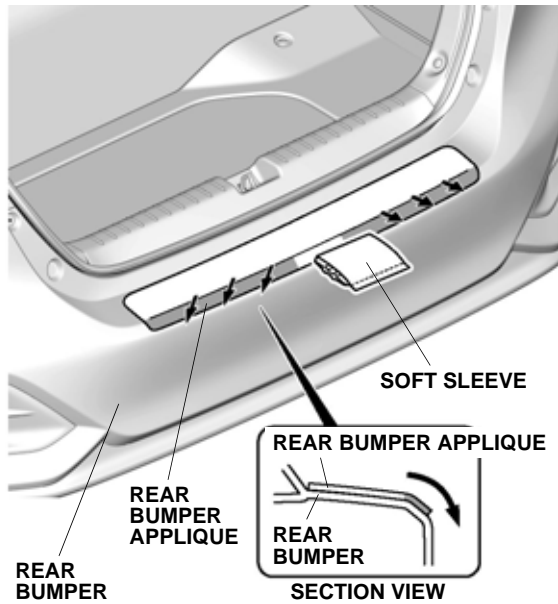

QF21512CT

12. Using a shop towel, wipe up the 3M protective tape application solution. Allow the rear bumper applique to dry thoroughly.

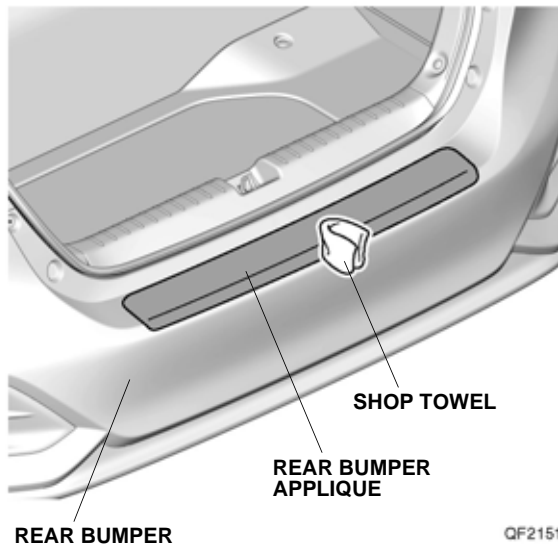

QF21513BT