

Germain Honda of College Hills



INSTALLATION INSTRUCTIONS

Accessory

SHIFT LEVER KNOB

Application

2023 CIVIC TYPE R
MODEL SERIES

Publications No.

VERSION 1

Issue Date

OCT 2022

GENERAL VIEW

SHIFT LEVER KNOB

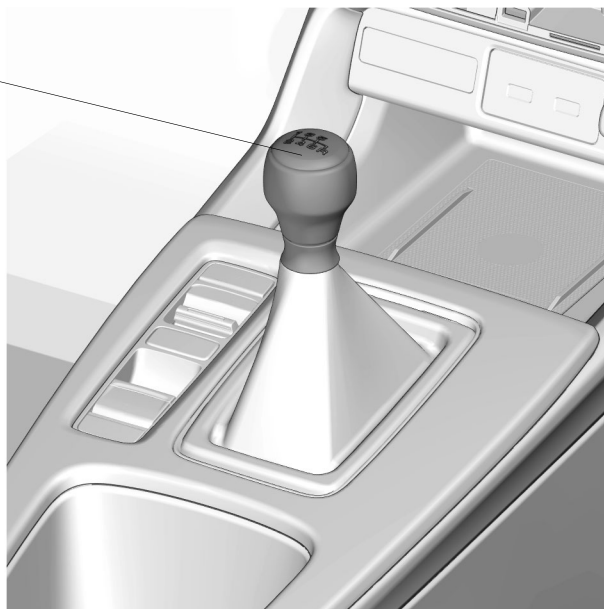

QM10201AT

FOR YOUR SAFETY (Read carefully.)

Warning Symbols

Safety: Your safety, and the safety of others, is important. To help you make informed decisions about service procedures, we have provided safety messages where appropriate. Of course, it is not practical or possible to warn you about all the hazards associated with servicing a vehicle - you must use your own good judgment.

You will find important safety messages preceded by one of the following symbols:

*All symbols are not used in all installation instructions.



DANGER

You will be killed or seriously hurt if you do not follow the instructions.



WARNING

You can be killed or seriously hurt if you do not follow the instructions.



CAUTION

You can be hurt if you do not follow the instructions.

NOTICE

Gives advice to prevent damage to the product, vehicle, the environment or other property.

NOTE

Gives helpful information or instructions to be followed when installing this product.

Germain Honda of College Hills



Indicates a prohibited action.

Procedure and Location Icons

These icons indicate the work location and the worker's point of view.

*All icons are not used in all installation instructions.

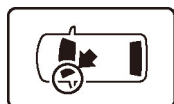

The location on the vehicle.

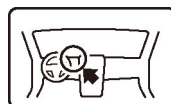

The location in the vehicle.
(Instrument panel.)



Wear eye protection.



Wear heavy gloves.



Use an assistant.



Place the part on a blanket.



Work perpendicular.



Remove any burrs.



Use touch-up paint and allow to dry.



Tighten to the specified torque.



Apply firm pressure while rolling, especially at the ends, to set the adhesive.



Press firmly.



Clean with isopropyl alcohol.



Return the original part to the customer.
(Do not reuse.)

Safety: General

- Observe all safety notes and precautions described in the service information, in addition to those described in this Installation Instruction. Be extremely careful for your safety and the safety of others.
- Be careful not to damage the vehicle or the parts.
- Note the locations of the parts before removing them so they can be properly installed in their original positions.
- The illustrations may differ slightly from the actual accessory.

Germain Honda of College Hills

Safety: Accessory

Always use the parts and tools specified in the installation instructions.

PARTS LIST

Shift Lever Knob Kit (P/N 08U92-T60-100)

Shift lever knob



Germain Honda of College Hills

REQUIRED TOOLS AND SUPPLIES

- 14 mm Open end wrench
- Torque wrench

INSTALLATION

1. Lower the shift lever boot.

Germain Honda of College Hills

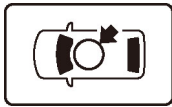

SHIFT LEVER BOOT

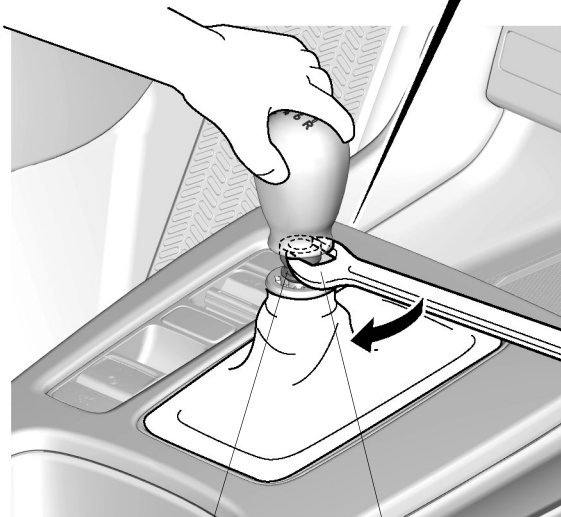

NUT
(Loosen.)

14 mm
OPEN END
WRENCH

QM10202AT

2. Loosen the nut.
3. Remove the shift lever knob.

Germain Honda of College Hills



QM10203AT

4. Install the new shift lever knob.

Germain Honda of College Hills

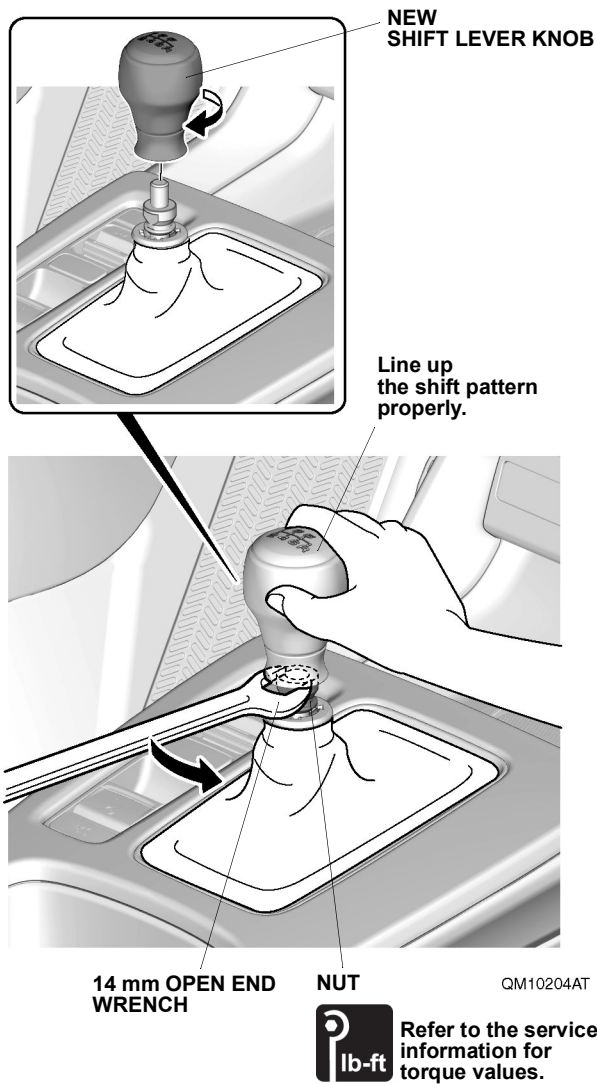

5. Secure the shift lever boot.

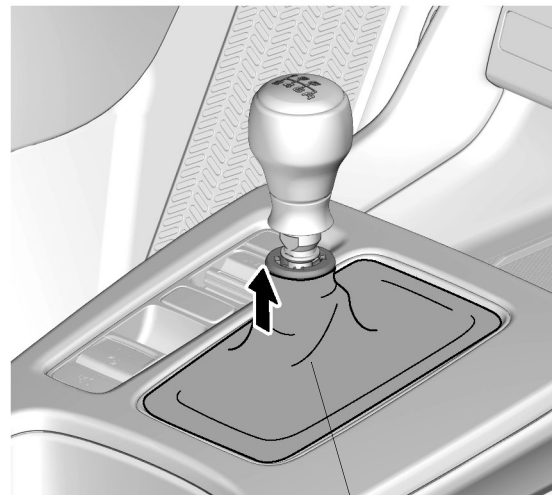

6. Make sure the shift lever and shift lever knob operate properly in all gear positions.

Please give your customer a copy of this page.

SHIFT LEVER KNOB

Use and Care

- Do not use volatile solvent (thinner, benzine, alcohol, gasoline, etc.). It may cause discoloration or stain.
- Using a soft cloth with mild soap and water, clean the shift lever knob, then wipe with a soft damp towel.