



INSTALLATION INSTRUCTIONS

Accessory

SIDE UNDER SPOILERS

Application

2022 CIVIC

Publications No.

All

Issue Date

JUN 2021

GENERAL VIEW

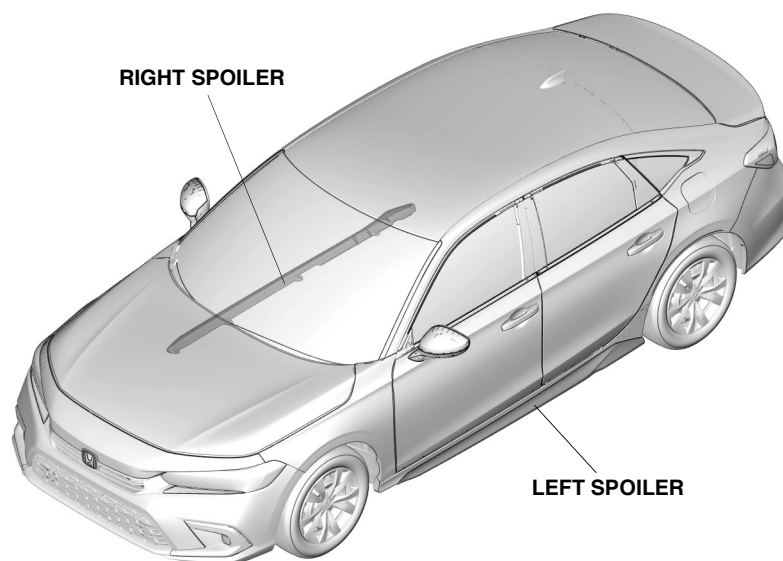

QK50101AT

FOR YOUR SAFETY (Read carefully.)

Warning Symbols

Safety: Your safety, and the safety of others, is important. To help you make informed decisions about service procedures, we have provided safety messages where appropriate. Of course, it is not practical or possible to warn you about all the hazards associated with servicing a vehicle - you must use your own good judgment.

You will find important safety messages preceded by one of following symbols:

*All symbols are not used in all installation instructions.

⚠ DANGER

You will be killed or seriously hurt if you do not follow the instructions.

⚠ WARNING

You can be killed or seriously hurt if you do not follow the instructions.

⚠ CAUTION

You can be hurt if you do not follow the instructions.

NOTICE

Gives advice to prevent damage to the product, vehicle, the environment or other property.

NOTE

Gives helpful information or instructions to be followed when installing this product.



Indicates a prohibited action.

Procedure and Location Icons

These icons indicate the work location and the worker's point of view.

*All icons are not used in all installation instructions.

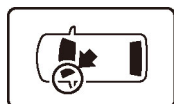

The location on the vehicle.

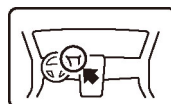

The location in the vehicle.
(instrument panel.)



Wear eye protection.



Wear heavy gloves.



Use an assistant.



Place the part on a blanket.



Work perpendicular.



Remove any burrs.



Use touch-up paint and allow to dry.



Tighten to the specified torque.



Apply firm pressure while rolling, especially at the ends, to set the adhesive.



Press firmly.



Clean with isopropyl alcohol.



Return the original part to the customer.
(Do not reuse.)

Safety: General

- Observe all safety notes and precautions described in the service information, in addition to those described in this Installation Instruction. Be extremely careful for your safety and the safety of others.
- Be careful not to damage the vehicle or the parts.
- Be extremely careful when handling retaining tabs and clips.
- Note the locations of the parts before removing them so they can be properly installed in their original positions.
- The illustrations may differ slightly from the actual accessory.

Safety: Accessory

- Always use the parts and tools specified in the installation instructions.
- Do not install the accessory on a dirty surface or in direct sunlight.
- Make sure the ambient air temperature is 60°F (15°C) or above when installing accessories that use adhesive material.
- When pressing the accessory firmly with the palm of your hand, be careful not to damage it or the vehicle.

- When applying adhesive material, make sure it is lined up properly before attaching. Once the adhesive material touches the surface, do not try to remove it. If you do, you could damage the part.
- Do not wash the vehicle for 24 hours to allow the adhesive to cure.

PARTS LIST

Side Under Spoilers Kit (P/N 08F04-T20-100)

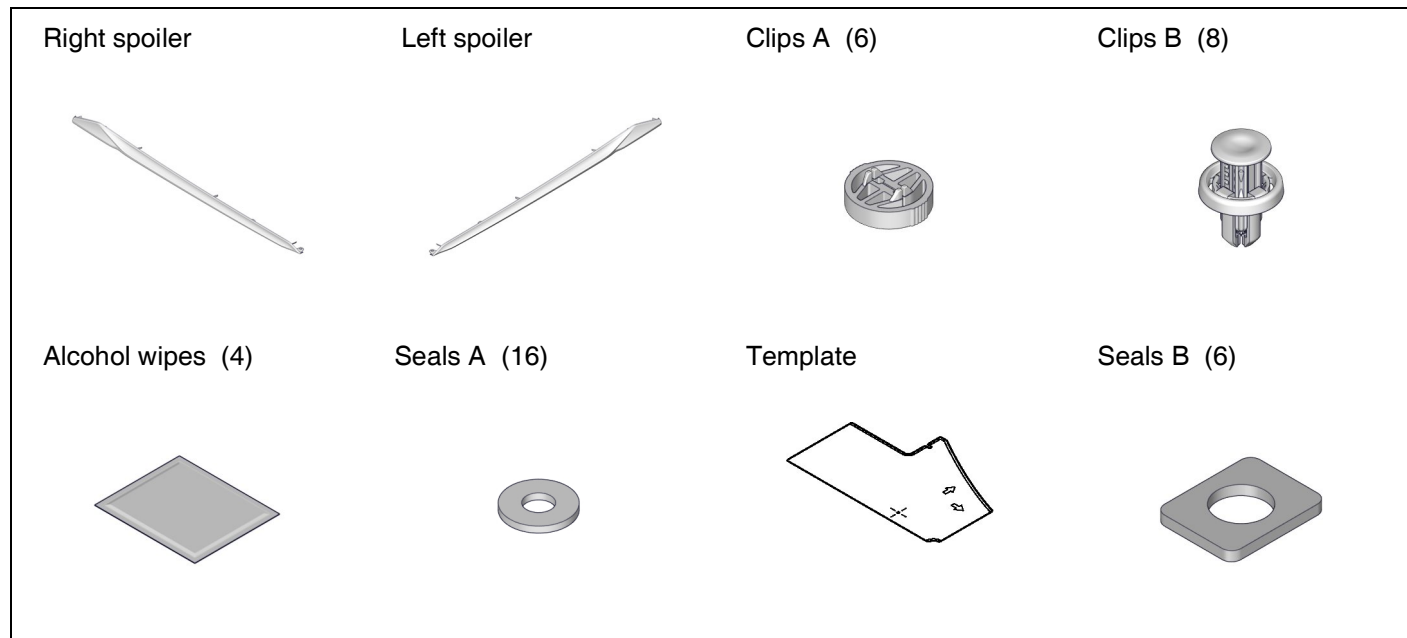

REQUIRED TOOLS AND SUPPLIES

- | | | |
|---|----------------|--|
| • Phillips screwdriver | • File | • Pushpin |
| • Stubby Phillips screwdriver | • Masking tape | • Diagonal cutters |
| • Blanket | • Drill | • 3 mm, 6 mm, 8 mm, and 10 mm Drill bits |
| • Eye protection
(face shield, safety goggles, etc.) | | |

The following tools are available through the Honda Tool and Equipment Program:

- Trim Tool Set (T/N SOJATP2014)
- Rubber Roller (T/N MHLE5)

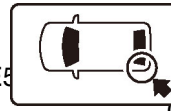

Plastic Trim Tool
(T/N SILTRIMTL10)

INSTALLATION

1. Turn the steering wheel fully counterclockwise.

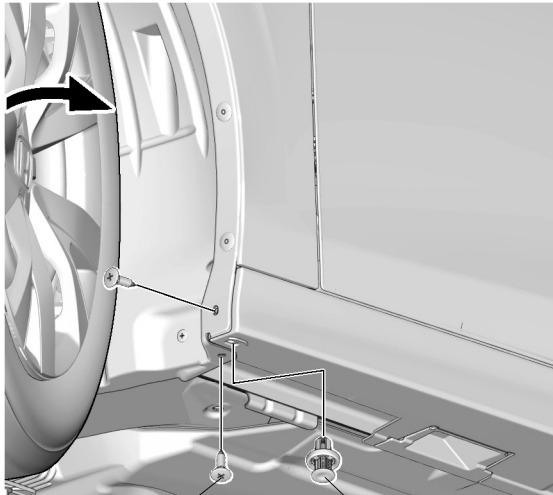

2 SELF-TAPPING
SCREWS

CLIP

QK50102BT

2. Remove the self-tapping screws and clip.
3. Remove the self-tapping screws.

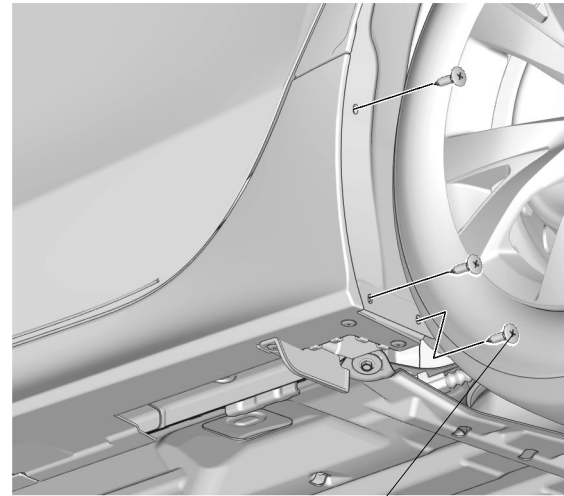

3 SELF-TAPPING
SCREWS

QK50103AT

4. Remove the clips.

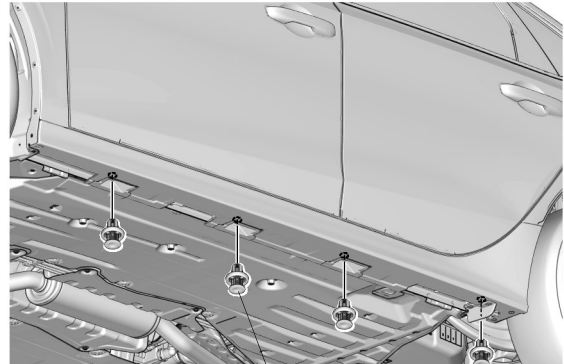
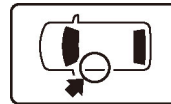

4 CLIPS

QK50124AT

5. Remove the left side sill trim.

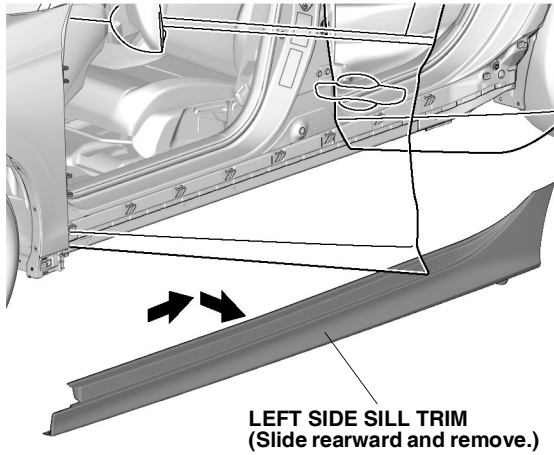

QK50104AT

6. Remove the left side inner sill trim.

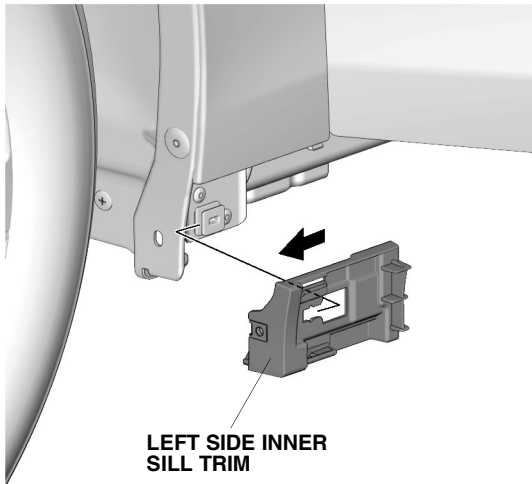
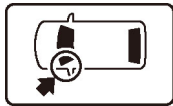

QK50105AT

7. Remove the clips.

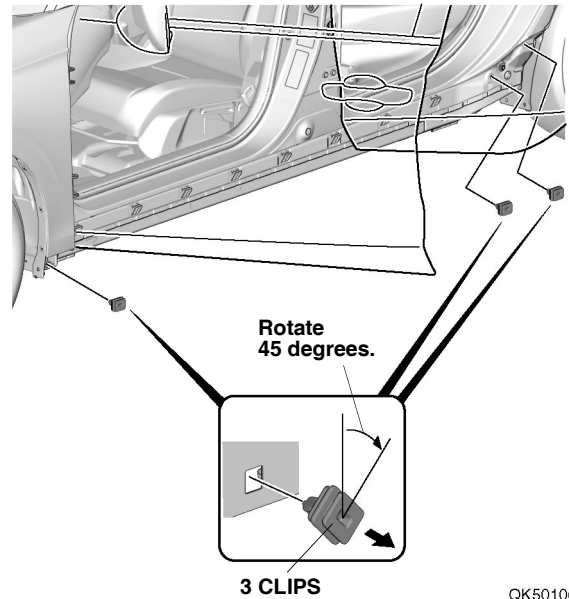
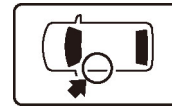

QK50106AT

8. Remove the clips.

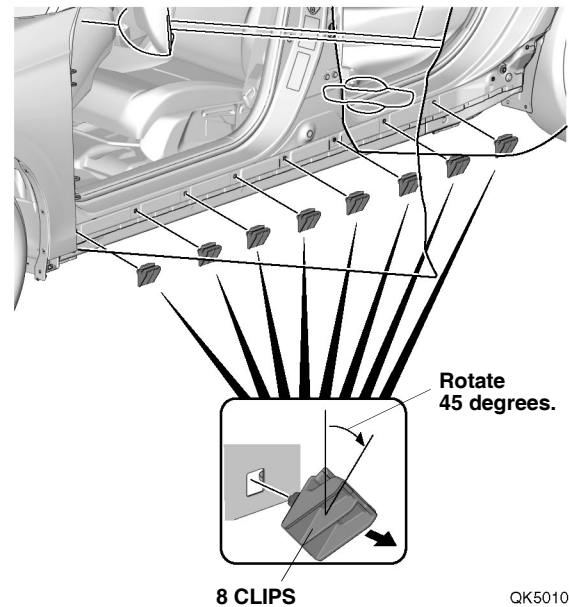

QK50107AT

9. Replace the seals A.

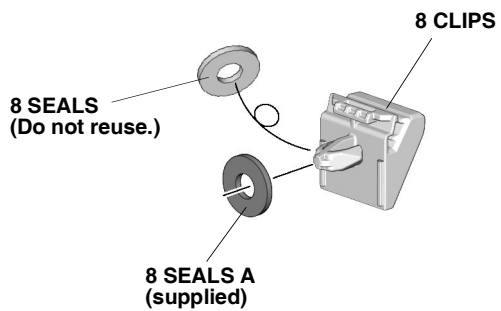

QK50108AT

10. Replace the seals B.

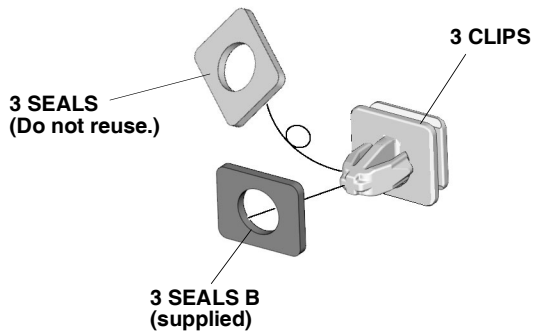

QK50125AT

11. Secure the template.

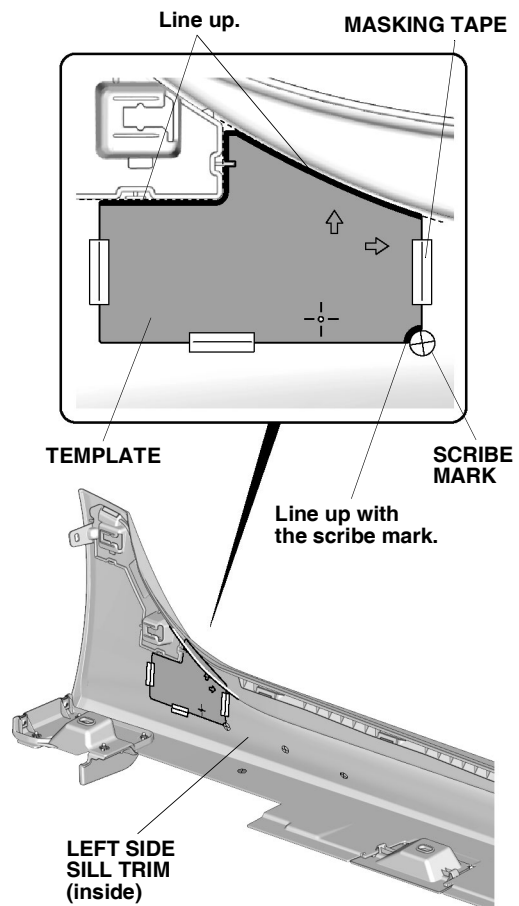

QK50109AT

12. Pierce the left side sill trim.

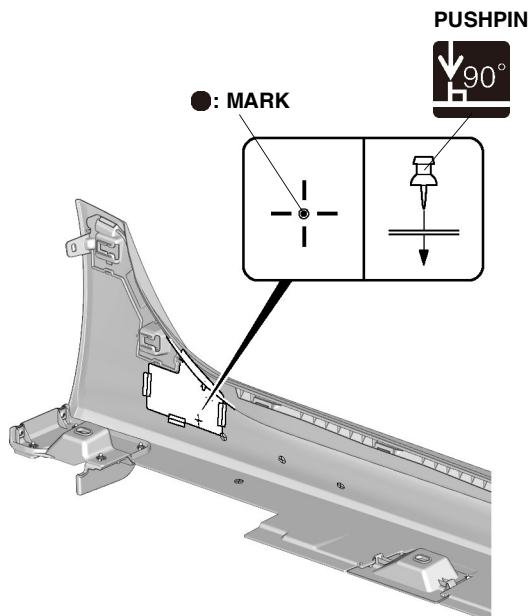

13. Pierce the left side sill trim.

NOTE

Make sure to locate the correct scribe mark.

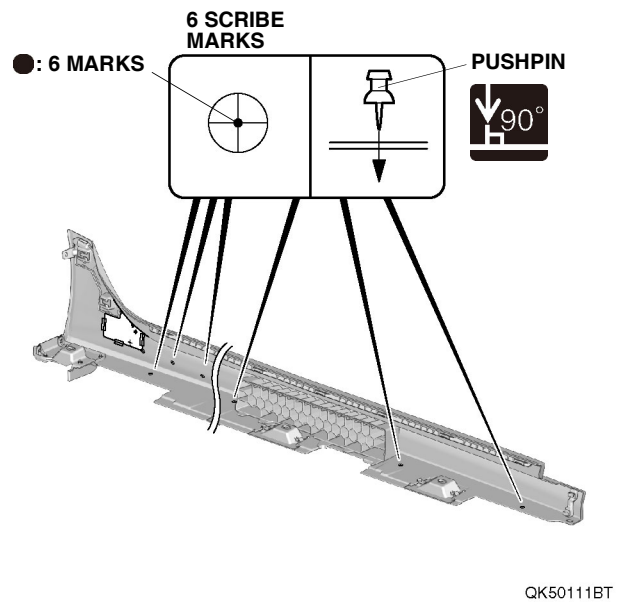

14. Remove the template.

15. Drill the left side sill trim.

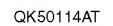
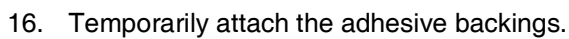

17. Clean the left side sill trim.

Allow to dry thoroughly.

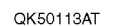

18. Install the left spoiler.

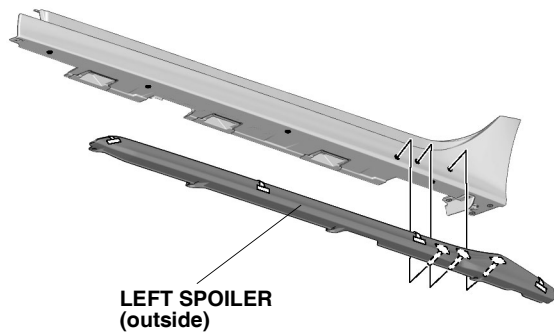

QK50115AT

19. Loosely secure the left spoiler.

NOTE

Make sure to install clip A in the correct orientation.

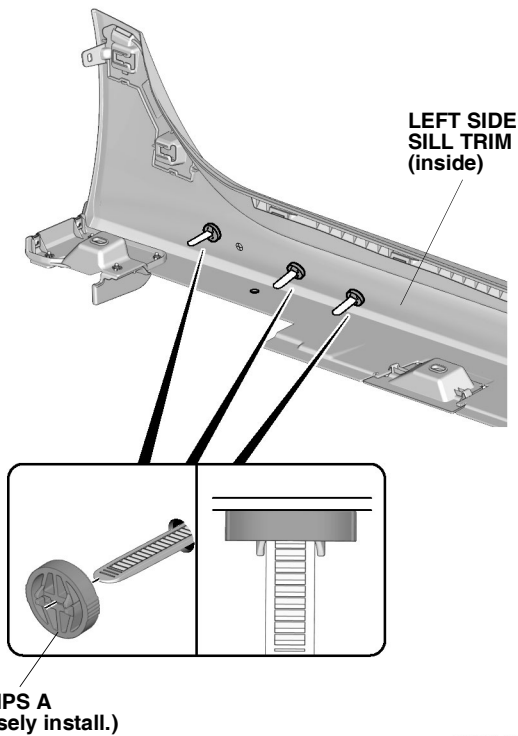

QK50117AT

20. Secure the left spoiler.

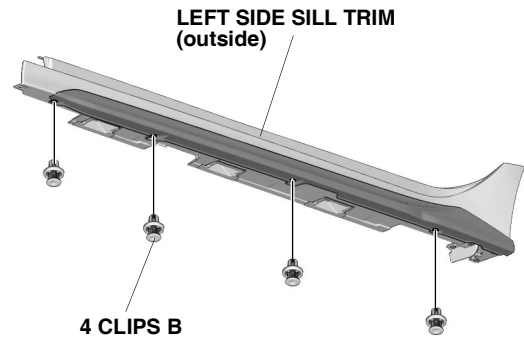

QK50119AT

21. Secure the left spoiler.

NOTE

Do not excessively push in the clips. Make sure to adjust the clips to install the spoiler.

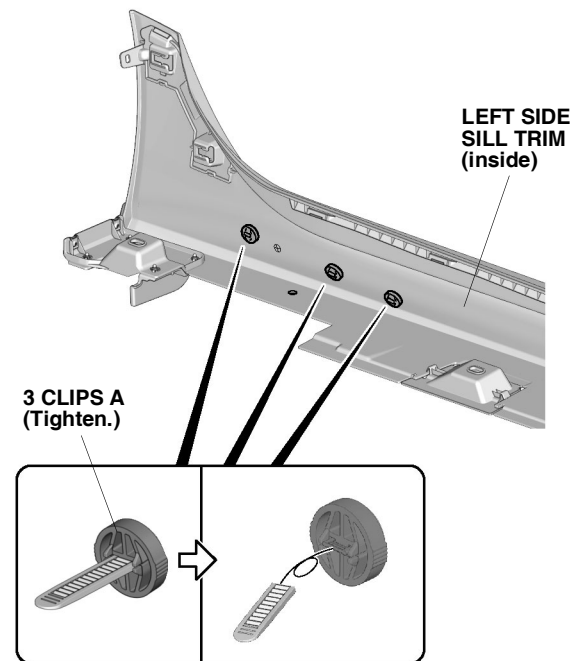

QK50118AT

22. Install the clips.

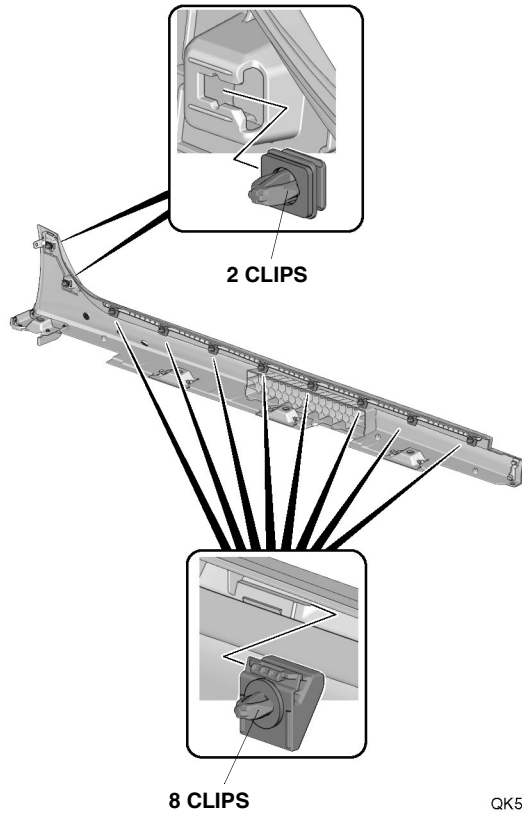

23. Install the clip.
24. Install the left side inner sill trim.

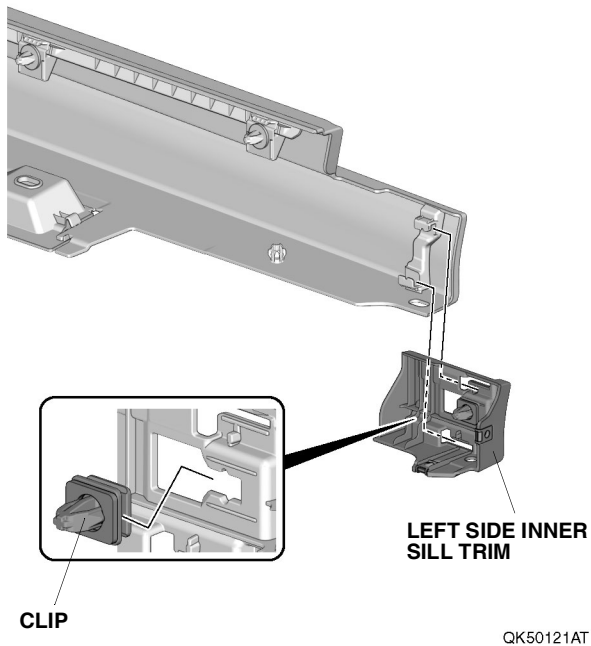

25. Install the left side sill trim.

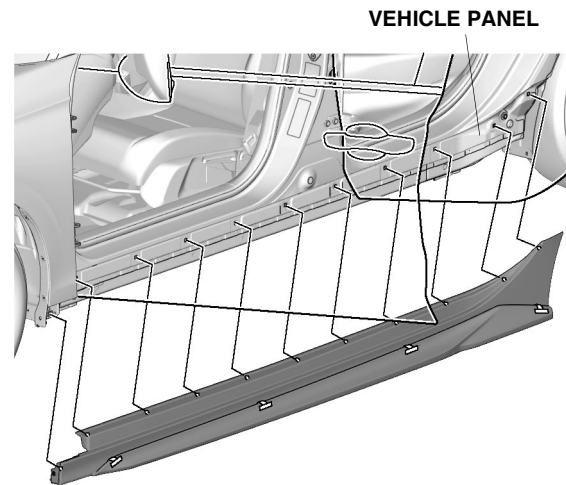
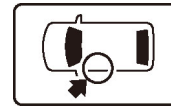

QK50130AT

26. Secure the left spoiler.

NOTE

Install in the order shown.

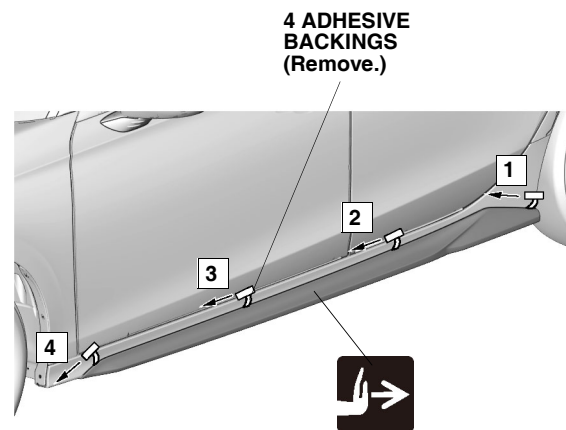

QK50116BT

27. Secure the left spoiler.

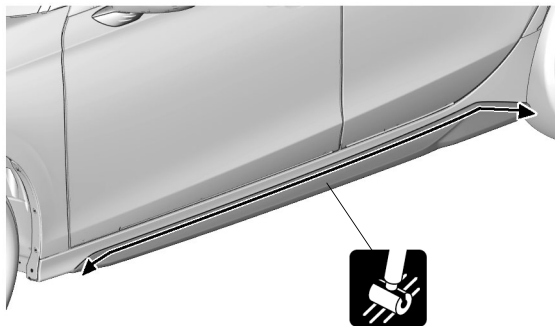

QK50123AT

28. Turn the steering wheel fully clockwise.
29. Flip the template.
30. Repeat the same procedures on the other side.

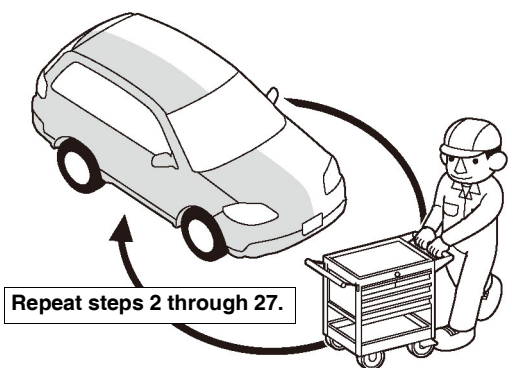

Q9D1014AM

31. Check that all parts are installed properly.