



INSTALLATION INSTRUCTIONS

Accessory

DOOR EDGE FILM

Application

2022 CIVIC

Publications No.

All

Issue Date

JUN 2021

GENERAL VIEW

If you are also installing body side moldings (sold separately), install the door edge films before you install the body side moldings.

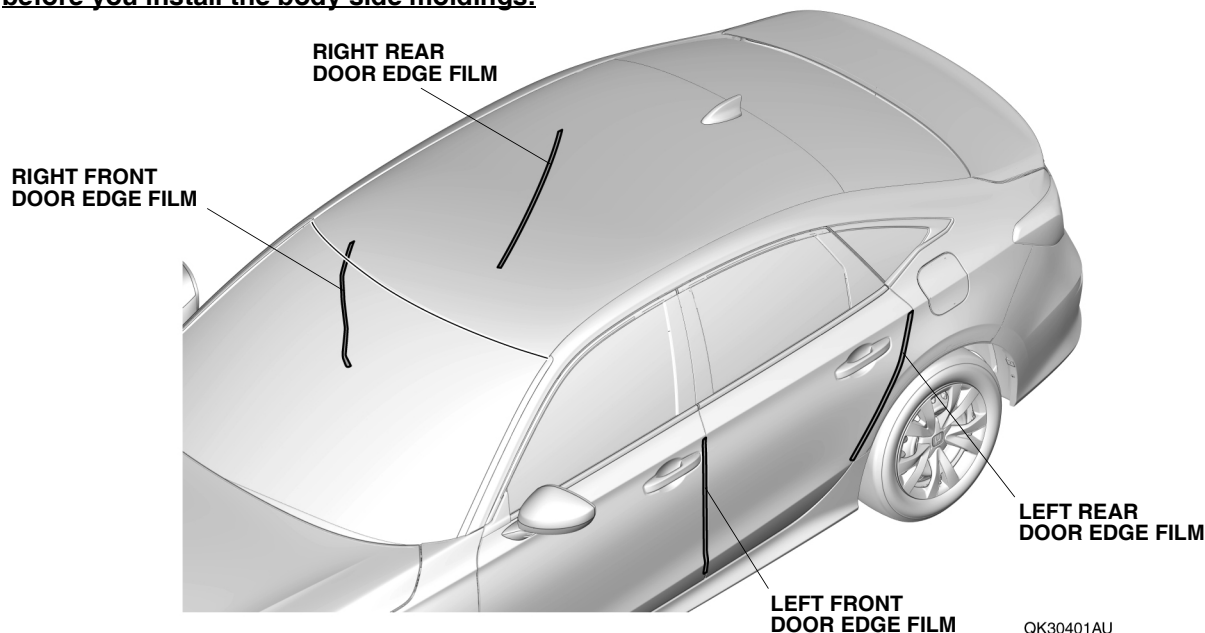

FOR YOUR SAFETY (Read carefully.)

Warning Symbols

Safety: Your safety, and the safety of others, is important. To help you make informed decisions about service procedures, we have provided safety messages where appropriate. Of course, it is not practical or possible to warn you about all the hazards associated with servicing a vehicle - you must use your own good judgment.

You will find important safety messages preceded by one of following symbols:

*All symbols are not used in all installation instructions.

⚠ DANGER

You will be killed or seriously hurt if you do not follow the instructions.

⚠ WARNING

You can be killed or seriously hurt if you do not follow the instructions.

⚠ CAUTION

You can be hurt if you do not follow the instructions.

NOTICE

Gives advice to prevent damage to the product, vehicle, the environment or other property.

NOTE

Gives helpful information or instructions to be followed when installing this product.



Indicates a prohibited action.

Procedure and Location Icons

These icons indicate the work location and the worker's point of view.

*All icons are not used in all installation instructions.

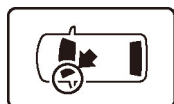

The location on the vehicle.

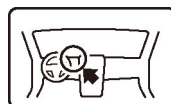

The location in the vehicle.
(instrument panel.)



Wear eye protection.



Wear heavy gloves.



Use an assistant.



Place the part on a blanket.



Work perpendicular.



Remove any burrs.



Use touch-up paint and allow to dry.



Tighten to the specified torque.



Apply firm pressure while rolling, especially at the ends, to set the adhesive.



Press firmly.



Clean with isopropyl alcohol.



Return the original part to the customer.
(Do not reuse.)

Safety: General

- Be careful not to damage the vehicle or the parts.
- The illustrations may differ slightly from the actual accessory.

Safety: Accessory

- Always use the parts and tools specified in the installation instructions.
- Do not install the accessory on a dirty surface or in direct sunlight.
- Make sure the ambient air temperature is 60°F (15°C) or above when installing accessories that use adhesive material.
- When applying adhesive material, make sure it is lined up properly before attaching. Once the adhesive material touches the surface, do not try to remove it. If you do, you could damage the part.
- Cover nearby parts with a shop towel to prevent getting them wet.

- Always wear gloves when working with 3M Protective tape application solution.
- Use 3M protective tape application solution with a spray bottle.
- Do not wash the vehicle for 24 hours to allow the adhesive to cure.

PARTS LIST

Door Edge Film Kit (P/N 08P20-T20-100A)

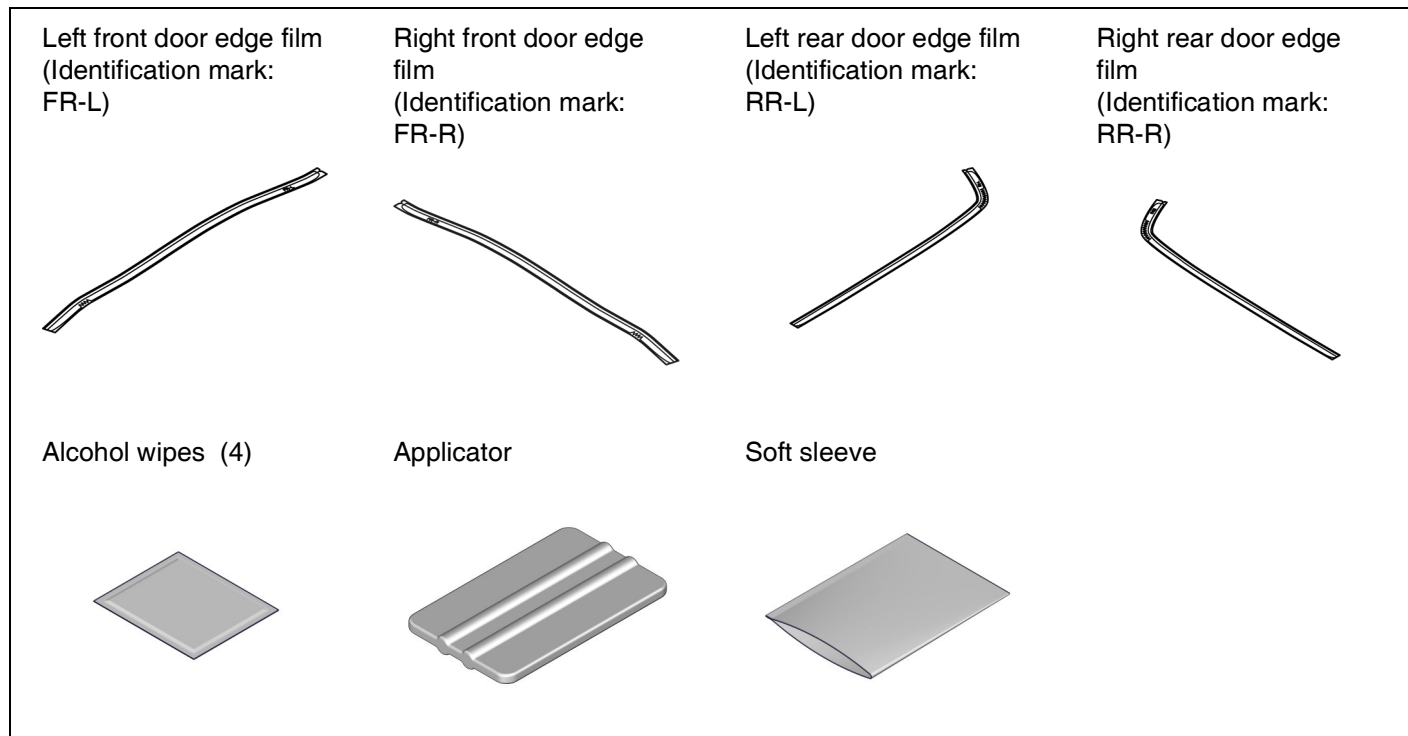

REQUIRED TOOLS AND SUPPLIES

- Shop towel
- Spray bottle

The following tool are available through the Honda Tool and Equipment Program:

3M Protective tape application solution (P/N: 08712-0008)

INSTALLATION

1. Clean the attaching area.

NOTE
Allow to dry thoroughly.

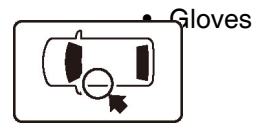

LEFT
FRONT DOOR
(outside)

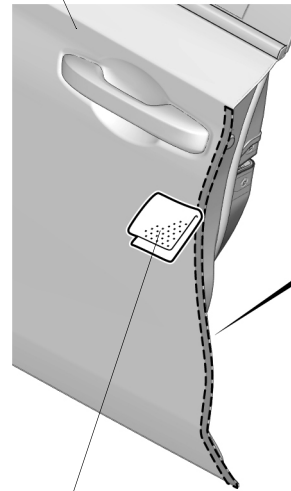

ALCOHOL WIPE



LEFT
FRONT DOOR
(inside)

QK30402AU

2. Spray the left front door.

NOTE

Spray the outer surface of the door only.



**LEFT
FRONT DOOR
(outside)**

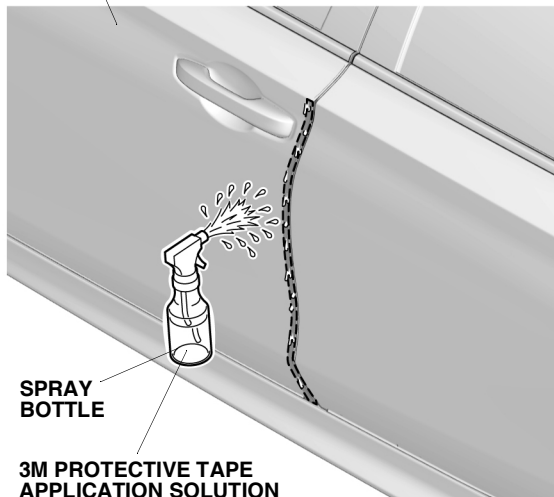

**SPRAY
BOTTLE**

**3M PROTECTIVE TAPE
APPLICATION SOLUTION**

QK30404AU

3. Attach the left front door edge film.

NOTE

Make sure to check the identification mark before installation.

**LEFT FRONT
DOOR EDGE FILM**
(Identification mark:
FR-L)

V-NOTCH
(Line up with the bottom of
the character line.)

**CHARACTER
LINE**

**ADHESIVE
BACKING
(Remove.)**

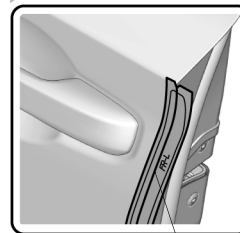
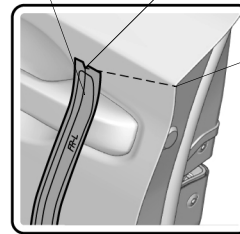

MARK
(Line up with the edge of
the left front door.)

QK30405AU

4. Secure the left front door edge film.

NOTE

Make sure that there are no air bubbles.

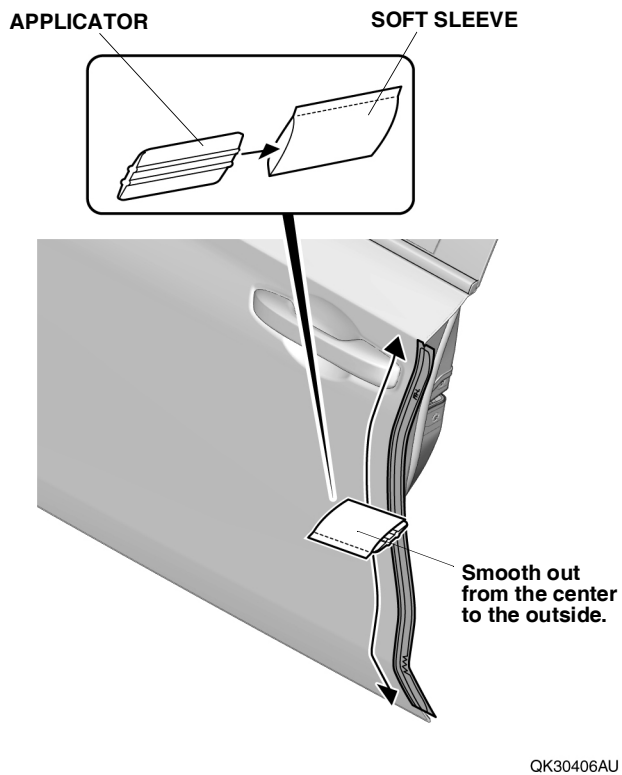

5. Remove the protective film.

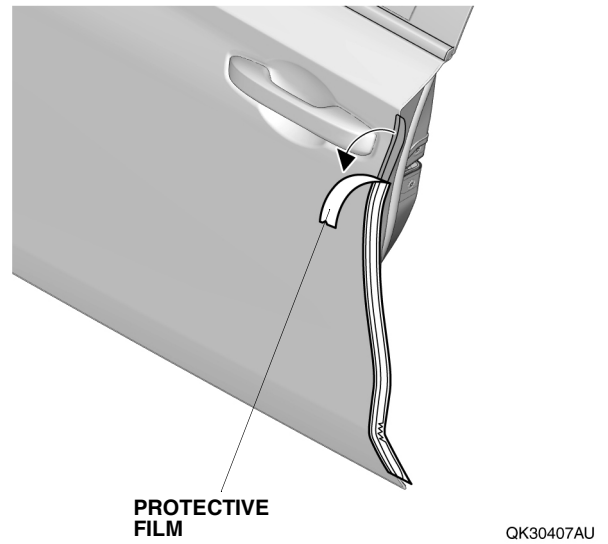

6. Secure the left front door edge film.

NOTE

- Do not trim or damage the seam sealant.
- Make sure to prevent air from entering.

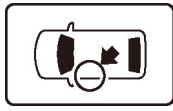

LEFT FRONT DOOR
EDGE FILM

LEFT FRONT DOOR

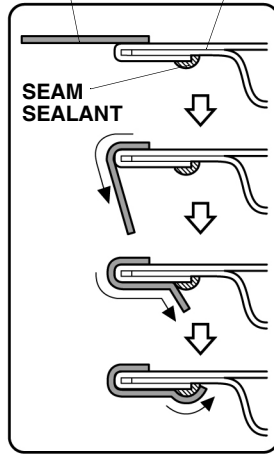

SECTION VIEW

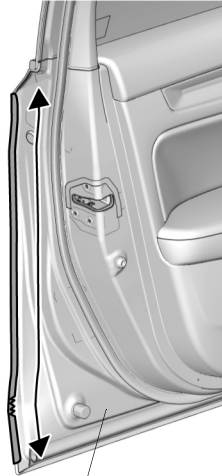

LEFT FRONT DOOR
(inside)

QK30408AU

7. Wipe the 3M protective tape application solution.

NOTE

Allow to dry thoroughly.

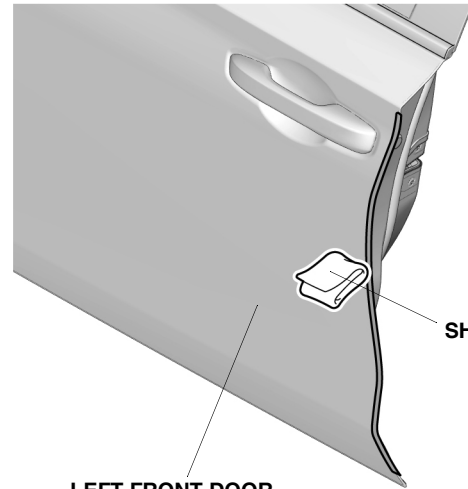
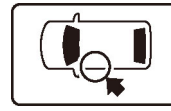

SHOP TOWEL

LEFT FRONT DOOR
(outside)

QK30409AU

8. Clean the attaching area.

NOTE

Allow to dry thoroughly.

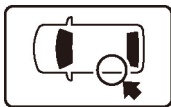

**LEFT
REAR DOOR
(outside)**

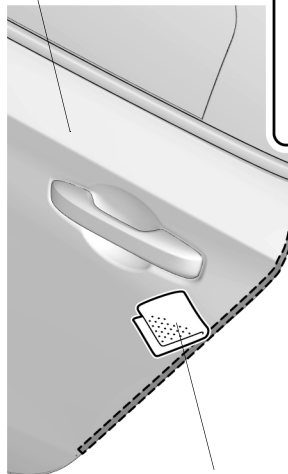

**ALCOHOL
WIPE**

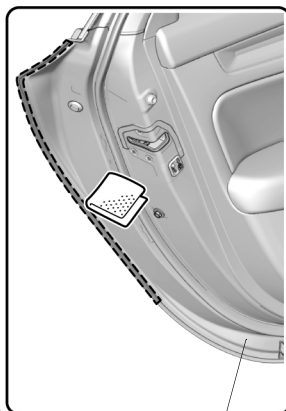

**LEFT
REAR DOOR
(inside)**

QK30403AU

9. Spray the left rear door.

NOTE

Spray the outer surface of the door only.

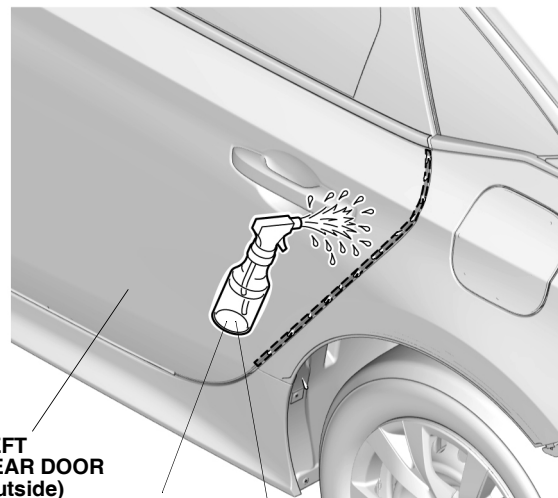

**LEFT
REAR DOOR
(outside)**

**SPRAY
BOTTLE**

**3M PROTECTIVE TAPE
APPLICATION SOLUTION**

QK30410AU

10. Attach the left rear door edge film.

NOTE

Make sure to check the identification mark before installation.

**LEFT
REAR DOOR
EDGE FILM**
(Identification
mark: RR-L)

V-NOTCH
(Line up with the bottom of
the character line.)

**CHARACTER
LINE**

**ADHESIVE
BACKING**
(Remove.)

MARK
(Line up with the edge of
the left rear door.)

QK30411AU

11. Secure the left rear door edge film.

NOTE

Make sure that there are no air bubbles.

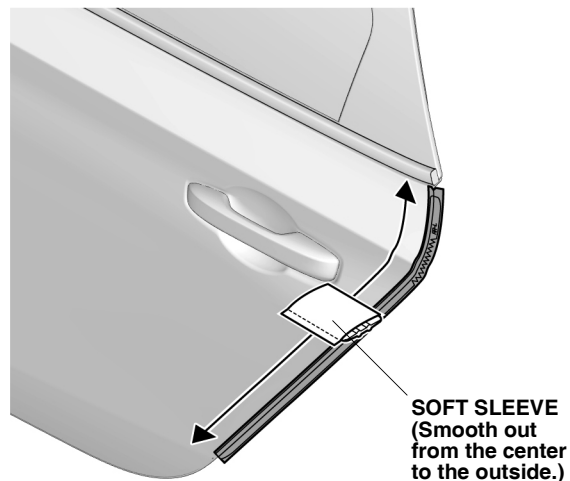

QK30412AU

12. Remove the protective film.

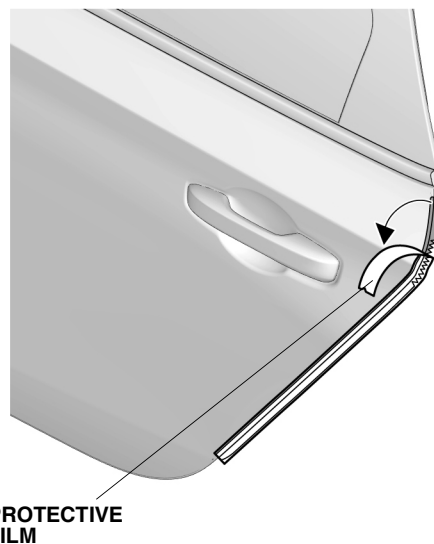

QK30413AU

13. Secure the left rear door edge film.

NOTE

- Do not trim or damage the seam sealant.
- Make sure to prevent air from entering.

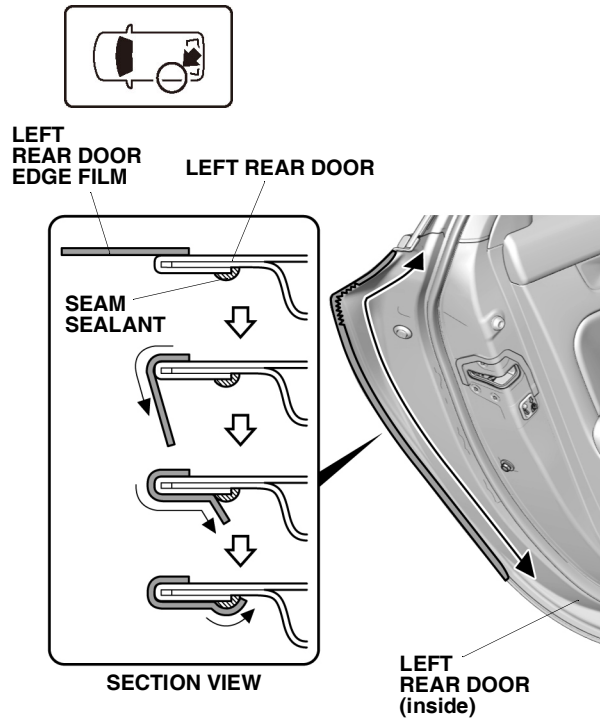

QK30414AU

14. Wipe the 3M protective tape application solution.

NOTE

Allow to dry thoroughly.

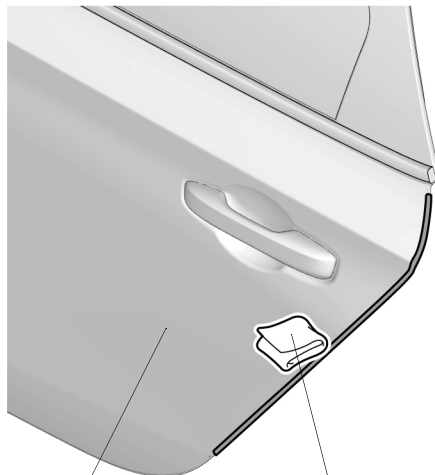
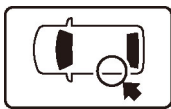

QK30415AU

15. Repeat the same procedures on the other side.

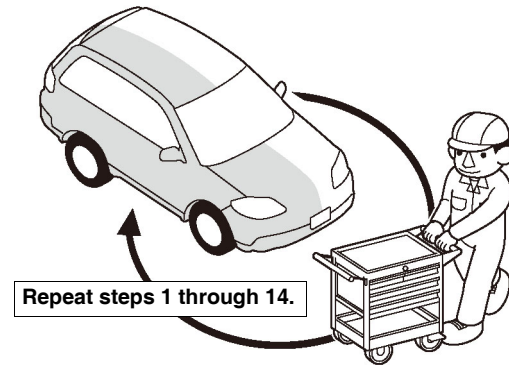

Q9D1014AM

16. Check that all parts are installed properly.