



HONDA INSTALLATION INSTRUCTIONS

Accessory

WIRELESS CHARGER

Application

2021 CIVIC

Publications No.

VERSION 1

Issue Date

AUG 2020

PARTS LIST

Wireless Charger Attachment Kit
P/N 08U58-TBA-100A

Upper tray mat

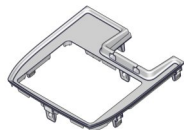

Wireless charger harness

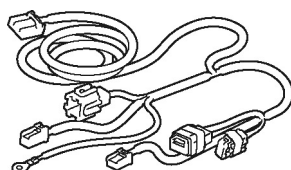

14 Wire ties
(Some may not be used)



2 Self-tapping screws



Fuse label

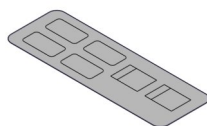

Wire tie with clip A



Urethane tape

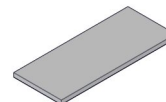

Wire tie with clip B



20A Blade fuse
(May not be used)

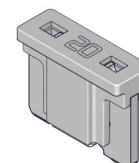

Wireless Charger Unit Kit
P/N 08U58-TBA-102

Wireless charger unit

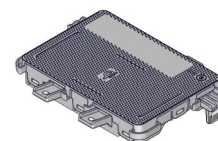

Accessory User's Information Manual



TOOLS AND SUPPLIES REQUIRED

Phillips screwdriver
10 mm Open end wrench
Ratchet
10 mm Socket
Masking tape
Scissors
Diagonal cutters
Isopropyl alcohol
Shop towel

The following tools are available through the Honda Tool and Equipment Program. On the iN, click on Service > Service Bay > Tool and Equipment Program, then enter the number under "Search." Or, call 888-424-6857.

- Trim Tool Set (T/N SOJATP2014)
- Plastic Trim Tool (T/N SILTRIMTL10)

Illustration of the Wireless Charger Installed in the Vehicle

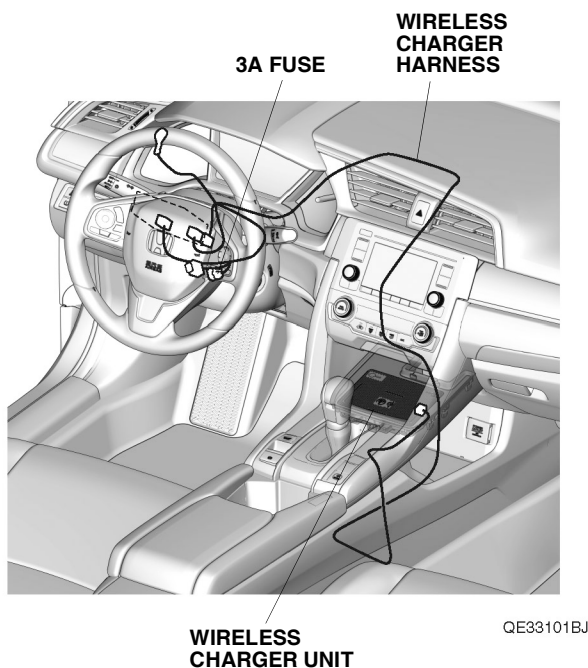

INSTALLATION

Customer Information: The information in this installation instruction is intended for use only by skilled technicians who have the proper tools, equipment, and training to correctly and safely add equipment to your vehicle. These procedures should not be attempted by "do-it-yourselfers."

1. Disconnect the negative cable from the battery.

2. Remove the driver's dashboard lower cover, unplug the vehicle connectors, and aspirator hose.

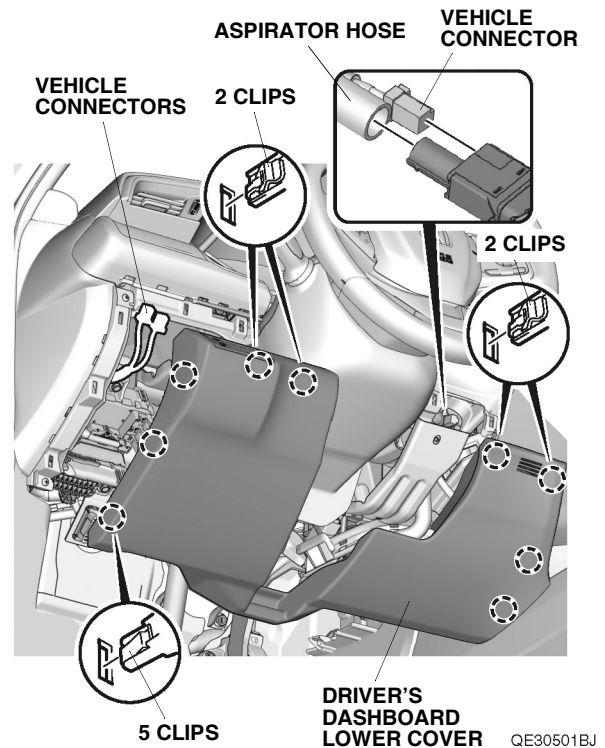

3. Remove the left console armrest.

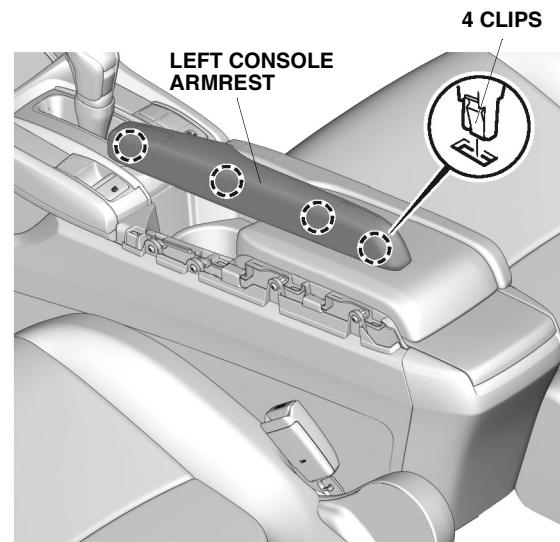

4. Attach masking tape to the area shown.

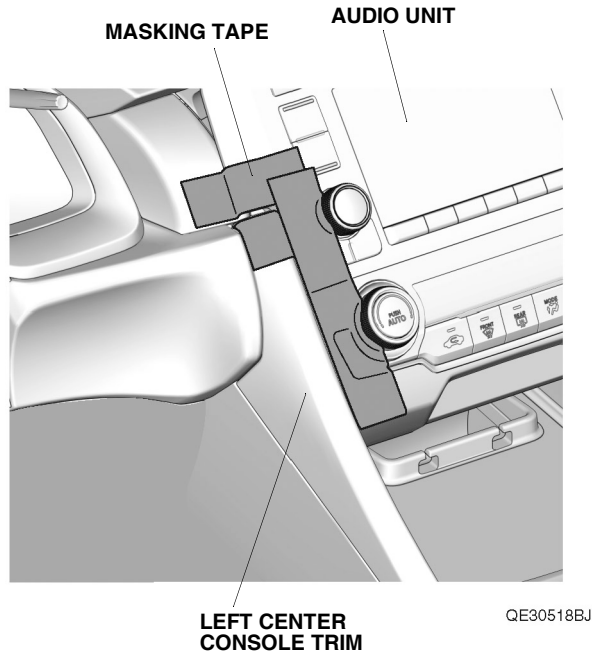

5. Remove the left center console trim.

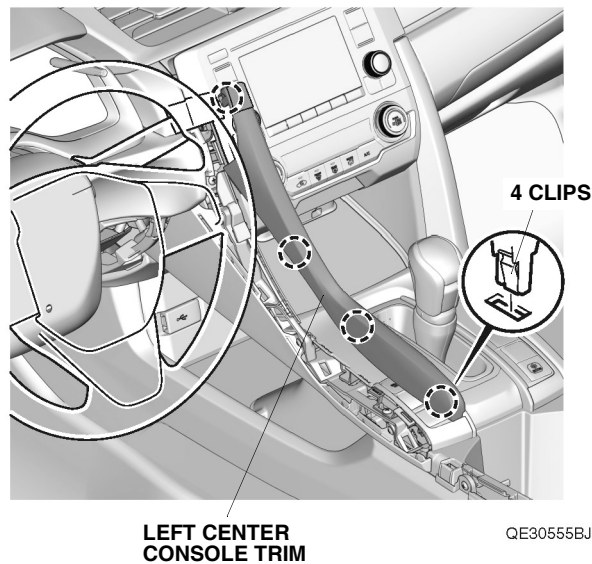

6. Remove the right console armrest.

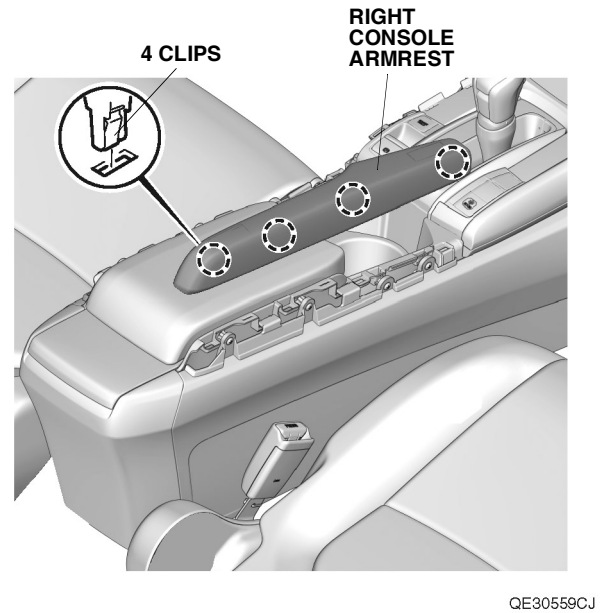

7. Attach masking tape to the area shown.

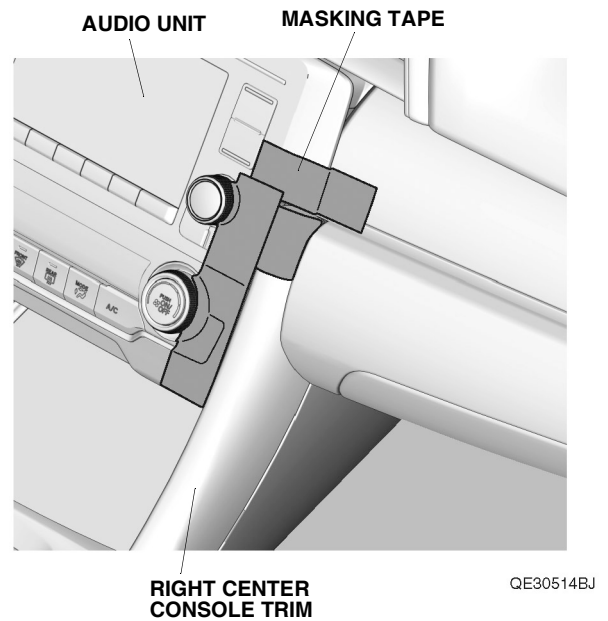

8. Remove the right center console trim.

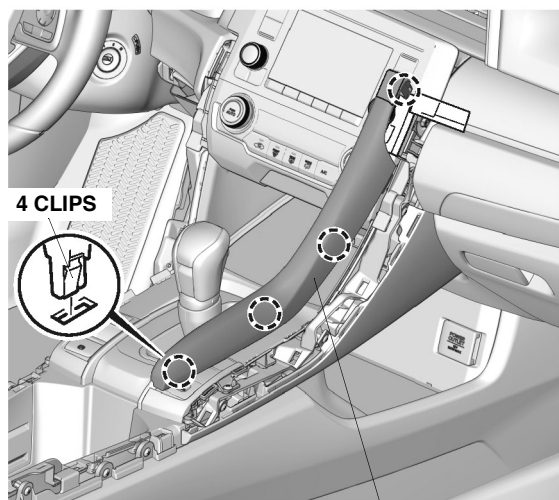

**RIGHT CENTER
CONSOLE TRIM** QE30517BJ

9. Remove the A/C control unit, and unplug the vehicle connectors.

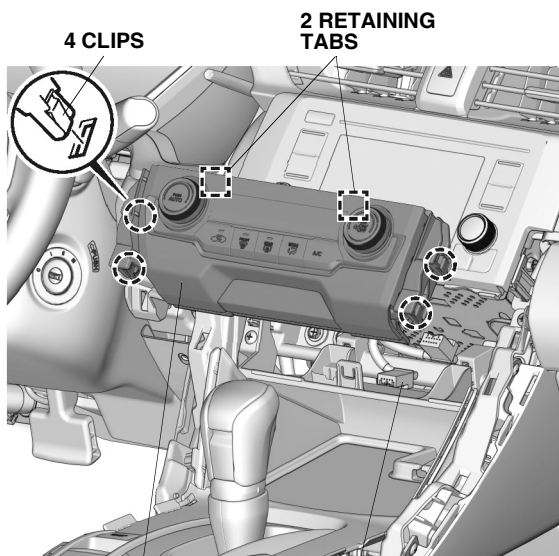

**A/C CONTROL
UNIT** **VEHICLE
CONNECTORS** QE30557AJ

10. Remove the console rear panel, and unplug the vehicle connectors, if equipped.

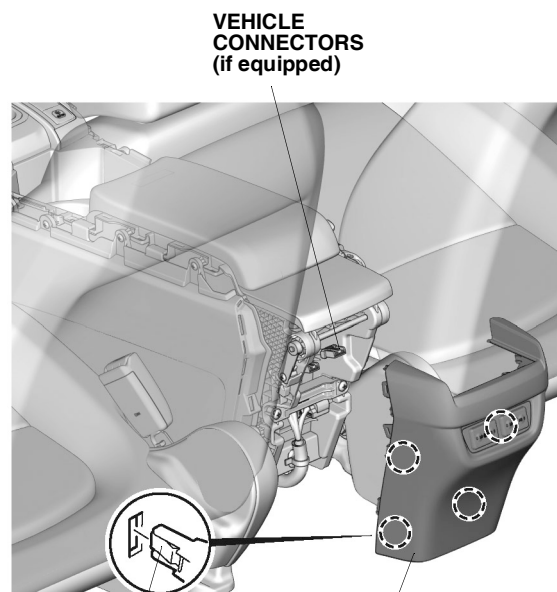

**CONSOLE
REAR PANEL** QE30538CJ

11. Remove the shift lever console panel:

A/T Models

- Open the center console armrest, and slide the sliding tray (if equipped) and the beverage holder rearward.
- Remove the shift lock release cover with a plastic trim tool.
- Insert the key into the shift lock release slot, and move the shift lever knob to the D position.

NOTE: Make sure to apply the parking brake.

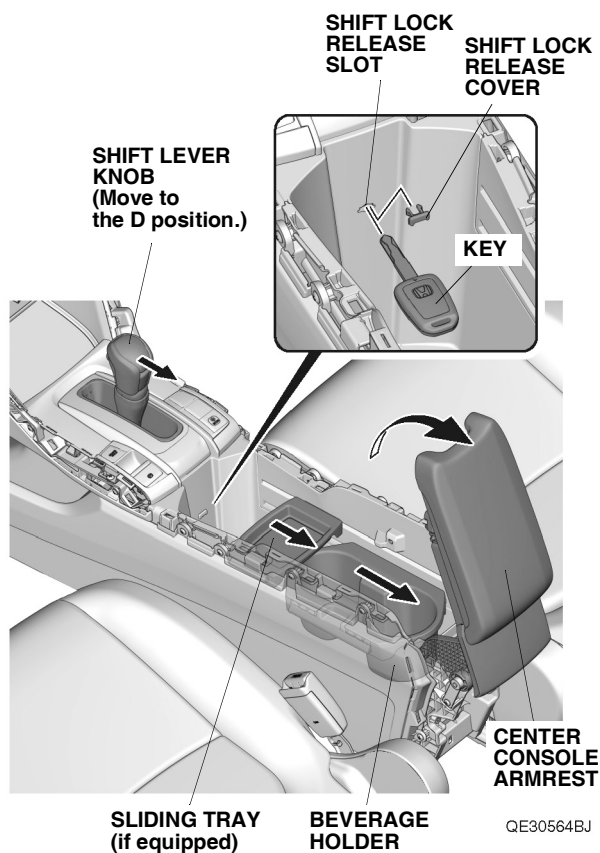

- Remove the console panel, and unplug the vehicle connectors.

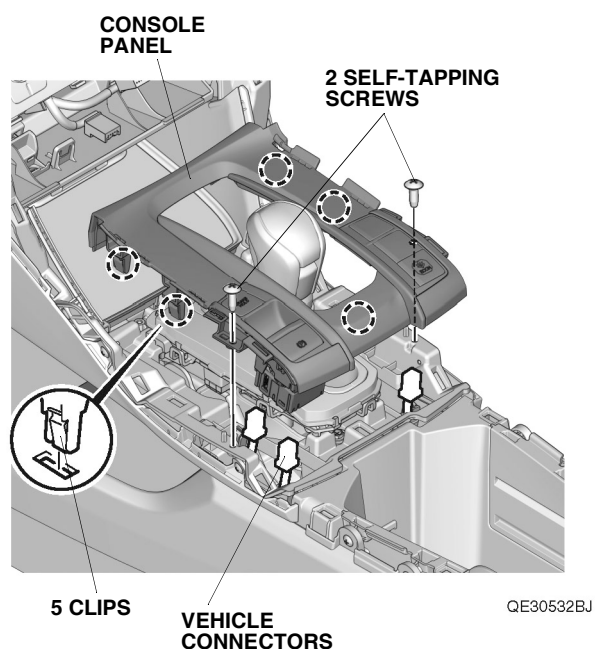

- Release the shift lever panel.

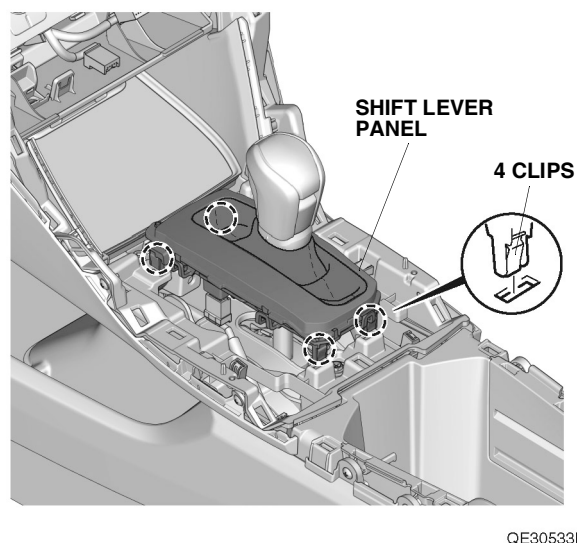

M/T Models

- Lower the shift lever boot to release two retaining tabs from the boot.
- Remove the shift lever knob.

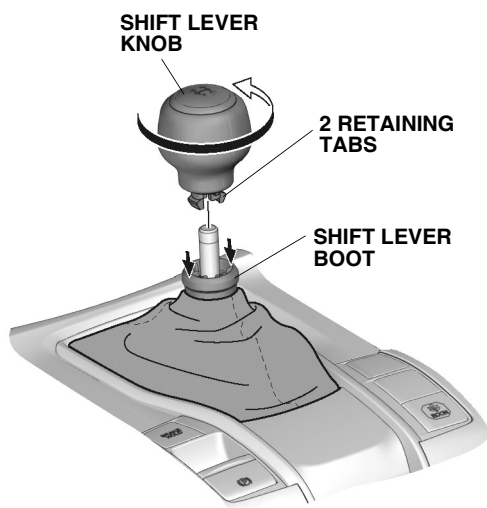

QE30541AJ

- Remove the shift lever panel, and unplug the vehicle connectors.

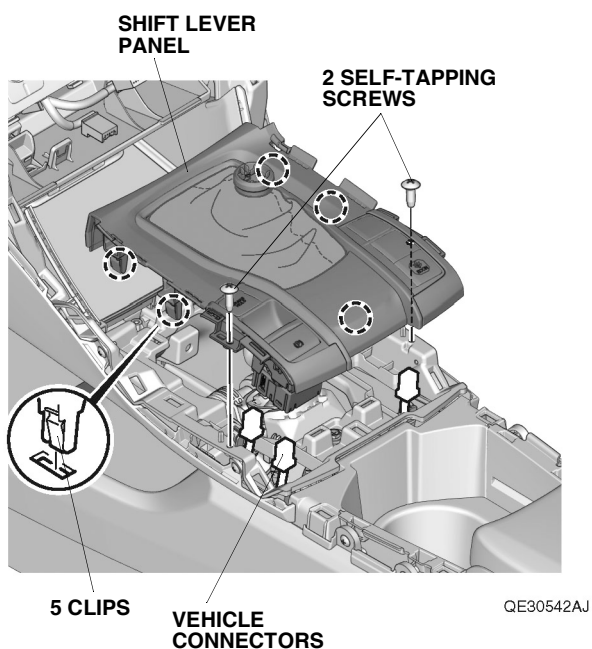

QE30542AJ

12. Remove the upper tray mat.

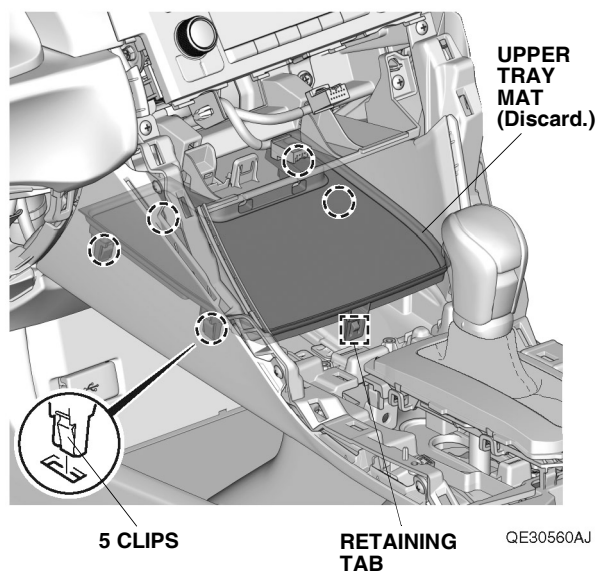

QE30560AJ

13. Remove the console panel.

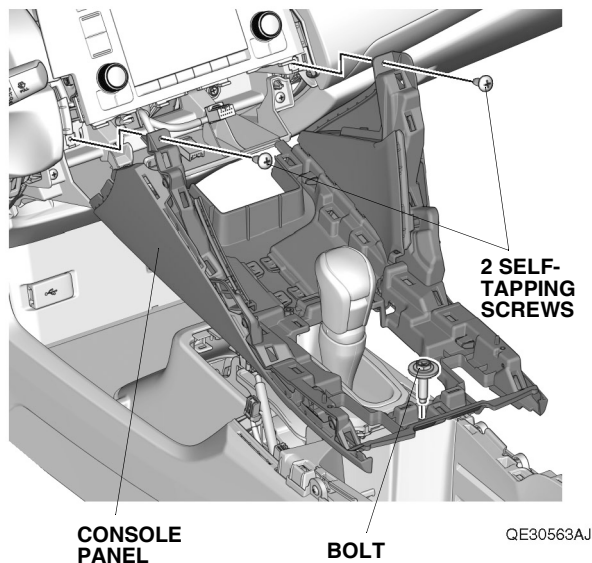

QE30563AJ

14. If equipped, remove the lower tray mat.

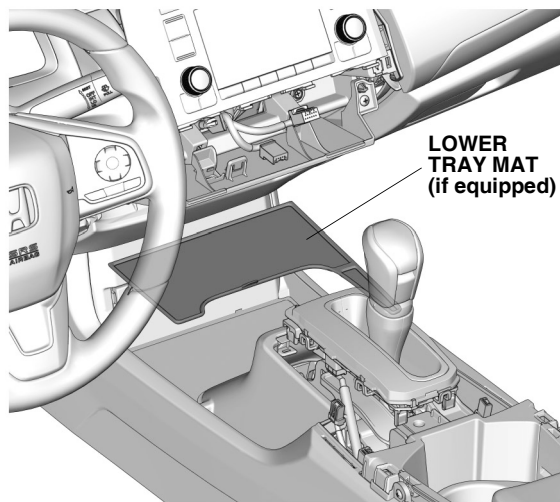

QE30546BJ

15. Using a plastic trim tool, remove the switch panel, and unplug the vehicle connectors.

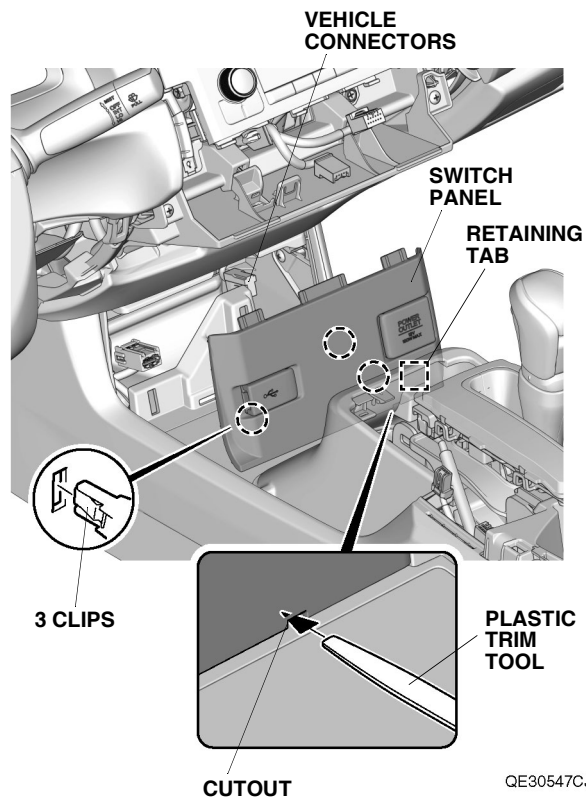

QE30547CJ

16. If equipped, release the vehicle clip, and unplug the vehicle connector.

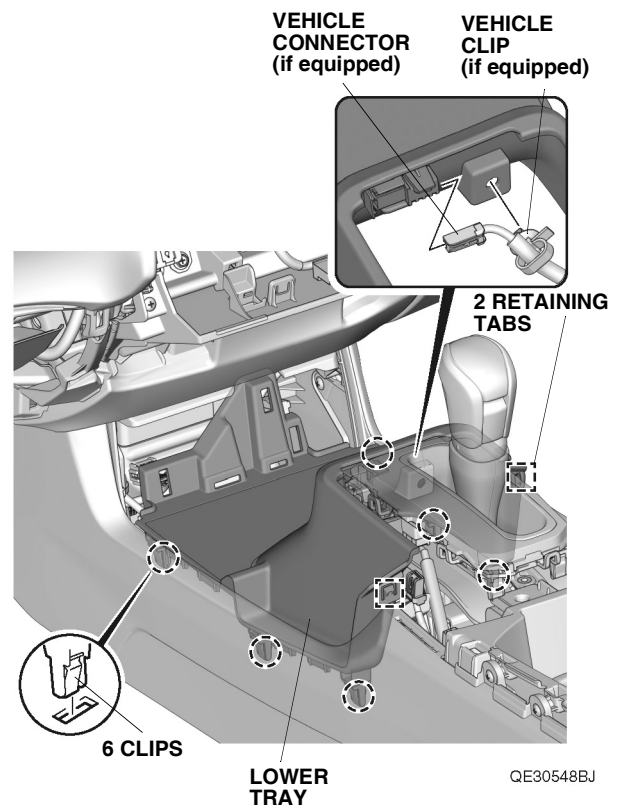

QE30548BJ

17. Remove the lower tray.

18. Remove the left side panel.

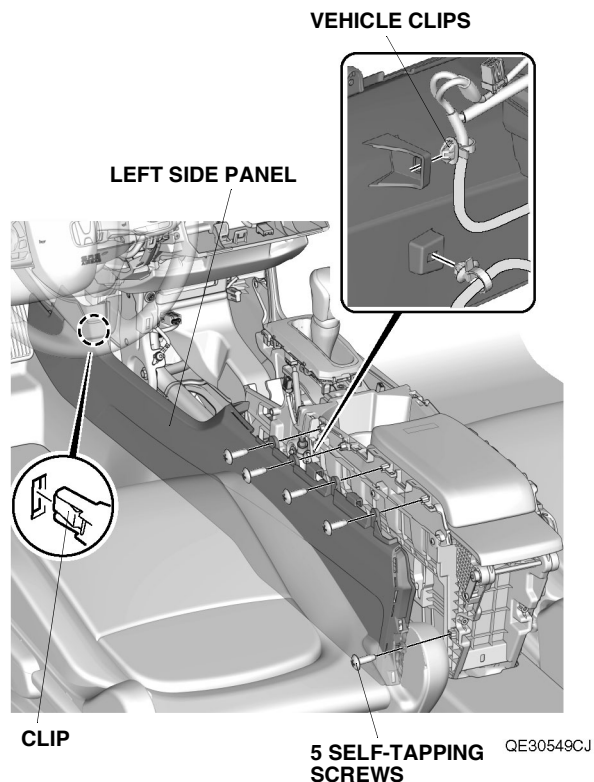

19. Remove the right side panel.

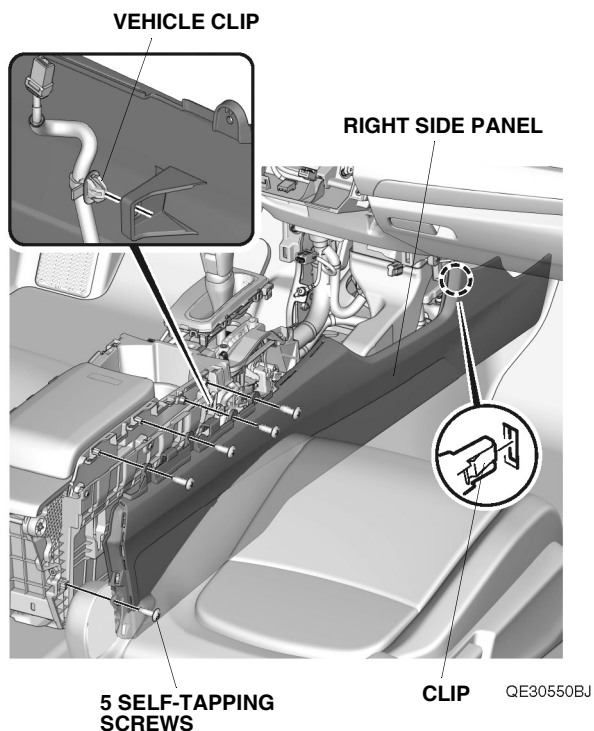

20. Using isopropyl alcohol on a shop towel, thoroughly clean the area where the urethane tape will attach.

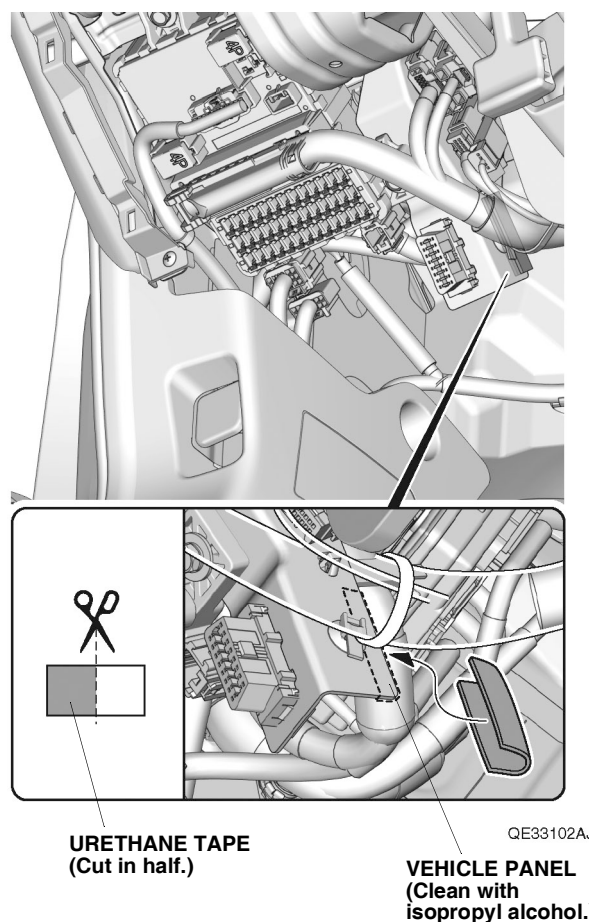

21. Using scissors, cut one urethane tape in half, and attach one piece of urethane tape to the vehicle panel.

22. Using isopropyl alcohol on a shop towel, thoroughly clean the area where the urethane tape will attach.

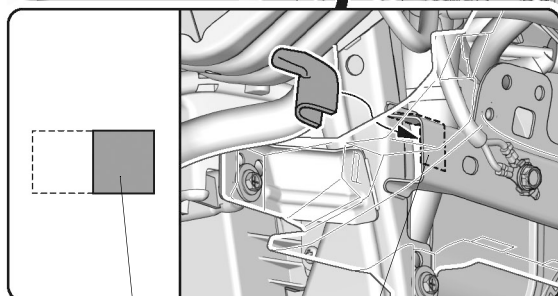
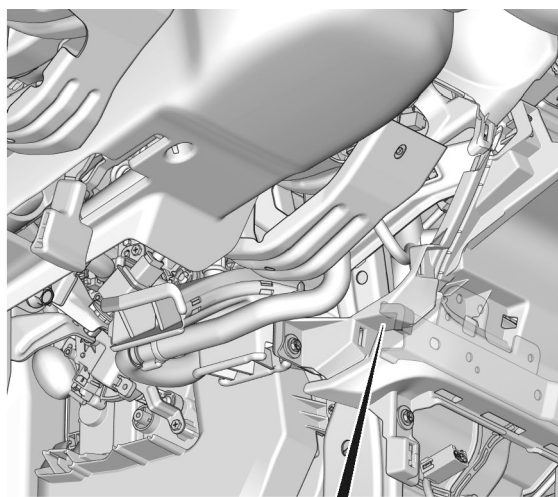

URETHANE TAPE

VEHICLE PANEL
(Clean with
isopropyl alcohol.)

QE33103AJ

23. Attach one piece of urethane tape to the vehicle panel.

24. Using isopropyl alcohol on a shop towel, thoroughly clean the area where the fuse label will attach.

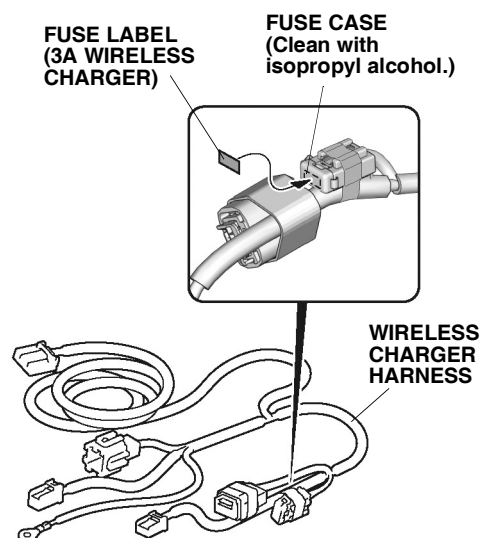

FUSE LABEL
(3A WIRELESS
CHARGER)

FUSE CASE
(Clean with
isopropyl alcohol.)

**WIRELESS
CHARGER
HARNESS**

QE33104AJ

25. Attach the fuse label to the wireless charger harness fuse case.

26. Plug the wireless charger harness 4-pin connector into the fuse box.

WIRELESS CHARGER HARNESS 4-PIN CONNECTOR

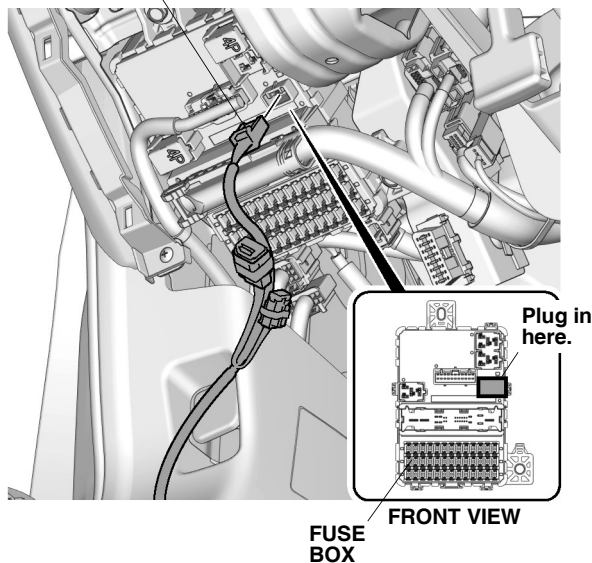

WITH OTHER ACCESSORY HARNESSES
If the dummy connector is plugged, unplug it.

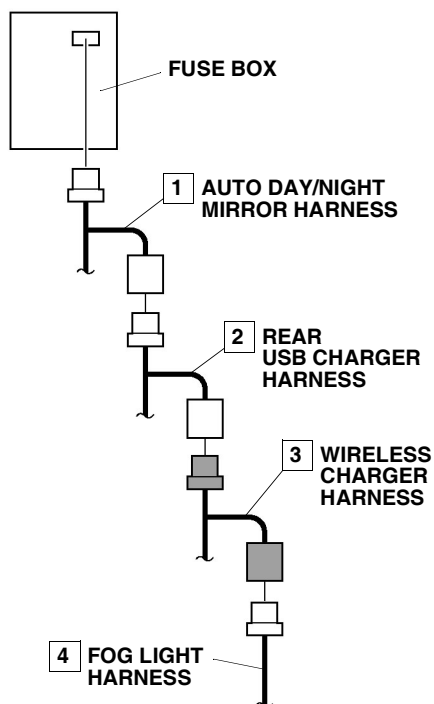

QH41801BT

27. Line up the white tape on the wireless charger harness with the vehicle clip. Secure the wireless charger harness to the vehicle harness with one wire tie.

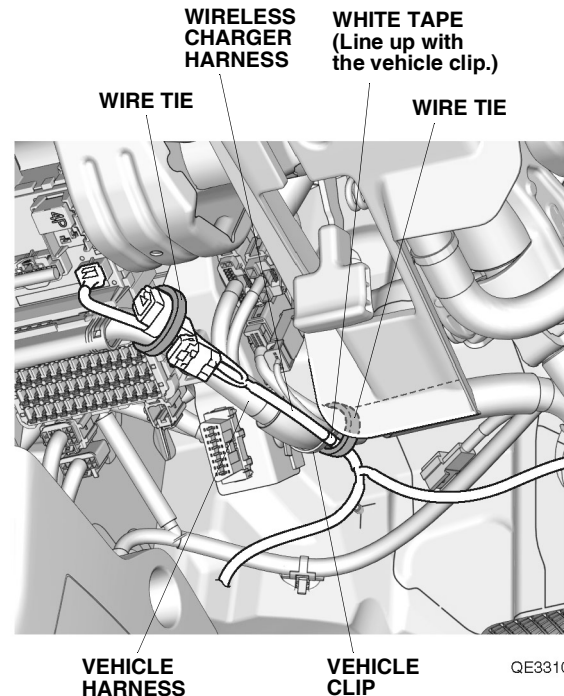

28. Secure the wireless charger harness to the vehicle harness with one wire tie.

29. Plug the wireless charger harness 6-pin connector into the vehicle 6-pin connector.

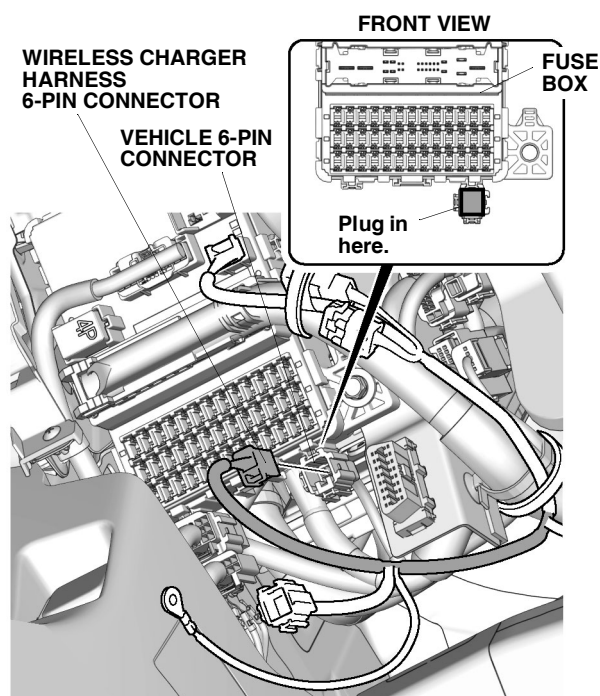

WITH OTHER ACCESSORY HARNESSES
If the dummy connector is plugged, unplug it.

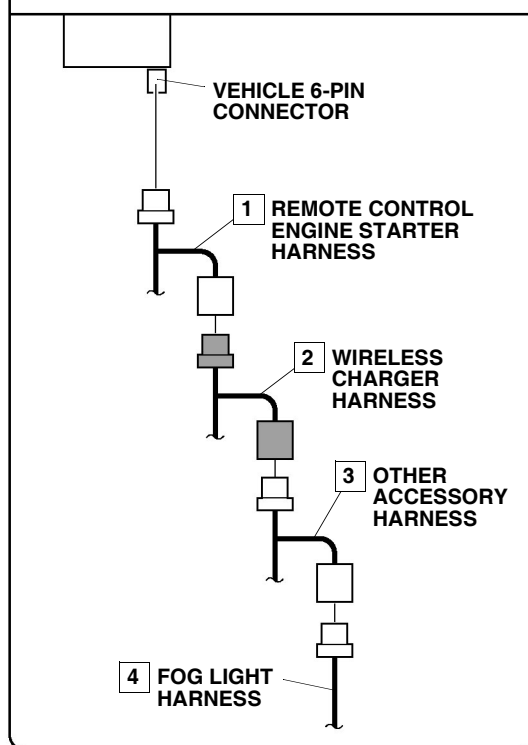

QH41802BT

30. Attach the wireless charger harness 6-pin connector to any of the positions shown.

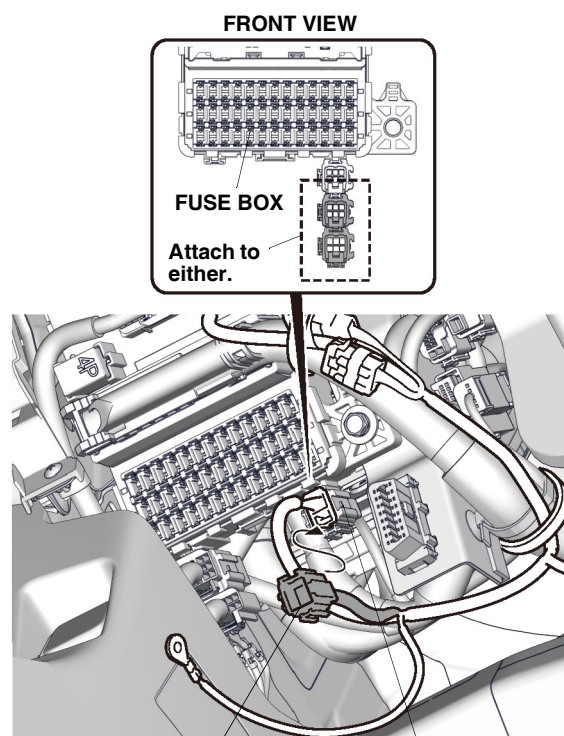

WIRELESS CHARGER HARNESS 6-PIN CONNECTOR

VEHICLE 6-PIN CONNECTOR OR REMOTE CONTROL ENGINE STARTER HARNESS 6-PIN CONNECTOR QH41803AT

31. Remove the vehicle ground bolt, and install the wireless charger harness ground terminal with vehicle ground bolt as shown. Do not put the ground terminal calking on top of one another.

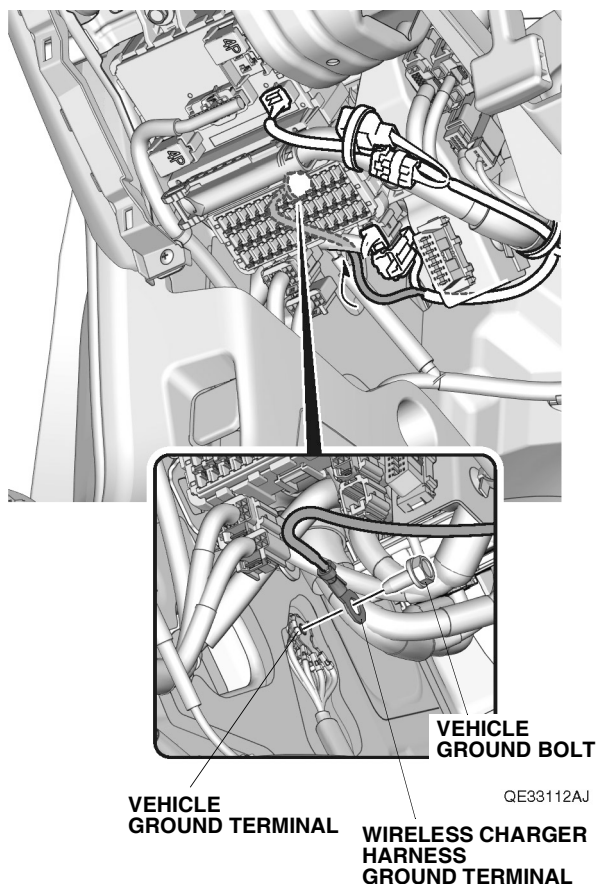

If A/T models, continue with step 32; otherwise, go to step 36.

A/T Models

32. Route the wireless charger harness as shown. Line up the white tape on the wireless charger harness with the vehicle clip. Secure the wireless charger harness to the vehicle harness with one wire tie.

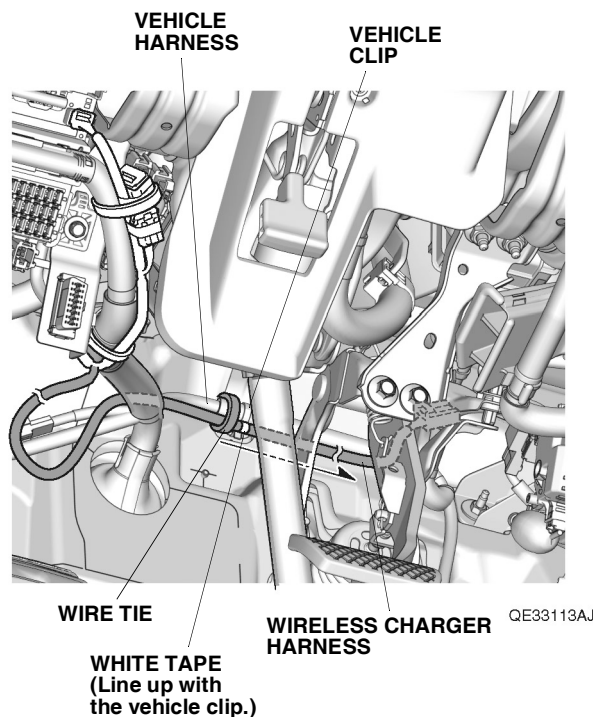

33. Secure the wireless charger harness to the vehicle harness with two wire ties.

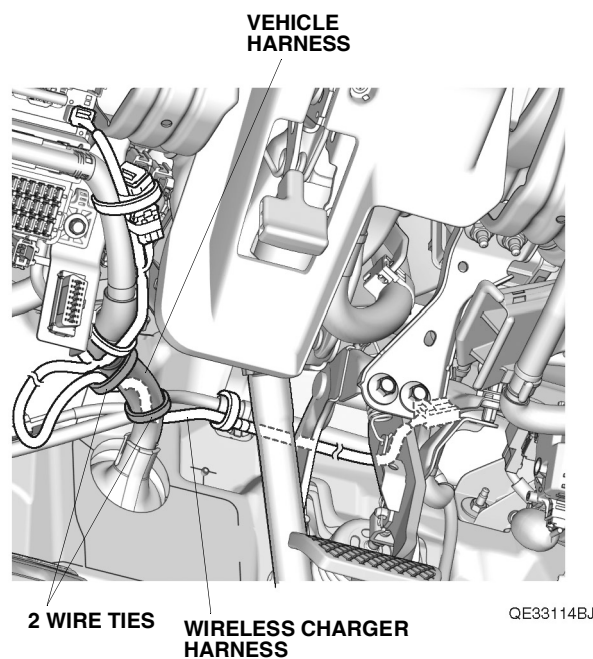

34. Secure the wireless charger harness to the wireless charger harness 6-pin connector with one wire tie with clip B.

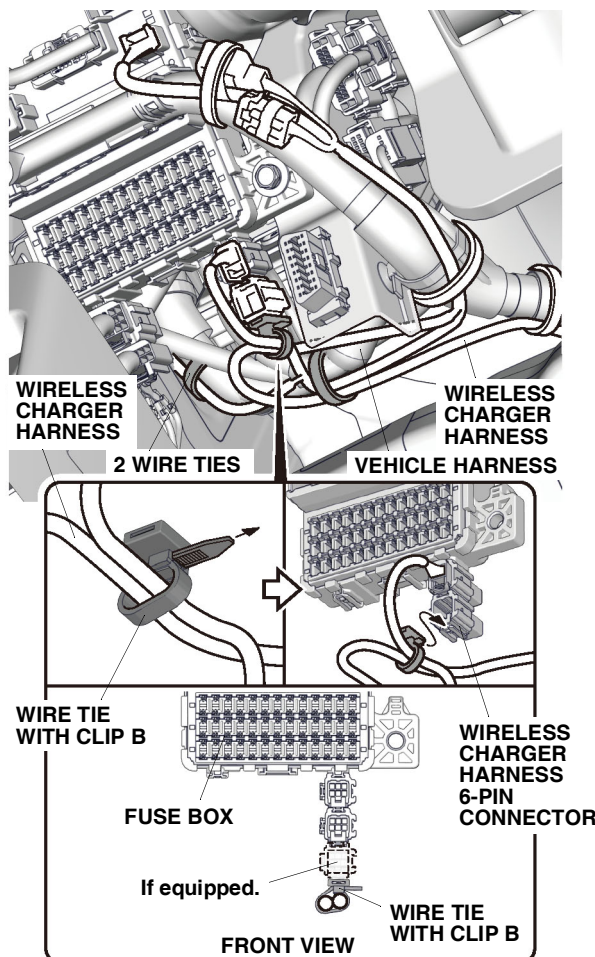

QH41804AT

35. Secure the wireless charger harness to the vehicle harness with two wire ties. Go to step 40.

M/T Models

36. Route the wireless charger harness as shown. Line up the white tape on the wireless charger harness with the vehicle clip. Secure the wireless charger harness to the vehicle harness with one wire tie.

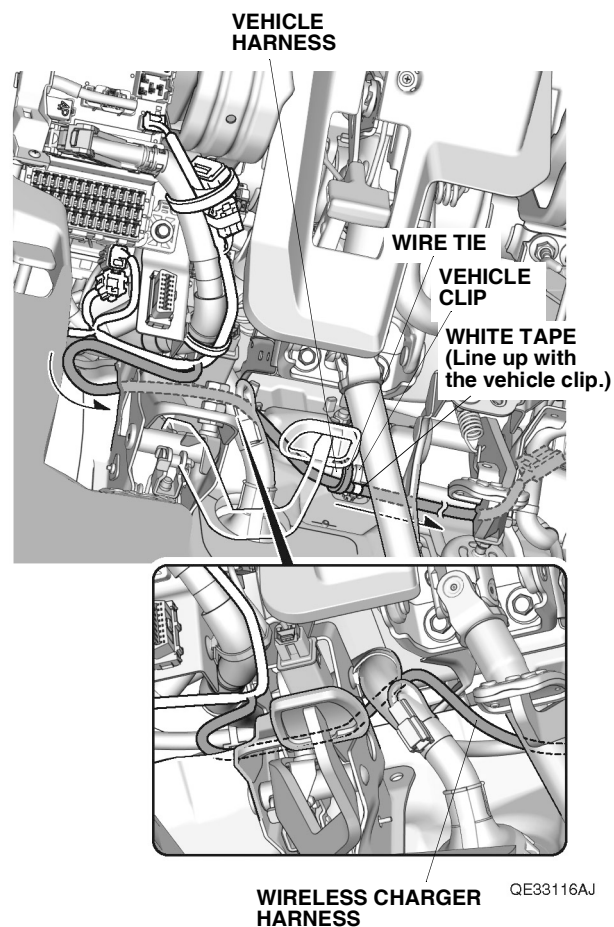

37. Secure the wireless charger harness to the vehicle harness with three wire ties.

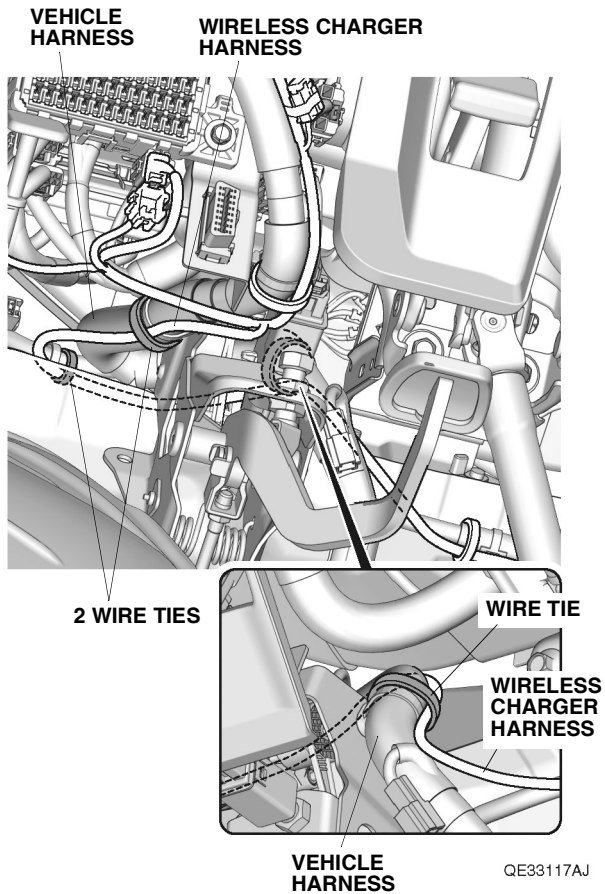

38. Secure the wireless charger harness to the wireless charger harness 6-pin connector with one wire tie with clip B.

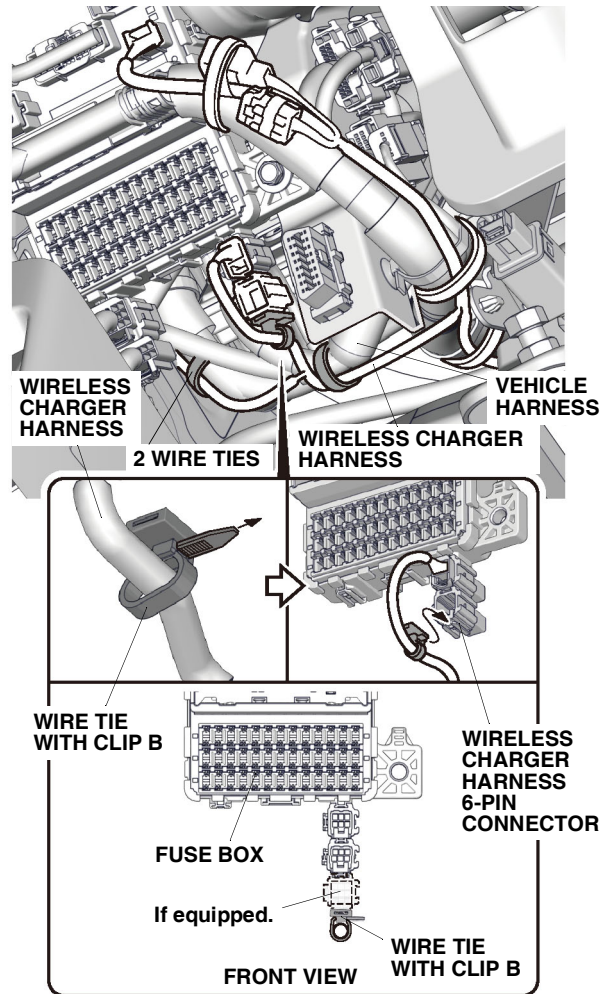

39. Secure the wireless charger harness to the vehicle harness with two wire ties.

40. Route the wireless charger harness along the vehicle harness as shown.

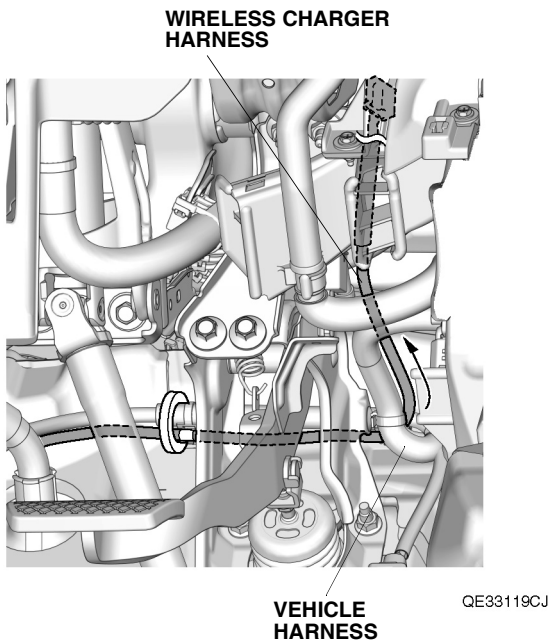

41. Route the wireless charger harness as shown.

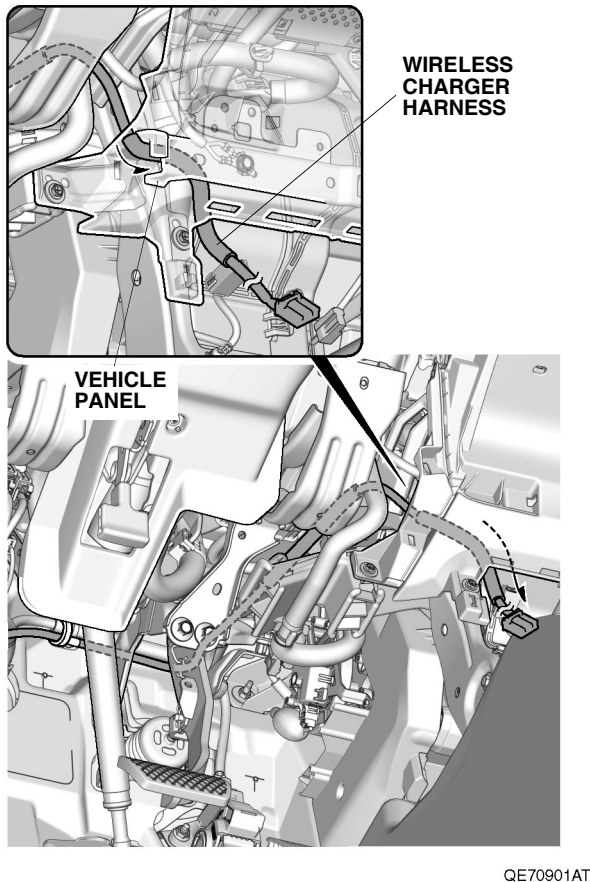

42. Route the wireless charger harness as shown. Line up the white tape on the wireless charger harness with the vehicle clip. Secure the wireless charger harness to the vehicle harness with one wire tie.

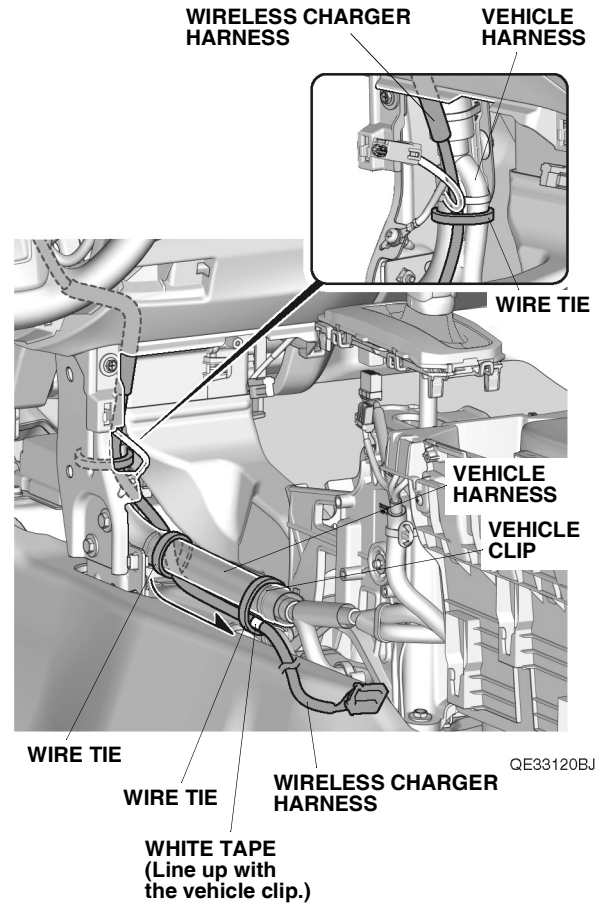

43. Secure the wireless charger harness to the vehicle harness with two wire ties.

44. Secure the wireless charger harness to the vehicle panel with one wire tie.

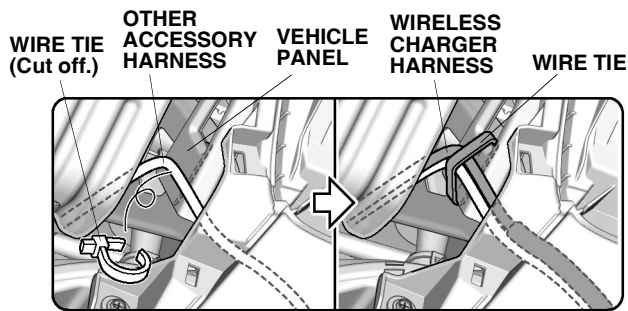

WITH OTHER ACCESSORY HARNESS

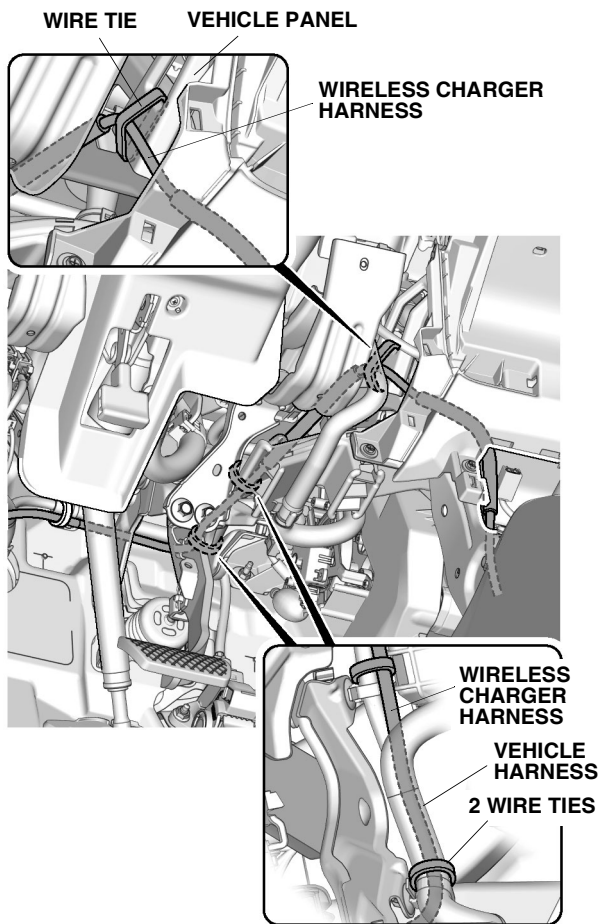

QH41810AT

45. Secure the wireless charger harness to the vehicle harness with two wire ties.

46. Route the wireless charger harness as shown.

A/T models

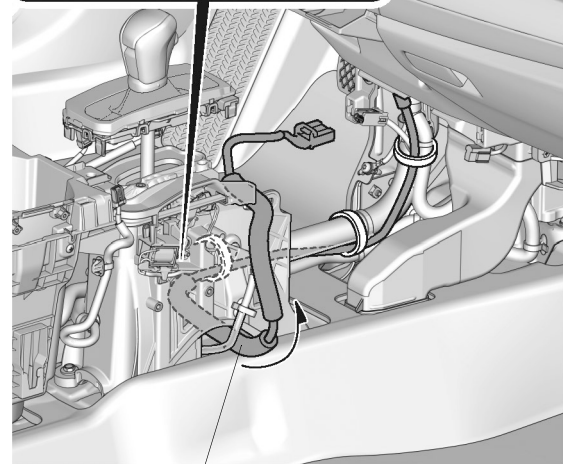
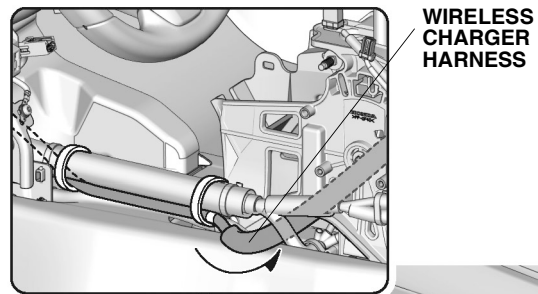

WIRELESS CHARGER HARNESS

QE33122BJ

M/T models

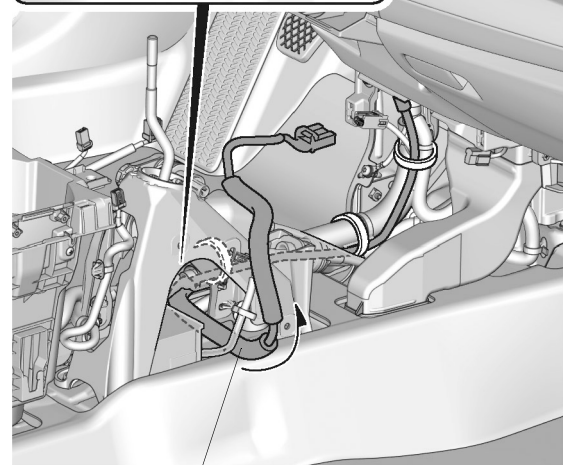
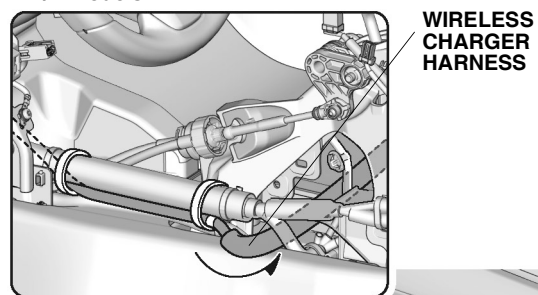

WIRELESS CHARGER HARNESS

QE33123AJ

47. Reinstall the left and right side panels and the lower tray.

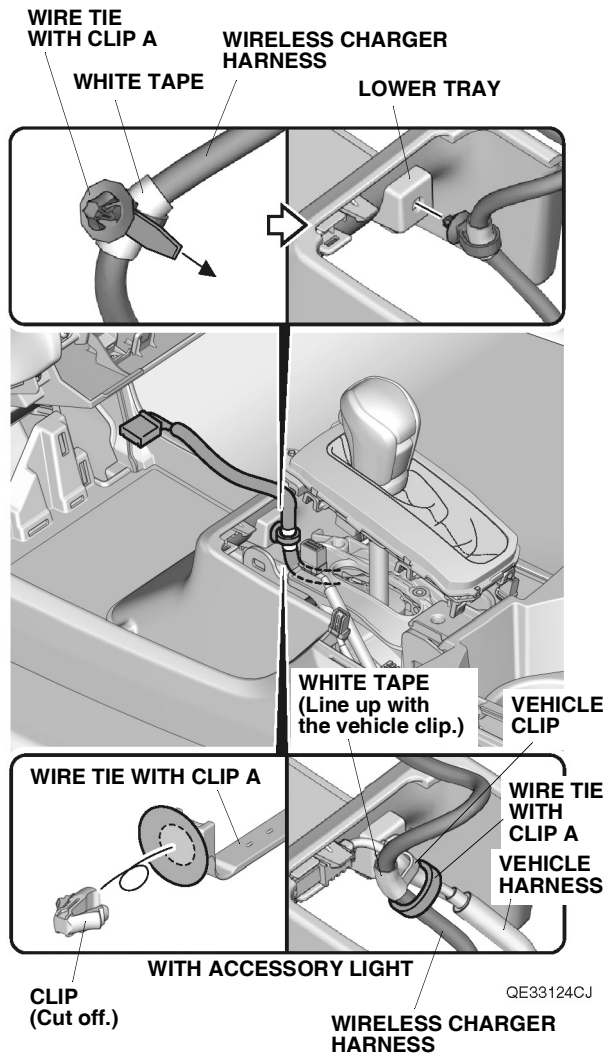

48. Attach one wire tie with clip A to the white tape on the wireless charger harness, secure the wire tie with clip A to the lower tray. If the vehicle is equipped with the accessory light, secure the wireless charger harness to the vehicle harness with one wire tie with clip A.

49. Reinstall the switch panel, the lower tray mat, and the console panel.

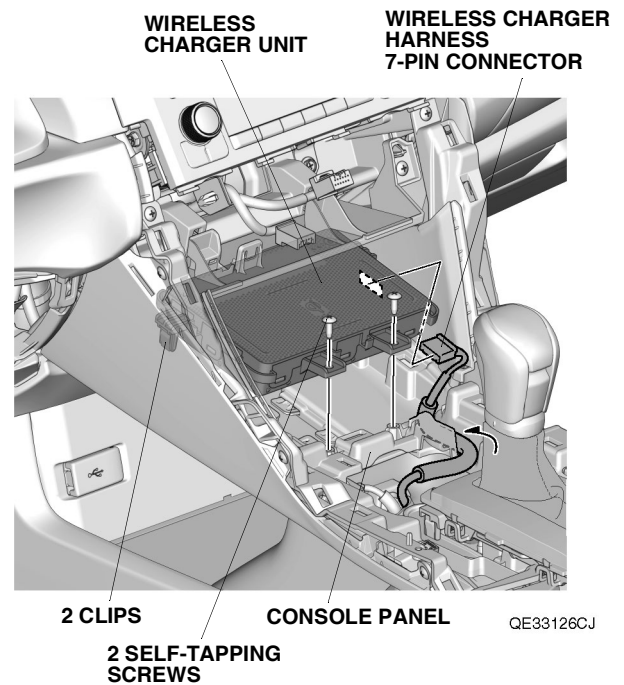

50. Plug the wireless charger harness 7-pin connector into the wireless charger unit, and install the wireless charger unit to the console panel with two self-tapping screws and two clips.
51. Install the upper tray mat to the console panel with five clips and two retaining tabs.

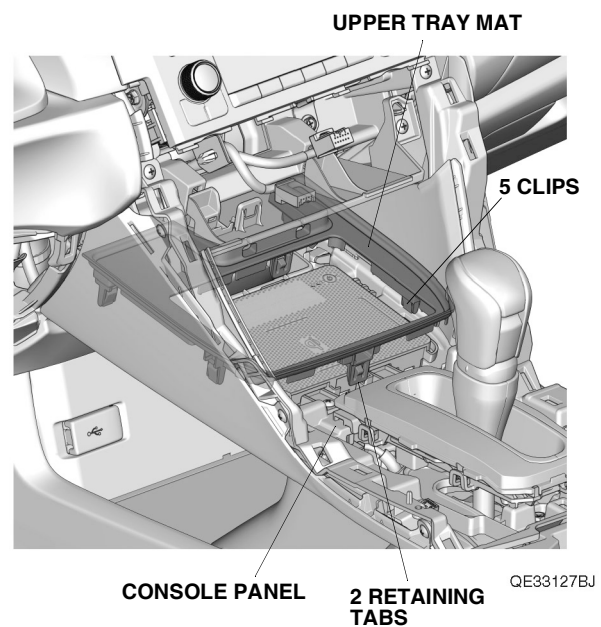

52. Plug the 20A blade fuse into the fuse box. If the 20A fuse is already plugged, do not plug the 20A blade fuse.

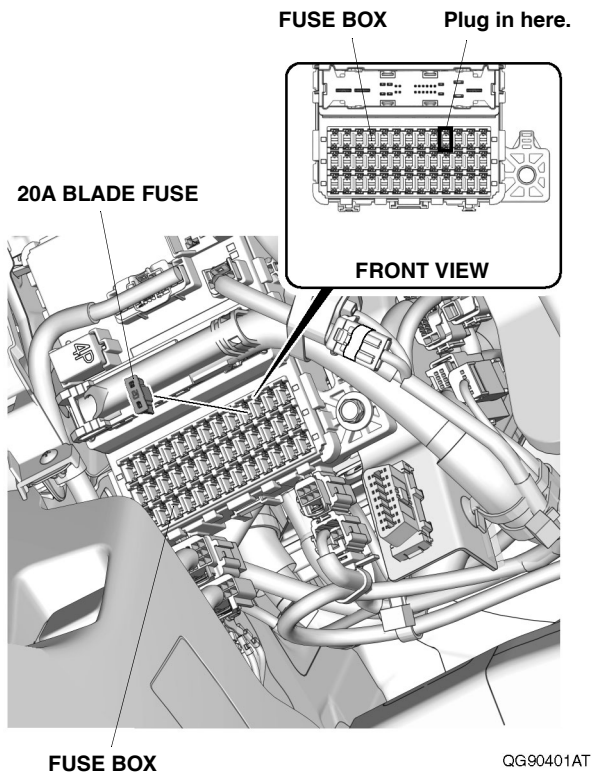

If the option fuse label is already attached on the driver's kick panel, go to step 55; otherwise continue with step 53.

53. Using isopropyl alcohol on a shop towel, thoroughly clean the area where the fuse label will attach.

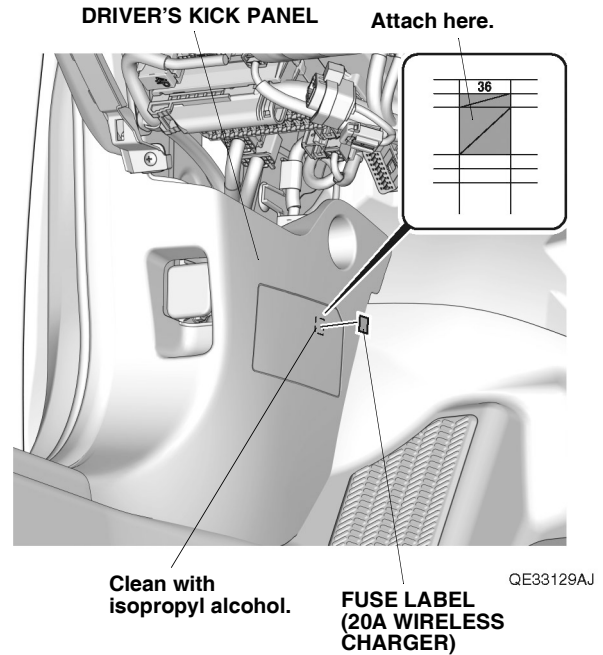

54. Attach the fuse label on the driver's kick panel.
55. Check that all wire harnesses are routed properly and all connectors are plugged in.
56. Install all removed parts.
57. Connect the negative cable to the battery.
58. Press and hold the audio unit power button for 2 seconds to restore the audio and navi (if equipped) system functions.
59. Set the clock on vehicles without navigation.
60. If necessary, restore the systems back to normal operation as described in the service information.

Check the Operation of the Wireless Charger

61. Check that the wireless charger works properly as described in the accessory user's information manual.