



HONDA INSTALLATION INSTRUCTIONS

Accessory

REAR USB CHARGER
P/N 08U57-TBA-100

Application

2021 CIVIC

Publications No.

VERSION 1

Issue Date

AUG 2020

PARTS LIST

USB Charger

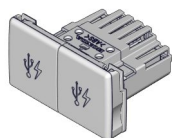

USB Charger harness

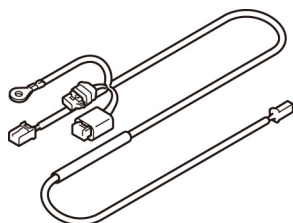

17 Wire ties
(Some may not be used)



Wire tie with clip



Fuse label

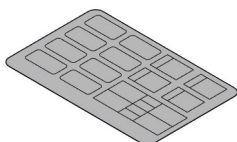

2 Well nuts



2 Screws



Cushion

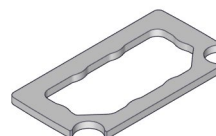

Template

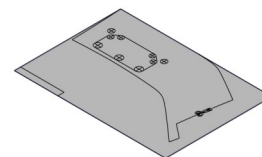

Accessory user's information manual

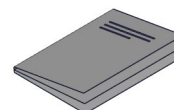

TOOLS AND SUPPLIES REQUIRED

Phillips screwdriver
Ratchet
10 mm Socket
10 mm Open end wrench
Isopropyl alcohol
Shop towel
Diagonal cutters
Pushpin
Scissors
Drill
3 mm, 6.5 mm, and 8 mm Drill bits
Eye protection (face shield, safety goggles, etc.)
File
Utility knife
Masking tape
Hacksaw

The following tools are available through the Honda Tool and Equipment Program. On the iN, click on Service > Service Bay > Tool and Equipment Program, then enter the number under "Search." Or, call 888-424-6857.

- Trim Tool Set (T/N SOJATP2014)
- Plastic Trim Tool (T/N SILTRIMTL10)

Illustration of the Rear USB Charger Installed in the Vehicle

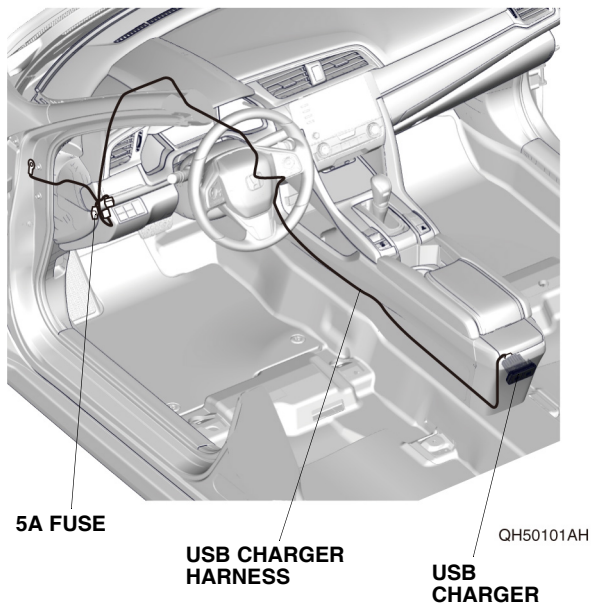

INSTALLATION

Customer Information: The information in this installation instruction is intended for use only by skilled technicians who have the proper tools, equipment, and training to correctly and safely add equipment to your vehicle. These procedures should not be attempted by "do-it-yourselfers."

1. Disconnect the negative cable from the battery.
2. Remove the driver's dashboard lower cover, unplug the vehicle connectors, and aspirator hose.

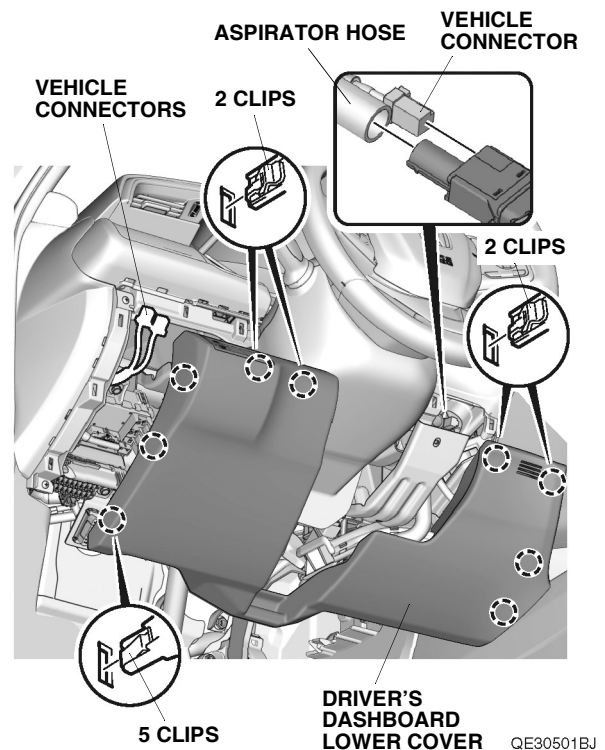

3. Remove the left console armrest.

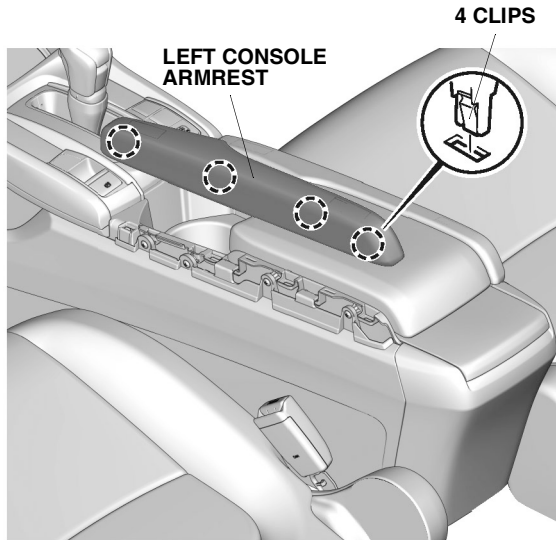

QE30558BJ

4. Attach masking tape to the area shown.

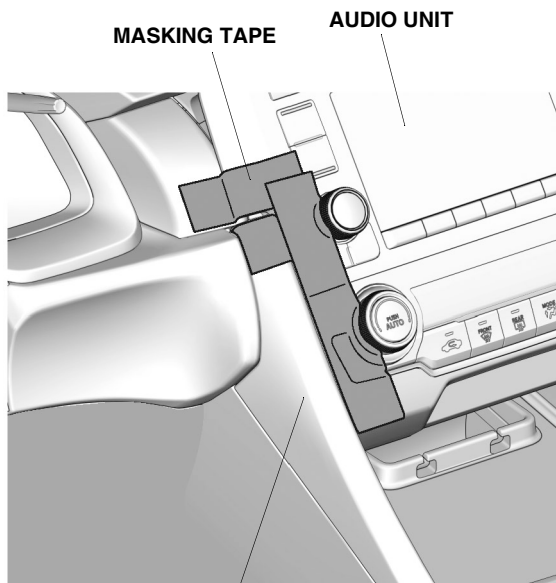

LEFT CENTER
CONSOLE TRIM

QE30518BJ

5. Remove the left center console trim.

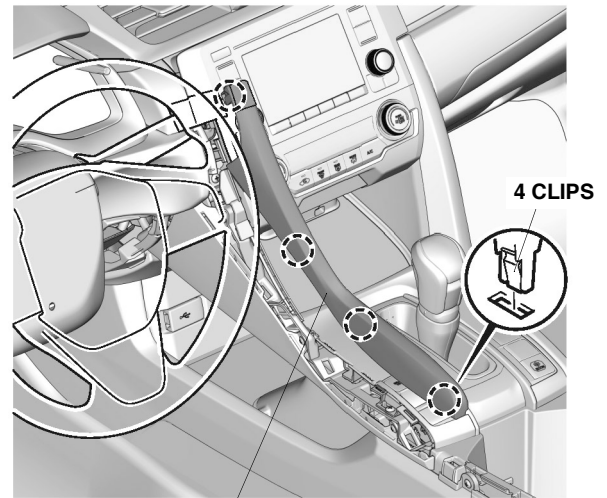

LEFT CENTER
CONSOLE TRIM

QE30555BJ

6. Remove the right console armrest.

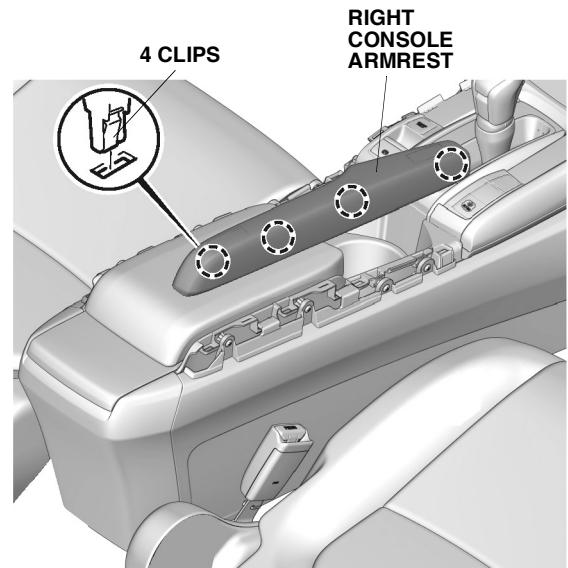

QE30559CJ

7. Attach masking tape to the area shown.

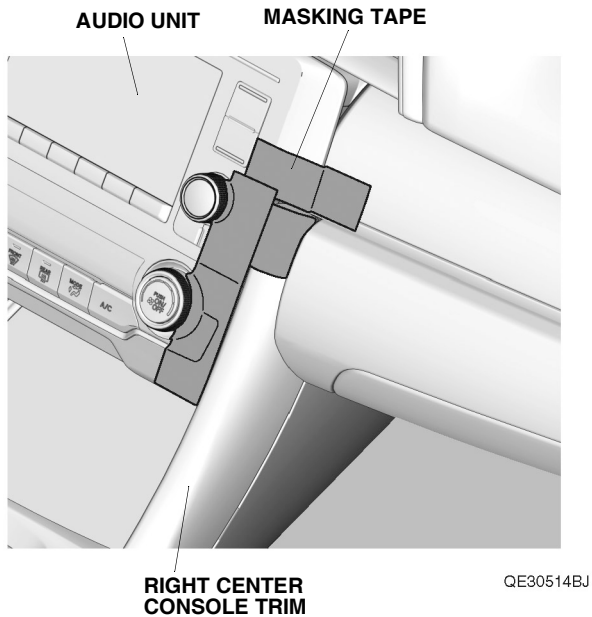

8. Remove the right center console trim.

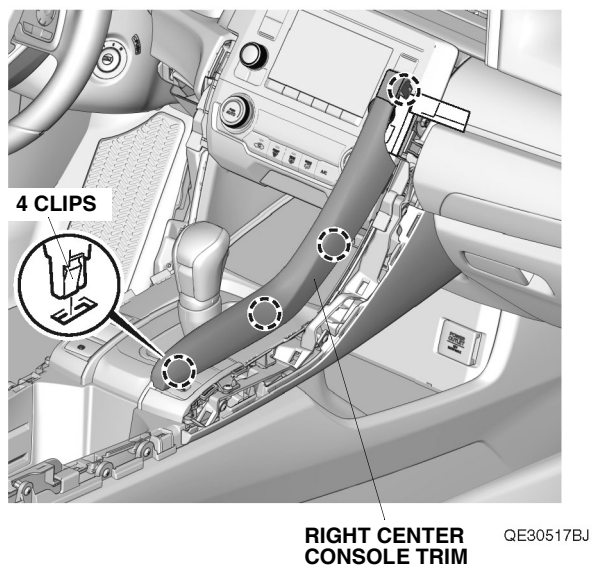

9. Remove the A/C control unit, and unplug the vehicle connectors.

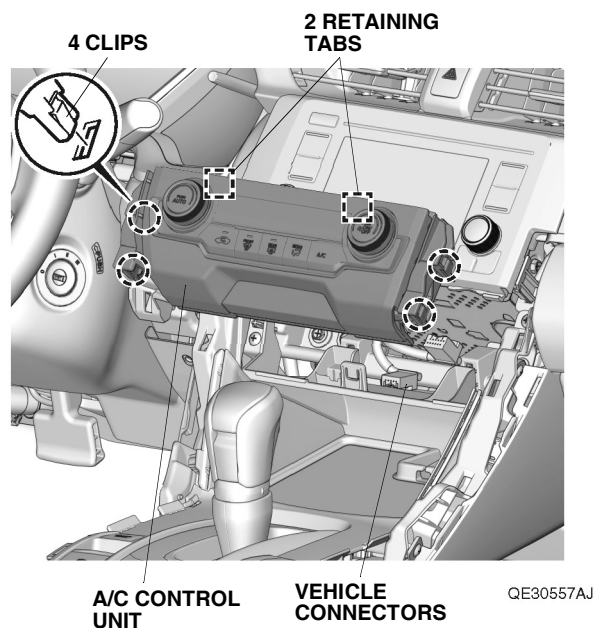

10. Remove the console rear panel.

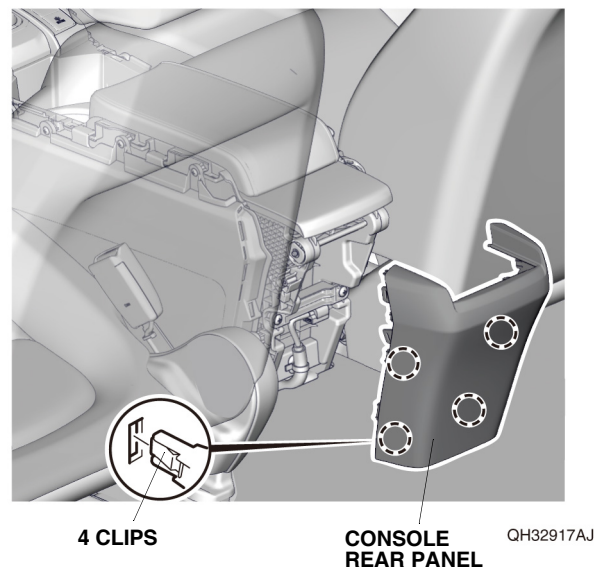

11. Remove the shift lever console panel:

A/T Models

- Open the center console armrest, and slide the sliding tray (if equipped) and the beverage holder rearward.
- Remove the shift lock release cover with a plastic trim tool.
- Insert the key into the shift lock release slot, and move the shift lever knob to the D position.

NOTE: Make sure to apply the parking brake.

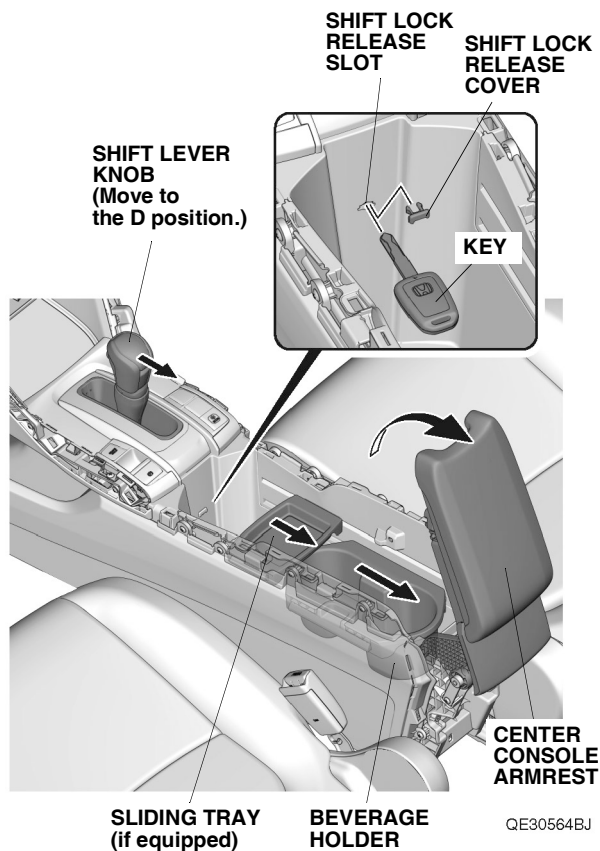

- Remove the console panel, and unplug the vehicle connectors.

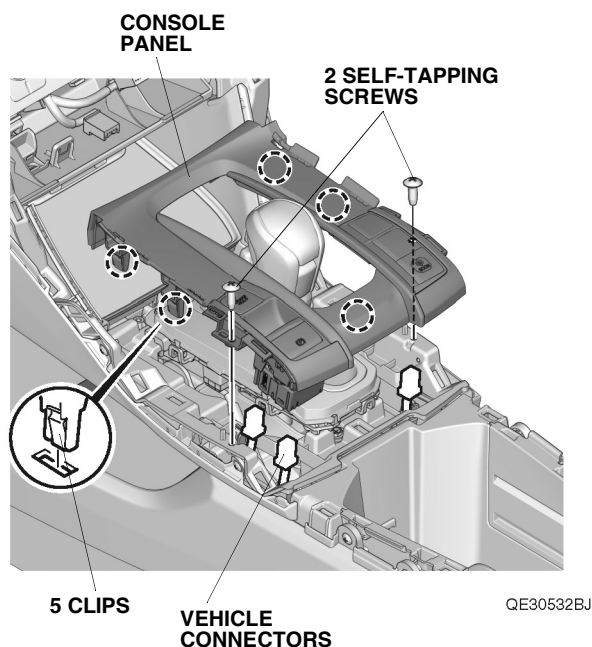

- Release the shift lever panel.

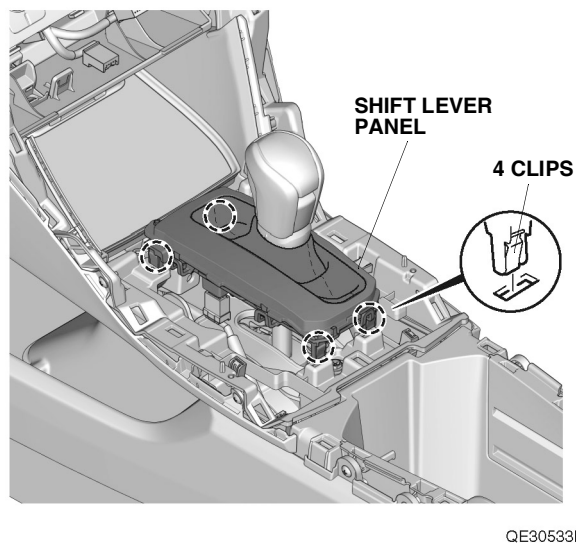

M/T Models

- Lower the shift lever boot to release two retaining tabs from the boot.
- Remove the shift lever knob.

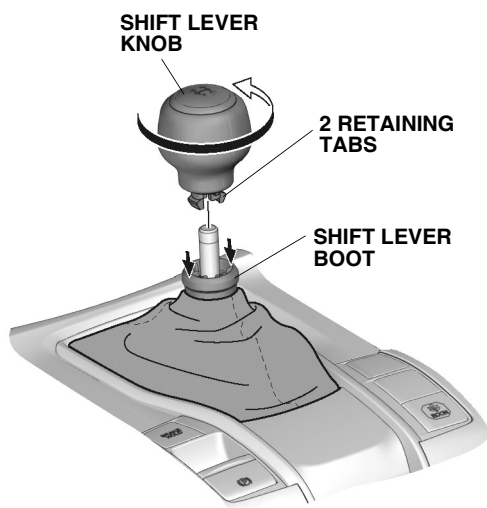

QE30541AJ

- Remove the shift lever panel, and unplug the vehicle connectors.

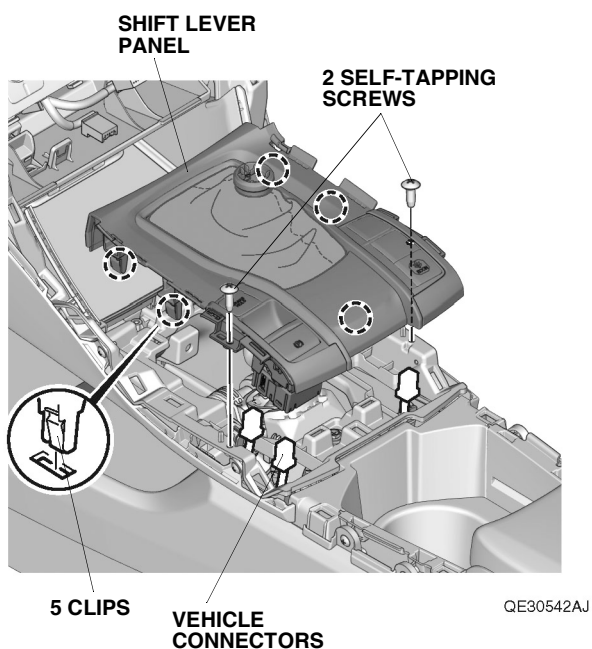

QE30542AJ

12. Remove the upper tray mat.

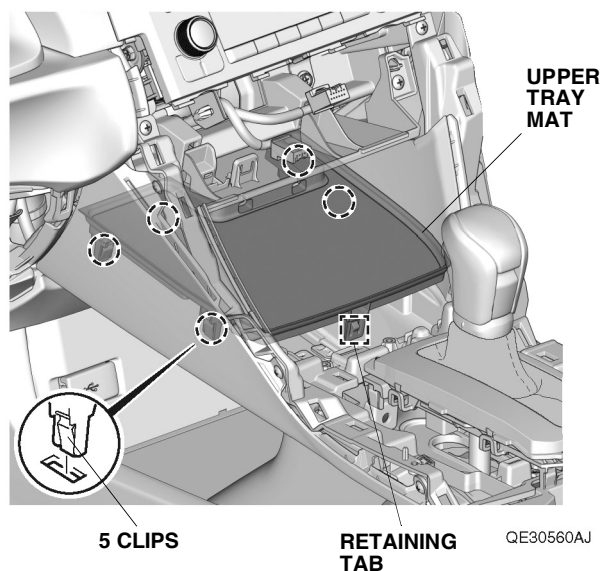

QE30560AJ

13. Remove the console panel.

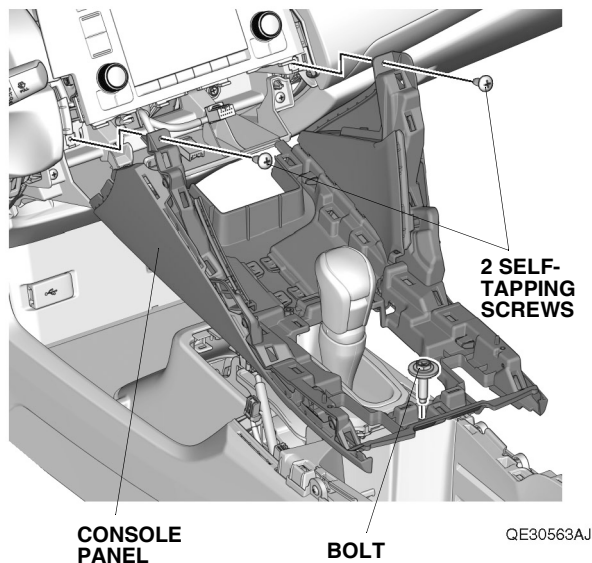

QE30563AJ

14. If equipped, remove the lower tray mat.

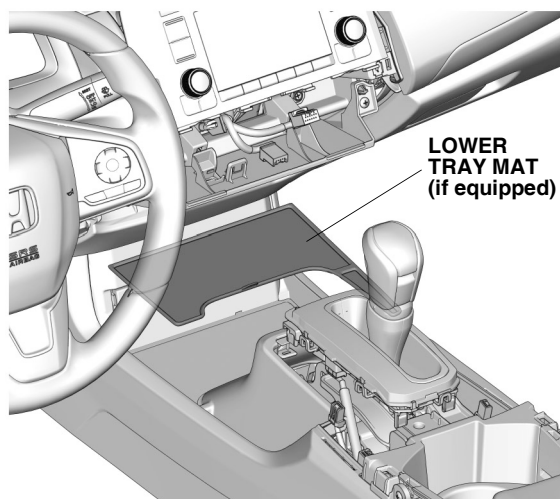

QE30546BJ

15. Using a plastic trim tool, remove the switch panel, and unplug the vehicle connectors.

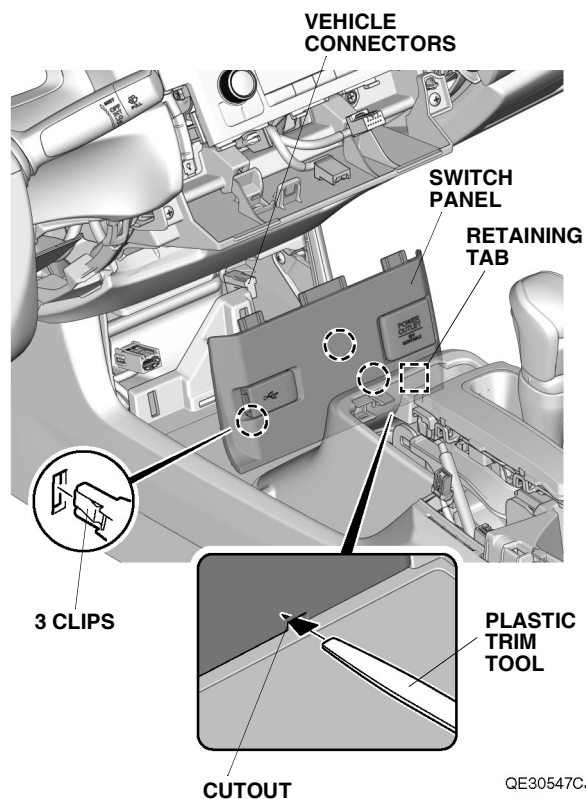

QE30547CJ

16. If equipped, release the vehicle clip, and unplug the vehicle connector.

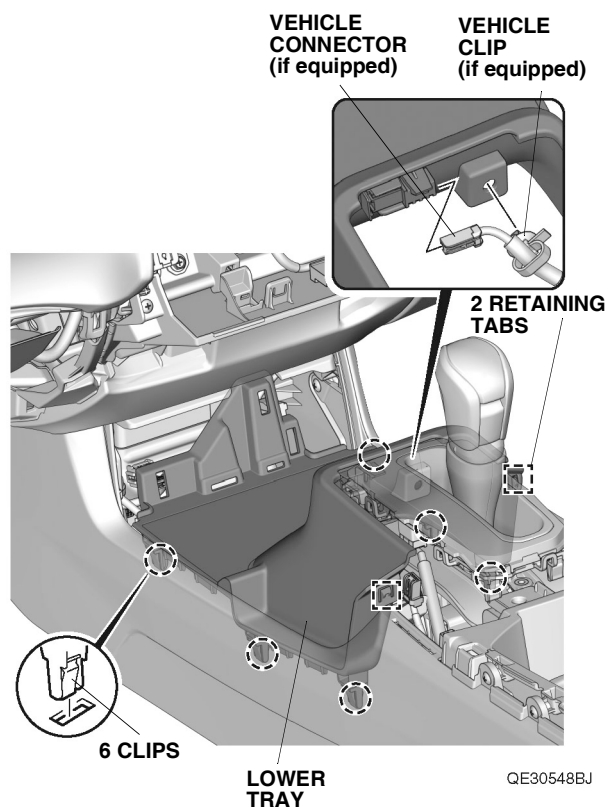

QE30548BJ

17. Remove the lower tray.

18. Remove the left side panel.

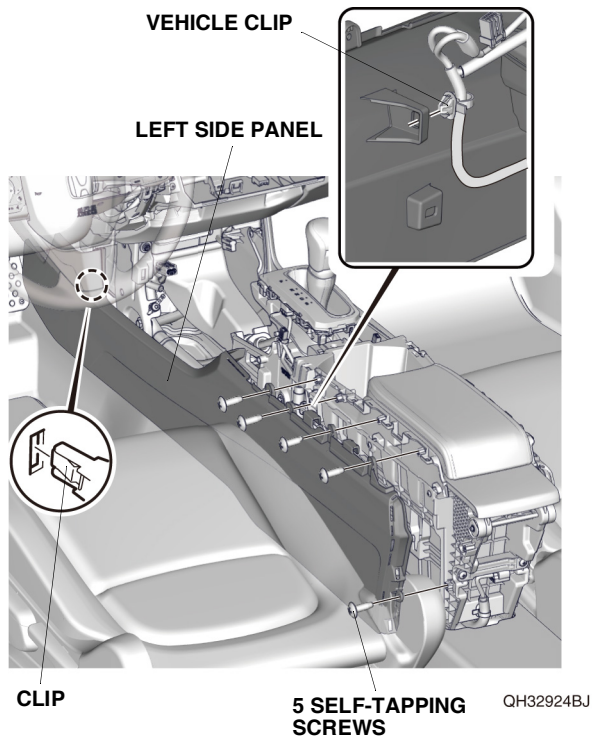

19. Open the console center armrest, and remove the mat and two bolts.

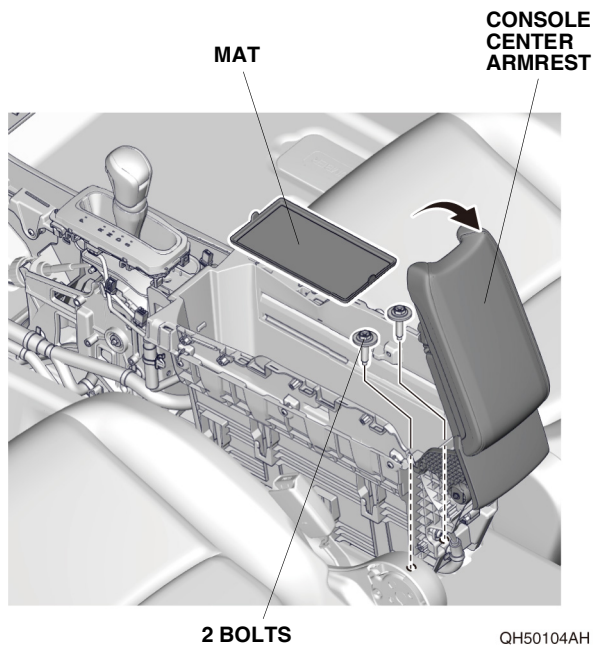

20. Using isopropyl alcohol on a shop towel, thoroughly clean the fuse case where the fuse label will attach. Attach the fuse label (5A 2PLUG USB CHARGER) to the fuse case on the USB charger harness.

**FUSE LABEL
(5A 2PLUG
USB CHARGER)**

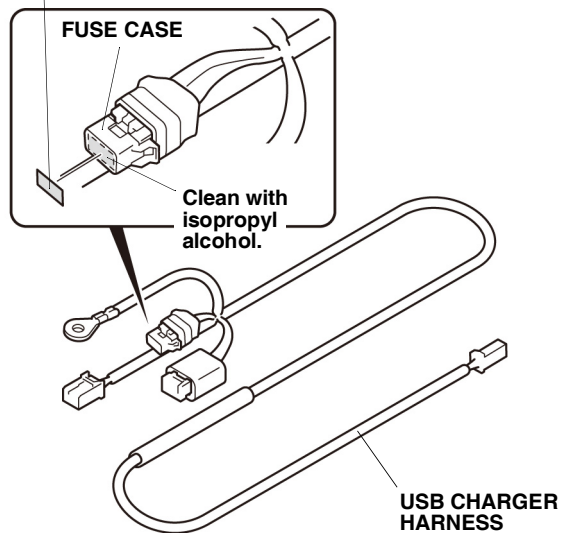

21. Plug the USB charger harness 4-pin connector into the fuse box.

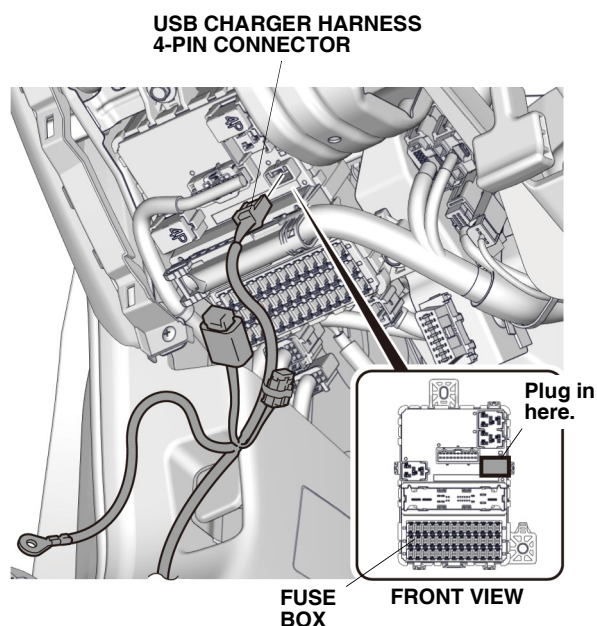

WITH OTHER ACCESSORY HARNESSES
If the dummy connector is plugged, unplug it.

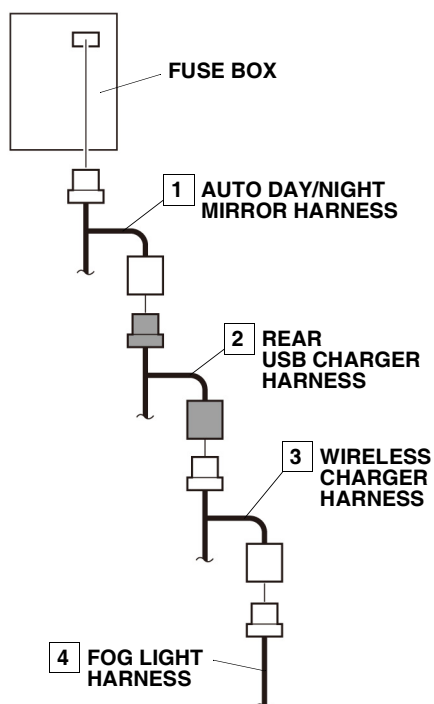

QH50106AH

22. Line up the branch of the USB charger harness with the branch of the vehicle harness, and secure the USB charger harness to the vehicle harness with two wire ties.

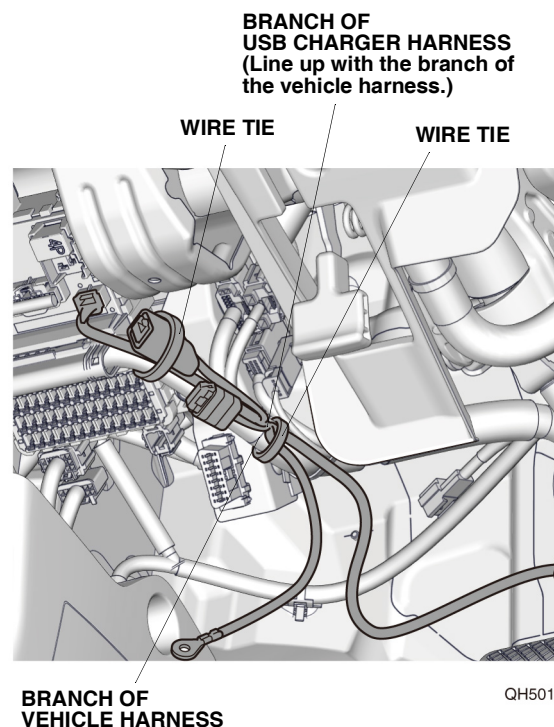

23. Remove the vehicle ground bolt, and install the USB charger harness ground terminal with vehicle ground bolt as shown. Do not put the ground terminal calking on top of one another.

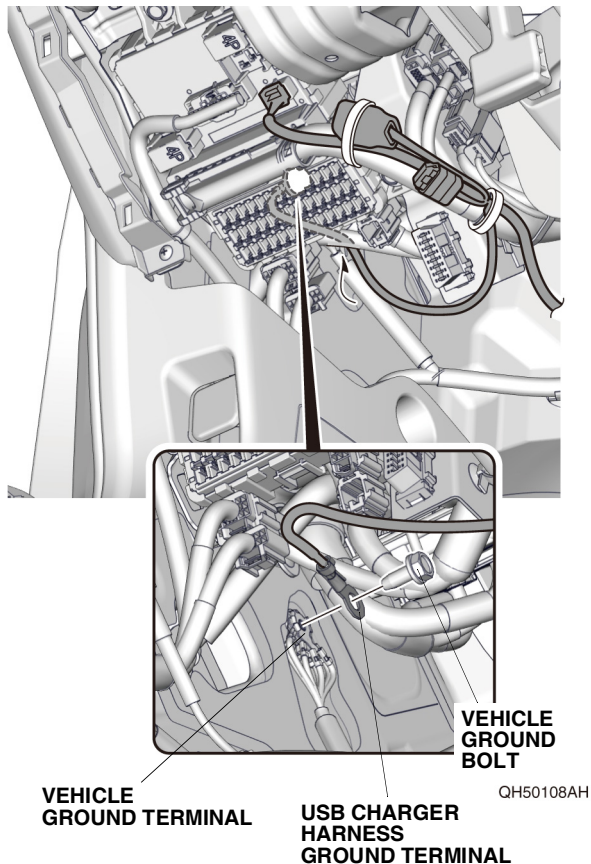

24. Secure the USB charger harness to the vehicle harness with two wire ties.

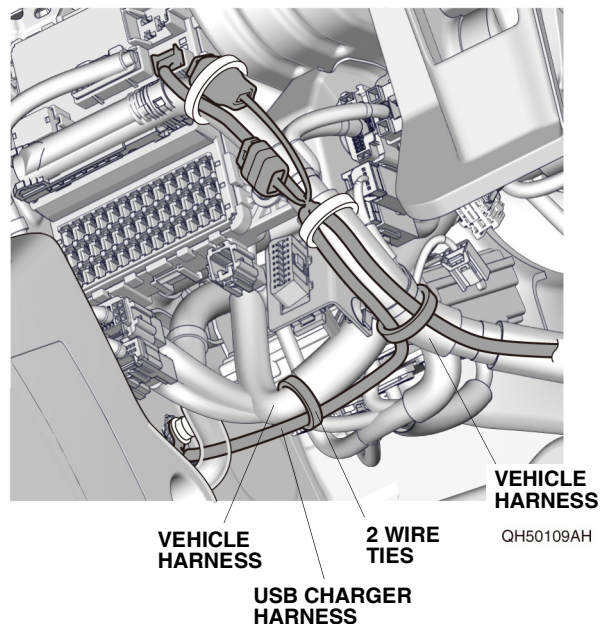

If A/T models, continue with step 25; otherwise, go to step 26.

A/T Models

25. Route the USB charger harness along the vehicle harness as shown. Go to step 27.

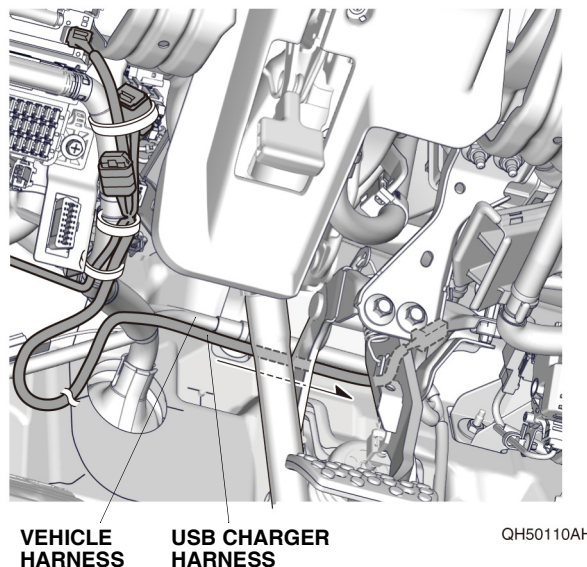

M/T Models

26. Route the USB charger harness along the vehicle harness as shown.

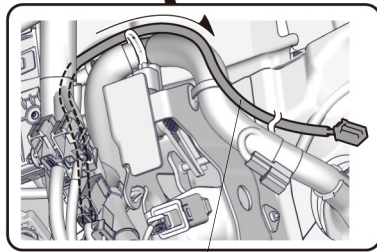
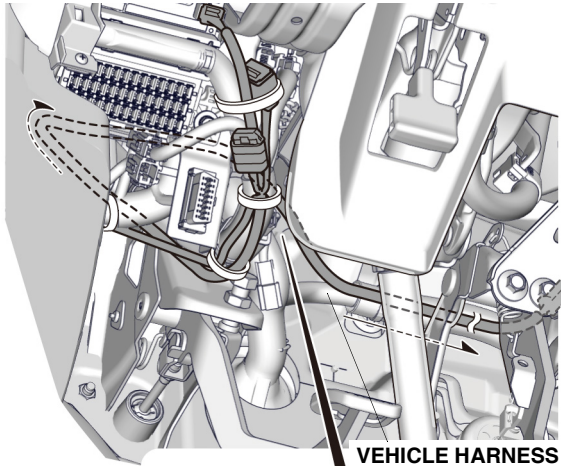

USB CHARGER HARNESS

QH50111AH

27. Route the USB charger harness along the vehicle harness as shown.

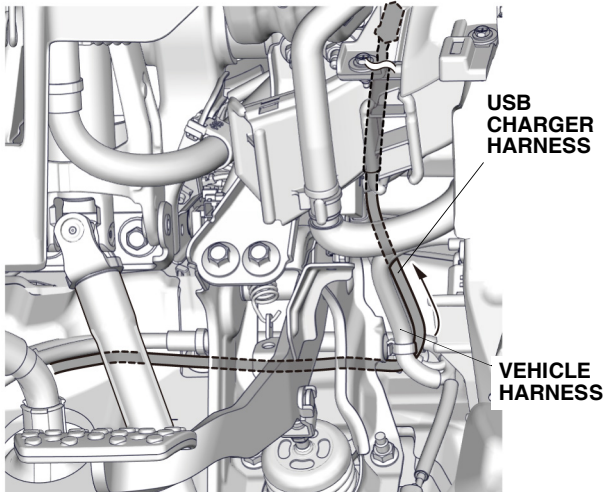

QH50112AH

28. Route the USB charger harness as shown.

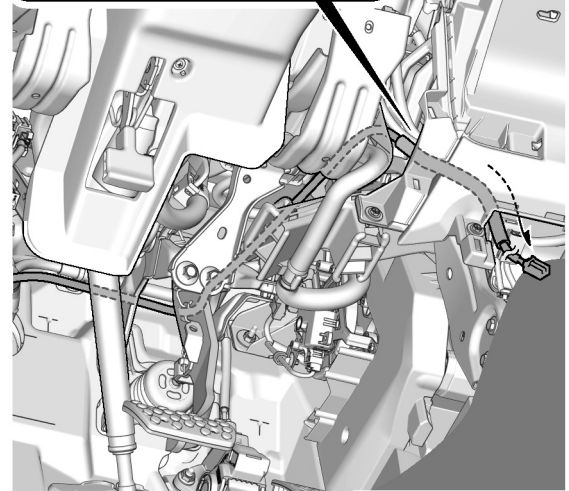
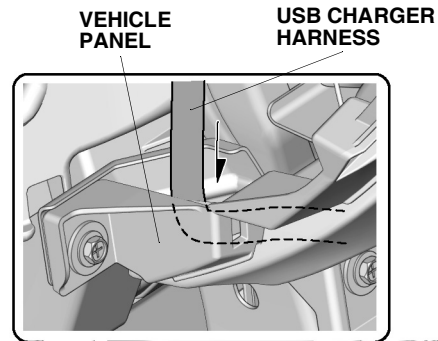

QH50113BH

29. Line up the end of the urethane tape on the USB charger harness with the vehicle panel hole, and secure the USB charger harness to the vehicle panel with one wire tie as shown.

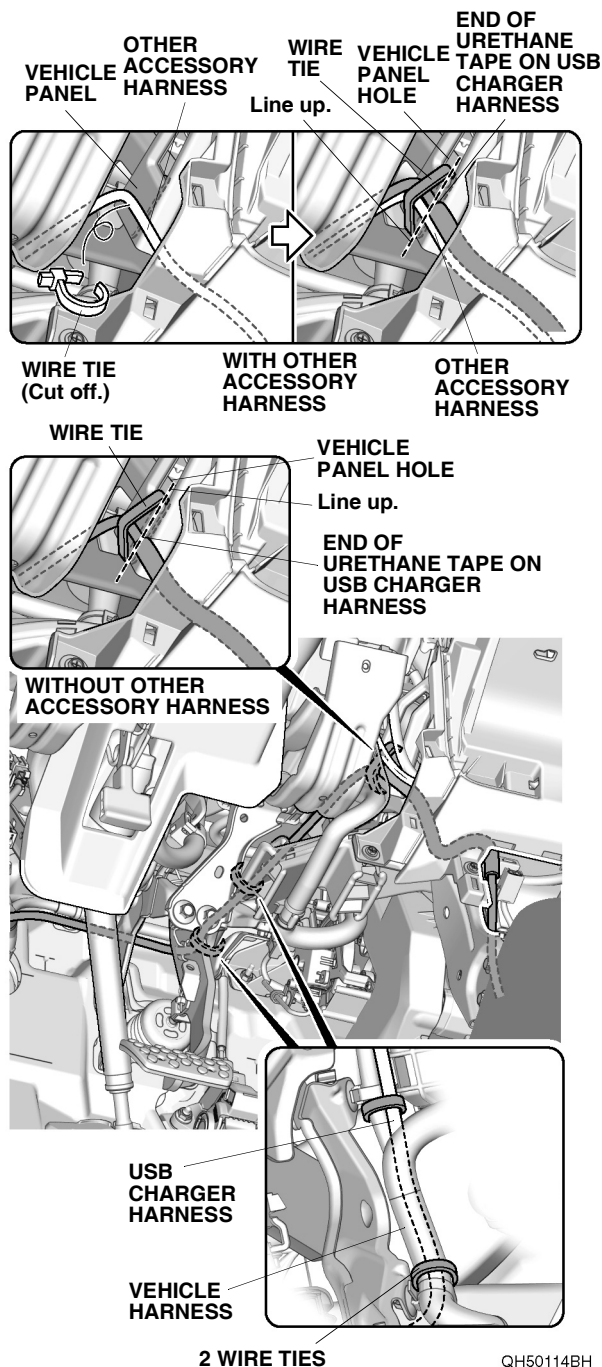

30. Secure the USB charger harness to the vehicle harness with two wire ties.

If A/T models, continue with step 31; otherwise, go to step 32.

A/T Models

31. Bundle up the excess USB charger harness as shown, and secure the USB charger harness to the vehicle harness with two wire ties. Go to step 33.

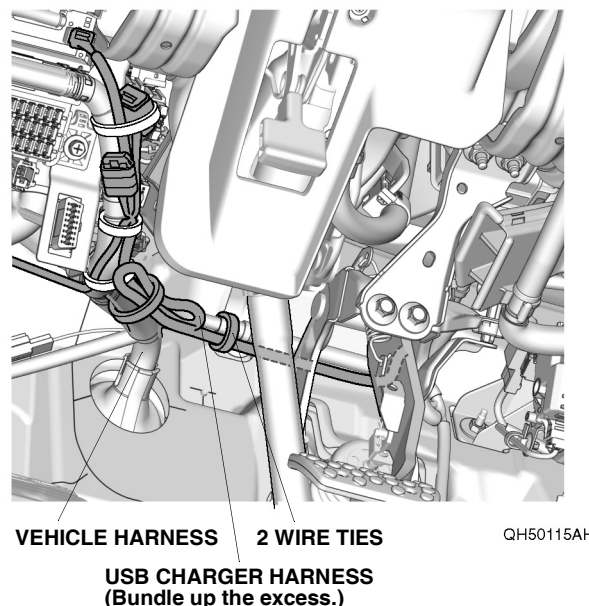

M/T Models

32. Secure the USB charger harness to the vehicle harness with four wire ties.

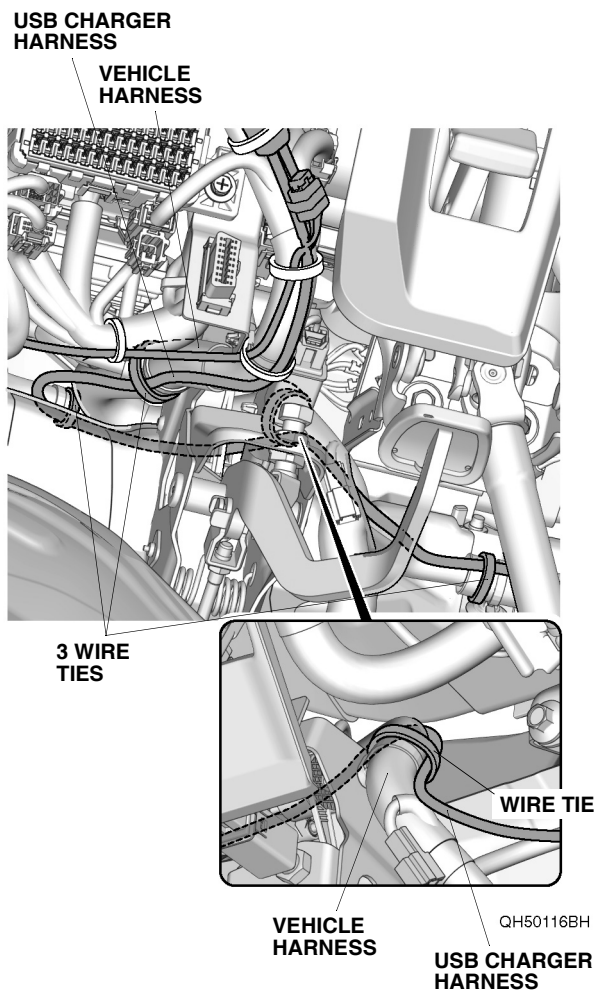

33. Route the wireless charger harness as shown. Secure the USB charger harness to the vehicle harness with two wire ties.

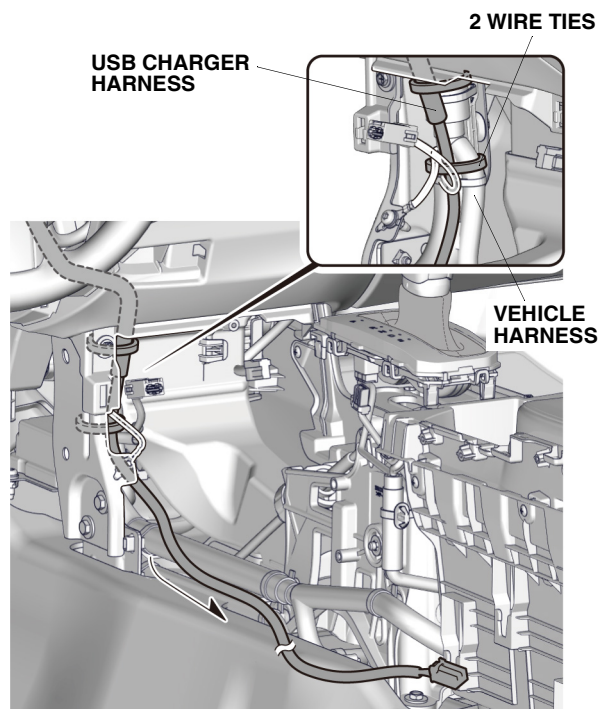

34. Route the USB charger harness as shown.

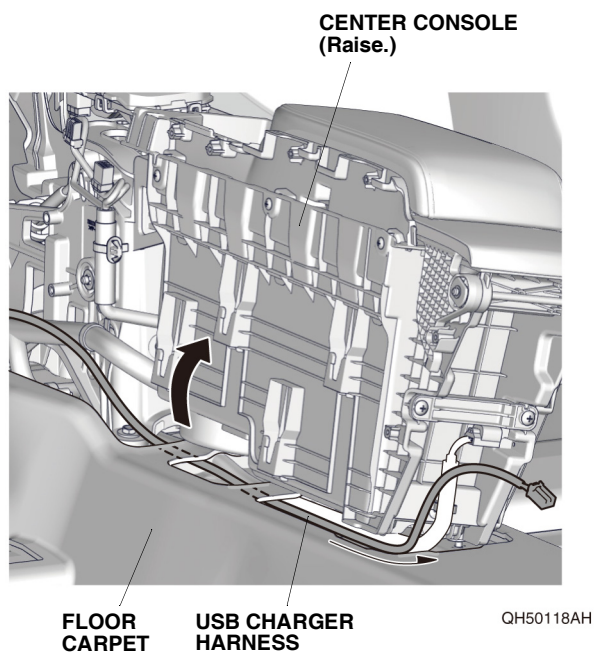

If the vehicle is equipped with keyless access system, continue with step 35; otherwise, go to step 39.

With keyless access system

35. Release the bracket, and route the USB charger harness as shown.

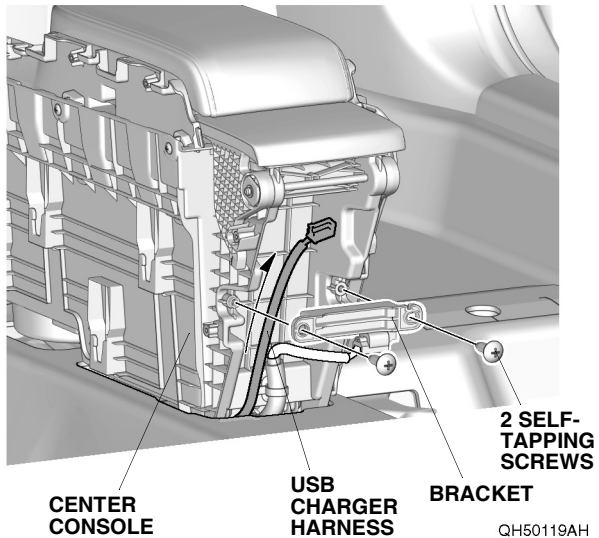

36. Install the bracket.

37. Using diagonal cutters, cut the clip portion off of one wire tie with clip.

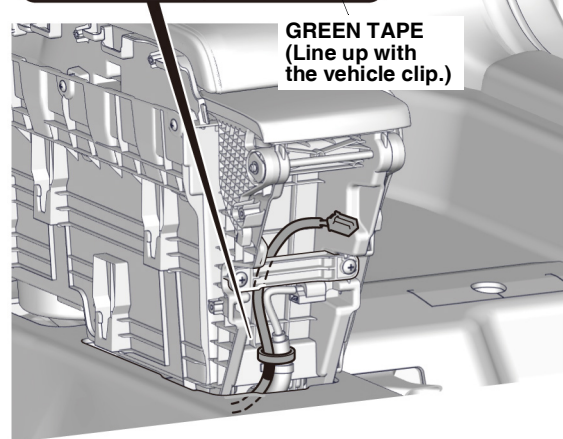
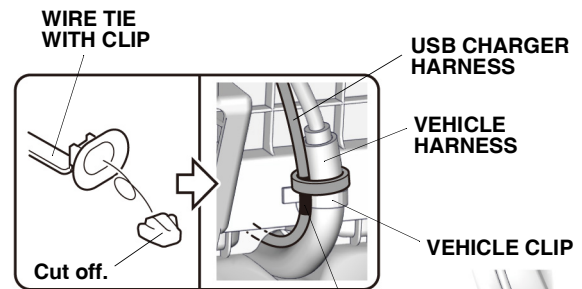

QH50120AH

38. Line up the green tape on the USB charger harness with the vehicle clip, and secure the USB charger harness to the vehicle harness with one wire tie with clip. Go to step 40.

Without keyless access system

39. Secure the USB charger harness to the center console with one wire tie with clip at the green tape on the USB charger harness.

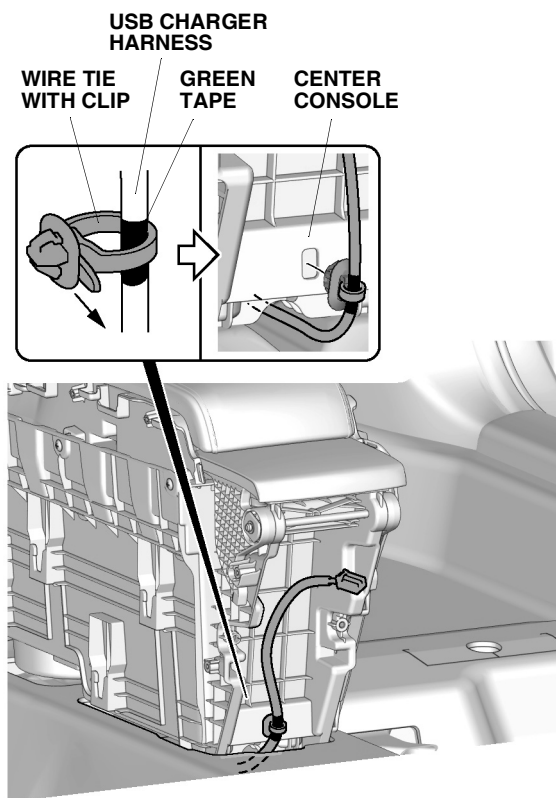

QH50121AH

40. Secure the USB charger harness to the vehicle harness with four wire ties.

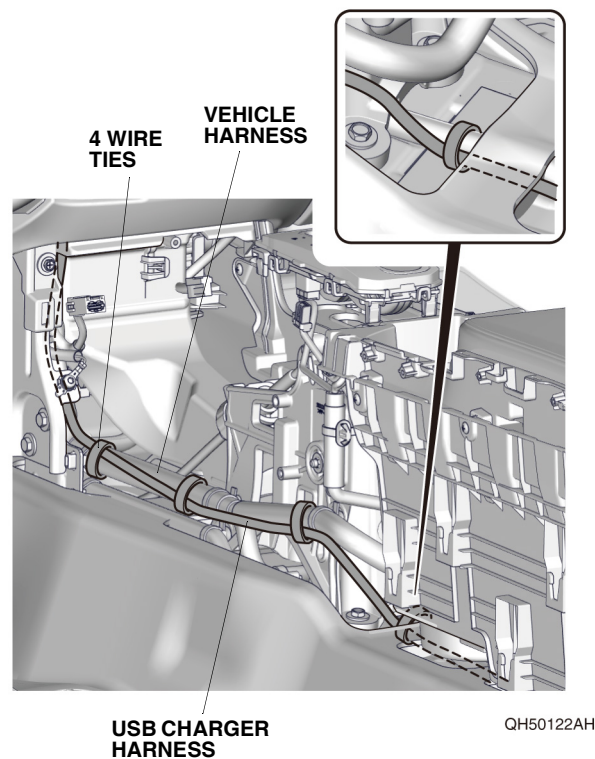

QH50122AH

41. Using scissors, cut out the template.

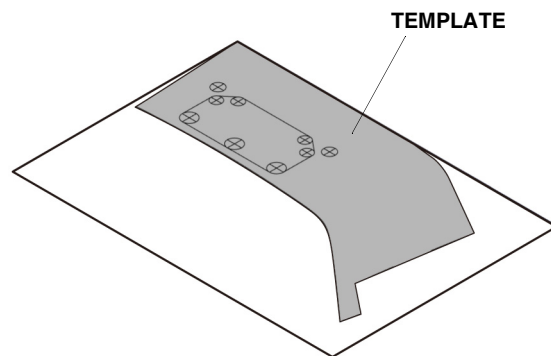

QH50123AH

42. Line up template with the console rear panel, and attach it with masking tape as shown.

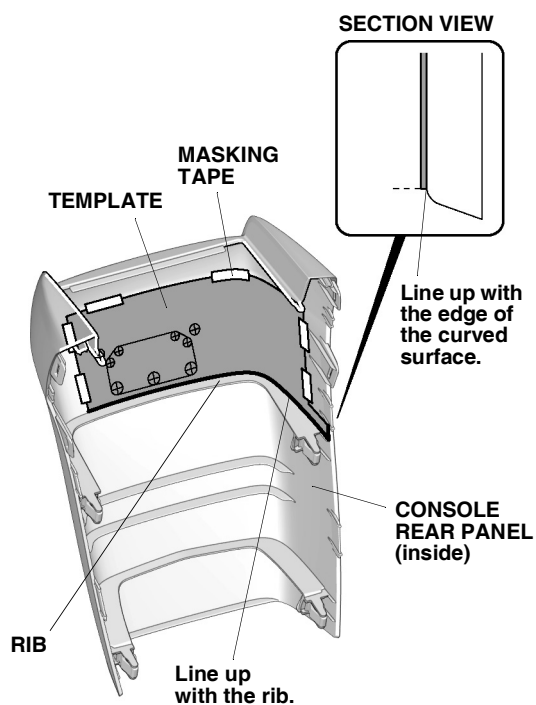

QH50124AH

43. Using a pushpin, pierce the nine marks in the template.
- NOTE:** Make sure to pierce the marks perpendicular to the console rear panel.

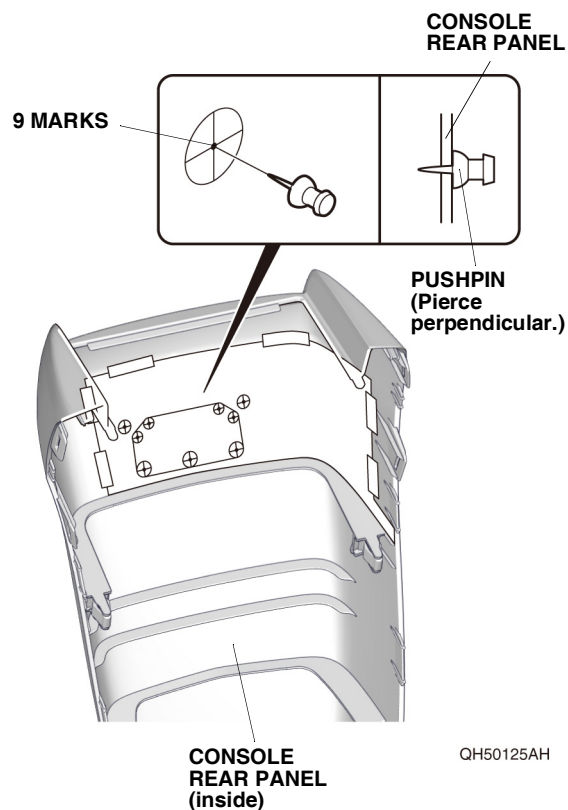

QH50125AH

44. Using a utility knife, mark the console rear panel along the printed line in the template. Remove the template.

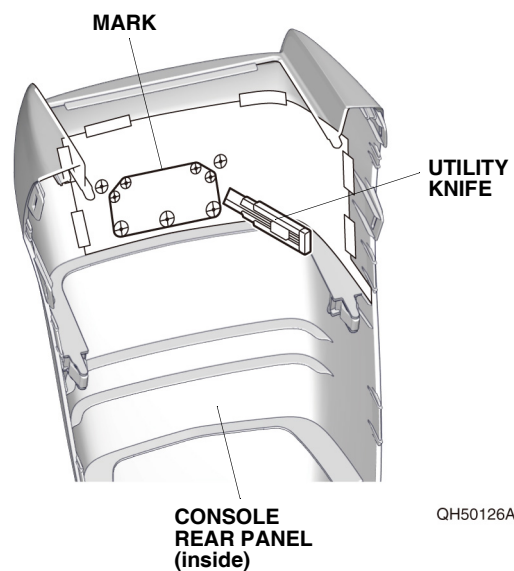

QH50126AH

45. While wearing eye protection, drill the nine pierced marks on the console rear panel to 6.5 mm. First, drill with a 3 mm drill bit, then finish with a 6.5 mm drill bit. Remove any burrs.

NOTE: Make sure to drill perpendicular to the console rear panel.

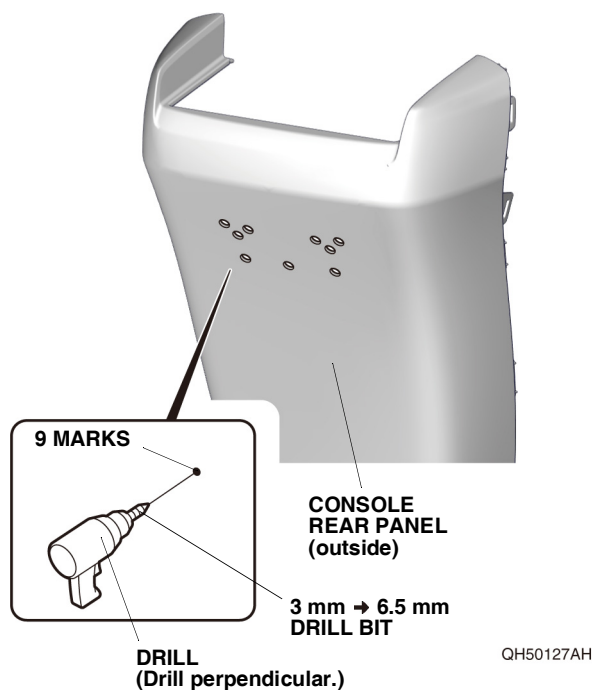

46. While wearing eye protection, enlarge the three 6.5 mm holes to 8 mm with an 8 mm drill bit.

NOTE:

- Make sure to drill the correct positions.
- Make sure to drill perpendicular to the console rear panel.

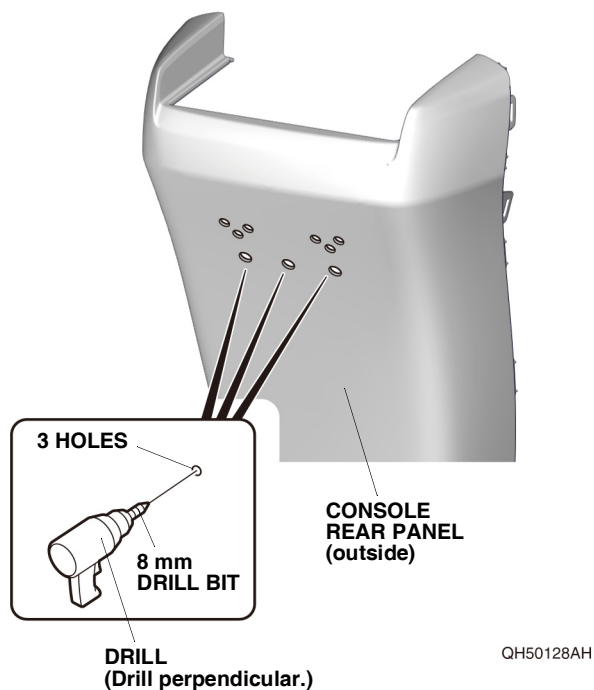

47. Using a hacksaw, cut out the console rear panel along the marks made in step 44. Remove any burrs.

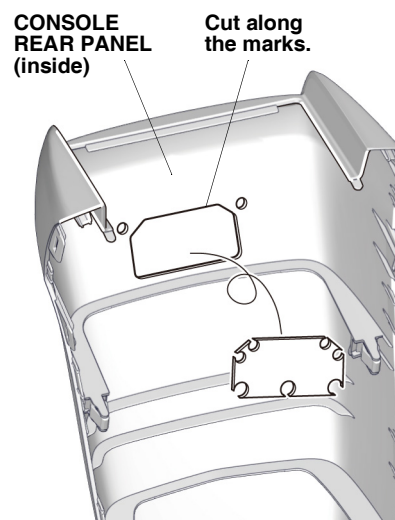

QH50129AH

48. Install the two well nuts to the console rear panel.

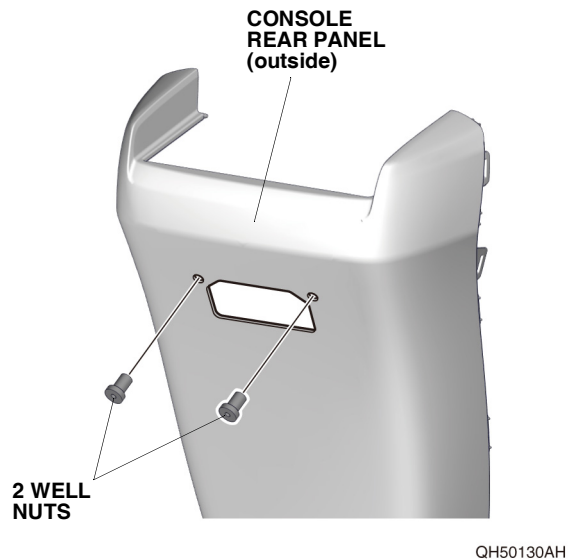

49. Install the cushion to the USB charger.

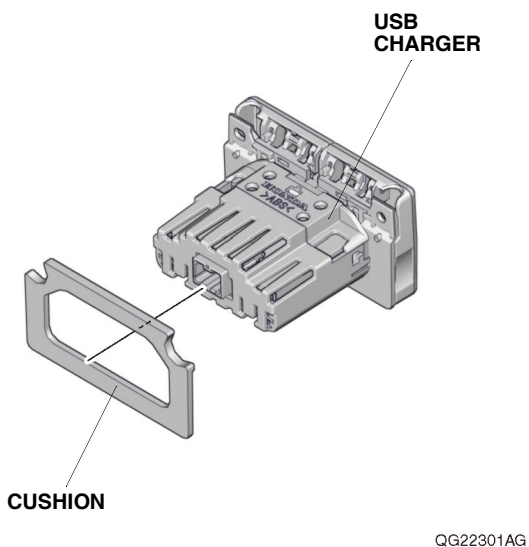

50. Install the USB charger to the console rear panel with two screws as shown.
NOTE: Do not over tighten the screws. Make sure that the cushion does not protrude from the USB charger.

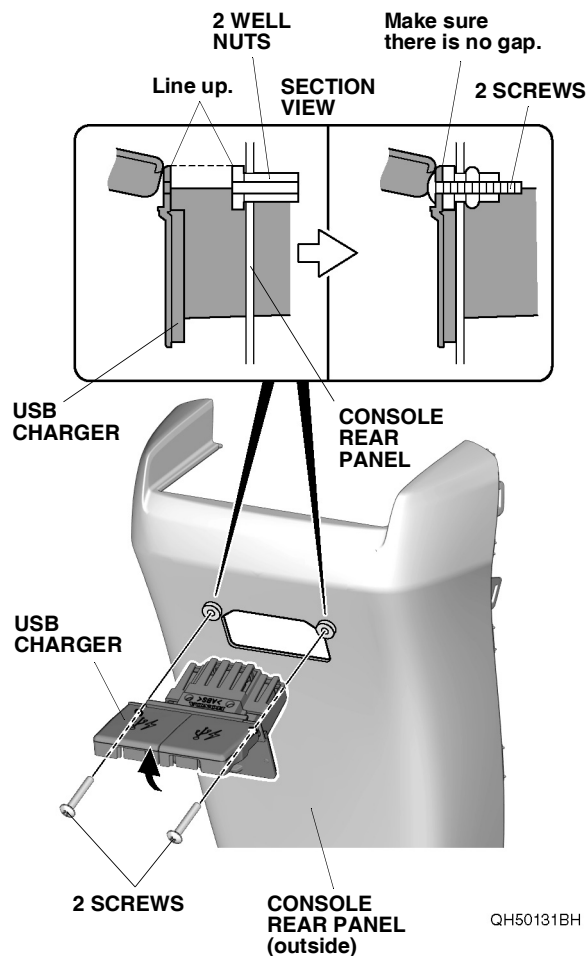

51. Install the left side panel.

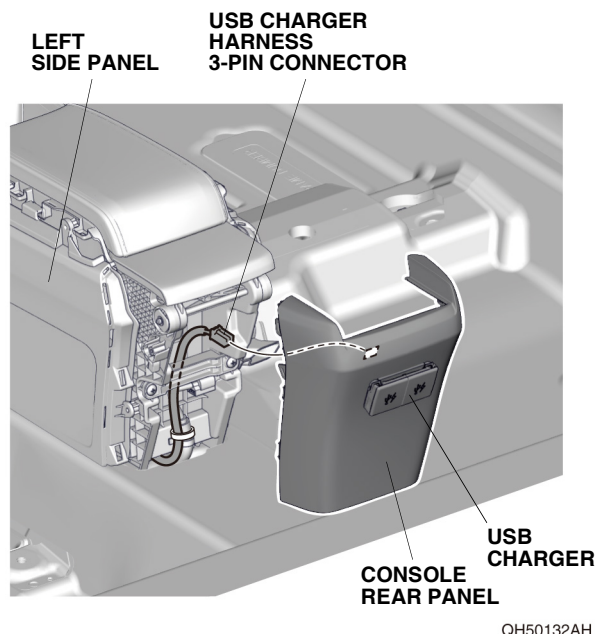

52. Plug the USB charger harness 3-pin connector into the USB charger, and install the console rear panel.
53. Using isopropyl alcohol on a shop towel, thoroughly clean the driver's kick panel where the fuse label will attach.

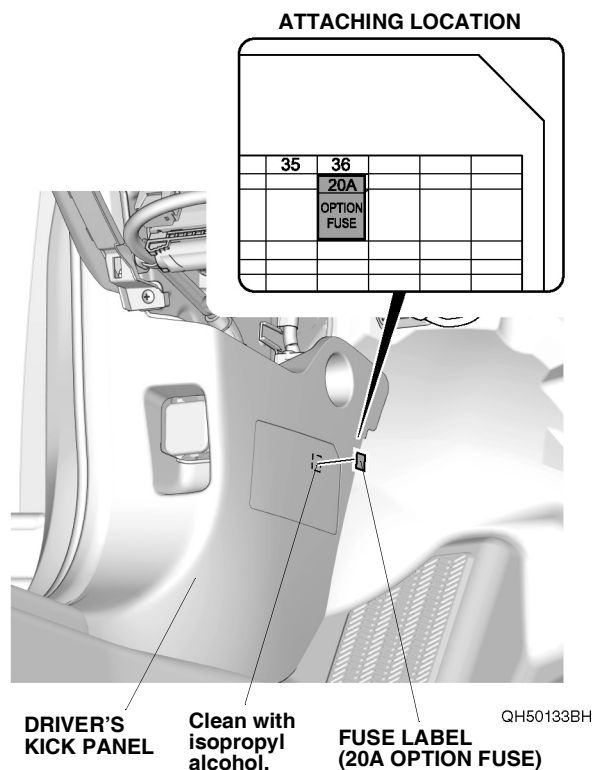

54. Attach the fuse label on the driver's kick panel.

55. Check that all wire harnesses are routed properly and all connectors are plugged in.
56. Install all removed parts.
57. Connect the negative cable to the battery.
58. Press and hold the audio unit power button for 2 seconds to restore the audio and navi (if equipped) system functions.
59. Set the clock on vehicles without navigation.
60. If necessary, restore the systems back to normal operation as described in the service information.

Check the Operation of the Rear USB Charger

61. Make sure the rear USB charger works properly as described in the accessory user's information manual with this kit.