



## HONDA INSTALLATION INSTRUCTIONS

### Accessory

INTERIOR PANELS  
P/N 08Z03-TBA-100

### Application

2021 CIVIC

### Publications No.

VERSION 1

### Issue Date

AUG 2020

## PARTS LIST

Driver upper outer panel



Driver upper inner panel



Driver lower panel



Passenger panel



2 Alcohol wipes

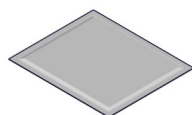

## TOOLS AND SUPPLIES REQUIRED

Masking tape

## Illustration of the Interior Panels Installed in the Vehicle

DRIVER UPPER  
OUTER PANEL      DRIVER UPPER  
INNER PANEL      PASSENGER  
PANEL

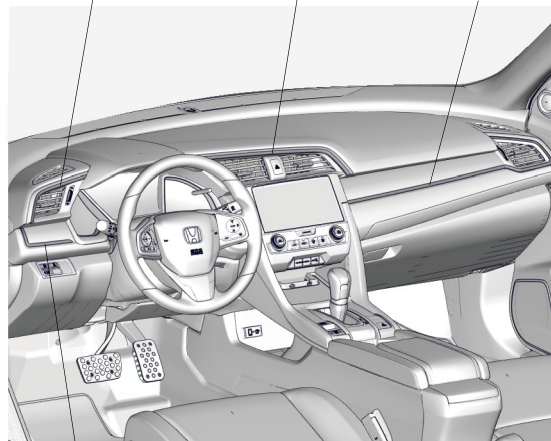

DRIVER LOWER  
PANEL

QH41901AT

## INSTALLATION

**Customer Information:** The information in this installation instruction is intended for use only by skilled technicians who have the proper tools, equipment, and training to correctly and safely add equipment to your vehicle. These procedures should not be attempted by "do-it-yourselfers."

### NOTE:

- Be careful not to damage the body paint finish.
- This kit should be installed only if the ambient air temperature is 60°F (15°C) or above.

1. Peel back the adhesive backings, and tape them to the front surface of the driver upper outer panel with masking tape.

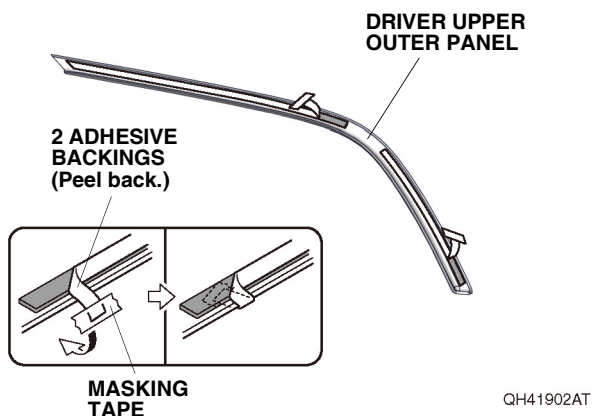

2. Using an alcohol wipe, thoroughly clean the meter lower visor where the driver upper outer panel will attach.

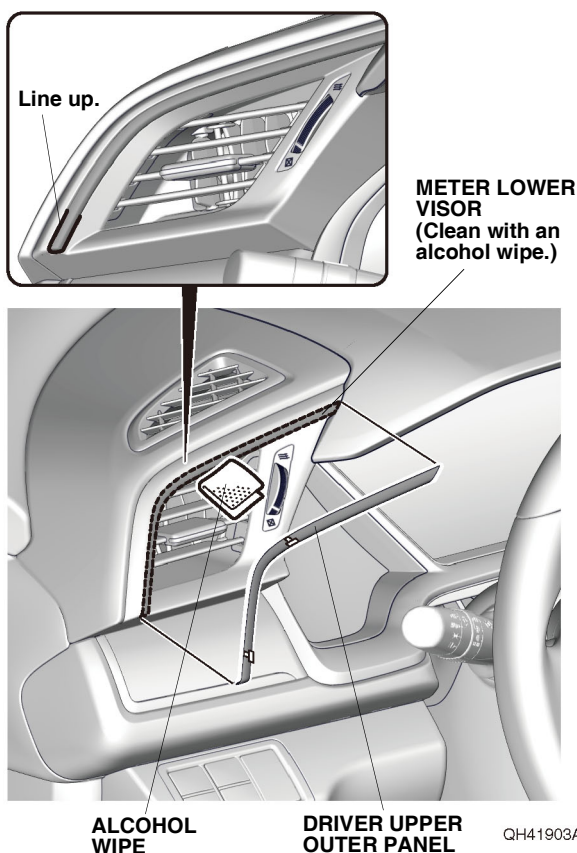

3. Line up the driver upper outer panel with the meter lower visor, and attach it as shown.

4. While applying light pressure against the driver upper outer panel, carefully remove the taped adhesive backings.

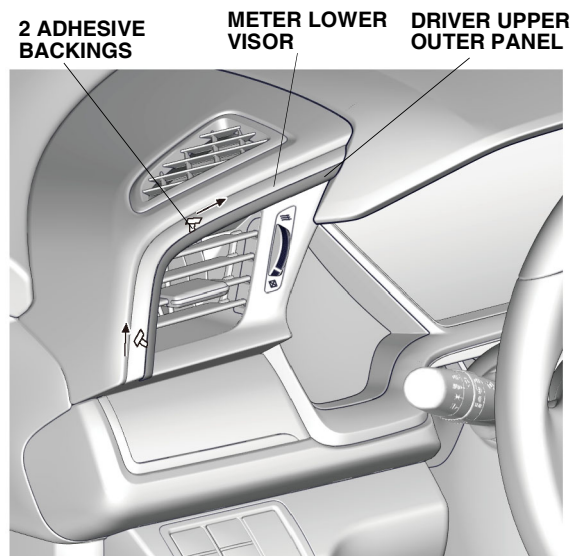

5. Using the palm of your hand, firmly press the driver upper outer panel against the meter lower visor.
6. Peel back the adhesive backings, and tape them to the front surface of the driver lower panel with masking tape.

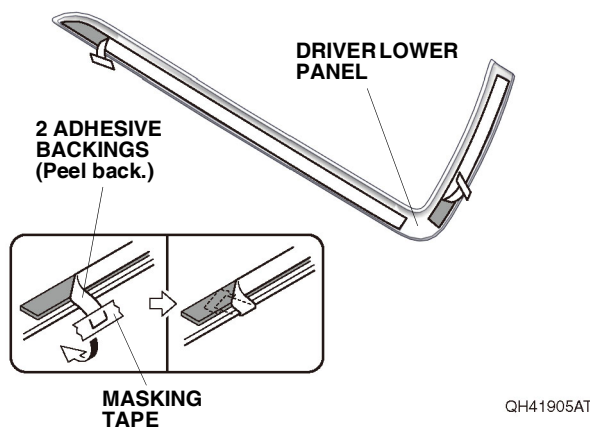

- Using an alcohol wipe, thoroughly clean the meter lower visor where the driver lower panel will attach.

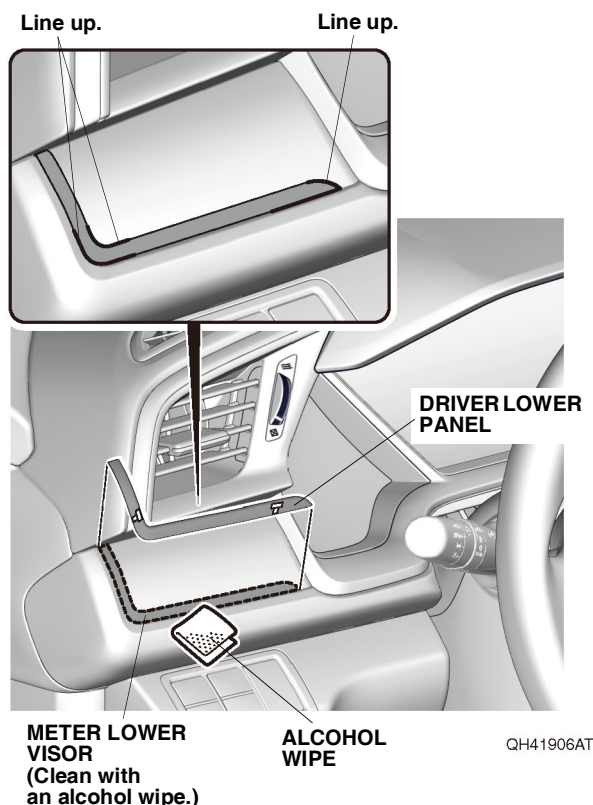

- Line up the driver lower panel with the meter lower visor, and attach it as shown.
- While applying light pressure against the driver lower panel, carefully remove the taped adhesive backings.

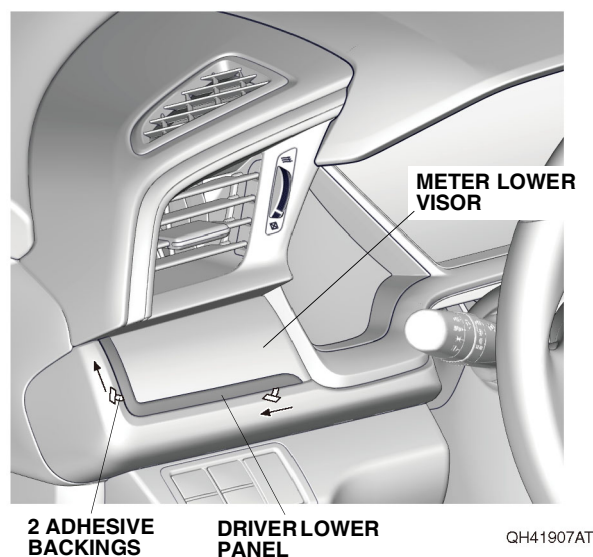

- Using the palm of your hand, firmly press the driver lower panel against the meter lower visor.

- Peel back the adhesive backings, and tape them to the front surface of the driver upper inner panel with masking tape.

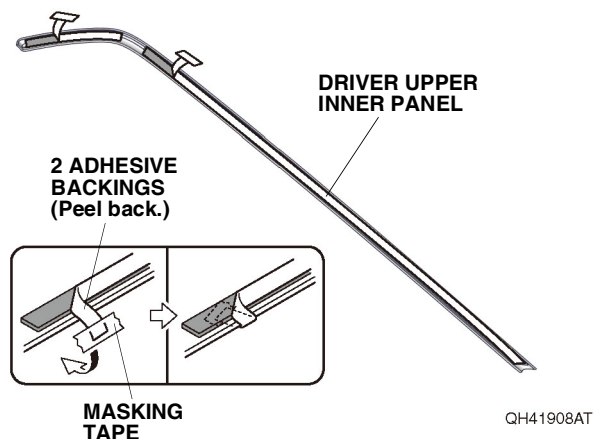

- Using an alcohol wipe, thoroughly clean the meter lower visor where the driver upper inner panel will attach.

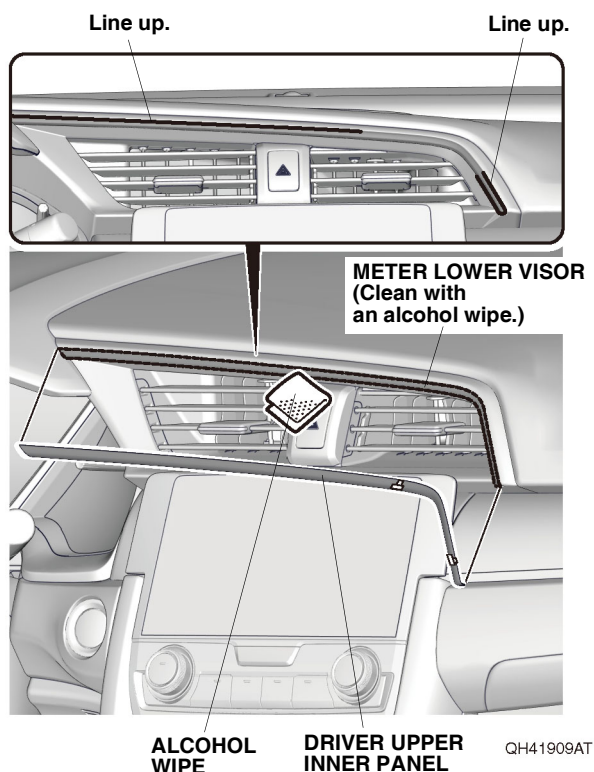

- Line up the driver upper inner panel with the meter lower visor, and attach it as shown.

14. While applying light pressure against the driver upper inner panel, carefully remove the taped adhesive backings.

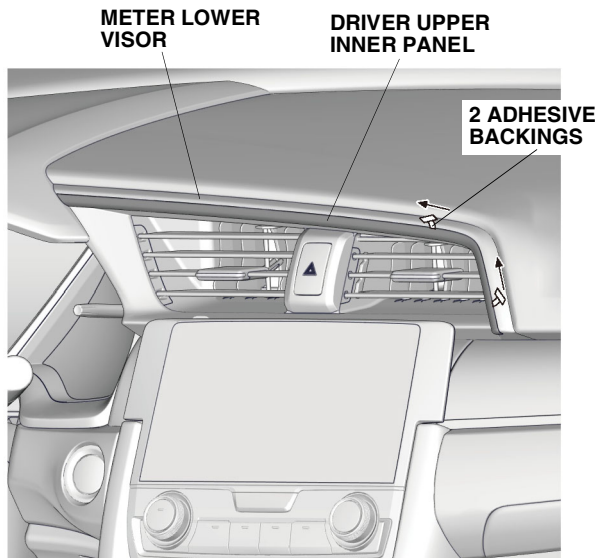

QH41910AT

15. Using the palm of your hand, firmly press the driver upper inner panel against the meter lower visor.
16. Peel back the adhesive backings, and tape them to the front surface of the passenger panel with masking tape. Remove the remaining adhesive backings.

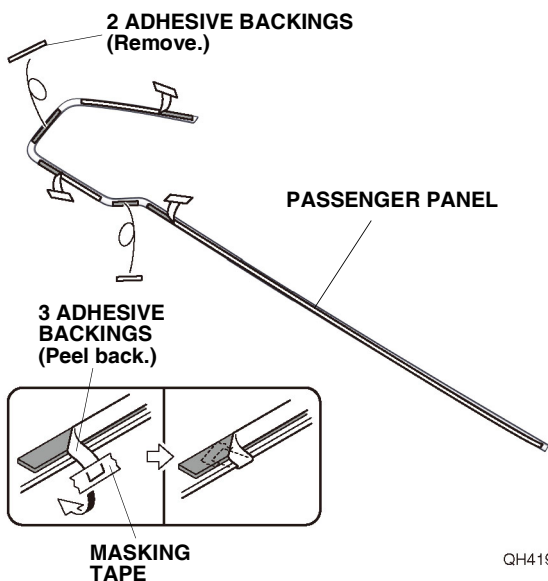

QH41911AT

17. Using an alcohol wipe, thoroughly clean the passenger's dashboard trim where the passenger panel will attach.

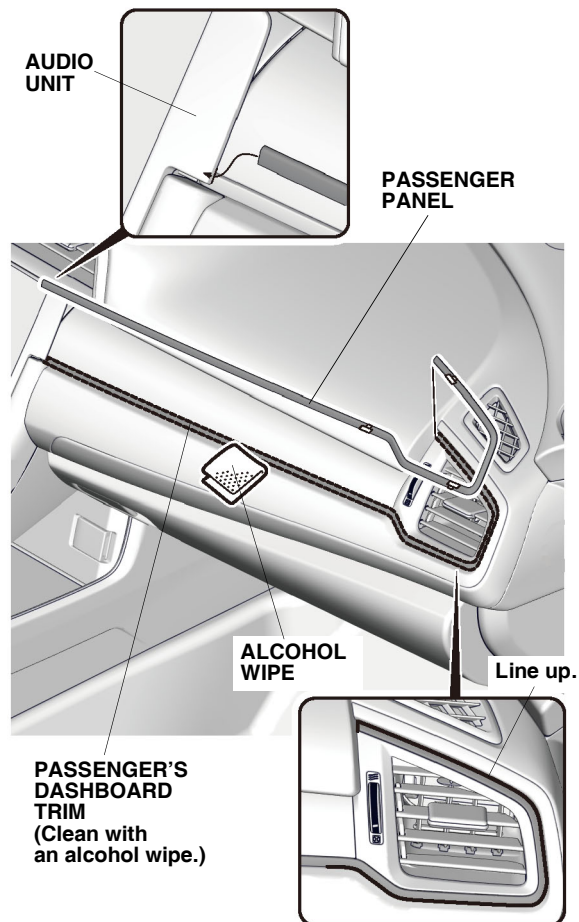

QH41912AT

18. Line up the passenger's panel with the passenger's dashboard trim, and attach it as shown.

19. While applying light pressure against the passenger panel, carefully remove the taped adhesive backings.

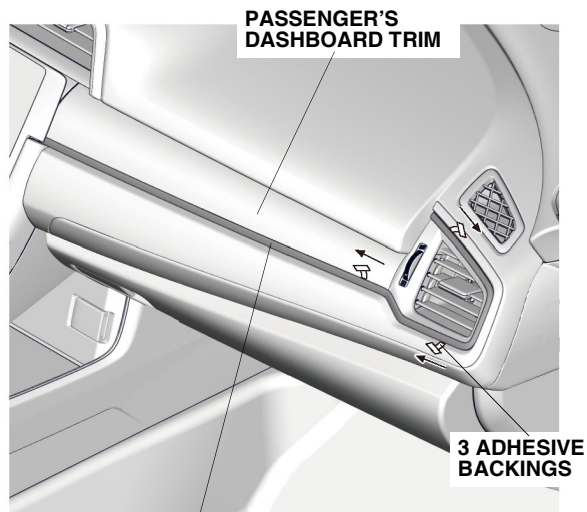

**PASSENGER PANEL**

QH41913AT

20. Using the palm of your hand, firmly press the passenger panel against the passenger's dashboard trim.