



HONDA INSTALLATION INSTRUCTIONS

Accessory
AUTOMATIC DAY/NIGHT
MIRROR

Application
2021 CIVIC

Publications No.
VERSION 1
Issue Date
AUG 2020

PARTS LIST

Attachment Kit
P/N 08V03-TBA-1A0

Automatic day/night mirror harness

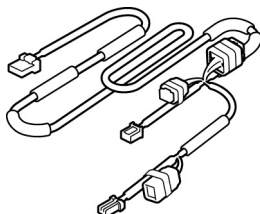

Harness cover



11 Wire ties



2 Urethane tapes
(Some may not be used)

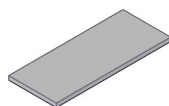

Aluminum tape

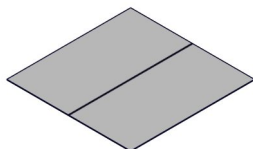

Fuse label A

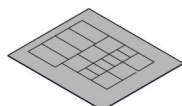

Fuse label B

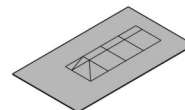

20A Blade fuse
(May not be used)

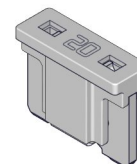

Service Parts

Automatic day/night mirror

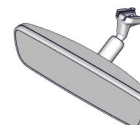

TOOLS AND SUPPLIES REQUIRED

Phillips screwdriver

Flat-tip screwdriver

Ratchet

10 mm Socket

Isopropyl alcohol

Shop towel

Diagonal cutters

Torque wrench

T20 TORX bit

10 mm Open end wrench

Ruler

Masking tape

Scissors

Small flat-tip screwdriver

The following tools are available through the Honda Tool and Equipment Program. On the iN, click on Service > Service Bay > Tool and Equipment Program, then enter the number under "Search." Or, call 888-424-6857.

- Trim Tool Set (T/N SOJATP2014)
- Plastic Trim Tool (T/N SILTRIMTL10)

Illustration of the Automatic Day/Night Mirror Installed in the Vehicle

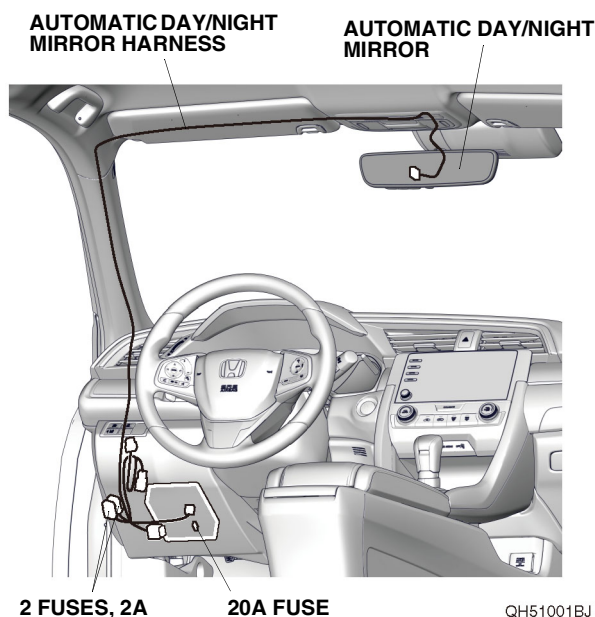

INSTALLATION

Customer Information: The information in this installation instruction is intended for use only by skilled technicians who have the proper tools, equipment, and training to correctly and safely add equipment to your vehicle. These procedures should not be attempted by “do-it-yourselfers.”

1. Disconnect the negative cable from the battery.
2. Remove the cover from the camera cover.

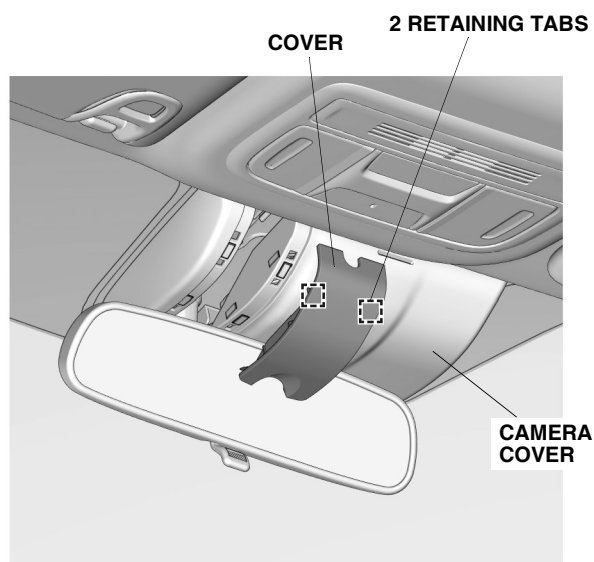

3. Remove the camera cover.
NOTE: To prevent damage, remove carefully in following order.

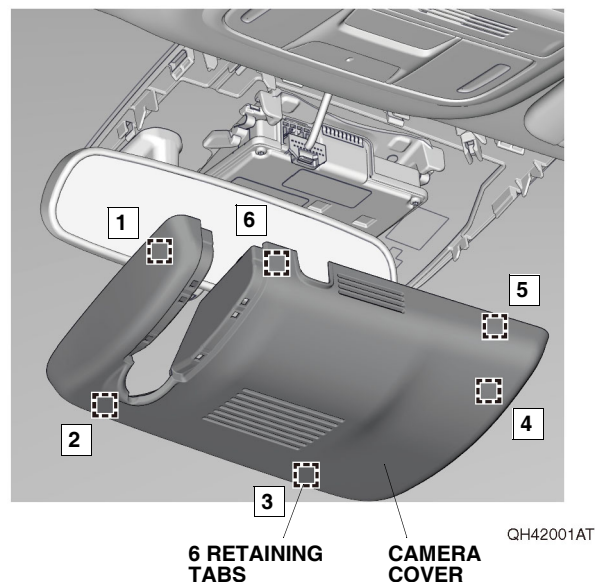

- Loosen the Torx screw, and remove the rearview mirror from the mirror mount, and unplug the vehicle connector (if equipped).

DAY/NIGHT CHANGE Type

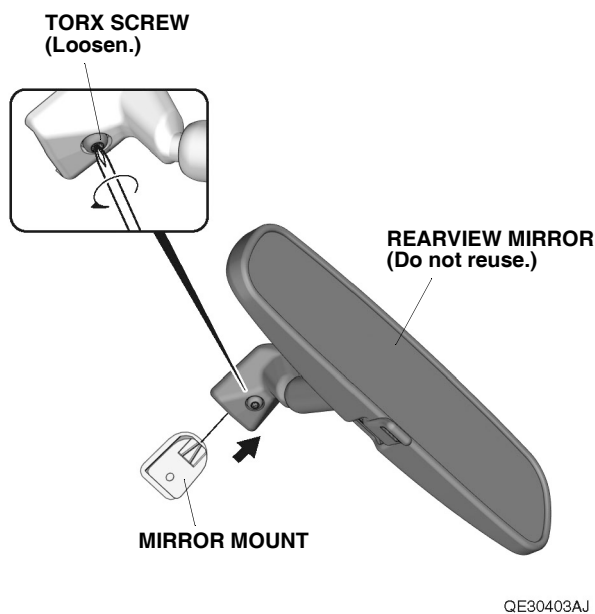

AUTO DIMMING Type

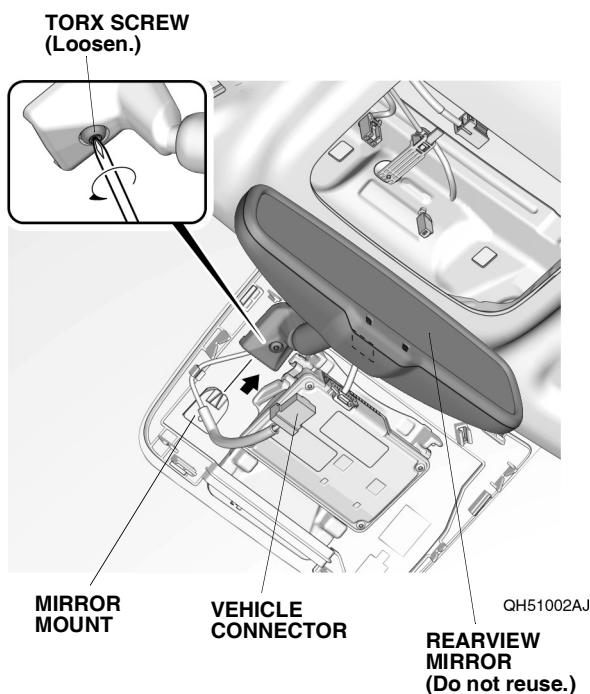

- Remove the left and right map light lenses from the roof console. Remove the two self-tapping screws. With Moonroof: Remove the roof console. Then unplug the vehicle connectors, and remove the switch.

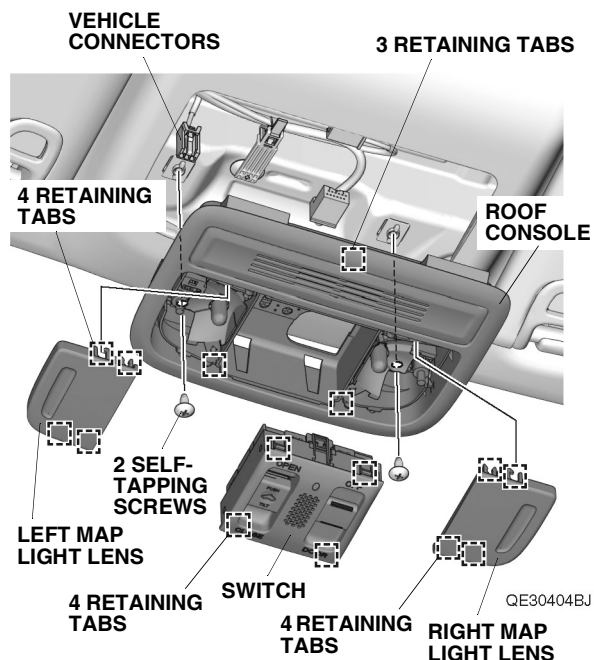

Without Moonroof and With Ambient light: Remove the roof console, and unplug the vehicle connectors.

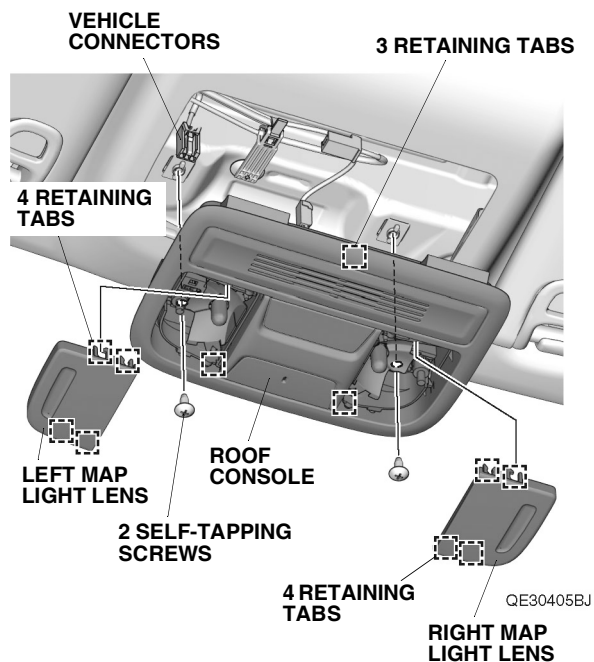

Without Moonroof and Ambient light: Remove the roof console, and unplug the vehicle connectors.

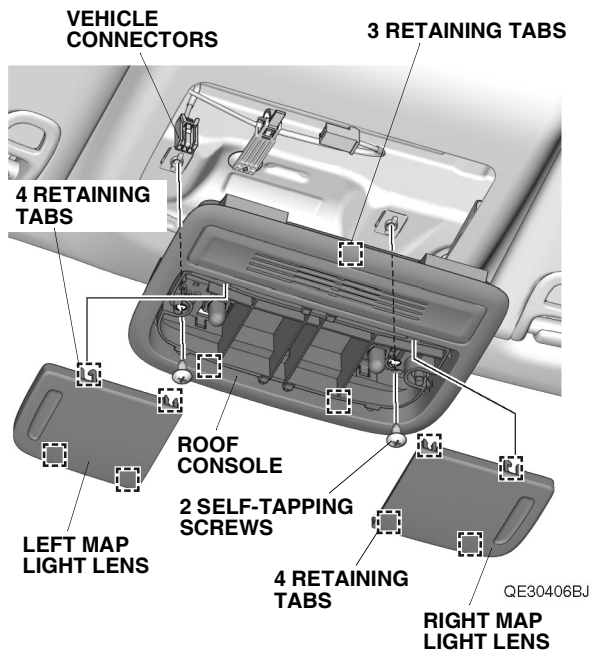

6. Release the passenger's sunvisor from the passenger's sunvisor holder.

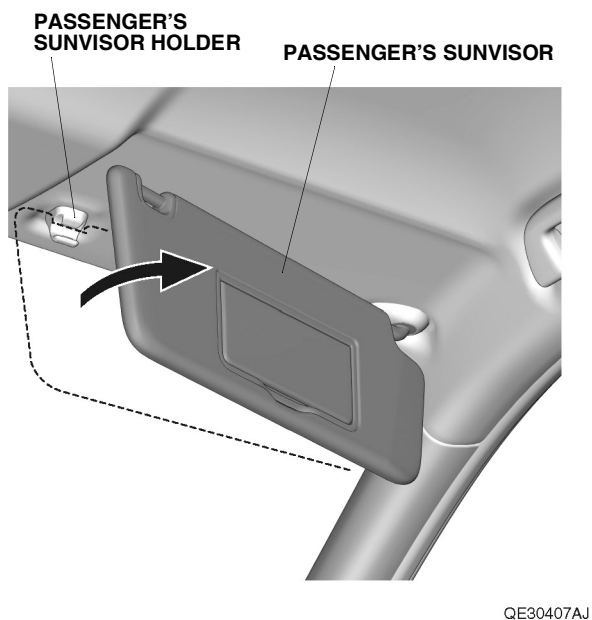

7. Remove the passenger's sunvisor holder by rotating it 90° counterclockwise.

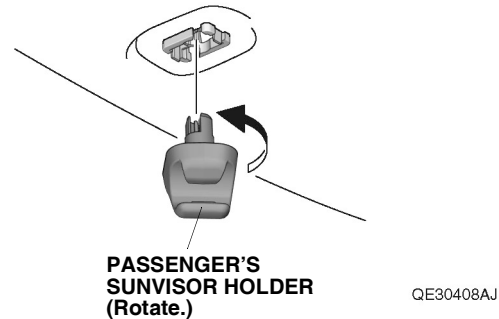

8. Remove the driver's sunvisor (unplug the vehicle connector):
- Pivot the driver's sunvisor downward.
 - Wrap masking tape around the tip of a flat-tip screwdriver.
 - Locate the slot in the base cover, and insert the flat-tip screwdriver into the slot. Push in and hold the retaining tab.
 - While holding the retaining tab, push up on the sunvisor and rotate it toward the door.
- NOTE: If the retaining tab does not stay pushed in, return the sunvisor to its original position and repeat this step.

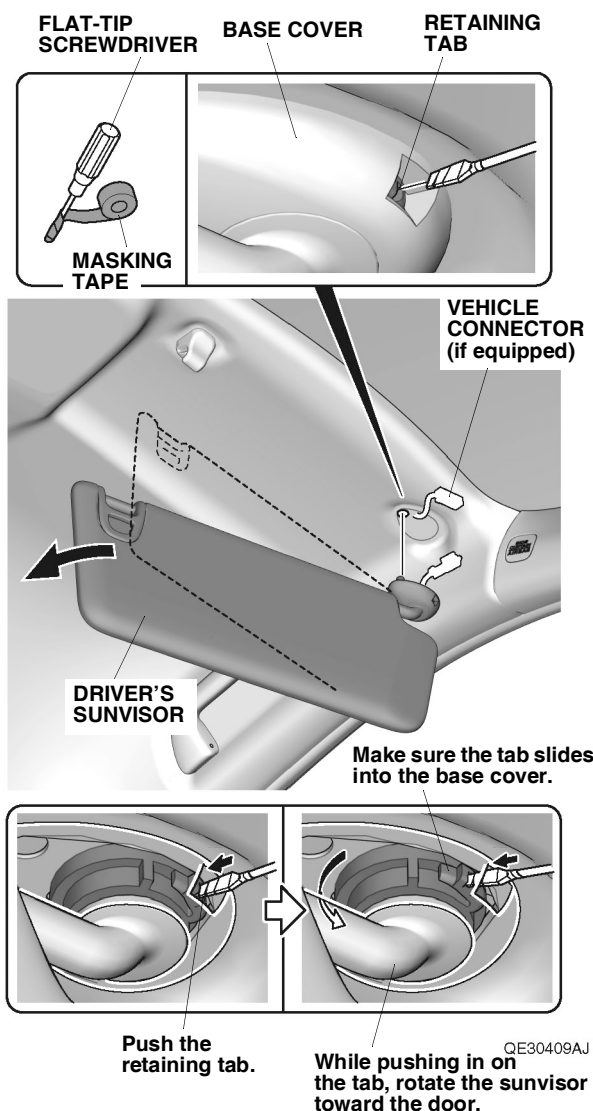

9. Remove the driver's sunvisor holder by rotating it 90° counterclockwise.

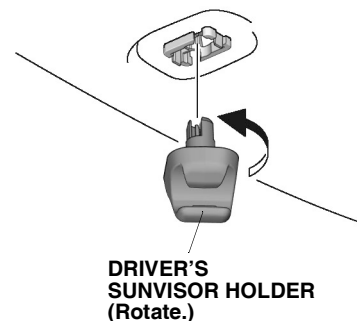

10. Open the cap, and remove the bolt.

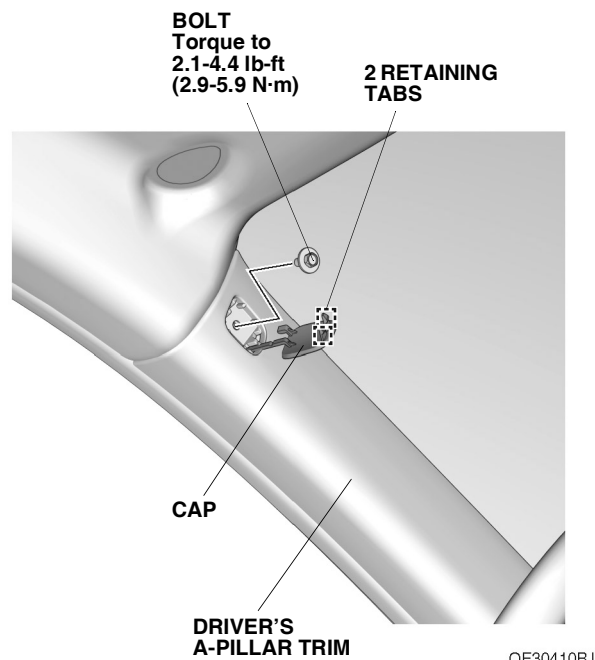

11. Pull away the door opening seal, and remove the driver's A-pillar trim.

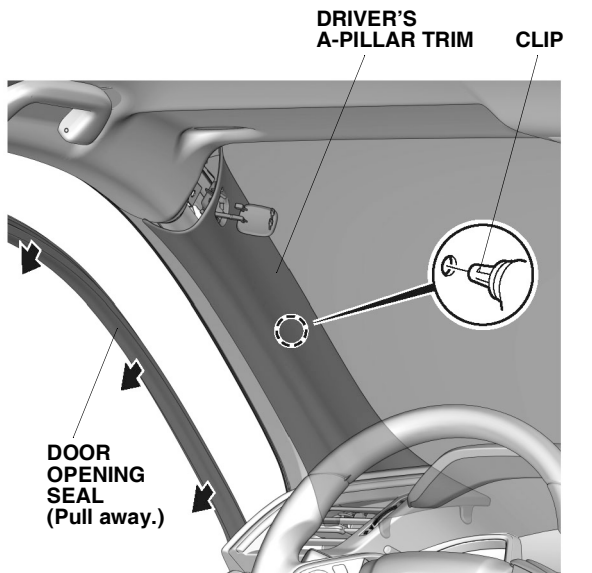

QE30411BJ

12. Remove the driver's dashboard lower cover, and unplug the vehicle connectors and aspirator hose.

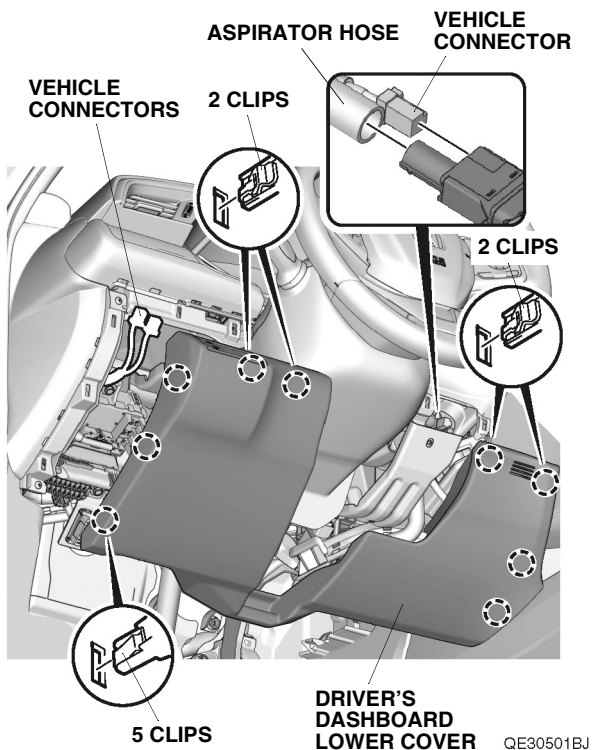

QE30501BJ

13. Pull away the door opening seal, and remove the driver's dashboard side lid.

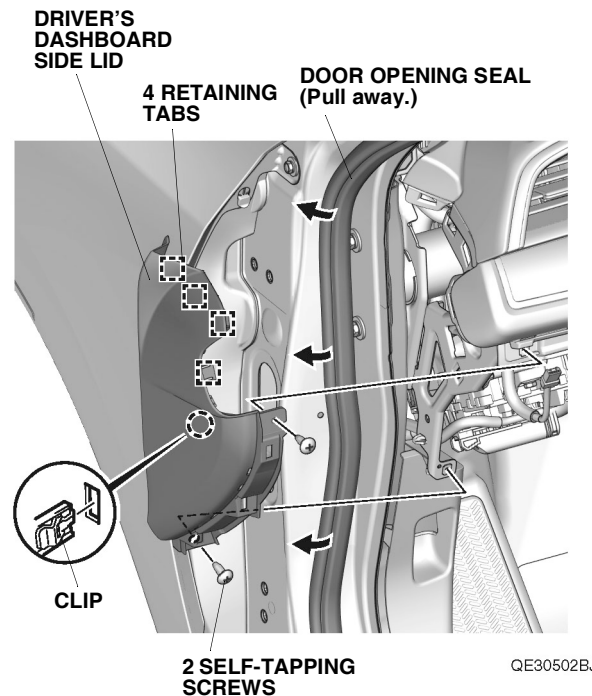

QE30502BJ

14. Using isopropyl alcohol on a shop towel, thoroughly clean the automatic day/night mirror harness fuse cases where the fuse labels A will attach.

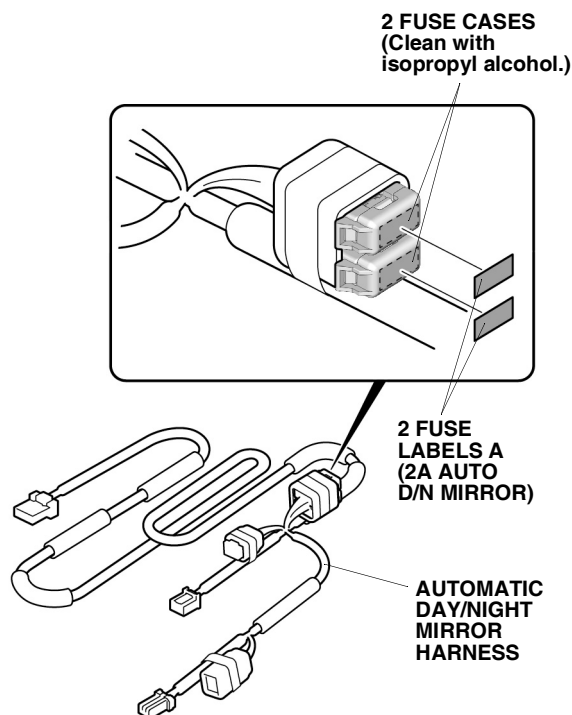

QH51003AJ

15. Apply the two fuse labels A (2A AUTO D/N MIRROR) to the automatic day/night mirror harness fuse cases.
16. Using scissors, cut one urethane tape as shown.

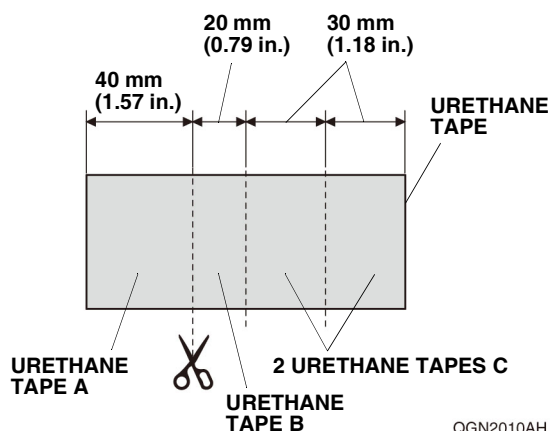

17. Using isopropyl alcohol on a shop towel, thoroughly clean the vehicle panel where urethane tape A will attach.

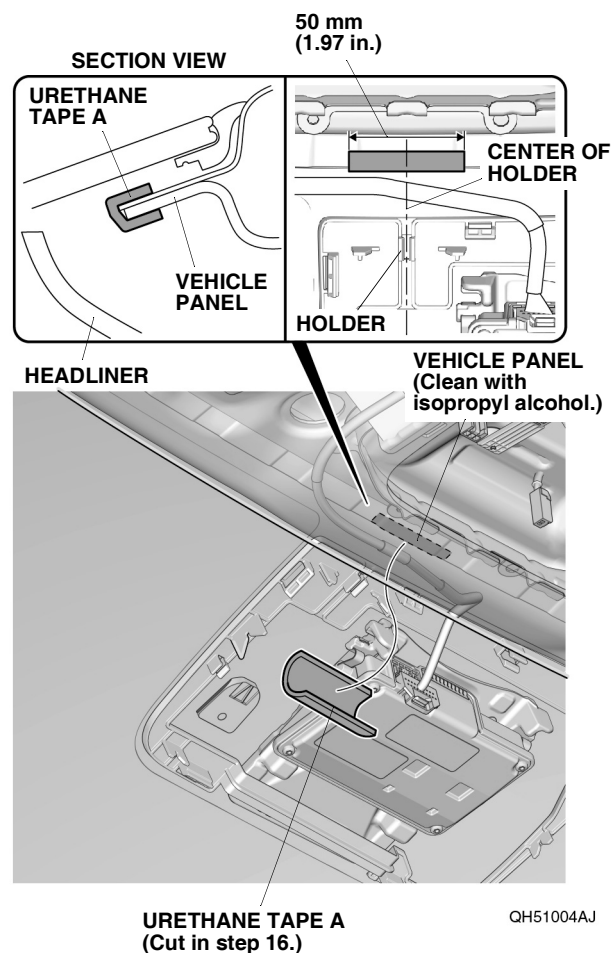

18. Attach urethane tape A to the vehicle panel.
NOTE: Be careful not to crease the headliner.

19. Using isopropyl alcohol on a shop towel, thoroughly clean the vehicle panel where urethane tape B and the two urethane tapes C will attach.

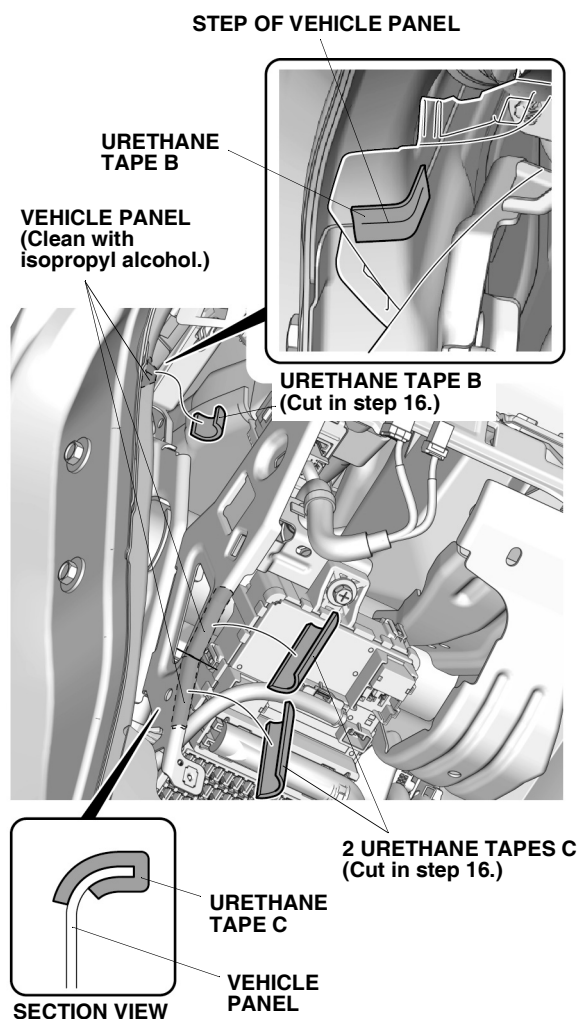

20. Attach urethane tapes B and C to the vehicle panel.

If the vehicle is equipped with auto dimming type, continue with step 21; otherwise, go to step 24.

With Auto Dimming Type

21. Release the vehicle harness from the cover base.

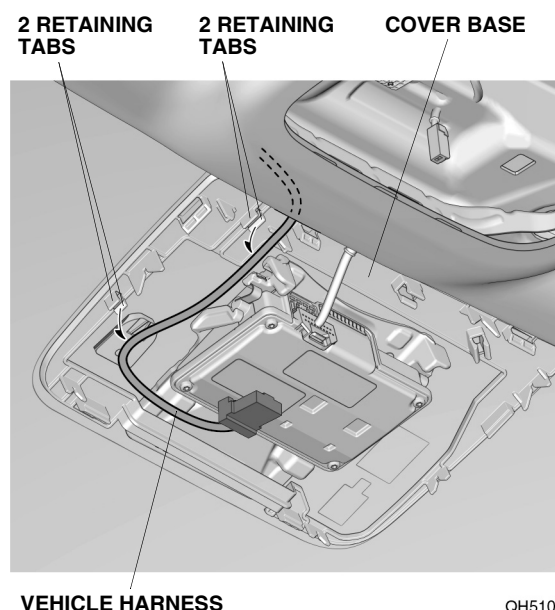

22. Wrap the urethane tape to the vehicle connector and vehicle harness as shown.

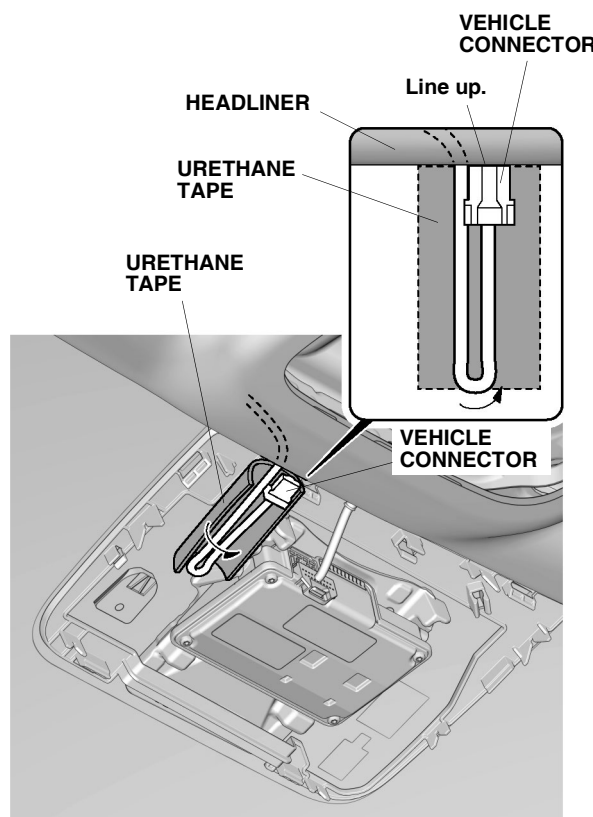

23. Gently pull back the headliner, and tuck the vehicle harness behind the headliner.
NOTE: Be careful not to crease the headliner.

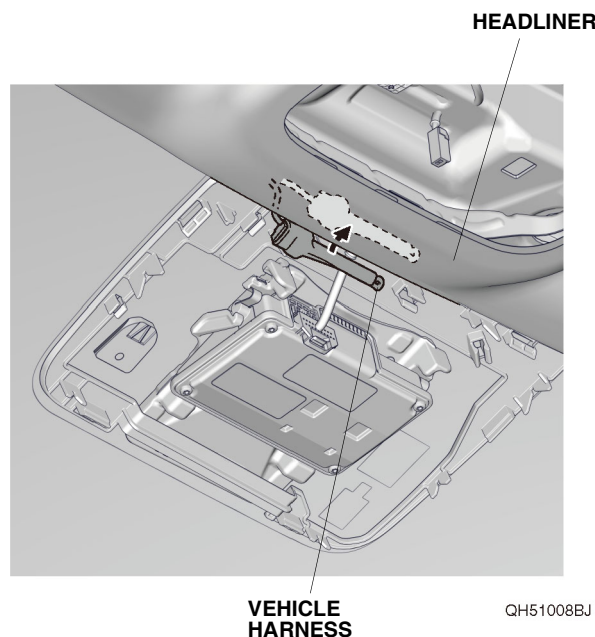

24. Secure the automatic day/night mirror harness to the vehicle panel with one wire tie as shown.

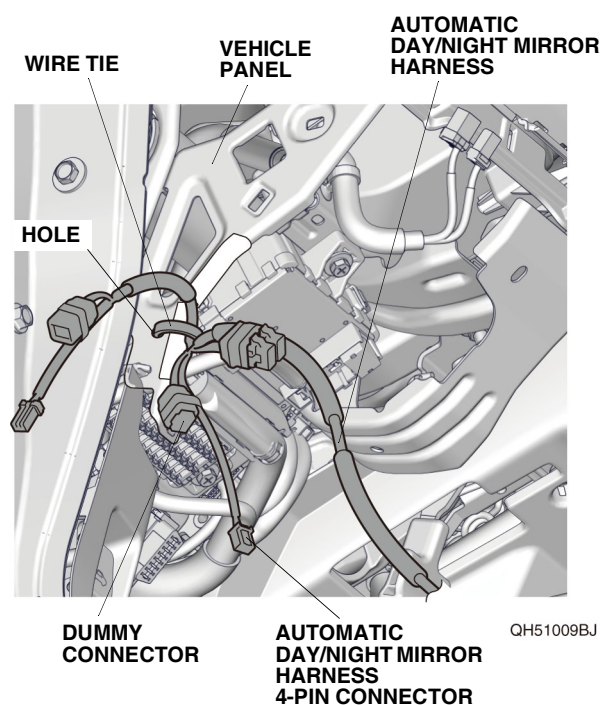

If the vehicle is equipped with another accessory harness 4-pin connector, go to step 26; otherwise, continue with step 25.

Without Another Accessory Harness 4-Pin Connector

25. Plug the automatic day/night mirror harness 4-pin connector into the fuse box. Go to step 27.

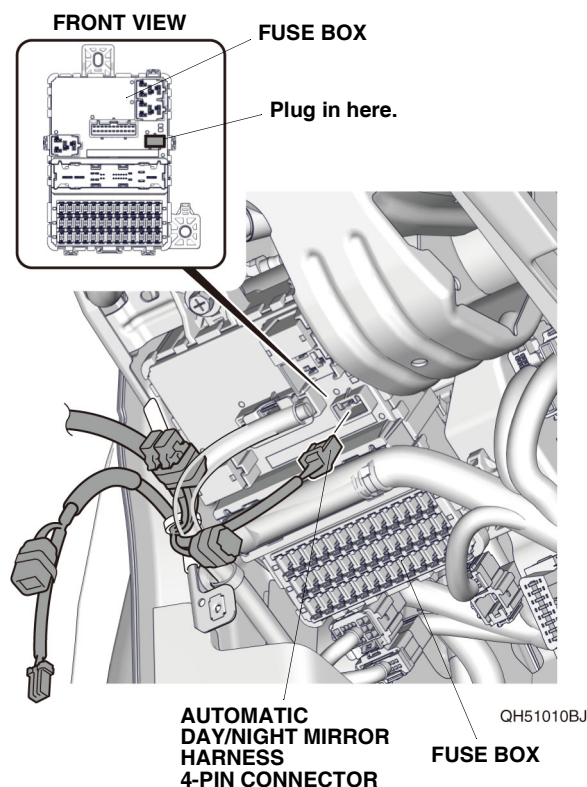

With Another Accessory Harness 4-Pin Connector

26. If the other accessory harness 4-pin connector is plugged into the fuse box, unplug it from the fuse box, then plug the automatic day/night mirror harness 4-pin connector into the fuse box. Remove and do not reuse the dummy connector from the automatic day/night mirror harness 4-pin connector, and plug the other accessory harness 4-pin connector into it.

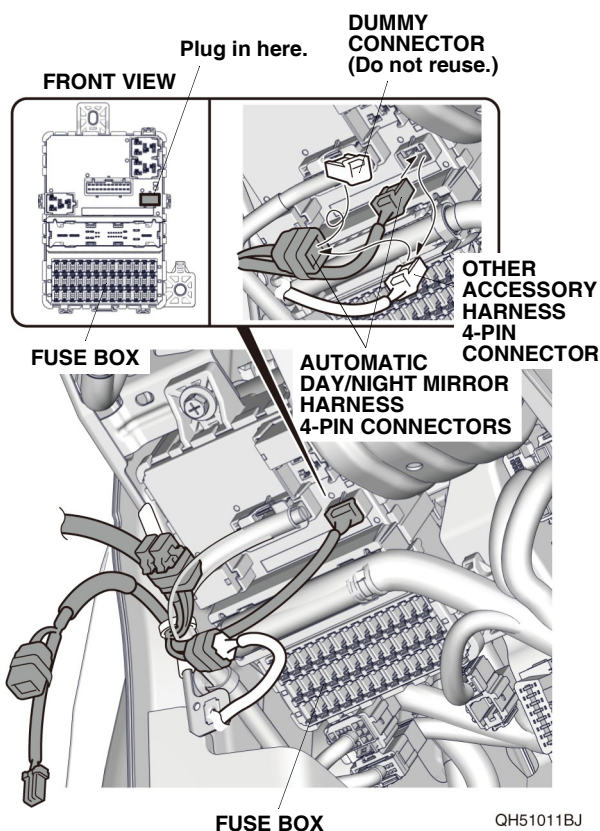

27. Secure the automatic day/night mirror harness to the vehicle harness with one wire tie.

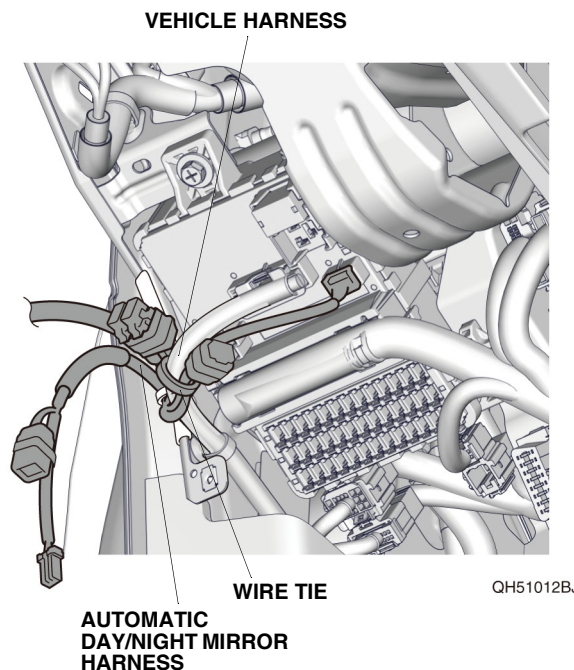

28. Route the automatic day/night mirror harness as shown.

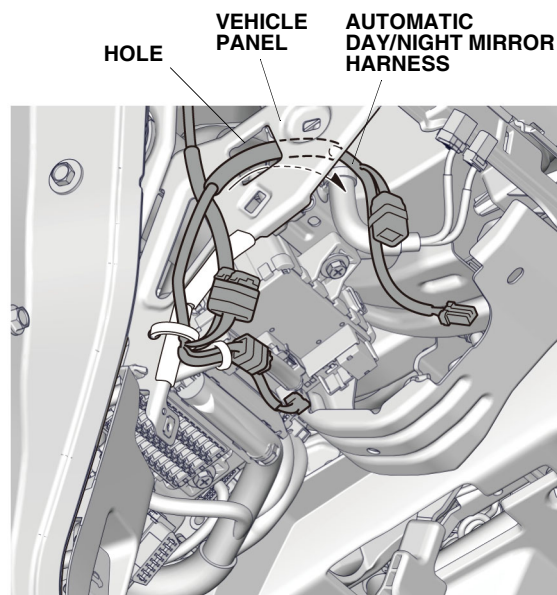

29. Plug the vehicle 4-pin connector (VSA OFF switch) into the automatic day/night mirror harness 4-pin connector.

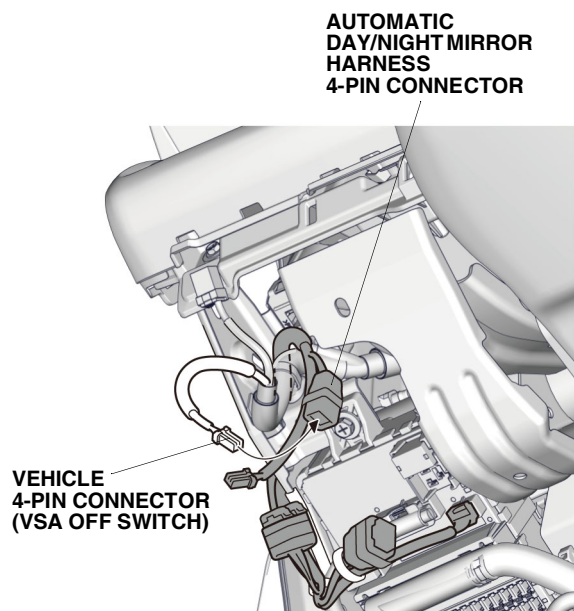

QH51014BJ

30. Line up the branch of the automatic day/night mirror harness with the vehicle clip, and secure the automatic day/night mirror harness and 4-pin connectors to the vehicle harness with two wire ties.

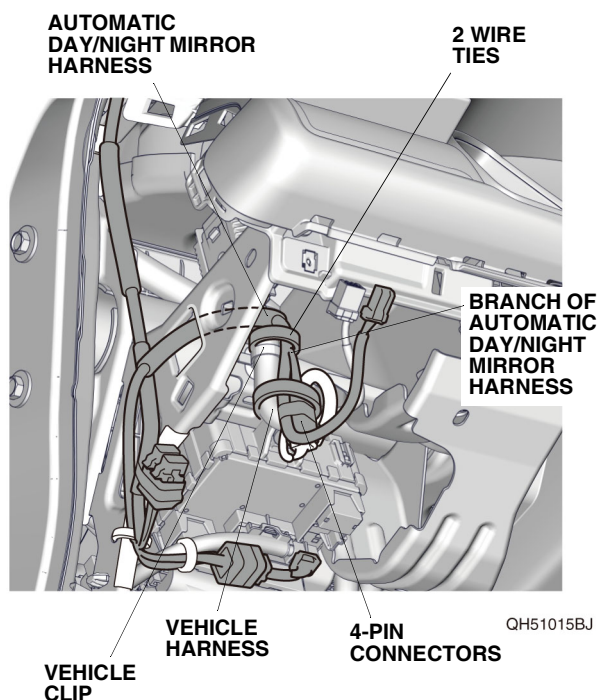

QH51015BJ

31. Route the automatic day/night mirror harness upward toward the dashboard as shown.

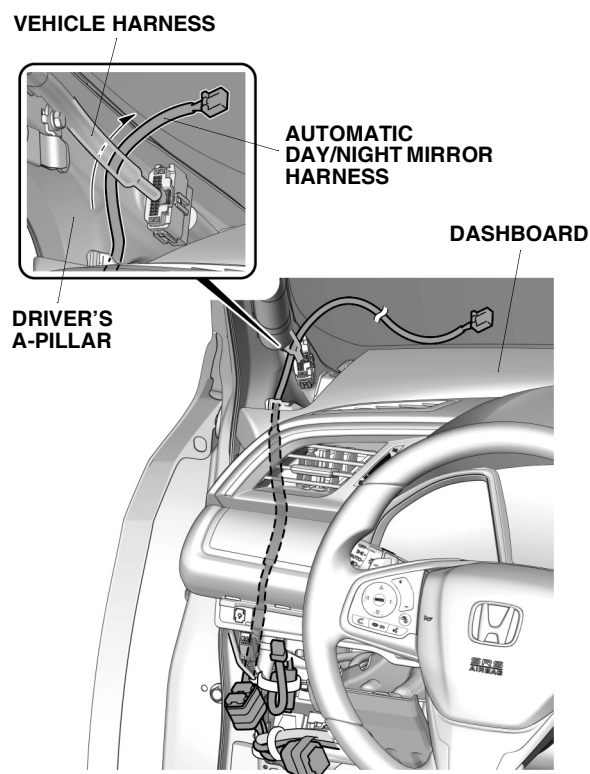

QH51016AJ

32. Route the automatic day/night mirror harness along the driver's A-pillar. Gently pull back the headliner, and tuck the automatic day/night mirror harness behind the headliner.
- NOTE: Be careful not to crease the headliner.

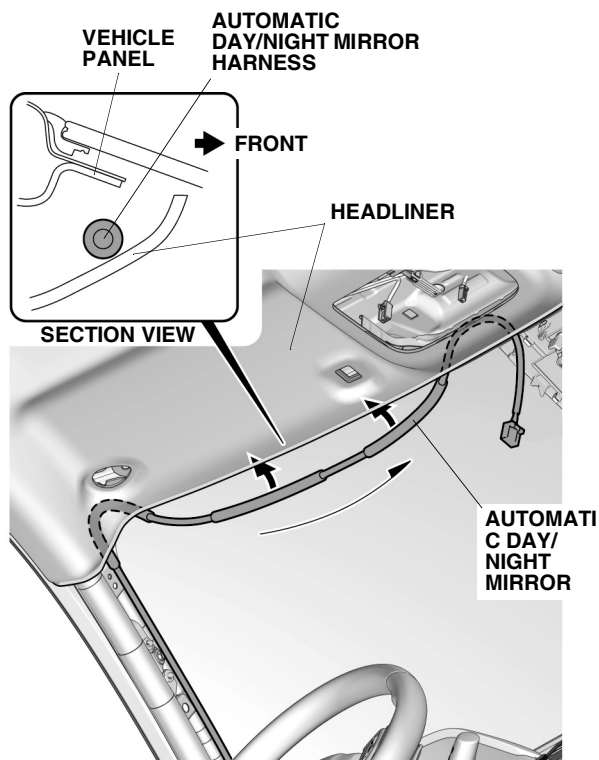

QH51017AJ

33. Line up the end of the urethane tape on the automatic day/night mirror harness with the vehicle bracket, and secure the automatic day/night mirror harness to the vehicle harness with one wire tie as shown.

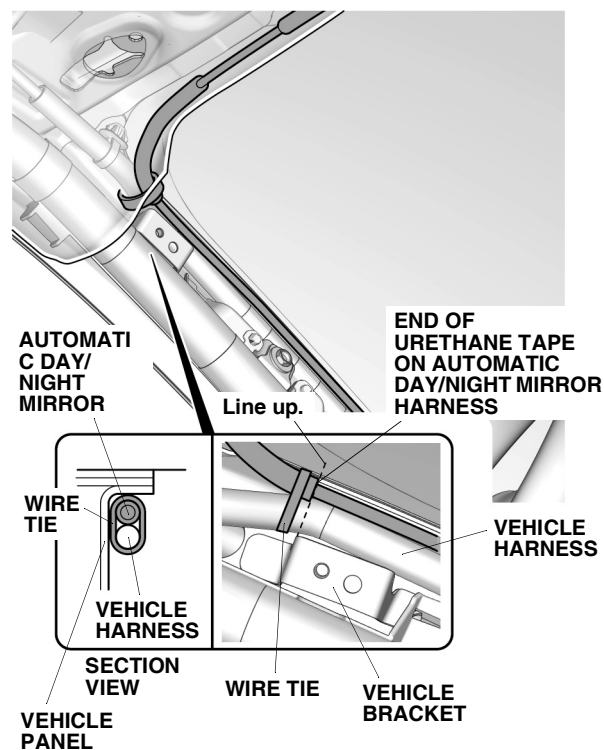

QH51018AJ

34. Using isopropyl alcohol on a shop towel, thoroughly clean the vehicle panel where the aluminum tape will attach.

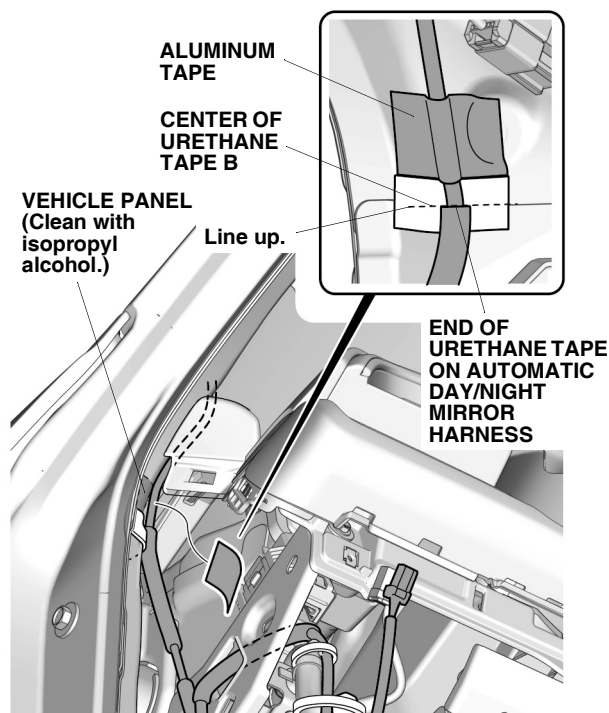

QH51019AJ

35. Line up the end of the urethane tape on the automatic day/night mirror harness with the center of urethane tape B, and secure the automatic day/night mirror harness to the vehicle panel with one piece of aluminum tape as shown.

36. Secure the automatic day/night mirror harness to the vehicle harness with four wire ties as shown. NOTE: Do not cover the installation holes of the driver's A-pillar trim.

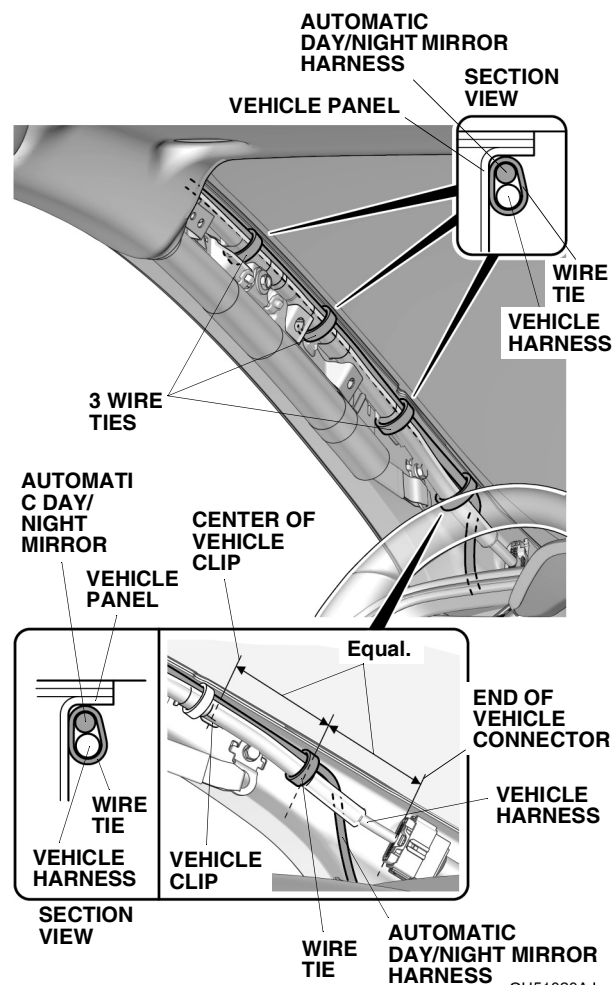

QH51020AJ

37. Secure the automatic day/night mirror harness to the vehicle panel with two wire ties.

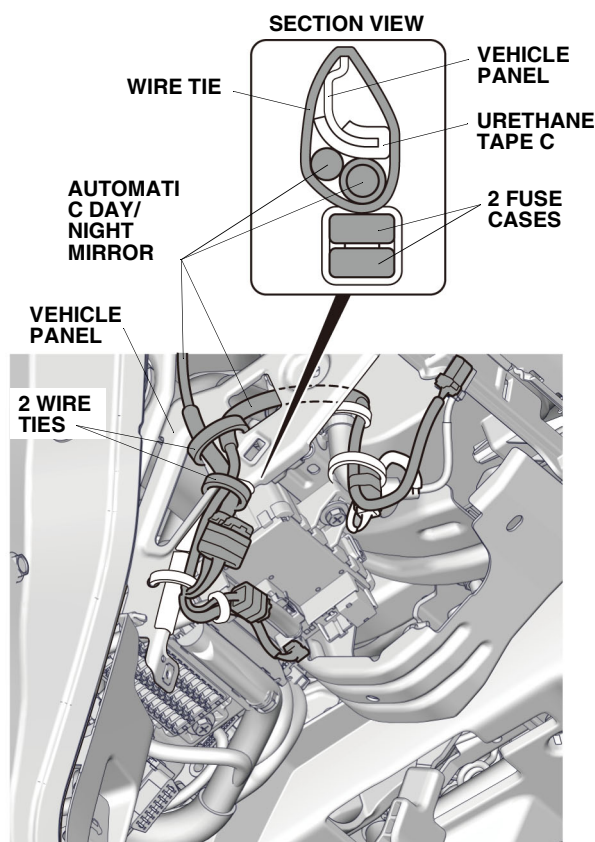

QH51021BJ

38. Install the automatic day/night mirror to the mirror mount as shown. Torque the Torx screw to 1.1-1.5 lb-ft (1.5-2.0 N·m).

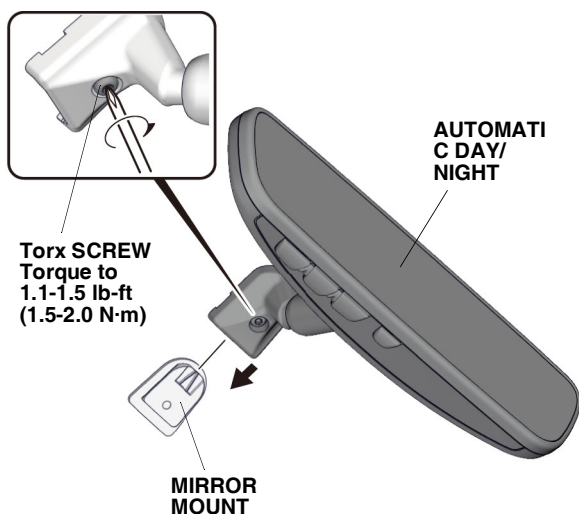

QGN2029AH

39. Plug the automatic day/night mirror harness 7-pin connector into the automatic day/night mirror.

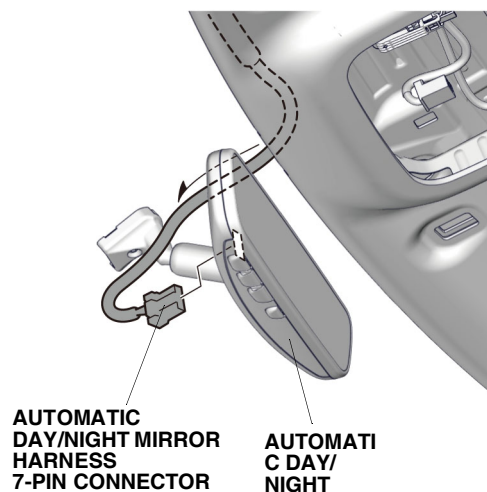

QGN2030AH

40. Secure the automatic day/night mirror harness to the automatic day/night mirror with the harness cover. NOTE: Make sure the automatic day/night mirror harness is not pinched.

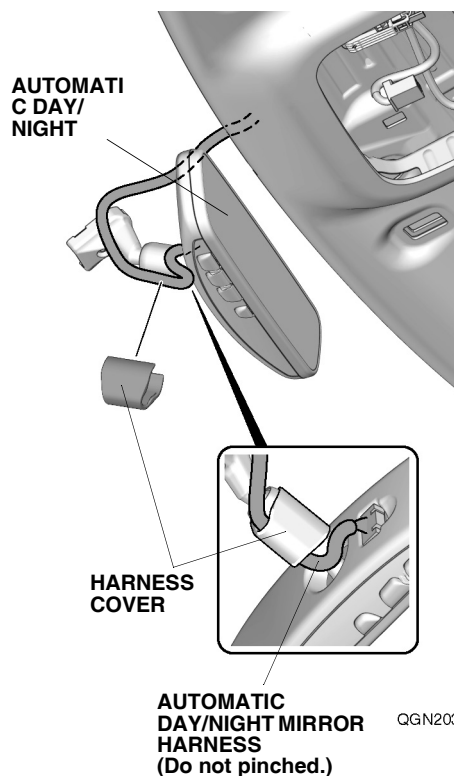

QGN2031AH

41. Secure the automatic day/night mirror harness to the cover base.

NOTE: Make sure that the automatic day/night mirror harness is not pinched.

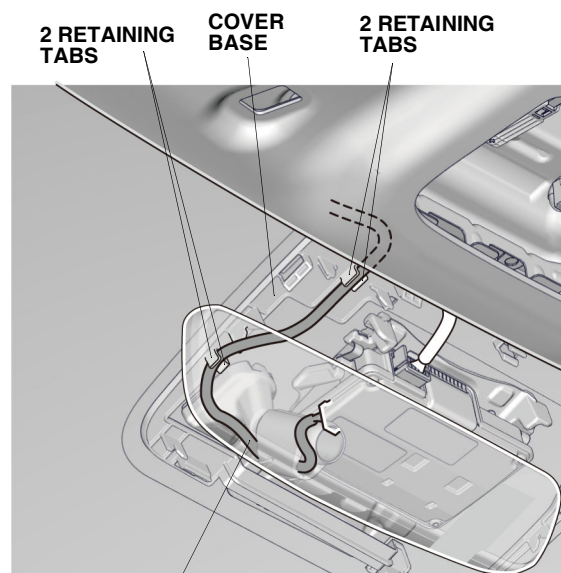

AUTOMATIC DAY/NIGHT MIRROR HARNESS
(Do not pinch.)

QGN2032AH

42. Install the driver's dashboard side lid. Plug the automatic day/night mirror harness 4-pin connector into the VSA OFF switch. Install the driver's dashboard lower cover.

NOTE: The position of the switch depends on the vehicle.

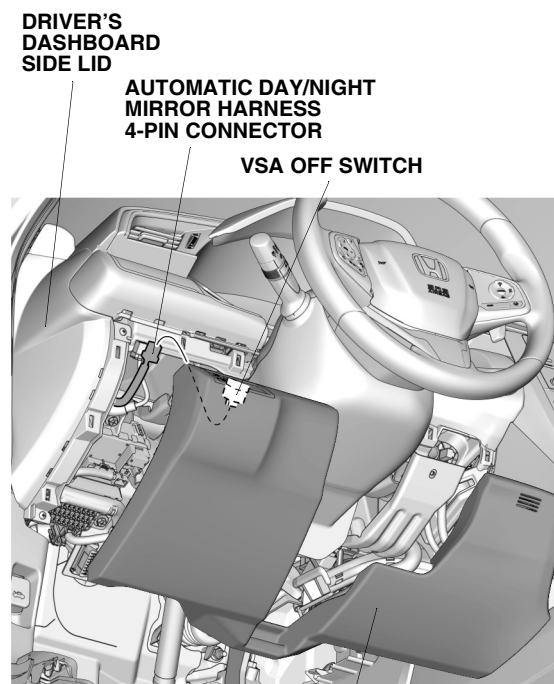

DRIVER'S DASHBOARD LOWER COVER

QH51022AJ

43. Plug the 20A blade fuse into the fuse box. If the 20A fuse is already plugged, do not plug the 20A blade fuse.

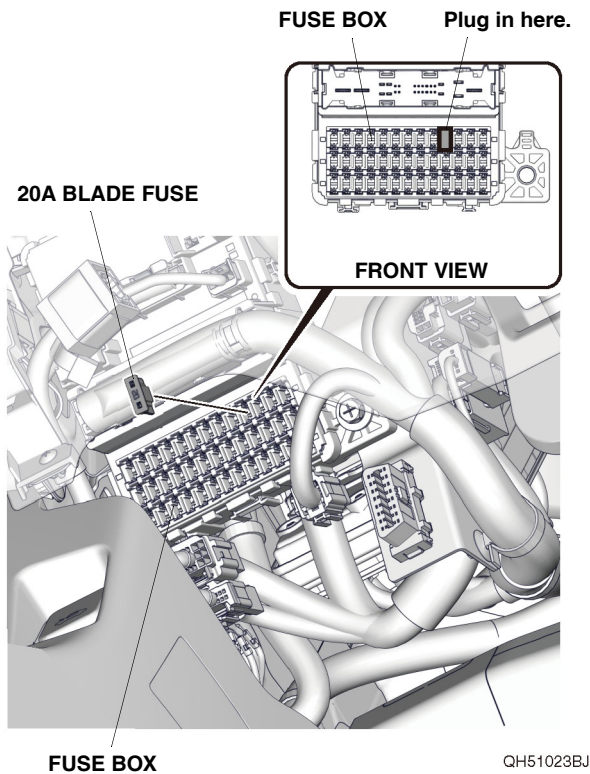

44. Using isopropyl alcohol on a shop towel, thoroughly clean the area where the fuse label B will attach.

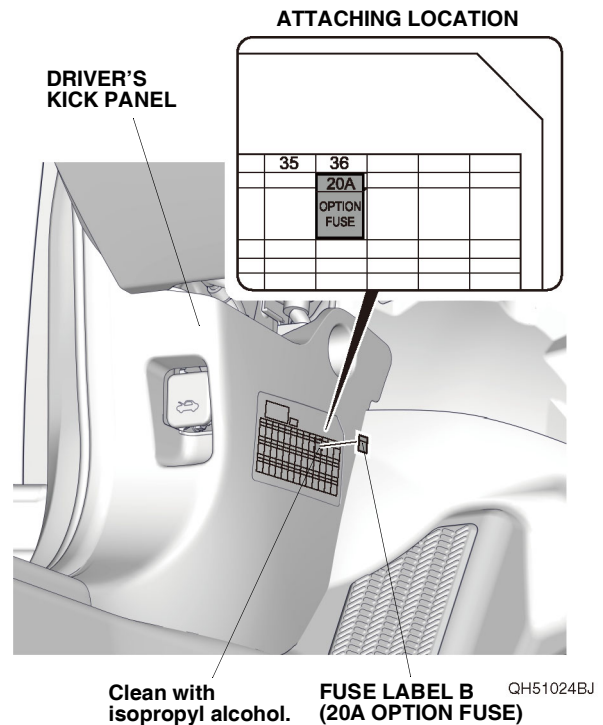

45. Attach the fuse label B on the driver's kick panel.
46. Check that all wire harnesses are routed properly and all connectors are plugged in.
47. Install all removed parts.
48. Connect the negative cable to the battery.
49. Press and hold the audio unit power button for 2 seconds to restore the audio and navi (if equipped) system functions.
50. Set the clock on vehicles without navigation.
51. If necessary, restore the systems back to normal operation as described in the service information.

Check the Operation of the Automatic Day/Night Mirror

52. Make sure the automatic day/night mirror works properly as described in the online owner's manual.