



## HONDA INSTALLATION INSTRUCTIONS

Accessory  
ARMREST ILLUMINATION

Application  
2021 CIVIC

Publications No.  
**VERSION 1**  
Issue Date  
**AUG 2020**

### PARTS LIST

Armrest Illumination Kit  
P/N 08E16-TBA-100A  
P/N 08E16-TBA-100B

Left light  
(Identification mark: L)



Right light  
(Identification mark: R)



Light harness

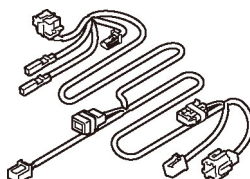

14 Wire ties

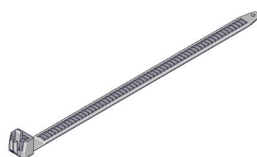

Fuse label

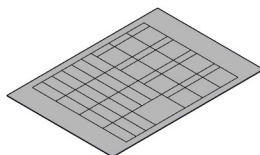

2 Urethane tapes

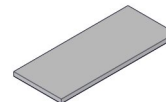

4 Aluminum tapes

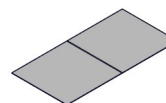

Relay



Clip

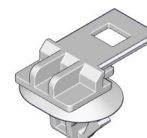

Wire tie with holder



Unit

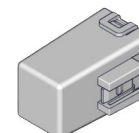

## Console Armrest Kit P/N 08U89-TXM-100

Console center armrest



Left console side armrest



Right console side armrest



Accessory user's information manual

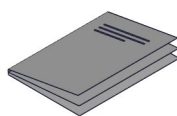

## TOOLS AND SUPPLIES REQUIRED

Phillips screwdriver

Ratchet

10 mm Socket

10 mm Open end wrench

Diagonal cutters

Masking tape

Ruler

Isopropyl alcohol

Shop towel

Scissors

Blanket

Hacksaw

File

*The following tools are available through the Honda Tool and Equipment Program. On the iN, click on Service > Service Bay > Tool and Equipment Program, then enter the number under "Search." Or, call 888-424-6857.*

- Plastic Trim Tool (T/N SILTRIMTL10)
- Trim Tool Set (T/N SOJATP2014)

## Illustration of the Armrest Illumination Installed in the Vehicle

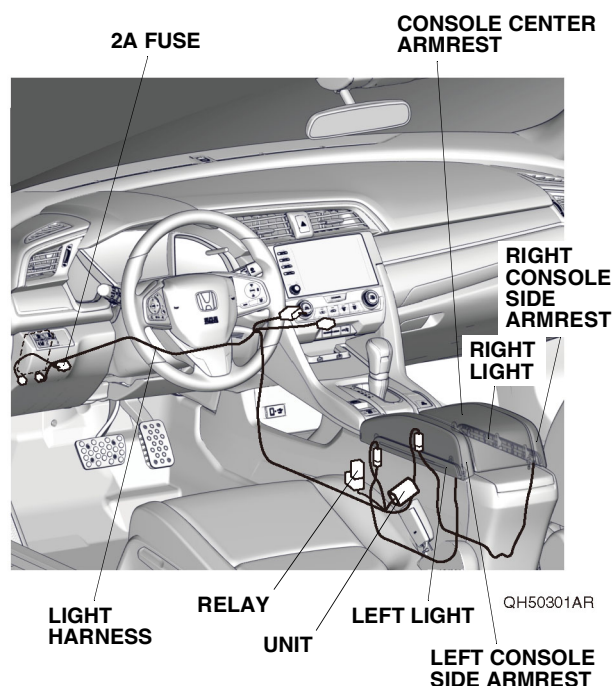

## INSTALLATION

**Customer Information:** The information in this installation instruction is intended for use only by skilled technicians who have the proper tools, equipment, and training to correctly and safely add equipment to your vehicle. These procedures should not be attempted by “do-it-yourselfers.”

1. Disconnect the negative cable from the battery.
2. Remove the passenger's dashboard side lid, and unplug the vehicle connector, if equipped. Pull away the door opening seal.

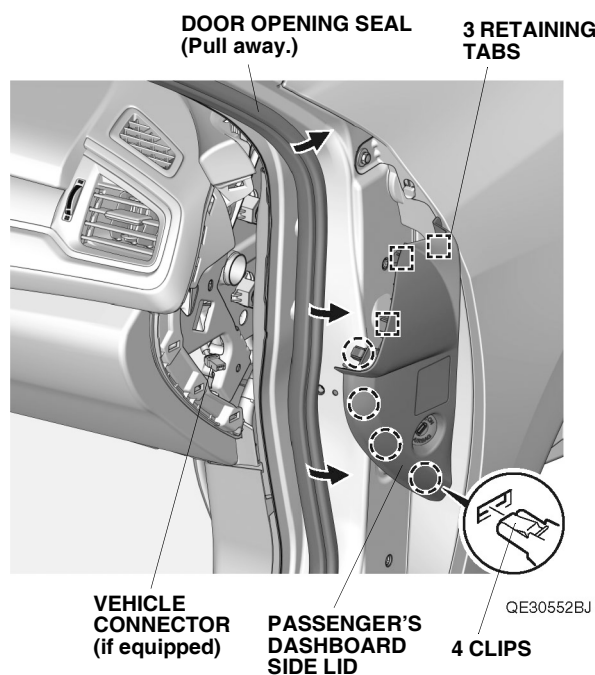

3. Remove the passenger's under cover.

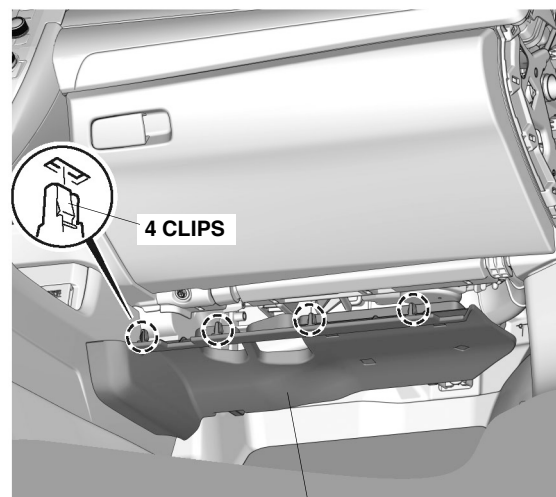

4. Open the glove box, push inward on the glove box stops and remove the glove box.

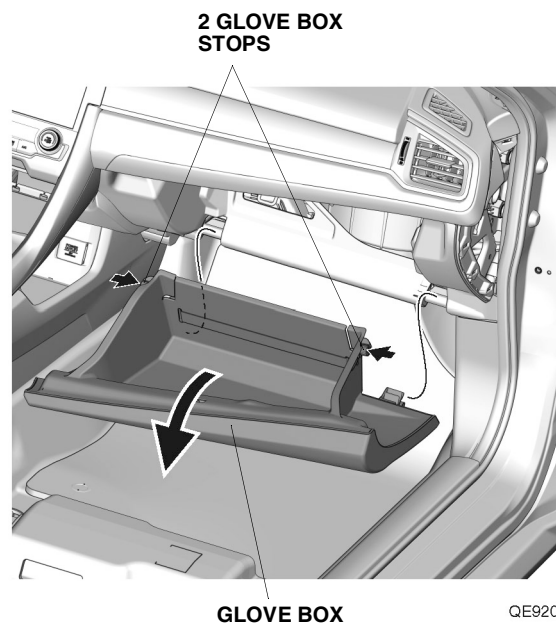

5. Remove the glove box cover, and unplug the vehicle connector, if equipped.

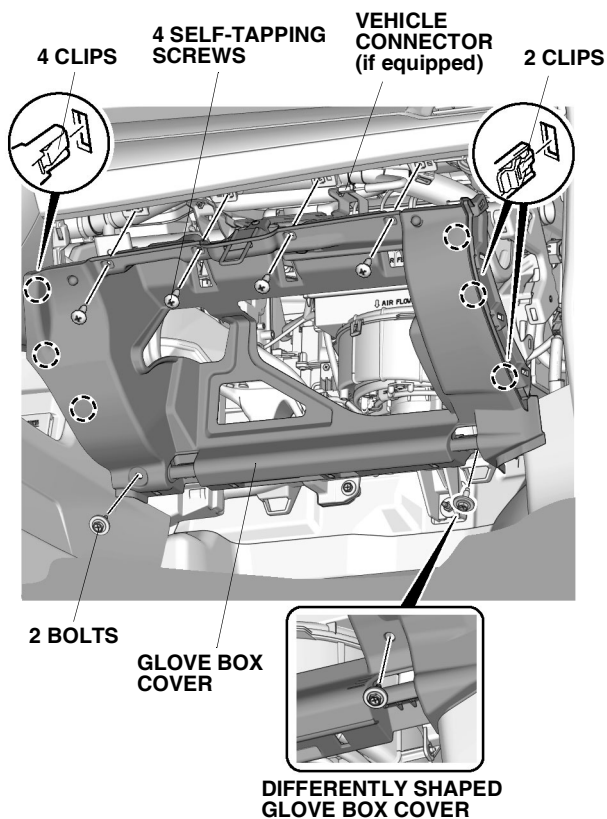

6. Remove the driver's dashboard lower cover, unplug the vehicle connectors and aspirator hose.

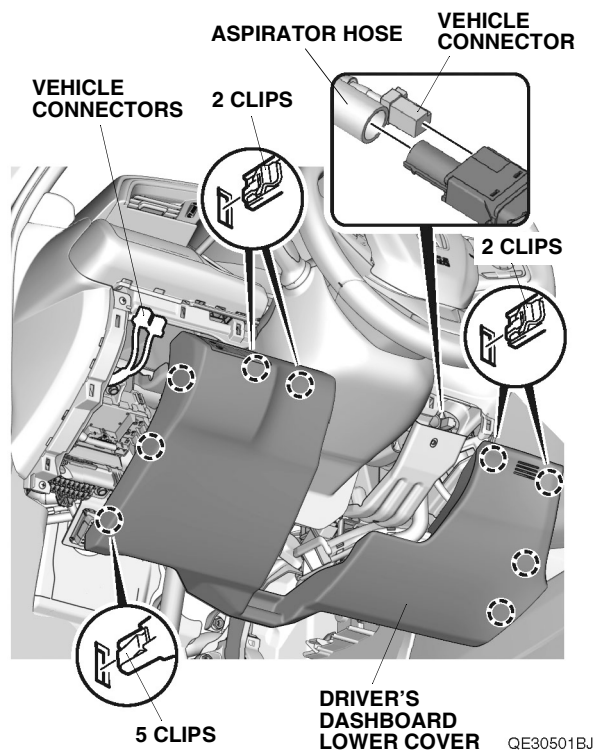

7. Remove the left console armrest.

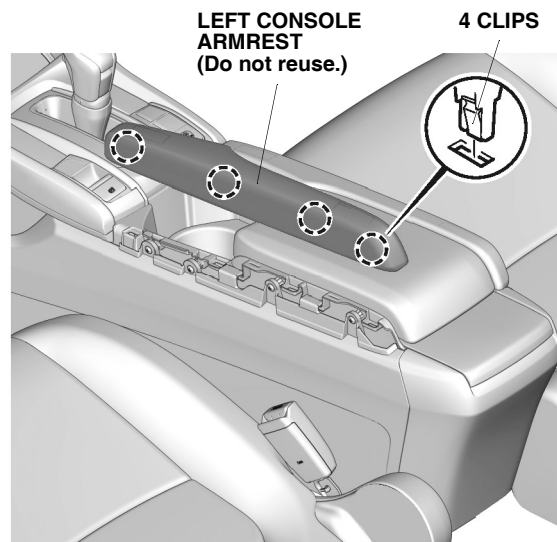



8. Attach masking tape to the area shown.

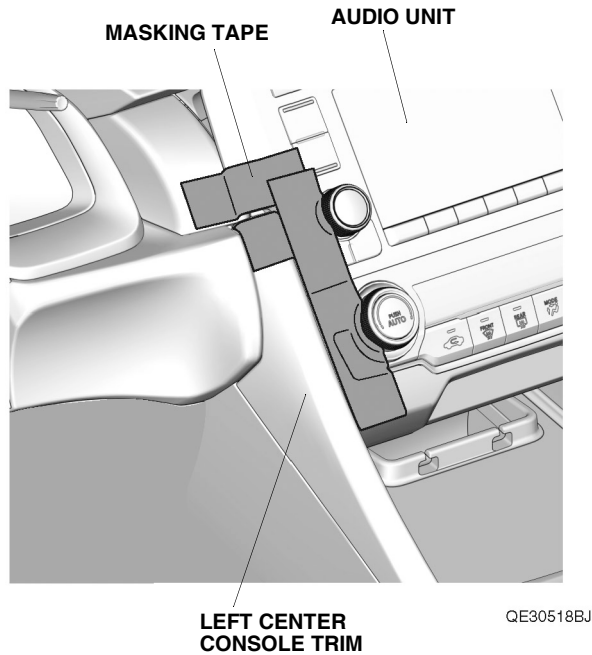

9. Remove the left center console trim.

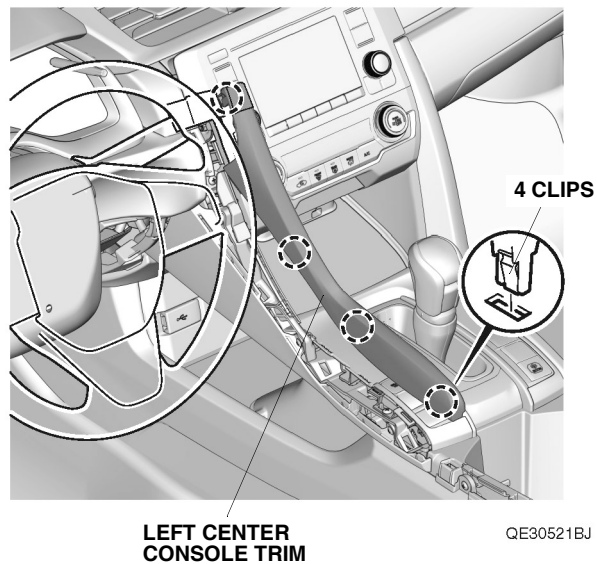

10. Remove the right console armrest.

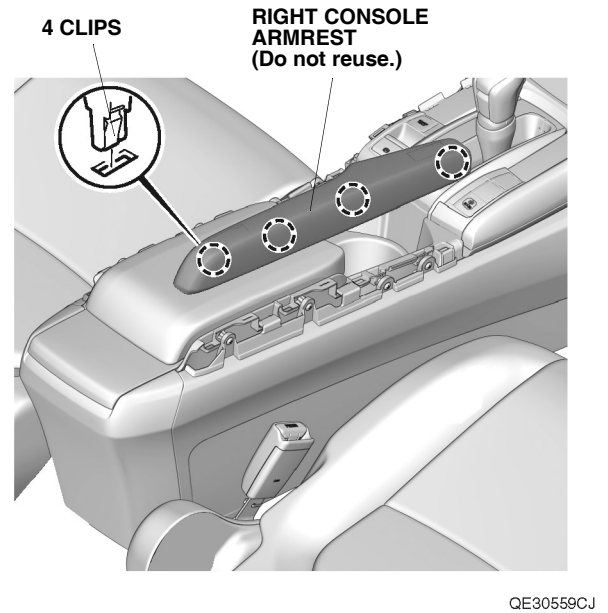

11. Attach masking tape to the area shown.

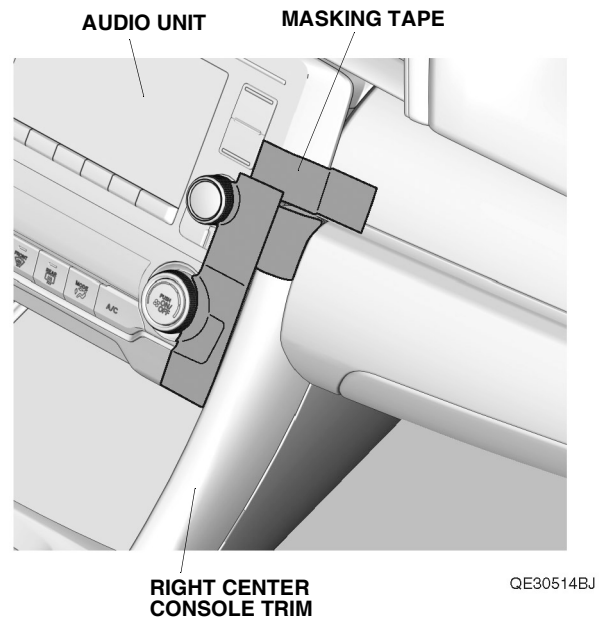

12. Remove the right center console trim.

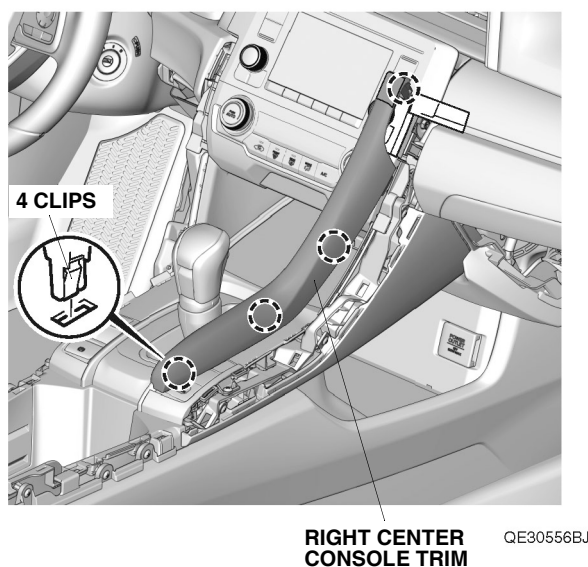

13. Remove the A/C control unit, and unplug the vehicle connectors.

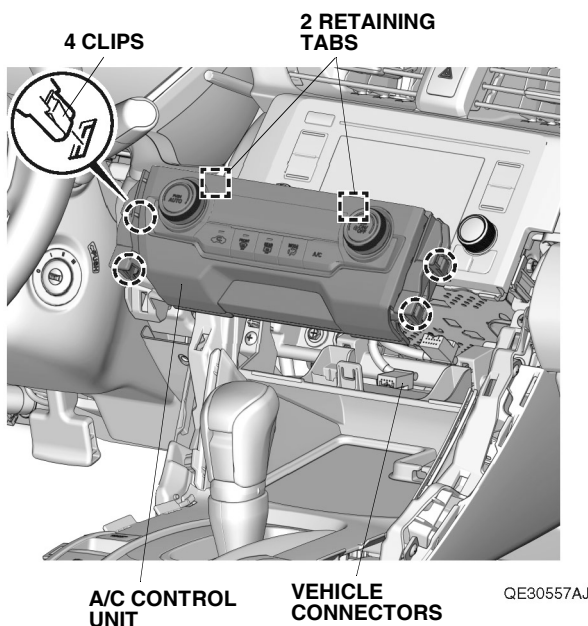

14. Remove the audio unit, and unplug the vehicle connectors.

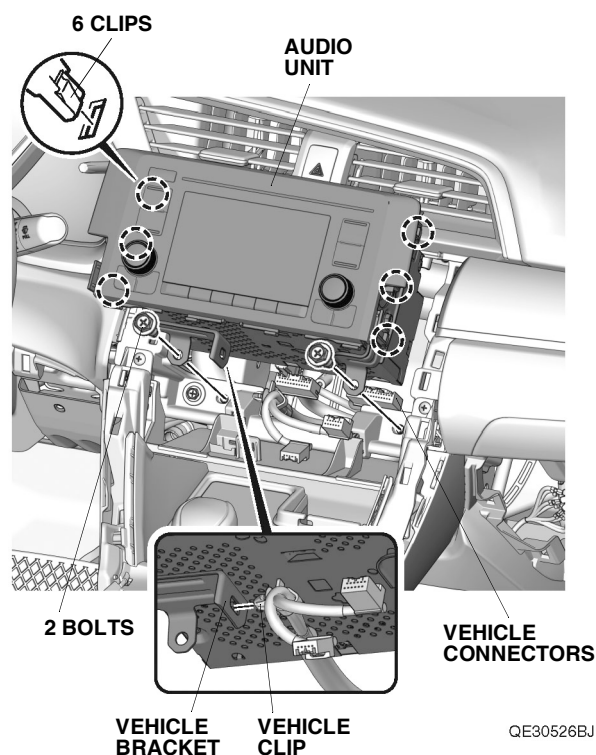

15. Remove the console rear panel and unplug the vehicle connectors, if equipped.

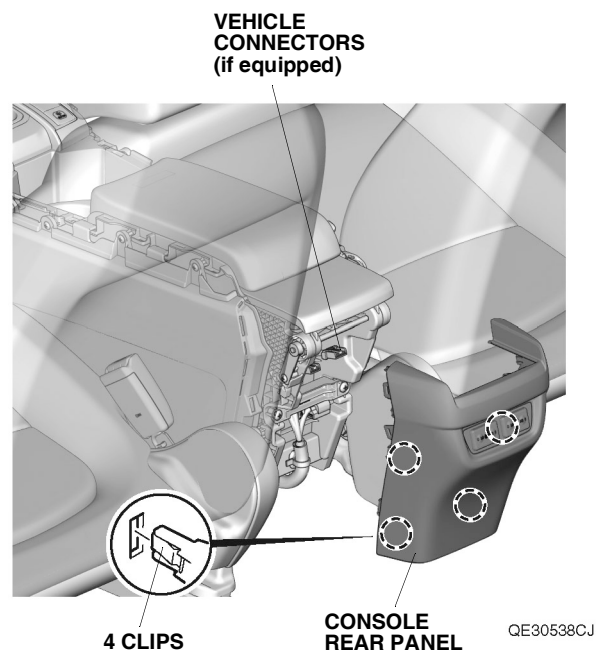

## 16. Remove the shift lever console panel:

### A/T Models

- Open the center console armrest, and slide the sliding tray (if equipped) and the beverage holder rearward.
- Remove the shift lock release cover with a plastic trim tool.
- Insert the key into the shift lock release slot, and move the shift lever knob to the D position.

NOTE: Make sure to apply the parking brake.

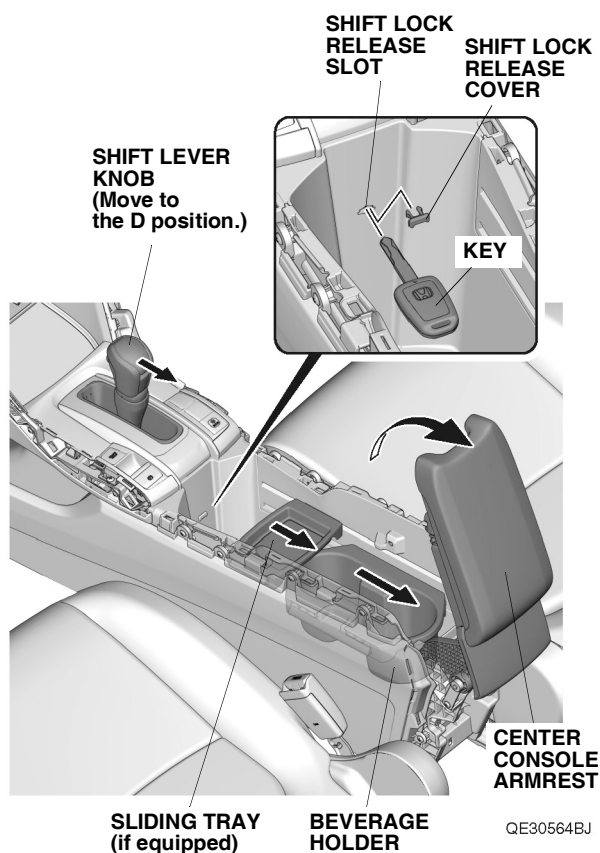

- Remove the console panel, and unplug the vehicle connectors.

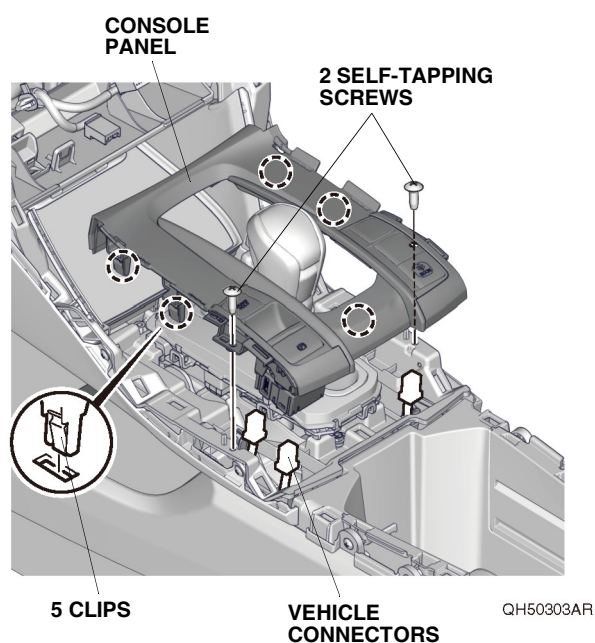

- Release the shift lever panel.

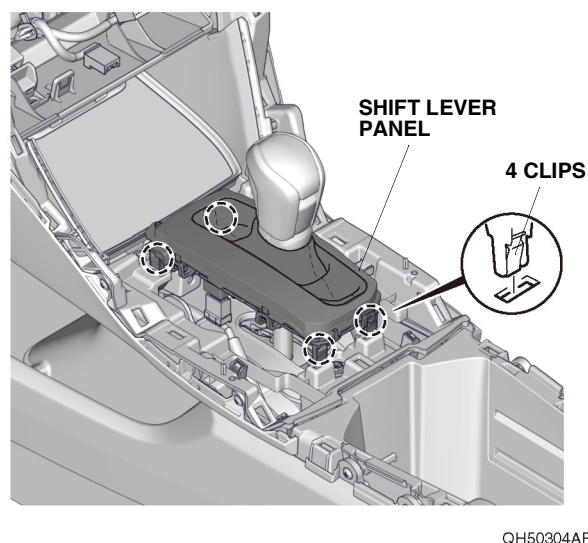

## M/T Models

- Lower the shift lever boot to release two retaining tabs from the boot.
- Remove the shift lever knob.

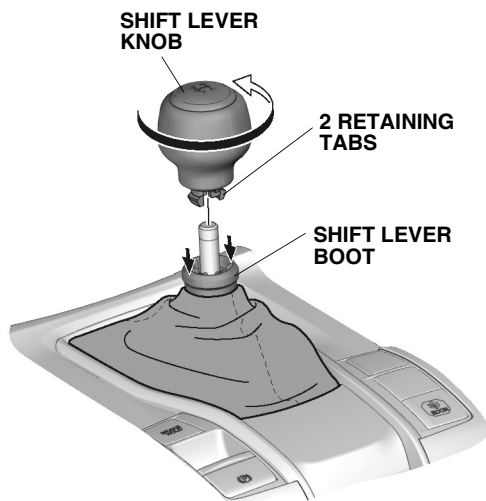

QE30541AJ

- Remove the shift lever panel, and unplug the vehicle connectors.

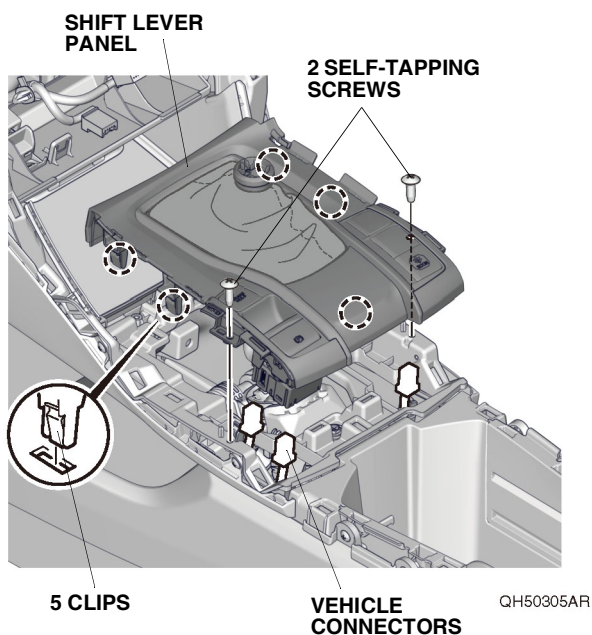

QH50305AR

17. Remove the upper tray mat.

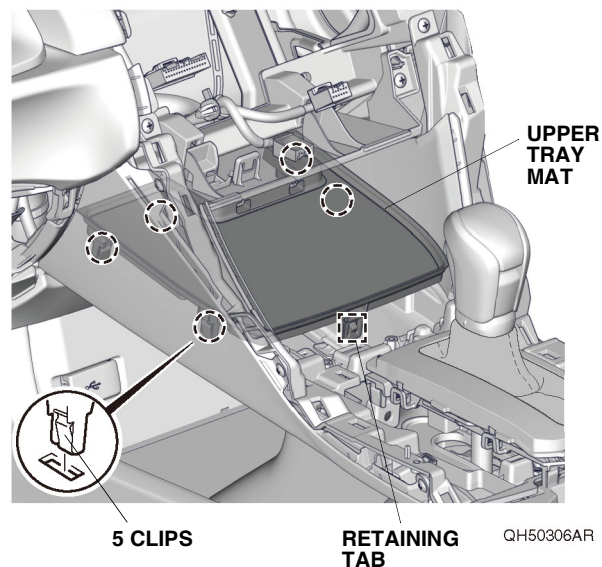

QH50306AR

18. Remove the console panel.

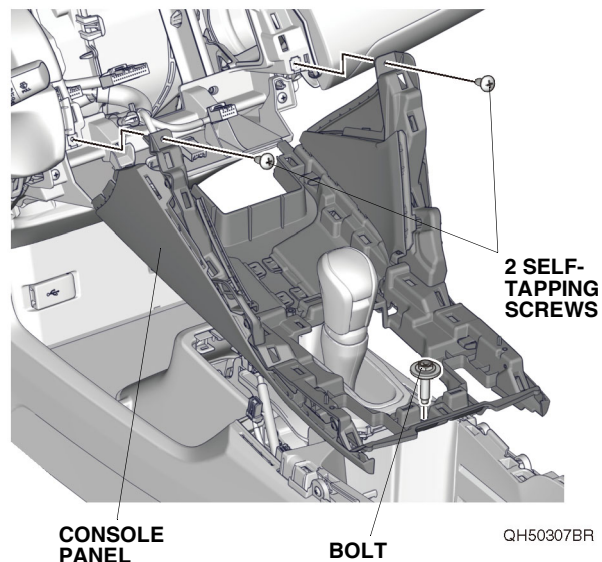

QH50307BR



19. If equipped, remove the lower tray mat.

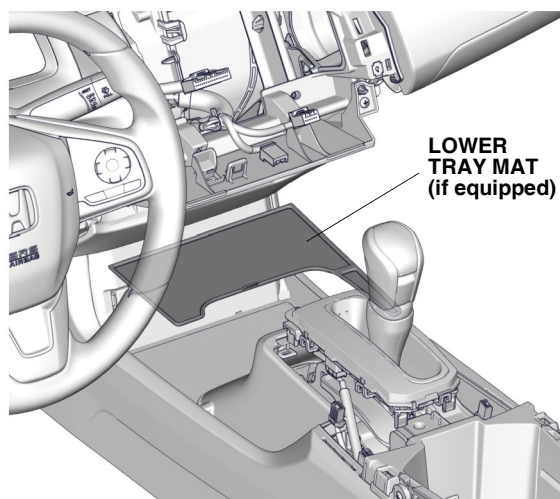

QH50308BR

20. Using a plastic trim tool, remove the switch panel, and unplug the vehicle connectors.

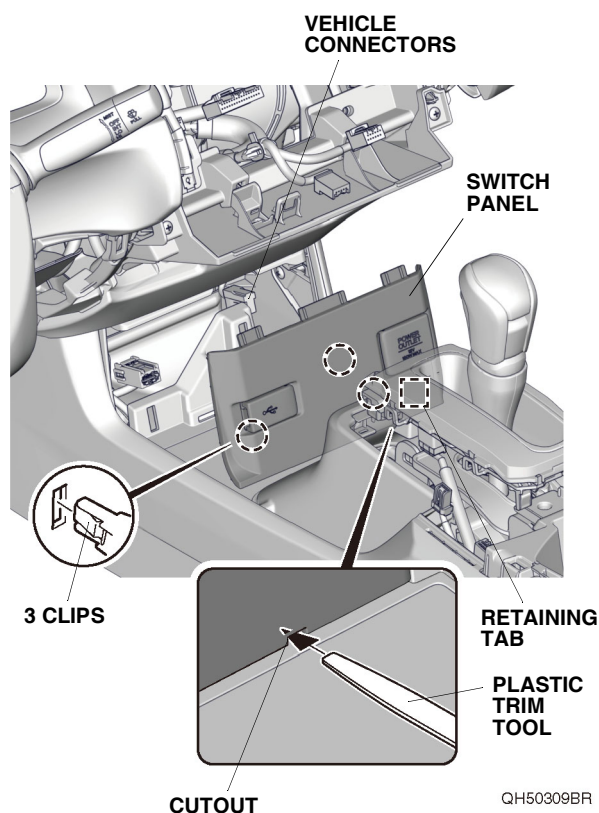

QH50309BR

21. If equipped, release the vehicle clip, and unplug the vehicle connector.

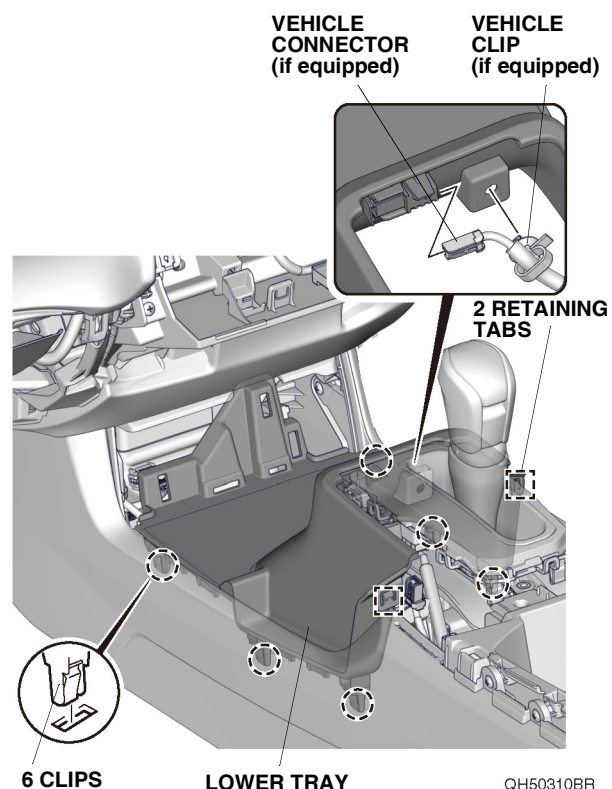

QH50310BR

22. Remove the lower tray.

23. Remove the left side panel.

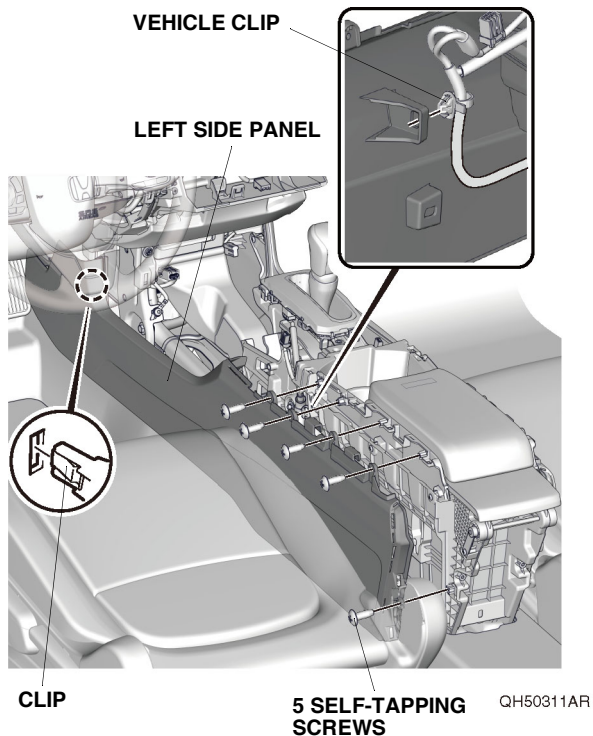

24. Remove the right side panel.

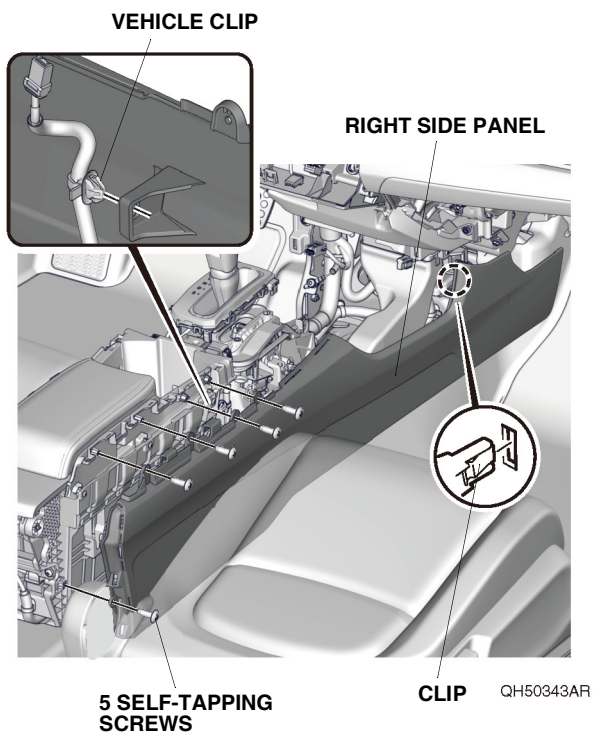

25. Remove the dashboard center lower cover.

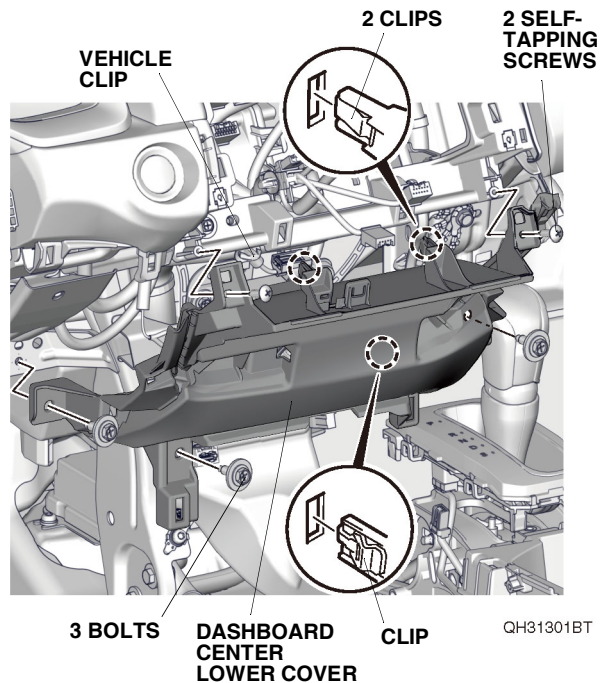

26. Remove the two self-tapping screws from the center console armrest.

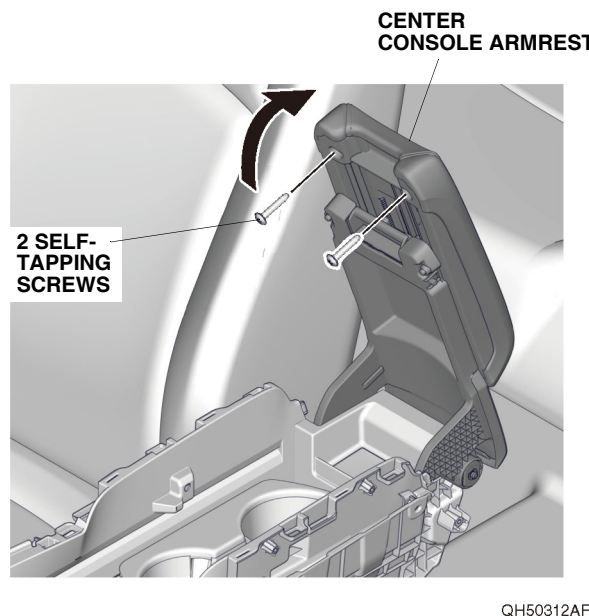

27. Remove the center console armrest.

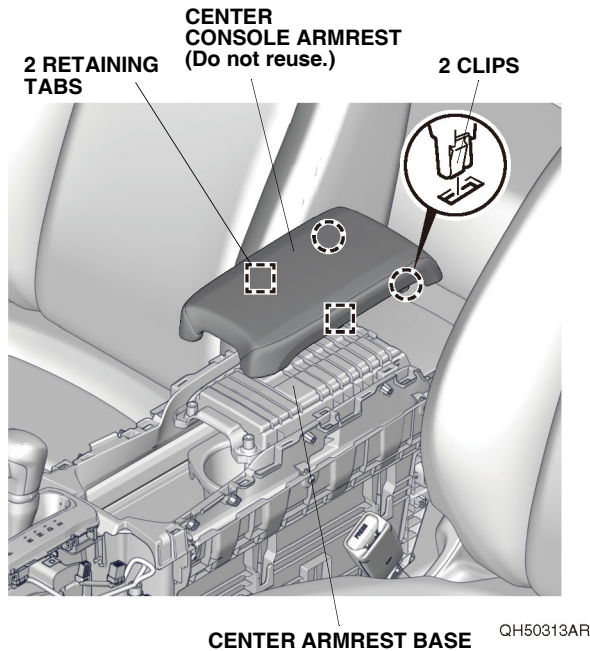

28. Apply masking tape to the left side panel as shown.

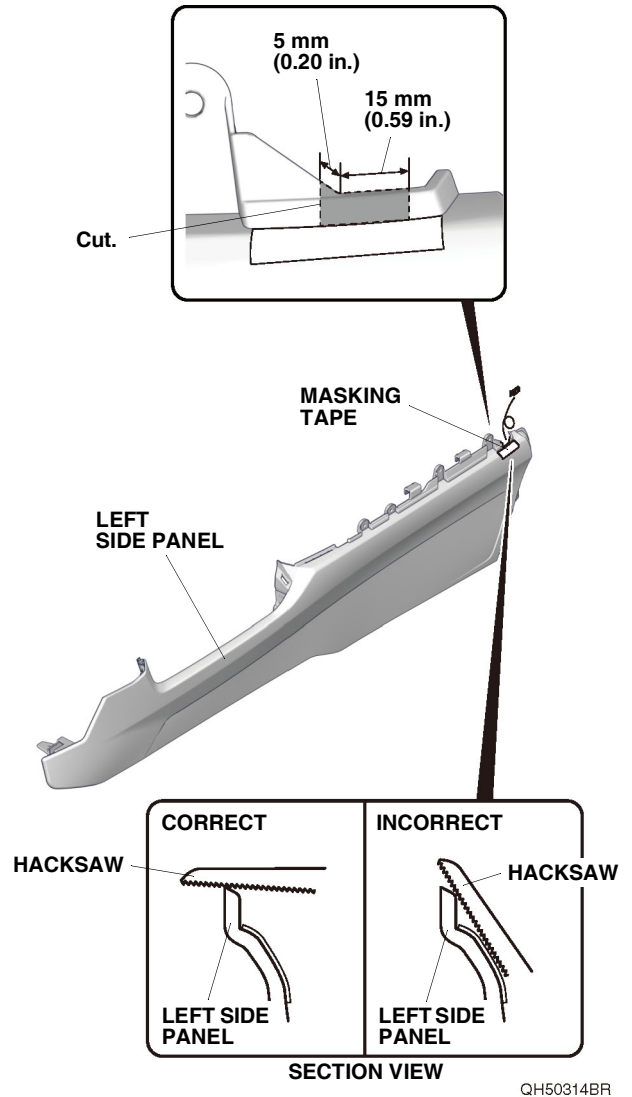

29. Using a hacksaw, cut the left side panel as shown. Using a file, remove any burrs.  
NOTE: Be careful not to damage the left side panel.
30. Remove the masking tape.
31. Repeat steps 28 through 30 on the other side.

32. Apply masking tape to the left light harness as shown.  
NOTE: Make sure to check the identification mark of the left light.

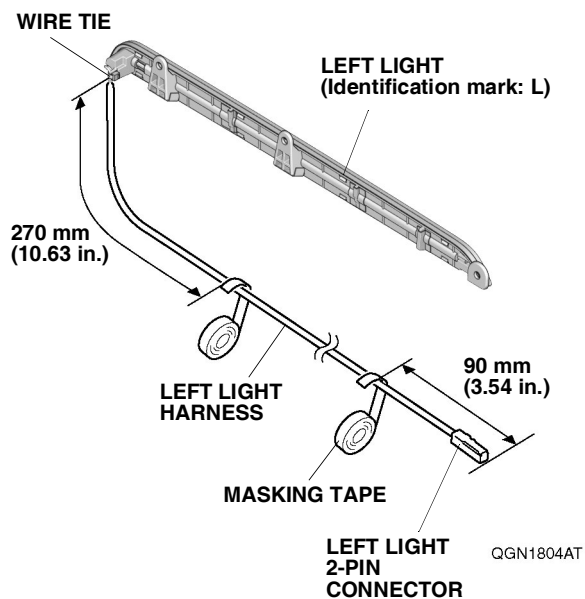

33. Using isopropyl alcohol on a shop towel, thoroughly clean the left side panel where the aluminum tape will attach.

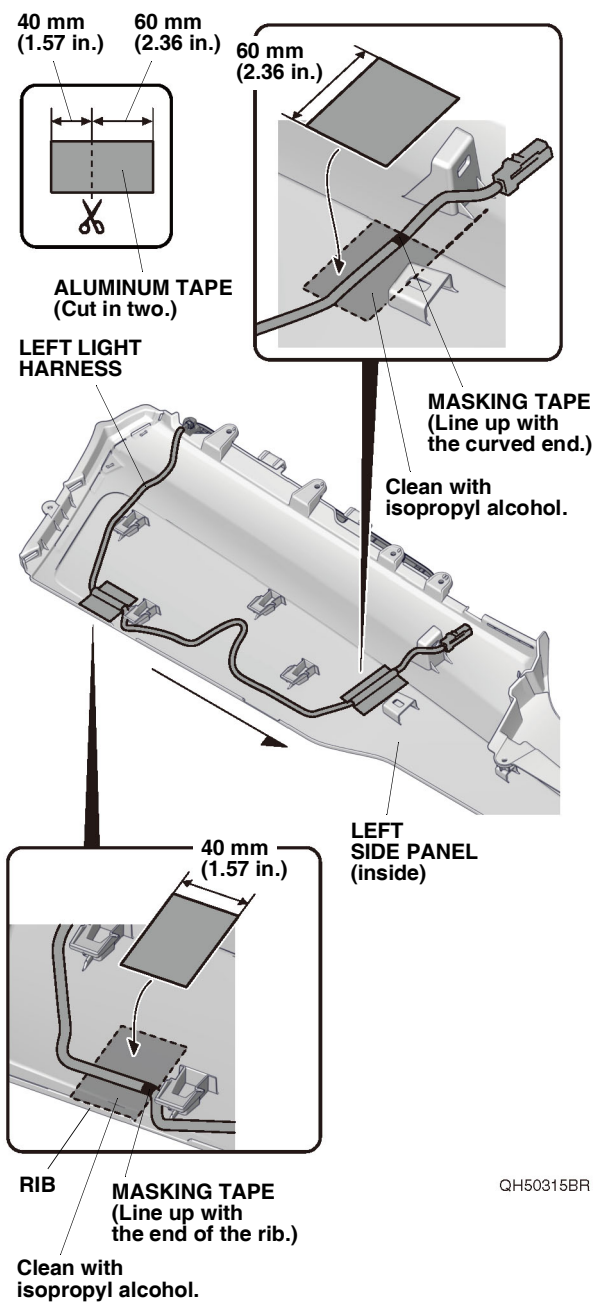

34. Using scissors, cut one piece of aluminum tape as shown. Secure the left light harness to the left side panel with two pieces of aluminum tape.



35. Using isopropyl alcohol on a shop towel, thoroughly clean the left side panel where the aluminum tape will attach.

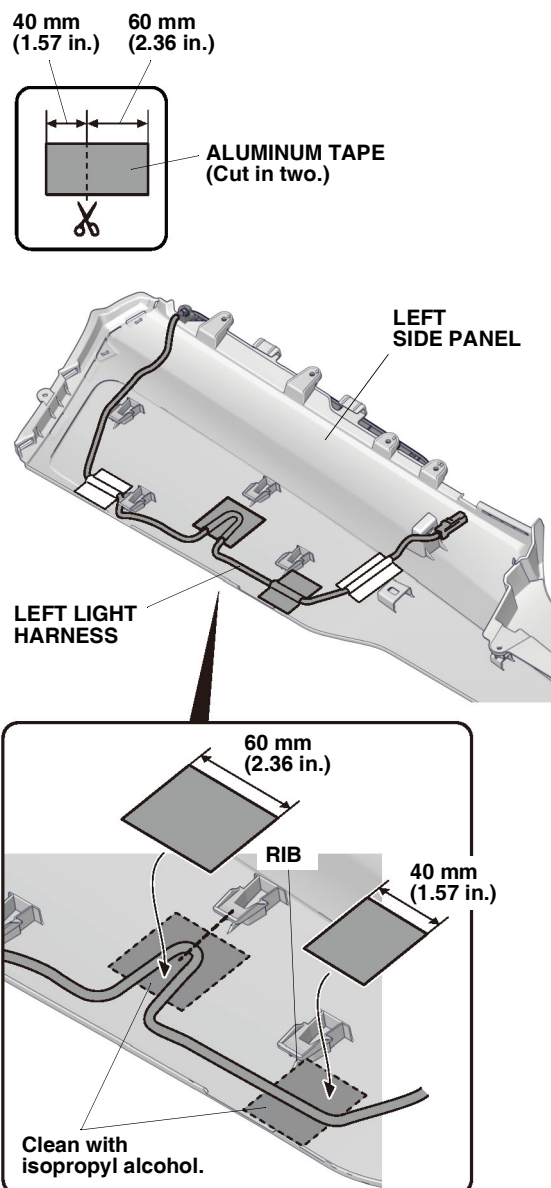

36. Using scissors, cut one piece of aluminum tape as shown. Secure the left light harness to the left side panel with two pieces of aluminum tape.
- NOTE: Do not fold the left light harness.
37. Repeat steps 32 through 36 to install the right light to the right side panel.

38. Using isopropyl alcohol on a shop towel, thoroughly clean the fuse case where the fuse label will attach.

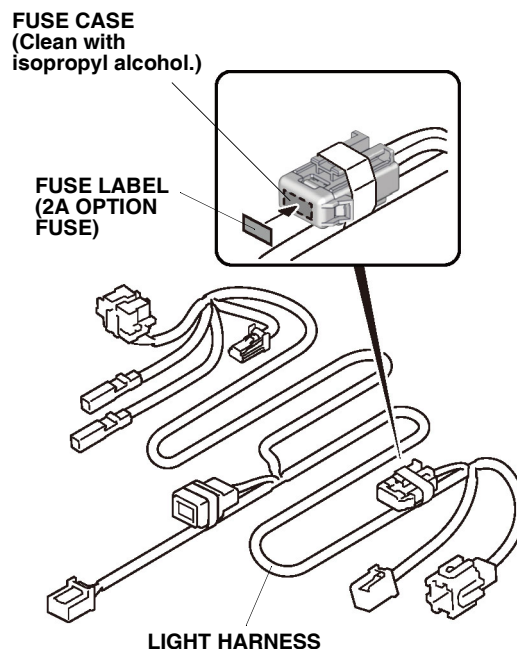

39. Apply the fuse label to the light harness fuse case.

40. Route the light harness as shown.

**LIGHT HARNESS  
6-PIN CONNECTOR**

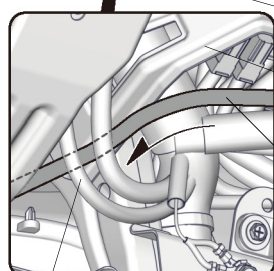
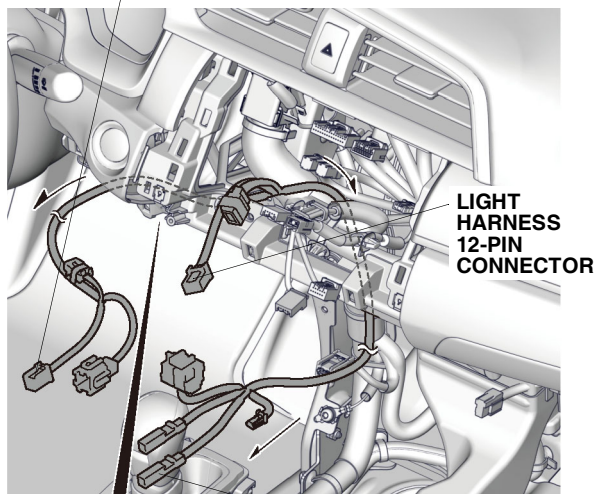

**OPPOSITE SIDE  
VIEW**

**VEHICLE  
HARNESS**

QH50318BR

41. Line up the green tape on the light harness with the vehicle clip, and secure the light harness to the vehicle harness with one wire tie.

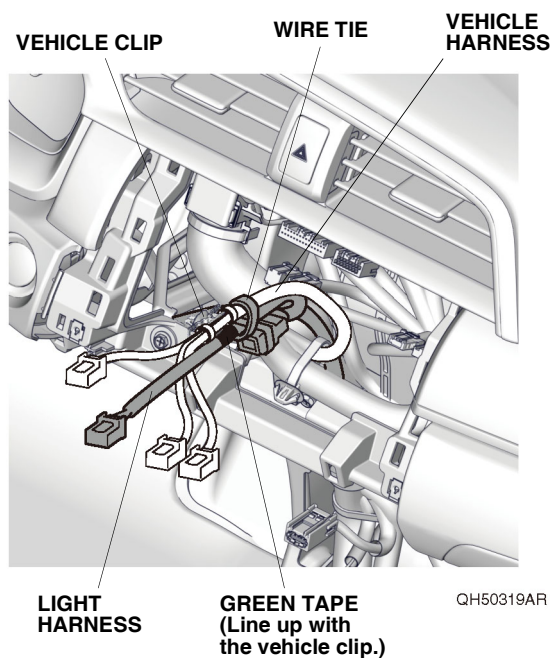

QH50319AR

42. Plug the vehicle or other accessory 12-pin connector into the light harness 12-pin connector.

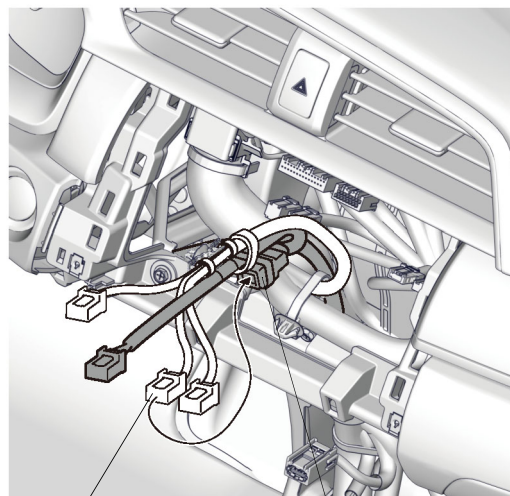

QH50320AR

43. Route the light harness as shown.

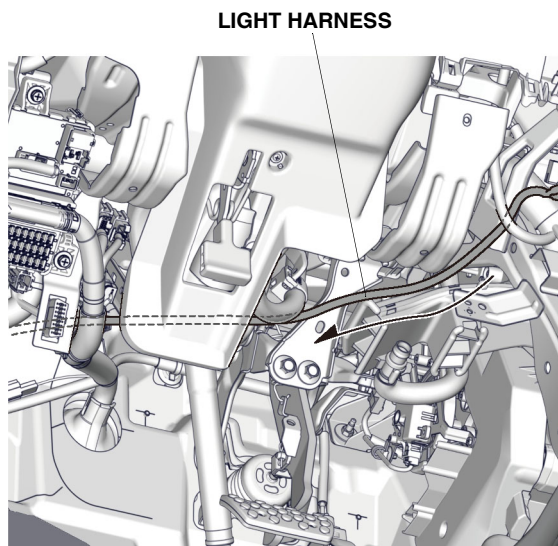

QH50321AR

44. Plug the light harness 6-pin connector into the vehicle 6-pin connector.

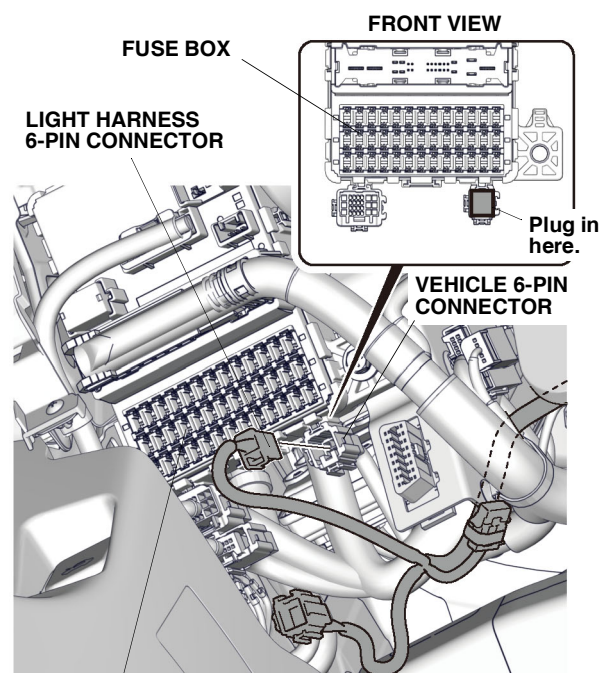

FUSE BOX

**WITH OTHER ACCESSORY HARNESSES**  
If the dummy connector is plugged, unplug it.

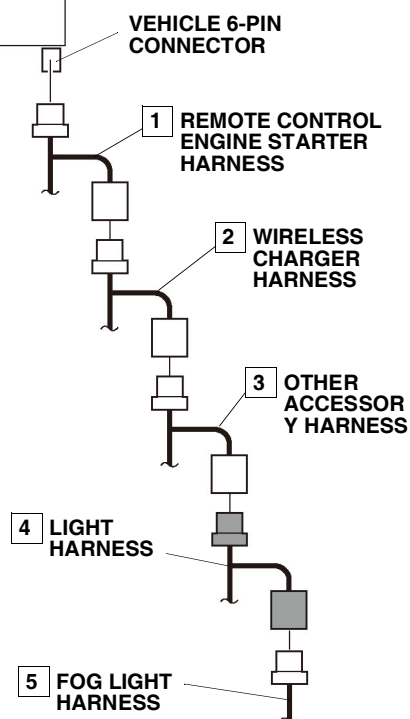

QH50322BR



45. Attach the light harness 6-pin connector to any of the positions shown.

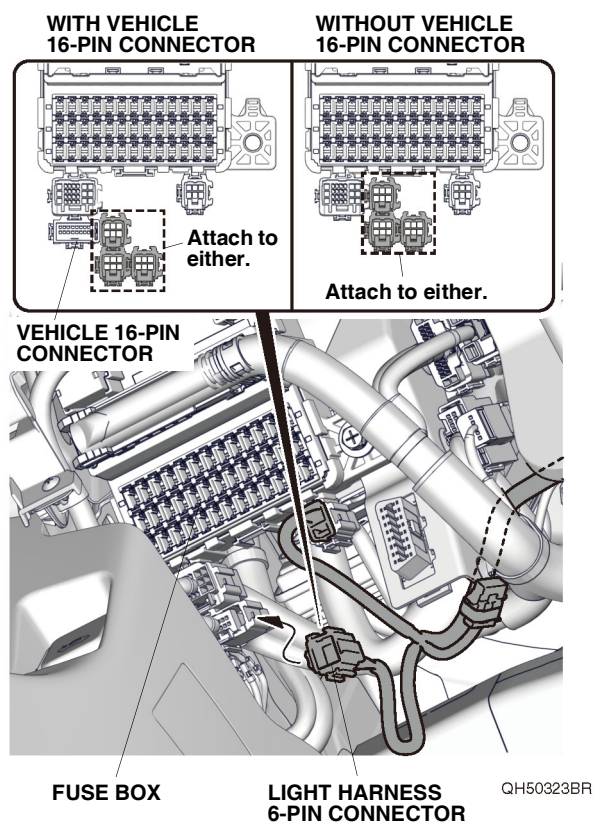

46. Secure the light harness to the vehicle harness with the three wire ties.

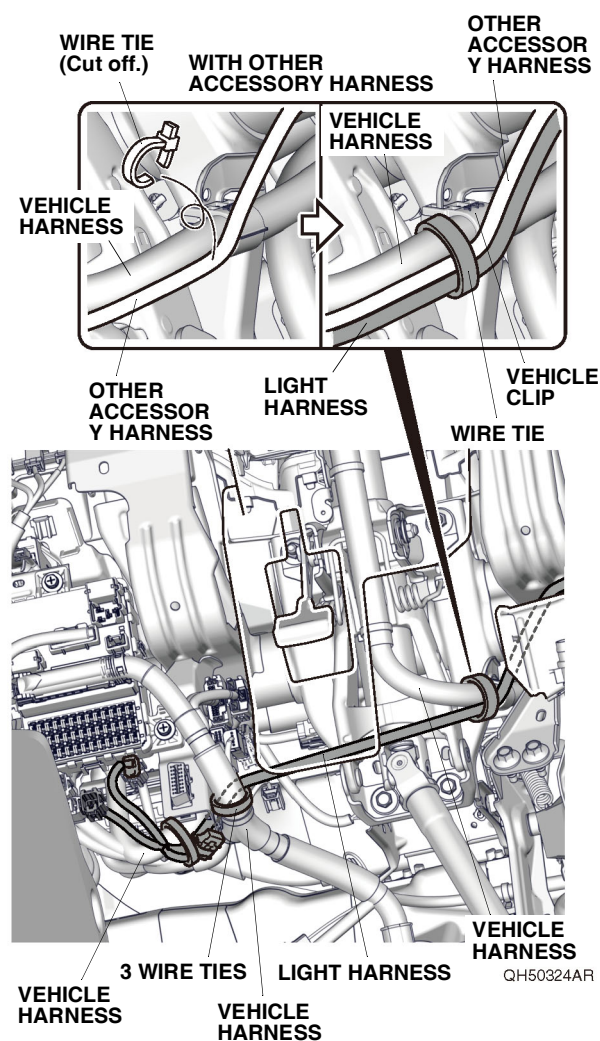

47. Secure the light harness to the vehicle duct with the two wire ties.

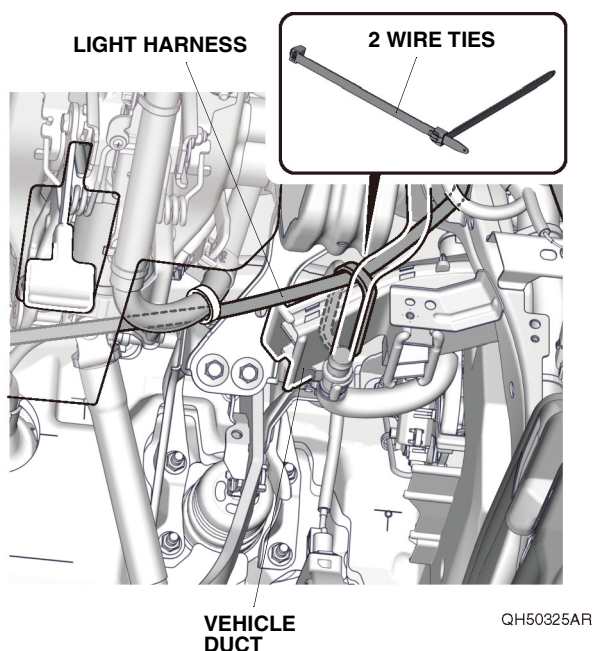

48. Secure the light harness to the vehicle panel and vehicle harness with two wire ties.

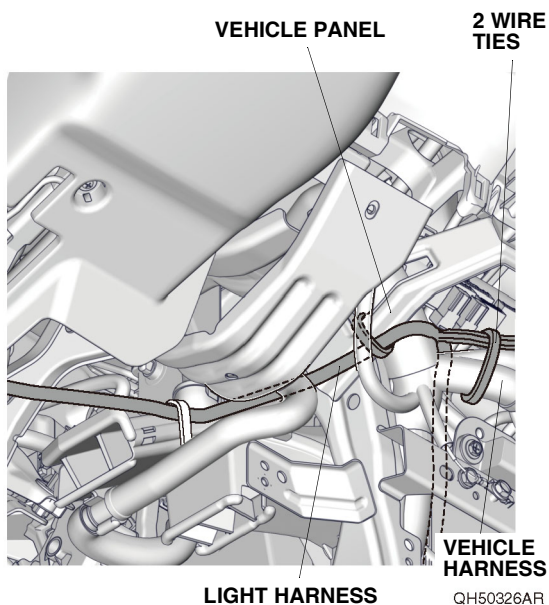

49. Install the relay and the clip to the light harness relay block.

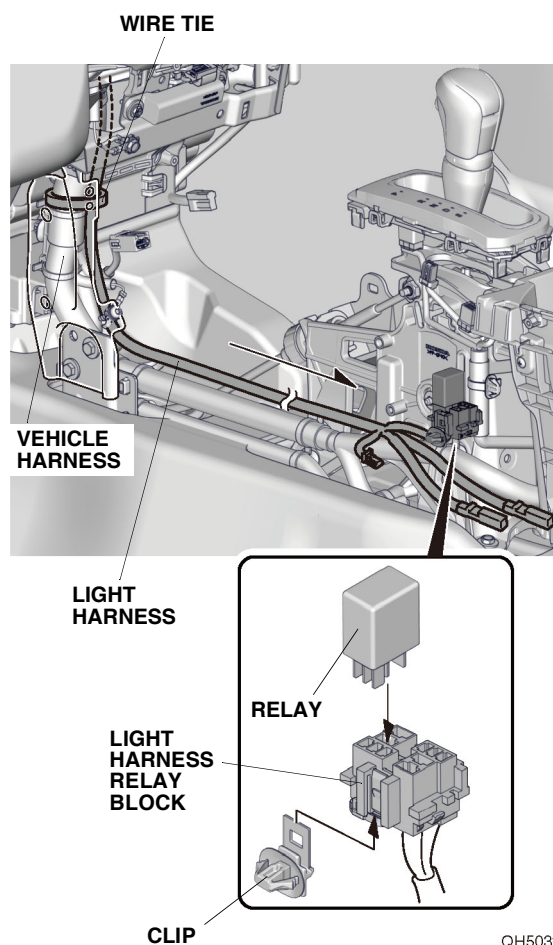

50. Secure the light harness to the vehicle harness with one wire tie.

51. Plug the light harness 4-pin connector into the unit.

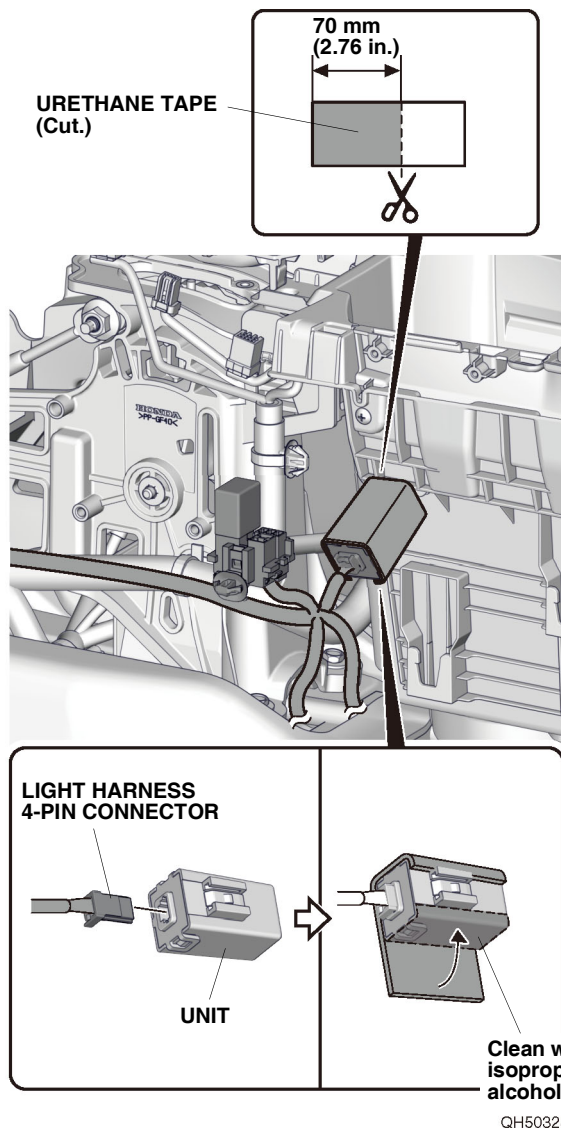

52. Using isopropyl alcohol on a shop towel, thoroughly clean the unit where the urethane tape will attach.
53. Using scissors, cut one urethane tape as shown. Wrap the cut urethane tape around the unit.

54. Using scissors, cut one urethane tape in half, and attach each piece around the light harness 2-pin connectors.

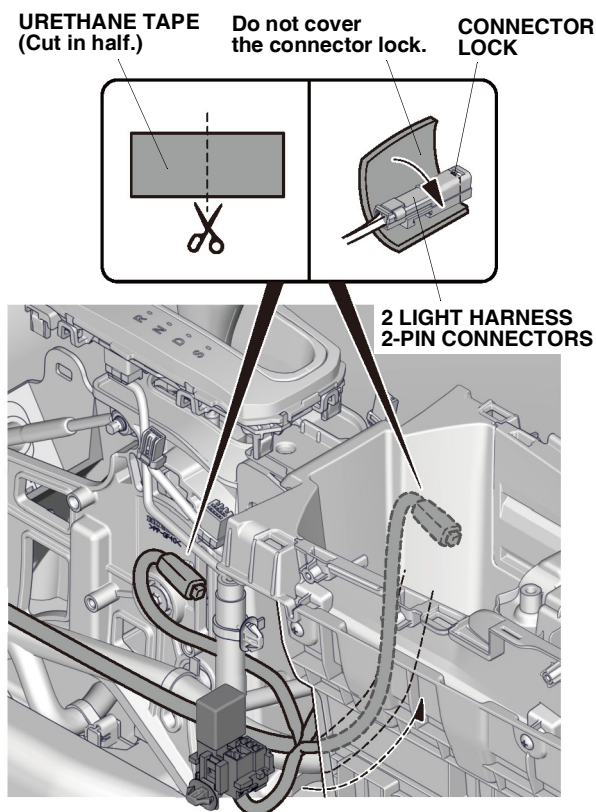

55. Secure the light harness and the 2-pin connector to the vehicle harness with one wire tie.

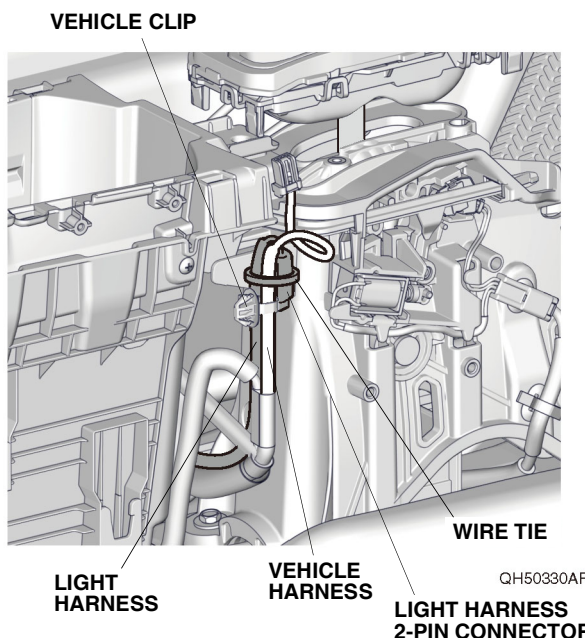



56. Secure the light harness 2-pin connector to the vehicle harness with one wire tie.

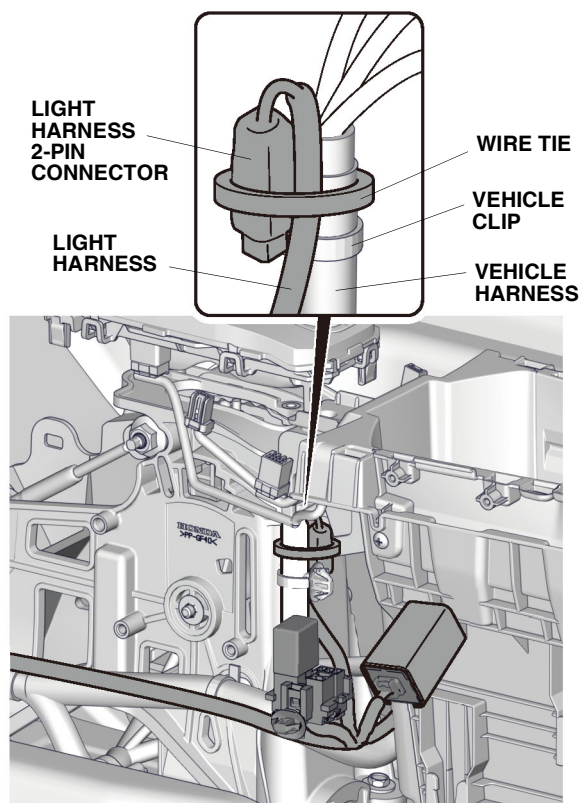

QH50331AR

57. Secure the unit and the light harness to the vehicle harness with one wire tie with holder.

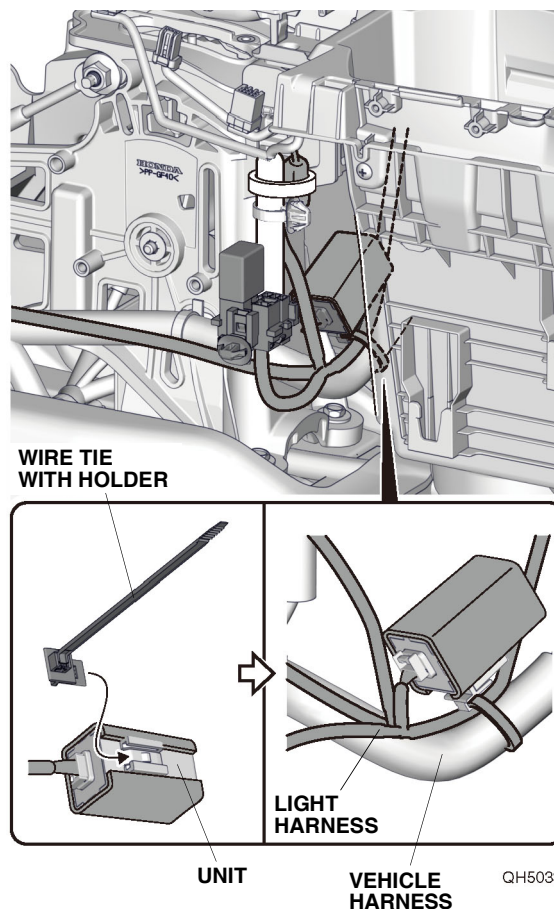

QH50332AR

58. Secure the light harness to the vehicle harness with the three wire ties.

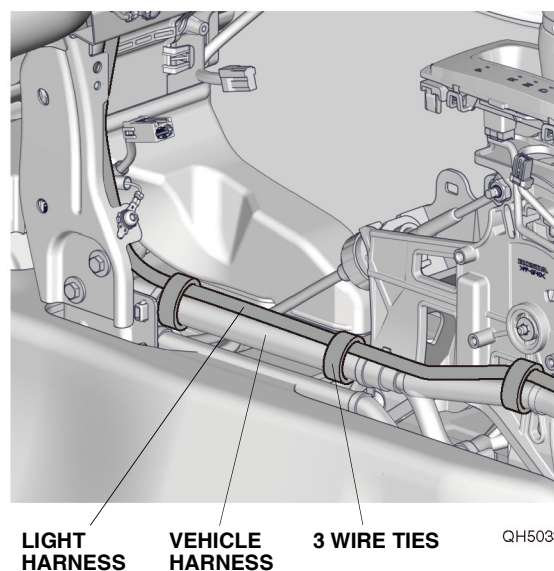

QH50333AR

59. Install the dashboard center lower cover, and plug the left light 2-pin connector into the light harness 2-pin connector.

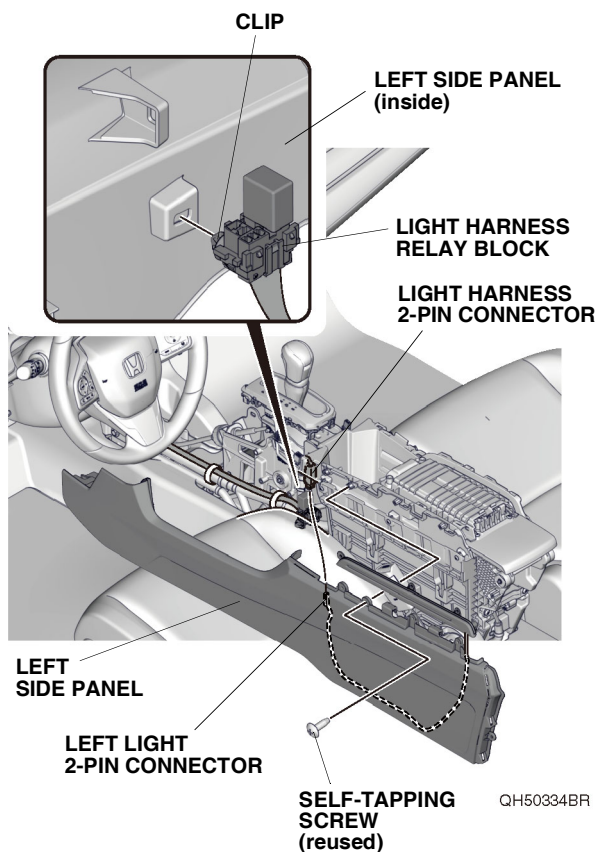

60. Plug the left light 2-pin connect into the light harness 2-pin connector.
61. Secure the light harness relay block to the left side panel, and install the left side panel with one self-tapping screw.

62. Install the left light with the three self-tapping screws while pushing up on it.  
NOTE: Wrap masking tape around a Phillips screwdriver.

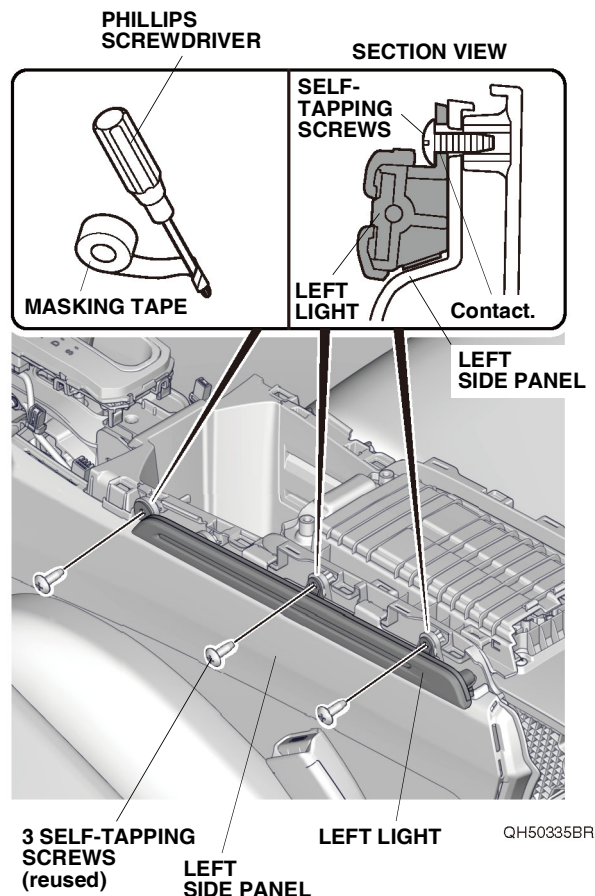



63. Plug the right light 2-pin connector into the light harness 2-pin connector, and install the right side panel with one self-tapping screw.

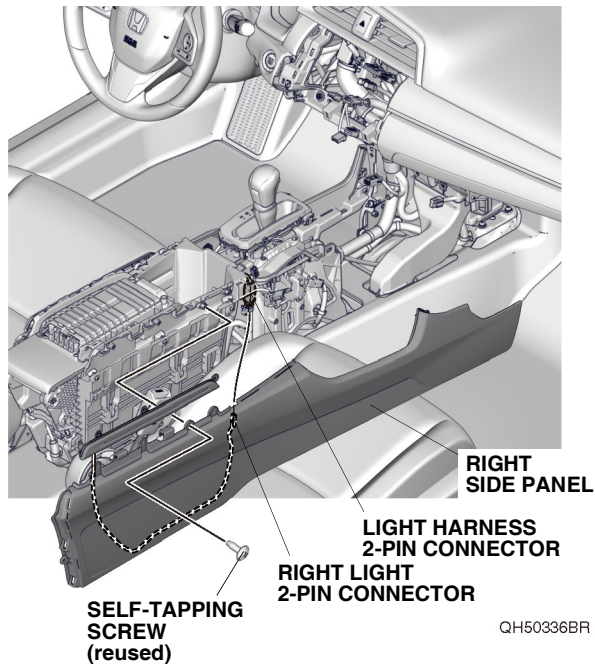

64. Install the right light with the three self-tapping screws while pushing up on it.  
NOTE: Wrap masking tape around a Phillips screwdriver.

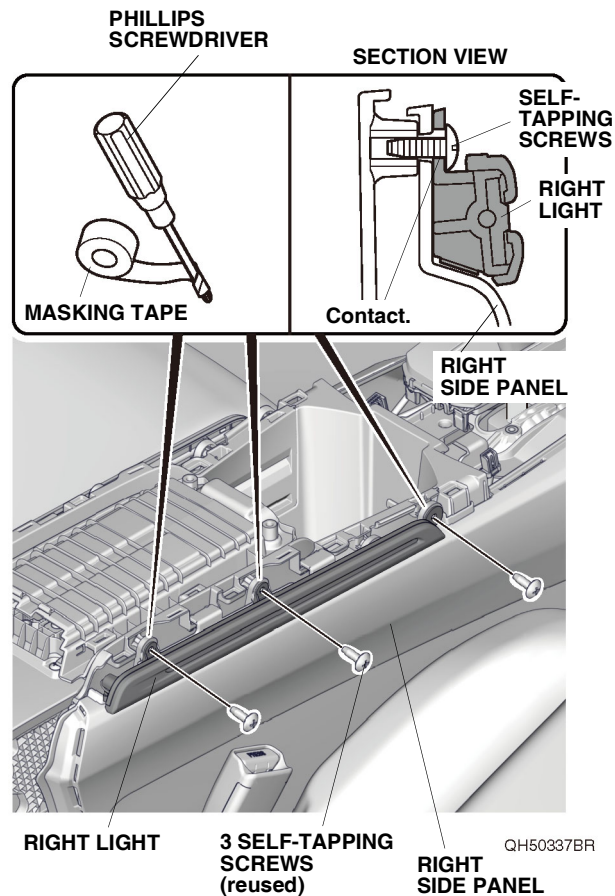

65. Install the lower tray, the switch panel, the lower tray mat (if equipped), the console panel, the upper tray mat, the trim panel, the console rear panel, and the audio unit.

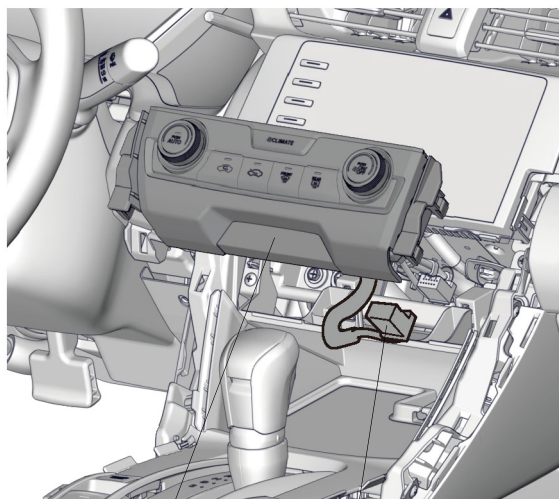

**A/C CONTROL UNIT**

**LIGHT HARNESS 12-PIN CONNECTOR**

QH50338AR

66. Plug the light harness 12-pin connector into the A/C control unit, and install the A/C control unit.
67. Install the left and right center console trims.

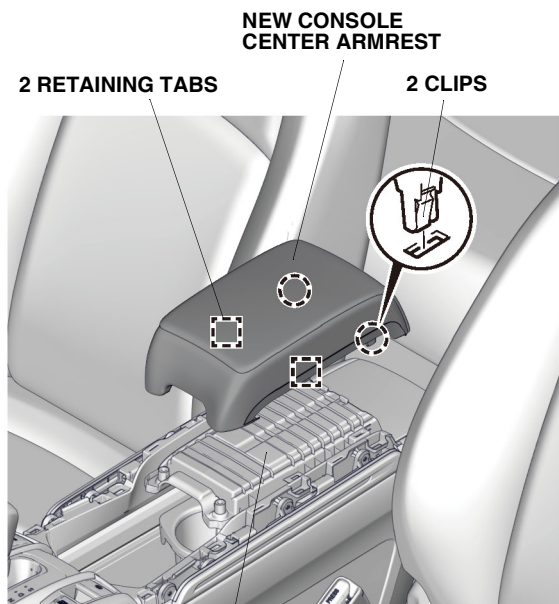

**CENTER ARMREST BASE**

QH50339BR

68. Install the new console center armrest to the center armrest base.

69. Open the console center armrest, and secure it with the two self-tapping screws.

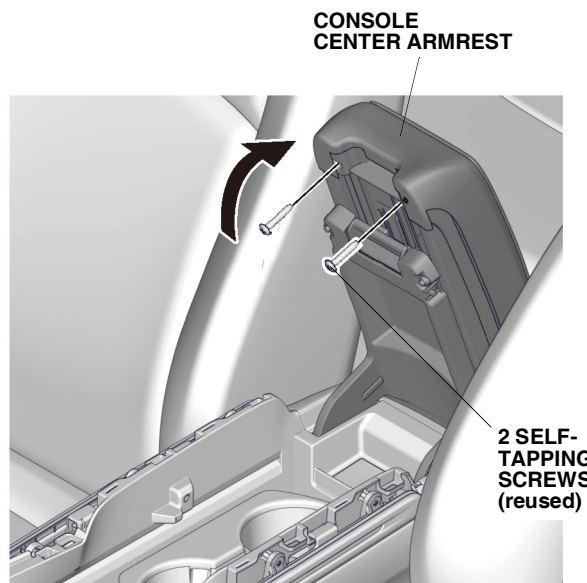

QH50340AR

70. Install the new left console side armrest to the center console.

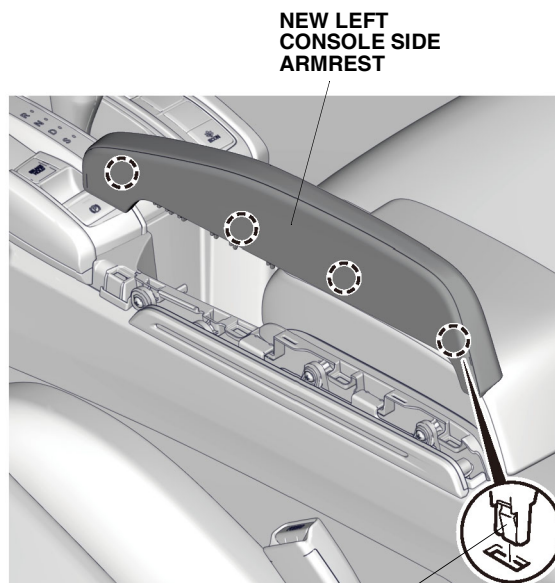

**4 CLIPS**

QH50341BR

71. Install the new right console side armrest to the center console.

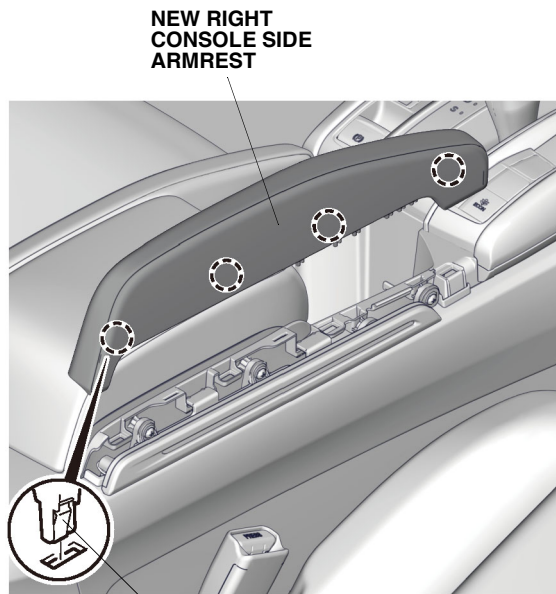

QH50342BR

72. Check that all wire harnesses are routed properly and all connectors are plugged in.
73. Install all removed parts.
74. Connect the negative cable to the battery.
75. Turn the engine switch to ON; the SRS indicator should come on for about 6 seconds and then go off.
76. Press and hold the audio unit power button for 2 seconds to restore the audio and navi (if equipped) system functions.
77. Set the clock on vehicles without navigation.
78. If necessary, restore the systems back to normal operation as described in the service information.

## Check the Operation of the Armrest Illumination

79. Set the light switch to the or position, and make sure the left and right lights are on.
80. Set the headlight switch to the AUTO position, and make sure the left and right lights are on with the parking lights or headlights.
81. Check that the armrest illumination brightness varies along with the instrument panel brightness by turning the brightness control knob.
82. Make sure the left and right lights come on when you open each door.
83. If the left and right lights do not come on, check the fuse and all of the connectors.

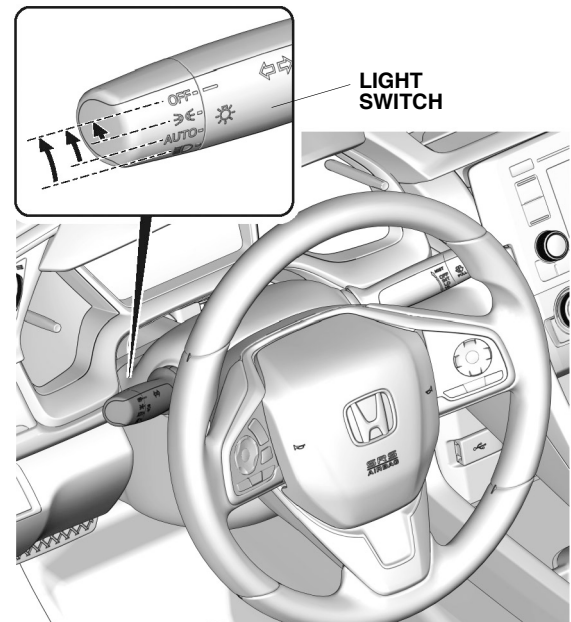

QE32317AJ