



HONDA INSTALLATION INSTRUCTIONS

Accessory

DOOR MIRROR COVERS
P/N 08R06-TGH-100

Application

2018 CIVIC TYPE R

Publications No.

VERSION 1

Issue Date

FEB 2019

PARTS LIST

Left door mirror cover



Right door mirror cover



Alcohol wipe



Left mirror housing upper cover
(black)



Right mirror housing upper cover
(black)



TOOLS AND SUPPLIES REQUIRED

Flat-tip screwdriver

Masking tape

Shop towel

10 mm Open end wrench

Ratchet

10 mm Socket

Illustration of the Door Mirror Covers Installed on the Vehicle

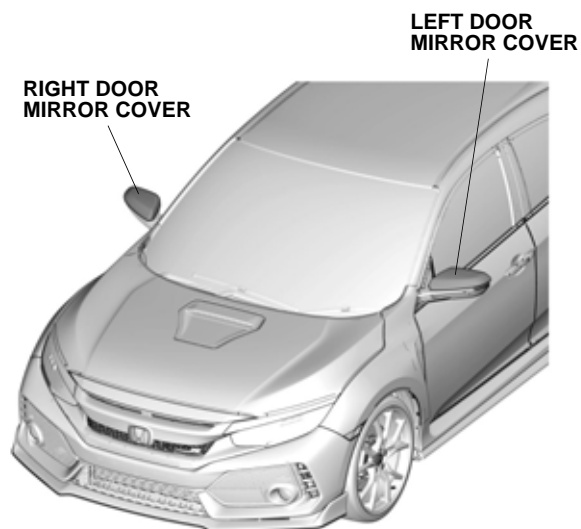

QG91401AR

INSTALLATION

Customer Information: The information in this installation instruction is intended for use only by skilled technicians who have the proper tools, equipment, and training to correctly and safely add equipment to your vehicle. These procedures should not be attempted by "do-it-yourselfers."

NOTE:

- Be careful not to damage the paint finish.
 - This door mirror covers kit should be installed only if the ambient air temperature is 15°C (60°F) or above.
 - To allow the adhesive to cure, do not wash the vehicle for 24 hours. Make sure your customer is aware of this.
1. Disconnect the negative cable from the battery.

2. Apply masking tape, and attach a shop towel as shown.

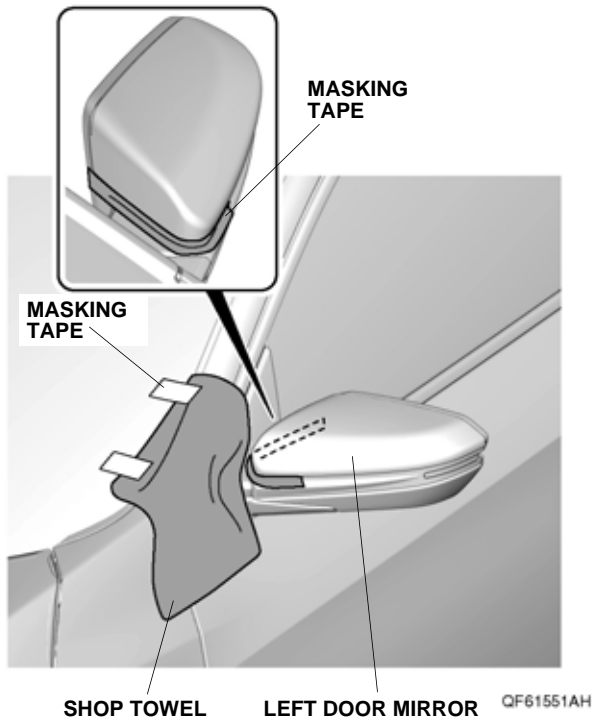

3. Release the left mirror holder. Be careful not to damage the retaining tabs.

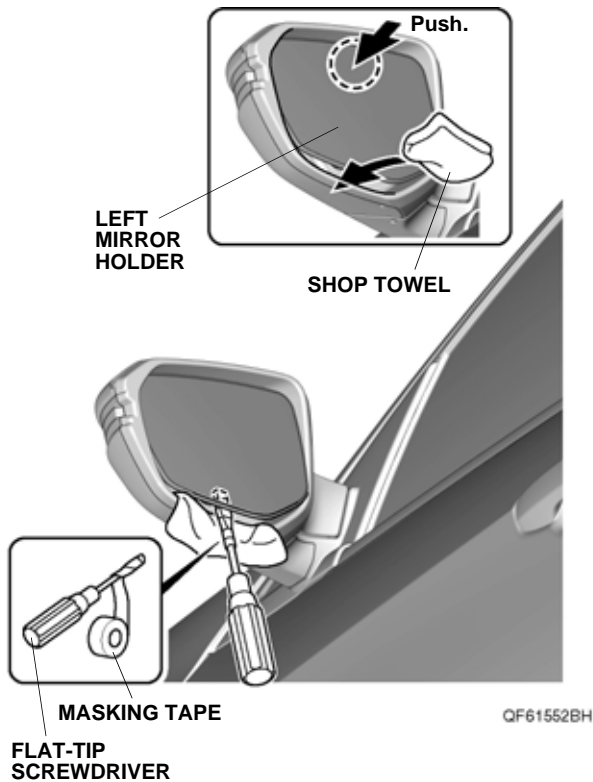

4. Remove the left mirror holder.
NOTE: Make sure there are no cracks or deformities on the mirror holder.

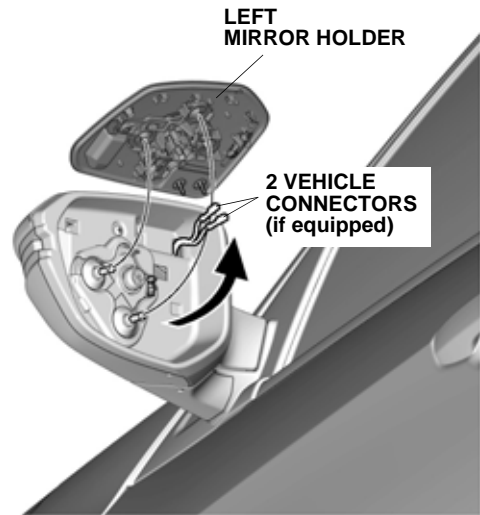

5. Release the two retaining tabs.
NOTE: Be careful not to damage the retaining tabs.

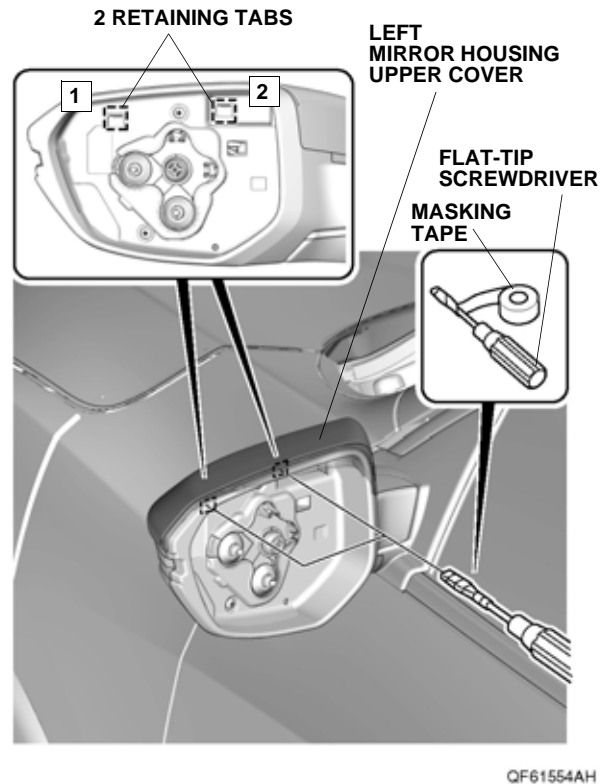

6. Insert a shop towel, and release the retaining tab.
NOTE: Be careful not to damage the retaining tab.

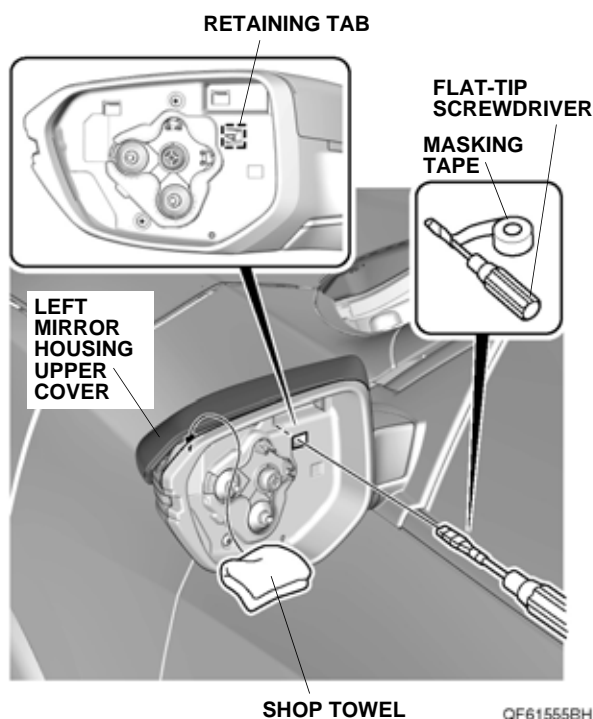

7. Remove the left mirror housing upper cover from the left visor.
NOTE: Be careful not to damage the retaining tab.

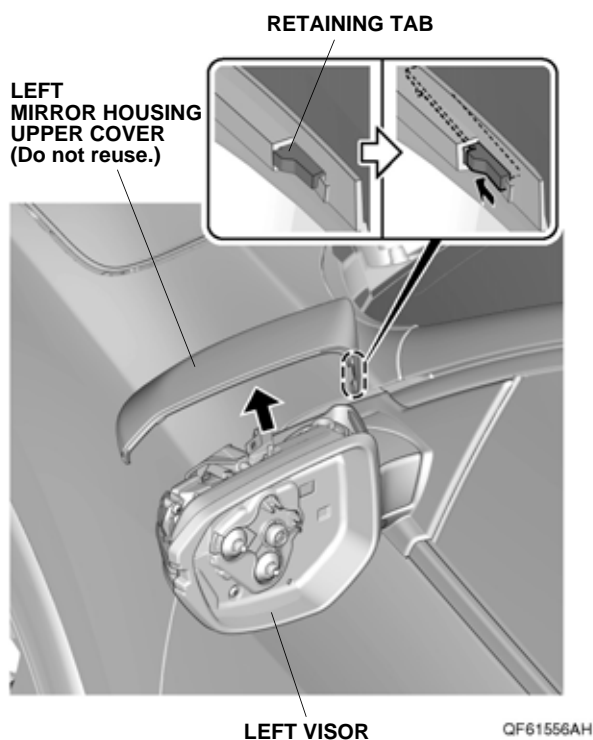

8. Install the left mirror housing upper cover to the left visor. Make sure there is no gap between the cover and the visor. Make sure to secure the retaining tabs properly.

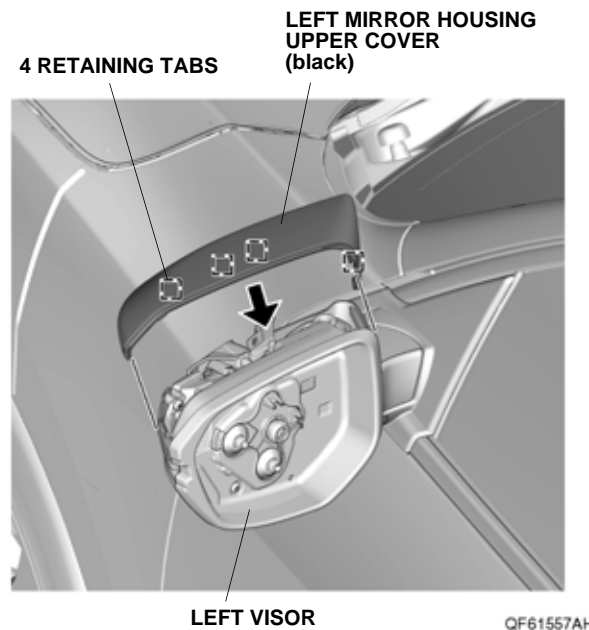

If the actuator rods and boots stay in the mirror holder, continue with step 9; otherwise, go to step 12.

With Actuator Rods and Boots in the Mirror Holder

9. Remove the actuator rods and the boots from the left mirror holder.

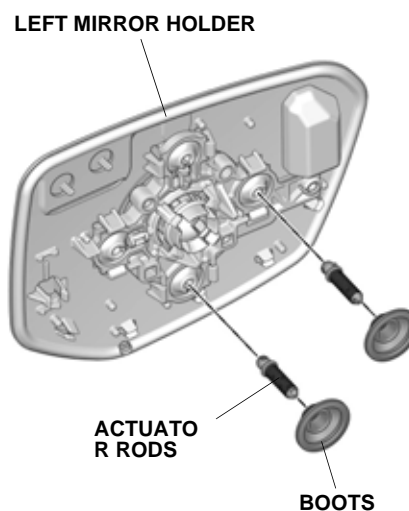

QF70401AH

10. Assemble the actuator rods and the boots.

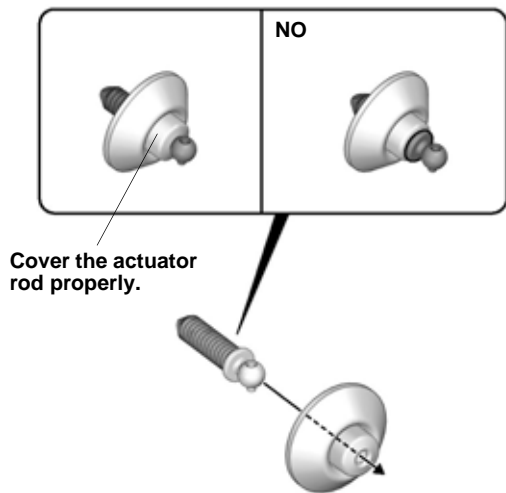

QG91402AR

11. Install the actuator rods to the inner holder. Make sure to install the actuator rod in the correct position and orientation. Go to step 13.

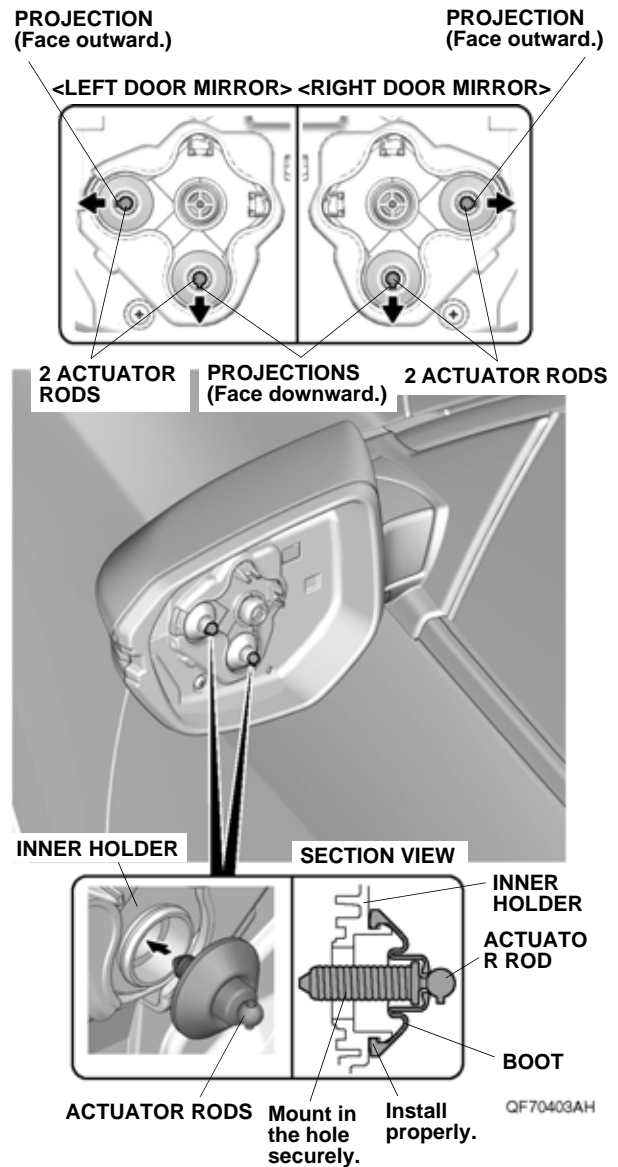

With Actuator Rods and Boots in the Inner Holder

12. Push the actuator rods into the inner holder. Make sure to install the actuator rod in the correct position and orientation.

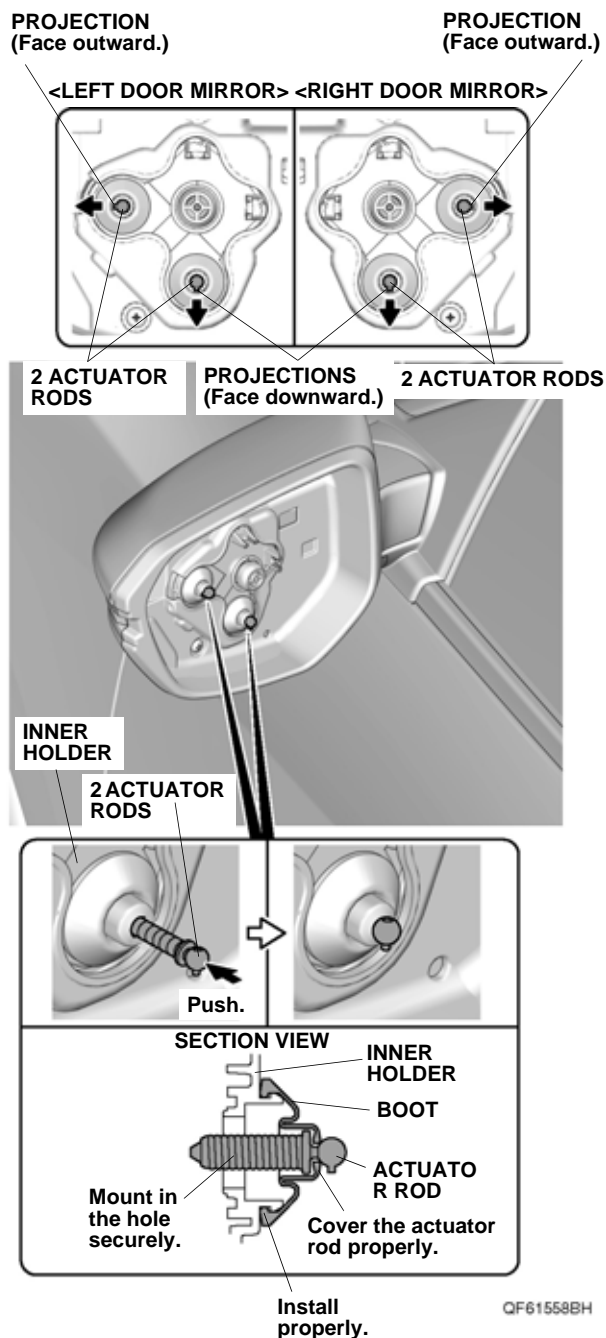

13. Plug the vehicle connectors into the left mirror holder (if equipped), and install the left mirror holder. NOTE: Make sure the actuator rod is installed properly.

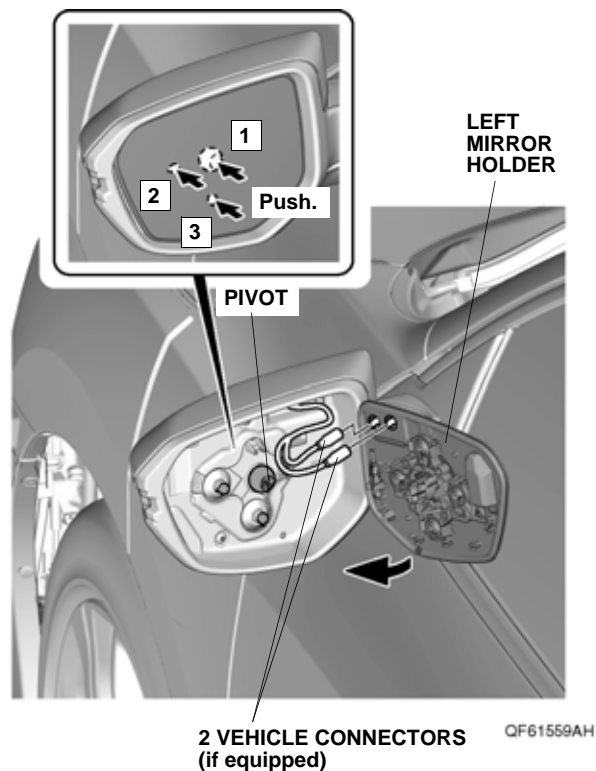

14. Move the left mirror holder in all directions to check if it is installed securely.

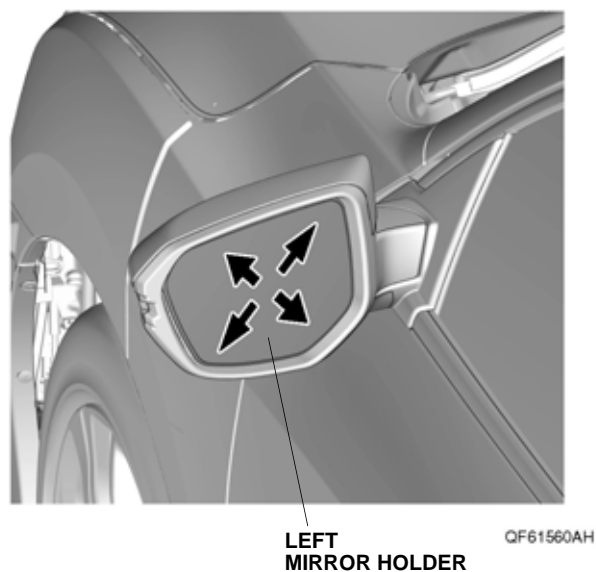

15. Peel back the two adhesive backings, and tape them to the front surface of the left door mirror cover with masking tape.

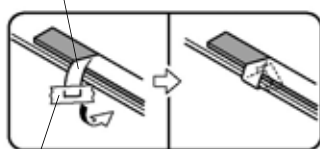
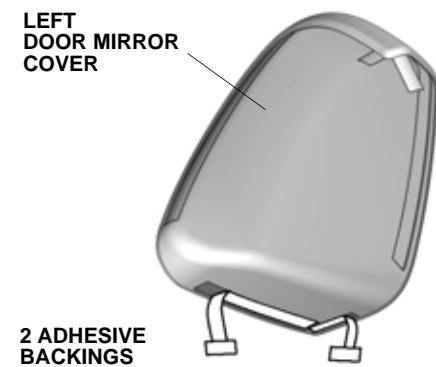

QF93102BT

16. Using an alcohol wipe, thoroughly clean the left mirror housing upper cover where the left door mirror cover will attach.

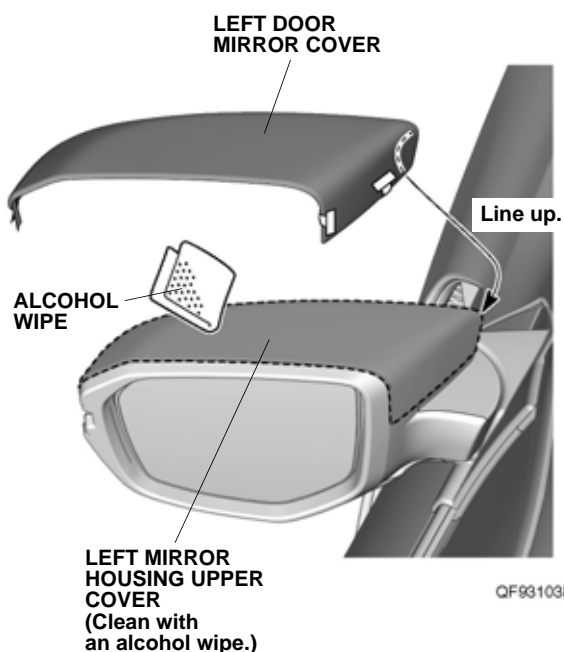

QF93103BT

17. Line up the left door mirror cover with the left mirror housing upper cover as shown.

18. Install the left door mirror cover to the left mirror housing upper cover as shown.

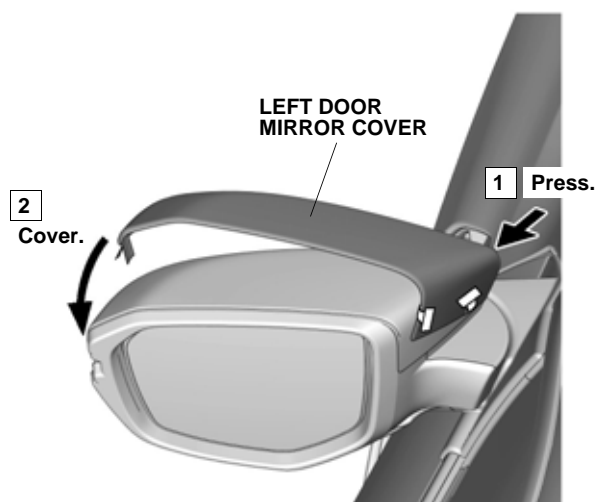

QF93104BT

19. While applying light pressure against the left door mirror cover, carefully remove the adhesive backings.

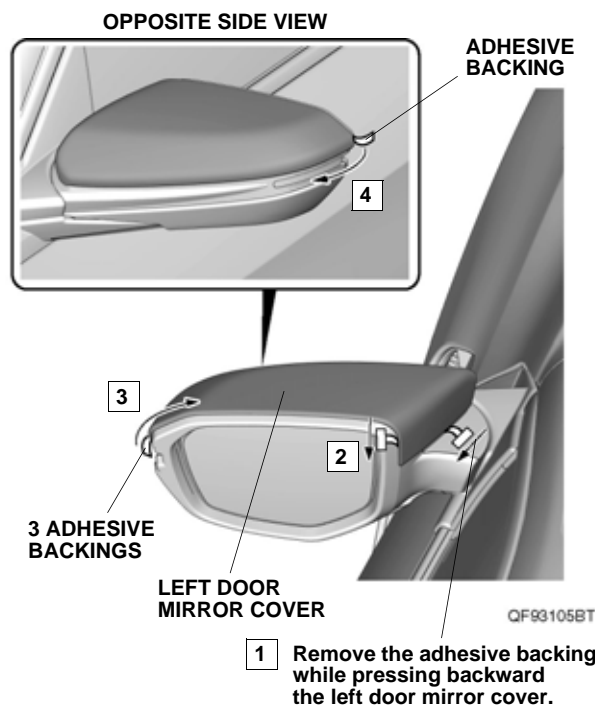

QF93105BT

20. Using the palm of your hand, firmly press the left door mirror cover against the left mirror housing upper cover for 30 seconds.
21. Repeat steps 2 through 20 on the right side of the vehicle.

22. Check that all wire harnesses are routed properly and all connectors are plugged in.
23. Connect the negative cable to the battery.
24. Press and hold the audio unit power button for 2 seconds to restore the audio and navi system functions.
25. Set the clock.
26. If necessary, restore the systems back to normal operation as described in the service information.