

Germain Honda of College Hills



INSTALLATION INSTRUCTIONS

Accessory

FRONT FENDER TRIMS

Application

2023 ACCORD
MODEL SERIES

Publications No.

VERSION 1

Issue Date

DEC 2022

GENERAL VIEW

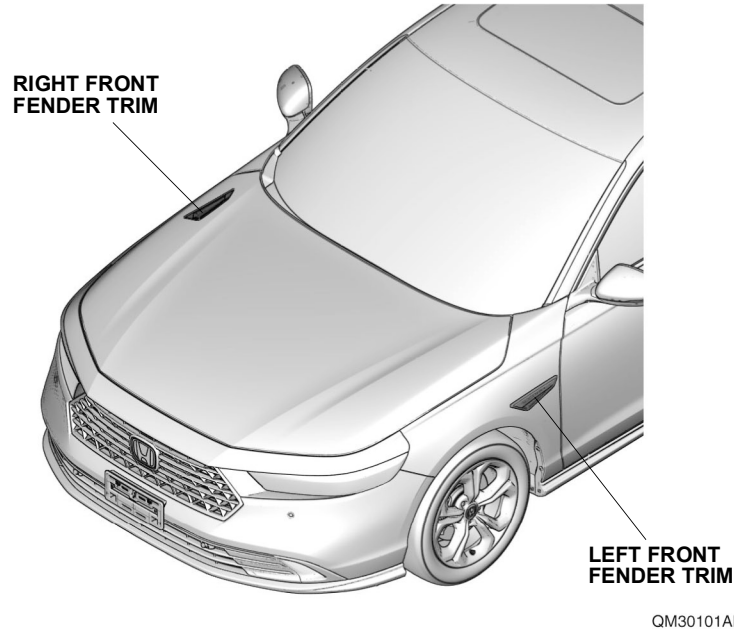

FOR YOUR SAFETY (Read carefully.)

Warning Symbols

Safety: Your safety, and the safety of others, is important. To help you make informed decisions about service procedures, we have provided safety messages where appropriate. Of course, it is not practical or possible to warn you about all the hazards associated with servicing a vehicle - you must use your own good judgment.

You will find important safety messages preceded by one of the following symbols:

*All symbols are not used in all installation instructions.

 **DANGER**

You will be killed or seriously hurt if you do not follow the instructions.

 **WARNING**

You can be killed or seriously hurt if you do not follow the instructions.

 **CAUTION**

You can be hurt if you do not follow the instructions.

NOTICE

Gives advice to prevent damage to the product, vehicle, the environment or other property.

NOTE

Gives helpful information or instructions to be followed when installing this product.



Indicates a prohibited action.

Germain Honda of College Hills

Procedure and Location Icons

These icons indicate the work location and the worker's point of view.

*All icons are not used in all installation instructions.



The location on the vehicle.



The location in the vehicle.
(Instrument panel.)



Wear eye protection.



Wear heavy gloves.



Use an assistant.



Place the part on a blanket.



Work perpendicular.



Remove any burrs.



Use touch-up paint and allow to dry.



Tighten to the specified torque.



Apply firm pressure while rolling, especially at the ends, to set the adhesive.



Press firmly.



Clean with isopropyl alcohol.



Return the original part to the customer.
(Do not reuse.)

Safety: General

- Be careful not to damage the vehicle or the parts.
- The illustrations may differ slightly from the actual accessory.



Safety: Accessory

- Always use the parts and tools specified in the installation instructions.
- Do not install the accessory on a dirty surface or in direct sunlight.
- Make sure the ambient air temperature is 60°F (15°C) or above when installing accessories that use adhesive material.
- When pressing the accessory firmly with the palm of your hand, be careful not to damage it or the vehicle.
- When applying adhesive material, make sure it is lined up properly before attaching. Once the adhesive material touches the surface, do not try to remove it. If you do, you could damage the part.
- Do not wash the vehicle for 24 hours to allow the adhesive to cure.

Germain Honda of College Hills

PARTS LIST

Front Fender Trims Kit (P/N 08F59-30A-100)

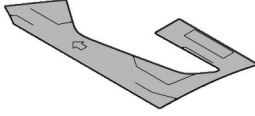
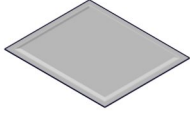
Left front fender trim	Right front fender trim	Template	Alcohol wipes (2)
			

REQUIRED TOOLS AND SUPPLIES

Masking tape

The following tool is available through the Honda Tool and Equipment Program:

Rubber Roller (T/N MHLE54D)

Germain Honda of College Hills

INSTALLATION

1. Secure the template.

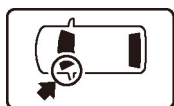

Line up with the edge of the left front fender.

LEFT FRONT FENDER

TEMPLATE

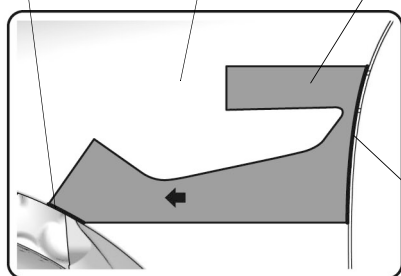

Line up with the edge of the left front fender.

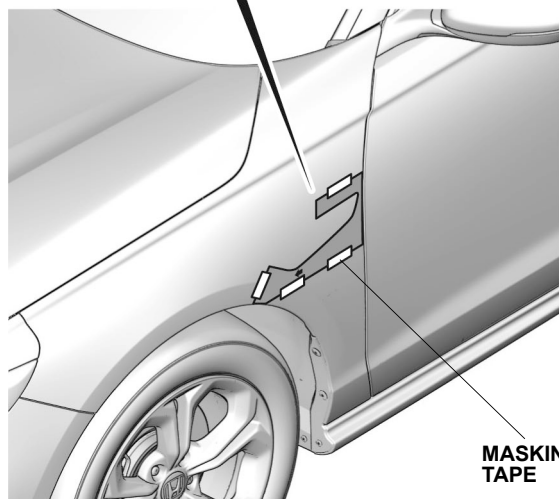

MASKING TAPE

QM30102AB

2. Clean the attaching area.

NOTE

Allow to dry thoroughly.

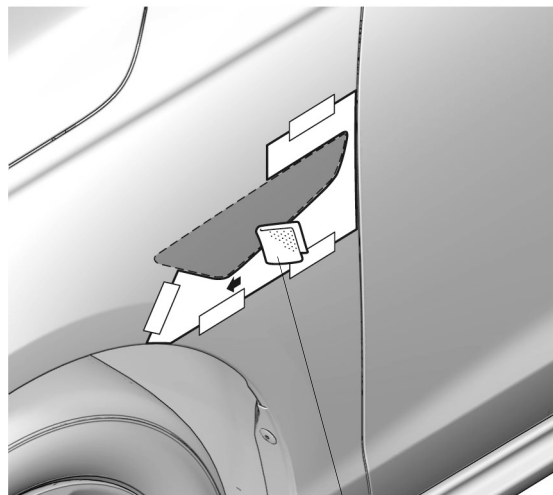

ALCOHOL WIPE

QM30103AB

3. Temporarily attach the adhesive backings.

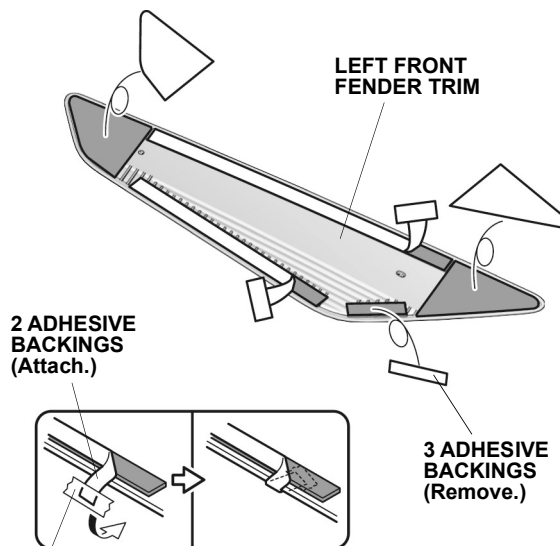

LEFT FRONT FENDER TRIM

2 ADHESIVE BACKINGS (Attach.)

3 ADHESIVE BACKINGS (Remove.)

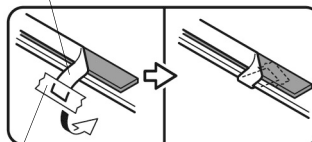

MASKING TAPE

QM30104AB

4. Remove the adhesive backings.

Germain Honda of College Hills

5. Line up the left front fender trim.

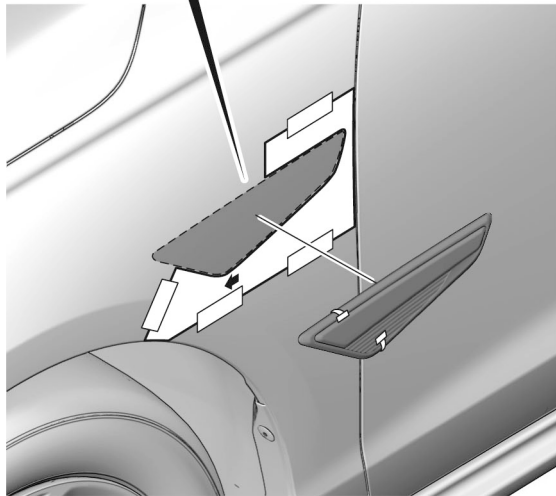
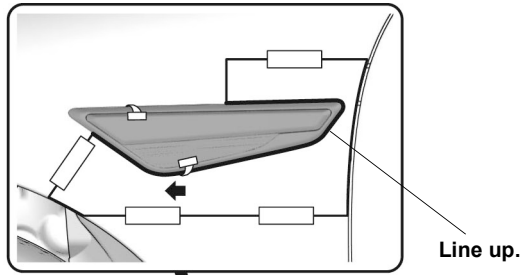

6. Secure the left front fender trim.

NOTE

Check the position of the double-sided adhesive tapes and make sure to press firmly.

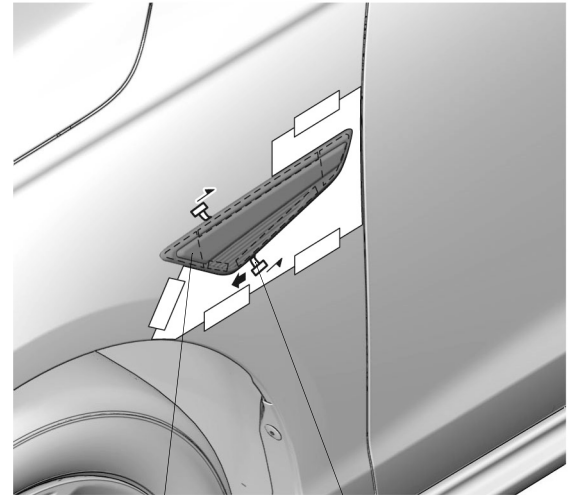

7. Secure the left front fender trim.

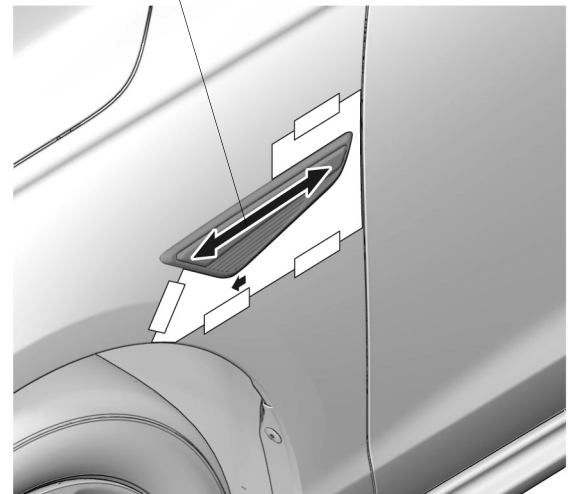

8. Remove the template.

Germain Honda of College Hills

9. Flip the template, and repeat the same procedures on the other side.

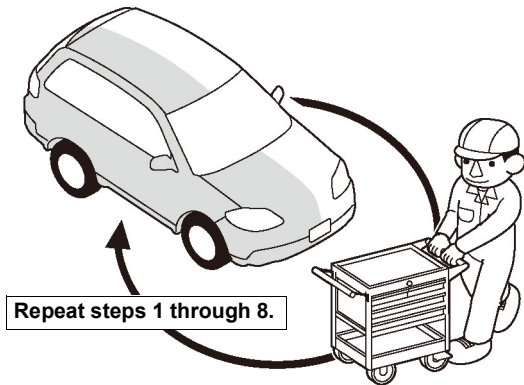

Q9D1012AE

10. Check that all parts are installed properly.