

# Germain Honda of College Hills



## INSTALLATION INSTRUCTIONS

Accessory  
**DOOR EDGE FILMS**

Application  
**2023 ACCORD  
MODEL SERIES**

Publications No.  
**VERSION 1**  
Issue Date  
**DEC 2022**

## GENERAL VIEW

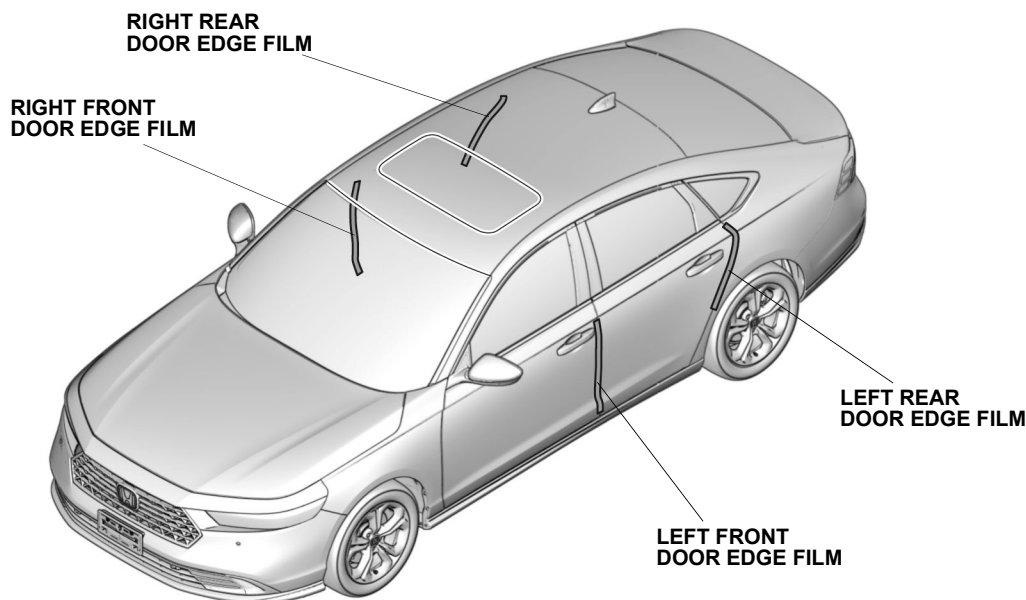

QM31101AN

## FOR YOUR SAFETY (Read carefully.)

### Warning Symbols

Safety: Your safety, and the safety of others, is important. To help you make informed decisions about service procedures, we have provided safety messages where appropriate. Of course, it is not practical or possible to warn you about all the hazards associated with servicing a vehicle - you must use your own good judgment.

You will find important safety messages preceded by one of the following symbols:

\*All symbols are not used in all installation instructions.

**⚠ DANGER**

You will be killed or seriously hurt if you do not follow the instructions.

**⚠ WARNING**

You can be killed or seriously hurt if you do not follow the instructions.

**⚠ CAUTION**

You can be hurt if you do not follow the instructions.

**NOTICE**

Gives advice to prevent damage to the product, vehicle, the environment or other property.

**NOTE**

Gives helpful information or instructions to be followed when installing this product.



Indicates a prohibited action.

# Germain Honda of College Hills

## Procedure and Location Icons

These icons indicate the work location and the worker's point of view.

\*All icons are not used in all installation instructions.



The location on the vehicle.



The location in the vehicle.  
(Instrument panel.)



Wear eye protection.



Wear heavy gloves.



Use an assistant.



Place the part on a blanket.



Work perpendicular.



Remove any burrs.



Use touch-up paint and allow to dry.



Tighten to the specified torque.



Apply firm pressure while rolling, especially at the ends, to set the adhesive.



Press firmly.



Clean with isopropyl alcohol.



Return the original part to the customer.  
(Do not reuse.)

## Safety: General

- Be careful not to damage the vehicle or the parts.
- The illustrations may differ slightly from the actual accessory.

## Safety: Accessory

- Always use the parts and tools specified in the installation instructions.
- Do not install the accessory on a dirty surface or in direct sunlight.
- Make sure the ambient air temperature is 60°F (15°C) or above when installing accessories that use adhesive material.
- When applying adhesive material, make sure it is lined up properly before attaching. Once the adhesive material touches the surface, do not try to remove it. If you do, you could damage the part.
- Cover nearby parts with a shop towel to prevent getting them wet.
- Always wear gloves when working with 3M protective tape application solution.
- Use 3M protective tape application solution with a spray bottle.
- Do not wash the vehicle for 24 hours to allow the adhesive to cure.

# Germain Honda of College Hills

## PARTS LIST

Door Edge Films Kit (P/N 08P20-30A-100A)

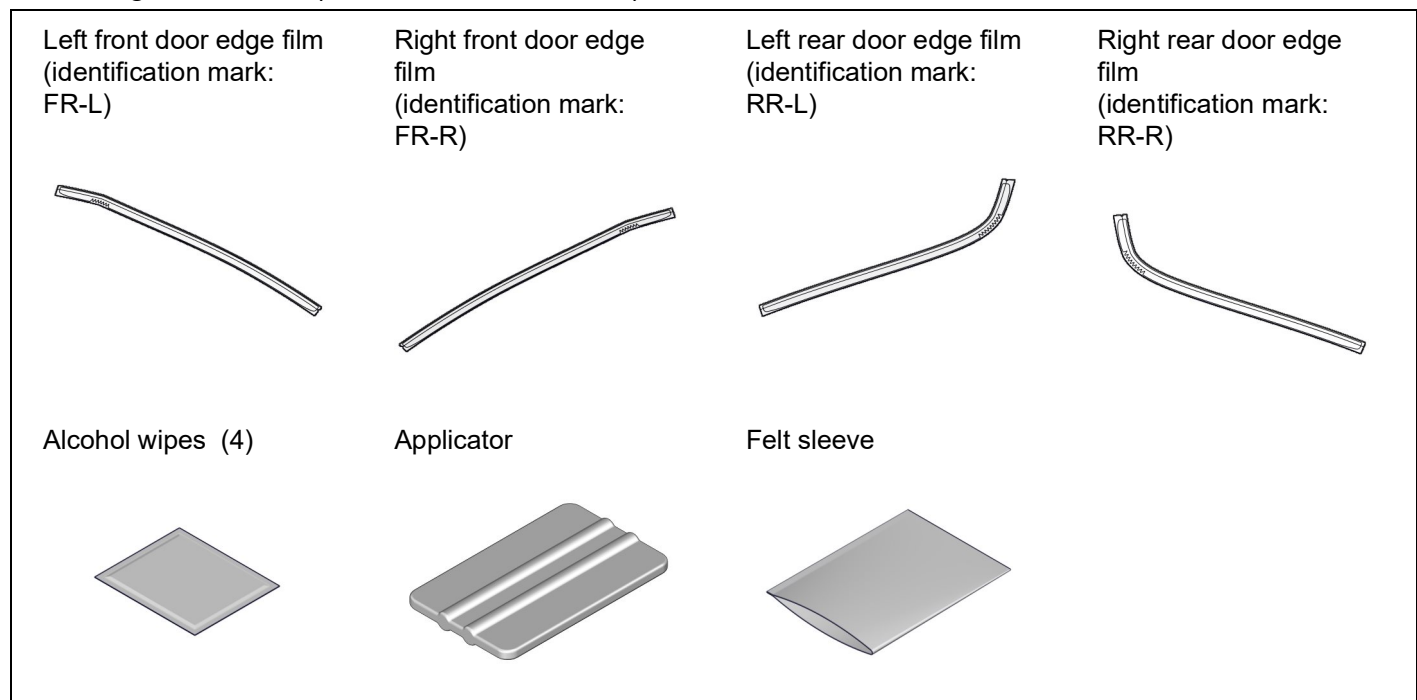

## REQUIRED TOOLS AND SUPPLIES

- Shop towel
- 3M Protective tape application solution
- Gloves
- Ruler

# Germain Honda of College Hills

## INSTALLATION

1. Clean the attaching area.

### NOTE

Allow to dry thoroughly.

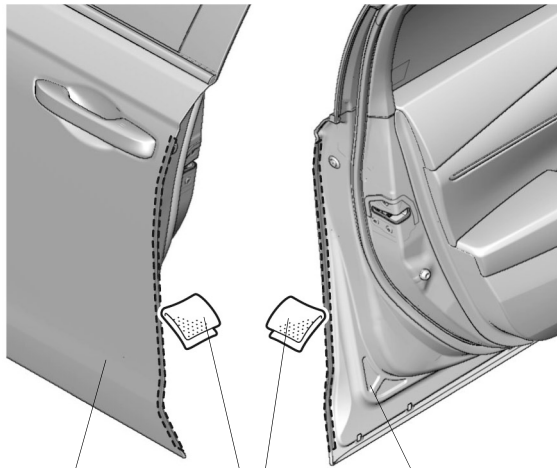
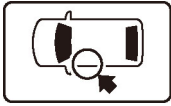

LEFT FRONT DOOR  
(outside)

ALCOHOL  
WIPE

LEFT FRONT DOOR  
(inside)

QM31401AN

2. Spray the left front door.

### NOTE

Spray the outer surface of the door only.

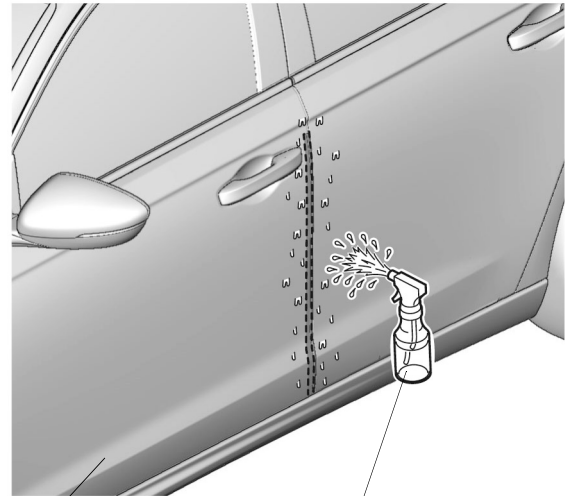
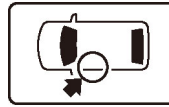

LEFT FRONT  
DOOR

3M PROTECTIVE TAPE  
APPLICATION SOLUTION

QM31402AN

# Germain Honda of College Hills

## 3. Attach the left front door edge film.

### NOTE

Make sure to check the identification mark before installation.

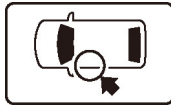

LEFT FRONT  
DOOR

END OF THE  
CURVED SURFACE

TOP EDGE OF  
THE LEFT FRONT  
DOOR EDGE FILM

15 mm  
(0.59 in.)

MARK  
(Line up with the  
edge of the left front door.)

LEFT FRONT  
DOOR EDGE  
FILM  
(identification  
mark: FR-L)

ADHESIVE  
BACKING  
(Remove.)

QM31403AN

## 4. Secure the left front door edge film.

### NOTE

- Move the felt sleeve in one direction only.
- Make sure that there are no air bubbles.

FELT SLEEVE  
APPLICATOR

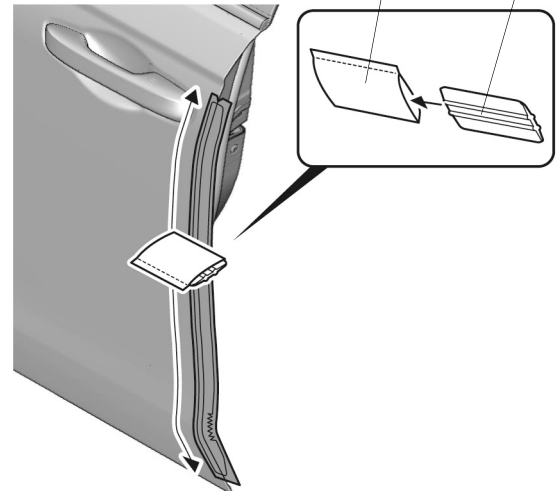

QM31404AN

## 5. Remove the protective film.

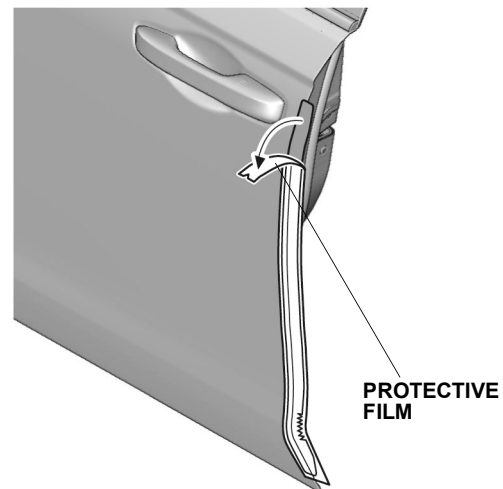

QM31405AN

# Germain Honda of College Hills

6. Secure the left front door edge film.

## NOTE

- Do not trim or damage the seam sealant.
- Make sure to prevent air from entering.

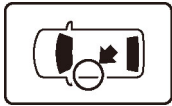

LEFT FRONT DOOR  
EDGE FILM

LEFT FRONT DOOR

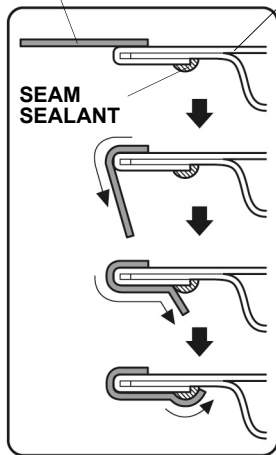

SECTION VIEW

LEFT FRONT DOOR  
(inside)

QM31406AN

7. Wipe off the 3M protective tape application solution.

## NOTE

Allow to dry thoroughly.

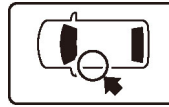

SHOP TOWEL

LEFT FRONT DOOR  
(outside)

QM31407AN

# Germain Honda of College Hills

8. Clean the attaching area.

## NOTE

Allow to dry thoroughly.

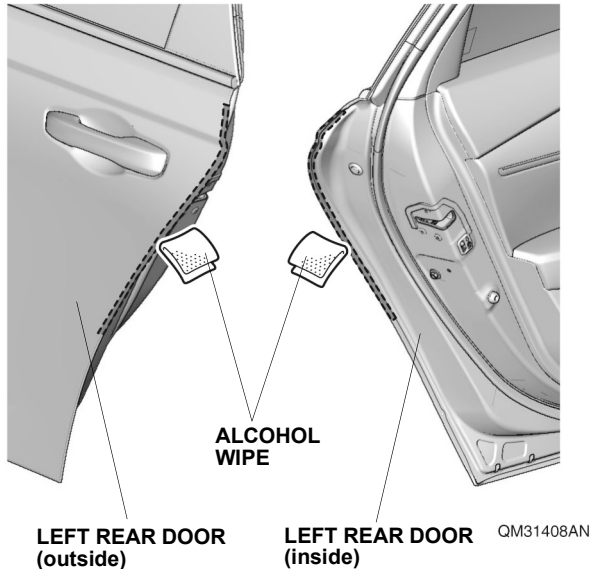
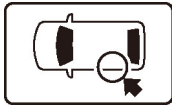

9. Spray the left rear door.

## NOTE

Spray the outer surface of the door only.

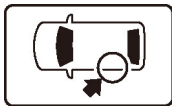

LEFT REAR DOOR



3M PROTECTIVE TAPE  
APPLICATION SOLUTION

QM31409AN

10. Attach the left rear door edge film.

## NOTE

Make sure to check the identification mark before installation.

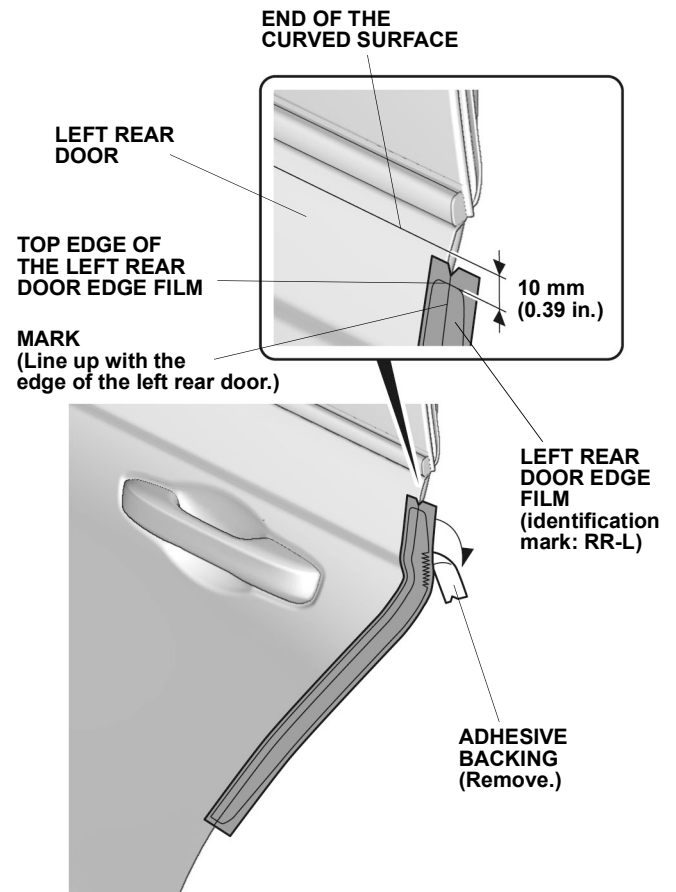
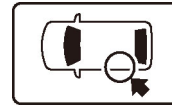

QM31410AN

# Germain Honda of College Hills

11. Secure the left rear door edge film.

## NOTE

- Move the felt sleeve in one direction only.
- Make sure that there are no air bubbles.

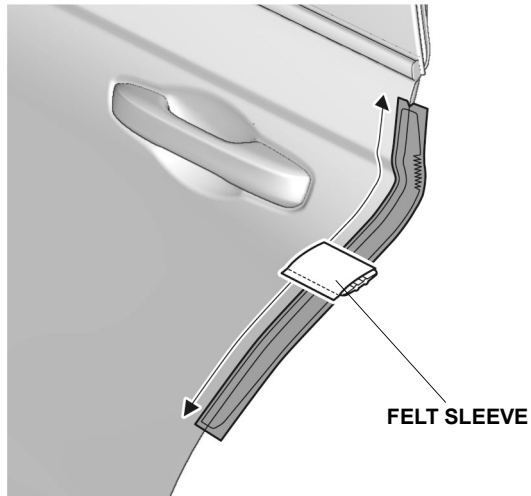

QM31411AN

12. Remove the protective film.

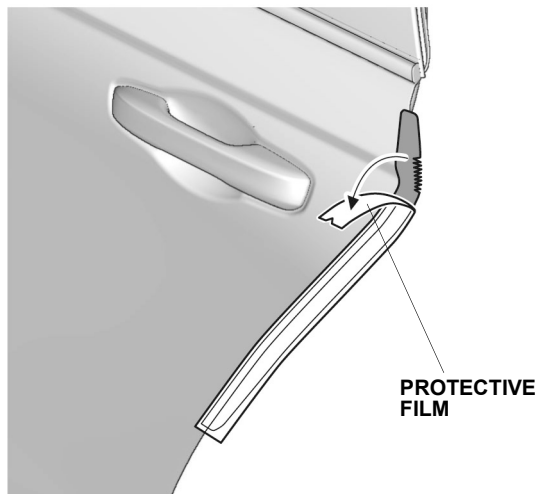

QM31412AN

13. Secure the left rear door edge film.

## NOTE

- Do not trim or damage the seam sealant.
- Make sure to prevent air from entering.

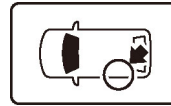

LEFT REAR DOOR  
EDGE FILM

LEFT REAR DOOR

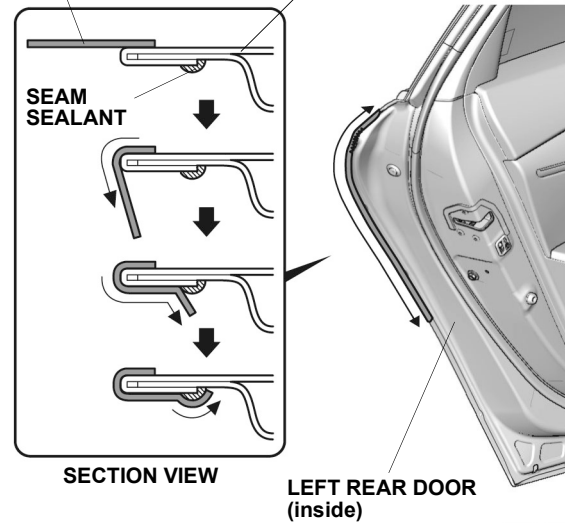

QM31413AN



# Germain Honda of College Hills

14. Wipe off the 3M protective tape application solution.

NOTE
Allow to dry thoroughly.

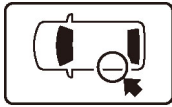

LEFT REAR DOOR  
(outside)

QM31414AN

15. Repeat the same procedures on the other side.

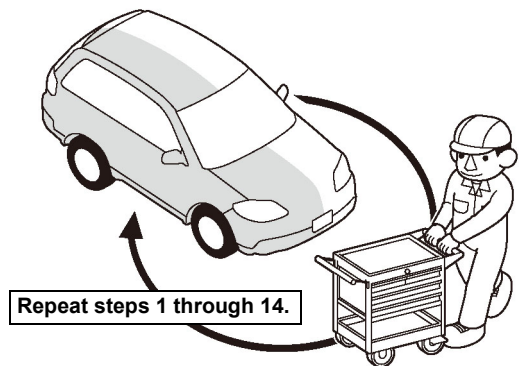

Q9D1014AM

16. Check that all parts are installed properly.