

Germain Honda of College Hills



HONDA INSTALLATION INSTRUCTIONS

Accessory

WIRELESS CHARGER
P/N 08U58-TVA-100A

Application

2022 ACCORD
2022 ACCORD HYBRID

Publications No.

VERSION 1

Issue Date

OCT 2021

PARTS LIST

Wireless charger unit

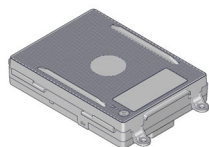

Wireless charger harness

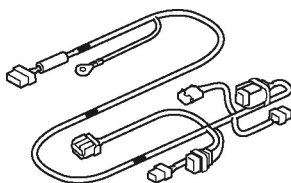

Center pocket

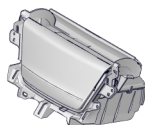

10 Wire ties



Wire tie with clip A



Wire tie with clip B



Fuse label A

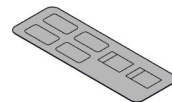

Fuse label B
(May not be used)

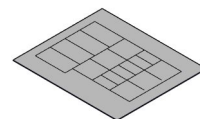

20A Fuse
(May not be used)

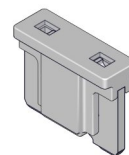

4 Self-tapping screws



Aluminum tape

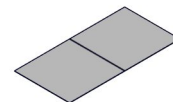

Germain Honda of College Hills

TOOLS AND SUPPLIES REQUIRED

Phillips screwdriver
Isopropyl alcohol
Shop towel
Diagonal cutters
10 mm Open end wrench
Masking tape
Ratchet
10 mm Socket
Scissors

The following tools are available through the Honda Tool and Equipment Program. On the iN, click on Service > Service Bay > Tool and Equipment Program, then enter the number under "Search." Or, call 888-424-6857.

- Trim Tool Set (T/N SOJATP2014)
- Plastic Trim Tool (T/N SILTRIMTL10)

Illustration of the Wireless Charger in the Vehicle

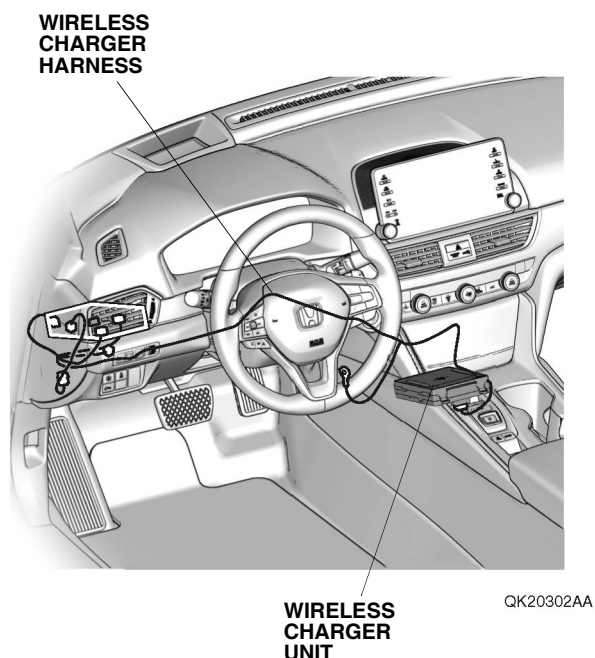

INSTALLATION

Customer Information: The information in this installation instruction is intended for use only by skilled technicians who have the proper tools, equipment, and training to correctly and safely add equipment to your vehicle. These procedures should not be attempted by "do-it-yourselfers."

1. Lower and pull out the steering wheel as shown.

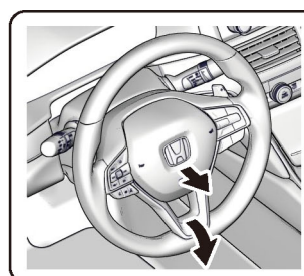

MASKING TAPE

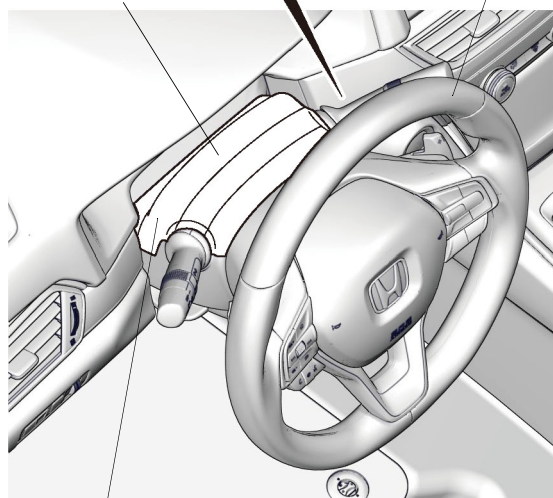

2. Apply masking tape to the upper column cover.

Germain Honda of College Hills

3. Turn the steering wheel 90° counterclockwise. Using a plastic trim tool, release the upper column cover.

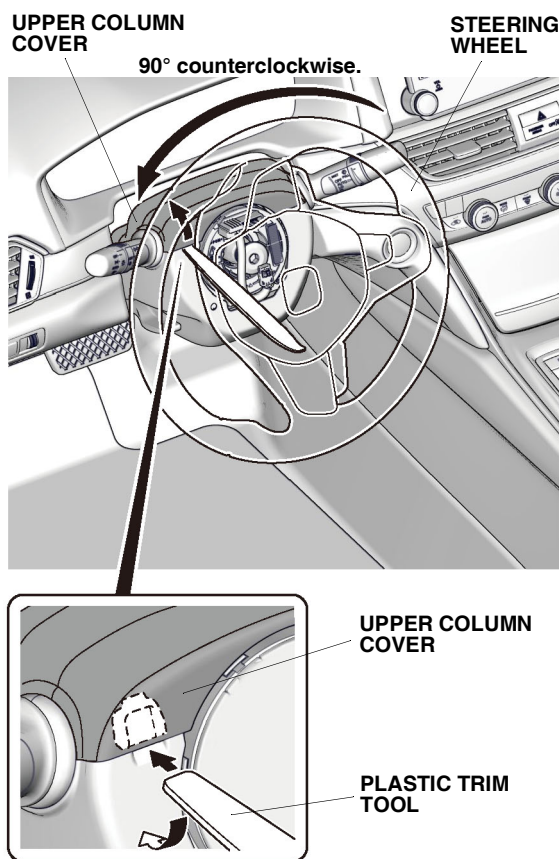

QG13106AB

4. Turn the steering wheel 180° clockwise. Using a plastic trim tool, release the upper column cover.

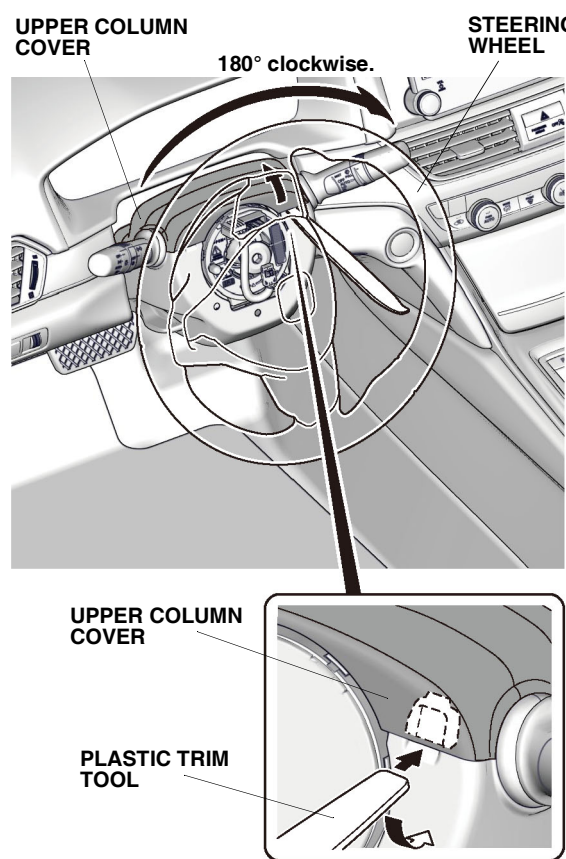

QG13107AB

5. Release the upper column cover and secure it to the dashboard with masking tape.

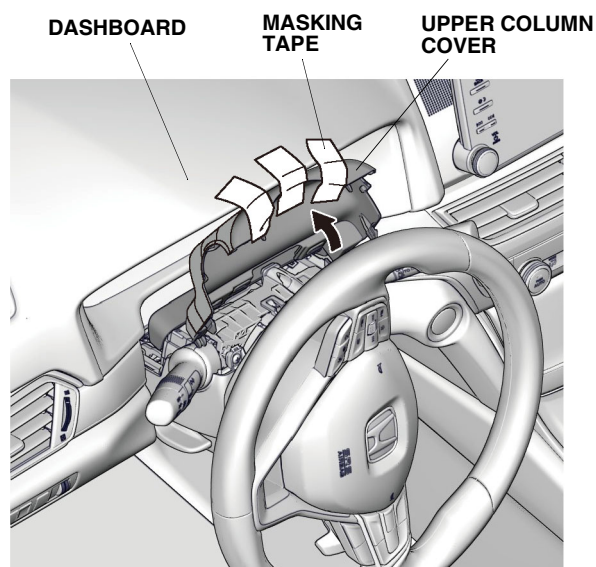

QG13108AB

Germain Honda of College Hills

6. Remove the self-tapping screw from the lower column cover.

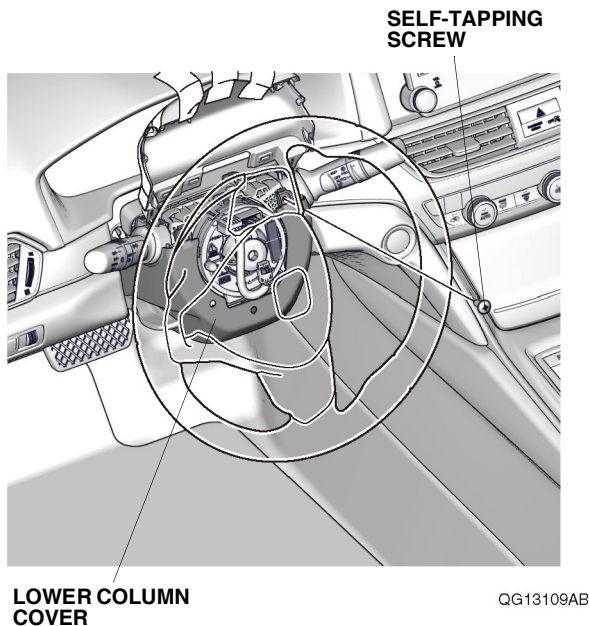

7. Turn the steering wheel 180° counterclockwise, and remove the other self-tapping screw from the lower column cover.

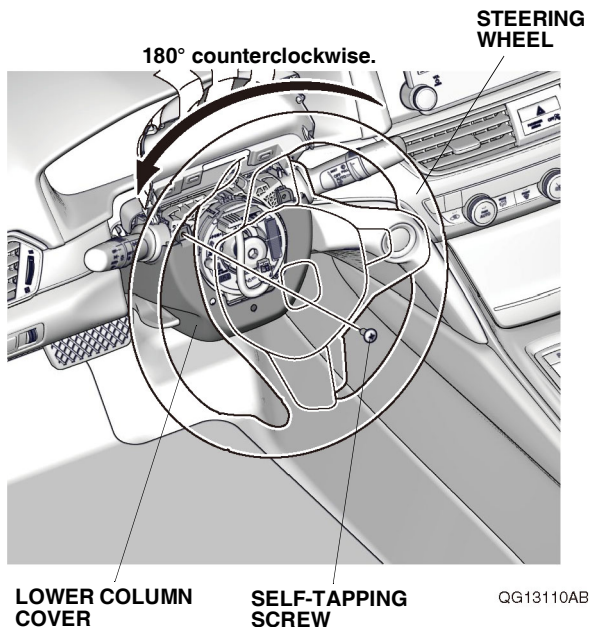

8. Disconnect the negative cable from the battery, then wait at least 3 minutes before starting work.

9. Pull away the door opening seal and remove the passenger's dashboard side lid.

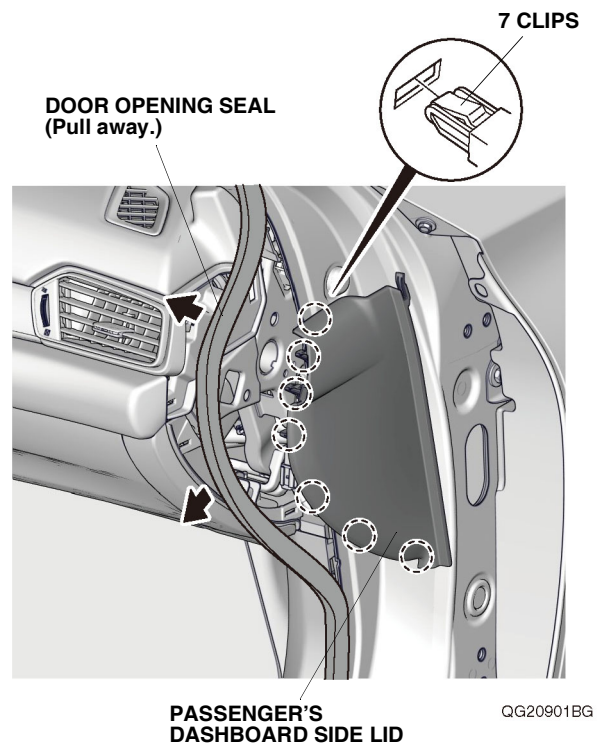

10. Open the glove box and remove the passenger's trim panel. Close the glove box.

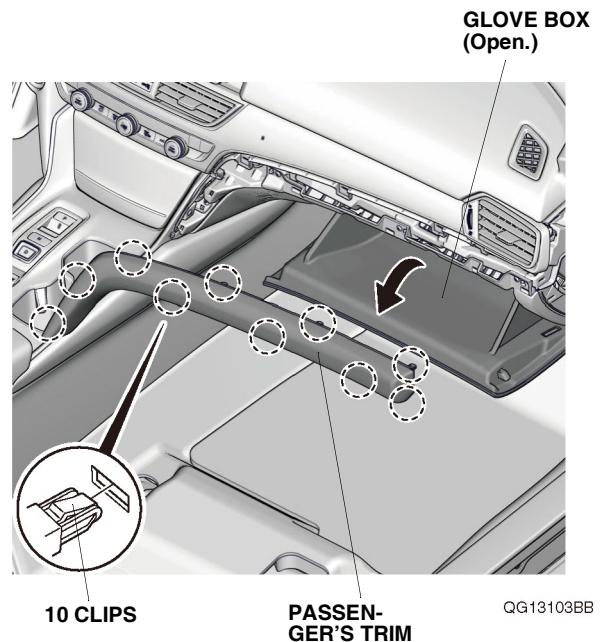

Germain Honda of College Hills

11. Remove the passenger's outlet.

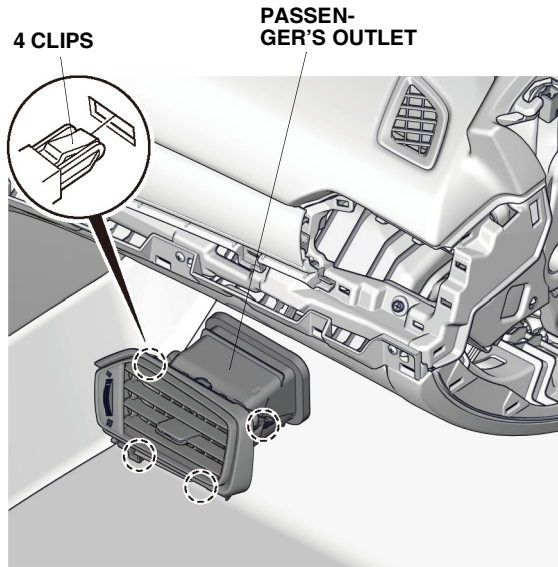

QG20902AG

12. Remove the right console side cover.

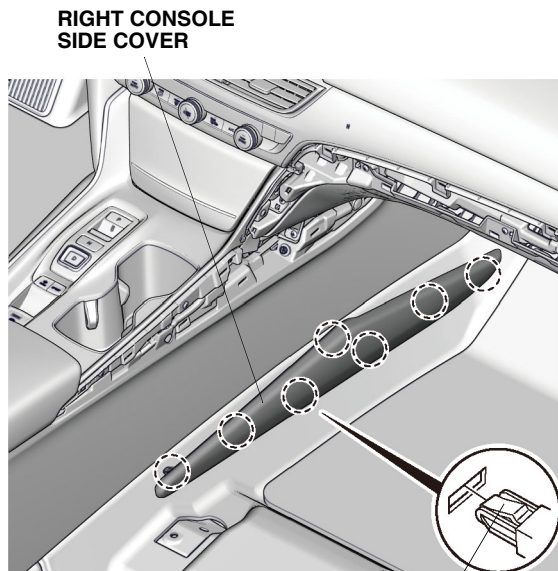

QG30901AB

13. Remove the driver's dashboard lower cover and unplug the vehicle connectors.

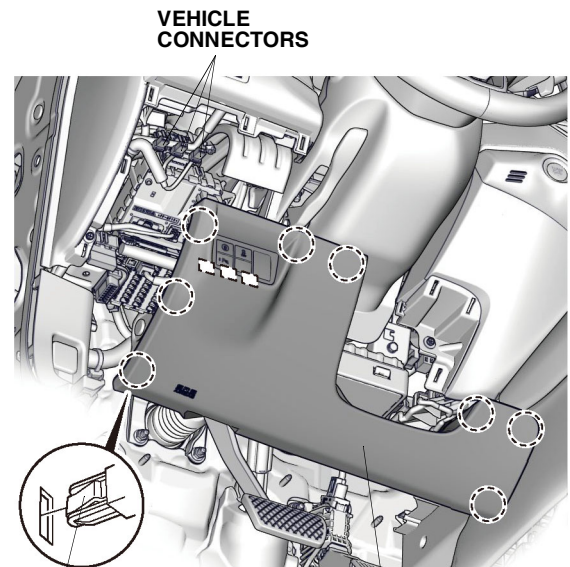

QG13104AB

14. Remove the driver's door sill trim.

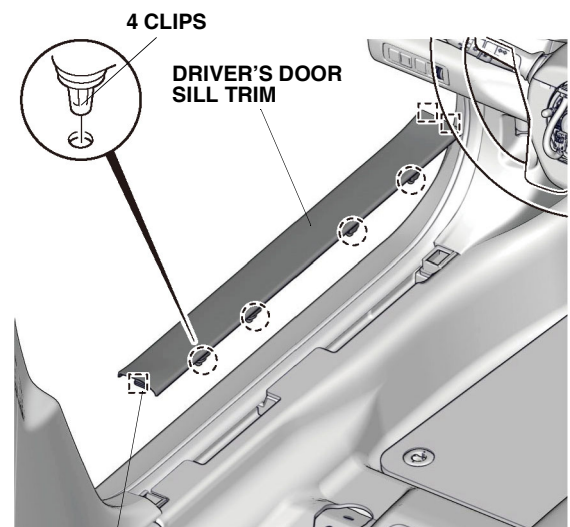

QG20207BG

Germain Honda of College Hills

15. Pull away the door opening seal and remove the driver's kick panel.

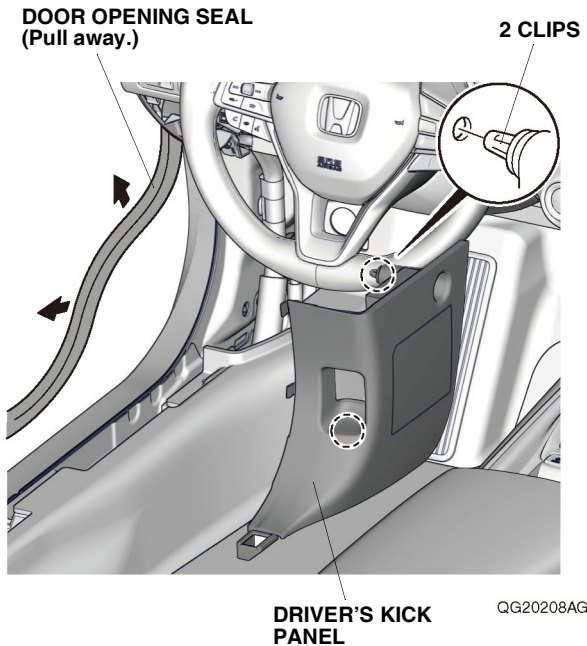

16. Remove the lower column cover.

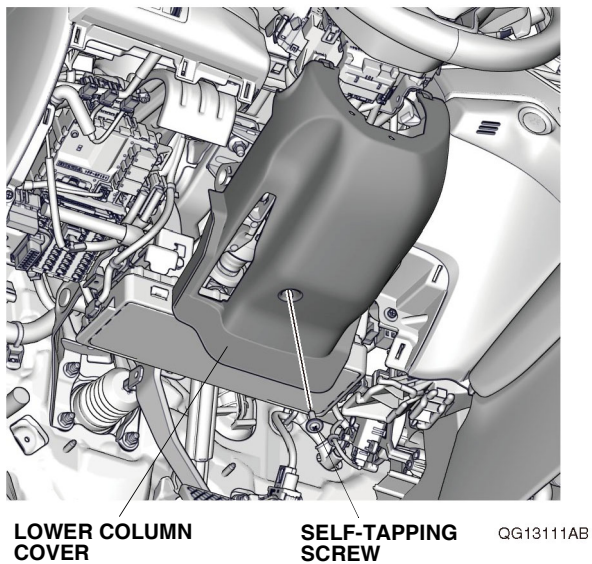

17. Remove the driver's inner dashboard trim and unplug the vehicle connector.

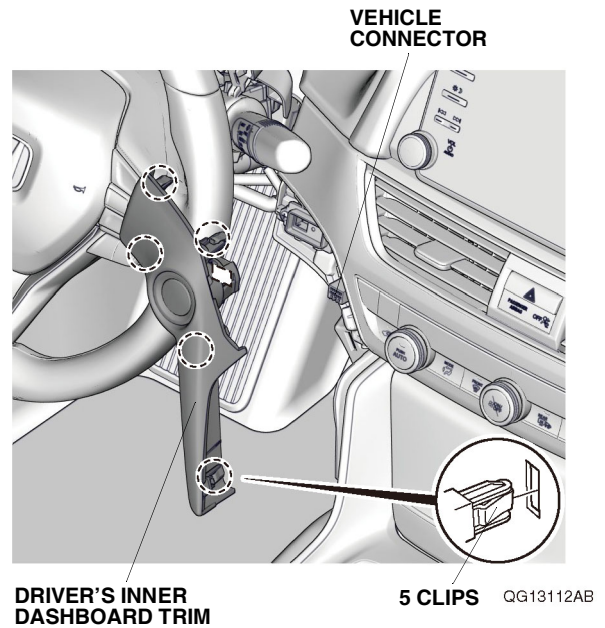

18. Remove the left console side cover.

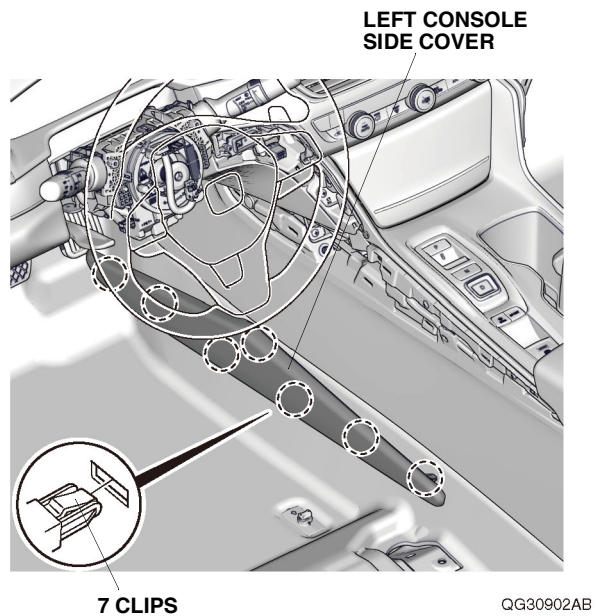

Germain Honda of College Hills

19. Remove the rear console panel, and unplug the vehicle connector (if equipped).

NOTE: Follow this procedure even if the rear console panel has a different shape.

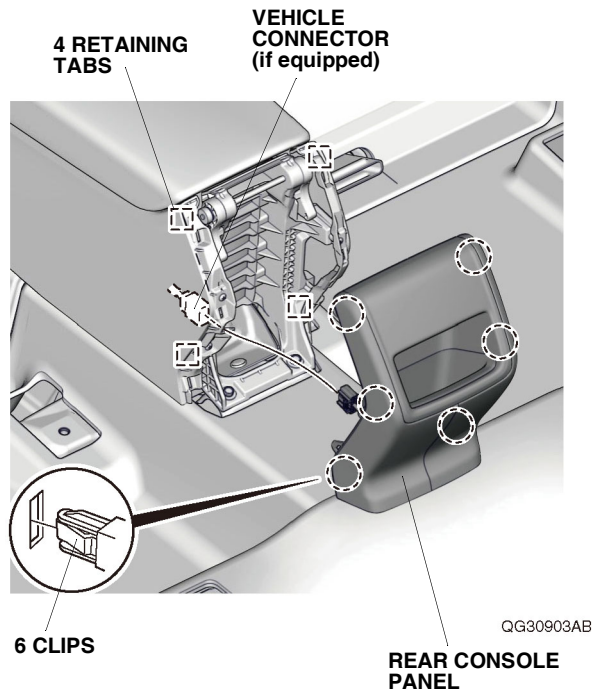

20. Open the lid, and remove the mat.

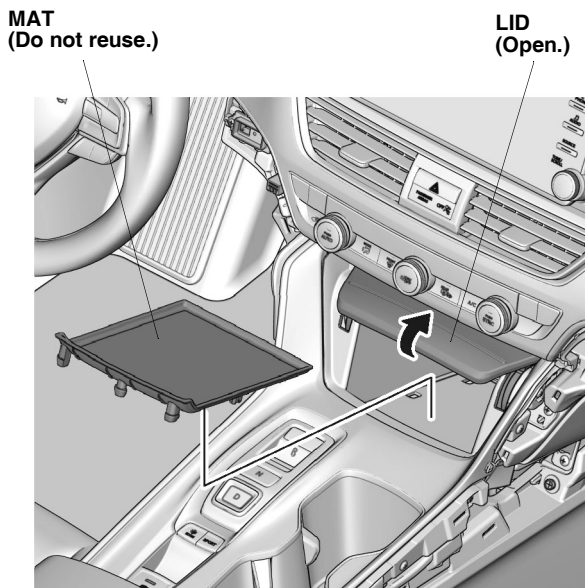

QK20413AA

21. Remove the cover.

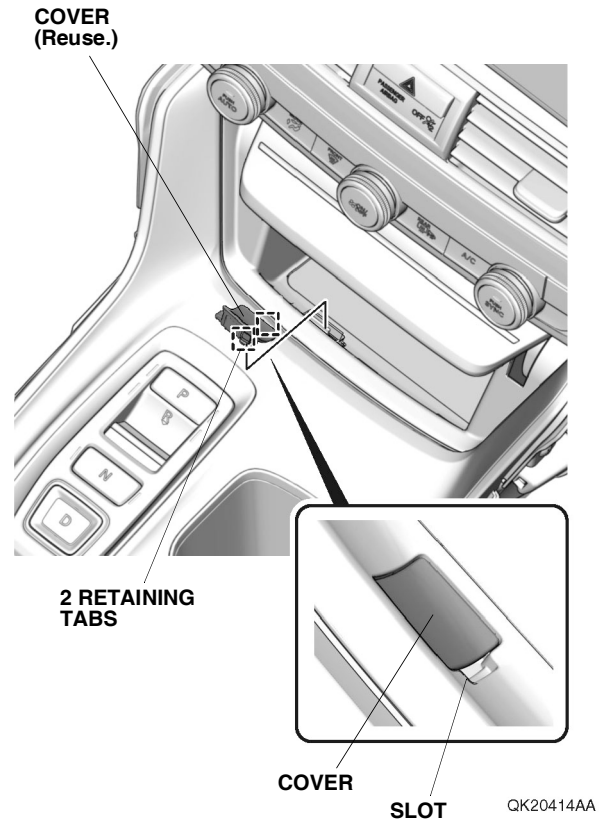

Germain Honda of College Hills

If the vehicle is equipped with shift lever, continue with step 22; otherwise, go to step 28.

With shift lever

22. Insert the key into the cover opening. Push on the key, and move the shift lever to Drive.

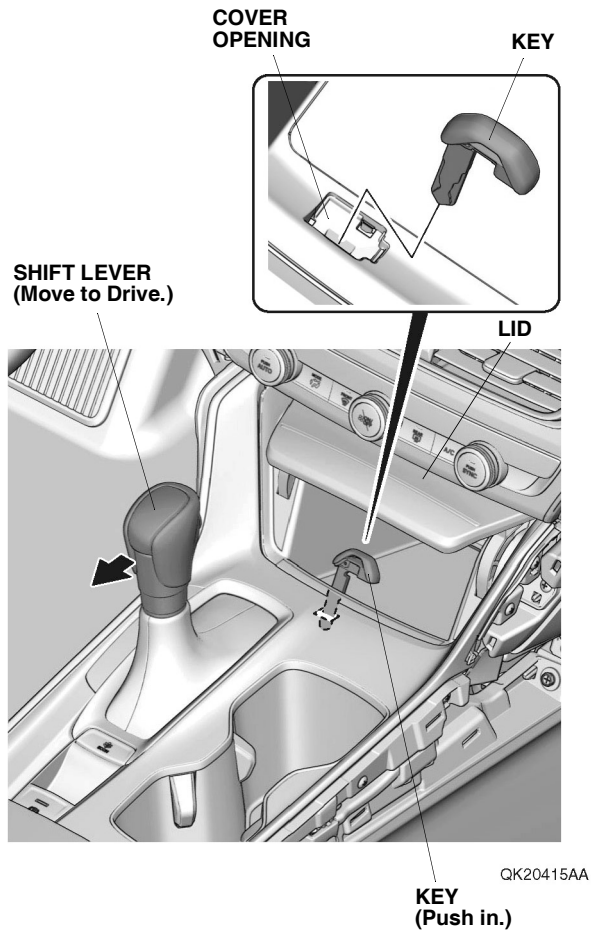

23. Remove the key, and close the lid.

24. Apply masking tape to the shift lever knob.

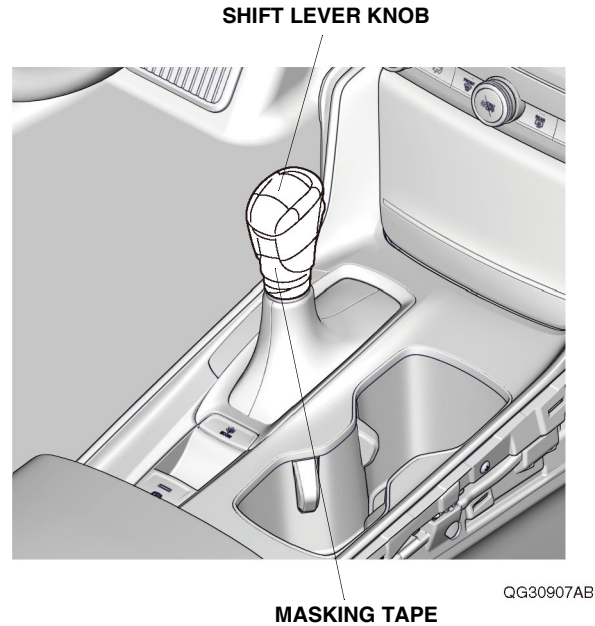

25. Remove the shift lever trim.

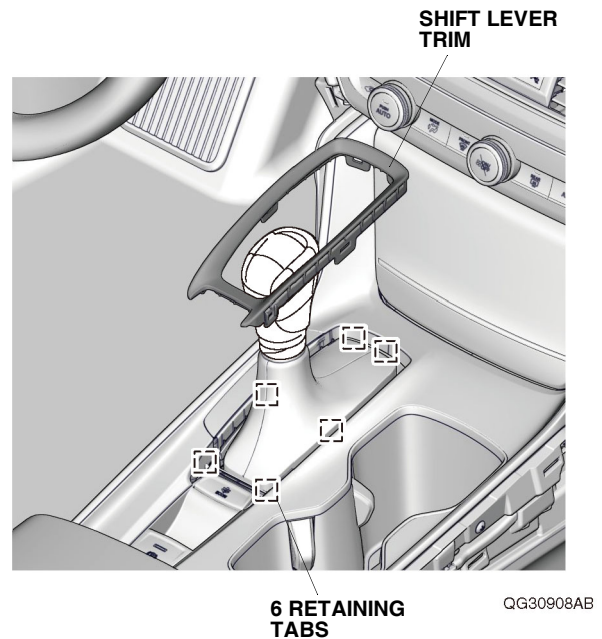

Germain Honda of College Hills

26. Release the shift boot.

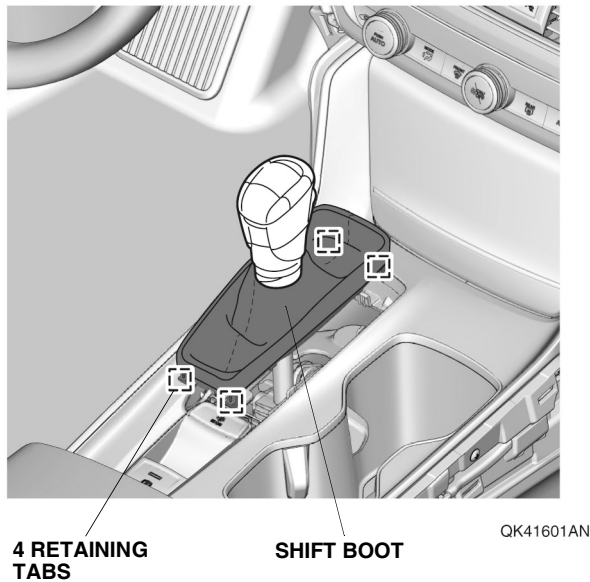

27. Open the armrest. Remove the console panel, and unplug the vehicle connectors. Go to step 29.

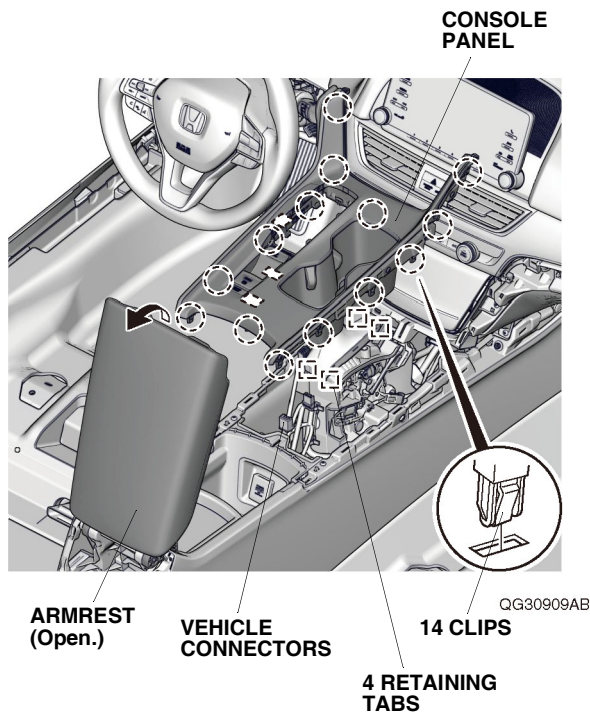

Without shift lever

28. Close the lid, and open the armrest. Remove the console panel, and unplug the vehicle connectors.

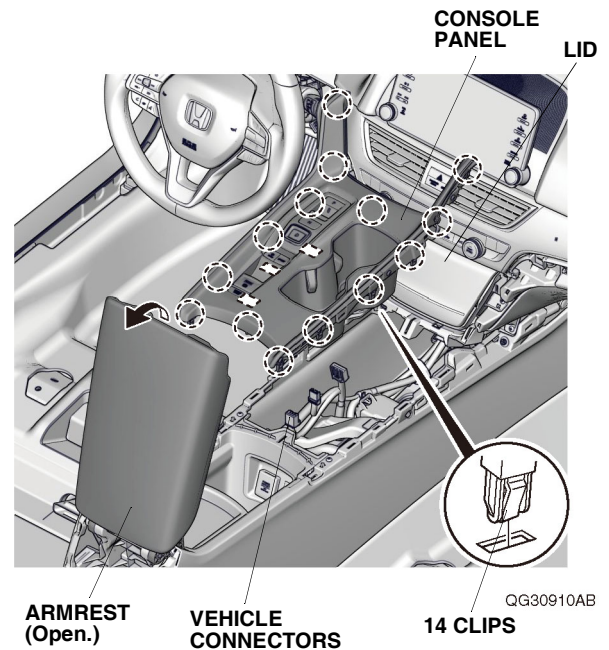

Germain Honda of College Hills

29. Remove the dashboard center trim and unplug the vehicle connectors.

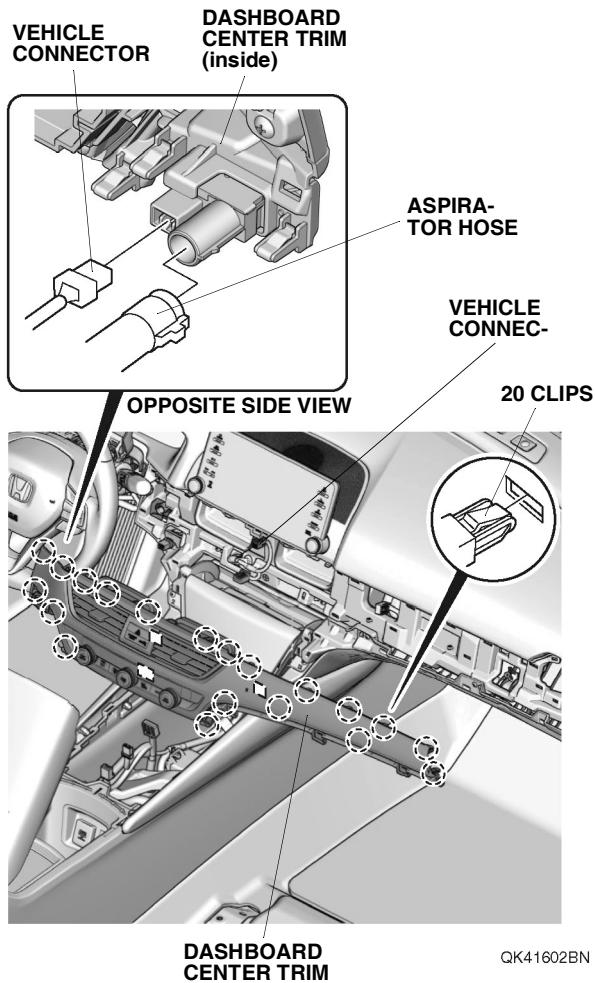

30. Remove the center pocket, and unplug the vehicle connectors.

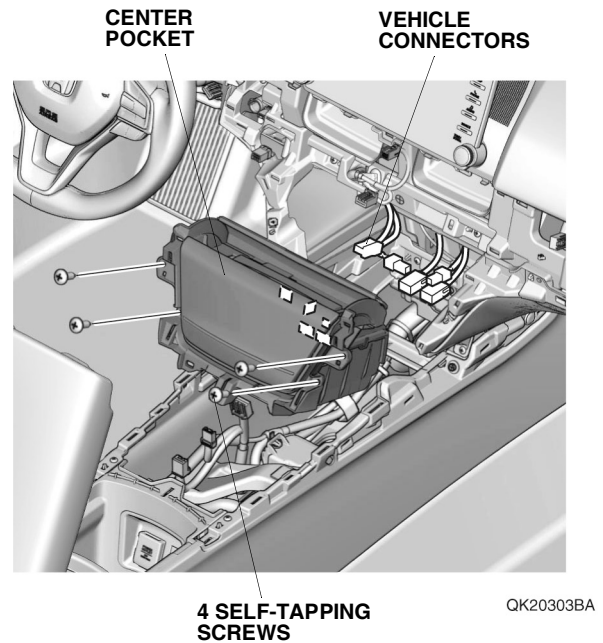

31. Remove the left side panel.

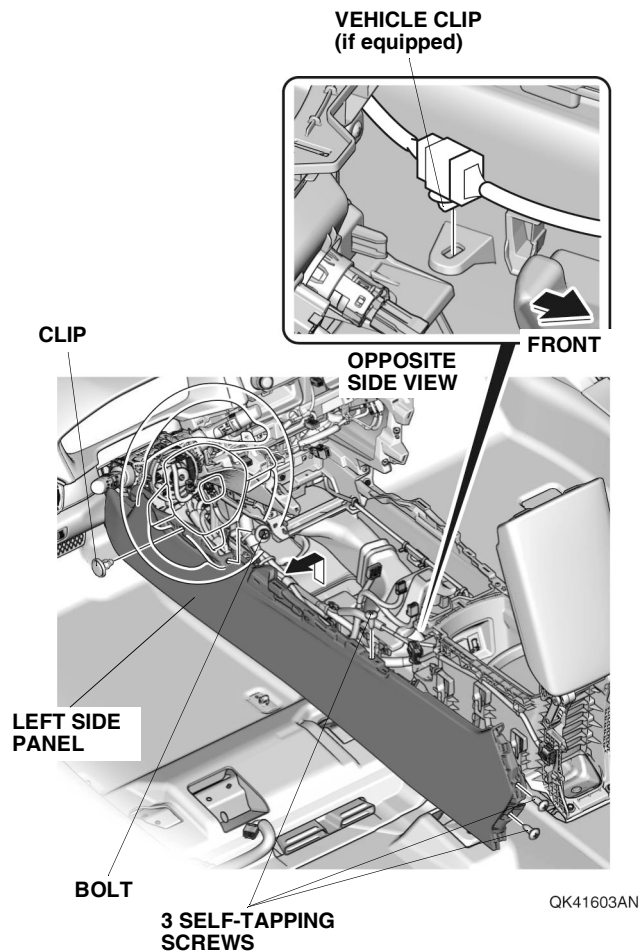

Germain Honda of College Hills

32. Remove the right side panel.

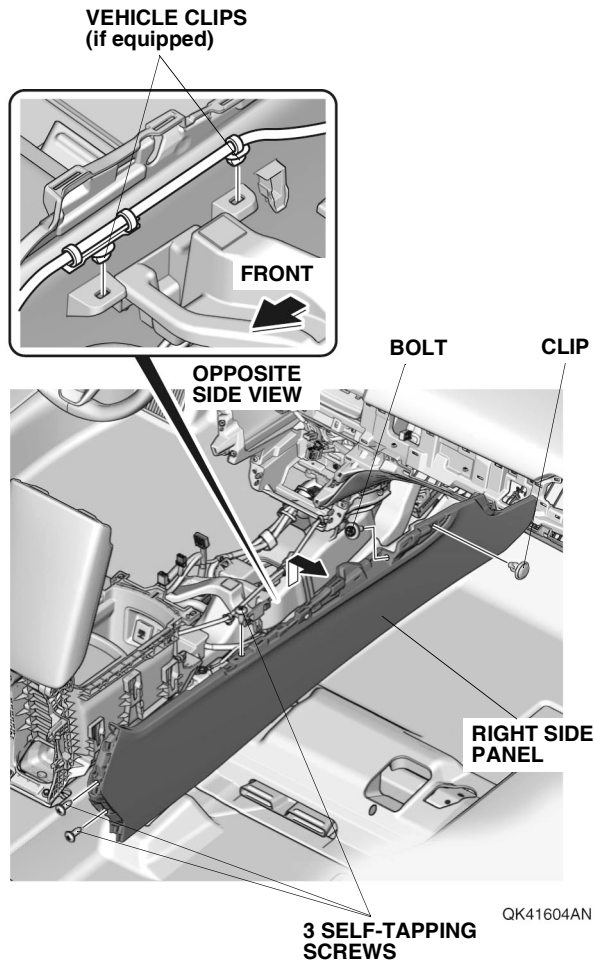

33. Using isopropyl alcohol on a shop towel, thoroughly clean the fuse case where fuse label A will attach. Attach fuse label A (5A WIRELESS CHARGER) to the fuse case on the wireless charger harness.

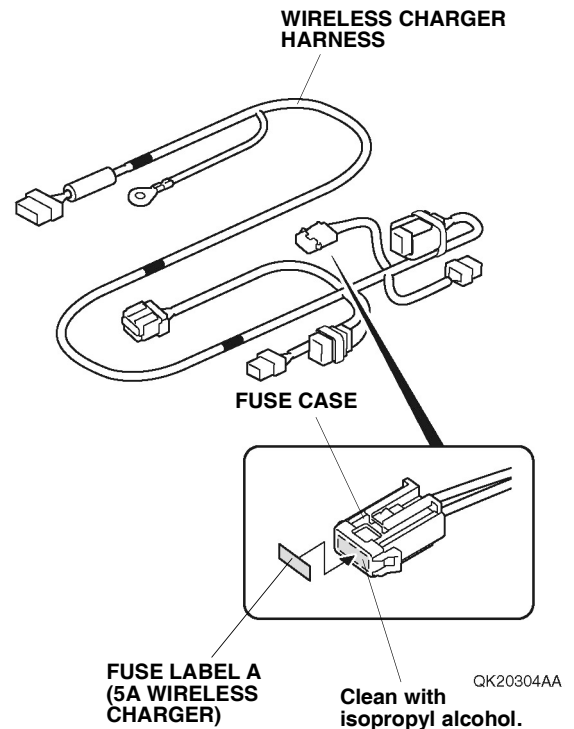

34. Line up the branch section of the wireless charger harness with the vehicle clip. Secure the wireless charger harness to the vehicle harness with two wire ties.

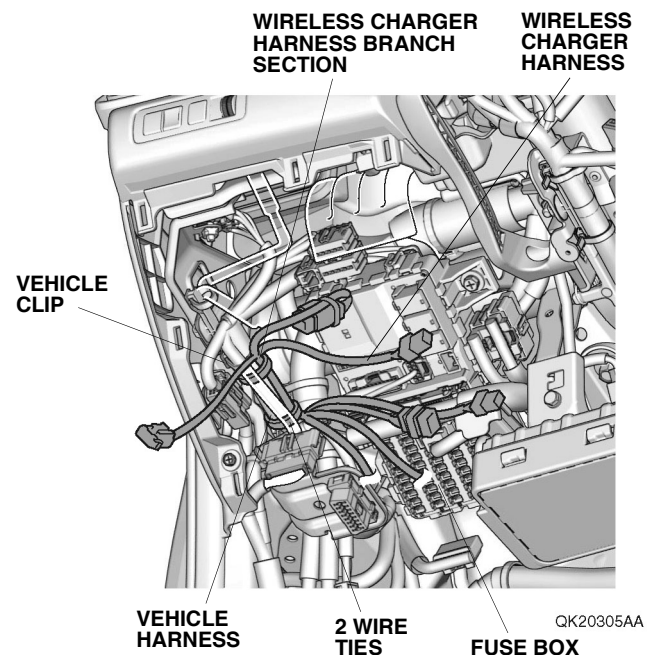

Germain Honda of College Hills

35. Secure the fuse case to the vehicle connectors.

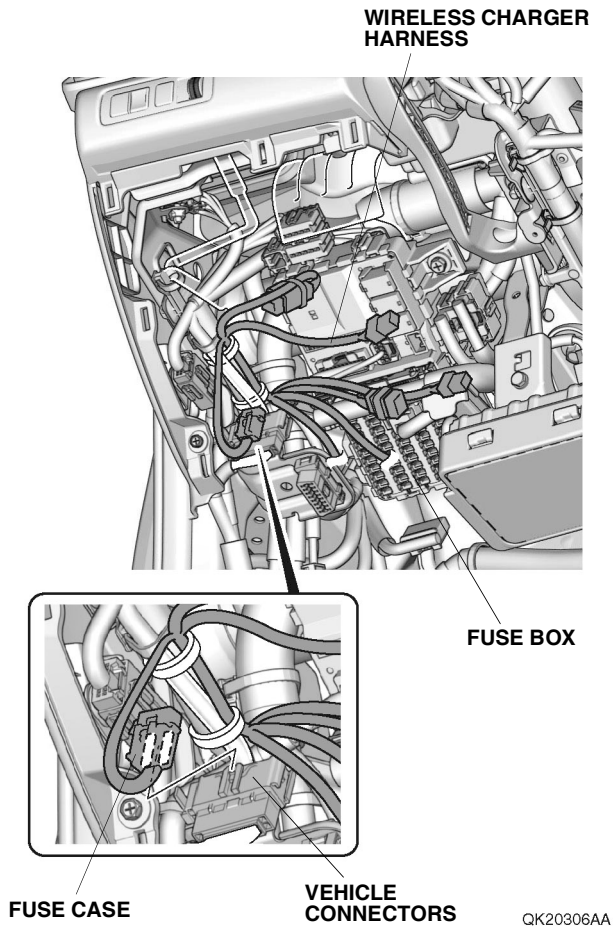

36. If the vehicle is equipped with another accessory harness, follow the plug-in order shown below.

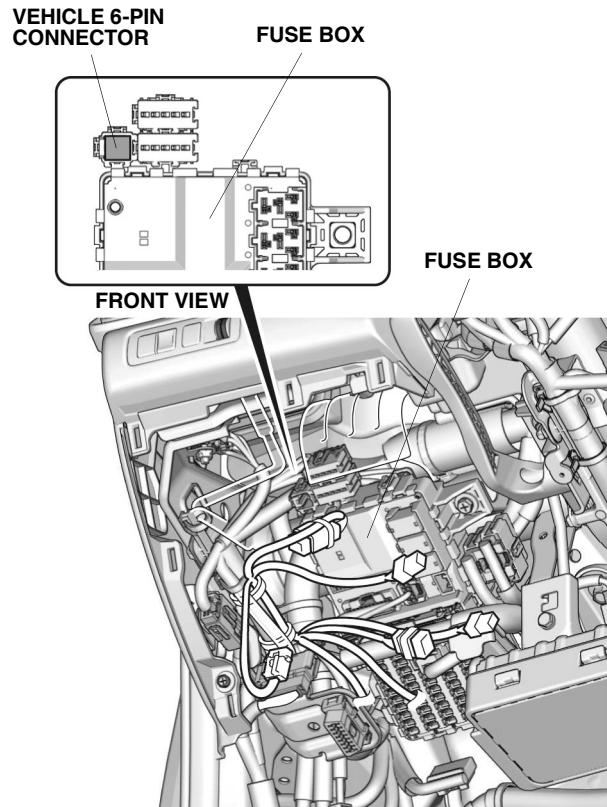

WITH OTHER ACCESSORY HARNESS
If the dummy connector is plugged, unplug it.

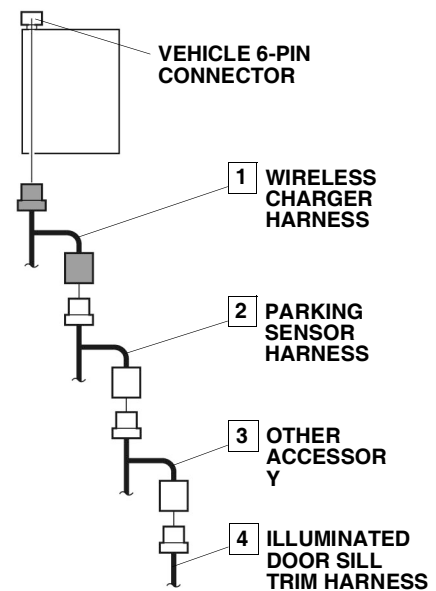

QK31901AB

Germain Honda of College Hills

If the vehicle is equipped with accessory automatic day/night mirror, go to step 39; if the vehicle is equipped with another accessory, go to step 44; otherwise, continue with step 37.

Without another accessory

37. Plug the wireless charger harness 6-pin connector into the vehicle 6-pin connector.

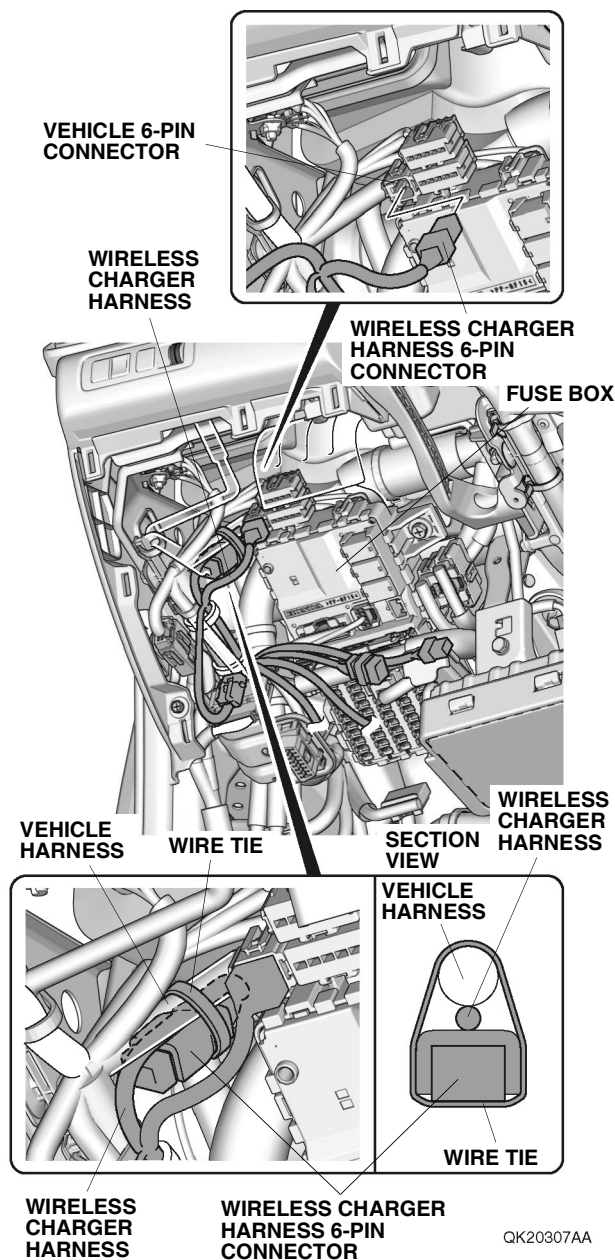

38. Secure the wireless charger harness 6-pin connector to the vehicle harness with one wire tie as shown. Go to step 47.

With accessory automatic day/night mirror

39. Cut off the wire tie from the accessory automatic day/night mirror harness.
- NOTE: Be careful not to damage the accessory automatic day/night mirror harness.

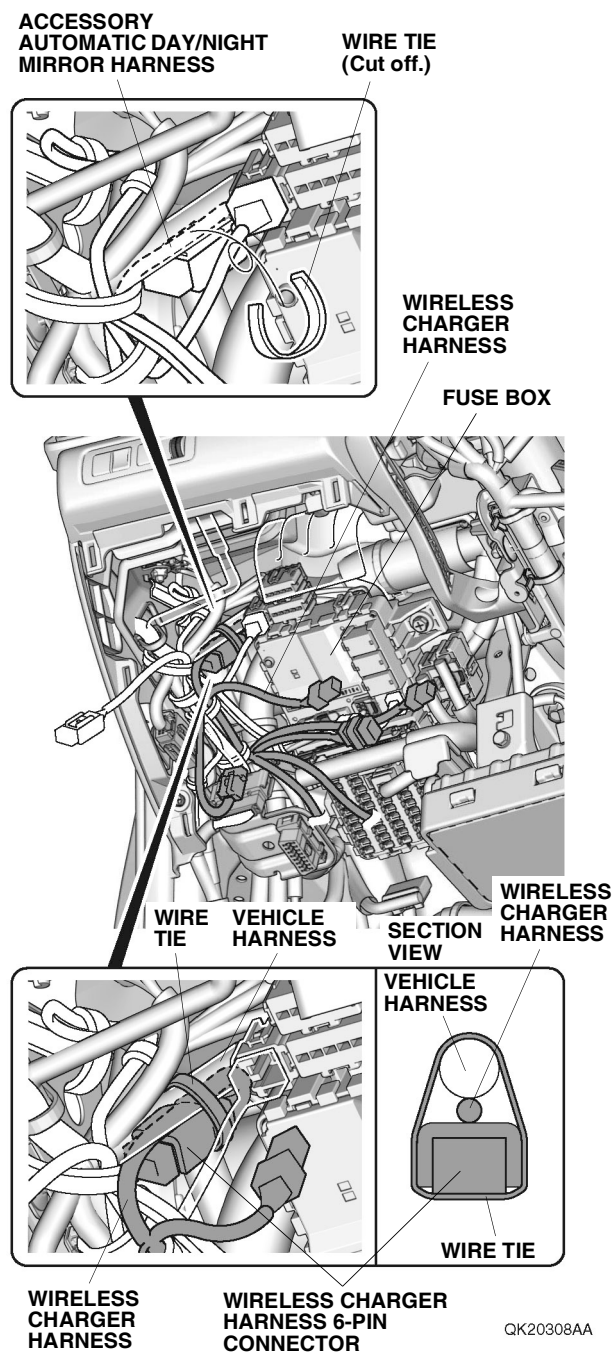

40. Secure the wireless charger harness 6-pin connector to the vehicle harness with one wire tie as shown.

Germain Honda of College Hills

41. Unplug the accessory automatic day/night mirror harness 6-pin connector, and plug the wireless charger harness 6-pin connector into the vehicle 6-pin connector.

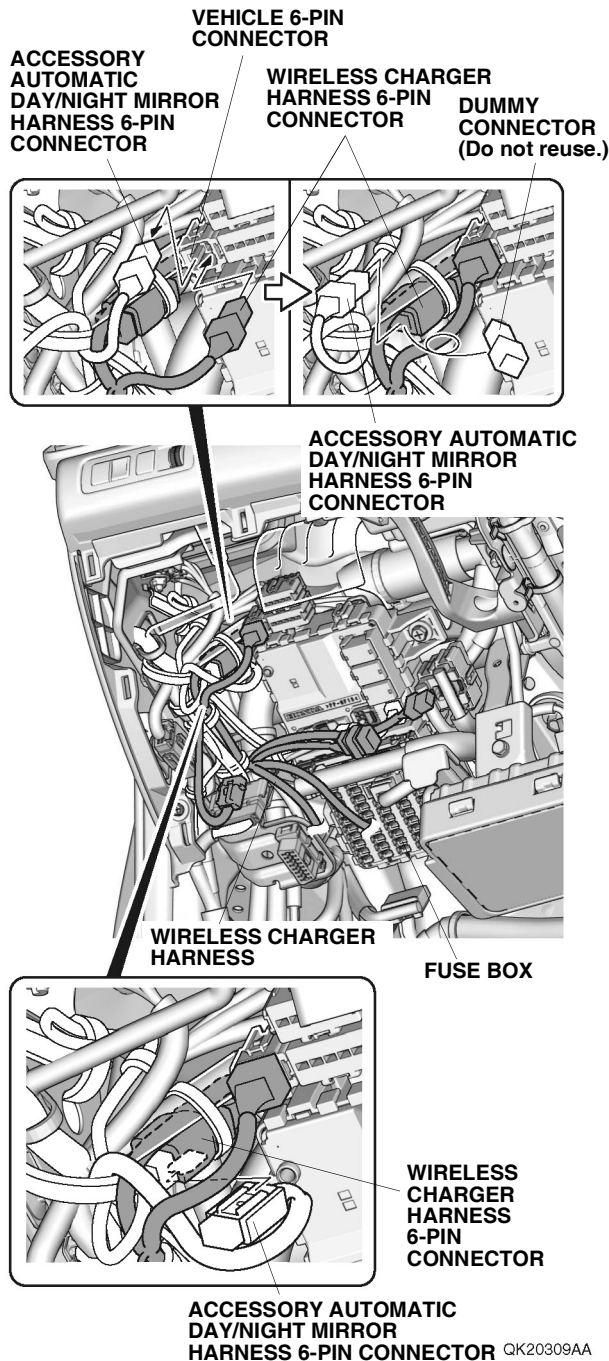

42. Remove the dummy connector from the wireless charger harness 6-pin connector. Plug the accessory automatic day/night mirror harness 6-pin connector into that connector.
43. Secure the accessory automatic day/night mirror harness 6-pin connector to the wireless charger harness 6-pin connector. Go to step 47.

With another accessory

44. Secure the wireless charger harness 6-pin connector to the vehicle harness with one wire tie as shown.

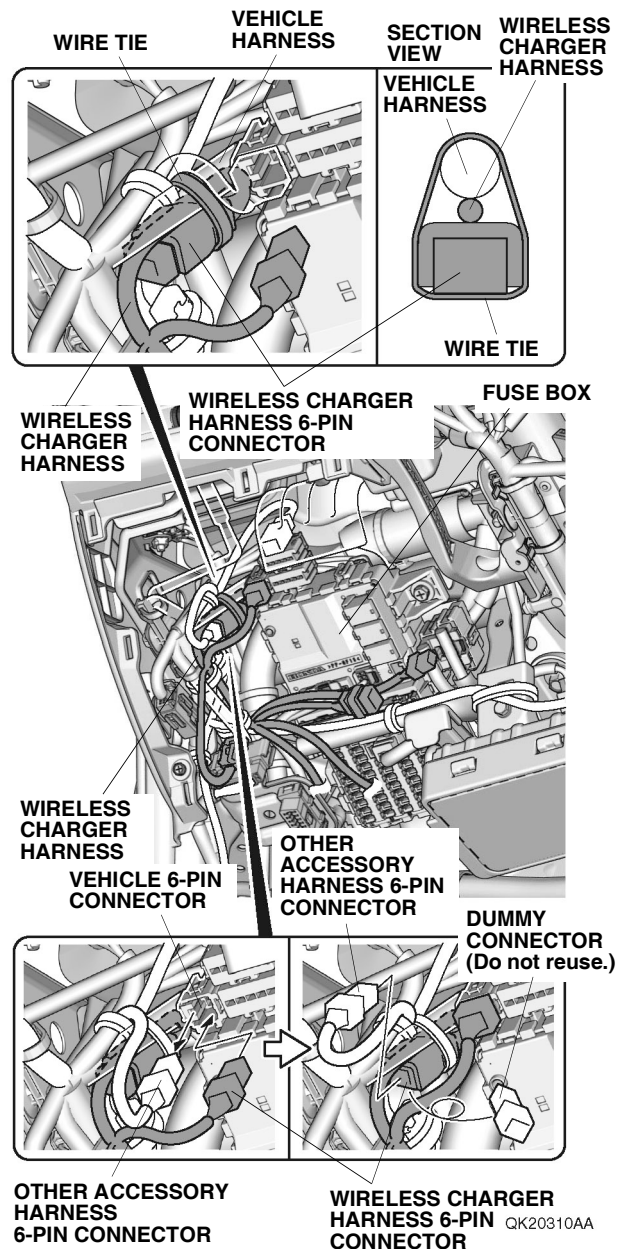

45. Unplug the other accessory harness 6-pin connector, and plug the wireless charger harness 6-pin connector into the vehicle 6-pin connector.
46. Remove the dummy connector from the wireless charger harness 6-pin connector. Plug the other accessory harness 6-pin connector into that connector.

Germain Honda of College Hills

If the vehicle is equipped with another accessory harness 4-pin connector, go to step 48; otherwise, continue with step 47.

Without another accessory harness 4-pin connector

47. Plug the wireless charger harness 4-pin connector into the fuse box. Go to step 49.

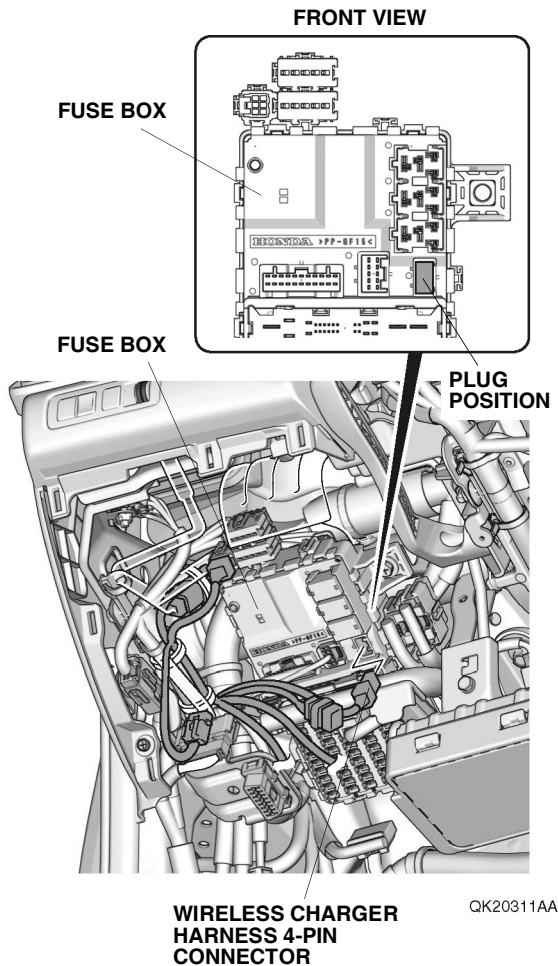

With another accessory harness 4-pin connector

48. Unplug the other accessory harness 4-pin connector, and plug the wireless charger harness 4-pin connector into the fuse box. Remove the dummy connector from the wireless charger harness 4-pin connector, and plug the other accessory harness 4-pin connector into that connector.

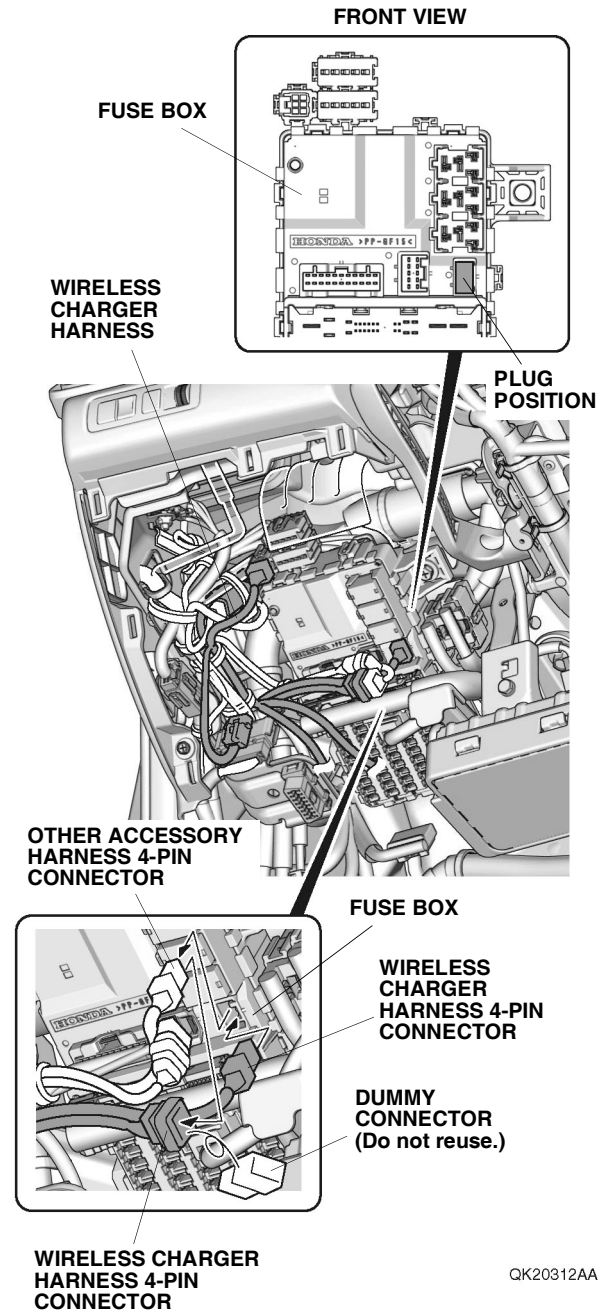

Germain Honda of College Hills

If the vehicle is equipped with sub fuse box, continue with step 49; otherwise, go to step 51.

With sub fuse box

49. Route the wireless charger harness. Secure the wireless charger harness 12-pin connector to the sub fuse box.

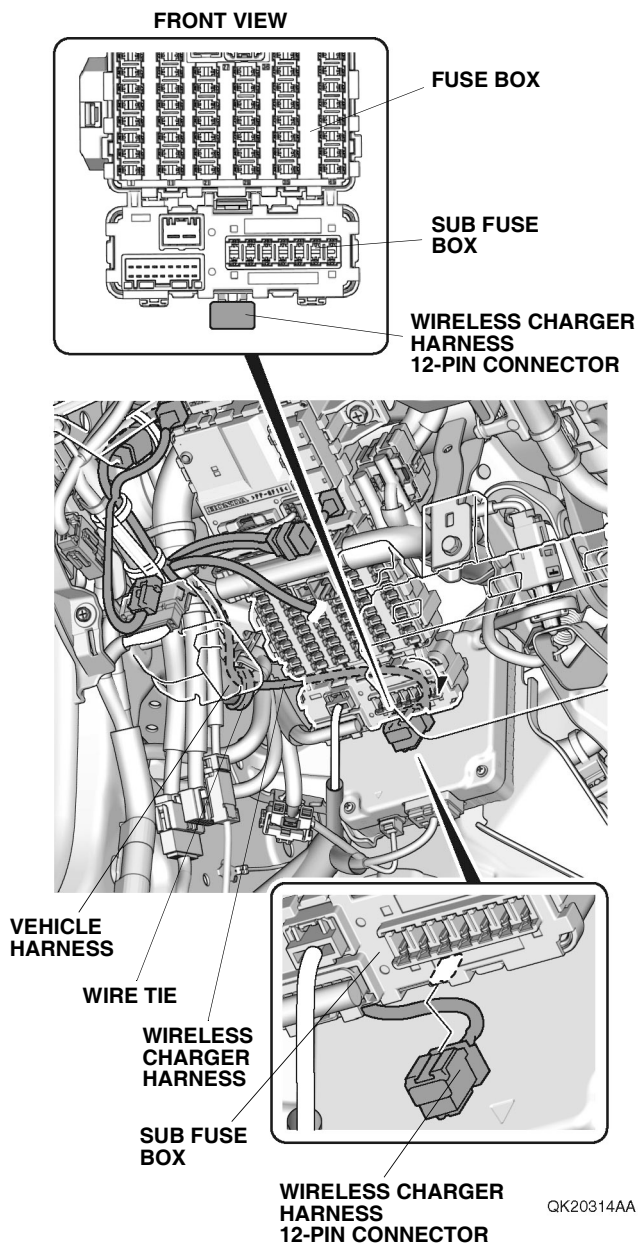

50. Secure the wireless charger harness to the vehicle harness with one wire tie. Go to step 53.

Without sub fuse box

51. Route the wireless charger harness. Secure the wireless charger harness 12-pin connector to the fuse box.

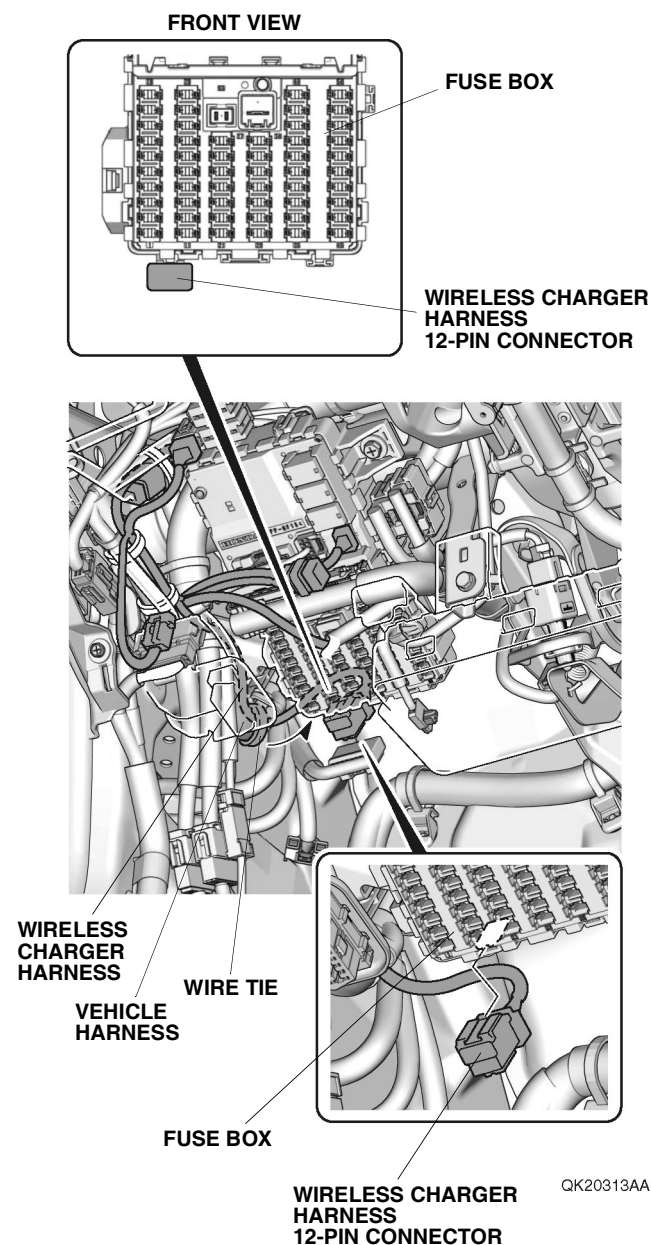

52. Secure the wireless charger harness to the vehicle harness with one wire tie.

Germain Honda of College Hills

53. Route the wireless charger harness. Line up the white tape on the wireless charger harness with the projection of the vehicle bracket, and secure the wireless charger harness to the vehicle bracket with one wire tie as shown.

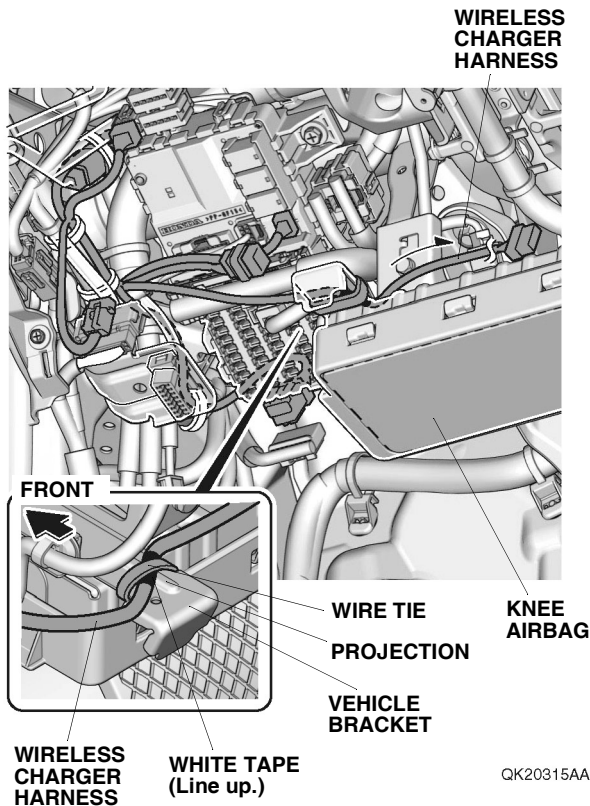

If the vehicle is equipped with another accessory harness, go to step 55; otherwise, continue with step 54.

Without another accessory harness

54. Route the wireless charger harness. Attach one wire tie with clip A around the white tape on the wireless charger harness as shown. Secure the wireless charger harness to the vehicle bracket with one wire tie with clip A. Go to step 57.

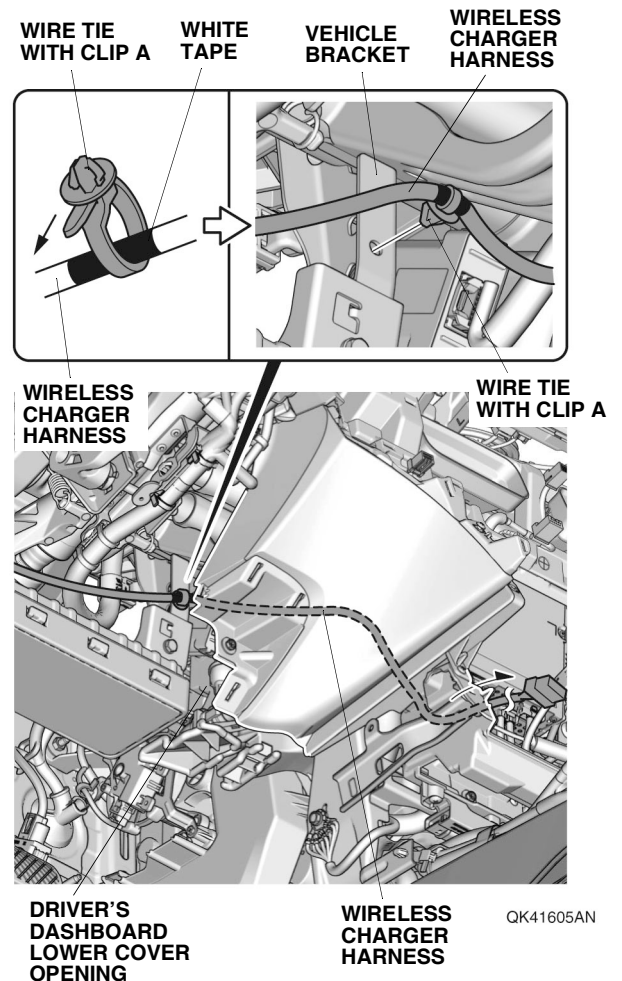

Germain Honda of College Hills

With another accessory harness

55. Route the wireless charger harness. Using diagonal cutters, cut the clip portion off of one wire tie with clip A.

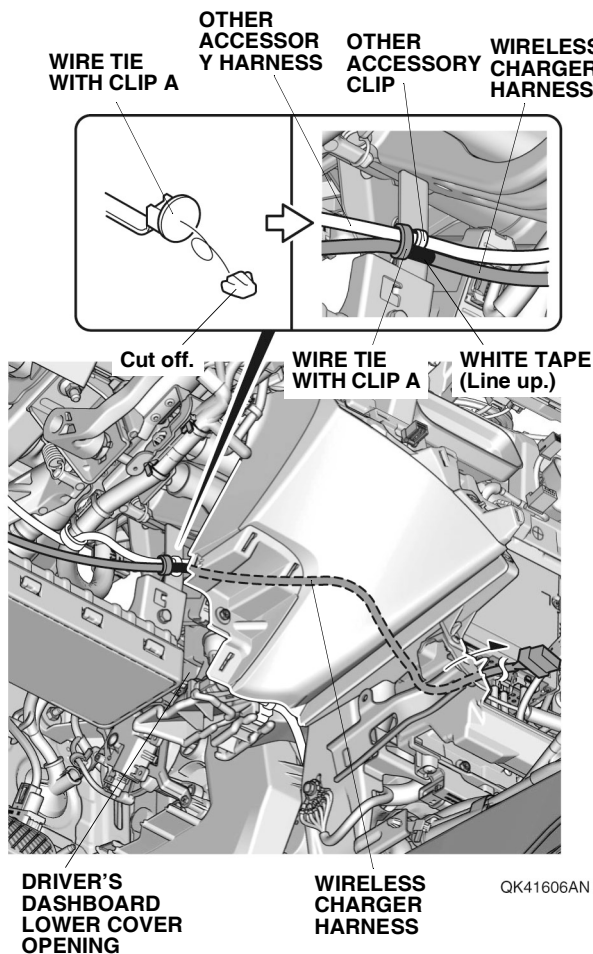

56. Line up the white tape on the wireless charger harness with the other accessory clip, and secure the wireless charger harness to the other accessory harness with one wire tie with clip A as shown.

57. Using isopropyl alcohol on a shop towel, thoroughly clean the knee airbag where the aluminum tape will attach.

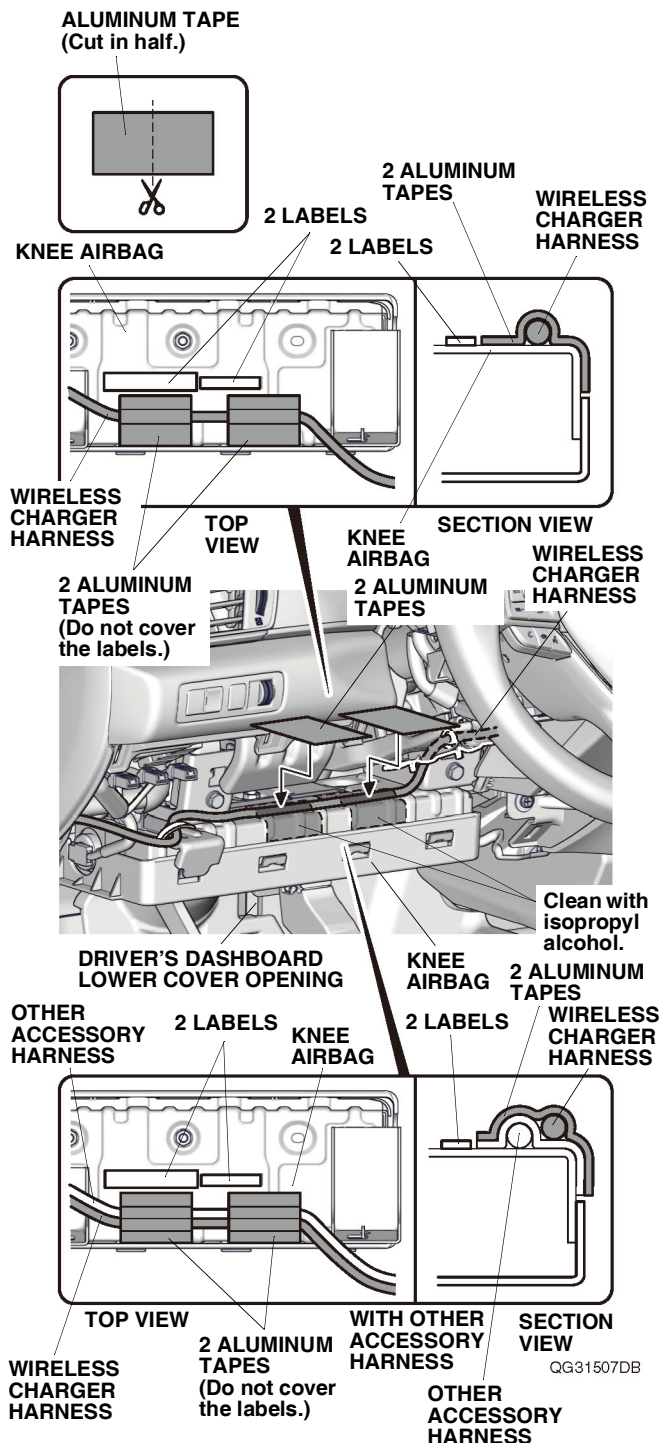

58. Using scissors, cut one piece of aluminum tape in half and secure the wireless charger harness to the knee airbag with two pieces of aluminum tape as shown. If the vehicle is already equipped with another accessory harness, secure the wireless charger harness to the knee airbag with two pieces of aluminum tape as shown.

Germain Honda of College Hills

If the vehicle is equipped with vehicle harness, go to step 60; otherwise, continue with step 59.

Without vehicle harness

59. Route the wireless charger harness. Attach one wire tie with clip B around the white tape on the wireless charger harness as shown. Secure the wireless charger harness to the vehicle panel with one wire tie with clip B. Go to step 62.

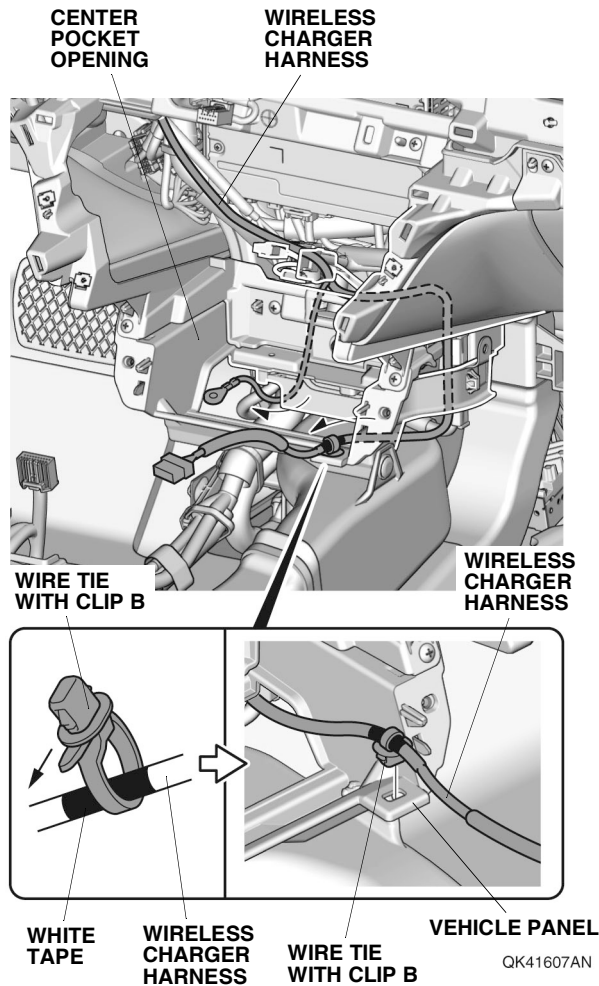

With vehicle harness

60. Route the wireless charger harness. Cut the clip portion off of one wire tie with clip B.

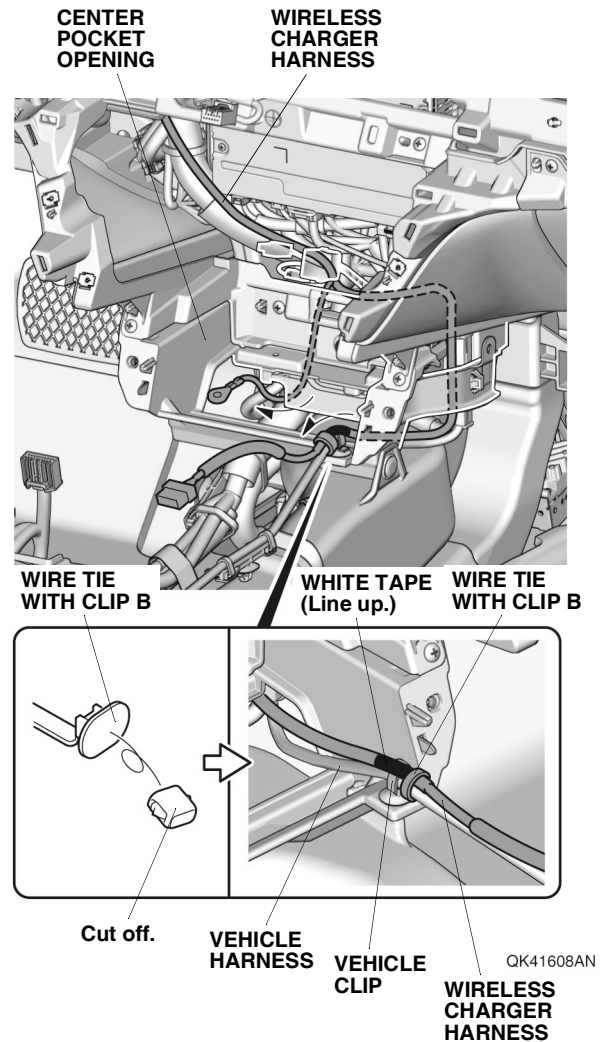

61. Line up the white tape on the wireless charger harness with the vehicle clip, and secure the wireless charger harness to the vehicle harness with one wire tie with clip B as shown.

Germain Honda of College Hills

62. Secure the wireless charger harness to the vehicle harness with four wire ties.

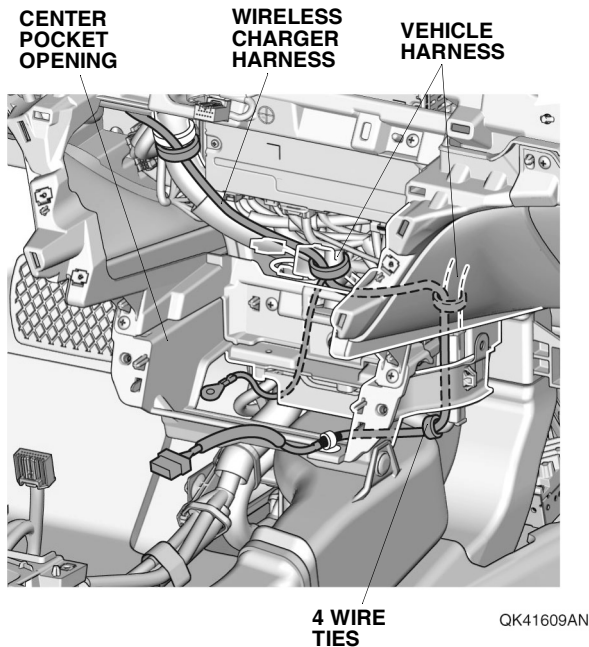

64. Secure the wireless charger harness to the vehicle harness with one wire tie.

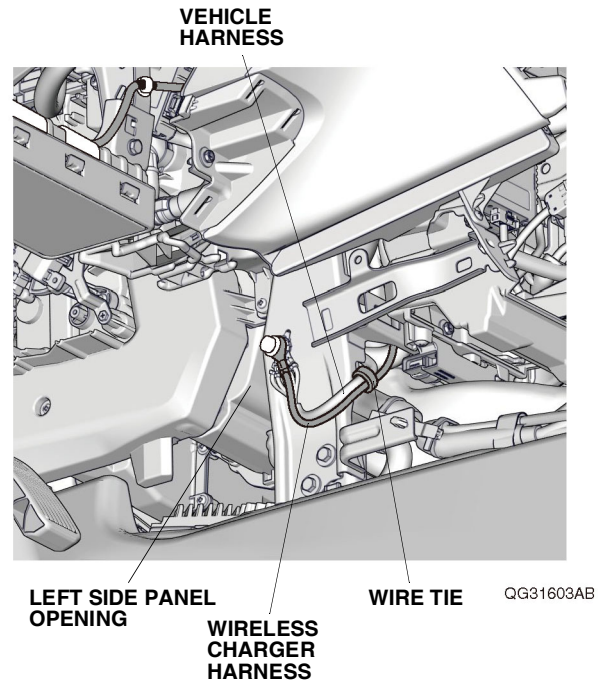

63. Remove the vehicle ground bolt, and secure the wireless charger harness ground terminal to the vehicle ground terminals with vehicle ground bolt. NOTE: Do not put the ground terminal calkings on top of one another.

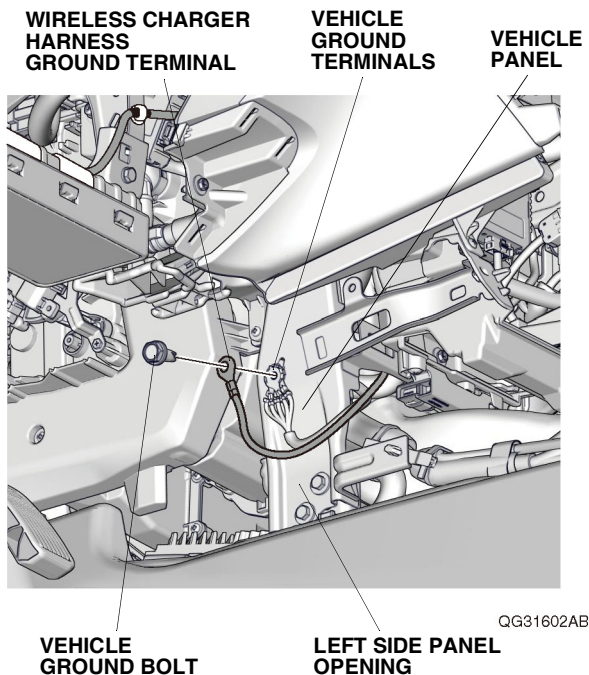

65. Open the lid, and remove the USB adapter holder.

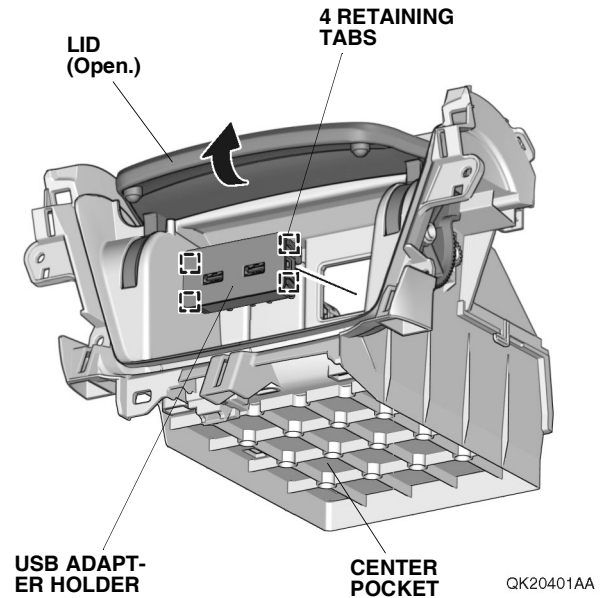

Germain Honda of College Hills

66. Open the housing cover, and remove the accessory power socket.

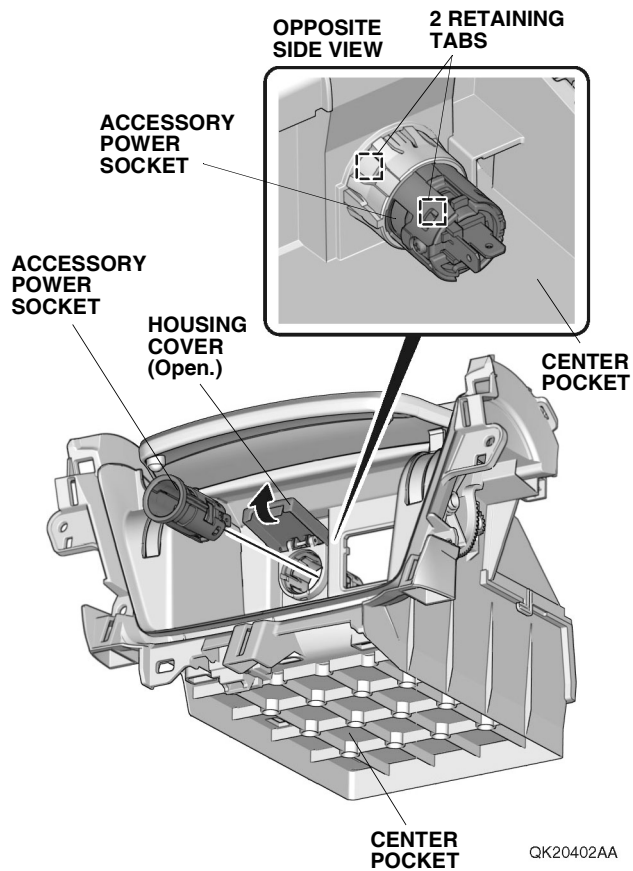

67. Remove the housing.

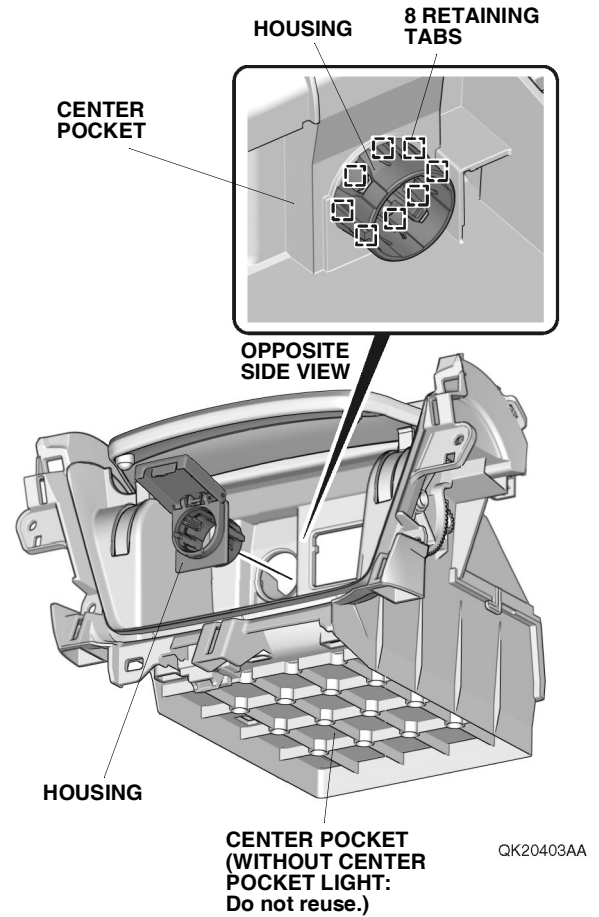

Germain Honda of College Hills

If the vehicle is equipped with center pocket light, continue with step 68; otherwise, go to step 70.

With center pocket light

68. Remove the center pocket light.

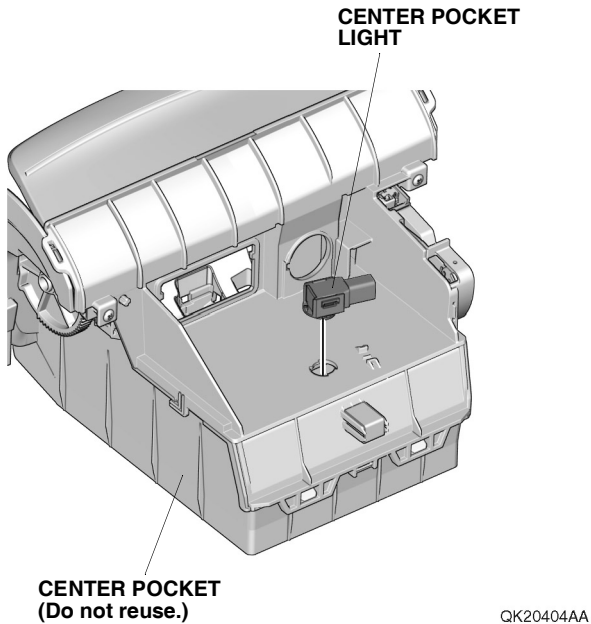

69. Install the center pocket light to the new center pocket.

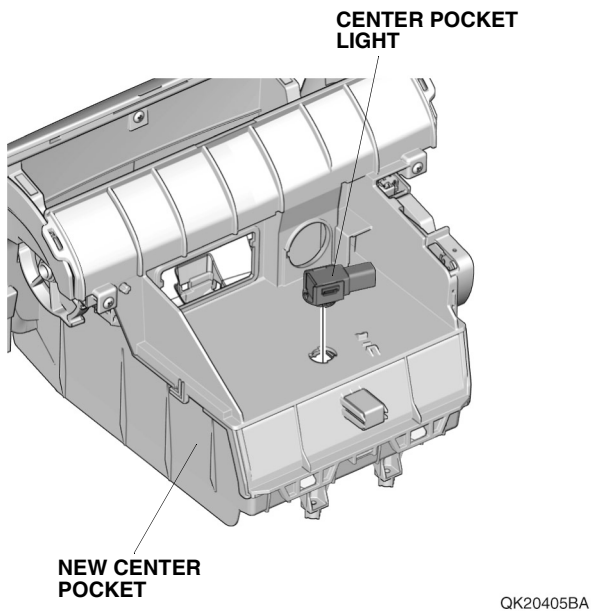

70. Open the lid, and install the USB adapter holder in the new center pocket with four retaining tabs.

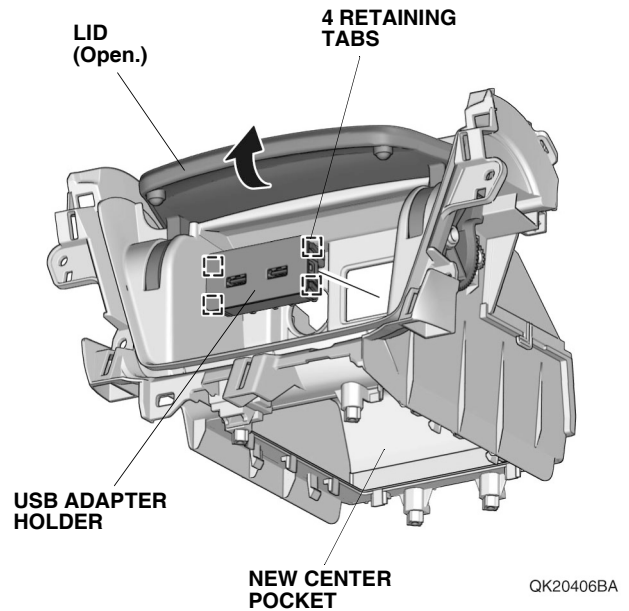

71. Install the housing in the new center pocket with eight retaining tabs.

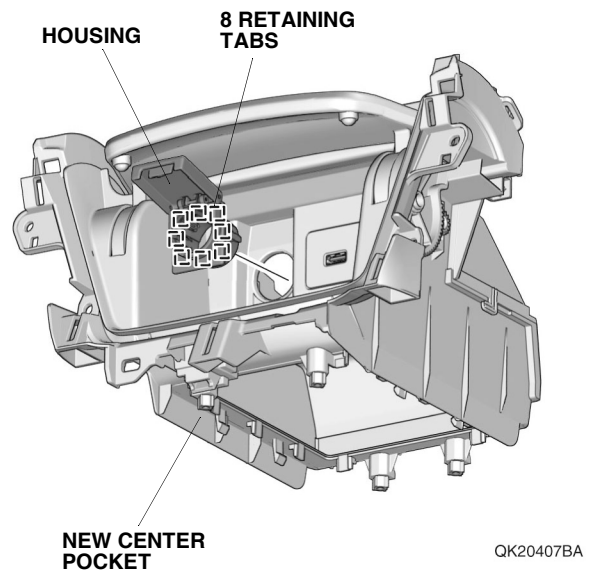

Germain Honda of College Hills

72. Install the accessory power socket in the housing with two retaining tabs.

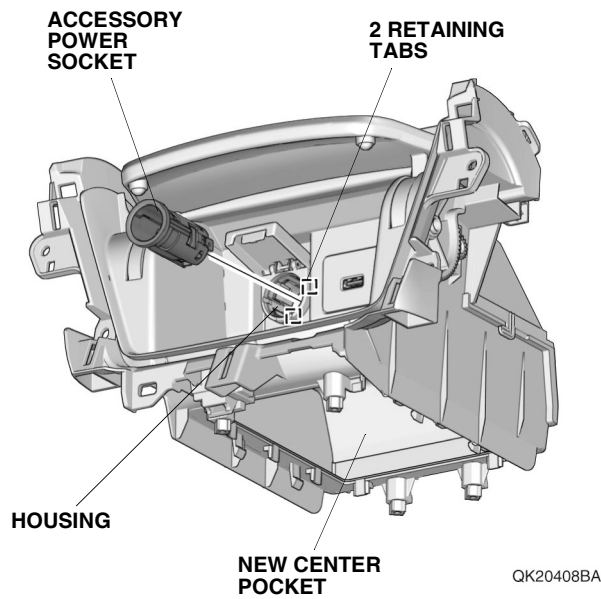

73. Install the cover removed in step 21 in the new center pocket with two retaining tabs.

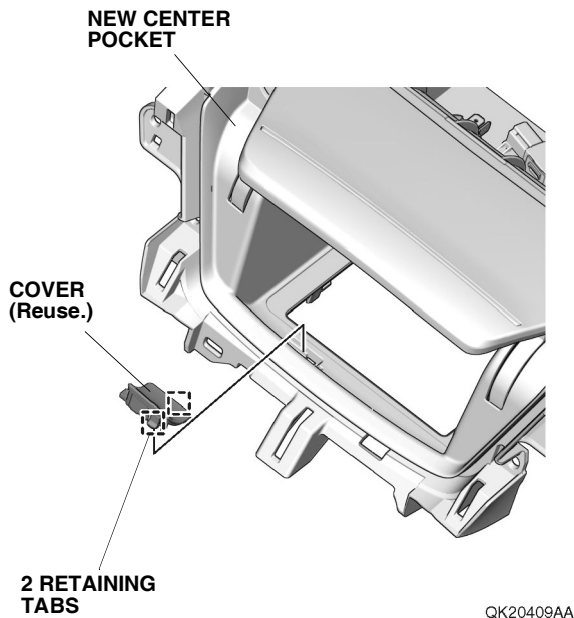

74. Install the wireless charger unit in the new center pocket with four retaining tabs and four self-tapping screws.

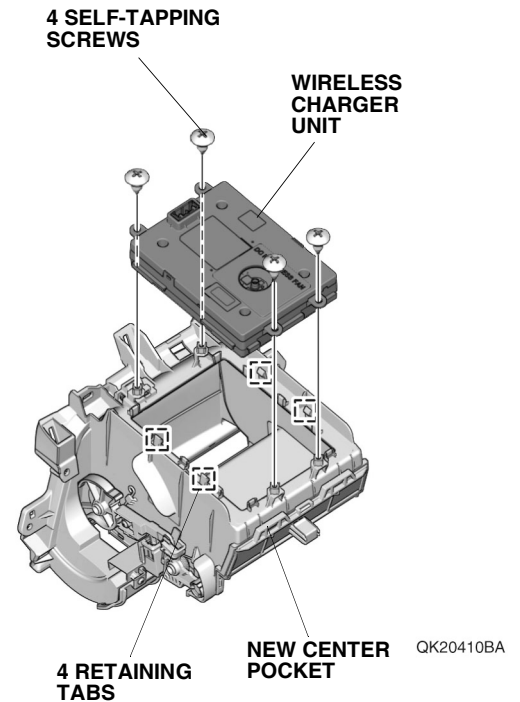

Germain Honda of College Hills

75. Plug the wireless charger harness 7-pin connector into the wireless charger unit.

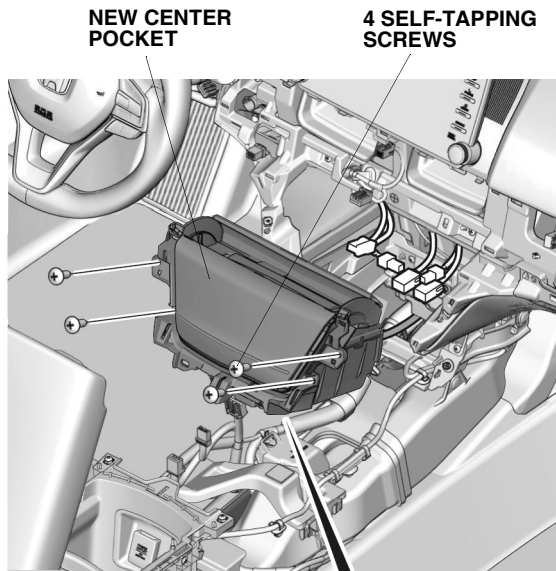

WIRELESS CHARGER UNIT

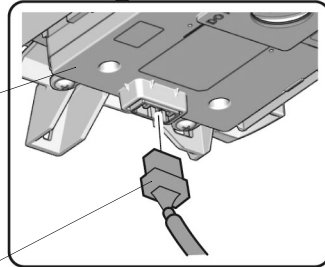

WIRELESS CHARGER HARNESS 7-PIN CONNECTOR

QK20411BA

76. Install the new center pocket with four self-tapping screws removed in step 30.

77. Plug the 20A fuse into the fuse box.
NOTE: If a 20A fuse is already installed in the fuse box as shown, go to step 79; otherwise, plug the 20A fuse into the fuse box.

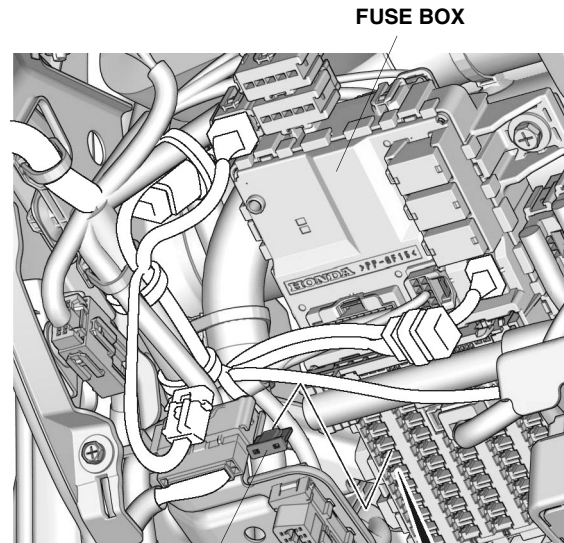

20A FUSE

PLUG POSITION

FUSE BOX

FRONT VIEW

QK20412AA

Germain Honda of College Hills

78. Using isopropyl alcohol on a shop towel, thoroughly clean the fuse label where the fuse label B will attach. Attach the fuse label B (20A OPTION FUSE) to the fuse label on the driver's kick panel as shown.

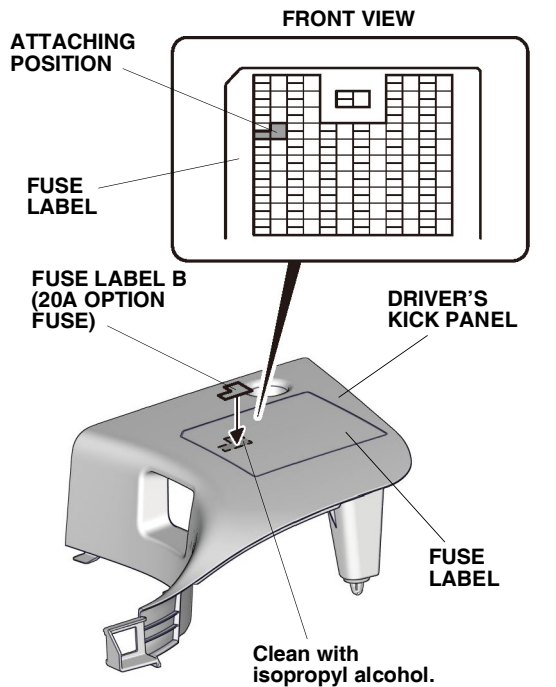

QG21433AA

79. Check that all wire harnesses are routed properly and all connectors are plugged in.
80. Install all removed parts.
81. Connect the negative cable to the battery.
82. Press and hold the audio unit power button for 2 seconds to restore the audio and navi (if equipped) system functions.
83. Set the clock on vehicles without navigation.
84. If necessary, restore the systems back to normal operation as described in the service information.

Check the Operation of the Wireless Charger

85. Make sure the wireless charger works properly as described in the Owner's Manual of the vehicle.