



## HONDA INSTALLATION INSTRUCTIONS

Accessory  
DOOR LINING COVERS

Application  
2021 ACCORD

Publications No.  
**VERSION 1**  
Issue Date  
**SEP 2020**

### PARTS LIST

**Door Lining Covers Kit**  
**P/N 08Z03-TVA-100A**  
**P/N 08Z03-TVA-100B**

\*: The part differs depending on the kits.

\*Right front door lining cover  
(P/N 08Z03-TVA-100A)



\*Right front door lining cover  
(P/N 08Z03-TVA-100B)



\*Left front door lining cover  
(P/N 08Z03-TVA-100A)



\*Left front door lining cover  
(P/N 08Z03-TVA-100B)



Right rear door lining cover



Left rear door lining cover



Front template

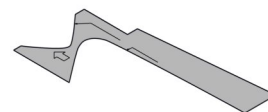

Rear template

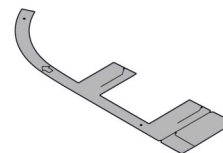

### TOOLS AND SUPPLIES REQUIRED

Isopropyl alcohol

Shop towel

Masking tape

### Illustration of the Door Lining Covers in the Vehicle

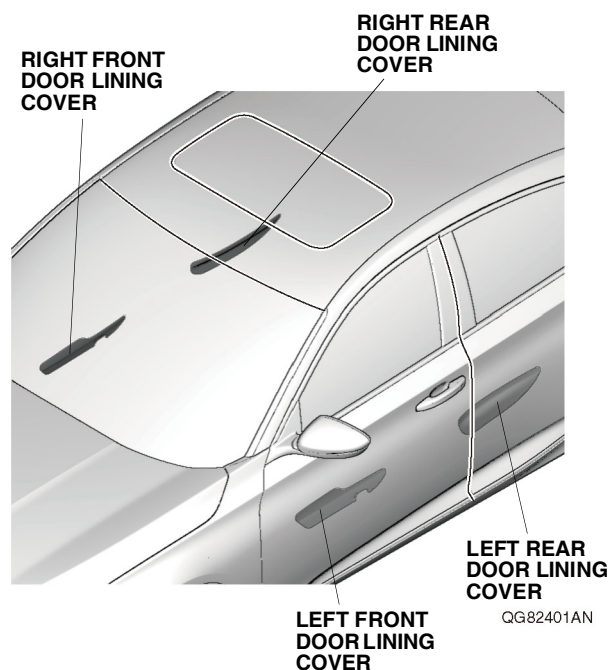

## INSTALLATION

**Customer Information:** The information in this installation instruction is intended for use only by skilled technicians who have the proper tools, equipment, and training to correctly and safely add equipment to your vehicle. These procedures should not be attempted by “do-it-yourselfers.”

### NOTE:

- Be careful not to damage the body paint finish.
- This kit should be installed only if the ambient air temperature is 60°F (15°C) or above.
- To allow the adhesive to cure, do not wash the vehicle for 24 hours. Make sure the customer is aware of this.

## Installing the Front Door Lining Covers

1. Line up the front template with the edges of the right front speaker and right front door pocket as shown. Tape the front template to the right front door lining with masking tape.

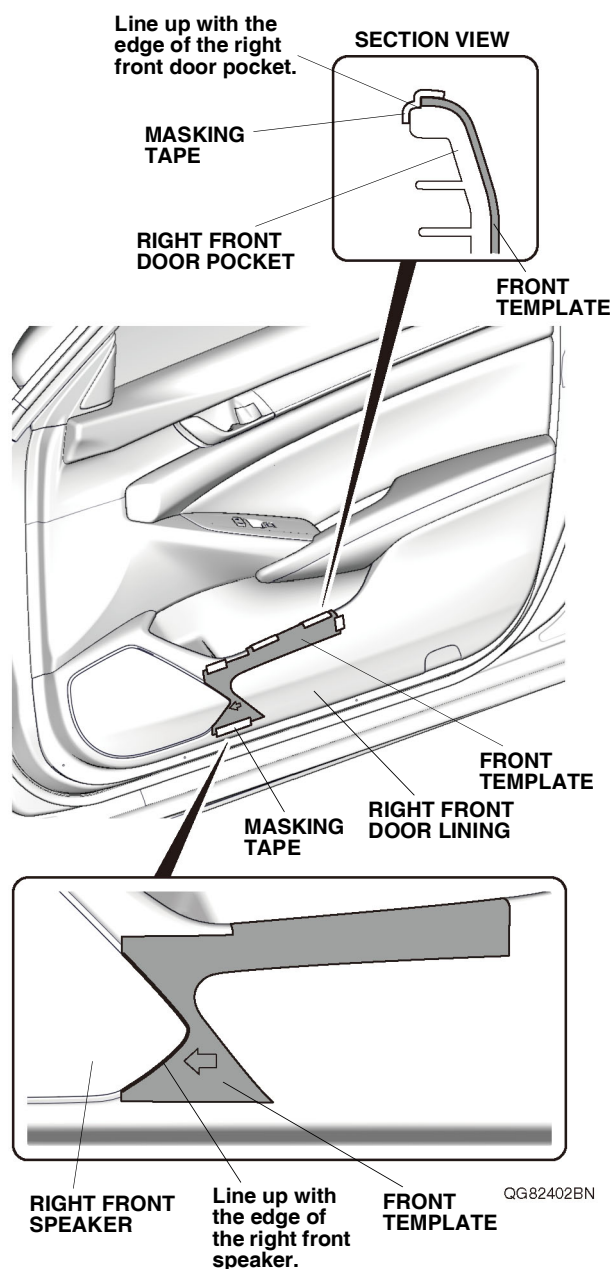

If the vehicle is equipped with courtesy lights, continue with step 2; otherwise, go to step 3.

## With courtesy lights

2. Peel back the adhesive backings, and tape them to the front surface of the right front door lining cover with masking tape. Remove the remaining adhesive backings. Go to step 4.

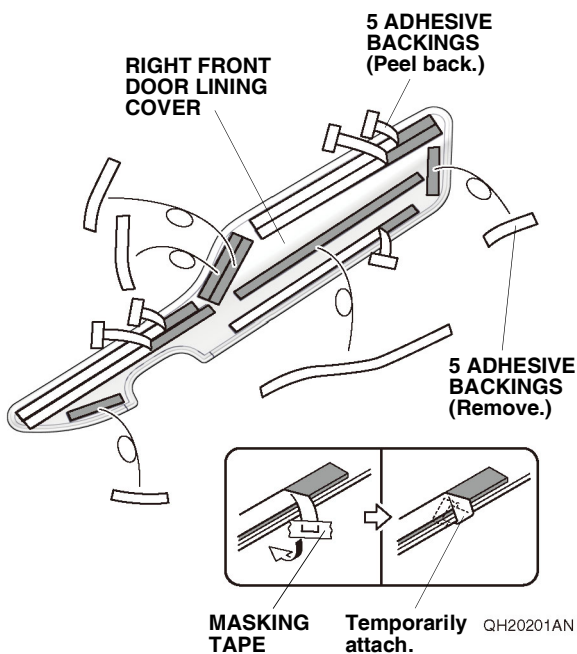

## Without courtesy lights

3. Peel back the adhesive backings, and tape them to the front surface of the right front door lining cover with masking tape. Remove the remaining adhesive backings.

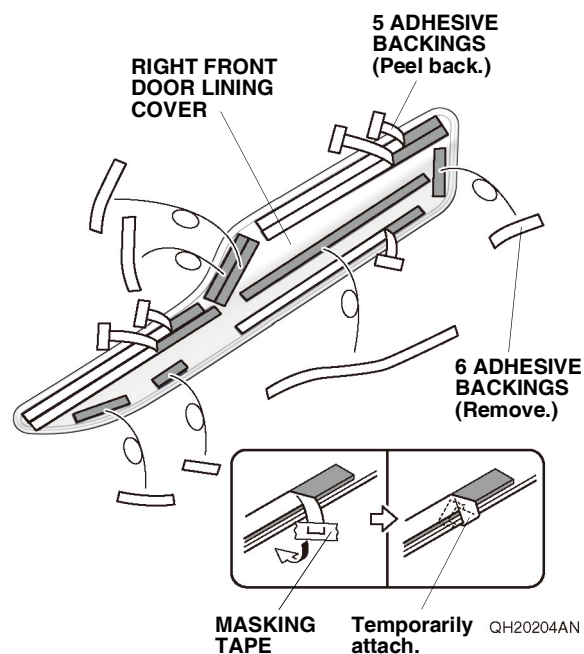

4. Using isopropyl alcohol on a shop towel, thoroughly clean the right front door lining where the right front door lining cover will attach.

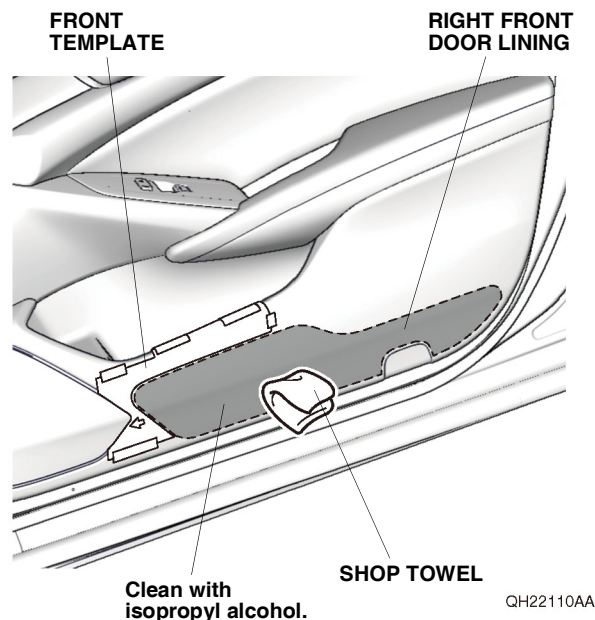

5. Line up the right front door lining cover with the front template. If the vehicle is equipped with courtesy light, make sure there is equal spacing, and attach the right front door lining cover as shown.

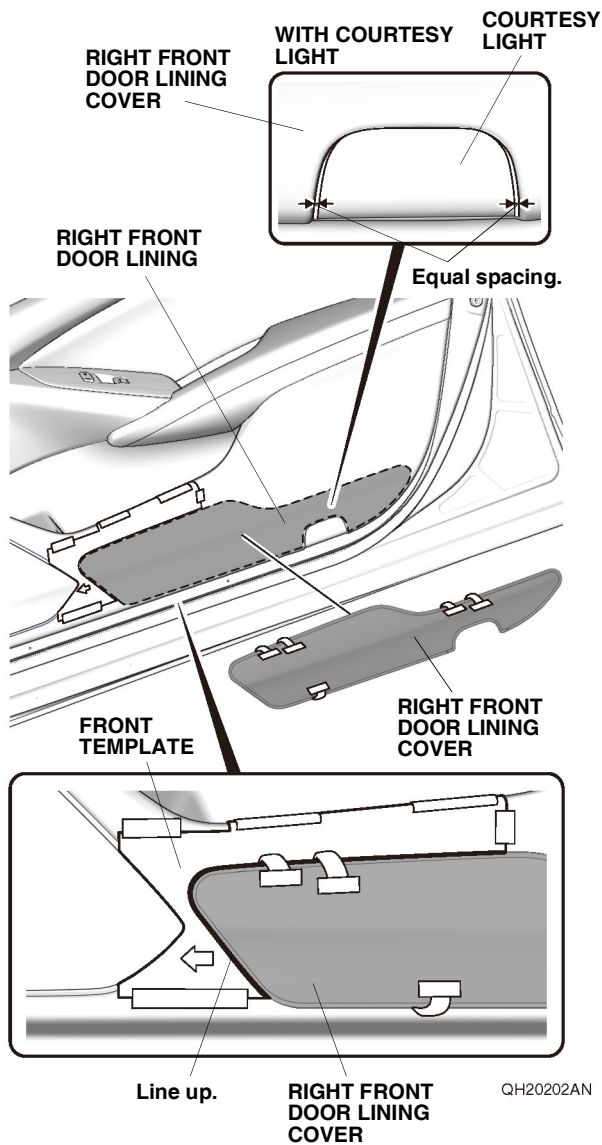

6. While applying light pressure against the right front door lining cover, carefully remove the taped adhesive backings.

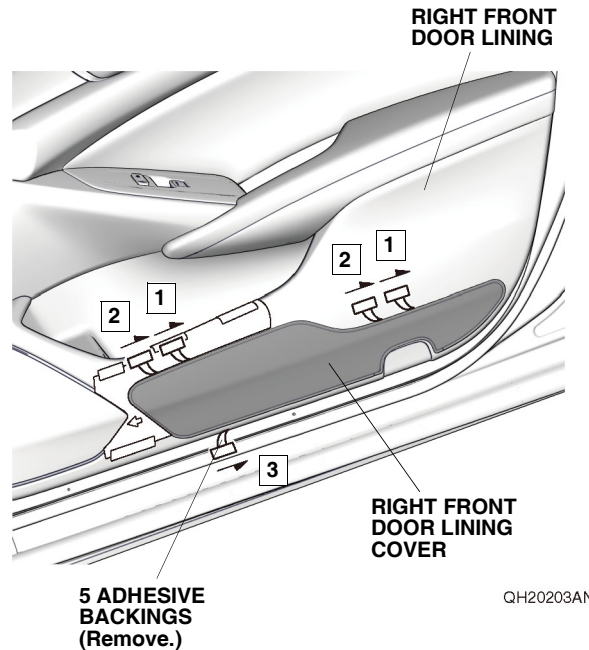

7. Using the palm of your hand, firmly press the right front door lining cover against the right front door lining. Remove the front template from the right front door lining.
8. Turn the front template over, and repeat steps 1 through 7 on the left side of the vehicle.

## Installing the Rear Door Lining Covers

9. Line up the rear template with two projections as shown. Tape the rear template to the right rear door lining with masking tape.

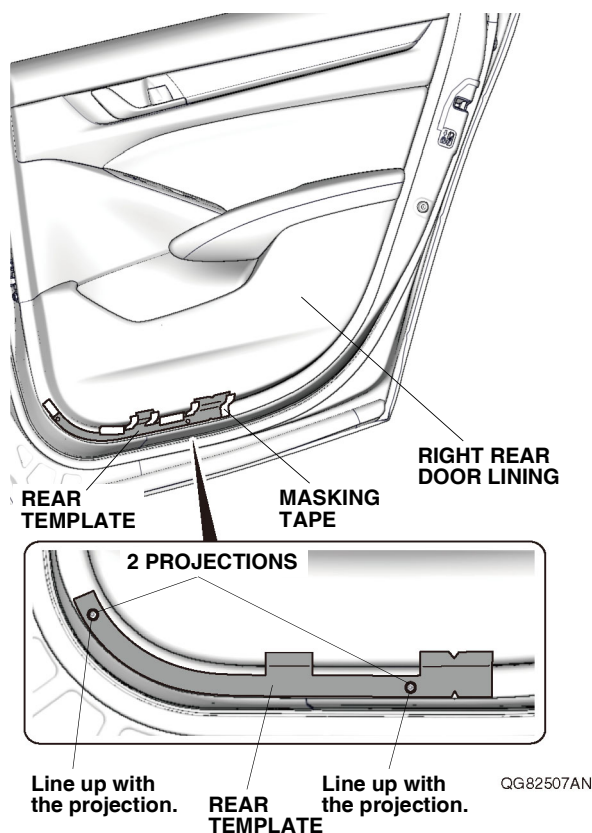

10. Attach masking tape to the right rear door lining cover as shown.

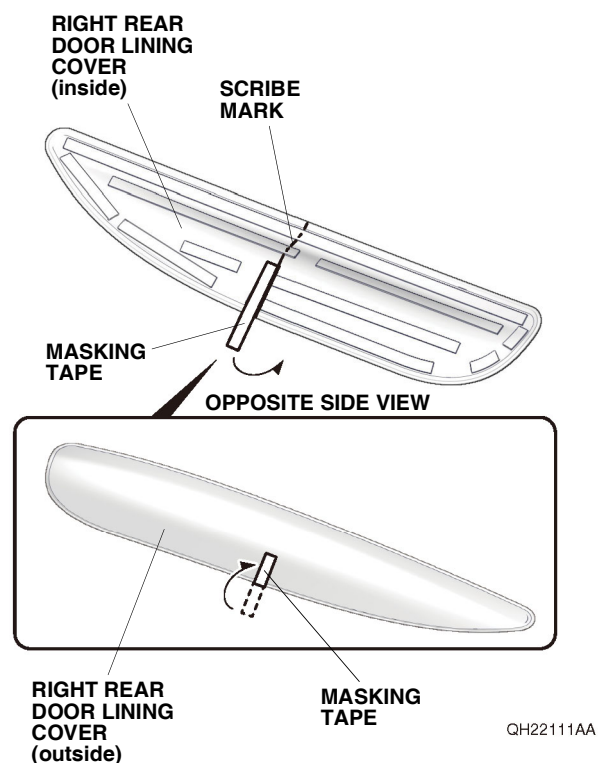

11. Attach masking tape to the right rear door lining cover as shown.

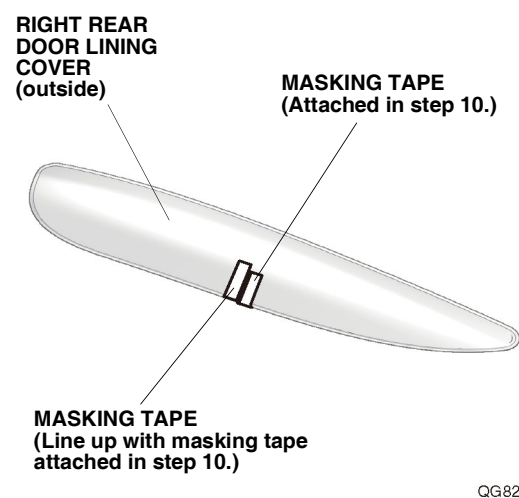

12. Remove masking tape attached in step 10 from the right rear door lining cover.



13. Using isopropyl alcohol on a shop towel, thoroughly clean the right rear door lining where the right rear door lining cover will attach.

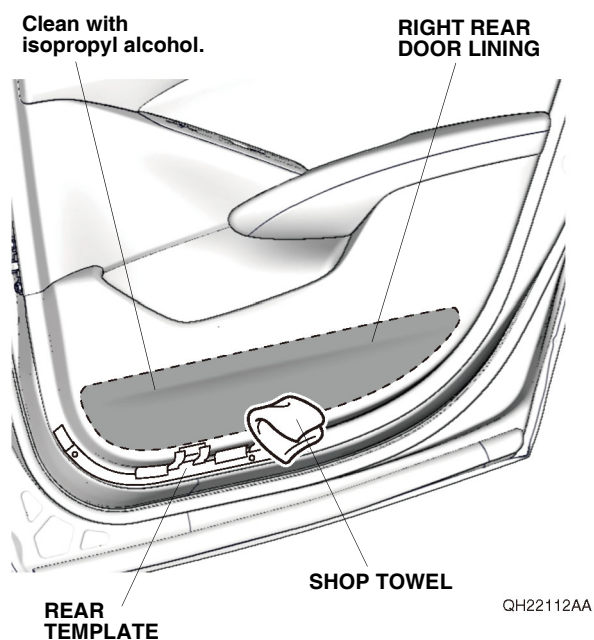

14. Peel back the adhesive backings, and tape them to the front surface of the right rear door lining cover with masking tape. Remove the remaining adhesive backings.

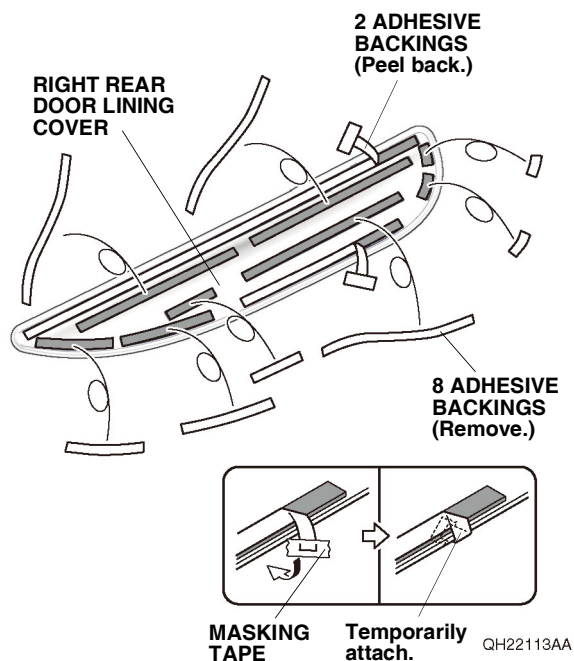

15. Line up the right rear door lining cover with the rear template, and attach it as shown.

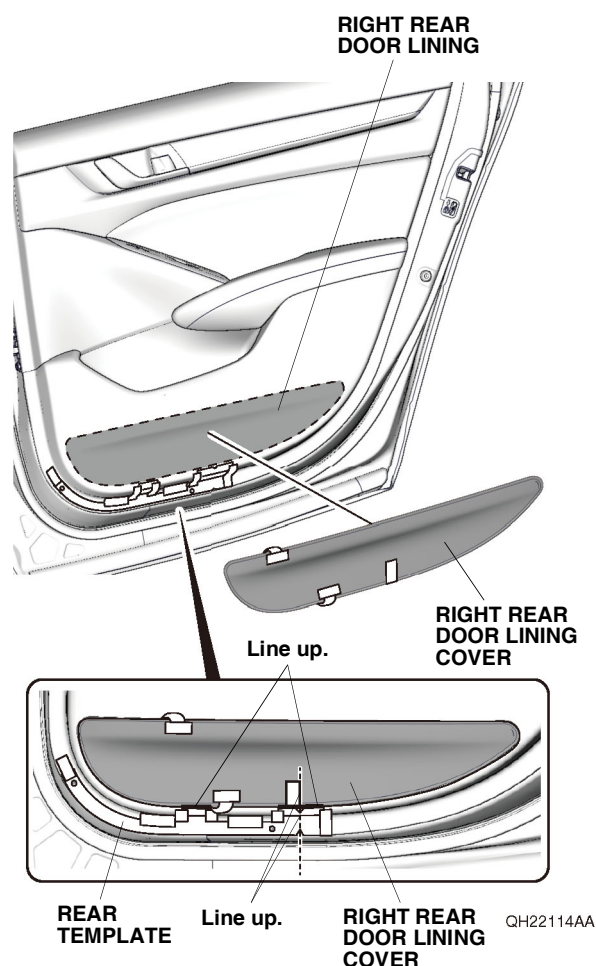

16. While applying light pressure against the right rear door lining cover, carefully remove the taped adhesive backings.

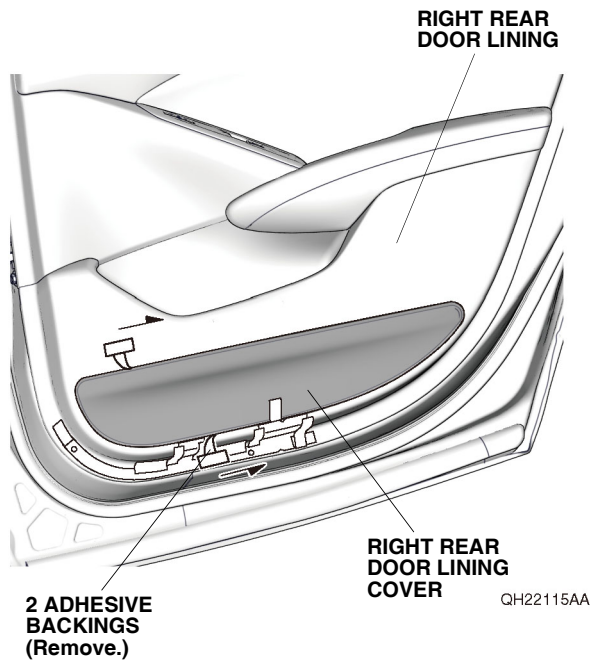

17. Using the palm of your hand, firmly press the right rear door lining cover against the right rear door lining. Remove masking tape from the right rear door lining cover.
18. Remove the rear template from the right rear door lining.
19. Turn the rear template over, and repeat steps 9 through 18 on the left side of the vehicle.