



## HONDA INSTALLATION INSTRUCTIONS

Accessory  
DOOR LINING  
ILLUMINATION  
P/N 08E20-TXM-100

Application  
2020 INSIGHT

Publications No.  
**VERSION 1**  
Issue Date  
**JULY 2019**

### PARTS LIST

2 Lights A  
(Identification mark: CWH-L)



2 Lights B  
(Identification mark: CWH-H)



2 Door lining illumination harnesses

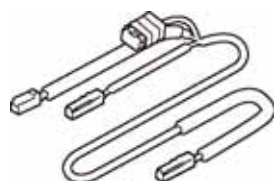

Right trim A  
(Identification mark: R)



Left trim A  
(Identification mark: L)



2 Trims B



4 Self-tapping screws



Fuse label



8 Wire ties



2 Wire ties with clip



2 Urethane tapes



Aluminum tape



## TOOLS AND SUPPLIES REQUIRED

Phillips screwdriver  
Diagonal cutters  
10 mm Open end wrench  
Isopropyl alcohol  
Shop towel  
Masking tape  
Scissors  
File  
Pushpin  
Ratchet  
Ruler  
10 mm Socket  
Drill  
3 mm, 6 mm, and 8 mm Drill bits  
Flat-tip screwdriver

Eye protection (face shield, safety goggles, etc.)

The following tools are available through the Honda Tool and Equipment Program. On the iN, click on Service > Service Bay > Tool and Equipment Program, then enter the number under "Search." Or, call 888-424-6857.

- Trim Tool Set (T/N SOJATP2014)
- Plastic Trim Tool (T/N SILTRIMTL10)

## Illustration of the Door Lining Illuminations Installed in the Vehicle

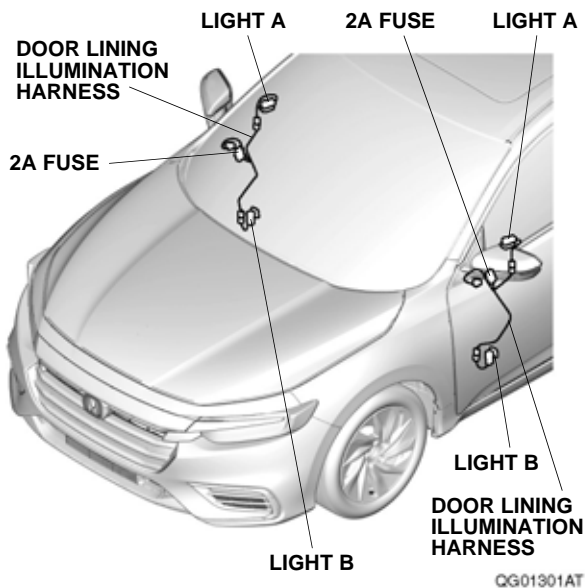

## INSTALLATION

**Customer Information:** The information in this installation instruction is intended for use only by skilled technicians who have the proper tools, equipment, and training to correctly and safely add equipment to your vehicle. These procedures should not be attempted by "do-it-yourselfers."

1. Remove the right side panel, and disconnect the negative cable from the battery.  
NOTE: Wait 3 minutes after turning the power switch to OFF before disconnecting the battery.

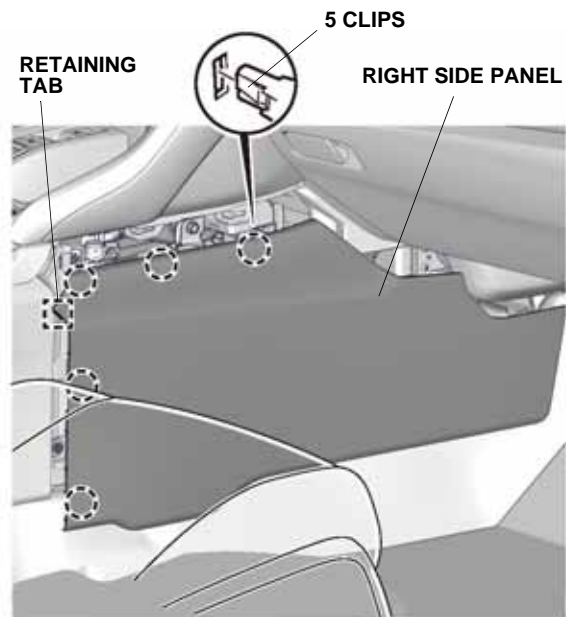

2. Remove the left front door switch panel.

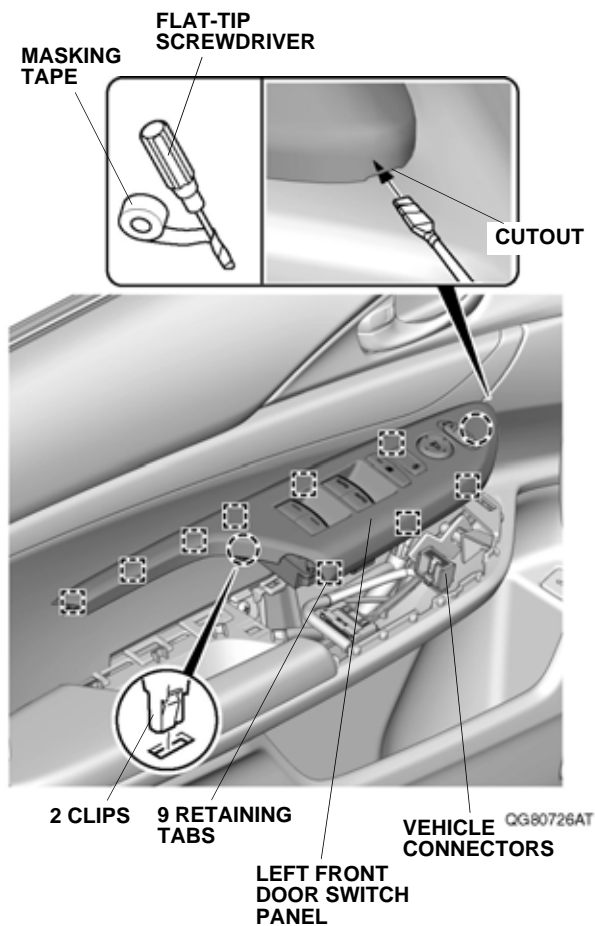

3. Remove the left front door lining.

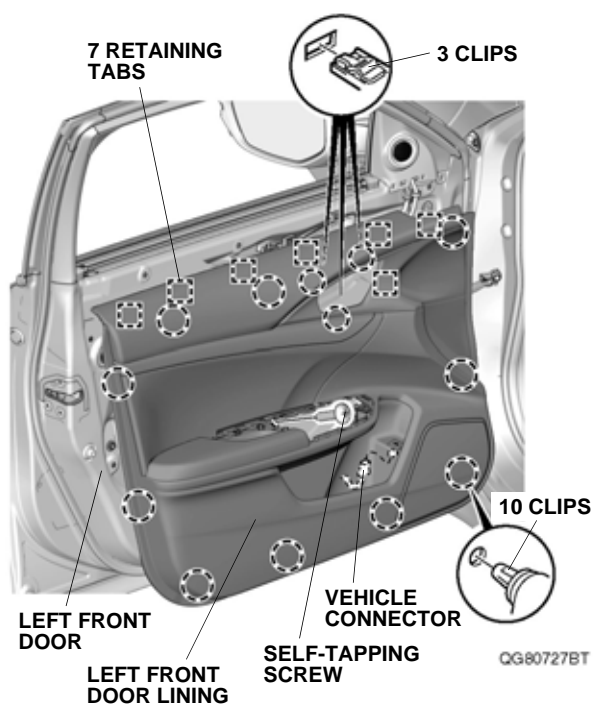

4. Remove the left inside handle.

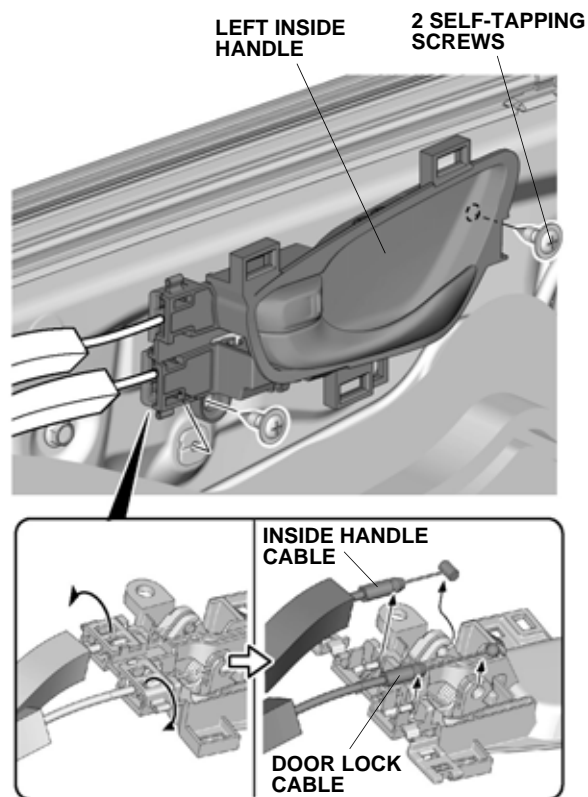

QG80728AT

5. Repeat steps 2 through 4 on the right side of the vehicle.

6. Using isopropyl alcohol on a shop towel, thoroughly clean the fuse case where the fuse label will attach.

**FUSE CASE**  
(Clean with isopropyl alcohol.)

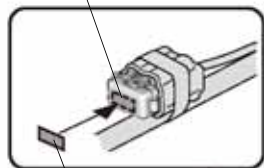

**FUSE LABEL**  
(2A OPTION)

**DOOR LINING ILLUMINATION HARNESS**

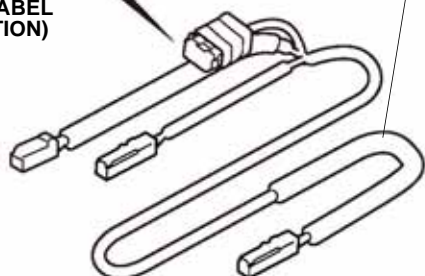

QG01302BT

7. Attach the fuse label to the door lining illumination harness fuse case.

8. Plug the door lining illumination harness 2-pin connector into the vehicle 2-pin connector. Line up the edge of the fuse case on the door lining illumination harness with the branch of the vehicle harness, and secure it to the vehicle harness with one wire tie as shown.

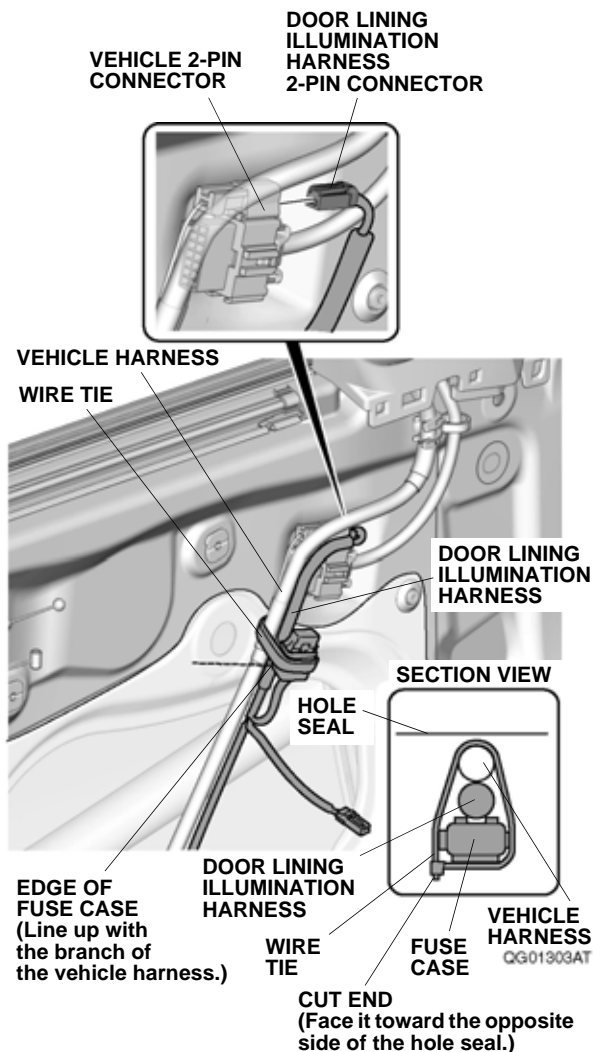

- Secure the door lining illumination harness to the vehicle harness with two wire ties as shown.

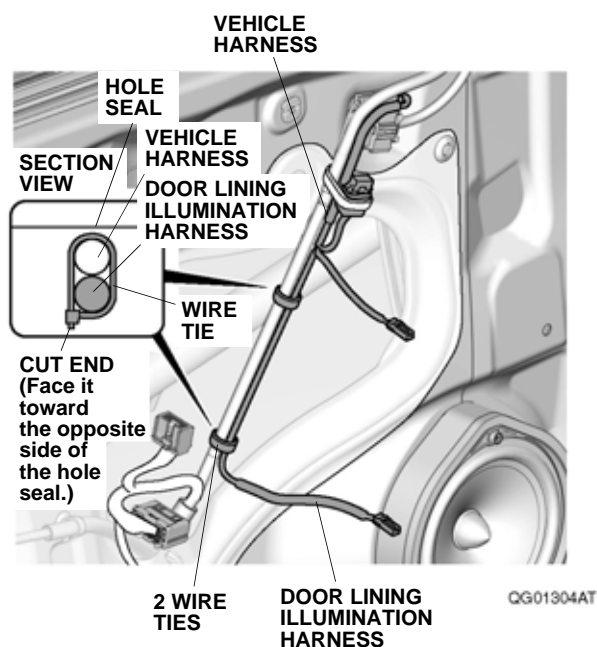

- Using a pushpin, pierce the inside of the left inside handle through the center of two scribe marks.

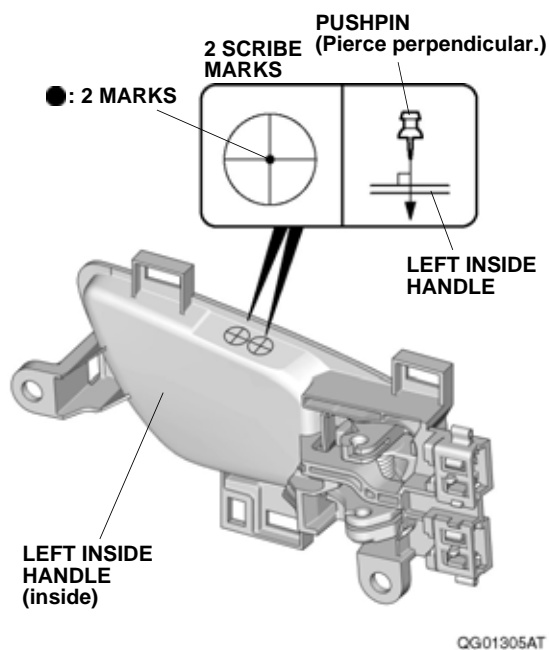

- While wearing eye protection, drill the two pierced marks to 8 mm. First, drill with a 3 mm drill bit, then follow with a 6 mm drill bit, and finish with an 8 mm drill bit.  
NOTE: Wrap masking tape around each drill bit 10 mm (0.39 in.) away from the tip or use a drill stop.

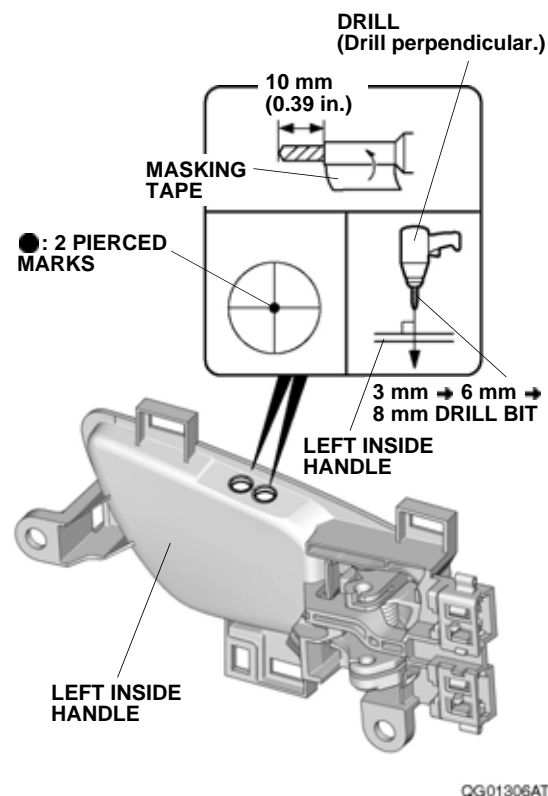

- Using a file, remove any burrs from the holes.

13. Install light A and left trim A to the left inside handle with one self-tapping screw.  
NOTE: Check the shape (identification mark) before installation.

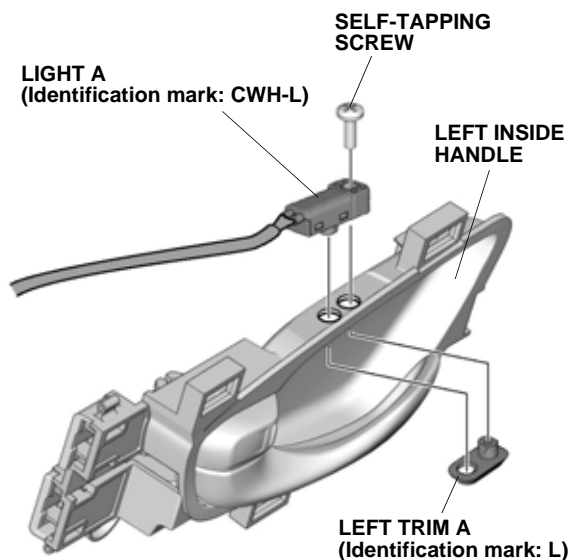

QG01307AT

14. Using scissors, cut one piece of urethane tape in half. Wrap one piece around the light A 2-pin connector, and secure the connector to the left inside handle with one wire tie.

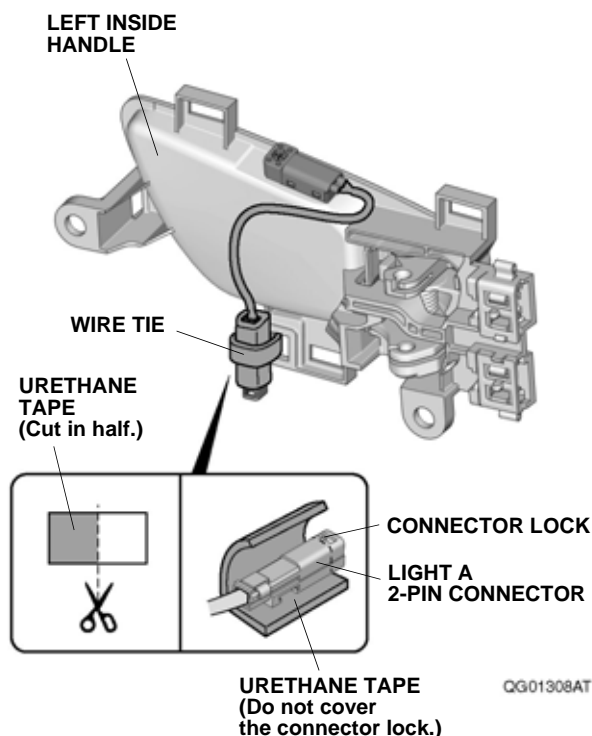

QG01308AT

15. Using isopropyl alcohol on a shop towel, thoroughly clean the left inside handle where the aluminum tape will attach.

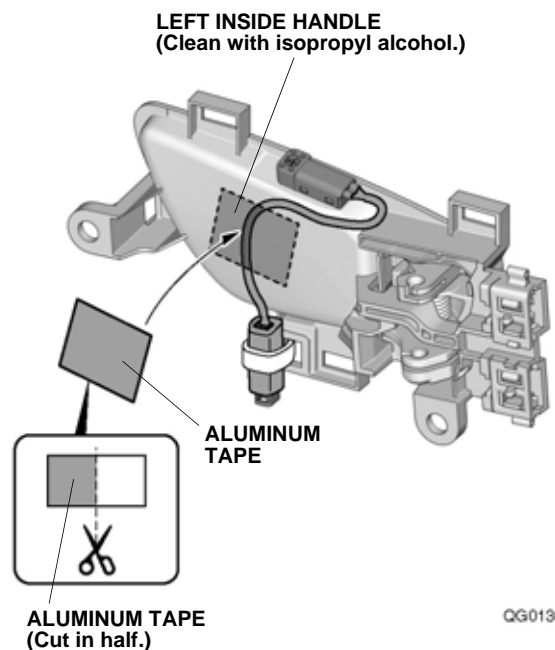

QG01309BT

16. Using scissors, cut one piece of aluminum tape in half. Secure the light A harness to the left inside handle with one piece of aluminum tape.  
17. Using a pushpin, pierce the inside of the left front door lining through the bottom of two scribe marks.

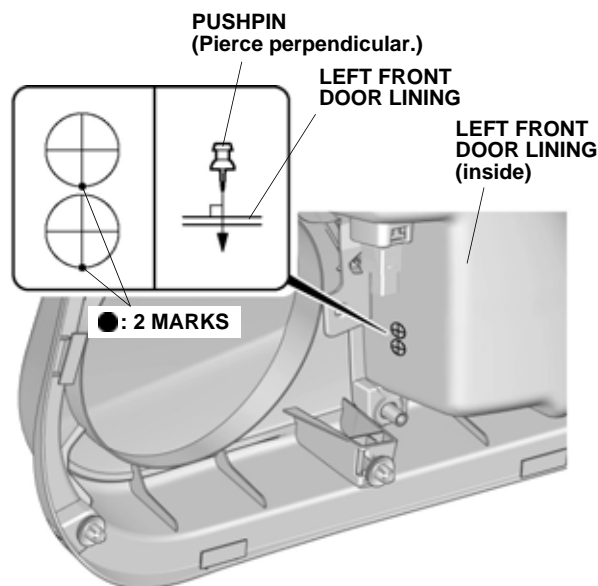

QG01310AT

18. While wearing eye protection, drill the two pierced marks to 8 mm. First, drill with a 3 mm drill bit, then follow with a 6 mm drill bit, and finish with an 8 mm drill bit.  
NOTE: Wrap masking tape around each drill bit 10 mm (0.39 in.) away from the tip or use a drill stop.

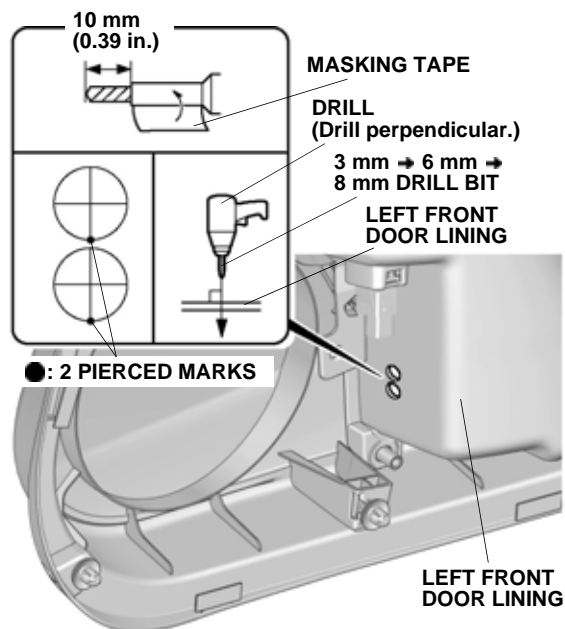

QG01311AT

19. Using a file, remove any burrs from the holes.

20. Install light B and trim B to the left front door lining with one self-tapping screw.  
NOTE: Check the shape (identification mark) before installation.

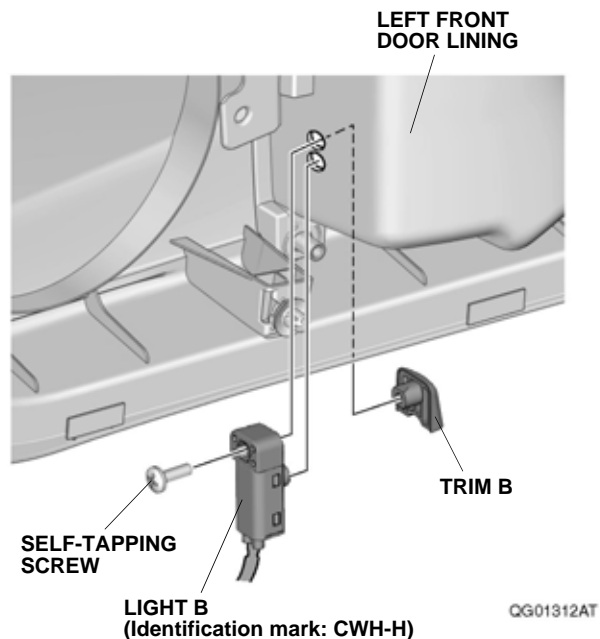

QG01312AT

21. Using the other piece of urethane tape cut in step 14, wrap the light B connector, and secure the light B connector to the left front door lining with one wire tie with clip.

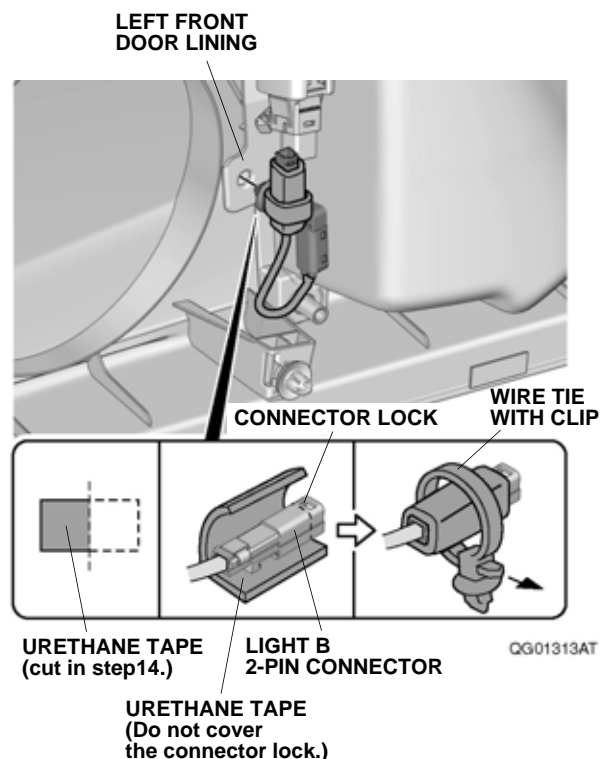

QG01313AT

22. Plug the door lining illumination harness 2-pin connector into the light A 2-pin connector.

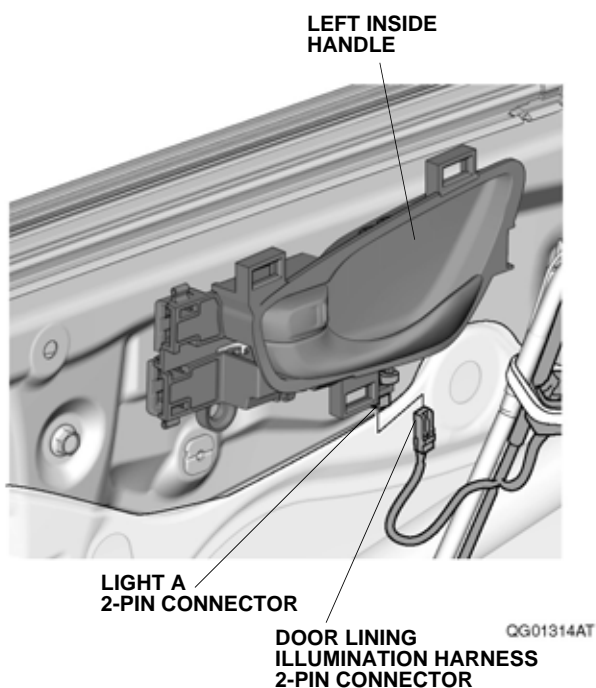

23. Install the left inside handle.
24. Plug the door lining illumination harness 2-pin connector into the light B 2-pin connector.

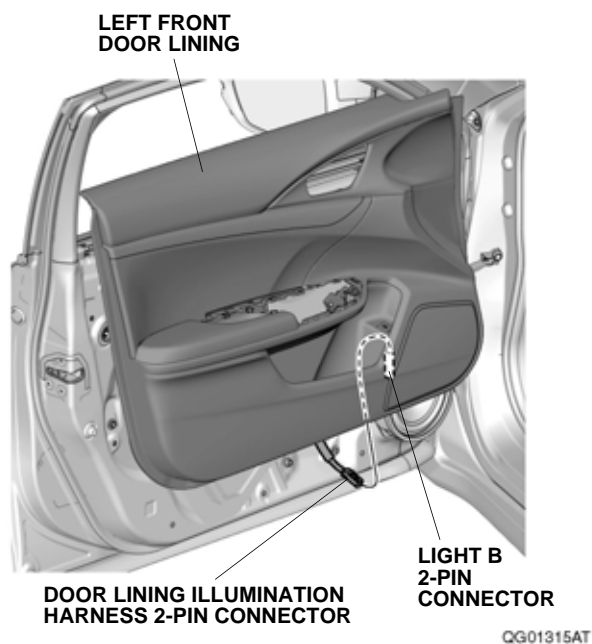

25. Install the left front door lining.

26. Using isopropyl alcohol on a shop towel, thoroughly clean the fuse case where the fuse label will attach.

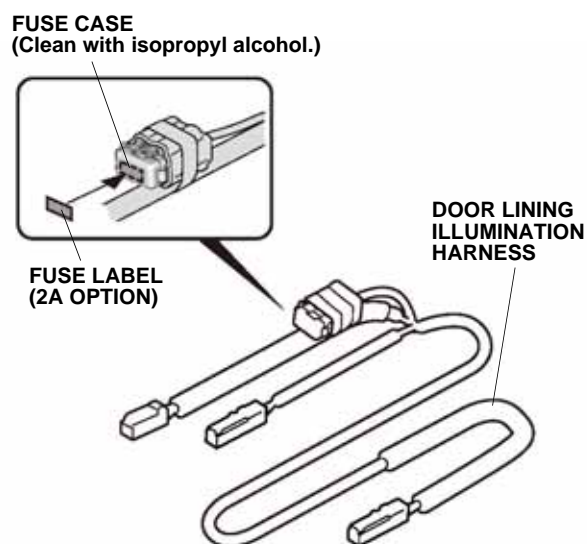

27. Attach the fuse label to the door lining illumination harness fuse case.



28. Plug the door lining illumination harness 2-pin connector into the vehicle 2-pin connector. Line up the edge of the fuse case on the door lining illumination harness with the branch of the vehicle harness, and secure it to the vehicle harness with one wire tie as shown.

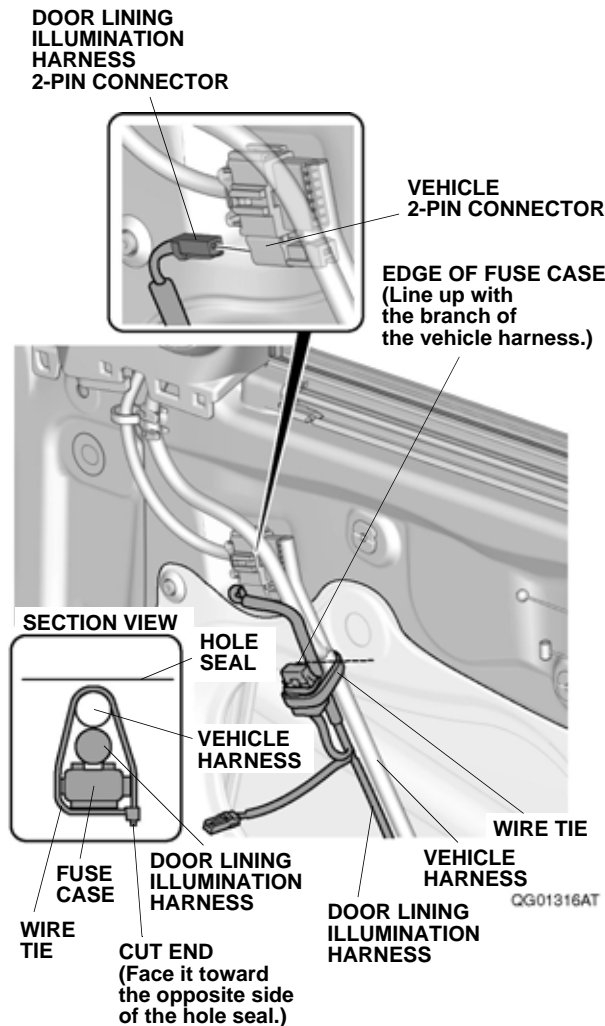

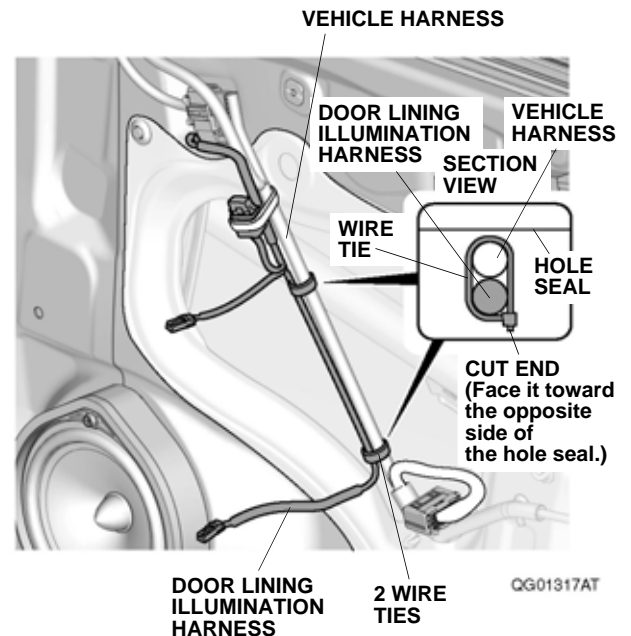

29. Secure the door lining illumination harness to the vehicle harness with two wire ties as shown.



30. Repeat steps 10 through 25 to install light A and light B.
31. Check that all wire harnesses are routed properly and all connectors are plugged in.
32. Install all removed parts except for the right side panel.
33. Connect the negative cable to the battery.
34. Install the right side panel.
35. Press and hold the audio unit power button for 2 seconds to restore the audio and navi (if equipped) system functions.
36. Set the clock on vehicle without navigation.
37. If necessary, restore the systems back to normal operation as described in the service information if necessary.

## Check the Operation of the Door Lining Illuminations

38. Set the light switch to the  or  position, and make sure the door lining illuminations are on.
39. Set the headlight switch to the AUTO position, and make sure the door lining illuminations are on with the parking lights or headlights.
40. Check that the door lining illumination brightness varies along with the instrument panel brightness by turning the brightness control knob.
41. If the door lining illuminations do not come on, check the fuse and all of the connectors.

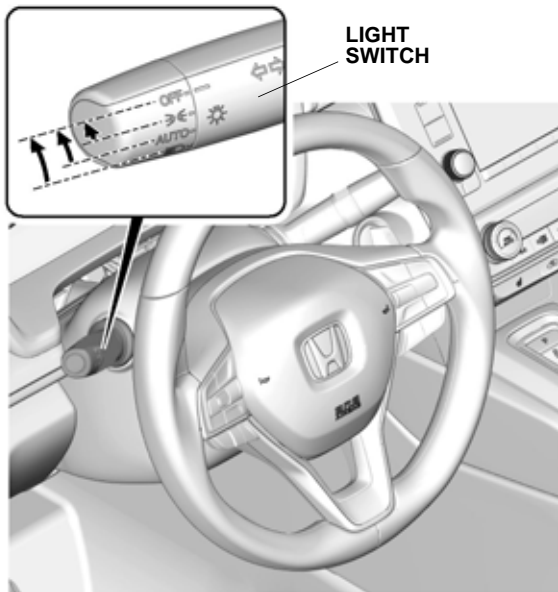

QGN1628AT