



HONDA INSTALLATION INSTRUCTIONS

Accessory

SECURITY SYSTEM
P/N 08E50-TK6-100

Application

2009 FIT
(BASE MODEL)

Publications No.

All 39871

Issue Date

AUG 2008

The security system will only work if the vehicle is equipped with a keyless entry system.

PARTS LIST

Control unit

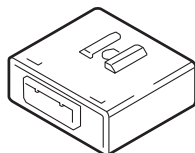

Security system label
(Give this label to your customer.)

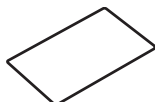

Security system bracket

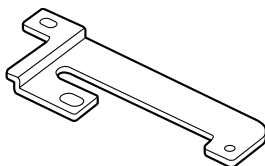

Security system harness

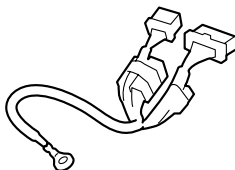

2 Self-tapping screws



20A Fuse blade

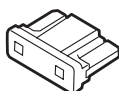

Wire tie A

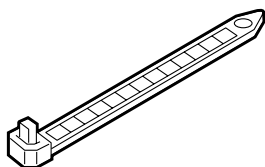

Fuse label (for kick panel)

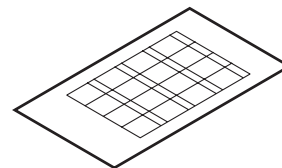

Ground bolt



Wire tie B

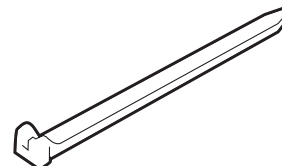

Fuse label (for harness fuse case)

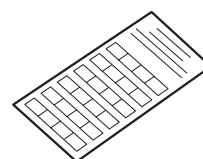

Accessory User's Information Manual

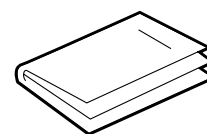

TOOLS AND SUPPLIES REQUIRED

Phillips screwdriver
Flat-tip screwdriver
Ratchet
10 mm Combination wrench
Diagonal cutters
Shop towel
Isopropyl alcohol
Utility knife
File

Illustration of the Security System Installed on the Vehicle

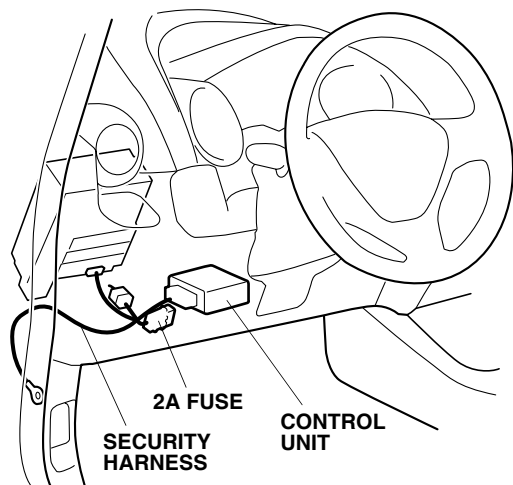

INSTALLATION

Customer Information: The information in this installation instruction is intended for use only by skilled technicians who have the proper tools, equipment, and training to correctly and safely add equipment to your vehicle. These procedures should not be attempted by “do-it-yourselfers.”

1. Make sure you have the anti-theft code for the audio unit, then write down the radio presets.
2. Disconnect the negative cable from the battery.

3. Under the dash on the left side of the vehicle, turn the knob of the driver's dashboard cover counterclockwise. Remove the driver's dashboard under cover (one clip and two tabs).

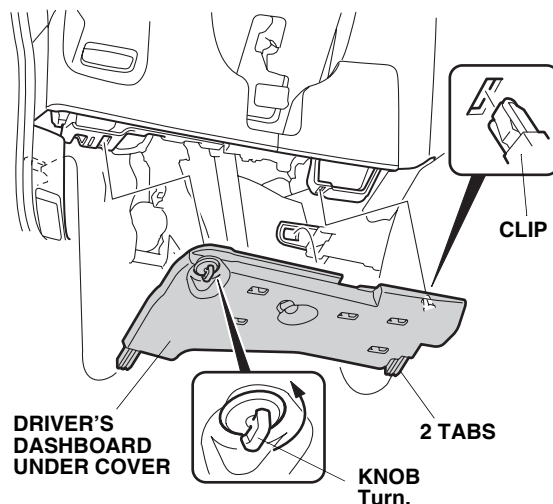

4. Pull away the door seal from the driver's kick panel, then remove the driver's kick panel (two clips and two tabs).

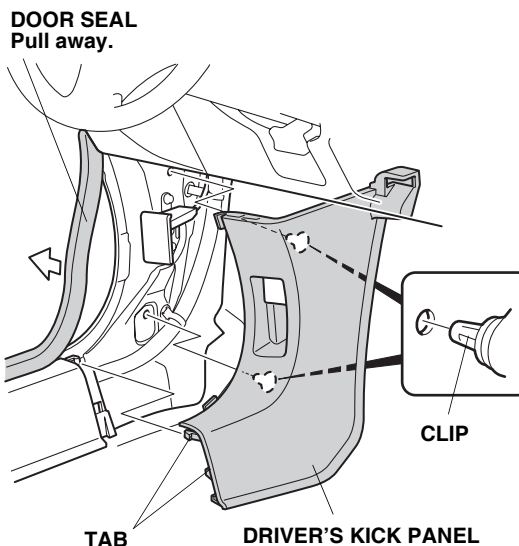

5. Remove the fuse access panel (five tabs, two clips and two hooks).

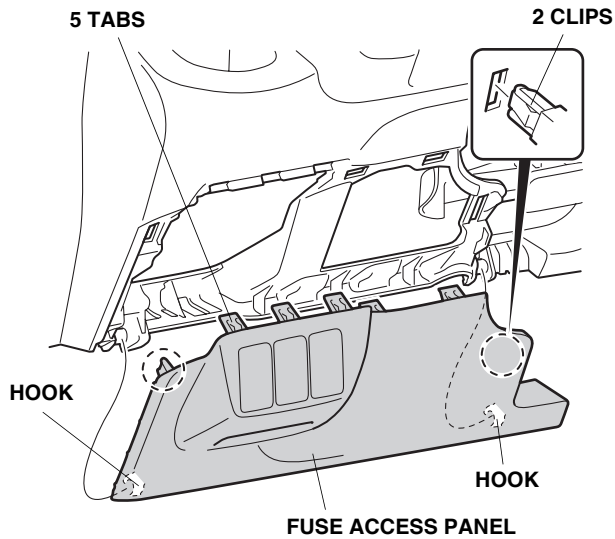

6. Insert the flat-tip screwdriver along the guide of the steering column lower cover, and release the retaining tabs of the column upper cover.

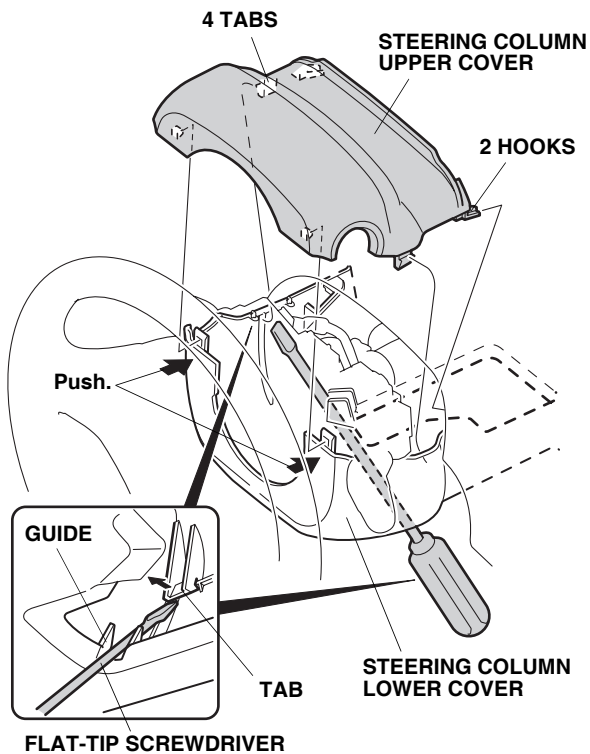

7. Remove the steering column upper cover (four tabs and two hooks).

8. Lower the tilt lever. Remove the steering column lower cover (three self-tapping screws).

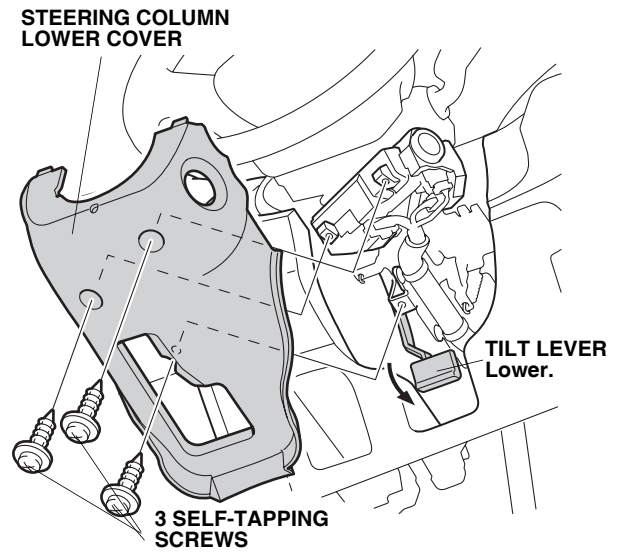

9. On the bottom of the steering column lower cover, cut off the small piece of the cover using a utility knife. Remove any burrs with a file.

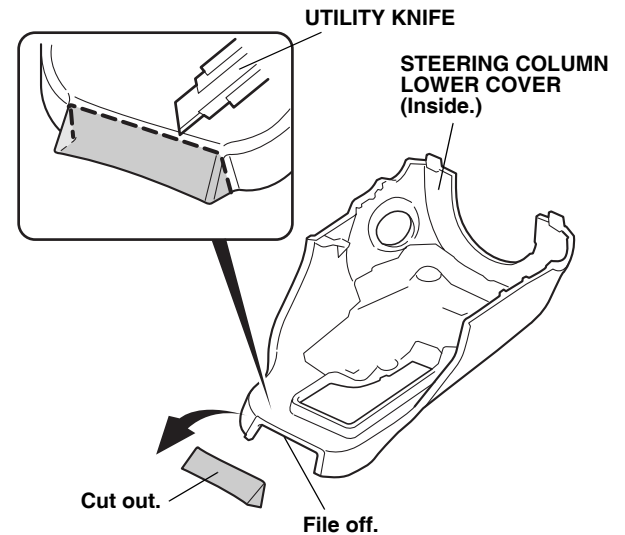

10. Using isopropyl alcohol, clean the area where the fuse label will attach.

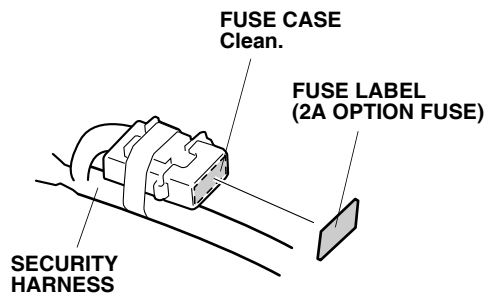

11. Attach the fuse label (2A OPTION FUSE) to the security system harness fuse case.

12. Plug the security system harness 8-pin connector into the fuse box in the location shown.

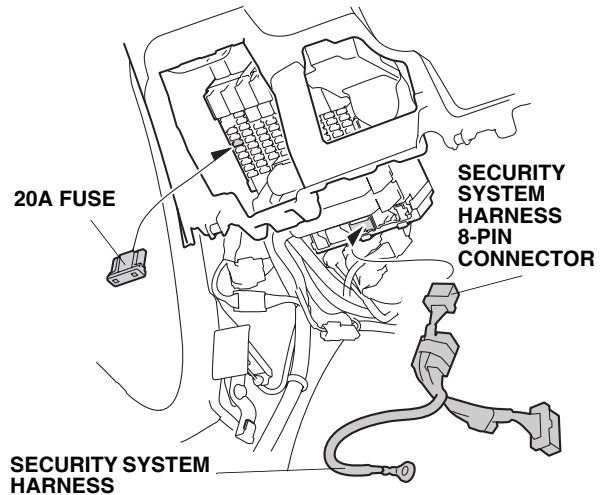
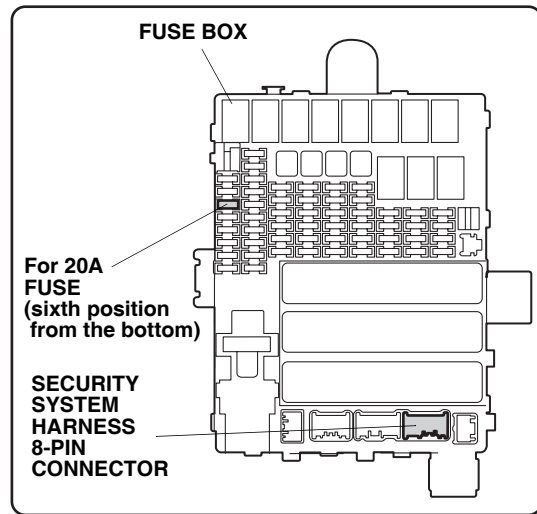

13. Install the 20A fuse to the fuse box in the location shown.

If another accessory connector is already plugged into the 8-pin connector of the fuse box: Unplug the other accessory connector, then remove the dummy connector and plug the other accessory connector to the security system harness 8-pin connector as shown.

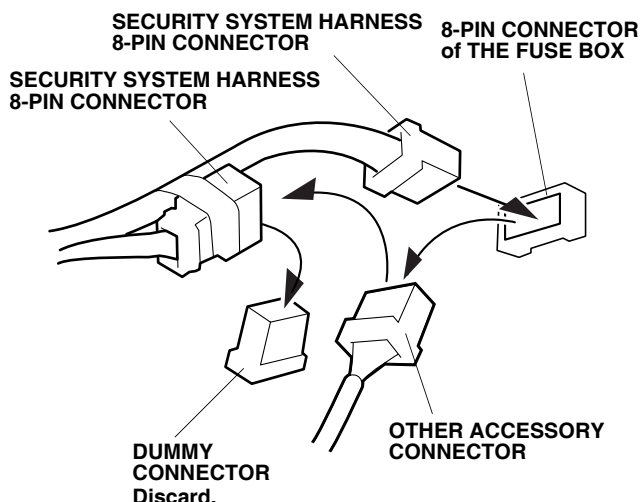

- If the vehicle is equipped with a remote engine starter, continue with step 14; otherwise, go to step 16.

14. Remove the tape that secures the 2-pin connector to the remote engine starter harness as shown.

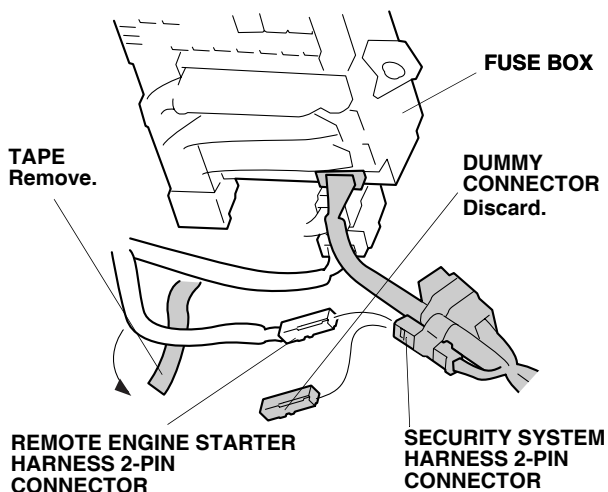

15. Remove the dummy connector from the security system harness 2-pin connector and plug the remote control engine starter harness 2-pin connector to the security system harness 2-pin connector.

16. Remove the upper hood release lever bolt. Using the ground bolt, attach the security system harness terminal to the vehicle panel as shown.

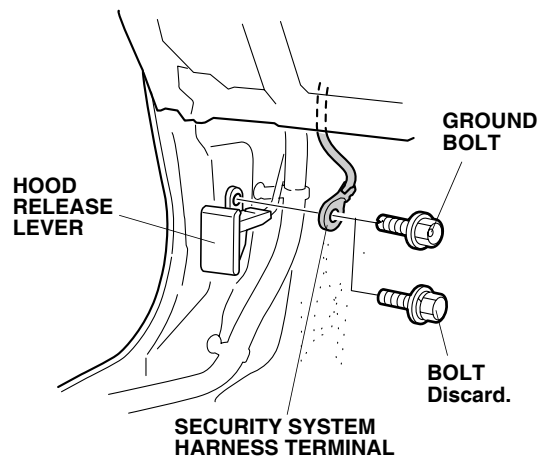

17. Using one wire tie A, secure the security system harness to the vehicle harness at the green tape location.

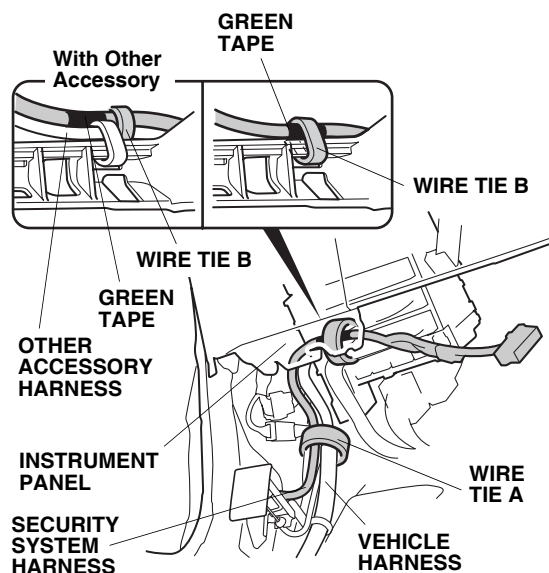

18. Using one wire tie B, secure the security system harness to the instrument panel as shown.

If the vehicle is equipped with another accessory, use one wire tie B to secure the security system harness to the other accessory.

19. Install the control unit to the security system bracket.

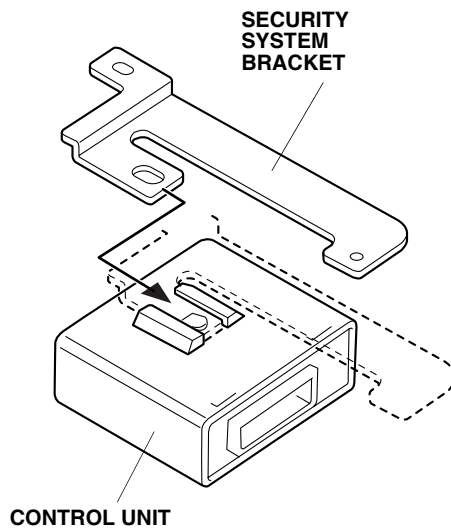

20. Using diagonal cutters, cut off the areas shown from the driver's dashboard under cover.

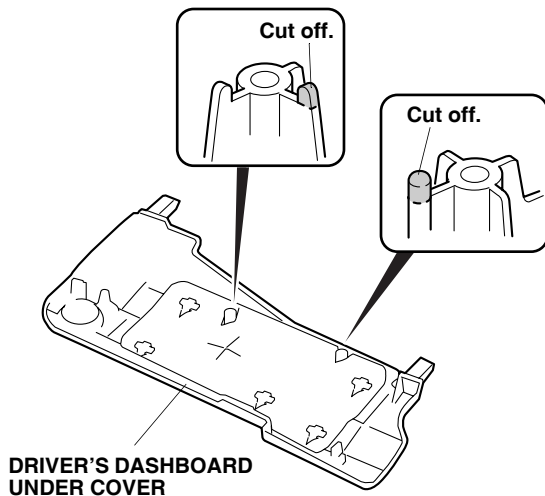

21. Install the security system bracket to the driver's dashboard under cover using two self-tapping screws.

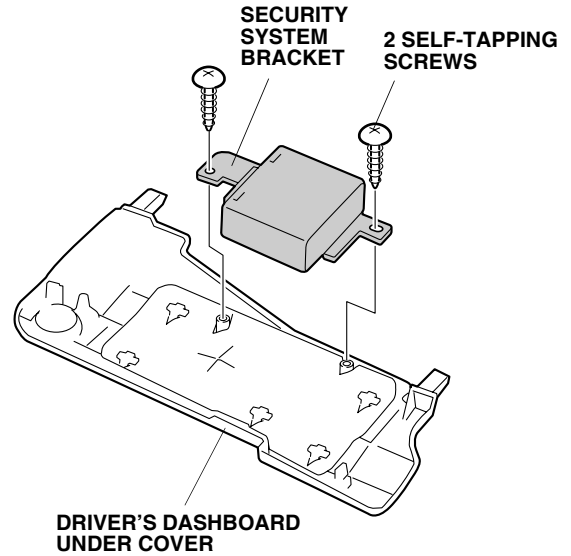

22. Plug the security system harness 18-pin connector to the control unit. Reinstall the driver's dashboard under cover.

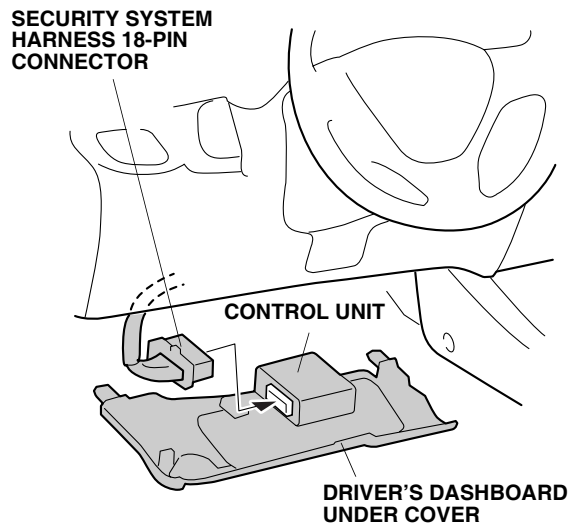

23. Using isopropyl alcohol on a shop towel, clean the area where the fuse label will attach.

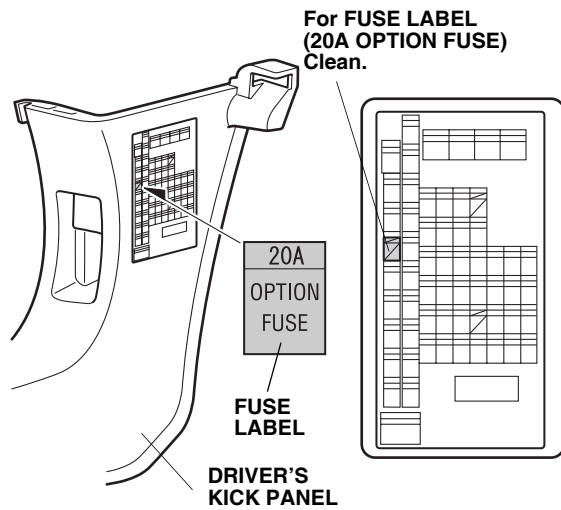

24. Attach the fuse label (20A OPTION FUSE) to driver's kick panel as shown.
25. Reinstall all removed parts.
26. Reconnect the negative cable to the battery.
27. Enter the anti-theft codes for the audio unit and enter the customer's radio presets.
28. Reset the clock.
29. Check operation of the security system according to the accessory user's information manual.