



# INSTALLATION INSTRUCTIONS

Accessory  
**CARGO NET**

Application  
**2008 FIT**

Publications No.  
**All 37451**  
Issue Date  
**JULY 2007**

Put this information in the glove box with the vehicle owner's manual.

## PARTS LIST

Cargo net

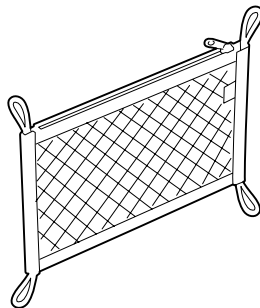

4 Snaps



2 Straps



## INSTALLATION

NOTE: The cargo net can be installed in 2 different positions, horizontally or vertically.

1. Attach the four snaps onto the cargo net as shown.

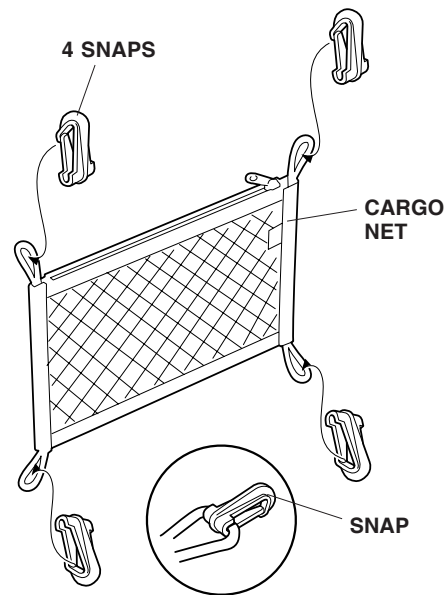

### Installation in the Horizontal Position

2. Attach the snaps to the tie-down hooks in the trunk.

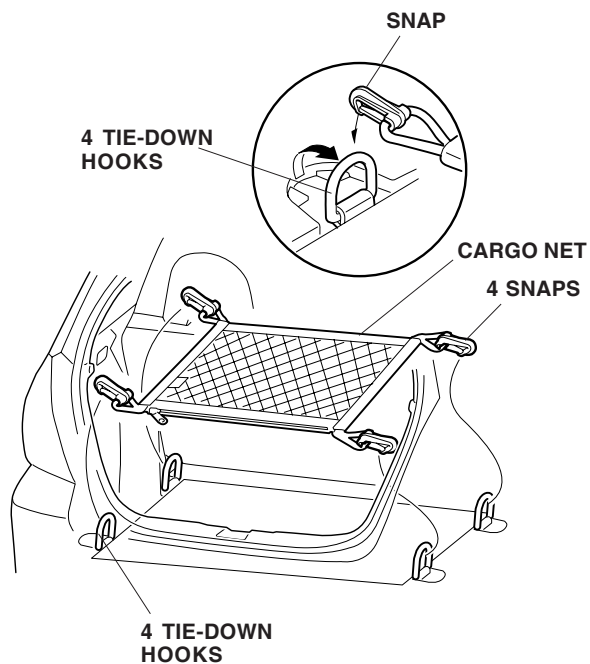

### Installation in the Vertical Position

3. Remove the screws from the body. Attach the straps to the body with the screws.
4. Attach the snaps to the tie-down hooks and straps.

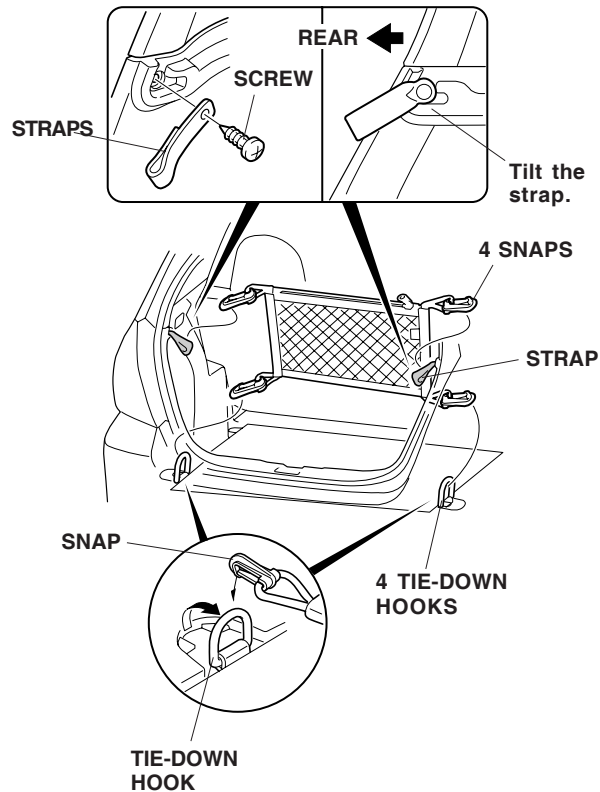

### NOTE

- Do not store large or fragile objects in the net.
- Do not store objects with sharp edges or corners, as they may damage the cargo net or the vehicle. Wrap such objects in paper or a blanket so they will not contact the net directly.