



HONDA INSTALLATION INSTRUCTIONS

Accessory

NOSE MASK
P/N 08P35-SZT-100B

Application

2016 CR-Z

Publications No.

VERSION 1

Issue Date

OCT 2015

PARTS LIST

Mask

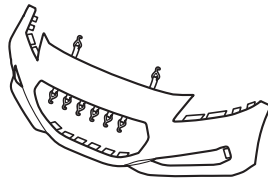

4 Snap-screws



Storage bag

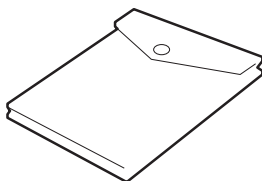

TOOLS AND SUPPLIES REQUIRED

Stubby Phillips screwdriver

Illustration of the Nose Mask on the Vehicle

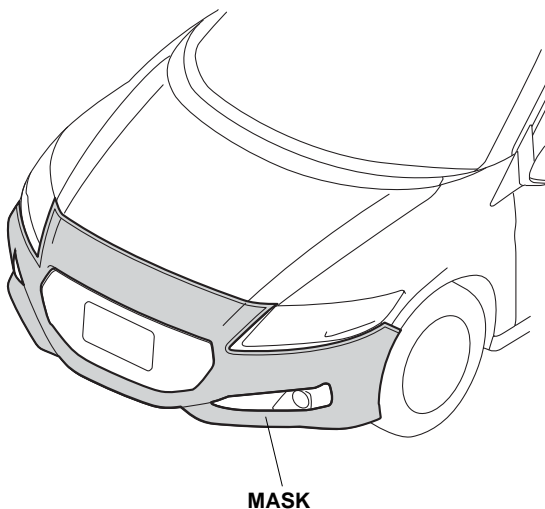

QE62201AN

INSTALLATION

Customer Information: The information in this installation instruction is intended for use only by skilled technicians who have the proper tools, equipment, and training to correctly and safely add equipment to your vehicle. These procedures should not be attempted by "do-it-yourselfers."

NOTE:

- Make sure the vehicle and nose mask are clean and completely dry before installation. If moisture under the mask is allowed to dry, it may cloud the paint. If the mask gets wet, remove and allow it to air-dry completely.
- Make sure any repainted surfaces are cured.
- Make sure the nose of the vehicle have been waxed with a high-quality paste wax.
- Make sure to install the nose mask securely. If the nose mask starts to flap or comes loose while driving, safely pull to the side of the road, stop the vehicle, and secure or remove the nose mask. Make sure your customer is aware of this.

1. Turn the steering wheel fully clockwise.

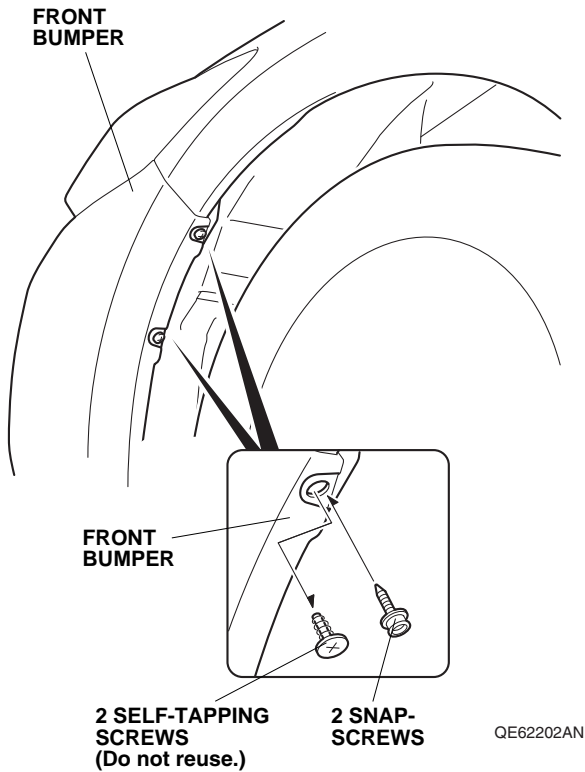

2. Remove and discard the two self-tapping screws from the front bumper.
3. Install the two snap-screws to the front bumper.
4. Turn the steering wheel fully counterclockwise, and repeat steps 2 and 3 on the right side.

5. Open the hood. Hook the pocket on the mask onto the corner of the front bumper. Repeat on the right side.

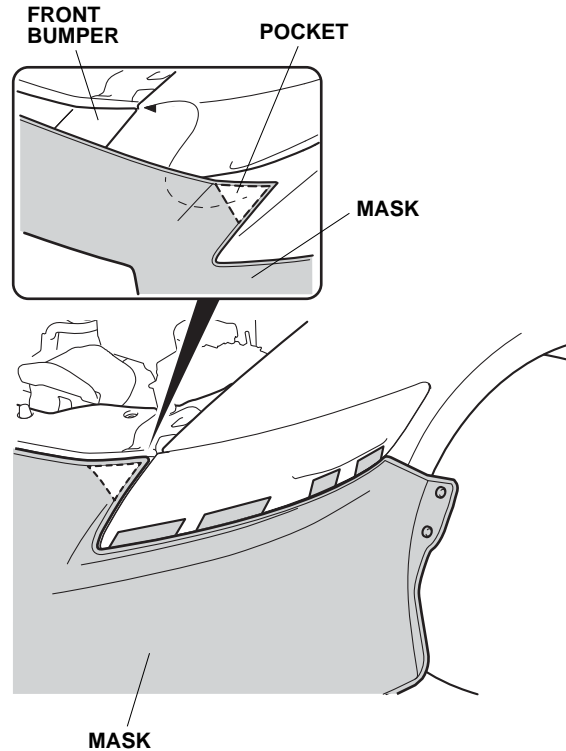

6. Pull the mask back toward the left front inner fender, smooth out any wrinkles, and secure two snaps on the mask to the two snap-screws.

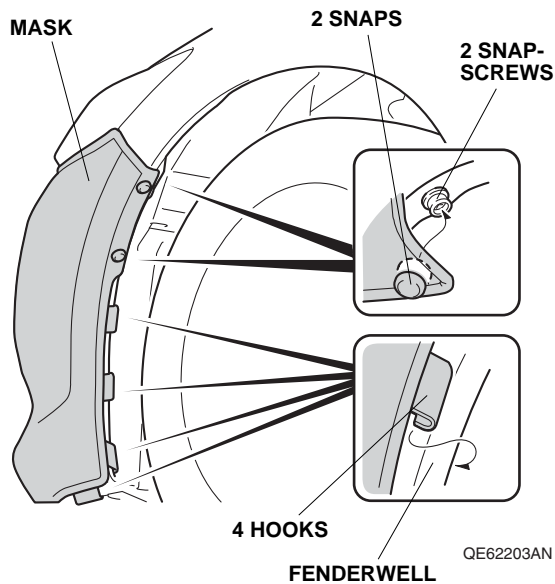

7. Secure four hooks on the mask to the left front fenderwell.
8. Repeat steps 6 and 7 on the right side.
9. Insert four tabs under the left headlight. Repeat on the right side.

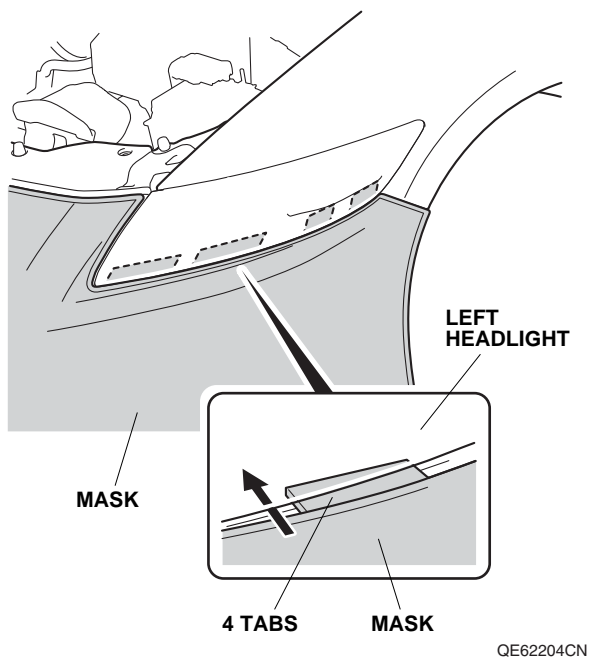

10. Insert four tabs into the left fog light trim. Repeat on the right side.

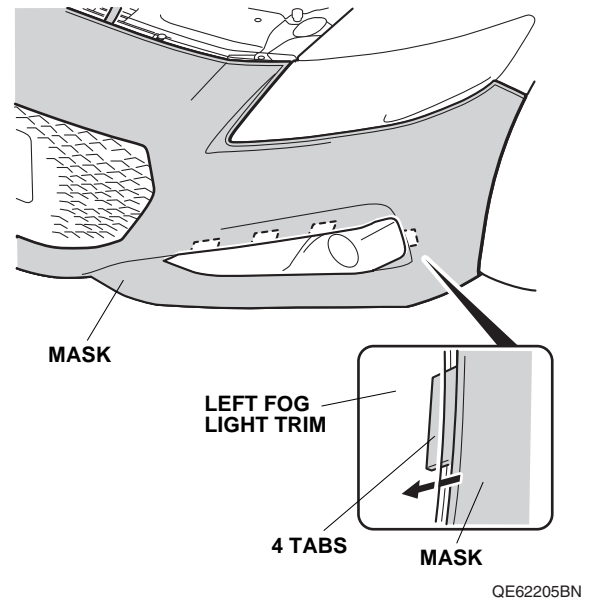

11. Attach six hooks to the front grille as shown.

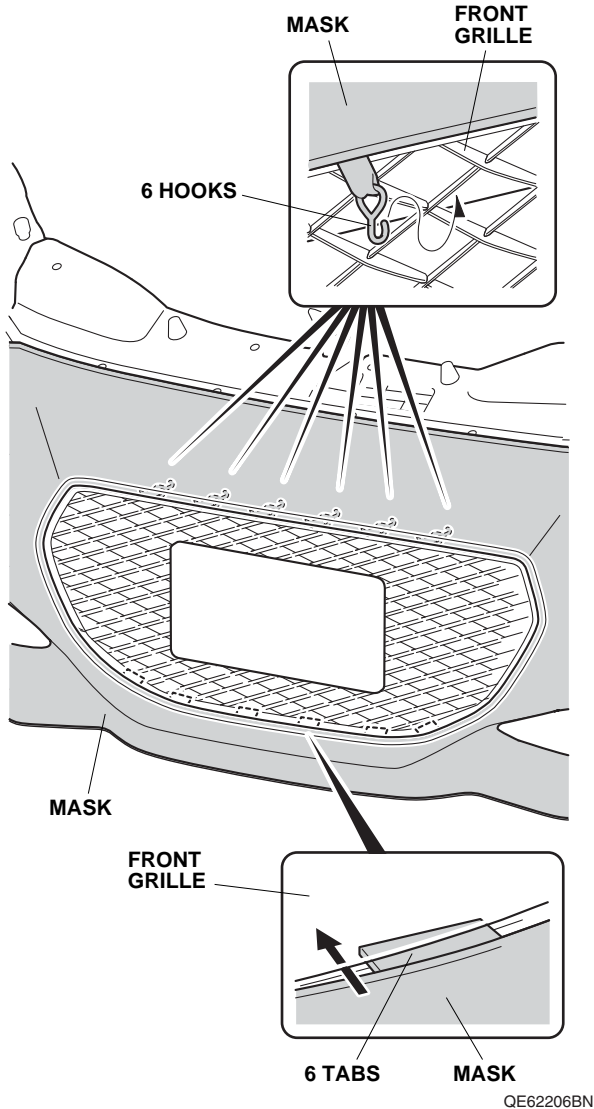

12. Insert six tabs under the front grille.

13. Attach two hooks to the front grille cover as shown.

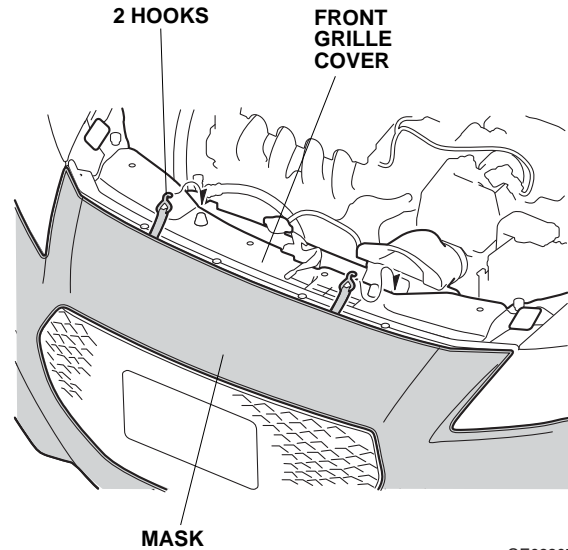

14. Close the hood, and adjust the position of the mask to the hood.

CLEANING THE NOSE MASK

Use a sponge or cloth and a solution of mild liquid dishwashing soap and water to clean the vinyl and the flannel backing. Rinse the mask completely with clean water, and hang it to dry out of direct sunlight. Make sure the mask is completely dry before you reinstall it.