



## HONDA INSTALLATION INSTRUCTIONS

### Accessory

SIDE HFP EMBLEMS  
P/N 08F20-TS9-100A

### Application

2017 CIVIC  
5-DOOR

### Publications No.

VERSION 1

### Issue Date

SEP 2016

### PARTS LIST

2 HFP emblems



### TOOLS AND SUPPLIES REQUIRED

Shop towel

Isopropyl alcohol

Masking tape

Ruler

### Illustration of the Side HFP Emblems Installed on the Vehicle

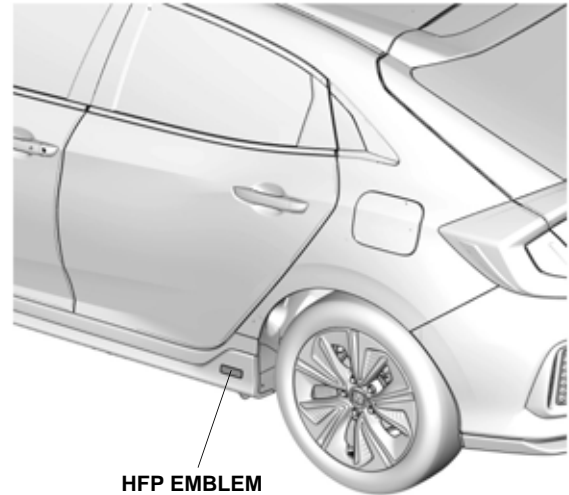

HFP EMBLEM

QF42801BT

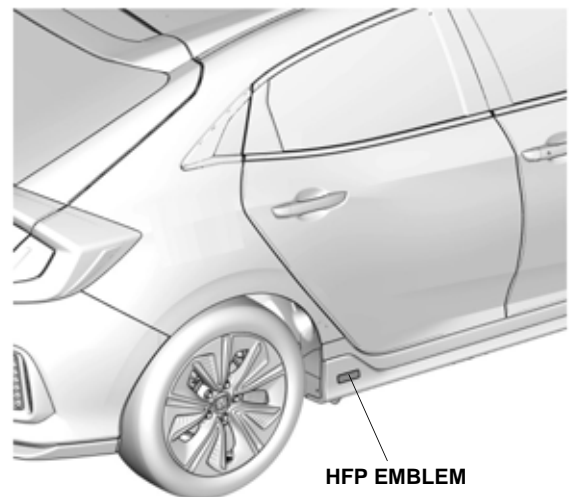

HFP EMBLEM

QF42802BT

## INSTALLATION

**Customer Information:** The information in this installation instruction is intended for use only by skilled technicians who have the proper tools, equipment, and training to correctly and safely add equipment to your vehicle. These procedures should not be attempted by "do-it-yourselfers."

### NOTE:

- Be careful not to damage the vehicle body paint finish.
- This kit should be installed only if the ambient air temperature is 15°C (60°F) or above.
- To allow the adhesive to cure, do not wash the vehicle for 24 hours. Make sure your customer is aware of this.

### Installing the HFP Emblems

1. Apply masking tape to the left side sill trim as shown.

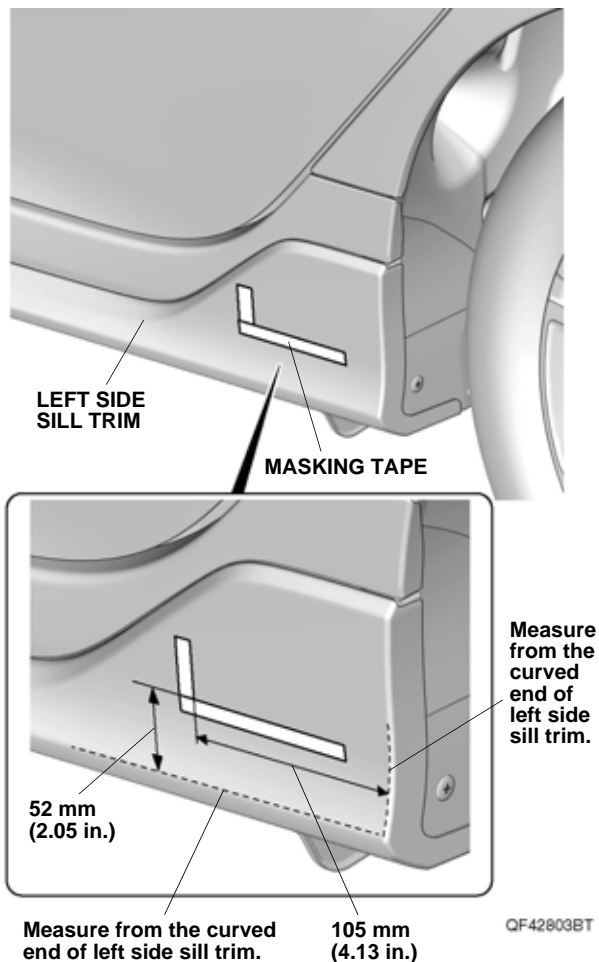

2. Using isopropyl alcohol on a shop towel, thoroughly clean the left side sill trim where the HFP emblem will attach.

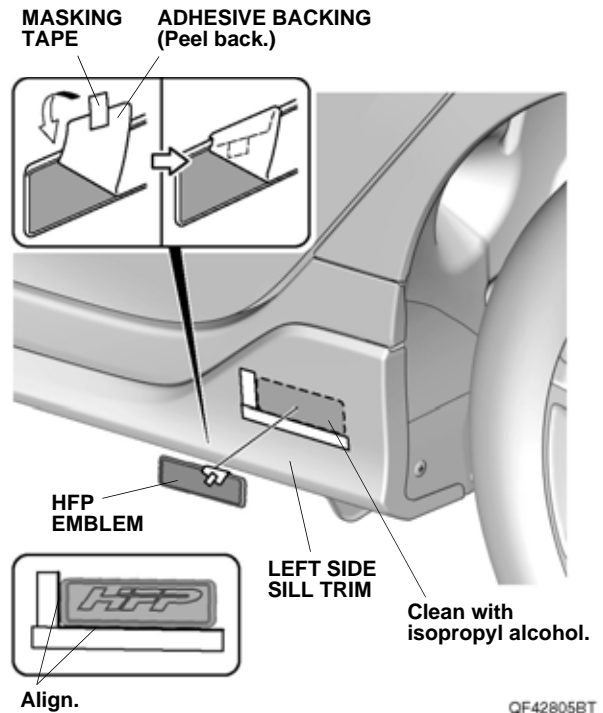

3. Peel back the adhesive backing, and tape it to the front surface of the HFP emblem as shown.
4. Attach the HFP emblem to the left side sill trim.

5. Gently hold the HFP emblem against the left side sill trim and remove the adhesive backing.

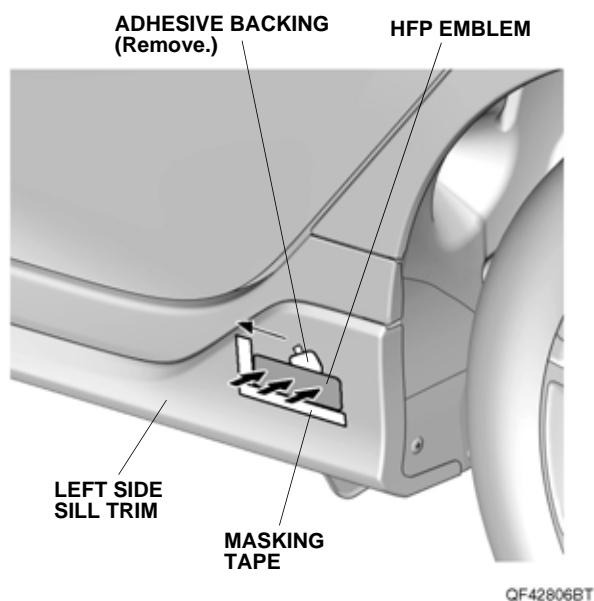

6. Using the palm of your hand, firmly press the HFP emblem against the left side sill trim for 30 seconds.
7. Remove the masking tape.
8. Repeat steps 1 through 7 to install the HFP emblem on the right side of the vehicle.