



## HONDA INSTALLATION INSTRUCTIONS

### Accessory

**AMBIENT LIGHTS**  
P/N 08E10-T2A-100A

### Application

**2013 ACCORD**  
4-DOOR

### Publications No.

**All 13002**

### Issue Date

**AUG 2012**

## PARTS LIST

bracket

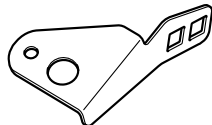

Ambient light harness

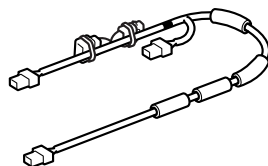

2 Ambient lights

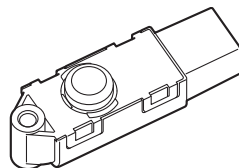

Fuse label

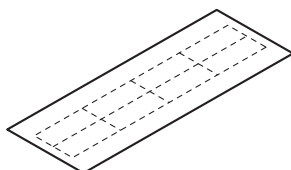

Wire tie with clip

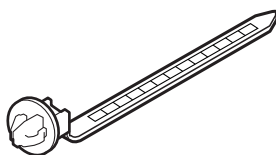

5 Wire ties

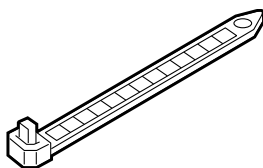

2 Screw grommets



2 Self-tapping screws, 5 x 16 mm



2 Self-tapping screws, 4 x 12 mm



Template

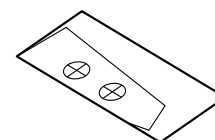

## TOOLS AND SUPPLIES REQUIRED

10 mm Open end wrench

Diagonal cutters

Phillips screwdriver

Masking tape

Drill

3 mm, 5 mm, and 7 mm Drill bits

File

Eye protection (face shield, safety goggles, etc.)

Pushpin

Steel wire

Electrical tape

Scissors

Isopropyl alcohol

Shop towel

*The following tool is available through the Honda Tool and Equipment Program. On the iN, click on: Service > Service Bay > Tool and Equipment Program, then enter the number under "Search." Or, call 888-424-6857.*

- Trim Tool Set (T/N SOJATP2014)

## Illustration of the Ambient Lights in the Vehicle

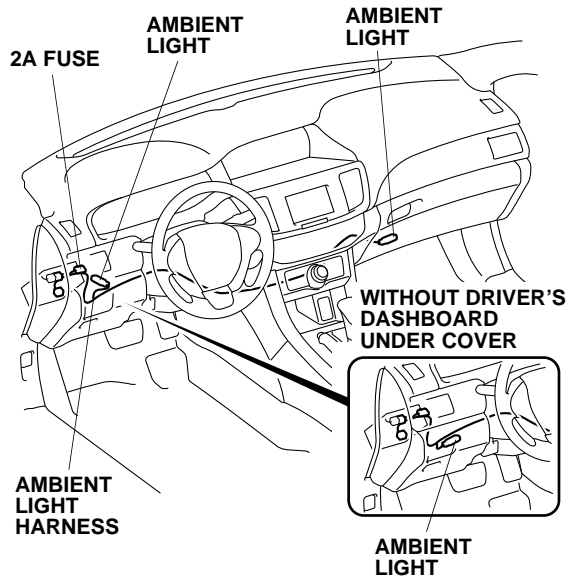

## INSTALLATION

**Customer Information:** The information in this installation instruction is intended for use only by skilled technicians who have the proper tools, equipment, and training to correctly and safely add equipment to your vehicle. These procedures should not be attempted by "do-it-yourselfers."

1. Disconnect the negative cable from the battery.
2. Remove the passenger's under cover (four clips and two pins).

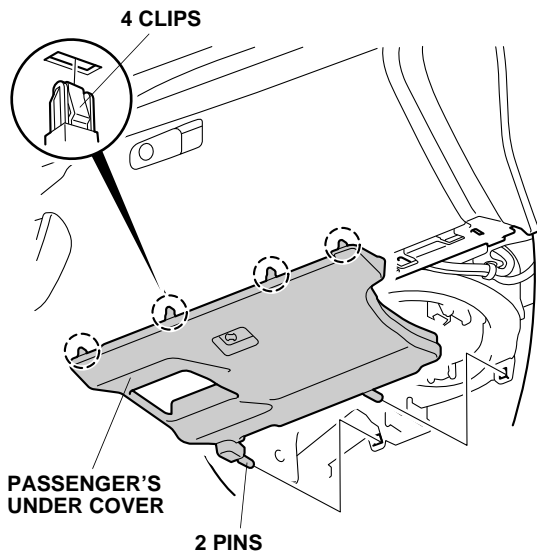

3. If equipped, remove the driver's dashboard under cover (turn the knob and release the two clips).

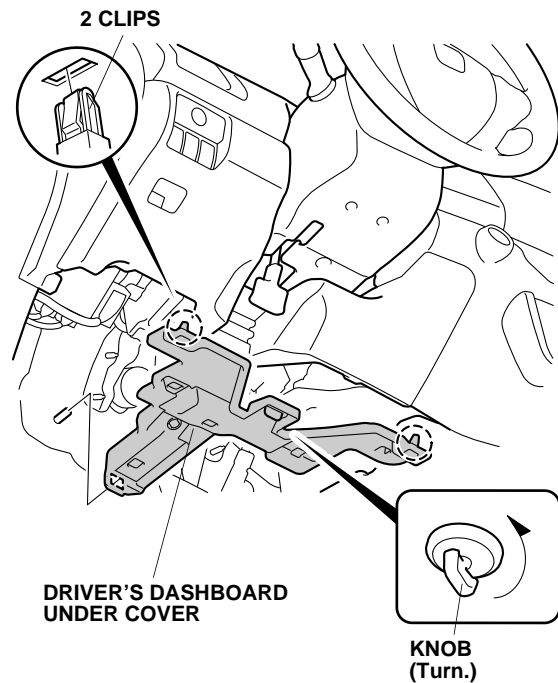

4. Remove the driver's dashboard lower cover (nine clips and unplug the vehicle connectors).

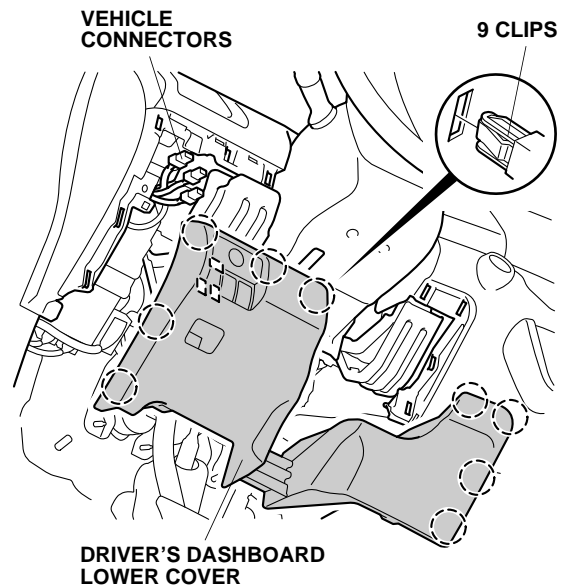

- Using isopropyl alcohol on a shop towel, thoroughly clean the fuse case where the fuse label will attach. Attach the fuse label (2A FOOT LIGHT [ILLUMI+]) to the fuse case on the ambient light harness.

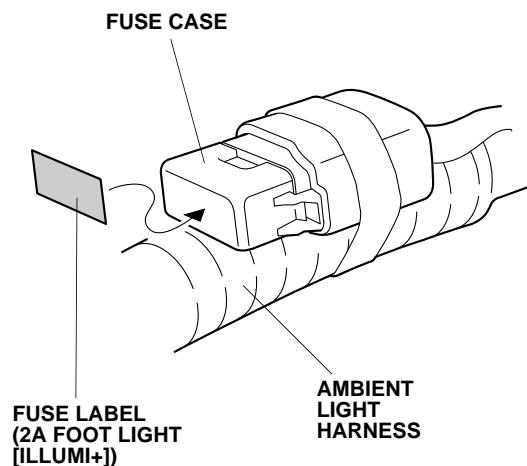

- Route the ambient light harness as shown.

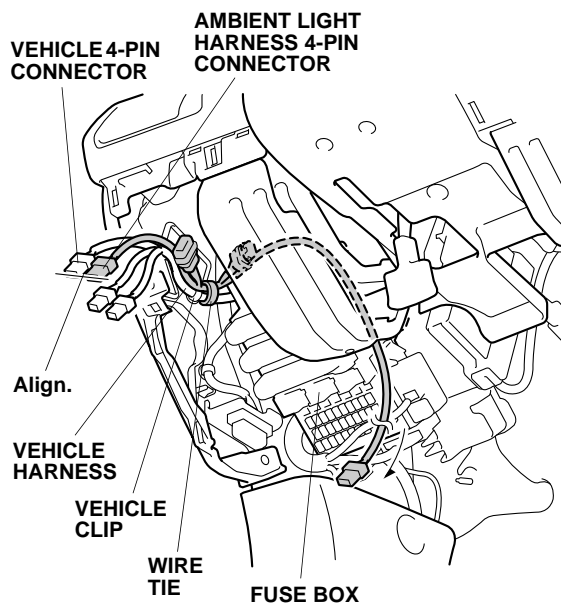

- Align the ambient light harness 4-pin connector with the vehicle 4-pin connector, and secure the ambient light harness to the vehicle harness with one wire tie.

- Plug the vehicle 4-pin connector into the ambient light harness 4-pin connector.

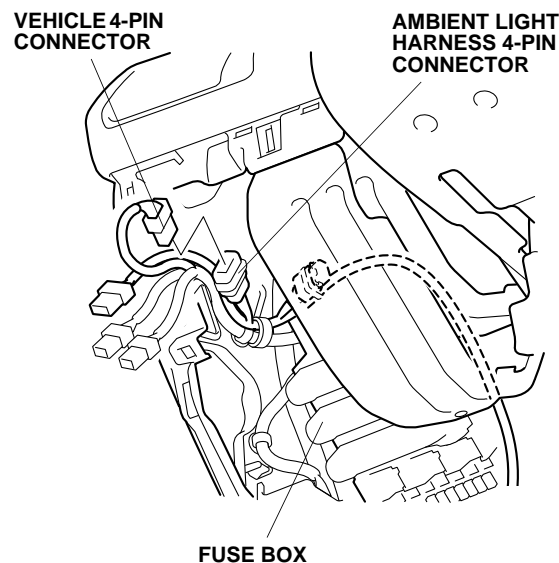

*If the vehicle is already equipped with another accessory harness, go to step 10; Otherwise, continue with step 9.*

- Attach one wire tie with clip around the green tape on the ambient light harness, then secure the harness to the hole in the vehicle panel with the clip. Go to step 12.

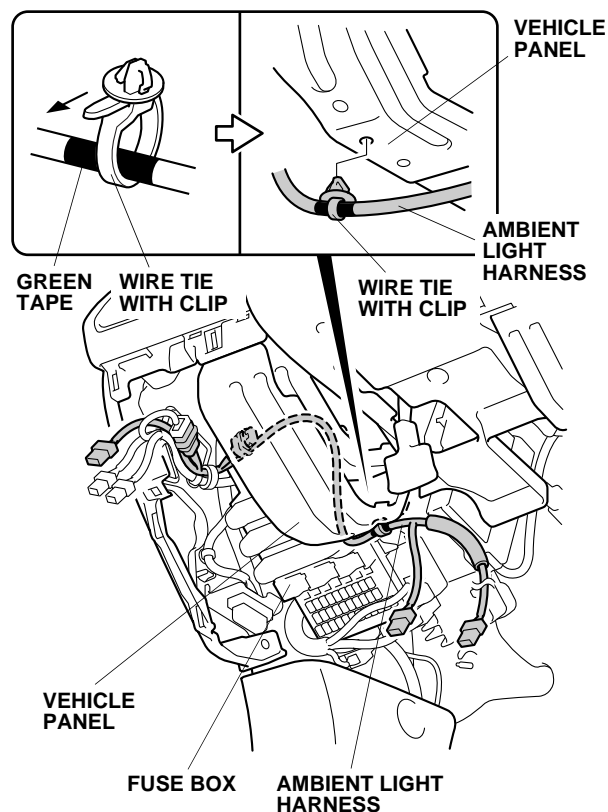

10. Using diagonal cutters, cut the clip portion off of one wire tie.

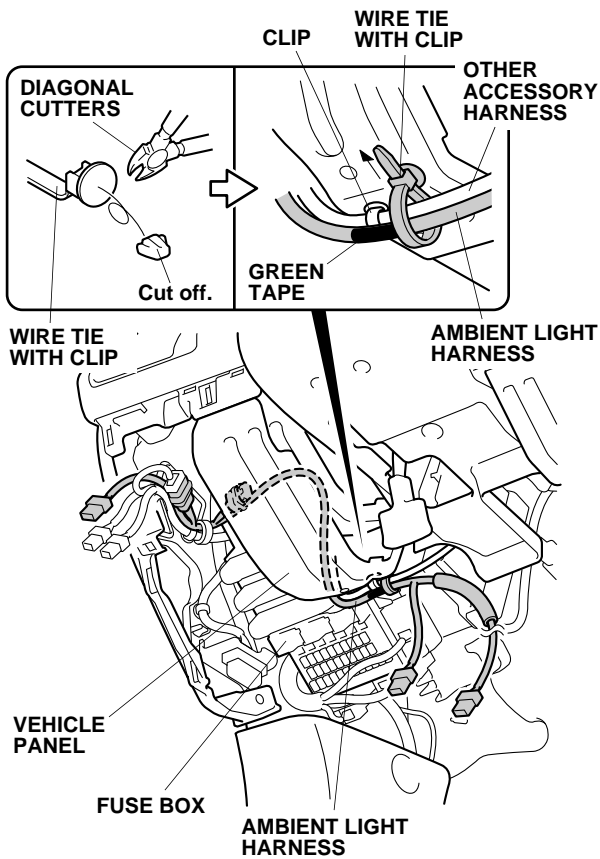

11. Attach the cut wire tie with clip around the green tape on the ambient light harness, and secure the ambient light harness to the other accessory harness with the wire tie with clip.
12. Secure the ambient light harness to the vehicle harness with one additional wire tie.

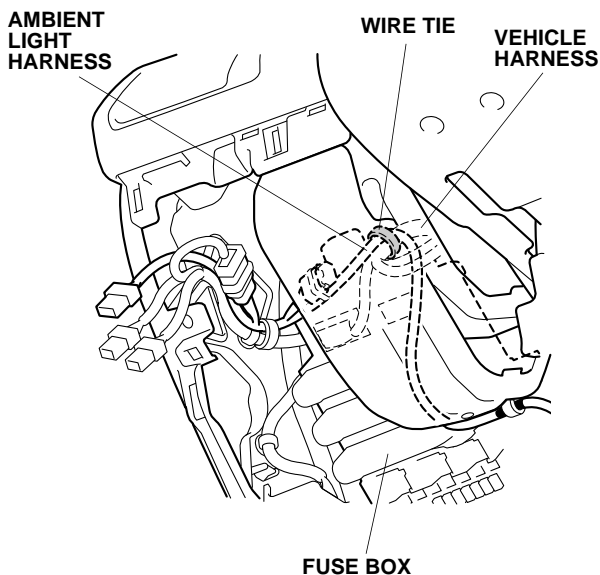

13. Release the driver's console side cover (one hook and one clip).
- NOTE: Do not damage the driver's console side cover.

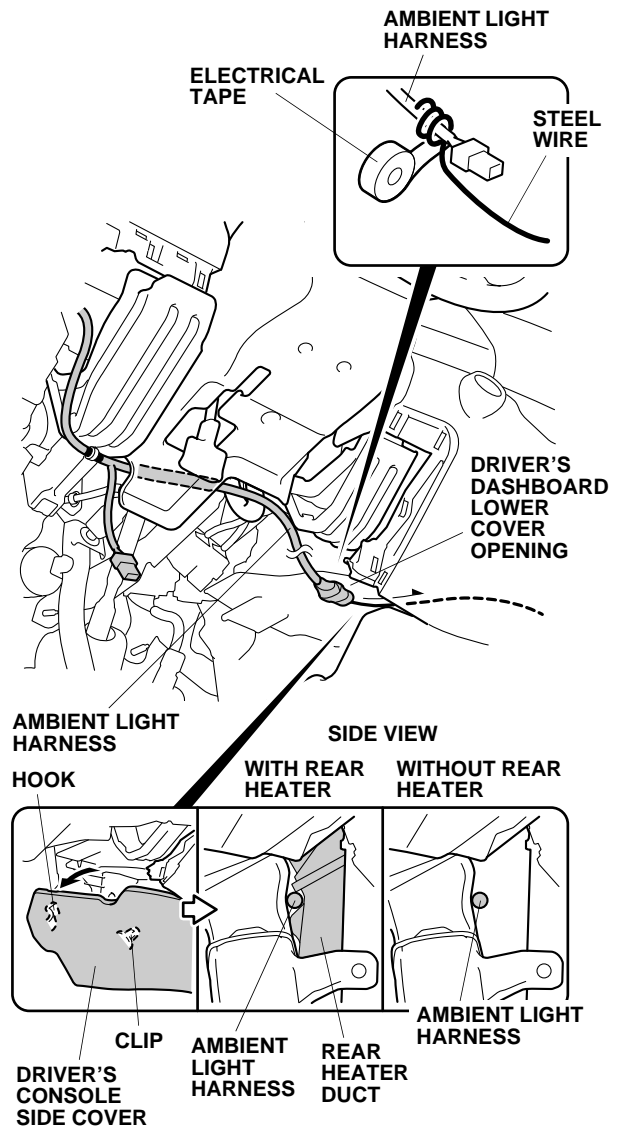

14. Attach a piece of steel wire to the ambient light harness with electrical tape. Route the ambient light harness through the center console from the driver's dashboard lower cover opening to the passenger's under cover opening.

15. Release the passenger's console side cover (two clips).  
NOTE: Do not damage the passenger's console side cover.

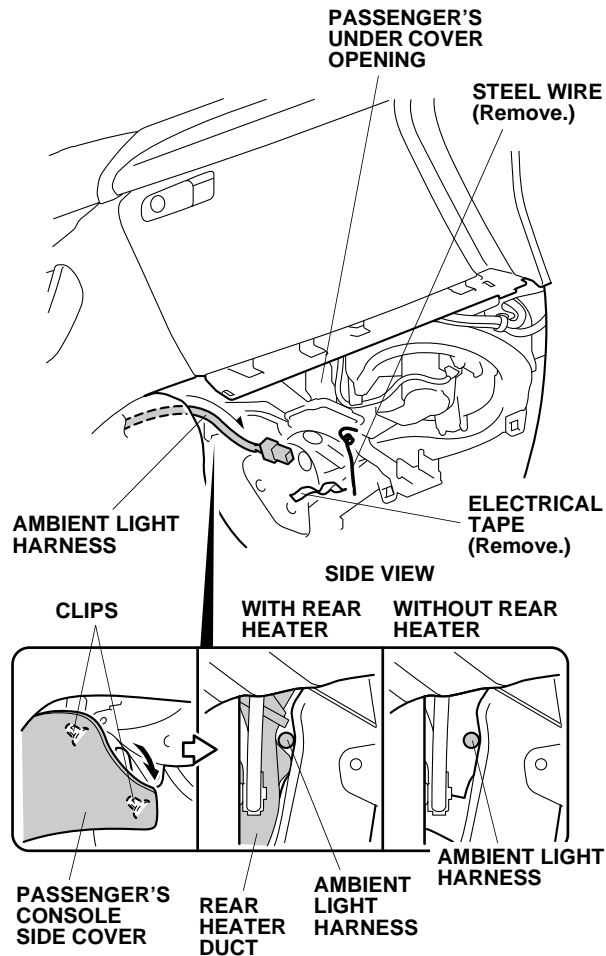

16. Route the ambient light harness as shown, then remove the electrical tape and steel wire.

17. Align the edge of the urethane tape on the ambient light harness with the vehicle frame as shown, and secure the ambient light harness to the vehicle frame with one wire tie.

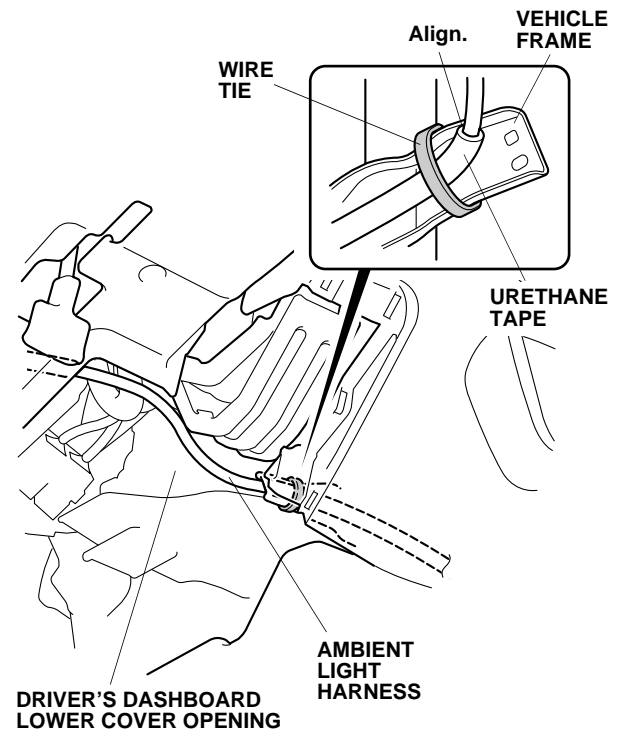

18. Secure the ambient light harness to the vehicle harness with one wire tie. Move the steering wheel up and down through its full adjustment range and make sure the harness is not being stretched.

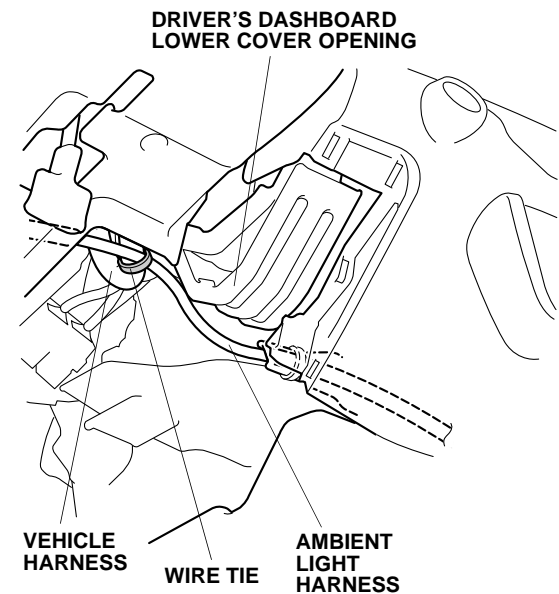

19. On the passenger's side of the vehicle, route and secure the ambient light harness to the vehicle harness with one wire tie.

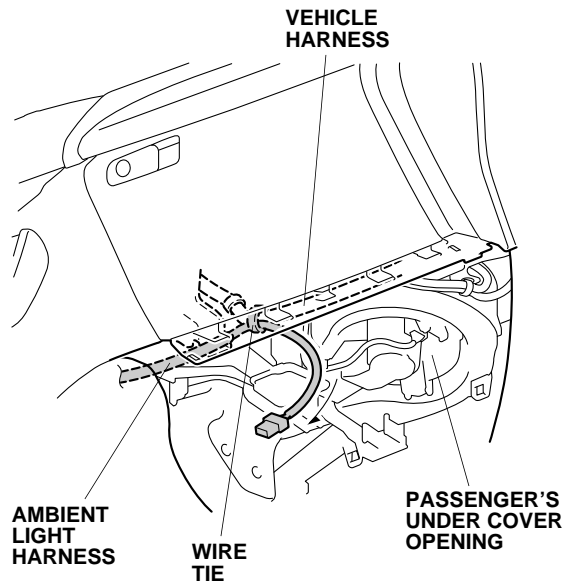

*If the vehicle is equipped with a driver's dashboard under cover, continue with step 20; Otherwise, go to step 25.*

20. Remove the insulator from the driver's dashboard under cover.

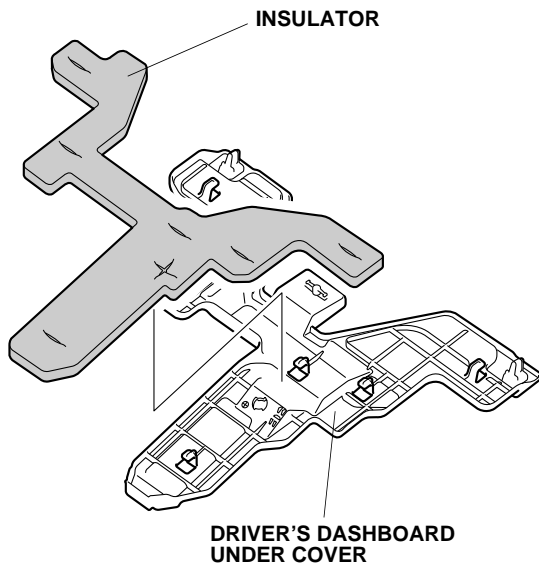

21. Using a pushpin, pierce the center of the scribe mark on the driver's dashboard under cover in the area shown.

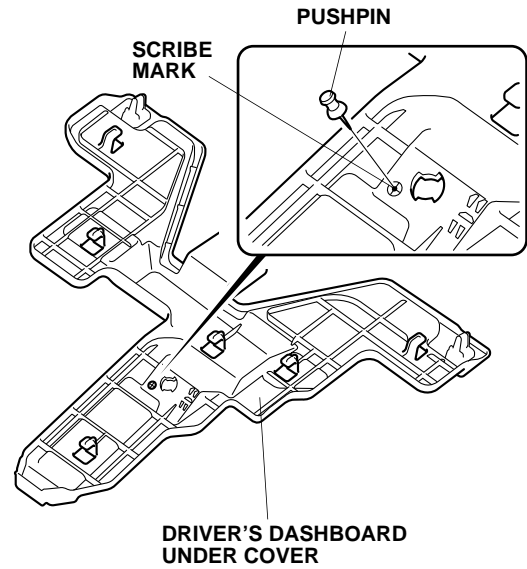

22. While wearing eye protection, drill the pierced mark on the driver's dashboard under cover with a 3 mm drill bit, then enlarge the hole to 5 mm using a 5 mm drill bit. Remove all burrs.

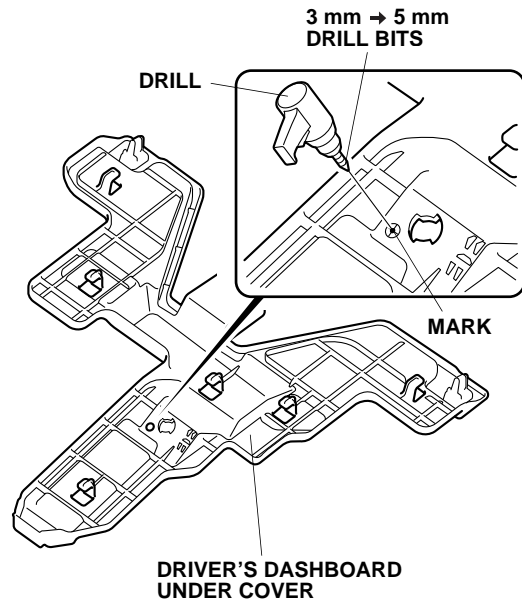

23. Install the ambient light to the driver's dashboard under cover with one 4 x 12 mm self-tapping screw.

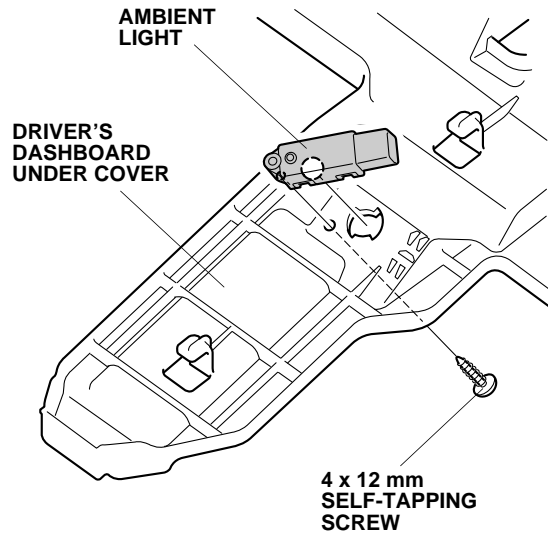

24. Reinstall the insulator. Go to step 33.  
25. Using scissors, cut out the template.

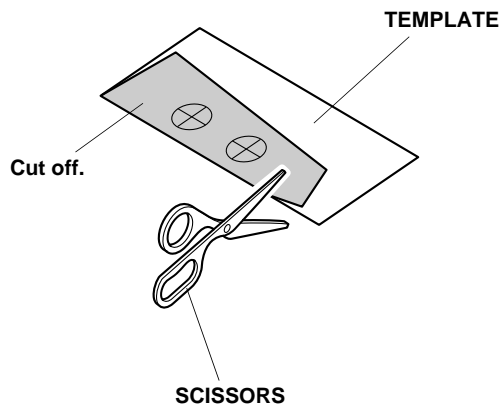

26. Attach the template to the driver's dashboard lower cover with masking tape.

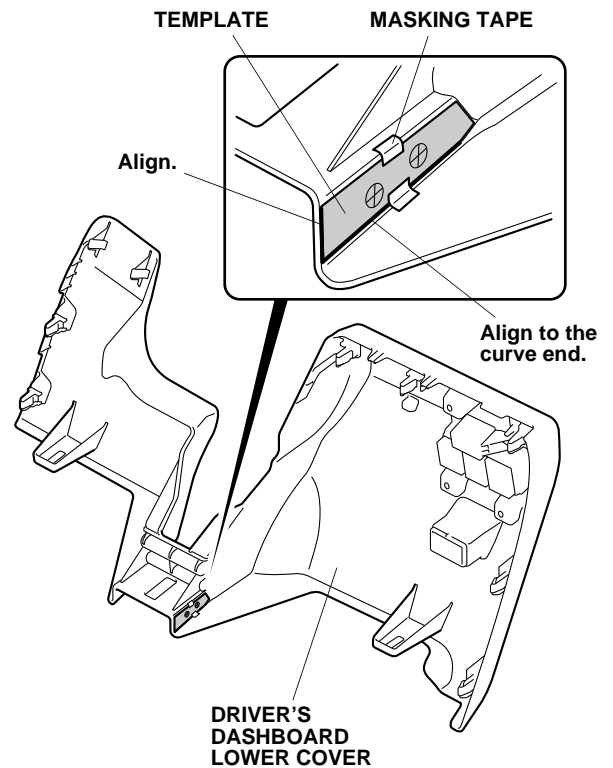

27. Using a pushpin, pierce the center of the two marks on the template.

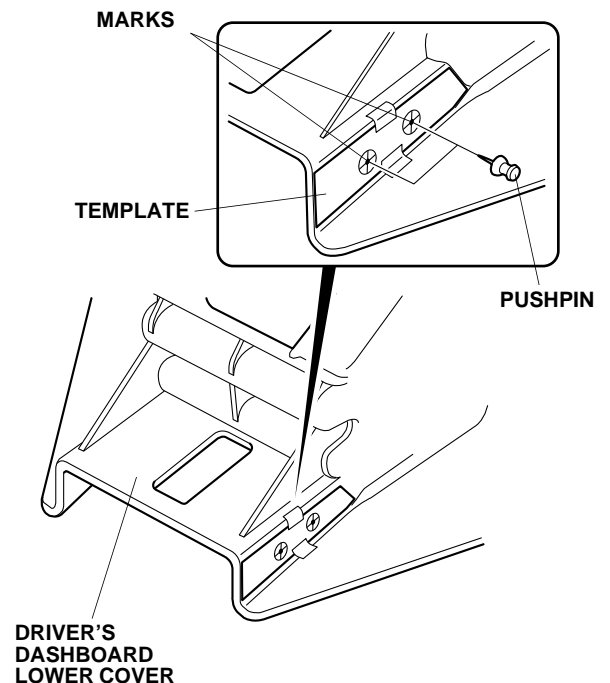

28. Remove the template.

29. While wearing eye protection, drill the two pierced marks on the driver's dashboard lower cover with a 3 mm drill bit, then enlarge the hole to 7 mm using a 7 mm drill bit. Remove all burrs.

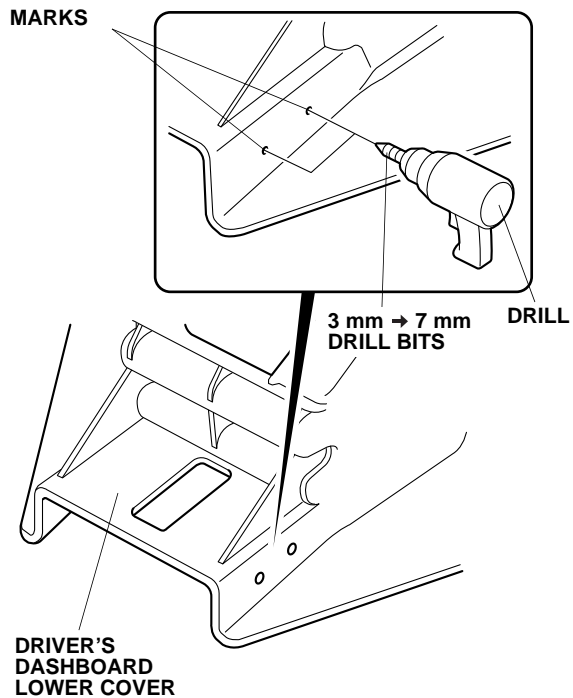

30. Get the two screw grommets and the bracket, and install the two screw grommets into the bracket.

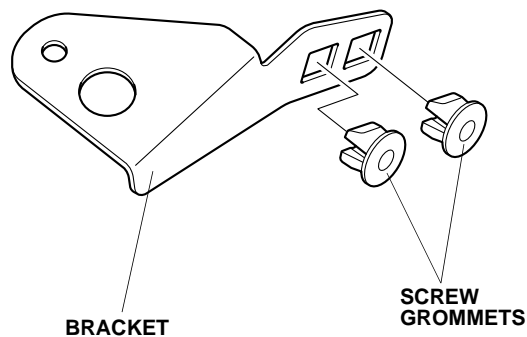

31. Install the ambient light to the bracket with one 4 x 12 mm self-tapping screw.

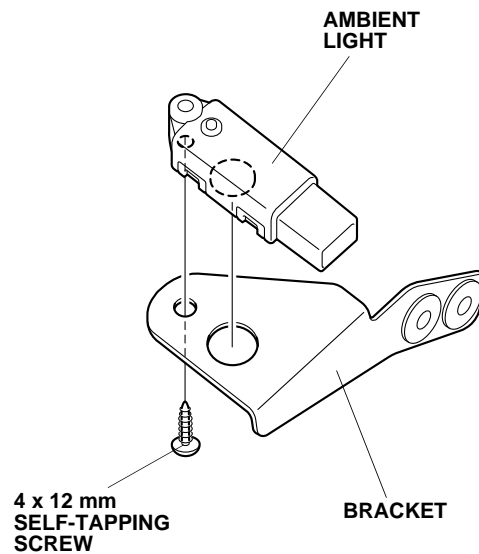

32. Install the bracket to the driver's dashboard lower cover with two 5 x 16 mm self-tapping screws.

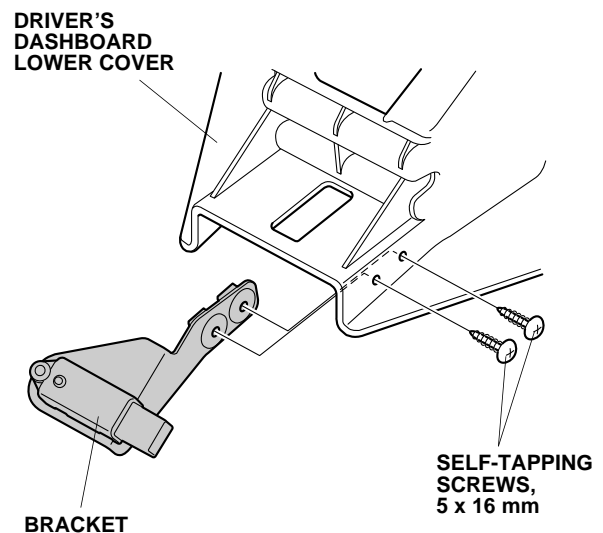



33. Using a pushpin, pierce the center of the scribe mark on the passenger's under cover.

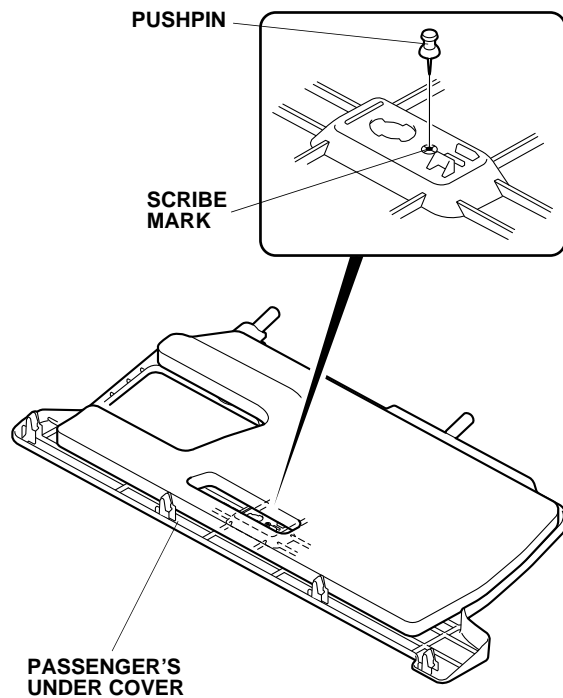

34. While wearing eye protection, drill the pierced mark on the passenger's under cover with a 3 mm drill bit, then enlarge the hole to 5 mm using a 5 mm drill bit. Remove all burrs.

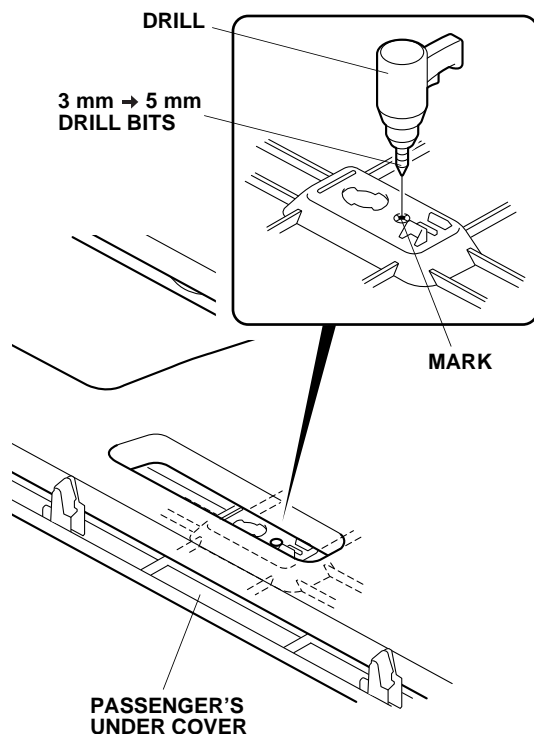

35. Install the ambient light to the passenger's under cover with one 4 x 12 mm self-tapping screw.

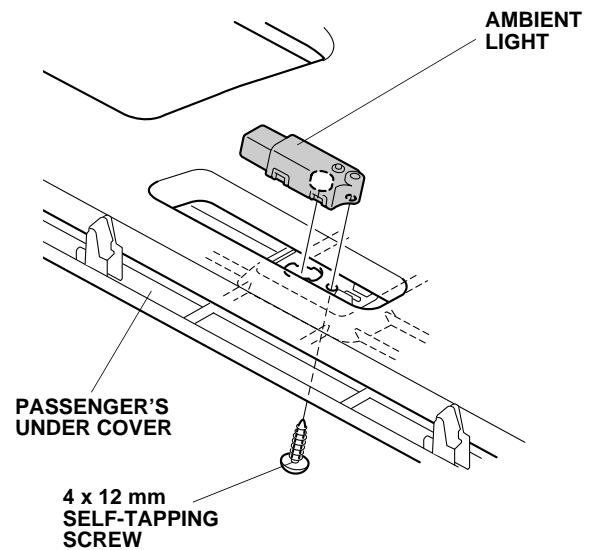

36. Plug the ambient light harness 4-pin connector into the ambient light, and reinstall the passenger's under cover.

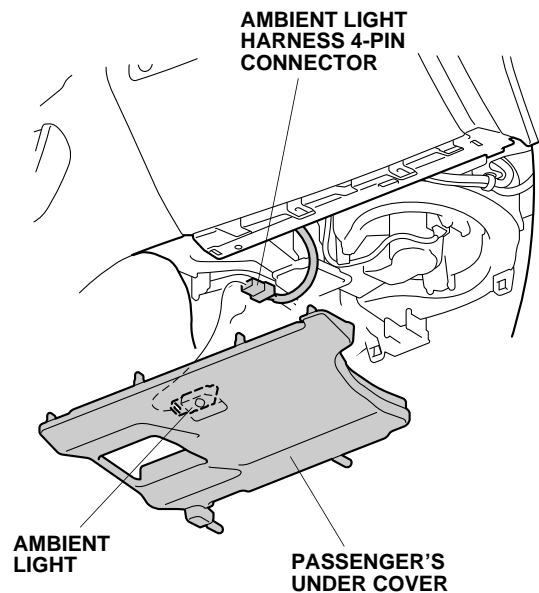

*If the vehicle is equipped with a driver's dashboard under cover, continue with step 37; Otherwise, go to step 39.*

37. Reinstall the driver's dashboard lower cover.

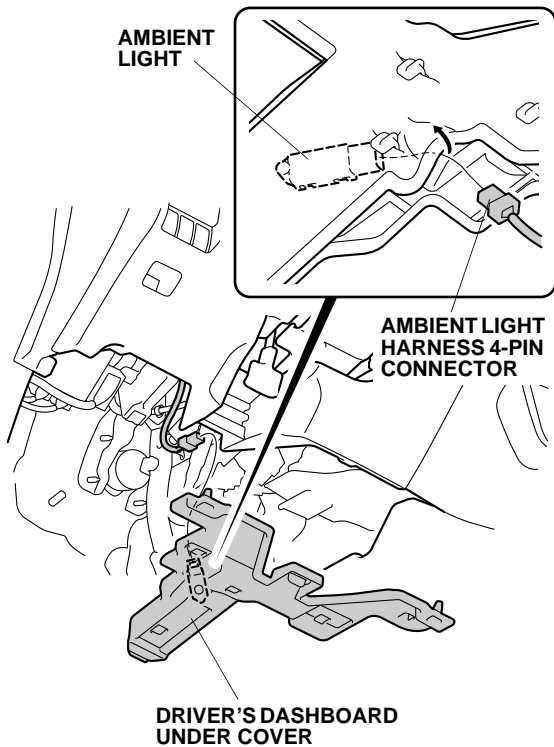

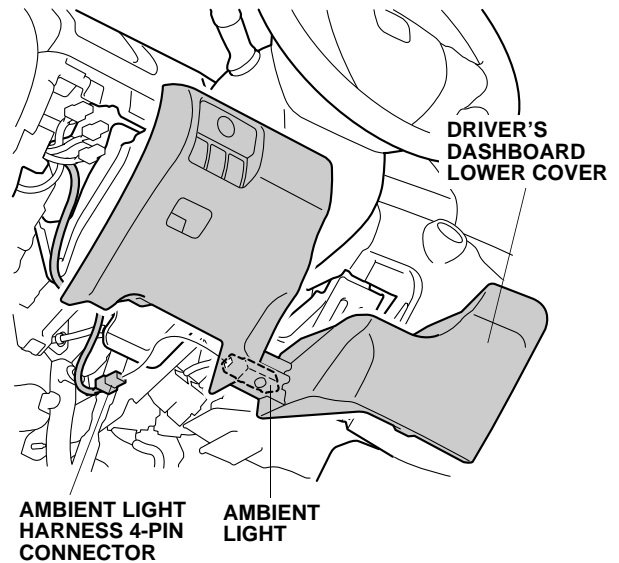

38. Plug the ambient light harness 4-pin connector into the ambient light, and reinstall the driver's dashboard under cover. Go to step 40.

39. Plug the ambient light harness 4-pin connector into the ambient light, and reinstall the driver's dashboard lower cover.

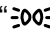

40. Check that all wire harnesses are routed properly and all connectors are plugged in.
41. Reconnect the negative cable to the battery.
42. Press and hold the radio power button for two seconds to restore the radio and navi (if equipped) system functions.
43. Reset the clock on vehicle without navigation.

## HOW TO OPERATE

- With the light switch set to the “” or “” position, the ambient lights are on.
- When the headlight switch is in the “AUTO” position, the ambient lights are on with the parking lights or headlights.
- If the ambient lights do not come on, check the fuse and all the connectors.

